



RECEIVED

11:11 am, Jul 21, 2010

Alameda County
Environmental Health

Aaron Costa
Project Manager
Marketing Business Unit

**Chevron Environmental
Management Company**
6111 Bollinger Canyon Road
San Ramon, CA 94583
Tel (925) 543-2961
Fax (925) 543-2324
acosta@chevron.com

Alameda County Health Care Services
1131 Harbor Bay Parkway, Suite 250
Alameda, CA 94502-6577

Re: Chevron Service Station No. 9-1153
3135 Gibbons Drive (3126 Fernside Blvd)
Alameda, CA

I have reviewed the attached report dated July 20, 2010.

The information in this report is accurate to the best of my knowledge and all local Agency/Regional Board guidelines have been followed. This report was prepared by Conestoga-Rovers & Associates, upon whose assistance and advice I have relied.

This letter is submitted pursuant to the requirements of California Water Code Section 13267(b)(1) and the regulating implementation entitled Appendix A pertaining thereto.

I declare under penalty of perjury that the foregoing is true and correct to the best of my knowledge.

Sincerely,

A handwritten signature in black ink that reads "Aaron Costa".

Aaron Costa
Project Manager

Attachment: Report



**CONESTOGA-ROVERS
& ASSOCIATES**

5900 Hollis Street, Suite A
Emeryville, California 94608
Telephone: (510) 420-0700 Fax: (510) 420-9170
<http://www.craworld.com>

July 20, 2010

Reference No. 311642

Mr. Mark Detterman
Alameda County Environmental Health Services
1131 Harbor Bay Parkway, Suite 250
Alameda, California 94502-6577

Re: Second Quarter 2010 Groundwater Monitoring and Sampling Report
Former Chevron Service Station 9-1153
3135 Gibbons Drive (3126 Fernside Blvd.)
Alameda, California
Fuel Leak Case No. RO0000341

Dear Mr. Mark Detterman:

Conestoga-Rovers & Associates (CRA) is submitting this *Second Quarter 2010 Groundwater Monitoring and Sampling Report* for the site referenced above (Figure 1) on behalf of Chevron Environmental Management Company (Chevron). On May 17, 2010, groundwater monitoring was performed by Blaine Tech Services, Inc. (Blaine Tech) of San Jose, California. Groundwater potentiometric data for this event are presented on Figure 2. Cumulative groundwater monitoring and sampling data are presented in Table 1. Blaine Tech's May 27, 2010 *Second Quarter 2010 Monitoring* report is presented as Attachment A. Light non-aqueous phase liquid was only detected in well C-1 at a thickness of 0.25 foot.

Equal
Employment Opportunity
Employer



**CONESTOGA-ROVERS
& ASSOCIATES**

July 20, 2010

Reference No. 311642

- 2 -

Please contact Nathan Lee at (510) 420-3333 or nlee@croworld.com if you have any questions or require additional information.

Sincerely,

CONESTOGA-ROVERS & ASSOCIATES

Cortlandt Toczykowski

Nathan Lee, P.G. #8486



CT/doh/8

Encl.

Figure 1	Vicinity Map
Figure 2	Groundwater Elevation Map
Table 1	Groundwater Monitoring and Sampling Data
Attachment A	Blaine Tech's May 27, 2010 <i>Second Quarter 2010 Monitoring Report</i>

cc: Mr. Aaron Costa, Chevron
Mr. Mark Hom, Property Owner

FIGURES

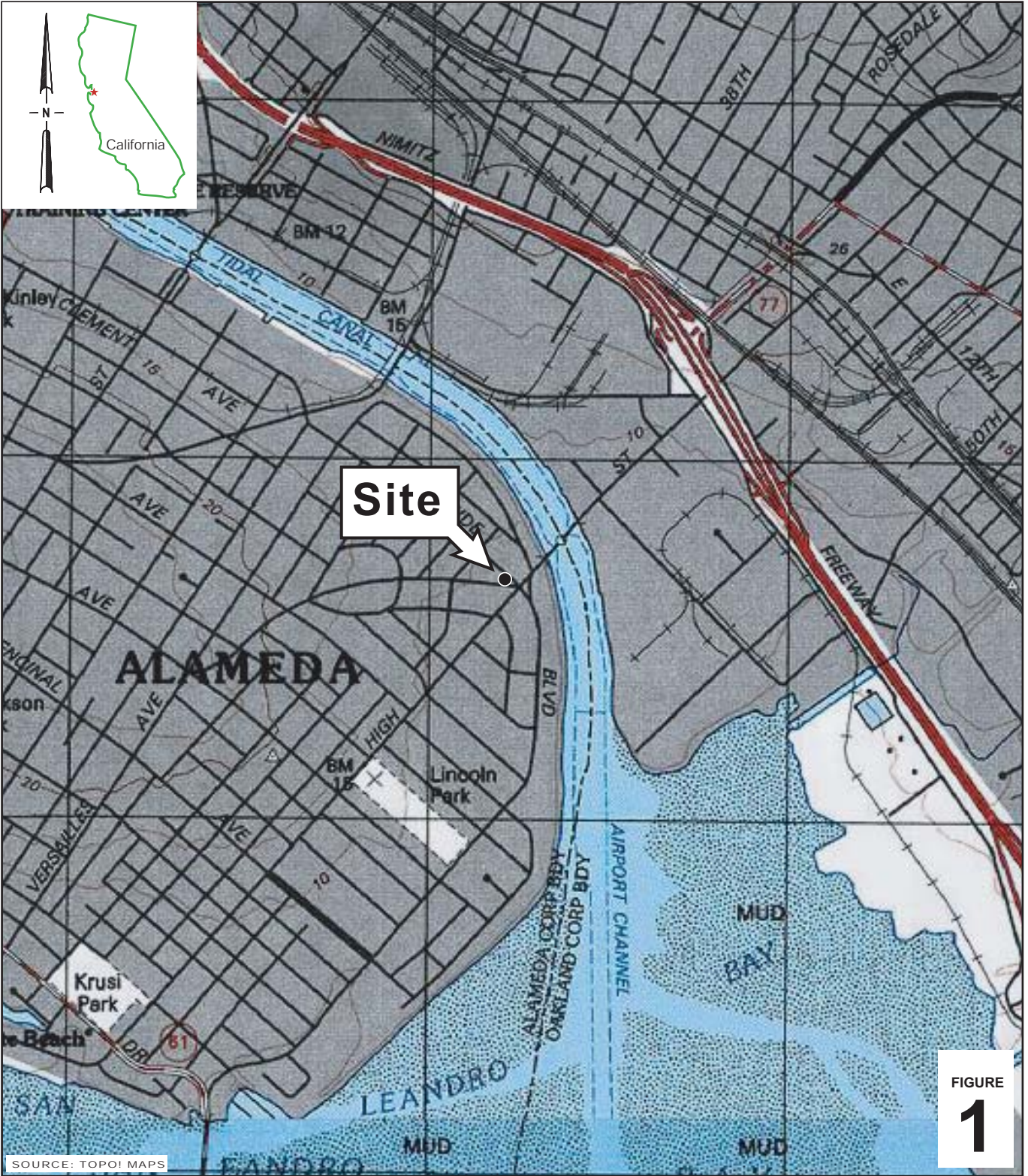

FIGURE
1

L:\CHEV\311642\311642-FIGURES\311642_EM001_VICINITY-MAP.A1

SOURCE: TOPOI MAPS

0 1/8 1/4 1/2 1
SCALE : 1" = 1/4 MILE

Former Chevron Station 9-1153
3135 Gibbons Drive (3126 Fernside Blvd)
Alameda, California



**CONESTOGA-ROVERS
& ASSOCIATES**

Vicinity Map

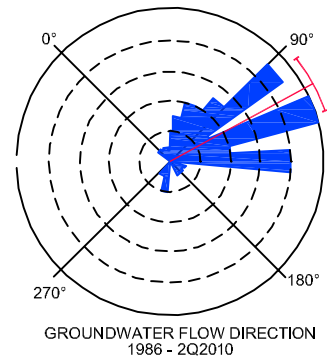
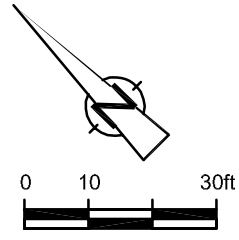

- LEGEND**
- MW-1 ● MONITORING WELL LOCATION
 - RW-1 ⊕ EXTRACTION WELL LOCATION
 - C-2 ■ DESTROYED WELL LOCATION
 - (5.61) GROUNDWATER ELEVATION (ft-amsl)
 - (SA) SAMPLED ANNUALLY
 - (SSA) SAMPLED SEMI-ANNUALLY
 - ** WELL NOT USED IN CONTOURING
 - (LNAPL) LIGHT NON-AQUEOUS PHASE LIQUIDS - NOT SAMPLED
 - 4.50— GROUNDWATER ELEVATION CONTOUR
DASHED WHERE INFERRED

↑
GROUNDWATER FLOW
DIRECTION AT A GRADIENT OF 0.014

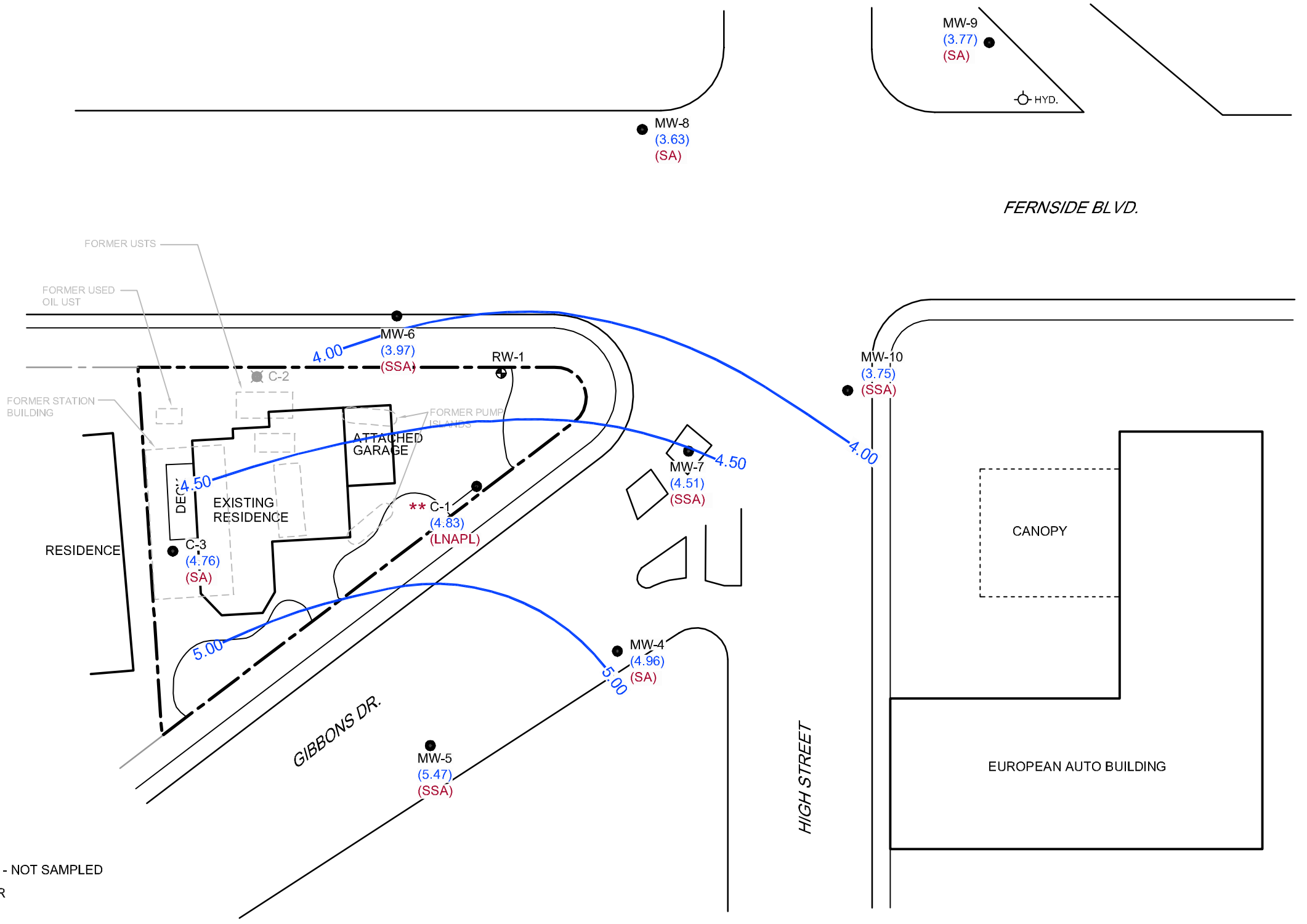

Figure 2
GROUNDWATER ELEVATION MAP - MAY 17, 2010
FORMER CHEVRON SERVICE STATION 9-1153
3135 GIBBONS DRIVE (3126 FERNESIDE BLVD)
Alameda, California

TABLE

TABLE 1
GROUNDWATER MONITORING AND SAMPLING DATA
FORMER CHEVRON SERVICE STATION 9-1153
3135 GIBBONS DRIVE (3126 FERNSIDE BOULEVARD), ALAMEDA, CA

Location	Date	TOC	DTW	GWE	LNAPL	DO (Pre-Purged)	HYDROCARBONS	PRIMARY VOCS				
							TPH-GRO	B	T	E	X	MTBE by SW8260
	Units	ft	ft	ft	ft	mg/L	ug/L	ug/L	ug/L	ug/L	ug/L	ug/L
C-1	08/18/1986	-	4.10	-	0.00	-	-	-	-	-	-	-
C-1	09/04/1986	-	-	-	0.00	-	15000	760	820	1500	-	-
C-1	07/22/1987	-	-	-	0.00	-	1100	250	7.0	40	-	-
C-1	05/03/1989	-	4.46	-	0.00	-	6900	3800	190	229	-	-
C-1	12/04/1989	-	4.16	-	0.00	-	17000	8000	490	470	-	-
C-1	02/14/1990	-	3.64	-	0.00	-	19000	12000	990	1050	-	-
C-1	03/07/1990	-	3.36	-	0.00	-	-	4260	261	430	-	-
C-1	09/06/1991	-	4.43	-	0.00	-	21000	10000	100	240	560	-
C-1	12/15/1991	-	4.78	-	0.00	-	20000	4900	43	110	330	-
C-1	03/03/1992	-	2.39	-	0.00	-	13000	5800	730	340	1200	-
C-1	06/04/1992	4.08	4.08	0.00	0.00	-	34000	9400	350	290	1200	-
C-1	10/13/1992	4.08	4.75	-0.67	0.00	-	24000	11000	98	280	530	-
C-1	01/11/1993	4.08	2.26	1.82	Sheen	-	7100	1500	130	150	700	-
C-1	04/14/1993	4.08	2.90	1.18	Sheen	-	29000	7300	4000	640	2300	-
C-1	07/13/1993	4.08	3.97	0.11	Sheen	-	650000	27000	18000	6300	29000	-
C-1	10/19/1993	4.08	4.50	-0.42	0.00	-	40000	12000	730	1100	3600	-
C-1	11/30/1993	7.50	4.27	3.23	0.00	-	-	-	-	-	-	-
C-1	01/27/1994	7.50	3.35	4.15	0.00	-	36000	8600	220	670	1900	-
C-1	04/07/1994	7.50	3.42	4.08	0.00	-	53000	12000	3500	480	3300	-
C-1	07/01/1994	7.50	3.96	3.54	0.00	-	65000	19000	5900	1000	9000	-
C-1	10/05/1994	7.50	4.39	3.11	0.00	-	160000	23000	12000	2200	11000	-
C-1	01/12/1995	7.50	1.52	6.38	0.50	-	-	-	-	-	-	-
C-1	04/26/1995	7.50	4.40	4.86	2.20	-	-	-	-	-	-	-
C-1	07/12/1995	7.50	4.85	4.10	1.81	-	-	-	-	-	-	-
C-1	10/30/1995	7.50	5.67	3.13	1.63	-	-	-	-	-	-	-

TABLE 1
GROUNDWATER MONITORING AND SAMPLING DATA
FORMER CHEVRON SERVICE STATION 9-1153
3135 GIBBONS DRIVE (3126 FERNSIDE BOULEVARD), ALAMEDA, CA

Location	Date	TOC	DTW	GWE	LNAPL	DO (Pre-Purged)	HYDROCARBONS		PRIMARY VOCS				
							TPH-GRO	B	T	E	X	MTBE by SW8260	
	Units	ft	ft	ft	ft	mg/L	ug/L	ug/L	ug/L	ug/L	ug/L	ug/L	
C-1	01/04/1996	7.50	3.92	3.68	0.12	-	-	-	-	-	-	-	
C-1	01/10/1996	7.50	3.48	4.12	0.13	-	-	-	-	-	-	-	
C-1	01/17/1996	7.50	3.40	4.12	0.02	-	-	-	-	-	-	-	
C-1	01/22/1996	7.50	2.90	4.60	0.00	-	82000	18000	4400	1400	5200	<1000	
C-1	02/23/1996	7.50	4.10	4.89	1.86	-	-	-	-	-	-	-	
C-1	02/28/1996	7.50	-	-	0.83	-	-	-	-	-	-	-	
C-1	03/08/1996	7.50	2.86	6.10	1.83	-	-	-	-	-	-	-	
C-1	03/26/1996	7.50	3.96	4.56	1.28	-	-	-	-	-	-	-	
C-1	04/11/1996	7.50	5.61	3.29	1.75	-	-	-	-	-	-	-	
C-1	04/19/1996	7.50	3.09	4.44	0.04	-	-	-	-	-	-	-	
C-1	04/24/1996	7.50	3.04	4.48	0.03	-	-	-	-	-	-	-	
C-1	05/03/1996	7.50	4.02	3.85	0.46	-	-	-	-	-	-	-	
C-1	05/08/1996	7.50	4.25	3.53	0.35	-	-	-	-	-	-	-	
C-1	05/17/1996	7.50	3.24	4.29	0.04	-	-	-	-	-	-	-	
C-1	05/22/1996	7.50	3.10	4.46	0.07	-	-	-	-	-	-	-	
C-1	06/18/1996	7.50	4.68	3.20	0.48	-	-	-	-	-	-	-	
C-1	07/03/1996	7.50	5.03	2.57	0.13	-	-	-	-	-	-	-	
C-1	07/09/1996	7.50	4.63	3.05	0.23	-	-	-	-	-	-	-	
C-1	07/17/1996	7.50	4.73	2.89	0.15	-	-	-	-	-	-	-	
C-1	07/29/1996	7.50	5.10	2.47	0.09	-	-	-	-	-	-	-	
C-1	08/02/1996	7.50	5.68	1.84	0.03	-	-	-	-	-	-	-	
C-1	08/07/1996	7.50	5.16	2.35	0.01	-	-	-	-	-	-	-	
C-1	08/23/1996	7.50	5.75	1.77	0.03	-	-	-	-	-	-	-	
C-1	08/28/1996	7.50	5.53	1.99	0.03	-	-	-	-	-	-	-	
C-1	09/06/1996	7.50	5.38	2.12	0.00	-	-	-	-	-	-	-	

**TABLE 1
GROUNDWATER MONITORING AND SAMPLING DATA
FORMER CHEVRON SERVICE STATION 9-1153
3135 GIBBONS DRIVE (3126 FERNSIDE BOULEVARD), ALAMEDA, CA**

Location	Date	TOC	DTW	GWE	LNAPL	DO (Pre-Purged)	HYDROCARBONS		PRIMARY VOCS				
							TPH-GRO	B	T	E	X	MTBE by SW8260	
													ug/L
Units	ft	ft	ft	ft	mg/L	ug/L	ug/L	ug/L	ug/L	ug/L	ug/L		
C-1	09/12/1996	7.50	5.48	2.04	0.03	-	-	-	-	-	-	-	
C-1	09/19/1996	7.50	6.32	1.20	0.03	-	-	-	-	-	-	-	
C-1	10/10/1996	7.50	4.58	3.00	0.10	-	-	-	-	-	-	-	
C-1	10/17/1996	7.50	5.61	1.90	0.01	-	-	-	-	-	-	-	
C-1	10/29/1996	7.50	6.01	1.49	0.00	-	-	-	-	-	-	-	
C-1	11/07/1996	7.50	5.56	1.94	0.04	-	-	-	-	-	-	-	
C-1	11/11/1996	7.50	5.32	2.18	0.04	-	-	-	-	-	-	-	
C-1	12/17/1996	7.50	3.73	3.77	0.01	-	-	-	-	-	-	-	
C-1	12/20/1996	7.50	3.33	4.17	0.03	-	-	-	-	-	-	-	
C-1	01/15/1997	7.50	2.74	4.76	0.00	-	47000	16000	2800	1300	4900	<1000	
C-1	01/22/1997	7.50	1.37	6.13	0.19	-	-	-	-	-	-	-	
C-1	02/04/1997	7.50	2.98	4.52	0.51	-	-	-	-	-	-	-	
C-1	02/20/1997	7.50	4.09	3.41	0.13	-	-	-	-	-	-	-	
C-1	03/06/1997	7.50	3.75	3.75	0.56	-	-	-	-	-	-	-	
C-1	03/14/1997	7.50	3.82	3.68	0.03	-	-	-	-	-	-	-	
C-1	03/20/1997	7.50	3.73	3.77	0.03	-	-	-	-	-	-	-	
C-1	03/25/1997	7.50	4.32	3.18	0.01	-	-	-	-	-	-	-	
C-1	03/31/1997	7.50	3.71	3.79	0.03	-	-	-	-	-	-	-	
C-1	04/03/1997	7.50	4.60	2.92	0.03	-	-	-	-	-	-	-	
C-1	04/09/1997	7.50	4.25	3.27	0.02	-	-	-	-	-	-	-	
C-1	04/24/1997	7.50	4.65	2.87	0.02	-	-	-	-	-	-	-	
C-1	04/30/1997	7.50	3.50	4.02	0.02	-	-	-	-	-	-	-	
C-1	05/22/1997	7.50	4.97	2.53	0.00	-	-	-	-	-	-	-	
C-1	06/03/1997	7.50	3.62	3.93	0.06	-	-	-	-	-	-	-	
C-1	07/09/1997	7.50	4.30	3.25	0.06	-	-	-	-	-	-	-	

TABLE 1
GROUNDWATER MONITORING AND SAMPLING DATA
FORMER CHEVRON SERVICE STATION 9-1153
3135 GIBBONS DRIVE (3126 FERNSIDE BOULEVARD), ALAMEDA, CA

Location	Date	TOC	DTW	GWE	LNAPL	DO (Pre-Purged)	HYDROCARBONS		PRIMARY VOCS				
							TPH-GRO	B	T	E	X	MTBE by SW8260	
													ug/L
Units	ft	ft	ft	ft	mg/L	ug/L	ug/L	ug/L	ug/L	ug/L	ug/L		
C-1	08/12/1997	7.50	5.18	2.32	0.00	-	-	-	-	-	-	-	
C-1	09/30/1997	7.50	5.25	2.65	0.50	-	-	-	-	-	-	-	
C-1	10/29/1997	7.50	5.33	2.19	0.03	-	-	-	-	-	-	-	
C-1	11/13/1997	7.50	4.86	2.66	0.02	-	-	-	-	-	-	-	
C-1	12/18/1997	7.50	2.34	5.16	0.00	-	-	-	-	-	-	-	
C-1	01/14/1998	7.50	0.25	7.27	0.02	-	-	-	-	-	-	-	
C-1	02/02/1998	7.50	2.35	5.19	0.05	-	-	-	-	-	-	-	
C-1	03/16/1998	7.50	2.50	5.40	0.50	-	-	-	-	-	-	-	
C-1	04/17/1998	7.50	2.65	5.17	0.40	-	-	-	-	-	-	-	
C-1	05/01/1998	7.50	2.39	5.14	0.04	-	-	-	-	-	-	-	
C-1	06/17/1998	7.50	3.26	4.30	0.08	-	-	-	-	-	-	-	
C-1	07/15/1998	7.50	3.55	3.95	0.00	-	110000	22000	22000	1000	10000	<250	
C-1	09/01/1998	7.50	4.00	3.50	0.00	-	-	-	-	-	-	-	
C-1	10/27/1998	7.50	4.48	3.02	0.00	-	45000	12000	5400	590	4300	<500	
C-1	11/19/1998	7.50	3.89	3.61	0.00	-	-	-	-	-	-	-	
C-1	12/19/1998	7.50	2.13	5.39	0.02	-	-	-	-	-	-	-	
C-1	01/20/1999	7.50	3.98	3.52	0.00	-	50300	7050	5030	244	6090	<40	
C-1	02/24/1999	7.50	2.55	4.95	0.00	-	-	-	-	-	-	-	
C-1	03/26/1999	7.50	2.14	5.97	0.76	-	-	-	-	-	-	-	
C-1	04/19/1999	7.50	1.04	6.46	0.00	-	150000	21000	20000	3000	18000	<2.5 / <49 ²	
C-1	07/29/1999	7.50	3.76	3.76	0.02	-	-	-	-	-	-	-	
C-1	08/30/1999	7.50	4.30	3.20	0.00	-	-	-	-	-	-	-	
C-1	09/23/1999	7.50	3.84	3.68	0.02	-	-	-	-	-	-	-	
C-1	10/13/1999	7.50	1.27	6.23	0.00	-	136000	23900	30000	2390	17300	<500	
C-1	11/17/1999	7.50	3.59	3.91	0.00	-	-	-	-	-	-	-	

TABLE 1
GROUNDWATER MONITORING AND SAMPLING DATA
FORMER CHEVRON SERVICE STATION 9-1153
3135 GIBBONS DRIVE (3126 FERNSIDE BOULEVARD), ALAMEDA, CA

Location	Date	TOC	DTW	GWE	LNAPL	DO (Pre-Purged)	HYDROCARBONS		PRIMARY VOCS				
							TPH-GRO	B	T	E	X	MTBE by SW8260	
	Units	ft	ft	ft	ft	mg/L	ug/L	ug/L	ug/L	ug/L	ug/L	ug/L	
C-1	12/08/1999	7.50	3.79	3.71	0.00	-	-	-	-	-	-	-	
C-1	01/25/2000	7.50	1.99	5.54	0.04	-	-	-	-	-	-	-	
C-1	04/03/2000	7.50	2.20	5.38**	0.10	-	-	-	-	-	-	-	
C-1	05/26/2000	7.50	2.52	5.16**	0.23	-	-	-	-	-	-	-	
C-1	06/19/2000	7.50	2.89	4.76**	0.19	-	-	-	-	-	-	-	
C-1	07/03/2000	7.50	3.45	4.25**	0.25	-	-	-	-	-	-	-	
C-1	08/01/2000	7.50	3.78	3.85**	0.16	-	-	-	-	-	-	-	
C-1	09/30/2000	7.50	4.03	3.50**	0.04	-	-	-	-	-	-	-	
C-1	10/23/2000	7.50	4.15	3.37**	0.03	-	-	-	-	-	-	-	
C-1	11/21/2000	7.50	3.42	4.08	0.00	-	-	-	-	-	-	-	
C-1	12/22/2000	7.50	2.96	4.54	0.00	-	-	-	-	-	-	-	
C-1	01/08/2001	7.50	2.94	4.56	0.00	-	-	-	-	-	-	-	
C-1	02/17/2001	7.50	2.09	5.88**	0.59	-	-	-	-	-	-	-	
C-1	03/13/2001	7.50	2.20	5.91**	0.76	-	-	-	-	-	-	-	
C-1	04/09/2001	7.50	2.45	5.26**	0.26	-	-	-	-	-	-	-	
C-1	05/18/2001	7.50	2.70	5.27**	0.59	-	-	-	-	-	-	-	
C-1	06/12/2001	7.50	3.50	4.78**	0.97	-	-	-	-	-	-	-	
C-1	07/19/2001	7.50	4.25	4.01**	0.95	-	-	-	-	-	-	-	
C-1	08/23/2001	7.50	4.34	3.22**	0.07	-	-	-	-	-	-	-	
C-1	09/17/2001	7.50	4.39	3.17**	0.08	-	-	-	-	-	-	-	
C-1	10/08/2001	7.50	4.45	3.08**	0.04	-	-	-	-	-	-	-	
C-1	11/27/2001	7.50	3.89	3.61	0.00	-	330000	9800	5300	3800	22000	<50	
C-1	12/17/2001	7.50	1.81	5.69	0.00	-	-	-	-	-	-	-	
C-1	01/07/2002	7.50	2.27	5.64**	0.51	-	-	-	-	-	-	-	
C-1	02/26/2002	7.50	2.70	5.22**	0.52	-	-	-	-	-	-	-	

TABLE 1
GROUNDWATER MONITORING AND SAMPLING DATA
FORMER CHEVRON SERVICE STATION 9-1153
3135 GIBBONS DRIVE (3126 FERNSIDE BOULEVARD), ALAMEDA, CA

Location	Date	TOC	DTW	GWE	LNAPL	DO (Pre-Purged)	HYDROCARBONS		PRIMARY VOCS				
							TPH-GRO	B	T	E	X	MTBE by SW8260	
	Units	ft	ft	ft	ft	mg/L	ug/L	ug/L	ug/L	ug/L	ug/L	ug/L	
C-1	03/27/2002	7.50	2.87	5.47**	1.05	-	-	-	-	-	-	-	
C-1	04/08/2002	7.50	2.45	6.03**	1.23	-	-	-	-	-	-	-	
C-1	05/23/2002	7.50	3.57	4.35**	0.52	-	-	-	-	-	-	-	
C-1	06/17/2002	7.50	3.90	3.88**	0.35	-	-	-	-	-	-	-	
C-1	07/31/2002	7.50	4.12	3.54**	0.20	-	-	-	-	-	-	-	
C-1	08/09/2002	7.50	4.15	3.48**	0.16	-	-	-	-	-	-	-	
C-1	09/17/2002	7.50	4.33	3.27**	0.12	-	-	-	-	-	-	-	
C-1	10/15/2002	7.50	4.51	3.11**	0.15	-	-	-	-	-	-	-	
C-1	11/08/2002	7.50	4.11	3.39	0.00	-	51000	7000	510	820	5800	<3.0	
C-1	12/19/2002	7.50	1.14	6.36	0.00	-	-	-	-	-	-	-	
C-1	01/14/2003	7.50	1.80	5.70	0.00	-	-	-	-	-	-	-	
C-1	02/07/2003	7.50	2.95	4.79**	0.30	-	-	-	-	-	-	-	
C-1	03/20/2003	7.50	2.86	4.97**	0.41	-	-	-	-	-	-	-	
C-1	04/15/2003	7.50	2.12	5.46**	0.10	-	-	-	-	-	-	-	
C-1	05/09/2003	7.50	2.95	5.11**	0.70	-	-	-	-	-	-	-	
C-1	06/27/2003	7.50	3.97	3.93**	0.50	-	-	-	-	-	-	-	
C-1	07/16/2003	7.50	3.68	4.04**	0.28	-	-	-	-	-	-	-	
C-1	08/15/2003	7.50	4.29	3.39**	0.22	-	-	-	-	-	-	-	
C-1	09/26/2003	7.50	4.60	3.05**	0.19	-	-	-	-	-	-	-	
C-1	10/18/2003	7.50	4.72	2.90**	0.15	-	-	-	-	-	-	-	
C-1	11/14/2003	7.50	4.31	3.35**	0.20	-	-	-	-	-	-	-	
C-1	12/23/2003	7.50	1.81	5.69	0.00	-	-	-	-	-	-	-	
C-1	01/22/2004	7.50	4.19	3.32**	0.01	-	-	-	-	-	-	-	
C-1	02/13/2004	7.50	3.04	4.49**	0.04	-	-	-	-	-	-	-	
C-1	03/11/2004	7.50	1.85	5.97**	0.40	-	-	-	-	-	-	-	

TABLE 1
GROUNDWATER MONITORING AND SAMPLING DATA
FORMER CHEVRON SERVICE STATION 9-1153
3135 GIBBONS DRIVE (3126 FERNSIDE BOULEVARD), ALAMEDA, CA

Location	Date	TOC	DTW	GWE	LNAPL	DO (Pre-Purged)	HYDROCARBONS		PRIMARY VOCS				
							TPH-GRO	B	T	E	X	MTBE by SW8260	
	Units	ft	ft	ft	ft	mg/L	ug/L	ug/L	ug/L	ug/L	ug/L	ug/L	
C-1	04/22/2004	7.50	3.08	4.60**	0.22	-	-	-	-	-	-	-	
C-1	05/14/2004	7.50	3.49	4.03**	0.03	-	-	-	-	-	-	-	
C-1	06/18/2004	7.50	3.41	4.19**	0.13	-	-	-	-	-	-	-	
C-1	07/23/2004	7.50	3.28	4.31**	0.11	-	-	-	-	-	-	-	
C-1	08/13/2004	7.50	3.14	4.40**	0.05	-	-	-	-	-	-	-	
C-1	09/13/2004	7.50	4.53	3.04**	0.09	-	-	-	-	-	-	-	
C-1	10/22/2004	7.50	3.19	4.33**	0.03	-	-	-	-	-	-	-	
C-1	11/12/2004	7.50	3.22	4.30**	0.03	-	-	-	-	-	-	-	
C-1	12/02/2004	7.50	3.28	4.24**	0.02	-	-	-	-	-	-	-	
C-1	01/28/2005	7.50	3.19	4.32**	0.01	-	-	-	-	-	-	-	
C-1	02/11/2005	7.50	2.75	4.78**	0.04	-	-	-	-	-	-	-	
C-1	03/11/2005	7.50	2.94	4.58**	0.03	-	-	-	-	-	-	-	
C-1	04/26/2005	7.50	3.03	4.49**	0.02	-	-	-	-	-	-	-	
C-1	05/13/2005	7.50	3.18	4.34**	0.02	-	-	-	-	-	-	-	
C-1	06/01/2005	7.50	3.22	4.30**	0.02	-	-	-	-	-	-	-	
C-1	07/15/2005	7.50	3.09	4.43**	0.02	-	-	-	-	-	-	-	
C-1	08/19/2005	7.50	2.88	4.64**	0.03	-	-	-	-	-	-	-	
C-1	09/23/2005	7.50	2.95	4.57**	0.02	-	-	-	-	-	-	-	
C-1	10/14/2005	7.50	3.01	4.50**	0.01	-	-	-	-	-	-	-	
C-1	11/18/2005	7.50	3.21	4.31**	0.02	-	-	-	-	-	-	-	
C-1	12/09/2005	7.50	3.61	3.90**	0.01	-	-	-	-	-	-	-	
C-1	01/12/2006	7.50	2.98	4.53**	0.01	-	-	-	-	-	-	-	
C-1	02/10/2006 ¹⁵	7.50	2.69	4.82**	0.01	-	100000	11000	2500	2900	15000	<10	
C-1	03/13/2006	7.50	2.81	4.70**	0.01	-	-	-	-	-	-	-	
C-1	04/13/2006	7.50	2.75	4.76**	0.01	-	-	-	-	-	-	-	

TABLE 1
GROUNDWATER MONITORING AND SAMPLING DATA
FORMER CHEVRON SERVICE STATION 9-1153
3135 GIBBONS DRIVE (3126 FERNSIDE BOULEVARD), ALAMEDA, CA

Location	Date	TOC	DTW	GWE	LNAPL	DO (Pre-Purged)	HYDROCARBONS		PRIMARY VOCS				
							TPH-GRO	B	T	E	X	MTBE by SW8260	
													ug/L
Units	ft	ft	ft	ft	mg/L	ug/L	ug/L	ug/L	ug/L	ug/L	ug/L	ug/L	
C-1	05/12/2006	7.50	3.02	4.49**	0.01	-	-	-	-	-	-	-	-
C-1	06/12/2006	7.50	3.10	4.41**	0.01	-	-	-	-	-	-	-	-
C-1	07/13/2006	7.50	3.14	4.38**	0.02	-	-	-	-	-	-	-	-
C-1	08/11/2006 ¹⁵	7.50	3.70	3.81**	0.01	-	200000	8600	470	1700	8800	<10	-
C-1	09/11/2006	7.50	3.75	3.77**	0.02	-	-	-	-	-	-	-	-
C-1	10/17/2006	7.50	3.82	3.69**	0.01	-	-	-	-	-	-	-	-
C-1	11/17/2006	7.50	3.11	4.41**	0.03	-	-	-	-	-	-	-	-
C-1	12/15/2006	7.50	2.95	4.57**	0.02	-	-	-	-	-	-	-	-
C-1	01/16/2007	7.50	2.98	4.54**	0.02	-	-	-	-	-	-	-	-
C-1	02/16/2007 ¹⁵	7.50	2.77	4.73	0.00	-	25000	4300	260	310	3300	<5	-
C-1	03/16/2007	7.50	3.07	4.44**	0.01	-	-	-	-	-	-	-	-
C-1	04/17/2007	7.50	2.98	4.53**	0.01	-	-	-	-	-	-	-	-
C-1	05/17/2007 ¹⁵	7.50	3.05	4.46**	0.01	-	110000 ¹⁶	12000 ¹⁶	1000 ¹⁶	2000 ¹⁶	15000 ¹⁶	<5	-
C-1	06/15/2007	7.50	3.08	4.43**	0.01	-	-	-	-	-	-	-	-
C-1	07/17/2007	7.50	3.13	4.38**	0.01	-	-	-	-	-	-	-	-
C-1	08/09/2007	7.50	3.24	4.28**	0.02	-	-	-	-	-	-	-	-
C-1	09/14/2007	7.50	3.16	4.35**	0.01	-	-	-	-	-	-	-	-
C-1	10/16/2007	7.50	3.04	4.47**	0.01	-	-	-	-	-	-	-	-
C-1	11/08/2007 ¹⁵	7.50	3.11	4.40**	0.01	-	150000	13000	570	1800	10000	<13	-
C-1	12/07/2007	7.50	2.98	4.54**	0.03	-	-	-	-	-	-	-	-
C-1	01/16/2008	7.50	2.95	4.57**	0.02	-	-	-	-	-	-	-	-
C-1	02/06/2008 ¹⁵	7.50	2.61	4.90**	0.01	-	110000	13000	500	5300	21000	<10	-
C-1	03/07/2008	7.50	2.87	4.65**	0.02	-	-	-	-	-	-	-	-
C-1	04/16/2008	7.50	3.06	4.46**	0.02	-	-	-	-	-	-	-	-
C-1	05/07/2008	7.50	2.98	4.54**	0.03	-	-	-	-	-	-	-	-

TABLE 1
GROUNDWATER MONITORING AND SAMPLING DATA
FORMER CHEVRON SERVICE STATION 9-1153
3135 GIBBONS DRIVE (3126 FERNSIDE BOULEVARD), ALAMEDA, CA

Location	Date	TOC	DTW	GWE	LNAPL	DO (Pre-Purged)	HYDROCARBONS		PRIMARY VOCS				
							TPH-GRO	B	T	E	X	MTBE by SW8260	
	Units	ft	ft	ft	ft	mg/L	ug/L	ug/L	ug/L	ug/L	ug/L	ug/L	
C-1	06/06/2008	7.50	3.02	4.50**	0.02	-	-	-	-	-	-	-	
C-1	07/16/2008	7.50	3.12	4.40**	0.02	-	-	-	-	-	-	-	
C-1	09/05/2008	7.50	3.97	3.75**	0.28	-	-	-	-	-	-	-	
C-1	09/11/2008	7.50	4.22	3.61**	0.41	-	-	-	-	-	-	-	
C-1	10/17/2008	7.50	4.16	3.60**	0.33	-	-	-	-	-	-	-	
C-1	11/10/2008	7.50	4.05	3.54**	0.11	-	-	-	-	-	-	-	
C-1	12/15/2008	7.50	3.85	3.69**	0.05	-	-	-	-	-	-	-	
C-1	01/21/2009	7.50	3.91	3.62**	0.04	-	-	-	-	-	-	-	
C-1	02/09/2009 ¹⁵	7.50	3.72	3.79**	0.01	-	53000	3100	66	660	3700	<1	
C-1	03/16/2009	7.50	3.81	3.71**	0.03	-	-	-	-	-	-	-	
C-1	05/28/2009	7.50	3.48	4.02**	0.02	-	-	-	-	-	-	-	
C-1	08/18/2009	7.50	4.40	3.10**	0.02	-	-	-	-	-	-	-	
C-1	11/17/2009	7.50	4.21	3.29**	0.03	-	-	-	-	-	-	-	
C-1	03/31/2010	7.50	2.07	5.46**	0.04	-	-	-	-	-	-	-	
C-1	05/17/2010	7.50	2.87	4.83**	0.25	-	-	-	-	-	-	-	
C-3	08/18/1986	-	4.00	-	0.00	-	-	-	-	-	-	-	
C-3	09/04/1986	-	-	-	0.00	-	50	3.2	5.4	5.8	-	-	
C-3	07/22/1987	-	-	-	0.00	-	<50	<0.5	<1.0	<4.0	-	-	
C-3	05/03/1989	-	4.15	-	0.00	-	<50	<0.5	<1.0	<2.0	-	-	
C-3	12/04/1989	-	4.24	-	0.00	-	<250	<0.5	<0.5	<0.5	-	-	
C-3	02/14/1990	-	3.57	-	0.00	-	<50	<0.5	<0.5	<0.5	-	-	
C-3	03/07/1990	-	3.31	-	0.00	-	-	<5.0	<5.0	<5.0	-	-	
C-3	09/06/1991	-	4.59	-	0.00	-	<50	<0.5	<0.5	<0.5	<0.5	-	
C-3	12/15/1991	-	4.84	-	0.00	-	<50	<0.5	<0.5	<0.5	<0.5	-	

TABLE 1
GROUNDWATER MONITORING AND SAMPLING DATA
FORMER CHEVRON SERVICE STATION 9-1153
3135 GIBBONS DRIVE (3126 FERNSIDE BOULEVARD), ALAMEDA, CA

Location	Date	TOC	DTW	GWE	LNAPL	DO (Pre-Purged)	HYDROCARBONS		PRIMARY VOCS				
							TPH-GRO	B	T	E	X	MTBE by SW8260	
													ug/L
Units	ft	ft	ft	ft	mg/L	ug/L	ug/L	ug/L	ug/L	ug/L	ug/L	ug/L	
C-3	03/03/1992	-	2.17	-	0.00	-	<50	<0.5	<0.5	<0.5	<0.5	-	
C-3	06/04/1992	4.41	4.01	0.40	0.00	-	<50	<0.5	<0.5	<0.5	<0.5	-	
C-3	10/13/1992	4.41	4.79	-0.38	0.00	-	<50	<0.5	<0.5	<0.5	<0.5	-	
C-3	01/11/1993	4.41	2.01	2.40	0.00	-	<50	<0.5	<0.5	<0.5	<0.5	-	
C-3	04/14/1993	4.41	2.76	1.65	0.00	-	<50	<0.5	<0.5	<0.5	<0.5	-	
C-3	07/13/1993	4.41	3.96	0.45	0.00	-	<50	<0.5	<0.5	<0.5	<1.5	-	
C-3	10/19/1993	4.41	4.53	-0.12	0.00	-	66	12	1.4	1.0	8.4	-	
C-3	11/30/1993	7.83	4.04	3.79	0.00	-	-	-	-	-	-	-	
C-3	01/27/1994	7.83	3.17	4.66	0.00	-	<50	<0.5	<0.5	<0.5	<0.5	-	
C-3	04/07/1994	7.83	3.20	4.63	0.00	-	<50	<0.5	<0.5	<0.5	<0.5	-	
C-3	07/01/1994	7.83	3.99	3.84	0.00	-	<50	<0.5	<0.5	<0.5	<0.5	-	
C-3	10/05/1994	7.83	4.54	3.29	0.00	-	<50	<0.5	<0.5	<0.5	<0.5	-	
C-3	01/12/1995	7.83	0.80	7.03	0.00	-	<50	<0.5	<0.5	<0.5	<0.5	-	
C-3	05/02/1995	7.83	2.15	5.68	0.00	-	<50	<0.5	<0.5	<0.5	<0.5	-	
C-3	07/12/1995	7.83	3.42	4.41	0.00	-	<50	<0.5	<0.5	<0.5	<0.5	-	
C-3	10/30/1995	7.83	4.46	3.37	0.00	-	<50	<0.5	<0.5	<0.5	<0.5	<2.5	
C-3	01/22/1996	7.83	1.73	6.10	0.00	-	<50	<0.5	<0.5	<0.5	<0.5	<2.5	
C-3	04/24/1996	7.83	2.62	5.21	0.00	-	<50	<0.5	<0.5	<0.5	<0.5	<2.5	
C-3	07/29/1996	7.83	3.94	3.89	0.00	-	<50	<0.5	<0.5	<0.5	<0.5	<2.5	
C-3	10/10/1996	7.83	4.06	3.77	0.00	-	<50	<0.5	<0.5	<0.5	<0.5	<2.5	
C-3	01/15/1997	7.83	1.54	6.29	0.00	-	<50	<0.5	<0.5	<0.5	<0.5	<2.5	
C-3	04/03/1997	7.83	3.23	4.60	0.00	-	<50	<0.5	<0.5	<0.5	<0.5	<2.5	
C-3	07/09/1997	7.83	4.36	3.47	0.00	-	<50	<0.5	<0.5	<0.5	<0.5	<2.5	
C-3	10/29/1997	7.83	4.65	3.18	0.00	-	<50	<0.5	<0.5	<0.5	<0.5	<2.5	
C-3	01/14/1998	7.83	0.77	7.06	0.00	-	<50	<0.5	<0.5	<0.5	<0.5	<2.5	

TABLE 1
GROUNDWATER MONITORING AND SAMPLING DATA
FORMER CHEVRON SERVICE STATION 9-1153
3135 GIBBONS DRIVE (3126 FERNSIDE BOULEVARD), ALAMEDA, CA

Location	Date	TOC	DTW	GWE	LNAPL	DO (Pre-Purged)	HYDROCARBONS	PRIMARY VOCS				
							TPH-GRO	B	T	E	X	MTBE by SW8260
	Units	ft	ft	ft	ft	mg/L	ug/L	ug/L	ug/L	ug/L	ug/L	ug/L
C-3	07/15/1998	7.83	3.72	4.11	0.00	-	<50	<0.5	<0.5	<0.5	<0.5	<2.5
C-3	01/20/1999	7.83	2.65	5.18	0.00	-	<50	<0.5	<0.5	<0.5	<0.5	<2.0
C-3	04/19/1999	7.83	1.78	6.05	0.00	-	-	-	-	-	-	-
C-3	04/03/2000	7.83	-	-	-	-	-	-	-	-	-	-
C-3	07/03/2000	7.83	-	-	-	-	-	-	-	-	-	-
C-3	10/23/2000	7.83	-	-	-	-	-	-	-	-	-	-
C-3	01/08/2001 ¹¹	7.83	3.71	4.12	0.00	-	<50	<0.50	<0.50	<0.50	<0.50	<2.5
C-3	04/09/2001	7.83	-	-	-	-	-	-	-	-	-	-
C-3	08/23/2001	7.83	-	-	-	-	-	-	-	-	-	-
C-3	11/27/2001	7.83	-	-	-	-	-	-	-	-	-	-
C-3	02/26/2002	7.83	2.38	5.45	0.00	-	<50	<0.50	<0.50	<0.50	<1.5	<2.5
C-3	05/23/2002	7.83	-	-	-	-	-	-	-	-	-	-
C-3	08/09/2002	7.83	-	-	-	-	-	-	-	-	-	-
C-3	11/08/2002	7.83	-	-	-	-	-	-	-	-	-	-
C-3	02/07/2003	7.83	2.73	5.10	0.00	-	<50	<0.50	<0.50	<0.50	<1.5	<2.5
C-3	05/09/2003	7.83	-	-	-	-	-	-	-	-	-	-
C-3	08/15/2003	7.83	-	-	-	-	-	-	-	-	-	-
C-3	11/14/2003	7.83	-	-	-	-	-	-	-	-	-	-
C-3	02/13/2004 ¹⁵	7.83	2.81	5.02	0.00	-	<50	<0.5	<0.5	<0.5	<0.5	<0.5
C-3	05/14/2004	7.83	-	-	-	-	-	-	-	-	-	-
C-3	11/12/2004	7.83	-	-	-	-	-	-	-	-	-	-
C-3	02/11/2005 ¹⁵	7.83	2.58	5.25	0.00	-	<50	<0.5	<0.5	<0.5	<0.5	<0.5
C-3	05/13/2005	7.83	-	-	-	-	-	-	-	-	-	-
C-3	08/19/2005	7.83	-	-	-	-	-	-	-	-	-	-
C-3	11/18/2005	7.83	-	-	-	-	-	-	-	-	-	-

TABLE 1
GROUNDWATER MONITORING AND SAMPLING DATA
FORMER CHEVRON SERVICE STATION 9-1153
3135 GIBBONS DRIVE (3126 FERNSIDE BOULEVARD), ALAMEDA, CA

Location	Date	TOC	DTW	GWE	LNAPL	DO (Pre-Purged)	HYDROCARBONS		PRIMARY VOCS				
							TPH-GRO	B	T	E	X	MTBE by SW8260	
													ug/L
Units	ft	ft	ft	ft	mg/L	ug/L	ug/L	ug/L	ug/L	ug/L	ug/L		
C-3	02/10/2006 ¹⁵	7.83	2.52	5.31	0.00	-	<50	<0.5	<0.5	<0.5	<0.5	<0.5	
C-3	05/12/2006	7.83	-	-	-	-	-	-	-	-	-	-	
C-3	08/11/2006	7.83	-	-	-	-	-	-	-	-	-	-	
C-3	11/17/2006	7.83	-	-	-	-	-	-	-	-	-	-	
C-3	02/16/2007 ¹⁵	7.83	2.63	5.20	0.00	-	<50	<0.5	<0.5	<0.5	<0.5	<0.5	
C-3	05/17/2007	7.83	-	-	-	-	-	-	-	-	-	-	
C-3	08/09/2007	7.83	-	-	-	-	-	-	-	-	-	-	
C-3	11/08/2007	7.83	-	-	-	-	-	-	-	-	-	-	
C-3	02/06/2008 ¹⁵	7.83	2.91	4.92	0.00	-	<50	<0.5	<0.5	<0.5	<0.5	<0.5	
C-3	05/07/2008	7.83	-	-	-	-	-	-	-	-	-	-	
C-3	09/11/2008	7.83	-	-	-	-	-	-	-	-	-	-	
C-3	11/10/2008	7.83	-	-	-	-	-	-	-	-	-	-	
C-3	02/09/2009 ¹⁵	7.83	2.95	4.88	0.00	-	<50	<0.5	<0.5	<0.5	<0.5	<0.5	
C-3	03/31/2010	7.83	2.22	5.61	0.00	-	<50	<0.5	<0.5	<0.5	<0.5	<0.5	
C-3	05/17/2010	7.83	3.07	4.76	0.00	-	-	-	-	-	-	-	
MW-4	06/04/1992	3.58	3.63	-0.05	0.00	-	<50	0.8	<0.5	<0.5	<0.5	-	
MW-4	10/13/1992	3.58	-	-	-	-	-	-	-	-	-	-	
MW-4	01/11/1993	3.58	1.89	1.69	0.00	-	<50	<0.5	<0.5	<0.5	<0.5	-	
MW-4	04/14/1993	3.58	2.20	1.38	0.00	-	<50	<0.5	<0.5	<0.5	<1.5	-	
MW-4	07/13/1993	3.58	3.51	0.07	0.00	-	54	2.6	1.6	<0.5	<1.5	-	
MW-4	10/19/1993	3.58	4.22	-0.64	0.00	-	<50	<0.5	<0.5	<0.5	<0.5	-	
MW-4	11/30/1993	7.01	4.01	3.00	0.00	-	-	-	-	-	-	-	
MW-4	01/27/1994	7.01	2.89	4.12	0.00	-	<50	<0.5	<0.5	<0.5	<0.5	-	
MW-4	04/07/1994	7.01	3.06	3.95	0.00	-	<50	<0.5	<0.5	<0.5	<0.5	-	

TABLE 1
GROUNDWATER MONITORING AND SAMPLING DATA
FORMER CHEVRON SERVICE STATION 9-1153
3135 GIBBONS DRIVE (3126 FERNSIDE BOULEVARD), ALAMEDA, CA

Location	Date	TOC	DTW	GWE	LNAPL	DO (Pre-Purged)	HYDROCARBONS		PRIMARY VOCS				
							TPH-GRO		B	T	E	X	MTBE by SW8260
	Units	ft	ft	ft	ft	mg/L	ug/L	ug/L	ug/L	ug/L	ug/L	ug/L	ug/L
MW-4	07/01/1994	7.01	3.59	3.42	0.00	-	<50	<0.5	<0.5	<0.5	<0.5	<0.5	-
MW-4	10/05/1994	7.01	4.33	2.68	0.00	-	<50	<0.5	<0.5	<0.5	<0.5	<0.5	-
MW-4	01/12/1995	7.01	1.20	5.81	0.00	-	<50	<0.5	<0.5	<0.5	<0.5	<0.5	-
MW-4	04/26/1995	7.01	1.15	5.86	0.00	-	<50	<0.5	<0.5	<0.5	<0.5	<0.5	-
MW-4	07/12/1995	7.01	2.72	4.29	0.00	-	<50	6.4	<0.5	0.63	0.72	<0.5	-
MW-4	10/30/1995	7.01	4.08	2.93	0.00	-	<50	<0.5	<0.5	<0.5	<0.5	<0.5	<2.5
MW-4	01/22/1996	7.01	1.76	5.25	0.00	-	<50	<0.5	<0.5	<0.5	<0.5	<0.5	<2.5
MW-4	04/24/1996	7.01	1.95	5.06	0.00	-	<50	<0.5	<0.5	<0.5	<0.5	<0.5	<2.5
MW-4	07/29/1996	7.01	3.37	3.64	0.00	-	<50	<0.5	<0.5	<0.5	<0.5	<0.5	<2.5
MW-4	10/10/1996	7.01	3.96	3.05	0.00	-	<50	<0.5	<0.5	<0.5	<0.5	<0.5	<2.5
MW-4	01/15/1997	7.01	1.27	5.74	0.00	-	<50	<0.5	<0.5	<0.5	<0.5	<0.5	<2.5
MW-4	04/03/1997	7.01	2.11	4.90	0.00	-	<50	<0.5	<0.5	<0.5	<0.5	<0.5	<2.5
MW-4	07/09/1997	7.01	4.04	2.97	0.00	-	<50	<0.5	<0.5	<0.5	<0.5	<0.5	<2.5
MW-4	10/29/1997	7.01	4.56	2.45	0.00	-	<50	<0.5	<0.5	<0.5	<0.5	<0.5	<2.5
MW-4	01/14/1998	7.01	0.39	6.62	0.00	-	<50	<0.5	<0.5	<0.5	<0.5	<0.5	<2.5
MW-4	01/20/1999	7.01	2.83	4.18	0.00	-	<50	<0.5	<0.5	<0.5	<0.5	<0.5	<2.0
MW-4	04/19/1999	7.01	2.91	4.10	0.00	-	-	-	-	-	-	-	-
MW-4	01/25/2000	7.01	1.92	5.09	0.00	-	<50	<0.5	<0.5	<0.5	<0.5	<0.5	<2.5
MW-4	04/03/2000	7.01	-	-	-	-	-	-	-	-	-	-	-
MW-4	07/03/2000	7.01	-	-	-	-	-	-	-	-	-	-	-
MW-4	10/23/2000	7.01	-	-	-	-	-	-	-	-	-	-	-
MW-4	01/08/2001 ¹¹	7.01	3.02	3.99	0.00	-	87 ¹²	<0.50	<0.50	0.55	2.9	<0.5	<2.5
MW-4	04/09/2001	7.01	-	-	-	-	-	-	-	-	-	-	-
MW-4	08/23/2001	7.01	-	-	-	-	-	-	-	-	-	-	-
MW-4	11/27/2001	7.01	-	-	-	-	-	-	-	-	-	-	-

TABLE 1
GROUNDWATER MONITORING AND SAMPLING DATA
FORMER CHEVRON SERVICE STATION 9-1153
3135 GIBBONS DRIVE (3126 FERNSIDE BOULEVARD), ALAMEDA, CA

Location	Date	TOC	DTW	GWE	LNAPL	DO (Pre-Purged)	HYDROCARBONS		PRIMARY VOCS				
							TPH-GRO	B	T	E	X	MTBE by SW8260	
													ug/L
Units	ft	ft	ft	ft	mg/L	ug/L	ug/L	ug/L	ug/L	ug/L	ug/L		
MW-4	02/26/2002	7.01	1.37	5.64	0.00	-	<50	<0.50	<0.50	<0.50	<1.5	<2.5	
MW-4	05/23/2002	7.01	-	-	-	-	-	-	-	-	-	-	
MW-4	08/09/2002	7.01	-	-	-	-	-	-	-	-	-	-	
MW-4	11/08/2002	7.01	-	-	-	-	-	-	-	-	-	-	
MW-4	02/07/2003	7.01	1.72	5.29	0.00	-	<50	<0.50	<0.50	<0.50	<1.5	<2.5	
MW-4	05/09/2003	7.01	-	-	-	-	-	-	-	-	-	-	
MW-4	08/15/2003	7.01	-	-	-	-	-	-	-	-	-	-	
MW-4	11/14/2003	7.01	-	-	-	-	-	-	-	-	-	-	
MW-4	02/13/2004 ¹⁵	7.01	1.82	5.19	0.00	-	<50	<0.5	<0.5	<0.5	<0.5	<0.5	
MW-4	05/14/2004	7.01	-	-	-	-	-	-	-	-	-	-	
MW-4	11/12/2004	7.01	-	-	-	-	-	-	-	-	-	-	
MW-4	02/11/2005 ¹⁵	7.01	1.46	5.55	0.00	-	<50	<0.5	<0.5	<0.5	<0.5	<0.5	
MW-4	05/13/2005	7.01	-	-	-	-	-	-	-	-	-	-	
MW-4	08/19/2005	7.01	-	-	-	-	-	-	-	-	-	-	
MW-4	11/18/2005	7.01	-	-	-	-	-	-	-	-	-	-	
MW-4	02/10/2006 ¹⁵	7.01	1.35	5.66	0.00	-	<50	<0.5	<0.5	<0.5	<0.5	<0.5	
MW-4	05/12/2006	7.01	-	-	-	-	-	-	-	-	-	-	
MW-4	08/11/2006	7.01	-	-	-	-	-	-	-	-	-	-	
MW-4	11/17/2006	7.01	-	-	-	-	-	-	-	-	-	-	
MW-4	02/16/2007 ¹⁵	7.01	1.48	5.53	0.00	-	<50	<0.5	<0.5	<0.5	<0.5	<0.5	
MW-4	05/17/2007	7.01	-	-	-	-	-	-	-	-	-	-	
MW-4	08/09/2007	7.01	-	-	-	-	-	-	-	-	-	-	
MW-4	11/08/2007	7.01	-	-	-	-	-	-	-	-	-	-	
MW-4	02/06/2008 ¹⁵	7.01	1.27	5.74	0.00	-	<50	<0.5	<0.5	<0.5	<0.5	<0.5	
MW-4	05/07/2008	7.01	-	-	-	-	-	-	-	-	-	-	

TABLE 1
GROUNDWATER MONITORING AND SAMPLING DATA
FORMER CHEVRON SERVICE STATION 9-1153
3135 GIBBONS DRIVE (3126 FERNSIDE BOULEVARD), ALAMEDA, CA

Location	Date	TOC	DTW	GWE	LNAPL	DO (Pre-Purged)	HYDROCARBONS		PRIMARY VOCS				
							TPH-GRO	B	T	E	X	MTBE by SW8260	
													ug/L
Units	ft	ft	ft	ft	mg/L	ug/L	ug/L	ug/L	ug/L	ug/L	ug/L		
MW-4	09/11/2008	7.01	-	-	-	-	-	-	-	-	-	-	
MW-4	11/10/2008	7.01	-	-	-	-	-	-	-	-	-	-	
MW-4	02/09/2009 ¹⁵	7.01	2.33	4.68	0.00	-	<50	<0.5	<0.5	<0.5	<0.5	<0.5	
MW-4	03/31/2010	7.01	2.13	4.88	0.00	-	<50	<0.5	<0.5	<0.5	<0.5	<0.5	
MW-4	05/17/2010	7.01	2.05	4.96	0.00	-	-	-	-	-	-	-	
MW-5	06/04/1992	3.61	3.25	0.36	0.00	-	560	110	0.5	37	2.2	-	
MW-5	10/13/1992	3.61	4.20	-0.59	0.00	-	1200	150	<2.5	84	8.6	-	
MW-5	01/11/1993	3.61	1.30	2.31	0.00	-	1300	48	1.0	83	33	-	
MW-5	04/14/1993	3.61	1.20	2.41	0.00	-	2600	240	6.1	250	170	-	
MW-5	07/13/1993	3.61	3.15	0.46	0.00	-	1700	260	7.8	160	100	-	
MW-5	10/19/1993	3.61	3.82	-0.21	0.00	-	1900	190	3.3	200	93	-	
MW-5	11/30/1993	7.04	3.56	3.48	0.00	-	-	-	-	-	-	-	
MW-5	01/27/1994	7.04	2.42	4.62	0.00	-	4000	100	12	210	110	-	
MW-5	04/07/1994	7.04	2.33	4.71	0.00	-	2600	170	10	150	88	-	
MW-5	07/01/1994	7.04	3.18	3.86	0.00	-	2300	350	9.1	110	76	-	
MW-5	10/05/1994	7.04	3.98	3.06	0.00	-	11000	840	150	130	340	-	
MW-5	01/12/1995	7.04	0.40	6.64	0.00	-	2300	82	<2.5	54	20	-	
MW-5	04/26/1995	7.04	0.50	6.54	0.00	-	1600	52	<5.0	36	61	-	
MW-5	07/12/1995	7.04	2.41	4.63	0.00	-	2800	150	<5.0	34	38	-	
MW-5	10/30/1995	7.04	3.78	3.26	0.00	-	1100	81	<5.0	<5.0	<5.0	35	
MW-5	01/22/1996	7.04	0.78	6.26	0.00	-	880	7.3	<2.0	15	4.8	<10	
MW-5	04/24/1996	7.04	1.65	5.39	0.00	-	1600	51	3.8	14	5.6	56	
MW-5	07/29/1996	7.04	-	-	-	-	-	-	-	-	-	-	
MW-5	10/10/1996	7.04	3.60	3.44	0.00	-	1000	18	<1.2	1.5	<1.2	<6.2	

TABLE 1
GROUNDWATER MONITORING AND SAMPLING DATA
FORMER CHEVRON SERVICE STATION 9-1153
3135 GIBBONS DRIVE (3126 FERNSIDE BOULEVARD), ALAMEDA, CA

Location	Date	TOC	DTW	GWE	LNAPL	DO (Pre-Purged)	HYDROCARBONS		PRIMARY VOCS				
							TPH-GRO	B	T	E	X	MTBE by SW8260	
													ug/L
Units	ft	ft	ft	ft	mg/L	ug/L	ug/L	ug/L	ug/L	ug/L	ug/L		
MW-5	01/15/1997	7.04	0.45	6.59	0.00	-	520	0.84	<0.5	3.1	1.2	8.4	
MW-5	04/03/1997	7.04	2.11	4.93	0.00	-	1400	13	<2.0	4.3	8.4	32	
MW-5	07/09/1997	7.04	3.71	3.33	0.00	-	810	3.6	0.97	<0.5	<0.5	9.7	
MW-5	10/29/1997	7.04	4.20	2.84	0.00	-	<50	<0.5	<0.5	<0.5	<0.5	<2.5	
MW-5	01/14/1998	7.04	0.00	7.04	0.00	-	430	5.8	2.4	<0.5	1.6	17	
MW-5	04/17/1998	7.04	0.71	6.33	0.00	-	-	-	-	-	-	-	
MW-5	07/15/1998	7.04	0.00	7.04	0.00	-	990	11	3.9	0.56	2.2	61	
MW-5	10/27/1998	7.04	4.23	2.81	0.00	-	-	-	-	-	-	-	
MW-5	01/20/1999	7.04	2.58	4.46	0.00	-	168	<0.5	<0.5	<0.5	0.692	<2.0	
MW-5	04/19/1999	7.04	2.07	4.97	0.00	-	-	-	-	-	-	-	
MW-5	07/29/1999	7.04	3.43	3.61	0.00	-	246	1.54	<0.5	<0.5	<0.5	<5.0 / <2.0 ²	
MW-5	10/13/1999	7.04	-	-	-	-	-	-	-	-	-	-	
MW-5	01/25/2000	7.04	1.51	5.53	0.00	-	169	1.94	<0.5	<0.5	<0.5	201	
MW-5	04/03/2000	7.04	1.20	5.84	0.00	-	-	-	-	-	-	-	
MW-5	07/03/2000	7.04	2.98	4.06	0.00	-	320 ^{6,10}	5.3	1.1	<0.50	<0.50	5.0	
MW-5	10/23/2000	7.04	4.18	2.86	0.00	-	-	-	-	-	-	-	
MW-5	01/08/2001 ¹¹	7.04	2.92	4.12	0.00	-	220 ⁶	3.9	<0.50	<0.50	<0.50	7.7	
MW-5	04/09/2001	7.04	1.01	6.03	0.00	-	-	-	-	-	-	-	
MW-5	08/23/2001	7.04	3.48	3.56	0.00	-	630	40	3.5	<2.5	<2.5	43	
MW-5	11/27/2001	7.04	3.05	3.99	0.00	-	-	-	-	-	-	-	
MW-5	02/26/2002	7.04	1.00	6.04	0.00	-	410	4.3	<0.50	<0.50	<1.5	<2.5	
MW-5	05/23/2002	7.04	2.21	4.83	0.00	-	-	-	-	-	-	-	
MW-5	08/09/2002	7.04	3.38	3.66	0.00	-	240	1.3	<0.50	<0.50	<1.5	<2.5	
MW-5	11/08/2002	7.04	4.56	2.48	0.00	-	-	-	-	-	-	-	
MW-5	02/07/2003	7.04	1.42	5.62	0.00	-	380	3.2	<0.50	0.64	<1.5	<2.5	

TABLE 1
GROUNDWATER MONITORING AND SAMPLING DATA
FORMER CHEVRON SERVICE STATION 9-1153
3135 GIBBONS DRIVE (3126 FERNSIDE BOULEVARD), ALAMEDA, CA

Location	Date	TOC	DTW	GWE	LNAPL	DO (Pre-Purged)	HYDROCARBONS	PRIMARY VOCS				
							TPH-GRO	B	T	E	X	MTBE by SW8260
Units	ft	ft	ft	ft	mg/L	ug/L	ug/L	ug/L	ug/L	ug/L	ug/L	
MW-5	05/09/2003	7.04	1.25	5.79	0.00	-	-	-	-	-	-	-
MW-5	08/15/2003 ¹⁵	7.04	3.61	3.43	0.00	-	<50	<0.5	<0.5	<0.5	<0.5	<0.5
MW-5	11/14/2003	7.04	3.57	3.47	0.00	-	-	-	-	-	-	-
MW-5	02/13/2004 ¹⁵	7.04	1.50	5.54	0.00	-	<50	<0.5	<0.5	<0.5	<0.5	<0.5
MW-5	05/14/2004	7.04	2.47	4.57	0.00	-	-	-	-	-	-	-
MW-5	08/13/2004 ¹⁵	7.04	5.46	1.58	0.00	-	<50	<0.5	<0.5	<0.5	<0.5	<0.5
MW-5	11/12/2004	7.04	4.65	2.39	0.00	-	-	-	-	-	-	-
MW-5	02/11/2005 ¹⁵	7.04	1.20	5.84	0.00	-	130	<0.5	<0.5	<0.5	<0.5	<0.5
MW-5	05/13/2005	7.04	4.36	2.68	0.00	-	-	-	-	-	-	-
MW-5	08/19/2005 ¹⁵	7.04	2.78	4.26	0.00	-	96	<0.5	<0.5	<0.5	<0.5	<0.5
MW-5	11/18/2005	7.04	4.51	2.53	0.00	-	-	-	-	-	-	-
MW-5	02/10/2006 ¹⁵	7.04	1.12	5.92	0.00	-	<50	<0.5	<0.5	<0.5	<0.5	<0.5
MW-5	05/12/2006	7.04	2.23	4.81	0.00	-	-	-	-	-	-	-
MW-5	08/11/2006 ¹⁵	7.04	3.40	3.64	0.00	-	<50	<0.5	<0.5	<0.5	<0.5	<0.5
MW-5	11/17/2006	7.04	4.16	2.88	0.00	-	-	-	-	-	-	-
MW-5	02/16/2007 ¹⁵	7.04	1.22	5.82	0.00	-	<50	<0.5	<0.7	<0.8	<0.8	<0.5
MW-5	05/17/2007	7.04	4.06	2.98	0.00	-	-	-	-	-	-	-
MW-5	08/09/2007 ¹⁵	7.04	3.61	3.43	0.00	-	<50	<0.5	<0.5	<0.5	<0.5	<0.5
MW-5	11/08/2007	7.04	3.70	3.34	0.00	-	-	-	-	-	-	-
MW-5	02/06/2008 ¹⁵	7.04	1.06	5.98	0.00	-	<50	<0.5	<0.5	<0.5	<0.5	<0.5
MW-5	05/07/2008	7.04	3.57	3.47	0.00	-	-	-	-	-	-	-
MW-5	09/11/2008 ¹⁵	7.04	4.58	2.46	0.00	-	<50	<0.5	<0.5	<0.5	<0.5	<0.5
MW-5	11/10/2008	7.04	4.26	2.78	0.00	-	-	-	-	-	-	-
MW-5	02/09/2009 ¹⁵	7.04	2.15	4.89	0.00	-	<50	<0.5	<0.5	<0.5	<0.5	<0.5
MW-5	05/28/2009	7.04	2.76	4.28	0.00	-	-	-	-	-	-	-

TABLE 1
GROUNDWATER MONITORING AND SAMPLING DATA
FORMER CHEVRON SERVICE STATION 9-1153
3135 GIBBONS DRIVE (3126 FERNSIDE BOULEVARD), ALAMEDA, CA

Location	Date	TOC	DTW	GWE	LNAPL	DO (Pre-Purged)	HYDROCARBONS		PRIMARY VOCS				
							TPH-GRO	B	T	E	X	MTBE by SW8260	
													ug/L
Units	ft	ft	ft	ft	mg/L	ug/L	ug/L	ug/L	ug/L	ug/L	ug/L		
MW-5	08/18/2009 ¹⁵	7.04	3.81	3.23	0.00	-	<50	<0.5	<0.5	<0.5	<0.5	<0.5	
MW-5	11/17/2009	7.04	4.02	3.02	0.00	-	-	-	-	-	-	-	
MW-5	03/31/2010	7.04	1.86	5.18	0.00	-	<50	<0.5	<0.5	<0.5	<0.5	<0.5	
MW-5	05/17/2010	7.04	1.57	5.47	0.00	-	-	-	-	-	-	-	
MW-6	06/04/1992	3.85	3.89	-0.04	0.00	-	210	54	<0.5	1.9	2.4	-	
MW-6	10/13/1992	3.85	4.56	-0.71	0.00	-	10000	5300	<10	70	<10	-	
MW-6	01/11/1993	3.85	2.36	1.49	0.00	-	100	50	<0.5	<0.5	<0.5	-	
MW-6	04/14/1993	3.85	3.15	0.70	0.00	-	<50	<0.5	<0.5	<0.5	<0.5	-	
MW-6	07/13/1993	3.85	3.94	-0.09	0.00	-	<50	1.8	<0.5	<0.5	<1.5	-	
MW-6	10/19/1993	3.85	4.40	-0.55	0.00	-	320	150	<0.5	0.8	<0.5	-	
MW-6	11/30/1993	7.27	4.16	3.11	0.00	-	-	-	-	-	-	-	
MW-6	01/27/1994	7.27	3.33	3.94	0.00	-	120	45	<0.5	<0.5	<0.5	-	
MW-6	04/07/1994	7.27	3.43	3.84	0.00	-	<50	<0.5	<0.5	<0.5	<0.5	-	
MW-6	07/01/1994	7.27	3.94	3.33	0.00	-	<50	<0.5	<0.5	<0.5	<0.5	-	
MW-6	10/05/1994	7.27	4.38	2.89	0.00	-	8300	2400	160	42	190	-	
MW-6	01/12/1995 ¹	7.27	2.43	4.84	0.00	-	<50	12	<0.5	<0.5	<0.5	-	
MW-6	04/26/1995	7.27	2.06	5.21	0.00	-	<50	5.5	0.67	<0.5	1.3	-	
MW-6	07/12/1995	7.27	3.53	3.74	0.00	-	65	27	<0.5	<0.5	<0.5	-	
MW-6	10/30/1995	7.27	4.34	2.93	0.00	-	<50	3.9	<0.5	<0.5	<0.5	<2.5	
MW-6	01/22/1996	7.27	2.61	4.66	0.00	-	<50	0.93	<0.5	<0.5	<0.5	<2.5	
MW-6	04/24/1996	7.27	2.50	4.77	0.00	-	260	110	<1.2	<1.2	<1.2	<6.2	
MW-6	07/29/1996	7.27	3.85	3.42	0.00	-	<50	23	<0.5	<0.5	<0.5	<2.5	
MW-6	10/10/1996	7.27	4.37	2.90	0.00	-	79	31	<0.5	<0.5	<0.5	<2.5	
MW-6	01/15/1997	7.27	2.63	4.64	0.00	-	<50	<0.5	<0.5	<0.5	<0.5	<2.5	

TABLE 1
GROUNDWATER MONITORING AND SAMPLING DATA
FORMER CHEVRON SERVICE STATION 9-1153
3135 GIBBONS DRIVE (3126 FERNSIDE BOULEVARD), ALAMEDA, CA

Location	Date	TOC	DTW	GWE	LNAPL	DO (Pre-Purged)	HYDROCARBONS		PRIMARY VOCS				
							TPH-GRO	B	T	E	X	MTBE by SW8260	
													ug/L
Units	ft	ft	ft	ft	mg/L	ug/L	ug/L	ug/L	ug/L	ug/L	ug/L		
MW-6	04/03/1997	7.27	3.42	3.85	0.00	-	670	360	<5.0	<5.0	<5.0	<25	
MW-6	07/09/1997	7.27	4.29	2.98	0.00	-	330	140	<2.0	<2.0	<2.0	<10	
MW-6	10/29/1997	7.27	4.56	2.71	0.00	-	400	260	<2.0	<2.0	<2.0	5.8	
MW-6	01/14/1998	7.27	1.01	6.26	0.00	-	<50	<0.5	<0.5	<0.5	<0.5	<2.5	
MW-6	04/17/1998	7.27	2.94	4.33	0.00	-	<50	1.7	<0.5	<0.5	<0.5	<2.5	
MW-6	07/15/1998	7.27	4.72	2.55	0.00	-	<50	<0.5	<0.5	<0.5	<0.5	<2.5	
MW-6	10/27/1998	7.27	-	-	-	-	-	-	-	-	-	-	
MW-6	11/25/1998	7.27	4.16	3.11	0.00	-	110 ³	54	<0.5	<0.5	<0.5	<2.5	
MW-6	01/20/1999	7.27	3.45	3.82	0.00	-	<50	10	<0.5	<0.5	<0.5	<2.0	
MW-6	04/19/1999	7.27	3.39	3.88	0.00	-	<50	2.6	<0.5	<0.5	<0.5	<2.5 / <2.0 ²	
MW-6	07/29/1999 ⁴	7.27	4.34	2.93	0.00	-	<5000	2590	<50	<50	<50	<500	
MW-6	10/13/1999	7.27	5.89	1.38	0.00	-	9270	4610	44.2	<25	<25	<125	
MW-6	01/25/2000	7.27	4.11	3.16	0.00	-	529	289	<0.5	<0.5	<0.5	738	
MW-6	04/03/2000 ^{7,8}	7.27	2.84	4.43	0.00	-	<50	<0.50	<0.50	<0.50	<0.50	<2.5	
MW-6	07/03/2000 ⁷	7.27	3.77	3.50	0.00	-	91 ⁶	89	0.77	<0.50	<0.50	<2.5	
MW-6	10/12/2000	7.27	6.32	0.95	0.00	-	<50	8.0	<0.50	<0.50	<0.50	<2.5	
MW-6	01/08/2001 ^{7,11}	7.27	3.74	3.53	0.00	-	400 ⁶	640	8.2	8.0	5.0	10	
MW-6	04/09/2001 ⁷	7.27	3.03	4.24	0.00	-	91.3	22.0	3.36	0.751	2.14	<0.500	
MW-6	08/23/2001 ⁷	7.27	4.70	2.57	0.00	-	53 ¹³	23	0.50	<0.50	1.1	<2.5	
MW-6	11/27/2001 ¹⁴	7.27	4.43	2.84	0.00	-	<50	4.1	<0.50	<0.50	<1.5	<2.5	
MW-6	02/26/2002 ¹⁴	7.27	2.50	4.77	0.00	-	100	53	<0.50	<0.50	<1.5	<2.5	
MW-6	05/23/2002	7.27	3.27	4.00	0.00	-	610	260	4.2	1.7	2.1	<2.5	
MW-6	08/09/2002	7.27	4.11	3.16	0.00	-	<50	1.1	<0.50	<0.50	<1.5	<2.5	
MW-6	11/08/2002	7.27	4.12	3.15	0.00	2.10	<50	<0.50	<0.50	<0.50	<1.5	<2.5	
MW-6	02/07/2003	7.27	2.60	4.67	0.00	2.60	<50	0.65	<0.50	<0.50	<1.5	<2.5	

TABLE 1
GROUNDWATER MONITORING AND SAMPLING DATA
FORMER CHEVRON SERVICE STATION 9-1153
3135 GIBBONS DRIVE (3126 FERNSIDE BOULEVARD), ALAMEDA, CA

Location	Date	TOC	DTW	GWE	LNAPL	DO (Pre-Purged)	HYDROCARBONS		PRIMARY VOCS				
							TPH-GRO	B	T	E	X	MTBE by SW8260	
													ug/L
MW-6	05/09/2003	7.27	2.57	4.70	0.00	3.10	<50	1.9	<0.5	<0.5	<1.5	<2.5	
MW-6	08/15/2003 ¹⁵	7.27	4.15	3.12	0.00	2.90	<50	<0.5	<0.5	<0.5	<0.5	<0.5	
MW-6	11/14/2003 ¹⁵	7.27	4.10	3.17	0.00	3.41	<50	<0.5	0.6	<0.5	<0.5	1	
MW-6	02/13/2004 ¹⁵	7.27	2.66	4.61	0.00	-	<50	<0.5	<0.5	<0.5	<0.5	<0.5	
MW-6	05/14/2004 ¹⁵	7.27	3.55	3.72	0.00	-	<50	3	<0.5	<0.5	<0.5	<0.5	
MW-6	08/13/2004 ¹⁵	7.27	4.32	2.95	0.00	-	<50	<0.5	<0.5	<0.5	<0.5	<0.5	
MW-6	11/12/2004 ¹⁵	7.27	4.20	3.07	0.00	-	<50	<0.5	<0.5	<0.5	<0.5	<0.5	
MW-6	02/11/2005 ¹⁵	7.27	2.18	5.09	0.00	-	<50	<0.5	<0.5	<0.5	<0.5	<0.5	
MW-6	05/13/2005 ¹⁵	7.27	4.11	3.16	0.00	-	<50	<0.5	<0.5	<0.5	<0.5	<0.5	
MW-6	08/19/2005 ¹⁵	7.27	3.70	3.57	0.00	1.90	<50	<0.5	<0.5	<0.5	<0.5	<0.5	
MW-6	11/18/2005 ¹⁵	7.27	3.98	3.29	0.00	1.70	<50	<0.5	<0.5	<0.5	<0.5	<0.5	
MW-6	02/10/2006 ¹⁵	7.27	2.11	5.16	0.00	2.20	<50	<0.5	<0.5	<0.5	<0.5	<0.5	
MW-6	05/12/2006 ¹⁵	7.27	3.18	4.09	0.00	2.80	<50	<0.5	<0.5	<0.5	<0.5	<0.5	
MW-6	08/11/2006 ¹⁵	7.27	3.80	3.47	0.00	2.50	<50	<0.5	<0.5	<0.5	<0.5	<0.5	
MW-6	11/17/2006 ¹⁵	7.27	3.78	3.49	0.00	2.20	<50	<0.5	<0.5	<0.5	<0.5	<0.5	
MW-6	02/16/2007 ¹⁵	7.27	2.08	5.19	0.00	1.80	<50	1	<0.5	<0.5	<0.5	<0.5	
MW-6	05/17/2007 ¹⁵	7.27	3.61	3.66	0.00	2.0	<50	<0.5	<0.5	<0.5	<0.5	<0.5	
MW-6	08/09/2007 ¹⁵	7.27	4.05	3.22	0.00	2.6	<50	<0.5	<0.5	<0.5	<0.5	<0.5	
MW-6	11/08/2007 ¹⁵	7.27	4.12	3.15	0.00	2.2	<50	5	<0.5	<0.5	<0.5	<0.5	
MW-6	02/06/2008 ¹⁵	7.27	1.85	5.42	0.00	2.4	<50	<0.5	<0.5	<0.5	<0.5	<0.5	
MW-6	05/07/2008 ¹⁵	7.27	3.91	3.36	0.00	2.3	63	18	<0.5	<0.5	<0.5	<0.5	
MW-6	09/11/2008 ¹⁵	7.27	4.93	2.34	0.00	1.9	<50	<0.5	<0.5	<0.5	<0.5	<0.5	
MW-6	11/10/2008 ¹⁵	7.27	4.30	2.97	0.00	2.2	<50	<0.5	<0.5	<0.5	<0.5	<0.5	
MW-6	02/09/2009 ¹⁵	7.27	2.97	4.30	0.00	2.0	<50	2	<0.5	<0.5	<0.5	<0.5	
MW-6	05/28/2009 ¹⁵	7.27	3.53	3.74	0.00	1.77	<50	4	<0.5	<0.5	<0.5	<0.5	

TABLE 1
GROUNDWATER MONITORING AND SAMPLING DATA
FORMER CHEVRON SERVICE STATION 9-1153
3135 GIBBONS DRIVE (3126 FERNSIDE BOULEVARD), ALAMEDA, CA

Location	Date	TOC	DTW	GWE	LNAPL	DO (Pre-Purged)	HYDROCARBONS		PRIMARY VOCS				
							TPH-GRO	B	T	E	X	MTBE by SW8260	
													ug/L
Units	ft	ft	ft	ft	mg/L	ug/L	ug/L	ug/L	ug/L	ug/L	ug/L		
MW-6	08/18/2009 ¹⁵	7.27	3.38	3.89	0.00	1.81	560	130	3	<0.5	0.7J	<0.5	
MW-6	11/17/2009	7.27	4.00	3.27	0.00	-	-	-	-	-	-	-	
MW-6	03/31/2010	7.27	2.44	4.83	0.00	-	<50	<0.5	<0.5	<0.5	<0.5	<0.5	
MW-6	05/17/2010	7.27	3.30	3.97	0.00	-	-	-	-	-	-	-	
MW-7	11/30/1993	8.22	5.33	2.89	0.00	-	480	110	41	4.4	38	-	
MW-7	01/27/1994	8.22	4.50	3.72	0.00	-	120	21	1.1	2.2	4.8	-	
MW-7	04/07/1994	8.22	4.62	3.60	0.00	-	2600	630	39	56	94	-	
MW-7	07/01/1994	8.22	5.13	3.09	0.00	-	2200	770	42	<10	92	-	
MW-7	10/05/1994	8.22	5.61	2.61	0.00	-	15000	3300	90	130	320	-	
MW-7	01/12/1995	8.22	2.83	5.39	0.00	-	340	57	<1.3	18	6.4	-	
MW-7	04/26/1995	8.22	2.35	5.87	0.00	-	15000	3700	210	520	800	-	
MW-7	07/12/1995	8.22	4.66	3.56	0.00	-	7700	1800	59	130	370	-	
MW-7	10/30/1995	8.22	5.48	2.74	0.00	-	770	260	<5.0	33	48	25	
MW-7	01/22/1996	8.22	3.34	4.88	0.00	-	290	63	<1.0	6.4	5.7	<5.0	
MW-7	04/24/1996	8.22	4.12	4.10	0.00	-	12000	2500	510	380	810	<125	
MW-7	07/29/1996	8.22	5.03	3.19	0.00	-	2600	650	<25	61	150	<125	
MW-7	10/10/1996	8.22	5.52	2.70	0.00	-	5800	1700	28	170	210	<62	
MW-7	01/15/1997	8.22	2.92	5.30	0.00	-	1000	230	<2.5	28	11	63	
MW-7	04/03/1997	8.22	4.65	3.57	0.00	-	6000	1800	100	140	170	<100	
MW-7	07/09/1997	8.22	5.39	2.83	0.00	-	5500	2200	<20	41	30	<100	
MW-7	10/29/1997	8.22	5.58	2.64	0.00	-	220	40	0.61	3.0	2.4	7.6	
MW-7	01/14/1998	8.22	2.80	5.42	0.00	-	140	5.1	<0.5	<0.5	1.4	<2.5	
MW-7	04/17/1998	8.22	3.00	5.22	0.00	-	13000	4200	98	250	240	250	
MW-7	07/15/1998	8.22	-	-	-	-	-	-	-	-	-	-	

TABLE 1
GROUNDWATER MONITORING AND SAMPLING DATA
FORMER CHEVRON SERVICE STATION 9-1153
3135 GIBBONS DRIVE (3126 FERNSIDE BOULEVARD), ALAMEDA, CA

Location	Date	TOC	DTW	GWE	LNAPL	DO (Pre-Purged)	HYDROCARBONS	PRIMARY VOCS				
							TPH-GRO	B	T	E	X	MTBE by SW8260
	Units	ft	ft	ft	ft	mg/L	ug/L	ug/L	ug/L	ug/L	ug/L	ug/L
MW-7	08/17/1998 ⁵	7.92	5.52	2.40	0.00	-	1600	380	51	68	280	22
MW-7	10/27/1998	7.92	7.51	0.41	0.00	-	190	2.3	0.53	<0.5	<0.5	33
MW-7	01/20/1999	7.92	3.45	4.47	0.00	-	<50	<0.5	<0.5	<0.5	<0.5	<2.0
MW-7	04/19/1999	7.92	4.61	3.31	0.00	-	6500	3000	<0.5	110	210	310 / 150 ²
MW-7	07/29/1999 ⁴	7.92	5.00	2.92	0.00	-	8390	2100	129	222	729	248
MW-7	10/13/1999	7.92	5.61	2.31	0.00	-	14300	6600	58.8	117	190	<125
MW-7	01/25/2000	7.92	3.32	4.60	0.00	-	1100	184	<5.0	13.5	33.7	151
MW-7	04/03/2000 ^{7,9}	7.92	3.38	4.54	0.00	-	2600 ⁶	780	12	<5.0	61	95
MW-7	07/03/2000 ⁷	7.92	4.34	3.58	0.00	-	4100 ⁶	2600	72	240	690	<50
MW-7	10/23/2000	7.92	6.11	1.81	0.00	-	12000 ⁶	2600	<50	150	290	<250
MW-7	01/08/2001 ^{7,11}	7.92	4.32	3.60	0.00	-	3900 ⁶	2200	61	140	350	<25
MW-7	04/09/2001 ⁷	7.92	3.63	4.29	0.00	-	25100	4590	1200	843	1920	48.1
MW-7	08/23/2001 ⁷	7.92	4.83	3.09	0.00	-	27000	4100	970	1100	3500	<500
MW-7	11/27/2001	7.92	4.30	3.62	0.00	-	12000	1800	50	450	830	91
MW-7	02/26/2002	7.92	3.00	4.92	0.00	-	15000	3100	260	380	860	<10
MW-7	05/23/2002	7.92	3.69	4.23	0.00	-	28000	6000	120	820	1900	42
MW-7	08/09/2002	7.92	4.38	3.54	0.00	-	24000	3700	81	710	1300	56
MW-7	11/08/2002	7.92	4.43	3.49	0.00	-98.00	18000	2300	150	660	1400	<100
MW-7	02/07/2003	7.92	3.20	4.72	0.00	2.90	13000	2300	200	310	620	<25
MW-7	05/09/2003	7.92	3.18	4.74	0.00	2.60	17000	4200	36	350	360	<50
MW-7	08/15/2003 ¹⁵	7.92	4.75	3.17	0.00	2.30	29000	7300	140	780	1900	<5
MW-7	11/14/2003 ¹⁵	7.92	4.95	2.97	0.00	1.87	7200	950	3	45	20	7
MW-7	02/13/2004 ¹⁵	7.92	3.29	4.63	0.00	-	3300	360	4	82	130	3
MW-7	05/14/2004 ¹⁵	7.92	3.98	3.94	0.00	-	17000	3100	480	510	1300	3
MW-7	08/13/2004 ¹⁵	7.92	5.94	1.98	0.00	-	10000	2000	4	130	150	4

TABLE 1
GROUNDWATER MONITORING AND SAMPLING DATA
FORMER CHEVRON SERVICE STATION 9-1153
3135 GIBBONS DRIVE (3126 FERNSIDE BOULEVARD), ALAMEDA, CA

Location	Date	TOC	DTW	GWE	LNAPL	DO (Pre-Purged)	HYDROCARBONS	PRIMARY VOCS				
							TPH-GRO	B	T	E	X	MTBE by SW8260
Units	ft	ft	ft	ft	mg/L	ug/L	ug/L	ug/L	ug/L	ug/L	ug/L	
MW-7	11/12/2004 ¹⁵	7.92	4.50	3.42	0.00	-	680	4	<0.5	1	0.7	0.8
MW-7	02/11/2005 ¹⁵	7.92	3.07	4.85	0.00	-	4600	680	6	80	44	4
MW-7	05/13/2005 ¹⁵	7.92	4.51	3.41	0.00	-	4200	380	3	38	13	2
MW-7	08/19/2005 ¹⁵	7.92	4.03	3.89	0.00	0.80	7900	1300	3	190	310	<1
MW-7	11/18/2005 ¹⁵	7.92	4.62	3.30	0.00	0.90	3900	4	1	16	8	2
MW-7	02/10/2006 ¹⁵	7.92	3.12	4.80	0.00	1.30	3200	320	2	14	8	2
MW-7	05/12/2006 ¹⁵	7.92	4.25	3.67	0.00	1.40	3600	1000	2	65	27	<1
MW-7	08/11/2006 ¹⁵	7.92	4.45	3.47	0.00	1.10	6700	1900	6	280	300	<1
MW-7	11/17/2006 ¹⁵	7.92	4.71	3.21	0.00	0.70	1200	0.6	<0.5	1	0.8	<0.5
MW-7	02/16/2007 ¹⁵	7.92	3.26	4.66	0.00	1.10	110	<0.5	<0.5	<0.5	<0.5	<0.5
MW-7	05/17/2007 ¹⁵	7.92	4.62	3.30	0.00	1.7	6400	1400	4	130	26	<1
MW-7	08/09/2007 ¹⁵	7.92	4.61	3.31	0.00	1.2	10000	1400	4	230	12	<3
MW-7	11/08/2007 ¹⁵	7.92	4.72	3.20	0.00	0.9	2300	4	1	3	7	0.9
MW-7	02/06/2008 ¹⁵	7.92	2.98	4.94	0.00	0.5	190	<0.5	<0.5	<0.5	<0.5	<0.5
MW-7	05/07/2008 ¹⁵	7.92	4.48	3.44	0.00	1.2	8000	1500	15	380	260	<1
MW-7	09/11/2008 ¹⁵	7.92	5.95	1.97	0.00	1.0	5100	530	4	47	12	0.7
MW-7	11/10/2008 ¹⁵	7.92	5.81	2.11	0.00	0.6	2800	13	1	1	7	<0.5
MW-7	02/09/2009 ¹⁵	7.92	4.06	3.86	0.00	0.8	3900	190	2	51	11	0.5
MW-7	05/28/2009 ^{15,17}	7.92	3.84	4.08	0.00	0.45	5800	870 J	8 J	220 J	27 J	<0.5 UJ
MW-7	08/18/2009 ¹⁵	7.92	4.80	3.12	0.00	0.57	6700	660	4	110	13	0.7 J
MW-7	11/17/2009	7.92	4.52	3.40	0.00	-	-	-	-	-	-	-
MW-7	03/31/2010	7.92	3.11	4.81	0.00	-	2000	110	1	2	3	0.7 J
MW-7	05/17/2010	7.92	3.41	4.51	0.00	-	-	-	-	-	-	-
MW-8	10/17/1995	6.96	4.40	2.56	0.00	-	-	-	-	-	-	-

TABLE 1
GROUNDWATER MONITORING AND SAMPLING DATA
FORMER CHEVRON SERVICE STATION 9-1153
3135 GIBBONS DRIVE (3126 FERNSIDE BOULEVARD), ALAMEDA, CA

Location	Date	TOC	DTW	GWE	LNAPL	DO (Pre-Purged)	HYDROCARBONS		PRIMARY VOCS				
							TPH-GRO	B	T	E	X	MTBE by SW8260	
													ug/L
Units	ft	ft	ft	ft	mg/L	ug/L	ug/L	ug/L	ug/L	ug/L	ug/L		
MW-8	10/30/1995	6.96	4.44	2.52	0.00	-	<50	<0.5	<0.5	<0.5	<0.5	<2.5	
MW-8	01/22/1996	6.96	2.24	4.72	0.00	-	<50	<0.5	<0.5	<0.5	<0.5	<2.5	
MW-8	04/24/1996	6.96	2.97	3.99	0.00	-	<50	<0.5	<0.5	<0.5	<0.5	<2.5	
MW-8	07/29/1996	6.96	3.37	3.59	0.00	-	<50	<0.5	<0.5	<0.5	<0.5	<2.5	
MW-8	10/10/1996	6.96	4.12	2.84	0.00	-	<50	<0.5	<0.5	<0.5	<0.5	<2.5	
MW-8	01/15/1997	6.96	0.94	6.02	0.00	-	<50	<0.5	<0.5	<0.5	<0.5	<2.5	
MW-8	04/03/1997	6.96	2.20	4.76	0.00	-	<50	<0.5	<0.5	<0.5	<0.5	<2.5	
MW-8	07/09/1997	6.96	4.30	2.66	0.00	-	<50	<0.5	<0.5	<0.5	<0.5	<2.5	
MW-8	10/29/1997	6.96	4.57	2.39	0.00	-	<50	<0.5	<0.5	<0.5	<0.5	<2.5	
MW-8	01/14/1998	6.96	0.83	6.13	0.00	-	<50	<0.5	<0.5	<0.5	<0.5	<2.5	
MW-8	01/20/1999	6.96	2.69	4.27	0.00	-	<50	<0.5	<0.5	<0.5	<0.5	<2.0	
MW-8	04/19/1999	6.96	3.76	3.20	0.00	-	-	-	-	-	-	-	
MW-8	01/25/2000	6.96	1.41	5.55	0.00	-	<50	<0.5	<0.5	<0.5	<0.5	<2.5	
MW-8	04/03/2000	6.96	-	-	-	-	-	-	-	-	-	-	
MW-8	07/03/2000	6.96	-	-	-	-	-	-	-	-	-	-	
MW-8	10/23/2000	6.96	-	-	-	-	-	-	-	-	-	-	
MW-8	01/08/2001 ¹¹	6.96	3.58	3.38	0.00	-	<50	<0.50	<0.50	<0.50	<0.50	<2.5	
MW-8	04/09/2001	6.96	-	-	-	-	-	-	-	-	-	-	
MW-8	08/23/2001	6.96	-	-	-	-	-	-	-	-	-	-	
MW-8	11/27/2001	6.96	-	-	-	-	-	-	-	-	-	-	
MW-8	02/26/2002	6.96	2.91	4.05	0.00	-	<50	<0.50	<0.50	<0.50	<1.5	<2.5	
MW-8	05/23/2002	6.96	-	-	-	-	-	-	-	-	-	-	
MW-8	08/09/2002	6.96	-	-	-	-	-	-	-	-	-	-	
MW-8	11/08/2002	6.96	-	-	-	-	-	-	-	-	-	-	
MW-8	02/07/2003	6.96	3.13	3.83	0.00	-	<50	<0.50	<0.50	<0.50	<1.5	<2.5	

TABLE 1
GROUNDWATER MONITORING AND SAMPLING DATA
FORMER CHEVRON SERVICE STATION 9-1153
3135 GIBBONS DRIVE (3126 FERNSIDE BOULEVARD), ALAMEDA, CA

Location	Date	TOC	DTW	GWE	LNAPL	DO (Pre-Purged)	HYDROCARBONS	PRIMARY VOCS				
							TPH-GRO	B	T	E	X	MTBE by SW8260
	Units	ft	ft	ft	ft	mg/L	ug/L	ug/L	ug/L	ug/L	ug/L	ug/L
MW-8	05/09/2003	6.96	-	-	-	-	-	-	-	-	-	-
MW-8	08/15/2003	6.96	-	-	-	-	-	-	-	-	-	-
MW-8	11/14/2003	6.96	-	-	-	-	-	-	-	-	-	-
MW-8	02/13/2004 ¹⁵	6.96	3.20	3.76	0.00	-	<50	<0.5	<0.5	<0.5	<0.5	<0.5
MW-8	05/14/2004	6.96	-	-	-	-	-	-	-	-	-	-
MW-8	11/12/2004	6.96	-	-	-	-	-	-	-	-	-	-
MW-8	02/11/2005 ¹⁵	6.96	2.85	4.11	0.00	-	<50	<0.5	<0.5	<0.5	<0.5	<0.5
MW-8	05/13/2005	6.96	-	-	-	-	-	-	-	-	-	-
MW-8	08/19/2005	6.96	-	-	-	-	-	-	-	-	-	-
MW-8	11/18/2005	6.96	-	-	-	-	-	-	-	-	-	-
MW-8	02/10/2006 ¹⁵	6.96	2.74	4.22	<50	-	<0.5	<0.5	<0.5	<0.5	<0.5	<0.5
MW-8	05/12/2006	6.96	-	-	-	-	-	-	-	-	-	-
MW-8	08/11/2006	6.96	-	-	-	-	-	-	-	-	-	-
MW-8	11/17/2006	6.96	-	-	-	-	-	-	-	-	-	-
MW-8	02/16/2007 ¹⁵	6.96	2.69	4.27	0.00	-	<50	<0.5	<0.5	<0.5	<0.5	<0.5
MW-8	05/17/2007	6.96	-	-	-	-	-	-	-	-	-	-
MW-8	08/09/2007	6.96	-	-	-	-	-	-	-	-	-	-
MW-8	11/08/2007	6.96	-	-	-	-	-	-	-	-	-	-
MW-8	02/06/2008 ¹⁵	6.96	2.57	4.39	0.00	-	<50	<0.5	<0.5	<0.5	<0.5	<0.5
MW-8	05/07/2008	6.96	-	-	-	-	-	-	-	-	-	-
MW-8	09/11/2008	6.96	-	-	-	-	-	-	-	-	-	-
MW-8	11/10/2008	6.96	-	-	-	-	-	-	-	-	-	-
MW-8	02/09/2009 ¹⁵	6.96	3.28	3.68	0.00	-	<50	<0.5	<0.5	<0.5	<0.5	<0.5
MW-8	03/31/2010	6.96	2.85	4.11	0.00	-	<50	<0.5	<0.5	<0.5	<0.5	<0.5
MW-8	05/17/2010	6.96	3.33	3.63	0.00	-	-	-	-	-	-	-

TABLE 1
GROUNDWATER MONITORING AND SAMPLING DATA
FORMER CHEVRON SERVICE STATION 9-1153
3135 GIBBONS DRIVE (3126 FERNSIDE BOULEVARD), ALAMEDA, CA

Location	Date	TOC	DTW	GWE	LNAPL	DO (Pre-Purged)	HYDROCARBONS	PRIMARY VOCS				
							TPH-GRO	B	T	E	X	MTBE by SW8260
	Units	ft	ft	ft	ft	mg/L	ug/L	ug/L	ug/L	ug/L	ug/L	ug/L
MW-9	10/17/1995	7.21	4.80	2.41	0.00	-	-	-	-	-	-	-
MW-9	10/30/1995	7.21	4.97	2.24	0.00	-	<50	<0.5	<0.5	<0.5	<0.5	<2.5
MW-9	01/22/1996	7.21	3.40	3.81	0.00	-	<50	<0.5	<0.5	<0.5	<0.5	<2.5
MW-9	04/24/1996	7.21	4.18	3.03	0.00	-	<50	<0.5	<0.5	<0.5	<0.5	<2.5
MW-9	07/29/1996	7.21	4.69	2.52	0.00	-	<50	<0.5	<0.5	<0.5	<0.5	<2.5
MW-9	10/10/1996	7.21	5.20	2.01	0.00	-	<50	<0.5	<0.5	<0.5	<0.5	<2.5
MW-9	01/15/1997	7.21	3.31	3.90	0.00	-	<50	<0.5	<0.5	<0.5	<0.5	<2.5
MW-9	04/03/1997	7.21	4.57	2.64	0.00	-	<50	<0.5	<0.5	<0.5	<0.5	<2.5
MW-9	07/09/1997	7.21	5.04	2.17	0.00	-	<50	<0.5	<0.5	<0.5	<0.5	<2.5
MW-9	10/29/1997	7.21	4.96	2.25	0.00	-	<50	<0.5	<0.5	<0.5	<0.5	<2.5
MW-9	01/14/1998	7.21	2.40	4.81	0.00	-	<50	<0.5	<0.5	<0.5	<0.5	<2.5
MW-9	01/20/1999	7.21	4.31	2.90	0.00	-	<50	<0.5	<0.5	<0.5	<0.5	<2.0
MW-9	04/19/1999	7.21	3.92	3.29	0.00	-	-	-	-	-	-	-
MW-9	01/25/2000	7.21	2.95	4.26	0.00	-	<50	<0.5	<0.5	<0.5	<0.5	<2.5
MW-9	04/03/2000	7.21	-	-	-	-	-	-	-	-	-	-
MW-9	07/03/2000	7.21	-	-	-	-	-	-	-	-	-	-
MW-9	10/23/2000	7.21	-	-	-	-	-	-	-	-	-	-
MW-9	01/08/2001 ¹¹	7.21	4.59	2.62	0.00	-	<50	<0.50	<0.50	<0.50	<0.50	<2.5
MW-9	04/09/2001	7.21	-	-	-	-	-	-	-	-	-	-
MW-9	08/23/2001	7.21	-	-	-	-	-	-	-	-	-	-
MW-9	11/27/2001	7.21	-	-	-	-	-	-	-	-	-	-
MW-9	02/26/2002	7.21	3.75	3.46	0.00	-	<50	<0.50	<0.50	<0.50	<1.5	<2.5
MW-9	05/23/2002	7.21	-	-	-	-	-	-	-	-	-	-
MW-9	08/09/2002	7.21	-	-	-	-	-	-	-	-	-	-

TABLE 1
GROUNDWATER MONITORING AND SAMPLING DATA
FORMER CHEVRON SERVICE STATION 9-1153
3135 GIBBONS DRIVE (3126 FERNSIDE BOULEVARD), ALAMEDA, CA

Location	Date	TOC	DTW	GWE	LNAPL	DO (Pre-Purged)	HYDROCARBONS	PRIMARY VOCS				
							TPH-GRO	B	T	E	X	MTBE by SW8260
	Units	ft	ft	ft	ft	mg/L	ug/L	ug/L	ug/L	ug/L	ug/L	ug/L
MW-9	11/08/2002	7.21	-	-	-	-	-	-	-	-	-	-
MW-9	02/07/2003	7.21	3.97	3.24	0.00	-	<50	<0.50	<0.50	<0.50	<1.5	<2.5
MW-9	05/09/2003	7.21	-	-	-	-	-	-	-	-	-	-
MW-9	08/15/2003	7.21	-	-	-	-	-	-	-	-	-	-
MW-9	11/14/2003	7.21	-	-	-	-	-	-	-	-	-	-
MW-9	02/13/2004 ¹⁵	7.21	3.94	3.27	0.00	-	<50	<0.5	<0.5	<0.5	<0.5	<0.5
MW-9	05/14/2004	7.21	-	-	-	-	-	-	-	-	-	-
MW-9	11/12/2004	7.21	-	-	-	-	-	-	-	-	-	-
MW-9	02/11/2005 ¹⁵	7.21	3.66	3.55	0.00	-	<50	<0.5	<0.5	<0.5	<0.5	<0.5
MW-9	05/13/2005	7.21	-	-	-	-	-	-	-	-	-	-
MW-9	08/19/2005	7.21	-	-	-	-	-	-	-	-	-	-
MW-9	11/18/2005	7.21	-	-	-	-	-	-	-	-	-	-
MW-9	02/10/2006 ¹⁵	7.21	3.53	3.68	0.00	-	<0.5	<0.5	<0.5	<0.5	<0.5	<0.5
MW-9	05/12/2006	7.21	-	-	-	-	-	-	-	-	-	-
MW-9	08/11/2006	7.21	-	-	-	-	-	-	-	-	-	-
MW-9	11/17/2006	7.21	-	-	-	-	-	-	-	-	-	-
MW-9	02/16/2007 ¹⁵	7.21	3.50	3.71	0.00	-	<50	<0.5	<0.5	<0.5	<0.5	<0.5
MW-9	05/17/2007	7.21	-	-	-	-	-	-	-	-	-	-
MW-9	08/09/2007	7.21	-	-	-	-	-	-	-	-	-	-
MW-9	11/08/2007	7.21	-	-	-	-	-	-	-	-	-	-
MW-9	02/06/2008 ¹⁵	7.21	3.14	4.07	0.00	-	<50	<0.5	<0.5	<0.5	<0.5	<0.5
MW-9	05/07/2008	7.21	-	-	-	-	-	-	-	-	-	-
MW-9	09/11/2008	7.21	-	-	-	-	-	-	-	-	-	-
MW-9	11/10/2008	7.21	-	-	-	-	-	-	-	-	-	-
MW-9	02/09/2009 ¹⁵	7.21	3.91	3.30	0.00	-	<50	<0.5	<0.5	<0.5	<0.5	<0.5

TABLE 1
GROUNDWATER MONITORING AND SAMPLING DATA
FORMER CHEVRON SERVICE STATION 9-1153
3135 GIBBONS DRIVE (3126 FERNSIDE BOULEVARD), ALAMEDA, CA

Location	Date	TOC	DTW	GWE	LNAPL	DO (Pre-Purged)	HYDROCARBONS		PRIMARY VOCS				
							TPH-GRO	B	T	E	X	MTBE by SW8260	
													ug/L
Units	ft	ft	ft	ft	mg/L	ug/L	ug/L	ug/L	ug/L	ug/L	ug/L		
MW-9	03/31/2010	7.21	3.16	4.05	0.00	-	<50	<0.5	<0.5	<0.5	<0.5	<0.5	
MW-9	05/17/2010	7.21	3.44	3.77	0.00	-	-	-	-	-	-	-	
MW-10	10/17/1995	7.28	5.05	2.23	-	-	-	-	-	-	-	-	
MW-10	10/30/1995	7.28	5.11	2.17	0.00	-	<50	<0.5	<0.5	<0.5	<0.5	5.1	
MW-10	01/22/1996	7.28	4.03	3.25	0.00	-	<50	<0.5	<0.5	<0.5	0.70	17	
MW-10	04/24/1996	7.28	4.30	2.98	0.00	-	<50	<0.5	<0.5	<0.5	<0.5	12	
MW-10	07/29/1996	7.28	4.70	2.58	0.00	-	<50	<0.5	<0.5	<0.5	<0.5	14	
MW-10	10/10/1996	7.28	5.24	2.04	0.00	-	<50	<0.5	<0.5	<0.5	<0.5	<2.5	
MW-10	01/15/1997	7.28	3.35	3.93	0.00	-	<50	<0.5	<0.5	<0.5	<0.5	<2.5	
MW-10	04/03/1997	7.28	4.64	2.64	0.00	-	<50	<0.5	<0.5	<0.5	<0.5	8.2	
MW-10	07/09/1997	7.28	5.12	2.16	0.00	-	<50	<0.5	<0.5	<0.5	<0.5	<2.5	
MW-10	10/29/1997	7.28	5.10	2.18	0.00	-	<50	<0.5	<0.5	<0.5	<0.5	5.3	
MW-10	01/14/1998	7.28	3.08	4.20	0.00	-	<50	<0.5	<0.5	<0.5	<0.5	8.6	
MW-10	04/17/1998	7.28	3.79	3.49	0.00	-	-	-	-	-	-	-	
MW-10	07/15/1998	7.28	4.55	2.73	0.00	-	<50	<0.5	<0.5	<0.5	<0.5	7.5	
MW-10	10/27/1998	7.28	5.32	1.96	0.00	-	-	-	-	-	-	-	
MW-10	01/20/1999	7.28	4.24	3.04	0.00	-	<50	<0.5	<0.5	<0.5	<0.5	<2.0	
MW-10	04/19/1999	7.28	4.07	3.21	0.00	-	-	-	-	-	-	-	
MW-10	07/29/1999	7.28	4.82	2.46	0.00	-	<50	<0.5	<0.5	<0.5	<0.5	<5.0 / <2.4 ²	
MW-10	10/13/1999	7.28	4.86	2.42	0.00	-	-	-	-	-	-	-	
MW-10	01/25/2000	7.28	3.00	4.28	0.00	-	<50	<0.5	<0.5	<0.5	<0.5	4.33	
MW-10	04/03/2000	7.28	3.04	4.24	0.00	-	-	-	-	-	-	-	
MW-10	07/03/2000	7.28	4.00	3.28	0.00	-	<50	<0.50	<0.50	<0.50	<0.50	4.7	
MW-10	10/23/2000	7.28	5.86	1.42	0.00	-	-	-	-	-	-	-	

TABLE 1
GROUNDWATER MONITORING AND SAMPLING DATA
FORMER CHEVRON SERVICE STATION 9-1153
3135 GIBBONS DRIVE (3126 FERNSIDE BOULEVARD), ALAMEDA, CA

Location	Date	TOC	DTW	GWE	LNAPL	DO (Pre-Purged)	HYDROCARBONS		PRIMARY VOCS				
							TPH-GRO	B	T	E	X	MTBE by SW8260	
													ug/L
Units	ft	ft	ft	ft	mg/L	ug/L	ug/L	ug/L	ug/L	ug/L	ug/L		
MW-10	01/08/2001 ¹¹	7.28	3.98	3.30	0.00	-	<50	<0.50	<0.50	<0.50	<0.50	<2.5	
MW-10	04/09/2001	7.28	3.74	3.54	0.00	-	-	-	-	-	-	-	
MW-10	08/23/2001	7.28	-	-	-	-	-	-	-	-	-	-	
MW-10	11/27/2001	7.28	4.13	3.15	0.00	-	-	-	-	-	-	-	
MW-10	02/26/2002	7.28	3.54	3.74	0.00	-	<50	<0.50	<0.50	<0.50	<1.5	<2.5	
MW-10	05/23/2002	7.28	3.82	3.46	0.00	-	-	-	-	-	-	-	
MW-10	08/09/2002	7.28	4.18	3.10	0.00	-	<50	<0.50	<0.50	<0.50	<1.5	<2.5	
MW-10	11/08/2002	7.28	3.91	3.37	0.00	-	-	-	-	-	-	-	
MW-10	02/07/2003	7.28	3.61	3.67	0.00	-	<50	<0.50	<0.50	<0.50	<1.5	<2.5	
MW-10	05/09/2003	7.28	3.25	4.03	0.00	-	-	-	-	-	-	-	
MW-10	08/15/2003 ¹⁵	7.28	4.35	2.93	0.00	-	<50	<0.5	<0.5	<0.5	<0.5	<0.5	
MW-10	11/14/2003	7.28	4.30	2.98	0.00	-	-	-	-	-	-	-	
MW-10	02/13/2004 ¹⁵	7.28	4.27	3.01	0.00	-	<50	<0.5	<0.5	<0.5	<0.5	<0.5	
MW-10	05/14/2004	7.28	4.08	3.20	0.00	-	-	-	-	-	-	-	
MW-10	08/13/2004 ¹⁵	7.28	3.92	3.36	0.00	-	<50	<0.5	<0.5	<0.5	<0.5	<0.5	
MW-10	11/12/2004	7.28	3.98	3.30	0.00	-	-	-	-	-	-	-	
MW-10	02/11/2005 ¹⁵	7.28	4.07	3.21	0.00	-	<50	<0.5	<0.5	<0.5	<0.5	<0.5	
MW-10	05/13/2005	7.28	4.01	3.27	0.00	-	-	-	-	-	-	-	
MW-10	08/19/2005 ¹⁵	7.28	3.69	3.59	0.00	-	<50	<0.5	<0.5	<0.5	<0.5	<0.5	
MW-10	11/18/2005	7.28	3.86	3.42	0.00	-	-	-	-	-	-	-	
MW-10	02/10/2006 ¹⁵	7.28	3.94	3.34	0.00	-	<0.5	<0.5	<0.5	<0.5	<0.5	<0.5	
MW-10	05/12/2006	7.28	4.07	3.21	0.00	-	-	-	-	-	-	-	
MW-10	08/11/2006 ¹⁵	7.28	4.21	3.07	0.00	-	<50	<0.5	<0.5	<0.5	<0.5	<0.5	
MW-10	11/17/2006	7.28	3.83	3.45	0.00	-	-	-	-	-	-	-	
MW-10	02/16/2007 ¹⁵	7.28	3.87	3.41	0.00	-	<50	<0.5	<0.5	<0.5	<0.5	<0.5	

TABLE 1
GROUNDWATER MONITORING AND SAMPLING DATA
FORMER CHEVRON SERVICE STATION 9-1153
3135 GIBBONS DRIVE (3126 FERNSIDE BOULEVARD), ALAMEDA, CA

Location	Date	TOC	DTW	GWE	LNAPL	DO (Pre-Purged)	HYDROCARBONS		PRIMARY VOCS				
							TPH-GRO	B	T	E	X	MTBE by SW8260	
													ug/L
Units	ft	ft	ft	ft	mg/L	ug/L	ug/L	ug/L	ug/L	ug/L	ug/L		
MW-10	05/17/2007	7.28	3.71	3.57	0.00	-	-	-	-	-	-	-	
MW-10	08/09/2007	7.28	-	-	-	-	-	-	-	-	-	-	
MW-10	11/08/2007	7.28	-	-	-	-	-	-	-	-	-	-	
MW-10	02/06/2008	7.28	-	-	-	-	-	-	-	-	-	-	
MW-10	05/07/2008	7.28	-	-	-	-	-	-	-	-	-	-	
MW-10	09/11/2008 ¹⁵	7.28	4.63	2.65	0.00	-	<50	<0.5	<0.5	<0.5	<0.5	<0.5	
MW-10	11/10/2008	7.28	4.28	3.00	0.00	-	-	-	-	-	-	-	
MW-10	02/09/2009 ¹⁵	7.28	2.17	5.11	0.00	-	<50	<0.5	<0.5	<0.5	<0.5	<0.5	
MW-10	05/28/2009	7.28	3.69	3.59	0.00	-	-	-	-	-	-	-	
MW-10	08/18/2009 ¹⁵	7.28	4.07	3.21	0.00	-	<50	<0.5	<0.5	<0.5	<0.5	<0.5	
MW-10	11/17/2009	7.28	4.12	3.16	0.00	-	-	-	-	-	-	-	
MW-10	03/31/2010	7.28	3.43	3.85	0.00	-	<50	<0.5	<0.5	<0.5	<0.5	<0.5	
MW-10	05/17/2010	7.28	3.53	3.75	0.00	-	-	-	-	-	-	-	
TRIP BLANK	02/14/1990	-	-	-	-	-	<50	<0.5	1.1	<0.5	<0.5	-	
TRIP BLANK	09/06/1991	-	-	-	-	-	<50	<0.5	<0.5	<0.5	<0.5	-	
TRIP BLANK	12/15/1991	-	-	-	-	-	<50	<0.5	<0.5	<0.5	<0.5	-	
TRIP BLANK	03/03/1992	-	-	-	-	-	<50	<0.5	<0.5	<0.5	<0.5	-	
TRIP BLANK	06/04/1992	-	-	-	-	-	<50	<0.5	<0.5	<0.5	<0.5	-	
TRIP BLANK	10/13/1992	-	-	-	-	-	<50	<0.5	<0.5	<0.5	<0.5	-	
TRIP BLANK	01/11/1993	-	-	-	-	-	<50	<0.5	<0.5	<0.5	<0.5	-	
TRIP BLANK	04/14/1993	-	-	-	-	-	<50	<0.5	<0.5	<0.5	<0.5	-	
TRIP BLANK	07/13/1993	-	-	-	-	-	<50	<0.5	<0.5	<0.5	<0.5	-	
TRIP BLANK	10/19/1993	-	-	-	-	-	<50	<0.5	<0.5	<0.5	<1.5	-	
TRIP BLANK	01/27/1994	-	-	-	-	-	<50	<0.5	<0.5	<0.5	<0.5	-	

TABLE 1
GROUNDWATER MONITORING AND SAMPLING DATA
FORMER CHEVRON SERVICE STATION 9-1153
3135 GIBBONS DRIVE (3126 FERNSIDE BOULEVARD), ALAMEDA, CA

Location	Date	TOC	DTW	GWE	LNAPL	DO (Pre-Purged)	HYDROCARBONS		PRIMARY VOCS				
							TPH-GRO	B	T	E	X	MTBE by SW8260	
	Units	ft	ft	ft	ft	mg/L	ug/L	ug/L	ug/L	ug/L	ug/L	ug/L	
TRIP BLANK	04/07/1994	-	-	-	-	-	<50	<0.5	<0.5	<0.5	<0.5	-	
TRIP BLANK	07/01/1994	-	-	-	-	-	<50	<0.5	<0.5	<0.5	<0.5	-	
TRIP BLANK	10/05/1994	-	-	-	-	-	<50	<0.5	<0.5	<0.5	<0.5	-	
TRIP BLANK	01/12/1995	-	-	-	-	-	<50	<0.5	<0.5	<0.5	<0.5	-	
TRIP BLANK	04/26/1995	-	-	-	-	-	<50	<0.5	<0.5	<0.5	<0.5	-	
TRIP BLANK	07/12/1995	-	-	-	-	-	<50	<0.5	<0.5	<0.5	<0.5	-	
TRIP BLANK	10/30/1995	-	-	-	-	-	<50	<0.5	<0.5	<0.5	<0.5	-	
TRIP BLANK	01/22/1996	-	-	-	-	-	<50	<0.5	<0.5	<0.5	<0.5	<2.5	
TRIP BLANK	04/24/1996	-	-	-	-	-	<50	<0.5	<0.5	<0.5	<0.5	<2.5	
TRIP BLANK	07/29/1996	-	-	-	-	-	<50	<0.5	<0.5	<0.5	<0.5	<2.5	
TRIP BLANK	01/15/1997	-	-	-	-	-	<50	<0.5	<0.5	<0.5	<0.5	<2.5	
TRIP BLANK	04/03/1997	-	-	-	-	-	<50	<0.5	<0.5	<0.5	<0.5	<2.5	
TRIP BLANK	07/09/1997	-	-	-	-	-	<50	<0.5	<0.5	<0.5	<0.5	<2.5	
TRIP BLANK	10/29/1997	-	-	-	-	-	<50	<0.5	<0.5	<0.5	<0.5	<2.5	
TRIP BLANK	01/14/1998	-	-	-	-	-	<50	<0.5	<0.5	<0.5	<0.5	<2.5	
TRIP BLANK	04/17/1998	-	-	-	-	-	<50	<0.5	<0.5	<0.5	<0.5	<2.5	
TRIP BLANK	07/15/1998	-	-	-	-	-	<50	<0.5	<0.5	<0.5	<0.5	<2.5	
TRIP BLANK	10/27/1998	-	-	-	-	-	<50	<0.5	<0.5	<0.5	<0.5	<2.5	
TRIP BLANK	01/20/1999	-	-	-	-	-	<50	<0.5	<0.5	<0.5	<0.5	<2.0	
TRIP BLANK	04/19/1999	-	-	-	-	-	<50	<0.5	<0.5	<0.5	<0.5	<2.5	
TRIP BLANK	07/29/1999	-	-	-	-	-	<50	<0.5	<0.5	<0.5	<0.5	<5.0	
TRIP BLANK	10/13/1999	-	-	-	-	-	<50	<0.5	<0.5	<0.5	<0.5	<2.5	
TRIP BLANK	01/25/2000	-	-	-	-	-	<50	<0.5	<0.5	<0.5	<0.5	<2.5	
TRIP BLANK	04/03/2000	-	-	-	-	-	<50	<0.50	<0.50	<0.50	<0.50	<2.5	
TRIP BLANK	07/03/2000	-	-	-	-	-	<50	<0.50	<0.50	<0.50	<0.50	<2.5	

TABLE 1
GROUNDWATER MONITORING AND SAMPLING DATA
FORMER CHEVRON SERVICE STATION 9-1153
3135 GIBBONS DRIVE (3126 FERNSIDE BOULEVARD), ALAMEDA, CA

Location	Date	TOC	DTW	GWE	LNAPL	DO (Pre-Purged)	HYDROCARBONS		PRIMARY VOCS				
							TPH-GRO	B	T	E	X	MTBE by SW8260	
	Units	ft	ft	ft	ft	mg/L	ug/L	ug/L	ug/L	ug/L	ug/L	ug/L	
TRIP BLANK	10/23/2000	-	-	-	-	-	<50	<0.50	<0.50	<0.50	<0.50	<2.5	
TRIP BLANK	01/08/2001 ¹¹	-	-	-	-	-	<50	<0.50	<0.50	<0.50	<0.50	<2.5	
TRIP BLANK	04/09/2001	-	-	-	-	-	<50.0	<0.500	<2.00	<0.500	<2.00	<0.500	
TRIP BLANK	08/23/2001	-	-	-	-	-	<50	<0.50	<0.50	<0.50	<0.50	<2.5	
TRIP BLANK	11/27/2001	-	-	-	-	-	<50	<0.50	<0.50	<0.50	<1.5	<2.5	
TRIP BLANK	02/26/2002	-	-	-	-	-	<50	<0.50	<0.50	<0.50	<1.5	<2.5	
TRIP BLANK	05/23/2002	-	-	-	-	-	<50	<0.50	<0.50	<0.50	<1.5	<2.5	
TRIP BLANK	08/09/2002	-	-	-	-	-	<50	<0.50	<0.50	<0.50	<1.5	<2.5	
TRIP BLANK	11/08/2002	-	-	-	-	-	<50	<0.50	<0.50	<0.50	<1.5	<2.5	
TRIP BLANK	02/07/2003	-	-	-	-	-	<50	<0.50	<0.50	<0.50	<1.5	<2.5	
TRIP BLANK	05/09/2003	-	-	-	-	-	<50	<0.5	<0.5	<0.5	<1.5	<2.5	
TRIP BLANK	08/15/2003 ¹⁵	-	-	-	-	-	<50	<0.5	<0.5	<0.5	<0.5	<0.5	
TRIP BLANK	11/14/2003	-	-	-	-	-	<50	<0.5	<0.5	<0.5	<0.5	<0.5	
TRIP BLANK	02/13/2004 ¹⁵	-	-	-	-	-	<50	<0.5	<0.5	<0.5	<0.5	<0.5	
TRIP BLANK	05/14/2004 ¹⁵	-	-	-	-	-	<50	<0.5	<0.5	<0.5	<0.5	<0.5	
TRIP BLANK	08/13/2004	-	-	-	-	-	<50	<0.5	<0.5	<0.5	<0.5	<0.5	
TRIP BLANK	11/12/2004	-	-	-	-	-	<50	<0.5	<0.5	<0.5	<0.5	<0.5	
TRIP BLANK	02/11/2005	-	-	-	-	-	<50	<0.5	<0.5	<0.5	<0.5	<0.5	
TRIP BLANK	05/13/2005	-	-	-	-	-	<50	<0.5	<0.5	<0.5	<0.5	<0.5	
TRIP BLANK	08/19/2005	-	-	-	-	-	<50	<0.5	<0.5	<0.5	<0.5	<0.5	
TRIP BLANK	11/18/2005	-	-	-	-	-	<50	<0.5	<0.5	<0.5	<0.5	<0.5	
TRIP BLANK	02/10/2006	-	-	-	-	-	<50	<0.5	<0.5	<0.5	<0.5	<0.5	
TRIP BLANK	05/12/2006	-	-	-	-	-	<50	<0.5	<0.5	<0.5	<0.5	<0.5	
TRIP BLANK	08/11/2006	-	-	-	-	-	<50	<0.5	<0.5	<0.5	<0.5	<0.5	
TRIP BLANK	11/17/2006	-	-	-	-	-	<50	<0.5	<0.5	<0.5	<0.5	<0.5	

TABLE 1
GROUNDWATER MONITORING AND SAMPLING DATA
FORMER CHEVRON SERVICE STATION 9-1153
3135 GIBBONS DRIVE (3126 FERNSIDE BOULEVARD), ALAMEDA, CA

Location	Date	TOC	DTW	GWE	LNAPL	DO (Pre-Purged)	HYDROCARBONS		PRIMARY VOCS				
							TPH-GRO	B	T	E	X	MTBE by SW8260	
	Units	ft	ft	ft	ft	mg/L	ug/L	ug/L	ug/L	ug/L	ug/L	ug/L	
TRIP BLANK	02/16/2007	-	-	-	-	-	<50	<0.5	<0.5	<0.5	<0.5	<0.5	
TRIP BLANK	05/17/2007	-	-	-	-	-	<50	<0.5	<0.5	<0.5	<0.5	<0.5	
TRIP BLANK	08/09/2007	-	-	-	-	-	<50	<0.5	<0.5	<0.5	<0.5	<0.5	
TRIP BLANK	11/08/2007	-	-	-	-	-	<50	<0.5	<0.5	<0.5	<0.5	<0.5	
TRIP BLANK	02/06/2008	-	-	-	-	-	<50	<0.5	<0.5	<0.5	<0.5	<0.5	
TRIP BLANK	05/07/2008	-	-	-	-	-	<50	<0.5	<0.5	<0.5	<0.5	<0.5	
TRIP BLANK	09/11/2008	-	-	-	-	-	<50	<0.5	<0.5	<0.5	<0.5	<0.5	
TRIP BLANK	11/10/2008	-	-	-	-	-	<50	<0.5	<0.5	<0.5	<0.5	<0.5	
TRIP BLANK	02/09/2009	-	-	-	-	-	<50	<0.5	<0.5	<0.5	<0.5	<0.5	
TRIP BLANK	05/28/2009 ¹⁵	-	-	-	-	-	<50	<0.5	<0.5	<0.5	<0.5	<0.5	
TRIP BLANK	08/18/2009 ¹⁵	-	-	-	-	-	<50	<0.5	<0.5	<0.5	<0.5	<0.5	
TRIP BLANK	03/31/2010	-	-	-	-	-	<50	<0.5	<0.5	<0.5	<0.5	<0.5	
C-2	09/04/1986	-	-	-	-	-	1100	49	18	84	-	-	
C-2	07/22/1987	-	-	-	-	-	<50	1.8	<1.0	<4.0	-	-	
TMW-1	11/11/1993	-	-	-	-	-	<1.0	<0.5	<0.5	<0.5	<0.5	-	
3115A GIBBONS DR.	01/14/1998	-	-	-	-	-	<50	<0.5	<0.5	<0.5	<0.5	<2.5	

EXPLANATIONS:

TOC = Top of Casing

DTP = Depth to Product

DTW = Depth to Water

**TABLE 1
GROUNDWATER MONITORING AND SAMPLING DATA
FORMER CHEVRON SERVICE STATION 9-1153
3135 GIBBONS DRIVE (3126 FERNSIDE BOULEVARD), ALAMEDA, CA**

Location	Date	TOC	DTW	GWE	LNAPL	DO (Pre-Purged)	HYDROCARBONS		PRIMARY VOCS			
							TPH-GRO	B	T	E	X	MTBE by SW8260
	Units	ft	ft	ft	ft	mg/L	ug/L	ug/L	ug/L	ug/L	ug/L	ug/L

GWE = Groundwater Elevation
 (ft-amsl) = Feet Above Mean sea level
 LNAPL = Light Non-Aqueous Phase Liquid Thickness
 DO = Dissolved Oxygen
 TPH-GRO = Total Petroleum Hydrocarbons - Gasoline Range Organics
 B = Benzene
 T = Toluene
 E = Ethylbenzene
 X = Xylenes
 MTBE = Methyl Tertiary Butyl Ether
 Ft. = Feet
 Mg/L = Milligrams per liter
 µg/L = Micrograms per liter
 -- = Not available/not applicable
 <x = Not detected above laboratory method detection limit
 J = Estimated value
 U = Compound not detected

** GWE has been corrected due to the presence of LNAPL; correction factor: [(TOC - DTW) + (LNAPL x 0.80)].

- 1 Laboratory report indicates EPA 8010 were not detected (ND)
- 2 MTBE confirmed
- 3 Chromatogram report indicates an unidentified hydrocarbon
- 4 ORC installed
- 5 TOC elevation altered due to well head maintenance
- 6 Laboratory report indicates gasoline C6-C12
- 7 ORC in well

TABLE 1
GROUNDWATER MONITORING AND SAMPLING DATA
FORMER CHEVRON SERVICE STATION 9-1153
3135 GIBBONS DRIVE (3126 FERNSIDE BOULEVARD), ALAMEDA, CA

<i>Location</i>	<i>Date</i>	<i>TOC</i>	<i>DTW</i>	<i>GWE</i>	<i>LNAPL</i>	<i>DO (Pre-Purged)</i>	<i>HYDROCARBONS</i>		<i>PRIMARY VOCS</i>				
							<i>TPH-GRO</i>	<i>B</i>	<i>T</i>	<i>E</i>	<i>X</i>	<i>MTBE by SW8260</i>	
	<i>Units</i>	<i>ft</i>	<i>ft</i>	<i>ft</i>	<i>ft</i>	<i>mg/L</i>	<i>ug/L</i>	<i>ug/L</i>	<i>ug/L</i>	<i>ug/L</i>	<i>ug/L</i>	<i>ug/L</i>	<i>ug/L</i>

8 Laboratory report indicates Dissolved Oxygen was 1.50 parts per million (ppm) by EPA Method 360.1
9 Laboratory report indicates Dissolved Oxygen was 0.300 ppm by EPA Method 360.1
10 Laboratory report indicates sample originally shot in hold time at a raise D.L. re-analyzed and reported past hold time
11 Laboratory report indicates this sample was analyzed outside of the EPA recommended holding time
12 Laboratory report indicates unidentified hydrocarbons C6-C12
13 Laboratory report indicates hydrocarbon pattern is present in the requested fuel quantitation range but does not resemble the pattern of the :
14 ORC removed
15 BTEX and MTBE by EPA Method 8260
16 Laboratory confirmed analytical result
17 The vial submitted did not have pH<2. The pH of this sample used for the undiluted analysis was pH = 3

ATTACHMENT A

BLAINE TECH'S MAY 27, 2010 *SECOND QUARTER 2010 MONITORING REPORT*



May 27, 2010

Chevron Environmental Management Company
Aaron Costa
6111 Bollinger Canyon Rd.
San Ramon, CA 94583

Second Quarter 2010 Monitoring at
Chevron Service Station 91153
3135 Gibbons Dr.
Alameda, CA

Monitoring performed on May 17, 2010

Blaine Tech Services, Inc. Groundwater Monitoring Event 100517-FS1

This submission covers the routine monitoring of groundwater wells conducted on May 17, 2010 at this location. Nine monitoring wells were measured for depth to groundwater (DTW). Zero monitoring wells were sampled. Well C-1 was not sampled due to presence of SPH. SPH was bailed from the well and placed into drum that was removed by IWM the same day. All other wells are sampled on a semi-annual frequency. All sampling activities were performed in accordance with local, state and federal guidelines.

Water levels measurements were collected using an electronic slope indicator. All sampled wells were purged of three case volumes, depending on well recovery, or until water temperature, pH and conductivity stabilized. Purging was accomplished using electric submersible pumps, positive air-displacement pumps or stainless steel, Teflon or disposable bailers. Subsequent sample collection and sample handling was performed in accordance with EPA protocols using disposable bailers. Alternately, where applicable, wells were sampled utilizing no-purge methodology. All reused equipment was decontaminated in an integrated stainless steel sink with de-ionized water supplied Hotsy pressure washer and Liquinox or equivalent.

First Quarter Groundwater Monitoring at Chevron 91153, 3135 Gibbons Dr., Alameda, CA

SAN JOSE

SACRAMENTO

LOS ANGELES

SAN DIEGO

1680 ROGERS AVENUE

SAN JOSE, CA 95112-1105

(408) 573-0555

FAX (408) 573-7771

LIC. 746684

www.blainetech.com

Samples were delivered under chain-of-custody to Lancaster Laboratories of Lancaster, Pennsylvania, for analysis. Monitoring well purgewater and equipment rinsate water was collected and transported under bill-of-lading to IWM facilities of San Jose, California.

Enclosed documentation from this event includes copies of the Well Gauging Sheet, Well Monitoring Data Sheets, and Chain-of-Custody.

Blaine Tech Services, Inc.'s activities at this site consisted of objective data and sample collection only. No interpretation of analytical results, defining of hydrogeologic conditions or formulation of recommendations was performed.

Please call if you have any questions.

Sincerely,



Dustin Becker
Blaine Tech Services, Inc.
Senior Project Manager

attachments: SOP
Well Gauging Sheet
Individual Well Monitoring Data Sheets
Wellhead Inspection Form

cc: CRA
Attn: Nathan Lee
5900 Hollis St. Suite A
Emeryville, CA 94608

First Quarter Groundwater Monitoring at Chevron 91153, 3135 Gibbons Dr., Alameda, CA

SAN JOSE

SACRAMENTO

LOS ANGELES

SAN DIEGO

1680 ROGERS AVENUE

SAN JOSE, CA 95112-1105

(408) 573-0555

FAX (408) 573-7771

LIC. 746684

www.blainetech.com

BLAINE TECH SERVICES, INC. METHODS AND PROCEDURES FOR THE ROUTINE MONITORING OF GROUNDWATER WELLS AT CHEVRON SITES

Blaine Tech Services, Inc. performs environmental sampling and documentation as an independent third party. We specialize in groundwater monitoring assignments and intentionally limit the scope of our services to those centered on the generation of objective information.

To avoid conflicts of interest, Blaine Tech Services, Inc. personnel do not evaluate or interpret the information we collect. As a state licensed contractor (C-57 well drilling –water – 746684) performing strictly technical services, we do not make any professional recommendations and perform no consulting of any kind.

SAMPLING PROCEDURES OVERVIEW

SAFETY

All groundwater monitoring assignments performed for Chevron comply with Chevron's safety guidelines, 29 CFR 1910.120 and SB-198 Injury and Illness Prevention Program (IIPP). All Field Technicians receive the full 40-hour 29CFR 1910.120 OSHA SARA HAZWOPER course, medical clearance and on-the-job training prior to commencing any work on any Chevron site.

INSPECTION AND GAUGING

Wells are inspected prior to evacuation and sampling. The condition of the wellhead is checked and noted according to a wellhead inspection checklist.

Standard measurements include the depth to water (DTW) and the total well depth (TD) obtained with industry standard electronic water level indicators that are graduated in increments of hundredths of a foot.

The water in each well is inspected for the presence of immiscibles. When free product is suspected, its presence is confirmed using an electronic interface probe (e.g. GeoTech). No samples are collected from a well containing over two-hundredths of a foot (0.02') of product.

EVACUATION

Depth to water measurements are collected by our personnel prior to purging and minimum purge volumes are calculated anew for each well based on the height of the water column and the diameter of the well. Expected purge volumes are never less than three case volumes and are set at no less than four case volumes in some jurisdictions.

Well purging devices are selected on the basis of the well diameter and the total volume to be

evacuated. In most cases the well will be purged using an electric submersible pump (i.e. Grundfos) suspended near (but not touching) the bottom of the well.

PARAMETER STABILIZATION

Well purging completion standards include minimum purge volumes, but additionally require stabilization of specific groundwater parameters prior to sample collection. Typical groundwater parameters used to measure stability are electrical conductivity, pH, and temperature. Instrument readings are obtained at regular intervals during the evacuation process (no less than once per case volume).

Stabilization standards for routine quarterly monitoring of fuel sites include the following: Temperature is considered to have stabilized when successive readings do not fluctuate more than +/- 1 degree Celsius. Electrical conductivity is considered stable when successive readings are within 10%. pH is considered to be stable when successive readings remain constant or vary no more than 0.2 of a pH unit.

DEWATERED WELLS

Normal evacuation removes no less than three case volumes of water from the well. However, less water may be removed in cases where the well dewateres and does not immediately recharge.

MEASURING RECHARGE

Upon completion of well purging, a depth to water measurement is collected and notated to ensure that the well has recharged to within 80% of its static, pre-purge level prior to sampling.

Wells that do not immediately show 80% recharge or dewatered wells will be allowed approximately 2 hours to recharge prior to sampling or will be sampled at site departure. All wells requiring off-site traffic control in the public right-of-way, the 80% recharge rule may be disregarded in the interests of Health and Safety. The sample may be collected as soon as there is sufficient water. The water level at time of sampling will be noted.

PURGEWATER CONTAINMENT

All non-hazardous purgewater evacuated from each groundwater monitoring well is captured and contained in on-board storage tanks on the Sampling Vehicle and/or special water hauling trailers. Effluent from the decontamination of reusable apparatus (sounders, electric pumps and hoses etc.), consisting of groundwater combined with deionized water and non-phosphate soap, is also captured and pumped into effluent tanks.

Non-hazardous purgewater is transported under standard Bill of Lading documentation to a Blaine Tech Services, Inc. facility before being transported to a Chevron approved disposal facility.

SAMPLE COLLECTION DEVICES

All samples are collected using disposable bailers.

SAMPLE CONTAINERS

Sample material is decanted directly from the sampling bailer into sample containers provided by the laboratory that will analyze the samples. The transfer of sample material from the bailer to the sample container conforms to specifications contained in the USEPA T.E.G.D. The type of sample container, material of construction, method of closure and filling requirements are specific to the intended analysis. Chemicals needed to preserve the sample material are commonly placed inside the sample containers by the laboratory or glassware vendor prior to delivery of the bottle to our personnel. The laboratory sets the number of replicate containers.

TRIP BLANKS

Trip Blanks, if requested, are taken to the site and kept inside the sample cooler for the duration of the event. They are turned over to the laboratory for analysis with the samples from that site.

DUPLICATES

Duplicates, if requested, may be collected at a site. The Duplicate sample is collected, typically from the well containing the most measurable contaminants. The Duplicate sample is labeled the same as the original.

SAMPLE STORAGE

All sample containers are promptly placed in food grade ice chests for storage in the field and transport (direct or via our facility) to the designated analytical laboratory. These ice chests contain quantities of restaurant grade ice as a refrigerant material. The samples are maintained in either an ice chest or a refrigerator until relinquished into the custody of the laboratory or laboratory courier.

DOCUMENTATION CONVENTIONS

A label must be affixed to all sample containers. In most cases these labels are generated by our office personnel and are partially preprinted. Labels can also be hand written by our field personnel. The site is identified with the store number and site address, as is the particular groundwater well from which the sample is drawn (e.g. MW-1, MW-2, S-1 etc.). The time and date of sample collection along with the initials of the person who collects the sample are handwritten onto the label.

Chain of Custody records are created using client specific preprinted forms following USEPA specifications.

Bill of Lading records are contemporaneous records created in the field at the site where the non-hazardous purgewater is generated. Field Technicians use preprinted Bill of Lading forms.

DECONTAMINATION

All equipment is brought to the site in clean and serviceable condition and is cleaned after use in each well and before subsequent use in any other well. Equipment is decontaminated before leaving the site.

The primary decontamination device is a commercial steam cleaner. The steam cleaner is de-tuned to function as a hot pressure washer that is then operated with high quality deionized water that is produced at our facility and stored onboard our sampling vehicle. Cleaning is facilitated by the use of proprietary fixtures and devices included in the patented workstation (U.S. Patent 5,535,775) that is incorporated in each sampling vehicle. The steam cleaner is used to decon reels, pumps and bailers.

Any sensitive equipment or parts (i.e. Dissolved Oxygen sensor membrane, water level indicator, etc.) that cannot be washed using the high pressure water, will be sprayed with a non-phosphate soap and deionized water solution and rinsed with deionized water.

DISSOLVED OXYGEN READINGS

Dissolved Oxygen readings are taken pre- and/or post-purge using YSI meters (e.g. YSI Model 550) or HACH field test kits.

The YSI meters are able to collect accurate in-situ readings. The probe allows downhole measurements to be taken from wells with diameters as small as two inches. The probe and reel is decontaminated between wells as described above. The meter is calibrated between wells as per the instructions in the operating manual. The probe is lowered into the water column and the reading is allowed to stabilize prior to collection.

OXYIDATON REDUCTION POTENTIAL READINGS

All readings are obtained with either Corning or Myron-L meters (e.g. Corning ORP-65 or a Myron-L Ultrameter GP). The meter is cleaned between wells as described above. The meter is calibrated at the start of each day according to the instruction manual.

FERROUS IRON MEASUREMENTS

All field measurements are collected at time of sampling with a HACH test kit.

WELL GAUGING DATA

Project # 100517-FSI Date 5-17-10 Client CHEVRON

Site 3125 GIBBONS DR. ALAMEDA, CA

Well ID	Time	Well Size (in.)	Sheen / Odor	Depth to Immiscible Liquid (ft.)	Thickness of Immiscible Liquid (ft.)	Volume of Immiscibles Removed (ml)	Depth to water (ft.)	Depth to well bottom (ft.)	Survey Point: TOB or TOC	Notes
C-1	910	23	Sheen odor	2.62	0.25	350.1	2.87	—	TOC	
C-3	900	23					3.07	18.50	↓	
MW-4	815	2				2.05	12.91			
MW-5	825	2				1.57	12.78			
MW-6	830	2				3.30	13.34			
MW-7	830	2				3.71	5.91			
MW-8	840	2				3.30	9.11			
MW-9	855	2				3.44	8.51			
MW-10	850	2				3.53	8.83			

WELLHEAD INSPECTION CHECKLIST

Client CHURCH Date 5-17-10

Site Address 3135 GIBBONS DR. ALAMODA, CA

Job Number 100517-FS1 Technician FJ

Well ID	Well Inspected - No Corrective Action Required	WELL IS SECURABLE BY DESIGN (12" or less)	WELL IS CLEARLY MARKED WITH THE WORDS "MONITORING WELL" (12" or less)	Water Bailed From Wellbox	Wellbox Components Cleaned	Cap Replaced	Lock Replaced	Other Action Taken (explain below)	Well Not Inspected (explain below)	Repair Order Submitted
C-1	✓	N/A								
C-3	✓	.								
MW-4		✓	✓	✓						
MW-5		✓	✓	✓						
MW-6	✓	✓								
MW-7	✓	✓		✓						
MW-8		✓	✓							
MW-9		✓	✓							
MW-10				✓						

NOTES: C-3, C-1 CHRISTY MW-4 & MW-5 2/2 TABS
 BROKEN 2/2 BOLTS MISSING, MW-8 1/3 BOLTS MISSING
 MW-9 3/3 BOLTS MISSING, C-3 CHRISTY