



**RECEIVED**

9:35 am, Apr 30, 2010

Alameda County  
Environmental Health

**Aaron Costa**  
Project Manager  
Marketing Business Unit

**Chevron Environmental  
Management Company**  
6111 Bollinger Canyon Road  
San Ramon, CA 94583  
Tel (925) 543-2961  
Fax (925) 543-2324  
acosta@chevron.com

Alameda County Health Care Services  
1131 Harbor Bay Parkway, Suite 250  
Alameda, CA 94502-6577

Re: Chevron Service Station No. 9-1153  
3135 Gibbons Drive (3126 Fernside Blvd)  
Alameda, CA

I have reviewed the attached report dated April 30, 2010.

The information in this report is accurate to the best of my knowledge and all local Agency/Regional Board guidelines have been followed. This report was prepared by Conestoga-Rovers & Associates, upon whose assistance and advice I have relied.

This letter is submitted pursuant to the requirements of California Water Code Section 13267(b)(1) and the regulating implementation entitled Appendix A pertaining thereto.

I declare under penalty of perjury that the foregoing is true and correct to the best of my knowledge.

Sincerely,

A handwritten signature in black ink that reads "Aaron Costa".

Aaron Costa  
Project Manager

Attachment: Report



**CONESTOGA-ROVERS  
& ASSOCIATES**

5900 Hollis Street, Suite A  
Emeryville, California 94608  
Telephone: (510) 420-0700 Fax: (510) 420-9170  
<http://www.craworld.com>

April 30, 2010

Reference No. 311642

Mr. Mark Detterman  
Alameda County Environmental Health Services  
1131 Harbor Bay Parkway, Suite 250  
Alameda, California 94502-6577

Re: Fourth Quarter 2009 Groundwater Monitoring and Sampling Report  
Former Chevron Service Station 9-1153  
3135 Gibbons Drive (3126 Fernside Blvd.)  
Alameda, California  
Fuel Leak Case No. RO0000341

Dear Mr. Detterman:

Conestoga-Rovers & Associates is submitting this *Fourth Quarter 2009 Groundwater Monitoring and Sampling Report* for the site referenced above (Figure 1) on behalf of Chevron Environmental Management Company (Chevron).

On November 17, 2009, groundwater monitoring and sampling was performed by Blaine Tech Services (Blaine Tech) of San Jose, California. Groundwater potentiometric and concentration data for this event are presented on Figure 2. Cumulative groundwater monitoring and sampling data are presented in Tables 1 through 3. Blaine Tech's November 18, 2009 *Fourth Quarter Monitoring* report is presented as Attachment A. Well C-1 contained light non-aqueous phase liquid and no other monitoring wells were scheduled for sampling during this event.

---

Equal  
Employment Opportunity  
Employer

---



**CONESTOGA-ROVERS  
& ASSOCIATES**

April 30, 2010

Reference No. 311642

- 2 -

Please contact Brandon Wilken at (510) 420-3355 if you have any questions or require additional information.

Sincerely,

CONESTOGA-ROVERS & ASSOCIATES

Ian Hull

Brandon S. Wilken P.G. #7564



IH/doh/6

Encl.

- |              |   |
|--------------|---|
| Figure 1     | Vicinity Map  |
| Figure 2     | Groundwater Elevation and Hydrocarbon Concentration Map                           |
| Table 1      | Groundwater Monitoring Data and Analytical Results                                |
| Table 2      | Light Non-Aqueous Phase Liquid Thickness and Removal Data                         |
| Table 3      | Dissolved Oxygen Concentrations   |
| Attachment A | Blaine Tech's November 18, 2009 <i>Groundwater Monitoring and Sampling</i> report |

cc: Mr. Aaron Costa, Chevron  
Mr. Mark Hom, Property Owner

## FIGURES



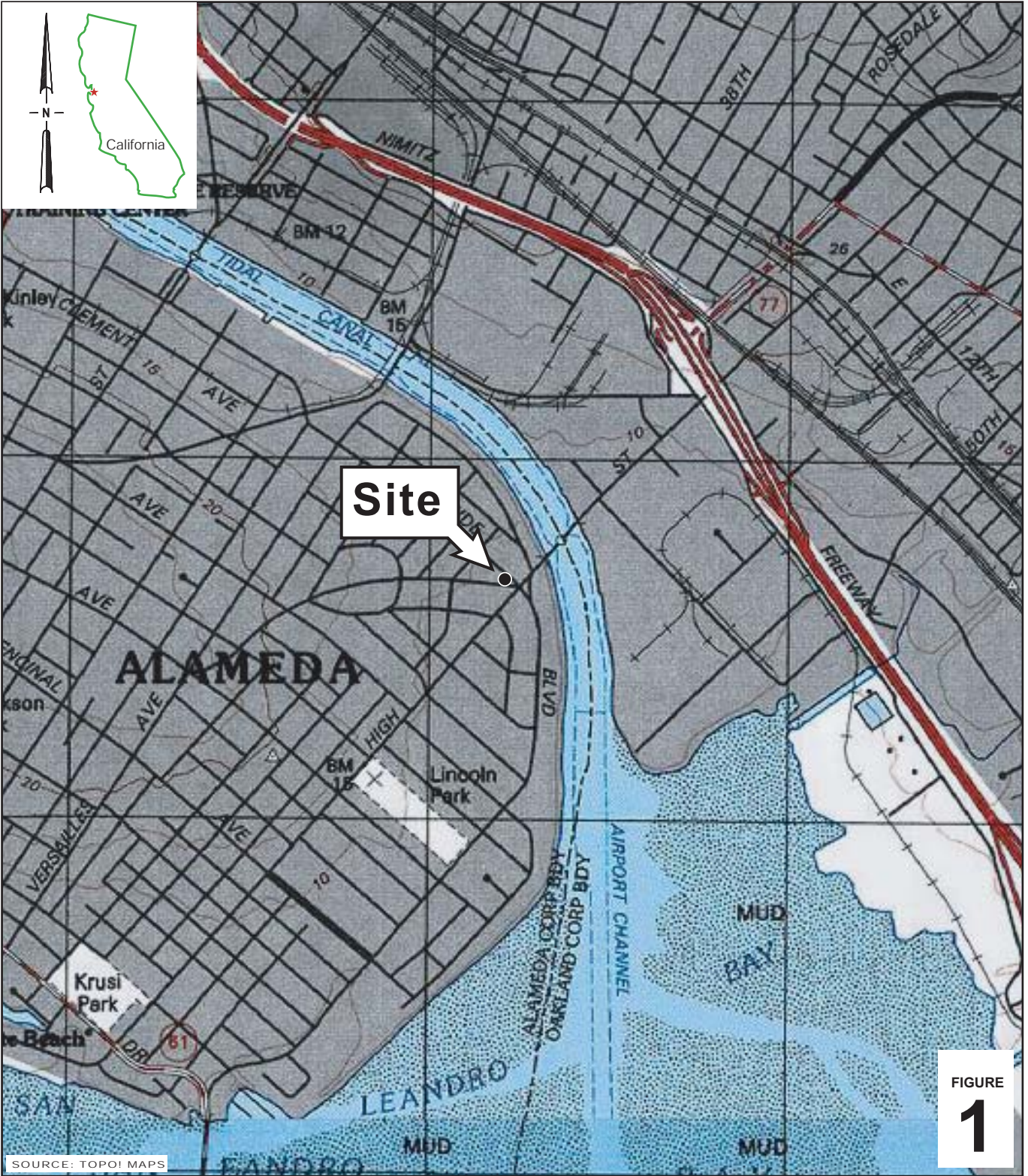

FIGURE  
**1**

L:\CHEV\311642\311642-FIGURES\311642\_EM001\_VICINITY-MAP.A1

SOURCE: TOPOI MAPS

0 1/8 1/4 1/2 1  
SCALE : 1" = 1/4 MILE

**Former Chevron Station 9-1153**  
3135 Gibbons Drive (3126 Fernside Blvd)  
Alameda, California



**CONESTOGA-ROVERS  
& ASSOCIATES**

**Vicinity Map**

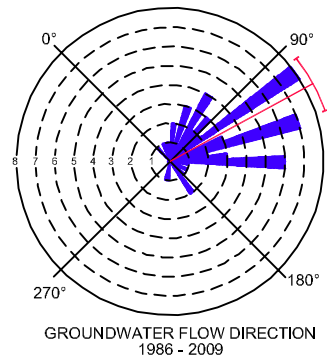
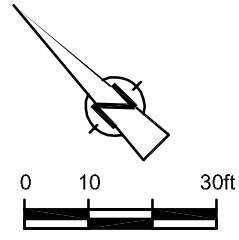

- LEGEND**
- MW-1 ● MONITORING WELL LOCATION
  - RW-1 ⊕ EXTRACTION WELL LOCATION
  - C-2 ■ DESTROYED WELL LOCATION
  - (3.02) GROUNDWATER ELEVATION (ft-MSL)
  - (MA) MONITORED ANNUALLY
  - (SA) SAMPLED ANNUALLY
  - (SSA) SAMPLED SEMI-ANNUALLY
  - (LNAPL) LIGHT NON-AQUEOUS PHASE LIQUIDS - NOT SAMPLED
  - 3.10— GROUNDWATER ELEVATION CONTOUR  
DASHED WHERE INFERRERD

4Q09 GROUNDWATER FLOW  
DIRECTION AT A GRADIENT OF 0.002

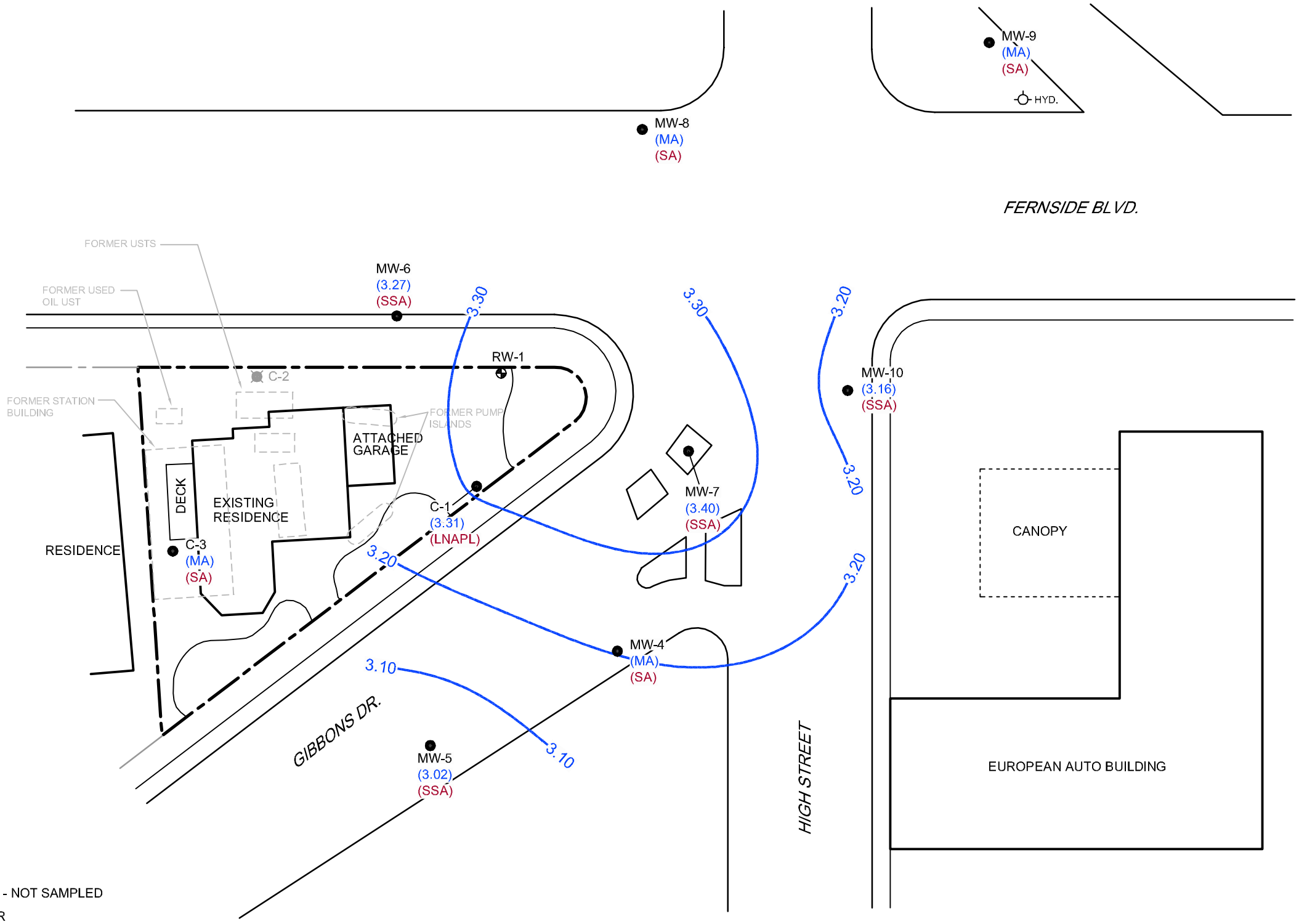

Figure 2  
 GROUNDWATER ELEVATION AND HYDROCARBON CONCENTRATION MAP - NOVEMBER 17, 2009  
 FORMER CHEVRON SERVICE STATION 9-1153  
 3135 GIBBONS DRIVE (3126 FERNSIDE BLVD)  
 Alameda, California

## TABLES

**GROUNDWATER MONITORING DATA AND ANALYTICAL RESULTS  
FORMER CHEVRON SERVICE STATION 9-1153  
3135 GIBBONS DRIVE (3126 FERNSIDE BOULEVARD), ALAMEDA, CALIFORNIA**

WELL ID/ DATE	TOC* (ft-msl)	DTW (ft.)	GWE (ft-msl)	LNAPLT (ft.)	TPHg (µg/L)	B (µg/L)	T (µg/L)	E (µg/L)	X (µg/L)	MTBE (µg/L)
<b>C-1</b>										
08/18/86	--	4.10	--	--	--	--	--	--	--	--
09/04/86	--	--	--	--	15,000	760	820	1,500	--	--
07/22/87	--	--	--	--	1,100	250	7.0	40	--	--
05/03/89	--	4.46	--	--	6,900	3,800	190	229	--	--
12/04/89	--	4.16	--	--	17,000	8,000	490	470	--	--
02/14/90	--	3.64	--	--	19,000	12,000	990	1,050	--	--
03/07/90	--	3.36	--	--	--	4,260	261	430	--	--
09/06/91	--	4.43	--	--	21,000	10,000	100	240	560	--
12/15/91	--	4.78	--	--	20,000	4,900	43	110	330	--
03/03/92	--	2.39	--	--	13,000	5,800	730	340	1,200	--
06/04/92	4.08	4.08	0.00	--	34,000	9,400	350	290	1,200	--
10/13/92	4.08	4.75	-0.67	--	24,000	11,000	98	280	530	--
01/11/93	4.08	2.26	1.82	Sheen	7,100	1,500	130	150	700	--
04/14/93	4.08	2.90	1.18	Sheen	29,000	7,300	4,000	640	2,300	--
07/13/93	4.08	3.97	0.11	Sheen	650,000	27,000	18,000	6,300	29,000	--
10/19/93	4.08	4.50	-0.42	--	40,000	12,000	730	1,100	3,600	--
11/30/93	7.50	4.27	3.23	--	--	--	--	--	--	--
01/27/94	7.50	3.35	4.15	--	36,000	8,600	220	670	1,900	--
04/07/94	7.50	3.42	4.08	--	53,000	12,000	3,500	480	3,300	--
07/01/94	7.50	3.96	3.54	--	65,000	19,000	5,900	1,000	9,000	--
10/05/94	7.50	4.39	3.11	--	160,000	23,000	12,000	2,200	11,000	--
01/12/95	7.50	1.52	6.38	0.50	--	--	--	--	--	--
04/26/95	7.50	4.40	4.86	2.20	--	--	--	--	--	--
07/12/95	7.50	4.85	4.10	1.81	--	--	--	--	--	--
10/30/95	7.50	5.67	3.13	1.63	--	--	--	--	--	--
01/04/96	7.50	3.92	3.68	0.12	--	--	--	--	--	--
01/10/96	7.50	3.48	4.12	0.13	--	--	--	--	--	--
01/17/96	7.50	3.40	4.12	0.02	--	--	--	--	--	--
01/22/96	7.50	2.90	4.60	0.00	82,000	18,000	4,400	1,400	5,200	<1,000
02/23/96	7.50	4.10	4.89	1.86	--	--	--	--	--	--
02/28/96	7.50	--	--	>0.83	--	--	--	--	--	--
03/08/96	7.50	2.86	6.10	1.83	--	--	--	--	--	--
03/08/96	7.50	2.30	5.49	0.36	--	--	--	--	--	--
03/08/96	7.50	2.33	5.46	0.36	--	--	--	--	--	--
03/08/96	7.50	2.28	5.40	0.22	--	--	--	--	--	--
03/26/96	7.50	3.96	4.56	1.28	--	--	--	--	--	--



**GROUNDWATER MONITORING DATA AND ANALYTICAL RESULTS  
FORMER CHEVRON SERVICE STATION 9-1153  
3135 GIBBONS DRIVE (3126 FERNSIDE BOULEVARD), ALAMEDA, CALIFORNIA**

<b>WELL ID/ DATE</b>	<b>TOC* (ft-msl)</b>	<b>DTW (ft.)</b>	<b>GWE (ft-msl)</b>	<b>LNAPLT (ft.)</b>	<b>TPHg (µg/L)</b>	<b>B (µg/L)</b>	<b>T (µg/L)</b>	<b>E (µg/L)</b>	<b>X (µg/L)</b>	<b>MTBE (µg/L)</b>
<b>C-1 (cont)</b>										
04/11/96	7.50	5.61	3.29	1.75	--	--	--	--	--	--
04/19/96	7.50	3.09	4.44	0.04	--	--	--	--	--	--
04/24/96	7.50	3.04	4.48	0.03	--	--	--	--	--	--
05/03/96	7.50	4.02	3.85	0.46	--	--	--	--	--	--
05/03/96	7.50	3.89	3.99	0.47	--	--	--	--	--	--
05/08/96	7.50	4.25	3.53	0.35	--	--	--	--	--	--
05/17/96	7.50	3.24	4.29	0.04	--	--	--	--	--	--
05/17/96	7.50	3.35	4.16	0.01	--	--	--	--	--	--
05/17/96	7.50	3.43	4.08	0.01	--	--	--	--	--	--
05/17/96	7.50	3.65	3.86	0.01	--	--	--	--	--	--
05/22/96	7.50	3.10	4.46	0.07	--	--	--	--	--	--
06/18/96	7.50	4.68	3.20	0.48	--	--	--	--	--	--
07/03/96	7.50	5.03	2.57	0.13	--	--	--	--	--	--
07/09/96	7.50	4.63	3.05	0.23	--	--	--	--	--	--
07/17/96	7.50	4.73	2.89	0.15	--	--	--	--	--	--
07/29/96	7.50	5.10	2.47	0.09	--	--	--	--	--	--
08/02/96	7.50	5.68	1.84	0.03	--	--	--	--	--	--
08/07/96	7.50	5.16	2.35	0.01	--	--	--	--	--	--
08/23/96	7.50	5.75	1.77	0.03	--	--	--	--	--	--
08/28/96	7.50	5.53	1.99	0.03	--	--	--	--	--	--
09/06/96	7.50	5.38	2.12	--	--	--	--	--	--	--
09/12/96	7.50	5.48	2.04	0.03	--	--	--	--	--	--
09/19/96	7.50	6.32	1.20	0.03	--	--	--	--	--	--
10/10/96	7.50	4.58	3.00	0.10	--	--	--	--	--	--
10/17/96	7.50	5.61	1.90	0.01	--	--	--	--	--	--
10/29/96	7.50	6.01	1.49	--	--	--	--	--	--	--
11/07/96	7.50	5.56	1.94	0.04	--	--	--	--	--	--
11/11/96	7.50	5.32	2.18	0.04	--	--	--	--	--	--
12/20/96	7.50	3.33	4.17	0.03	--	--	--	--	--	--
12/17/96	7.50	3.73	3.77	0.01	--	--	--	--	--	--
01/15/97	7.50	2.74	4.76	--	47,000	16,000	2,800	1,300	4,900	<1,000
01/22/97	7.50	1.37	6.13	0.19	--	--	--	--	--	--
02/04/97	7.50	2.98	4.52	0.51	--	--	--	--	--	--
02/20/97	7.50	4.09	3.41	0.13	--	--	--	--	--	--
03/06/97	7.50	3.75	3.75	0.56	--	--	--	--	--	--
03/14/97	7.50	3.82	3.68	0.03	--	--	--	--	--	--

**GROUNDWATER MONITORING DATA AND ANALYTICAL RESULTS  
FORMER CHEVRON SERVICE STATION 9-1153  
3135 GIBBONS DRIVE (3126 FERNSIDE BOULEVARD), ALAMEDA, CALIFORNIA**

WELL ID/ DATE	TOC* (ft-msl)	DTW (ft.)	GWE (ft-msl)	LNAPLT (ft.)	TPHg (µg/L)	B (µg/L)	T (µg/L)	E (µg/L)	X (µg/L)	MTBE (µg/L)
<b>C-1 (cont)</b>										
03/20/97	7.50	3.73	3.77	0.03	--	--	--	--	--	--
03/25/97	7.50	4.32	3.18	0.01	--	--	--	--	--	--
03/31/97	7.50	3.71	3.79	0.03	--	--	--	--	--	--
04/03/97	7.50	4.60	2.92	0.03	--	--	--	--	--	--
04/09/97	7.50	4.25	3.27	0.02	--	--	--	--	--	--
04/24/97	7.50	4.65	2.87	0.02	--	--	--	--	--	--
04/30/97	7.50	3.50	4.02	0.02	--	--	--	--	--	--
05/22/97	7.50	4.97	2.53	--	--	--	--	--	--	--
06/03/97	7.50	3.62	3.93	0.06	--	--	--	--	--	--
07/09/97	7.50	4.30	3.25	0.06	--	--	--	--	--	--
08/12/97	7.50	5.18	2.32	0.00	--	--	--	--	--	--
09/30/97	7.50	5.25	2.65	0.50	--	--	--	--	--	--
10/29/97	7.50	5.33	2.19	0.03	--	--	--	--	--	--
11/13/97	7.50	4.86	2.66	0.02	--	--	--	--	--	--
12/18/97	7.50	2.34	5.16	--	--	--	--	--	--	--
01/14/98	7.50	0.25	7.27	0.02	--	--	--	--	--	--
02/02/98	7.50	2.35	5.19	0.05	--	--	--	--	--	--
03/16/98	7.50	2.50	5.40	0.50	--	--	--	--	--	--
04/17/98	7.50	2.65	5.17	0.40	--	--	--	--	--	--
05/01/98	7.50	2.39	5.14	0.04	--	--	--	--	--	--
06/17/98	7.50	3.26	4.30	0.08	--	--	--	--	--	--
07/15/98	7.50	3.55	3.95	--	110,000	22,000	22,000	1,000	10,000	<250
09/01/98	7.50	4.00	3.50	--	--	--	--	--	--	--
10/27/98	7.50	4.48	3.02	--	45,000	12,000	5,400	590	4,300	<500
11/19/98	7.50	3.89	3.61	--	--	--	--	--	--	--
12/19/98	7.50	2.13	5.39	0.02	--	--	--	--	--	--
01/20/99	7.50	3.98	3.52	--	50,300	7,050	5,030	244	6,090	<40
02/24/99	7.50	2.55	4.95	--	--	--	--	--	--	--
03/26/99	7.50	2.14	5.97	0.76	--	--	--	--	--	--
04/19/99	7.50	1.04	6.46	--	150,000	21,000	20,000	3,000	18,000	<2.5/49 <sup>2</sup>
07/29/99	7.50	3.76	3.76	0.02	--	--	--	--	--	--
08/30/99	7.50	4.30	3.20	--	--	--	--	--	--	--
09/23/99	7.50	3.84	3.68	0.02	--	--	--	--	--	--
10/13/99	7.50	1.27	6.23	--	136,000	23,900	30,000	2,390	17,300	<500
11/17/99	7.50	3.59	3.91	--	--	--	--	--	--	--
12/08/99	7.50	3.79	3.71	--	--	--	--	--	--	--

**GROUNDWATER MONITORING DATA AND ANALYTICAL RESULTS  
FORMER CHEVRON SERVICE STATION 9-1153  
3135 GIBBONS DRIVE (3126 FERNSIDE BOULEVARD), ALAMEDA, CALIFORNIA**

WELL ID/ DATE	TOC* (ft-msl)	DTW (ft.)	GWE (ft-msl)	LNAPLT (ft.)	TPHg (µg/L)	B (µg/L)	T (µg/L)	E (µg/L)	X (µg/L)	MTBE (µg/L)
<b>C-1 (cont)</b>										
01/25/00	7.50	1.99	5.54	0.04	--	--	--	--	--	--
04/03/00	7.50	2.20	5.38**	0.10	--	--	--	--	--	--
05/26/00	7.50	2.52	5.16**	0.23	--	--	--	--	--	--
06/19/00	7.50	2.89	4.76**	0.19	--	--	--	--	--	--
07/03/00	7.50	3.45	4.25**	0.25	--	--	--	--	--	--
08/01/00	7.50	3.78	3.85**	0.16	--	--	--	--	--	--
09/30/00	7.50	4.03	3.50**	0.04	--	--	--	--	--	--
10/23/00	7.50	4.15	3.37**	0.03	--	--	--	--	--	--
11/21/00	7.50	3.42	4.08	0.00	--	--	--	--	--	--
12/22/00	7.50	2.96	4.54	0.00	--	--	--	--	--	--
01/08/01	7.50	2.94	4.56	0.00	--	--	--	--	--	--
02/17/01	7.50	2.09	5.88**	0.59	--	--	--	--	--	--
03/13/01	7.50	2.20	5.91**	0.76	--	--	--	--	--	--
04/09/01	7.50	2.45	5.26**	0.26	NOT SAMPLED DUE TO THE PRESENCE OF LNAPL				--	--
05/18/01	7.50	2.70	5.27**	0.59	--	--	--	--	--	--
06/12/01	7.50	3.50	4.78**	0.97	--	--	--	--	--	--
07/19/01	7.50	4.25	4.01**	0.95	--	--	--	--	--	--
08/23/01	7.50	4.34	3.22**	0.07	NOT SAMPLED DUE TO THE PRESENCE OF LNAPL				--	--
09/17/01	7.50	4.39	3.17**	0.08	--	--	--	--	--	--
10/08/01	7.50	4.45	3.08**	0.04	--	--	--	--	--	--
11/27/01	7.50	3.89	3.61	0.00	330,000	9,800	5,300	3,800	22,000	<50
12/17/01	7.50	1.81	5.69	0.00	--	--	--	--	--	--
01/07/02	7.50	2.27	5.64**	0.51	--	--	--	--	--	--
02/26/02	7.50	2.70	5.22**	0.52	NOT SAMPLED DUE TO THE PRESENCE OF LNAPL				--	--
03/27/02	7.50	2.87	5.47**	1.05	--	--	--	--	--	--
04/08/02	7.50	2.45	6.03**	1.23	--	--	--	--	--	--
05/23/02	7.50	3.57	4.35**	0.52	NOT SAMPLED DUE TO THE PRESENCE OF LNAPL				--	--
06/17/02	7.50	3.90	3.88**	0.35	--	--	--	--	--	--
07/31/02	7.50	4.12	3.54**	0.20	--	--	--	--	--	--
08/09/02	7.50	4.15	3.48**	0.16	NOT SAMPLED DUE TO THE PRESENCE OF LNAPL				--	--
09/17/02	7.50	4.33	3.27**	0.12	--	--	--	--	--	--
10/15/02	7.50	4.51	3.11**	0.15	--	--	--	--	--	--
11/08/02	7.50	4.11	3.39	0.00	51,000	7,000	510	820	5,800	<3.0
12/19/02	7.50	1.14	6.36	0.00	--	--	--	--	--	--
01/14/03	7.50	1.80	5.70	0.00	--	--	--	--	--	--
02/07/03	7.50	2.95	4.79**	0.30	NOT SAMPLED DUE TO THE PRESENCE OF LNAPL				--	--

**GROUNDWATER MONITORING DATA AND ANALYTICAL RESULTS  
FORMER CHEVRON SERVICE STATION 9-1153  
3135 GIBBONS DRIVE (3126 FERNSIDE BOULEVARD), ALAMEDA, CALIFORNIA**

WELL ID/ DATE	TOC* (ft-msl)	DTW (ft.)	GWE (ft-msl)	LNAPLT (ft.)	TPHg (µg/L)	B (µg/L)	T (µg/L)	E (µg/L)	X (µg/L)	MTBE (µg/L)	
<b>C-1 (cont)</b>											
03/20/03	7.50	2.86	4.97**	0.41	--	--	--	--	--	--	
04/15/03	7.50	2.12	5.46**	0.10	--	--	--	--	--	--	
05/09/03	7.50	2.95	5.11**	0.70	NOT SAMPLED DUE TO THE PRESENCE OF LNAPL					--	--
06/27/03	7.50	3.97	3.93**	0.50	--	--	--	--	--	--	
07/16/03	7.50	3.68	4.04**	0.28	--	--	--	--	--	--	
08/15/03	7.50	4.29	3.39**	0.22	NOT SAMPLED DUE TO THE PRESENCE OF LNAPL					--	--
09/26/03	7.50	4.60	3.05**	0.19	--	--	--	--	--	--	
10/18/03	7.50	4.72	2.90**	0.15	--	--	--	--	--	--	
11/14/03	7.50	4.31	3.35**	0.20	NOT SAMPLED DUE TO THE PRESENCE OF LNAPL					--	--
12/23/03	7.50	1.81	5.69	0.00	--	--	--	--	--	--	
01/22/04	7.50	4.19	3.32**	0.01	--	--	--	--	--	--	
02/13/04	7.50	3.04	4.49**	0.04	NOT SAMPLED DUE TO THE PRESENCE OF LNAPL					--	--
03/11/04	7.50	1.85	5.97**	0.40	--	--	--	--	--	--	
04/22/04	7.50	3.08	4.60**	0.22	--	--	--	--	--	--	
05/14/04	7.50	3.49	4.03**	0.03	NOT SAMPLED DUE TO THE PRESENCE OF LNAPL					--	--
06/18/04	7.50	3.41	4.19**	0.13	--	--	--	--	--	--	
07/23/04	7.50	3.28	4.31**	0.11	--	--	--	--	--	--	
08/13/04	7.50	3.14	4.40**	0.05	NOT SAMPLED DUE TO THE PRESENCE OF LNAPL					--	--
09/13/04	7.50	4.53	3.04**	0.09	--	--	--	--	--	--	
10/22/04	7.50	3.19	4.33**	0.03	--	--	--	--	--	--	
11/12/04	7.50	3.22	4.30**	0.03	NOT SAMPLED DUE TO THE PRESENCE OF LNAPL					--	--
12/02/04	7.50	3.28	4.24**	0.02	--	--	--	--	--	--	
01/28/05	7.50	3.19	4.32**	0.01	--	--	--	--	--	--	
02/11/05	7.50	2.75	4.78**	0.04	NOT SAMPLED DUE TO THE PRESENCE OF LNAPL					--	--
03/11/05	7.50	2.94	4.58**	0.03	--	--	--	--	--	--	
04/26/05	7.50	3.03	4.49**	0.02	--	--	--	--	--	--	
05/13/05	7.50	3.18	4.34**	0.02	NOT SAMPLED DUE TO THE PRESENCE OF LNAPL					--	--
06/01/05	7.50	3.22	4.30**	0.02	--	--	--	--	--	--	
07/15/05	7.50	3.09	4.43**	0.02	--	--	--	--	--	--	
08/19/05	7.50	2.88	4.64**	0.03	NOT SAMPLED DUE TO THE PRESENCE OF LNAPL					--	--
09/23/05	7.50	2.95	4.57**	0.02	--	--	--	--	--	--	
10/14/05	7.50	3.01	4.50**	0.01	--	--	--	--	--	--	
11/18/05	7.50	3.21	4.31**	0.02	NOT SAMPLED DUE TO THE PRESENCE OF LNAPL					--	--
12/09/05	7.50	3.61	3.90**	0.01	--	--	--	--	--	--	
01/12/06	7.50	2.98	4.53**	0.01	--	--	--	--	--	--	
02/10/06 <sup>15</sup>	7.50	2.69	4.82**	0.01	100,000	11,000	2,500	2,900	15,000	<10	

**GROUNDWATER MONITORING DATA AND ANALYTICAL RESULTS  
FORMER CHEVRON SERVICE STATION 9-1153  
3135 GIBBONS DRIVE (3126 FERNSIDE BOULEVARD), ALAMEDA, CALIFORNIA**

WELL ID/ DATE	TOC* (ft-msl)	DTW (ft.)	GWE (ft-msl)	LNAPL (ft.)	TPHg (µg/L)	B (µg/L)	T (µg/L)	E (µg/L)	X (µg/L)	MTBE (µg/L)
<b>C-1 (cont)</b>										
03/13/06	7.50	2.81	4.70**	0.01	--	--	--	--	--	--
04/13/06	7.50	2.75	4.76**	0.01	--	--	--	--	--	--
05/12/06	7.50	3.02	4.49**	0.01	NOT SAMPLED DUE TO THE PRESENCE OF LNAPL				--	--
06/12/06	7.50	3.10	4.41**	0.01	--	--	--	--	--	--
07/13/06	7.50	3.14	4.38**	0.02	--	--	--	--	--	--
08/11/06 <sup>15</sup>	7.50	3.70	3.81**	0.01	200,000	8,600	470	1,700	8,800	<10
09/11/06	7.50	3.75	3.77**	0.02	--	--	--	--	--	--
10/17/06	7.50	3.82	3.69**	0.01	--	--	--	--	--	--
11/17/06	7.50	3.11	4.41**	0.03	NOT SAMPLED DUE TO THE PRESENCE OF LNAPL				--	--
12/15/06	7.50	2.95	4.57**	0.02	--	--	--	--	--	--
01/16/07	7.50	2.98	4.54**	0.02	--	--	--	--	--	--
02/16/07 <sup>15</sup>	7.50	2.77	4.73	0.00	25,000	4,300	260	310	3,300	<5
03/16/07	7.50	3.07	4.44**	0.01	--	--	--	--	--	--
04/17/07	7.50	2.98	4.53**	0.01	--	--	--	--	--	--
05/17/07 <sup>15</sup>	7.50	3.05	4.46**	0.01	110,000 <sup>16</sup>	12,000 <sup>16</sup>	1,000 <sup>16</sup>	2,000 <sup>16</sup>	15,000 <sup>16</sup>	<5
06/15/07	7.50	3.08	4.43**	0.01	--	--	--	--	--	--
07/17/07	7.50	3.13	4.38**	0.01	--	--	--	--	--	--
08/09/07	7.50	3.24	4.28**	0.02	NOT SAMPLED DUE TO THE PRESENCE OF LNAPL				--	--
09/14/07	7.50	3.16	4.35**	0.01	--	--	--	--	--	--
10/16/07	7.50	3.04	4.47**	0.01	--	--	--	--	--	--
11/08/07 <sup>15</sup>	7.50	3.11	4.40**	0.01	150,000	13,000	570	1,800	10,000	<13
12/07/07	7.50	2.98	4.54**	0.03	--	--	--	--	--	--
01/16/08	7.50	2.95	4.57**	0.02	--	--	--	--	--	--
02/06/08 <sup>15</sup>	7.50	2.61	4.90**	0.01	110,000	13,000	500	5,300	21,000	<10
03/07/08	7.50	2.87	4.65**	0.02	--	--	--	--	--	--
04/16/08	7.50	3.06	4.46**	0.02	--	--	--	--	--	--
05/07/08	7.50	2.98	4.54**	0.03	NOT SAMPLED DUE TO THE PRESENCE OF LNAPL				--	--
06/06/08	7.50	3.02	4.50**	0.02	--	--	--	--	--	--
07/16/08	7.50	3.12	4.40**	0.02	--	--	--	--	--	--
09/05/08	7.50	3.97	3.75**	0.28	--	--	--	--	--	--
09/11/08	7.50	4.22	3.61**	0.41	NOT SAMPLED DUE TO THE PRESENCE OF LNAPL				--	--
10/17/08	7.50	4.16	3.60**	0.33	--	--	--	--	--	--
11/10/08	7.50	4.05	3.54**	0.11	NOT SAMPLED DUE TO THE PRESENCE OF LNAPL				--	--
12/15/08	7.50	3.85	3.69**	0.05	--	--	--	--	--	--
01/21/09	7.50	3.91	3.62**	0.04	--	--	--	--	--	--
02/09/09 <sup>15</sup>	7.50	3.72	3.79**	0.01	53,000	3,100	66	660	3,700	<1

**GROUNDWATER MONITORING DATA AND ANALYTICAL RESULTS  
FORMER CHEVRON SERVICE STATION 9-1153  
3135 GIBBONS DRIVE (3126 FERNSIDE BOULEVARD), ALAMEDA, CALIFORNIA**

WELL ID/ DATE	TOC* (ft-msl)	DTW (ft.)	GWE (ft-msl)	LNAPLT (ft.)	TPHg (µg/L)	B (µg/L)	T (µg/L)	E (µg/L)	X (µg/L)	MTBE (µg/L)
<b>C-1 (cont)</b>										
03/16/09	7.50	3.81	3.71**	0.03	--	--	--	--	--	--
05/28/09	7.50	3.48	4.04**	0.02	NOT SAMPLED DUE TO THE PRESENCE OF LNAPL					--
08/18/09	7.50	4.40	3.12**	0.02	NOT SAMPLED DUE TO THE PRESENCE OF LNAPL					--
<b>11/17/09</b>	<b>7.50</b>	<b>4.21</b>	<b>3.31**</b>	<b>0.03</b>	<b>NOT SAMPLED DUE TO THE PRESENCE OF LNAPL</b>					<b>--</b>
<b>C-3</b>										
08/18/86	--	4.00	--	--	--	--	--	--	--	--
09/04/86	--	--	--	--	50	3.2	5.4	5.8	--	--
07/22/87	--	--	--	--	<50	<0.5	<1.0	<4.0	--	--
05/03/89	--	4.15	--	--	<50	<0.5	<1.0	<2.0	--	--
12/04/89	--	4.24	--	--	<250	<0.5	<0.5	<0.5	--	--
02/14/90	--	3.57	--	--	<50	<0.5	<0.5	<0.5	--	--
03/07/90	--	3.31	--	--	--	<5.0	<5.0	<5.0	--	--
09/06/91	--	4.59	--	--	<50	<0.5	<0.5	<0.5	<0.5	--
12/15/91	--	4.84	--	--	<50	<0.5	<0.5	<0.5	<0.5	--
03/03/92	--	2.17	--	--	<50	<0.5	<0.5	<0.5	<0.5	--
06/04/92	4.41	4.01	0.40	--	<50	<0.5	<0.5	<0.5	<0.5	--
10/13/92	4.41	4.79	-0.38	--	<50	<0.5	<0.5	<0.5	<0.5	--
01/11/93	4.41	2.01	2.40	--	<50	<0.5	<0.5	<0.5	<0.5	--
04/14/93	4.41	2.76	1.65	--	<50	<0.5	<0.5	<0.5	<0.5	--
07/13/93	4.41	3.96	0.45	--	<50	<0.5	<0.5	<0.5	<1.5	--
10/19/93	4.41	4.53	-0.12	--	66	12	1.4	1.0	8.4	--
11/30/93	7.83	4.04	3.79	--	--	--	--	--	--	--
01/27/94	7.83	3.17	4.66	--	<50	<0.5	<0.5	<0.5	<0.5	--
04/07/94	7.83	3.20	4.63	--	<50	<0.5	<0.5	<0.5	<0.5	--
07/01/94	7.83	3.99	3.84	--	<50	<0.5	<0.5	<0.5	<0.5	--
10/05/94	7.83	4.54	3.29	--	<50	<0.5	<0.5	<0.5	<0.5	--
01/12/95	7.83	0.80	7.03	--	<50	<0.5	<0.5	<0.5	<0.5	--
05/02/95	7.83	2.15	5.68	--	<50	<0.5	<0.5	<0.5	<0.5	--
07/12/95	7.83	3.42	4.41	--	<50	<0.5	<0.5	<0.5	<0.5	--
10/30/95	7.83	4.46	3.37	--	<50	<0.5	<0.5	<0.5	<0.5	<2.5
01/22/96	7.83	1.73	6.10	--	<50	<0.5	<0.5	<0.5	<0.5	<2.5
04/24/96	7.83	2.62	5.21	--	<50	<0.5	<0.5	<0.5	<0.5	<2.5
07/29/96	7.83	3.94	3.89	--	<50	<0.5	<0.5	<0.5	<0.5	<2.5
10/10/96	7.83	4.06	3.77	--	<50	<0.5	<0.5	<0.5	<0.5	<2.5
01/15/97	7.83	1.54	6.29	--	<50	<0.5	<0.5	<0.5	<0.5	<2.5



**GROUNDWATER MONITORING DATA AND ANALYTICAL RESULTS  
FORMER CHEVRON SERVICE STATION 9-1153  
3135 GIBBONS DRIVE (3126 FERNSIDE BOULEVARD), ALAMEDA, CALIFORNIA**

WELL ID/ DATE	TOC* (ft-msl)	DTW (ft.)	GWE (ft-msl)	LNAPLT (ft.)	TPHg (µg/L)	B (µg/L)	T (µg/L)	E (µg/L)	X (µg/L)	MTBE (µg/L)
<b>C-3 (cont)</b>										
04/03/97	7.83	3.23	4.60	--	<50	<0.5	<0.5	<0.5	<0.5	<2.5
07/09/97	7.83	4.36	3.47	--	<50	<0.5	<0.5	<0.5	<0.5	<2.5
10/29/97	7.83	4.65	3.18	--	<50	<0.5	<0.5	<0.5	<0.5	<2.5
01/14/98	7.83	0.77	7.06	--	<50	<0.5	<0.5	<0.5	<0.5	<2.5
07/15/98	7.83	3.72	4.11	--	<50	<0.5	<0.5	<0.5	<0.5	<2.5
01/20/99	7.83	2.65	5.18	--	<50	<0.5	<0.5	<0.5	<0.5	<2.0
04/19/99	7.83	1.78	6.05	--	--	--	--	--	--	--
04/03/00	7.83	MONITORED/SAMPLED ANNUALLY			--	--	--	--	--	--
07/03/00	7.83	--	--	--	--	--	--	--	--	--
10/23/00	7.83	--	--	--	--	--	--	--	--	--
01/08/01 <sup>11</sup>	7.83	3.71	4.12	0.00	<50	<0.50	<0.50	<0.50	<0.50	<2.5
04/09/01	7.83	--	--	--	--	--	--	--	--	--
08/23/01	7.83	MONITORED/SAMPLED ANNUALLY			--	--	--	--	--	--
11/27/01	7.83	MONITORED/SAMPLED ANNUALLY			--	--	--	--	--	--
02/26/02	7.83	2.38	5.45	0.00	<50	<0.50	<0.50	<0.50	<1.5	<2.5
05/23/02	7.83	MONITORED/SAMPLED ANNUALLY			--	--	--	--	--	--
08/09/02	7.83	MONITORED/SAMPLED ANNUALLY			--	--	--	--	--	--
11/08/02	7.83	MONITORED/SAMPLED ANNUALLY			--	--	--	--	--	--
02/07/03	7.83	2.73	5.10	0.00	<50	<0.50	<0.50	<0.50	<1.5	<2.5
05/09/03	7.83	MONITORED/SAMPLED ANNUALLY			--	--	--	--	--	--
08/15/03	7.83	MONITORED/SAMPLED ANNUALLY			--	--	--	--	--	--
11/14/03	7.83	MONITORED/SAMPLED ANNUALLY			--	--	--	--	--	--
02/13/04 <sup>15</sup>	7.83	2.81	5.02	0.00	<50	<0.5	<0.5	<0.5	<0.5	<0.5
05/14/04	7.83	MONITORED/SAMPLED ANNUALLY			--	--	--	--	--	--
11/12/04	7.83	MONITORED/SAMPLED ANNUALLY			--	--	--	--	--	--
02/11/05 <sup>15</sup>	7.83	2.58	5.25	0.00	<50	<0.5	<0.5	<0.5	<0.5	<0.5
05/13/05	7.83	MONITORED/SAMPLED ANNUALLY			--	--	--	--	--	--
08/19/05	7.83	MONITORED/SAMPLED ANNUALLY			--	--	--	--	--	--
11/18/05	7.83	MONITORED/SAMPLED ANNUALLY			--	--	--	--	--	--
02/10/06 <sup>15</sup>	7.83	2.52	5.31	0.00	<50	<0.5	<0.5	<0.5	<0.5	<0.5
05/12/06	7.83	MONITORED/SAMPLED ANNUALLY			--	--	--	--	--	--
08/11/06	7.83	MONITORED/SAMPLED ANNUALLY			--	--	--	--	--	--
11/17/06	7.83	MONITORED/SAMPLED ANNUALLY			--	--	--	--	--	--
02/16/07 <sup>15</sup>	7.83	2.63	5.20	0.00	<50	<0.5	<0.5	<0.5	<0.5	<0.5
05/17/07	7.83	MONITORED/SAMPLED ANNUALLY			--	--	--	--	--	--
08/09/07	7.83	MONITORED/SAMPLED ANNUALLY			--	--	--	--	--	--

**GROUNDWATER MONITORING DATA AND ANALYTICAL RESULTS  
FORMER CHEVRON SERVICE STATION 9-1153  
3135 GIBBONS DRIVE (3126 FERNSIDE BOULEVARD), ALAMEDA, CALIFORNIA**

WELL ID/ DATE	TOC* (ft-msl)	DTW (ft.)	GWE (ft-msl)	LNAPLT (ft.)	TPHg (µg/L)	B (µg/L)	T (µg/L)	E (µg/L)	X (µg/L)	MTBE (µg/L)	
<b>C-3 (cont)</b>											
11/08/07	7.83	MONITORED/SAMPLED ANNUALLY				--	--	--	--	--	--
02/06/08 <sup>15</sup>	7.83	2.91	4.92	0.00	<50	<0.5	<0.5	<0.5	<0.5	<0.5	
05/07/08	7.83	MONITORED/SAMPLED ANNUALLY				--	--	--	--	--	
09/11/08	7.83	MONITORED/SAMPLED ANNUALLY				--	--	--	--	--	
11/10/08	7.83	MONITORED/SAMPLED ANNUALLY				--	--	--	--	--	
02/09/09 <sup>15</sup>	7.83	2.95	4.88	0.00	<50	<0.5	<0.5	<0.5	<0.5	<0.5	
05/28/09	7.83	MONITORED/SAMPLED ANNUALLY				--	--	--	--	--	
08/18/09	7.83	MONITORED/SAMPLED ANNUALLY				--	--	--	--	--	
<b>11/17/09</b>	<b>7.83</b>	<b>MONITORED/SAMPLED ANNUALLY</b>				--	--	--	--	--	
<b>MW-4</b>											
06/04/92	3.58	3.63	-0.05	--	<50	0.8	<0.5	<0.5	<0.5	--	
10/13/92	3.58	--	--	--	--	--	--	--	--	--	
01/11/93	3.58	1.89	1.69	--	<50	<0.5	<0.5	<0.5	<0.5	--	
04/14/93	3.58	2.20	1.38	--	<50	<0.5	<0.5	<0.5	<1.5	--	
07/13/93	3.58	3.51	0.07	--	54	2.6	1.6	<0.5	<1.5	--	
10/19/93	3.58	4.22	-0.64	--	<50	<0.5	<0.5	<0.5	<0.5	--	
11/30/93	7.01	4.01	3.00	--	--	--	--	--	--	--	
01/27/94	7.01	2.89	4.12	--	<50	<0.5	<0.5	<0.5	<0.5	--	
04/07/94	7.01	3.06	3.95	--	<50	<0.5	<0.5	<0.5	<0.5	--	
07/01/94	7.01	3.59	3.42	--	<50	<0.5	<0.5	<0.5	<0.5	--	
10/05/94	7.01	4.33	2.68	--	<50	<0.5	<0.5	<0.5	<0.5	--	
01/12/95	7.01	1.20	5.81	--	<50	<0.5	<0.5	<0.5	<0.5	--	
04/26/95	7.01	1.15	5.86	--	<50	<0.5	<0.5	<0.5	<0.5	--	
07/12/95	7.01	2.72	4.29	--	<50	6.4	<0.5	0.63	0.72	--	
10/30/95	7.01	4.08	2.93	--	<50	<0.5	<0.5	<0.5	<0.5	<2.5	
01/22/96	7.01	1.76	5.25	--	<50	<0.5	<0.5	<0.5	<0.5	<2.5	
04/24/96	7.01	1.95	5.06	--	<50	<0.5	<0.5	<0.5	<0.5	<2.5	
07/29/96	7.01	3.37	3.64	--	<50	<0.5	<0.5	<0.5	<0.5	<2.5	
10/10/96	7.01	3.96	3.05	--	<50	<0.5	<0.5	<0.5	<0.5	<2.5	
01/15/97	7.01	1.27	5.74	--	<50	<0.5	<0.5	<0.5	<0.5	<2.5	
04/03/97	7.01	2.11	4.90	--	<50	<0.5	<0.5	<0.5	<0.5	<2.5	
07/09/97	7.01	4.04	2.97	--	<50	<0.5	<0.5	<0.5	<0.5	<2.5	
10/29/97	7.01	4.56	2.45	--	<50	<0.5	<0.5	<0.5	<0.5	<2.5	
01/14/98	7.01	0.39	6.62	--	<50	<0.5	<0.5	<0.5	<0.5	<2.5	
01/20/99	7.01	2.83	4.18	--	<50	<0.5	<0.5	<0.5	<0.5	<2.0	

**GROUNDWATER MONITORING DATA AND ANALYTICAL RESULTS  
FORMER CHEVRON SERVICE STATION 9-1153  
3135 GIBBONS DRIVE (3126 FERNSIDE BOULEVARD), ALAMEDA, CALIFORNIA**

WELL ID/ DATE	TOC* (ft-msl)	DTW (ft.)	GWE (ft-msl)	LNAPLT (ft.)	TPHg (µg/L)	B (µg/L)	T (µg/L)	E (µg/L)	X (µg/L)	MTBE (µg/L)
<b>MW-4 (cont)</b>										
04/19/99	7.01	2.91	4.10	--	--	--	--	--	--	--
01/25/00	7.01	1.92	5.09	--	<50	<0.5	<0.5	<0.5	<0.5	<2.5
04/03/00	7.01	MONITORED/SAMPLED ANNUALLY			--	--	--	--	--	--
07/03/00	7.01	--	--	--	--	--	--	--	--	--
10/23/00	7.01	--	--	--	--	--	--	--	--	--
01/08/01 <sup>11</sup>	7.01	3.02	3.99	0.00	87 <sup>12</sup>	<0.50	<0.50	0.55	2.9	<2.5
04/09/01	7.01	--	--	--	--	--	--	--	--	--
08/23/01	7.01	MONITORED/SAMPLED ANNUALLY			--	--	--	--	--	--
11/27/01	7.01	MONITORED/SAMPLED ANNUALLY			--	--	--	--	--	--
02/26/02	7.01	1.37	5.64	0.00	<50	<0.50	<0.50	<0.50	<1.5	<2.5
05/23/02	7.01	MONITORED/SAMPLED ANNUALLY			--	--	--	--	--	--
08/09/02	7.01	MONITORED/SAMPLED ANNUALLY			--	--	--	--	--	--
11/08/02	7.01	MONITORED/SAMPLED ANNUALLY			--	--	--	--	--	--
02/07/03	7.01	1.72	5.29	0.00	<50	<0.50	<0.50	<0.50	<1.5	<2.5
05/09/03	7.01	MONITORED/SAMPLED ANNUALLY			--	--	--	--	--	--
08/15/03	7.01	MONITORED/SAMPLED ANNUALLY			--	--	--	--	--	--
11/14/03	7.01	MONITORED/SAMPLED ANNUALLY			--	--	--	--	--	--
02/13/04 <sup>15</sup>	7.01	1.82	5.19	0.00	<50	<0.5	<0.5	<0.5	<0.5	<0.5
05/14/04	7.01	MONITORED/SAMPLED ANNUALLY			--	--	--	--	--	--
11/12/04	7.01	MONITORED/SAMPLED ANNUALLY			--	--	--	--	--	--
02/11/05 <sup>15</sup>	7.01	1.46	5.55	0.00	<50	<0.5	<0.5	<0.5	<0.5	<0.5
05/13/05	7.01	MONITORED/SAMPLED ANNUALLY			--	--	--	--	--	--
08/19/05	7.01	MONITORED/SAMPLED ANNUALLY			--	--	--	--	--	--
11/18/05	7.01	MONITORED/SAMPLED ANNUALLY			--	--	--	--	--	--
02/10/06 <sup>15</sup>	7.01	1.35	5.66	0.00	<50	<0.5	<0.5	<0.5	<0.5	<0.5
05/12/06	7.01	MONITORED/SAMPLED ANNUALLY			--	--	--	--	--	--
08/11/06	7.01	MONITORED/SAMPLED ANNUALLY			--	--	--	--	--	--
11/17/06	7.01	MONITORED/SAMPLED ANNUALLY			--	--	--	--	--	--
02/16/07 <sup>15</sup>	7.01	1.48	5.53	0.00	<50	<0.5	<0.5	<0.5	<0.5	<0.5
05/17/07	7.01	MONITORED/SAMPLED ANNUALLY			--	--	--	--	--	--
08/09/07	7.01	MONITORED/SAMPLED ANNUALLY			--	--	--	--	--	--
11/08/07	7.01	MONITORED/SAMPLED ANNUALLY			--	--	--	--	--	--
02/06/08 <sup>15</sup>	7.01	1.27	5.74	0.00	<50	<0.5	<0.5	<0.5	<0.5	<0.5
05/07/08	7.01	MONITORED/SAMPLED ANNUALLY			--	--	--	--	--	--
09/11/08	7.01	MONITORED/SAMPLED ANNUALLY			--	--	--	--	--	--
11/10/08	7.01	MONITORED/SAMPLED ANNUALLY			--	--	--	--	--	--

**GROUNDWATER MONITORING DATA AND ANALYTICAL RESULTS  
FORMER CHEVRON SERVICE STATION 9-1153  
3135 GIBBONS DRIVE (3126 FERNSIDE BOULEVARD), ALAMEDA, CALIFORNIA**

WELL ID/ DATE	TOC* (ft-msl)	DTW (ft.)	GWE (ft-msl)	LNAPLT (ft.)	TPHg (µg/L)	B (µg/L)	T (µg/L)	E (µg/L)	X (µg/L)	MTBE (µg/L)
<b>MW-4 (cont)</b>										
02/09/09 <sup>15</sup>	7.01	2.33	4.68	0.00	<50	<0.5	<0.5	<0.5	<0.5	<0.5
05/28/09	7.01	MONITORED/SAMPLED ANNUALLY			--	--	--	--	--	--
08/18/09	7.01	MONITORED/SAMPLED ANNUALLY			--	--	--	--	--	--
11/17/09	7.01	MONITORED/SAMPLED ANNUALLY			--	--	--	--	--	--
<b>MW-5</b>										
06/04/92	3.61	3.25	0.36	--	560	110	0.5	37	2.2	--
10/13/92	3.61	4.20	-0.59	--	1,200	150	<2.5	84	8.6	--
01/11/93	3.61	1.30	2.31	--	1,300	48	1.0	83	33	--
04/14/93	3.61	1.20	2.41	--	2,600	240	6.1	250	170	--
07/13/93	3.61	3.15	0.46	--	1,700	260	7.8	160	100	--
10/19/93	3.61	3.82	-0.21	--	1,900	190	3.3	200	93	--
11/30/93	7.04	3.56	3.48	--	--	--	--	--	--	--
01/27/94	7.04	2.42	4.62	--	4,000	100	12	210	110	--
04/07/94	7.04	2.33	4.71	--	2,600	170	10	150	88	--
07/01/94	7.04	3.18	3.86	--	2,300	350	9.1	110	76	--
10/05/94	7.04	3.98	3.06	--	11,000	840	150	130	340	--
01/12/95	7.04	0.40	6.64	--	2,300	82	<2.5	54	20	--
04/26/95	7.04	0.50	6.54	--	1,600	52	<5.0	36	61	--
07/12/95	7.04	2.41	4.63	--	2,800	150	<5.0	34	38	--
10/30/95	7.04	3.78	3.26	--	1,100	81	<5.0	<5.0	<5.0	35
01/22/96	7.04	0.78	6.26	--	880	7.3	<2.0	15	4.8	<10
04/24/96	7.04	1.65	5.39	--	1,600	51	3.8	14	5.6	56
07/29/96	7.04	INACCESSIBLE		--	--	--	--	--	--	--
10/10/96	7.04	3.60	3.44	--	1,000	18	<1.2	1.5	<1.2	<6.2
01/15/97	7.04	0.45	6.59	--	520	0.84	<0.5	3.1	1.2	8.4
04/03/97	7.04	2.11	4.93	--	1,400	13	<2.0	4.3	8.4	32
07/09/97	7.04	3.71	3.33	--	810	3.6	0.97	<0.5	<0.5	9.7
10/29/97	7.04	4.20	2.84	--	<50	<0.5	<0.5	<0.5	<0.5	<2.5
01/14/98	7.04	0.00	7.04	--	430	5.8	2.4	<0.5	1.6	17
04/17/98	7.04	0.71	6.33	--	SAMPLED SEMI-ANNUALLY		--	--	--	--
07/15/98	7.04	0.00	7.04	--	990	11	3.9	0.56	2.2	61
10/27/98	7.04	4.23	2.81	--	--	--	--	--	--	--
01/20/99	7.04	2.58	4.46	--	168	<0.5	<0.5	<0.5	0.692	<2.0
04/19/99	7.04	2.07	4.97	--	--	--	--	--	--	--
07/29/99	7.04	3.43	3.61	--	246	1.54	<0.5	<0.5	<0.5	<5.0/<2.0 <sup>2</sup>

**GROUNDWATER MONITORING DATA AND ANALYTICAL RESULTS  
FORMER CHEVRON SERVICE STATION 9-1153  
3135 GIBBONS DRIVE (3126 FERNSIDE BOULEVARD), ALAMEDA, CALIFORNIA**

WELL ID/ DATE	TOC* (ft-msl)	DTW (ft.)	GWE (ft-msl)	LNAPLT (ft.)	TPHg (µg/L)	B (µg/L)	T (µg/L)	E (µg/L)	X (µg/L)	MTBE (µg/L)	
<b>MW-5 (cont)</b>											
10/13/99	7.04	INACCESSIBLE		--	--	--	--	--	--	--	
01/25/00	7.04	1.51	5.53	--	169	1.94	<0.5	<0.5	<0.5	201	
04/03/00	7.04	1.20	5.84	0.00	--	--	--	--	--	--	
07/03/00	7.04	2.98	4.06	0.00	320 <sup>6,10</sup>	5.3	1.1	<0.50	<0.50	5.0	
10/23/00	7.04	4.18	2.86	0.00	--	--	--	--	--	--	
01/08/01 <sup>11</sup>	7.04	2.92	4.12	0.00	220 <sup>6</sup>	3.9	<0.50	<0.50	<0.50	7.7	
04/09/01	7.04	1.01	6.03	0.00	--	--	--	--	--	--	
08/23/01	7.04	3.48	3.56	0.00	630	40	3.5	<2.5	<2.5	43	
11/27/01	7.04	3.05	3.99	0.00	SAMPLED SEMI-ANNUALLY					--	--
02/26/02	7.04	1.00	6.04	0.00	410	4.3	<0.50	<0.50	<1.5	<2.5	
05/23/02	7.04	2.21	4.83	0.00	SAMPLED SEMI-ANNUALLY					--	--
08/09/02	7.04	3.38	3.66	0.00	240	1.3	<0.50	<0.50	<1.5	<2.5	
11/08/02	7.04	4.56	2.48	0.00	SAMPLED SEMI-ANNUALLY					--	--
02/07/03	7.04	1.42	5.62	0.00	380	3.2	<0.50	0.64	<1.5	<2.5	
05/09/03	7.04	1.25	5.79	0.00	SAMPLED SEMI-ANNUALLY					--	--
08/15/03 <sup>15</sup>	7.04	3.61	3.43	0.00	<50	<0.5	<0.5	<0.5	<0.5	<0.5	
11/14/03	7.04	3.57	3.47	0.00	SAMPLED SEMI-ANNUALLY					--	--
02/13/04 <sup>15</sup>	7.04	1.50	5.54	0.00	<50	<0.5	<0.5	<0.5	<0.5	<0.5	
05/14/04	7.04	2.47	4.57	0.00	SAMPLED SEMI-ANNUALLY					--	--
08/13/04 <sup>15</sup>	7.04	5.46	1.58	0.00	<50	<0.5	<0.5	<0.5	<0.5	<0.5	
11/12/04	7.04	4.65	2.39	0.00	SAMPLED SEMI-ANNUALLY					--	--
02/11/05 <sup>15</sup>	7.04	1.20	5.84	0.00	130	<0.5	<0.5	<0.5	<0.5	<0.5	
05/13/05	7.04	4.36	2.68	0.00	SAMPLED SEMI-ANNUALLY					--	--
08/19/05 <sup>15</sup>	7.04	2.78	4.26	0.00	96	<0.5	<0.5	<0.5	<0.5	<0.5	
11/18/05	7.04	4.51	2.53	0.00	SAMPLED SEMI-ANNUALLY					--	--
02/10/06 <sup>15</sup>	7.04	1.12	5.92	0.00	<50	<0.5	<0.5	<0.5	<0.5	<0.5	
05/12/06	7.04	2.23	4.81	0.00	SAMPLED SEMI-ANNUALLY					--	--
08/11/06 <sup>15</sup>	7.04	3.40	3.64	0.00	<50	<0.5	<0.5	<0.5	<0.5	<0.5	
11/17/06	7.04	4.16	2.88	0.00	SAMPLED SEMI-ANNUALLY					--	--
02/16/07 <sup>15</sup>	7.04	1.22	5.82	0.00	<50	<0.5	<0.7	<0.8	<0.8	<0.5	
05/17/07	7.04	4.06	2.98	0.00	SAMPLED SEMI-ANNUALLY					--	--
08/09/07 <sup>15</sup>	7.04	3.61	3.43	0.00	<50	<0.5	<0.5	<0.5	<0.5	<0.5	
11/08/07	7.04	3.70	3.34	0.00	SAMPLED SEMI-ANNUALLY					--	--
02/06/08 <sup>15</sup>	7.04	1.06	5.98	0.00	<50	<0.5	<0.5	<0.5	<0.5	<0.5	
05/07/08	7.04	3.57	3.47	0.00	SAMPLED SEMI-ANNUALLY					--	--
09/11/08 <sup>15</sup>	7.04	4.58	2.46	0.00	<50	<0.5	<0.5	<0.5	<0.5	<0.5	

**GROUNDWATER MONITORING DATA AND ANALYTICAL RESULTS  
FORMER CHEVRON SERVICE STATION 9-1153  
3135 GIBBONS DRIVE (3126 FERNSIDE BOULEVARD), ALAMEDA, CALIFORNIA**

WELL ID/ DATE	TOC* (ft-msl)	DTW (ft.)	GWE (ft-msl)	LNAPLT (ft.)	TPHg (µg/L)	B (µg/L)	T (µg/L)	E (µg/L)	X (µg/L)	MTBE (µg/L)
<b>MW-5 (cont)</b>										
11/10/08	7.04	4.26	2.78	0.00	SAMPLED SEMI-ANNUALLY		--	--	--	--
02/09/09 <sup>15</sup>	7.04	2.15	4.89	0.00	<50	<0.5	<0.5	<0.5	<0.5	<0.5
05/28/09	7.04	2.76	4.28	0.00	SAMPLED SEMI-ANNUALLY		--	--	--	--
08/18/09 <sup>14</sup>	7.04	3.81	3.23	0.00	<50	<0.5	<0.5	<0.5	<0.5	<0.5
<b>11/17/09</b>	<b>7.04</b>	<b>4.02</b>	<b>3.02</b>	<b>0.00</b>	<b>SAMPLED SEMI-ANNUALLY</b>		<b>--</b>	<b>--</b>	<b>--</b>	<b>--</b>
<b>MW-6</b>										
06/04/92	3.85	3.89	-0.04	--	210	54	<0.5	1.9	2.4	--
10/13/92	3.85	4.56	-0.71	--	10,000	5,300	<10	70	<10	--
01/11/93	3.85	2.36	1.49	--	100	50	<0.5	<0.5	<0.5	--
04/14/93	3.85	3.15	0.70	--	<50	<0.5	<0.5	<0.5	<0.5	--
07/13/93	3.85	3.94	-0.09	--	<50	1.8	<0.5	<0.5	<1.5	--
10/19/93	3.85	4.40	-0.55	--	320	150	<0.5	0.8	<0.5	--
11/30/93	7.27	4.16	3.11	--	--	--	--	--	--	--
01/27/94	7.27	3.33	3.94	--	120	45	<0.5	<0.5	<0.5	--
04/07/94	7.27	3.43	3.84	--	<50	<0.5	<0.5	<0.5	<0.5	--
07/01/94	7.27	3.94	3.33	--	<50	<0.5	<0.5	<0.5	<0.5	--
10/05/94	7.27	4.38	2.89	--	8,300	2,400	160	42	190	--
01/12/95 <sup>1</sup>	7.27	2.43	4.84	--	<50	12	<0.5	<0.5	<0.5	--
04/26/95	7.27	2.06	5.21	--	<50	5.5	0.67	<0.5	1.3	--
07/12/95	7.27	3.53	3.74	--	65	27	<0.5	<0.5	<0.5	--
10/30/95	7.27	4.34	2.93	--	<50	3.9	<0.5	<0.5	<0.5	<2.5
01/22/96	7.27	2.61	4.66	--	<50	0.93	<0.5	<0.5	<0.5	<2.5
04/24/96	7.27	2.50	4.77	--	260	110	<1.2	<1.2	<1.2	<6.2
07/29/96	7.27	3.85	3.42	--	<50	23	<0.5	<0.5	<0.5	<2.5
10/10/96	7.27	4.37	2.90	--	79	31	<0.5	<0.5	<0.5	<2.5
01/15/97	7.27	2.63	4.64	--	<50	<0.5	<0.5	<0.5	<0.5	<2.5
04/03/97	7.27	3.42	3.85	--	670	360	<5.0	<5.0	<5.0	<25
07/09/97	7.27	4.29	2.98	--	330	140	<2.0	<2.0	<2.0	<10
10/29/97	7.27	4.56	2.71	--	400	260	<2.0	<2.0	<2.0	5.8
01/14/98	7.27	1.01	6.26	--	<50	<0.5	<0.5	<0.5	<0.5	<2.5
04/17/98	7.27	2.94	4.33	--	<50	1.7	<0.5	<0.5	<0.5	<2.5
07/15/98	7.27	4.72	2.55	--	<50	<0.5	<0.5	<0.5	<0.5	<2.5
10/27/98	7.27	INACCESSIBLE		--	--	--	--	--	--	--
11/25/98	7.27	4.16	3.11	--	110 <sup>3</sup>	54	<0.5	<0.5	<0.5	<2.5
01/20/99	7.27	3.45	3.82	--	<50	10	<0.5	<0.5	<0.5	<2.0



**GROUNDWATER MONITORING DATA AND ANALYTICAL RESULTS  
FORMER CHEVRON SERVICE STATION 9-1153  
3135 GIBBONS DRIVE (3126 FERNSIDE BOULEVARD), ALAMEDA, CALIFORNIA**

WELL ID/ DATE	TOC* (ft-msl)	DTW (ft.)	GWE (ft-msl)	LNAPLT (ft.)	TPHg (µg/L)	B (µg/L)	T (µg/L)	E (µg/L)	X (µg/L)	MTBE (µg/L)
<b>MW-6 (cont)</b>										
04/19/99	7.27	3.39	3.88	--	<50	2.6	<0.5	<0.5	<0.5	<2.5/<2.0 <sup>2</sup>
07/29/99 <sup>4</sup>	7.27	4.34	2.93	--	<5,000	2,590	<50	<50	<50	<500
10/13/99	7.27	5.89	1.38	--	9,270	4,610	44.2	<25	<25	<125
01/25/00	7.27	4.11	3.16	--	529	289	<0.5	<0.5	<0.5	738
04/03/00 <sup>7,8</sup>	7.27	2.84	4.43	0.00	<50	<0.50	<0.50	<0.50	<0.50	<2.5
07/03/00 <sup>7</sup>	7.27	3.77	3.50	0.00	91 <sup>6</sup>	89	0.77	<0.50	<0.50	<2.5
10/12/00	7.27	6.32	0.95	0.00	<50	8.0	<0.50	<0.50	<0.50	<2.5
01/08/01 <sup>7,11</sup>	7.27	3.74	3.53	0.00	400 <sup>6</sup>	640	8.2	8.0	5.0	10
04/09/01 <sup>7</sup>	7.27	3.03	4.24	0.00	91.3	22.0	3.36	0.751	2.14	<0.500
08/23/01 <sup>7</sup>	7.27	4.70	2.57	0.00	53 <sup>13</sup>	23	0.50	<0.50	1.1	<2.5
11/27/01 <sup>14</sup>	7.27	4.43	2.84	0.00	<50	4.1	<0.50	<0.50	<1.5	<2.5
02/26/02 <sup>14</sup>	7.27	2.50	4.77	0.00	100	53	<0.50	<0.50	<1.5	<2.5
05/23/02	7.27	3.27	4.00	0.00	<b>610</b>	<b>260</b>	<b>4.2</b>	<b>1.7</b>	<b>2.1</b>	<2.5
08/09/02	7.27	4.11	3.16	0.00	<50	<b>1.1</b>	<0.50	<0.50	<1.5	<2.5
11/08/02	7.27	4.12	3.15	0.00	<50	<0.50	<0.50	<0.50	<1.5	<2.5
02/07/03	7.27	2.60	4.67	0.00	<50	0.65	<0.50	<0.50	<1.5	<2.5
05/09/03	7.27	2.57	4.70	0.00	<50	1.9	<0.5	<0.5	<1.5	<2.5
08/15/03 <sup>15</sup>	7.27	4.15	3.12	0.00	<50	<0.5	<0.5	<0.5	<0.5	<0.5
11/14/03 <sup>15</sup>	7.27	4.10	3.17	0.00	<50	<0.5	0.6	<0.5	<0.5	1
02/13/04 <sup>15</sup>	7.27	2.66	4.61	0.00	<50	<0.5	<0.5	<0.5	<0.5	<0.5
05/14/04 <sup>15</sup>	7.27	3.55	3.72	0.00	<50	3	<0.5	<0.5	<0.5	<0.5
08/13/04 <sup>15</sup>	7.27	4.32	2.95	0.00	<50	<0.5	<0.5	<0.5	<0.5	<0.5
11/12/04 <sup>15</sup>	7.27	4.20	3.07	0.00	<50	<0.5	<0.5	<0.5	<0.5	<0.5
02/11/05 <sup>15</sup>	7.27	2.18	5.09	0.00	<50	<0.5	<0.5	<0.5	<0.5	<0.5
05/13/05 <sup>15</sup>	7.27	4.11	3.16	0.00	<50	<0.5	<0.5	<0.5	<0.5	<0.5
08/19/05 <sup>15</sup>	7.27	3.70	3.57	0.00	<50	<0.5	<0.5	<0.5	<0.5	<0.5
11/18/05 <sup>15</sup>	7.27	3.98	3.29	0.00	<50	<0.5	<0.5	<0.5	<0.5	<0.5
02/10/06 <sup>15</sup>	7.27	2.11	5.16	0.00	<50	<0.5	<0.5	<0.5	<0.5	<0.5
05/12/06 <sup>15</sup>	7.27	3.18	4.09	0.00	<50	<0.5	<0.5	<0.5	<0.5	<0.5
08/11/06 <sup>15</sup>	7.27	3.80	3.47	0.00	<50	<0.5	<0.5	<0.5	<0.5	<0.5
11/17/06 <sup>15</sup>	7.27	3.78	3.49	0.00	<50	<0.5	<0.5	<0.5	<0.5	<0.5
02/16/07 <sup>15</sup>	7.27	2.08	5.19	0.00	<50	1	<0.5	<0.5	<0.5	<0.5
05/17/07 <sup>15</sup>	7.27	3.61	3.66	0.00	<50	<0.5	<0.5	<0.5	<0.5	<0.5
08/09/07 <sup>15</sup>	7.27	4.05	3.22	0.00	<50	<0.5	<0.5	<0.5	<0.5	<0.5
11/08/07 <sup>15</sup>	7.27	4.12	3.15	0.00	<50	5	<0.5	<0.5	<0.5	<0.5
02/06/08 <sup>15</sup>	7.27	1.85	5.42	0.00	<50	<0.5	<0.5	<0.5	<0.5	<0.5

**GROUNDWATER MONITORING DATA AND ANALYTICAL RESULTS  
FORMER CHEVRON SERVICE STATION 9-1153  
3135 GIBBONS DRIVE (3126 FERNSIDE BOULEVARD), ALAMEDA, CALIFORNIA**

WELL ID/ DATE	TOC* (ft-msl)	DTW (ft.)	GWE (ft-msl)	LNAPLT (ft.)	TPHg (µg/L)	B (µg/L)	T (µg/L)	E (µg/L)	X (µg/L)	MTBE (µg/L)
<b>MW-6 (cont)</b>										
05/07/08 <sup>15</sup>	7.27	3.91	3.36	0.00	63	18	<0.5	<0.5	<0.5	<0.5
09/11/08 <sup>15</sup>	7.27	4.93	2.34	0.00	<50	<0.5	<0.5	<0.5	<0.5	<0.5
11/10/08 <sup>15</sup>	7.27	4.30	2.97	0.00	<50	<0.5	<0.5	<0.5	<0.5	<0.5
02/09/09 <sup>15</sup>	7.27	2.97	4.30	0.00	<50	2	<0.5	<0.5	<0.5	<0.5
05/28/09 <sup>1b</sup>	7.27	3.53	3.74	0.00	<50	4	<0.5	<0.5	<0.5	<0.5
08/18/09 <sup>1c</sup>	7.27	3.38	3.89	0.00	560	130	3	<0.5	0.7 J	<0.5
<b>11/17/09</b>	<b>7.27</b>	<b>4.00</b>	<b>3.27</b>	<b>0.00</b>	<b>MONITORED/SAMPLED SEMI-ANNUALLY</b>			--	--	--
<b>MW-7</b>										
11/30/93	8.22	5.33	2.89	--	480	110	41	4.4	38	--
01/27/94	8.22	4.50	3.72	--	120	21	1.1	2.2	4.8	--
04/07/94	8.22	4.62	3.60	--	2,600	630	39	56	94	--
07/01/94	8.22	5.13	3.09	--	2,200	770	42	<10	92	--
10/05/94	8.22	5.61	2.61	--	15,000	3,300	90	130	320	--
01/12/95	8.22	2.83	5.39	--	340	57	<1.3	18	6.4	--
04/26/95	8.22	2.35	5.87	--	15,000	3,700	210	520	800	--
07/12/95	8.22	4.66	3.56	--	7,700	1,800	59	130	370	--
10/30/95	8.22	5.48	2.74	--	770	260	<5.0	33	48	25
01/22/96	8.22	3.34	4.88	--	290	63	<1.0	6.4	5.7	<5.0
04/24/96	8.22	4.12	4.10	--	12,000	2,500	510	380	810	<125
07/29/96	8.22	5.03	3.19	--	2,600	650	<25	61	150	<125
10/10/96	8.22	5.52	2.70	--	5,800	1,700	28	170	210	<62
01/15/97	8.22	2.92	5.30	--	1,000	230	<2.5	28	11	63
04/03/97	8.22	4.65	3.57	--	6,000	1,800	100	140	170	<100
07/09/97	8.22	5.39	2.83	--	5,500	2,200	<20	41	30	<100
10/29/97	8.22	5.58	2.64	--	220	40	0.61	3.0	2.4	7.6
01/14/98	8.22	2.80	5.42	--	140	5.1	<0.5	<0.5	1.4	<2.5
04/17/98	8.22	3.00	5.22	--	13,000	4,200	98	250	240	250
07/15/98	8.22	INACCESSIBLE		--	--	--	--	--	--	--
08/17/98 <sup>5</sup>	7.92	5.52	2.40	--	1,600	380	51	68	280	22
10/27/98	7.92	7.51	0.41	--	190	2.3	0.53	<0.5	<0.5	33
01/20/99	7.92	3.45	4.47	--	<50	<0.5	<0.5	<0.5	<0.5	<2.0
04/19/99	7.92	4.61	3.31	--	6,500	3,000	<0.5	110	210	310/150 <sup>2</sup>
07/29/99 <sup>4</sup>	7.92	5.00	2.92	--	8,390	2,100	129	222	729	248
10/13/99	7.92	5.61	2.31	--	14,300	6,600	58.8	117	190	<125
01/25/00	7.92	3.32	4.60	--	1,100	184	<5.0	13.5	33.7	151

**GROUNDWATER MONITORING DATA AND ANALYTICAL RESULTS  
FORMER CHEVRON SERVICE STATION 9-1153  
3135 GIBBONS DRIVE (3126 FERNSIDE BOULEVARD), ALAMEDA, CALIFORNIA**

WELL ID/ DATE	TOC* (ft-msl)	DTW (ft.)	GWE (ft-msl)	LNAPLT (ft.)	TPHg (µg/L)	B (µg/L)	T (µg/L)	E (µg/L)	X (µg/L)	MTBE (µg/L)
<b>MW-7 (cont)</b>										
04/03/00 <sup>7,9</sup>	7.92	3.38	4.54	0.00	2,600 <sup>6</sup>	780	12	<5.0	61	95
07/03/00 <sup>7</sup>	7.92	4.34	3.58	0.00	4,100 <sup>6</sup>	2,600	72	240	690	<50
10/23/00	7.92	6.11	1.81	0.00	12,000 <sup>6</sup>	2,600	<50	150	290	<250
01/08/01 <sup>7,11</sup>	7.92	4.32	3.60	0.00	3,900 <sup>6</sup>	2,200	61	140	350	<25
04/09/01 <sup>7</sup>	7.92	3.63	4.29	0.00	25,100	4,590	1,200	843	1,920	48.1
08/23/01 <sup>7</sup>	7.92	4.83	3.09	0.00	27,000	4,100	970	1,100	3,500	<500
11/27/01	7.92	4.30	3.62	0.00	12,000	1,800	50	450	830	91
02/26/02	7.92	3.00	4.92	0.00	15,000	3,100	260	380	860	<10
05/23/02	7.92	3.69	4.23	0.00	28,000	6,000	120	820	1,900	42
08/09/02	7.92	4.38	3.54	0.00	24,000	3,700	81	710	1,300	56
11/08/02	7.92	4.43	3.49	0.00	18,000	2,300	150	660	1,400	<100
02/07/03	7.92	3.20	4.72	0.00	13,000	2,300	200	310	620	<25
05/09/03	7.92	3.18	4.74	0.00	17,000	4,200	36	350	360	<50
08/15/03 <sup>15</sup>	7.92	4.75	3.17	0.00	29,000	7,300	140	780	1,900	<5
11/14/03 <sup>15</sup>	7.92	4.95	2.97	0.00	7,200	950	3	45	20	7
02/13/04 <sup>15</sup>	7.92	3.29	4.63	0.00	3,300	360	4	82	130	3
05/14/04 <sup>15</sup>	7.92	3.98	3.94	0.00	17,000	3,100	480	510	1,300	3
08/13/04 <sup>15</sup>	7.92	5.94	1.98	0.00	10,000	2,000	4	130	150	4
11/12/04 <sup>15</sup>	7.92	4.50	3.42	0.00	680	4	<0.5	1	0.7	0.8
02/11/05 <sup>15</sup>	7.92	3.07	4.85	0.00	4,600	680	6	80	44	4
05/13/05 <sup>15</sup>	7.92	4.51	3.41	0.00	4,200	380	3	38	13	2
08/19/05 <sup>15</sup>	7.92	4.03	3.89	0.00	7,900	1,300	3	190	310	<1
11/18/05 <sup>15</sup>	7.92	4.62	3.30	0.00	3,900	4	1	16	8	2
02/10/06 <sup>15</sup>	7.92	3.12	4.80	0.00	3,200	320	2	14	8	2
05/12/06 <sup>15</sup>	7.92	4.25	3.67	0.00	3,600	1,000	2	65	27	<1
08/11/06 <sup>15</sup>	7.92	4.45	3.47	0.00	6,700	1,900	6	280	300	<1
11/17/06 <sup>15</sup>	7.92	4.71	3.21	0.00	1,200	0.6	<0.5	1	0.8	<0.5
02/16/07 <sup>15</sup>	7.92	3.26	4.66	0.00	110	<0.5	<0.5	<0.5	<0.5	<0.5
05/17/07 <sup>15</sup>	7.92	4.62	3.30	0.00	6,400	1,400	4	130	26	<1
08/09/07 <sup>15</sup>	7.92	4.61	3.31	0.00	10,000	1,400	4	230	12	<3
11/08/07 <sup>15</sup>	7.92	4.72	3.20	0.00	2,300	4	1	3	7	0.9
02/06/08 <sup>15</sup>	7.92	2.98	4.94	0.00	190	<0.5	<0.5	<0.5	<0.5	<0.5
05/07/08 <sup>15</sup>	7.92	4.48	3.44	0.00	8,000	1,500	15	380	260	<1
09/11/08 <sup>15</sup>	7.92	5.95	1.97	0.00	5,100	530	4	47	12	0.7
11/10/08 <sup>15</sup>	7.92	5.81	2.11	0.00	2,800	13	1	1	7	<0.5
02/09/09 <sup>15</sup>	7.92	4.06	3.86	0.00	3,900	190	2	51	11	0.5

**GROUNDWATER MONITORING DATA AND ANALYTICAL RESULTS  
FORMER CHEVRON SERVICE STATION 9-1153  
3135 GIBBONS DRIVE (3126 FERNSIDE BOULEVARD), ALAMEDA, CALIFORNIA**

WELL ID/ DATE	TOC* (ft-msl)	DTW (ft.)	GWE (ft-msl)	LNAPLT (ft.)	TPHg (µg/L)	B (µg/L)	T (µg/L)	E (µg/L)	X (µg/L)	MTBE (µg/L)
<b>MW-7 (cont)</b>										
05/28/09 <sup>15,17</sup>	7.92	3.84	4.08	0.00	5,800	870 J	8 J	220 J	27 J	<0.5 UJ
08/18/09 <sup>17</sup>	7.92	4.80	3.12	0.00	6,700	660	4	110	13	0.7 J
<b>11/17/09</b>	<b>7.92</b>	<b>4.52</b>	<b>3.40</b>	<b>0.00</b>	<b>MONITORED/SAMPLED SEMI-ANNUALLY</b>			--	--	--
<b>MW-8</b>										
10/17/95	6.96	4.40	2.56	--	--	--	--	--	--	--
10/30/95	6.96	4.44	2.52	--	<50	<0.5	<0.5	<0.5	<0.5	<2.5
01/22/96	6.96	2.24	4.72	--	<50	<0.5	<0.5	<0.5	<0.5	<2.5
04/24/96	6.96	2.97	3.99	--	<50	<0.5	<0.5	<0.5	<0.5	<2.5
07/29/96	6.96	3.37	3.59	--	<50	<0.5	<0.5	<0.5	<0.5	<2.5
10/10/96	6.96	4.12	2.84	--	<50	<0.5	<0.5	<0.5	<0.5	<2.5
01/15/97	6.96	0.94	6.02	--	<50	<0.5	<0.5	<0.5	<0.5	<2.5
04/03/97	6.96	2.20	4.76	--	<50	<0.5	<0.5	<0.5	<0.5	<2.5
07/09/97	6.96	4.30	2.66	--	<50	<0.5	<0.5	<0.5	<0.5	<2.5
10/29/97	6.96	4.57	2.39	--	<50	<0.5	<0.5	<0.5	<0.5	<2.5
01/14/98	6.96	0.83	6.13	--	<50	<0.5	<0.5	<0.5	<0.5	<2.5
01/20/99	6.96	2.69	4.27	--	<50	<0.5	<0.5	<0.5	<0.5	<2.0
04/19/99	6.96	3.76	3.20	--	--	--	--	--	--	--
01/25/00	6.96	1.41	5.55	--	<50	<0.5	<0.5	<0.5	<0.5	<2.5
04/03/00	6.96	MONITORED/SAMPLED ANNUALLY			--	--	--	--	--	--
07/03/00	6.96	--	--	--	--	--	--	--	--	--
10/23/00	6.96	--	--	--	--	--	--	--	--	--
01/08/01 <sup>11</sup>	6.96	3.58	3.38	0.00	<50	<0.50	<0.50	<0.50	<0.50	<2.5
04/09/01	6.96	--	--	--	--	--	--	--	--	--
08/23/01	6.96	MONITORED/SAMPLED ANNUALLY			--	--	--	--	--	--
11/27/01	6.96	MONITORED/SAMPLED ANNUALLY			--	--	--	--	--	--
02/26/02	6.96	2.91	4.05	0.00	<50	<0.50	<0.50	<0.50	<1.5	<2.5
05/23/02	6.96	MONITORED/SAMPLED ANNUALLY			--	--	--	--	--	--
08/09/02	6.96	MONITORED/SAMPLED ANNUALLY			--	--	--	--	--	--
11/08/02	6.96	MONITORED/SAMPLED ANNUALLY			--	--	--	--	--	--
02/07/03	6.96	3.13	3.83	0.00	<50	<0.50	<0.50	<0.50	<1.5	<2.5
05/09/03	6.96	MONITORED/SAMPLED ANNUALLY			--	--	--	--	--	--
08/15/03	6.96	MONITORED/SAMPLED ANNUALLY			--	--	--	--	--	--
11/14/03	6.96	MONITORED/SAMPLED ANNUALLY			--	--	--	--	--	--
02/13/04 <sup>15</sup>	6.96	3.20	3.76	0.00	<50	<0.5	<0.5	<0.5	<0.5	<0.5
05/14/04	6.96	MONITORED/SAMPLED ANNUALLY			--	--	--	--	--	--

**GROUNDWATER MONITORING DATA AND ANALYTICAL RESULTS  
FORMER CHEVRON SERVICE STATION 9-1153  
3135 GIBBONS DRIVE (3126 FERNSIDE BOULEVARD), ALAMEDA, CALIFORNIA**

WELL ID/ DATE	TOC* (ft-msl)	DTW (ft.)	GWE (ft-msl)	LNAPLT (ft.)	TPHg (µg/L)	B (µg/L)	T (µg/L)	E (µg/L)	X (µg/L)	MTBE (µg/L)	
<b>MW-8 (cont)</b>											
11/12/04	6.96	MONITORED/SAMPLED ANNUALLY				--	--	--	--	--	--
02/11/05 <sup>15</sup>	6.96	2.85	4.11	0.00	<50	<0.5	<0.5	<0.5	<0.5	<0.5	
05/13/05	6.96	MONITORED/SAMPLED ANNUALLY				--	--	--	--	--	
08/19/05	6.96	MONITORED/SAMPLED ANNUALLY				--	--	--	--	--	
11/18/05	6.96	MONITORED/SAMPLED ANNUALLY				--	--	--	--	--	
02/10/06 <sup>15</sup>	6.96	2.74	4.22	<50	<0.5	<0.5	<0.5	<0.5	<0.5	<0.5	
05/12/06	6.96	MONITORED/SAMPLED ANNUALLY				--	--	--	--	--	
08/11/06	6.96	MONITORED/SAMPLED ANNUALLY				--	--	--	--	--	
11/17/06	6.96	MONITORED/SAMPLED ANNUALLY				--	--	--	--	--	
<b>MW-8 (cont)</b>											
02/16/07 <sup>15</sup>	6.96	2.69	4.27	0.00	<50	<0.5	<0.5	<0.5	<0.5	<0.5	
05/17/07	6.96	MONITORED/SAMPLED ANNUALLY				--	--	--	--	--	
08/09/07	6.96	MONITORED/SAMPLED ANNUALLY				--	--	--	--	--	
11/08/07	6.96	MONITORED/SAMPLED ANNUALLY				--	--	--	--	--	
02/06/08 <sup>15</sup>	6.96	2.57	4.39	0.00	<50	<0.5	<0.5	<0.5	<0.5	<0.5	
05/07/08	6.96	MONITORED/SAMPLED ANNUALLY				--	--	--	--	--	
09/11/08	6.96	MONITORED/SAMPLED ANNUALLY				--	--	--	--	--	
11/10/08	6.96	MONITORED/SAMPLED ANNUALLY				--	--	--	--	--	
02/09/09 <sup>15</sup>	6.96	3.28	3.68	0.00	<50	<0.5	<0.5	<0.5	<0.5	<0.5	
05/28/09	6.96	MONITORED/SAMPLED ANNUALLY				--	--	--	--	--	
08/18/09	6.96	MONITORED/SAMPLED ANNUALLY				--	--	--	--	--	
<b>11/17/09</b>	<b>6.96</b>	<b>MONITORED/SAMPLED ANNUALLY</b>				--	--	--	--	--	
<b>MW-9</b>											
10/17/95	7.21	4.80	2.41	--	--	--	--	--	--	--	
10/30/95	7.21	4.97	2.24	--	<50	<0.5	<0.5	<0.5	<0.5	<2.5	
01/22/96	7.21	3.40	3.81	--	<50	<0.5	<0.5	<0.5	<0.5	<2.5	
04/24/96	7.21	4.18	3.03	--	<50	<0.5	<0.5	<0.5	<0.5	<2.5	
07/29/96	7.21	4.69	2.52	--	<50	<0.5	<0.5	<0.5	<0.5	<2.5	
10/10/96	7.21	5.20	2.01	--	<50	<0.5	<0.5	<0.5	<0.5	<2.5	
01/15/97	7.21	3.31	3.90	--	<50	<0.5	<0.5	<0.5	<0.5	<2.5	
04/03/97	7.21	4.57	2.64	--	<50	<0.5	<0.5	<0.5	<0.5	<2.5	
07/09/97	7.21	5.04	2.17	--	<50	<0.5	<0.5	<0.5	<0.5	<2.5	
10/29/97	7.21	4.96	2.25	--	<50	<0.5	<0.5	<0.5	<0.5	<2.5	
01/14/98	7.21	2.40	4.81	--	<50	<0.5	<0.5	<0.5	<0.5	<2.5	
01/20/99	7.21	4.31	2.90	--	<50	<0.5	<0.5	<0.5	<0.5	<2.0	

**GROUNDWATER MONITORING DATA AND ANALYTICAL RESULTS  
FORMER CHEVRON SERVICE STATION 9-1153  
3135 GIBBONS DRIVE (3126 FERNSIDE BOULEVARD), ALAMEDA, CALIFORNIA**

WELL ID/ DATE	TOC* (ft-msl)	DTW (ft.)	GWE (ft-msl)	LNAPLT (ft.)	TPHg (µg/L)	B (µg/L)	T (µg/L)	E (µg/L)	X (µg/L)	MTBE (µg/L)
<b>MW-9 (cont)</b>										
04/19/99	7.21	3.92	3.29	--	--	--	--	--	--	--
01/25/00	7.21	2.95	4.26	--	<50	<0.5	<0.5	<0.5	<0.5	<2.5
04/03/00	7.21	MONITORED/SAMPLED ANNUALLY			--	--	--	--	--	--
07/03/00	7.21	--	--	--	--	--	--	--	--	--
10/23/00	7.21	--	--	--	--	--	--	--	--	--
01/08/01 <sup>11</sup>	7.21	4.59	2.62	0.00	<50	<0.50	<0.50	<0.50	<0.50	<2.5
04/09/01	7.21	--	--	--	--	--	--	--	--	--
08/23/01	7.21	MONITORED/SAMPLED ANNUALLY			--	--	--	--	--	--
11/27/01	7.21	MONITORED/SAMPLED ANNUALLY			--	--	--	--	--	--
02/26/02	7.21	3.75	3.46	0.00	<50	<0.50	<0.50	<0.50	<1.5	<2.5
05/23/02	7.21	MONITORED/SAMPLED ANNUALLY			--	--	--	--	--	--
08/09/02	7.21	MONITORED/SAMPLED ANNUALLY			--	--	--	--	--	--
11/08/02	7.21	MONITORED/SAMPLED ANNUALLY			--	--	--	--	--	--
02/07/03	7.21	3.97	3.24	0.00	<50	<0.50	<0.50	<0.50	<1.5	<2.5
05/09/03	7.21	MONITORED/SAMPLED ANNUALLY			--	--	--	--	--	--
08/15/03	7.21	MONITORED/SAMPLED ANNUALLY			--	--	--	--	--	--
11/14/03	7.21	MONITORED/SAMPLED ANNUALLY			--	--	--	--	--	--
02/13/04 <sup>15</sup>	7.21	3.94	3.27	0.00	<50	<0.5	<0.5	<0.5	<0.5	<0.5
05/14/04	7.21	MONITORED/SAMPLED ANNUALLY			--	--	--	--	--	--
11/12/04	7.21	MONITORED/SAMPLED ANNUALLY			--	--	--	--	--	--
02/11/05 <sup>15</sup>	7.21	3.66	3.55	0.00	<50	<0.5	<0.5	<0.5	<0.5	<0.5
05/13/05	7.21	MONITORED/SAMPLED ANNUALLY			--	--	--	--	--	--
08/19/05	7.21	MONITORED/SAMPLED ANNUALLY			--	--	--	--	--	--
11/18/05	7.21	MONITORED/SAMPLED ANNUALLY			--	--	--	--	--	--
02/10/06 <sup>15</sup>	7.21	3.53	3.68	0.00	<0.5	<0.5	<0.5	<0.5	<0.5	<0.5
05/12/06	7.21	MONITORED/SAMPLED ANNUALLY			--	--	--	--	--	--
08/11/06	7.21	MONITORED/SAMPLED ANNUALLY			--	--	--	--	--	--
11/17/06	7.21	MONITORED/SAMPLED ANNUALLY			--	--	--	--	--	--
02/16/07 <sup>15</sup>	7.21	3.50	3.71	0.00	<50	<0.5	<0.5	<0.5	<0.5	<0.5
05/17/07	7.21	MONITORED/SAMPLED ANNUALLY			--	--	--	--	--	--
08/09/07	7.21	MONITORED/SAMPLED ANNUALLY			--	--	--	--	--	--
11/08/07	7.21	MONITORED/SAMPLED ANNUALLY			--	--	--	--	--	--
02/06/08 <sup>15</sup>	7.21	3.14	4.07	0.00	<50	<0.5	<0.5	<0.5	<0.5	<0.5
05/07/08	7.21	MONITORED/SAMPLED ANNUALLY			--	--	--	--	--	--
09/11/08	7.21	MONITORED/SAMPLED ANNUALLY			--	--	--	--	--	--
11/10/08	7.21	MONITORED/SAMPLED ANNUALLY			--	--	--	--	--	--



**GROUNDWATER MONITORING DATA AND ANALYTICAL RESULTS  
FORMER CHEVRON SERVICE STATION 9-1153  
3135 GIBBONS DRIVE (3126 FERNSIDE BOULEVARD), ALAMEDA, CALIFORNIA**

WELL ID/ DATE	TOC* (ft-msl)	DTW (ft.)	GWE (ft-msl)	LNAPLT (ft.)	TPHg (µg/L)	B (µg/L)	T (µg/L)	E (µg/L)	X (µg/L)	MTBE (µg/L)	
<b>MW-9 (cont)</b>											
02/09/09 <sup>15</sup>	7.21	3.91	3.30	0.00	<50	<0.5	<0.5	<0.5	<0.5	<0.5	
05/28/09	7.21	MONITORED/SAMPLED ANNUALLY			--	--	--	--	--	--	
08/18/09	7.21	MONITORED/SAMPLED ANNUALLY			--	--	--	--	--	--	
11/17/09	7.21	MONITORED/SAMPLED ANNUALLY			--	--	--	--	--	--	
<b>MW-10</b>											
10/17/95	7.28	5.05	2.23	--	--	--	--	--	--	--	
10/30/95	7.28	5.11	2.17	--	<50	<0.5	<0.5	<0.5	<0.5	5.1	
01/22/96	7.28	4.03	3.25	--	<50	<0.5	<0.5	<0.5	0.70	17	
04/24/96	7.28	4.30	2.98	--	<50	<0.5	<0.5	<0.5	<0.5	12	
07/29/96	7.28	4.70	2.58	--	<50	<0.5	<0.5	<0.5	<0.5	14	
10/10/96	7.28	5.24	2.04	--	<50	<0.5	<0.5	<0.5	<0.5	<2.5	
01/15/97	7.28	3.35	3.93	--	<50	<0.5	<0.5	<0.5	<0.5	<2.5	
04/03/97	7.28	4.64	2.64	--	<50	<0.5	<0.5	<0.5	<0.5	8.2	
07/09/97	7.28	5.12	2.16	--	<50	<0.5	<0.5	<0.5	<0.5	<2.5	
10/29/97	7.28	5.10	2.18	--	<50	<0.5	<0.5	<0.5	<0.5	5.3	
01/14/98	7.28	3.08	4.20	--	<50	<0.5	<0.5	<0.5	<0.5	8.6	
04/17/98	7.28	3.79	3.49	--	SAMPLED SEMI-ANNUALLY		--	--	--	--	
07/15/98	7.28	4.55	2.73	--	<50	<0.5	<0.5	<0.5	<0.5	7.5	
10/27/98	7.28	5.32	1.96	--	--	--	--	--	--	--	
01/20/99	7.28	4.24	3.04	--	<50	<0.5	<0.5	<0.5	<0.5	<2.0	
04/19/99	7.28	4.07	3.21	--	--	--	--	--	--	--	
07/29/99	7.28	4.82	2.46	--	<50	<0.5	<0.5	<0.5	<0.5	<5.0/2.4 <sup>2</sup>	
10/13/99	7.28	4.86	2.42	--	--	--	--	--	--	--	
01/25/00	7.28	3.00	4.28	--	<50	<0.5	<0.5	<0.5	<0.5	4.33	
04/03/00	7.28	3.04	4.24	0.00	--	--	--	--	--	--	
07/03/00	7.28	4.00	3.28	0.00	<50	<0.50	<0.50	<0.50	<0.50	4.7	
10/23/00	7.28	5.86	1.42	0.00	--	--	--	--	--	--	
01/08/01 <sup>11</sup>	7.28	3.98	3.30	0.00	<50	<0.50	<0.50	<0.50	<0.50	<2.5	
04/09/01	7.28	3.74	3.54	0.00	--	--	--	--	--	--	
08/23/01	7.28	INACCESSIBLE - DUE TO TRAFFIC CONTROL				--	--	--	--	--	--
11/27/01	7.28	4.13	3.15	0.00	SAMPLED SEMI-ANNUALLY		--	--	--	--	
02/26/02	7.28	3.54	3.74	0.00	<50	<0.50	<0.50	<0.50	<1.5	<2.5	
05/23/02	7.28	3.82	3.46	0.00	SAMPLED SEMI-ANNUALLY		--	--	--	--	
08/09/02	7.28	4.18	3.10	0.00	<50	<0.50	<0.50	<0.50	<1.5	<2.5	
11/08/02	7.28	3.91	3.37	0.00	SAMPLED SEMI-ANNUALLY		--	--	--	--	

**GROUNDWATER MONITORING DATA AND ANALYTICAL RESULTS  
FORMER CHEVRON SERVICE STATION 9-1153  
3135 GIBBONS DRIVE (3126 FERNSIDE BOULEVARD), ALAMEDA, CALIFORNIA**

WELL ID/ DATE	TOC* (ft-msl)	DTW (ft.)	GWE (ft-msl)	LNAPLT (ft.)	TPHg (µg/L)	B (µg/L)	T (µg/L)	E (µg/L)	X (µg/L)	MTBE (µg/L)
<b>MW-10 (cont)</b>										
02/07/03	7.28	3.61	3.67	0.00	<50	<0.50	<0.50	<0.50	<1.5	<2.5
05/09/03	7.28	3.25	4.03	0.00	SAMPLED SEMI-ANNUALLY	--	--	--	--	--
08/15/03 <sup>15</sup>	7.28	4.35	2.93	0.00	<50	<0.5	<0.5	<0.5	<0.5	<0.5
11/14/03	7.28	4.30	2.98	0.00	SAMPLED SEMI-ANNUALLY	--	--	--	--	--
02/13/04 <sup>15</sup>	7.28	4.27	3.01	0.00	<50	<0.5	<0.5	<0.5	<0.5	<0.5
05/14/04	7.28	4.08	3.20	0.00	SAMPLED SEMI-ANNUALLY	--	--	--	--	--
08/13/04 <sup>15</sup>	7.28	3.92	3.36	0.00	<50	<0.5	<0.5	<0.5	<0.5	<0.5
11/12/04	7.28	3.98	3.30	0.00	SAMPLED SEMI-ANNUALLY	--	--	--	--	--
02/11/05 <sup>15</sup>	7.28	4.07	3.21	0.00	<50	<0.5	<0.5	<0.5	<0.5	<0.5
05/13/05	7.28	4.01	3.27	0.00	SAMPLED SEMI-ANNUALLY	--	--	--	--	--
08/19/05 <sup>15</sup>	7.28	3.69	3.59	0.00	<50	<0.5	<0.5	<0.5	<0.5	<0.5
11/18/05	7.28	3.86	3.42	0.00	SAMPLED SEMI-ANNUALLY	--	--	--	--	--
02/10/06 <sup>15</sup>	7.28	3.94	3.34	0.00	<0.5	<0.5	<0.5	<0.5	<0.5	<0.5
05/12/06	7.28	4.07	3.21	0.00	SAMPLED SEMI-ANNUALLY	--	--	--	--	--
08/11/06 <sup>15</sup>	7.28	4.21	3.07	0.00	<50	<0.5	<0.5	<0.5	<0.5	<0.5
11/17/06	7.28	3.83	3.45	0.00	SAMPLED SEMI-ANNUALLY	--	--	--	--	--
02/16/07 <sup>15</sup>	7.28	3.87	3.41	0.00	<50	<0.5	<0.5	<0.5	<0.5	<0.5
05/17/07	7.28	3.71	3.57	0.00	SAMPLED SEMI-ANNUALLY	--	--	--	--	--
08/09/07	7.28	INACCESSIBLE	--	--	--	--	--	--	--	--
11/08/07	7.28	INACCESSIBLE	--	--	--	--	--	--	--	--
02/06/08	7.28	INACCESSIBLE	--	--	--	--	--	--	--	--
05/07/08	7.28	INACCESSIBLE	--	--	--	--	--	--	--	--
09/11/08 <sup>15</sup>	7.28	4.63	2.65	0.00	<50	<0.5	<0.5	<0.5	<0.5	<0.5
11/10/08	7.28	4.28	3.00	0.00	SAMPLED SEMI-ANNUALLY	--	--	--	--	--
02/09/09 <sup>15</sup>	NP	2.17	5.11	0.00	<50	<0.5	<0.5	<0.5	<0.5	<0.5
05/28/09	7.28	3.69	3.59	0.00	--	--	--	--	--	--
08/18/09 <sup>15</sup>	7.28	4.07	3.21	0.00	<50	<0.5	<0.5	<0.5	<0.5	<0.5
<b>11/17/09</b>	<b>7.28</b>	<b>4.12</b>	<b>3.16</b>	<b>0.00</b>	--	--	--	--	--	--
<b>C-2</b>										
08/18/86	--	--	--	--	--	--	--	--	--	--
09/04/86	--	--	--	--	1,100	49	18	84	--	--
07/22/87	--	--	--	--	<50	1.8	<1.0	<4.0	--	--
ABANDONED										

**GROUNDWATER MONITORING DATA AND ANALYTICAL RESULTS  
FORMER CHEVRON SERVICE STATION 9-1153  
3135 GIBBONS DRIVE (3126 FERNSIDE BOULEVARD), ALAMEDA, CALIFORNIA**

WELL ID/ DATE	TOC* (ft-msl)	DTW (ft.)	GWE (ft-msl)	LNAPLT (ft.)	TPHg (µg/L)	B (µg/L)	T (µg/L)	E (µg/L)	X (µg/L)	MTBE (µg/L)
<b>TMW-1</b>										
11/11/93	--	--	--	--	<1.0	<0.5	<0.5	<0.5	<0.5	--
NOT MONITORED/SAMPLED										
<b>3115A GIBBONS DR.</b>										
01/14/98	--	--	--	--	<50	<0.5	<0.5	<0.5	<0.5	<2.5
<b>TRIP BLANK</b>										
<b>TB-LB</b>										
02/14/90	--	--	--	--	<50	<0.5	1.1	<0.5	<0.5	--
09/06/91	--	--	--	--	<50	<0.5	<0.5	<0.5	<0.5	--
12/15/91	--	--	--	--	<50	<0.5	<0.5	<0.5	<0.5	--
03/03/92	--	--	--	--	<50	<0.5	<0.5	<0.5	<0.5	--
06/04/92	--	--	--	--	<50	<0.5	<0.5	<0.5	<0.5	--
10/13/92	--	--	--	--	<50	<0.5	<0.5	<0.5	<0.5	--
01/11/93	--	--	--	--	<50	<0.5	<0.5	<0.5	<0.5	--
04/14/93	--	--	--	--	<50	<0.5	<0.5	<0.5	<0.5	--
07/13/93	--	--	--	--	<50	<0.5	<0.5	<0.5	<0.5	--
10/19/93	--	--	--	--	<50	<0.5	<0.5	<0.5	<1.5	--
01/27/94	--	--	--	--	<50	<0.5	<0.5	<0.5	<0.5	--
04/07/94	--	--	--	--	<50	<0.5	<0.5	<0.5	<0.5	--
07/01/94	--	--	--	--	<50	<0.5	<0.5	<0.5	<0.5	--
10/05/94	--	--	--	--	<50	<0.5	<0.5	<0.5	<0.5	--
01/12/95	--	--	--	--	<50	<0.5	<0.5	<0.5	<0.5	--
04/26/95	--	--	--	--	<50	<0.5	<0.5	<0.5	<0.5	--
07/12/95	--	--	--	--	<50	<0.5	<0.5	<0.5	<0.5	--
10/30/95	--	--	--	--	<50	<0.5	<0.5	<0.5	<0.5	--
01/22/96	--	--	--	--	<50	<0.5	<0.5	<0.5	<0.5	<2.5
04/24/96	--	--	--	--	<50	<0.5	<0.5	<0.5	<0.5	<2.5
07/29/96	--	--	--	--	<50	<0.5	<0.5	<0.5	<0.5	<2.5
10/10/96	--	--	--	--	--	--	--	--	--	--
01/15/97	--	--	--	--	<50	<0.5	<0.5	<0.5	<0.5	<2.5
04/03/97	--	--	--	--	<50	<0.5	<0.5	<0.5	<0.5	<2.5
07/09/97	--	--	--	--	<50	<0.5	<0.5	<0.5	<0.5	<2.5

**GROUNDWATER MONITORING DATA AND ANALYTICAL RESULTS  
FORMER CHEVRON SERVICE STATION 9-1153  
3135 GIBBONS DRIVE (3126 FERNSIDE BOULEVARD), ALAMEDA, CALIFORNIA**

WELL ID/ DATE	TOC* (ft-msl)	DTW (ft.)	GWE (ft-msl)	LNAPLT (ft.)	TPHg (µg/L)	B (µg/L)	T (µg/L)	E (µg/L)	X (µg/L)	MTBE (µg/L)
<b>Trip Blank (cont)</b>										
10/29/97	--	--	--	--	<50	<0.5	<0.5	<0.5	<0.5	<2.5
01/14/98	--	--	--	--	<50	<0.5	<0.5	<0.5	<0.5	<2.5
04/17/98	--	--	--	--	<50	<0.5	<0.5	<0.5	<0.5	<2.5
07/15/98	--	--	--	--	<50	<0.5	<0.5	<0.5	<0.5	<2.5
10/27/98	--	--	--	--	<50	<0.5	<0.5	<0.5	<0.5	<2.5
01/20/99	--	--	--	--	<50	<0.5	<0.5	<0.5	<0.5	<2.0
04/19/99	--	--	--	--	<50	<0.5	<0.5	<0.5	<0.5	<2.5
07/29/99	--	--	--	--	<50	<0.5	<0.5	<0.5	<0.5	<5.0
10/13/99	--	--	--	--	<50	<0.5	<0.5	<0.5	<0.5	<2.5
01/25/00	--	--	--	--	<50	<0.5	<0.5	<0.5	<0.5	<2.5
04/03/00	--	--	--	--	<50	<0.50	<0.50	<0.50	<0.50	<2.5
07/03/00	--	--	--	--	<50	<0.50	<0.50	<0.50	<0.50	<2.5
10/23/00	--	--	--	--	<50	<0.50	<0.50	<0.50	<0.50	<2.5
01/08/01 <sup>11</sup>	--	--	--	--	<50	<0.50	<0.50	<0.50	<0.50	<2.5
04/09/01	--	--	--	--	<50.0	<0.500	<2.00	<0.500	<2.00	<0.500
08/23/01	--	--	--	--	<50	<0.50	<0.50	<0.50	<0.50	<2.5
11/27/01	--	--	--	--	<50	<0.50	<0.50	<0.50	<1.5	<2.5
02/26/02	--	--	--	--	<50	<0.50	<0.50	<0.50	<1.5	<2.5
05/23/02	--	--	--	--	<50	<0.50	<0.50	<0.50	<1.5	<2.5
08/09/02	--	--	--	--	<50	<0.50	<0.50	<0.50	<1.5	<2.5
11/08/02	--	--	--	--	<50	<0.50	<0.50	<0.50	<1.5	<2.5
02/07/03	--	--	--	--	<50	<0.50	<0.50	<0.50	<1.5	<2.5
05/09/03	--	--	--	--	<50	<0.5	<0.5	<0.5	<1.5	<2.5
08/15/03 <sup>15</sup>	--	--	--	--	<50	<0.5	<0.5	<0.5	<0.5	<0.5
11/14/03	--	--	--	--	<50	<0.5	<0.5	<0.5	<0.5	<0.5
02/13/04 <sup>15</sup>	--	--	--	--	<50	<0.5	<0.5	<0.5	<0.5	<0.5
05/14/04 <sup>15</sup>	--	--	--	--	<50	<0.5	<0.5	<0.5	<0.5	<0.5
<b>QA</b>										
08/13/04 <sup>15</sup>	--	--	--	--	<50	<0.5	<0.5	<0.5	<0.5	<0.5
11/12/04 <sup>15</sup>	--	--	--	--	<50	<0.5	<0.5	<0.5	<0.5	<0.5
02/11/05 <sup>15</sup>	--	--	--	--	<50	<0.5	<0.5	<0.5	<0.5	<0.5
05/13/05 <sup>15</sup>	--	--	--	--	<50	<0.5	<0.5	<0.5	<0.5	<0.5
08/19/05 <sup>15</sup>	--	--	--	--	<50	<0.5	<0.5	<0.5	<0.5	<0.5
11/18/05 <sup>15</sup>	--	--	--	--	<50	<0.5	<0.5	<0.5	<0.5	<0.5
02/10/06 <sup>15</sup>	--	--	--	--	<50	<0.5	<0.5	<0.5	<0.5	<0.5
05/12/06 <sup>15</sup>	--	--	--	--	<50	<0.5	<0.5	<0.5	<0.5	<0.5

**GROUNDWATER MONITORING DATA AND ANALYTICAL RESULTS  
FORMER CHEVRON SERVICE STATION 9-1153  
3135 GIBBONS DRIVE (3126 FERNSIDE BOULEVARD), ALAMEDA, CALIFORNIA**

<b>WELL ID/ DATE</b>	<b>TOC* (ft-msl)</b>	<b>DTW (ft.)</b>	<b>GWE (ft-msl)</b>	<b>LNAPLT (ft.)</b>	<b>TPHg (µg/L)</b>	<b>B (µg/L)</b>	<b>T (µg/L)</b>	<b>E (µg/L)</b>	<b>X (µg/L)</b>	<b>MTBE (µg/L)</b>
<b>QA (cont)</b>										
08/11/06 <sup>15</sup>	--	--	--	--	<50	<0.5	<0.5	<0.5	<0.5	<0.5
11/17/06 <sup>15</sup>	--	--	--	--	<50	<0.5	<0.5	<0.5	<0.5	<0.5
02/16/07 <sup>15</sup>	--	--	--	--	<50	<0.5	<0.5	<0.5	<0.5	<0.5
05/17/07 <sup>15</sup>	--	--	--	--	<50	<0.5	<0.5	<0.5	<0.5	<0.5
08/09/07 <sup>15</sup>	--	--	--	--	<50	<0.5	<0.5	<0.5	<0.5	<0.5
11/08/07 <sup>15</sup>	--	--	--	--	<50	<0.5	<0.5	<0.5	<0.5	<0.5
02/06/08 <sup>15</sup>	--	--	--	--	<50	<0.5	<0.5	<0.5	<0.5	<0.5
05/07/08 <sup>15</sup>	--	--	--	--	<50	<0.5	<0.5	<0.5	<0.5	<0.5
09/11/08 <sup>15</sup>	--	--	--	--	<50	<0.5	<0.5	<0.5	<0.5	<0.5
11/10/08 <sup>15</sup>	--	--	--	--	<50	<0.5	<0.5	<0.5	<0.5	<0.5
02/09/09 <sup>15</sup>	--	--	--	--	<50	<0.5	<0.5	<0.5	<0.5	<0.5
05/28/09 <sup>15</sup>	--	--	--	--	<50	<0.5	<0.5	<0.5	<0.5	<0.5
08/18/09 <sup>15</sup>	--	--	--	--	<50	<0.5	<0.5	<0.5	<0.5	<0.5
11/17/09 <sup>15</sup>	--	--	--	--	SITE NOT SAMPLED DUE TO PRESENCE OF LNAPL IN C-1				--	--

**GROUNDWATER MONITORING DATA AND ANALYTICAL RESULTS  
FORMER CHEVRON SERVICE STATION 9-1153  
3135 GIBBONS DRIVE (3126 FERNSIDE BOULEVARD), ALAMEDA, CALIFORNIA**

WELL ID/ DATE	TOC* (ft-msl)	DTW (ft.)	GWE (ft-msl)	LNAPLT (ft.)	TPHg (µg/L)	B (µg/L)	T (µg/L)	E (µg/L)	X (µg/L)	MTBE (µg/L)
------------------	------------------	--------------	-----------------	-----------------	----------------	-------------	-------------	-------------	-------------	----------------

**EXPLANATIONS:**

Groundwater monitoring data and laboratory analytical results prior to April 3, 2000, were compiled from reports prepared by Blaine Tech Services, Inc.

TOC = Top of Casing (ft.) = Feet	B = Benzene T = Toluene	QA = Quality Assurance/Trip Blank NP= No Purge
DTW = Depth to Water	E = Ethylbenzene	J = Estimate value
GWE = Groundwater Elevation (ft-msl) = Mean sea level	X = Xylenes	U = Compound not detected
LNAPLT = Light Non-Aqueous Phase Liquid Thickness	MTBE = Methyl Tertiary Butyl Ether	
TPHg = Total Petroleum Hydrocarbons as Gasoline	(µg/L) = Micrograms per liter	
	-- = Not Measured/Not Analyzed	

- \* TOC elevations are referenced to feet above mean sea level (ft-msl)
- \*\* GWE has been corrected due to the presence of LNAPL; correction factor: [(TOC - DTW) + (LNAPLT x 0.80)].
- 1 Laboratory report indicates EPA 8010 were not detected (ND).
- 2 MTBE confirmed.
- 3 Chromatogram report indicates an unidentified hydrocarbon.
- 4 ORC installed.
- 5 TOC elevation altered due to well head maintenance.
- 6 Laboratory report indicates gasoline C6-C12.
- 7 ORC in well.
- 8 Laboratory report indicates Dissolved Oxygen was 1.50 parts per million (ppm) by EPA Method 360.1.
- 9 Laboratory report indicates Dissolved Oxygen was 0.300 ppm by EPA Method 360.1.
- 10 Laboratory report indicates sample originally shot in hold time at a raise D.L. re-analyzed and reported past hold time.
- 11 Laboratory report indicates this sample was analyzed outside of the EPA recommended holding time.
- 12 Laboratory report indicates unidentified hydrocarbons C6-C12.
- 13 Laboratory report indicates hydrocarbon pattern is present in the requested fuel quantitation range but does not resemble the pattern of the requested fuel.
- 14 ORC removed.
- 15 BTEX and MTBE by EPA Method 8260.
- 16 Laboratory confirmed analytical result.
- 17 The vial submitted did not have pH<2. The pH of this sample used for the undiluted analysis was pH = 3.

**LIGHT NON-AQUEOUS PHASE LIQUID THICKNESS AND REMOVAL DATA  
FORMER CHEVRON SERVICE STATION 9-1153  
3135 GIBBONS DRIVE (3126 FERNSIDE BOULEVARD), ALAMEDA, CALIFORNIA**

<b>WELL ID</b>	<b>DATE</b>	<b>DTW (ft.)</b>	<b>LNAPLT (ft.)</b>	<b>AMOUNT BAILED (Product + Water) (gallons)</b>	<b>TOTAL BAILED (Product + Water) (gallons)</b>
C-1	08/18/86	4.10	--	--	--
	09/04/86	--	--	--	--
	07/22/87	--	--	--	--
	05/03/89	4.46	--	--	--
	12/04/89	4.16	--	--	--
	02/14/90	3.64	--	--	--
	03/07/90	3.36	--	--	--
	09/06/91	4.43	--	--	--
	12/15/91	4.78	--	--	--
	03/03/92	2.39	--	--	--
	06/04/92	4.08	--	--	--
	10/13/92	4.75	--	--	--
	01/11/93	2.26	Sheen	--	--
	04/14/93	2.90	Sheen	--	--
	07/13/93	3.97	Sheen	--	--
	10/19/93	4.50	--	--	--
	11/30/93	4.27	--	--	--
	01/27/94	3.35	--	--	--
	04/07/94	3.42	--	--	--
	07/01/94	3.96	--	--	--
	10/05/94	4.39	--	--	--
	01/12/95	1.52	0.50	0.26	0.26
	04/26/95	4.40	2.20	1.32	1.59
	07/12/95	4.85	1.81	0.66	2.25
	10/30/95	5.67	1.63	0.53	2.77
	01/04/96	3.92	0.12	0.26	3.04
	01/10/96	3.48	0.13	0.07	3.10
	01/17/96	3.40	0.02	0.40	3.50
	01/22/96	2.90	0.00	0.00	3.50
	02/23/96	4.10	1.86	0.66	4.16
	02/28/96	--	>0.83	1.25	5.41
	03/08/96	2.86	1.83	0.26	5.68
	03/08/96	2.30	0.36	0.53	6.20
	03/08/96	2.33	0.36	0.26	6.47
	03/08/96	2.28	0.22	0.53	7.00
	03/26/96	3.96	1.28	0.40	7.39
	04/11/96	5.61	1.75	0.53	7.92
	04/19/96	3.09	0.04	0.40	8.32
	04/24/96	3.04	0.03	0.40	8.71
	05/03/96	4.02	0.46	0.40	9.11
	05/03/96	3.89	0.47	0.00	9.11
	05/08/96	4.25	0.35	0.07	9.17
	05/17/96	3.24	0.04	0.03	9.20
	05/17/96	3.35	0.01	0.03	9.23
	05/17/96	3.43	0.01	0.03	9.26
	05/17/96	3.65	0.01	0.00	9.26
	05/22/96	3.10	0.07	0.08	9.34
	06/18/96	4.68	0.48	0.26	9.60
	07/03/96	5.03	0.13	0.15	9.75
	07/09/96	4.63	0.23	0.09	9.84
	07/17/96	4.73	0.15	0.32	10.16

**LIGHT NON-AQUEOUS PHASE LIQUID THICKNESS AND REMOVAL DATA  
FORMER CHEVRON SERVICE STATION 9-1153  
3135 GIBBONS DRIVE (3126 FERNSIDE BOULEVARD), ALAMEDA, CALIFORNIA**

<b>WELL ID</b>	<b>DATE</b>	<b>DTW (ft.)</b>	<b>LNAPLT (ft.)</b>	<b>AMOUNT BAILED (Product + Water) (gallons)</b>	<b>TOTAL BAILED (Product + Water) (gallons)</b>
<b>C-1 (cont)</b>	07/29/96	5.10	0.09	0.26	10.42
	08/02/96	5.68	0.03	0.03	10.45
	08/07/96	5.16	0.01	0.13	10.59
	08/23/96	5.75	0.03	0.03	10.61
	08/28/96	5.53	0.03	0.01	10.63
	09/06/96	5.38	--	0.05	10.67
	09/12/96	5.48	0.03	0.01	10.68
	09/19/96	6.32	0.03	0.01	10.69
	10/10/96	4.58	0.10	0.13	10.83
	10/17/96	5.61	0.01	0.01	10.84
	10/29/96	6.01	--	--	10.84
	11/07/96	5.56	0.04	0.13	10.97
	11/11/96	5.32	0.04	0.13	11.10
	12/20/96	3.33	0.03	0.05	11.16
	12/17/96	3.73	0.01	0.01	11.17
	01/15/97	2.74	--	--	11.17
	01/22/97	1.37	0.19	0.07	11.23
	02/04/97	2.98	0.51	0.15	11.38
	02/20/97	4.09	0.13	0.11	11.48
	03/06/97	3.75	0.56	1.19	12.67
	03/14/97	3.82	0.03	0.12	12.79
	03/20/97	3.73	0.03	0.01	12.80
	03/25/97	4.32	0.01	--	12.80
	03/31/97	3.71	0.03	0.00	12.81
	04/03/97	4.60	0.03	0.00	12.81
	04/09/97	4.25	0.02	0.03	12.84
	04/24/97	4.65	0.02	0.01	12.84
	04/30/97	3.50	0.02	0.01	12.85
	05/22/97	4.97	--	0.01	12.86
	06/03/97	3.62	0.06	0.01	12.86
	07/09/97	4.30	0.06	0.13	13.00
	08/12/97	5.18	0.00	0.05	13.05
	09/30/97	5.25	0.50	0.07	13.12
	10/29/97	5.33	0.03	0.02	13.14
	11/13/97	4.86	0.02	0.03	13.16
	12/18/97	2.34	--	--	13.16
	01/14/98	0.25	0.02	0.13	13.29
	02/02/98	2.35	0.05	0.03	13.32
	03/16/98	2.50	0.50	0.13	13.45
	04/17/98	2.65	0.40	0.11	13.56
	05/01/98	2.39	0.04	0.26	13.82
	06/17/98	3.26	0.08	0.03	13.86
	07/15/98	3.55	--	--	13.86
	09/01/98	4.00	--	--	13.86
	10/27/98	4.48	--	--	13.86
	11/19/98	3.89	--	--	13.86
	12/19/98	2.13	0.02	0.04	13.90
	01/20/99	3.98	--	--	13.90
	02/24/99	2.55	--	--	13.90
	03/26/99	2.14	0.76	0.26	14.16
	04/19/99	1.04	--	--	14.16



**LIGHT NON-AQUEOUS PHASE LIQUID THICKNESS AND REMOVAL DATA  
FORMER CHEVRON SERVICE STATION 9-1153  
3135 GIBBONS DRIVE (3126 FERNSIDE BOULEVARD), ALAMEDA, CALIFORNIA**

<b>WELL ID</b>	<b>DATE</b>	<b>DTW (ft.)</b>	<b>LNAPLT (ft.)</b>	<b>AMOUNT BAILED (Product + Water) (gallons)</b>	<b>TOTAL BAILED (Product + Water) (gallons)</b>
<b>C-1 (cont)</b>	04/19/99	1.04	--	--	--
	07/29/99	3.76	0.02	0.01	14.17
	08/30/99	4.30	--	--	14.17
	09/23/99	3.84	0.02	0.03	14.20
	10/13/99	1.27	--	--	14.20
	11/17/99	3.59	--	--	--
	12/08/99	3.79	--	--	--
	01/25/00	1.99	0.04	0.03	14.23
	04/03/00	2.20	0.10	0.00	14.23
	05/26/00	2.52	0.23	0.26	14.49
	06/19/00 <sup>1</sup>	2.89	0.19	0.26	14.75
	07/03/00	3.45	0.25	0.26	15.01
	08/01/00	3.78	0.16	0.10	15.11
	09/30/00	4.03	0.04	0.26	15.37
	10/23/00	4.15	0.03	0.26	15.63
	11/21/00	3.42	0.00	0.26	15.89
	12/22/00	2.96	0.00	0.26	16.15
	01/08/01	2.94	0.00	0.26	16.41
	02/17/01	2.09	0.59	0.26	16.67
	03/13/01	2.20	0.76	0.26	16.93
	04/09/01	2.45	0.26	0.26	17.19
	05/18/01	2.70	0.59	0.26	17.45
	06/12/01	3.50	0.97	0.26	17.71
	07/19/01	4.25	0.95	0.26	17.97
	08/23/01	4.34	0.07	0.26	18.23
	09/17/01	4.39	0.08	0.00	18.23
	10/08/01	4.45	0.04	0.02	18.25
	11/27/01	3.89	0.00	0.00	18.25
	12/17/01	1.81	0.00	0.00	18.25
	01/07/02	2.27	0.51	1.50	19.75
	02/26/02	2.70	0.52	0.13	19.88
	03/27/02	2.87	1.05	0.26	20.14
	04/08/02	2.45	1.23	0.53	20.67
	05/23/02	3.57	0.52	0.12	20.79
	06/17/02	3.90	0.35	0.07	20.86
	07/31/02	4.12	0.20	0.02	20.88
	08/09/02	4.15	0.16	0.02	20.90
	09/17/02	4.33	0.12	0.01	20.91
	10/15/02	4.51	0.15	0.04	20.95
	11/08/02	4.11	0.00	0.00	20.95
	12/19/02	1.14	0.00	0.00	20.95
	01/14/03	1.80	0.00	0.00	20.95
	02/07/03	2.95	0.30	0.05	21.00
	03/20/03	2.86	0.41	0.13	21.13
	04/15/03	2.12	0.10	0.03	21.16
	05/09/03	2.95	0.70	0.22	21.38
	06/27/03	3.97	0.50	0.11	21.49
	07/16/03	3.68	0.28	0.04	21.53
	08/15/03	4.29	0.22	0.03	21.56
	09/26/03	4.60	0.19	0.04	21.60
	10/18/03	4.72	0.15	0.02	21.62

**LIGHT NON-AQUEOUS PHASE LIQUID THICKNESS AND REMOVAL DATA  
FORMER CHEVRON SERVICE STATION 9-1153  
3135 GIBBONS DRIVE (3126 FERNSIDE BOULEVARD), ALAMEDA, CALIFORNIA**

<b>WELL ID</b>	<b>DATE</b>	<b>DTW (ft.)</b>	<b>LNAPLT (ft.)</b>	<b>AMOUNT BAILED (Product + Water) (gallons)</b>	<b>TOTAL BAILED (Product + Water) (gallons)</b>
<b>C-1 (cont)</b>	11/14/03	4.31	0.20	0.04	21.66
	12/23/03	1.81	0.00	0.00	21.66
	01/22/04	4.19	0.01	0.25 <sup>c</sup>	21.91
	02/13/04	3.04	0.04	0.27	22.18
	03/11/04	1.85	0.40	0.04	22.22
	04/22/04	3.08	0.22	0.66	22.88
	05/14/04	3.49	0.03	0.54	23.42
	06/18/04	3.41	0.13	0.63	24.05
	07/23/04	3.28	0.11	0.59	24.64
	08/13/04	3.14	0.05	1.02	25.66
	09/13/04	4.53	0.09	0.03	25.69
	10/22/04	3.19	0.03	1.02	26.71
	11/12/04	3.22	0.03	0.51	27.22
	12/02/04	3.28	0.02	0.26	27.48
	01/28/05	3.19	0.01	0.51	27.99
	02/11/05	2.75	0.04	0.53	28.52
	03/11/05	2.94	0.03	1.02	29.54
	04/26/05	3.03	0.02	1.02	30.56
	05/13/05	3.18	0.02	1.02	31.58
	06/01/05	3.22	0.02	0.51	32.09
	07/15/05	3.09	0.02	1.51	33.60
	08/19/05	2.88	0.03	1.53	35.13
	09/23/05	2.95	0.02	1.02	36.15
	10/14/05	3.01	0.01	0.52	36.67
	11/18/05	3.21	0.02	1.02	37.69
	12/09/05	3.61	0.01	1.01	38.70
	01/12/06	2.98	0.01	0.51	39.21
	02/10/06	2.69	0.01	0.50 <sup>o</sup>	39.71
	03/13/06	2.81	0.01	1.00 <sup>+</sup>	40.71
	04/13/06	2.75	0.01	0.50 <sup>+</sup>	41.22
	05/12/06	3.02	0.01	0.50 <sup>+</sup>	41.72
	06/12/06	3.10	0.01	0.50 <sup>+</sup>	42.22
	07/13/06	3.14	0.02	1.01	43.23
	08/11/06	3.70	0.01	1.01	44.24
	09/11/06	3.75	0.02	1.02	45.26
	10/17/06	3.82	0.01	1.02	46.28
	11/17/06	3.11	0.03	1.02	47.30
	12/15/06	2.95	0.02	1.02	48.32
	01/16/07	2.98	0.02	0.52	48.84
	02/16/07	2.77	0.00	0.00	48.84
	03/16/07	3.07	0.01	0.51 <sup>+</sup>	49.35
	04/17/07	2.98	0.01	0.50 <sup>o</sup>	49.85
	05/17/07	3.05	0.01	0.51 <sup>+</sup>	50.36
	06/15/07	3.08	0.01	1.02	51.38
	07/17/07	3.13	0.01	0.50 <sup>+</sup>	51.88
	08/09/07	3.24	0.02	0.52	52.40
	09/14/07	3.16	0.01	0.26 <sup>+</sup>	52.67
	10/16/07	3.04	0.01	0.26 <sup>+</sup>	52.93
	11/08/07	3.11	0.01	0.00	52.93
	12/07/07	2.98	0.03	0.55	53.48
	01/16/08	2.95	0.02	0.27	53.75

**LIGHT NON-AQUEOUS PHASE LIQUID THICKNESS AND REMOVAL DATA  
FORMER CHEVRON SERVICE STATION 9-1153  
3135 GIBBONS DRIVE (3126 FERNSIDE BOULEVARD), ALAMEDA, CALIFORNIA**

<b>WELL ID</b>	<b>DATE</b>	<b>DTW (ft.)</b>	<b>LNAPLT (ft.)</b>	<b>AMOUNT BAILED (Product + Water) (gallons)</b>	<b>TOTAL BAILED (Product + Water) (gallons)</b>
<b>C-1 (cont)</b>	02/06/08	2.61	0.01	0.00	53.75
	03/07/08	2.87	0.02	0.40 <sup>*</sup>	54.16
	04/16/08	3.06	0.02	0.55	54.71
	05/07/08	2.98	0.03	0.55	55.26
	06/06/08	3.04	0.02	0.55	55.81
	07/16/08	3.12	0.02	0.41	56.22
	09/05/08	3.97	0.28	0.61	56.83
	09/11/08	4.22	0.41	0.92	57.75
	10/17/08	4.16	0.33	0.64	58.39
	11/10/08	4.05	0.11	0.32	58.71
	12/15/08	3.85	0.05	0.30	59.01
	01/21/09	3.91	0.04	0.29	59.30
	02/09/09	3.72	0.01	0.14	59.44
	03/16/09	3.81	0.02	0.15	59.59
	05/28/09	3.48	0.02	0.01	59.60
	08/18/09	4.40	0.02	0.01	59.61
	<b>11/17/09</b>	<b>4.21</b>	<b>0.03</b>	<b>0.01</b>	<b>59.62</b>

**EXPLANATIONS:**

Groundwater monitoring data prior to July 3, 2000, were compiled from reports prepared by Blaine Tech Services, Inc.

DTW = Depth to Water

(ft.) = Feet

LNAPLT = Light Non-Aqueous Phase Liquid Thickness

-- = Not Measured

- <sup>1</sup> There is no skimmer present in this well.  
<sup>2</sup> Removed less than one ounce of LNAPL from well.  
<sup>3</sup> Removed 0.5 ounces of LNAPL from well.  
<sup>4</sup> Removed 1 ounce of LNAPL from well.

**DISSOLVED OXYGEN CONCENTRATIONS  
FORMER CHEVRON SERVICE STATION 9-1153  
3135 GIBBONS DRIVE (3126 FERNSIDE BOULEVARD), ALAMEDA, CALIFORNIA**

<i>WELL ID</i>	<i>DATE</i>	<i>PRE-PURGE (mg/L)</i>	<i>POST-PURGE (mg/L)</i>
MW-6	11/08/02	2.10	--
	02/07/03	2.60	--
	05/09/03	3.10	--
	08/15/03	2.90	--
	11/14/03	3.41	--
	08/19/05	1.90	--
	11/18/05	1.70	--
	02/10/06	2.20	--
	05/12/06	2.80	--
	08/11/06	2.50	--
	11/17/06	2.20	--
	02/16/07	1.80	--
	05/17/07	2.0	--
	08/09/07	2.6	--
	11/08/07	2.2	--
	02/06/08	2.4	--
	05/07/08	2.3	--
	09/11/08	1.9	--
	11/10/08	2.2	--
	02/09/09	2.0	--
05/28/09	1.70	--	
08/18/09	1.81	--	
	<b>11/17/09</b>	--	--
MW-7	11/08/02	-98.00 <sup>1</sup>	--
	02/07/03	2.90	--
	05/09/03	2.60	--
	08/15/03	2.30	--
	11/14/03	1.87	--
	08/19/05	0.80	--
	11/18/05	0.90	--
	02/10/06	1.30	--
	05/12/06	1.40	--
	08/11/06	1.10	--
	11/17/06	0.70	--
	02/16/07	1.10	--
	05/17/07	1.7	--
	08/09/07	1.2	--
	11/08/07	0.9	--
	02/06/08	0.5	--
	05/07/08	1.2	--
	09/11/08	1.0	--
	11/10/08	0.6	--
	02/09/09	0.8	--
05/28/09	0.45	--	
08/18/09	0.57	--	
	<b>11/17/09</b>	--	--

**EXPLANATIONS:**

mg/L = milligrams per liter

-- = Not Measured

<sup>1</sup> Below D.O. meter range.

ATTACHMENT A

BLAINE TECH'S NOVEMBER 18, 2009 *GROUNDWATER MONITORING  
AND SAMPLING REPORT*



November 18, 2009

Chevron Environmental Management Company  
Aaron Costa  
6111 Bollinger Canyon Rd.  
San Ramon, CA 94583

Fourth Quarter 2009 Monitoring at  
Chevron Service Station 91153  
3135 Gibbons Dr.  
Alameda, CA

Monitoring performed on November 17, 2009

---

**Blaine Tech Services, Inc. Groundwater Monitoring Event 091117-JO1**

This submission covers the routine monitoring of groundwater wells conducted on November 17, 2009 at this location. Five monitoring wells were measured for depth to groundwater (DTW). Well C-1 was checked for SPH with an electronic interface probe. SPH was bailed from well and placed into drum.

Water levels measurements were collected using an electronic slope indicator. All reused equipment was decontaminated in an integrated stainless steel sink with de-ionized water supplied Hotsy pressure washer and Liquinox or equivalent.

SPH drum with SPH and equipment rinsate water was collected and picked up by IWM and transported to IWM facilities of San Jose, California.

Enclosed documentation from this event includes copies of the Well Gauging Sheet, and Well Monitoring Data Sheets.

Fourth Quarter Groundwater Monitoring at Chevron 91153, 3135 Gibbons Dr., Alameda, CA

SAN JOSE

SACRAMENTO

LOS ANGELES

SAN DIEGO

1680 ROGERS AVENUE

SAN JOSE, CA 95112-1105

(408) 573-0555

FAX (408) 573-7771

LIC. 746684

[www.blainetech.com](http://www.blainetech.com)

Blaine Tech Services, Inc.'s activities at this site consisted of objective data and sample collection only. No interpretation of analytical results, defining of hydrogeologic conditions or formulation of recommendations was performed.

Please call if you have any questions.

Sincerely,



Pete Cornish  
Blaine Tech Services, Inc.  
Project Manager

attachments: SOP  
Well Gauging Sheet  
Individual Well Monitoring Data Sheets

cc: CRA  
Attn: Charlotte Evans  
5900 Hollis St. Suite A  
Emeryville, CA 94608

Fourth Quarter Groundwater Monitoring at Chevron 91153, 3135 Gibbons Dr., Alameda, CA

SAN JOSE

SACRAMENTO

LOS ANGELES

SAN DIEGO

1680 ROGERS AVENUE

SAN JOSE, CA 95112-1105

(408) 573-0555

FAX (408) 573-7771

LIC. 746684

[www.blainetech.com](http://www.blainetech.com)

# BLAINE TECH SERVICES, INC. METHODS AND PROCEDURES FOR THE ROUTINE MONITORING OF GROUNDWATER WELLS AT CHEVRON SITES

Blaine Tech Services, Inc. performs environmental sampling and documentation as an independent third party. We specialize in groundwater monitoring assignments and intentionally limit the scope of our services to those centered on the generation of objective information.

To avoid conflicts of interest, Blaine Tech Services, Inc. personnel do not evaluate or interpret the information we collect. As a state licensed contractor (C-57 well drilling –water – 746684) performing strictly technical services, we do not make any professional recommendations and perform no consulting of any kind.

---

## SAMPLING PROCEDURES OVERVIEW

### SAFETY

All groundwater monitoring assignments performed for Chevron comply with Chevron's safety guidelines, 29 CFR 1910.120 and SB-198 Injury and Illness Prevention Program (IIPP). All Field Technicians receive the full 40-hour 29CFR 1910.120 OSHA SARA HAZWOPER course, medical clearance and on-the-job training prior to commencing any work on any Chevron site.

### INSPECTION AND GAUGING

Wells are inspected prior to evacuation and sampling. The condition of the wellhead is checked and noted according to a wellhead inspection checklist.

Standard measurements include the depth to water (DTW) and the total well depth (TD) obtained with industry standard electronic water level indicators that are graduated in increments of hundredths of a foot.

The water in each well is inspected for the presence of immiscibles. When free product is suspected, its presence is confirmed using an electronic interface probe (e.g. GeoTech). No samples are collected from a well containing over two-hundredths of a foot (0.02') of product.

### EVACUATION

Depth to water measurements are collected by our personnel prior to purging and minimum purge volumes are calculated anew for each well based on the height of the water column and the diameter of the well. Expected purge volumes are never less than three case volumes and are set at no less than four case volumes in some jurisdictions.

Well purging devices are selected on the basis of the well diameter and the total volume to be



evacuated. In most cases the well will be purged using an electric submersible pump (i.e. Grundfos) suspended near (but not touching) the bottom of the well.

## PARAMETER STABILIZATION

Well purging completion standards include minimum purge volumes, but additionally require stabilization of specific groundwater parameters prior to sample collection. Typical groundwater parameters used to measure stability are electrical conductivity, pH, and temperature. Instrument readings are obtained at regular intervals during the evacuation process (no less than once per case volume).

Stabilization standards for routine quarterly monitoring of fuel sites include the following: Temperature is considered to have stabilized when successive readings do not fluctuate more than +/- 1 degree Celsius. Electrical conductivity is considered stable when successive readings are within 10%. pH is considered to be stable when successive readings remain constant or vary no more than 0.2 of a pH unit.

## DEWATERED WELLS

Normal evacuation removes no less than three case volumes of water from the well. However, less water may be removed in cases where the well dewateres and does not immediately recharge.

## MEASURING RECHARGE

Upon completion of well purging, a depth to water measurement is collected and notated to ensure that the well has recharged to within 80% of its static, pre-purge level prior to sampling.

Wells that do not immediately show 80% recharge or dewatered wells will be allowed approximately 2 hours to recharge prior to sampling or will be sampled at site departure. All wells requiring off-site traffic control in the public right-of-way, the 80% recharge rule may be disregarded in the interests of Health and Safety. The sample may be collected as soon as there is sufficient water. The water level at time of sampling will be noted.

## PURGEWATER CONTAINMENT

All non-hazardous purgewater evacuated from each groundwater monitoring well is captured and contained in on-board storage tanks on the Sampling Vehicle and/or special water hauling trailers. Effluent from the decontamination of reusable apparatus (sounders, electric pumps and hoses etc.), consisting of groundwater combined with deionized water and non-phosphate soap, is also captured and pumped into effluent tanks.

Non-hazardous purgewater is transported under standard Bill of Lading documentation to a Blaine Tech Services, Inc. facility before being transported to a Chevron approved disposal facility.

## SAMPLE COLLECTION DEVICES

All samples are collected using disposable bailers.

## SAMPLE CONTAINERS

Sample material is decanted directly from the sampling bailer into sample containers provided by the laboratory that will analyze the samples. The transfer of sample material from the bailer to the sample container conforms to specifications contained in the USEPA T.E.G.D. The type of sample container, material of construction, method of closure and filling requirements are specific to the intended analysis. Chemicals needed to preserve the sample material are commonly placed inside the sample containers by the laboratory or glassware vendor prior to delivery of the bottle to our personnel. The laboratory sets the number of replicate containers.

## TRIP BLANKS

Trip Blanks, if requested, are taken to the site and kept inside the sample cooler for the duration of the event. They are turned over to the laboratory for analysis with the samples from that site.

## DUPLICATES

Duplicates, if requested, may be collected at a site. The Duplicate sample is collected, typically from the well containing the most measurable contaminants. The Duplicate sample is labeled the same as the original.

## SAMPLE STORAGE

All sample containers are promptly placed in food grade ice chests for storage in the field and transport (direct or via our facility) to the designated analytical laboratory. These ice chests contain quantities of restaurant grade ice as a refrigerant material. The samples are maintained in either an ice chest or a refrigerator until relinquished into the custody of the laboratory or laboratory courier.

## DOCUMENTATION CONVENTIONS

A label must be affixed to all sample containers. In most cases these labels are generated by our office personnel and are partially preprinted. Labels can also be hand written by our field personnel. The site is identified with the store number and site address, as is the particular groundwater well from which the sample is drawn (e.g. MW-1, MW-2, S-1 etc.). The time and date of sample collection along with the initials of the person who collects the sample are handwritten onto the label.

Chain of Custody records are created using client specific preprinted forms following USEPA specifications.

Bill of Lading records are contemporaneous records created in the field at the site where the non-hazardous purgewater is generated. Field Technicians use preprinted Bill of Lading forms.

## DECONTAMINATION

All equipment is brought to the site in clean and serviceable condition and is cleaned after use in each well and before subsequent use in any other well. Equipment is decontaminated before leaving the site.

The primary decontamination device is a commercial steam cleaner. The steam cleaner is de-tuned to function as a hot pressure washer that is then operated with high quality deionized water that is produced at our facility and stored onboard our sampling vehicle. Cleaning is facilitated by the use of proprietary fixtures and devices included in the patented workstation (U.S. Patent 5,535,775) that is incorporated in each sampling vehicle. The steam cleaner is used to decon reels, pumps and bailers.

Any sensitive equipment or parts (i.e. Dissolved Oxygen sensor membrane, water level indicator, etc.) that cannot be washed using the high pressure water, will be sprayed with a non-phosphate soap and deionized water solution and rinsed with deionized water.

## DISSOLVED OXYGEN READINGS

Dissolved Oxygen readings are taken pre- and/or post-purge using YSI meters (e.g. YSI Model 550) or HACH field test kits.

The YSI meters are able to collect accurate in-situ readings. The probe allows downhole measurements to be taken from wells with diameters as small as two inches. The probe and reel is decontaminated between wells as described above. The meter is calibrated between wells as per the instructions in the operating manual. The probe is lowered into the water column and the reading is allowed to stabilize prior to collection.

## OXYIDATON REDUCTION POTENTIAL READINGS

All readings are obtained with either Corning or Myron-L meters (e.g. Corning ORP-65 or a Myron-L Ultrameter GP). The meter is cleaned between wells as described above. The meter is calibrated at the start of each day according to the instruction manual.

## FERROUS IRON MEASUREMENTS

All field measurements are collected at time of sampling with a HACH test kit.

## WELL GAUGING DATA

Project # 091117-001 Date 11-17-09 Client Chewan

Site 3135 Gibson Dr. Alameda CA

Well ID	Time	Well Size (in.)	Sheen / Odor	Depth to Immiscible Liquid (ft.)	Thickness of Immiscible Liquid (ft.)	Volume of Immiscibles Removed (ml)	Depth to water (ft.)	Depth to well bottom (ft.)	Survey Point: TOB or TOC	Notes
C-1	0910	3	yes	4.18	0.03	42	4.21	—	↓	
<del>C-3</del>	—	—	Annual	gauge			—	—		
<del>MW-4</del>	—	—	Annual	gauge			—	—		
MW-5	0945	2					4.02	12.62		
MW-6	0940	2					4.00	13.28		
MW-7	0930	2					4.52	5.94		
MW-10	0900	2					4.12	9.00		

# WELLHEAD INSPECTION CHECKLIST

Page 1 of     

Client Chevron Date 11-17-09

Site Address 3135 Gibson Dr. Menlo Park CA

Job Number 091117-601 Technician JD

Well ID	Well Inspected - No Corrective Action Required	WELL IS SECURABLE BY DESIGN (12" or less)	WELL IS CLEARLY MARKED WITH THE WORDS "MONITORING WELL" (12" or less)	Water Bailed From Wellbox	Wellbox Components Cleaned	Cap Replaced	Lock Replaced	Other Action Taken (explain below)	Well Not Inspected (explain below)	Repair Order Submitted
C-1								X		
MW-5		yx	yx					X		
MW-6	X									
MW-7	✓									
MW-10								X		

NOTES: C-1, Check Box, MW-5 212 Bolts missing, MW-10  
Pull up lid,

## CHEVRON WELL MONITORING DATA SHEET

Project #: 091117-501	Station #: 9-1153
Sampler: 50	Date: 11-17-09
Weather: cloudy sunny	Ambient Air Temperature: 65°F
Well I.D.: C-1	Well Diameter: 2 (3) 4 6 8
Total Well Depth:	Depth to Water: 4.21
Depth to Free Product: 4.18	Thickness of Free Product (feet): 0.03
Referenced to: <u>PVC</u> Grade	D.O. Meter (if req'd): YSI HACH
DTW with 80% Recharge [(Height of Water Column x 0.20) + DTW]: <u>                    </u>	

Purge Method:

- Bailer
- Disposable Bailer
- Positive Air Displacement
- Electric Submersible
- Waterra
- Peristaltic
- Extraction Pump
- Other \_\_\_\_\_

Sampling Method:

- Bailer
- Disposable Bailer
- Extraction Port
- Dedicated Tubing
- Other: \_\_\_\_\_

<u>                    </u> (Gals.) X	<u>                    </u> =	<u>                    </u> Gals.
1 Case Volume	Specified Volumes	Calculated Volume

Well Diameter	Multiplier	Well Diameter	Multiplier
1"	0.04	4"	0.65
2"	0.16	6"	1.47
3"	0.37	Other	radius <sup>2</sup> * 0.163

Time	Temp (°F)	pH	Cond. (mS or µS)	Turbidity (NTUs)	Gals. Removed	Observations
	0.37 X	0.03 X	3785	2	42ml	spit removed + 1 gallon H <sub>2</sub> O

Did well dewater?    Yes                      No                      Gallons actually evacuated:                     

Sampling Date:                      Sampling Time:                      Depth to Water:

Sample I.D.:                      Laboratory:                      Lancaster    Other \_\_\_\_\_

Analyzed for:    TPH-G    BTEX    MTBE    OXYS    Other:

Duplicate I.D.:                      Analyzed for:    TPH-G    BTEX    MTBE    OXYS    Other:

D.O. (if req'd):	Pre-purge:	mg/L	Post-purge:	mg/L
O.R.P. (if req'd):	Pre-purge:	mV	Post-purge:	mV