



RECEIVED

9:05 am, Apr 23, 2010

Alameda County
Environmental Health

Aaron Costa
Project Manager
Marketing Business Unit

**Chevron Environmental
Management Company**
6111 Bollinger Canyon Road
San Ramon, CA 94583
Tel (925) 543-2961
Fax (925) 543-2324
acosta@chevron.com

Alameda County Health Care Services
1131 Harbor Bay Parkway, Suite 250
Alameda, CA 94502-6577

Re: Chevron Service Station No. 9-1153
3135 Gibbons Drive (3126 Fernside Blvd.)
Alameda, California

I have reviewed the attached report dated April 22, 2010.

I agree with the conclusions and recommendations presented in the referenced report. The information in this report is accurate to the best of my knowledge and all local Agency/Regional Board guidelines have been followed. This report was prepared by Conestoga Rovers Associates, upon who assistance and advice I have relied.

This letter is submitted pursuant to the requirements of California Water Code Section 13267(b)(1) and the regulating implementation entitled Appendix A pertaining thereto.

I declare under penalty of perjury that the foregoing is true and correct to the best of my knowledge.

Sincerely,

Aaron Costa
Project Manager

Attachment: Report



**CONESTOGA-ROVERS
& ASSOCIATES**

5900 Hollis Street, Suite A
Emeryville, California 94608
Telephone: (510) 420-0700 Fax: (510) 420-9170
<http://www.craworld.com>

April 22, 2010

Reference No. 311642

Mr. Mark Detterman
Alameda County Environmental Health Services
1131 Harbor Bay Parkway, Suite 250
Alameda, California 94502-6577

Re: Third Quarter 2009 Groundwater Monitoring and Sampling Report
Former Chevron Service Station 9-1153
3135 Gibbons Drive (3126 Fernside Blvd.)
Alameda, California
Fuel Leak Case No. RO0000341

Dear Mr. Mark Detterman:

Conestoga-Rovers & Associates is submitting this *Third Quarter 2009 Groundwater Monitoring and Sampling Report* for the site referenced above (Figure 1) on behalf of Chevron Environmental Management Company (Chevron).

Groundwater monitoring and sampling was performed by Blaine Tech Services (Blaine Tech) of San Jose, California. Groundwater potentiometric and concentration data for this event are presented on Figure 2. Cumulative groundwater monitoring and sampling data are presented in Tables 1 through 3. Blaine Tech's August 19, 2009 *Third Quarter Monitoring* report is presented as Attachment A. Groundwater samples were analyzed by Lancaster Laboratories and the analytical report is included as Attachment B.

Equal
Employment Opportunity
Employer



**CONESTOGA-ROVERS
& ASSOCIATES**

April 22, 2010

Reference No. 311642

- 2 -

Please contact Brandon Wilken at (510) 420-3355 if you have any questions or require additional information.

Sincerely,

CONESTOGA-ROVERS & ASSOCIATES

Ian Hull



Brandon S. Wilken, P.G. #7564

IH/doh/3
Encl.

Figure 1	Vicinity Map
Figure 2	Groundwater Elevation and Hydrocarbon Concentrations Map
Table 1	Groundwater Monitoring Data and Analytical Results
Table 2	Light Non-Aqueous Phase Liquid Thickness and Removal Data
Table 3	Dissolved Oxygen Concentrations
Attachment A	Blaine Tech's August 19, 2009 <i>Third Quarter Monitoring</i> report
Attachment B	Lancaster Laboratories' August 31, 2009 analytical report

cc: Mr. Aaron Costa, Chevron Environmental Management Company
Mr. Mark Hom, Property Owner

FIGURES

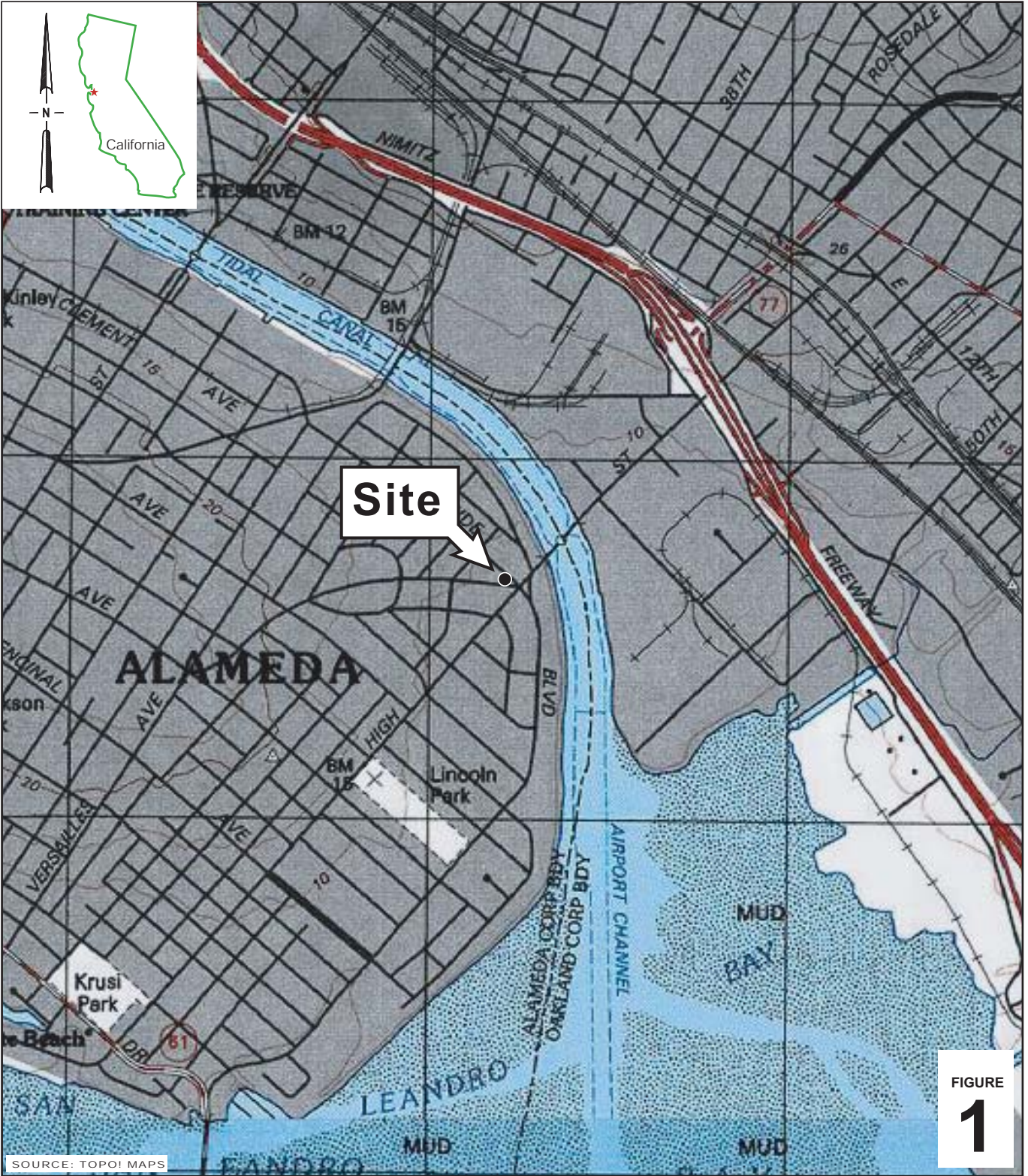

FIGURE
1

L:\CHEV\311642\311642-FIGURES\311642_EM001_VICINITY-MAP.A1

SOURCE: TOPOI MAPS

0 1/8 1/4 1/2 1
SCALE : 1" = 1/4 MILE

Former Chevron Station 9-1153
3135 Gibbons Drive (3126 Fernside Blvd)
Alameda, California



**CONESTOGA-ROVERS
& ASSOCIATES**

Vicinity Map

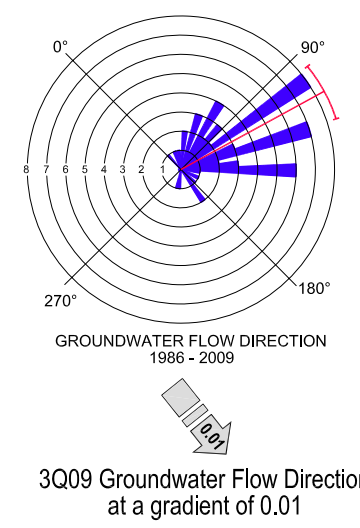
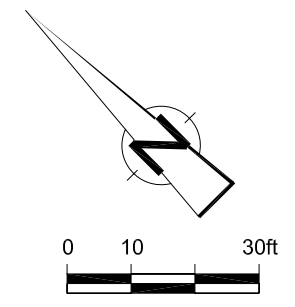

EXPLANATION

- MW-1 ● Monitoring well location
- RW-1 ⦿ Extraction well location
- C-2 ⊗ Destroyed well location
- ID Well Designation
- GW Groundwater elevation (ft. - msl)
- TPHD } Hydrocarbon concentrations in groundwater, in micrograms per liter (µg/L)
- TPHG }
- BENZ }
- 4.00 — Groundwater elevation contour line dashed where inferred
- MA Monitored Annually
- SA Sampled Annually
- LNAPL Light non-aqueous phase liquid
- ** GWE has been corrected due to presence of LNAPL

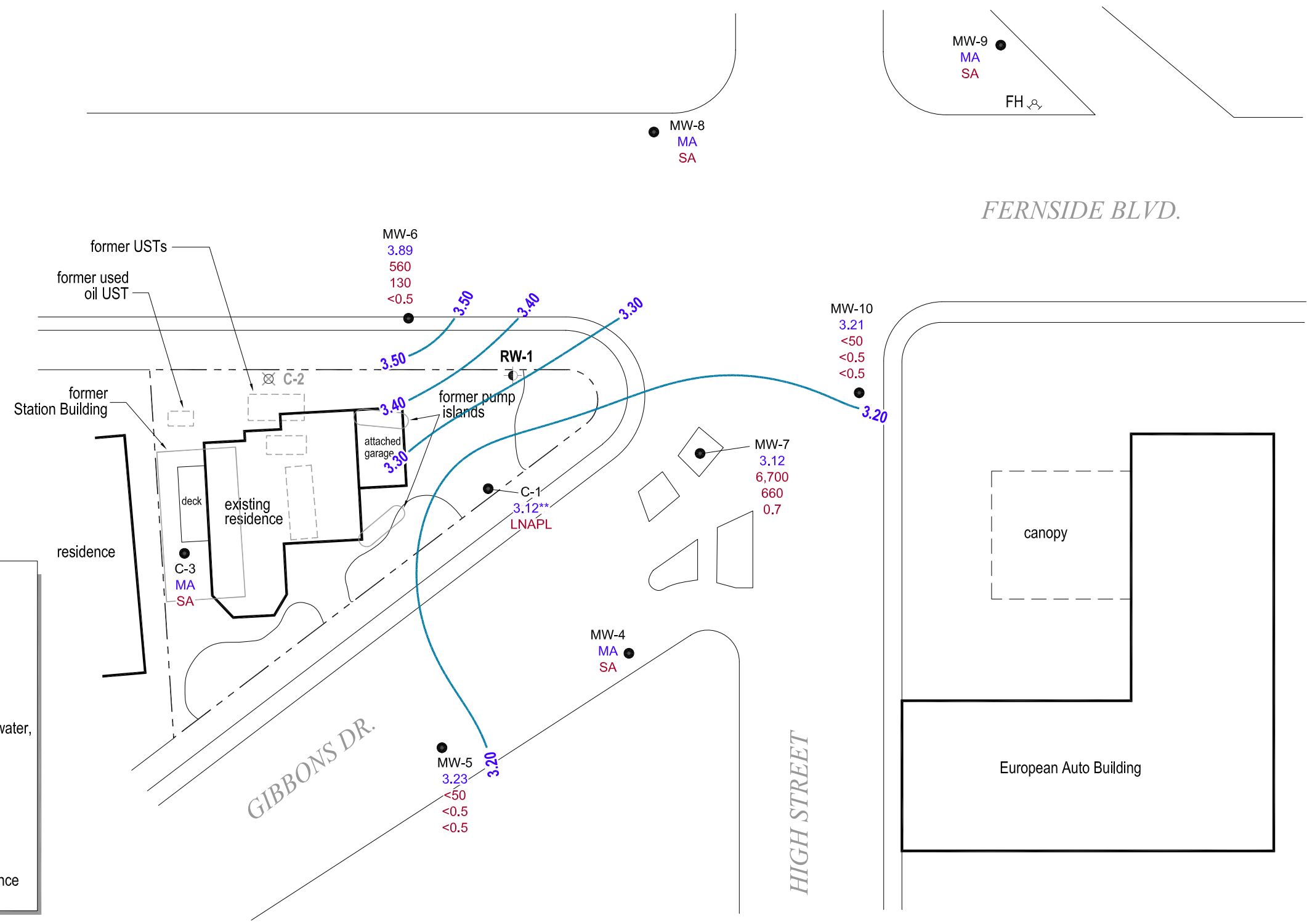

Figure 2
 GROUNDWATER ELEVATION AND HYDROCARBON CONCENTRATIONS MAP
 FORMER CHEVRON SERVICE STATION 9-1153
 3135 GIBBONS DRIVE (3126 FERNSIDE BLVD)
 Alameda, California
 August 18, 2009



TABLES

**GROUNDWATER MONITORING DATA AND ANALYTICAL RESULTS
FORMER CHEVRON SERVICE STATION 9-1153
3135 GIBBONS DRIVE (3126 FERNSIDE BOULEVARD), ALAMEDA, CALIFORNIA**

WELL ID/ DATE	TOC* (ft-msl)	DTW (ft.)	GWE (ft-msl)	LNAPLT (ft.)	TPHg (µg/L)	B (µg/L)	T (µg/L)	E (µg/L)	X (µg/L)	MTBE (µg/L)
C-1										
08/18/86	--	4.10	--	--	--	--	--	--	--	--
09/04/86	--	--	--	--	15,000	760	820	1,500	--	--
07/22/87	--	--	--	--	1,100	250	7.0	40	--	--
05/03/89	--	4.46	--	--	6,900	3,800	190	229	--	--
12/04/89	--	4.16	--	--	17,000	8,000	490	470	--	--
02/14/90	--	3.64	--	--	19,000	12,000	990	1,050	--	--
03/07/90	--	3.36	--	--	--	4,260	261	430	--	--
09/06/91	--	4.43	--	--	21,000	10,000	100	240	560	--
12/15/91	--	4.78	--	--	20,000	4,900	43	110	330	--
03/03/92	--	2.39	--	--	13,000	5,800	730	340	1,200	--
06/04/92	4.08	4.08	0.00	--	34,000	9,400	350	290	1,200	--
10/13/92	4.08	4.75	-0.67	--	24,000	11,000	98	280	530	--
01/11/93	4.08	2.26	1.82	Sheen	7,100	1,500	130	150	700	--
04/14/93	4.08	2.90	1.18	Sheen	29,000	7,300	4,000	640	2,300	--
07/13/93	4.08	3.97	0.11	Sheen	650,000	27,000	18,000	6,300	29,000	--
10/19/93	4.08	4.50	-0.42	--	40,000	12,000	730	1,100	3,600	--
11/30/93	7.50	4.27	3.23	--	--	--	--	--	--	--
01/27/94	7.50	3.35	4.15	--	36,000	8,600	220	670	1,900	--
04/07/94	7.50	3.42	4.08	--	53,000	12,000	3,500	480	3,300	--
07/01/94	7.50	3.96	3.54	--	65,000	19,000	5,900	1,000	9,000	--
10/05/94	7.50	4.39	3.11	--	160,000	23,000	12,000	2,200	11,000	--
01/12/95	7.50	1.52	6.38	0.50	--	--	--	--	--	--
04/26/95	7.50	4.40	4.86	2.20	--	--	--	--	--	--
07/12/95	7.50	4.85	4.10	1.81	--	--	--	--	--	--
10/30/95	7.50	5.67	3.13	1.63	--	--	--	--	--	--
01/04/96	7.50	3.92	3.68	0.12	--	--	--	--	--	--
01/10/96	7.50	3.48	4.12	0.13	--	--	--	--	--	--
01/17/96	7.50	3.40	4.12	0.02	--	--	--	--	--	--
01/22/96	7.50	2.90	4.60	0.00	82,000	18,000	4,400	1,400	5,200	<1,000
02/23/96	7.50	4.10	4.89	1.86	--	--	--	--	--	--
02/28/96	7.50	--	--	>0.83	--	--	--	--	--	--
03/08/96	7.50	2.86	6.10	1.83	--	--	--	--	--	--
03/08/96	7.50	2.30	5.49	0.36	--	--	--	--	--	--
03/08/96	7.50	2.33	5.46	0.36	--	--	--	--	--	--
03/08/96	7.50	2.28	5.40	0.22	--	--	--	--	--	--
03/26/96	7.50	3.96	4.56	1.28	--	--	--	--	--	--

**GROUNDWATER MONITORING DATA AND ANALYTICAL RESULTS
FORMER CHEVRON SERVICE STATION 9-1153
3135 GIBBONS DRIVE (3126 FERNSIDE BOULEVARD), ALAMEDA, CALIFORNIA**

WELL ID/ DATE	TOC* (ft-msl)	DTW (ft.)	GWE (ft-msl)	LNAPLT (ft.)	TPHg (µg/L)	B (µg/L)	T (µg/L)	E (µg/L)	X (µg/L)	MTBE (µg/L)
C-1 (cont)										
04/11/96	7.50	5.61	3.29	1.75	--	--	--	--	--	--
04/19/96	7.50	3.09	4.44	0.04	--	--	--	--	--	--
04/24/96	7.50	3.04	4.48	0.03	--	--	--	--	--	--
05/03/96	7.50	4.02	3.85	0.46	--	--	--	--	--	--
05/03/96	7.50	3.89	3.99	0.47	--	--	--	--	--	--
05/08/96	7.50	4.25	3.53	0.35	--	--	--	--	--	--
05/17/96	7.50	3.24	4.29	0.04	--	--	--	--	--	--
05/17/96	7.50	3.35	4.16	0.01	--	--	--	--	--	--
05/17/96	7.50	3.43	4.08	0.01	--	--	--	--	--	--
05/17/96	7.50	3.65	3.86	0.01	--	--	--	--	--	--
05/22/96	7.50	3.10	4.46	0.07	--	--	--	--	--	--
06/18/96	7.50	4.68	3.20	0.48	--	--	--	--	--	--
07/03/96	7.50	5.03	2.57	0.13	--	--	--	--	--	--
07/09/96	7.50	4.63	3.05	0.23	--	--	--	--	--	--
07/17/96	7.50	4.73	2.89	0.15	--	--	--	--	--	--
07/29/96	7.50	5.10	2.47	0.09	--	--	--	--	--	--
08/02/96	7.50	5.68	1.84	0.03	--	--	--	--	--	--
08/07/96	7.50	5.16	2.35	0.01	--	--	--	--	--	--
08/23/96	7.50	5.75	1.77	0.03	--	--	--	--	--	--
08/28/96	7.50	5.53	1.99	0.03	--	--	--	--	--	--
09/06/96	7.50	5.38	2.12	--	--	--	--	--	--	--
09/12/96	7.50	5.48	2.04	0.03	--	--	--	--	--	--
09/19/96	7.50	6.32	1.20	0.03	--	--	--	--	--	--
10/10/96	7.50	4.58	3.00	0.10	--	--	--	--	--	--
10/17/96	7.50	5.61	1.90	0.01	--	--	--	--	--	--
10/29/96	7.50	6.01	1.49	--	--	--	--	--	--	--
11/07/96	7.50	5.56	1.94	0.04	--	--	--	--	--	--
11/11/96	7.50	5.32	2.18	0.04	--	--	--	--	--	--
12/20/96	7.50	3.33	4.17	0.03	--	--	--	--	--	--
12/17/96	7.50	3.73	3.77	0.01	--	--	--	--	--	--
01/15/97	7.50	2.74	4.76	--	47,000	16,000	2,800	1,300	4,900	<1,000
01/22/97	7.50	1.37	6.13	0.19	--	--	--	--	--	--
02/04/97	7.50	2.98	4.52	0.51	--	--	--	--	--	--
02/20/97	7.50	4.09	3.41	0.13	--	--	--	--	--	--
03/06/97	7.50	3.75	3.75	0.56	--	--	--	--	--	--
03/14/97	7.50	3.82	3.68	0.03	--	--	--	--	--	--

**GROUNDWATER MONITORING DATA AND ANALYTICAL RESULTS
FORMER CHEVRON SERVICE STATION 9-1153
3135 GIBBONS DRIVE (3126 FERNSIDE BOULEVARD), ALAMEDA, CALIFORNIA**

WELL ID/ DATE	TOC* (ft-msl)	DTW (ft.)	GWE (ft-msl)	LNAPLT (ft.)	TPHg (µg/L)	B (µg/L)	T (µg/L)	E (µg/L)	X (µg/L)	MTBE (µg/L)
C-1 (cont)										
03/20/97	7.50	3.73	3.77	0.03	--	--	--	--	--	--
03/25/97	7.50	4.32	3.18	0.01	--	--	--	--	--	--
03/31/97	7.50	3.71	3.79	0.03	--	--	--	--	--	--
04/03/97	7.50	4.60	2.92	0.03	--	--	--	--	--	--
04/09/97	7.50	4.25	3.27	0.02	--	--	--	--	--	--
04/24/97	7.50	4.65	2.87	0.02	--	--	--	--	--	--
04/30/97	7.50	3.50	4.02	0.02	--	--	--	--	--	--
05/22/97	7.50	4.97	2.53	--	--	--	--	--	--	--
06/03/97	7.50	3.62	3.93	0.06	--	--	--	--	--	--
07/09/97	7.50	4.30	3.25	0.06	--	--	--	--	--	--
08/12/97	7.50	5.18	2.32	0.00	--	--	--	--	--	--
09/30/97	7.50	5.25	2.65	0.50	--	--	--	--	--	--
10/29/97	7.50	5.33	2.19	0.03	--	--	--	--	--	--
11/13/97	7.50	4.86	2.66	0.02	--	--	--	--	--	--
12/18/97	7.50	2.34	5.16	--	--	--	--	--	--	--
01/14/98	7.50	0.25	7.27	0.02	--	--	--	--	--	--
02/02/98	7.50	2.35	5.19	0.05	--	--	--	--	--	--
03/16/98	7.50	2.50	5.40	0.50	--	--	--	--	--	--
04/17/98	7.50	2.65	5.17	0.40	--	--	--	--	--	--
05/01/98	7.50	2.39	5.14	0.04	--	--	--	--	--	--
06/17/98	7.50	3.26	4.30	0.08	--	--	--	--	--	--
07/15/98	7.50	3.55	3.95	--	110,000	22,000	22,000	1,000	10,000	<250
09/01/98	7.50	4.00	3.50	--	--	--	--	--	--	--
10/27/98	7.50	4.48	3.02	--	45,000	12,000	5,400	590	4,300	<500
11/19/98	7.50	3.89	3.61	--	--	--	--	--	--	--
12/19/98	7.50	2.13	5.39	0.02	--	--	--	--	--	--
01/20/99	7.50	3.98	3.52	--	50,300	7,050	5,030	244	6,090	<40
02/24/99	7.50	2.55	4.95	--	--	--	--	--	--	--
03/26/99	7.50	2.14	5.97	0.76	--	--	--	--	--	--
04/19/99	7.50	1.04	6.46	--	150,000	21,000	20,000	3,000	18,000	<2.5/49 ²
07/29/99	7.50	3.76	3.76	0.02	--	--	--	--	--	--
08/30/99	7.50	4.30	3.20	--	--	--	--	--	--	--
09/23/99	7.50	3.84	3.68	0.02	--	--	--	--	--	--
10/13/99	7.50	1.27	6.23	--	136,000	23,900	30,000	2,390	17,300	<500
11/17/99	7.50	3.59	3.91	--	--	--	--	--	--	--
12/08/99	7.50	3.79	3.71	--	--	--	--	--	--	--

GROUNDWATER MONITORING DATA AND ANALYTICAL RESULTS
FORMER CHEVRON SERVICE STATION 9-1153
3135 GIBBONS DRIVE (3126 FERNSIDE BOULEVARD), ALAMEDA, CALIFORNIA

WELL ID/ DATE	TOC* (ft-msl)	DTW (ft.)	GWE (ft-msl)	LNAPLT (ft.)	TPHg (µg/L)	B (µg/L)	T (µg/L)	E (µg/L)	X (µg/L)	MTBE (µg/L)
C-1 (cont)										
01/25/00	7.50	1.99	5.54	0.04	--	--	--	--	--	--
04/03/00	7.50	2.20	5.38**	0.10	--	--	--	--	--	--
05/26/00	7.50	2.52	5.16**	0.23	--	--	--	--	--	--
06/19/00	7.50	2.89	4.76**	0.19	--	--	--	--	--	--
07/03/00	7.50	3.45	4.25**	0.25	--	--	--	--	--	--
08/01/00	7.50	3.78	3.85**	0.16	--	--	--	--	--	--
09/30/00	7.50	4.03	3.50**	0.04	--	--	--	--	--	--
10/23/00	7.50	4.15	3.37**	0.03	--	--	--	--	--	--
11/21/00	7.50	3.42	4.08	0.00	--	--	--	--	--	--
12/22/00	7.50	2.96	4.54	0.00	--	--	--	--	--	--
01/08/01	7.50	2.94	4.56	0.00	--	--	--	--	--	--
02/17/01	7.50	2.09	5.88**	0.59	--	--	--	--	--	--
03/13/01	7.50	2.20	5.91**	0.76	--	--	--	--	--	--
04/09/01	7.50	2.45	5.26**	0.26	NOT SAMPLED DUE TO THE PRESENCE OF LNAPL				--	--
05/18/01	7.50	2.70	5.27**	0.59	--	--	--	--	--	--
06/12/01	7.50	3.50	4.78**	0.97	--	--	--	--	--	--
07/19/01	7.50	4.25	4.01**	0.95	--	--	--	--	--	--
08/23/01	7.50	4.34	3.22**	0.07	NOT SAMPLED DUE TO THE PRESENCE OF LNAP				--	--
09/17/01	7.50	4.39	3.17**	0.08	--	--	--	--	--	--
10/08/01	7.50	4.45	3.08**	0.04	--	--	--	--	--	--
11/27/01	7.50	3.89	3.61	0.00	330,000	9,800	5,300	3,800	22,000	<50
12/17/01	7.50	1.81	5.69	0.00	--	--	--	--	--	--
01/07/02	7.50	2.27	5.64**	0.51	--	--	--	--	--	--
02/26/02	7.50	2.70	5.22**	0.52	NOT SAMPLED DUE TO THE PRESENCE OF LNAP				--	--
03/27/02	7.50	2.87	5.47**	1.05	--	--	--	--	--	--
04/08/02	7.50	2.45	6.03**	1.23	--	--	--	--	--	--
05/23/02	7.50	3.57	4.35**	0.52	NOT SAMPLED DUE TO THE PRESENCE OF LNAP				--	--
06/17/02	7.50	3.90	3.88**	0.35	--	--	--	--	--	--
07/31/02	7.50	4.12	3.54**	0.20	--	--	--	--	--	--
08/09/02	7.50	4.15	3.48**	0.16	NOT SAMPLED DUE TO THE PRESENCE OF LNAP				--	--
09/17/02	7.50	4.33	3.27**	0.12	--	--	--	--	--	--
10/15/02	7.50	4.51	3.11**	0.15	--	--	--	--	--	--
11/08/02	7.50	4.11	3.39	0.00	51,000	7,000	510	820	5,800	<3.0
12/19/02	7.50	1.14	6.36	0.00	--	--	--	--	--	--
01/14/03	7.50	1.80	5.70	0.00	--	--	--	--	--	--
02/07/03	7.50	2.95	4.79**	0.30	NOT SAMPLED DUE TO THE PRESENCE OF LNAP				--	--

GROUNDWATER MONITORING DATA AND ANALYTICAL RESULTS
FORMER CHEVRON SERVICE STATION 9-1153
3135 GIBBONS DRIVE (3126 FERNSIDE BOULEVARD), ALAMEDA, CALIFORNIA

WELL ID/ DATE	TOC* (ft-msl)	DTW (ft.)	GWE (ft-msl)	LNAPLT (ft.)	TPHg (µg/L)	B (µg/L)	T (µg/L)	E (µg/L)	X (µg/L)	MTBE (µg/L)
C-1 (cont)										
03/20/03	7.50	2.86	4.97**	0.41	--	--	--	--	--	--
04/15/03	7.50	2.12	5.46**	0.10	--	--	--	--	--	--
05/09/03	7.50	2.95	5.11**	0.70	NOT SAMPLED DUE TO THE PRESENCE OF LNAP			--	--	--
06/27/03	7.50	3.97	3.93**	0.50	--	--	--	--	--	--
07/16/03	7.50	3.68	4.04**	0.28	--	--	--	--	--	--
08/15/03	7.50	4.29	3.39**	0.22	NOT SAMPLED DUE TO THE PRESENCE OF LNAP			--	--	--
09/26/03	7.50	4.60	3.05**	0.19	--	--	--	--	--	--
10/18/03	7.50	4.72	2.90**	0.15	--	--	--	--	--	--
11/14/03	7.50	4.31	3.35**	0.20	NOT SAMPLED DUE TO THE PRESENCE OF LNAP			--	--	--
12/23/03	7.50	1.81	5.69	0.00	--	--	--	--	--	--
01/22/04	7.50	4.19	3.32**	0.01	--	--	--	--	--	--
02/13/04	7.50	3.04	4.49**	0.04	NOT SAMPLED DUE TO THE PRESENCE OF LNAPL			--	--	--
03/11/04	7.50	1.85	5.97**	0.40	--	--	--	--	--	--
04/22/04	7.50	3.08	4.60**	0.22	--	--	--	--	--	--
05/14/04	7.50	3.49	4.03**	0.03	NOT SAMPLED DUE TO THE PRESENCE OF LNAPL			--	--	--
06/18/04	7.50	3.41	4.19**	0.13	--	--	--	--	--	--
07/23/04	7.50	3.28	4.31**	0.11	--	--	--	--	--	--
08/13/04	7.50	3.14	4.40**	0.05	NOT SAMPLED DUE TO THE PRESENCE OF LNAPL			--	--	--
09/13/04	7.50	4.53	3.04**	0.09	--	--	--	--	--	--
10/22/04	7.50	3.19	4.33**	0.03	--	--	--	--	--	--
11/12/04	7.50	3.22	4.30**	0.03	NOT SAMPLED DUE TO THE PRESENCE OF LNAPL			--	--	--
12/02/04	7.50	3.28	4.24**	0.02	--	--	--	--	--	--
01/28/05	7.50	3.19	4.32**	0.01	--	--	--	--	--	--
02/11/05	7.50	2.75	4.78**	0.04	NOT SAMPLED DUE TO THE PRESENCE OF LNAPL			--	--	--
03/11/05	7.50	2.94	4.58**	0.03	--	--	--	--	--	--
04/26/05	7.50	3.03	4.49**	0.02	--	--	--	--	--	--
05/13/05	7.50	3.18	4.34**	0.02	NOT SAMPLED DUE TO THE PRESENCE OF LNAPL			--	--	--
06/01/05	7.50	3.22	4.30**	0.02	--	--	--	--	--	--
07/15/05	7.50	3.09	4.43**	0.02	--	--	--	--	--	--
08/19/05	7.50	2.88	4.64**	0.03	NOT SAMPLED DUE TO THE PRESENCE OF LNAPL			--	--	--
09/23/05	7.50	2.95	4.57**	0.02	--	--	--	--	--	--
10/14/05	7.50	3.01	4.50**	0.01	--	--	--	--	--	--
11/18/05	7.50	3.21	4.31**	0.02	NOT SAMPLED DUE TO THE PRESENCE OF LNAPL			--	--	--
12/09/05	7.50	3.61	3.90**	0.01	--	--	--	--	--	--
01/12/06	7.50	2.98	4.53**	0.01	--	--	--	--	--	--
02/10/06 ¹⁵	7.50	2.69	4.82**	0.01	100,000	11,000	2,500	2,900	15,000	<10

GROUNDWATER MONITORING DATA AND ANALYTICAL RESULTS
FORMER CHEVRON SERVICE STATION 9-1153
3135 GIBBONS DRIVE (3126 FERNSIDE BOULEVARD), ALAMEDA, CALIFORNIA

WELL ID/ DATE	TOC* (ft-msl)	DTW (ft.)	GWE (ft-msl)	LNAPLT (ft.)	TPHg (µg/L)	B (µg/L)	T (µg/L)	E (µg/L)	X (µg/L)	MTBE (µg/L)	
C-1 (cont)											
03/13/06	7.50	2.81	4.70**	0.01	--	--	--	--	--	--	
04/13/06	7.50	2.75	4.76**	0.01	--	--	--	--	--	--	
05/12/06	7.50	3.02	4.49**	0.01	NOT SAMPLED DUE TO THE PRESENCE OF LNAPL					--	--
06/12/06	7.50	3.10	4.41**	0.01	--	--	--	--	--	--	
07/13/06	7.50	3.14	4.38**	0.02	--	--	--	--	--	--	
08/11/06 ¹⁵	7.50	3.70	3.81**	0.01	200,000	8,600	470	1,700	8,800	<10	
09/11/06	7.50	3.75	3.77**	0.02	--	--	--	--	--	--	
10/17/06	7.50	3.82	3.69**	0.01	--	--	--	--	--	--	
11/17/06	7.50	3.11	4.41**	0.03	NOT SAMPLED DUE TO THE PRESENCE OF LNAPL					--	--
12/15/06	7.50	2.95	4.57**	0.02	--	--	--	--	--	--	
01/16/07	7.50	2.98	4.54**	0.02	--	--	--	--	--	--	
02/16/07 ¹⁵	7.50	2.77	4.73	0.00	25,000	4,300	260	310	3,300	<5	
03/16/07	7.50	3.07	4.44**	0.01	--	--	--	--	--	--	
04/17/07	7.50	2.98	4.53**	0.01	--	--	--	--	--	--	
05/17/07 ¹⁵	7.50	3.05	4.46**	0.01	110,000 ¹⁶	12,000 ¹⁶	1,000 ¹⁶	2,000 ¹⁶	15,000 ¹⁶	<5	
06/15/07	7.50	3.08	4.43**	0.01	--	--	--	--	--	--	
07/17/07	7.50	3.13	4.38**	0.01	--	--	--	--	--	--	
08/09/07	7.50	3.24	4.28**	0.02	NOT SAMPLED DUE TO THE PRESENCE OF LNAPL					--	--
09/14/07	7.50	3.16	4.35**	0.01	--	--	--	--	--	--	
10/16/07	7.50	3.04	4.47**	0.01	--	--	--	--	--	--	
11/08/07 ¹⁵	7.50	3.11	4.40**	0.01	150,000	13,000	570	1,800	10,000	<13	
12/07/07	7.50	2.98	4.54**	0.03	--	--	--	--	--	--	
01/16/08	7.50	2.95	4.57**	0.02	--	--	--	--	--	--	
02/06/08 ¹⁵	7.50	2.61	4.90**	0.01	110,000	13,000	500	5,300	21,000	<10	
03/07/08	7.50	2.87	4.65**	0.02	--	--	--	--	--	--	
04/16/08	7.50	3.06	4.46**	0.02	--	--	--	--	--	--	
05/07/08	7.50	2.98	4.54**	0.03	NOT SAMPLED DUE TO THE PRESENCE OF LNAPL					--	--
06/06/08	7.50	3.02	4.50**	0.02	--	--	--	--	--	--	
07/16/08	7.50	3.12	4.40**	0.02	--	--	--	--	--	--	
09/05/08	7.50	3.97	3.75**	0.28	--	--	--	--	--	--	
09/11/08	7.50	4.22	3.61**	0.41	NOT SAMPLED DUE TO THE PRESENCE OF LNAPL					--	--
10/17/08	7.50	4.16	3.60**	0.33	--	--	--	--	--	--	
11/10/08	7.50	4.05	3.54**	0.11	NOT SAMPLED DUE TO THE PRESENCE OF LNAPL					--	--
12/15/08	7.50	3.85	3.69**	0.05	--	--	--	--	--	--	
01/21/09	7.50	3.91	3.62**	0.04	--	--	--	--	--	--	
02/09/09 ¹⁵	7.50	3.72	3.79**	0.01	53,000	3,100	66	660	3,700	<1	

GROUNDWATER MONITORING DATA AND ANALYTICAL RESULTS
FORMER CHEVRON SERVICE STATION 9-1153
3135 GIBBONS DRIVE (3126 FERNSIDE BOULEVARD), ALAMEDA, CALIFORNIA

WELL ID/ DATE	TOC* (ft-msl)	DTW (ft.)	GWE (ft-msl)	LNAPLT (ft.)	TPHg (µg/L)	B (µg/L)	T (µg/L)	E (µg/L)	X (µg/L)	MTBE (µg/L)
C-1 (cont)										
03/16/09	7.50	3.81	3.71**	0.03	--	--	--	--	--	--
05/28/09	7.50	3.48	4.02**	0.00	NOT SAMPLED DUE TO THE PRESENCE OF LNAPL				--	--
08/18/09	7.50	4.40	3.12**	0.02	NOT SAMPLED DUE TO THE PRESENCE OF LNAPL				--	--
C-3										
08/18/86	--	4.00	--	--	--	--	--	--	--	--
09/04/86	--	--	--	--	50	3.2	5.4	5.8	--	--
07/22/87	--	--	--	--	<50	<0.5	<1.0	<4.0	--	--
05/03/89	--	4.15	--	--	<50	<0.5	<1.0	<2.0	--	--
12/04/89	--	4.24	--	--	<250	<0.5	<0.5	<0.5	--	--
02/14/90	--	3.57	--	--	<50	<0.5	<0.5	<0.5	--	--
03/07/90	--	3.31	--	--	--	<5.0	<5.0	<5.0	--	--
09/06/91	--	4.59	--	--	<50	<0.5	<0.5	<0.5	<0.5	--
12/15/91	--	4.84	--	--	<50	<0.5	<0.5	<0.5	<0.5	--
03/03/92	--	2.17	--	--	<50	<0.5	<0.5	<0.5	<0.5	--
06/04/92	4.41	4.01	0.40	--	<50	<0.5	<0.5	<0.5	<0.5	--
10/13/92	4.41	4.79	-0.38	--	<50	<0.5	<0.5	<0.5	<0.5	--
01/11/93	4.41	2.01	2.40	--	<50	<0.5	<0.5	<0.5	<0.5	--
04/14/93	4.41	2.76	1.65	--	<50	<0.5	<0.5	<0.5	<0.5	--
07/13/93	4.41	3.96	0.45	--	<50	<0.5	<0.5	<0.5	<1.5	--
10/19/93	4.41	4.53	-0.12	--	66	12	1.4	1.0	8.4	--
11/30/93	7.83	4.04	3.79	--	--	--	--	--	--	--
01/27/94	7.83	3.17	4.66	--	<50	<0.5	<0.5	<0.5	<0.5	--
04/07/94	7.83	3.20	4.63	--	<50	<0.5	<0.5	<0.5	<0.5	--
07/01/94	7.83	3.99	3.84	--	<50	<0.5	<0.5	<0.5	<0.5	--
10/05/94	7.83	4.54	3.29	--	<50	<0.5	<0.5	<0.5	<0.5	--
01/12/95	7.83	0.80	7.03	--	<50	<0.5	<0.5	<0.5	<0.5	--
05/02/95	7.83	2.15	5.68	--	<50	<0.5	<0.5	<0.5	<0.5	--
07/12/95	7.83	3.42	4.41	--	<50	<0.5	<0.5	<0.5	<0.5	--
10/30/95	7.83	4.46	3.37	--	<50	<0.5	<0.5	<0.5	<0.5	<2.5
01/22/96	7.83	1.73	6.10	--	<50	<0.5	<0.5	<0.5	<0.5	<2.5
04/24/96	7.83	2.62	5.21	--	<50	<0.5	<0.5	<0.5	<0.5	<2.5
07/29/96	7.83	3.94	3.89	--	<50	<0.5	<0.5	<0.5	<0.5	<2.5
10/10/96	7.83	4.06	3.77	--	<50	<0.5	<0.5	<0.5	<0.5	<2.5
01/15/97	7.83	1.54	6.29	--	<50	<0.5	<0.5	<0.5	<0.5	<2.5
04/03/97	7.83	3.23	4.60	--	<50	<0.5	<0.5	<0.5	<0.5	<2.5

GROUNDWATER MONITORING DATA AND ANALYTICAL RESULTS
FORMER CHEVRON SERVICE STATION 9-1153
3135 GIBBONS DRIVE (3126 FERNSIDE BOULEVARD), ALAMEDA, CALIFORNIA

WELL ID/ DATE	TOC* (ft-msl)	DTW (ft.)	GWE (ft-msl)	LNAPLT (ft.)	TPHg (µg/L)	B (µg/L)	T (µg/L)	E (µg/L)	X (µg/L)	MTBE (µg/L)
C-3 (cont)										
07/09/97	7.83	4.36	3.47	--	<50	<0.5	<0.5	<0.5	<0.5	<2.5
10/29/97	7.83	4.65	3.18	--	<50	<0.5	<0.5	<0.5	<0.5	<2.5
01/14/98	7.83	0.77	7.06	--	<50	<0.5	<0.5	<0.5	<0.5	<2.5
07/15/98	7.83	3.72	4.11	--	<50	<0.5	<0.5	<0.5	<0.5	<2.5
01/20/99	7.83	2.65	5.18	--	<50	<0.5	<0.5	<0.5	<0.5	<2.0
04/19/99	7.83	1.78	6.05	--	--	--	--	--	--	--
04/03/00	7.83	MONITORED/SAMPLED ANNUALLY			--	--	--	--	--	--
07/03/00	7.83	--	--	--	--	--	--	--	--	--
10/23/00	7.83	--	--	--	--	--	--	--	--	--
01/08/01 ¹¹	7.83	3.71	4.12	0.00	<50	<0.50	<0.50	<0.50	<0.50	<2.5
04/09/01	7.83	--	--	--	--	--	--	--	--	--
08/23/01	7.83	MONITORED/SAMPLED ANNUALLY			--	--	--	--	--	--
11/27/01	7.83	MONITORED/SAMPLED ANNUALLY			--	--	--	--	--	--
02/26/02	7.83	2.38	5.45	0.00	<50	<0.50	<0.50	<0.50	<1.5	<2.5
05/23/02	7.83	MONITORED/SAMPLED ANNUALLY			--	--	--	--	--	--
08/09/02	7.83	MONITORED/SAMPLED ANNUALLY			--	--	--	--	--	--
11/08/02	7.83	MONITORED/SAMPLED ANNUALLY			--	--	--	--	--	--
02/07/03	7.83	2.73	5.10	0.00	<50	<0.50	<0.50	<0.50	<1.5	<2.5
05/09/03	7.83	MONITORED/SAMPLED ANNUALLY			--	--	--	--	--	--
08/15/03	7.83	MONITORED/SAMPLED ANNUALLY			--	--	--	--	--	--
11/14/03	7.83	MONITORED/SAMPLED ANNUALLY			--	--	--	--	--	--
02/13/04 ¹⁵	7.83	2.81	5.02	0.00	<50	<0.5	<0.5	<0.5	<0.5	<0.5
05/14/04	7.83	MONITORED/SAMPLED ANNUALLY			--	--	--	--	--	--
11/12/04	7.83	MONITORED/SAMPLED ANNUALLY			--	--	--	--	--	--
02/11/05 ¹⁵	7.83	2.58	5.25	0.00	<50	<0.5	<0.5	<0.5	<0.5	<0.5
05/13/05	7.83	MONITORED/SAMPLED ANNUALLY			--	--	--	--	--	--
08/19/05	7.83	MONITORED/SAMPLED ANNUALLY			--	--	--	--	--	--
11/18/05	7.83	MONITORED/SAMPLED ANNUALLY			--	--	--	--	--	--
02/10/06 ¹⁵	7.83	2.52	5.31	0.00	<50	<0.5	<0.5	<0.5	<0.5	<0.5
05/12/06	7.83	MONITORED/SAMPLED ANNUALLY			--	--	--	--	--	--
08/11/06	7.83	MONITORED/SAMPLED ANNUALLY			--	--	--	--	--	--
11/17/06	7.83	MONITORED/SAMPLED ANNUALLY			--	--	--	--	--	--
02/16/07 ¹⁵	7.83	2.63	5.20	0.00	<50	<0.5	<0.5	<0.5	<0.5	<0.5
05/17/07	7.83	MONITORED/SAMPLED ANNUALLY			--	--	--	--	--	--
08/09/07	7.83	MONITORED/SAMPLED ANNUALLY			--	--	--	--	--	--
11/08/07	7.83	MONITORED/SAMPLED ANNUALLY			--	--	--	--	--	--

GROUNDWATER MONITORING DATA AND ANALYTICAL RESULTS
FORMER CHEVRON SERVICE STATION 9-1153
3135 GIBBONS DRIVE (3126 FERNSIDE BOULEVARD), ALAMEDA, CALIFORNIA

WELL ID/ DATE	TOC* (ft-msl)	DTW (ft.)	GWE (ft-msl)	LNAPLT (ft.)	TPHg (µg/L)	B (µg/L)	T (µg/L)	E (µg/L)	X (µg/L)	MTBE (µg/L)
C-3 (cont)										
02/06/08 ¹⁵	7.83	2.91	4.92	0.00	<50	<0.5	<0.5	<0.5	<0.5	<0.5
05/07/08	7.83	MONITORED/SAMPLED ANNUALLY			--	--	--	--	--	--
09/11/08	7.83	MONITORED/SAMPLED ANNUALLY			--	--	--	--	--	--
11/10/08	7.83	MONITORED/SAMPLED ANNUALLY			--	--	--	--	--	--
02/09/09 ¹⁵	7.83	2.95	4.88	0.00	<50	<0.5	<0.5	<0.5	<0.5	<0.5
05/28/09	7.83	MONITORED/SAMPLED ANNUALLY			--	--	--	--	--	--
08/18/09	7.83	MONITORED/SAMPLED ANNUALLY			--	--	--	--	--	--
MW-4										
06/04/92	3.58	3.63	-0.05	--	<50	0.8	<0.5	<0.5	<0.5	--
10/13/92	3.58	--	--	--	--	--	--	--	--	--
01/11/93	3.58	1.89	1.69	--	<50	<0.5	<0.5	<0.5	<0.5	--
04/14/93	3.58	2.20	1.38	--	<50	<0.5	<0.5	<0.5	<1.5	--
07/13/93	3.58	3.51	0.07	--	54	2.6	1.6	<0.5	<1.5	--
10/19/93	3.58	4.22	-0.64	--	<50	<0.5	<0.5	<0.5	<0.5	--
11/30/93	7.01	4.01	3.00	--	--	--	--	--	--	--
01/27/94	7.01	2.89	4.12	--	<50	<0.5	<0.5	<0.5	<0.5	--
04/07/94	7.01	3.06	3.95	--	<50	<0.5	<0.5	<0.5	<0.5	--
07/01/94	7.01	3.59	3.42	--	<50	<0.5	<0.5	<0.5	<0.5	--
10/05/94	7.01	4.33	2.68	--	<50	<0.5	<0.5	<0.5	<0.5	--
01/12/95	7.01	1.20	5.81	--	<50	<0.5	<0.5	<0.5	<0.5	--
04/26/95	7.01	1.15	5.86	--	<50	<0.5	<0.5	<0.5	<0.5	--
07/12/95	7.01	2.72	4.29	--	<50	6.4	<0.5	0.63	0.72	--
10/30/95	7.01	4.08	2.93	--	<50	<0.5	<0.5	<0.5	<0.5	<2.5
01/22/96	7.01	1.76	5.25	--	<50	<0.5	<0.5	<0.5	<0.5	<2.5
04/24/96	7.01	1.95	5.06	--	<50	<0.5	<0.5	<0.5	<0.5	<2.5
07/29/96	7.01	3.37	3.64	--	<50	<0.5	<0.5	<0.5	<0.5	<2.5
10/10/96	7.01	3.96	3.05	--	<50	<0.5	<0.5	<0.5	<0.5	<2.5
01/15/97	7.01	1.27	5.74	--	<50	<0.5	<0.5	<0.5	<0.5	<2.5
04/03/97	7.01	2.11	4.90	--	<50	<0.5	<0.5	<0.5	<0.5	<2.5
07/09/97	7.01	4.04	2.97	--	<50	<0.5	<0.5	<0.5	<0.5	<2.5
10/29/97	7.01	4.56	2.45	--	<50	<0.5	<0.5	<0.5	<0.5	<2.5
01/14/98	7.01	0.39	6.62	--	<50	<0.5	<0.5	<0.5	<0.5	<2.5
01/20/99	7.01	2.83	4.18	--	<50	<0.5	<0.5	<0.5	<0.5	<2.0
04/19/99	7.01	2.91	4.10	--	--	--	--	--	--	--
01/25/00	7.01	1.92	5.09	--	<50	<0.5	<0.5	<0.5	<0.5	<2.5

**GROUNDWATER MONITORING DATA AND ANALYTICAL RESULTS
FORMER CHEVRON SERVICE STATION 9-1153
3135 GIBBONS DRIVE (3126 FERNSIDE BOULEVARD), ALAMEDA, CALIFORNIA**

WELL ID/ DATE	TOC* (ft-msl)	DTW (ft.)	GWE (ft-msl)	LNAPLT (ft.)	TPHg (µg/L)	B (µg/L)	T (µg/L)	E (µg/L)	X (µg/L)	MTBE (µg/L)
MW-4 (cont)										
04/03/00	7.01	MONITORED/SAMPLED ANNUALLY			--	--	--	--	--	--
07/03/00	7.01	--	--	--	--	--	--	--	--	--
10/23/00	7.01	--	--	--	--	--	--	--	--	--
01/08/01 ¹¹	7.01	3.02	3.99	0.00	87 ¹²	<0.50	<0.50	0.55	2.9	<2.5
04/09/01	7.01	--	--	--	--	--	--	--	--	--
08/23/01	7.01	MONITORED/SAMPLED ANNUALLY			--	--	--	--	--	--
11/27/01	7.01	MONITORED/SAMPLED ANNUALLY			--	--	--	--	--	--
02/26/02	7.01	1.37	5.64	0.00	<50	<0.50	<0.50	<0.50	<1.5	<2.5
05/23/02	7.01	MONITORED/SAMPLED ANNUALLY			--	--	--	--	--	--
08/09/02	7.01	MONITORED/SAMPLED ANNUALLY			--	--	--	--	--	--
11/08/02	7.01	MONITORED/SAMPLED ANNUALLY			--	--	--	--	--	--
02/07/03	7.01	1.72	5.29	0.00	<50	<0.50	<0.50	<0.50	<1.5	<2.5
05/09/03	7.01	MONITORED/SAMPLED ANNUALLY			--	--	--	--	--	--
08/15/03	7.01	MONITORED/SAMPLED ANNUALLY			--	--	--	--	--	--
11/14/03	7.01	MONITORED/SAMPLED ANNUALLY			--	--	--	--	--	--
02/13/04 ¹⁵	7.01	1.82	5.19	0.00	<50	<0.5	<0.5	<0.5	<0.5	<0.5
05/14/04	7.01	MONITORED/SAMPLED ANNUALLY			--	--	--	--	--	--
11/12/04	7.01	MONITORED/SAMPLED ANNUALLY			--	--	--	--	--	--
02/11/05 ¹⁵	7.01	1.46	5.55	0.00	<50	<0.5	<0.5	<0.5	<0.5	<0.5
05/13/05	7.01	MONITORED/SAMPLED ANNUALLY			--	--	--	--	--	--
08/19/05	7.01	MONITORED/SAMPLED ANNUALLY			--	--	--	--	--	--
11/18/05	7.01	MONITORED/SAMPLED ANNUALLY			--	--	--	--	--	--
02/10/06 ¹⁵	7.01	1.35	5.66	0.00	<50	<0.5	<0.5	<0.5	<0.5	<0.5
05/12/06	7.01	MONITORED/SAMPLED ANNUALLY			--	--	--	--	--	--
08/11/06	7.01	MONITORED/SAMPLED ANNUALLY			--	--	--	--	--	--
11/17/06	7.01	MONITORED/SAMPLED ANNUALLY			--	--	--	--	--	--
02/16/07 ¹⁵	7.01	1.48	5.53	0.00	<50	<0.5	<0.5	<0.5	<0.5	<0.5
05/17/07	7.01	MONITORED/SAMPLED ANNUALLY			--	--	--	--	--	--
08/09/07	7.01	MONITORED/SAMPLED ANNUALLY			--	--	--	--	--	--
11/08/07	7.01	MONITORED/SAMPLED ANNUALLY			--	--	--	--	--	--
02/06/08 ¹⁵	7.01	1.27	5.74	0.00	<50	<0.5	<0.5	<0.5	<0.5	<0.5
05/07/08	7.01	MONITORED/SAMPLED ANNUALLY			--	--	--	--	--	--
09/11/08	7.01	MONITORED/SAMPLED ANNUALLY			--	--	--	--	--	--
11/10/08	7.01	MONITORED/SAMPLED ANNUALLY			--	--	--	--	--	--
02/09/09 ¹⁵	7.01	2.33	4.68	0.00	<50	<0.5	<0.5	<0.5	<0.5	<0.5
05/28/09	7.01	MONITORED/SAMPLED ANNUALLY			--	--	--	--	--	--

**GROUNDWATER MONITORING DATA AND ANALYTICAL RESULTS
FORMER CHEVRON SERVICE STATION 9-1153
3135 GIBBONS DRIVE (3126 FERNSIDE BOULEVARD), ALAMEDA, CALIFORNIA**

WELL ID/ DATE	TOC* (ft-msl)	DTW (ft.)	GWE (ft-msl)	LNAPLT (ft.)	TPHg (µg/L)	B (µg/L)	T (µg/L)	E (µg/L)	X (µg/L)	MTBE (µg/L)
MW-4 (cont)										
08/18/09	7.01	MONITORED/SAMPLED ANNUALLY			--	--	--	--	--	--
MW-5										
06/04/92	3.61	3.25	0.36	--	560	110	0.5	37	2.2	--
10/13/92	3.61	4.20	-0.59	--	1,200	150	<2.5	84	8.6	--
01/11/93	3.61	1.30	2.31	--	1,300	48	1.0	83	33	--
04/14/93	3.61	1.20	2.41	--	2,600	240	6.1	250	170	--
07/13/93	3.61	3.15	0.46	--	1,700	260	7.8	160	100	--
10/19/93	3.61	3.82	-0.21	--	1,900	190	3.3	200	93	--
11/30/93	7.04	3.56	3.48	--	--	--	--	--	--	--
01/27/94	7.04	2.42	4.62	--	4,000	100	12	210	110	--
04/07/94	7.04	2.33	4.71	--	2,600	170	10	150	88	--
07/01/94	7.04	3.18	3.86	--	2,300	350	9.1	110	76	--
10/05/94	7.04	3.98	3.06	--	11,000	840	150	130	340	--
01/12/95	7.04	0.40	6.64	--	2,300	82	<2.5	54	20	--
04/26/95	7.04	0.50	6.54	--	1,600	52	<5.0	36	61	--
07/12/95	7.04	2.41	4.63	--	2,800	150	<5.0	34	38	--
10/30/95	7.04	3.78	3.26	--	1,100	81	<5.0	<5.0	<5.0	35
01/22/96	7.04	0.78	6.26	--	880	7.3	<2.0	15	4.8	<10
04/24/96	7.04	1.65	5.39	--	1,600	51	3.8	14	5.6	56
07/29/96	7.04	INACCESSIBLE		--	--	--	--	--	--	--
10/10/96	7.04	3.60	3.44	--	1,000	18	<1.2	1.5	<1.2	<6.2
01/15/97	7.04	0.45	6.59	--	520	0.84	<0.5	3.1	1.2	8.4
04/03/97	7.04	2.11	4.93	--	1,400	13	<2.0	4.3	8.4	32
07/09/97	7.04	3.71	3.33	--	810	3.6	0.97	<0.5	<0.5	9.7
10/29/97	7.04	4.20	2.84	--	<50	<0.5	<0.5	<0.5	<0.5	<2.5
01/14/98	7.04	0.00	7.04	--	430	5.8	2.4	<0.5	1.6	17
04/17/98	7.04	0.71	6.33	--	SAMPLED SEMI-ANNUALLY			--	--	--
07/15/98	7.04	0.00	7.04	--	990	11	3.9	0.56	2.2	61
10/27/98	7.04	4.23	2.81	--	--	--	--	--	--	--
01/20/99	7.04	2.58	4.46	--	168	<0.5	<0.5	<0.5	0.692	<2.0
04/19/99	7.04	2.07	4.97	--	--	--	--	--	--	--
07/29/99	7.04	3.43	3.61	--	246	1.54	<0.5	<0.5	<0.5	<5.0/<2.0 ²
10/13/99	7.04	INACCESSIBLE		--	--	--	--	--	--	--
01/25/00	7.04	1.51	5.53	--	169	1.94	<0.5	<0.5	<0.5	201
04/03/00	7.04	1.20	5.84	0.00	--	--	--	--	--	--

**GROUNDWATER MONITORING DATA AND ANALYTICAL RESULTS
FORMER CHEVRON SERVICE STATION 9-1153
3135 GIBBONS DRIVE (3126 FERNSIDE BOULEVARD), ALAMEDA, CALIFORNIA**

WELL ID/ DATE	TOC* (ft-msl)	DTW (ft.)	GWE (ft-msl)	LNAPLT (ft.)	TPHg (µg/L)	B (µg/L)	T (µg/L)	E (µg/L)	X (µg/L)	MTBE (µg/L)
MW-5 (cont)										
07/03/00	7.04	2.98	4.06	0.00	320 ^{6,10}	5.3	1.1	<0.50	<0.50	5.0
10/23/00	7.04	4.18	2.86	0.00	--	--	--	--	--	--
01/08/01 ¹¹	7.04	2.92	4.12	0.00	220 ⁶	3.9	<0.50	<0.50	<0.50	7.7
04/09/01	7.04	1.01	6.03	0.00	--	--	--	--	--	--
08/23/01	7.04	3.48	3.56	0.00	630	40	3.5	<2.5	<2.5	43
11/27/01	7.04	3.05	3.99	0.00	SAMPLED SEMI-ANNUALLY		--	--	--	--
02/26/02	7.04	1.00	6.04	0.00	410	4.3	<0.50	<0.50	<1.5	<2.5
05/23/02	7.04	2.21	4.83	0.00	SAMPLED SEMI-ANNUALLY		--	--	--	--
08/09/02	7.04	3.38	3.66	0.00	240	1.3	<0.50	<0.50	<1.5	<2.5
11/08/02	7.04	4.56	2.48	0.00	SAMPLED SEMI-ANNUALLY		--	--	--	--
02/07/03	7.04	1.42	5.62	0.00	380	3.2	<0.50	0.64	<1.5	<2.5
05/09/03	7.04	1.25	5.79	0.00	SAMPLED SEMI-ANNUALLY		--	--	--	--
08/15/03 ¹⁵	7.04	3.61	3.43	0.00	<50	<0.5	<0.5	<0.5	<0.5	<0.5
11/14/03	7.04	3.57	3.47	0.00	SAMPLED SEMI-ANNUALLY		--	--	--	--
02/13/04 ¹⁵	7.04	1.50	5.54	0.00	<50	<0.5	<0.5	<0.5	<0.5	<0.5
05/14/04	7.04	2.47	4.57	0.00	SAMPLED SEMI-ANNUALLY		--	--	--	--
08/13/04 ¹⁵	7.04	5.46	1.58	0.00	<50	<0.5	<0.5	<0.5	<0.5	<0.5
11/12/04	7.04	4.65	2.39	0.00	SAMPLED SEMI-ANNUALLY		--	--	--	--
02/11/05 ¹⁵	7.04	1.20	5.84	0.00	130	<0.5	<0.5	<0.5	<0.5	<0.5
05/13/05	7.04	4.36	2.68	0.00	SAMPLED SEMI-ANNUALLY		--	--	--	--
08/19/05 ¹⁵	7.04	2.78	4.26	0.00	96	<0.5	<0.5	<0.5	<0.5	<0.5
11/18/05	7.04	4.51	2.53	0.00	SAMPLED SEMI-ANNUALLY		--	--	--	--
02/10/06 ¹⁵	7.04	1.12	5.92	0.00	<50	<0.5	<0.5	<0.5	<0.5	<0.5
05/12/06	7.04	2.23	4.81	0.00	SAMPLED SEMI-ANNUALLY		--	--	--	--
08/11/06 ¹⁵	7.04	3.40	3.64	0.00	<50	<0.5	<0.5	<0.5	<0.5	<0.5
11/17/06	7.04	4.16	2.88	0.00	SAMPLED SEMI-ANNUALLY		--	--	--	--
02/16/07 ¹⁵	7.04	1.22	5.82	0.00	<50	<0.5	<0.7	<0.8	<0.8	<0.5
05/17/07	7.04	4.06	2.98	0.00	SAMPLED SEMI-ANNUALLY		--	--	--	--
08/09/07 ¹⁵	7.04	3.61	3.43	0.00	<50	<0.5	<0.5	<0.5	<0.5	<0.5
11/08/07	7.04	3.70	3.34	0.00	SAMPLED SEMI-ANNUALLY		--	--	--	--
02/06/08 ¹⁵	7.04	1.06	5.98	0.00	<50	<0.5	<0.5	<0.5	<0.5	<0.5
05/07/08	7.04	3.57	3.47	0.00	SAMPLED SEMI-ANNUALLY		--	--	--	--
09/11/08 ¹⁵	7.04	4.58	2.46	0.00	<50	<0.5	<0.5	<0.5	<0.5	<0.5
11/10/08	7.04	4.26	2.78	0.00	SAMPLED SEMI-ANNUALLY		--	--	--	--
02/09/09 ¹⁵	7.04	2.15	4.89	0.00	<50	<0.5	<0.5	<0.5	<0.5	<0.5
05/28/09	7.04	2.76	4.28	0.00	SAMPLED SEMI-ANNUALLY		--	--	--	--

**GROUNDWATER MONITORING DATA AND ANALYTICAL RESULTS
FORMER CHEVRON SERVICE STATION 9-1153
3135 GIBBONS DRIVE (3126 FERNSIDE BOULEVARD), ALAMEDA, CALIFORNIA**

WELL ID/ DATE	TOC* (ft-msl)	DTW (ft.)	GWE (ft-msl)	LNAPLT (ft.)	TPHg (µg/L)	B (µg/L)	T (µg/L)	E (µg/L)	X (µg/L)	MTBE (µg/L)
MW-5 (cont)										
08/18/09 ¹⁵	7.04	3.81	3.23	0.00	<50	<0.5	<0.5	<0.5	<0.5	<0.5
MW-6										
06/04/92	3.85	3.89	-0.04	--	210	54	<0.5	1.9	2.4	--
10/13/92	3.85	4.56	-0.71	--	10,000	5,300	<10	70	<10	--
01/11/93	3.85	2.36	1.49	--	100	50	<0.5	<0.5	<0.5	--
04/14/93	3.85	3.15	0.70	--	<50	<0.5	<0.5	<0.5	<0.5	--
07/13/93	3.85	3.94	-0.09	--	<50	1.8	<0.5	<0.5	<1.5	--
10/19/93	3.85	4.40	-0.55	--	320	150	<0.5	0.8	<0.5	--
11/30/93	7.27	4.16	3.11	--	--	--	--	--	--	--
01/27/94	7.27	3.33	3.94	--	120	45	<0.5	<0.5	<0.5	--
04/07/94	7.27	3.43	3.84	--	<50	<0.5	<0.5	<0.5	<0.5	--
07/01/94	7.27	3.94	3.33	--	<50	<0.5	<0.5	<0.5	<0.5	--
10/05/94	7.27	4.38	2.89	--	8,300	2,400	160	42	190	--
01/12/95 ¹	7.27	2.43	4.84	--	<50	12	<0.5	<0.5	<0.5	--
04/26/95	7.27	2.06	5.21	--	<50	5.5	0.67	<0.5	1.3	--
07/12/95	7.27	3.53	3.74	--	65	27	<0.5	<0.5	<0.5	--
10/30/95	7.27	4.34	2.93	--	<50	3.9	<0.5	<0.5	<0.5	<2.5
01/22/96	7.27	2.61	4.66	--	<50	0.93	<0.5	<0.5	<0.5	<2.5
04/24/96	7.27	2.50	4.77	--	260	110	<1.2	<1.2	<1.2	<6.2
07/29/96	7.27	3.85	3.42	--	<50	23	<0.5	<0.5	<0.5	<2.5
10/10/96	7.27	4.37	2.90	--	79	31	<0.5	<0.5	<0.5	<2.5
01/15/97	7.27	2.63	4.64	--	<50	<0.5	<0.5	<0.5	<0.5	<2.5
04/03/97	7.27	3.42	3.85	--	670	360	<5.0	<5.0	<5.0	<25
07/09/97	7.27	4.29	2.98	--	330	140	<2.0	<2.0	<2.0	<10
10/29/97	7.27	4.56	2.71	--	400	260	<2.0	<2.0	<2.0	5.8
01/14/98	7.27	1.01	6.26	--	<50	<0.5	<0.5	<0.5	<0.5	<2.5
04/17/98	7.27	2.94	4.33	--	<50	1.7	<0.5	<0.5	<0.5	<2.5
07/15/98	7.27	4.72	2.55	--	<50	<0.5	<0.5	<0.5	<0.5	<2.5
10/27/98	7.27	INACCESSIBLE		--	--	--	--	--	--	--
11/25/98	7.27	4.16	3.11	--	110 ³	54	<0.5	<0.5	<0.5	<2.5
01/20/99	7.27	3.45	3.82	--	<50	10	<0.5	<0.5	<0.5	<2.0
04/19/99	7.27	3.39	3.88	--	<50	2.6	<0.5	<0.5	<0.5	<2.5/<2.0 ²
07/29/99 ⁴	7.27	4.34	2.93	--	<5,000	2,590	<50	<50	<50	<500
10/13/99	7.27	5.89	1.38	--	9,270	4,610	44.2	<25	<25	<125
01/25/00	7.27	4.11	3.16	--	529	289	<0.5	<0.5	<0.5	738

GROUNDWATER MONITORING DATA AND ANALYTICAL RESULTS
FORMER CHEVRON SERVICE STATION 9-1153
3135 GIBBONS DRIVE (3126 FERNSIDE BOULEVARD), ALAMEDA, CALIFORNIA

WELL ID/ DATE	TOC* (ft-msl)	DTW (ft.)	GWE (ft-msl)	LNAPLT (ft.)	TPHg (µg/L)	B (µg/L)	T (µg/L)	E (µg/L)	X (µg/L)	MTBE (µg/L)
MW-6 (cont)										
04/03/00 ^{7,8}	7.27	2.84	4.43	0.00	<50	<0.50	<0.50	<0.50	<0.50	<2.5
07/03/00 ⁷	7.27	3.77	3.50	0.00	91 ⁶	89	0.77	<0.50	<0.50	<2.5
10/12/00	7.27	6.32	0.95	0.00	<50	8.0	<0.50	<0.50	<0.50	<2.5
01/08/01 ^{7,11}	7.27	3.74	3.53	0.00	400 ⁶	640	8.2	8.0	5.0	10
04/09/01 ⁷	7.27	3.03	4.24	0.00	91.3	22.0	3.36	0.751	2.14	<0.500
08/23/01 ⁷	7.27	4.70	2.57	0.00	53 ¹³	23	0.50	<0.50	1.1	<2.5
11/27/01 ¹⁴	7.27	4.43	2.84	0.00	<50	4.1	<0.50	<0.50	<1.5	<2.5
02/26/02 ¹⁴	7.27	2.50	4.77	0.00	100	53	<0.50	<0.50	<1.5	<2.5
05/23/02	7.27	3.27	4.00	0.00	610	260	4.2	1.7	2.1	<2.5
08/09/02	7.27	4.11	3.16	0.00	<50	1.1	<0.50	<0.50	<1.5	<2.5
11/08/02	7.27	4.12	3.15	0.00	<50	<0.50	<0.50	<0.50	<1.5	<2.5
02/07/03	7.27	2.60	4.67	0.00	<50	0.65	<0.50	<0.50	<1.5	<2.5
05/09/03	7.27	2.57	4.70	0.00	<50	1.9	<0.5	<0.5	<1.5	<2.5
08/15/03 ¹⁵	7.27	4.15	3.12	0.00	<50	<0.5	<0.5	<0.5	<0.5	<0.5
11/14/03 ¹⁵	7.27	4.10	3.17	0.00	<50	<0.5	0.6	<0.5	<0.5	1
02/13/04 ¹⁵	7.27	2.66	4.61	0.00	<50	<0.5	<0.5	<0.5	<0.5	<0.5
05/14/04 ¹⁵	7.27	3.55	3.72	0.00	<50	3	<0.5	<0.5	<0.5	<0.5
08/13/04 ¹⁵	7.27	4.32	2.95	0.00	<50	<0.5	<0.5	<0.5	<0.5	<0.5
11/12/04 ¹⁵	7.27	4.20	3.07	0.00	<50	<0.5	<0.5	<0.5	<0.5	<0.5
02/11/05 ¹⁵	7.27	2.18	5.09	0.00	<50	<0.5	<0.5	<0.5	<0.5	<0.5
05/13/05 ¹⁵	7.27	4.11	3.16	0.00	<50	<0.5	<0.5	<0.5	<0.5	<0.5
08/19/05 ¹⁵	7.27	3.70	3.57	0.00	<50	<0.5	<0.5	<0.5	<0.5	<0.5
11/18/05 ¹⁵	7.27	3.98	3.29	0.00	<50	<0.5	<0.5	<0.5	<0.5	<0.5
02/10/06 ¹⁵	7.27	2.11	5.16	0.00	<50	<0.5	<0.5	<0.5	<0.5	<0.5
05/12/06 ¹⁵	7.27	3.18	4.09	0.00	<50	<0.5	<0.5	<0.5	<0.5	<0.5
08/11/06 ¹⁵	7.27	3.80	3.47	0.00	<50	<0.5	<0.5	<0.5	<0.5	<0.5
11/17/06 ¹⁵	7.27	3.78	3.49	0.00	<50	<0.5	<0.5	<0.5	<0.5	<0.5
02/16/07 ¹⁵	7.27	2.08	5.19	0.00	<50	1	<0.5	<0.5	<0.5	<0.5
05/17/07 ¹⁵	7.27	3.61	3.66	0.00	<50	<0.5	<0.5	<0.5	<0.5	<0.5
08/09/07 ¹⁵	7.27	4.05	3.22	0.00	<50	<0.5	<0.5	<0.5	<0.5	<0.5
11/08/07 ¹⁵	7.27	4.12	3.15	0.00	<50	5	<0.5	<0.5	<0.5	<0.5
02/06/08 ¹⁵	7.27	1.85	5.42	0.00	<50	<0.5	<0.5	<0.5	<0.5	<0.5
05/07/08 ¹⁵	7.27	3.91	3.36	0.00	63	18	<0.5	<0.5	<0.5	<0.5
09/11/08 ¹⁵	7.27	4.93	2.34	0.00	<50	<0.5	<0.5	<0.5	<0.5	<0.5
11/10/08 ¹⁵	7.27	4.30	2.97	0.00	<50	<0.5	<0.5	<0.5	<0.5	<0.5
02/09/09 ¹⁵	7.27	2.97	4.30	0.00	<50	2	<0.5	<0.5	<0.5	<0.5

**GROUNDWATER MONITORING DATA AND ANALYTICAL RESULTS
FORMER CHEVRON SERVICE STATION 9-1153
3135 GIBBONS DRIVE (3126 FERNSIDE BOULEVARD), ALAMEDA, CALIFORNIA**

WELL ID/ DATE	TOC* (ft-msl)	DTW (ft.)	GWE (ft-msl)	LNAPLT (ft.)	TPHg (µg/L)	B (µg/L)	T (µg/L)	E (µg/L)	X (µg/L)	MTBE (µg/L)
MW-6 (cont)										
05/28/09 ¹⁵	7.27	3.53	3.74	0.00	<50	4	<0.5	<0.5	<0.5	<0.5
08/18/09 ¹⁵	7.27	3.38	3.89	0.00	560	130	3	<0.5	0.7J	<0.5
MW-7										
11/30/93	8.22	5.33	2.89	--	480	110	41	4.4	38	--
01/27/94	8.22	4.50	3.72	--	120	21	1.1	2.2	4.8	--
04/07/94	8.22	4.62	3.60	--	2,600	630	39	56	94	--
07/01/94	8.22	5.13	3.09	--	2,200	770	42	<10	92	--
10/05/94	8.22	5.61	2.61	--	15,000	3,300	90	130	320	--
01/12/95	8.22	2.83	5.39	--	340	57	<1.3	18	6.4	--
04/26/95	8.22	2.35	5.87	--	15,000	3,700	210	520	800	--
07/12/95	8.22	4.66	3.56	--	7,700	1,800	59	130	370	--
10/30/95	8.22	5.48	2.74	--	770	260	<5.0	33	48	25
01/22/96	8.22	3.34	4.88	--	290	63	<1.0	6.4	5.7	<5.0
04/24/96	8.22	4.12	4.10	--	12,000	2,500	510	380	810	<125
07/29/96	8.22	5.03	3.19	--	2,600	650	<25	61	150	<125
10/10/96	8.22	5.52	2.70	--	5,800	1,700	28	170	210	<62
01/15/97	8.22	2.92	5.30	--	1,000	230	<2.5	28	11	63
04/03/97	8.22	4.65	3.57	--	6,000	1,800	100	140	170	<100
07/09/97	8.22	5.39	2.83	--	5,500	2,200	<20	41	30	<100
10/29/97	8.22	5.58	2.64	--	220	40	0.61	3.0	2.4	7.6
01/14/98	8.22	2.80	5.42	--	140	5.1	<0.5	<0.5	1.4	<2.5
04/17/98	8.22	3.00	5.22	--	13,000	4,200	98	250	240	250
07/15/98	8.22	INACCESSIBLE		--	--	--	--	--	--	--
08/17/98 ⁵	7.92	5.52	2.40	--	1,600	380	51	68	280	22
10/27/98	7.92	7.51	0.41	--	190	2.3	0.53	<0.5	<0.5	33
01/20/99	7.92	3.45	4.47	--	<50	<0.5	<0.5	<0.5	<0.5	<2.0
04/19/99	7.92	4.61	3.31	--	6,500	3,000	<0.5	110	210	310/150 ²
07/29/99 ⁴	7.92	5.00	2.92	--	8,390	2,100	129	222	729	248
10/13/99	7.92	5.61	2.31	--	14,300	6,600	58.8	117	190	<125
01/25/00	7.92	3.32	4.60	--	1,100	184	<5.0	13.5	33.7	151
04/03/00 ^{7,9}	7.92	3.38	4.54	0.00	2,600 ⁶	780	12	<5.0	61	95
07/03/00 ⁷	7.92	4.34	3.58	0.00	4,100 ⁶	2,600	72	240	690	<50
10/23/00	7.92	6.11	1.81	0.00	12,000 ⁶	2,600	<50	150	290	<250
01/08/01 ^{7,11}	7.92	4.32	3.60	0.00	3,900 ⁶	2,200	61	140	350	<25

**GROUNDWATER MONITORING DATA AND ANALYTICAL RESULTS
FORMER CHEVRON SERVICE STATION 9-1153
3135 GIBBONS DRIVE (3126 FERNSIDE BOULEVARD), ALAMEDA, CALIFORNIA**

WELL ID/ DATE	TOC* (ft-msl)	DTW (ft.)	GWE (ft-msl)	LNAPLT (ft.)	TPHg (µg/L)	B (µg/L)	T (µg/L)	E (µg/L)	X (µg/L)	MTBE (µg/L)
MW-7 (cont)										
04/09/01 ⁷	7.92	3.63	4.29	0.00	25,100	4,590	1,200	843	1,920	48.1
08/23/01 ⁷	7.92	4.83	3.09	0.00	27,000	4,100	970	1,100	3,500	<500
11/27/01	7.92	4.30	3.62	0.00	12,000	1,800	50	450	830	91
02/26/02	7.92	3.00	4.92	0.00	15,000	3,100	260	380	860	<10
05/23/02	7.92	3.69	4.23	0.00	28,000	6,000	120	820	1,900	42
08/09/02	7.92	4.38	3.54	0.00	24,000	3,700	81	710	1,300	56
11/08/02	7.92	4.43	3.49	0.00	18,000	2,300	150	660	1,400	<100
02/07/03	7.92	3.20	4.72	0.00	13,000	2,300	200	310	620	<25
05/09/03	7.92	3.18	4.74	0.00	17,000	4,200	36	350	360	<50
08/15/03 ¹⁵	7.92	4.75	3.17	0.00	29,000	7,300	140	780	1,900	<5
11/14/03 ¹⁵	7.92	4.95	2.97	0.00	7,200	950	3	45	20	7
02/13/04 ¹⁵	7.92	3.29	4.63	0.00	3,300	360	4	82	130	3
05/14/04 ¹⁵	7.92	3.98	3.94	0.00	17,000	3,100	480	510	1,300	3
08/13/04 ¹⁵	7.92	5.94	1.98	0.00	10,000	2,000	4	130	150	4
11/12/04 ¹⁵	7.92	4.50	3.42	0.00	680	4	<0.5	1	0.7	0.8
02/11/05 ¹⁵	7.92	3.07	4.85	0.00	4,600	680	6	80	44	4
05/13/05 ¹⁵	7.92	4.51	3.41	0.00	4,200	380	3	38	13	2
08/19/05 ¹⁵	7.92	4.03	3.89	0.00	7,900	1,300	3	190	310	<1
11/18/05 ¹⁵	7.92	4.62	3.30	0.00	3,900	4	1	16	8	2
02/10/06 ¹⁵	7.92	3.12	4.80	0.00	3,200	320	2	14	8	2
05/12/06 ¹⁵	7.92	4.25	3.67	0.00	3,600	1,000	2	65	27	<1
08/11/06 ¹⁵	7.92	4.45	3.47	0.00	6,700	1,900	6	280	300	<1
11/17/06 ¹⁵	7.92	4.71	3.21	0.00	1,200	0.6	<0.5	1	0.8	<0.5
02/16/07 ¹⁵	7.92	3.26	4.66	0.00	110	<0.5	<0.5	<0.5	<0.5	<0.5
05/17/07 ¹⁵	7.92	4.62	3.30	0.00	6,400	1,400	4	130	26	<1
08/09/07 ¹⁵	7.92	4.61	3.31	0.00	10,000	1,400	4	230	12	<3
11/08/07 ¹⁵	7.92	4.72	3.20	0.00	2,300	4	1	3	7	0.9
02/06/08 ¹⁵	7.92	2.98	4.94	0.00	190	<0.5	<0.5	<0.5	<0.5	<0.5
05/07/08 ¹⁵	7.92	4.48	3.44	0.00	8,000	1,500	15	380	260	<1
09/11/08 ¹⁵	7.92	5.95	1.97	0.00	5,100	530	4	47	12	0.7
11/10/08 ¹⁵	7.92	5.81	2.11	0.00	2,800	13	1	1	7	<0.5
02/09/09 ¹⁵	7.92	4.06	3.86	0.00	3,900	190	2	51	11	0.5
05/28/09 ^{15,17}	7.92	3.84	4.08	0.00	5,800	870 J	8 J	220 J	27 J	<0.5 UJ
08/18/09¹⁵	7.92	4.80	3.12	0.00	6,700	660	4	110	13	0.7J

GROUNDWATER MONITORING DATA AND ANALYTICAL RESULTS
FORMER CHEVRON SERVICE STATION 9-1153
3135 GIBBONS DRIVE (3126 FERNSIDE BOULEVARD), ALAMEDA, CALIFORNIA

WELL ID/ DATE	TOC* (ft-msl)	DTW (ft.)	GWE (ft-msl)	LNAPLT (ft.)	TPHg (µg/L)	B (µg/L)	T (µg/L)	E (µg/L)	X (µg/L)	MTBE (µg/L)
MW-8										
10/17/95	6.96	4.40	2.56	--	--	--	--	--	--	--
10/30/95	6.96	4.44	2.52	--	<50	<0.5	<0.5	<0.5	<0.5	<2.5
01/22/96	6.96	2.24	4.72	--	<50	<0.5	<0.5	<0.5	<0.5	<2.5
04/24/96	6.96	2.97	3.99	--	<50	<0.5	<0.5	<0.5	<0.5	<2.5
07/29/96	6.96	3.37	3.59	--	<50	<0.5	<0.5	<0.5	<0.5	<2.5
10/10/96	6.96	4.12	2.84	--	<50	<0.5	<0.5	<0.5	<0.5	<2.5
01/15/97	6.96	0.94	6.02	--	<50	<0.5	<0.5	<0.5	<0.5	<2.5
04/03/97	6.96	2.20	4.76	--	<50	<0.5	<0.5	<0.5	<0.5	<2.5
07/09/97	6.96	4.30	2.66	--	<50	<0.5	<0.5	<0.5	<0.5	<2.5
10/29/97	6.96	4.57	2.39	--	<50	<0.5	<0.5	<0.5	<0.5	<2.5
01/14/98	6.96	0.83	6.13	--	<50	<0.5	<0.5	<0.5	<0.5	<2.5
01/20/99	6.96	2.69	4.27	--	<50	<0.5	<0.5	<0.5	<0.5	<2.0
04/19/99	6.96	3.76	3.20	--	--	--	--	--	--	--
01/25/00	6.96	1.41	5.55	--	<50	<0.5	<0.5	<0.5	<0.5	<2.5
04/03/00	6.96	MONITORED/SAMPLED ANNUALLY			--	--	--	--	--	--
07/03/00	6.96	--	--	--	--	--	--	--	--	--
10/23/00	6.96	--	--	--	--	--	--	--	--	--
01/08/01 ¹¹	6.96	3.58	3.38	0.00	<50	<0.50	<0.50	<0.50	<0.50	<2.5
04/09/01	6.96	--	--	--	--	--	--	--	--	--
08/23/01	6.96	MONITORED/SAMPLED ANNUALLY			--	--	--	--	--	--
11/27/01	6.96	MONITORED/SAMPLED ANNUALLY			--	--	--	--	--	--
02/26/02	6.96	2.91	4.05	0.00	<50	<0.50	<0.50	<0.50	<1.5	<2.5
05/23/02	6.96	MONITORED/SAMPLED ANNUALLY			--	--	--	--	--	--
08/09/02	6.96	MONITORED/SAMPLED ANNUALLY			--	--	--	--	--	--
11/08/02	6.96	MONITORED/SAMPLED ANNUALLY			--	--	--	--	--	--
02/07/03	6.96	3.13	3.83	0.00	<50	<0.50	<0.50	<0.50	<1.5	<2.5
05/09/03	6.96	MONITORED/SAMPLED ANNUALLY			--	--	--	--	--	--
08/15/03	6.96	MONITORED/SAMPLED ANNUALLY			--	--	--	--	--	--
11/14/03	6.96	MONITORED/SAMPLED ANNUALLY			--	--	--	--	--	--
02/13/04 ¹⁵	6.96	3.20	3.76	0.00	<50	<0.5	<0.5	<0.5	<0.5	<0.5
05/14/04	6.96	MONITORED/SAMPLED ANNUALLY			--	--	--	--	--	--
11/12/04	6.96	MONITORED/SAMPLED ANNUALLY			--	--	--	--	--	--
02/11/05 ¹⁵	6.96	2.85	4.11	0.00	<50	<0.5	<0.5	<0.5	<0.5	<0.5
05/13/05	6.96	MONITORED/SAMPLED ANNUALLY			--	--	--	--	--	--
08/19/05	6.96	MONITORED/SAMPLED ANNUALLY			--	--	--	--	--	--
11/18/05	6.96	MONITORED/SAMPLED ANNUALLY			--	--	--	--	--	--

**GROUNDWATER MONITORING DATA AND ANALYTICAL RESULTS
FORMER CHEVRON SERVICE STATION 9-1153
3135 GIBBONS DRIVE (3126 FERNSIDE BOULEVARD), ALAMEDA, CALIFORNIA**

WELL ID/ DATE	TOC* (ft-msl)	DTW (ft.)	GWE (ft-msl)	LNAPLT (ft.)	TPHg (µg/L)	B (µg/L)	T (µg/L)	E (µg/L)	X (µg/L)	MTBE (µg/L)
MW-8 (cont)										
02/10/06 ¹⁵	6.96	2.74	4.22	<50	<0.5	<0.5	<0.5	<0.5	<0.5	<0.5
05/12/06	6.96	MONITORED/SAMPLED ANNUALLY			--	--	--	--	--	--
08/11/06	6.96	MONITORED/SAMPLED ANNUALLY			--	--	--	--	--	--
11/17/06	6.96	MONITORED/SAMPLED ANNUALLY			--	--	--	--	--	--
02/16/07 ¹⁵	6.96	2.69	4.27	0.00	<50	<0.5	<0.5	<0.5	<0.5	<0.5
05/17/07	6.96	MONITORED/SAMPLED ANNUALLY			--	--	--	--	--	--
08/09/07	6.96	MONITORED/SAMPLED ANNUALLY			--	--	--	--	--	--
11/08/07	6.96	MONITORED/SAMPLED ANNUALLY			--	--	--	--	--	--
02/06/08 ¹⁵	6.96	2.57	4.39	0.00	<50	<0.5	<0.5	<0.5	<0.5	<0.5
05/07/08	6.96	MONITORED/SAMPLED ANNUALLY			--	--	--	--	--	--
09/11/08	6.96	MONITORED/SAMPLED ANNUALLY			--	--	--	--	--	--
11/10/08	6.96	MONITORED/SAMPLED ANNUALLY			--	--	--	--	--	--
02/09/09 ¹⁵	6.96	3.28	3.68	0.00	<50	<0.5	<0.5	<0.5	<0.5	<0.5
05/28/09	6.96	MONITORED/SAMPLED ANNUALLY			--	--	--	--	--	--
08/18/09	6.96	MONITORED/SAMPLED ANNUALLY			--	--	--	--	--	--
MW-9										
10/17/95	7.21	4.80	2.41	--	--	--	--	--	--	--
10/30/95	7.21	4.97	2.24	--	<50	<0.5	<0.5	<0.5	<0.5	<2.5
01/22/96	7.21	3.40	3.81	--	<50	<0.5	<0.5	<0.5	<0.5	<2.5
04/24/96	7.21	4.18	3.03	--	<50	<0.5	<0.5	<0.5	<0.5	<2.5
07/29/96	7.21	4.69	2.52	--	<50	<0.5	<0.5	<0.5	<0.5	<2.5
10/10/96	7.21	5.20	2.01	--	<50	<0.5	<0.5	<0.5	<0.5	<2.5
01/15/97	7.21	3.31	3.90	--	<50	<0.5	<0.5	<0.5	<0.5	<2.5
04/03/97	7.21	4.57	2.64	--	<50	<0.5	<0.5	<0.5	<0.5	<2.5
07/09/97	7.21	5.04	2.17	--	<50	<0.5	<0.5	<0.5	<0.5	<2.5
10/29/97	7.21	4.96	2.25	--	<50	<0.5	<0.5	<0.5	<0.5	<2.5
01/14/98	7.21	2.40	4.81	--	<50	<0.5	<0.5	<0.5	<0.5	<2.5
01/20/99	7.21	4.31	2.90	--	<50	<0.5	<0.5	<0.5	<0.5	<2.0
04/19/99	7.21	3.92	3.29	--	--	--	--	--	--	--
01/25/00	7.21	2.95	4.26	--	<50	<0.5	<0.5	<0.5	<0.5	<2.5
04/03/00	7.21	MONITORED/SAMPLED ANNUALLY			--	--	--	--	--	--
07/03/00	7.21	--	--	--	--	--	--	--	--	--
10/23/00	7.21	--	--	--	--	--	--	--	--	--
01/08/01 ¹¹	7.21	4.59	2.62	0.00	<50	<0.50	<0.50	<0.50	<0.50	<2.5
04/09/01	7.21	--	--	--	--	--	--	--	--	--

**GROUNDWATER MONITORING DATA AND ANALYTICAL RESULTS
FORMER CHEVRON SERVICE STATION 9-1153
3135 GIBBONS DRIVE (3126 FERNSIDE BOULEVARD), ALAMEDA, CALIFORNIA**

WELL ID/ DATE	TOC* (ft-msl)	DTW (ft.)	GWE (ft-msl)	LNAPLT (ft.)	TPHg (µg/L)	B (µg/L)	T (µg/L)	E (µg/L)	X (µg/L)	MTBE (µg/L)
MW-9 (cont)										
08/23/01	7.21	MONITORED/SAMPLED ANNUALLY			--	--	--	--	--	--
11/27/01	7.21	MONITORED/SAMPLED ANNUALLY			--	--	--	--	--	--
02/26/02	7.21	3.75	3.46	0.00	<50	<0.50	<0.50	<0.50	<1.5	<2.5
05/23/02	7.21	MONITORED/SAMPLED ANNUALLY			--	--	--	--	--	--
08/09/02	7.21	MONITORED/SAMPLED ANNUALLY			--	--	--	--	--	--
11/08/02	7.21	MONITORED/SAMPLED ANNUALLY			--	--	--	--	--	--
02/07/03	7.21	3.97	3.24	0.00	<50	<0.50	<0.50	<0.50	<1.5	<2.5
05/09/03	7.21	MONITORED/SAMPLED ANNUALLY			--	--	--	--	--	--
08/15/03	7.21	MONITORED/SAMPLED ANNUALLY			--	--	--	--	--	--
11/14/03	7.21	MONITORED/SAMPLED ANNUALLY			--	--	--	--	--	--
02/13/04 ¹⁵	7.21	3.94	3.27	0.00	<50	<0.5	<0.5	<0.5	<0.5	<0.5
05/14/04	7.21	MONITORED/SAMPLED ANNUALLY			--	--	--	--	--	--
11/12/04	7.21	MONITORED/SAMPLED ANNUALLY			--	--	--	--	--	--
02/11/05 ¹⁵	7.21	3.66	3.55	0.00	<50	<0.5	<0.5	<0.5	<0.5	<0.5
05/13/05	7.21	MONITORED/SAMPLED ANNUALLY			--	--	--	--	--	--
08/19/05	7.21	MONITORED/SAMPLED ANNUALLY			--	--	--	--	--	--
11/18/05	7.21	MONITORED/SAMPLED ANNUALLY			--	--	--	--	--	--
02/10/06 ¹⁵	7.21	3.53	3.68	0.00	<0.5	<0.5	<0.5	<0.5	<0.5	<0.5
05/12/06	7.21	MONITORED/SAMPLED ANNUALLY			--	--	--	--	--	--
08/11/06	7.21	MONITORED/SAMPLED ANNUALLY			--	--	--	--	--	--
11/17/06	7.21	MONITORED/SAMPLED ANNUALLY			--	--	--	--	--	--
02/16/07 ¹⁵	7.21	3.50	3.71	0.00	<50	<0.5	<0.5	<0.5	<0.5	<0.5
05/17/07	7.21	MONITORED/SAMPLED ANNUALLY			--	--	--	--	--	--
08/09/07	7.21	MONITORED/SAMPLED ANNUALLY			--	--	--	--	--	--
11/08/07	7.21	MONITORED/SAMPLED ANNUALLY			--	--	--	--	--	--
02/06/08 ¹⁵	7.21	3.14	4.07	0.00	<50	<0.5	<0.5	<0.5	<0.5	<0.5
05/07/08	7.21	MONITORED/SAMPLED ANNUALLY			--	--	--	--	--	--
09/11/08	7.21	MONITORED/SAMPLED ANNUALLY			--	--	--	--	--	--
11/10/08	7.21	MONITORED/SAMPLED ANNUALLY			--	--	--	--	--	--
02/09/09 ¹⁵	7.21	3.91	3.30	0.00	<50	<0.5	<0.5	<0.5	<0.5	<0.5
05/28/09	7.21	MONITORED/SAMPLED ANNUALLY			--	--	--	--	--	--
08/18/09	7.21	MONITORED/SAMPLED ANNUALLY			--	--	--	--	--	--
MW-10										
10/17/95	7.28	5.05	2.23	--	--	--	--	--	--	--
10/30/95	7.28	5.11	2.17	--	<50	<0.5	<0.5	<0.5	<0.5	5.1

**GROUNDWATER MONITORING DATA AND ANALYTICAL RESULTS
FORMER CHEVRON SERVICE STATION 9-1153
3135 GIBBONS DRIVE (3126 FERNSIDE BOULEVARD), ALAMEDA, CALIFORNIA**

WELL ID/ DATE	TOC* (ft-msl)	DTW (ft.)	GWE (ft-msl)	LNAPLT (ft.)	TPHg (µg/L)	B (µg/L)	T (µg/L)	E (µg/L)	X (µg/L)	MTBE (µg/L)	
MW-10 (cont)											
01/22/96	7.28	4.03	3.25	--	<50	<0.5	<0.5	<0.5	0.70	17	
04/24/96	7.28	4.30	2.98	--	<50	<0.5	<0.5	<0.5	<0.5	12	
07/29/96	7.28	4.70	2.58	--	<50	<0.5	<0.5	<0.5	<0.5	14	
10/10/96	7.28	5.24	2.04	--	<50	<0.5	<0.5	<0.5	<0.5	<2.5	
01/15/97	7.28	3.35	3.93	--	<50	<0.5	<0.5	<0.5	<0.5	<2.5	
04/03/97	7.28	4.64	2.64	--	<50	<0.5	<0.5	<0.5	<0.5	8.2	
07/09/97	7.28	5.12	2.16	--	<50	<0.5	<0.5	<0.5	<0.5	<2.5	
10/29/97	7.28	5.10	2.18	--	<50	<0.5	<0.5	<0.5	<0.5	5.3	
01/14/98	7.28	3.08	4.20	--	<50	<0.5	<0.5	<0.5	<0.5	8.6	
04/17/98	7.28	3.79	3.49	--	SAMPLED SEMI-ANNUALLY					--	--
07/15/98	7.28	4.55	2.73	--	<50	<0.5	<0.5	<0.5	<0.5	7.5	
10/27/98	7.28	5.32	1.96	--	--	--	--	--	--	--	
01/20/99	7.28	4.24	3.04	--	<50	<0.5	<0.5	<0.5	<0.5	<2.0	
04/19/99	7.28	4.07	3.21	--	--	--	--	--	--	--	
07/29/99	7.28	4.82	2.46	--	<50	<0.5	<0.5	<0.5	<0.5	<5.0/2.4 ²	
10/13/99	7.28	4.86	2.42	--	--	--	--	--	--	--	
01/25/00	7.28	3.00	4.28	--	<50	<0.5	<0.5	<0.5	<0.5	4.33	
04/03/00	7.28	3.04	4.24	0.00	--	--	--	--	--	--	
07/03/00	7.28	4.00	3.28	0.00	<50	<0.50	<0.50	<0.50	<0.50	4.7	
10/23/00	7.28	5.86	1.42	0.00	--	--	--	--	--	--	
01/08/01 ¹¹	7.28	3.98	3.30	0.00	<50	<0.50	<0.50	<0.50	<0.50	<2.5	
04/09/01	7.28	3.74	3.54	0.00	--	--	--	--	--	--	
08/23/01	7.28	INACCESSIBLE - DUE TO TRAFFIC CONTROL				--	--	--	--	--	--
11/27/01	7.28	4.13	3.15	0.00	SAMPLED SEMI-ANNUALLY					--	--
02/26/02	7.28	3.54	3.74	0.00	<50	<0.50	<0.50	<0.50	<1.5	<2.5	
05/23/02	7.28	3.82	3.46	0.00	SAMPLED SEMI-ANNUALLY					--	--
08/09/02	7.28	4.18	3.10	0.00	<50	<0.50	<0.50	<0.50	<1.5	<2.5	
11/08/02	7.28	3.91	3.37	0.00	SAMPLED SEMI-ANNUALLY					--	--
02/07/03	7.28	3.61	3.67	0.00	<50	<0.50	<0.50	<0.50	<1.5	<2.5	
05/09/03	7.28	3.25	4.03	0.00	SAMPLED SEMI-ANNUALLY					--	--
08/15/03 ¹⁵	7.28	4.35	2.93	0.00	<50	<0.5	<0.5	<0.5	<0.5	<0.5	
11/14/03	7.28	4.30	2.98	0.00	SAMPLED SEMI-ANNUALLY					--	--
02/13/04 ¹⁵	7.28	4.27	3.01	0.00	<50	<0.5	<0.5	<0.5	<0.5	<0.5	
05/14/04	7.28	4.08	3.20	0.00	SAMPLED SEMI-ANNUALLY					--	--
08/13/04 ¹⁵	7.28	3.92	3.36	0.00	<50	<0.5	<0.5	<0.5	<0.5	<0.5	
11/12/04	7.28	3.98	3.30	0.00	SAMPLED SEMI-ANNUALLY					--	--

**GROUNDWATER MONITORING DATA AND ANALYTICAL RESULTS
FORMER CHEVRON SERVICE STATION 9-1153
3135 GIBBONS DRIVE (3126 FERNSIDE BOULEVARD), ALAMEDA, CALIFORNIA**

WELL ID/ DATE	TOC* (ft-msl)	DTW (ft.)	GWE (ft-msl)	LNAPLT (ft.)	TPHg (µg/L)	B (µg/L)	T (µg/L)	E (µg/L)	X (µg/L)	MTBE (µg/L)
MW-10 (cont)										
02/11/05 ¹⁵	7.28	4.07	3.21	0.00	<50	<0.5	<0.5	<0.5	<0.5	<0.5
05/13/05	7.28	4.01	3.27	0.00	SAMPLED SEMI-ANNUALLY	--	--	--	--	--
08/19/05 ¹⁵	7.28	3.69	3.59	0.00	<50	<0.5	<0.5	<0.5	<0.5	<0.5
11/18/05	7.28	3.86	3.42	0.00	SAMPLED SEMI-ANNUALLY	--	--	--	--	--
02/10/06 ¹⁵	7.28	3.94	3.34	0.00	<0.5	<0.5	<0.5	<0.5	<0.5	<0.5
05/12/06	7.28	4.07	3.21	0.00	SAMPLED SEMI-ANNUALLY	--	--	--	--	--
08/11/06 ¹⁵	7.28	4.21	3.07	0.00	<50	<0.5	<0.5	<0.5	<0.5	<0.5
11/17/06	7.28	3.83	3.45	0.00	SAMPLED SEMI-ANNUALLY	--	--	--	--	--
02/16/07 ¹⁵	7.28	3.87	3.41	0.00	<50	<0.5	<0.5	<0.5	<0.5	<0.5
05/17/07	7.28	3.71	3.57	0.00	SAMPLED SEMI-ANNUALLY	--	--	--	--	--
08/09/07	7.28	INACCESSIBLE	--	--	--	--	--	--	--	--
11/08/07	7.28	INACCESSIBLE	--	--	--	--	--	--	--	--
02/06/08	7.28	INACCESSIBLE	--	--	--	--	--	--	--	--
05/07/08	7.28	INACCESSIBLE	--	--	--	--	--	--	--	--
09/11/08 ¹⁵	7.28	4.63	2.65	0.00	<50	<0.5	<0.5	<0.5	<0.5	<0.5
11/10/08	7.28	4.28	3.00	0.00	SAMPLED SEMI-ANNUALLY	--	--	--	--	--
02/09/09 ¹⁵	NP	7.28	2.17	5.11	0.00	<50	<0.5	<0.5	<0.5	<0.5
05/28/09	7.28	3.69	3.59	--	--	--	--	--	--	--
08/18/09¹⁵	7.28	4.07	3.21	0.00	<50	<0.5	<0.5	<0.5	<0.5	<0.5
C-2										
08/18/86	--	--	--	--	--	--	--	--	--	--
09/04/86	--	--	--	--	1,100	49	18	84	--	--
07/22/87	--	--	--	--	<50	1.8	<1.0	<4.0	--	--
ABANDONED										
TMW-1										
11/11/93	--	--	--	--	<1.0	<0.5	<0.5	<0.5	<0.5	--
NOT MONITORED/SAMPLED										
3115A GIBBONS DR.										
01/14/98	--	--	--	--	<50	<0.5	<0.5	<0.5	<0.5	<2.5
TRIP BLANK										
TB-LB										
02/14/90	--	--	--	--	<50	<0.5	1.1	<0.5	<0.5	--

GROUNDWATER MONITORING DATA AND ANALYTICAL RESULTS
FORMER CHEVRON SERVICE STATION 9-1153
3135 GIBBONS DRIVE (3126 FERNSIDE BOULEVARD), ALAMEDA, CALIFORNIA

WELL ID/ DATE	TOC* (ft-msl)	DTW (ft.)	GWE (ft-msl)	LNAPLT (ft.)	TPHg (µg/L)	B (µg/L)	T (µg/L)	E (µg/L)	X (µg/L)	MTBE (µg/L)
Trip Blank (cont)										
09/06/91	--	--	--	--	<50	<0.5	<0.5	<0.5	<0.5	--
12/15/91	--	--	--	--	<50	<0.5	<0.5	<0.5	<0.5	--
03/03/92	--	--	--	--	<50	<0.5	<0.5	<0.5	<0.5	--
06/04/92	--	--	--	--	<50	<0.5	<0.5	<0.5	<0.5	--
10/13/92	--	--	--	--	<50	<0.5	<0.5	<0.5	<0.5	--
01/11/93	--	--	--	--	<50	<0.5	<0.5	<0.5	<0.5	--
04/14/93	--	--	--	--	<50	<0.5	<0.5	<0.5	<0.5	--
07/13/93	--	--	--	--	<50	<0.5	<0.5	<0.5	<0.5	--
10/19/93	--	--	--	--	<50	<0.5	<0.5	<0.5	<1.5	--
01/27/94	--	--	--	--	<50	<0.5	<0.5	<0.5	<0.5	--
04/07/94	--	--	--	--	<50	<0.5	<0.5	<0.5	<0.5	--
07/01/94	--	--	--	--	<50	<0.5	<0.5	<0.5	<0.5	--
10/05/94	--	--	--	--	<50	<0.5	<0.5	<0.5	<0.5	--
01/12/95	--	--	--	--	<50	<0.5	<0.5	<0.5	<0.5	--
04/26/95	--	--	--	--	<50	<0.5	<0.5	<0.5	<0.5	--
07/12/95	--	--	--	--	<50	<0.5	<0.5	<0.5	<0.5	--
10/30/95	--	--	--	--	<50	<0.5	<0.5	<0.5	<0.5	--
01/22/96	--	--	--	--	<50	<0.5	<0.5	<0.5	<0.5	<2.5
04/24/96	--	--	--	--	<50	<0.5	<0.5	<0.5	<0.5	<2.5
07/29/96	--	--	--	--	<50	<0.5	<0.5	<0.5	<0.5	<2.5
10/10/96	--	--	--	--	--	--	--	--	--	--
01/15/97	--	--	--	--	<50	<0.5	<0.5	<0.5	<0.5	<2.5
04/03/97	--	--	--	--	<50	<0.5	<0.5	<0.5	<0.5	<2.5
07/09/97	--	--	--	--	<50	<0.5	<0.5	<0.5	<0.5	<2.5
10/29/97	--	--	--	--	<50	<0.5	<0.5	<0.5	<0.5	<2.5
01/14/98	--	--	--	--	<50	<0.5	<0.5	<0.5	<0.5	<2.5
04/17/98	--	--	--	--	<50	<0.5	<0.5	<0.5	<0.5	<2.5
07/15/98	--	--	--	--	<50	<0.5	<0.5	<0.5	<0.5	<2.5
10/27/98	--	--	--	--	<50	<0.5	<0.5	<0.5	<0.5	<2.5
01/20/99	--	--	--	--	<50	<0.5	<0.5	<0.5	<0.5	<2.0
04/19/99	--	--	--	--	<50	<0.5	<0.5	<0.5	<0.5	<2.5
07/29/99	--	--	--	--	<50	<0.5	<0.5	<0.5	<0.5	<5.0
10/13/99	--	--	--	--	<50	<0.5	<0.5	<0.5	<0.5	<2.5
01/25/00	--	--	--	--	<50	<0.5	<0.5	<0.5	<0.5	<2.5
04/03/00	--	--	--	--	<50	<0.50	<0.50	<0.50	<0.50	<2.5
07/03/00	--	--	--	--	<50	<0.50	<0.50	<0.50	<0.50	<2.5

GROUNDWATER MONITORING DATA AND ANALYTICAL RESULTS
FORMER CHEVRON SERVICE STATION 9-1153
3135 GIBBONS DRIVE (3126 FERNSIDE BOULEVARD), ALAMEDA, CALIFORNIA

WELL ID/ DATE	TOC* (ft-msl)	DTW (ft.)	GWE (ft-msl)	LNAPLT (ft.)	TPHg (µg/L)	B (µg/L)	T (µg/L)	E (µg/L)	X (µg/L)	MTBE (µg/L)
Trip Blank (cont)										
10/23/00	--	--	--	--	<50	<0.50	<0.50	<0.50	<0.50	<2.5
01/08/01 ¹¹	--	--	--	--	<50	<0.50	<0.50	<0.50	<0.50	<2.5
04/09/01	--	--	--	--	<50.0	<0.500	<2.00	<0.500	<2.00	<0.500
08/23/01	--	--	--	--	<50	<0.50	<0.50	<0.50	<0.50	<2.5
11/27/01	--	--	--	--	<50	<0.50	<0.50	<0.50	<1.5	<2.5
02/26/02	--	--	--	--	<50	<0.50	<0.50	<0.50	<1.5	<2.5
05/23/02	--	--	--	--	<50	<0.50	<0.50	<0.50	<1.5	<2.5
08/09/02	--	--	--	--	<50	<0.50	<0.50	<0.50	<1.5	<2.5
11/08/02	--	--	--	--	<50	<0.50	<0.50	<0.50	<1.5	<2.5
02/07/03	--	--	--	--	<50	<0.50	<0.50	<0.50	<1.5	<2.5
05/09/03	--	--	--	--	<50	<0.5	<0.5	<0.5	<1.5	<2.5
08/15/03 ¹⁵	--	--	--	--	<50	<0.5	<0.5	<0.5	<0.5	<0.5
11/14/03	--	--	--	--	<50	<0.5	<0.5	<0.5	<0.5	<0.5
02/13/04 ¹⁵	--	--	--	--	<50	<0.5	<0.5	<0.5	<0.5	<0.5
05/14/04 ¹⁵	--	--	--	--	<50	<0.5	<0.5	<0.5	<0.5	<0.5
QA										
08/13/04 ¹⁵	--	--	--	--	<50	<0.5	<0.5	<0.5	<0.5	<0.5
11/12/04 ¹⁵	--	--	--	--	<50	<0.5	<0.5	<0.5	<0.5	<0.5
02/11/05 ¹⁵	--	--	--	--	<50	<0.5	<0.5	<0.5	<0.5	<0.5
05/13/05 ¹⁵	--	--	--	--	<50	<0.5	<0.5	<0.5	<0.5	<0.5
08/19/05 ¹⁵	--	--	--	--	<50	<0.5	<0.5	<0.5	<0.5	<0.5
11/18/05 ¹⁵	--	--	--	--	<50	<0.5	<0.5	<0.5	<0.5	<0.5
02/10/06 ¹⁵	--	--	--	--	<50	<0.5	<0.5	<0.5	<0.5	<0.5
05/12/06 ¹⁵	--	--	--	--	<50	<0.5	<0.5	<0.5	<0.5	<0.5
08/11/06 ¹⁵	--	--	--	--	<50	<0.5	<0.5	<0.5	<0.5	<0.5
11/17/06 ¹⁵	--	--	--	--	<50	<0.5	<0.5	<0.5	<0.5	<0.5
02/16/07 ¹⁵	--	--	--	--	<50	<0.5	<0.5	<0.5	<0.5	<0.5
05/17/07 ¹⁵	--	--	--	--	<50	<0.5	<0.5	<0.5	<0.5	<0.5
08/09/07 ¹⁵	--	--	--	--	<50	<0.5	<0.5	<0.5	<0.5	<0.5
11/08/07 ¹⁵	--	--	--	--	<50	<0.5	<0.5	<0.5	<0.5	<0.5
02/06/08 ¹⁵	--	--	--	--	<50	<0.5	<0.5	<0.5	<0.5	<0.5
05/07/08 ¹⁵	--	--	--	--	<50	<0.5	<0.5	<0.5	<0.5	<0.5
09/11/08 ¹⁵	--	--	--	--	<50	<0.5	<0.5	<0.5	<0.5	<0.5
11/10/08 ¹⁵	--	--	--	--	<50	<0.5	<0.5	<0.5	<0.5	<0.5
02/09/09 ¹⁵	--	--	--	--	<50	<0.5	<0.5	<0.5	<0.5	<0.5

**GROUNDWATER MONITORING DATA AND ANALYTICAL RESULTS
FORMER CHEVRON SERVICE STATION 9-1153
3135 GIBBONS DRIVE (3126 FERNSIDE BOULEVARD), ALAMEDA, CALIFORNIA**

WELL ID/ DATE	TOC* (ft-msl)	DTW (ft.)	GWE (ft-msl)	LNAPLT (ft.)	TPHg (µg/L)	B (µg/L)	T (µg/L)	E (µg/L)	X (µg/L)	MTBE (µg/L)
QA (cont) 05/28/09 ¹⁵	--	--	--	--	<50	<0.5	<0.5	<0.5	<0.5	<0.5

EXPLANATIONS:

Groundwater monitoring data and laboratory analytical results prior to April 3, 2000, were compiled from reports prepared by Blaine Tech Services, Inc.

TOC = Top of Casing (ft.) = Feet	TPHg = Total Petroleum Hydrocarbons as Gasoline B = Benzene	MTBE = Methyl Tertiary Butyl Ether (µg/L) = Micrograms per liter
DTW = Depth to Water	T = Toluene	-- = Not Measured/Not Analyzed
GWE = Groundwater Elevation (ft-msl) = Feet above mean sea level	E = Ethylbenzene	QA = Quality Assurance/Trip Blank
LNAPLT = Light Non-Aqueous Phase Liquid Thickness	X = Xylenes	NP= No Purge

* TOC elevations are referenced to msl.

** GWE has been corrected due to the presence of LNAPL; correction factor: [(TOC - DTW) + (LNAPLT x 0.80)].

1 Laboratory report indicates EPA 8010 were not detected (ND).

2 MTBE confirmed.

3 Chromatogram report indicates an unidentified hydrocarbon.

4 ORC installed.

5 TOC elevation altered due to well head maintenance.

6 Laboratory report indicates gasoline C6-C12.

7 ORC in well.

8 Laboratory report indicates Dissolved Oxygen was 1.50 parts per million (ppm) by EPA Method 360.1.

9 Laboratory report indicates Dissolved Oxygen was 0.300 ppm by EPA Method 360.1.

10 Laboratory report indicates sample originally shot in hold time at a raise D.L. re-analyzed and reported past hold time.

11 Laboratory report indicates this sample was analyzed outside of the EPA recommended holding time.

12 Laboratory report indicates unidentified hydrocarbons C6-C12.

13 Laboratory report indicates hydrocarbon pattern is present in the requested fuel quantitation range but does not resemble the pattern of the requested fuel.

14 ORC removed.

15 BTEX and MTBE by EPA Method 8260.

16 Laboratory confirmed analytical result.

17 The vial submitted did not have pH<2. The pH of this sample used for the undiluted analysis was pH = 3.

**LIGHT NON-AQUEOUS PHASE LIQUID THICKNESS AND REMOVAL DATA
FORMER CHEVRON SERVICE STATION 9-1153
3135 GIBBONS DRIVE (3126 FERNSIDE BOULEVARD), ALAMEDA, CALIFORNIA**

<i>WELL ID</i>	<i>DATE</i>	<i>DTW (ft.)</i>	<i>LNAPLT (ft.)</i>	<i>AMOUNT BAILED (LNAPL + Water) (gallons)</i>	<i>TOTAL BAILED (LNAPL + Water) (gallons)</i>
C-1	08/18/86	4.10	--	--	--
	09/04/86	--	--	--	--
	07/22/87	--	--	--	--
	05/03/89	4.46	--	--	--
	12/04/89	4.16	--	--	--
	02/14/90	3.64	--	--	--
	03/07/90	3.36	--	--	--
	09/06/91	4.43	--	--	--
	12/15/91	4.78	--	--	--
	03/03/92	2.39	--	--	--
	06/04/92	4.08	--	--	--
	10/13/92	4.75	--	--	--
	01/11/93	2.26	Sheen	--	--
	04/14/93	2.90	Sheen	--	--
	07/13/93	3.97	Sheen	--	--
	10/19/93	4.50	--	--	--
	11/30/93	4.27	--	--	--
	01/27/94	3.35	--	--	--
	04/07/94	3.42	--	--	--
	07/01/94	3.96	--	--	--
	10/05/94	4.39	--	--	--
	01/12/95	1.52	0.50	0.26	0.26
	04/26/95	4.40	2.20	1.32	1.59
	07/12/95	4.85	1.81	0.66	2.25
	10/30/95	5.67	1.63	0.53	2.77
	01/04/96	3.92	0.12	0.26	3.04
	01/10/96	3.48	0.13	0.07	3.10
	01/17/96	3.40	0.02	0.40	3.50
	01/22/96	2.90	0.00	0.00	3.50
	02/23/96	4.10	1.86	0.66	4.16
	02/28/96	--	>0.83	1.25	5.41
	03/08/96	2.86	1.83	0.26	5.68
	03/08/96	2.30	0.36	0.53	6.20
	03/08/96	2.33	0.36	0.26	6.47
	03/08/96	2.28	0.22	0.53	7.00
	03/26/96	3.96	1.28	0.40	7.39

**LIGHT NON-AQUEOUS PHASE LIQUID THICKNESS AND REMOVAL DATA
FORMER CHEVRON SERVICE STATION 9-1153
3135 GIBBONS DRIVE (3126 FERNSIDE BOULEVARD), ALAMEDA, CALIFORNIA**

<i>WELL ID</i>	<i>DATE</i>	<i>DTW (ft.)</i>	<i>LNAPLT (ft.)</i>	<i>AMOUNT BAILED (LNAPL + Water) (gallons)</i>	<i>TOTAL BAILED (LNAPL + Water) (gallons)</i>
C-1 (cont)	04/11/96	5.61	1.75	0.53	7.92
	04/19/96	3.09	0.04	0.40	8.32
	04/24/96	3.04	0.03	0.40	8.71
	05/03/96	4.02	0.46	0.40	9.11
	05/03/96	3.89	0.47	0.00	9.11
	05/08/96	4.25	0.35	0.07	9.17
	05/17/96	3.24	0.04	0.03	9.20
	05/17/96	3.35	0.01	0.03	9.23
	05/17/96	3.43	0.01	0.03	9.26
	05/17/96	3.65	0.01	0.00	9.26
	05/22/96	3.10	0.07	0.08	9.34
	06/18/96	4.68	0.48	0.26	9.60
	07/03/96	5.03	0.13	0.15	9.75
	07/09/96	4.63	0.23	0.09	9.84
	07/17/96	4.73	0.15	0.32	10.16
	07/29/96	5.10	0.09	0.26	10.42
	08/02/96	5.68	0.03	0.03	10.45
	08/07/96	5.16	0.01	0.13	10.59
	08/23/96	5.75	0.03	0.03	10.61
	08/28/96	5.53	0.03	0.01	10.63
	09/06/96	5.38	--	0.05	10.67
	09/12/96	5.48	0.03	0.01	10.68
	09/19/96	6.32	0.03	0.01	10.69
	10/10/96	4.58	0.10	0.13	10.83
	10/17/96	5.61	0.01	0.01	10.84
	10/29/96	6.01	--	--	10.84
	11/07/96	5.56	0.04	0.13	10.97
	11/11/96	5.32	0.04	0.13	11.10
	12/20/96	3.33	0.03	0.05	11.16
	12/17/96	3.73	0.01	0.01	11.17
	01/15/97	2.74	--	--	11.17
	01/22/97	1.37	0.19	0.07	11.23
	02/04/97	2.98	0.51	0.15	11.38
	02/20/97	4.09	0.13	0.11	11.48
	03/06/97	3.75	0.56	1.19	12.67
	03/14/97	3.82	0.03	0.12	12.79

**LIGHT NON-AQUEOUS PHASE LIQUID THICKNESS AND REMOVAL DATA
FORMER CHEVRON SERVICE STATION 9-1153
3135 GIBBONS DRIVE (3126 FERNSIDE BOULEVARD), ALAMEDA, CALIFORNIA**

<i>WELL ID</i>	<i>DATE</i>	<i>DTW (ft.)</i>	<i>LNAPLT (ft.)</i>	<i>AMOUNT BAILED (LNAPL + Water) (gallons)</i>	<i>TOTAL BAILED (LNAPL + Water) (gallons)</i>
C-1 (cont)	03/20/97	3.73	0.03	0.01	12.80
	03/25/97	4.32	0.01	--	12.80
	03/31/97	3.71	0.03	0.00	12.81
	04/03/97	4.60	0.03	0.00	12.81
	04/09/97	4.25	0.02	0.03	12.84
	04/24/97	4.65	0.02	0.01	12.84
	04/30/97	3.50	0.02	0.01	12.85
	05/22/97	4.97	--	0.01	12.86
	06/03/97	3.62	0.06	0.01	12.86
	07/09/97	4.30	0.06	0.13	13.00
	08/12/97	5.18	0.00	0.05	13.05
	09/30/97	5.25	0.50	0.07	13.12
	10/29/97	5.33	0.03	0.02	13.14
	11/13/97	4.86	0.02	0.03	13.16
	12/18/97	2.34	--	--	13.16
	01/14/98	0.25	0.02	0.13	13.29
	02/02/98	2.35	0.05	0.03	13.32
	03/16/98	2.50	0.50	0.13	13.45
	04/17/98	2.65	0.40	0.11	13.56
	05/01/98	2.39	0.04	0.26	13.82
	06/17/98	3.26	0.08	0.03	13.86
	07/15/98	3.55	--	--	13.86
	09/01/98	4.00	--	--	13.86
	10/27/98	4.48	--	--	13.86
	11/19/98	3.89	--	--	13.86
	12/19/98	2.13	0.02	0.04	13.90
	01/20/99	3.98	--	--	13.90
	02/24/99	2.55	--	--	13.90
	03/26/99	2.14	0.76	0.26	14.16
	04/19/99	1.04	--	--	14.16
	04/19/99	1.04	--	--	--
	07/29/99	3.76	0.02	0.01	14.17
	08/30/99	4.30	--	--	14.17
	09/23/99	3.84	0.02	0.03	14.20
	10/13/99	1.27	--	--	14.20
	11/17/99	3.59	--	--	--

**LIGHT NON-AQUEOUS PHASE LIQUID THICKNESS AND REMOVAL DATA
FORMER CHEVRON SERVICE STATION 9-1153
3135 GIBBONS DRIVE (3126 FERNSIDE BOULEVARD), ALAMEDA, CALIFORNIA**

<i>WELL ID</i>	<i>DATE</i>	<i>DTW (ft.)</i>	<i>LNAPLT (ft.)</i>	<i>AMOUNT BAILED (LNAPL + Water) (gallons)</i>	<i>TOTAL BAILED (LNAPL + Water) (gallons)</i>
C-1 (cont)	12/08/99	3.79	--	--	--
	01/25/00	1.99	0.04	0.03	14.23
	04/03/00	2.20	0.10	0.00	14.23
	05/26/00	2.52	0.23	0.26	14.49
	06/19/00 ¹	2.89	0.19	0.26	14.75
	07/03/00	3.45	0.25	0.26	15.01
	08/01/00	3.78	0.16	0.10	15.11
	09/30/00	4.03	0.04	0.26	15.37
	10/23/00	4.15	0.03	0.26	15.63
	11/21/00	3.42	0.00	0.26	15.89
	12/22/00	2.96	0.00	0.26	16.15
	01/08/01	2.94	0.00	0.26	16.41
	02/17/01	2.09	0.59	0.26	16.67
	03/13/01	2.20	0.76	0.26	16.93
	04/09/01	2.45	0.26	0.26	17.19
	05/18/01	2.70	0.59	0.26	17.45
	06/12/01	3.50	0.97	0.26	17.71
	07/19/01	4.25	0.95	0.26	17.97
	08/23/01	4.34	0.07	0.26	18.23
	09/17/01	4.39	0.08	0.00	18.23
	10/08/01	4.45	0.04	0.02	18.25
	11/27/01	3.89	0.00	0.00	18.25
	12/17/01	1.81	0.00	0.00	18.25
	01/07/02	2.27	0.51	1.50	19.75
	02/26/02	2.70	0.52	0.13	19.88
	03/27/02	2.87	1.05	0.26	20.14
	04/08/02	2.45	1.23	0.53	20.67
	05/23/02	3.57	0.52	0.12	20.79
	06/17/02	3.90	0.35	0.07	20.86
	07/31/02	4.12	0.20	0.02	20.88
	08/09/02	4.15	0.16	0.02	20.90
	09/17/02	4.33	0.12	0.01	20.91
	10/15/02	4.51	0.15	0.04	20.95
	11/08/02	4.11	0.00	0.00	20.95
	12/19/02	1.14	0.00	0.00	20.95
	01/14/03	1.80	0.00	0.00	20.95

**LIGHT NON-AQUEOUS PHASE LIQUID THICKNESS AND REMOVAL DATA
FORMER CHEVRON SERVICE STATION 9-1153
3135 GIBBONS DRIVE (3126 FERNSIDE BOULEVARD), ALAMEDA, CALIFORNIA**

<i>WELL ID</i>	<i>DATE</i>	<i>DTW (ft.)</i>	<i>LNAPLT (ft.)</i>	<i>AMOUNT BAILED (LNAPL + Water) (gallons)</i>	<i>TOTAL BAILED (LNAPL + Water) (gallons)</i>
C-1 (cont)	02/07/03	2.95	0.30	0.05	21.00
	03/20/03	2.86	0.41	0.13	21.13
	04/15/03	2.12	0.10	0.03	21.16
	05/09/03	2.95	0.70	0.22	21.38
	06/27/03	3.97	0.50	0.11	21.49
	07/16/03	3.68	0.28	0.04	21.53
	08/15/03	4.29	0.22	0.03	21.56
	09/26/03	4.60	0.19	0.04	21.60
	10/18/03	4.72	0.15	0.02	21.62
	11/14/03	4.31	0.20	0.04	21.66
	12/23/03	1.81	0.00	0.00	21.66
	01/22/04	4.19	0.01	0.25 ^c	21.91
	02/13/04	3.04	0.04	0.27	22.18
	03/11/04	1.85	0.40	0.04	22.22
	04/22/04	3.08	0.22	0.66	22.88
	05/14/04	3.49	0.03	0.54	23.42
	06/18/04	3.41	0.13	0.63	24.05
	07/23/04	3.28	0.11	0.59	24.64
	08/13/04	3.14	0.05	1.02	25.66
	09/13/04	4.53	0.09	0.03	25.69
	10/22/04	3.19	0.03	1.02	26.71
	11/12/04	3.22	0.03	0.51	27.22
	12/02/04	3.28	0.02	0.26	27.48
	01/28/05	3.19	0.01	0.51	27.99
	02/11/05	2.75	0.04	0.53	28.52
	03/11/05	2.94	0.03	1.02	29.54
	04/26/05	3.03	0.02	1.02	30.56
	05/13/05	3.18	0.02	1.02	31.58
	06/01/05	3.22	0.02	0.51	32.09
	07/15/05	3.09	0.02	1.51	33.60
	08/19/05	2.88	0.03	1.53	35.13
	09/23/05	2.95	0.02	1.02	36.15
	10/14/05	3.01	0.01	0.52	36.67
	11/18/05	3.21	0.02	1.02	37.69
	12/09/05	3.61	0.01	1.01	38.70
	01/12/06	2.98	0.01	0.51	39.21

**LIGHT NON-AQUEOUS PHASE LIQUID THICKNESS AND REMOVAL DATA
FORMER CHEVRON SERVICE STATION 9-1153
3135 GIBBONS DRIVE (3126 FERNSIDE BOULEVARD), ALAMEDA, CALIFORNIA**

<i>WELL ID</i>	<i>DATE</i>	<i>DTW (ft.)</i>	<i>LNAPLT (ft.)</i>	<i>AMOUNT BAILED (LNAPL + Water) (gallons)</i>	<i>TOTAL BAILED (LNAPL + Water) (gallons)</i>
C-1 (cont)	02/10/06	2.69	0.01	0.50 ⁺	39.71
	03/13/06	2.81	0.01	1.00 [±]	40.71
	04/13/06	2.75	0.01	0.50 [±]	41.22
	05/12/06	3.02	0.01	0.50 [±]	41.72
	06/12/06	3.10	0.01	0.50 [±]	42.22
	07/13/06	3.14	0.02	1.01	43.23
	08/11/06	3.70	0.01	1.01	44.24
	09/11/06	3.75	0.02	1.02	45.26
	10/17/06	3.82	0.01	1.02	46.28
	11/17/06	3.11	0.03	1.02	47.30
	12/15/06	2.95	0.02	1.02	48.32
	01/16/07	2.98	0.02	0.52	48.84
	02/16/07	2.77	0.00	0.00	48.84
	03/16/07	3.07	0.01	0.51 [±]	49.35
	04/17/07	2.98	0.01	0.50 [±]	49.85
	05/17/07	3.05	0.01	0.51 [±]	50.36
	06/15/07	3.08	0.01	1.02	51.38
	07/17/07	3.13	0.01	0.50 [±]	51.88
	08/09/07	3.24	0.02	0.52	52.40
	09/14/07	3.16	0.01	0.26 [±]	52.67
	10/16/07	3.04	0.01	0.26 [±]	52.93
	11/08/07	3.11	0.01	0.00	52.93
	12/07/07	2.98	0.03	0.55	53.48
	01/16/08	2.95	0.02	0.27	53.75
	02/06/08	2.61	0.01	0.00	53.75
	03/07/08	2.87	0.02	0.40 [±]	54.16
	04/16/08	3.06	0.02	0.55	54.71
	05/07/08	2.98	0.03	0.55	55.26
	06/06/08	3.04	0.02	0.55	55.81
	07/16/08	3.12	0.02	0.41	56.22
	09/05/08	3.97	0.28	0.61	56.83
	09/11/08	4.22	0.41	0.92	57.75
	10/17/08	4.16	0.33	0.64	58.39
	11/10/08	4.05	0.11	0.32	58.71
	12/15/08	3.85	0.05	0.30	59.01
	01/21/09	3.91	0.04	0.29	59.30
	02/09/09	3.72	0.01	0.14	59.44

**LIGHT NON-AQUEOUS PHASE LIQUID THICKNESS AND REMOVAL DATA
FORMER CHEVRON SERVICE STATION 9-1153
3135 GIBBONS DRIVE (3126 FERNSIDE BOULEVARD), ALAMEDA, CALIFORNIA**

<i>WELL ID</i>	<i>DATE</i>	<i>DTW (ft.)</i>	<i>LNAPLT (ft.)</i>	<i>AMOUNT BAILED (LNAPL + Water) (gallons)</i>	<i>TOTAL BAILED (LNAPL + Water) (gallons)</i>
C-1 (cont)	03/16/09	3.81	0.02	0.15	59.59
	05/28/09	3.48	0.02	0.01	59.60
	08/18/09	4.40	0.02	0.01	59.61

EXPLANATIONS:

Groundwater monitoring data prior to July 3, 2000, were compiled from reports prepared by Blaine Tech Services, Inc.

DTW = Depth to Water

(ft.) = Feet

LNAPLT = Light Non-Aqueous Phase Liquid Thickness

-- = Not Measured

- 1 There is no skimmer present in this well.
- 2 Removed less than one ounce of LNAPL from well.
- 3 Removed 0.5 ounces of LNAPL from well.
- 4 Removed 1 ounce of LNAPL from well.

**DISSOLVED OXYGEN CONCENTRATIONS
FORMER CHEVRON SERVICE STATION 9-1153
3135 GIBBONS DRIVE (3126 FERNSIDE BOULEVARD), ALAMEDA, CALIFORNIA**

WELL ID	DATE	PRE-PURGE (mg/L)	POST-PURGE (mg/L)
MW-6	11/08/02	2.10	--
	02/07/03	2.60	--
	05/09/03	3.10	--
	08/15/03	2.90	--
	11/14/03	3.41	--
	08/19/05	1.90	--
	11/18/05	1.70	--
	02/10/06	2.20	--
	05/12/06	2.80	--
	08/11/06	2.50	--
	11/17/06	2.20	--
	02/16/07	1.80	--
	05/17/07	2.0	--
	08/09/07	2.6	--
	11/08/07	2.2	--
	02/06/08	2.4	--
	05/07/08	2.3	--
	09/11/08	1.9	--
	11/10/08	2.2	--
	02/09/09	2.0	--
05/28/09	1.70	--	
	08/18/09	1.81	--
MW-7	11/08/02	-98.00 ¹	--
	02/07/03	2.90	--
	05/09/03	2.60	--
	08/15/03	2.30	--
	11/14/03	1.87	--
	08/19/05	0.80	--
	11/18/05	0.90	--
	02/10/06	1.30	--
	05/12/06	1.40	--
	08/11/06	1.10	--
	11/17/06	0.70	--
	02/16/07	1.10	--
	05/17/07	1.7	--
	08/09/07	1.2	--
	11/08/07	0.9	--
02/06/08	0.5	--	

**DISSOLVED OXYGEN CONCENTRATIONS
FORMER CHEVRON SERVICE STATION 9-1153
3135 GIBBONS DRIVE (3126 FERNSIDE BOULEVARD), ALAMEDA, CALIFORNIA**

<i>WELL ID</i>	<i>DATE</i>	<i>PRE-PURGE (mg/L)</i>	<i>POST-PURGE (mg/L)</i>
MW-7 (cont)	05/07/08	1.2	--
	09/11/08	1.0	--
	11/10/08	0.6	--
	02/09/09	0.8	--
	05/28/09	0.45	--
	08/18/09	0.57	

EXPLANATIONS:

mg/L = milligrams per liter

-- = Not Measured

¹ Below D.O. meter range.

ATTACHMENT A

BLAINE TECH'S AUGUST 19, 2009 *THIRD QUARTER MONITORING REPORT*



August 19, 2009

Chevron Environmental Management Company
Aaron Costa
6111 Bollinger Canyon Rd.
San Ramon, CA 94583

Third Quarter 2009 Monitoring at
Chevron Service Station 91153
3135 Gibbons Dr.
Alameda, CA

Monitoring performed on August 18, 2009

Blaine Tech Services, Inc. Groundwater Monitoring Event 090818-JO1

This submission covers the routine monitoring of groundwater wells conducted on August 18, 2009 at this location. Five monitoring wells were measured for depth to groundwater (DTW). 4 monitoring wells were sampled. Well C-1 was not sampled due to presence of SPH. SPH was bailed from well and placed into drum. All sampling activities were performed in accordance with local, state and federal guidelines.

Water levels measurements were collected using an electronic slope indicator or an electronic interface probe. All sampled wells were purged of three case volumes, depending on well recovery, or until water temperature, pH and conductivity stabilized. Purging was accomplished using electric submersible pumps, positive air-displacement pumps or stainless steel, Teflon or disposable bailers. Subsequent sample collection and sample handling was performed in accordance with EPA protocols using disposable bailers. Alternately, where applicable, wells were sampled utilizing no-purge methodology. All reused equipment was decontaminated in an integrated stainless steel sink with de-ionized water supplied Hotsy pressure washer and Liquinox or equivalent.

Third Quarter Groundwater Monitoring at Chevron 91153, 3135 Gibbons Dr., Alameda, CA

SAN JOSE

SACRAMENTO

LOS ANGELES

SAN DIEGO

1680 ROGERS AVENUE

SAN JOSE, CA 95112-1105

(408) 573-0555

FAX (408) 573-7771

LIC. 746684

www.blainetech.com

Samples were delivered under chain-of-custody to Lancaster Laboratories of Lancaster, Pennsylvania, for analysis. Monitoring well purgewater and equipment rinsate water was collected and transported under bill-of-lading to IWM facilities of San Jose, California.

Enclosed documentation from this event includes copies of the Well Gauging Sheet, Well Monitoring Data Sheets, and Chain-of-Custody.

Blaine Tech Services, Inc.'s activities at this site consisted of objective data and sample collection only. No interpretation of analytical results, defining of hydrogeologic conditions or formulation of recommendations was performed.

Please call if you have any questions.

Sincerely,



Pete Cornish
Blaine Tech Services, Inc.
Project Manager

attachments: SOP
Well Gauging Sheet
Individual Well Monitoring Data Sheets
Chain of Custody
Wellhead Inspection Form
Bill of Lading
Calibration Log

cc: CRA
Attn: Charlotte Evans
5900 Hollis St. Suite A
Emeryville, CA 94608

Third Quarter Groundwater Monitoring at Chevron 91153, 3135 Gibbons Dr., Alameda, CA

SAN JOSE

SACRAMENTO

LOS ANGELES

SAN DIEGO

1680 ROGERS AVENUE

SAN JOSE, CA 95112-1105

(408) 573-0555

FAX (408) 573-7771

LIC. 746684

www.blainetech.com

BLAINE TECH SERVICES, INC. METHODS AND PROCEDURES FOR THE ROUTINE MONITORING OF GROUNDWATER WELLS AT CHEVRON SITES

Blaine Tech Services, Inc. performs environmental sampling and documentation as an independent third party. We specialize in groundwater monitoring assignments and intentionally limit the scope of our services to those centered on the generation of objective information.

To avoid conflicts of interest, Blaine Tech Services, Inc. personnel do not evaluate or interpret the information we collect. As a state licensed contractor (C-57 well drilling –water – 746684) performing strictly technical services, we do not make any professional recommendations and perform no consulting of any kind.

SAMPLING PROCEDURES OVERVIEW

SAFETY

All groundwater monitoring assignments performed for Chevron comply with Chevron's safety guidelines, 29 CFR 1910.120 and SB-198 Injury and Illness Prevention Program (IIPP). All Field Technicians receive the full 40-hour 29CFR 1910.120 OSHA SARA HAZWOPER course, medical clearance and on-the-job training prior to commencing any work on any Chevron site.

INSPECTION AND GAUGING

Wells are inspected prior to evacuation and sampling. The condition of the wellhead is checked and noted according to a wellhead inspection checklist.

Standard measurements include the depth to water (DTW) and the total well depth (TD) obtained with industry standard electronic water level indicators that are graduated in increments of hundredths of a foot.

The water in each well is inspected for the presence of immiscibles. When free product is suspected, its presence is confirmed using an electronic interface probe (e.g. GeoTech). No samples are collected from a well containing over two-hundredths of a foot (0.02') of product.

EVACUATION

Depth to water measurements are collected by our personnel prior to purging and minimum purge volumes are calculated anew for each well based on the height of the water column and the diameter of the well. Expected purge volumes are never less than three case volumes and are set at no less than four case volumes in some jurisdictions.

Well purging devices are selected on the basis of the well diameter and the total volume to be

evacuated. In most cases the well will be purged using an electric submersible pump (i.e. Grundfos) suspended near (but not touching) the bottom of the well.

PARAMETER STABILIZATION

Well purging completion standards include minimum purge volumes, but additionally require stabilization of specific groundwater parameters prior to sample collection. Typical groundwater parameters used to measure stability are electrical conductivity, pH, and temperature. Instrument readings are obtained at regular intervals during the evacuation process (no less than once per case volume).

Stabilization standards for routine quarterly monitoring of fuel sites include the following: Temperature is considered to have stabilized when successive readings do not fluctuate more than +/- 1 degree Celsius. Electrical conductivity is considered stable when successive readings are within 10%. pH is considered to be stable when successive readings remain constant or vary no more than 0.2 of a pH unit.

DEWATERED WELLS

Normal evacuation removes no less than three case volumes of water from the well. However, less water may be removed in cases where the well dewateres and does not immediately recharge.

MEASURING RECHARGE

Upon completion of well purging, a depth to water measurement is collected and notated to ensure that the well has recharged to within 80% of its static, pre-purge level prior to sampling.

Wells that do not immediately show 80% recharge or dewatered wells will be allowed approximately 2 hours to recharge prior to sampling or will be sampled at site departure. All wells requiring off-site traffic control in the public right-of-way, the 80% recharge rule may be disregarded in the interests of Health and Safety. The sample may be collected as soon as there is sufficient water. The water level at time of sampling will be noted.

PURGEWATER CONTAINMENT

All non-hazardous purgewater evacuated from each groundwater monitoring well is captured and contained in on-board storage tanks on the Sampling Vehicle and/or special water hauling trailers. Effluent from the decontamination of reusable apparatus (sounders, electric pumps and hoses etc.), consisting of groundwater combined with deionized water and non-phosphate soap, is also captured and pumped into effluent tanks.

Non-hazardous purgewater is transported under standard Bill of Lading documentation to a Blaine Tech Services, Inc. facility before being transported to a Chevron approved disposal facility.

SAMPLE COLLECTION DEVICES

All samples are collected using disposable bailers.

SAMPLE CONTAINERS

Sample material is decanted directly from the sampling bailer into sample containers provided by the laboratory that will analyze the samples. The transfer of sample material from the bailer to the sample container conforms to specifications contained in the USEPA T.E.G.D. The type of sample container, material of construction, method of closure and filling requirements are specific to the intended analysis. Chemicals needed to preserve the sample material are commonly placed inside the sample containers by the laboratory or glassware vendor prior to delivery of the bottle to our personnel. The laboratory sets the number of replicate containers.

TRIP BLANKS

Trip Blanks, if requested, are taken to the site and kept inside the sample cooler for the duration of the event. They are turned over to the laboratory for analysis with the samples from that site.

DUPLICATES

Duplicates, if requested, may be collected at a site. The Duplicate sample is collected, typically from the well containing the most measurable contaminants. The Duplicate sample is labeled the same as the original.

SAMPLE STORAGE

All sample containers are promptly placed in food grade ice chests for storage in the field and transport (direct or via our facility) to the designated analytical laboratory. These ice chests contain quantities of restaurant grade ice as a refrigerant material. The samples are maintained in either an ice chest or a refrigerator until relinquished into the custody of the laboratory or laboratory courier.

DOCUMENTATION CONVENTIONS

A label must be affixed to all sample containers. In most cases these labels are generated by our office personnel and are partially preprinted. Labels can also be hand written by our field personnel. The site is identified with the store number and site address, as is the particular groundwater well from which the sample is drawn (e.g. MW-1, MW-2, S-1 etc.). The time and date of sample collection along with the initials of the person who collects the sample are handwritten onto the label.

Chain of Custody records are created using client specific preprinted forms following USEPA specifications.

Bill of Lading records are contemporaneous records created in the field at the site where the non-hazardous purgewater is generated. Field Technicians use preprinted Bill of Lading forms.

DECONTAMINATION

All equipment is brought to the site in clean and serviceable condition and is cleaned after use in each well and before subsequent use in any other well. Equipment is decontaminated before leaving the site.

The primary decontamination device is a commercial steam cleaner. The steam cleaner is de-tuned to function as a hot pressure washer that is then operated with high quality deionized water that is produced at our facility and stored onboard our sampling vehicle. Cleaning is facilitated by the use of proprietary fixtures and devices included in the patented workstation (U.S. Patent 5,535,775) that is incorporated in each sampling vehicle. The steam cleaner is used to decon reels, pumps and bailers.

Any sensitive equipment or parts (i.e. Dissolved Oxygen sensor membrane, water level indicator, etc.) that cannot be washed using the high pressure water, will be sprayed with a non-phosphate soap and deionized water solution and rinsed with deionized water.

DISSOLVED OXYGEN READINGS

Dissolved Oxygen readings are taken pre- and/or post-purge using YSI meters (e.g. YSI Model 550) or HACH field test kits.

The YSI meters are able to collect accurate in-situ readings. The probe allows downhole measurements to be taken from wells with diameters as small as two inches. The probe and reel is decontaminated between wells as described above. The meter is calibrated between wells as per the instructions in the operating manual. The probe is lowered into the water column and the reading is allowed to stabilize prior to collection.

OXYIDATON REDUCTION POTENTIAL READINGS

All readings are obtained with either Corning or Myron-L meters (e.g. Corning ORP-65 or a Myron-L Ultrameter GP). The meter is cleaned between wells as described above. The meter is calibrated at the start of each day according to the instruction manual.

FERROUS IRON MEASUREMENTS

All field measurements are collected at time of sampling with a HACH test kit.

WELL GAUGING DATA

Project # 040818-S01 Date 8-18-09 Client chevron

Site 3135 Gibbons Ave Alameda CA

Well ID	Time	Well Size (in.)	Sheen / Odor	Depth to Immiscible Liquid (ft.)	Thickness of Immiscible Liquid (ft.)	Volume of Immiscibles Removed (ml)	Depth to water (ft.)	Depth to well bottom (ft.)	Survey Point: TOB or TOC	Notes
C-1	0850	3	yes	4.38	0.02	28ml	4.40	—	TOC	SPLT
C-3	—	2	annual		gauge		—	—	TOC	
MW-4	—	2	annual		gauge		—	—	TOC	
MW-5	0830	2					3.81	12.61	TOC	
MW-6	0840	2					3.38	13.28	TOC	
MW-7	0845	2					4.80	5.95	TOC	
MW-8	—	2	annual		gauge		—	—	—	
MW-9	—	2	annual		gauge		—	—	—	
MW-10	1055	2					4.02	8.81	TOC	(TW)
C-1	SPL	Volume		0.37	x 0.02	x 3785	= 28ml			

CHEVRON WELL MONITORING DATA SHEET

Project #: <u>090818-J01</u>	Station #: <u>9-1153</u>
Sampler: <u>JO</u>	Date: <u>9-19-09</u>
Weather: <u>overcast</u>	Ambient Air Temperature: <u>65°</u>
Well I.D.: <u>C-1</u>	Well Diameter: 2 <u>(3)</u> 4 6 8 _____
Total Well Depth: _____	Depth to Water: <u>4.40</u>
Depth to Free Product: <u>4.38</u>	Thickness of Free Product (feet): <u>0.02</u>
Referenced to: <u>(PVC)</u> Grade	D.O. Meter (if req'd): YSI HACH
DTW with 80% Recharge [(Height of Water Column x 0.20) + DTW]:	

Purge Method:	Sampling Method: <u>Bailer</u>
<input checked="" type="checkbox"/> Bailer <input checked="" type="checkbox"/> Disposable Bailer <input checked="" type="checkbox"/> Positive Air Displacement <input type="checkbox"/> Electric Submersible	<input checked="" type="checkbox"/> Waterra <input checked="" type="checkbox"/> Peristaltic <input checked="" type="checkbox"/> Extraction Pump <input type="checkbox"/> Other _____
	<input checked="" type="checkbox"/> Disposable Bailer <input checked="" type="checkbox"/> Extraction Port <input checked="" type="checkbox"/> Dedicated Tubing Other: _____

_____ (Gals.) X _____	=	_____ Gals.
1 Case Volume	Specified Volumes	Calculated Volume

Well Diameter	Multiplier	Well Diameter	Multiplier
1"	0.04	4"	0.65
2"	0.16	6"	1.47
3"	0.37	Other	radius ² * 0.163

Time	Temp (°F)	pH	Cond. (mS or µS)	Turbidity (NTUs)	Gals. Removed	Observations
<u>SPH</u>	<u>volume</u>	<u>0.37</u>	<u>x 0.02</u>	<u>x 3785 mL</u>	<u>= 28 mL</u>	
<u>28 mL of</u>		<u>SPH removed</u>	<u>+</u>	<u>3.0 gallons H₂O</u>		

Did well dewater? Yes <input type="checkbox"/> No <input type="checkbox"/>	Gallons actually evacuated: _____
Sampling Date: _____	Sampling Time: _____
Sample I.D.: _____	Depth to Water: _____
Analyzed for: TPH-G BTEX MTBE OXYS Other: _____	Laboratory: Lancaster Other _____
Duplicate I.D.: _____	Analyzed for: TPH-G BTEX MTBE OXYS Other: _____
D.O. (if req'd): _____	Pre-purge: _____ mg/L Post-purge: _____ mg/L
O.R.P. (if req'd): _____	Pre-purge: _____ mV Post-purge: _____ mV

CHEVRON WELL MONITORING DATA SHEET

Project #: 090318-J01	Station #: 9-1153
Sampler: 30	Date: 8-18-09
Weather: Overcast	Ambient Air Temperature: 70°
Well I.D.: MW-5	Well Diameter: (2) 3 4 6 8 _____
Total Well Depth: 12.61	Depth to Water: 3.81
Depth to Free Product:	Thickness of Free Product (feet):
Referenced to: (PVC) Grade	D.O. Meter (if req'd): YSI HACH
DTW with 80% Recharge [(Height of Water Column x 0.20) + DTW]: 5.57	

Purge Method:

- Bailer
 Disposable Bailer
 Positive Air Displacement
 Electric Submersible
- Waterra
 Peristaltic
 Extraction Pump
 Other _____

Sampling Method: Bailer

- Disposable Bailer
 Extraction Port
 Dedicated Tubing
 Other: _____

1.4	(Gals.) X	3	=	4.2	Gals.
1 Case Volume		Specified Volumes		Calculated Volume	

Well Diameter	Multiplier	Well Diameter	Multiplier
1"	0.04	4"	0.65
2"	0.16	6"	1.47
3"	0.37	Other	radius ² * 0.163

Time	Temp (°F)	pH	Cond. (mS or μS)	Turbidity (NTUs)	Gals. Removed	Observations
0909	67.1	7.21	699	621	1.4	particulates
0912	67.2	7.19	708	881	2.8	↓
0915	67.0	7.18	718	891	4.2	

Did well dewater? Yes No Gallons actually evacuated: 4.2

Sampling Date: 8-18-09 Sampling Time: 0920 Depth to Water: 5.42

Sample I.D.: MW-5 Laboratory: (Lancaster) Other _____

Analyzed for: TPH-G BTEX MTBE OXYS Other: See Col

Duplicate I.D.: Analyzed for: TPH-G BTEX MTBE OXYS Other:

D.O. (if req'd):	Pre-purge:	mg/L	Post-purge:	mg/L
O.R.P. (if req'd):	Pre-purge:	mV	Post-purge:	mV

CHEVRON WELL MONITORING DATA SHEET

Project #: 090513-J01	Station #: 9-1153
Sampler: 10	Date: 8-18-09
Weather: ☀ Overcast	Ambient Air Temperature: 70° F
Well I.D.: MW-6	Well Diameter: (2) 3 4 6 8 _____
Total Well Depth: 13.28	Depth to Water: 3.30
Depth to Free Product:	Thickness of Free Product (feet):
Referenced to: (PVC) Grade	D.O. Meter (if req'd): YSI HACH
DTW with 80% Recharge [(Height of Water Column x 0.20) + DTW]: 5.36	

Purge Method:

- Bailer
 Disposable Bailer
 Positive Air Displacement
 Electric Submersible
- Waterra
 Peristaltic
 Extraction Pump
 Other _____

Sampling Method: Bailer

- Disposable Bailer
 Extraction Port
 Dedicated Tubing
 Other: _____

1.5	(Gals.) X	3	=	4.5	Gals.
1 Case Volume		Specified Volumes		Calculated Volume	

Well Diameter	Multiplier	Well Diameter	Multiplier
1"	0.04	4"	0.65
2"	0.16	6"	1.47
3"	0.37	Other	radius ² * 0.163

Time	Temp (°F)	pH	Cond. (mS or μS)	Turbidity (NTUs)	Gals. Removed	Observations
0932	66.4	6.78	1181	>1000	1.5	Brown cloudy
0936	66.3	6.74	1174	>1000	3.0	↓
0940	66.8	6.72	1162	>1000	4.5	↓

Did well dewater? Yes No Gallons actually evacuated: 4.5

Sampling Date: 8-18-09 Sampling Time: 1000 Depth to Water: 5.31

Sample I.D.: MW-6 Laboratory: (Lancaster) Other _____

Analyzed for: TPH-G BTEX MTBE OXYS Other: See Col

Duplicate I.D.: Analyzed for: TPH-G BTEX MTBE OXYS Other:

D.O. (if req'd): Pre-purge: 1.81 mg/L Post-purge: mg/L

O.R.P. (if req'd): Pre-purge: mV Post-purge: mV

CHEVRON WELL MONITORING DATA SHEET

Project #: 090518-501	Station #: 9-1153
Sampler: 10	Date: 8-18-09
Weather: overcast	Ambient Air Temperature: 73° F
Well I.D.: MW-7	Well Diameter: (2) 3 4 6 8 _____
Total Well Depth: 5.95	Depth to Water: 4.80
Depth to Free Product:	Thickness of Free Product (feet):
Referenced to: (PVC) Grade	D.O. Meter (if req'd): YSI HACH
DTW with 80% Recharge [(Height of Water Column x 0.20) + DTW]: 5.03	

Purge Method:

- Bailer
 Disposable Bailer
 Positive Air Displacement
 Electric Submersible
- Waterra
 Peristaltic
 Extraction Pump
 Other _____

Sampling Method:

- Bailer
 Disposable Bailer
 Extraction Port
 Dedicated Tubing
 Other: _____

0.2 (Gals.) X	3	= 0.6 Gals.
1 Case Volume	Specified Volumes	Calculated Volume

Well Diameter	Multiplier	Well Diameter	Multiplier
1"	0.04	4"	0.65
2"	0.16	6"	1.47
3"	0.37	Other	radius ² * 0.163

Time	Temp (°F)	pH	Cond. (mS or μS)	Turbidity (NTUs)	Gals. Removed	Observations
1016	69.2	6.87	1281	>1000	0.2	odor / grey
1018	69.3	6.88	1287	>1000	0.4	↓
1020	69.2	6.93	1301	>1000	0.6	

Did well dewater? Yes No Gallons actually evacuated: 0.6

Sampling Date: 8-18-09 Sampling Time: 1025 Depth to Water: 5.60

Sample I.D.: MW-7 Laboratory: (Lancaster) Other _____

Analyzed for: TPH-G BTEX MTBE OXYS Other: See Coc

Duplicate I.D.: Analyzed for: TPH-G BTEX MTBE OXYS Other:

D.O. (if req'd): Pre-purge: 0.57 mg/L Post-purge: _____ mg/L

O.R.P. (if req'd): Pre-purge: _____ mV Post-purge: _____ mV

CHEVRON WELL MONITORING DATA SHEET

Project #: 090313-J01	Station #: 9-1153
Sampler: JO	Date: 8-18-09
Weather: Sunny	Ambient Air Temperature: 88°F
Well I.D.: MW-10	Well Diameter: (2) 3 4 6 8 _____
Total Well Depth: 8.61	Depth to Water: 4.07
Depth to Free Product:	Thickness of Free Product (feet):
Referenced to: (PVC) Grade	D.O. Meter (if req'd): YSI HACH
DTW with 80% Recharge [(Height of Water Column x 0.20) + DTW]: 5.07	

Purge Method:

- Bailer
 Disposable Bailer
 Positive Air Displacement
 Electric Submersible
- Waterra
 Peristaltic
 Extraction Pump
 Other _____

Sampling Method: Bailer

- Disposable Bailer
 Extraction Port
 Dedicated Tubing
 Other: _____

$$0.75 \text{ (Gals.)} \times 3 = 2.25 \text{ Gals.}$$
 1 Case Volume Specified Volumes Calculated Volume

Well Diameter	Multiplier	Well Diameter	Multiplier
1"	0.04	4"	0.65
2"	0.16	6"	1.47
3"	0.37	Other	radius ² * 0.163

Time	Temp (°F)	pH	Cond. (mS or μS)	Turbidity (NTUs)	Gals. Removed	Observations
1054	74.7	7.39	4699	95	0.75	cloudy
1102	74.3	7.10	5199	72	1.50	
1105	74.0	6.98	5955	285	2.25	↓

Did well dewater? Yes No Gallons actually evacuated: 2.25

Sampling Date: 8-18-09 Sampling Time: 1105 Depth to Water: 6.20 *True*

Sample I.D.: MW-10 Laboratory: (Lancaster) Other _____

Analyzed for: TPH-G BTEX MTBE OXYS Other: See Coc

Duplicate I.D.: Analyzed for: TPH-G BTEX MTBE OXYS Other:

D.O. (if req'd):	Pre-purge:	mg/L	Post-purge:	mg/L
O.R.P. (if req'd):	Pre-purge:	mV	Post-purge:	mV

CHAIN OF CUSTODY FORM

Chevron Environmental Management Company ■ 6111 Bollinger Canyon Rd. ■ San Ramon, CA 94583 COC 6 of 1

Chevron Site Number: 91153
 Chevron Site Global ID: T0600100330
 Chevron Site Address: 3135 Gibbons Dr.
Alameda, CA
 Chevron PM: AARON COSTA
 Chevron PM Phone No.: (925)543-2961
 Retail and Terminal Business Unit (RTBU) Job
 Construction/Retail Job

Chevron Consultant: CRA
 Address: 5900 Hollis St. Suite A Emeryville,
CA Consultant Contact: Charlotte Evans
 Consultant Phone No. 510-420-3351
 Consultant Project No. 090818-102
 Sampling Company: Blaine Tech Services
 Sampled By (Print): J Ortiz
 Sampler Signature: [Signature]

ANALYSES REQUIRED												Preservation Codes	
<input checked="" type="checkbox"/>	<input checked="" type="checkbox"/>	<input type="checkbox"/>	<input type="checkbox"/>	<input type="checkbox"/>	<input type="checkbox"/>	<input type="checkbox"/>	<input type="checkbox"/>	<input type="checkbox"/>	<input type="checkbox"/>	<input type="checkbox"/>	<input type="checkbox"/>		H = HCL T = Thiosulfate N = HNO ₃ B = NaOH S = H ₂ SO ₄ O = Other
EPA 8260B/GC/MS	<input checked="" type="checkbox"/>	<input type="checkbox"/>	<input type="checkbox"/>	<input type="checkbox"/>	<input type="checkbox"/>	<input type="checkbox"/>	<input type="checkbox"/>	<input type="checkbox"/>	<input type="checkbox"/>	<input type="checkbox"/>	<input type="checkbox"/>		

Charge Code: **NWRTB-0091153-0-OML**
 NWRTB 00SITE NUMBER-0- WBS
(WBS ELEMENTS:
 SITE ASSESSMENT: A1L REMEDIATION IMPLEMENTATION: R5L
 SITE MONITORING: OML OPERATION MAINTENANCE & MONITORING: M1L
THIS IS A LEGAL DOCUMENT. ALL FIELDS MUST BE FILLED OUT CORRECTLY AND COMPLETELY.

Lancaster Laboratories
 Lancaster, PA
 Lab Contact: Jill Parker
 2425 New Holland Pike,
 Lancaster, PA 17601
 Phone No:
 (717)656-2300

Other Lab	Temp. Blank Check Time	Temp.
	0.200	15
	10.00	20
	13.00	20
	14.00	20

SAMPLE ID				Sample Time	# of Containers	Container Type
Field Point Name	Matrix	Top Depth	Date (yyymmdd)			
MW-5	W		090818	0920	6	Vials
MW-6	↓			1000	↓	
MW-7	↓			1025	↓	
MW-10	↓			1105	↓	
QA	T			1000	2	

EPA 8260B/GC/MS	BTEX	MTBE	OXYGENATES	HVOC	EPA 8015B	GRO	DRO	ORO	HC SCREEN	EPA 8021B	BTEX	MTBE	EPA 6010	Ca, Fe, K, Mg, Mn, Na	EPA6010/7000	TITLE 22 METALS	TLC	STLC	EPA 310.1	ALKALINITY	SM2510B	SPECIFIC CONDUCTIVITY	EPA 418.1	TRPH	EPA 413.1	OIL & GREASE	Notes/Comments
<input checked="" type="checkbox"/>	<input checked="" type="checkbox"/>	<input checked="" type="checkbox"/>	<input checked="" type="checkbox"/>	<input checked="" type="checkbox"/>	<input checked="" type="checkbox"/>	<input checked="" type="checkbox"/>	<input checked="" type="checkbox"/>	<input checked="" type="checkbox"/>	<input checked="" type="checkbox"/>	<input checked="" type="checkbox"/>	<input checked="" type="checkbox"/>	<input checked="" type="checkbox"/>	<input checked="" type="checkbox"/>	<input checked="" type="checkbox"/>	<input checked="" type="checkbox"/>	<input checked="" type="checkbox"/>	<input checked="" type="checkbox"/>	<input checked="" type="checkbox"/>	<input checked="" type="checkbox"/>	<input checked="" type="checkbox"/>	<input checked="" type="checkbox"/>	<input checked="" type="checkbox"/>	<input checked="" type="checkbox"/>	<input checked="" type="checkbox"/>	<input checked="" type="checkbox"/>	<input checked="" type="checkbox"/>	

Relinquished By [Signature] Company BTS Date/Time: 8-18-09/1555

Relinquished To [Signature] Company BTS Date/Time: 8-18-09/1555

Turnaround Time: Standard 24 Hours 48 hours 72 Hours Other
 Sample Integrity: (Check by lab on arrival)
 Intact: _____ On Ice: _____ Temp: _____
 COC # _____

WELLHEAD INSPECTION CHECKLIST

Client Cherwin Date 5-18-09

Site Address 3135 Gibson Ave Alameda Ca

Job Number 090818 - SDI Technician JO

Well ID	Well Inspected - No Corrective Action Required	WELL IS SECURABLE BY DESIGN (12" or less)	WELL IS CLEARLY MARKED WITH THE WORDS "MONITORING WELL" (12" or less)	Water Bailed From Wellbox	Wellbox Components Cleaned	Cap Replaced	Lock Replaced	Other Action Taken (explain below)	Well Not Inspected (explain below)	Repair Order Submitted
C-1								X		
MW-5		X	X					X		
MW-6	X									
MW-7	X									
MW-10								X		

NOTES: C-1, Christy BOX, MW-5 212 Bolts missing, MW-10 Full up
lid

CHEVRON-NORTHERN CALIFORNIA TYPE **A** BILL OF LADING

SOURCE RECORD **BILL OF LADING**

FOR NON-HAZARDOUS PURGEWATER RECOVERED FROM GROUNDWATER WELLS AT CHEVRON FACILITIES IN THE STATE OF CALIFORNIA. THE NON-HAZARDOUS PURGE- WATER WHICH HAS BEEN RECOVERED FROM GROUND- WATER WELLS IS COLLECTED BY THE CONTRACTOR, MADE UP INTO LOADS OF APPROPRIATE SIZE AND HAULED BY IWM TO THEIR FACILITY IN SAN JOSE, CALIFORNIA.

The contractor performing this work is BLAINE TECH SERVICES, INC. (BTS), 1680 Rogers Ave. San Jose CA (408)573-0555). Blaine Tech Services, Inc. is authorized by CHEVRON PRODUCTS COMPANY (CHEVRON) to recover, collect, apportion into loads, and haul the Non-Hazardous Well Purgewater that is drawn from wells at the CHEVRON facility indicated below and to deliver that purgewater to BTS. Transport routing of the Non-Hazardous Well Purgewater may be direct from one Chevron facility to BTS; from one Chevron facility to BTS via another Chevron facility; or any combination thereof. The Non-Hazardous Well Purgewater is and remains the property of CHEVRON.

This **Source Record BILL OF LADING** was initiated to cover the recovery of Non-Hazardous Well Purgewater from wells at the Chevron facility described below:

9-1153
 CHEVRON # 9-1153 Arcom Coorin
 Chevron Engineer
 3135 G. Adams Dr Alameda CA
 street number street name city state

WELL I.D.	GALS.	WELL I.D.	GALS.
<u>MW-10</u>	<u>2.25</u>	/	/
/	/	/	/
/	/	/	/
/	/	/	/
/	/	/	/
/	/	/	/
/	/	/	/
/	/	/	/
added equip.	<u>2.0</u>	any other	/
rinse water	/	adjustments	/

TOTAL GALS.
RECOVERED 4.25

loaded onto
 BTS vehicle # 86

BTS event # 090818 - 10F time 06 date 8/18/09
 signature [Signature]

REC'D AT BIS time 1540 date 8/18/09

unloaded by signature [Signature]

ATTACHMENT B

LANCASTER LABORATORIES' AUGUST 31, 2009 ANALYTICAL REPORT

ANALYTICAL RESULTS

Prepared for:

Chevron
6001 Bollinger Canyon Rd L4310
San Ramon CA 94583

925-842-8582

Prepared by:

Lancaster Laboratories
2425 New Holland Pike
Lancaster, PA 17605-2425

August 31, 2009

SAMPLE GROUP

The sample group for this submittal is 1158455. Samples arrived at the laboratory on Thursday, August 20, 2009. The PO# for this group is 0015040460 and the release number is COSTA.

<u>Client Description</u>	<u>Lancaster Labs Number</u>
MW-5-W-090818 NA Water	5754681
MW-6-W-090818 NA Water	5754682
MW-7-W-090818 NA Water	5754683
MW-10-W-090818 NA Water	5754684
QA-T-090818 NA Water	5754685

METHODOLOGY

The specific methodologies used in obtaining the enclosed analytical results are indicated on the Laboratory Sample Analysis Record.

ELECTRONIC COPY TO
ELECTRONIC COPY TO

Chevron c/o CRA
CRA

Attn: Report Contact

Attn: Charlotte Evans

Questions? Contact your Client Services Representative
Jill M Parker at (717) 656-2300

Respectfully Submitted,



Robin C. Runkle
Senior Specialist

Lancaster Laboratories Sample No. WW 5754681

Group No. 1158455
CA

MW-5-W-090818 NA Water

Facility# 91153 BTST

3135 Gibbons-Alameda T0600100330 MW-5

Collected: 08/18/2009 09:20 by JO

Account Number: 10991

Submitted: 08/20/2009 09:05

Chevron

Reported: 08/31/2009 at 17:41

6001 Bollinger Canyon Rd L4310

Discard: 10/01/2009

San Ramon CA 94583

GDA05

CAT No.	Analysis Name	CAS Number	As Received Result	As Received Method Detection Limit*	As Received Limit of Quantitation	Dilution Factor
GC/MS	Volatiles	SW-846 8260B	ug/l	ug/l	ug/l	
06054	Benzene	71-43-2	N.D.	0.5	1	1
06054	Ethylbenzene	100-41-4	N.D.	0.5	1	1
06054	Methyl Tertiary Butyl Ether	1634-04-4	N.D.	0.5	1	1
06054	Toluene	108-88-3	N.D.	0.5	1	1
06054	Xylene (Total)	1330-20-7	N.D.	0.5	1	1
GC	Volatiles	SW-846 8015B	ug/l	ug/l	ug/l	
01728	TPH-GRO N. CA water C6-C12	n.a.	N.D.	50	100	1

General Sample Comments

State of California Lab Certification No. 2501

All QC is compliant unless otherwise noted. Please refer to the Quality Control Summary for overall QC performance data and associated samples.

Laboratory Sample Analysis Record

CAT No.	Analysis Name	Method	Trial#	Batch#	Analysis Date and Time	Analyst	Dilution Factor
06054	BTEX+MTBE by 8260B	SW-846 8260B	1	F092361AA	08/24/2009 16:39	Anita M Dale	1
01163	GC/MS VOA Water Prep	SW-846 5030B	1	F092361AA	08/24/2009 16:39	Anita M Dale	1
01728	TPH-GRO N. CA water C6-C12	SW-846 8015B	1	09237A20A	08/26/2009 20:08	Fanella S Zamcho	1
01146	GC VOA Water Prep	SW-846 5030B	1	09237A20A	08/26/2009 20:08	Fanella S Zamcho	1

Lancaster Laboratories Sample No. WW 5754682
**Group No. 1158455
CA**
MW-6-W-090818 NA Water
Facility# 91153 BTST
3135 Gibbons-Alameda T0600100330 MW-6

Collected: 08/18/2009 10:00 by JO

Account Number: 10991

Submitted: 08/20/2009 09:05

Chevron

Reported: 08/31/2009 at 17:41

6001 Bollinger Canyon Rd L4310

Discard: 10/01/2009

San Ramon CA 94583

GDA06

CAT No.	Analysis Name	CAS Number	As Received Result	As Received Method Detection Limit*	As Received Limit of Quantitation	Dilution Factor
GC/MS	Volatiles	SW-846 8260B	ug/l	ug/l	ug/l	
06054	Benzene	71-43-2	130	0.5	1	1
06054	Ethylbenzene	100-41-4	N.D.	0.5	1	1
06054	Methyl Tertiary Butyl Ether	1634-04-4	N.D.	0.5	1	1
06054	Toluene	108-88-3	3	0.5	1	1
06054	Xylene (Total)	1330-20-7	0.7 J	0.5	1	1
GC	Volatiles	SW-846 8015B	ug/l	ug/l	ug/l	
01728	TPH-GRO N. CA water C6-C12	n.a.	560	50	100	1

General Sample Comments

State of California Lab Certification No. 2501

All QC is compliant unless otherwise noted. Please refer to the Quality Control Summary for overall QC performance data and associated samples.

Laboratory Sample Analysis Record

CAT No.	Analysis Name	Method	Trial#	Batch#	Analysis Date and Time	Analyst	Dilution Factor
06054	BTEX+MTBE by 8260B	SW-846 8260B	1	F092361AA	08/24/2009 17:01	Anita M Dale	1
01163	GC/MS VOA Water Prep	SW-846 5030B	1	F092361AA	08/24/2009 17:01	Anita M Dale	1
01728	TPH-GRO N. CA water C6-C12	SW-846 8015B	1	09237A20A	08/26/2009 20:30	Fanella S Zamcho	1
01146	GC VOA Water Prep	SW-846 5030B	1	09237A20A	08/26/2009 20:30	Fanella S Zamcho	1



Analysis Report

2425 New Holland Pike, PO Box 12425, Lancaster, PA 17605-2425 • 717-656-2300 Fax: 717-656-2681 • www.lancasterlabs.com

Lancaster Laboratories Sample No. WW 5754683

Group No. 1158455
CA

MW-7-W-090818 NA Water
Facility# 91153 BTST
3135 Gibbons-Alameda T0600100330 MW-7

Collected: 08/18/2009 10:25 by JO

Account Number: 10991

Submitted: 08/20/2009 09:05
Reported: 08/31/2009 at 17:41
Discard: 10/01/2009

Chevron
6001 Bollinger Canyon Rd L4310
San Ramon CA 94583

GDA07

CAT No.	Analysis Name	CAS Number	As Received Result	As Received Method Detection Limit*	As Received Limit of Quantitation	Dilution Factor
GC/MS Volatiles SW-846 8260B						
06054	Benzene	71-43-2	660	5	10	10
06054	Ethylbenzene	100-41-4	110	0.5	1	1
06054	Methyl Tertiary Butyl Ether	1634-04-4	0.7 J	0.5	1	1
06054	Toluene	108-88-3	4	0.5	1	1
06054	Xylene (Total)	1330-20-7	13	0.5	1	1
GC Volatiles SW-846 8015B						
01728	TPH-GRO N. CA water C6-C12	n.a.	6,700	250	500	5

General Sample Comments

State of California Lab Certification No. 2501

All QC is compliant unless otherwise noted. Please refer to the Quality Control Summary for overall QC performance data and associated samples.

Laboratory Sample Analysis Record

CAT No.	Analysis Name	Method	Trial#	Batch#	Analysis Date and Time	Analyst	Dilution Factor
06054	BTEX+MTBE by 8260B	SW-846 8260B	1	F092364AA	08/25/2009 00:01	Florida A Cimino	1
06054	BTEX+MTBE by 8260B	SW-846 8260B	1	F092373AA	08/25/2009 20:20	Florida A Cimino	10
01163	GC/MS VOA Water Prep	SW-846 5030B	1	F092364AA	08/25/2009 00:01	Florida A Cimino	1
01163	GC/MS VOA Water Prep	SW-846 5030B	2	F092373AA	08/25/2009 20:20	Florida A Cimino	10
01728	TPH-GRO N. CA water C6-C12	SW-846 8015B	1	09237A20A	08/26/2009 22:56	Fanella S Zamcho	5
01146	GC VOA Water Prep	SW-846 5030B	1	09237A20A	08/26/2009 22:56	Fanella S Zamcho	5

*=This limit was used in the evaluation of the final result

Lancaster Laboratories Sample No. WW 5754684
**Group No. 1158455
CA**
MW-10-W-090818 NA Water
Facility# 91153 BTST
3135 Gibbons-Alameda T0600100330 MW-10

Collected: 08/18/2009 11:05 by JO

Account Number: 10991

Submitted: 08/20/2009 09:05

Chevron

Reported: 08/31/2009 at 17:41

6001 Bollinger Canyon Rd L4310

Discard: 10/01/2009

San Ramon CA 94583

GDA10

CAT No.	Analysis Name	CAS Number	As Received Result	As Received Method Detection Limit*	As Received Limit of Quantitation	Dilution Factor
GC/MS	Volatiles	SW-846 8260B	ug/l	ug/l	ug/l	
06054	Benzene	71-43-2	N.D.	0.5	1	1
06054	Ethylbenzene	100-41-4	N.D.	0.5	1	1
06054	Methyl Tertiary Butyl Ether	1634-04-4	N.D.	0.5	1	1
06054	Toluene	108-88-3	N.D.	0.5	1	1
06054	Xylene (Total)	1330-20-7	N.D.	0.5	1	1
GC	Volatiles	SW-846 8015B	ug/l	ug/l	ug/l	
01728	TPH-GRO N. CA water C6-C12	n.a.	N.D.	50	100	1

General Sample Comments

State of California Lab Certification No. 2501

All QC is compliant unless otherwise noted. Please refer to the Quality Control Summary for overall QC performance data and associated samples.

Laboratory Sample Analysis Record

CAT No.	Analysis Name	Method	Trial#	Batch#	Analysis Date and Time	Analyst	Dilution Factor
06054	BTEX+MTBE by 8260B	SW-846 8260B	1	F092364AA	08/25/2009 00:23	Florida A Cimino	1
01163	GC/MS VOA Water Prep	SW-846 5030B	1	F092364AA	08/25/2009 00:23	Florida A Cimino	1
01728	TPH-GRO N. CA water C6-C12	SW-846 8015B	1	09237A20A	08/26/2009 21:28	Fanella S Zamcho	1
01146	GC VOA Water Prep	SW-846 5030B	1	09237A20A	08/26/2009 21:28	Fanella S Zamcho	1

Lancaster Laboratories Sample No. WW 5754685

Group No. 1158455
CA

QA-T-090818 NA Water
Facility# 91153 BTST
3135 Gibbons-Alameda T0600100330 QA

Collected: 08/18/2009 10:00

Account Number: 10991

Submitted: 08/20/2009 09:05
Reported: 08/31/2009 at 17:41
Discard: 10/01/2009

Chevron
6001 Bollinger Canyon Rd L4310
San Ramon CA 94583

GDATE

CAT No.	Analysis Name	CAS Number	As Received Result	As Received Method Detection Limit*	As Received Limit of Quantitation	Dilution Factor
GC/MS	Volatiles	SW-846 8260B	ug/l	ug/l	ug/l	
06054	Benzene	71-43-2	N.D.	0.5	1	1
06054	Ethylbenzene	100-41-4	N.D.	0.5	1	1
06054	Methyl Tertiary Butyl Ether	1634-04-4	N.D.	0.5	1	1
06054	Toluene	108-88-3	N.D.	0.5	1	1
06054	Xylene (Total)	1330-20-7	N.D.	0.5	1	1
GC	Volatiles	SW-846 8015B	ug/l	ug/l	ug/l	
01728	TPH-GRO N. CA water C6-C12	n.a.	N.D.	50	100	1

General Sample Comments

State of California Lab Certification No. 2501

All QC is compliant unless otherwise noted. Please refer to the Quality Control Summary for overall QC performance data and associated samples.

Laboratory Sample Analysis Record

CAT No.	Analysis Name	Method	Trial#	Batch#	Analysis Date and Time	Analyst	Dilution Factor
06054	BTEX+MTBE by 8260B	SW-846 8260B	1	F092364AA	08/25/2009 00:44	Florida A Cimino	1
01163	GC/MS VOA Water Prep	SW-846 5030B	1	F092364AA	08/25/2009 00:44	Florida A Cimino	1
01728	TPH-GRO N. CA water C6-C12	SW-846 8015B	1	09237A20A	08/26/2009 16:31	Fanella S Zamcho	1
01146	GC VOA Water Prep	SW-846 5030B	1	09237A20A	08/26/2009 16:31	Fanella S Zamcho	1

Quality Control Summary

 Client Name: Chevron
 Reported: 08/31/09 at 05:41 PM

Group Number: 1158455

Matrix QC may not be reported if site-specific QC samples were not submitted. In these situations, to demonstrate precision and accuracy at a batch level, a LCS/LCSD was performed, unless otherwise specified in the method.

Laboratory Compliance Quality Control

<u>Analysis Name</u>	<u>Blank Result</u>	<u>Blank MDL**</u>	<u>Blank LOQ</u>	<u>Report Units</u>	<u>LCS %REC</u>	<u>LCSD %REC</u>	<u>LCS/LCSD Limits</u>	<u>RPD</u>	<u>RPD Max</u>
Batch number: F092361AA	Sample number(s): 5754681-5754682								
Benzene	N.D.	0.5	1	ug/l	97	93	80-116	4	30
Ethylbenzene	N.D.	0.5	1	ug/l	94	90	80-113	3	30
Methyl Tertiary Butyl Ether	N.D.	0.5	1	ug/l	95	95	78-117	0	30
Toluene	N.D.	0.5	1	ug/l	97	93	80-115	4	30
Xylene (Total)	N.D.	0.5	1	ug/l	97	93	81-114	4	30
Batch number: F092364AA	Sample number(s): 5754683-5754685								
Benzene	N.D.	0.5	1	ug/l	95		80-116		
Ethylbenzene	N.D.	0.5	1	ug/l	93		80-113		
Methyl Tertiary Butyl Ether	N.D.	0.5	1	ug/l	97		78-117		
Toluene	N.D.	0.5	1	ug/l	94		80-115		
Xylene (Total)	N.D.	0.5	1	ug/l	96		81-114		
Batch number: F092373AA	Sample number(s): 5754683								
Benzene	N.D.	0.5	1	ug/l	95	93	80-116	2	30
Batch number: 09237A20A	Sample number(s): 5754681-5754685								
TPH-GRO N. CA water C6-C12	N.D.	50.	100	ug/l	127	127	75-135	0	30

Sample Matrix Quality Control

Unspiked (UNSPK) = the sample used in conjunction with the matrix spike
 Background (BKG) = the sample used in conjunction with the duplicate

<u>Analysis Name</u>	<u>MS %REC</u>	<u>MSD %REC</u>	<u>MS/MSD Limits</u>	<u>RPD</u>	<u>RPD MAX</u>	<u>BKG Conc</u>	<u>DUP Conc</u>	<u>DUP RPD</u>	<u>Dup RPD Max</u>
Batch number: F092361AA	Sample number(s): 5754681-5754682 UNSPK: P754678								
Benzene	100		80-126						
Ethylbenzene	55 (2)		77-125						
Methyl Tertiary Butyl Ether	99		72-126						
Toluene	100		80-125						
Xylene (Total)	68 (2)		79-125						
Batch number: F092364AA	Sample number(s): 5754683-5754685 UNSPK: P756286								
Benzene	118	119	80-126	0	30				
Ethylbenzene	101	-14*	77-125	42*	30				
Methyl Tertiary Butyl Ether	101	100	72-126	1	30				
Toluene	103	103	80-125	0	30				
Xylene (Total)	103	116	79-125	7	30				
Batch number: F092373AA	Sample number(s): 5754683 UNSPK: P756399								
Benzene	99		80-126						

*- Outside of specification

** - This limit was used in the evaluation of the final result for the blank

- (1) The result for one or both determinations was less than five times the LOQ.
- (2) The unspiked result was more than four times the spike added.

Quality Control Summary

 Client Name: Chevron
 Reported: 08/31/09 at 05:41 PM

Group Number: 1158455

Sample Matrix Quality Control

 Unspiked (UNSPK) = the sample used in conjunction with the matrix spike
 Background (BKG) = the sample used in conjunction with the duplicate

<u>Analysis Name</u>	<u>MS</u> <u>%REC</u>	<u>MSD</u> <u>%REC</u>	<u>MS/MSD</u> <u>Limits</u>	<u>RPD</u> <u>MAX</u>	<u>BKG</u> <u>Conc</u>	<u>DUP</u> <u>Conc</u>	<u>DUP</u> <u>RPD</u>	<u>Dup RPD</u> <u>Max</u>
Batch number: 09237A20A TPH-GRO N. CA water C6-C12								
Sample number(s): 5754681-5754685 UNSPK: 5754681 118 63-154								

Surrogate Quality Control

Surrogate recoveries which are outside of the QC window are confirmed unless attributed to dilution or otherwise noted on the Analysis Report.

Analysis Name: BTEX+MTBE by 8260B

Batch number: F092361AA

	Dibromofluoromethane	1,2-Dichloroethane-d4	Toluene-d8	4-Bromofluorobenzene
5754681	91	88	90	106
5754682	89	89	91	108
Blank	90	89	90	102
LCS	94	92	91	109
LCSD	93	91	92	108
MS	90	89	90	104
Limits:	80-116	77-113	80-113	78-113

Analysis Name: BTEX+MTBE by 8260B

Batch number: F092364AA

	Dibromofluoromethane	1,2-Dichloroethane-d4	Toluene-d8	4-Bromofluorobenzene
5754683	90	87	89	110
5754684	89	87	88	107
5754685	90	88	90	108
Blank	89	89	90	107
LCS	92	89	91	110
MS	91	91	90	111
MSD	93	90	91	111
Limits:	80-116	77-113	80-113	78-113

Analysis Name: 8260 Master Scan (water)

Batch number: F092373AA

	Dibromofluoromethane	1,2-Dichloroethane-d4	Toluene-d8	4-Bromofluorobenzene
Blank	96	97	94	103
LCS	100	102	98	110
LCSD	100	102	96	108
MS	99	103	94	105
Limits:	80-116	77-113	80-113	78-113

Analysis Name: TPH-GRO N. CA water C6-C12

Batch number: 09237A20A

Trifluorotoluene-F

*- Outside of specification

**-This limit was used in the evaluation of the final result for the blank

- (1) The result for one or both determinations was less than five times the LOQ.
- (2) The unspiked result was more than four times the spike added.

Quality Control Summary

Client Name: Chevron
Reported: 08/31/09 at 05:41 PM

Group Number: 1158455

Surrogate Quality Control

5754681	86
5754682	97
5754683	107
5754684	86
5754685	86
Blank	87
LCS	126
LCSD	125
MS	125

Limits: 63-135

*- Outside of specification

** - This limit was used in the evaluation of the final result for the blank

- (1) The result for one or both determinations was less than five times the LOQ.
- (2) The unspiked result was more than four times the spike added.

081909-17

CHAIN OF CUSTODY FORM
Chevron Environmental Management Company ■ 6111 Bollinger Canyon Rd. ■ San Ramon, CA 94583 **COC 1 of 1**

Chevron Site Number: 91153
 Chevron Site Global ID: T0600100330
 Chevron Site Address: 3135 Gibbons Dr., Alameda, CA
 Chevron PM: AARON COSTA
 Chevron PM Phone No.: (925)543-2961
 Retail and Terminal Business Unit (RTBU) Job
 Construction/Retail Job

Chevron Consultant: CRA
 Address: 5900 Hollis St. Suite A Emeryville,
 CA Consultant Contact: Charlotte Evans
 Consultant Phone No. 510-420-3351
 Consultant Project No. 090818-802
 Sampling Company: Blaine Tech Services
 Sampled By (Print): L Ortiz
 Sampler Signature: [Signature]

ANALYSES REQUIRED

- EPA 8260B/GCMS
- EPA 8015B
- EPA 8021B
- EPA 6010 Ca, Fe, K, Mg, Mn, Na
- EPA 6010/7000 TITLE 22 METALS
- EPA 150.1 PH
- SM2510B SPECIFIC CONDUCTIVITY
- EPA 418.1 TRPH
- HVOC
- OXYGENATES
- DRO
- GRO
- MTBE
- HC SCREEN
- ORO
- TLC
- STLC
- EPA 310.1 ALKALINITY
- EPA 413.1 OIL & GREASE

Preservation Codes
 H = HCL T = Thiosulfate
 N = HNO₃ B = NaOH
 S = H₂SO₄ O = Other

Charge Code: NWRTB-0091153-0-OML
 NWRTB 00SITE NUMBER-0- WBS
(WBS ELEMENTS:
 SITE ASSESSMENT: A1L REMEDIATION IMPLEMENTATION: R5L
 SITE MONITORING: OML OPERATION MAINTENANCE & MONITORING: M1L
THIS IS A LEGAL DOCUMENT. ALL FIELDS MUST BE FILLED OUT CORRECTLY AND COMPLETELY.

Lancaster Laboratories
 Lancaster, PA
 Lab Contact: Jill Parker
 2425 New Holland Pike,
 Lancaster, PA 17601
 Phone No:
 (717)656-2300

Other Lab

Temp. Blank Check
 Time Temp.
0:00 1°
1:00 20
1:00 20
1:00 20

Special Instructions
 Must meet lowest detection limits possible for 8260 Compounds
acc# 10991
Ep# 1158455
sample# 5754681-65

SAMPLE ID				Sample Time	# of Containers	Container Type	ANALYSES REQUIRED												Notes/Comments				
Field Point Name	Matrix	Top Depth	Date (yyymmdd)				EPA 8260B/GCMS	EPA 8015B	EPA 8021B	EPA 6010 Ca, Fe, K, Mg, Mn, Na	EPA 6010/7000 TITLE 22 METALS	EPA 150.1 PH	SM2510B SPECIFIC CONDUCTIVITY	EPA 418.1 TRPH	HVOC	OXYGENATES	DRO	GRO		MTBE	TLC	STLC	EPA 310.1 ALKALINITY
MW-5	W		090818	0920	6	VOLS	X	X	X	X	X	X	X	X	X	X	X	X	X	X	X	X	
MW-6	↓		↓	1000	↓	↓	X	X	X	X	X	X	X	X	X	X	X	X	X	X	X	X	
MW-7	↓		↓	1025	↓	↓	X	X	X	X	X	X	X	X	X	X	X	X	X	X	X	X	
MW-10	↓		↓	1105	↓	↓	X	X	X	X	X	X	X	X	X	X	X	X	X	X	X	X	
QA	T		↓	1000	2	↓	X	X	X	X	X	X	X	X	X	X	X	X	X	X	X	X	

Relinquished By: <u>[Signature]</u> Company: <u>BTS</u> Date/Time: <u>8-18-09/1555</u>	Relinquished To: <u>[Signature]</u> Company: <u>BTS</u> Date/Time: <u>8-16-09/1555</u>
Relinquished By: <u>[Signature]</u> Company: <u>(BTS)</u> Date/Time: <u>8/19/09 1305</u>	Relinquished To: <u>[Signature]</u> Company: <u>LLI</u> Date/Time: <u>8/19/09 1305</u>
Relinquished By: <u>[Signature]</u> Company: <u>LLI</u> Date/Time: <u>19 AUG 09 1630</u>	Relinquished To: <u>[Signature]</u> Company: <u>FED EX</u> Date/Time: _____

Turnaround Time:
 Standard 24 Hours 48 hours 72
 Hours Other
 Sample Integrity: (Check by lab on arrival)
 Intact: On Ice: Temp: 13-23
 COC # _____

[Signature] LLI [Signature] Phobon 0905

Lancaster Laboratories Explanation of Symbols and Abbreviations

The following defines common symbols and abbreviations used in reporting technical data:

N.D.	none detected	BMQL	Below Minimum Quantitation Level
TNTC	Too Numerous To Count	MPN	Most Probable Number
IU	International Units	CP Units	cobalt-chloroplatinate units
umhos/cm	micromhos/cm	NTU	nephelometric turbidity units
C	degrees Celsius	F	degrees Fahrenheit
Cal	(diet) calories	lb.	pound(s)
meq	milliequivalents	kg	kilogram(s)
g	gram(s)	mg	milligram(s)
ug	microgram(s)	l	liter(s)
ml	milliliter(s)	ul	microliter(s)
m3	cubic meter(s)	fib >5 um/ml	fibers greater than 5 microns in length per ml
<	less than – The number following the sign is the <u>limit of quantitation</u> , the smallest amount of analyte which can be reliably determined using this specific test.		
>	greater than		
ppm	parts per million – One ppm is equivalent to one milligram per kilogram (mg/kg), or one gram per million grams. For aqueous liquids, ppm is usually taken to be equivalent to milligrams per liter (mg/l), because one liter of water has a weight very close to a kilogram. For gases or vapors, one ppm is equivalent to one microliter of gas per liter of gas.		
ppb	parts per billion		
Dry weight basis	Results printed under this heading have been adjusted for moisture content. This increases the analyte weight concentration to approximate the value present in a similar sample without moisture.		

U.S. EPA data qualifiers:

Organic Qualifiers

A	TIC is a possible aldol-condensation product
B	Analyte was also detected in the blank
C	Pesticide result confirmed by GC/MS
D	Compound quantitated on a diluted sample
E	Concentration exceeds the calibration range of the instrument
J	Estimated value
N	Presumptive evidence of a compound (TICs only)
P	Concentration difference between primary and confirmation columns >25%
U	Compound was not detected
X,Y,Z	Defined in case narrative

Inorganic Qualifiers

B	Value is <CRDL, but ≥IDL
E	Estimated due to interference
M	Duplicate injection precision not met
N	Spike amount not within control limits
S	Method of standard additions (MSA) used for calculation
U	Compound was not detected
W	Post digestion spike out of control limits
*	Duplicate analysis not within control limits
+	Correlation coefficient for MSA <0.995

Analytical test results for methods listed on the laboratories' accreditation scope meet all requirements of NELAC unless otherwise noted under the individual analysis.

Tests results relate only to the sample tested. Clients should be aware that a critical step in a chemical or microbiological analysis is the collection of the sample. Unless the sample analyzed is truly representative of the bulk of material involved, the test results will be meaningless. If you have questions regarding the proper techniques of collecting samples, please contact us. We cannot be held responsible for sample integrity, however, unless sampling has been performed by a member of our staff. This report shall not be reproduced except in full, without the written approval of the laboratory.

WARRANTY AND LIMITS OF LIABILITY – In accepting analytical work, we warrant the accuracy of test results for the sample as submitted. THE FOREGOING EXPRESS WARRANTY IS EXCLUSIVE AND IS GIVEN IN LIEU OF ALL OTHER WARRANTIES, EXPRESSED OR IMPLIED. WE DISCLAIM ANY OTHER WARRANTIES, EXPRESSED OR IMPLIED, INCLUDING A WARRANTY OF FITNESS FOR PARTICULAR PURPOSE AND WARRANTY OF MERCHANTABILITY. IN NO EVENT SHALL LANCASTER LABORATORIES BE LIABLE FOR INDIRECT, SPECIAL, CONSEQUENTIAL, OR INCIDENTAL DAMAGES INCLUDING, BUT NOT LIMITED TO, DAMAGES FOR LOSS OF PROFIT OR GOODWILL REGARDLESS OF (A) THE NEGLIGENCE (EITHER SOLE OR CONCURRENT) OF LANCASTER LABORATORIES AND (B) WHETHER LANCASTER LABORATORIES HAS BEEN INFORMED OF THE POSSIBILITY OF SUCH DAMAGES. We accept no legal responsibility for the purposes for which the client uses the test results. No purchase order or other order for work shall be accepted by Lancaster Laboratories which includes any conditions that vary from the Standard Terms and Conditions of Lancaster Laboratories and we hereby object to any conflicting terms contained in any acceptance or order submitted by client.