



BLAINE TECH SERVICES INC.

1370 TULLY RD., SUITE 505
SAN JOSE, CA 95122
(408) 995-5535

June 19, 1986

Chevron USA, Inc.
2 Annabel Lane, Suite 200
San Ramon, CA 94583

Attention: Vicki Hobbs

Re: Field sampling at

Chevron Station #1153
Fernside Blvd.
Alameda, CA
on
June 4, 1986

SAMPLING REPORT

Sampling was performed in accordance with approved methodology at the locations shown on the accompanying site diagram. The lab numbers assigned to the samples are given on the site diagram. Samples were collected in appropriate containers, which were sealed, chilled and transported to the laboratory for analysis. Analytical services were provided by Thermo Analytical, Inc/ERG with a separate report and billing invoice referencing their lab numbers.

Tanks

age -- unspecified

type -- one 550 gallon waste oil
one 750 gallon waste oil
one 3,000 gallon gasoline
one 6,000 gallon gasoline
one 8,000 gallon gasoline

reason for removal -- discontinuation of on site storage

Reportage

Submission to the Regional Water Quality Control Board and the Fire Department should include copies of both the sampling report and the laboratory report. The property owner should attach a cover letter and submit all documents together in a package.

MAP REF: THOMAS BROS.
ALAMEDA COUNTY
P. 12 A-5

LEGEND: F = FILL END

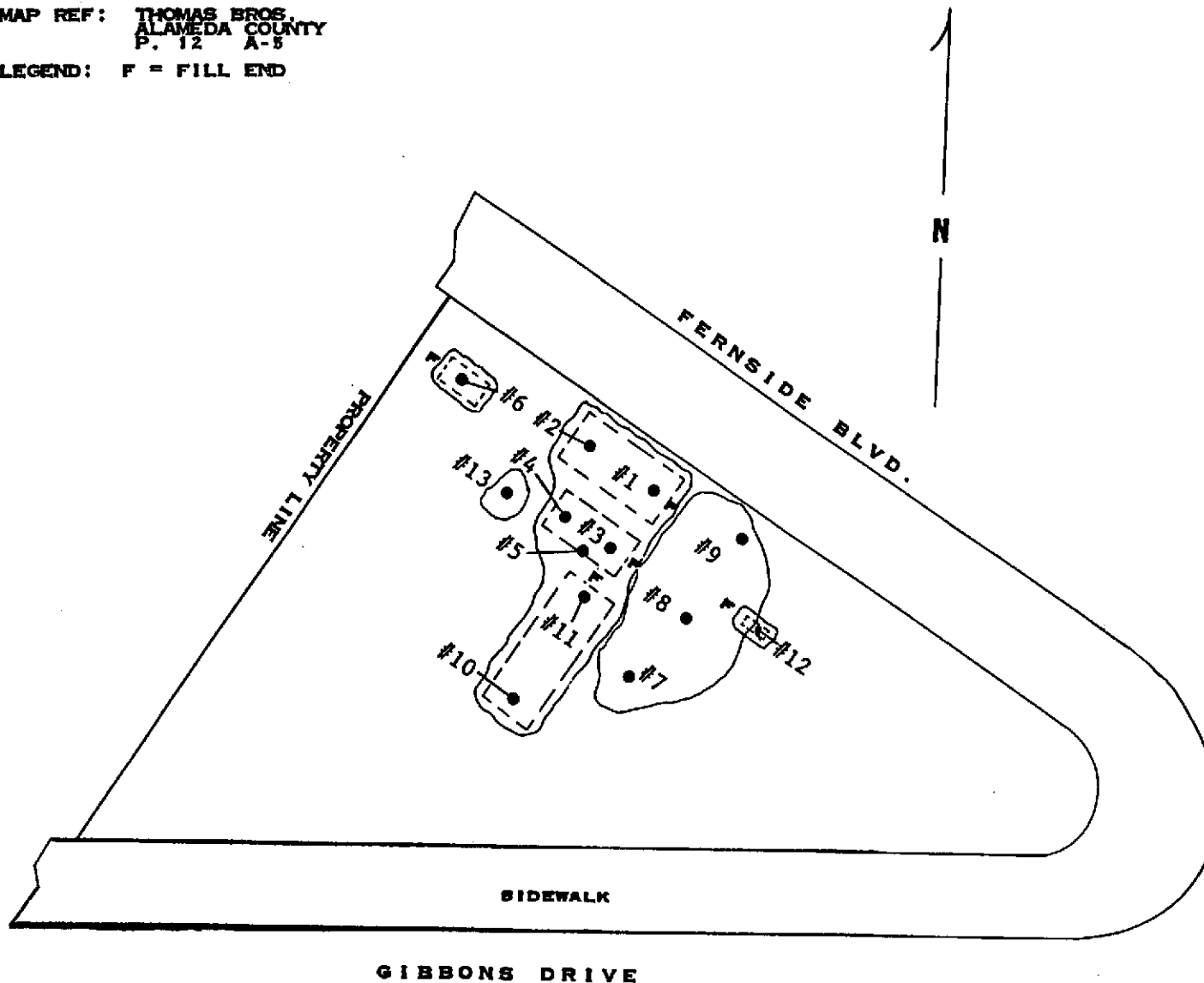

- #1 SOIL FROM 11' ANALYSIS FOR GASOLINE AT THERMO ANALYTICAL, INC/ERG TMA/ERG LAB NO. 7920-1
- #2 SOIL FROM 12' ANALYSIS FOR GASOLINE TMA/ERG LAB NO. 7920-2
- #3 SOIL FROM 10' ANALYSIS FOR GASOLINE TMA/ERG LAB NO. 7920-3
- #4 SOIL FROM 10.5' ANALYSIS FOR GASOLINE TMA/ERG LAB NO. 7920-4
- #5 SUBSURFACE WATER SAMPLE ANALYSIS FOR GASOLINE TMA/ERG LAB NO. 7920-5
- #6 SOIL FROM 8' ANALYSIS FOR WASTE OIL TMA/ERG LAB NO. 7920-6
- #7 SOIL FROM STOCKPILE AT 18" BELOW SURFACE ANALYSIS FOR GASOLINE TMA/ERG LAB NO. 7920-7
- #8 SOIL FROM STOCKPILE AT 20" BELOW SURFACE ANALYSIS FOR GASOLINE TMA/ERG LAB NO. 7920-8
- #9 SOIL FROM STOCKPILE AT 13" BELOW SURFACE ANALYSIS FOR GASOLINE TMA/ERG LAB NO. 7920-9
- #10 SOIL FROM 10' ANALYSIS FOR GASOLINE TMA/ERG LAB NO. 7920-10
- #11 SOIL FROM 12' ANALYSIS FOR GASOLINE TMA/ERG LAB NO. 7920-11
- #12 SOIL FROM 10' ANALYSIS FOR GASOLINE TMA/ERG LAB NO. 7920-12
- #13 SOIL FROM STOCKPILE AT 12-18" BELOW SURFACE ANALYSIS FOR WASTE OIL TMA/ERG LAB NO. 7920-13

SAMPLING PERFORMED BY
FRANK A. CLINE

DIAGRAM PREPARED BY
TAMMIE STALLINGS

The following addresses have been listed here for your convenience:

Water Quality Control Board
San Francisco Bay Region
1111 Jackson Street
Room 6040
Oakland, CA 94607
ATTN: Dale Bowyer

Alameda Bureau of Fire Prevention
1300 Park Street
Alameda, CA 94504
ATTN: Albert L. Smith

If I can be of any further assistance, please call.

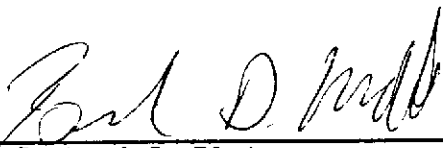

Richard C. Blaine

RCB/tls

BLAKE TECH SERVICES

P.O. BOX 5745
SAN JOSE, CA 95150
(408) 723-3974

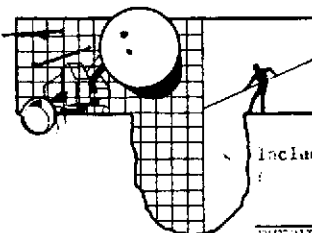

Include ALL of the following designation in lab reports and invoices

86155 F1

Chevron #1153
at Fernside Dr
Alameda

EVERYTHING written above this line is the project designation

Field sampling completed 13:50 hrs. 6-4-86 performed by Blair

RELEASED BY	ACCEPTED BY
14:16 hrs. 6-4-86 <u>Blair</u>	14:16 hrs. 6-4-86 <u>[Signature]</u>
: hrs. - -86	: hrs. - -86
: hrs. - -86	: hrs. - -86
: hrs. - -86	: hrs. - -86

LAB #	TYPE	ANALYSIS	LAB #	RESULTS	INSTR.
#1 Gas	Soil	Gas			N
#2 Gas					
#3 Gas					
#4 Gas					
#5 Gas	Waste				
#6 Waste Oil	Soil	Waste Oil			ND
#7 Stockpile	Soil				150
#8 Stockpile	Soil				530
#9 Stockpile	Soil				150
#10 Gas	Soil				150
#11 Gas	Soil				150

TURN AROUND 2 1/2 hr Rush to Vicki Hobbs
#12 Waste Oil Soil Waste Oil
#13 Gas Stockpile Soil Wet Gas
CHEVRON USA, INC
2 HANNA DEL LANE, SUITE 200
SANTA RIMON, CA 94583

Attn: VICKI HOBBS
Phone: 415-832-5232
Attn: _____
Verbal/Ref: _____

SPECIAL INSTRUCTIONS
() Phone results to _____
() Phone results to _____

TMA

Thermo Analytical Inc.

TMA/ERG

1400 West 53rd Street

Suite 460

Emeryville, CA 94608-2946

(415) 652-2300

June 4, 1986

Chevron USA
2 Annabel Lane, Suite #200
San Ramon, CA 94583

Attention: Vicki Hobbs

Report #7920

Release #23

Site Location: Chevron Station #1153, Fernside Dr., Alameda.

RE: Ten (10) soil samples submitted on June 4, 1986 for rush gasoline analysis; also two (2) samples for waste oil analysis; one (1) water for gasoline analysis.

Procedure: The samples are analyzed for gasoline by following the method described in Attachment 2, Analytical Procedures for Fuel Leak Investigations. The samples are concentrated on a Tekmar LSC-2 automatic sample concentrator prior to injection into a gas chromatograph fitted with a flame ionization detector. Quantitation is performed, as total hydrocarbon response, against known concentrations of gasoline. The limit of detection for this method of analysis is one part per million (mg/kg), unless stated otherwise.

The samples are analyzed for waste oil by following a modified EPA Method 3510 extraction procedure. The samples are extracted three times with hexane. The solvent is removed from the combined extracts and carbon disulfide is added. The solution is injected into a gas chromatograph fitted with a flame ionization detector. Quantitation is performed, as total hydrocarbon response, against a solution made from a known concentration of light machine oil. The limit of detection for this method of analysis is eleven parts per million (mg/kg).

The results are summarized in Table I.

Submitted by:

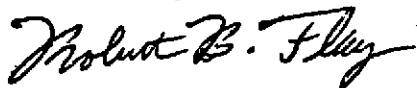

Robert B. Flay
Manager, Organics Department

RBF:sm1

cc: Rich Blaine
Blaine Tech Service
P.O. Box 5745
San Jose, CA 95150

TABLE I

<u>ERG #</u>	<u>CLIENT ID</u>	<u>GASOLINE CONCENTRATION (mg/kg or mg/L)</u>
7920-1	86155 F1 #1	ND(1)
7920-2	86155 F1 #2	ND(1)
7920-3	86155 F1 #3	ND(1)
7920-4	86155 F1 #4	ND(1)
7920-5	86155 F1 #5	130 ppm**
7920-6	86155 F1 #6	ND(11)*
7920-7	86155 F1 #7	1400
7920-8	86155 F1 #8	530
7920-9	86155 F1 #9	150
7920-10	86155 F1 #10	ND(1)
7920-11	86155 F1 #11	ND(1)
7920-12	86155 F1 #12	ND(11)*
7920-13	86155 F1 #13	33

*waste oil, by extraction

**water sample (mg/L)

ND = None detected. The limits of detection are in ().