

Commercial Laundry

California Linen Rental Co.

Complete Towel & Linen Service
Washable Uniforms for All Professions
Walk on Mats/Cloth Towel Cabinets

FAX COVER SHEET

DATE: *10/5/05* LOG NO.

TIME: *1:00 PM* NUMBER OF PAGES 2
(INCLUDING COVER SHEET)

INSTRUCTIONS
CONFIDENTIAL
URGENT
PLEASE REPLY
FOR YOUR INFORMATION

TO:
Mr. ~~Ms.~~ *Barney Chan*

OF: *Alameda County Dept of Environmental Health*

FAX #: *510-337-9335*

FROM:
Mr. **JOEL PITNEY**

OF: **CALIFORNIA LINEN RENTAL CO. INC.**

ADDRESS: **989 41st STREET OAKLAND, CA. 94608**

FAX #: **510 - 601-8005**

PHONE: **510 - 653-6300**

MESSAGE:

California Linen Rental Co., Inc. 989 41ST STREET • OAKLAND, CALIFORNIA 94608 • PHONE: (510) 653-6300 • FAX: (510) 601-8005

WE RENT TABLE LINENS, APRONS,
TOWELS, MATS, AND WASHABLE
GARMENTS FOR ALL BUSINESSES
AND PROFESSIONS

ESTABLISHED OVER 80 YEARS • PROMPT ECONOMICAL SERVICE

October 5, 2005

**Mr. Barney Chan
Alameda County Department of Environmental Health
1131 Harbor Bay Parkway, Suite 250
Alameda, CA 94502**

**Re: WORK PLAN ADDENDUM CERTIFICATION
California Linen Rental Co.
Fuel Leak Case RO0000337
989 41st St.
Oakland, CA 94608**

Dear Mr. Chan:

RGA Environmental, Inc. (RGA) has transmitted to you under separate cover a work plan addendum (document 0304.W2A) dated October 5, 2005 for RGA's Subsurface Investigation Work Plan (B4 to B9), dated May 25, 2005, (document 0304.W2). Boreholes B4, B5 and B6 were drilled on September 13, 2005. The work plan addendum is submitted to further investigate the presence of Stoddard solvent detected in borehole B6.

I declare, under penalty of perjury, that the information and/or recommendations contained in the above-mentioned work plan for the subject site is true and correct to the best of my knowledge.

Should you have any questions, please do not hesitate to call me at (510) 653-6300.

Cordially,

California Linen Supply Co.

Joel C. Pitney
General Manager

**Cc: Donald J. Miller, California Linen Supply Co.
LeRoy Griffin, Oakland Fire Department, Office of Emergency Services, 250
Frank Ogawa Plaza, Suite 3341, Oakland, CA 94612**

phk
0304.L15

October 5, 2005
Work Plan 0304.W2A
RGA Job # CLR11939

Mr. Barney Chan
Alameda County Environmental Health Services
1131 Harbor Bay Parkway
Alameda, CA 94502-6577



SUBJECT: SUBSURFACE INVESTIGATION WORK PLAN ADDENDUM
Fuel Leak Case RO0000337
California Linen Rental Company
989 41st Street
Oakland, CA

Dear Mr. Chan:

RGA Environmental, Inc. (RGA) is pleased to present this addendum to our previously submitted Subsurface Contamination Work Plan (B4 to B9) dated May 25, 2005 (document 0304.W2). The work plan was approved in a letter from the Alameda County Environmental Health Services (ACEHS) dated July 18, 2005.

This work plan addendum is prepared as a result of conditions encountered during the drilling of boreholes B4 through B6 on September 13, 2005. During drilling, strong solvent odors distinctly different from gasoline were encountered in borehole B6. Boreholes B7 through B9 identified in the May 25, 2005 work plan have not yet been drilled.

The groundwater samples from boreholes B4 and B6 were collected using PVC pipe in boreholes that were open to depths of 28 and 24 feet, respectively. In borehole B5, a depth-discrete groundwater sample was collected using a Hydropunch between the depths of 24 and 28 feet to avoid ^{cross contamination} because groundwater entered the borehole and rose to an elevation above shallow soil exhibiting very strong petroleum hydrocarbon odors and green discoloration. For boreholes B4 through B6, the soil sample results are summarized in Table 1, and groundwater sample results are summarized in Table 2.

RGA proposes to drill boreholes B7 through B12 at locations shown on the attached Site Vicinity Map, Figure 1. The locations of B7 through B9 shown on Figure 1 supersede the locations of B7 through B9 in the May 25, 2005 work plan. Soil and water samples from boreholes B7 through B12 will be collected and analyzed using procedures and methods identified in the May 25, 2005 work plan.

October 5, 2005
Work Plan 0304.W2A
RGA Job # CLR11939

Should you have any questions or comments, please do not hesitate to contact us at (510) 547-7771.

Sincerely,

RGA Environmental, Inc.



for

Karin Schroeter
Project Manager

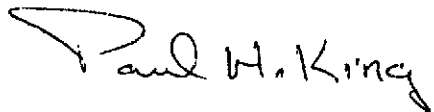

Paul H. King
Professional Geologist #5901
Expires: 12/31/05

Attachments: Tables 1, 2
Site Vicinity Map (Figure 1)

PHK
0304.W2A

October 5, 2005
 Work Plan 0304.W2A
 RGA Job # CLR11939

TABLE 1
 SUMMARY OF LABORATORY ANALYTICAL RESULTS
 BOREHOLE SOIL SAMPLES

Borehole No.	TPH-G/ TPH-SS	Benzene	Toluene	Ethylbenzene	Xylenes	Other VOCs
B4-5.0	ND<1.0/--	ND<0.005	ND<0.005	ND<0.005	ND<0.005	ND<0.05
B4-7.5	ND<1.0/--	ND<0.005	ND<0.005	ND<0.005	ND<0.005	ND<0.05
B4-10.0	ND<1.0/--	ND<0.005	ND<0.005	ND<0.005	ND<0.005	ND<0.05
B4-21.5	ND<1.0/--	ND<0.005	ND<0.005	ND<0.005	ND<0.005	ND<0.05
B5-5.0	ND<1.0/--	ND<0.005	ND<0.005	ND<0.005	ND<0.005	ND<0.05
B5-7.5	590,b,c/--	ND<0.20	0.20	0.66	4.0	ND<2.0
B5-11.0	ND<1.0/--	ND<0.005	ND<0.005	ND<0.005	ND<0.005	ND<0.05
B5-19.5	ND<1.0/--	ND<0.005	ND<0.005	ND<0.005	ND<0.005	ND<0.05
B6-5	ND<1.0/--	ND<0.005	ND<0.005	ND<0.005	ND<0.005	ND<0.05
B6-7	240,a,c/--	ND<0.20	ND<0.20	1.7	9.2	ND<2.0
B6-10	ND<1.0/ ND<1.0	ND<0.005	ND<0.005	ND<0.005	ND<0.005	ND<0.05
B6-12.5	4.9/5.1	ND<0.005	0.020	0.040	0.23	ND<0.05
B6-13.5	ND<1.0/ ND<1.0	ND<0.005	ND<0.005	ND<0.005	0.019	ND<0.05
B6-17.0	15/12	0.0085	ND<0.005	0.17	0.84	ND<0.05
B6-19.0	ND<1.0/ ND<1.0	ND<0.005	ND<0.005	ND<0.005	ND<0.005	ND<0.05

Notes:

TPH-G = Total Petroleum Hydrocarbons as Gasoline.

TPH-SS = Total Petroleum Hydrocarbons as Stoddard Solvent.

MTBE = Methyl tert-Butyl Ether

ND = Not Detected.

-- = Not Analyzed.

a = Laboratory analytical report note: heavier gasoline range compounds are significant (aged gasoline?).

b = Laboratory analytical report note: strongly aged gasoline or diesel range compounds are significant.

c = Laboratory analytical report note: no recognizable pattern.

Results in milligrams per Kilogram (mg/Kg), unless otherwise indicated.

October 5, 2005
 Work Plan 0304.W2A
 RGA Job # CLR11939

TABLE 2
 SUMMARY OF LABORATORY ANALYTICAL RESULTS
 BOREHOLE GROUNDWATER SAMPLES

Borehole No.	TPH-G/ TPH-SS	Benzene	Toluene	Ethylbenzene	Xylenes	Other VOCs
B4-28.0, Water	0.12,a	ND<0.0005	0.0016	ND<0.0005	0.00079	ND<0.005
B5-28.0, Water	0.12,a	0.001	0.001	0.0011	0.005	ND<0.005
B6-24.0, Water	1.9/ 1.4	0.023	0.00095	0.062	0.24	ND<0.005

Notes:

TPH-G = Total Petroleum Hydrocarbons as Gasoline.

TPH-SS = Total Petroleum Hydrocarbons as Stoddard Solvent.

MTBE = Methyl tert-Butyl Ether

ND = Not detected.

a = Laboratory analytical report note: liquid sample that contains greater than ~1 vol. % sediment.

Results in milligrams per Liter (mg/L), unless otherwise indicated.

LEGEND

- ◆ B6 EXISTING BOREHOLE LOCATION
 - ◆ B12 PROPOSED BOREHOLE LOCATION
 - UST FORMER UNDERGROUND STORAGE TANK
 - AST ABOVEGROUND STORAGE TANK
 - ⊕ MW2 EXISTING GROUNDWATER MONITORING WELL
- (1900) TPH-G CONCENTRATION IN GROUNDWATER, (ug/L)

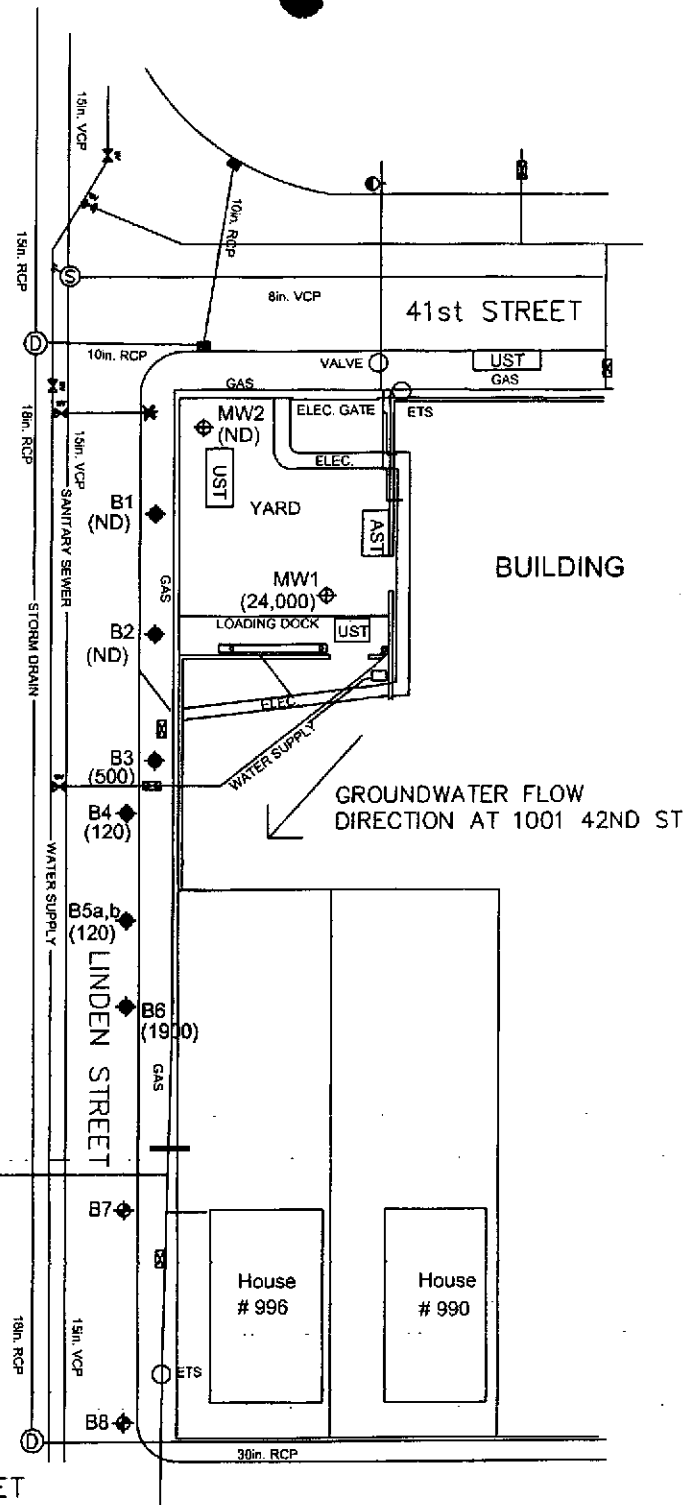
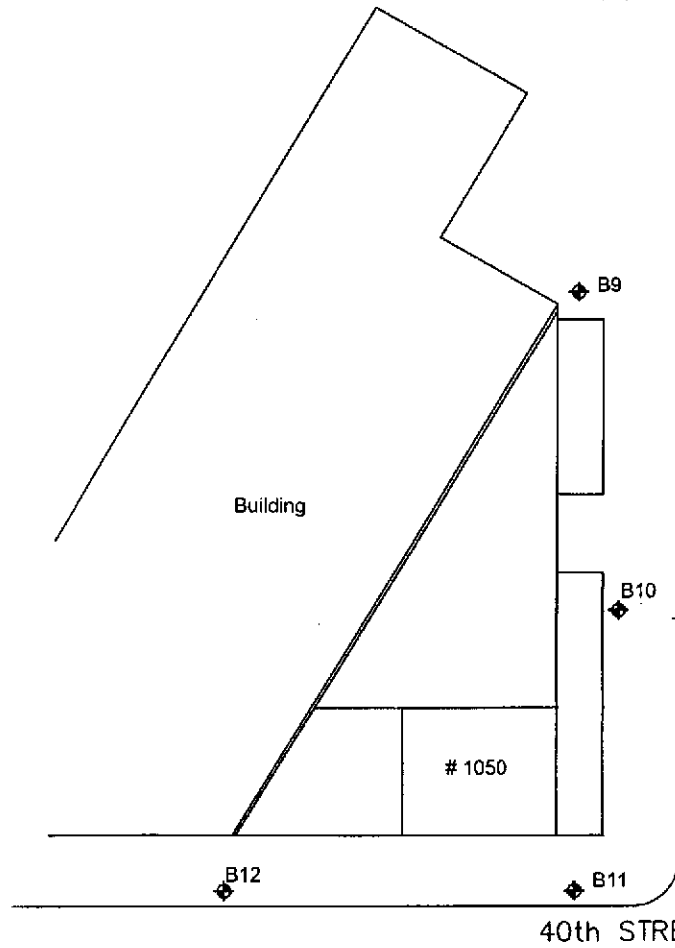

Figure 1
Site Vicinity Map
 California Linen Rental Company
 989 41st. Street
 Oakland, California



Based Map From
 California Utility Survey
 Utility Sketch Plan
 Feb. 14, 2005

RGA Environmental, Inc.
 1466 66th St.
 Emeryville, CA 94608

0 10 20 30 40 50
 Scale in Feet