

P&D ENVIRONMENTAL, INC.

55 Santa Clara Avenue, Suite 240

Oakland, CA 94610

(510) 658-6916

August 31, 2012

Letter 0304.L110

Ms. Cheryl Robinson

984 40th Street

Oakland, CA 94608

SUBJECT: SITE SAMPLING SUMMARY

984 40th Street

Oakland, CA

RECEIVED

4:43 pm, Sep 17, 2012

Alameda County

Environmental Health

Dear Ms. Robinson:

This letter summarizes the results of a groundwater grab sample collected on July 3, 2012 from a borehole designated as B92 and a soil gas sample collected on July 26, 2012 from a soil gas well designated as VW6-5 at 984 40th Street in Oakland. A map showing the sample collection locations is attached as Figure 1.

Both the groundwater sample B92-W and the soil gas sample VW6 were analyzed for Total Petroleum Hydrocarbons as Gasoline, and for the associated gasoline components of MTBE, benzene, toluene, ethylbenzene, and total xylenes. The only compounds detected in groundwater sample B92-W were toluene, ethylbenzene, and total xylenes at concentrations below regulatory agency screening concentrations. The only compounds detected in soil gas sample V W6 were gasoline, toluene, ethylbenzene, m,p-xylenes, and o-xylenes which were also detected at concentrations below regulatory agency screening levels. Concentrations below regulatory agency screening levels are considered to not be harmful, and for this reason do not require further evaluation. Copies of the laboratory reports are attached with this letter. The laboratory reports have been redacted to only show results for samples collected at your property.

August 31, 2012
Letter 0304.L110

Should you have any questions, please do not hesitate to call me at (510) 658-4363.

Sincerely,
P&D Environmental, Inc.

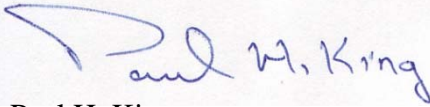

Paul H. King
California Professional Geologist #5901
Expires: 12/31/13

Cc: Mr. Mark Detterman

Attachments:

Figure 1 - Site Map Showing Sample Collection Locations at 984 40th Street
Appendix A - Laboratory Analytical Reports and Chain of Custody Documentation

PHK/sjc
0304.L110

FIGURES

41st STREET

SIDEWALK

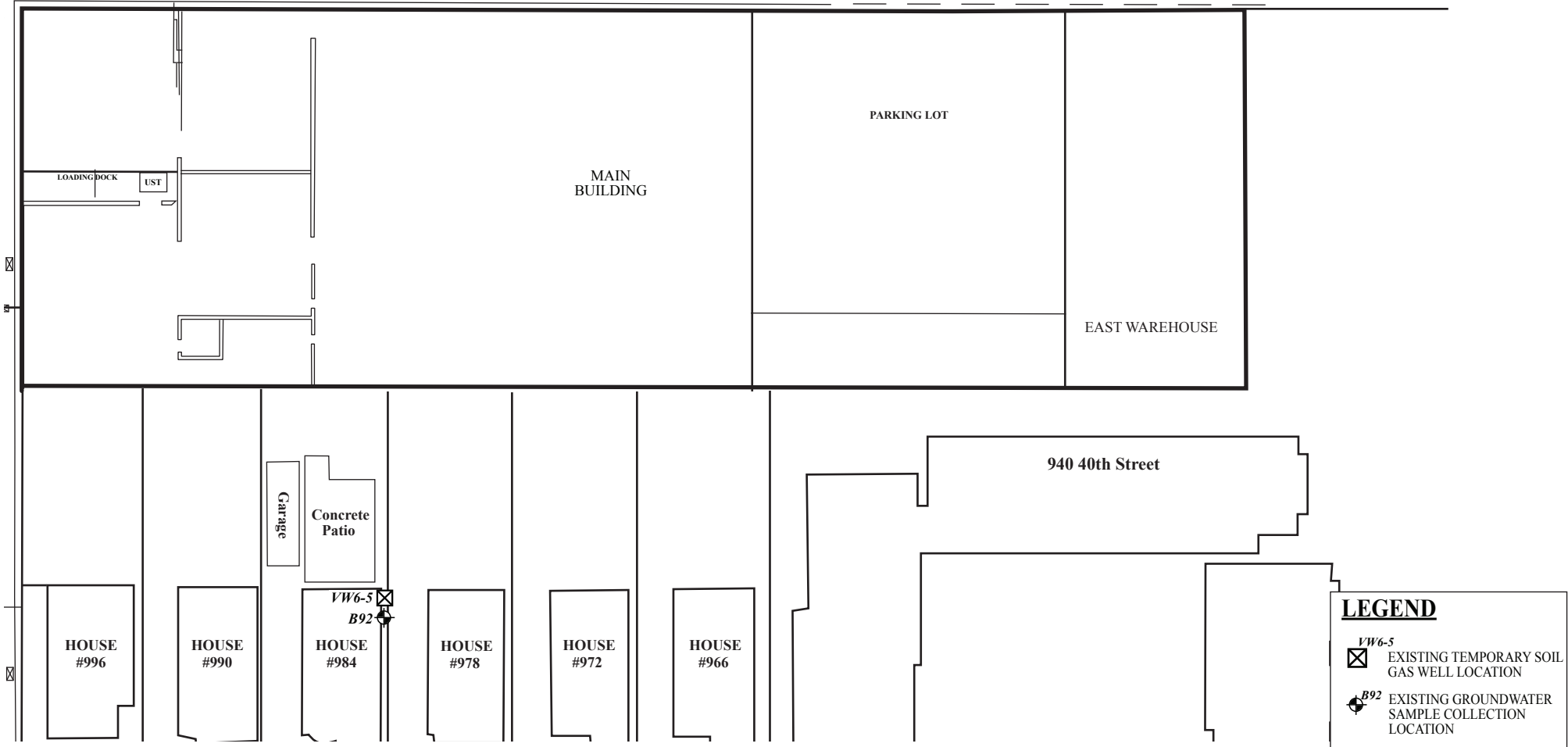

LEGEND





-  VW6-5 EXISTING TEMPORARY SOIL GAS WELL LOCATION
-  B92 EXISTING GROUNDWATER SAMPLE COLLECTION LOCATION

Figure 1
 Site Map Showing Sample Collection Locations at 984 40th Street
 California Linen Rental Company
 989 41st Street
 Oakland, California

Base Map From:
 California Utility Survey Utility Sketch Plan,
 Feb. 14, 2005, Google Earth, June 2007,
 and JR Associates, June 2011

P&D Environmental, Inc.
 55 Santa Clara Avenue, Suite 240
 Oakland, CA 94610

0 25 50

 Approximate Scale in Feet

 N

APPENDIX A

Laboratory Analytical Reports and Chain of Custody Documentation

- **McC Campbell Analytical Inc. Work Order # 1207071 - Groundwater sample B92 Analytical Results**
- **Air Toxics Work Order # 1207155A - Soil Gas Sample VW6 TPH-G Results**
- **Air Toxics Work Order # 1207155B - Soil Gas Sample VW6 MTBE, and BTEX Results**



Analytical Report

P & D Environmental 55 Santa Clara, Ste.240 Oakland, CA 94610	Client Project ID: #0304; California Linen Rental Co.	Date Sampled: 07/02/12-07/03/12
		Date Received: 07/03/12
	Client Contact: Paul King	Date Reported: 07/09/12
	Client P.O.:	Date Completed: 07/09/12

WorkOrder: 1207071

July 09, 2012

Dear Paul:

Enclosed within are:

- 1) The results of the **2** analyzed samples from your project: **#0304; California Linen Rental Co.,**
- 2) QC data for the above samples, and
- 3) A copy of the chain of custody.

All analyses were completed satisfactorily and all QC samples were found to be within our control limits.

If you have any questions or concerns, please feel free to give me a call. Thank you for choosing

McC Campbell Analytical Laboratories for your analytical needs.

Best regards,

Angela Rydelius
 Laboratory Manager
 McC Campbell Analytical, Inc.

The analytical results relate only to the items tested.

CHAIN OF CUSTODY RECORD

1207071

PAGE 1 OF 1

P&D ENVIRONMENTAL, INC.

55 Santa Clara Ave., Suite 240
Oakland, CA 94610
(510) 658-6916

PROJECT NUMBER:

0304

PROJECT NAME:

CALIFORNIA LINEN RENTAL Co.
989 41st ST
OAKLAND

SAMPLED BY: (PRINTED & SIGNATURE)

Michael Deschenes *Michael Deschenes*

NUMBER OF CONTAINERS

ANALYSIS(ES):

TPHS BY EPA 8013 AND MODIFIED
EPA 8015 WITH SILICA GEL CLEANUP
MBTEX BY EPA 8021B

PRESERVATIVE

REMARKS

+
L

B92-w

7/3/12

1300

H20

984 40th St.

5 X

X

ICE

" " "

ICE/1st

24

GOOD CONDITION

APPROPRIATE

HEAD SPACE ABSENT

CONTAINERS

DECLORINATED IN LAB

PRESERVED IN LAB

VOAS | O&G | METALS | OTHER

PRESERVATION

RELINQUISHED BY: (SIGNATURE)

DATE

TIME

RECEIVED BY: (SIGNATURE)

Total No. of Samples (This Shipment)

2

LABORATORY:

RELINQUISHED BY: (SIGNATURE)

DATE

TIME

RECEIVED BY: (SIGNATURE)

Total No. of Containers (This Shipment)

10

McCAUPBELL ANALYTICAL

RELINQUISHED BY: (SIGNATURE)

DATE

TIME

RECEIVED FOR LABORATORY BY: (SIGNATURE)

LABORATORY CONTACT:

LABORATORY PHONE NUMBER:

ANGELA RYDELIUS (925) 252-9262

SAMPLE ANALYSIS REQUEST SHEET

ATTACHED: () YES (X) NO

Results and billing to:
P&D Environmental, Inc.
lab@pdenviro.com

REMARKS:

ALL VOA'S PRESERVED WITH HCL



1534 Willow Pass Rd
 Pittsburg, CA 94565-1701
 (925) 252-9262

WorkOrder: 1207071

ClientCode: PDEO

WaterTrax
 WriteOn
 EDF
 Excel
 EQUiS
 Email
 HardCopy
 ThirdParty
 J-flag

Report to:	Paul King P & D Environmental 55 Santa Clara, Ste.240 Oakland, CA 94610 (510) 658-6916 FAX: 510-834-0152	Email: lab@pdenviro.com cc: PO: ProjectNo: #0304; California Linen Rental Co.	Bill to:	Accounts Payable P & D Environmental 55 Santa Clara, Ste.240 Oakland, CA 94610	Requested TAT:	5 days
					<i>Date Received:</i>	07/03/2012
					<i>Date Printed:</i>	07/03/2012

Lab ID	Client ID	Matrix	Collection Date	Hold	Requested Tests (See legend below)												
					1	2	3	4	5	6	7	8	9	10	11	12	
1207071-001	B91-W	Water	7/2/2012 13:50	<input type="checkbox"/>	A												
1207071-002	B92-W	Water	7/3/2012 13:00	<input type="checkbox"/>	A												

Test Legend:

1	G-MBTEX_W	2		3		4		5	
6		7		8		9		10	
11		12							

Prepared by: Zoraida Cortez

Comments:

NOTE: Soil samples are discarded 60 days after results are reported unless other arrangements are made (Water samples are 30 days).
 Hazardous samples will be returned to client or disposed of at client expense.



Sample Receipt Checklist

Client Name: **P & D Environmental** Date and Time Received: **7/3/2012 9:48:26 PM**
 Project Name: **#0304; California Linen Rental Co.** LogIn Reviewed by: **Zoraida Cortez**
 WorkOrder N°: **1207071** Matrix: Water Carrier: Rob Pringle (MAI Courier)

Chain of Custody (COC) Information

Chain of custody present? Yes No
 Chain of custody signed when relinquished and received? Yes No
 Chain of custody agrees with sample labels? Yes No
 Sample IDs noted by Client on COC? Yes No
 Date and Time of collection noted by Client on COC? Yes No
 Sampler's name noted on COC? Yes No

Sample Receipt Information

Custody seals intact on shipping container/cooler? Yes No NA
 Shipping container/cooler in good condition? Yes No
 Samples in proper containers/bottles? Yes No
 Sample containers intact? Yes No
 Sufficient sample volume for indicated test? Yes No

Sample Preservation and Hold Time (HT) Information

All samples received within holding time? Yes No
 Container/Temp Blank temperature Cooler Temp: 2.4°C NA
 Water - VOA vials have zero headspace / no bubbles? Yes No No VOA vials submitted
 Sample labels checked for correct preservation? Yes No
 Metal - pH acceptable upon receipt (pH<2)? Yes No NA
 Samples Received on Ice? Yes No

(Ice Type: WET ICE)

* NOTE: If the "No" box is checked, see comments below.

 Comments:



McC Campbell Analytical, Inc.

"When Quality Counts"

1534 Willow Pass Road, Pittsburg, CA 94565-1701
Toll Free Telephone: (877) 252-9262 / Fax: (925) 252-9269
http://www.mcccampbell.com / E-mail: main@mcccampbell.com

P & D Environmental 55 Santa Clara, Ste.240 Oakland, CA 94610	Client Project ID: #0304; California Linen Rental Co.	Date Sampled: 07/02/12-07/03/12
	Client Contact: Paul King	Date Received: 07/03/12
	Client P.O.:	Date Extracted: 07/07/12
		Date Analyzed: 07/07/12

Gasoline Range (C6-C12) Volatile Hydrocarbons as Gasoline with BTEX and MTBE*

Extraction method: SW5030B

Analytical methods: SW8021B/8015Bm

Work Order: 1207071

Lab ID	Client ID	Matrix	TPH(g)	MTBE	Benzene	Toluene	Ethylbenzene	Xylenes	DF	% SS	Comments
002A	B92-W	W	ND	ND	ND	5.7	0.56	3.3	1	94	

Reporting Limit for DF =1; ND means not detected at or above the reporting limit	W	50	5.0	0.5	0.5	0.5	0.5	0.5	µg/L
	S	1.0	0.05	0.005	0.005	0.005	0.005	0.005	mg/Kg

* water and vapor samples are reported in ug/L, soil/sludge/solid samples in mg/kg, wipe samples in µg/wipe, product/oil/non-aqueous liquid samples and all TCLP & SPLP extracts in mg/L.

cluttered chromatogram; sample peak coelutes w/surrogate peak; low surrogate recovery due to matrix interference. %SS = Percent Recovery of Surrogate Standard; DF = Dilution Factor

The following descriptions of the TPH chromatogram are cursory in nature and McC Campbell Analytical is not responsible for their interpretation:
d2) heavier gasoline range compounds are significant (aged gasoline?)



QC SUMMARY REPORT FOR SW8021B/8015Bm

W.O. Sample Matrix: Water

QC Matrix: Water

BatchID: 68886

WorkOrder: 1207071

EPA Method: SW8021B/8015Bm		Extraction: SW5030B					Spiked Sample ID: 1207036-004A			
Analyte	Sample	Spiked	MS	MSD	MS-MSD	LCS	Acceptance Criteria (%)			
	µg/L	µg/L	% Rec.	% Rec.	% RPD	% Rec.	MS / MSD	RPD	LCS	
TPH(btex) £	ND	60	83.9	85.7	2.15	94.4	70 - 130	20	70 - 130	
MTBE	ND	10	90	88.7	1.44	98.2	70 - 130	20	70 - 130	
Benzene	ND	10	84.4	81	4.04	88.1	70 - 130	20	70 - 130	
Toluene	ND	10	86.5	82.2	5.03	88.6	70 - 130	20	70 - 130	
Ethylbenzene	ND	10	86.1	82.3	4.52	89.9	70 - 130	20	70 - 130	
Xylenes	ND	30	88.6	85	4.07	93	70 - 130	20	70 - 130	
%SS:	96	10	95	91	4.24	91	70 - 130	20	70 - 130	

All target compounds in the Method Blank of this extraction batch were ND less than the method RL with the following exceptions:
 NONE

BATCH 68886 SUMMARY

Lab ID	Date Sampled	Date Extracted	Date Analyzed	Lab ID	Date Sampled	Date Extracted	Date Analyzed
1207071-001A	07/02/12 1:50 PM	07/07/12	07/07/12 5:21 AM	1207071-002A	07/03/12 1:00 PM	07/07/12	07/07/12 5:50 AM

MS = Matrix Spike; MSD = Matrix Spike Duplicate; LCS = Laboratory Control Sample; LCSD = Laboratory Control Sample Duplicate; RPD = Relative Percent Deviation.
 % Recovery = 100 * (MS-Sample) / (Amount Spiked); RPD = 100 * (MS - MSD) / ((MS + MSD) / 2).
 MS / MSD spike recoveries and / or %RPD may fall outside of laboratory acceptance criteria due to one or more of the following reasons: a) the sample is inhomogenous AND contains significant concentrations of analyte relative to the amount spiked, or b) the spiked sample's matrix interferes with the spike recovery.
 £ TPH(btex) = sum of BTEX areas from the FID.
 # cluttered chromatogram; sample peak coelutes with surrogate peak.
 N/A = not enough sample to perform matrix spike and matrix spike duplicate.
 NR = matrix interference and/or analyte concentration in sample exceeds spike amount for soil matrix or exceeds 2x spike amount for water matrix or sample diluted due to high matrix or analyte content, or inconsistency in sample containers.

7/17/2012
Mr. Paul King
P & D Environmental
55 Santa Clara
Suite 240
Oakland CA 94610

Project Name: California Linen Rental Co. 989 41st St.
Project #: 0304
Workorder #: 1207155A

Dear Mr. Paul King

The following report includes the data for the above referenced project for sample(s) received on 7/10/2012 at Air Toxics Ltd.

The data and associated QC analyzed by Modified TO-3 are compliant with the project requirements or laboratory criteria with the exception of the deviations noted in the attached case narrative.

Thank you for choosing Air Toxics Ltd. for your air analysis needs. Air Toxics Ltd. is committed to providing accurate data of the highest quality. Please feel free to contact the Project Manager: Kyle Vagadori at 916-985-1000 if you have any questions regarding the data in this report.

Regards,



Kyle Vagadori
Project Manager

WORK ORDER #: 1207155A

Work Order Summary

CLIENT: Mr. Paul King
P & D Environmental
55 Santa Clara
Suite 240
Oakland, CA 94610

BILL TO: Mr. Paul King
P & D Environmental
55 Santa Clara
Suite 240
Oakland, CA 94610

PHONE: 510-658-6916

P.O. #

FAX: 510-834-0772

PROJECT # 0304 California Linen Rental Co. 989

DATE RECEIVED: 07/10/2012

CONTACT: 41st St.
Kyle Vagadori

DATE COMPLETED: 07/17/2012

<u>FRACTION #</u>	<u>NAME</u>	<u>TEST</u>	<u>RECEIPT VAC./PRES.</u>	<u>FINAL PRESSURE</u>
01A	VW5	Modified TO-3	6.0 "Hg	5 psi
02A	VW6	Modified TO-3	4.0 "Hg	5 psi
03A	VW7	Modified TO-3	2.0 "Hg	5 psi
04A	Lab Blank	Modified TO-3	NA	NA
05A	LCS	Modified TO-3	NA	NA
05AA	LCSD	Modified TO-3	NA	NA

CERTIFIED BY:



Technical Director

DATE: 07/17/12

Certification numbers: AZ Licensure AZ0719, CA NELAP - 02110CA, LA NELAP - 02089,
NY NELAP - 11291, TX NELAP - T104704434-11-3, UT NELAP -CA009332011-1, WA NELAP - C935
Name of Accrediting Agency: NELAP/Florida Department of Health, Scope of Application: Clean Air Act,
Accreditation number: E87680, Effective date: 07/01/11 , Expiration date: 06/30/12.

Air Toxics Ltd. certifies that the test results contained in this report meet all requirements of the NELAC standards

This report shall not be reproduced, except in full, without the written approval of Eurofins | Air Toxics, Inc.

180 BLUE RAVINE ROAD, SUITE B FOLSOM, CA - 95630
(916) 985-1000 . (800) 985-5955 . FAX (916) 985-1020

LABORATORY NARRATIVE
Modified TO-3
P & D Environmental
Workorder# 1207155A

Three 1 Liter Summa Canister samples were received on July 10, 2012. The laboratory performed analysis for volatile organic compounds in air via modified EPA Method TO-3 using gas chromatography with flame ionization detection. The TPH results are calculated using the response of Gasoline. A molecular weight of 100 is used to convert the TPH ppmv result to ug/L. The method involves concentrating up to 200 mL of sample. The concentrated aliquot is then dry purged to remove water vapor prior to entering the chromatographic system.

Method modifications taken to run these samples are summarized in the table below. Specific project requirements may over-ride the ATL modifications.

<i>Requirement</i>	<i>TO-3</i>	<i>ATL Modifications</i>
Daily Calibration Standard Frequency	Prior to sample analysis and every 4 - 6 hrs	Prior to sample analysis and after the analytical batch ≤ 20 samples.
Initial Calibration Calculation	4-point calibration using a linear regression model	5-point calibration using average Response Factor
Initial Calibration Frequency	Weekly	When daily calibration standard recovery is outside 75 - 125 %, or upon significant changes to procedure or instrumentation
Moisture Control	Nafion system	Sorbent system
Minimum Detection Limit (MDL)	Calculated using the equation $DL = A + 3.3S$, where A is intercept of calibration line and S is the standard deviation of at least 3 reps of low level standard	40 CFR Pt. 136 App. B
Preparation of Standards	Levels achieved through dilution of gas mixture	Levels achieved through loading various volumes of the gas mixture

Receiving Notes

There were no receiving discrepancies.

Analytical Notes

There were no analytical discrepancies.

Definition of Data Qualifying Flags

Seven qualifiers may have been used on the data analysis sheets and indicate as follows:

B - Compound present in laboratory blank greater than reporting limit.

J - Estimated value.

E - Exceeds instrument calibration range.

S - Saturated peak.

Q - Exceeds quality control limits.

U - Compound analyzed for but not detected above the detection limit.

M - Reported value may be biased due to apparent matrix interferences.

File extensions may have been used on the data analysis sheets and indicates as follows:

a-File was requantified

b-File was quantified by a second column and detector

r1-File was requantified for the purpose of reissue

Summary of Detected Compounds
MODIFIED EPA METHOD TO-3 GC/FID

Client Sample ID: VW6

Lab ID#: 1207155A-02A

Compound	Rpt. Limit (ppmv)	Rpt. Limit (ug/L)	Amount (ppmv)	Amount (ug/L)
TPH (Gasoline Range)	0.039	0.16	1.8	7.4



Air Toxics

Client Sample ID: VW6

Lab ID#: 1207155A-02A

MODIFIED EPA METHOD TO-3 GC/FID

File Name:	d071006	Date of Collection:	7/6/12 10:05:00 AM	
Dil. Factor:	1.55	Date of Analysis:	7/11/12 10:00 AM	

Compound	Rpt. Limit (ppmv)	Rpt. Limit (ug/L)	Amount (ppmv)	Amount (ug/L)
TPH (Gasoline Range)	0.039	0.16	1.8	7.4

Container Type: 1 Liter Summa Canister

Surrogates	%Recovery	Method Limits
Fluorobenzene (FID)	90	75-150



Air Toxics

Client Sample ID: Lab Blank

Lab ID#: 1207155A-04A

MODIFIED EPA METHOD TO-3 GC/FID

File Name:	d071004	Date of Collection:	NA	
Dil. Factor:	1.00	Date of Analysis:	7/10/12 08:21 PM	

Compound	Rpt. Limit (ppmv)	Rpt. Limit (ug/L)	Amount (ppmv)	Amount (ug/L)
TPH (Gasoline Range)	0.025	0.10	Not Detected	Not Detected

Container Type: NA - Not Applicable

Surrogates	%Recovery	Method Limits
Fluorobenzene (FID)	89	75-150



Air Toxics

Client Sample ID: LCS

Lab ID#: 1207155A-05A

MODIFIED EPA METHOD TO-3 GC/FID

File Name:	d071002	Date of Collection: NA
Dil. Factor:	1.00	Date of Analysis: 7/10/12 06:12 PM

Compound	%Recovery
TPH (Gasoline Range)	110

Container Type: NA - Not Applicable

Surrogates	%Recovery	Method Limits
Fluorobenzene (FID)	97	75-150



Air Toxics

Client Sample ID: LCSD

Lab ID#: 1207155A-05AA

MODIFIED EPA METHOD TO-3 GC/FID

File Name:	d071010	Date of Collection: NA
Dil. Factor:	1.00	Date of Analysis: 7/11/12 02:30 PM

Compound	%Recovery
TPH (Gasoline Range)	104

Container Type: NA - Not Applicable

Surrogates	%Recovery	Method Limits
Fluorobenzene (FID)	87	75-150

CHAIN OF CUSTODY RECORD

1207155

PAGE 1 OF 1

P&D ENVIRONMENTAL, INC. 55 Santa Clara Ave., Suite 240 Oakland, CA 94610 (510) 658-6916					NUMBER OF CONTAINERS	ANALYSIS(ES): TPH-G BY TO-3 MBTEX BY TO-3 TRACER GAS = DIFLUOROETHANE (CAS# 75-37-6)										PRESERVATIVE	REMARKS							
PROJECT NUMBER: 0304		PROJECT NAME: CALIFORNIA LIVEN RENTAL CO. 989 41ST ST. OAKLAND																						
SAMPLED BY: (PRINTED & SIGNATURE) Michael Deschenes																								
SAMPLE NUMBER	DATE	TIME	TYPE	INIT-SAMPLE LOCATION: <small>VAC SUMMA # FILL VAC (OPEN)</small>																				
VW5	7/5/12	14448	SIVCA	-30 37364-5 0	1	X	X														NINE NORMAL TURNAROUND			
VW6	7/6/12	100510	II	-30 36446-5 0	1	X	X														Y			
VW7	7/5/12	150356	II	-30 37740-4 0	1	X	X														U			
RELINQUISHED BY: (SIGNATURE) Michael Deschenes					DATE 7/6/12	TIME	RECEIVED BY: (SIGNATURE) FedEx					Total No. of Samples (This Shipment) 3	LABORATORY: AIR TOXICS LTD											
RELINQUISHED BY: (SIGNATURE)					DATE 7.12.12	TIME 1370	RECEIVED BY: (SIGNATURE) Tom Au					LABORATORY CONTACT: KYLE VAGADRI					LABORATORY PHONE NUMBER: (916) 985-1000							
RELINQUISHED BY: (SIGNATURE)					DATE	TIME	RECEIVED FOR LABORATORY BY: (SIGNATURE)					SAMPLE ANALYSIS REQUEST SHEET ATTACHED: () YES (X) NO												
Results and billing to: P&D Environmental, Inc. lab@pdenviro.com					Custody Seal Intact? Y N None Temp					REMARKS: TRACER GAS = DIFLUOROETHANE (CAS# 75-37-6)														

DIA
 B-A
 ONX

led

7/17/2012

Mr. Paul King
P & D Environmental
55 Santa Clara
Suite 240
Oakland CA 94610

Project Name: California Linen Rental Co. 989 41st St.

Project #: 0304

Workorder #: 1207155B

Dear Mr. Paul King

The following report includes the data for the above referenced project for sample(s) received on 7/10/2012 at Air Toxics Ltd.

The data and associated QC analyzed by Modified TO-15 are compliant with the project requirements or laboratory criteria with the exception of the deviations noted in the attached case narrative.

Thank you for choosing Air Toxics Ltd. for your air analysis needs. Air Toxics Ltd. is committed to providing accurate data of the highest quality. Please feel free to contact the Project Manager: Kyle Vagadori at 916-985-1000 if you have any questions regarding the data in this report.

Regards,



Kyle Vagadori
Project Manager

WORK ORDER #: 1207155B

Work Order Summary

CLIENT: Mr. Paul King
P & D Environmental
55 Santa Clara
Suite 240
Oakland, CA 94610

BILL TO: Mr. Paul King
P & D Environmental
55 Santa Clara
Suite 240
Oakland, CA 94610

PHONE: 510-658-6916

P.O. #

FAX: 510-834-0772

PROJECT # 0304 California Linen Rental Co. 989

DATE RECEIVED: 07/10/2012

CONTACT: 41st St.
Kyle Vagadori

DATE COMPLETED: 07/17/2012

<u>FRACTION #</u>	<u>NAME</u>	<u>TEST</u>	<u>RECEIPT VAC./PRES.</u>	<u>FINAL PRESSURE</u>
01A	VW5	Modified TO-15	6.0 "Hg	5 psi
02A	VW6	Modified TO-15	4.0 "Hg	5 psi
03A	VW7	Modified TO-15	2.0 "Hg	5 psi
04A	Lab Blank	Modified TO-15	NA	NA
05A	CCV	Modified TO-15	NA	NA
06A	LCS	Modified TO-15	NA	NA
06AA	LCSD	Modified TO-15	NA	NA

CERTIFIED BY:



Technical Director

DATE: 07/17/12

Certification numbers: AZ Licensure AZ0719, CA NELAP - 02110CA, LA NELAP - 02089,
NY NELAP - 11291, TX NELAP - T104704434-11-3, UT NELAP -CA009332011-1, WA NELAP - C935
Name of Accrediting Agency: NELAP/Florida Department of Health, Scope of Application: Clean Air Act,
Accreditation number: E87680, Effective date: 07/01/11 , Expiration date: 06/30/12.

Air Toxics Ltd. certifies that the test results contained in this report meet all requirements of the NELAC standards

This report shall not be reproduced, except in full, without the written approval of Eurofins | Air Toxics, Inc.

180 BLUE RAVINE ROAD, SUITE B FOLSOM, CA - 95630
(916) 985-1000 . (800) 985-5955 . FAX (916) 985-1020

LABORATORY NARRATIVE
EPA Method TO-15
P & D Environmental
Workorder# 1207155B

Three 1 Liter Summa Canister samples were received on July 10, 2012. The laboratory performed analysis via EPA Method TO-15 using GC/MS in the full scan mode.

This workorder was independently validated prior to submittal using 'USEPA National Functional Guidelines' as generally applied to the analysis of volatile organic compounds in air. A rules-based, logic driven, independent validation engine was employed to assess completeness, evaluate pass/fail of relevant project quality control requirements and verification of all quantified amounts.

Receiving Notes

There were no receiving discrepancies.

Analytical Notes

The reported CCV for each daily batch may be derived from more than one analytical file due to the client's request for non-standard compounds.

Non-standard compounds may have different acceptance criteria than the standard TO-14A/TO-15 compound list as per contract or verbal agreement.

A dilution was performed on sample VW5 due to the presence of high level target species.

Definition of Data Qualifying Flags

Eight qualifiers may have been used on the data analysis sheets and indicates as follows:

B - Compound present in laboratory blank greater than reporting limit (background subtraction not performed).

J - Estimated value.

E - Exceeds instrument calibration range.

S - Saturated peak.

Q - Exceeds quality control limits.

U - Compound analyzed for but not detected above the reporting limit.

UJ- Non-detected compound associated with low bias in the CCV and/or LCS.

N - The identification is based on presumptive evidence.

File extensions may have been used on the data analysis sheets and indicates as follows:

a-File was requantified

b-File was quantified by a second column and detector

r1-File was requantified for the purpose of reissue

Summary of Detected Compounds
EPA METHOD TO-15 GC/MS FULL SCAN

Client Sample ID: VW6

Lab ID#: 1207155B-02A

Compound	Rpt. Limit (ppbv)	Amount (ppbv)	Rpt. Limit (ug/m3)	Amount (ug/m3)
Toluene	1.0	32	3.9	120
Ethyl Benzene	1.0	2.4	4.5	10
m,p-Xylene	1.0	7.2	4.5	31
o-Xylene	1.0	7.5	4.5	32



Air Toxics

Client Sample ID: VW6

Lab ID#: 1207155B-02A

EPA METHOD TO-15 GC/MS FULL SCAN

File Name:	j071214	Date of Collection:	7/6/12 10:05:00 AM
Dil. Factor:	2.08	Date of Analysis:	7/12/12 10:37 PM

Compound	Rpt. Limit (ppbv)	Amount (ppbv)	Rpt. Limit (ug/m3)	Amount (ug/m3)
Methyl tert-butyl ether	1.0	Not Detected	3.7	Not Detected
Benzene	1.0	Not Detected	3.3	Not Detected
Toluene	1.0	32	3.9	120
Ethyl Benzene	1.0	2.4	4.5	10
m,p-Xylene	1.0	7.2	4.5	31
o-Xylene	1.0	7.5	4.5	32
1,1-Difluoroethane	4.2	Not Detected	11	Not Detected

Container Type: 1 Liter Summa Canister

Surrogates	%Recovery	Method Limits
Toluene-d8	96	70-130
1,2-Dichloroethane-d4	97	70-130
4-Bromofluorobenzene	100	70-130



Air Toxics

Client Sample ID: Lab Blank

Lab ID#: 1207155B-04A

EPA METHOD TO-15 GC/MS FULL SCAN

File Name:	j071209	Date of Collection:	NA
Dil. Factor:	1.00	Date of Analysis:	7/12/12 06:55 PM

Compound	Rpt. Limit (ppbv)	Amount (ppbv)	Rpt. Limit (ug/m3)	Amount (ug/m3)
Methyl tert-butyl ether	0.50	Not Detected	1.8	Not Detected
Benzene	0.50	Not Detected	1.6	Not Detected
Toluene	0.50	Not Detected	1.9	Not Detected
Ethyl Benzene	0.50	Not Detected	2.2	Not Detected
m,p-Xylene	0.50	Not Detected	2.2	Not Detected
o-Xylene	0.50	Not Detected	2.2	Not Detected
1,1-Difluoroethane	2.0	Not Detected	5.4	Not Detected

Container Type: NA - Not Applicable

Surrogates	%Recovery	Method Limits
Toluene-d8	95	70-130
1,2-Dichloroethane-d4	95	70-130
4-Bromofluorobenzene	99	70-130



Air Toxics

Client Sample ID: CCV

Lab ID#: 1207155B-05A

EPA METHOD TO-15 GC/MS FULL SCAN

File Name:	j071202	Date of Collection: NA
Dil. Factor:	1.00	Date of Analysis: 7/12/12 02:00 PM

Compound	%Recovery
Methyl tert-butyl ether	118
Benzene	109
Toluene	108
Ethyl Benzene	112
m,p-Xylene	115
o-Xylene	114
1,1-Difluoroethane	118

Container Type: NA - Not Applicable

Surrogates	%Recovery	Method Limits
Toluene-d8	99	70-130
1,2-Dichloroethane-d4	101	70-130
4-Bromofluorobenzene	105	70-130



Air Toxics

Client Sample ID: LCS

Lab ID#: 1207155B-06A

EPA METHOD TO-15 GC/MS FULL SCAN

File Name:	j071203	Date of Collection: NA
Dil. Factor:	1.00	Date of Analysis: 7/12/12 02:40 PM

Compound	%Recovery
Methyl tert-butyl ether	111
Benzene	106
Toluene	107
Ethyl Benzene	107
m,p-Xylene	112
o-Xylene	110
1,1-Difluoroethane	Not Spiked

Container Type: NA - Not Applicable

Surrogates	%Recovery	Method Limits
Toluene-d8	100	70-130
1,2-Dichloroethane-d4	98	70-130
4-Bromofluorobenzene	99	70-130



Air Toxics

Client Sample ID: LCSD

Lab ID#: 1207155B-06AA

EPA METHOD TO-15 GC/MS FULL SCAN

File Name:	j071204	Date of Collection: NA
Dil. Factor:	1.00	Date of Analysis: 7/12/12 02:59 PM

Compound	%Recovery
Methyl tert-butyl ether	114
Benzene	107
Toluene	107
Ethyl Benzene	109
m,p-Xylene	115
o-Xylene	114
1,1-Difluoroethane	Not Spiked

Container Type: NA - Not Applicable

Surrogates	%Recovery	Method Limits
Toluene-d8	101	70-130
1,2-Dichloroethane-d4	101	70-130
4-Bromofluorobenzene	106	70-130

CHAIN OF CUSTODY RECORD

1207155

PAGE 1 OF 1

P&D ENVIRONMENTAL, INC. 55 Santa Clara Ave., Suite 240 Oakland, CA 94610 (510) 658-6916					NUMBER OF CONTAINERS	ANALYSIS(ES): TPH-G BY TO-3 MBTEX BY TO-3 TRACER GAS = DIFLUOROETHANE (CAS# 75-37-6)										PRESERVATIVE	REMARKS				
PROJECT NUMBER: 0304		PROJECT NAME: CALIFORNIA LIVEN RENTAL CO. 989 41ST ST. OAKLAND																			
SAMPLED BY: (PRINTED & SIGNATURE) Michael Deschenes <i>Michael Deschenes</i>																					
SAMPLE NUMBER	DATE	TIME	TYPE	INIT-SAMPLE LOCATION: <small>VAC SUMMA # FILLER PID VAC (OPEN)</small>																	
VW5	7/5/12	14448	SIVCA	-30 37364-5 0	1	X	X														NINE NORMAL TURNAROUND
VW6	7/6/12	100510	II	-30 36446-5 0	1	X	X														II Y "
VW7	7/5/12	150356	II	-30 37740-4 0	1	X	X														II " "
RELINQUISHED BY: (SIGNATURE) <i>Michael Deschenes</i>					DATE 7/6/12	TIME	RECEIVED BY: (SIGNATURE) FedEx					Total No. of Samples (This Shipment) 3	LABORATORY: AIR TOXICS LTD								
RELINQUISHED BY: (SIGNATURE)					DATE 7.12.12	TIME 1370	RECEIVED BY: (SIGNATURE) <i>Tom Au</i>					LABORATORY CONTACT: LABORATORY PHONE NUMBER: KYLE VAGADRI (916) 985-1000									
RELINQUISHED BY: (SIGNATURE)					DATE	TIME	RECEIVED FOR LABORATORY BY: (SIGNATURE)					SAMPLE ANALYSIS REQUEST SHEET ATTACHED: () YES (X) NO									
Results and billing to: P&D Environmental, Inc. lab@pdenviro.com					Custody Seal Intact? Y N None Temp <i>ed</i>					REMARKS: TRACER GAS = DIFLUOROETHANE (CAS# 75-37-6)											

OIA
 B-A
 OIA