

STP 1629
LS



Chevron

June 15, 1998

Chevron Products Company
6001 Bollinger Canyon Road
Building L
San Ramon, CA 94583
P.O. Box 6004
San Ramon, CA 94583-0904

Marketing - Sales West
Phone 510 842-9500

Mr. Thomas Peacock
Alameda County Health Care Services
Department of Environmental Health
1131 Harbor Bay Parkway, Suite 250
Alameda, CA 94502-6577

Re: Chevron Service Station #9-6607
2340 Otis Drive, Alameda, California

98 JUN 17 PM 2:55
ENVIRONMENTAL
PROTECTION

Dear Mr. Peacock:

Enclosed is the Second Quarter Groundwater Monitoring Report for 1998 that was prepared by our consultant Blaine Tech Services Inc. for the above noted site. Ground water samples were collected and analyzed for TPH-g, BTEX and MtBE constituents. Monitoring wells MW-1 and M-2 are sampled quarterly and analyzed for all of the constituents, while wells MW-3 and MW-4 are sampled annually (first quarter), but measured for groundwater depth quarterly.

The concentration of the benzene constituent increased in monitoring well MW-1 from the previous sampling event, while concentrations of the TPH-g and BTEX constituents were below method detection limits in well MW-2.

Depth to groundwater varied from 3.61 feet to 4.73 feet below grade, with a direction of flow varying northeasterly and southwesterly from well MW-4 to wells MW-1 and MW-3 respectively.

For your information, this station is in full compliance with the EPA December 1998 requirements, i.e. double wall tanks with spill containment and double wall piping and under dispenser containment.

June 15, 1998
Mr. Thomas Peacock
Chevron Service Station #9-6607
Page 2

If you have any questions or comments, call me at (510) 842-9136.

Sincerely,
CHEVRON PRODUCTS COMPANY



Philip R. Briggs
Site Assessment and Remediation Project Manger

Enclosure

Cc. Mr. Wayne Weber
Chevron Station # 9-6607
2340 Otis Drive
Alameda, CA 94501

Harsh Investment Corp.
523 West Plaza
South Shore Center
Alameda, CA 94501

Mr. Bill Scudder, Chevron



1680 ROGERS AVENUE
SAN JOSE, CALIFORNIA 95112
(408) 573-7771 FAX
(408) 573-0555 PHONE

June 4, 1998

Phil Briggs
Chevron U.S.A. Products Company
P.O. Box 6004
San Ramon, CA 94583-0904

2nd Quarter 1998 Monitoring at 9-6607

Second Quarter 1998 Groundwater Monitoring at
Chevron Service Station Number 9-6607
2340 Otis Drive
Alameda, CA

Monitoring Performed on April 24, 1998

Groundwater Sampling Report 980424-K-4

This report covers the routine monitoring of groundwater wells at this Chevron facility. Blaine Tech Services, Inc.'s work at the site includes inspection, gauging, evacuation, purgewater containment, sample collection and sample handling in accordance with standard procedures that conform to Regional Water Quality Control Board requirements.

Routine field data collection includes depth to water, total well depth, thickness of any separate immiscible layer, water column volume, calculated volume of a three-case volume purge, elapsed evacuation time, total volume of water removed, and standard water parameter instrument readings. Sample material is collected, contained, stored, and transported to the laboratory in conformance with EPA standards. Purgewater is, likewise, collected and transported to McKittrick Waste Treatment Site for disposal.

Basic field information is presented alongside analytical values excerpted from the laboratory report in the cumulative table of **WELL DATA AND ANALYTICAL RESULTS**. The full analytical report for the most recent samples is located in the **Analytical Appendix**. The table also contains new groundwater elevation calculations taken from the computer plotted gradient map which is located in the **Professional Engineering Appendix**.

At a minimum, Blaine Tech Services, Inc. field personnel are certified upon completion of a forty-hour Hazardous Materials and Emergency Response training course per 29 CFR 1910.120. Field personnel are also enrolled in annual eight hour refresher courses.

Blaine Tech Services, Inc. conducts sampling and documentation assignments of this type as an independent third party. In order to avoid compromising the objectivity necessary for the proper and disinterested performance of this work, Blaine Tech Services, Inc. concentrates on objective data collection and does not participate in the interpretation of analytical results, the definition of geological or hydrological conditions, the formulation of recommendations, or the marketing of remedial systems.

Please call if you have any questions.

Yours truly,

A handwritten signature in black ink, appearing to read "Francis Thie", with a stylized flourish at the end.

Francis Thie
Vice President

FPT/aa

attachments: Professional Engineering Appendix
Cumulative Table of Well Data and Analytical Results
Analytical Appendix
Field Data Sheets

Professional Engineering Appendix

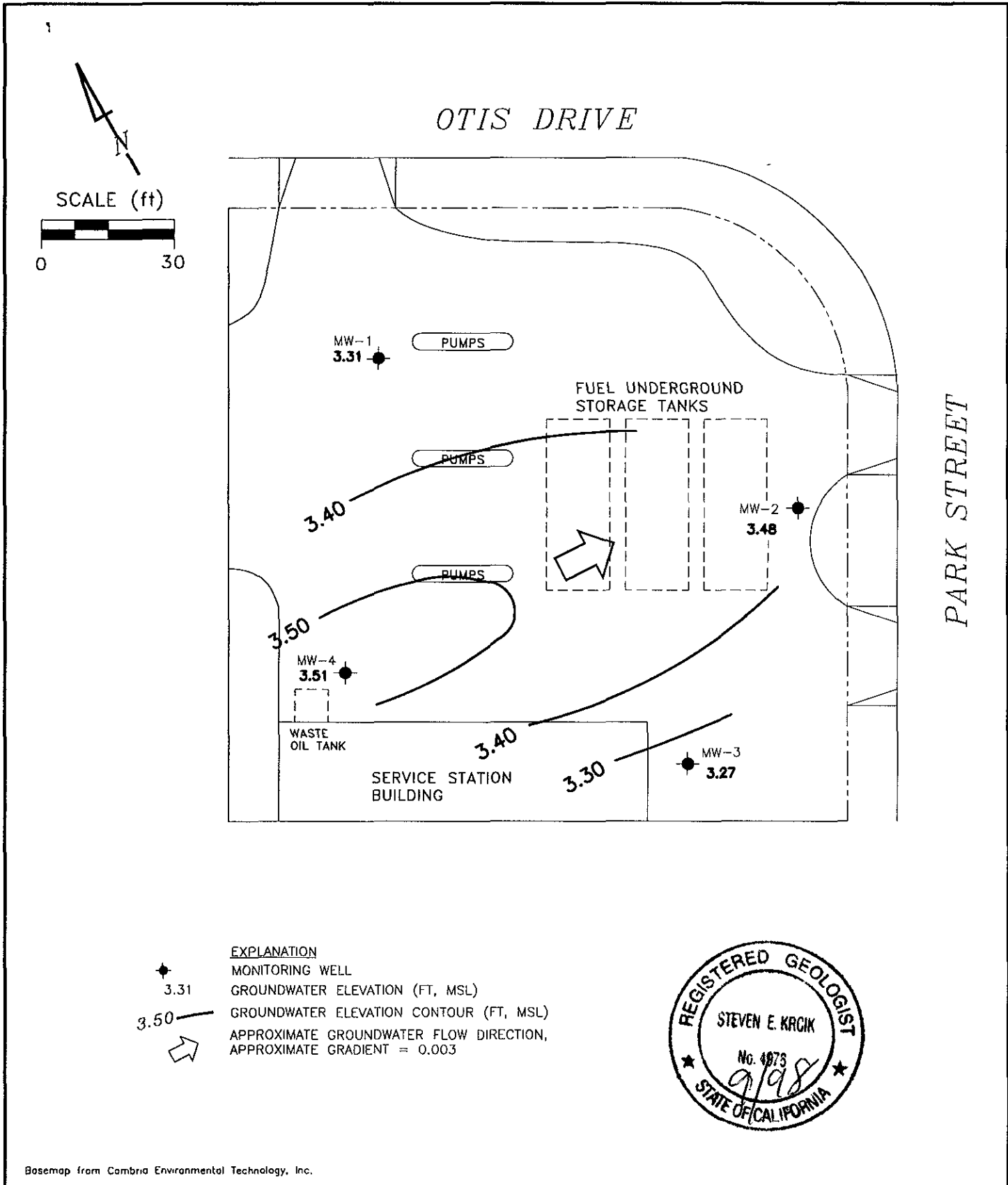

PREPARED BY

RRM
engineering contracting firm

Chevron Station 9-6607
2340 Otis Drive
Alameda, California

GROUNDWATER ELEVATION CONTOUR MAP,
APRIL 24, 1998

FIGURE:

1

PROJECT:

DAC04

Table of Well Data and Analytical Results

Cumulative Table of Well Data and Analytical Results

Vertical Measurements are in feet.

Analytical results are in parts per billion (ppb)

DATE	Well Head Elev.	Ground Water Elev.	Depth To Water	Notes	TPH-Gasoline	Benzene	Toluene	Ethyl-Benzene	Xylene	TOG	TPH-Diesel	MTBE	Other VOCs	PNAs	
MW-1															
08/21/91	7.12	1.02	6.10	--	<50	<0.5	<0.5	<0.5	<0.5	--	--	--	--	--	
01/09/92	7.12	3.16	3.96	--	<50	<0.5	<0.5	<0.5	<0.5	<5000	--	--	--	--	
04/20/92	7.12	3.22	3.90	--	<50	<0.5	<0.5	<0.5	<0.5	--	--	--	--	--	
07/25/92	7.12	2.94	4.18	--	<50	<0.5	<0.5	<0.5	<0.5	--	--	--	--	--	
11/24/92	7.12	2.40	4.72	--	<50	<0.5	<0.5	<0.5	<0.5	--	--	--	--	--	
01/21/93	7.12	3.94	3.18	--	<50	<0.5	0.7	<0.5	1.0	--	--	--	--	--	
04/13/93	7.12	3.42	3.70	--	<50	<0.5	<0.5	<0.5	1.0	--	--	--	--	--	
07/14/93	7.12	2.91	4.21	--	<50	<0.5	<0.5	<0.5	<0.5	--	--	--	--	--	
10/26/93	7.12	2.84	4.28	--	<50	<0.5	<0.5	<0.5	<0.5	--	--	--	--	--	
01/11/94	7.12	2.96	4.16	--	<50	<0.5	<0.5	<0.5	<0.5	--	--	--	--	--	
03/31/94	7.12	3.24	3.88	--	<50	<0.5	0.6	<0.5	0.7	--	--	--	--	--	
07/14/94	7.12	4.12	3.00	--	<50	<0.5	<0.5	<0.5	<0.5	--	--	--	--	--	
10/12/94	7.12	2.87	4.25	--	80	<0.5	<0.5	<0.5	<0.5	--	--	121	<5.0-<50	--	
01/11/95	7.12	4.00	3.12	--	<50	<0.5	<0.5	<0.5	<0.5	--	--	130	--	--	
04/05/95	7.12	3.66	3.46	--	<50	<0.5	<0.5	<0.5	<0.5	--	--	170	--	<5.0	
07/13/95	7.12	3.13	3.99	--	<125	<1.2	<1.2	<1.2	<1.2	--	--	400	--	--	
10/05/95	7.12	2.74	4.38	--	<50	<0.5	2.3	0.66	4.0	--	--	300	--	--	
10/03/96	7.12	2.68	4.44	--	<50	0.63	<0.5	<0.5	<0.5	--	--	560	--	--	
01/22/97	7.12	3.73	3.39	--	<200	<2.0	<2.0	<2.0	<2.0	--	--	530	--	--	
01/22/97	7.12	3.73	3.39	Confirmation run	--	--	--	--	--	--	--	880	--	--	
04/09/97	6.92*	3.22	3.70	--	<125	<1.2	<1.2	<1.2	<1.2	--	--	610	--	--	
07/09/97	6.92	3.05	3.87	--	240	47	<2.0	<2.0	<2.0	--	--	990	--	--	
10/16/97	6.92	2.95	3.97	--	250	<2.0	<2.0	<2.0	<2.0	--	--	1000	--	--	
01/08/98	6.92	3.47	3.45	--	<200	<2.0	<2.0	<2.0	<2.0	--	--	**	--	--	
04/24/98	6.92	3.31	3.61	--	170	20	<0.5	<0.5	<0.5	--	--	1700	--	--	

* Wellhead elevation altered due to maintenance.

** No value for MTBE could be determined; see lab report.

Cumulative Table of Well Data and Analytical Results

Vertical Measurements are in feet.

Analytical results are in parts per billion (ppb)

DATE	Well Head Elev.	Ground Water Elev.	Depth To Water	Notes	TPH-Gasoline	Benzene	Toluene	Ethyl-Benzene	Xylene	TOG	TPH-Diesel	MTBE	Other VOCs	PNAAs
MW-2														
08/21/91	7.43	1.03	6.40	--	430	170	0.9	1.0	3.6	--	--	--	--	--
01/09/92	7.43	3.20	4.23	--	58	16	<0.5	<0.5	<0.5	<5000	--	--	--	--
04/20/92	7.43	3.26	4.17	--	180	9.6	<0.5	0.8	<0.5	--	--	--	--	--
07/25/92	7.43	2.96	4.47	--	220	8.0	0.7	4.0	8.6	--	--	--	--	--
11/24/92	7.43	1.61	5.82	--	72	3.2	<0.5	0.5	0.6	--	--	--	--	--
01/21/93	7.43	4.08	3.35	--	<50	0.8	<0.5	<0.5	<0.5	--	--	--	--	--
04/13/93	7.43	3.41	4.02	--	78	<0.5	<0.5	<0.5	0.6	--	--	--	--	--
07/14/93	7.43	2.94	4.49	--	<50	<0.5	<0.5	<0.5	<0.5	--	--	--	--	--
10/26/93	7.43	2.87	4.56	--	<50	<0.5	0.9	<0.5	0.6	--	--	--	--	--
01/11/94	7.43	3.04	4.39	--	<50	<0.5	1.0	<0.5	<0.5	--	--	--	--	--
03/31/94	7.43	3.25	4.18	--	<50	0.5	<0.5	<0.5	0.8	--	--	--	--	--
07/14/94	7.43	2.53	4.90	--	<50	<0.5	<0.5	<0.5	0.6	--	--	--	--	--
10/12/94	7.43	2.89	4.54	--	<50	<0.5	<0.5	<0.5	<0.5	--	--	2900	<50-<500	--
01/11/95	7.43	4.17	3.26	--	<50	<0.5	<0.5	<0.5	<0.5	--	--	2500	--	--
04/05/95	7.43	3.78	3.65	--	<50	<0.5	<0.5	<0.5	<0.5	--	--	<2.0	--	<5.0
07/13/95	7.43	3.12	4.31	--	<250	<2.5	<2.5	<2.5	<2.5	--	--	1100	--	--
10/05/95	7.43	2.75	4.68	--	<50	<0.5	1.9	0.54	3.4	--	--	280	--	--
10/03/96	7.43	2.63	4.80	--	<500	<5.0	<5.0	<5.0	<5.0	--	--	1000	--	--
01/22/97	7.43	4.07	3.36	--	540*	<5.0	<5.0	<5.0	<5.0	--	--	1300	--	--
01/22/97	7.43	4.07	3.36	Confirmation run	--	--	--	--	--	--	--	1600	--	--
04/09/97	7.43	3.18	4.25	--	<500	<5.0	<5.0	<5.0	<5.0	--	--	970	--	--
07/09/97	7.43	2.95	4.48	--	<125	<1.2	<1.2	<1.2	<1.2	--	--	710	--	--
10/16/97	7.43	2.99	4.44	--	<100	<1.0	<1.0	<1.0	<1.0	--	--	1000	--	--
01/08/98	7.43	3.64	3.79	--	68	<0.5	<0.5	<0.5	<0.5	--	--	**	--	--
04/24/98	7.43	3.48	3.95	--	<50	<0.5	<0.5	<0.5	<0.5	--	--	490	--	--

* Chromatogram pattern indicates an unidentified hydrocarbon.

** No value for MTBE could be determined; see lab report.

Cumulative Table of Well Data and Analytical Results

Vertical Measurements are in feet

Analytical results are in parts per billion (ppb)

DATE	Well Head Elev.	Ground Water Elev.	Depth To Water	Notes	TPH-Gasoline	Benzene	Toluene	Ethyl-Benzene	Xylene	TOG	TPH-Diesel	MTBE	Other VOCs	PNAAs
MW-3														
08/21/91	8.07	0.97	7.10	--	<50	<0.5	<0.5	<0.5	<0.5	--	--	--	--	--
01/09/92	8.07	3.04	5.03	--	<50	<0.5	<0.5	<0.5	<0.5	<5000	--	--	--	--
04/20/92	8.07	3.16	4.91	--	<50	<0.5	<0.5	<0.5	<0.5	--	--	--	--	--
07/25/92	8.07	2.73	5.34	--	<50	1.0	1.0	1.0	3.4	--	--	--	--	--
11/24/92	8.07	3.07	5.00	--	<50	<0.5	<0.5	<0.5	<0.5	--	--	--	--	--
01/21/93	8.07	3.73	4.34	--	<50	<0.5	0.5	<0.5	1.0	--	--	--	--	--
04/13/93	8.07	3.23	4.84	--	<50	<0.5	<0.5	<0.5	0.6	--	--	--	--	--
07/14/93	8.07	2.78	5.29	--	<50	<0.5	<0.5	<0.5	2.0	--	--	--	--	--
10/26/93	8.07	2.71	5.36	--	<50	<0.5	<0.5	<0.5	<0.5	--	--	--	--	--
01/11/94	8.07	2.85	5.22	--	<50	<0.5	1.0	<0.5	<0.5	--	--	--	--	--
03/31/94	8.07	3.08	4.99	--	<50	<0.5	<0.5	<0.5	<0.5	--	--	--	--	--
07/14/94	8.07	2.71	5.36	--	<50	<0.5	<0.5	<0.5	<0.5	--	--	--	--	--
10/12/94	8.07	3.05	5.02	--	<50	<0.5	<0.5	<0.5	<0.5	--	--	--	--	--
01/11/95	8.07	3.72	4.35	--	<50	<0.5	<0.5	<0.5	0.7	--	--	<5.0	--	--
04/05/95	8.07	5.43	2.64	--	<50	<0.5	<0.5	<0.5	<0.5	--	--	<5.0	--	<5.0
07/13/95	8.07	2.94	5.13	--	<50	<0.5	<0.5	<0.5	<0.5	--	--	--	--	--
10/05/95	8.07	2.61	5.46	--	<50	<0.5	1.2	<0.5	<0.5	--	--	--	--	--
10/03/96	8.07	2.54	5.53	--	<50	0.98	1.2	0.53	2.5	--	--	<2.5	--	--
01/22/97	8.07	3.45	4.62	--	<50	<0.5	<0.5	<0.5	<0.5	--	--	<2.5	--	--
04/09/97	8.00*	2.95	5.05	Sampled annually	--	--	--	--	--	--	--	--	--	--
07/09/97	8.00	2.86	5.14	--	--	--	--	--	--	--	--	--	--	--
10/16/97	8.00	2.80	5.20	--	<50	<0.5	<0.5	<0.5	<0.5	--	--	<2.5	--	--
01/08/98	8.00	3.25	4.75	--	<50	<0.5	<0.5	<0.5	<0.5	--	--	9.3	--	--
04/24/98	8.00	3.27	4.73	--	--	--	--	--	--	--	--	--	--	--

* Wellhead elevation altered due to maintenance.

Cumulative Table of Well Data and Analytical Results

Vertical Measurements are in feet.

Analytical results are in parts per billion (ppb)

DATE	Well Head Elev.	Ground Water Elev.	Depth To Water	Notes	TPH-Gasoline	Benzene	Toluene	Ethyl-Benzene	Xylene	TOG	TPH-Diesel	MTBE	Other VOCs	PNAs
MW-4														
08/21/91	7.85	1.00	6.85	--	<50	0.6	<0.5	<0.5	<0.5	<5000	--	--	--	--
01/09/92	7.85	3.15	4.70	--	<50	<0.5	<0.5	<0.5	<0.5	<5000	--	--	--	--
04/20/92	7.85	3.21	4.64	--	<50	<0.5	<0.5	<0.5	<0.5	<5000	--	--	--	--
07/25/92	7.85	2.90	4.95	--	<50	0.5	1.1	<0.5	0.8	--	78	--	--	--
11/24/92	7.85	2.43	5.42	--	<50	<0.5	<0.5	<0.5	1.0	<5000	--	--	--	--
01/21/93	7.85	3.78	4.07	--	<50	<0.5	0.5	<0.5	0.7	--	<10	--	--	--
04/13/93	7.85	3.40	4.45	--	<50	<0.5	<0.5	<0.5	1.0	--	<10	--	--	--
07/14/93	7.85	2.95	4.90	--	<50	<0.5	<0.5	<0.5	<0.5	--	--	--	--	--
10/26/93	7.85	2.90	4.95	--	<50	2.0	3.0	2.0	3.0	--	--	--	--	--
01/11/94	7.85	3.08	4.77	--	<50	<0.5	0.5	<0.5	<0.5	--	--	--	--	--
03/31/94	7.85	3.20	4.65	--	<50	<0.5	<0.5	<0.5	1.0	--	--	--	--	--
07/14/94	7.85	2.80	5.05	--	<50	0.9	1.2	<0.5	2.0	--	--	--	--	--
10/12/94	7.85	2.97	4.88	--	<50	<0.5	0.9	<0.5	0.7	--	--	--	--	--
01/11/95	7.85	3.85	4.00	--	<50	<0.5	0.8	0.7	1.5	--	--	<5.0	--	--
04/05/95	7.85	3.63	4.22	--	<50	<0.5	<0.5	<0.5	<0.5	<5000	--	<2.0	<5.0	--
07/13/95	7.85	3.14	4.71	--	<50	<0.5	<0.5	<0.5	<0.5	--	--	--	--	--
10/05/95	7.85	2.83	5.02	--	<50	<0.5	<0.5	<0.5	<0.5	--	--	--	--	--
10/03/96	7.85	2.77	5.08	--	100	5.5	5.6	2.5	12	--	--	<2.5	--	--
01/22/97	7.85	3.57	4.28	--	<50	<0.5	<0.5	<0.5	<0.5	--	--	<2.5	--	--
04/09/97	7.85	3.25	4.60	Sampled annually	--	--	--	--	--	--	--	--	--	--
07/09/97	7.85	3.06	4.79	--	--	--	--	--	--	--	--	--	--	--
10/16/97	7.85	3.04	4.81	--	<50	<0.5	<0.5	<0.5	<0.5	--	--	2.7	--	--
01/08/98	7.85	3.48	4.37	--	<50	<0.5	<0.5	<0.5	<0.5	--	--	<2.5	--	--
04/24/98	7.85	3.51	4.34	--	--	--	--	--	--	--	--	--	--	--

Cumulative Table of Well Data and Analytical Results

Vertical Measurements are in feet.

Analytical results are in parts per billion (ppb)

DATE	Well Head Elev.	Ground Water Elev.	Depth To Water	Notes	TPH-Gasoline	Benzene	Toluene	Ethyl-Benzene	Xylene	TOG	TPH-Diesel	MTBE	Other VOCs	PNAs
TRIP BLANK														
01/21/93	--	--	--	--	<50	<0.5	<0.5	<0.5	<0.5	--	--	--	--	--
04/13/93	--	--	--	--	<50	<0.5	<0.5	<0.5	<0.5	--	--	--	--	--
07/14/93	--	--	--	--	<50	<0.5	<0.5	<0.5	<0.5	--	--	--	--	--
10/26/93	--	--	--	--	<50	<0.5	<0.5	<0.5	<0.5	--	--	--	--	--
01/11/94	--	--	--	--	<50	<0.5	<0.5	<0.5	<0.5	--	--	--	--	--
03/31/94	--	--	--	--	<50	<0.5	<0.5	<0.5	<0.5	--	--	--	--	--
07/14/94	--	--	--	--	<50	<0.5	<0.5	<0.5	<0.5	--	--	--	--	--
10/12/94	--	--	--	--	<50	<0.5	<0.5	<0.5	<0.5	--	--	--	--	--
01/11/95	--	--	--	--	<50	<0.5	<0.5	<0.5	<0.5	--	--	--	--	--
04/05/95	--	--	--	--	<50	<0.5	<0.5	<0.5	<0.5	--	--	--	--	--
07/13/95	--	--	--	--	<50	<0.5	<0.5	<0.5	<0.5	--	--	--	--	--
10/05/95	--	--	--	--	<50	<0.5	<0.5	<0.5	<0.5	--	--	--	--	--
10/03/96	--	--	--	--	<50	<0.5	<0.5	<0.5	<0.5	--	--	--	--	--
01/22/97	--	--	--	--	<50	<0.5	<0.5	<0.5	<0.5	--	--	<2.5	--	--
04/09/97	--	--	--	--	<50	<0.5	<0.5	<0.5	<0.5	--	--	<2.5	--	--
07/09/97	--	--	--	--	<50	<0.5	<0.5	<0.5	<0.5	--	--	<2.5	--	--
10/16/97	--	--	--	--	<50	<0.5	<0.5	<0.5	<0.5	--	--	<2.5	--	--
01/08/98	--	--	--	--	<50	<0.5	<0.5	<0.5	<0.5	--	--	<2.5	--	--
04/24/98	--	--	--	--	<50	<0.5	<0.5	<0.5	<0.5	--	--	<2.5	--	--

Note: Blaine Tech Services, Inc. began routine monitoring of the groundwater wells at this site on April 5, 1995.
Earlier field data and analytical results provided by Sierra Environmental.

ABBREVIATIONS:

- TPH = Total Petroleum Hydrocarbons
- TOG = Total Oil and Grease
- MTBE = Methyltertiary butylether
- VOC = Volatile Organic Compound

Analytical Appendix



Sequoia Analytical

680 Chesapeake Drive
404 N. Wiget Lane
819 Striker Avenue, Suite 8
1455 McDowell Blvd. North, Ste. D

Redwood City, CA 94063
Walnut Creek, CA 94598
Sacramento, CA 95834
Petaluma, CA 94954

(650) 364-9600
(510) 988-9600
(916) 921-9600
(707) 792-1865

FAX (650) 364-9233
FAX (510) 988-9673
FAX (916) 921-0100
FAX (707) 792-0342

Blaine Tech Services 1680 Rogers Avenue San Jose, CA 95112	Client Proj. ID: Chevron 9-6607/980424-K4 Sample Descript: MW-1 Matrix: LIQUID Analysis Method: 8015Mod/8020 Lab Number: 9804G96-01	Sampled: 04/24/98 Received: 04/27/98 Analyzed: 05/01/98 Reported: 05/05/98
--	---	---

QC Batch Number: GC0501988020HP2
Instrument ID: HP2

Analyte	Detection Limit ug/L	Sample Results ug/L
TPPH as Gas	50	170
Methyl t-Butyl Ether	2.5	1700
Benzene	0.50	20
Toluene	0.50	N.D.
Ethyl Benzene	0.50	N.D.
Xylenes (Total)	0.50	N.D.
Chromatogram Pattern: Discrete Peaks		C6

Surrogates	Control Limits %	% Recovery
Trifluorotoluene	70 130	104

Analytes reported as N.D. were not present above the stated limit of detection.

SEQUOIA ANALYTICAL - ELAP #2000

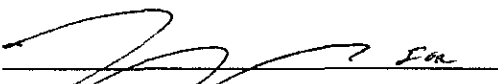

Peggy Penner
Project Manager





Sequoia Analytical

680 Chesapeake Drive
404 N. Wiget Lane
819 Striker Avenue, Suite 8
1455 McDowell Blvd. North, Ste. D

Redwood City, CA 94063
Walnut Creek, CA 94598
Sacramento, CA 95834
Petaluma, CA 94954

(650) 364-9600
(510) 988-9600
(916) 921-9600
(707) 792-1865

FAX (650) 364-9233
FAX (510) 988-9673
FAX (916) 921-0100
FAX (707) 792-0342

Blaine Tech Services 1680 Rogers Avenue San Jose, CA 95112	Client Proj. ID: Chevron 9-6607/980424-K4 Sample Descript: MW-2 Matrix: LIQUID Analysis Method: 8015Mod/8020 Lab Number: 9804G96-02	Sampled: 04/24/98 Received: 04/27/98 Analyzed: 05/01/98 Reported: 05/05/98
--	---	---

QC Batch Number: GC0501988020HP2
Instrument ID: HP2

Analyte	Detection Limit ug/L	Sample Results ug/L
TPPH as Gas	50	N.D.
Methyl t-Butyl Ether	2.5	490
Benzene	0.50	N.D.
Toluene	0.50	N.D.
Ethyl Benzene	0.50	N.D.
Xylenes (Total)	0.50	N.D.
Chromatogram Pattern:		
Surrogates	Control Limits %	% Recovery
Trifluorotoluene	70 130	72

Analytes reported as N.D. were not present above the stated limit of detection.

SEQUOIA ANALYTICAL - ELAP #2000



Peggy Penner
Project Manager





Sequoia Analytical

680 Chesapeake Drive
404 N. Wiget Lane
819 Striker Avenue, Suite 8
1455 McDowell Blvd. North, Ste. D

Redwood City, CA 94063
Walnut Creek, CA 94598
Sacramento, CA 95834
Petaluma, CA 94954

(650) 364-9600
(510) 988-9600
(916) 921-9600
(707) 792-1865

FAX (650) 364-9233
FAX (510) 988-9673
FAX (916) 921-0100
FAX (707) 792-0342

Blaine Tech Services	Client Proj. ID: Chevron 9-6607/980424-K4	Sampled: 04/24/98
1680 Rogers Avenue	Sample Descript: TB	Received: 04/27/98
San Jose, CA 95112	Matrix: LIQUID	
	Analysis Method: 8015Mod/8020	Analyzed: 05/01/98
Attention: Fran Thie	Lab Number: 9804G96-03	Reported: 05/05/98

QC Batch Number: GC0501988020HP2
Instrument ID: HP2

Analyte	Detection Limit ug/L	Sample Results ug/L
TPPH as Gas	50	N.D.
Methyl t-Butyl Ether	2.5	N.D.
Benzene	0.50	N.D.
Toluene	0.50	N.D.
Ethyl Benzene	0.50	N.D.
Xylenes (Total)	0.50	N.D.
Chromatogram Pattern:		
Surrogates	Control Limits %	% Recovery
Trifluorotoluene	70 130	79

Analytes reported as N.D. were not present above the stated limit of detection.

SEQUOIA ANALYTICAL - ELAP #2000



Peggy Penner
Project Manager





Sequoia Analytical

680 Chesapeake Drive
404 N. Wiget Lane
819 Striker Avenue, Suite 8
1455 McDowell Blvd. North, Ste D

Redwood City, CA 94063
Walnut Creek, CA 94598
Sacramento, CA 95834
Petaluma, CA 94954

(650) 364-9600
(510) 988-9600
(916) 921-9600
(707) 792-1865

FAX (650) 364-9233
FAX (510) 988-9673
FAX (916) 921-0100
FAX (707) 792-0342

Blaine Tech Services, Inc.
1680 Rogers Ave.
San Jose, CA 95112
Attention: Fran Thie

Client Project ID: **Chevron 9-6607 / 980424-K4**
Matrix: **Liquid**

QC Sample Group: **9804G96 -01-03**

Reported: **May 12, 1998**

QUALITY CONTROL DATA REPORT

ANALYTE	Benzene	Toluene	Ethyl Benzene	Xylenes
Method:	EPA 8020	EPA 8020	EPA 8020	EPA 8020
Analyst:	M.W.	M.W.	M.W.	M.W.

MS/MSD Batch#:	LCS050198	LCS050198	LCS050198	LCS050198
Date Prepared:	5/1/98	5/1/98	5/1/98	5/1/98
Date Analyzed:	5/1/98	5/1/98	5/1/98	5/1/98
Instrument I.D.#:	-	-	-	-
Conc. Spiked:	20 µg/L	20 µg/L	20 µg/L	60 µg/L
Matrix Spike % Recovery:	102	101	93	100
Matrix Spike Duplicate % Recovery:	104	100	93	104
Relative % Difference:	1.9	1.0	0.0	3.9

LCS Batch#:	LCS050198	LCS050198	LCS050198	LCS050198
Date Prepared:	5/1/98	5/1/98	5/1/98	5/1/98
Date Analyzed:	5/1/98	5/1/98	5/1/98	5/1/98
Instrument I.D.#:	-	-	-	-
LCS % Recovery:	102	101	93	100

% Recovery Control Limits:	60-140	60-140	60-140	60-140
----------------------------	--------	--------	--------	--------

SEQUOIA ANALYTICAL
Elaap #1849

Peggy Penner
Project Manager

Please Note:

The LCS is a control sample of known, interferent free matrix that is analyzed using the same reagents, preparation, and analytical methods employed for the samples. The matrix spike is an aliquot of sample fortified with known quantities of specific compounds and subjected to the entire analytical procedure. If the recovery of analytes from the matrix spike does not fall within specified control limits due to matrix interference, the LCS recovery is to be used to validate the batch.





**Sequoia
Analytical**

680 Chesapeake Drive
404 N. Wiget Lane
819 Striker Avenue, Suite 8
1455 McDowell Blvd. North, Ste. D

Redwood City, CA 94063
Walnut Creek, CA 94598
Sacramento, CA 95834
Petaluma, CA 94954

(650) 364-9600
(510) 988-9600
(916) 921-9600
(707) 792-1865

FAX (650) 364-9233
FAX (510) 988-9673
FAX (916) 921-0100
FAX (707) 792-0342

Blaine Tech Services
1680 Rogers Avenue
San Jose, CA 95112
Attention: Fran Thie

Client Proj. ID: Chevron 9-6607/980424-K4

Received: 04/27/98

Lab Proj. ID: 9804G96

Reported: 05/05/98

LABORATORY NARRATIVE

In order to properly interpret this report, it must be reproduced in its entirety. This report contains a total of 5 pages including the laboratory narrative, sample results, quality control, and related documents as required (cover page, COC, raw data, etc.).

SEQUOIA ANALYTICAL

Peggy Penner
Project Manager



Field Data Sheets

