

**GRIBI Associates** *Geological and Environmental Consulting Services*

May 5, 2006

GA Project No. 147-01-03

Alameda County Department of  
Environmental Health  
1131 Harbor Bay Parkway, 2<sup>nd</sup> Floor  
Alameda, CA 94502

Attention: Mr. Barney Chan

Subject: First Quarter 2006 Groundwater Monitoring Report  
Dublin Toyota UST Site  
6450 Dublin Court  
Dublin, California  
Alameda County LOP Site ID No. 699

Ladies and Gentlemen:

Gribi Associates is pleased to submit this First Quarter 2006 Groundwater Monitoring Report on behalf of Dublin Toyota for the underground storage tank (UST) site located at 6450 Dublin Court in Dublin, California (Figure 1 and Figure 2). This report summarizes groundwater monitoring activities conducted at the site on March 30, 2006.

**DESCRIPTION OF SAMPLING ACTIVITIES**

1. Gribi Associates personnel conducted groundwater monitoring activities for all three site wells (MW-1, MW-2 and MW-3) on March 30, 2006.
2. Groundwater monitoring was conducted in accordance with California LUFT Field Manual, including the following:
  - a. measuring static water levels;
  - b. checking for presence of free-product;
  - c. and purging of approximately three well volumes while recording of temperature, pH, conductivity, and clarity.
3. Collected groundwater samples were placed in an ice-chilled cooler and submitted to a state-certified laboratory for analyses.
4. Copies of groundwater sampling field data sheets are provided as Attachment A.

**RESULTS OF GROUNDWATER MONITORING****Hydrologic Conditions**

1. Groundwater depths ranged from approximately 4.35 feet (MW-3) to 5.81 feet (MW-1).
2. Groundwater elevations ranged from 323.08 feet (MW-1) to 323.09 feet (MW-3).
3. Groundwater flow direction is to the west northwest, though contours are relatively flat.

- a. Historically, groundwater flow direction has trended in a southwesterly direction and appears to be generally related to surface topography.
4. Free-product was not present in any of the three wells.

### **Laboratory Analytical Results**

1. Groundwater samples from the three wells were analyzed for the following parameters with standard method turn around time on results:
  - a. USEPA 8015M Total Petroleum Hydrocarbons as Gasoline (TPH-G)
  - b. USEPA 8260B Benzene, Toluene, Ethylbenzene, Xylenes (BTEX)
  - c. USEPA 8260B Methyl-t-butyl Ether (MTBE)
  - d. USEPA 8260B Oxygenates (TBA, MTBE, DIPE, ETBE, and TAME)
2. Groundwater analytical results are summarized in Table 1.
3. Groundwater MTBE results for this monitoring event are summarized on Figure 3.
4. The laboratory analytical data report and chain-of custody are contained in Attachment B.

### **CONCLUSIONS**

1. MTBE concentrations in groundwater were generally similar to results from previous quarters.
  - a. The MTBE groundwater concentration at MW-1 was 6,900 ppb.
  - b. The MTBE groundwater concentration at MW-2 groundwater increased to 13 ppb.
  - c. The MTBE groundwater concentrations at MW-3 decreased to 160 ppb.

### **PLANNED ACTIVITIES**

1. Gribi Associates performed an Aggressive Fluid/Vapor Recovery (AFVR) at newly installed dual phase extraction wells near the source area during First Quarter 2006 per the "*Interim Remedial Measures (IRM) Workplan*" (Gribi Associates, March 2005).
2. Gribi Associates has installed ten additional groundwater monitoring wells in accordance with the approval of Alameda County Department of Environmental Health. The well locations and construction details were included in an SWI report dated June 20, 2005.
3. Gribi Associates plans to perform Second Quarter 2006 groundwater monitoring and sampling.

Mr. Barney Chan  
Alameda County Department of Environmental Health  
May 5, 2006  
Page 3

We appreciate this opportunity to provide this report for your review. Please contact us if there are questions or if additional information is required.

Very truly yours,



Matthew A. Rosman  
Project Engineer



James E. Gribi  
Registered Geologist  
California No. 5843



Enclosure  
cc:Mr. Scott Anderson, Dublin Toyota

## **FIGURES**

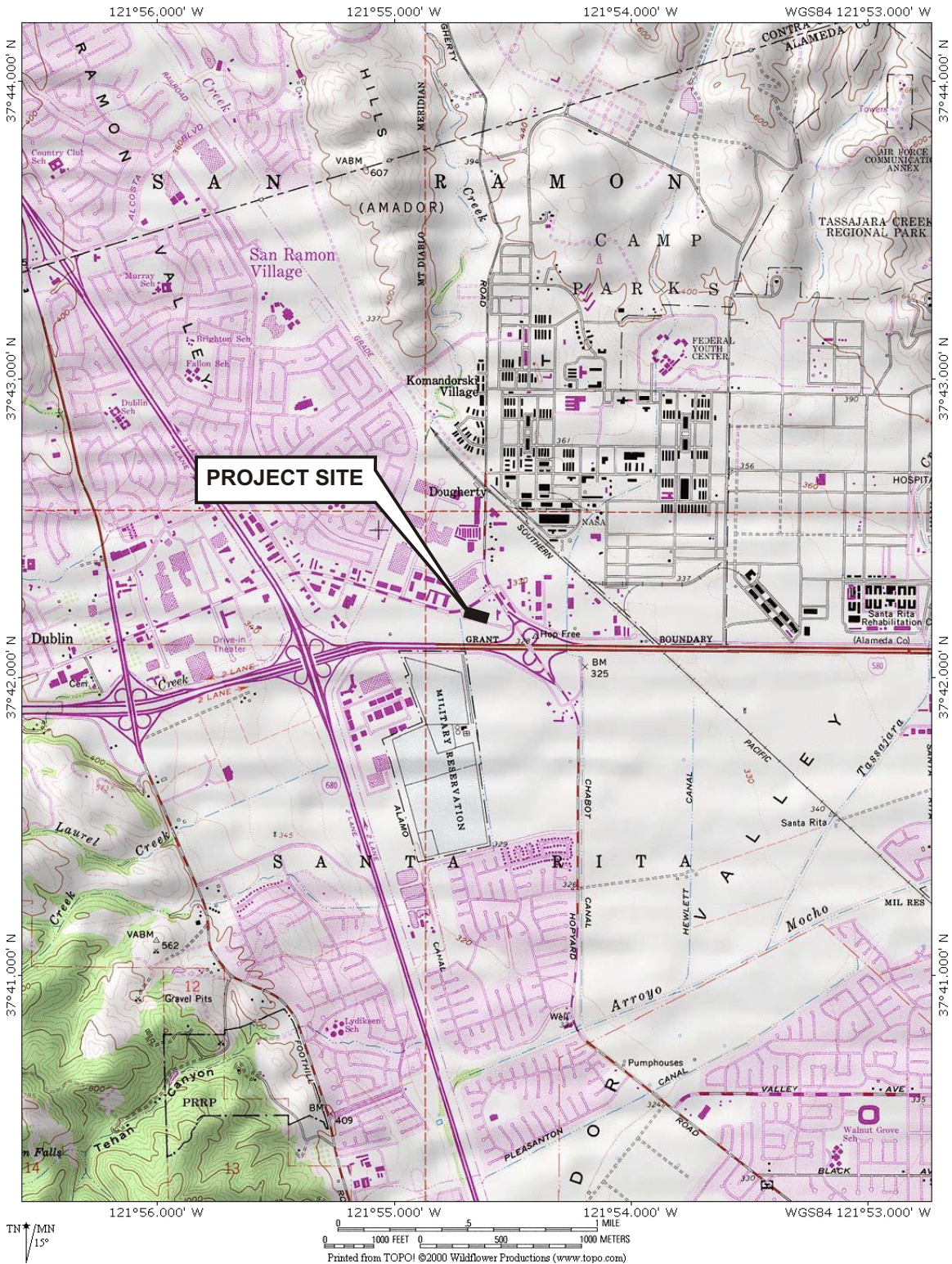

DESIGNED BY:	CHECKED BY:	<b>SITE VICINITY MAP</b>	DATE: 05/07/03	FIGURE: 1
DRAWN BY: EGH	SCALE:		<b>GRIBI Associates</b>	
PROJECT NO: 147-01				



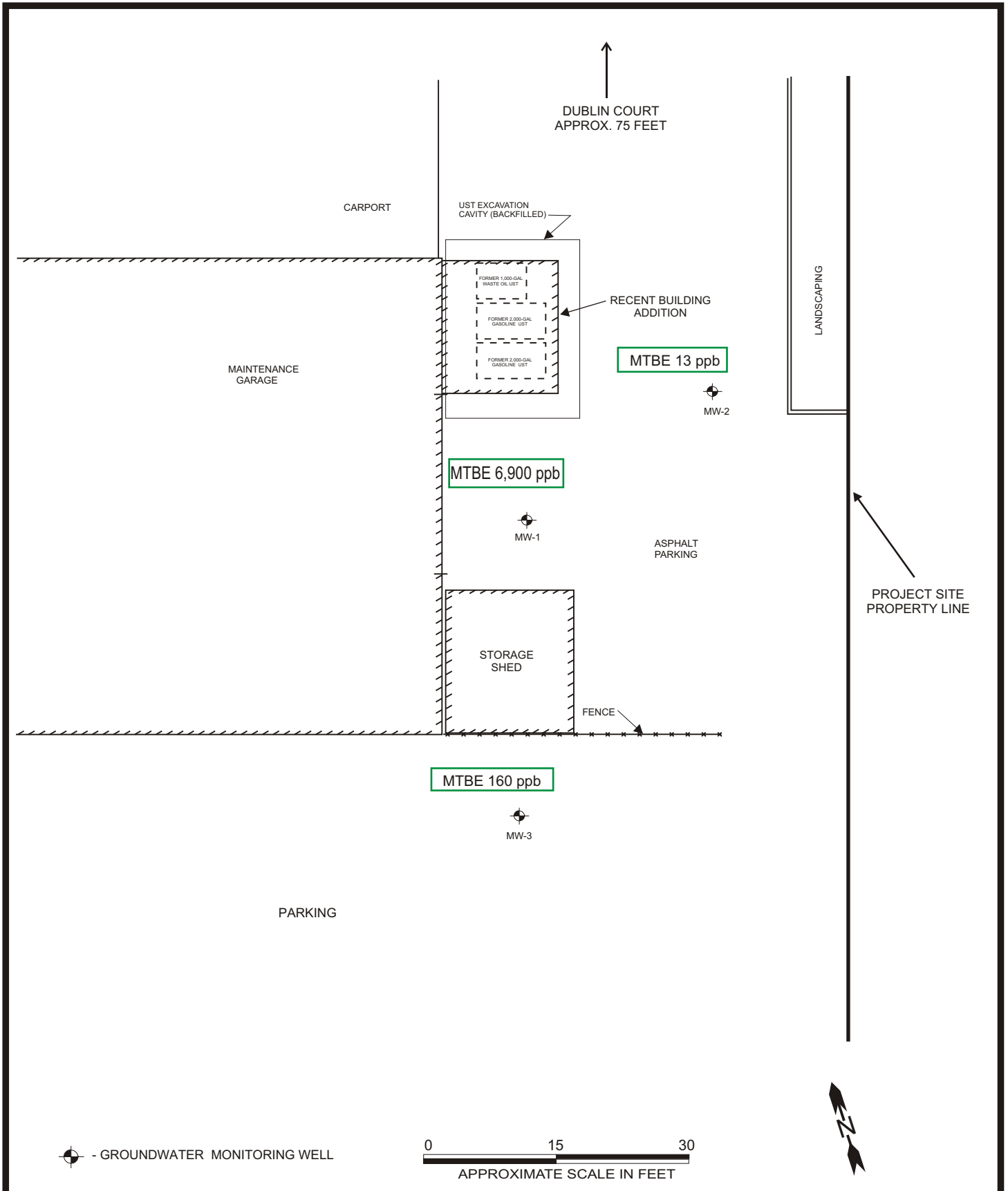

DESIGNED BY:	CHECKED BY:	<b>SITE PLAN</b>	DATE: 4/18/06	FIGURE: 2
DRAWN BY: MR	SCALE:		<b>GRIBI Associates</b>	
PROJECT NO: 147-01-03		DUBLIN TOYOTAUST SITE 6450 DUBLIN COURT DUBLIN, CALIFORNIA		

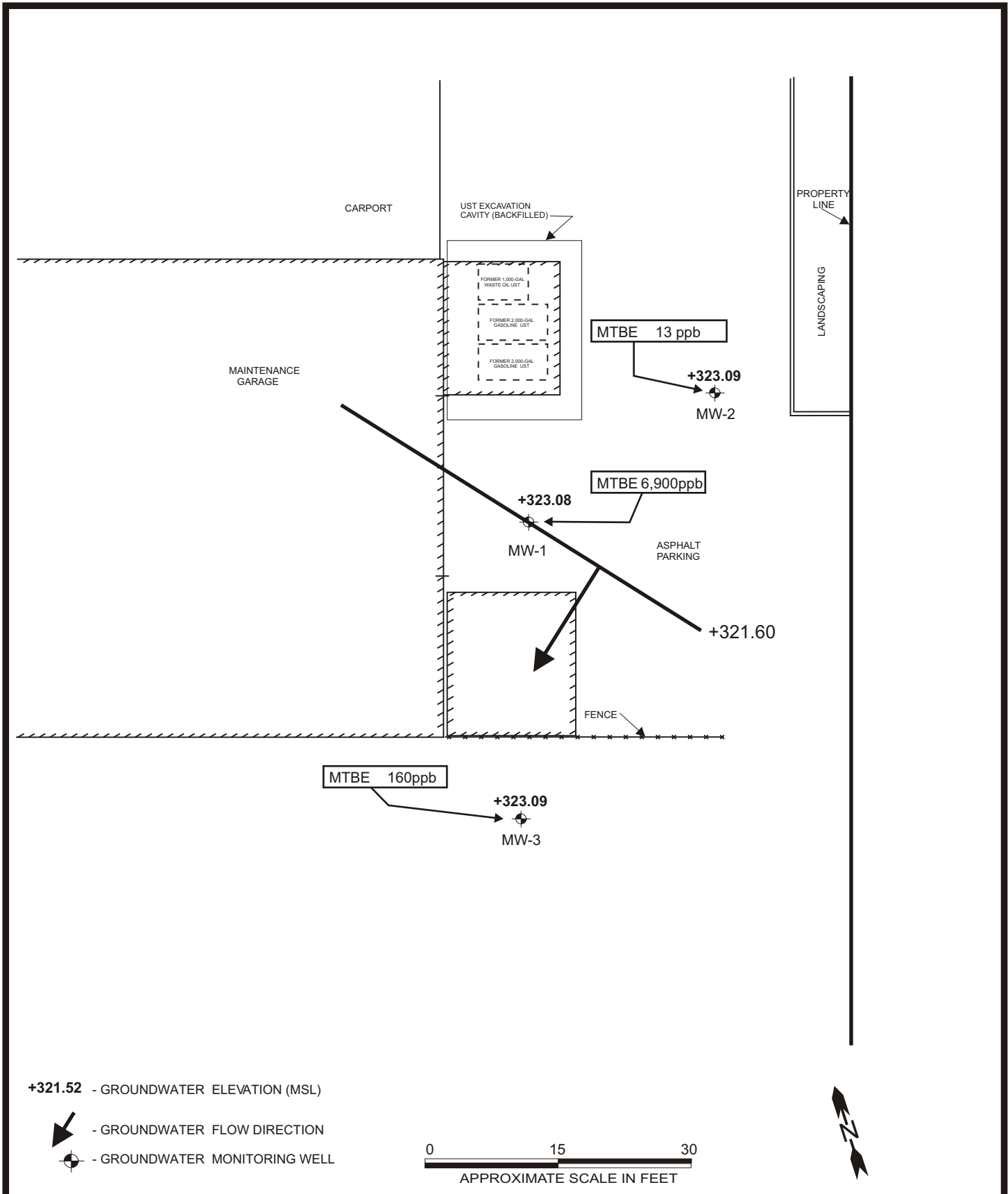

DESIGNED BY:	CHECKED BY:	<b>GROUNDWATER GRADIENT &amp;          MTBE CONCENTRATIONS, 10-16-04</b> DUBLIN TOYOTAUST SITE 6450 DUBLIN COURT DUBLIN, CALIFORNIA	DATE: 4/18/06	FIGURE: 3
DRAWN BY: MR	SCALE:		<b>GRIBI Associates</b>	
PROJECT NO: 147-01-03				

## **TABLE**



**Table 1**  
**SUMMARY OF GROUNDWATER ANALYTICAL RESULTS**  
Dublin Toyota UST Site

Sample ID	Sample Date	GW Elevation	Concentration (ug/l)											
			TPH-D	TPH-MO	TPH-G	B	T	E	X	TAME	TBA	DIPE	ETBE	MTBE
<b>MW-1</b>	12/15/98	323.15	<0.050	<b>110</b>	<b>46,000</b>	<100	<100	<100	<100	--	--	--	--	<b>62,000</b>
<328.89>	04/06/99	323.80	<50	<100	<b>45,000</b>	<50	<50	<50	<50	--	--	--	--	<b>86,000<sup>1</sup></b>
	07/14/99	322.71	<50	<100	<b>2,800</b>	<100	<100	<100	<100	--	--	--	--	<b>65,000<sup>1</sup></b>
	10/14/99	322.03	<50	<100	<b>11,000</b>	<17	<17	<17	<17	--	--	--	--	<b>98,000<sup>1</sup></b>
	08/18/00	321.91	<50	<100	<b>36,000</b>	<50	<50	<50	<50	--	--	--	--	<b>66,000<sup>1</sup></b>
	05/29/02	322.47	--	--	<b>29,100</b>	<15	<15	<15	<30	<b>841</b>	<500	<100	N50	<b>27,800<sup>1</sup></b>
	11/20/02	322.24	--	--	<b>110</b>	<0.5	<0.5	<0.5	<1.0	<20	<50	<20	<20	<b>20,000</b>
	04/06/03	322.94	--	--	<b>1,300</b>	<1.0	<1.0	<1.0	<1.0	<b>10</b>	<b>360</b>	<2.0	<b>2.2</b>	<b>15,000</b>
	07/13/03	322.34	--	--	<b>74</b>	<0.5	<0.5	<0.5	<1.0	<b>10</b>	<b>42</b>	<5.0	<5.0	<b>15,000</b>
	02/11/04	323.15	--	--	<50	<0.5	<0.5	<0.5	<1.0	<b>10</b>	<b>420</b>	<2.0	<b>2.5</b>	<b>34,000</b>
	06/16/04	322.52	--	--	<b>180</b>	<0.5	<0.5	<0.5	<1.0	<b>6.8</b>	<b>290</b>	<2.0	<2.0	<b>7,600</b>
	10/16/04	321.60	--	--	<50	<0.5	<0.5	<0.5	<1.0	<2.0	<10	<2.0	<2.0	<b>6,720</b>
	12/30/04	323.05	--	--	<b>92</b>	<0.5	<0.5	<0.5	<1.0	<b>5.2</b>	<10	<2.0	<2.0	<b>2,600</b>
	03/22/05	323.67	--	--	<50	<0.5	<0.5	<0.5	<1.0	<b>7.3</b>	<10	<2.0	<2.0	<b>6,900</b>
	06/10/05	322.72	--	--	<b>100</b>	<0.5	<0.5	<0.5	<1.0	<b>9.8</b>	<10	<2.0	<2.0	<b>25,000</b>
	10/04/05	321.40	--	--	<50	<0.5	<0.5	<0.5	<1.0	<2.0	<10	<2.0	<2.0	<b>2,500</b>
	12/21/05	321.71	--	--	<50	<0.5	<0.5	<0.5	<1.0	<2.0	<10	<2.0	<2.0	<b>6,800</b>
	3/30/06	323.08	--	--	<50	<0.5	<0.5	<b>1.1</b>	<b>2.6</b>	<2.0	<10	<2.0	<2.0	<b>6,900</b>
<b>MW-2</b>	12/15/98	323.34	<50	<b>570</b>	<50	<0.50	<b>0.90</b>	<0.50	<b>1.5</b>	--	--	--	--	<5.0
<327.64>	04/06/99	324.22	<50	<100	<50	<0.50	<0.50	<0.50	<0.50	--	--	--	--	<5.0
	07/14/99	322.88	<50	<100	<50	<0.50	<0.50	<0.50	<0.50	--	--	--	--	<5.0

**Table 1**  
**SUMMARY OF GROUNDWATER ANALYTICAL RESULTS**  
Dublin Toyota UST Site

Sample ID	Sample Date	GW Elevation	Concentration (ug/l)											
			TPH-D	TPH-MO	TPH-G	B	T	E	X	TAME	TBA	DIPE	ETBE	MTBE
	10/14/99	322.16	<50	<100	<50	<0.50	<0.50	<0.50	<0.50	--	--	--	--	<5.0
	08/18/00	321.92	<50	<100	<50	<0.50	<0.50	<0.50	<b>1.1</b>	--	--	--	--	<b>16</b>
	05/29/02	322.46	--	--	<50	<0.3	<0.3	<0.3	<b>3.9</b>	<2.0	<10	<2.0	<2.0	<b>2.6</b>
	11/20/02	322.12	--	--	<b>57</b>	<0.5	<0.5	<0.5	<1.0	<20	<50	<20	<20	<b>9.1</b>
	04/06/03	323.05	--	--	<50	<1.0	<1.0	<1.0	<1.0	<2.0	<10	<2.0	<2.0	<b>5.7</b>
	07/13/03	322.40	--	--	<50	<0.5	<0.5	<0.5	<1.0	<5.0	<10	<5.0	<5.0	<b>6.5</b>
	02/11/04	323.19	--	--	<50	<0.5	<0.5	<0.5	<1.0	<2.0	<10	<2.0	<2.0	<b>8.5</b>
	06/16/04	322.71	--	--	<50	<0.5	<0.5	<0.5	<1.0	<2.0	<10	<2.0	<2.0	<b>120</b>
	10/16/04	321.67	--	--	<b>78</b>	<0.5	<0.5	<0.5	<1.0	<b>4.1</b>	<10	<2.0	<2.0	<b>43.2</b>
	12/30/04	322.90	--	--	<50	<0.5	<0.5	<0.5	<1.0	<b>4.1</b>	<10	<2.0	<2.0	<b>14</b>
	03/22/05	323.78	--	--	<50	<0.5	<0.5	<0.5	<1.0	<2.0	<10	<2.0	<2.0	<b>13</b>
	06/10/05	322.81	--	--	<50	<0.5	<0.5	<0.5	<1.0	<2.0	<10	<2.0	<2.0	<b>14</b>
	10/04/05	321.45	--	--	<50	<0.5	<0.5	<0.5	<1.0	<2.0	<10	<2.0	<2.0	<b>5.2</b>
	12/21/05	321.83	--	--	<50	<0.5	<0.5	<0.5	<1.0	<2.0	<10	<2.0	<2.0	<1.0
	3/30/06	323.09	--	--	<50	<0.5	<0.5	<b>1.7</b>	<b>3.9</b>	<2.0	<10	<2.0	<2.0	<b>13</b>
<b>MW-3</b>	08/18/00	321.77	<50	<100	<b>210</b>	<0.50	<b>0.58</b>	<0.50	<b>0.59</b>	--	--	--	--	<b>570<sup>1</sup></b>
<327.44>	05/29/02	322.34	--	--	<50	<0.3	<0.3	<0.3	<b>219</b>	<2.0	<10	<2.0	<2.0	<b>281</b>
	11/20/02	321.88	--	--	<b>200</b>	<0.5	<0.5	<0.5	<1.0	<20	<50	<20	<20	<b>460</b>
	04/06/03	322.80	--	--	<b>270</b>	<1.0	<1.0	<1.0	<1.0	<2.0	<10	<2.0	<2.0	<b>340</b>
	07/13/03	321.96	--	--	<50	<0.5	<0.5	<0.5	<1.0	<5.0	<10	<5.0	<5.0	<b>460</b>
	02/11/04	322.97	--	--	<50	<0.5	<0.5	<0.5	<1.0	<b>2.2</b>	<b>1,000</b>	<2.0	<2.0	<b>4,000</b>
	06/16/04	322.21	--	--	<50	<0.5	<0.5	<0.5	<1.0	<2.0	<10	<2.0	<2.0	<b>240</b>

**Table 1**  
**SUMMARY OF GROUNDWATER ANALYTICAL RESULTS**  
 Dublin Toyota UST Site

Sample ID	Sample Date	GW Elevation	Concentration (ug/l)											
			TPH-D	TPH-MO	TPH-G	B	T	E	X	TAME	TBA	DIPE	ETBE	MTBE
	10/16/04	321.52	--	--	<50	<0.5	<0.5	<0.5	<1.0	<2.0	<10	<2.0	<2.0	<b>210</b>
	12/30/04	322.90	--	--	<50	<0.5	<0.5	<0.5	<1.0	<2.0	<b>120</b>	<2.0	<2.0	<b>190</b>
	03/22/05	323.54	--	--	<50	<0.5	<0.5	<0.5	<1.0	<2.0	<10	<2.0	<2.0	<b>210</b>
	06/10/05	322.61	--	--	<50	<0.5	<0.5	<0.5	<1.0	<2.0	<10	<2.0	<2.0	<b>230</b>
	10/04/05	321.42	--	--	<50	<0.5	<0.5	<0.5	<1.0	<2.0	<10	<2.0	<2.0	<b>380</b>
	12/21/05	321.70	--	--	<50	<0.5	<0.5	<0.5	<1.0	<2.0	<10	<2.0	<2.0	<b>320</b>
	3/30/06	323.09	--	--	<50	<0.5	<0.5	<b>1.3</b>	<b>3.0</b>	<2.0	<10	<2.0	<2.0	<b>160</b>

**Table Notes:**

GW Elevation = Groundwater mean sea level elevation.  
 TPH-D = Total Petroleum Hydrocarbons as Diesel  
 TPH-MO = Total Petroleum Hydrocarbons as Motor Oil  
 TPH-G = Total Petroleum Hydrocarbons as Gasoline  
 B = Benzene  
 T = Toluene  
 E = Ethylbenzene  
 X = Xylenes  
 TAME = Tert-amyl Methyl Ether  
 TBA = tert-Butanol

DIPE = Diisopropyle ether ETBE = Ethyl-tert-butyl ether  
 MTBE = Methyl-t-Butyl Ether  
 NA = Not analyzed for particular parameter  
 <0.050 = Not detected above the expressed value.  
 <328.89> = Surveyed top of casing mean sea level elevation.  
 1 = MTBE result was confirmed using USEPA Method 8260B.  
 2 = MW-1 and MW-2 laboratory results reported by Sunstar Laboratories appear to be mistakenly switched. This has been corrected herein.

**ATTACHMENT A**  
**GROUNDWATER MONITORING FIELD DATA RECORDS**

## Ground Water Monitoring Field Sheet

Site Dublin Toyota  
 Sampling Personnel ASG  
 Weather Conditions \_\_\_\_\_  
 Well ID MW-1  
 Depth to Water (ft) 5.81  
 Water Column (ft) 14.19  
 3X Well Volume (gal) 9

Project Number \_\_\_\_\_  
 Date 3/30/06  
 Casing Diameter (inches) \_\_\_\_\_  
 Total Depth (ft) 20.0  
 One Well Volume (gal) \_\_\_\_\_

~~12.5~~  
~~12.5~~  
5.81  

---

14.19  
 .2  

---

2838  
2123  

---

8514

Notes:  
 One Well Volume is determined by multiplying "Water Column" by:  
 \* 0.059 for 3/4 inch well, 0.17 for 2 inch well, 0.38 for 3 inch well, 0.66 for 4 inch well, 1.50 for 6 inch well

**Field Methods (check appropriate box)**

Activity	Bailer	Pump	Comments
<u>PURGE</u>		<u>X</u>	<u>12 V pump</u>

**Field Parameters**

Time	Volume Purged	Temp (Celsius)	E.C. (mS/cm)	D.O. (mg/L)	pH	ORP (mv)	Comments
<del>6:00</del>	<u>5</u>	<u>17.23</u>	<u>1.951</u>	<u>12.50</u>	<u>7.22</u>	<u>15.8</u>	
<u>6:05</u>	<u>4</u>	<u>16.94</u>	<u>1.836</u>	<u>2.66</u>	<u>7.14</u>	<u>-47.3</u>	

328.05

**Sample Observations**

Characteristic	None	Slight	Moderate	Strong	Comments
Color	<u>✓</u>				
Odor	<u>✓</u>				
Turbidity	<u>✓</u>				
Sheen	<u>✓</u>				
Floating Particles					
Precipitate					

Sample Time 6:05 pm

Sampler's Signature [Signature]

Ground Water Monitoring Field Sheet

Site Dublin Toyota

Project Number \_\_\_\_\_

Sampling Personnel AGG

Date 3/30/06

Weather Conditions SPRINKLES

Well ID MW-2

Casing Diameter (inches) \_\_\_\_\_

Depth to Water (ft) 4.55

Total Depth (ft) 20.0

Water Column (ft) 15.45

One Well Volume (gal) \_\_\_\_\_

3X Well Volume (gal) 9

Notes:

One Well Volume is determined by multiplying "Water Column" by:

\* 0.059 for 3/4 inch well, 0.17 for 2 inch well, 0.38 for 3 inch well, 0.66 for 4 inch well, 1.50 for 6 inch well

**Field Methods (check appropriate box)**

Activity	Bailer	Pump	Comments
<u>Pump</u>		<input checked="" type="checkbox"/>	<u>12 V pump</u>

**Field Parameters**

Time	Volume Purged	Temp (Celsius)	E.C. (mS/cm)	D.O. (mg/L)	pH	ORP (mv)	Comments
<u>4:55</u>	<u>5</u>	<u>14.85</u>	<u>.478</u>	<u>12.65</u>	<u>6.67</u>	<u>-42.8</u>	
<u>5:00</u>	<u>4</u>	<u>18.29</u>	<u>1.081</u>	<u>4.88</u>	<u>7.43</u>	<u>-141.8</u>	

**Sample Observations**

Characteristic	None	Slight	Moderate	Strong	Comments
Color				<input checked="" type="checkbox"/>	<u>BLACK</u>
Odor			<input checked="" type="checkbox"/>		
Turbidity				<input checked="" type="checkbox"/>	
Sheen		<input checked="" type="checkbox"/>			
Floating Particles					
Precipitate					

Sample Time 6:00 pm

Sampler's Signature AGG

~~12.65~~  
4.55  
-----  
15.45  
1.2  
-----  
3.290  
2.3  
-----  
9.270

Ground Water Monitoring Field Sheet

Site Dublin Toyota Project Number \_\_\_\_\_  
 Sampling Personnel AJG Date 3/30/06  
 Weather Conditions Cloudy / Rain / Wind  
 Well ID MW-3 Casing Diameter (inches) 2"  
 Depth to Water (ft) 4.35 Total Depth (ft) 28.0  
 Water Column (ft) 15.65 One Well Volume (gal) \_\_\_\_\_  
 3X Well Volume (gal) 9

~~18.0~~ ~~5.0~~  
 4.35  
 15.65  
 .2  
 31.30

Notes:

One Well Volume is determined by multiplying "Water Column" by:  
 \* 0.059 for 3/4 inch well, 0.17 for 2 inch well, 0.38 for 3 inch well, 0.66 for 4 inch well, 1.50 for 6 inch well

**Field Methods (check appropriate box)**

Activity	Bailer	Pump	Comments
		X	12 V / MP

**Field Parameters**

Time	Volume Purged	Temp (Celsius)	E.C. (mS/cm)	D.O. (mg/L)	pH	ORP (mv)	Comments
5:30	5	19.82	4.852	3.15	7.04	30.7	
5:35	4	20.53	4.828	2.91	7.03	-29.5	

**Sample Observations**

Characteristic	None	Slight	Moderate	Strong	Comments
Color	✓				
Odor	✓				
Turbidity	✓				
Sheen	✓				
Floating Particles					
Precipitate					

Sample Time 5:35 ~~5:30~~ pm Sampler's Signature AJG



**ATTACHMENT B**

**LABORATORY DATA REPORTS AND  
CHAIN-OF-CUSTODY RECORDS**

07 April 2006

Jim Gribi  
Gribi Associates  
1090 Adam Street, Suite K  
Benicia, CA 94510  
RE: Dublin Toyota

Enclosed are the results of analyses for samples received by the laboratory on 04/05/06 09:00. If you have any questions concerning this report, please feel free to contact me.

Sincerely,

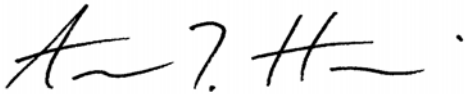
A handwritten signature in black ink, appearing to read "A. Harris". The signature is written in a cursive style with a period at the end.

Aaron Harris  
Project Coordinator

Gribi Associates  
1090 Adam Street, Suite K  
Benicia CA, 94510

Project: Dublin Toyota  
Project Number: 147-01-03  
Project Manager: Jim Gribi

**Reported:**  
04/07/06 17:11

**ANALYTICAL REPORT FOR SAMPLES**

Sample ID	Laboratory ID	Matrix	Date Sampled	Date Received
MW-1	T600428-01	Water	03/30/06 18:00	04/05/06 09:00
MW-2	T600428-02	Water	03/30/06 17:00	04/05/06 09:00
MW-3	T600428-03	Water	03/30/06 17:35	04/05/06 09:00

SunStar Laboratories, Inc.

*The results in this report apply to the samples analyzed in accordance with the chain of custody document. This analytical report must be reproduced in its entirety.*

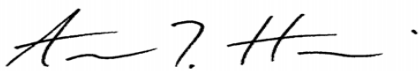

Aaron Harris, Project Coordinator

Gribi Associates  
 1090 Adam Street, Suite K  
 Benicia CA, 94510

Project: Dublin Toyota  
 Project Number: 147-01-03  
 Project Manager: Jim Gribi

**Reported:**  
 04/07/06 17:11

**MW-1**  
**T600428-01 (Water)**

Analyte	Result	Reporting Limit	Units	Dilution	Batch	Prepared	Analyzed	Method	Notes
---------	--------	-----------------	-------	----------	-------	----------	----------	--------	-------

**SunStar Laboratories, Inc.**

**Purgeable Petroleum Hydrocarbons by EPA 8015m**

C6-C12 (GRO)	ND	50	ug/l	1	6040501	04/05/06	04/05/06	EPA 8015m	
<i>Surrogate: 4-Bromofluorobenzene</i>		96.0 %	65-135		"	"	"	"	

**Volatile Organic Compounds by EPA Method 8260B**

Benzene	ND	0.50	ug/l	1	6040502	04/05/06	04/05/06	EPA 8260B	
Toluene	ND	0.50	"	"	"	"	"	"	
<b>Ethylbenzene</b>	<b>1.1</b>	0.50	"	"	"	"	"	"	
<b>m,p-Xylene</b>	<b>2.6</b>	1.0	"	"	"	"	"	"	
o-Xylene	ND	0.50	"	"	"	"	"	"	
Tert-amyl methyl ether	ND	2.0	"	"	"	"	"	"	
Tert-butyl alcohol	ND	10	"	"	"	"	"	"	
Di-isopropyl ether	ND	2.0	"	"	"	"	"	"	
Ethyl tert-butyl ether	ND	2.0	"	"	"	"	"	"	
<b>Methyl tert-butyl ether</b>	<b>6900</b>	100	"	100	"	"	"	"	
<i>Surrogate: Toluene-d8</i>		99.8 %	87.6-115		"	"	"	"	
<i>Surrogate: 4-Bromofluorobenzene</i>		97.0 %	80-112		"	"	"	"	
<i>Surrogate: Dibromofluoromethane</i>		115 %	78.6-122		"	"	"	"	

SunStar Laboratories, Inc.

*The results in this report apply to the samples analyzed in accordance with the chain of custody document. This analytical report must be reproduced in its entirety.*

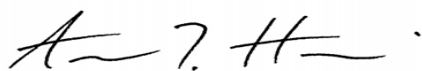

Aaron Harris, Project Coordinator

Gribi Associates  
 1090 Adam Street, Suite K  
 Benicia CA, 94510

Project: Dublin Toyota  
 Project Number: 147-01-03  
 Project Manager: Jim Gribi

**Reported:**  
 04/07/06 17:11

**MW-2**  
**T600428-02 (Water)**

Analyte	Result	Reporting Limit	Units	Dilution	Batch	Prepared	Analyzed	Method	Notes
---------	--------	-----------------	-------	----------	-------	----------	----------	--------	-------

**SunStar Laboratories, Inc.**

**Purgeable Petroleum Hydrocarbons by EPA 8015m**

C6-C12 (GRO)	ND	50	ug/l	1	6040501	04/05/06	04/05/06	EPA 8015m	
<i>Surrogate: 4-Bromofluorobenzene</i>		78.6 %	65-135		"	"	"	"	

**Volatile Organic Compounds by EPA Method 8260B**

Benzene	ND	0.50	ug/l	1	6040502	04/05/06	04/05/06	EPA 8260B	
Toluene	ND	0.50	"	"	"	"	"	"	
<b>Ethylbenzene</b>	<b>1.7</b>	0.50	"	"	"	"	"	"	
<b>m,p-Xylene</b>	<b>3.9</b>	1.0	"	"	"	"	"	"	
o-Xylene	ND	0.50	"	"	"	"	"	"	
Tert-amyl methyl ether	ND	2.0	"	"	"	"	"	"	
Tert-butyl alcohol	ND	10	"	"	"	"	"	"	
Di-isopropyl ether	ND	2.0	"	"	"	"	"	"	
Ethyl tert-butyl ether	ND	2.0	"	"	"	"	"	"	
<b>Methyl tert-butyl ether</b>	<b>13</b>	1.0	"	"	"	"	"	"	
<i>Surrogate: Toluene-d8</i>		100 %	87.6-115		"	"	"	"	
<i>Surrogate: 4-Bromofluorobenzene</i>		99.8 %	80-112		"	"	"	"	
<i>Surrogate: Dibromofluoromethane</i>		120 %	78.6-122		"	"	"	"	

SunStar Laboratories, Inc.

*The results in this report apply to the samples analyzed in accordance with the chain of custody document. This analytical report must be reproduced in its entirety.*

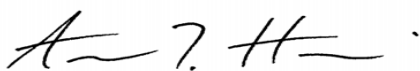

Aaron Harris, Project Coordinator

Gribi Associates  
 1090 Adam Street, Suite K  
 Benicia CA, 94510

Project: Dublin Toyota  
 Project Number: 147-01-03  
 Project Manager: Jim Gribi

**Reported:**  
 04/07/06 17:11

**MW-3**  
**T600428-03 (Water)**

Analyte	Result	Reporting Limit	Units	Dilution	Batch	Prepared	Analyzed	Method	Notes
---------	--------	-----------------	-------	----------	-------	----------	----------	--------	-------

**SunStar Laboratories, Inc.**

**Purgeable Petroleum Hydrocarbons by EPA 8015m**

C6-C12 (GRO)	ND	50	ug/l	1	6040501	04/05/06	04/05/06	EPA 8015m	
<i>Surrogate: 4-Bromofluorobenzene</i>		85.8 %	65-135		"	"	"	"	

**Volatile Organic Compounds by EPA Method 8260B**

Benzene	ND	0.50	ug/l	1	6040502	04/05/06	04/05/06	EPA 8260B	
Toluene	ND	0.50	"	"	"	"	"	"	
<b>Ethylbenzene</b>	<b>1.3</b>	0.50	"	"	"	"	"	"	
<b>m,p-Xylene</b>	<b>3.0</b>	1.0	"	"	"	"	"	"	
o-Xylene	ND	0.50	"	"	"	"	"	"	
Tert-amyl methyl ether	ND	2.0	"	"	"	"	"	"	
Tert-butyl alcohol	ND	10	"	"	"	"	"	"	
Di-isopropyl ether	ND	2.0	"	"	"	"	"	"	
Ethyl tert-butyl ether	ND	2.0	"	"	"	"	"	"	
<b>Methyl tert-butyl ether</b>	<b>160</b>	1.0	"	"	"	"	"	"	
<i>Surrogate: Toluene-d8</i>		102 %	87.6-115		"	"	"	"	
<i>Surrogate: 4-Bromofluorobenzene</i>		96.8 %	80-112		"	"	"	"	
<i>Surrogate: Dibromofluoromethane</i>		118 %	78.6-122		"	"	"	"	

SunStar Laboratories, Inc.

*The results in this report apply to the samples analyzed in accordance with the chain of custody document. This analytical report must be reproduced in its entirety.*

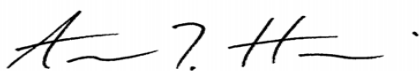

Aaron Harris, Project Coordinator

Gribi Associates  
 1090 Adam Street, Suite K  
 Benicia CA, 94510

Project: Dublin Toyota  
 Project Number: 147-01-03  
 Project Manager: Jim Gribi

**Reported:**  
 04/07/06 17:11

**Purgeable Petroleum Hydrocarbons by EPA 8015m - Quality Control**  
**SunStar Laboratories, Inc.**

Analyte	Result	Reporting Limit	Units	Spike Level	Source Result	%REC	%REC Limits	RPD	RPD Limit	Notes
<b>Batch 6040501 - EPA 5030 GC</b>										
<b>Blank (6040501-BLK1)</b>										
Prepared & Analyzed: 04/05/06										
Surrogate: 4-Bromofluorobenzene	39.0		ug/l	50.0		78.0	65-135			
C6-C12 (GRO)	ND	50	"							
<b>LCS (6040501-BS1)</b>										
Prepared & Analyzed: 04/05/06										
Surrogate: 4-Bromofluorobenzene	50.0		ug/l	50.0		100	65-135			
C6-C12 (GRO)	6410	50	"	5500		117	75-125			
<b>Matrix Spike (6040501-MS1)</b>										
Source: T600428-03 Prepared & Analyzed: 04/05/06										
Surrogate: 4-Bromofluorobenzene	44.9		ug/l	50.0		89.8	65-135			
C6-C12 (GRO)	5860	50	"	5500	ND	107	65-135			
<b>Matrix Spike Dup (6040501-MSD1)</b>										
Source: T600428-03 Prepared & Analyzed: 04/05/06										
Surrogate: 4-Bromofluorobenzene	52.4		ug/l	50.0		105	65-135			
C6-C12 (GRO)	5840	50	"	5500	ND	106	65-135	0.342	20	

SunStar Laboratories, Inc.

*The results in this report apply to the samples analyzed in accordance with the chain of custody document. This analytical report must be reproduced in its entirety.*

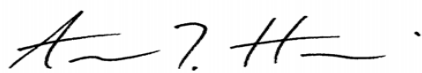

Aaron Harris, Project Coordinator



Gribi Associates  
 1090 Adam Street, Suite K  
 Benicia CA, 94510

Project: Dublin Toyota  
 Project Number: 147-01-03  
 Project Manager: Jim Gribi

**Reported:**  
 04/07/06 17:11

**Volatile Organic Compounds by EPA Method 8260B - Quality Control**  
**SunStar Laboratories, Inc.**

Analyte	Result	Reporting Limit	Units	Spike Level	Source Result	%REC	%REC Limits	RPD	RPD Limit	Notes
---------	--------	-----------------	-------	-------------	---------------	------	-------------	-----	-----------	-------

**Batch 6040502 - EPA 5030 GCMS**

**Blank (6040502-BLK1)**

Prepared & Analyzed: 04/05/06

Surrogate: Toluene-d8	40.2		ug/l	40.0		100	86-115			
Surrogate: 4-Bromofluorobenzene	37.5		"	40.0		93.8	86-115			
Surrogate: Dibromofluoromethane	46.2		"	40.0		116	86-118			
1,2-Dibromoethane (EDB)	ND	0.50	"							
1,2-Dichloroethane	ND	0.50	"							
Benzene	ND	0.50	"							
Toluene	ND	0.50	"							
Ethylbenzene	ND	0.50	"							
m,p-Xylene	ND	1.0	"							
o-Xylene	ND	0.50	"							
Tert-amyl methyl ether	ND	2.0	"							
Tert-butyl alcohol	ND	10	"							
Di-isopropyl ether	ND	2.0	"							
Ethyl tert-butyl ether	ND	2.0	"							
Methyl tert-butyl ether	ND	1.0	"							
C6-C12 (GRO)	ND	50	"							

**LCS (6040502-BS1)**

Prepared & Analyzed: 04/05/06

Surrogate: Toluene-d8	39.6		ug/l	40.0		99.0	86-115			
Surrogate: 4-Bromofluorobenzene	37.6		"	40.0		94.0	86-115			
Surrogate: Dibromofluoromethane	48.2		"	40.0		120	81-136			
Chlorobenzene	99.7	1.0	"	100		99.7	75-125			
1,1-Dichloroethene	115	1.0	"	100		115	15-125			
Trichloroethene	92.1	1.0	"	100		92.1	75-125			
Benzene	92.5	0.50	"	100		92.5	75-125			
Toluene	94.2	0.50	"	100		94.2	75-125			

**Matrix Spike (6040502-MS1)**

Source: T600428-03

Prepared & Analyzed: 04/05/06

Surrogate: Toluene-d8	40.0		ug/l	40.0		100	86-115			
Surrogate: 4-Bromofluorobenzene	39.2		"	40.0		98.0	86-115			
Surrogate: Dibromofluoromethane	47.8		"	40.0		120	81-136			
Chlorobenzene	96.9	1.0	"	100	ND	96.9	75-125			
1,1-Dichloroethene	115	1.0	"	100	ND	115	75-125			
Trichloroethene	91.6	1.0	"	100	ND	91.6	75-125			
Benzene	93.5	0.50	"	100	ND	93.5	75-125			
Toluene	93.5	0.50	"	100	ND	93.5	75-125			

SunStar Laboratories, Inc.

The results in this report apply to the samples analyzed in accordance with the chain of custody document. This analytical report must be reproduced in its entirety.

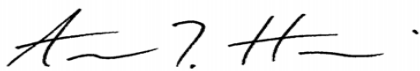

Aaron Harris, Project Coordinator

Gribi Associates  
1090 Adam Street, Suite K  
Benicia CA, 94510

Project: Dublin Toyota  
Project Number: 147-01-03  
Project Manager: Jim Gribi

**Reported:**  
04/07/06 17:11

**Volatile Organic Compounds by EPA Method 8260B - Quality Control**

**SunStar Laboratories, Inc.**

Analyte	Result	Reporting Limit	Units	Spike Level	Source Result	%REC	%REC Limits	RPD	RPD Limit	Notes
---------	--------	-----------------	-------	-------------	---------------	------	-------------	-----	-----------	-------

**Batch 6040502 - EPA 5030 GCMS**

**Matrix Spike Dup (6040502-MSD1)**

Source: T600428-03

Prepared & Analyzed: 04/05/06

Surrogate: Toluene-d8	40.0		ug/l	40.0		100	86-115			
Surrogate: 4-Bromofluorobenzene	38.6		"	40.0		96.5	86-115			
Surrogate: Dibromofluoromethane	49.8		"	40.0		124	81-136			
Chlorobenzene	107	1.0	"	100	ND	107	75-125	9.91	20	
1,1-Dichloroethene	123	1.0	"	100	ND	123	75-125	6.72	20	
Trichloroethene	98.4	1.0	"	100	ND	98.4	75-125	7.16	20	
Benzene	98.5	0.50	"	100	ND	98.5	75-125	5.21	20	
Toluene	102	0.50	"	100	ND	102	75-125	8.70	20	

SunStar Laboratories, Inc.

*The results in this report apply to the samples analyzed in accordance with the chain of custody document. This analytical report must be reproduced in its entirety.*

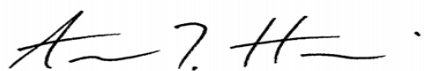

Aaron Harris, Project Coordinator

Gribi Associates  
1090 Adam Street, Suite K  
Benicia CA, 94510

Project: Dublin Toyota  
Project Number: 147-01-03  
Project Manager: Jim Gribi

**Reported:**  
04/07/06 17:11

### Notes and Definitions

DET Analyte DETECTED  
ND Analyte NOT DETECTED at or above the reporting limit  
NR Not Reported  
dry Sample results reported on a dry weight basis  
RPD Relative Percent Difference

---

SunStar Laboratories, Inc.

*The results in this report apply to the samples analyzed in accordance with the chain of custody document. This analytical report must be reproduced in its entirety.*

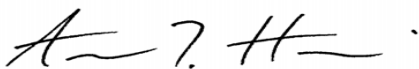

---

Aaron Harris, Project Coordinator

SunStar Laboratories, Inc.  
 3002 Dow Ave, Suite 212  
 Tustin, CA 92780  
 1-800-781-6777

**Chain of Custody Record**

T600428

Client: **GRIBI ASSOCIATES**  
 Address: **1090 ADAMS STREET, SUITE K**  
 Phone: **(707) 748-7743** Fax: **(707) 748-7763**  
 Project Manager: **JAMES GRIBI**

Date: **5/5/06** Page: **1** Of **1**  
 Project Name: **DUBLIN TOYOTA**  
 Collector: **ARCON GARZA** Client Project #: **147-01-03**  
 Batch #: \_\_\_\_\_ Proposal #: \_\_\_\_\_

Sample ID	Date Sampled	Time	Sample Type	Container Type	BTEX/TPH Gas/MTBE (8021B/M8015)	TPH as Gas (M8015)	TPH as Diesel (M8015)	TPH as Motor Oil (M8015)	TPH Gas/BTEX/MTBE (8260B)	5 Oxygenates/BTEX (8260B)	7 Oxygenates/TPH Gas/BTEX (8260B)	5 Oxygenates (8260B)	Lead Scav. (1,2 DCA & 1,2 EDB (8260B)	EPA 8260 (Full List)	Halogenated VOCs (8260B)	Laboratory ID #	Preservative	Comments	Total # of containers
MW-1	3/30/06	6:50pm	Water	VOA		X				X						01	HCl		4
MW-2	3/30/06	5:20pm	Water	VOA		X				X						02	HCl		4
MW-3	3/30/06	5:35pm	Water	VOA		X				X						03	HCl		4
<b>STD. TAT</b>																			
A/H																			
Relinquished by: (signature) _____ Date / Time <b>5/5/06 5:30am</b>					Received by: (signature) _____ Date / Time <b>4/4/06 11:45</b>					Total # of containers		12		Notes  <b>PLEASE PROVIDE EDF REPORT</b>					
Relinquished by: (signature) <b>GSO</b> Date / Time <b>4/5/06 0900</b>					Received by: (signature) <b>A=7.H</b> Date / Time <b>4/5/06 0900</b>					Chain of Custody seals Y/N <b>(NA)</b>									
Relinquished by: (signature) _____ Date / Time _____					Received by: (signature) _____ Date / Time _____					Seals intact? Y/N <b>(NA)</b>		Received good condition <b>(C)</b>							
Turn around time: _____																			

Sample disposal Instructions: Disposal @ \$2.00 each \_\_\_\_\_ Return to client \_\_\_\_\_ Pickup \_\_\_\_\_