



TANK PROTECT ENGINEERING  
of Northern California, inc.

# 2116

FROM: TANK PROTECT ENGINEERING

DATE: 7-13-95

TO: ACHCSA

ATTN: Barney Chan

RE.: 2345 E. 14<sup>th</sup> St

NO. OF PAGES: 9  
(Include cover sheet)

If all pages are not received please notify sender.

MESSAGE:

Results of recent soil sampling. Results for  
1000 ~~1000~~ ~~1000~~ Alameda, Oakland  
2345 E 14<sup>th</sup>

~~not~~ monitoring:  
done in June?

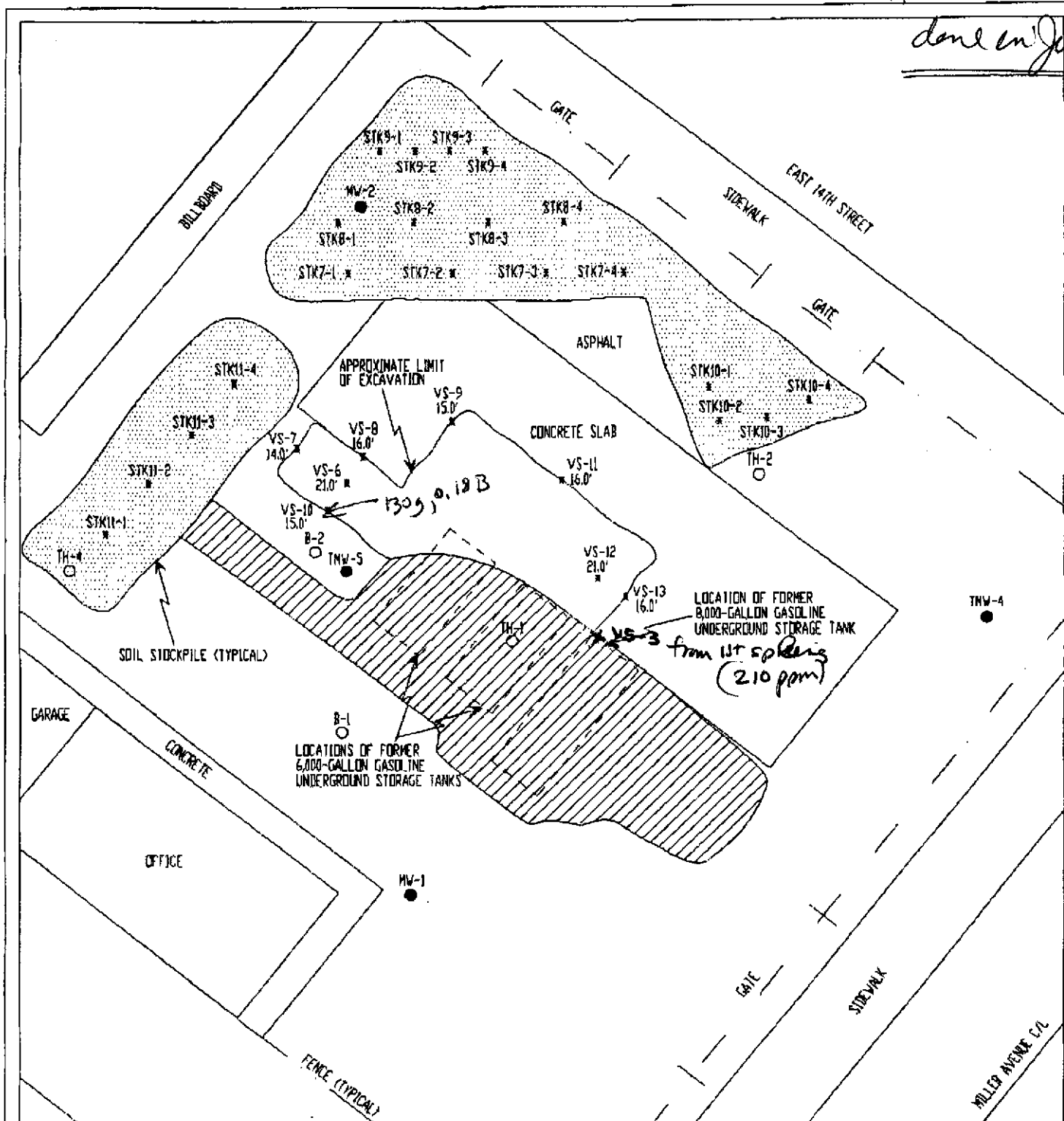

LEGEND

- TMW-4 NAME AND LOCATION OF GROUNDWATER MONITORING WELL INSTALLED BY TPE
- MW-1 NAME AND LOCATION OF GROUNDWATER MONITORING WELL INSTALLED BY OTHERS
- B-1 NAME AND APPROXIMATE LOCATION OF SOIL BORING DRILLED BY OTHERS
- VS-9 15.0' \* NAME, DEPTH, AND LOCATION OF SOIL SAMPLE
- ▨ AREA BACKFILLED

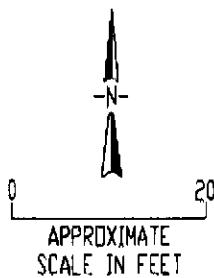

TANK PROTECT ENGINEERING

SITE PLAN  
EXCAVATION (6/30 - 7/5/95)

CREDIT WORLD AUTO SALES  
2345 E. 14TH STREET  
OAKLAND, CA 94601

DATE	7/11/95
FIGURE	2
FILE #	267-2N
DRAWN BY	NT
CHECKED BY	LMH

Project name: CREDIT WORLD AUTO  
 Project location: 2345 East 14th St.  
 Project number: 267070595

Date sampled: Jul 05, 1995  
 Date extracted: Jul 06-08, 1995

Date submitted: Jul 06, 1995  
 Date analyzed: Jul 06-08, 1995

**RESULTS:**

SAMPLE I.D.	Gasoline (mg/Kg)	Diesel (mg/Kg)	Benzene (ug/Kg)	Toluene (ug/Kg)	Ethyl Benzene (ug/Kg)	Total Xylene (ug/Kg)
STK10-1,2,3,4*	22	---	12	12	32	89
STK11-1,2,3,4*	N.D.	N.D.	N.D.	N.D.	N.D.	N.D.
VS-8	33	---	36	22	66	99
VS-9	42	---	60	36	89	120
VS-10	130	---	180	85	250	370
VS-11	81	---	73	86	160	210
VS-12	N.D.	---	N.D.	N.D.	N.D.	N.D.
VS-13	75	---	48	40	78	180
Blank	N.D.	N.D.	N.D.	N.D.	N.D.	N.D.
Spiked Recovery	94.6%	88.1%	81.2%	85.8%	80.1%	98.3%
Detection limit	1.0	1.0	5.0	5.0	5.0	5.0
Method of Analysis	5030 / 8015	3550 / 8015	8020	8020	8020	8020

\*Composited soil samples.

  
 David Duong  
 Laboratory Director



TANK PROTECT ENGINEERING

2821 WHIPPLE ROAD  
UNION CITY, CA 94587  
(415) 429-8088  
(800) 523-8988  
FAX (415) 429-8089

PEL # 9507004  
INV # 26122

LAB: Priority Env  
TURNAROUND: NORMAL  
P.O. #: 1078

PAGE 1 OF 2

CHAIN OF CUSTODY

PROJECT NO.		SITE NAME & ADDRESS				(1) TYPE OF CONTAINER	ANALYTES REQUESTED						REMARKS
267 070595		Credit worth Auto Sales 2345 E 14 <sup>th</sup> St					TOTAL LIGHT MET	AROMATIC HC	TOTAL HEAVY MET	OLEF & GASES	PCB SEAM (224's)	OTHER	
SAMPLER NAME, ADDRESS AND TELEPHONE NUMBER													
Lee Huckins 2821 WHIPPLE ROAD, UNION CITY, CA 94587 (415) 429-8088													
ID NO.	DATE	TIME	SOIL	WATER	SAMPLING LOCATION								
✓ VS-8	7/5	1058	X		16	BRASS	X	X					
✓ VS-9	7/5	1066	X		15	BRASS	X	X					
✓ VS-10	7/5	1079	X		15	BRASS	X	X					
✓ VS-11	7/5	1061	X		16	BRASS	X	X					
✓ VS-12	7/5	1077	X		21	BRASS	X	X					
✓ VS-13	7/5	1048	X		16	BRASS	X	X					
Relinquished by: (Signature)		Date / Time		Received by: (Signature)		Relinquished by: (Signature)		Date / Time		Received by: (Signature)			
Lee Huckins		7/6/95 18:00		[Signature]		[Signature]		7/6/95 12:44		[Signature]			
Relinquished by: (Signature)		Date / Time		Received by: (Signature)		Relinquished by: (Signature)		Date / Time		Received by: (Signature)			
[Signature]		7/6/95 12:44		[Signature]		[Signature]		[Signature]		[Signature]			
Relinquished by: (Signature)		Date / Time		Received for Laboratory by: (Signature)		Date / Time		Remarks					
[Signature]		[Signature]		PEL		[Signature]		[Signature]					

DATE: \_\_\_\_\_



TANK PROTECT ENGINEERING

2821 WHIPPLE ROAD  
UNION CITY, CA 94587  
(415) 429-8088  
(800) 523-8088  
FAX (415) 429-8089

LAB: Priority  
TURNAROUND: 1108 MAL  
P.O. #: 107B

CHAIN OF CUSTODY

PROJECT NO.		SITE NAME & ADDRESS				(1) TYPE OF CON- TAINER	ANALYTES REQUESTED						REMARKS
267070595		Credit World Auto Sales 2348 E 14th St					TOTAL LEAD PC	AROMATIC PC	TOTAL BENTH PC	OLE & GREASE	PCB SCUM (P2+3)	OTHER	
SAMPLER NAME, ADDRESS AND TELEPHONE NUMBER													
Lee Huckins 2821 WHIPPLE ROAD, UNION CITY, CA 94587 (415) 429-8088													
ID NO.	DATE	FINE	GALL	WATER	SAMPLING LOCATION								
✓ STK10-1	7/5	1701	2		3.0	x	x					Composite into 1 sample	
✓ STK10-2	7/5	1659	2		3.0	x	x						
✓ STK10-3	7/5	167	2		3.0	x	x						
✓ STK10-4	7/5	165	2		3.0	x	x						
✓ STK11-1	7/5	1145	✓		3.0	x	x	x				Composite into 1 sample	
✓ STK11-2	7/5	1147	2		3.0	x	x	x					
✓ STK11-3	7/5	1149	2		3.0	x	x	x					
✓ STK11-4	7/5	1151	2		3.0	x	x	x					
Relinquished by: (Signature)		Date / Time		Received by: (Signature)		Relinquished by: (Signature)		Date / Time		Received by: (Signature)			
Lee Huckins		7/6/95 18:00		[Signature]		[Signature]		7/6/95 18:00		[Signature]			
Relinquished by: (Signature)		Date / Time		Received by: (Signature)		Relinquished by: (Signature)		Date / Time		Received by: (Signature)			
[Signature]		7/6/95 12:4		[Signature]		[Signature]				[Signature]			
Relinquished by: (Signature)		Date / Time		Received for Laboratory by: (Signature)		Date / Time		Remarks					
[Signature]				PEL									

DATE: \_\_\_\_\_

**Trace Analysis Laboratory, Inc.**

3423 Investment Boulevard, #8 • Hayward, California 94545

Telephone (510) 783-8980

Facsimile (510) 783-1512



LOG NUMBER: 5658  
 DATE SAMPLED: 06/30/95 and 07/03/95  
 DATE RECEIVED: 07/05/95  
 DATE EXTRACTED: 07/07/95  
 DATE ANALYZED: 07/08/95 and 07/11/95  
 DATE REPORTED: 07/12/95

CUSTOMER: Tank Protect Engineering  
 REQUESTER: Jeff Farhoomand  
 PROJECT: No. 267-070395, Credit Auto World, 2345 East 14th Street

Sample Type: Soil

Method and Constituent:	Units	VS-6		VS-7		Composite of STK7(1-4)	
		Concen- tration	Reporting Limit	Concen- tration	Reporting Limit	Concen- tration	Reporting Limit
DHS Method:							
Total Petroleum Hydro- carbons as Gasoline	ug/kg	ND	500	50,000	740	290,000	7,200
Modified EPA Method 8020 for:							
Benzene	ug/kg	ND	5.0	370	15	560	140
Toluene	ug/kg	ND	5.0	70	15	970	140
Ethylbenzene	ug/kg	ND	5.0	990	15	3,000	140
Xylenes	ug/kg	ND	15	3,300	44	11,000	430

Concentrations reported as ND were not detected at or above the reporting limit.



Trace Analysis Laboratory, Inc.

LOG NUMBER: 5658  
 DATE SAMPLED: 07/03/95  
 DATE RECEIVED: 07/05/95  
 DATE EXTRACTED: 07/07/95  
 DATE ANALYZED: 07/11/95  
 DATE REPORTED: 07/12/95  
 PAGE: Two

Sample Type: Soil

Method and Constituent:	Units	Composite of STK8(1-4)		Composite of STK9(1-4)		Method Blank	
		Concen- tration	Reporting Limit	Concen- tration	Reporting Limit	Concen- tration	Reporting Limit
<b>DHS Method:</b>							
Total Petroleum Hydrocarbons as Gasoline	ug/kg	49,000	3,500	78,000	500	ND	500
<b>Modified EPA Method 8020 for:</b>							
Benzene	ug/kg	100	70	52	5.0	ND	5.0
Toluene	ug/kg	100	70	36	5.0	ND	5.0
Ethylbenzene	ug/kg	550	70	520	5.0	ND	5.0
Xylenes	ug/kg	1,800	210	1,600	15	ND	15

DC Summary:

% Recovery: 111, 104  
 % RPD: 1.8, 5.4

Concentrations reported as ND were not detected at or above the reporting limit.

  
 Louis W. DuPuis  
 Quality Assurance/Quality Control Manager

5658



TANK PROTECT ENGINEERING

2921 WHIFFLE ROAD  
UNION CITY, CA 94507  
(415) 429-0089  
(800) 529-0089  
FAX (415) 429-0089

LAB: JAL

TURNAROUND: 5 day

P.O. #: 1077

CHAIN OF CUSTODY

PAGE 1 OF 2

PROJECT NO.		SITE NAME & ADDRESS				(1) TYPE OF CONTAINER	ANALYTES REQUESTED	TOTAL LIGHT MET	AROMATIC HC (HT)	TOTAL HEAVY MET	OIL & GREASE	PC BEAR (HT)	OTHER	REMARKS
267 07035		Credit Auto world 2345 E 14th												
SAMPLER NAME, ADDRESS AND TELEPHONE NUMBER														
Lee Hickins 2921 WHIFFLE ROAD, UNION CITY, CA 94507 (415) 429-0089														
ID NO.	DATE	TIME	SOIL	WATER	SAMPLING LOCATION									
STK7-1	7/3	1611	X		3.0	Bress	X	X						Composite into 1 sample
STK7-2	7/3	1610	L		3.0		X	L						
STK7-3	7/3	1609	L		3.0		X	L						
STK7-4	7/3	1606	L		3.6		X	X						
STK8-1	7/3	1611	X		2.0		X	X						
STK8-2	7/3	1612	L		2.0		X	X						
STK8-3	7/3	1614	X		2.0		X	X					Composite into 1 sample	
STK8-4	7/3	1616	L		2.0		X	X						
Relinquished by: (Signature)		Date / Time		Received by: (Signature)		Relinquished by: (Signature)		Date / Time		Received by: (Signature)				
<i>Lee Hickins</i>		7/5/95 19:51												
Relinquished by: (Signature)		Date / Time		Received by: (Signature)		Relinquished by: (Signature)		Date / Time		Received by: (Signature)				
Relinquished by: (Signature)		Date / Time		Received for Laboratory by: (Signature)		Date / Time		Remarks						
				<i>Scott T. ...</i>		7/5/95 19:51								

Plus, soil, 1-BT each, on 14, V-9, S-Dap

DATE: \_\_\_\_\_



# 5658



## TANK PROTECT ENGINEERING

2021 WHIPPLE ROAD  
UNION CITY, CA 94587  
(415) 429-8000  
(800) 513-8000  
FAX (415) 429-8009

LAB: TAL

TURNAROUND: 5 day

P.O. #: 1077

PAGE 2 OF 2

### CHAIN OF CUSTODY

PROJECT NO.		SITE NAME & ADDRESS				(1) TYPE OF CONTAINER	ANALYTES REQUESTED							REMARKS
26707035		Credit Au bworld 2345 E 14th Street					TOTAL LIQUID HC	AROMATIC HC	TOTAL BENTH HC	OLEF & GREASE	PCB BLEN (2010)	OTHER		
SAMPLER NAME, ADDRESS AND TELEPHONE NUMBER														
Lee Hudkins 2021 WHIPPLE ROAD, UNION CITY, CA 94587 (415) 429-8000														
ID NO.	DATE	TIME	SOIL	WATER	SAMPLING LOCATION									
5TK9-1	7/3	1619	K		20	BRASS	+	+					} Composite into 1 sample	
5TK9-2	7/3	1621	L		20	BRASS	+	+						
5TK9-3	7/3	1623	V		20	BRASS	+	+						
5TK9-4	7/3	1625	L		20	BRASS	+	+						
VS-6	4/30	1319	L		21'	BRASS	+	+						
VS-7	4/30	1320	L		14	BRASS	+	+						
Relinquished by: (Signature)		Date / Time		Received by: (Signature)		Relinquished by: (Signature)		Date / Time		Received by: (Signature)				
<i>Lee Hudkins</i>		7/5/95 9:57 AM												
Relinquished by: (Signature)		Date / Time		Received by: (Signature)		Relinquished by: (Signature)		Date / Time		Received by: (Signature)				
Relinquished by: (Signature)		Date / Time		Received for Laboratory by: (Signature)		Date / Time		Remarks						
				<i>Lee Hudkins</i>		7/5/95 9:57 AM								

DATE: \_\_\_\_\_

07/13/1995 10:07 5104298089 TANK PROTECT ENG PAGE 09

TRAKE ANALYSIS 210106/0102 09:21 58/21/00