

- EXPLANATION**
- Northern area excavation boundary completed by Levine-Fricke
  - A Excavation completed by Aqua Resources, Inc.
  - ⊗ Abandoned shallow monitoring wells installed by Aqua Resources, Inc.
  - Shallow monitoring well location
  - 12.22 Ground-water elevation (feet)
  - ~12 Ground-water elevation contour (feet); (dashed where inferred)

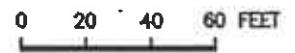

**Figure 2A:**  
**SHALLOW GROUND-WATER ELEVATION**  
**CONTOUR MAP, MAY 14, 1992**  
**FORMER RANSOME COMPANY PROPERTY**

Project No. 1649.07

**LEVINE•FRICKE**  
 ENGINEERS, HYDROGEOLOGISTS & APPLIED SCIENTISTS

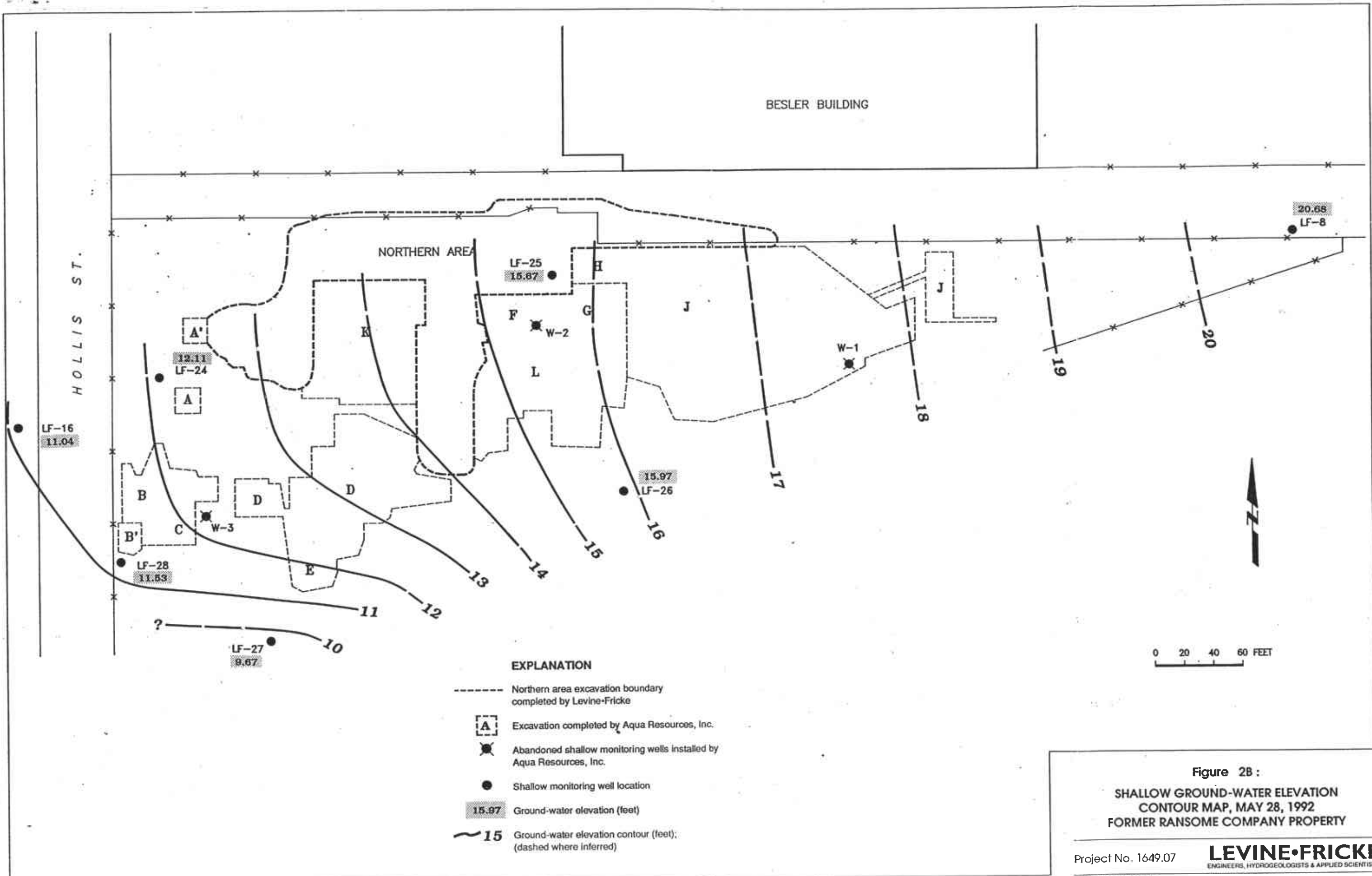

Figure 2B:  
 SHALLOW GROUND-WATER ELEVATION  
 CONTOUR MAP, MAY 28, 1992  
 FORMER RANSOME COMPANY PROPERTY

Project No. 1649.07 **LEVINE-FRICKE**  
 ENGINEERS, HYDROGEOLOGISTS & APPLIED SCIENTISTS  
 WEM05JUN92MP

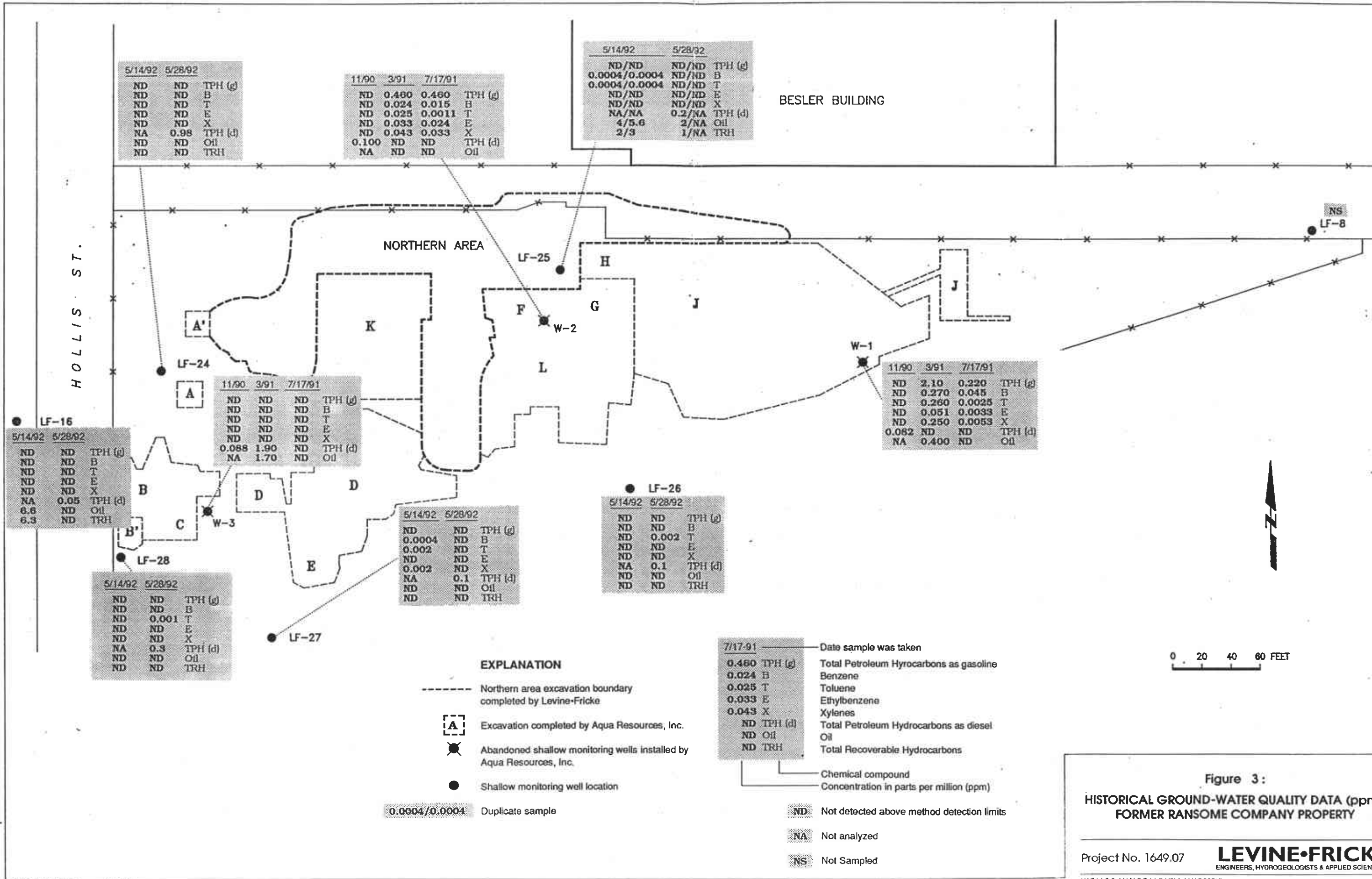

Figure 3:  
**HISTORICAL GROUND-WATER QUALITY DATA (ppm)**  
**FORMER RANSOME COMPANY PROPERTY**

Project No. 1649.07

**LEVINE-FRICKI**  
 ENGINEERS, HYDROGEOLOGISTS & APPLIED SCIENTISTS

W E M 0 8 J U N 9 2 M P / J S M 4 A U G 9 2 R Y L