

# LOWNEY ASSOCIATES

Environmental / Geotechnical / Engineering Services

2150 Rheem Drive, Suite E  
Pleasanton, California 94588-2689  
PHONE (510) 462-7808 FAX (510) 462-8346

405 Clyde Avenue  
Mountain View, California 94043  
PHONE (415) 967-2365 FAX (415) 967-2785

129 Filbert St.  
Oakland, California 94607  
PHONE (510) 267-1970 FAX (510) 267-1972

#39 LS

<b>FAX</b>  <b>TRANSMITTAL</b>	<b>To:</b>	MR. KEVIN TINSLEY ALAMEDA COUNTY ENVIRONMENTAL HEALTH SERVICES ENVIRONMENTAL PROTECTION DIVISION		
	<b>FROM:</b>	PETER LANGTRY	<b>DATE:</b>	JUNE 23, 1997
	<b>PROJECT NUMBER:</b>		<b>FAX No.:</b>	510-337- <del>8877</del> 9535
	<b>PROJECT NAME:</b>	726 HARRISON STREET	<b>PAGES:</b>	2
	<b>CC:</b>	94607	<b>FAX No.</b>	

Kevin, attached is a site plan showing the proposed boring location at 726 Harrison Street in Oakland. I have also shown the locations of ground water monitoring wells MW-7 and MW-8, which were installed for the investigation at 800 Harrison Street, and well MW-4, which was installed for the investigation at 706 Harrison Street. The most recent analytical results and ground water flow direction are also shown. With the existing data, I believe that one exploratory boring will provide a sufficient amount of data since we already have analytical information for the up-gradient and down-gradient property boundaries.

We are currently scheduled to perform the drilling on July 3. I will call you this week to discuss the proposed boring location

Thank you,

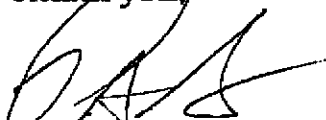

Peter Langtry

Mail Copy to Follow-Yes\_\_\_; No   
Please notify us immediately if you have received this fax in error.

Time Sent \_\_\_\_\_  
Sender's Initials \_\_\_\_\_

TPHg ND  
Benzene ND  
MTBE 3,400

8th Street

MW-7

MW-8

TPHg 72 ppb  
Benzene 1.0 ppb  
MTBE 140 ppb

Property Boundary

Overexcavation  
to depth of approx. 20 feet  
below ground surface

Ground Water  
Flow

Property Boundary

Property Boundary

Harrison Street

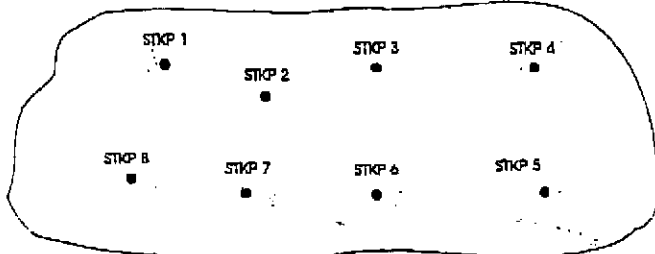
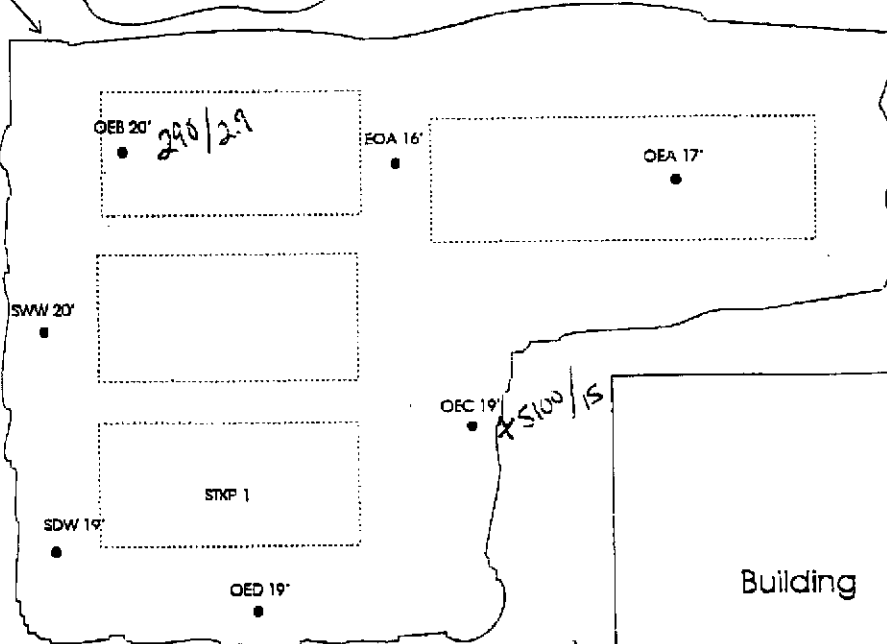

MW-4 - TPHg 3,300 ppb  
Benzene 520 ppb

Property Boundary

