

Detterman, Mark, Env. Health

From: Detterman, Mark, Env. Health
Sent: Tuesday, November 29, 2011 3:27 PM
To: 'Paul Parmentier'
Cc: 'Kaplan, Scott'; 'Murray, Dave'; 'Kristene Tidwell'
Subject: RE: Paco Pump Groundwater sampling RO 000302

Paul,
Thanks for the email and status update. While I understand the interest in limiting the costs associated with a groundwater monitoring event, I also believe a site wide sampling event will be very useful since some of the wells proposed for gauging only haven't been sampled in a year or more since the DPE event; thus the event should include all of the wells. I'm also hopeful that with the data we could limit the number of wells; converting some to semi-annual or annual intervals thereafter.
Best,

Mark Detterman
Senior Hazardous Materials Specialist, PG, CEG
Alameda County Environmental Health
1131 Harbor Bay Parkway
Alameda, CA 94502
Direct: 510.567.6876
Fax: 510.337.9335
Email: mark.detterman@acgov.org

PDF copies of case files can be downloaded at:

<http://www.acgov.org/aceh/lop/ust.htm>

From: Paul Parmentier [<mailto:pparmentier@thesourcegroup.net>]
Sent: Monday, November 28, 2011 9:30 AM
To: Detterman, Mark, Env. Health
Cc: 'Kaplan, Scott'; 'Murray, Dave'; 'Kristene Tidwell'
Subject: Paco Pump Groundwater sampling RO 000302

Re: RO 000302

Dear Mr. Detterman

We received your letter of November 1, 2011 regarding the former Paco Pump site, and we will be addressing your comments and requests following the schedule outlined in that letter.

In the meantime, we are scheduling the second semi-annual groundwater sampling at the site and we are proposing to add a limited number of the wells drilled as extraction wells to the set of wells to be sampled. A total of 22 wells, including the 12 wells installed as extraction points are located in area 100 feet by 60 feet and sampling all of the wells would provide redundant data. We, therefore, propose to sample the wells as described on the attached summary table.

In addition to the monitoring wells previously sampled semi-annually, we would add wells E-3, E-6, E-10 and E-12 to the sampling (See attached figure). Wells E-1, E-4, E-5, E-9, and E-11 would not be considered as critical to understanding site conditions and are proposed to be gauged, but not sampled.

Tentatively, the sampling is scheduled for December 16th, and therefore we would appreciate your concurrence to this approach by December 9th.

Paul Parmentier, CHG
562 / 597.1055 ext. 106

Principal Hydrogeologist

The Source Group, Inc.

Environmental Engineering, Hydrogeologic & Management

1962 Freeman Ave

Signal Hill, CA 90755

Cell: 714.519.1218

www.thesourcegroup.net

The materials transmitted by this electronic mail are confidential, are only for the use of the intended recipient, and may also be subject to applicable privileges. Any dissemination, distribution, or copying of this communication is strictly prohibited. If you have received this communication in error, please immediately notify the sender. Please also remove this message from your hard drive, diskette, and any other storage device.



Reduce, Reuse, Recycle.

PROPOSED 2011 GROUNDWATER SAMPLING/MONITORING

County Reference: RO-000320

Location: Paco Pumps
9201 San Leandro Street

City: Oakland

Well ID	Gauging Sampling Frequency Qtr 2 2011	Proposed Gauging Sampling Frequency Qtr 4 2011	Comments
Area 1 Monitoring Wells			
MW-2	GPS	GPS	
Area 2 Monitoring Wells			
MW-5	G	G	Consistently ND
Area 3 Monitoring Wells			
MW-1	G	G	Consistently ND
Area 4 Monitoring Wells			
MW-3	GPS	GPS	
MW-4	GPS	GPS	
MW-6	GPS	GPS	
MW-7	GPS	GPS	
MW-8	GPS	GPS	
AS-1S	G	G	within 20 feet of E-10 and MW-3
ASMW-2S	G	G	within 20 feet of E-10
AS-1D	G	G	Consistently ND
ASMW-2D	G	G	Consistently ND
E-1	G	G	withing 15 feet of MW-3
E-2	GPS	GPS	
E-3	G	GPS	
E-4	G	G	Between E 12 and MW-6
E-5	G	G	surrounding E-2, E-3, and E-6
E-6	G	GPS	
E-7	GPS	GPS	
E-8	GPS	GPS	
E-9	G	G	surrounded by E-8 and E-10
E-10	G	GPS	
E-11	G	G	within 20 feet of E-10
E-12	G	GPS	
Total	24	24	

NOTES

G,P,S* = Gauge, purge, sar

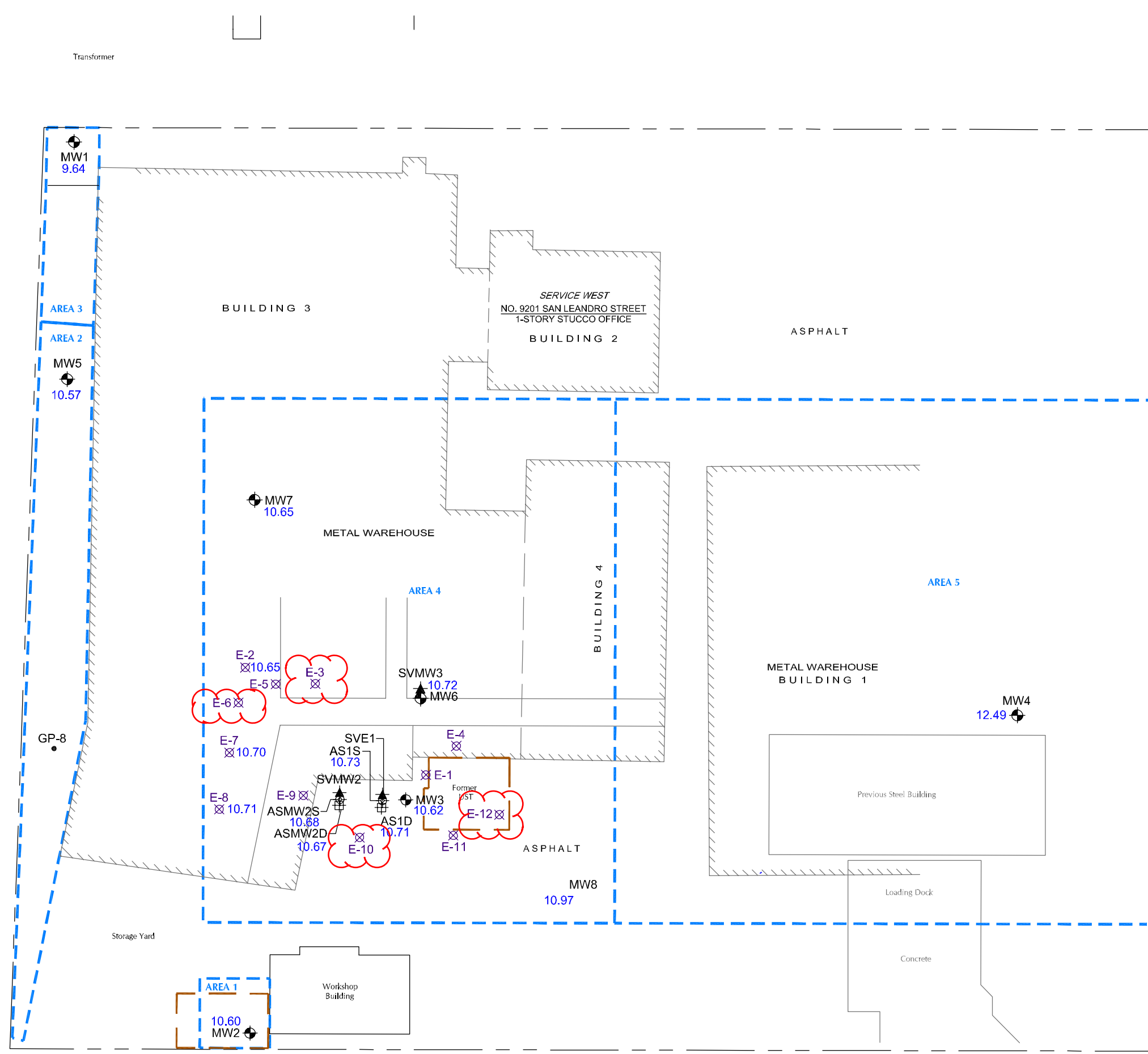

LEGEND

- Site Boundary
- Project areas of concern
- Groundwater contours June 8, 2011.
- Deep groundwater air injection or air injection monitoring well by LFR January 2009
- Shallow groundwater air injection or air injection monitoring well LFR January 2009
- Vadose well by LFR January 2009
- Groundwater monitoring well
- Membrane interface probe by LFR January 2009
- Grab groundwater sample location by LFR January 2009
- Area of excavation
- Groundwater elevation measured June 8, 2011
- Not Measured
- Groundwater elevation in deeper well not used in contour

Existing Semi-Annual Groundwater Monitoring Wells

Proposed Additional Semi-Annual Groundwater Monitoring Wells

0 40 80

 APPROXIMATE SCALE IN FEET

DATE: 06/2011	FILE NAME: PCC-Q2-11.DWG	SOURCE: LFR, MAY 2009
------------------	-----------------------------	--------------------------

Proposed Additional GW Monitoring Wells

9201 SAN LEANDRO STREET
OAKLAND, CALIFORNIA