



RIEDEL ENVIRONMENTAL SERVICES INC.

17 March 1994

ALCO
HAZMAT

94 MAR 22 PM 1:31

California/Western Region:
4138 Lakeside Drive
Richmond, California 94806
(510) 222-7810
FAX: (510) 222-6868

Alameda County Department of Environmental Health
Attn: Ms. Jennifer Eberle
80 Swan Way, Rm.350
Oakland, California 94621

Subject: **Addendum: Work Plan - Monitoring Well Installation**
505 Cedar Street, Oakland, California
RES Project No. 4043

Dear Ms. Eberle:

Riedel Environmental Services, Inc. recently produced a work plan detailing the installation of monitoring wells for the Cal East site located at 505 Cedar Streets in Oakland, California. The scope of work includes advancing three soil borings to a depth of approximately 30 feet, installing a ground water monitoring well in each, and the collection of soil and ground water samples for laboratory analysis, and preparation of a report documenting the installation and sampling.

This letter is provided to document the changes requested as per our conversation of 16 March 1994. Under section 4.1 of the work plan the EPA analysis should read "BTEX and halogenated organics by EPA method 8240." With respect to the placement of the monitoring well MW1, it shall be emplaced outside of the former tank pit in such a way as to surround the former excavation (see Figure 1). A minimum of 72 hours will be allowed for between development of the wells and sampling.

inst. +

If you have any questions, please contact Chris Merritt at (510) 222-7810.

Sincerely,

RIEDEL ENVIRONMENTAL SERVICES, INC.

CHRIS MERRITT

Chris Merritt
Geologist

Christopher B. White

Christopher B. White
Senior Geologist
R.G. 4983



Job No: 4043
CAD File: Draw3-94\CTCoIES3

Drawn:
Date:

C. Barton
/25/94

Checked:
Approved:

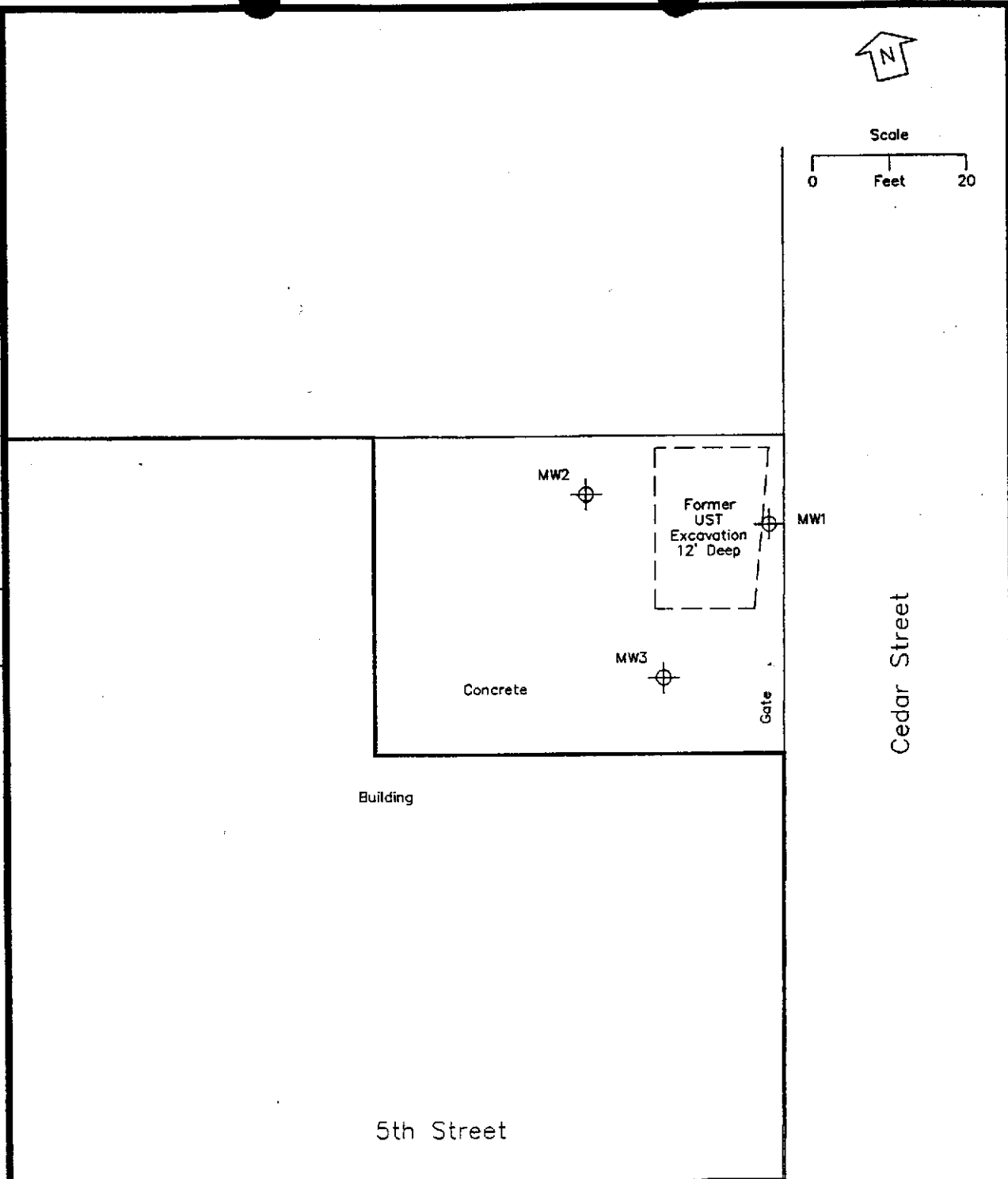
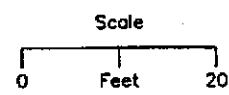

Proposed Monitoring Well
Location Map
CalTrans/Cal-East Foods
Cypress Construction Office
Oakland, CA



RIEDEL ENVIRONMENTAL SERVICES, INC RICHMOND, CALIFORNIA

FIGURE
1