

✓ R0306 (505 Cedar St.)
No data for 727 Pine



Department of Toxic Substances Control



Alan C. Lloyd, Ph.D.
Agency Secretary
Cal/EPA

Maureen F. Gorsen, Director
700 Heinz Avenue, Suite 200
Berkeley, California 94710-2721

Arnold Schwarzenegger
Governor

April 3, 2006

Environmental Health

APR 06 2006

Director's Office

Mr. Rafat A. Shahid
Alameda County Department of Environmental Health
1131 Harbor Bay Parkway
Alameda, California 94502-6577

Mr. Leroy Griffin
Oakland Fire Department
Office of Emergency Service
Hazardous Materials Unit
1605 Martin Luther King Jr. Way
Oakland, California 94612

Dear Mr. Shahid and Mr. Griffin:

The Department of Toxic Substances Control (DTSC) would like to acquire copies of closure reports, if the cases have been closed, for two properties in the City of Oakland, the Cal-East Foods property, located at 505 Cedar Street, and the Old Oakland Fire House #3, located at 727 Pine Street. DTSC understands that either the Alameda County Department of Environmental Health or the Oakland Fire Department Hazardous Material Unit supervised the removal of underground storage tanks and contaminated soil from these two properties in or about 1993; these properties are within the Cypress Freeway Reconstruction Project.

DTSC is attempting to close out these projects and final resolution of the underground tank cleanup is a data gap we need to fill. Please identify who in your staff is most knowledgeable about these sites and notify us if you have any documents regarding the above sites. We would like to acquire copies of that information. Jacinto Soto of my staff will be contacting you individually to determine who he should be working with. We need to close out these two sites by early June 2006.

Please contact Jacinto Soto of my staff at (510) 540-3842.

Sincerely,

Mark E. Piro

for Barbara J. Cook, P.E., Chief
Northern California
Coastal Cleanup Operations Branch



Department of Toxic Substances Control

Closest site
525 Cedar
R# 306



Edwin F. Lowry, Director
700 Heinz Avenue, Suite 200
Berkeley, California 94710-2721

Winston H. Hickox
Agency Secretary
California Environmental
Protection Agency

Gray Davis
Governor

July 31, 2003

Alameda County

AUG 08 2003

Environmental Health

Mr. Raymond Pang
Caltrans
P.O. Box 23660
Oakland, California 94623-0660

Dear Mr. Pang:

The Department of Toxic Substances Control (DTSC) received the Draft Site Investigation Report for the Phoenix 524 Property, 524 Cedar Street, Cypress Reconstruction Project, Oakland, California. The report, dated July 7, 2003, was prepared by Shaw Environmental, Inc. on behalf of Caltrans. DTSC has reviewed the report and has the following comments:

1. Page ES-2, Executive Summary and Section 4.0, Data Evaluation: The report compares the analytical results to the Regional Water Quality Control Board, San Francisco Bay Region's Risk-Based Screening Levels (RBSLs). Until the current review of the RBSLs has been completed, the screening values should not be used. Specific Cypress Freeway remediation goals were developed and the data should be compared to these values.
2. Page 2-4, Section 2.3, Investigation-Derived Waste Disposal: This section states that the drums were stored at the Former Hall Property located at 2601 Wood Street; however, the "Event Summary" found in Appendix F states that a drum of purge water was "left on a wooden pallet at the Thomas Short site." Please clarify where the investigation-derived waste was stored.
3. Appendix D, Soil Laboratory Analytical Reports and Chain-Of-Custody Forms: A spot check of the laboratory data sheets indicates that the RPD was out of limits for barium and zinc for QC Batch ICPP4383. The Spike %Recovery and Spike Dup %Recovery for mercury (QC Batch DIG 1429) also were outside of the acceptable recovery and RPD limits. The report needs to discuss what affect the QC data has on the quality of the analytical data.

The energy challenge facing California is real. Every Californian needs to take immediate action to reduce energy consumption. For a list of simple ways you can reduce demand and cut your energy costs, see our Web-site at www.dtsc.ca.gov.

Mr. Raymond Pang
July 31, 2003
Page 2

If you have any questions please contact Lynn Nakashima of my staff at
(510) 540-3839.

Sincerely,

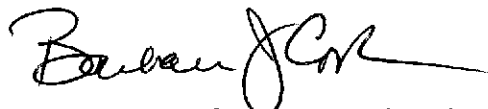

Barbara J. Cook, P.E., Chief
Northern California - Coastal Cleanup
Operations Branch

cc: Ms. Betty Graham
Regional Water Quality Control Board
San Francisco Bay Region
1515 Clay Street, Suite 1400
Oakland, California 94612

✓ Mr. Barney Chan
Alameda County Health Agency
Department of Environmental Health
1131 Harbor Bay Parkway
Alameda, California 94502

Mr. Christopher Wilson
Caltrans - Environmental Engineering
P.O. Box 23660
Oakland, California 94623-0660

ALAMEDA COUNTY
HEALTH CARE SERVICES
AGENCY

DAVID J. KEARS, Agency Director



RAFAT A. SHAHID, DIRECTOR

September 18, 1995
STID# 3971

Mr. Christopher Wilson
Department of Transportation
Box 23660
Oakland, California 94623-0660

DEPARTMENT OF ENVIRONMENTAL HEALTH
State Water Resources Control Board
Division of Clean Water Programs
UST Local Oversight Program
1131 Harbor Bay Parkway
Alameda, CA 94502-6577
(510) 567-6700

**RE: Groundwater Monitoring Program
Former Cal East Foods - 505 Cedar Street, Oakland, CA 94607**

Dear Mr. Wilson:

The Alameda County Department of Environmental Health, Environmental Protection Division has completed review of the case file including the Quarterly Groundwater Monitoring Report (April 1995) prepared by Environmental Solutions, Inc. for the referenced site.

Based on the review of all the historical data submitted for the subject site, this office recommends the following groundwater monitoring program:

- 1) The three groundwater monitoring wells MW -1, MW-2, and MW-3, shall be sampled every quarter for one year, if possible starting with the month of October 1995, followed by sampling events in January 1996, April 1996, July 1996 and October 1996.
- 2) Groundwater level measurements shall be collected every sampling event and groundwater flow direction must be established for the site.
- 3) Groundwater samples shall be analyzed for TPH gasoline, BTEX, chlorinated solvents and for methyl tertiary butyl ether (MTBE).
- 4) Following the last scheduled sampling event (October, 1996), the data collected for the site will be evaluated and case closure will be recommended if appropriate (depending on the concentration of contaminants found at the subject site).
- 5) Please submit copies of the quarterly groundwater monitoring reports for the sampling events conducted on October 27, 1994 and January 19, 1995. These reports are missing from the file.
- 6) Please notify this office 72 hours in advance of any field activity at the site.

A report must be submitted to this agency within 45 days after completion of any phase of this investigation. Until clean up is complete, you will need to submit reports to this office every three months or at a more frequent interval, if specified at any

Mr. Christopher Wilson
RE: 505 Cedar Street, Oakland, CA 94607
September 18, 1995
Page 2 of 2

time. In addition, the following items must be incorporated in your future reports or work plans:

- a cover letter from the responsible party or tank owner stating the accuracy of the report and whether he/she concurs with the conclusions and recommendations in the report or work plan
- site map delineating contamination contours for soil and groundwater based on recent data should be included and the status of the investigation and cleanup must be identified
- proposed continuing or next phase of investigation / cleanup activities must be included to inform this department of the responsible party or tank owner's intention
- any changes in the groundwater flow direction and gradient based on the measured data since the last sampling event must be explained
- historical records of groundwater level in each well must be tabulated to indicate the fluctuation in water levels
- tabulate analytical results from all previous sampling events; provide laboratory reports (including quality control/quality assurance) and chain of custody documentation

All reports and proposals must be submitted under seal of a California Registered Geologist or Registered Civil Engineer with a statement of qualifications for each lead professionals involved with the project.

If you have any questions concerning this letter, please call me at (510) 567-6780.

Sincerely,

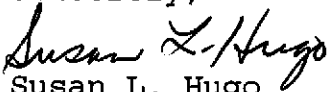

Susan L. Hugo
Senior Hazardous Materials Specialist

cc: Jun Makishima, Interim Director, Environmental Health
George Young, Acting Chief, Environmental Protection ~~Files~~
Kevin Graves, San Francisco Bay RWQCB
Lynn Nakashima, DTSC Region 2, 700 Heinz Avenue, Suite 200
Berkeley, California 94710-2737

**ALAMEDA COUNTY
HEALTH CARE SERVICES
AGENCY**

DAVID J. KEARS, Agency Director



RAFAT A. SHAHID, ASST. AGENCY DIRECTOR

March 22, 1994
STID 3971

Kate Pargett
CalTrans
1121-7th St.
Oakland CA 94607

RE: CalEast Foods site
505 Cedar St.
Oakland CA 94607

DEPARTMENT OF ENVIRONMENTAL HEALTH
State Water Resources Control Board
Division of Clean Water Programs
UST Local Oversight Program
80 Swan Way, Rm 200
Oakland, CA 94621
(510) 271-4530

Dear Ms. Pargett,

We have received the 1/21/94 Tank Removal Report, the 3/1/94 Work Plan for Monitoring Well Installation, and the 3/17/94 Addendum to the Work Plan, all prepared by Riedel Environmental Services Inc. As you know, the Work Plan and the Addendum propose 3 monitoring wells surrounding the former UST excavation, in a triangulated fashion. This work plan and its addendum are acceptable on the condition that a minimum of 72 hours be allowed between well installation and development, and a minimum of 24 hours be allowed between well development and sampling.

Kindly submit a cover letter with your consultant's reports. If you have any questions, please contact me at 510-271-4530.

Please notify me at least 2 business days in advance of field activities so that I may arrange to be onsite.

Sincerely,

A handwritten signature in cursive script, appearing to read 'Jennifer Eberle'.

Jennifer Eberle
Hazardous Materials Specialist

cc: Mark Williams, Riedel Environmental Services, 4138 Lakeside
Dr., Richmond CA 94806
Ed Howell/file

je

ALAMEDA COUNTY
HEALTH CARE SERVICES
AGENCY

DAVID J. KEARS, Agency Director



RAFAT A. SHAHID, ASST. AGENCY DIRECTOR

January 10, 1994
STID 3971

Kate Pargett
CalTrans
1121-7th St.
Oakland CA 94607

DEPARTMENT OF ENVIRONMENTAL HEALTH
State Water Resources Control Board
Division of Clean Water Programs
UST Local Oversight Program
80 Swan Way, Rm 200
Oakland, CA 94621
(510) 271-4530

RE: CalEast Foods site
505 Cedar St.
Oakland CA 94607

Dear Ms. Pargett,

We have received your faxes dated 1/5/94 and 1/10/94. These faxes contain laboratory reports for the soil and groundwater sampling conducted on 11/23/93 for the above referenced site. Contaminated soil was removed down to maximum concentrations of 45 ppm TPH-g and 0.320 ppm benzene. As per our telephone conversation of today, you indicated that the excavation has already been backfilled because the fence was broken into.

Groundwater contained 31,000 ppb TPH-g and 6,300 ppb benzene after being sampled on 11/23/93. The water was subsequently vacuumed out. Please provide a copy of the manifest for this with the tank removal report. The tank removal report is due to this office within 60 days from the date of tank removal, as per the "Underground Tank Closure Plan." Please submit the tank removal report **within 30 days or by February 10, 1994.**

In addition, a subsurface investigation must ensue to determine the impact to groundwater.

Therefore, we request a workplan or proposal for a groundwater investigation, **within 45 days or by February 25, 1994**, submitted under cover letter from yourself, and prepared by a recognized professional as outlined below. The groundwater investigation should consist of a minimum of three monitoring wells in an equilateral triangular configuration to determine groundwater flow direction and to assess groundwater quality.

All work should adhere to a) the Tri-Regional Board Staff Recommendations for Preliminary Evaluation and Investigation of Underground Tank Sites, dated 8/10/90; and b) Article 11 of Title 23, California Code of Regulations. Reports and proposals must be submitted **under seal** of a California-Registered Geologist, - Certified Engineering Geologist, or -Registered Civil Engineer.

January 10, 1994
STID 3971
Kate Pargett
page 2 of 2

Kindly submit a cover letter with your consultant's reports. If you have any questions, please contact me at 510-271-4530.

Please notify me at least 2 business days in advance of field activities so that I may arrange to be onsite.

Sincerely,



Jennifer Eberle
Hazardous Materials Specialist

cc: Mark Williams, Riedel Environmental Services, 4138 Lakeside
Dr., Richmond CA 94806
Ed Howell/file

je

ALAMEDA COUNTY, DEPARTMENT OF ENVIRONMENTAL HEALTH

80 Swan Way, #200
Oakland, CA 94621
(415) 271-4320

Hazardous Materials Division Inspection Form

Site ID# _____ Site Name Cal East Foods Today's Date 11/23/93
 Site Address 505 Cedar St. EPA ID# _____
 City Oakland Zip 94607 Phone _____

MAX Amt. Stored > 500lbs/55g/200cf? Y N
 Hazardous Waste generated per month? _____

Inspection Categories:

- I. Haz. Mat/Waste GENERATOR/TRANSPORTER
- II. Business Plans, Acute Hazardous Materials
- III. Underground Tanks

The marked items represent violations of the Calif. Administration Code (CAC) or the Health & Safety Code (HS&C)

I.A. GENERATOR (Title 22)

11:30

Arrived onsite.
Comments:

- | | | |
|-------|-----------------------------|---------|
| ___ | 1. Waste ID | * 66471 |
| ___ | 2. EPA ID | 66472 |
| ___ | 3. > 90 days | 66508 |
| ___ | 4. Label dates | 66508 |
| ___ | 5. Biennial | 66493 |
| <hr/> | | |
| ___ | 6. Records | 66492 |
| ___ | 7. Correct | 66484 |
| ___ | 8. Copy sent | 66492 |
| ___ | 9. Exception | 66484 |
| ___ | 10. Copies Rec'd | 66492 |
| <hr/> | | |
| ___ | 11. Treatment | 66371 |
| ___ | 12. On-site Disp. (H.S.&C.) | 26189.5 |
| ___ | 13. Ex Haz. Waste | 66570 |
| <hr/> | | |
| ___ | 14. Communications | 67121 |
| ___ | 15. Aisle Space | 67124 |
| ___ | 16. Local Authority | 67126 |
| ___ | 17. Maintenance | 67120 |
| ___ | 18. Training | 67105 |
| <hr/> | | |
| ___ | 19. Prepared | 67140 |
| ___ | 20. Name List | 67141 |
| ___ | 21. Copies | 67141 |
| ___ | 22. Emg. Coord. Trng. | 67144 |
| <hr/> | | |
| ___ | 23. Condition | 67241 |
| ___ | 24. Compatibility | 67242 |
| ___ | 25. Maintenance | 67243 |
| ___ | 26. Inspection | 67244 |
| ___ | 27. Buffer Zone | 67246 |
| ___ | 28. Tank Inspection | 67259 |
| ___ | 29. Containment | 67245 |
| ___ | 30. Safe Storage | 67261 |
| ___ | 31. Freeboard | 67257 |

Pit has water, which was sampled prior to my arrival (GWI) Approx. 1500 gal pit water was subsequently vacuumed out. Pit has been overexcavated to 12' bgs, ~~the~~ which is the depth we originally thought we ~~we~~ took bottom samples at during tank removal on 11-18.
 Took 2 bottom samples (moist, due to gw), + 4 sidewall samples (see attached map).
 The stockpile is now ~ 170 yd³ in size. It will be sampled.

12:25 left site

I.B. TRANSPORTER (Title 22)

- | | | |
|-------|---------------------------|-------|
| ___ | 32. Applic./Insurance | 66428 |
| ___ | 33. Comp. Cert./CHP Insp. | 66448 |
| ___ | 34. Containers | 66465 |
| <hr/> | | |
| ___ | 35. Vehicles | 66465 |
| ___ | 36. EPA ID #s | 66531 |
| ___ | 37. Correct | 66541 |
| ___ | 38. HW Delivery | 66543 |
| ___ | 39. Records | 66544 |
| <hr/> | | |
| ___ | 40. Name/ Covers | 66545 |
| ___ | 41. Recyclables | 66800 |

"Imagining A Better World"

24 HOUR SERVICE



RIEDEL ENVIRONMENTAL SERVICES INC.

MARK WILLIAMS
UST Project Manager

California/Western Region
4138 Lakeside Dr., Richmond, California 94806
(415) 222-7810 1-800-334-0004 Fax (415) 222-6868

Rev 6/88

Contact: Caltrans
 Title: Transportation Engineer
 Signature: [Signature]
 Inspector: Jennifer Eberle
 Signature: [Signature]
 *fix camera

Job No: 4280-9324
 CAD File: Draw193\CTCalIES1

Checked: []
 Approved: []

Drawn: []
 Date: []

11-23-93
 samples

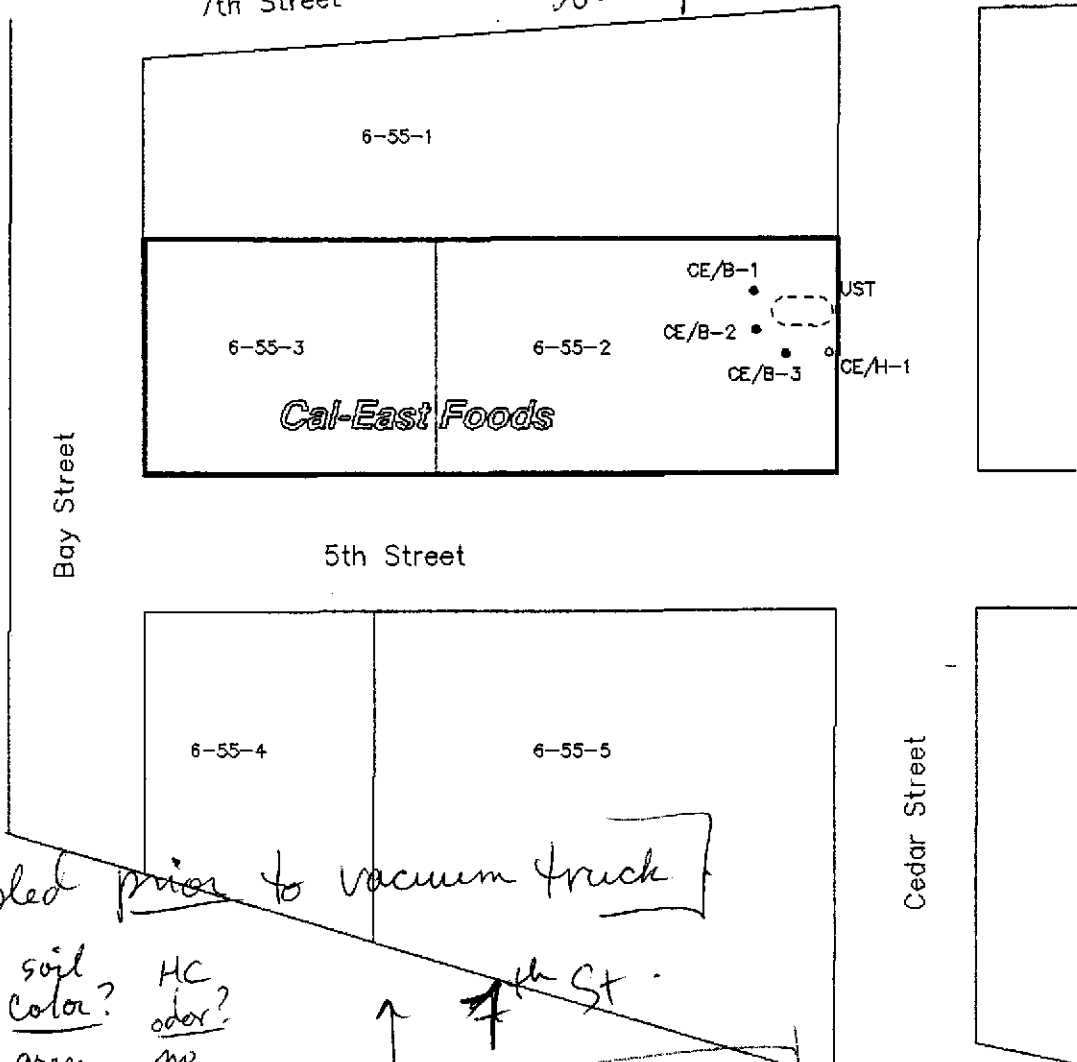

FW also

sampld prior to vacuum truck

	soil color?	HC odor?
EX1A	~12' green	no
EX2A	~12' brown	no
SW1A	~8' green	yes
SW2A	~8' green/brown	yes
SW3A	~8' green/brown	no
SW4A	~8' gr/bn	yes

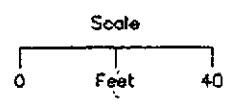
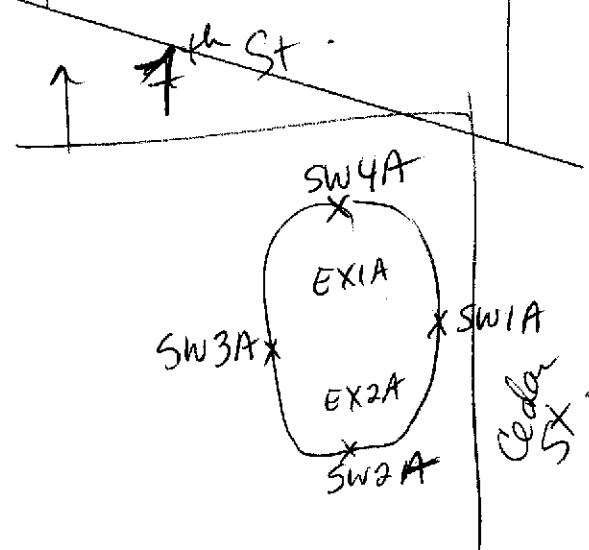

↓ 5th

Site Map
 CalTrans/Cal-East Foods
 Cypress Construction Office
 Oakland, CA



RIEDEL ENVIRONMENTAL SERVICES, INC RICHMOND, CALIFORNIA

FIGURE 1

JR skid 3921

UNDERGROUND STORAGE TANK UNAUTHORIZED RELEASE (LEAK) / CONTAMINATION SITE REPORT

EMERGENCY <input type="checkbox"/> YES <input checked="" type="checkbox"/> NO	HAS STATE OFFICE OF EMERGENCY SERVICES REPORT BEEN FILED? <input type="checkbox"/> YES <input type="checkbox"/> NO	FOR LOCAL AGENCY USE ONLY I HEREBY CERTIFY THAT I HAVE DISTRIBUTED THIS INFORMATION ACCORDING TO THE DISTRIBUTION SHOWN ON THE INSTRUCTION SHEET ON THE BACK PAGE OF THIS FORM SIGNED: <u>Kim M. [Signature]</u> DATE: <u>12/13/93</u>
REPORT DATE <u>1</u> M <u>1</u> D <u>2</u> 9 <u>3</u> Y	CASE #	

REPORTED BY	NAME OF INDIVIDUAL FILING REPORT KATHLEEN R. PARGETT	PHONE (510) 286-0709	SIGNATURE Kathleen R Pargett
	REPRESENTING <input type="checkbox"/> OWNER/OPERATOR <input type="checkbox"/> REGIONAL BOARD <input type="checkbox"/> LOCAL AGENCY <input checked="" type="checkbox"/> OTHER <u>Caltrans</u>	COMPANY OR AGENCY NAME CALIF. DEPT. OF TRANSPORTATION	
	ADDRESS 1121 7TH STREET, 2ND FLOOR, OAKLAND CA 94607		

RESPONSIBLE PARTY	NAME CALTRANS <input checked="" type="checkbox"/> UNKNOWN	CONTACT PERSON Tim Mehta	PHONE (510) 286-6269
	ADDRESS 111 Grand Ave PO Box 23660, Oakland CA 94623-0660		

SITE LOCATION	FACILITY NAME (IF APPLICABLE) CAL EAST SEAFOODS	OPERATOR	PHONE ()
	ADDRESS 505 Cedar St, Oakland CA 94607		
	CROSS STREET 5th Street		

IMPLEMENTING AGENCIES	LOCAL AGENCY Alameda Co. Health Care Services	AGENCY NAME	CONTACT PERSON	PHONE ()
	REGIONAL BOARD Region 2 WQCB			PHONE ()

SUBSTANCES INVOLVED	(1) NAME	QUANTITY LOST (GALLONS) <input checked="" type="checkbox"/> UNKNOWN
	(2)	<input type="checkbox"/> UNKNOWN

DISCOVERY/ABATEMENT	DATE DISCOVERED <u>1</u> M <u>1</u> D <u>8</u> 9 <u>3</u> Y	HOW DISCOVERED <input type="checkbox"/> INVENTORY CONTROL <input type="checkbox"/> SUBSURFACE MONITORING <input type="checkbox"/> NUISANCE CONDITIONS <input type="checkbox"/> TANK TEST <input checked="" type="checkbox"/> TANK REMOVAL <input type="checkbox"/> OTHER
	DATE DISCHARGE BEGAN <input checked="" type="checkbox"/> UNKNOWN	METHOD USED TO STOP DISCHARGE (CHECK ALL THAT APPLY) <input checked="" type="checkbox"/> REMOVE CONTENTS <input checked="" type="checkbox"/> CLOSE TANK & REMOVE <input type="checkbox"/> REPAIR PIPING <input type="checkbox"/> REPAIR TANK <input type="checkbox"/> CLOSE TANK & FILL IN PLACE <input type="checkbox"/> CHANGE PROCEDURE <input type="checkbox"/> REPLACE TANK <input type="checkbox"/> OTHER
	HAS DISCHARGE BEEN STOPPED? <input checked="" type="checkbox"/> YES <input type="checkbox"/> NO IF YES, DATE <u>1</u> M <u>1</u> D <u>8</u> 9 <u>3</u> Y	

SOURCE/CAUSE	SOURCE OF DISCHARGE <input checked="" type="checkbox"/> TANK LEAK <input type="checkbox"/> UNKNOWN <input type="checkbox"/> PIPING LEAK <input type="checkbox"/> OTHER	CAUSE(S) <input type="checkbox"/> OVERFILL <input type="checkbox"/> RUPTURE/FAILURE <input type="checkbox"/> SPILL <input type="checkbox"/> CORROSION <input type="checkbox"/> UNKNOWN <input type="checkbox"/> OTHER
--------------	--	---

CASE TYPE	CHECK ONE ONLY <input checked="" type="checkbox"/> UNDETERMINED <input type="checkbox"/> SOIL ONLY <input type="checkbox"/> GROUNDWATER <input type="checkbox"/> DRINKING WATER - (CHECK ONLY IF WATER WELLS HAVE ACTUALLY BEEN AFFECTED)
-----------	--

CURRENT STATUS	CHECK ONE ONLY <input checked="" type="checkbox"/> NO ACTION TAKEN <input type="checkbox"/> PRELIMINARY SITE ASSESSMENT WORKPLAN SUBMITTED <input type="checkbox"/> POLLUTION CHARACTERIZATION <input type="checkbox"/> LEAK BEING CONFIRMED <input type="checkbox"/> PRELIMINARY SITE ASSESSMENT UNDERWAY <input type="checkbox"/> POST CLEANUP MONITORING IN PROGRESS <input type="checkbox"/> REMEDIATION PLAN <input type="checkbox"/> CASE CLOSED (CLEANUP COMPLETED OR UNNECESSARY) <input type="checkbox"/> CLEANUP UNDERWAY
----------------	--

REMEDIAL ACTION	CHECK APPROPRIATE ACTION(S) (SEE BACK FOR DETAILS) <input type="checkbox"/> CAP SITE (CD) <input type="checkbox"/> EXCAVATE & DISPOSE (ED) <input type="checkbox"/> REMOVE FREE PRODUCT (FP) <input type="checkbox"/> ENHANCED BIO DEGRADATION (IT) <input type="checkbox"/> CONTAINMENT BARRIER (CB) <input type="checkbox"/> EXCAVATE & TREAT (ET) <input type="checkbox"/> PUMP & TREAT GROUNDWATER (GT) <input type="checkbox"/> REPLACE SUPPLY (RS) <input type="checkbox"/> VACUUM EXTRACT (VE) <input type="checkbox"/> NO ACTION REQUIRED (NA) <input type="checkbox"/> TREATMENT AT HOOKUP (HU) <input type="checkbox"/> VENT SOIL (VS) <input type="checkbox"/> OTHER (OT) <u>Not determined</u>
-----------------	--

COMMENTS	
----------	--

INSTRUCTIONS

EMERGENCY

Indicate whether emergency response personnel and equipment were involved at any time. If so, a Hazardous Material Incident Report should be filed with the State Office of Emergency Services (OES) at 2800 Meadowview Road, Sacramento, CA 95832. Copies of the OES report form may be obtained at your local underground storage tank permitting agency. Indicate whether the OES report has been filed as of the date of this report.

LOCAL AGENCY ONLY

To avoid duplicate notification pursuant to Health and Safety code Section 25180.5, a government employee should sign and date the form in this block. A signature here does not mean that the leak has been determined to pose a significant threat to human health or safety, only that notification procedures have been followed if required.

REPORTED BY

Enter your name, telephone number, and address. Indicate which party you represent and provide company or agency name.

RESPONSIBLE PARTY

Enter name, telephone number, contact person, and address of the party responsible for the leak. The responsible party would normally be the tank owner.

SITE LOCATION

Enter information regarding the tank facility. At a minimum, you must provide the facility name and full address.

IMPLEMENTING AGENCIES

Enter names of the local agency and Regional Water Quality Control Board involved.

SUBSTANCES INVOLVED

Enter the name and quantity lost of the hazardous substance involved. Room is provided for information on two substances if appropriate. If more than two substances leaked, list the two of most concern for cleanup.

DISCOVERY/ABATEMENT

Provide information regarding the discovery and abatement of the leak.

SOURCE/CAUSE

Indicate source(s) of leak. Check box(es) indicating cause of leak.

CASE TYPE

Indicate the case type category for this leak. Check one box only. Case type is based on the most sensitive resource affected. For example, if both soil and ground water have been affected, case type will be "Ground Water". Indicate "Drinking Water" only if one or more municipal or domestic water wells have actually been affected. A "Ground Water" designation does not imply that the affected water cannot be, or is not, used for drinking water, but only that water wells have not yet been affected. It is understood that case type may change upon further investigation.

CURRENT STATUS

Indicate the category which best describes the current status of the case. Check one box only. The response should be relative to the case type. For example, if case type is "Ground Water", then "Current Status" should refer to the status of the ground water investigation or cleanup, as opposed to that of soil. Descriptions of options follow:

No Action Taken - No action has been taken by responsible party beyond initial report of leak.

Leak Being Confirmed - Leak suspected at site, but has not been confirmed.

Preliminary Site Assessment Workplan Submitted - workplan/proposal requested of/submitted by responsible party to determine whether ground water has been, or will be, impacted as a result of the release.

Preliminary Site Assessment Underway - implementation of workplan.

Pollution Characterization - responsible party is in the process of fully defining the extent of contamination in soil and ground water and assessing impacts on surface and/or ground water.

Remediation Plan - remediation plan submitted evaluating long term remediation options. Proposal and implementation schedule for appropriate remediation options also submitted.

Cleanup Underway - implementation of remediation plan.

Post Cleanup Monitoring in Progress - periodic ground water or other monitoring at site, as necessary, to verify and/or evaluate effectiveness of remedial activities.

Case Closed - regional board and local agency in concurrence that no further work is necessary at the site.

IMPORTANT: THE INFORMATION PROVIDED ON THIS FORM IS INTENDED FOR GENERAL STATISTICAL PURPOSES ONLY AND IS NOT TO BE CONSTRUED AS REPRESENTING THE OFFICIAL POSITION OF ANY GOVERNMENTAL AGENCY

REMEDIAL ACTION

Indicate which action have been used to cleanup or remediate the leak. Descriptions of options follow:

Cap Site - install horizontal impermeable layer to reduce rainfall infiltration.

Containment Barrier - install vertical dike to block horizontal movement of contaminant.

Excavate and Dispose - remove contaminated soil and dispose in approved site.

Excavate and Treat - remove contaminated soil and treat (includes spreading or land farming).

Remove Free Product - remove floating product from water table.

Pump and Treat Groundwater - generally employed to remove dissolved contaminants.

Enhanced Biodegradation - use of any available technology to promote bacterial decomposition of contaminants.

Replace Supply - provide alternative water supply to affected parties.

Treatment at Hookup - install water treatment devices at each dwelling or other place of use.

Vacuum Extract - use pumps or blowers to draw air through soil.

Vent Soil - bore holes in soil to allow volatilization of contaminants.

No Action Required - incident is minor, requiring no remedial action.

COMMENTS - Use this space to elaborate on any aspects of the incident.

SIGNATURE - Sign the form in the space provided.

DISTRIBUTION

If the form is completed by the tank owner or his agent, retain the last copy and forward the remaining copies intact to your local tank permitting agency for distribution.

1. Original - Local Tank Permitting Agency
2. State Water Resources Control Board, Division of Clean Water Programs, Underground Storage Tank Program, P.O. Box 944212, Sacramento, CA 94244-2120
3. Regional Water Quality Control Board
4. Local Health Officer and County Board of Supervisors or their designee to receive Proposition 65 notifications.
5. Owner/responsible party.

ALAMEDA COUNTY, DEPARTMENT OF ENVIRONMENTAL HEALTH

80 Swan Way, #200
Oakland, CA 94621
(415) 271-4320

Hazardous Materials Division Inspection Form

Site ID# _____ Site Name Cal East Foods Today's Date 11/18/93
 Site Address 505 Cedar St. (bet. 5th & 7th St.) EPA ID# _____
 City Oakland Zip 94607 Phone _____

MAX Amt. Stored > 500lbs/55g/200cf? Y N
 Hazardous Waste generated per month? _____

Inspection Categories:

- I. Haz. Mat/Waste GENERATOR/TRANSPORTER
- II. Business Plans, Acute Hazardous Materials
- III. Underground Tanks removal

The marked items represent violations of the Calif. Administration Code (CAC) or the Health & Safety Code (HS&C)

IA GENERATOR (Title 22)

- | | | |
|-------|-----------------------------|---------|
| ___ | 1. Waste ID | 66471 |
| ___ | 2. EPA ID | 66472 |
| ___ | 3. > 90 days | 66508 |
| ___ | 4. Label dates | 66508 |
| ___ | 5. Biennial | 66493 |
| <hr/> | | |
| ___ | 6. Records | 66492 |
| ___ | 7. Correct | 66484 |
| ___ | 8. Copy sent | 66492 |
| ___ | 9. Exception | 66484 |
| ___ | 10. Copies Rec'd | 66492 |
| <hr/> | | |
| ___ | 11. Treatment | 66371 |
| ___ | 12. On-site Disp. (H.S.&C.) | 26189.5 |
| ___ | 13. Ex Haz. Waste | 66570 |
| <hr/> | | |
| ___ | 14. Communications | 67121 |
| ___ | 15. Aisle Space | 67124 |
| ___ | 16. Local Authority | 67126 |
| ___ | 17. Maintenance | 67120 |
| ___ | 18. Training | 67105 |
| <hr/> | | |
| ___ | 19. Prepared | 67140 |
| ___ | 20. Name List | 67141 |
| ___ | 21. Copies | 67141 |
| ___ | 22. Emg. Coord. Trng. | 67144 |
| <hr/> | | |
| ___ | 23. Condition | 67241 |
| ___ | 24. Compatibility | 67242 |
| ___ | 25. Maintenance | 67243 |
| ___ | 26. Inspection | 67244 |
| ___ | 27. Buffer Zone | 67246 |
| ___ | 28. Tank Inspection | 67259 |
| ___ | 29. Containment | 67245 |
| ___ | 30. Safe Storage | 67261 |
| ___ | 31. Freeboard | 67257 |

9:50 arrived onsite

Comments:

UST is actually ~2500 gal, not 10,000 gal. They removed ~50 gal gasoline on 11-17 under manifest. UST is steel w/tar wrap. Gary Collins of OFD arrived. 50 lbs dry ice has been placed inside UST. There are RR tracks in UST vicinity, which may be responsible for diesel pits detected at 1.5' bgs. (See Aug. 92 GRC report). Erickson onsite to transport UST under manifest #93132324

11:30 Tank removed. Two ^{sizeable} holes discovered on bottom/side edges. UST was sitting in water. UST had some pitting. UST bottom at 10' ~~10'~~ bgs. Emerald green soil, and a significant gasoline odor from the pit.

12:30 2 bottom samples. The S one taken from odorous, discolored soil. (See map) The east wall (along Cedar St.) has a black, oily substance seeping in at ~10' ~~10'~~ bgs. 4 wall samples. (See map). Not enough water in pit to sample; but it has a big sheen or maybe floating product.

IB TRANSPORTER (Title 22)

- | | | |
|-------|---------------------------|-------|
| ___ | 32. Applic./Insurance | 66428 |
| ___ | 33. Comp. Cert./CHP Insp. | 66448 |
| ___ | 34. Containers | 66465 |
| <hr/> | | |
| ___ | 35. Vehicles | 66465 |
| ___ | 36. EPA ID #s | 66531 |
| ___ | 37. Correct | 66541 |
| ___ | 38. HW Delivery | 66543 |
| ___ | 39. Records | 66544 |
| <hr/> | | |
| ___ | 40. Name/ Covers | 66545 |
| ___ | 41. Recyclables | 66900 |

Rev 6/88

Contact: Mark Williams

Title: UST Project mgr

Signature: Mark A. Williams

Inspector: J. Eberle

Signature: J. Eberle

State of California

Department of Transportation
District 4 Construction
1121 7th Street, 2nd Floor
Oakland, CA 94607-2601



Kerry Sandvik
Transportation Engineer

Office (510) 286-0679
FAX (510) 286-0692
CALNET 8-541-0679

"Imagineering A Better World"

24 HOUR SERVICE



**RIEDEL ENVIRONMENTAL
SERVICES INC.**

MARK WILLIAMS
UST Project Manager

California/Western Region
415 Lakeside Dr., Richmond, California 94806
(415) 222-7810 1-800-334-0004 Fax (415) 222-6868



Not letter? ULR?

Job No: 4280-9324
 CAD File: Draw1193\CTCalESI
 Checked: []
 Approved: []
 Drawn: C. Barlow
 Date: 11/17/93

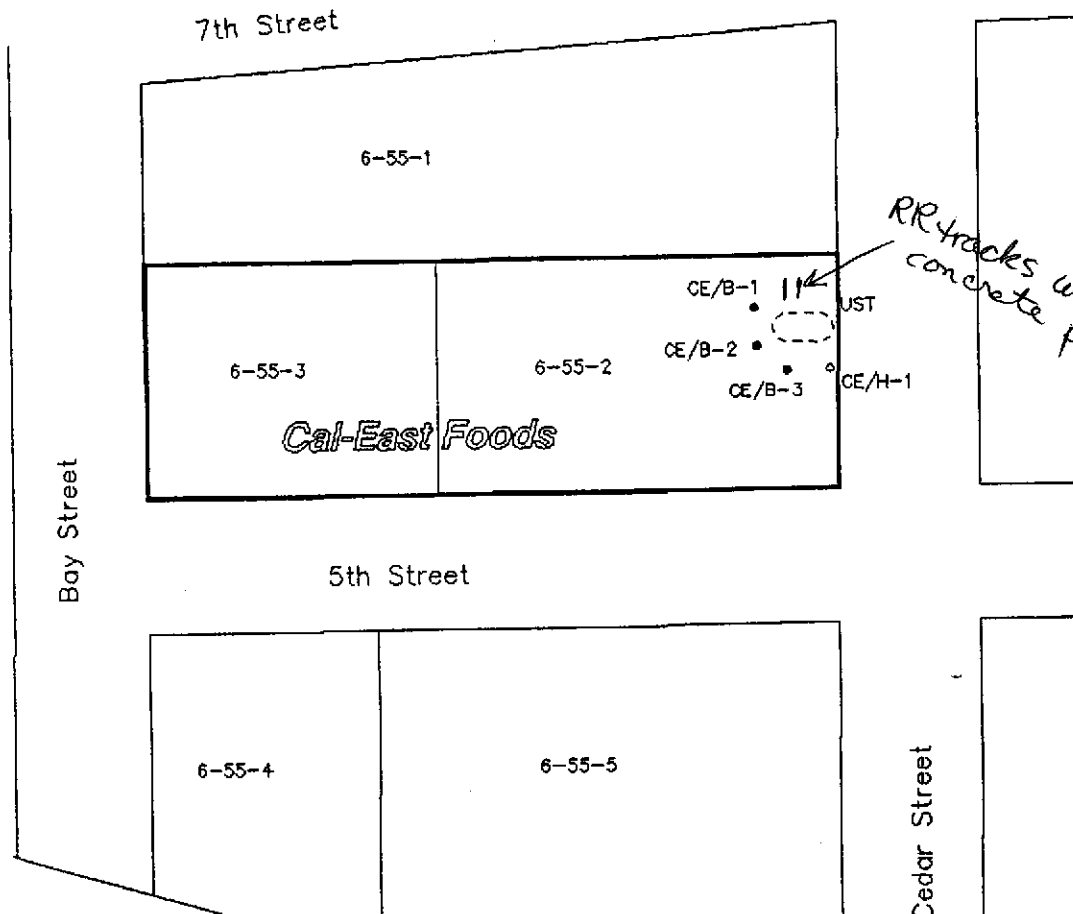

RR tracks under concrete parking lot

bottom
 "
 7-8' wall
 ~7' "
 7-8' "
 8-9' "

	discolored?	odor?
EX1 ~ 10'	slight	no
EX2 ~ 10'	yes	yes
SW1 9' 10'	yes*	yes
SW2 29'	slight	yes
SW3 10' 10'	yes	slight
SW4 10' 11'	slight	slight

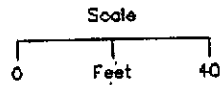
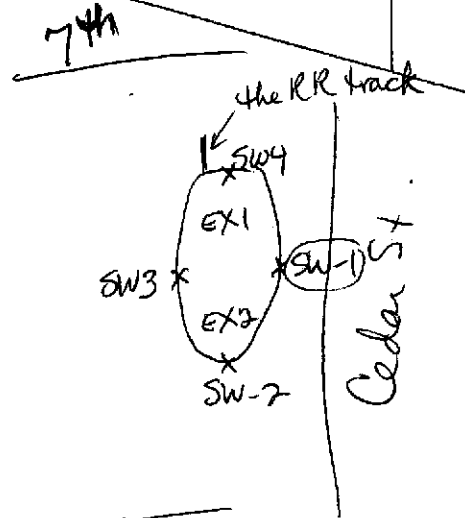

Site Map
 CalTrans/Cal-East Foods
 Cypress Construction Office
 Oakland, CA



RIEDEL ENVIRONMENTAL SERVICES, INC RICHMOND, CALIFORNIA

FIGURE 1

* has oily appearance. Will add TPHd + O+G to analyses.

ALAMEDA COUNTY HEALTH CARE SERVICES AGENCY
 DEPARTMENT OF ENVIRONMENTAL HEALTH
 HAZARDOUS MATERIALS DIVISION
 80 SWAN WAY, ROOM 200
 OAKLAND, CA 94621
 PHONE NO. 510/271-4320

Tennifer Eberke
 See comments in red
 Eberke 11-10-93

ACCEPTED

[Faint, mostly illegible text, possibly a permit or form body]

Insurance...
 is due...
 please...
 CONTRACT SPECIALIST

UNDERGROUND TANK CLOSURE PLAN
 * * * Complete according to attached instructions * * *

1. Business Name Cal East Foods
- Business Owner California Department of Transportation
2. Site Address 505 Cedar St
~~5th & Cedar Street~~ *no #'d address?*
- City Oakland, California Zip 94607 Phone _____
3. Mailing Address Caltrans Cypress Construction Office
- City Oakland, California Zip 94607 Phone (510) 286-0709
4. Land Owner California Department of Transportation Cypress Construction Office
- Address 1121 7th Street, 2nd Floor, State Oakland, CA Zip 94607
5. Generator name under which tank will be manifested _____
California Department of Transportation
- EPA I.D. No. under which tank will be manifested CAC000949168

*Contact?
 Kathleen
 Pargett*

6. Contractor Riedel Environmental Services
Address 4138 Lakeside Drive
City Richmond, CA 94806 Phone (510) 222-7810
License Type* A-Haz ID# 483436

*Effective January 1, 1992, Business and Professional Code Section 7058.7 requires prime contractors to also hold Hazardous Waste Certification issued by the State Contractors License Board. Indicate that the certificate has been received, in addition, to holding the appropriate contractors license type.

7. Consultant (RES) see above
Address _____
City _____ Phone _____

8. Contact Person for Investigation
Name Kathleen R. Pargett Title Resident Engineer
Phone (510) 286-0709

w/Caltrans
total # USB onsite? just one

9. Number of tanks being closed under this plan One (1)
Length of piping being removed under this plan 10'
Total number of tanks at facility One (1)

10. State Registered Hazardous Waste Transporters/Facilities (see instructions).

** Underground tanks are hazardous waste and must be handled **
as hazardous waste

a) Product/Residual Sludge/Rinsate Transporter

Name Refinery Services INC. EPA I.D. No. CAT080011059
Hauler License No. 2591 License Exp. Date _____
Address 13331 N. Hwy 33
City Patterson State CA Zip 95363

b) Product/Residual Sludge/Rinsate Disposal Site

Name Refinery Services INC. EPA I.D. No. CAD083166728
Address 13331 N. Hwy. 33
City Patterson State CA Zip 95363

c) Tank and Piping Transporter

Name Erickson, Inc. EPA I.D. No. CAD 009 466 392
Hauler License No. 0019 License Exp. Date NO EXP. DATE
Address 255 Parr Blvd.
City Richmond State CA Zip 94801

d) Tank and Piping Disposal Site

Name Erickson Inc EPA I.D. No. CAD 009 466 392
Address 255 Parr Blvd
City Richmond State CA Zip _____

11. Experienced Sample Collector

Name Mark Williams REA 4103
Company Riedel Enviromental Services Inc.
Address 4138 Lakeside Drive
City Richmond State CA Zip 94806 Phone (510) 222-7810

12. Laboratory

Name Argon Mobile Labs
Address 3008 McKittrick Ct. *11-10-93 ✓d up on them*
City Ceres State CA Zip 95307
State Certification No. 1873 ✓ exp. 3-31-95
TPH by LUFT, 8020

13. Have tanks or pipes leaked in the past? Yes [X] No []

If yes, describe. Borings taken on June 22, 1993 revealed elevated
GRC concentrations of TPH as gasoline and diesel as
well as BTEX.

*ask Susan
Area 1
Cal East Foods*

*results?
Lip?*

14. Describe methods to be used for rendering tank inert

Rinse tank and lines before removal. Excavate tank using a vacuum truck.
Then, Dry ice approximately 30 lbs. per each 1000 gallons of capacity.

Before tanks are pumped out and inerted, all associated piping must be flushed out into the tanks. All accessible associated piping must then be removed. Inaccessible piping must be plugged.

The Bay Area Air Quality Management District (771-6000), along with local Fire and Building Departments, must also be contacted for tank removal permits. Fire departments typically require the use of explosion proof combustible gas meters to verify tank inertness. It is the contractor's responsibility to bring a working combustible gas meter on site to verify tank inertness.

15. Tank History and Sampling Information

Tank		Material to be sampled (tank contents, soil, groundwater, etc.)	Location and Depth of Samples
Capacity	Use History (see instructions)		
10,000	Unleaded gasoline <i>date inst. unknown</i> <i>date last used Oct 91</i>	Soil & groundwater	Each end of excavation on side wall at groundwater soil interface. Groundwater

One soil sample must be collected for every 20 feet of piping that is removed. A ground water sample must be collected should any ground water be present in the excavation.

Excavated/Stockpiled Soil	
Stockpiled Soil Volume (Estimated)	Sampling Plan
150 Yards	4 Point composite for every 50 Yards removed <i>1 per 20 yd³ if reused on site</i>

Stockpiled soil must be placed on bermed plastic and must be completely covered by plastic sheeting.

16. Chemical methods and associated detection limits to be used for analyzing samples

The Tri-Regional Board recommended minimum verification analyses and practical quantitation reporting limits should be followed. See attached Table 2.

Contaminant Sought	Soil	Water	Method Detection Limit
	EPA, DHS, or Other Sample Preparation Method Number	EPA, DHS, or Other Analysis Method Number	
Unleaded gas	TPH G GCFID (3550) <i>5030</i> BTEX-G-8020 TPH and BTEX-E 8260 <i>total Pb</i>	TPH G (5030) 8020 or 8240 BTEX @ E 602, 624 <i>AA</i>	

17. Submit Site Health and Safety Plan (See Instructions)

18. Submit Worker's Compensation Certificate copy

Name of Insurer Pettit - Murray

19. Submit Plot Plan (See Instructions)

20. Enclose Deposit (See Instructions)

21. Report any leaks or contamination to this office within 5 days of discovery. The report shall be made on an Underground Storage Tank Unauthorized Leak/Contamination Site Report form. (see Instructions)

22. Submit a closure report to this office within 60 days of the tank removal. This report must contain all the information listed in item 22 of the instructions.

I declare that to the best of my knowledge and belief the statements and information provided above are correct and true.

I understand that information in addition to that provided above may be needed in order to obtain an approval from the Department of Environmental Health and that no work is to begin on this project until this plan is approved.

I understand that any changes in design, materials or equipment will void this plan if prior approval is not obtained.

I understand that all work performed during this project will be done in compliance with all applicable OSHA (Occupational Safety and Health Administration) requirements concerning personnel health and safety. I understand that site and worker safety are solely the responsibility of the property owner or his agent and that this responsibility is not shared nor assumed by the County of Alameda.

Once I have received my stamped, accepted closure plan, I will contact the project Hazardous Materials Specialist at least three working days in advance of site work to schedule the required inspections.

Signature of Contractor

Name (please type) Stephen M. Hendricks

Signature *Stephen M. Hendricks*

Date 11-4-92

Signature of Site Owner or Operator

Name (please type) Kathleen R. Pargett

Signature *Kathleen R. Pargett*

Date 11-5-93

INSTRUCTIONS

General Instructions

- * Three (3) copies of this plan plus attachments and deposit must be submitted to this Department.
- * Any cutting into tanks requires local fire department approval.
- * One complete copy of your approved plan must be at the construction site at all times; a copy of your approved plan must also be sent to the landowner.

Item Specific Instructions

2. SITE ADDRESS
Address at which closure is taking place.
5. EPA I.D. NO. under which the tanks will be manifested
EPA I.D. numbers may be obtained from the State Department of Health Services, 916/324-1781.
6. CONTRACTOR
Prime contractor for the project.
10. STATE REGISTERED HAZARDOUS WASTE TRANSPORTERS/FACILITIES
 - a) All residual liquids and sludges are to be removed from tanks before tanks are inerted.
 - c) Tanks must be hauled as hazardous waste.
 - d) This is the place where tanks will be taken for cleaning.
15. TANK HISTORY AND SAMPLING INFORMATION
Use History - This information is essential and must be accurate. Include tank installation date, products stored in the tank, and the date when the tank was last used.

Material to be sampled - e.g. water, oil, sludge, soil, etc.

Location and depth of samples - e.g. beneath the tank a maximum of two feet below the native soil/backfill interface, side wall at the high water mark, etc.

16. CHEMICAL METHODS AND ASSOCIATED DETECTION LIMITS
see attached Table 2.

17. SITE HEALTH AND SAFETY PLAN

A site specific Health and Safety plan must be submitted. We advocate the site health and safety plan include the following items, at a minimum:

- a) The name and responsibilities of the site health and safety officer;
- b) An outline of briefings to be held before work each day to appraise employees of site health and safety hazards;
- c) Identification of health and safety hazards of each work task. Include potential fire, explosion, physical, and chemical hazards;
- d) For each hazard, identify the action levels (contaminant concentrations in air) or physical conditions which will trigger changes in work habits to ensure workers are not exposed to unsafe chemical levels or physical conditions;
- e) Description of the work habit changes triggered by the above action levels or physical conditions;
- f) Frequency and types of air and personnel monitoring - along with the environmental sampling techniques and instrumentation - to be used to detect the above action levels. Include instrumentation maintenance and calibration methods and frequencies;
- g) Confined space entry procedures (if applicable);
- h) Decontamination procedures;
- i) Measures to be taken to secure the site, excavation and stockpiled soil during and after work hours (e.g. barricades, caution tape, fencing, trench plates, plastic sheeting, security guards, etc.);
- j) Spill containment/emergency/contingency plan. Be sure to include emergency phone numbers, the location of the phone nearest the site, and directions to the hospital nearest the site;
- k) Documentation that all site workers have received the appropriate OSHA approved trainings and participate in appropriate medical surveillance per 29 CFR 1910.120; and
- l) Page for employees to sign indicating they have read and will comply with the site health and safety plan.

The safety plan must be distributed to all employees and contractors working in hazardous waste operations on site. A complete copy of the site health and safety plan along with any standard operating procedures shall be on site and accessible at all times.

NOTE: These requirements are excerpts from 29 CFR Part 1910.120(b)(4), Hazardous Waste Operations and Emergency Response; Final Rule, March 6, 1989. Safety plans of certain underground tank sites may need to meet the complete requirements of this Rule.

19. PLOT PLAN

The plan should consist of a scaled view of the facility at which the tank(s) are located and should include the following information:

- a) Scale;
- b) North Arrow;
- c) Property Lines;
- d) Location of all Structures;
- e) Location of all relevant existing equipment including tanks and piping to be removed and dispensers;
- f) Streets;
- g) Underground conduits, sewers, water lines, utilities;
- h) Existing wells (drinking, monitoring, etc.);
- i) Depth to ground water; and
- j) All existing tanks and piping in addition to the ones being pulled.

20. DEPOSIT

A deposit, payable to Alameda County for the amount indicated on the Alameda County Underground Storage Tank Fee Schedule, must accompany the plans.

21. Blank Unauthorized Leak/Contamination Site Report forms may be obtained in limited quantities from our office and from the San Francisco Bay Regional Water Quality Control Board (415/464-1255). Larger quantities may be obtained directly from the State Water Resources Control Board at (916) 739-2421.

22. TANK CLOSURE REPORT

The tank closure report should contain the following information:

- a) General description of the closure activities;
- b) Description of tank, fittings and piping conditions. Indicate tank size and former contents; note any corrosion, pitting, holes, etc.;

7

7

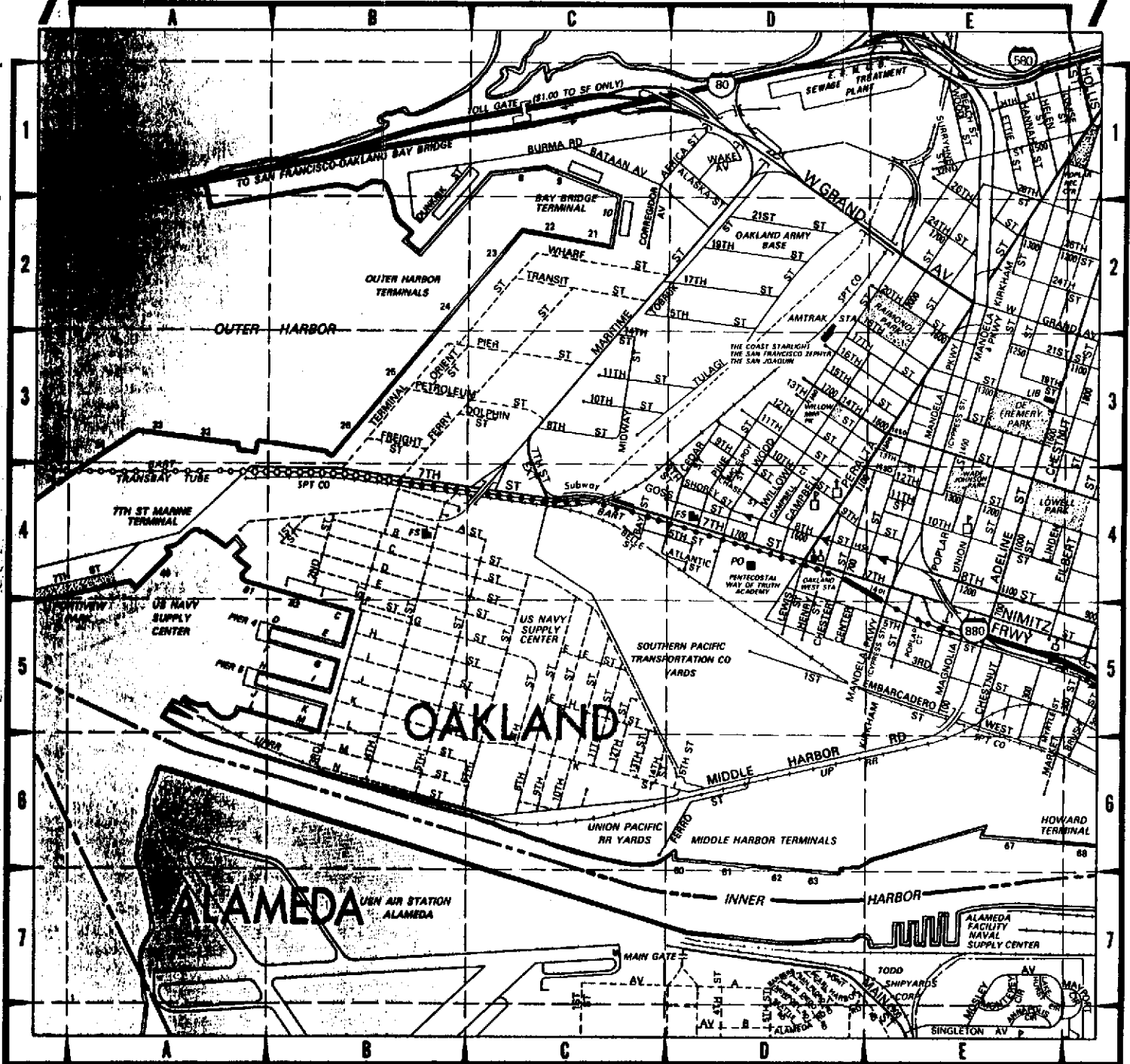

ALAMEDA CO

FOR CONTINUATION SEE MAP 9

DETAIL

1,470,

1,473,

1,482,

1,485,

CONTINUED FROM MAP 2

**CAL-TRANS/Cal East Food - UST Removal
Site Health and Safety Plan
(REV. 0 11/3/93)
Job Number 4280-9324**

The ultimate responsibility for the safety of all RES personnel performing work on this project will belong to RES Project Manager. The Project Manager will have responsibility for ensuring compliance with this plan by RES and subcontractor personnel.

All work practices and procedures performed on site must minimize worker contact with hazardous materials and eliminate or reduce the possibility of physical injury. All work will be performed in accordance with applicable State Occupational Health and Safety regulations.

It is a condition of employment that all personnel perform duties in a safe manner in accordance with how they have been trained, standard working procedure and common sense. Any RES personnel or subcontractor failing to follow established procedures will be reprimanded or excluded from the site, depending on the violation.

The following sections describe the health and safety program that will be in effect.

I. SITE DESCRIPTION

- A. All work will be conducted in an active warehouse parking lot located in a commercial/industrial zoned area.
- B. One buried 10,000 gallon underground storage tank formerly used to store gasoline and diesel will be removed. The last known product was gasoline.
- C. Excavation equipment will be operated in very close proximity to the sidewalk on Cedar Street. Both pedestrian and vehicle traffic will be impacted by tank removal operations.

II. SCOPE OF JOB/TASKS TO BE PERFORMED

- A. Remove residual liquids from tank using vac truck prior to startup of removal operations.
- B. Pressure wash interior of tank. Pump out generated liquid using vac truck.
- C. Inert tank to 5.0% oxygen or 50% of the amount of oxygen required to support combustion, whichever is less.

- C. Employees are to cease work if any unusual situation arises which might present an unsafe condition until the Response Manager or the foreman has made an assessment of the problem to determine what precautions should be taken.

VI. EMPLOYEE HEALTH/PHYSICALS

A. Baseline Physicals

All RES personnel working on site are required to have a baseline physical prior to the start of the project. The contents of these physicals are in accordance with the requirements set forth in 29CFR 1910.120. Proof of this exam will be maintained at the RES office.

B. Follow-up Physicals

A follow-up examination will be performed on any employee who might have been exposed to toxic material at a level which could possibly be hazardous. It is not expected that exposure levels or conditions will warrant the need for follow-up physicals.

VII. EMPLOYEE TRAINING

- A. All RES personnel on site have completed a 40 hour training class designed to meet the requirements of 29CFR 1910.120. Personnel that have been with the company longer than one year have received eight (8) hours of refresher training each year. Copies of training certificates will be maintained at the RES office.

- B. In addition to the training described in "A", all Project Managers have received an additional eight (8) hours of management and supervisor training as required in 29CFR 1910.120.

VIII. PERSONAL PROTECTIVE EQUIPMENT

A. Protective Clothing Requirements

1. Initial excavation and inerting operations are not expected to present a significant inhalation hazard and will be performed Level D.
2. Personnel will upgrade to level C if persistent vapor levels (as measured with a PID) exceed one response unit above background in the breathing zone.

If vapor buildup becomes a problem in and around the truck.

X. TANK INERTING PROCEDURE

- A. Determine the initial LEL and oxygen content of the tank.
- B. Prior to removing the tank from the ground, it must be inerted to 5.0% oxygen or less.
- C. Carbon dioxide (CO₂) will be the first choice for inerting since its density is greater than air causing the CO₂ to settle to the bottom of the tank which causes the oxygen and fuel vapor to be pushed up and out of the tank.
- D. Dry ice or gas from 50 or 100 pound cylinders of CO₂ will be used to inert the tank. Gas will allow the inerting process to proceed faster. At least 12 hours must be allowed prior to removal operations are started if dry ice is used.
- E. When using CO₂ from cylinders, the cylinder will be bonded to the tank with a heavy gauge wire. Care will be taken to ensure that the bonding wire connector form a good electrical connection at both connection point.
- F. The cylinder will then be grounded to earth ground by attaching a grounding wire to the cylinder and a copper rod driven at least 3 feet into the ground.
- G. The gas will be delivered through a metal conduit from the cylinder into the tank.
- H. The gas should be introduced at the lowest part of the tank. If this is not possible, then the conduit line should be placed as low as possible into the tank but not into any liquid present.
- I. If using dry ice, ensure that the ice is not dropped into standing liquid. If possible, drop ice into multiple locations inside the tank to help if sublime faster.
- J. Leave at least one vent opening at the top of the tank to allow escaping vapor/air to escape. Place a PVC pipe (at least 10 feet high) to direct discharged gases out of the breathing zone of personnel.
- K. The tank should be monitored for oxygen concentration throughout the procedure to ensure inert conditions are obtained.

3. Personnel need not upgrade if they can move to an upwind location.

B. PPE Descriptions

1. Level D

- a. Steel toed boots (with covers if walking in contaminated soil)
- b. Eye protection around flying hazards
- c. Hard hat
- d. Hearing Protection. Hearing protection will be worn by all personnel working near noisy equipment (in excess of 85 dBA) such as generators and heavy equipment.
- e. Leather gloves (handling dry ice, chain, wire rope, and other sharp/rough objects)
- f. PVC or nitrile gloves (handling contaminated soils)

2. Level C

- a. MSA Ultra Twin Respirator (GMC-H cartridge)
- b. Steel toed boots (with covers if walking in contaminated soil)
- c. Hard hat
- d. Hearing Protection. Hearing protection will be worn by all personnel working near noisy equipment (in excess of 85 dBA) such as generators and heavy equipment.
- e. Leather gloves (handling dry ice, chain, wire rope, and other sharp/rough objects)
- f. PVC or nitrile gloves (handling contaminated soils)

IX. TANK PUMPING PROCEDURE

- A. A bond wire will be used between the tank and the vac truck. Ensure that all connections are free of paint and scale.
- B. Ground the truck using a bond wire connected to a ground rod driven at least 3 feet into the ground. Ensure that all connections are free of paint and scale.
- C. Monitor the exhaust from the truck to ensure that there is no buildup of flammable vapor in and around the truck. Stop operations if levels in excess of 10% LEL are detected at ground level in the immediate area of the truck.
- D. Attach a hose to the pump discharge and direct it to a downwind location.

- L. Once the oxygen concentration drops below 10% LEL, readings are suspect because the meter needs oxygen to properly determine the LEL. Therefore only oxygen levels are measured. Measurements are to be made from top to bottom of the tank and at each end if possible.
- M. CO2 is damaging to the CGI oxygen sensor. Measurements should be made and the probe withdrawn. Do not leave the probe in the tank.
- N. Once the desired oxygen concentration is reached (listed in B above), all openings should be sealed.
- O. No hot work or ignition sources are allowed within 25 feet of any tank during removal. Heavy machinery used in lifting is excluded.

XI. EXCAVATION/TRENCHING/TANK REMOVAL PROCEDURES

- A. All underground utilities, if any, in the area of excavation must be determined and located prior to beginning excavation. Contact USA at least 48 hours prior to digging.
- B. If personnel are required to enter an excavation, all sides of the excavation shall be sloped at an angle not steeper than a slope of 1.5 feet horizontal for every one (1) foot of vertical rise.
- C. Personnel will not enter trenches or excavations that are not sloped (as described in "B" above) unless they are properly sloped or the excavation is less than four (4) feet deep and of material which will not likely produce cave-in.
- D. Prior to entry, any excavation deeper than (4) feet must have a ladder or have walls sloped to allow for easy and safe access and egress.
- E. All excavated material will be placed at least two (2) feet back from the edge of the excavation if personnel are required to enter the excavation.
- F. Wire rope will be attached to the lifting eyes of the tank prior to dirt being removed from around the side of the tank to preclude the possibility of personnel sliding off the tank (presenting fall hazard and exposure to unshored excavation walls). from having to walk on the tank when they would be presented with a fall hazard.
- F. The Project Manager must be present when equipment is moved such that it could come within 15 feet of an overhead energized power line. Equipment

will not be allowed to operate less than 10 feet from power lines.

- G. The Project Manager will inspect the wire rope slings prior to use to ensure that they are free of defects.
- H. Personnel will not stand directly under the suspended load for any reason.

XII. TANK DEMOLITION PROCEDURES

- A. Tank demolition will be performed only after the tank has been inerted to 5.0% oxygen.
- B. Only cold cutting methods will used if the tank initially exceeded 5% LEL and/or still contains flammable liquids or sludges.
- C. A hot cut method can be utilized if the initial LEL reading was less than 5% and interior walls have been thoroughly rinsed and rinsate has been removed.
- D. The tank will be tested prior to the cutting procedure to verify it remains inert.
- E. The tank will be checked for oxygen concentration from top to bottom to determine the adequacy of the inerting procedure.
- F. Two persons are to be on hand during cutting. One person will perform the cut and the other will act as a fire watch and operate the CGI.
- G. Mark an opening, approximately 3 x 3 feet, at a location in the middle of the end plate.
- H. For cold cutting, make a pilot hole at opposite corners of the square. Start the cutting (using a reciprocal saw) along the top horizontal line and continue across horizontally. Use liberal amounts of cutting fluid on the blade to keep it cool.
- I. When cold or hot cutting, the order of cutting (the top horizontal cut, then the two side cuts from top to bottom, and finally the bottom horizontal cut) is important.
- J. Cutting will introduce air into the tank which will tend to accumulate near the top of the tank while CO₂ levels will be more dense at the bottom. Cutting towards the bottom will ensure that the cutting zone is moving into the denser CO₂ region.

- K. LEL readings should be taken outside the tank while cutting, although levels exceeding the LEL are not expected. If vapor concentrations exceed 10% LEL, then a fan must be utilized to blow vapors away from the tank.
- L. Remove the plate when the total cut is completed. Use care as sharp edges are present and the plate is very heavy.
- M. The interior surfaces can not be inspected. Any further visible contamination should be rinsed and collected.

XIII. GENERAL SITE SAFETY RULES

- A. Personnel will not stand under suspended loads.
- B. Unnecessary entry into trenches/excavations is to be avoided.
- C. No smoking or eating is permitted except in designated break areas.
- D. A 20 pound ABC fire extinguisher will be available whenever gasoline or other flammable material is transferred onsite and immediately adjacent to the tank during cutting operations.
- E. Personnel will always work in pairs inside exclusion zones.
- F. Engines will be shut off while fueling.
- G. All portable electrical equipment used outside the response trailer will be plugged into a ground fault interrupter.
- H. All electrical equipment will be inspected and taken out of service if deficiencies are noted.
- I. A charged eye wash station will be available.

XIV. AIR MONITORING

- A. Area air monitoring will be performed around the tank during inerting. Area monitoring will consist of CGI measurements for flammable vapor concentration.
- B. During site characterization, a photoionization detector will be used to measure relative concentrations of organic vapors.
- C. The PID will be calibrated to the benzene response factor. Any vapor detected will be considered to be benzene. Personnel will upgrade to Level C if steady readings in excess of 1.0 ppm above background are measured in the breathing zone.

XV. PERSONNEL DECONTAMINATION

- A. Decontamination Procedures

1. Personnel will wash hands prior to drinking or smoking at breaks. Towels and soap will be provided. A source of clean water will be available.
2. The scope of work will not likely necessitate special decon procedures.
3. Personnel will remove boot covers that may have been contaminated with soils prior to leaving a contaminated area.

B. Lunches/Breaks

1. All eating must take place in an area specifically provided for that purpose.

XVI. HEAT STRESS/COLD STRESS

- A. Heat or cold stress is not considered a problem on this project.

XVII. DRUG/ALCOHOL POLICY

- A. Personnel will not report to work under the influence of either prescription and/or illegal drugs or alcohol.
- B. Personnel are not to have any illegal drug or alcohol in their possession while on company time.
- C. Violation of this policy can result in termination and or reprimand under RES policy.
- D. A drug/alcohol test will be given to any person involved in an accident requiring medical treatment or one where there is significant property damage in accordance with company policy.

XVIII. SPILL/FIRST AID CONTINGENCY PLAN

- A. The potential for spills or leaks during the pump off of the tank will be minimal.
- B. Spilled material will be contained and absorbed by covering with dirt and/or absorbent pads.
- C. Dirt and pads used to collect spilled material will be discarded as hazardous waste.

POST AT EACH PHONE

SITE ADDRESS: Cal East
505 Cedar Street, Oakland, California

FIRE: 911

POLICE: 911

AMBULANCE: 341-6628 OR 991-2400

POISON CENTER: 800/523-2222

HOSPITAL E.R.: 510/420-6080 Summit Medical Center

NON EMERGENCY CLINIC: 510/655-4000

ROUTE TO HOSPITAL: Summit Medical Center
MAP ATTACHED
350 Hawthorne Avenue (Cross Street: Webster Street)
Oakland, California 94609 (See Attached Map)

XIX. MEDICAL EMERGENCY RESPONSE PLAN

- A. The following steps are to be taken in the event of a medical emergency resulting from either illness or injury.
- B. Examples of medical emergencies are heart attack or suspect heart attack, serious bleeding, unconsciousness, any significant trauma, etc.
- C. If unsure as to the severity of any injury or illness, treat as a medical emergency.
- D. At least one RES personnel in each work area will possess a current First Aid/CPR card.
- E. In the event of any medical emergency:
 - 1. Stay with the person. Do not leave an injured or ill person alone.
 - 2. Perform first aid as necessary. Start CPR if breathing and pulse are absent.
 - 3. Send someone to contact the local fire department by phone by calling 911. State location and nature of injury. Do not leave person alone while phoning, unless it is unavoidable.
 - 4. Contact RES Project Manager as soon as possible.
 - 5. Injured or ill personnel are to be transported to the hospital identified on the SITE EMERGENCY PHONE NUMBER LIST> Any decision to move to another facility will be made by emergency personnel.
- F. Send someone to the hospital with the employee to explain what happened. Take a drug/alcohol test kit, and deliver to the medical personnel.
 - 1. Contact Corporate Health and Safety in the event of any injury requiring medical attention.

7

7

ALAMEDA CO.

FOR CONTINUATION SEE MAP 6

DETAIL

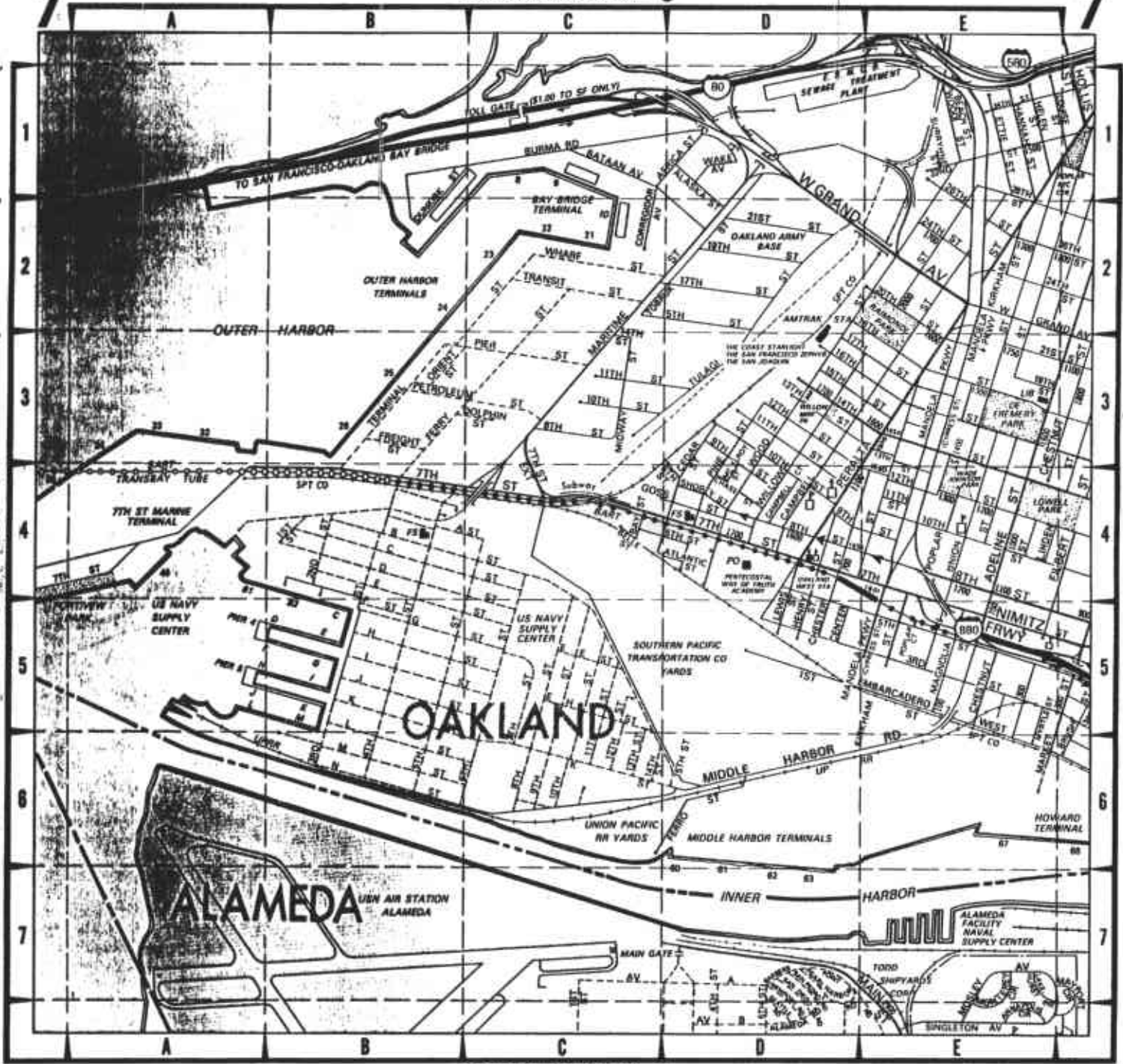

1,470,

1,473,

1,482,

1,485,

Copyright © 1980 by [unreadable]

Identification number: UN1993
DOT shipping name: FLAMMABLE LIQUIDS, N.O.S. (DIESEL FUEL)
Packing group: III
Label(s) required: FLAMMABL LIQUID
Special provisions: B1, B52, T7, T30
Packaging exceptions: 173.150
Non bulk packaging: 173.203
Bulk packaging: 173.242
Quantity limitations-
Passenger air/rail: 60 L
Cargo aircraft only: 220 L
Vessel stowage: A
Other stowage provisions:

STCC NUMBER: 4915113

CLEAN WATER ACT Sect.307:No
CLEAN WATER ACT Sect.311:No
CLEAN AIR ACT: Not listed
EPA WASTE NUMBER: D001
CERCLA REF:
RQ DESIGNATION: Not listed
SARA TPQ VALUE: Not listed
SARA Sect. 312
categories:

Acute toxicity: Irritant
Fire hazard: combustible.

UNITED STATES POSTAL SERVICE MAILABILITY:
Not given

NFPA CODES:

HEALTH HAZARD (BLUE): (1) Slightly hazardous to health. As a precaution
wear self-contained breathing apparatus.
FLAMMABILITY (RED) : (2) This material must be moderately heated before
ignition will occur.
REACTIVITY (YELLOW): (0) Stable even under fire conditions.
SPECIAL : Unspecified

----- SUMMARY OF REGULATORY LISTS THIS SUBSTANCE APPEARS ON -----

DIESEL FUEL [68512-90-3]
DOT Hazardous Materials Table. 49 CFR 172.101
EPA TSCA Chemical Inventory List 1989
EPA TSCA Test Submission (TSCATS) Database - April 1990
RCRA Hazardous Waste

----- TOXICITY DATA -----

SHORT TERM TOXICITY: Unknown

LONG TERM TOXICITY: unknown

TARGET ORGANS: eyes, skin

SYMPTOMS: Inhalation of mist or high concentrations of vapor can produce dizziness, headache, nausea, and possibly irritation of the eyes, nose and throat. Source:

CONC IDLH: Unknown

NIOSH REL: Not given

ACGIH TLV: Not listed

ACGIH STEL: Not listed

OSHA PEL: Not in Table Z-1-A

MAK INFORMATION: ppm

CARCINOGEN?: N STATUS: See below

CARCINOGEN LISTS:

IARC: Not listed
MAK: Not listed
NIOSH: Not listed
NTP: Not listed
ACGIH: Not listed
OSHA: Not listed

LD50 value: orl-rat LD50:9 gm/ kg

OTHER SPECIES TOXICITY DATA: (Source: NIOSH RTECS 1992)

orl-rat LD50:9 gm/kg

IRRITATION DATA: (Source: NIOSH RTECS 1992)

Reproductive toxicity (1992 RTECS):

This chemical has no known mammalian reproductive toxicity.

REPRODUCTIVE TOXICITY DATA (1992 RTECS)

California Prop 65: Not listed

----- PROTECTION AND FIRST AID -----

PROTECTION SUGGESTED
FROM THE CHRIS MANUAL:

wear protective gloves and clothing. eye protection such as safety glasses recommended.

FIRST AID SOURCE: DOT Emergency Response Guide 1990.
Move victim to fresh air and call emergency medical care; if not breathing, give artificial respiration; if breathing is difficult, give oxygen. In case of contact with material, immediately flush eyes with running water for at least 15 minutes. Wash skin with soap and water. Remove and isolate contaminated clothing and shoes at the site.

----- INITIAL INCIDENT RESPONSE -----

FIRE EXTINGUISHMENT: DRY CHEMICAL, CARBON DIOXIDE, HALOGENATED AGENTS, FOAM. Note: CHRIS91

US Department of Transportation Guide to Hazardous Materials Transport Information - Publication DOT 5800.5 (1990).

DOT SHIPPING NAME: FLAMMABLE LIQUIDS, N.O.S. (DIESEL FUEL)
DOT ID NUMBER: UN1993

ERG90

GUIDE 27

* POTENTIAL HAZARDS *

*FIRE OR EXPLOSION

Flammable/combustible material; may be ignited by heat, sparks or flames.

Vapors may travel to a source of ignition and flash back.

Container may explode in heat of fire.

Vapor explosion hazard indoors, outdoors or in sewers.

Runoff to sewer may create fire or explosion hazard.

*HEALTH HAZARDS

May be poisonous if inhaled or absorbed through skin.

Vapors may cause dizziness or suffocation.

Contact may irritate or burn skin and eyes.

Fire may produce irritating or poisonous gases.

Runoff from fire control or dilution water may cause pollution.

* EMERGENCY ACTION *

Keep unnecessary people away; isolate hazard area and deny entry.

Stay upwind; keep out of low areas.

Positive pressure self-contained breathing apparatus (SCBA) and structural firefighters' protective clothing will provide limited protection.

Isolate for 1/2 mile in all direction if tank, rail car or tank truck is involved in fire.

CALL CHEMTREC AT 1-800-424-9300 FOR EMERGENCY ASSISTANCE. If water pollution occurs, notify the appropriate authorities.

*FIRE

Small Fires: Dry chemical, CO2, water spray or regular foam.

Large Fires: Water spray, fog or regular foam.

Move container from fire area if you can do it without risk.

Apply cooling water to sides of containers that are exposed to flames until well after fire is out. Stay away from ends of tanks. For massive fire in cargo area, use unmanned hose holder or monitor nozzles; if this is impossible, withdraw from area and let fire burn. Withdraw immediately in case of rising sound of venting safety device or any discoloration of tank due to fire.

***SPILL OR LEAK**

Shut off ignition sources; no flares, smoking or flames in hazard area. Stop leak if you can do it without risk.

Water spray may reduce vapor; but it may not prevent ignition in closed spaces.

Small Spills: Take up with sand or other noncombustible absorbent material and place into containers for later disposal.

Large Spills: Dike far ahead of liquid spill for later disposal.

***FIRST AID**

Move victim to fresh air and call emergency medical care; if not breathing, give artificial respiration; if breathing is difficult, give oxygen.

In case of contact with material, immediately flush eyes with running water for at least 15 minutes. Wash skin with soap and water.

Remove and isolate contaminated clothing and shoes at the site.

DISCLAIMER: The data shown above on this chemical represents a best effort on the part of the compilers of the CHEMTOX database to obtain useful, accurate, and factual data. The use of these data shall be in accordance with the guidelines and limitations of the user's CHEMTOX license agreement. The COMPILERS of the CHEMTOX database shall not be held liable for inaccuracies or omissions within this database, or in any of its printed or displayed output forms.

IDENTIFIERS

CHEMTOX RECORD 1370 LAST UPDATE OF THIS RECORD: 06/03/93
NAME: GASOLINE
SYNONYMS: PETROL; BENZIN (GERMAN)
CAS: 8006-61-9 RTECS: LX3300000
FORMULA: MOL WT:
WLN:
CHEMICAL CLASS: Aromatic hydrocarbon; Paraffin

See other identifiers listed below under Regulations.

PROPERTIES

PHYSICAL DESCRIPTION: liquid; gasoline with lead may contain colored dyes, usually red, blue, green, or purple. (nydh)

BOILING POINT: 311.15-473.15 K 38-200 C 100.4-392 F
MELTING POINT: NA
FLASH POINT: <227.5 K <-45.65 C <-50.2 F
AUTO IGNITION: 553 K 279.8 C 1027.4 F
VAPOR PRESSURE:
UEL: 7.4 %
LEL: 1.4 %
IONIZATION POTENTIAL (eV): 6.19
VAPOR DENSITY: 3.0 (air=1)
SPECIFIC GRAVITY: 0.75
DENSITY: 0.75 g/cc or 6.975 lb/gal
WATER SOLUBILITY: INSOL
INCOMPATIBILITIES: strong ox

REACTIVITY WITH WATER: No data on water reactivity
REACTIVITY WITH COMMON MATERIALS: WITH OXIDIZING MATERIALS Source: SAX
STABILITY DURING TRANSPORT: No Data
NEUTRALIZING AGENTS: No data
POLYMERIZATION POSSIBILITIES: No data

TOXIC FIRE GASES: None reported other than possible unburned vapors
ODOR DETECTED AT (ppm): Unknown
ODOR DESCRIPTION: No data
100 % ODOR DETECTION: No data

REGULATIONS

DOT hazard class: 3 FLAMMABLE LIQUID
DOT guide: 27
Identification number: UN1203
DOT shipping name: Gasoline
Packing group: II

Label(s) required: FLAMMABLE LIQUID
Special provisions: T8
Packaging exceptions: 173.150
Non bulk packaging: 173.202
Bulk packaging: 173.242
Quantity limitations-
Passenger air/rail: 5 L
Cargo aircraft only: 60 L
Vessel stowage: E
Other stowage provisions:

STCC NUMBER: 4908178, 4908177

CLEAN WATER ACT Sect.307:No
CLEAN WATER ACT Sect.311:No
CLEAN AIR ACT: Not listed
EPA WASTE NUMBER: D001
CERCLA REF: Not listed
RQ DESIGNATION: Not listed
SARA TPQ VALUE: Not listed
SARA Sect. 312
categories:

Acute toxicity: Irritant
Acute toxicity: adverse effect to target organs.
Chronic toxicity: adverse effect to target organ
after long period of exposure.
Fire hazard: combustible.

UNITED STATES POSTAL SERVICE MAILABILITY:
Not given

NFPA CODES:
HEALTH HAZARD (BLUE): (1) Slightly hazardous to health. As a precaution
wear self-contained breathing apparatus.
FLAMMABILITY (RED) : (3) This material can be ignited under almost all
temperature conditions.
REACTIVITY (YELLOW): (0) Stable even under fire conditions.
SPECIAL : Unspecified

----- SUMMARY OF REGULATORY LISTS THIS SUBSTANCE APPEARS ON -----

ACGIH TLV list "Threshold Limit Values for 1992-1993"
Canadian Ingredient Disclosure List. 20/01/88 Canada Gazette part II, Vol 122.
DOT Hazardous Materials Table. 49 CFR 172.101
DOT Marine Pollutant. Proposed list. 57 FR 3854, Jan 31, 1992
EPA TSCA Chemical Inventory List 1990
EPA TSCA Chemical Inventory List 1992
EPA TSCA Test Submission (TSCATS) Database - September 1989
GASOLINE [8006-61-9]

Massachusetts Substance List.
New Jersey Right To Know Substance List. (December 1987)
OSHA Air Contaminant (Table Z-1-A). 54 FR 4332, Jan. 19, 1989 and revised.
Pennsylvania Hazardous Substance List
RCRA Hazardous Waste

----- TOXICITY DATA -----

SHORT TERM TOXICITY: INHALATION: nose and throat irritation have been reported after exposure to 900 ppm for 1 hour. drowsiness, dizziness, nausea and numbness may occur at 1,000 ppm after 15 minutes exposure. in animal studies, death occurred after 30,000 ppm for five minutes. SKIN: may cause itching and burning of the skin and after a longer exposure, redness and blistering. Eyes: moderate irritation of the eye has been reported after one hour exposure to 500 ppm. mild irritation has been reported after an 8 hour exposure to 140 ppm. INGESTION: gasoline causes a burning sensation in the mouth, throat and stomach. vomiting, diarrhea, drowsiness and intoxication may follow. as little as 3 to 4 ounces may be fatal. inhalation of liquid gasoline into the lungs following ingestion or vomiting may result in an accumulation of fluid in the lungs, rapid breathing or death. (NYDH)

LONG TERM TOXICITY: continuous 8 hour exposure to 200 ppm has resulted in eye irritation only. long term exposure may produce fatigue, muscle weakness, nausea, vomiting and abdominal pain. hexane, a component of gasoline, can produce nerve damage resulting in tremors, numbness of hands and feet and loss of muscle control. benzene, also a gasoline component, has been linked to blood disorders in man, including leukemia. lead additives can produce nausea, cramps, loss of appetite, sleep problems, headaches and agitation. (NYDH)

TARGET ORGANS: CNS, skin, eyes, liver

SYMPTOMS: INGESTION CAUSES INEBRIATION, VOMITING, VERTIGO, FEVER, DROWSINESS, CONFUSION, CYANOSIS; ASPIRATION CAUSES BRONCHITIS OR PNEUMONIA. INHALATION CAUSES INTENSE BURNING IN THROAT AND LUNGS; POSSIBLY BRONCHOPNEUMONIA. Source: MI10

CONC IDLH: Unknown

NIOSH REL: Potential occupational carcinogen

ACGIH TLV: TLV = 300ppm(900 mg/M3)

ACGIH STEL: STEL = 500 ppm(1,500 mg/M3)

OSHA PEL: Final R Limits:
TWA = 300 ppm (900 mg/M3)
STEL = 500 ppm(1500 mg/M3)

MAK INFORMATION: Not listed

CARCINOGEN?: N STATUS: See below

CARCINOGEN LISTS:

IARC: Not listed
MAK: Not listed
NIOSH: Not listed
NTP: Not listed
ACGIH: Not listed
OSHA: Not listed

HUMAN TOXICITY DATA: (Source: NIOSH RTECS)
ihl-man TClO:900 ppm/1H JIHTAB 25,225,43
SENSE ORGANS
Eye
Conjunctive irritation
BEHAVIORAL
Hallucinations, distorted perceptions
LUNGS, THORAX, OR RESPIRATION
Cough

LD50 value: No LD50 in RTECS 1992

OTHER SPECIES TOXICITY DATA: (Source: NIOSH RTECS 1992)

ihl-rat LC50:300 gm/m3/5M
ihl-mus LC50:300 gm/m3/5M
ihl-gpg LC50:300 gm/m3/5M
ihl-mam LClO:30000 ppm/5M

IRRITATION DATA: (Source: NIOSH RTECS 1992)

Reproductive toxicity (1992 RTECS):
This chemical has no known mammalian reproductive toxicity.

REPRODUCTIVE TOXICITY DATA (1992 RTECS)

California Prop 65: Not listed

----- PROTECTION AND FIRST AID -----

PROTECTION SUGGESTED
FROM THE CHRIS MANUAL:

FIRST AID SOURCE: DOT Emergency Response Guide 1990.
Move victim to fresh air and call emergency medical care; if not breathing, give artificial respiration; if breathing is difficult, give oxygen. In case of contact with material, immediately flush eyes with running water for at least 15 minutes. Wash skin with soap and water. Remove and isolate contaminated clothing and shoes at the site.

----- INITIAL INCIDENT RESPONSE -----

US Department of Transportation Guide to Hazardous Materials Transport Information - Publication DOT 5800.5 (1990).

DOT SHIPPING NAME: Gasoline
DOT ID NUMBER: UN1203

ERG90

GUIDE 27

* POTENTIAL HAZARDS *

*FIRE OR EXPLOSION

Flammable/combustible material; may be ignited by heat, sparks or flames.

Vapors may travel to a source of ignition and flash back.

Container may explode in heat of fire.

Vapor explosion hazard indoors, outdoors or in sewers.

Runoff to sewer may create fire or explosion hazard.

*HEALTH HAZARDS

May be poisonous if inhaled or absorbed through skin.

Vapors may cause dizziness or suffocation.

Contact may irritate or burn skin and eyes.

Fire may produce irritating or poisonous gases.

Runoff from fire control or dilution water may cause pollution.

* EMERGENCY ACTION *

Keep unnecessary people away; isolate hazard area and deny entry.
Stay upwind; keep out of low areas.

Positive pressure self-contained breathing apparatus (SCBA) and structural firefighters' protective clothing will provide limited protection.

Isolate for 1/2 mile in all direction if tank, rail car or tank truck is involved in fire.

CALL CHEMTREC AT 1-800-424-9300 FOR EMERGENCY ASSISTANCE. If water pollution occurs, notify the appropriate authorities.

*FIRE

Small Fires: Dry chemical, CO₂, water spray or regular foam.

Large Fires: Water spray, fog or regular foam.

Move container from fire area if you can do it without risk.

Apply cooling water to sides of containers that are exposed to flames until well after fire is out. Stay away from ends of tanks.

For massive fire in cargo area, use unmanned hose holder or monitor nozzles; if this is impossible, withdraw from area and let fire burn.

Withdraw immediately in case of rising sound of venting safety device or any discoloration of tank due to fire.

***SPILL OR LEAK**

Shut off ignition sources; no flares, smoking or flames in hazard area.
Stop leak if you can do it without risk.
Water spray may reduce vapor; but it may not prevent ignition in closed spaces.

Small Spills: Take up with sand or other noncombustible absorbent material and place into containers for later disposal.

Large Spills: Dike far ahead of liquid spill for later disposal.

***FIRST AID**

Move victim to fresh air and call emergency medical care; if not breathing, give artificial respiration; if breathing is difficult, give oxygen.

In case of contact with material, immediately flush eyes with running water for at least 15 minutes. Wash skin with soap and water.

Remove and isolate contaminated clothing and shoes at the site.

DISCLAIMER: The data shown above on this chemical represents a best effort on the part of the compilers of the CHEMTOX database to obtain useful, accurate, and factual data. The use of these data shall be in accordance with the guidelines and limitations of the user's CHEMTOX license agreement. The COMPILERS of the CHEMTOX database shall not be held liable for inaccuracies or omissions within this database, or in any of its printed or displayed output forms.



CERTIFICATE OF INSURANCE

INSURED: Riedel Environmental Services, Inc., PO Box 8807, Portland, OR 97208-8807

Pettit-Morry Co. of Oregon hereby certifies that Insurance Policies, as indicated hereunder, are in full force and effect on the date of issuance of the certificate.

COVERAGE	POLICY NO.	INSURER	EFFECTIVE DATE	LIMITS
i. Comprehensive General Liability; including Operations, Contractual XCU, Completed Operations, Personal Injury, Broad Form Property Damage 1976 ISO Type Form with Broadening Endorsement	SLM9261330	The Home Insurance Company of Illinois	4-1-93 to 4-1-94	\$2,000,000 General Aggregate \$2,000,000 Product-Comp/OP AGG \$2,000,000 Each Occurrence (SIR \$50,000)
ii. Business Automobile Liability; including Owned, Non-Owner and Hired Vehicles	BAF 718397	The Home Insurance Company	4-1-93 to 4-1-94	Bodily Injury and Property Damage Combined \$1,000,000 Any One Accident or Loss
iii. Workers' Compensation Statutory Coverage Washington, Nevada, North Dakota, Maine, Ohio, West Virginia, Wyoming, Rhode Island, Oregon, Minnesota, Utah, & Wisconsin U.S.L.&H. Employers Liability	WLR-C3978451-9	Pacific Employers Insurance Company	4-1-93 to 4-1-94	Statutory Statutory \$1,000,000
Workers' Compensation Statutory Coverage for Oregon, California, Minnesota, Utah & Wisconsin U.S.L.&H. Employers Liability	CCS-C3978452-0	Pacific Employers Insurance Company	4-1-93 to 4-1-94	Statutory Statutory \$1,000,000

DESCRIPTION AND LOCATION OF OPERATIONS: All operations of the named insured

This certificate of Insurance does not amend, extend or alter the coverage afforded by the policy or policies shown above notwithstanding any requirement, term or condition of any contract or other document with respect to which this certificate may be issued or may pertain.

CERTIFICATE ISSUED TO:

PETTIT-MORRY CO. OF OREGON

SPECIMEN

By: *Walter C. ...*

SPECIMEN

Date: May 18, 1993



Pettit-Morry Co.
INSURANCE

10300 S.W. GREENBURG ROAD, SUITE 110 • PORTLAND, OR 97223 • TELEPHONE: (503) 293-9500 • FAX: (503) 293-9599

CERTIFICATE:

CERTIFICATE OF INSURANCE

INSURED: Riedel Environmental Services, Inc., PO Box 5007, Portland, OR 97208-5007

Pettit-Morry Co. of Oregon hereby certifies that Insurance Policies, as indicated hereunder, are in full force and effect on the date of issuance of the certificate.

COVERAGE	POLICY NO.	INSURER	EFFECTIVE DATE	LIMITS
1. Business Automobile Liability; including Owned, Non-Owner and Hired Vehicles	BAF-433712	The Home Insurance Company	4-1-93 to 4-1-94	Bodily Injury and Property Damage Combined \$1,000,000 Any One Accident or Loss

DESCRIPTION AND LOCATION OF OPERATIONS:

This certificate of Insurance does not amend, extend or alter the coverage afforded by the policy or policies shown above notwithstanding any requirement, term or condition of any contract or other document with respect to which this certificate may be issued or may pertain.

CERTIFICATE ISSUED TO:

PETTIT-MORRY CO. OF OREGON

Specimen

By:

Date: May 21, 1993



Pettit-Morry Co.
INSURANCE

10300 S.W. GREENBURG ROAD, SUITE 110 • PORTLAND, OR 97223 • TELEPHONE: (503) 293-9500 • FAX: (503) 293-9599

CERTIFICATE OF INSURANCE

INSURED: Riedel Environmental Services, Inc., PO Box 5007, Portland, OR 97208-5007

Pettit-Morry Co. of Oregon hereby certifies that Insurance Policies, as indicated hereunder, are in full force and effect on the date of issuance of the certificate.

COVERAGE	POLICY NO.	INSURER	EFFECTIVE	
			DATE	LIMITS
I. First Umbrella	770-70-99	American International Surplus Lines Company	4-1-93	\$ 5,000,000
			to	Excess of Scheduled
			4-1-94	Underlying Limit

DESCRIPTION AND LOCATION OF OPERATIONS: All Operations of the Named Insured

This certificate of Insurance does not amend, extend or alter the coverage afforded by the policy or policies shown above notwithstanding any requirement, term or condition of any contract or other document with respect to which this certificate may be issued or may pertain.

CERTIFICATE ISSUED TO:

SPECIMEN

PETTIT-MORRY CO. OF OREGON

By: *Walter H. ...*

Date: May 18, 1993

SPECIMEN

ACORD **CERTIFICATE OF INSURANCE** DATE (MM/DD/YY)
5/11/93

PRODUCER
Pettit-Morry Co. of Oregon
10300 SW Greenburg Road, #110
Portland, OR 97223-5414

503-293-9500

THIS CERTIFICATE IS ISSUED AS A MATTER OF INFORMATION ONLY AND CONFERS NO RIGHTS UPON THE CERTIFICATE HOLDER. THIS CERTIFICATE DOES NOT AMEND, EXTEND OR ALTER THE COVERAGE AFFORDED BY THE POLICIES BELOW.

INSURED
Riedel Environmental Services Inc.
P. O. Box 5007
Portland, OR 97208-5007

COMPANIES AFFORDING COVERAGE

COMPANY LETTER A	Planet Insurance Company
COMPANY LETTER B	(ECS)
COMPANY LETTER C	
COMPANY LETTER D	
COMPANY LETTER E	

COVERAGES:
THIS IS TO CERTIFY THAT THE POLICIES OF INSURANCE LISTED BELOW HAVE BEEN ISSUED TO THE INDICATED, NOTWITHSTANDING ANY REQUIREMENT, TERM OR CONDITION OF ANY CONTRACT OR OTHER CERTIFICATE MAY BE ISSUED OR MAY PERTAIN. THE INSURANCE AFFORDED BY THE POLICIES DESCR EXCLUSIONS AND CONDITIONS OF SUCH POLICIES. LIMITS SHOWN MAY HAVE BEEN REDUCED BY PAID

CO LTR	TYPE OF INSURANCE	POLICY NUMBER	POLICY EFFECTIVE DATE (MM/DD/YY)	POLICY EXPIRATION DATE (MM/DD/YY)	LIMITS
	GENERAL LIABILITY <input type="checkbox"/> COMMERCIAL GENERAL LIABILITY <input type="checkbox"/> CLAIMS MADE <input type="checkbox"/> OCCUR <input type="checkbox"/> OWNER'S & CONTRACTOR'S PROT	N/A			GENERAL AGGREGATE ---- PRODUCTS-COMP/OP AGG. ---- PERSONAL & ADV. INJURY ---- EACH OCCURENCE ---- FIRE DAMAGE (Any one fire) ---- MED. EXPENSE (Any one person) ----
	AUTOMOBILE LIABILITY <input type="checkbox"/> ANY AUTO <input type="checkbox"/> ALL OWNED AUTOS <input type="checkbox"/> SCHEDULED AUTOS <input type="checkbox"/> HIRED AUTOS <input type="checkbox"/> NON-OWNED AUTOS <input type="checkbox"/> GARAGE LIABILITY	N/A			COMBINED SINGLE LIMIT ---- BODILY INJURY (Per person) ---- BODILY INJURY (Per accident) ---- PROPERTY DAMAGE ----
	EXCESS LIABILITY <input type="checkbox"/> UMBRELLA FORM <input type="checkbox"/> OTHER THAN UMBRELLA FORM	N/A			EACH OCCURENCE ---- AGGREGATE ---- STATUTORY LIMIT ----
	WORKER'S COMPENSATION AND EMPLOYER'S LIABILITY	N/A ?			EACH ACCIDENT ---- DISEASE-POLICY LIMIT ---- DISEASE-EACH EMPLOYEE ----
A	Consultants Environmental Liability	NTF125992903 SUDDEN & GRADUAL "CLAIMS MADE"	4/01/93	4/01/94	\$1,000,000 Ea Loss \$2,000,000 Total \$100,000 SIR

DESCRIPTION OF OPERATIONS/LOCATIONS/VEHICLES/SPECIAL ITEMS

CERTIFICATE HOLDER

S P E C I M E N

AUTHORIZED REPRESENTATIVE

[Signature] 572025000

ACORD **CERTIFICATE OF INSURANCE** DATE (MM/DD/YY)
5/11/93

PRODUCER
Pettit-Morry Co. of Oregon
10300 SW Greenburg Road, #110
Portland, OR 97223-5414

503-293-9500

THIS CERTIFICATE IS ISSUED AS A MATTER OF INFORMATION ONLY AND CONFERS NO RIGHTS UPON THE CERTIFICATE HOLDER. THIS CERTIFICATE DOES NOT AMEND, EXTEND OR ALTER THE COVERAGE AFFORDED BY THE POLICIES BELOW.

INSURED
Riedel Environmental Services Inc.
P. O. Box 5007
Portland OR 97208-5007

COMPANIES AFFORDING COVERAGE	
COMPANY LETTER A	Planet Insurance Company
COMPANY LETTER B	(ECS)
COMPANY LETTER C	
COMPANY LETTER D	
COMPANY LETTER E	

COVERAGES:
THIS IS TO CERTIFY THAT THE POLICIES OF INSURANCE LISTED BELOW HAVE BEEN ISSUED TO THE INDICATED, NOTWITHSTANDING ANY REQUIREMENT, TERM OR CONDITION OF ANY CONTRACT OR OTHER CERTIFICATE MAY BE ISSUED OR MAY PERTAIN. THE INSURANCE AFFORDED BY THE POLICIES DESCR EXCLUSIONS AND CONDITIONS OF SUCH POLICIES. LIMITS SHOWN MAY HAVE BEEN REDUCED BY PAID

CO LTR	TYPE OF INSURANCE	POLICY NUMBER	POLICY EFFECTIVE DATE (MM/DD/YY)	POLICY EXPIRATION DATE (MM/DD/YY)	LIMITS
	GENERAL LIABILITY <input type="checkbox"/> COMMERCIAL GENERAL LIABILITY <input type="checkbox"/> CLAIMS MADE <input type="checkbox"/> OCCUR <input type="checkbox"/> OWNER'S & CONTRACTOR'S PROT	N/A			GENERAL AGGREGATE PRODUCTS-COMP/OP AGG. PERSONAL & ADV. INJURY EACH OCCURENCE FIRE DAMAGE (Any one fire) MED. EXPENSE (Any one person)
A	AUTOMOBILE LIABILITY <input type="checkbox"/> ANY AUTO <input type="checkbox"/> ALL OWNED AUTOS <input checked="" type="checkbox"/> SCHEDULED AUTOS <input checked="" type="checkbox"/> HIRED AUTOS <input checked="" type="checkbox"/> NON-OWNED AUTOS <input type="checkbox"/> GARAGE LIABILITY	NKA125879004	4/01/93	4/01/94	COMBINED SINGLE LIMIT 5,000,000 BODILY INJURY (Per person) --- BODILY INJURY (Per accident) --- PROPERTY DAMAGE ---
	EXCESS LIABILITY <input type="checkbox"/> UMBRELLA FORM <input type="checkbox"/> OTHER THAN UMBRELLA FORM	N/A			EACH OCCURENCE AGGREGATE STATUTORY LIMIT
	WORKER'S COMPENSATION AND EMPLOYER'S LIABILITY	N/A ?			EACH ACCIDENT DISEASE-POLICY LIMIT DISEASE-EACH EMPLOYEE
	OTHER				

DESCRIPTION OF OPERATIONS/LOCATIONS/VEHICLES/SPECIAL ITEMS

CERTIFICATE HOLDER

S P E C I M E N

AUTHORIZED REPRESENTATIVE
[Signature] 572025000

MOTOR CARRIER POLICIES OF INSURANCE FOR PUBLIC LIABILITY
UNDER SECTION 29 AND 30 OF THE MOTOR CARRIER ACT OF 1980

UMC No. 212-0014

Issued to Riedel Environmental Services, Inc. of PO Box 5007, Portland OR 97208
4 Penn Center Plaza

Dated at Philadelphia PA 19103 this 1 day of April, 1993

Amending Policy No. NKA125879004 Effective Date April 1, 1993

Name of Insurance Company Planet Insurance Company

Telephone Number (215) 458-0570 Countersigned by [Signature]
Authorized Company Representative

The policy to which this endorsement is attached provides primary or excess insurance, as indicated by "", for the limits shown:

This insurance is primary and the company shall not be liable for amounts in excess of \$ 5,000,000 CST for each accident.

This insurance is excess and the company shall not be liable for amounts in excess of \$ _____ for each accident
in excess of the underlying limit of \$ _____ for each accident.

Whenever required by the Federal Highway Administration (FHWA) or the Interstate Commerce Commission (ICC), the company agrees to furnish the FHWA or the ICC a duplicate of said policy and all its endorsements. The company also agrees, upon telephone request by an authorized representative of the FHWA or the ICC, to verify that the policy is in force as of a particular date.

Cancellation of this endorsement may be effected by the company or the insured by giving (1) thirty-five (35) days notice in writing to the other party (said 35 days notice to commence from the date the notice is mailed, proof of mailing shall be sufficient proof of notice), and (2) if the insured is subject to the ICC's jurisdiction, by providing thirty (30) days notice to the ICC (said 30 days notice to commence from the date the notice is received by the ICC at its office in Washington, D.C.).

DEFINITIONS AS USED IN THIS ENDORSEMENT

ACCIDENT includes continuous or repeated exposure to conditions which results in bodily injury, property damage, or environmental damage which the insured neither expected nor intended.

MOTOR VEHICLE means a land vehicle, machine, truck, tractor, trailer, or semitrailer propelled or drawn by mechanical power and used on a highway for transporting property, or any combination thereof.

BODILY INJURY means injury to the body, sickness, or disease to any person, including death resulting from any of these.

ENVIRONMENTAL RESTORATION means restitution for the loss,

damage, or destruction of natural resources arising out of the accidental discharge, dispersal, release or escape into or upon the land, atmosphere, watercourse, or body of water, of any commodity transported by a motor carrier. This shall include the cost of removal and the cost of necessary measures taken to minimize or mitigate damage to human health, the natural environment, fish, shellfish, and wildlife.

PROPERTY DAMAGE means damage to or loss of use of tangible property.

PUBLIC LIABILITY means liability for bodily injury, property damage, and environmental restoration.

The insurance policy to which this endorsement is attached provides automobile liability insurance and is amended to assure compliance by the insured, within the limits stated herein, as a motor carrier of property, with Sections 29 and 30 of the Motor Carrier Act of 1980 and the rules and regulations of the Federal Highway Administration (FHWA) and the Interstate Commerce Commission (ICC).

In consideration of the premium stated in the policy to which this endorsement is attached, the insurer (the company) agrees to pay, within the limits of liability described herein, any final judgment recovered against the insured for public liability resulting from negligence in the operation, maintenance or use of motor vehicles subject to the financial responsibility requirements of Sections 29 and 30 of the Motor Carrier Act of 1980 regardless of whether or not each motor vehicle is specifically described in the policy and whether or not such negligence occurs on any route or in any territory authorized to be served by the insured or elsewhere. Such insurance as is afforded, for public liability, does not apply to injury to or death of the insured's employees while engaged in the course of their employment, or property transported by the insured, designated as cargo. It is understood and agreed that no condition, provision, stipulation, or limitation contained in the policy, this endorsement, or any other endorsement thereon, or violation

thereof, shall relieve the company from liability or from the payment of any final judgment, within the limits of liability herein described, irrespective of the financial condition, insolvency or bankruptcy of the insured. However, all terms, conditions, and limitations in the policy to which the endorsement is attached shall remain in full force and effect as binding between the insured and the company. The insured agrees to reimburse the company for any payment made by the company on account of any accident, claim, or suit involving a breach of the terms of the policy, and for any payment that the company would not have been obligated to make under the provisions of the policy except for the agreement contained in this endorsement.

It is further understood and agreed that, upon failure of the company to pay any final judgment recovered against the insured as provided herein, the judgment creditor may maintain an action in any court of competent jurisdiction against the company to compel such payment.

The limits of the company's liability for the amounts prescribed in this endorsement apply separately, to each accident, and any payment under the policy because of any one accident shall not operate to reduce the liability of the company for the payment of final judgments resulting from any other accident.

The Motor Carrier Act of 1980 requires limits of financial responsibility according to the type of carriage and commodity transported by the motor carrier. It is the MOTOR CARRIER'S obligation to obtain the required limits of financial responsibility.
THE SCHEDULE OF LIMITS SHOWN ON THE REVERSE SIDE DOES NOT PROVIDE COVERAGE.
The limits shown in the schedule are for information purposes only.

SCHEDULE OF LIMITS
Public Liability

Type of Carriage	Commodity Transported	Minimum Insurance
(1) For-hire (In interstate or foreign commerce):	Property (nonhazardous).	\$ 750,000
(2) For-hire and Private (In interstate, foreign, or intrastate commerce).	Hazardous substances, as defined in 49 CFR 171.8, transported in cargo tanks, portable tanks, or hopper-type vehicles with capacities in excess of 3,500 water gallons; or in bulk Class A or B explosives, poison gas (Poison A), liquefied compressed gas or compressed gas, or highway route controlled quantity radioactive materials as defined in 49 CFR 173.403.	5,000,000
(3) For-hire and Private (In interstate or foreign commerce: in any quantity) or (In intrastate commerce: in bulk only).	Oil listed in 49 CFR 172.101, hazardous waste, hazardous materials and hazardous substances defined in 49 CFR 171.8 and listed in 49 CFR 172.101, but not mentioned in (2) above or (4) below.	1,000,000
(4) For-hire and Private (In interstate or foreign commerce).	Any quantity of Class A or B explosives, any quantity of poison gas (Poison A), or highway route controlled quantity radioactive materials as defined in 49 CFR 173.403.	5,000,000

Note: The type of carriage listed under (1), (2), and (3) applies to vehicles with a gross vehicle weight rating of 10,000 pounds or more. The type of carriage listed under number (4) applies to all vehicles with a gross vehicle weight rating of less than 10,000 pounds.

SCHEDULE OF LIMITS
Public Liability

Type of Carriage	Commodity Transported	Minimum Insurance
(1) For-hire (In interstate or foreign commerce):	Property (nonhazardous).	\$ 750,000
(2) For-hire and Private (In interstate, foreign, or intrastate commerce).	Hazardous substances, as defined in 49 CFR 171.8, transported in cargo tanks, portable tanks, or hopper-type vehicles with capacities in excess of 3,500 water gallons; or in bulk Class A or B explosives, poison gas (Poison A), liquefied compressed gas or compressed gas, or highway route controlled quantity radioactive materials as defined in 49 CFR 173.403.	5,000,000
(3) For-hire and Private (In interstate or foreign commerce: in any quantity) or (In intrastate commerce: in bulk only).	Oil listed in 49 CFR 172.101, hazardous waste, hazardous materials and hazardous substances defined in 49 CFR 171.8 and listed in 49 CFR 172.101, but not mentioned in (2) above or (4) below.	1,000,000
(4) For-hire and Private (In interstate or foreign commerce).	Any quantity of Class A or B explosives, any quantity of poison gas (Poison A), or highway route controlled quantity radioactive materials as defined in 49 CFR 173.403.	5,000,000

Note: The type of carriage listed under (1), (2), and (3) applies to vehicles with a gross vehicle weight rating of 10,000 pounds or more. The type of carriage listed under number (4) applies to all vehicles with a gross vehicle weight rating of less than 10,000 pounds.