

RECEIVED

8:57 am, Dec 21, 2011

Alameda County
Environmental Health

Alameda County Environmental Health Services
1131 Harbor Bay Parkway, Suite 250
Alameda, California 94502-6577

Re: Document Transmittal
German Autocraft, 301 East 14th Street, San Leandro, California
AC LOP Case # 2783; Fuel Leak Case No. RO0000302; Global ID T0600100639

Dear Sir or Ma'am:

I declare, under penalty of perjury, that the information contained in the attached document / report are true and correct, to the best of my knowledge.

Sincerely,



Lee Seung
Owner, German Autocraft



3330 Cameron Park Drive, Ste 550
Cameron Park, California 95682
(530) 676-6004 ~ Fax: (530) 676-6005

December 16, 2011
Project No. 2076-0301-01

Mr. Mark Detterman
Alameda County Environmental Health Services
1131 Harbor Bay Parkway
Alameda, California 94502

Subject: **Well Destruction Report**
German Autocraft, 301 East 14th Street, San Leandro, California

Dear Mr. Detterman:

Stratus Environmental, Inc. (Stratus), on behalf of Mr. Seung Lee, has prepared this document for the German Autocraft Facility located at 301 East 14th Street, San Leandro, California. During the quarterly groundwater monitoring and sampling event on September 8, 2011, the Stratus technician noted that off-site monitoring well MW-6 had been damaged by the subsidence of its well box and surrounding pavement, caused by vehicle traffic over the box. Following receipt of Alameda County Environmental Health Services (ACEHS) email correspondence dated October 6, 2011, in which ACEHS concurred with Stratus's plan to destroy the well without replacement, Stratus proceeded with the proper destruction of the monitoring well. A site plan depicting the location of the well is attached.

Prior to initiating the well abandonment, a well abandonment permit (attached) was obtained from Alameda County Public Works Agency (ACPWA). A licensed drilling contractor (RSI Drilling, recently merged with Cascade Drilling, LLP, C-57 #938110) performed the well destruction activities. All work was completed under the direction of a California Professional Geologist.

On November 21, 2011, monitoring well MW-6 was destroyed by over-drilling. First, the wellbox and surrounding concrete collar were removed using hand tools. The well was then destroyed by over-drilling the entire length of the well, to a total depth of 37 feet below ground surface (bgs). The remaining borehole was backfilled using neat Portland cement grout, using a tremmie pipe to insert the grout from the bottom of the borehole. All soil cuttings and groundwater produced during the over-drilling and grouting process were collected and placed in DOT-rated 55-gallon drums and stored onsite pending disposal. Finally, the borehole was capped with a concrete patch at surface grade.

Mr. Mark Detterman, ACEHS
Well Destruction Report
German Autocraft, San Leandro, California
Page 2

December 16, 2011
Project No. 2076-0301-01

Following completion of the well destruction, Stratus submitted a *Well Completion Report* to the California Department of Water Resources (DWR) and to ACPWA under separate cover.

If you have any questions or comments, please contact Kasey Jones at (415) 516-0373.

Sincerely,

STRATUS ENVIRONMENTAL, INC.



Allan Dudding
Project Geologist



Scott Bittinger, P.G.
Senior Geologist

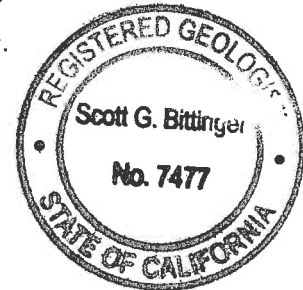

Attachments: ACPWA Well Destruction Permit
Site Plan

cc: Mr. Seung Lee, German Autocraft
Ms. Cherie McCaulou, RWQCB-SF

Alameda County Public Works Agency - Water Resources Well Permit



399 Elmhurst Street
Hayward, CA 94544-1395
Telephone: (510)670-6633 Fax:(510)782-1939

Application Approved on: 10/19/2011 By jamesy

Permit Numbers: W2011-0656
Permits Valid from 11/01/2011 to 11/01/2011

Application Id: 1319047416068 **City of Project Site:** San Leandro
Site Location: 301 E 14th street @ Garcia Avenue, San Leandro, CA
Project Start Date: 11/01/2011 **Completion Date:** 11/01/2011
Assigned Inspector: Contact Vicky Hamlin at (510) 670-5443 or vickyh@acpwa.org

Applicant: Stratus - Kasey Jones **Phone:** 530-676-6004
 3330 Cameron Park Dr #550, Cameron Park, CA 95682
Property Owner: Seung Lee **Phone:** 510-763-7551
 350 Cherrywood, San Leandro, CA 94577
Client: ** same as Property Owner **

	Total Due:	\$397.00
Receipt Number: WR2011-0307	Total Amount Paid:	\$397.00
Payer Name : Stratus	Paid By: CHECK	PAID IN FULL

Works Requesting Permits:

Well Destruction-Monitoring - 1 Wells
 Driller: RSI - Lic #: 802334 - Method: hstem

Work Total: \$397.00

Specifications

Permit #	Issued Date	Expire Date	Owner Well Id	Hole Diam.	Casing Diam.	Seal Depth	Max. Depth	State Well #	Orig. Permit #	DWR #
W2011-0656	10/19/2011	01/30/2012	MW6	8.00 in.	2.00 in.	20.00 ft	37.00 ft			

Specific Work Permit Conditions

1. Drilling Permit(s) can be voided/ cancelled only in writing. It is the applicant's responsibility to notify Alameda County Public Works Agency, Water Resources Section in writing for an extension or to cancel the drilling permit application. No drilling permit application(s) shall be extended beyond ninety (90) days from the original start date. Applicants may not cancel a drilling permit application after the completion date of the permit issued has passed.
2. Prior to any drilling activities, it shall be the applicant's responsibility to contact and coordinate an Underground Service Alert (USA), obtain encroachment permit(s), excavation permit(s) or any other permits or agreements required for that Federal, State, County or City, and follow all City or County Ordinances. No work shall begin until all the permits and requirements have been approved or obtained. It shall also be the applicants responsibilities to provide to the Cities or to Alameda County an Traffic Safety Plan for any lane closures or detours planned. No work shall begin until all the permits and requirements have been approved or obtained.
3. Compliance with the well-sealing specifications shall not exempt the well-sealing contractor from complying with appropriate State reporting-requirements related to well construction or destruction (Sections 13750 through 13755 (Division 7, Chapter 10, Article 3) of the California Water Code). Contractor must complete State DWR Form 188 and mail original to the Alameda County Public Works Agency, Water Resources Section, within 60 days. Including permit number and site map.
4. Applicant shall submit the copies of the approved encroachment permit to this office within 60 days.
5. Permittee shall assume entire responsibility for all activities and uses under this permit and shall indemnify, defend and save the Alameda County Public Works Agency, its officers, agents, and employees free and harmless from any and

Alameda County Public Works Agency - Water Resources Well Permit

all expense, cost and liability in connection with or resulting from the exercise of this Permit including, but not limited to, property damage, personal injury and wrongful death.

6. Applicant shall contact Vicky Hamlin for an inspection time at 510-670-5443 or email to vickyh@acpwa.org at least five (5) working days prior to starting, once the permit has been approved. Confirm the scheduled date(s) at least 24 hours prior to drilling.

7. Permittee, permittee's contractors, consultants or agents shall be responsible to assure that all material or waters generated during drilling, boring destruction, and/or other activities associated with this Permit will be safely handled, properly managed, and disposed of according to all applicable federal, state, and local statutes regulating such. In no case shall these materials and/or waters be allowed to enter, or potentially enter, on or off-site storm sewers, dry wells, or waterways or be allowed to move off the property where work is being completed.

8. Remove the Christy box or similar structure. Destroy well by overdrilling & Tremie Grouting with Cement. After the seal has set, backfill the remaining hole with concrete or compacted material to match existing.

9. Copy of approved drilling permit must be on site at all times. Failure to present or show proof of the approved permit application on site shall result in a fine of \$500.00.

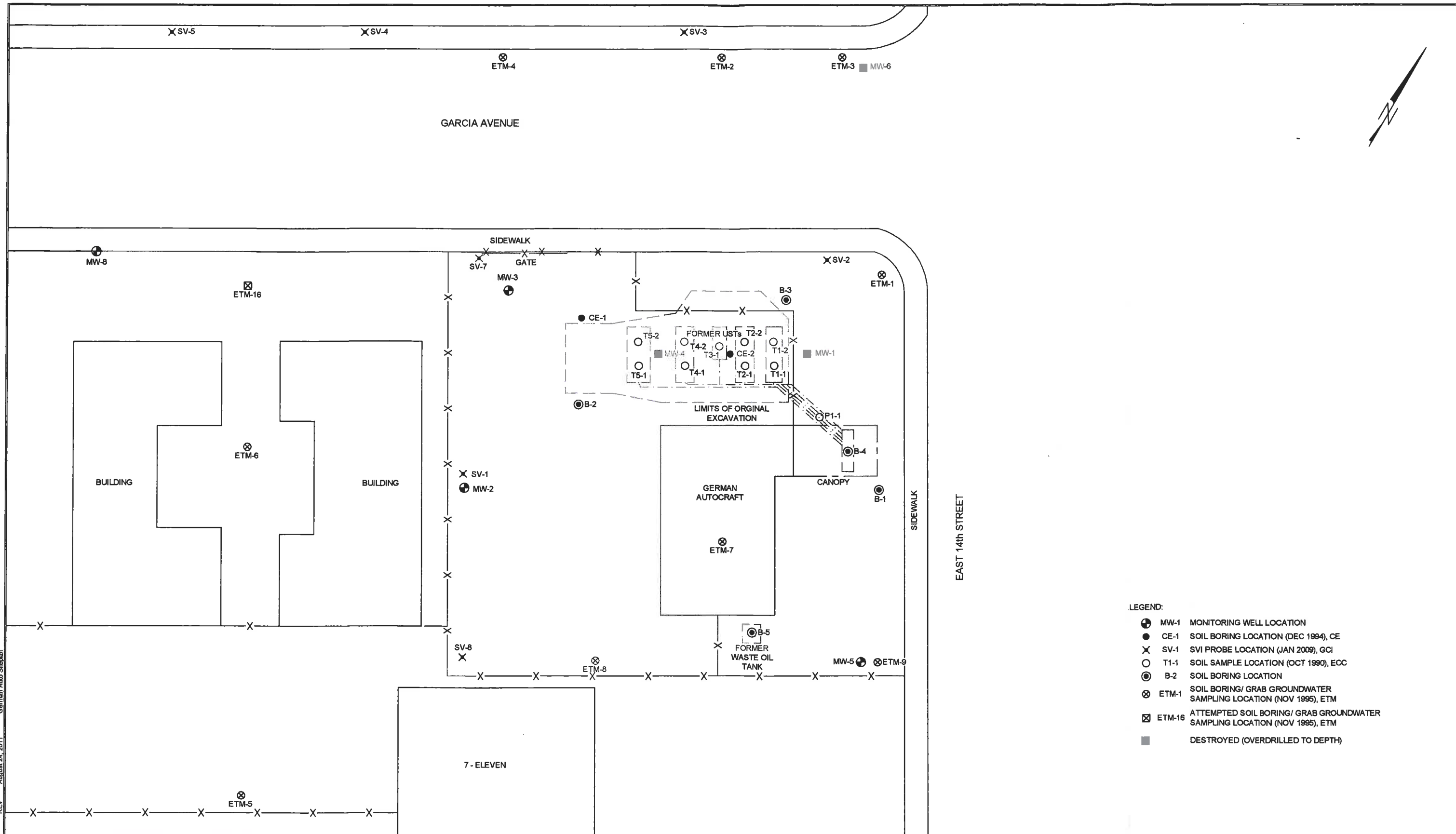

- LEGEND:
- MW-1 MONITORING WELL LOCATION
 - CE-1 SOIL BORING LOCATION (DEC 1994), CE
 - ⊗ SV-1 SVI PROBE LOCATION (JAN 2009), GCI
 - T1-1 SOIL SAMPLE LOCATION (OCT 1990), ECC
 - ⊙ B-2 SOIL BORING LOCATION
 - ⊗ ETM-1 SOIL BORING/ GRAB GROUNDWATER SAMPLING LOCATION (NOV 1995), ETM
 - ⊗ ETM-16 ATTEMPTED SOIL BORING/ GRAB GROUNDWATER SAMPLING LOCATION (NOV 1995), ETM
 - DESTROYED (OVERDRILLED TO DEPTH)

German Auto Siteplan
 REV August 24, 2011
 JMP

STRATUS
ENVIRONMENTAL, INC.

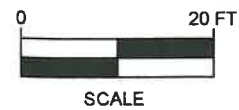

GERMAN AUTOCRAFT
301 EAST 14th STREET
SAN LEANDRO, CALIFORNIA

SITE PLAN

FIGURE

2

PROJECT NO.
2076-0301-01