

ENVIRONMENTAL TESTING & MGMT.
111 N. MARKET ST., 6th FLOOR
SAN JOSE, CALIFORNIA 95113
408.938.0939 FAX: 408.938.3929

FAX TRANSMITTAL (510) 357-9335

DATE: 1/13/99

TO: Scott Seery / Al. Co. Dept Health.

FROM: Tom Price

NUMBER OF PAGES INCLUDING COVER: 10

COMMENTS:

Hallo Scott,
Received your msg. I assume
these tests are what you're
interested in (h2 h2)! Busy
working in field at present,
will issue rpt soon. Bringing
in a surveyor nxt wk for
elevations.

Thanks, Tom Price

(408) 938-0939

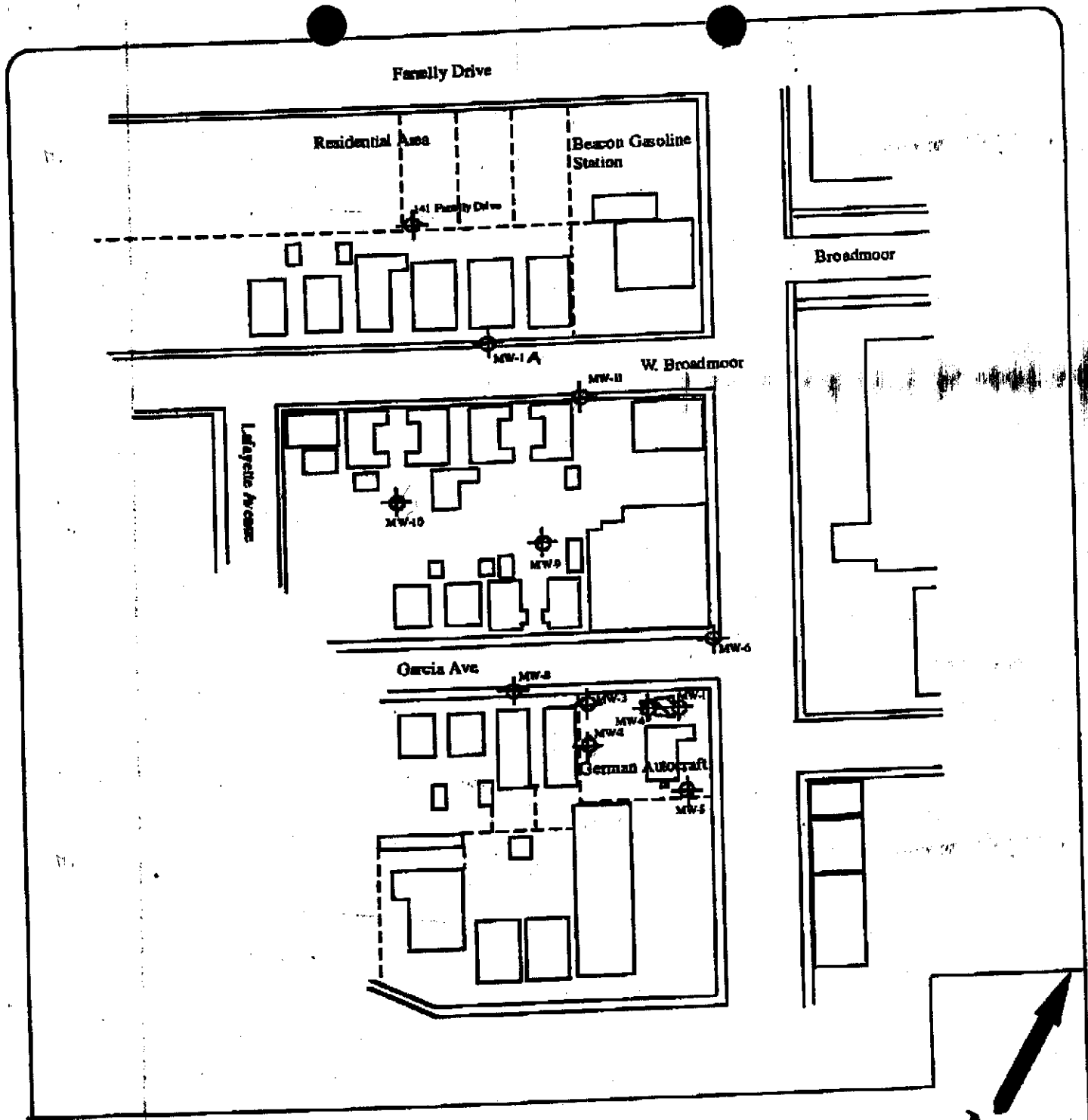

EXPLANATION:



Scale: 1"=120'

- Streets/Buildings
- ⊕ Groundwater Monitoring Well
- ▨ Former Tank Fit Areas
- Buildings



ENVIRONMENTAL TESTING & MAINT.
 11 N. MARKET STREET 6TH FLOOR
 SAN JOSE, CA 95113

German Autocraft
 301 East 14th Street
 San Leandro, California

Figure 2

Date: 11/98

Entech Analytical Labs, Inc.

CA ELAP# 2224

525 Del Rey Avenue, Suite E • Sunnyvale, CA 94086 • (408) 735-1550 • Fax (408) 735-1554

Environmental Testing & Management
 111 N. Market Street, Suite 600
 San Jose, CA 95113
 Attn: Tom Price

Date: 1/8/99
 Date Received: 12/31/98
 Project: GA
 PO #:
 Sampled By: Client

Certified Analytical Report

Water Sample Analysis:

Sample ID	12/30/98			12/30/98			12/30/98				
Sample Date	12/30/98			12/30/98			12/30/98				
Sample Time											
Lab #	E23439			E23439			E23440				
	Result	DF	DLR	Result	DF	DLR	Result	DF	DLR	PQL	Method
Results in µg/Liter:											
Analysis Date	1/7/99			1/5/99			1/4/99				
		1.0	50		20	1000		20	1000	50	8015M
		1.0	0.50		20	10		20	10	0.50	8020
Toluene	0.94	1.0	0.50	ND	20	10	19	20	10	0.50	8020
Ethyl Benzene	26	1.0	0.50	180	20	10	140	20	10	0.50	8020
Xylenes	15	1.0	0.50	630	20	10	210	20	10	0.50	8020
Analysis Date	1/5/99			1/5/99			1/5/99				
tert-Butanol	ND ¹	10	200	ND ¹	10	200	51	1.0	20	20	8260
	ND ¹	10	50	ND ¹	10	50	ND	1.0	5.0	5.0	8260
Dibutyl ether	ND ¹	10	50	ND ¹	10	50	ND	1.0	5.0	5.0	8260
Ethyl-tert-butyl ether	ND ¹	10	50	ND ¹	10	50	ND	1.0	5.0	5.0	8260
tert-Butylmethyl ether	ND ¹	10	50	ND ¹	10	50	ND	1.0	5.0	5.0	8260

DF=Dilution Factor ND= None Detected above DLR PQL=Practical Quantitation Limit DLR=Detection Reporting Limit

1. Sample diluted due to high concentrations of non-target hydrocarbons
2. Analysis performed by Entech Analytical Labs, Inc. (CA ELAP #2224)

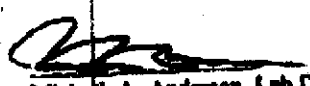
 Michelle L. Anderson, Lab Director

Environmental Analysis Since 1983

Entech Analytical Labs, Inc.

CA ELAP# 2224

525 Del Rey Avenue, Suite E • Sunnyvale, CA 94086 • (408) 735-1550 • Fax (408) 735-1554

Environmental Testing & Management
 111 N. Market Street, Suite 600
 San Jose, CA 95113
 Attn: Tom Price

Date: 1/8/99
 Date Received: 12/31/98
 Project: GA
 PO #
 Sampled By: Client

Certified Analytical Report

? duplicate?

? blank? irrigation well?

Water Sample Analysis:

Sample ID	12/30/98			12/30/98			12/30/98				
Sample Date	12/30/98			12/30/98			12/30/98				
Sample Time											
Lab #	E23441			E23442			E23443				
	Result	DF	DLR	Result	DF	DLR	Result	DF	DLR	PQL	Method
Results in µg/Liter:											
Analysis Date	1/4/99			1/4/99			1/4/99				
		1.0	50		1.0	50	ND	1.0	50	50	8015M
	ND	1.0	0.50	ND	1.0	0.50	ND	1.0	0.50	0.50	8020
Toluene	ND	1.0	0.50	ND	1.0	0.50	ND	1.0	0.50	0.50	8020
Ethyl Benzene	0.93	1.0	0.50	0.89	1.0	0.50	ND	1.0	0.50	0.50	8020
Xylenes	1.6	1.0	0.50	1.8	1.0	0.50	ND	1.0	0.50	0.50	8020
Analysis Date	1/5/99			1/5/99			1/5/99				
tert-Butanol	ND	1.0	20	ND	1.0	20	ND	1.0	20	20	8260
	ND	1.0	5.0	ND	1.0	5.0	ND	1.0	5.0	5.0	8260
Dibutyl ether	ND	1.0	5.0	ND	1.0	5.0	ND	1.0	5.0	5.0	8260
Ethyl-tert-butyl ether	ND	1.0	5.0	ND	1.0	5.0	ND	1.0	5.0	5.0	8260
tert-Amyl methyl ether	ND	1.0	5.0	ND	1.0	5.0	ND	1.0	5.0	5.0	8260

DF=Dilution Factor ND=None Detected above DLR PQL=Practical Quantitation Limit DLR=Detection Reporting Limit
 Analysis performed by Entech Analytical Labs, Inc. (CA ELAP #2224)

 Michelle L. Anderson, Lab Director

Environmental Analysis Since 1983

Entech Analytical Labs, Inc.

CA ELAP# 2224

525 Del Rey Avenue, Suite E • Sunnyvale, CA 94086 • (408) 735-1550 • Fax (408) 735-1554

Environmental Testing & Management
 111 N. Market Street, Suite 600
 San Jose, CA 95113
 Attn: Tom Price

Date: 1/8/99
 Date Received: 12/31/98
 Project: GA
 PO #:
 Sampled By: Client

Certified Analytical Report

W. Broadwater

Water Sample Analysis:

Sample ID	MW-1						MW-2					
Sample Date	12/30/98			12/30/98			12/30/98					
Sample Time												
Lab #	E23444			E23445			E23446					
	Result	DF	DLR	Result	DF	DLR	Result	DF	DLR	PQL	Method	
Results in µg/Liter:												
Analysis Date	1/4-1/5/99			1/7/99			1/4/99					
Benzene	78,000	40	2000	ND	1.0	50	9,300	20	1000	50	8015M	
Toluene	5,200	200	100	ND	1.0	0.50	510	20	10	0.50	8020	
Ethyl Benzene	24,000	200	100	ND	1.0	0.50	96	20	10	0.50	8020	
Xylenes	3,200	200	100	ND	1.0	0.50	450	20	10	0.50	8020	
Xylenes	19,000	200	100	ND	1.0	0.50	480	20	10	0.50	8020	
Analysis Date	1/5/99			1/5/99			1/5/99					
tert-Butanol	ND ¹	100	2000	ND ¹	10	200	ND ¹	10	200	20	8260	
MTHF	ND ¹	100	500	ND ¹	10	50	ND ¹	10	50	5.0	8260	
Dihydroxyethyl ether	ND ¹	100	500	ND ¹	10	50	ND ¹	10	50	5.0	8260	
Ethyl-tert-butyl ether	ND ¹	100	500	ND ¹	10	50	ND ¹	10	50	5.0	8260	
tert-Amyl methyl ether	ND ¹	100	500	ND ¹	10	50	ND ¹	10	50	5.0	8260	

DF=Dilution Factor ND= None Detected above DLR PQL=Practical Quantitation Limit DLR=Detection Reporting Limit

1. Sample diluted due to high concentrations of non-target hydrocarbons
2. Analysis performed by Entech Analytical Labs, Inc. (CA ELAP #2224)

Michelle L. Anderson
 Michelle L. Anderson, Lab Director

Environmental Analysis Since 1983

Entech Analytical Labs, Inc.

CA ELAP# 2224

525 Del Rey Avenue, Suite E • Sunnyvale, CA 94086 • (408) 735-1550 • Fax (408) 735-1554

Environmental Testing & Management
 111 N. Market Street, Suite 600
 San Jose, CA 95113
 Attn: Tom Price

Date: 1/8/99
 Date Received: 12/31/98
 Project: GA
 PO: [REDACTED]
 Sampled By: Client

Certified Analytical Report

Water Sample Analysis:

Sample ID	MW-3			MW-4			[REDACTED]				
Sample Date	12/30/98			12/30/98			12/30/98				
Sample Time											
Lab #	E23447			E23448			E23449				
	Result	DF	DLR	Result	DF	DLR	Result	DF	DLR	PQL	Method
Results in µg/Liter:											
Analysis Date	1/4/99			1/4/99			1/7/99				
TPH-Gas	34,000	20	1000	12,000	20	1000	170	1.0	50	50	8015M
Benzene	4,200	20	10	1,200	20	10	1.1	1.0	0.50	0.50	8020
Toluene	770	20	10	1,100	20	10	ND	1.0	0.50	0.50	8020
Ethyl Benzene	2,300	20	10	290	20	10	ND	1.0	0.50	0.50	8020
Xylenes	9,800	20	10	1,400	20	10	0.83	1.0	0.50	0.50	8020
Analysis Date	1/5/99			1/5/99			1/5/99				
tert-Butanol	ND ¹	100	2000	ND ¹	20	400	ND	1.0	20	20	8260
MTBE	ND ¹	100	500	ND ¹	20	100	ND	1.0	5.0	5.0	8260
Dibutyl ether	ND ¹	100	500	ND ¹	20	100	ND	1.0	5.0	5.0	8260
Ethyl-tert-butyl ether	ND ¹	100	500	ND ¹	20	100	ND	1.0	5.0	5.0	8260
tert-Butylmethyl ether	ND ¹	100	500	ND ¹	20	100	ND	1.0	5.0	5.0	8260

DF=Dilution Factor ND= None Detected above DLR PQL=Practical Quantitation Limit DLR=Detection Reporting Limit

1. Sample diluted due to high concentrations of non-target hydrocarbons
2. Analysis performed by Entech Analytical Labs, Inc. (CA ELAP #2224)

 Michelle L. Anderson, Lab Director

Environmental Analysis Since 1983

Entech Analytical Labs, Inc.

CA ELAP# 2224

525 Del Rey Avenue, Suite E • Sunnyvale, CA 94086 • (408) 735-1550 • Fax (408) 735-1554

Environmental Testing & Management
 111 N. Market Street, Suite 600
 San Jose, CA 95113
 Attn: Tom Price

Date: 1/8/99
 Date Received: 12/31/98
 Project: GA
 PO #:
 Sampled By: Client

Certified Analytical Report

Water Sample Analysis:

Sample ID	Sample Date	Sample Time	Lab #	Result	DF	DLR	PQL	Method
	12/30/98		E23490					
Analysis Date	1/4/99						50	8015M
					1.0	50	0.50	8020
					1.0	0.50	0.50	8020
Toluene	ND				1.0	0.50	0.50	8020
Ethyl Benzene	ND				1.0	0.50	0.50	8020
Xylenes	4.8				1.0	0.50	0.50	8020
Analysis Date	1/5/99						20	8260
tert-Butanol	ND				1.0	20	5.0	8260
MTBE	ND				1.0	5.0	5.0	8260
Diacetyl ether	ND				1.0	5.0	5.0	8260
Ethyl-tert-butyl ether	ND				1.0	5.0	5.0	8260
tert-Amyl methyl ether	ND				1.0	5.0	5.0	8260

DF=Dilution Factor ND= None Detected above DLR PQL=Practical Quantitation Limit DLR=Detection Reporting Limit
 Analysis performed by Entech Analytical Labs, Inc. (CA ELAP #2224)

 Michelle L. Anderson, Lab Director

Environmental Analysis Since 1983

Entech Analytical Labs, Inc.

CA ELAP# 2224

525 Del Rey Avenue, Suite E • Sunnyvale, CA 94086 • (408) 735-1550 • Fax (408) 735-1554

STANDARD LAB QUALIFIERS July, 1998

All Entech lab reports now reference standard lab qualifiers. These qualifiers are noted in the adjacent column to the analytical result and are adapted from the U.S. EPA CLP program. The current qualifier list is as follows:

Qualifier	Description
U	Compound was analyzed for but not detected
J	Estimated value for tentatively identified compounds or if result is below PQL but above MDL
N	Presumptive evidence of a compound (for Tentatively Identified Compounds)
B	Analyte is found in the associated Method Blank
E	Compounds whose concentrations exceed the upper level of the calibration range
D	Multiple dilutions reported for analysis; discrepancies between analytes may be due to dilution
X	Results within quantitation range; chromatographic pattern not typical of fuel

Environmental Analysis Since 1983

Entech Analytical Labs, Inc.

525 Del Rey Avenue, Suite B • San Jose, CA 94086 • Telephone: (408) 735-1550 (800) 287-1799 • Fax: (408) 735-1554

Chain of Custody/Analysis Work Order

Client: Env. Test Mgmt
 Address: 111 N Market St 6 Flr.
San Jose CA 95113
 Contact: Tom Price
 Telephone #: 938 0939
 Date Received: 12-31-98
 Turn Around: Normal

Project ID: GA
 Purchase Order #:

Sampler/Company: _____ Telephone #: _____
 Special Instructions/Comments

LAB USE ONLY

Samples arrived chilled and intact:
 Yes _____ No _____

Notes: _____

Sample Information							Requested Analysis								
Lab #	Sample ID	Grab/Composite	Matrix	Date Collected	Time Collected	Pres.	Sample Container	TPP/RTX	Other Analytes						
B22444	MW-1 (1)	G	W	12/30/98		Chill wet	VBS	✓	✓						
B22445	MW-1A (2)							✓	✓						
B22446	MW-2							✓	✓						
B22447	MW-3							✓	✓						
B22448	MW-4							✓	✓						
B22449	MW-5							✓	✓						
B22450	MW-6							✓	✓						

Relinquished By: <u>Tom Price</u>	Received By: <u>J. Mohr</u>	Date: <u>12-31-98</u>	Time: <u>11:15 AM</u>
Relinquished By: <u>J. Mohr</u>	Received By: <u>V. V. V.</u>	Date: <u>12-31-98</u>	Time: <u>11:50 AM</u>
Relinquished By:	Received By:	Date:	Time:

39201 Cherry St.
Newark.
5674

Entech Analytical Labs, Inc.

525 Del Rey Avenue, Suite B • Sunnyvale, CA 94086 • Telephone: (408) 735-1550 (800) 287-1799 • Fax: (408) 735-1554

Chain of Custody/Analysis Work Order

Client: ENVTEST Mgmt
 Address: 111 N Market St 6 Flr
SAN JOSE CA 95113
 Contact: Tom Price
 Telephone #: 938 0939
 Date Received: 12-31-98
 Turn Around: Normal

Project ID: GA
 Purchase Order #:

Sampler/Company: _____ Telephone #: _____
 Special Instructions/Comments: _____

LAB USE ONLY

Samples arrived chilled and intact:
 Yes _____ No _____

Notes: _____

Sample Information								Requested Analysis						
Lab #	Sample ID	Grab/Composite	Matrix	Date Collected	Time Collected	Pres. Chilled	Sample Container	TPMS/BTEX	Organics	8260				
B22438	MW-8	G	W	12/30/98		Yes	VAD3	✓	✓					
B22439	MW-9							✓	✓					
B22440	MW-10							✓	✓					
B22441	MW-11							✓	✓					
B22442	MW-12							✓	✓					
B22443	MW-13							✓	✓					
B22444														

Relinquished By: <u>Tom Price</u>	Received By: <u>J. Medina</u>	Date: <u>12-31-98</u>	Time: <u>11:15am</u>
Relinquished By: <u>J. Medina</u>	Received By: <u>VAD3</u>	Date: <u>12-31-98</u>	Time: <u>11:50am</u>
Relinquished By:	Received By: <u>1/5/99</u>	Date:	Time: