



Scale: 1" = 10'

Direction of Groundwater Flow Based on Water Levels in the Groundwater Monitoring Wells



MW-4

300 Gallons Used Oil Tank

R.T. Nahas Co., Union 76
20405 Redwood Road
Castro Valley, CA

Service Station Building

Vent Lines

Concrete

Pump Island

10,000 Gal. Super Gasoline Tank

10,000 Gal. Unleaded Gasoline Tank

Pump Lines

Pump Island

Fill Nozzle

Asphalt

MW-3

MW-2

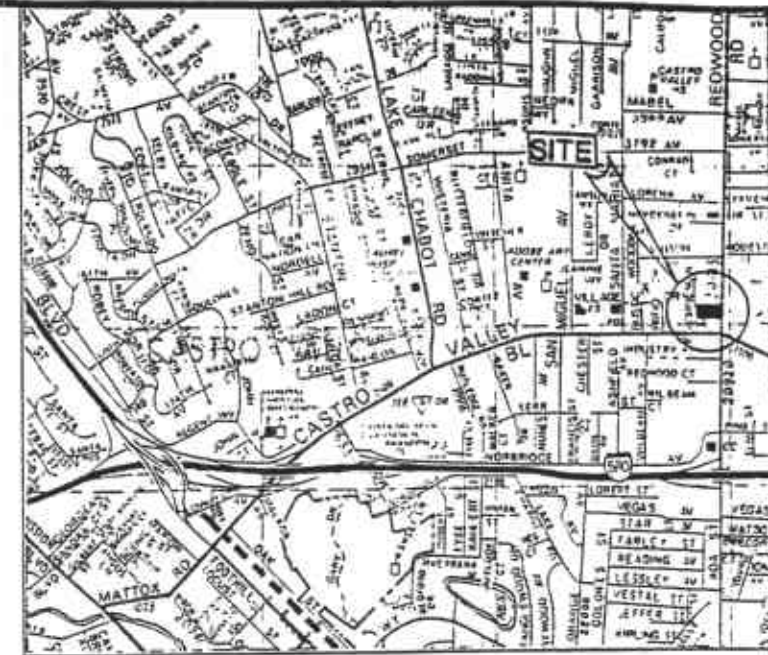

MW-1A

MW-1



VICINITY MAP (N.T.S.)

LEGEND:

-  MW-2, MW-3 and MW-4 denote existing groundwater monitoring wells installed in December 1989.
-  MW-1 and MW-1A denote well drilled, sampled and backfilled to surface with cement grout (exploration borings) in December 1989.

SITE PLAN

SECOND QUARTERLY MONITORING EXISTING MONITORING WELLS

Unocal Station
20405 Redwood Road
Castro Valley, CA

Job No. P90165
October 1990
FIGURE 1

BSK
& Associates

REDWOOD ROAD

SIDEWALK