

Environmental Management
Company
6001 Bollinger Canyon Rd, K2256
P.O. Box 6012
San Ramon, CA 94583-2324
Tel 925-842-1589
Fax 925-842-8370

Karen Streich
Project Manager

R-2804 ✓

ChevronTexaco

February 15, 2005

Alameda County Health Care Services
1131 Harbor Bay Parkway, Suite 250
Alameda, CA 94502-6577

Alameda County
FEB 16 2005
Environmental Health

Re: Chevron Service Station # 9-0121

Address: 3026 Lakeshore Ave., Oakland, California

I have reviewed the attached routine groundwater monitoring report dated January 27, 2005.

I agree with the conclusions and recommendations presented in the referenced report. The information in this report is accurate to the best of my knowledge and all local Agency/Regional Board guidelines have been followed. This report was prepared by Gettler-Ryan, Inc., upon whose assistance and advice I have relied.

This letter is submitted pursuant to the requirements of California Water Code Section 13267(b)(1) and the regulating implementation entitled Appendix A pertaining thereto.

I declare under penalty of perjury that the foregoing is true and correct.

Sincerely,



Karen Streich
Project Manager

Enclosure: Report



GETTLER-RYAN INC.

TRANSMITTAL

January 27, 2005

G-R #386462

TO: Mr. Robert Foss
Cambria Environmental Technology Inc.
5900 Hollis Street, Suite A
Emeryville, CA 94608

CC: Ms. Karen Streich
ChevronTexaco Company
P.O. Box 6012, Room K2256
San Ramon, California 94583

Alameda County
FEB 16 2005
Environmental Health

FROM: Deanna L. Harding
Project Coordinator
Gettler-Ryan Inc.
6747 Sierra Court, Suite J
Dublin, California 94568

TO: Chevron Service Station
#9-0121
3026 Lakeshore Avenue
Oakland, California
RO 0000284

WE HAVE ENCLOSED THE FOLLOWING:

COPIES	DATED	DESCRIPTION
1	January 26, 2005	Groundwater Monitoring and Sampling Report Fourth Quarter - Event of December 23, 2004

COMMENTS:

Please provide any comments/changes and propose any groundwater monitoring modifications for the next event prior to **February 14, 2005**, at which time the final report will be distributed to the following:

cc: Mr. Barney Chan, Alameda County Health Care Services, Dept. of Environmental Health, 1131 Harbor Bay Parkway, Suite 250, Alameda, CA 94502-6577

Enclosures

trans/9-0121-KS



GETTLER-RYAN INC.

January 26, 2005
G-R Job #386462

Ms. Karen Streich
ChevronTexaco Company
P.O. Box 6012, Room K2256
San Ramon, CA 94583

RE: Fourth Quarter Event of December 23, 2004
Groundwater Monitoring & Sampling Report
Chevron Service Station #9-0121
3026 Lakeshore Avenue
Oakland, California

Dear Ms. Streich:

This report documents the most recent groundwater monitoring and sampling event performed by Gettler-Ryan Inc. (G-R) at the referenced site. All field work was conducted in accordance with G-R Standard Operating Procedure - Groundwater Sampling (attached).

Static groundwater levels were measured and the wells were checked for the presence of separate-phase hydrocarbons. Static water level data, groundwater elevations, and separate-phase hydrocarbon thickness (if any) are presented in the attached Table 1. A Potentiometric Map is included as Figure 1. Dissolved Oxygen concentrations are presented in Table 2.

Groundwater samples were collected from the monitoring wells and submitted to a state certified laboratory for analyses. The field data sheets for this event are attached. Analytical results are presented in the table(s) listed below. The chain of custody document and laboratory analytical report are also attached.

Please call if you have any questions or comments regarding this report. Thank you.

Sincerely,

Deanna L. Harding
Project Coordinator

Hagop Kevork
P.E. No. C55734



Figure 1: Potentiometric Map
Table 1: Groundwater Monitoring Data and Analytical Results
Table 2: Dissolved Oxygen Concentrations
Table 3: Groundwater Analytical Results
Attachments: Standard Operating Procedure - Groundwater Sampling
Field Data Sheets
Chain of Custody Document and Laboratory Analytical Reports

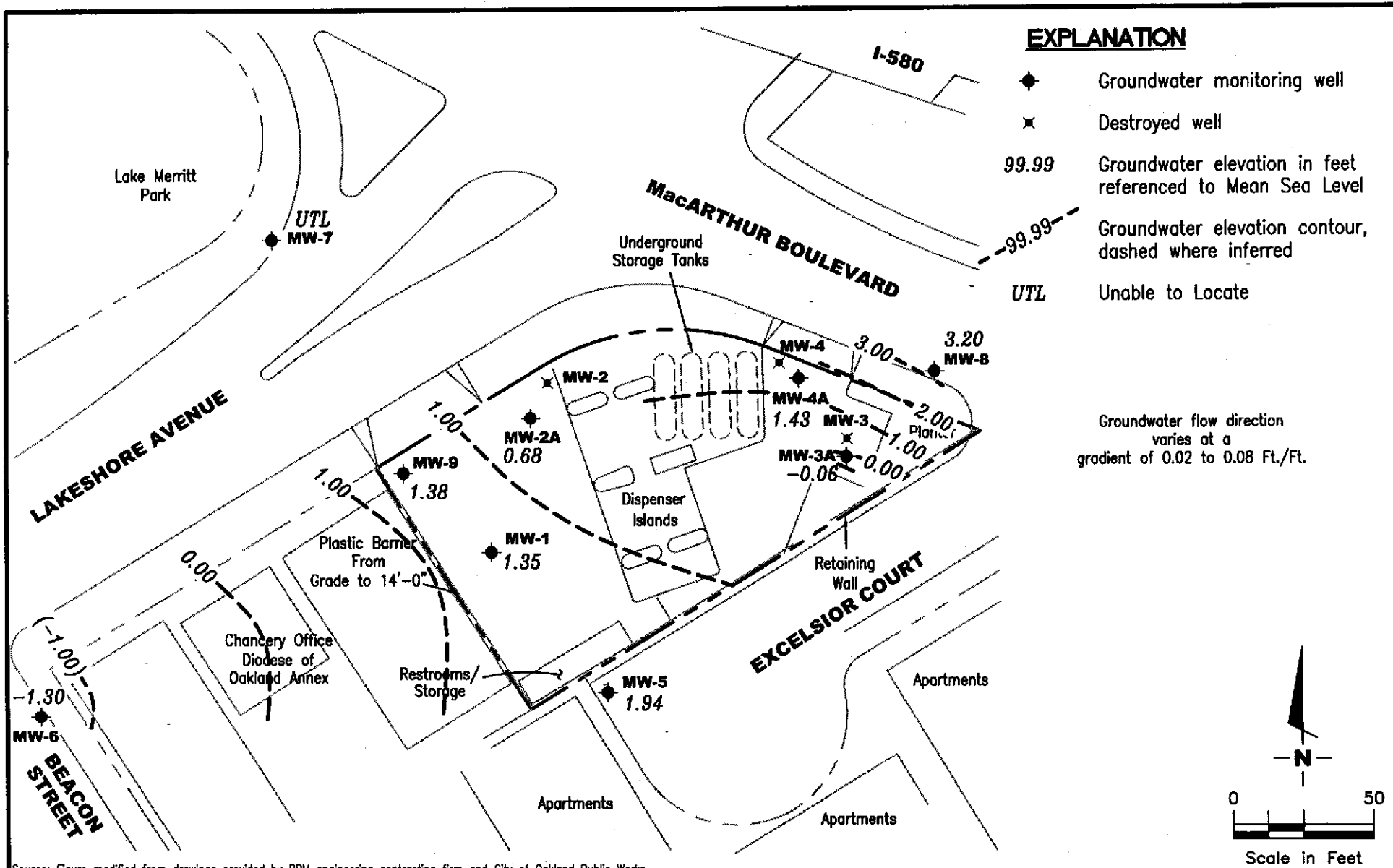

EXPLANATION

- ◆ Groundwater monitoring well
- ✕ Destroyed well
- 99.99 Groundwater elevation in feet referenced to Mean Sea Level
- 99.99 Groundwater elevation contour, dashed where inferred
- UTL Unable to Locate

Groundwater flow direction varies at a gradient of 0.02 to 0.08 Ft./Ft.

Source: Figure modified from drawings provided by RRM engineering contracting firm and City of Oakland Public Works.

GETTLER - RYAN INC.
 6747 Sierra Court, Suite J
 Dublin, CA 94568 (925) 551-7555

POTENTIOMETRIC MAP
 Chevron Service Station #9-0121
 3026 Lakeshore Avenue
 Oakland, California

FIGURE
1

PROJECT NUMBER 386462	REVIEWED BY	DATE December 23, 2004	REVISED DATE
---------------------------------	-------------	----------------------------------	--------------

Table 1
Groundwater Monitoring Data and Analytical Results
 Chevron Service Station #9-0121
 3026 Lakeshore Avenue
 Oakland, California

WELL ID/ DATE	TOC (ft.)	GWE (msl)	DTW (ft.)	SPHT (ft.)	SPH REMOVED (gallons)	TPH-D (ppb)	TPH-G (ppb)	B (ppb)	T (ppb)	E (ppb)	X (ppb)	MTBE (ppb)	ETHANOL ♦ (ppb)	TDS (ppb)
MW-1														
08/20/91	6.82	1.62	5.20	--	--	260	5,100	1,700	21	220	34	--	--	--
09/30/91	6.82	1.15	5.67	Sheen	--	--	--	--	--	--	--	--	--	--
10/28/91	6.82	1.50	5.30	0.03	--	--	--	--	--	--	--	--	--	--
01/08/92	6.82	1.67	5.15	Sheen	--	4,400	5,400	770	13	95	31	--	--	--
01/13/92	6.82	--	--	--	--	--	--	--	--	--	--	--	--	--
06/23/92	6.89	1.48	5.41	--	--	2,000	7,700	1,500	40	230	100	--	--	--
08/24/92	6.89	1.12	5.77	--	--	--	--	--	--	--	--	--	--	--
09/21/92	6.89	1.00	5.89	--	--	<50	3,500	1,700	28	190	78	--	--	--
10/26/92	6.89	0.95	5.94	--	--	--	--	--	--	--	--	--	--	--
12/23/92	6.89	2.18	4.71	--	--	5,500	60,000	7,100	240	2,000	1,300	--	--	--
01/08/93	6.89	--	--	--	--	--	--	--	--	--	--	--	--	--
03/25/93	6.89	2.17	4.72	--	--	<10	530	1,100	41	67	79	--	--	--
06/11/93	6.89	5.37	5.07	--	--	--	7,000	1,900	33	120	69	9,600	--	840
09/29/93	6.89	1.13	5.76	--	--	<10	6,600	1,600	28	43	74	--	--	--
12/20/93	6.89	1.74	5.15	--	--	<10	6,300	1,900	36	82	65	--	--	--
03/07/94	6.89	2.21	4.68	--	--	<10	7,700	1,100	55	66	38	12,000	--	--
06/17/94	6.89	1.83	5.06	--	--	2,200	4,300	710	12	90	38	--	--	--
09/12/94	6.89	1.24	5.65	--	--	2,500	6,400	1,500	<25	180	<25	12,000	--	--
11/30/94	6.89	2.32	4.57	--	--	2,300 ¹	4,900	690	26	97	60	3,900	--	--
03/24/95	6.89	3.91	2.98	--	--	1,400 ²	1,800	160	7.3	11	14	1,300	--	--
06/27/95	6.89	1.87	5.02	--	--	2,300 ²	4,600	1,300	11	97	13	5,100	--	--
09/28/95	6.89	1.59	5.30	--	--	3,900 ²	6,600	1,500	<20	<20	<20	5,800	--	--
12/19/95	6.89	2.21	4.68	--	--	2,600 ²	3,800	930	<10	100	<10	6,300	--	--
02/28/96	6.89	3.27	3.62	--	--	1,800 ²	3,600	280	<5.0	18	5.5	2,200	--	--
06/25/96	6.89	1.87	5.02	--	--	3,000	4,700	1,600	36	150	31	3,000	--	--
12/17/96	6.89	2.23	4.66	--	--	2,700 ³	7,800	1,000	28	340	63	1,200	--	--
03/31/97	6.89	2.01	4.88	--	--	2,200 ²	5,300	590	55	210	53	950	--	--
06/30/97	6.89	1.32	5.57	--	--	2,200 ²	4,400	350	<10	<10	11	580	--	--
09/12/97	6.89	1.56	5.33	--	--	2,300 ²	3,400	220	9.5	15	11	460	--	--
12/05/97	6.89	2.44	4.45	--	--	1,900 ²	4,700	870	21	120	18	750	--	--
02/16/98	6.89	3.52	3.37	--	--	1,600 ²	4,400	120	12	11	7.7	270	--	--
06/17/98	6.89	2.24	4.65	--	--	1,300 ²	7,800	<25	50	34	650	650	--	--

Table 1
Groundwater Monitoring Data and Analytical Results
Chevron Service Station #9-0121
3026 Lakeshore Avenue
Oakland, California

WELL ID/ DATE	TOC (ft.)	GWE (msl)	DTW (ft.)	SPHT (ft.)	SPH REMOVED (gallons)	TPH-D (ppb)	TPH-G (ppb)	B (ppb)	T (ppb)	E (ppb)	X (ppb)	MTBE (ppb)	ETHANOL ♦ (ppb)	TDS (ppb)
MW-1 (cont)														
08/31/98	6.89	1.70	5.19	--	--	2,400 ²	3,700	620	17	120	31	380	--	--
12/28/98	6.89	1.94	4.95	--	--	1,500 ²	3,800	250	14	28	15	330	--	--
03/04/99	6.89	3.24	3.65	--	--	1,070 ²	1,560	17.9	<0.5	4.17	1.05	70.4	--	--
06/14/99	6.89	1.89	5.00	--	--	2,500 ²	<10,000	820	240	320	640	<500	--	--
09/17/99	6.89	0.30	6.59	--	--	2,110 ²	3,300	141	12.3	<10	<10	238	--	--
12/20/99	6.89	1.92	4.97	--	--	1,840 ²	2,990	218	16.3	20	<10	232	--	--
03/20/00	6.89	3.11	3.78	--	--	938 ²	1,340	20	3.07	1.87	1.87	29.1	--	--
06/24/00 ^S	6.89	2.45	4.44	0.00	0.00	1,680 ⁹	1,500 ⁷	12	5.3	<2.5	7.9	190	--	--
09/07/00 ^S	6.89	1.74	5.15	0.00	0.00	1,500 ⁹	3,100 ⁷	190	13	14	<10	210	--	--
12/05/00 ^S	6.89	2.16	4.73	0.00	0.00	970 ¹³	2,140 ¹⁴	248	<5.00	20.5	<5.00	<25.0	--	--
03/01/01 ^S	6.89	3.33	3.56	0.00	0.00	610 ⁹	1,000 ⁷	21	<10	<10	<10	280	--	--
06/04/01 ^S	6.89	2.13	4.76	0.00	0.00	1,100 ⁹	2,800 ⁷	310	23	11	15	470	--	--
09/10/01 ^S	6.89	1.28	5.61	0.00	0.00	2,600	2,500 ¹⁶	<20	26	<20	<20	310	--	--
12/03/01 ^S	6.89	3.31	3.58	0.00	0.00	2,700	2,400	30	7.3	7.0	6.5	160	--	--
03/04/02 ^S	6.89	2.36	4.53	0.00	0.00	2,700	3,300	120	17	22	9.0	110	--	--
05/30/02 ^S	6.89	2.41	4.48	0.00	0.00	2,700	4,100	110	9.3	22	11	100	--	--
09/03/02 ^S	6.89	1.42	5.47	0.00	0.00	2,900	3,700	<5.0	7.8	3.2	10	130	--	--
12/09/02 ^S	6.89	1.61	5.28	0.00	0.00	3,000	2,900	35	5.1	5.5	8.3	170	--	--
03/10/03 ^S	6.89	2.50	4.39	0.00	0.00	1,600	3,000	42	5.0	8.2	8.7	110	--	--
06/09/03 ^{S,1R}	6.89	2.53	4.36	0.00	0.00	2,000	5,200	140	16	20	15	100	--	--
09/08/03 ^{S,1R}	6.89	1.52	5.37	0.00	0.00	2,100	3,500	4	10	2	11	200	<50	--
12/08/03 ^{S,1R}	6.89	2.44	4.45	0.00	0.00	3,400	2,200	8	4	3	8	160	<50	--
03/09/04 ^{1R,20}	6.89	2.86	4.03	0.00	0.00	3,300	1,500	16	3	5	4	99	<130	--
06/17/04 ^{1R}	6.89	1.41	5.48	0.00	0.00	2,700	3,400	180	13	27	13	160	<50	--
09/15/04 ^{1R}	6.89	-0.91	7.80	0.00	0.00	2,600	1,700	2	1	0.8	5	180	<50	--
12/23/04 ^{1R}	6.89	1.35	5.54	0.00	0.00	3,000	1,800	120	3	5	5	120	<50	--
MW-2														
08/20/91	6.27	1.92	4.35	--	--	600	9,300	3,700	55	530	75	--	--	--
09/30/91	6.27	1.28	4.99	--	--	--	3,500	2,600	47	440	68	--	--	--
10/28/91	6.27	1.36	4.91	--	--	--	4,600	1,800	29	290	53	--	--	--
01/08/92	6.27	1.63	4.64	Sheen	--	--	14,000	4,300	70	<25	130	--	--	--

Table 1
Groundwater Monitoring Data and Analytical Results
Chevron Service Station #9-0121
3026 Lakeshore Avenue
Oakland, California

WELL ID/ DATE	TOC (ft.)	GWE (msl)	DTW (ft.)	SPHT (ft.)	SPH REMOVED (gallons)	TPH-D (ppb)	TPH-G (ppb)	B (ppb)	T (ppb)	E (ppb)	X (ppb)	MTBE (ppb)	ETHANOL ♦ (ppb)	TDS (ppb)
MW-2 (cont)														
01/13/92	6.27	--	--	--	--	38,000	--	--	--	--	--	--	--	--
06/23/92	6.27	1.63	4.64	0.02	--	--	--	--	--	--	--	--	--	--
08/24/92	6.27	1.34	4.94	0.02	--	--	--	--	--	--	--	--	--	--
09/21/92	6.27	1.20	5.08	0.01	--	--	--	--	--	--	--	--	--	--
10/26/92	6.27	0.34	5.93	--	--	--	--	--	--	--	--	--	--	--
12/23/92	6.27	--	--	--	--	160,000	21,000	5,400	59	1,300	160	--	--	--
01/08/93	6.27	2.57	3.70	--	--	--	--	--	--	--	--	--	--	--
03/25/93	6.27	2.89	3.38	Sheen	--	--	--	--	--	--	--	--	--	--
06/11/93	6.27	2.09	4.18	--	--	--	5,900	1,100	23	240	51	--	--	2,300
09/29/93	6.27	0.07	6.20	--	--	--	--	--	--	--	--	--	--	--
12/20/93	6.27	1.94	4.35	0.02	--	--	--	--	--	--	--	--	--	--
03/07/94	6.27	2.60	3.67	--	--	<10	26,000	5,700	170	1,000	150	--	--	--
06/17/94	6.27	2.25	4.02	Sheen	--	--	--	--	--	--	--	--	--	--
09/12/94	6.27	1.45	4.83	0.01	--	--	--	--	--	--	--	--	--	--
11/30/94	6.27	2.27	4.00	--	--	INACCESSIBLE	--	--	--	--	--	--	--	--
03/24/95	6.27	2.73	4.01	0.59	--	--	--	--	--	--	--	--	--	--
06/27/95	6.27	1.71	4.96	0.50	0.013	--	--	--	--	--	--	--	--	--
09/28/95	6.27	2.62	4.25	0.75	0.013	--	--	--	--	--	--	--	--	--
12/19/95	6.27	1.99	4.76	0.60	0.010	--	--	--	--	--	--	--	--	--
02/28/96	6.27	1.99	4.58	0.38	0.008	--	--	--	--	--	--	--	--	--
06/25/96	6.27	2.36	4.29	0.47	0.030	--	--	--	--	--	--	--	--	--
12/17/96	6.27	2.22	4.16	0.14	--	--	--	--	--	--	--	--	--	--
03/31/97	6.27	2.34	4.07	0.18	0.030	--	--	--	--	--	--	--	--	--
06/30/97	6.27	2.06	4.32	0.14	0.030	--	--	--	--	--	--	--	--	--
09/12/97	6.27	2.00	4.38	0.14	--	--	--	--	--	--	--	--	--	--
12/05/97	6.27	2.51	3.78	0.02	--	--	--	--	--	--	--	--	--	--
02/16/98	6.27	3.08	3.29	0.12	0.007	--	--	--	--	--	--	--	--	--
06/17/98	6.27	2.35	4.00	0.10	0.010	--	--	--	--	--	--	--	--	--
08/31/98	6.27	0.65	5.71	0.11	0.008	--	--	--	--	--	--	--	--	--
12/28/98	6.27	1.75	4.60	0.10	0.005	--	--	--	--	--	--	--	--	--
03/04/99	6.27	2.58	3.73	0.05	0.200	--	--	--	--	--	--	--	--	--
DESTROYED														

Table 1
Groundwater Monitoring Data and Analytical Results
 Chevron Service Station #9-0121
 3026 Lakeshore Avenue
 Oakland, California

WELL ID/ DATE	TOC (ft.)	GWE (mst)	DTW (ft.)	SPHT (ft.)	SPH REMOVED (gallons)	TPH-D (ppb)	TPH-G (ppb)	B (ppb)	T (ppb)	E (ppb)	X (ppb)	MTBE (ppb)	ETHANOL ♦ (ppb)	TDS (ppb)
MW-2A														
04/19/99	6.53	1.67	4.86	--	--	820 ²	<2,000	<20	<20	<20	<20	9,200	--	--
06/14/99	6.53	1.23	5.30	--	--	2,000 ²	<5,000	89	<50	66	<50	10,000	--	--
09/17/99	6.53	0.69	5.84	--	--	1,050 ²	903	42	1.63	22.8	7.74	11,400	--	--
12/20/99	6.53	-0.07	6.60	--	--	2,820 ²	2,280	115	<10	87.2	27.2	14,000	--	--
03/20/00	6.53	1.74	4.79	--	--	1,220 ²	1,040	54.3	<5.0	33.8	12.1	10,900 ²	--	--
06/24/00	6.53	1.28	5.25	0.00	0.00	1,300 ⁹	690 ⁷	50	2.5	18	9.5	15,000 ⁸	--	--
09/07/00	6.53	1.09	5.44	0.00	0.00	770 ⁹	310 ⁷	6.7	1.4	1.6	3.8	16,000	--	--
12/05/00	6.53	1.16	5.37	0.00	0.00	810 ¹³	414 ¹⁴	32.4	<0.500	7.49	5.96	8,910 ⁸	--	--
03/01/01	6.53	2.03	4.50	0.00	0.00	590 ⁹	370 ⁷	30	4.0	12	9.2	8,200	--	--
06/04/01	6.53	1.36	5.17	0.00	0.00	930 ⁹	<500	19	<5.0	<5.0	<5.0	7,800	--	--
09/10/01	6.53	0.79	5.74	0.00	0.00	2,400	<5,000	<50	<50	<50	<50	9,700	--	--
12/03/01	6.53	1.46	5.07	0.00	0.00	2,500	480	4.5	<1.0	1.1	<3.0	10,000	--	--
03/04/02	6.53	1.52	5.01	0.00	0.00	2,300	630	5.4	1.5	2.9	2.3	7,000	--	--
05/30/02	6.53	1.66	4.87	0.00	0.00	2,100	520	6.1	<1.0	2.6	5.4	7,100	--	--
09/03/02	6.53	1.03	5.50	0.00	0.00	2,600	590	7.8	0.98	2.9	7.8	7,800	--	--
12/09/02	6.53	1.06	5.47	0.00	0.00	1,900	670	7.9	0.88	2.1	5.0	8,300	--	--
03/10/03	6.53	1.52	5.01	0.00	0.00	1,700	640	8.0	0.76	2.6	4.1	7,500	--	--
06/09/03 ^{1R}	6.53	1.77	4.76	0.00	0.00	1,900	540	3	<3	<3	<3	6,800	--	--
09/08/03 ^{1R}	6.53	1.16	5.37	0.00	0.00	2,000	540	3	0.7	0.7	3	7,000	<50	--
12/08/03 ^{1R}	6.53	1.34	5.19	0.00	0.00	3,100	480	<5	<5	<5	<5	6,500	<500	--
03/09/04 ^{1R}	6.53	1.81	4.72	0.00	0.00	1,200	1,300	44	2	15	10	2,900	<130	--
06/17/04 ^{1R}	6.53	-0.07	6.60	0.00	0.00	2,300	920	23	2	6	12	1,700	<100	--
09/15/04 ^{1R}	6.53	-2.34	8.87	0.00	0.00	1,900	880	6	2	<1	7	2,100	<100	--
12/23/04 ^{1R}	6.53	0.68	5.85	0.00	0.00	2,200	430	6	<3	<3	<3	5,100	<250	--
MW-3														
08/20/91	8.71	0.26	8.45	--	--	200	3,100	200	13	15	12	--	--	--
09/30/91	8.71	-0.03	8.74	--	--	--	1,000	150	8.3	13	6.7	--	--	--
10/28/91	8.71	-0.05	8.76	--	--	--	1,200	120	6.7	11	7.5	--	--	--
01/08/92	8.71	-0.06	8.77	--	--	--	410	120	0.9	4.1	3.4	--	--	--
01/13/92	8.71	--	--	--	--	220	--	--	--	--	--	--	--	--
06/23/92	8.71	0.03	8.68	--	--	<50	630	43	0.8	8.2	3.4	--	--	--

Table 1
Groundwater Monitoring Data and Analytical Results
Chevron Service Station #9-0121
3026 Lakeshore Avenue
Oakland, California

WELL ID/ DATE	TOC (ft.)	GWE (msl)	DTW (ft.)	SPHT (ft.)	SPH REMOVED (gallons)	TPH-D (ppb)	TPH-G (ppb)	B (ppb)	T (ppb)	E (ppb)	X (ppb)	MTBE (ppb)	ETHANOL ♦ (ppb)	TDS (ppb)
MW-3 (cont)														
08/24/92	8.71	-0.14	8.85	--	--	--	--	--	--	--	--	--	--	--
09/21/92	8.71	-0.23	8.94	--	--	<50	1,800	730	1.4	66	39	--	--	--
10/26/92	8.71	-0.36	9.07	--	--	--	--	--	--	--	--	--	--	--
12/23/92	8.71	--	--	--	--	850	840	270	3.4	15	4.2	--	--	--
01/08/93	8.71	1.02	7.69	--	--	--	--	--	--	--	--	--	--	--
03/25/93	8.71	0.97	7.74	--	--	<10	760	270	4.0	10	5.0	--	--	--
06/11/93	8.71	0.19	8.52	--	--	--	200	32	1.0	5.0	2.0	--	--	5,600
09/29/93	8.71	2.66	6.05	--	--	--	9,300	2,800	60	270	62	--	--	--
12/20/93	8.71	-0.12	8.83	--	--	<10	460	250	4.0	8.0	4.0	--	--	--
03/07/94	8.71	0.64	8.07	--	--	<10	2,400	260	13	35	18	--	--	--
06/17/94	8.71	0.19	8.52	--	--	<50	1,000	200	4.0	6.6	6.7	--	--	--
09/12/94	8.71	-0.21	8.92	--	--	<50	360	130	3.4	4.8	3.3	130	--	--
11/30/94	8.71	0.58	8.13	--	--	INACCESSIBLE		--	--	--	--	--	--	--
03/24/95	8.71	1.93	6.78	--	--	1,200 ²	4,100	920	<10	23	<10	70	--	--
06/27/95	8.71	0.49	8.22	--	--	1,000 ²	3,100	640	16	31	<10	<50	--	--
09/28/95	8.71	-0.14	8.85	--	--	460 ²	490	78	3.4	4.4	2.4	38	--	--
12/19/95	8.71	0.69	8.02	--	--	650 ²	2,600	580	<10	25	<10	<50	--	--
02/28/96	8.71	1.16	7.55	--	--	780 ²	1,500	510	<5.0	9.9	<5.0	<25	--	--
06/25/96	8.71	0.34	8.37	--	--	1,200 ²	1,300	390	7.8	14	6.5	31	--	--
12/17/96	8.71	0.41	8.30	--	--	1,100 ²	760	85	<1.2	5.9	5.1	<6.2	--	--
03/31/97	8.71	0.52	8.19	--	--	1,300 ²	2,000	380	12	24	12	<25	--	--
06/30/97	8.71	0.00	8.71	--	--	620 ²	1,900	340	9.9	23	6.1	<25	--	--
09/12/97	8.71	1.07	7.64	--	--	400 ²	1,200	200	4.6	14	4.8	3.9	--	--
12/05/97	8.71	0.46	8.25	--	--	190 ²	460	72	2.7	5.2	1.7	<5.0	--	--
02/16/98	8.71	1.71	7.00	--	--	1,000 ²	6,200	1,100	20	34	12	<50	--	--
06/17/98	8.71	0.71	8.00	--	--	1,100 ²	3,000	350	<10	<10	<10	120	--	--
08/31/98	8.71	0.08	8.63	--	--	790 ²	430	100	2.6	8.6	6.0	<12	--	--
12/28/98	8.71	-0.02	8.73	--	--	180 ²	1,400	220	<10	12	<10	<50	--	--
03/04/99	8.71	1.06	7.65	--	--	763 ²	2,880	355	9.15	19	<5.0	<20	--	4
DESTROYED														

Table 1
Groundwater Monitoring Data and Analytical Results
Chevron Service Station #9-0121
3026 Lakeshore Avenue
Oakland, California

WELL ID/ DATE	TOC (<i>ft.</i>)	GWE (<i>msf</i>)	DTW (<i>ft.</i>)	SPHT (<i>ft.</i>)	SPH REMOVED (<i>gallons</i>)	TPH-D (<i>ppb</i>)	TPH-G (<i>ppb</i>)	B (<i>ppb</i>)	T (<i>ppb</i>)	E (<i>ppb</i>)	X (<i>ppb</i>)	MTBE (<i>ppb</i>)	ETHANOL ♦ (<i>ppb</i>)	TDS (<i>ppb</i>)
MW-3A														
04/19/99	8.70	1.00	7.70	--	--	93 ²	<50	<0.5	<0.5	<0.5	<0.5	3.1	--	--
06/14/99	8.70	0.50	8.20	--	--	160 ²	148	4.55	0.82	0.53	1.1	3.7	--	--
09/17/99	8.70	-0.02	8.72	--	--	101 ²	169	6.02	0.806	0.515	0.786	4.68	--	--
12/20/99	8.70	-0.22	8.92	--	--	153 ²	<50	1.82	<0.5	<0.5	<0.5	11	--	--
03/20/00	8.70	1.06	7.64	--	--	223 ²	140	5.08	0.695	<0.5	<0.5	10.1	--	--
06/24/00	8.70	0.32	8.38	0.00	0.00	128 ⁹	<50	0.74	<0.50	<0.50	<0.50	34	--	--
09/07/00	8.70	-0.09	8.79	0.00	0.00	<50	<50	1.4	<0.50	<0.50	<0.50	15	--	--
12/05/00	8.70	0.02	8.68	0.00	0.00	<50	<50.0	1.39	<0.500	<0.500	<0.500	12.9	--	--
03/01/01	8.70	0.88	7.82	0.00	0.00	66 ¹¹	<50	1.0	<0.50	<0.50	<0.50	19	--	--
06/04/01	8.70	0.25	8.45	0.00	0.00	69 ⁹	<50	2.0	<0.50	<0.50	<0.50	37	--	--
09/10/01	8.70	-0.40	9.10	0.00	0.00	<50	<50	3.9	<0.50	<0.50	<0.50	19	--	--
12/03/01	8.70	0.62	8.08	0.00	0.00	56	<50	<0.50	<0.50	<0.50	<1.5	19	--	--
03/04/02	8.70	-0.24	8.94	0.00	0.00	85	<50	<0.50	<0.50	<0.50	<1.5	26	--	--
05/30/02	8.70	-0.08	8.78	0.00	0.00	210	<50	<0.50	<0.50	<0.50	<1.5	22	--	--
09/03/02	8.70	-0.28	8.98	0.00	0.00	89	<50	<0.50	<0.50	<0.50	<1.5	24	--	--
12/09/02	8.70	-0.20	8.90	0.00	0.00	110	<50	<0.50	<0.50	<0.50	<1.5	22	--	--
03/10/03	8.70	0.58	8.12	0.00	0.00	66	<50	<0.50	<0.50	<0.50	<1.5	40	--	--
06/09/03 ^{1R}	8.70	0.47	8.23	0.00	0.00	82	<50	<0.5	0.5	<0.5	<0.5	35	--	--
09/08/03 ^{1R}	8.70	-0.06	8.76	0.00	0.00	110	<50	<0.5	<0.5	<0.5	<0.5	27	<50	--
12/08/03 ^{1R}	8.70	0.20	8.50	0.00	0.00	74 ¹⁹	<50	<0.5	<0.5	<0.5	<0.5	23	<50	--
03/09/04 ^{1R}	8.70	0.99	7.71	0.00	0.00	410	53	1	<0.5	<0.5	<0.5	28	<50	--
06/17/04 ^{1R}	8.70	0.18	8.52	0.00	0.00	430	180	1	<0.5	<0.5	<0.5	3	<50	--
09/15/04 ^{1R}	8.70	-0.42	9.12	0.00	0.00	280	92	<0.5	<0.5	<0.5	<0.5	63	<50	--
12/23/04 ^{1R}	8.70	-0.06	8.76	0.00	0.00	330	76	<0.5	<0.5	<0.5	<0.5	5	<50	--
MW-4														
08/20/91	7.37	1.32	5.05	--	--	160	1,800	870	4.0	3.0	9.0	--	--	--
09/30/91	7.37	1.70	5.67	--	--	--	670	830	5.5	2.7	12	--	--	--
10/28/91	7.37	1.56	5.81	--	--	--	2,800	990	5.8	4.8	19	--	--	--
01/08/92	7.37	2.03	5.34	--	--	--	2,900	1,200	10	7.0	18	--	--	--
01/13/92	7.37	--	--	--	--	1,000	--	--	--	--	--	--	--	--
06/23/92	7.37	2.00	5.37	--	--	<50	1,600	380	6.5	3.0	12	--	--	--

Table 1
Groundwater Monitoring Data and Analytical Results
Chevron Service Station #9-0121
3026 Lakeshore Avenue
Oakland, California

WELL ID/ DATE	TOC (ft.)	GWE (msl)	DTW (ft.)	SPHT (ft.)	SPH REMOVED (gallons)	TPH-D (ppb)	TPH-G (ppb)	B (ppb)	T (ppb)	E (ppb)	X (ppb)	MTBE (ppb)	ETHANOL ♦ (ppb)	TDS (ppb)
MW-4 (cont)														
08/24/92	7.37	1.62	5.75	--	--	--	--	--	--	--	--	--	--	--
09/21/92	7.37	1.42	5.95	--	--	<50	1,200	480	5.6	3.7	11	--	--	--
10/26/92	7.37	1.41	5.96	--	--	--	--	--	--	--	--	--	--	--
12/23/92	7.37	--	--	--	--	1,800	1,500	700	3.6	3.2	11	--	--	--
01/08/93	7.37	2.73	4.64	--	--	--	--	--	--	--	--	--	--	--
03/25/93	7.37	2.95	4.42	--	--	<10	520	160	3.0	1.0	4.0	--	--	--
06/11/93	7.37	2.25	5.12	--	--	--	1,200	430	5.0	6.0	11	--	--	2,600
09/29/93	7.37	1.57	5.80	--	--	--	1,300	210	8.0	2.0	14	--	--	--
12/20/93	7.37	2.27	5.10	--	--	3,900	570	230	5.0	4.0	8.0	--	--	--
03/07/94	7.37	2.36	5.01	--	--	2,600	2,200	290	18	2.5	11	22,000	--	--
06/17/94	7.37	1.55	5.82	--	--	2,800	2,100	480	11	4.3	9.5	--	--	--
09/12/94	7.37	1.73	5.64	--	--	3,000	1,700	340	6.1	2.7	9.7	63,000	--	--
11/30/94	7.37	1.79	5.58	--	--	INACCESSIBLE		--	--	--	--	--	--	--
03/24/95	7.37	2.42	4.95	--	--	3,000 ²	1,500	280	<5.0	<5.0	6.9	12,000	--	--
06/27/95	7.37	-1.42	8.79	--	--	3,100 ²	<10,000	310	<100	<100	<100	32,000	--	--
09/28/95	7.37	1.52	5.85	--	--	6,300 ²	330	64	1.1	<0.5	<0.5	630	--	--
12/19/95	7.37	1.87	5.50	--	--	3,400 ²	3,000	520	<25	<25	<25	44,000	--	--
02/28/96	7.37	2.27	5.10	--	--	4,700 ²	<10,000	230	<100	<100	<100	32,000	--	--
06/25/96	7.37	1.59	5.78	--	--	3,100	<10,000	160	<100	<100	<100	31,000	--	--
12/17/96	7.37	1.42	5.95	--	--	3,600 ¹	<5,000	110	<50	<50	<50	22,000	--	--
03/31/97	7.37	1.75	5.62	--	--	2,700 ²	<2,500	130	<25	<25	<25	16,000	--	--
06/30/97	7.37	1.34	6.03	--	--	2,700 ²	<2,500	130	<25	<25	<25	14,000	--	--
09/12/97	7.37	1.68	5.69	--	--	2,100 ²	<5,000	63	<50	<50	<50	15,000	--	--
12/05/97	7.37	2.22	5.15	--	--	2,600 ²	1,300	120	<5.0	<5.0	8.5	15,000	--	--
02/16/98	7.37	1.11	6.26	--	--	1,300 ²	1,200	57	4.5	<2.5	7.0	12,000	--	--
06/17/98	7.37	2.41	4.96	--	--	530 ²	5,300	390	290	28	150	17,000	--	--
08/31/98	7.37	1.46	5.91	--	--	2,400 ²	<50	89	<0.5	<0.5	<0.5	14,000/16,000 ⁴	--	--
12/28/98	7.37	1.96	5.41	--	--	2,900 ²	1,000	52	5.6	4.6	9.1	8,400	--	--
03/04/99	7.37	2.17	5.20	--	--	4,490 ²	<2,500	85.5	40.9	<25	<25	11,400	--	--
DESTROYED														

Table 1
Groundwater Monitoring Data and Analytical Results
Chevron Service Station #9-0121
3026 Lakeshore Avenue
Oakland, California

WELL ID/ DATE	TOC (ft.)	GWE (msl)	DTW (ft.)	SPHT (ft.)	SPH REMOVED (gallons)	TPH-D (ppb)	TPH-G (ppb)	B (ppb)	T (ppb)	E (ppb)	X (ppb)	MTBE (ppb)	ETHANOL ♦ (ppb)	TDS (ppb)
MW-4A														
04/19/99	7.69	2.78	4.91	--	--	370 ²	<500	<5.0	<5.0	<5.0	<5.0	1,600	--	--
06/14/99	7.69	2.44	5.25	--	--	2,500 ²	5,360	312	<20	44	<20	2,880	--	--
09/17/99	7.69	0.32	7.37	--	--	1,430 ²	1,290	38.6	<5.0	7.01	<5.0	1,780	--	--
12/20/99	7.69	1.39	6.30	--	--	7,480 ²	852	43.5	4.63	9.18	4.36	1,070	--	--
03/20/99	7.69	2.07	5.62	--	--	1,280 ²	1,370	129	8.6	18.3	7.3	2,110	--	--
06/24/00	7.69	1.57	6.12	0.00	0.00	1,190 ⁹	190 ⁷	1.4	1.7	1.7	3.3	3,900 ⁷	--	--
09/07/00	7.69	1.43	6.26	0.00	0.00	740 ⁹	490 ⁷	15	1.9	1.1	3.9	3,300	--	--
12/05/00	7.69	1.70	5.99	0.00	0.00	560 ¹²	<500	<5.00	<5.00	<5.00	<5.00	3,380 ⁸	--	--
03/01/01	7.69	2.01	5.68	0.00	0.00	600 ⁹	<1,000	10	<10	<10	<10	4,600	--	--
06/04/01	7.69	1.09	6.60	0.00	0.00	770 ⁹	390 ¹⁵	8.4	3.8	<2.5	3.0	3,800	--	--
09/10/01	7.69	1.12	6.57	0.00	0.00	810	<500	13	<5.0	22	<5.0	4,900	--	--
12/03/01	7.69	1.74	5.95	0.00	0.00	2,100	<250	1.5	<1.0	<1.0	<3.0	3,800	--	--
03/04/02	7.69	-1.19	8.88	0.00	0.00	2,400	2,500	49	6.8	21	9.5	2,600	--	--
05/30/02	7.69	1.49	6.20	0.00	0.00	2,600	430	4.6	<1.0	2.0	<3.0	3,700	--	--
09/03/02	7.69	1.20	6.49	0.00	0.00	3,200	<500	4.5	<2.0	3.5	7.5	3,800	--	--
12/09/02	7.69	1.43	6.26	0.00	0.00	1,600	440	1.1	<0.50	0.71	<5.0	4,000	--	--
03/10/03	7.69	1.86	5.83	0.00	0.00	1,700	710	14	2.2	4.2	<10	4,100	--	--
06/09/03 ^{1R}	7.69	1.25	6.44	0.00	0.00	3,200	400	3	<1	2	<1	4,100	--	--
09/08/03 ^{1R}	7.69	1.83	5.86	0.00	0.00	3,900	1,300	28	4	4	<3	2,900	<250	--
12/08/03 ^{1R}	7.69	1.57	6.12	0.00	0.00	2,500	360	3	<3	<3	<3	3,200	<250	--
03/09/04 ^{1R}	7.69	2.32	5.37	0.00	0.00	4,300	1,400	28	5	10	3	3,200	<250	--
06/17/04 ^{1R}	7.69	1.64	6.05	0.00	0.00	7,900	6,000	140	20	52	16	1,500	<50	--
09/15/04 ^{1R}	7.69	0.29	7.40	0.00	0.00	4,200	3,300	14	5	4	6	2,400	<100	--
12/23/04 ^{1R}	7.69	1.43	6.26	0.00	0.00	2,800	1,500	7	3	4	4	3,000	<100	--
MW-5														
06/23/92	14.14	1.90	12.24	--	--	<50	<50	<0.5	<0.5	<0.5	<0.5	--	--	--
08/24/92	14.14	1.85	12.29	--	--	--	--	--	--	--	--	--	--	--
09/21/92	14.14	1.68	12.46	--	--	60	<50	<0.5	<0.5	<0.5	<0.5	--	--	--
10/26/92	14.14	1.62	12.52	--	--	--	--	--	--	--	--	--	--	--
12/23/92	14.14	3.02	11.12	--	--	--	--	--	--	--	--	--	--	--
01/08/93	14.14	--	--	--	--	--	--	--	--	--	--	--	--	--

Table 1
Groundwater Monitoring Data and Analytical Results
Chevron Service Station #9-0121
3026 Lakeshore Avenue
Oakland, California

WELL ID/ DATE	TOC (ft.)	GWE (msl)	DTW (ft.)	SPHT (ft.)	SPH REMOVED (gallons)	TPH-D (ppb)	TPH-G (ppb)	B (ppb)	T (ppb)	E (ppb)	X (ppb)	MTBE (ppb)	ETHANOL ♦ (ppb)	TDS (ppb)
MW-5 (cont)														
03/25/93	14.14	4.40	9.74	--	--	<10	<50	<0.5	<0.5	<0.5	0.9	--	--	--
06/11/93	14.14	3.70	10.44	--	--	--	<50	<0.5	<0.5	<0.5	<0.5	--	--	770
09/29/93	14.14	2.22	11.92	--	--	<10	<50	<0.5	0.6	<0.5	0.6	--	--	--
12/20/93	14.14	--	--	--	--	--	--	--	--	--	--	--	--	--
03/07/94	14.14	2.80	11.34	--	--	<10	<50	<0.5	<0.5	<0.5	<0.5	--	--	--
06/17/94	14.14	2.87	11.27	--	--	<50	<50	<0.5	<0.5	<0.5	<0.5	<5.0	--	--
09/12/94	14.14	1.28	12.86	--	--	<50	<50	<0.5	<0.5	<0.5	<0.5	--	--	--
11/30/94	14.14	2.23	11.91	--	--	99 ²	<50	<0.5	<0.5	<0.5	<0.5	--	--	--
03/24/95	14.14	4.38	9.76	--	--	<50	<50	<0.5	<0.5	<0.5	<0.5	--	--	--
06/27/95	14.14	2.74	11.40	--	--	55 ³	<50	<0.5	<0.5	<0.5	<0.5	--	--	--
09/28/95	14.14	2.24	11.90	--	--	300 ²	<50	<0.5	<0.5	<0.5	<0.5	--	--	--
12/19/95	14.14	1.56	12.58	--	--	53 ²	<50	<0.5	<0.5	<0.5	<0.5	3.1	--	--
02/28/96	14.14	2.44	11.70	--	--	<50	<50	<0.5	<0.5	<0.5	<0.5	<2.5	--	--
06/25/96	14.14	2.71	11.43	--	--	120 ²	<50	<0.5	<0.5	<0.5	<0.5	36	--	--
12/17/96	14.14	2.74	11.40	--	--	89 ²	<50	<0.5	<0.5	<0.5	<0.5	<2.5	--	--
03/31/97	14.14	2.04	12.10	--	--	150 ²	<50	<0.5	<0.5	<0.5	<0.5	<2.5	--	--
06/30/97	14.14	1.36	12.78	--	--	SAMPLED SEMI-ANNUALLY		--	--	--	--	--	--	--
09/12/97	14.14	0.46	13.68	--	--	<50	<50	<0.5	<0.5	<0.5	<0.5	<2.5	--	--
12/05/97	14.14	1.11	13.03	--	--	--	--	--	--	--	--	--	--	--
02/16/98	14.14	4.17	9.97	--	--	62 ²	<50	<0.5	<0.5	<0.5	<0.5	<2.5	--	--
06/17/98	14.14	2.29	11.85	--	--	--	--	--	--	--	--	--	--	--
08/31/98	14.14	1.32	12.82	--	--	<50	<50	<0.5	<0.5	<0.5	<0.5	<2.5	--	--
12/28/98	14.14	0.71	13.43	--	--	--	--	--	--	--	--	--	--	--
03/04/99	14.14	0.39	13.75	--	--	70.5	<50	<0.5	<0.5	<0.5	<0.5	3.34	--	--
06/14/99	14.14	0.04	14.10	--	--	--	--	--	--	--	--	--	--	--
09/17/99	14.14	-0.04	14.18	--	--	<50	<50	<0.5	<0.5	<0.5	<0.5	<2.5	--	--
12/20/99	14.14	0.44	13.70	--	--	--	--	--	--	--	--	--	--	--
03/20/00	14.14	1.50	12.64	--	--	115 ³	<50	<0.5	<0.5	<0.5	<0.5	<2.5	--	--
06/24/00	14.14	1.10	13.04	0.00	0.00	--	--	--	--	--	--	--	--	--
09/07/00	14.14	0.97	13.17	0.00	0.00	<50	<50	<0.50	<0.50	<0.50	<0.50	5.0	--	--
12/05/00	14.14	2.86	11.28	0.00	0.00	--	--	--	--	--	--	--	--	--
03/01/01	14.14	3.84	10.30	0.00	0.00	<50	<50	<0.50	<0.50	<0.50	<0.50	<2.5	--	--

Table 1
Groundwater Monitoring Data and Analytical Results
Chevron Service Station #9-0121
3026 Lakeshore Avenue
Oakland, California

WELL ID/ DATE	TOC (ft.)	GWE (msl)	DTW (ft.)	SPHT (ft.)	SPH REMOVED (gallons)	TPH-D (ppb)	TPH-G (ppb)	B (ppb)	T (ppb)	E (ppb)	X (ppb)	MTBE (ppb)	ETHANOL ♦ (ppb)	TDS (ppb)	
MW-5 (cont)															
06/04/01	14.14	2.83	11.31	0.00	0.00	SAMPLED SEMI-ANNUALLY		--	--	--	--	--	--	--	
09/10/01	14.14	1.98	12.16	0.00	0.00	<50	<50	<0.50	<0.50	<0.50	<0.50	<2.5	--	--	
12/03/01	14.14	5.52	8.62	0.00	0.00	SAMPLED SEMI-ANNUALLY		--	--	--	--	--	--	--	
03/04/02	14.14	4.29	9.85	0.00	0.00	78	<50	<0.50	<0.50	<0.50	<1.5	<2.5	--	--	
05/30/02	14.14	3.31	10.83	0.00	0.00	SAMPLED SEMI-ANNUALLY		--	--	--	--	--	--	--	
09/03/02	14.14	INACCESSIBLE - CAR PARKED OVER WELL						--	--	--	--	--	--	--	--
12/09/02	14.14	2.78	11.36	0.00	0.00	SAMPLED SEMI-ANNUALLY		--	--	--	--	--	--	--	
03/10/03	14.14	2.95	11.19	0.00	0.00	100	<50	<0.50	<0.50	<0.50	<1.5	8.2	--	--	
06/09/03	14.14	1.57	12.57	0.00	0.00	SAMPLED SEMI-ANNUALLY		--	--	--	--	--	--	--	
09/08/03 ^{1R}	14.14	2.13	12.01	0.00	0.00	65	<50	<0.5	<0.5	<0.5	<0.5	8	<50	--	
12/08/03	14.14	3.01	11.13	0.00	0.00	SAMPLED SEMI-ANNUALLY		--	--	--	--	--	--	--	
03/09/04 ^{1R}	14.14	3.56	10.58	0.00	0.00	110	<50	<0.5	<0.5	<0.5	<0.5	4	<50	--	
06/17/04	14.14	2.04	12.10	0.00	0.00	SAMPLED SEMI-ANNUALLY		--	--	--	--	--	--	--	
09/15/04 ^{1R}	14.14	1.56	12.58	0.00	0.00	92	<50	<0.5	<0.5	<0.5	<0.5	7	<50	--	
12/23/04	14.14	1.94	12.20	0.00	0.00	SAMPLED SEMI-ANNUALLY		--	--	--	--	--	--	--	
MW-6															
06/23/92	4.46	-0.68	5.14	--	--	120	<50	4.3	<0.5	0.8	0.9	--	--	--	
08/24/92	4.46	-0.49	4.95	--	--	--	--	--	--	--	--	--	--	--	
09/21/92	4.46	-0.44	4.90	--	--	<50	<250	<2.5	<2.5	<2.5	<2.5	--	--	--	
10/26/92	4.46	-1.06	5.52	--	--	--	--	--	--	--	--	--	--	--	
12/23/92	4.46	-0.94	5.40	--	--	81	<50	<0.5	<0.5	<0.5	<0.5	--	--	--	
01/08/93	4.46	--	--	--	--	--	--	--	--	--	--	--	--	--	
03/25/93	4.46	-1.64	6.10	--	--	<10	<50	<0.5	<0.5	<0.5	0.7	--	--	--	
06/11/93	4.46	-2.10	6.56	--	--	--	<50	<0.5	<0.5	<0.5	<0.5	--	--	15,000	
09/29/93	4.46	-0.71	5.17	--	--	<10	<50	<0.5	<0.5	<0.5	<0.5	--	--	--	
12/20/93	4.46	-1.47	5.93	--	--	<10	<50	<0.5	<0.5	<0.5	<0.5	--	--	--	
03/07/94	4.46	-0.81	5.27	--	--	<10	54	<0.5	<0.5	<0.5	0.6	--	--	--	
06/17/94	4.46	--	--	--	--	--	--	--	--	--	--	--	--	--	
09/12/94	4.46	-0.64	5.10	--	--	<50	<50	<0.5	<0.5	<0.5	<0.5	<50	--	--	
11/30/94	4.46	-1.12	5.58	--	--	800 ¹	<50	<0.5	<0.5	<0.5	<0.5	--	--	--	
03/24/95	4.46	-1.87	6.33	--	--	490 ²	<50	<0.5	<0.5	<0.5	<0.5	--	--	--	

Table 1
Groundwater Monitoring Data and Analytical Results
Chevron Service Station #9-0121
3026 Lakeshore Avenue
Oakland, California

WELL ID/ DATE	TOC (<i>ft.</i>)	GWE (<i>msl.</i>)	DTW (<i>ft.</i>)	SPHT (<i>ft.</i>)	SPH		TPH-D (<i>ppb.</i>)	TPH-G (<i>ppb.</i>)	B (<i>ppb.</i>)	T (<i>ppb.</i>)	E (<i>ppb.</i>)	X (<i>ppb.</i>)	MTBE (<i>ppb.</i>)	ETHANOL ♦ (<i>ppb.</i>)	TDS (<i>ppb.</i>)
					REMOVED (<i>gallons.</i>)										
MW-6 (cont)															
06/27/95	4.46	-3.74	8.20	--	--	300 ²	<50	<0.5	<0.5	<0.5	<0.5	<0.5	--	--	--
09/28/95	4.46	-0.19	4.65	--	--	1,200 ²	120	1.1	<0.5	<0.5	<0.5	<0.5	--	--	--
12/19/95	4.46	-1.58	6.04	--	--	820 ²	<50	<0.5	<0.5	<0.5	<0.5	<0.5	<2.5	--	--
02/28/96	4.46	-1.54	6.00	--	--	270 ²	<50	<0.5	<0.5	<0.5	<0.5	<0.5	<2.5	--	--
06/25/96	4.46	-1.71	6.17	--	--	750 ²	97	<0.5	<0.5	<0.5	0.71	<0.5	<2.5	--	--
12/17/96	4.46	-1.67	6.13	--	--	540 ²	65	<0.5	<0.5	<0.5	<0.5	<0.5	<2.5	--	--
03/31/97	4.46	-2.23	6.69	--	--	780 ²	65	<0.5	<0.5	<0.5	<0.5	<0.5	<2.5	--	--
06/30/97	4.46	-2.62	7.08	--	--	SAMPLED SEMI-ANNUALLY		--	--	--	--	--	--	--	--
09/12/97	4.46	-0.95	5.41	--	--	270 ²	65	<0.5	<0.5	<0.5	<0.5	<0.5	<2.5	--	--
12/05/97	4.46	-1.96	6.42	--	--	--	--	--	--	--	--	--	--	--	--
02/16/98	4.46	-0.30	4.76	--	--	330 ²	140	<0.5	<0.5	<0.5	<0.5	<0.5	<2.5	--	--
06/17/98	4.46	-1.54	6.00	--	--	--	--	--	--	--	--	--	--	--	--
08/31/98	4.46	-0.64	5.10	--	--	270 ¹	<50	<0.5	<0.5	<0.5	<0.5	<0.5	<2.5	--	--
12/28/98	4.46	-2.04	6.50	--	--	--	--	--	--	--	--	--	--	--	--
03/04/99	4.46	-1.35	5.81	--	--	638 ¹	95.5	<0.5	<0.5	<0.5	<0.5	<0.5	<2.0	--	--
06/14/99	4.46	-0.97	5.43	--	--	--	--	--	--	--	--	--	--	--	--
09/17/99	4.46	-1.74	6.20	--	--	258 ¹	<50	<0.5	<0.5	<0.5	<0.5	<0.5	<2.5	--	--
12/20/99	4.46	-2.31	6.77	--	--	--	--	--	--	--	--	--	--	--	--
03/20/00	4.46	-2.12	6.58	--	--	257 ²	<50	<0.5	<0.5	<0.5	<0.5	<0.5	<2.5	--	--
06/24/00	4.46	-2.52	6.98	0.00	0.00	SAMPLED SEMI-ANNUALLY		--	--	--	--	--	--	--	--
09/07/00	4.46	-0.46	4.92	0.00	0.00	98 ¹¹	<50	<0.50	<0.50	<0.50	<0.50	<0.50	<2.5	--	--
12/05/00	4.46	-0.64	5.10	0.00	0.00	--	--	--	--	--	--	--	--	--	--
03/01/01	4.46	-0.43	4.89	0.00	0.00	190 ⁹	<50	<0.50	<0.50	<0.50	<0.50	<0.50	<2.5	--	--
06/04/01	4.46	-0.75	5.21	0.00	0.00	SAMPLED SEMI-ANNUALLY		--	--	--	--	--	--	--	--
09/10/01	4.46	-0.65	5.11	0.00	0.00	140 ¹⁷	<50	<0.50	<0.50	<0.50	<0.50	<0.50	<2.5	--	--
12/03/01	4.46	-0.57	5.03	0.00	0.00	SAMPLED SEMI-ANNUALLY		--	--	--	--	--	--	--	--
03/04/02	4.46	INACCESSIBLE - CAR PARKED OVER WELL				--	--	--	--	--	--	--	--	--	--
05/30/02	4.46	-1.65	6.11	0.00	0.00	SAMPLED SEMI-ANNUALLY		--	--	--	--	--	--	--	--
09/03/02	4.46	-0.82	5.28	0.00	0.00	340	<500	<2.0	<2.0	<2.0	<6.0	<3.0	--	--	
12/09/02	4.46	-0.66	5.12	0.00	0.00	SAMPLED SEMI-ANNUALLY		--	--	--	--	--	--	--	--
03/10/03	4.46	-1.80	6.26	0.00	0.00	420	<50	<0.50	<0.50	<0.50	<1.5	<2.5	--	--	
06/09/03	4.46	-1.45	5.91	0.00	0.00	SAMPLED SEMI-ANNUALLY		--	--	--	--	--	--	--	--

Table 1
Groundwater Monitoring Data and Analytical Results
Chevron Service Station #9-0121
3026 Lakeshore Avenue
Oakland, California

WELL ID/ DATE	TOC (ft.)	GWE (msl)	DTW (ft.)	SPHT (ft.)	SPH REMOVED (gallons)	TPH-D (ppb)	TPH-G (ppb)	B (ppb)	T (ppb)	E (ppb)	X (ppb)	MTBE (ppb)	ETHANOL ♦ (ppb)	TDS (ppb)
MW-6 (cont)														
09/08/03 ^{1R}	4.46	-0.19	4.65	0.00	0.00	230	<50	<0.5	<0.5	<0.5	<0.5	<0.5	<50	--
12/08/03	4.46	-0.78	5.24	0.00	0.00	SAMPLED SEMI-ANNUALLY			--	--	--	--	--	--
03/09/04 ^{1R}	4.46	-1.39	5.85	0.00	0.00	1,500	<50	<0.5	<0.5	<0.5	<0.5	<0.5	<50	--
06/17/04	4.46	-1.62	6.08	0.00	0.00	SAMPLED SEMI-ANNUALLY			--	--	--	--	--	--
09/15/04 ^{1R}	4.46	-2.28	6.74	0.00	0.00	1,200	<50	<0.5	<0.5	<0.5	<0.5	<0.5	<50	--
12/23/04	4.46	-1.30	5.76	0.00	0.00	SAMPLED SEMI-ANNUALLY			--	--	--	--	--	--
MW-7														
08/24/92	5.26	-0.29	5.55	--	--	--	--	--	--	--	--	--	--	--
09/21/92	5.26	-0.39	5.65	--	--	<50	<50	<0.5	<0.5	<0.5	<0.5	--	--	--
10/26/92	5.26	-0.25	5.51	--	--	--	--	--	--	--	--	--	--	--
12/23/92	5.26	1.31	3.95	--	--	60	<50	2.9	<0.5	<0.5	<0.5	--	--	--
01/08/93	5.26	--	--	--	--	--	--	--	--	--	--	--	--	--
03/25/93	5.26	2.76	2.50	--	--	<10	<50	<0.5	<0.5	<0.5	<0.5	--	--	--
06/11/93	5.26	1.80	3.46	--	--	--	<50	0.6	<0.5	<0.5	<0.5	--	--	2,200
09/29/93	5.26	-0.26	5.52	--	--	<10	<50	2.0	1.0	1.0	7.0	--	--	--
12/20/93	5.26	0.85	4.41	--	--	<10	<50	2.0	<0.5	<0.5	<0.5	--	--	--
03/07/94	5.26	2.64	2.62	--	--	<10	<50	<0.5	<0.5	<0.5	<0.5	--	--	--
06/17/94	5.26	1.99	3.27	--	--	<50	<50	<0.5	<0.5	<0.5	<0.5	--	--	--
09/12/94	5.26	1.15	4.11	--	--	<50	<50	<0.5	<0.5	<0.5	<0.5	<5.0	--	--
11/30/94	5.26	2.50	2.76	--	--	92 ¹	<50	<0.5	<0.5	<0.5	<0.5	--	--	--
03/24/95	5.26	3.06	2.20	--	--	<50	<50	<0.5	<0.5	<0.5	<0.5	--	--	--
06/27/95	5.26	1.36	3.90	--	--	69 ²	<50	<0.5	<0.5	<0.5	<0.5	--	--	--
09/28/95	5.26	0.41	4.85	--	--	84 ²	<50	<0.5	<0.5	<0.5	<0.5	--	--	--
12/19/95	5.26	2.24	3.02	--	--	84 ²	<50	<0.5	<0.5	<0.5	<0.5	<2.5	--	--
02/28/96	5.26	3.83	1.43	--	--	99 ²	<50	<0.5	<0.5	<0.5	<0.5	<2.5	--	--
06/25/96	5.26	0.97	4.29	--	--	110 ²	<50	<0.5	<0.5	<0.5	<0.5	<2.5	--	--
12/17/96	5.26	3.08	2.18	--	--	54 ²	<50	<0.5	<0.5	<0.5	<0.5	<2.5	--	--
03/31/97	5.26	2.32	2.94	--	--	100 ²	<50	<0.5	<0.5	<0.5	<0.5	<2.5	--	--
06/30/97	5.26	1.68	3.58	--	--	SAMPLED ANNUALLY			--	--	--	--	--	--
09/12/97	5.26	1.85	3.41	--	--	--	--	--	--	--	--	--	--	--
12/05/97	5.26	3.37	1.89	--	--	--	--	--	--	--	--	--	--	--

Table 1
Groundwater Monitoring Data and Analytical Results
Chevron Service Station #9-0121
3026 Lakeshore Avenue
Oakland, California

WELL ID/ DATE	TOC (ft.)	GWE (msl)	DTW (ft.)	SPHT (ft.)	SPH REMOVED (gallons)	TPH-D (ppb)	TPH-G (ppb)	B (ppb)	T (ppb)	E (ppb)	X (ppb)	MTBE (ppb)	ETHANOL ♦ (ppb)	TDS (ppb)
MW-7 (cont)														
02/16/98	5.26	3.43	1.83	--	--	77 ²	<50	<0.5	<0.5	<0.5	<0.5	<2.5	--	--
06/17/98	5.26	3.32	1.94	--	--	--	--	--	--	--	--	--	--	--
08/31/98	5.26	1.07	4.19	--	--	--	--	--	--	--	--	--	--	--
12/28/98	5.26	0.79	4.47	--	--	--	--	--	--	--	--	--	--	--
03/04/99	5.26	3.51	1.75	--	--	73.4	<50	<0.5	<0.5	<0.5	<0.5	<2.0	--	--
06/14/99	5.26	3.64	1.62	--	--	--	--	--	--	--	--	--	--	--
09/17/99	5.26	0.42	4.84	--	--	--	--	--	--	--	--	--	--	--
12/20/99	5.26	0.45	4.81	--	--	--	--	--	--	--	--	--	--	--
03/20/00	5.26	3.41	1.85	--	--	<50	<50	<0.5	<0.5	<0.5	<0.5	<2.5	--	--
06/24/00	5.26	3.05	2.21	0.00	0.00	--	--	--	--	--	--	--	--	--
09/07/00	5.26	1.61	3.65	0.00	0.00	--	--	--	--	--	--	--	--	--
12/05/00	5.26	2.31	2.95	0.00	0.00	--	--	--	--	--	--	--	--	--
03/01/01	5.26	4.61	0.65	0.00	0.00	<50	<50	<0.50	<0.50	<0.50	<0.50	<2.5	--	--
06/04/01	5.26	3.74	1.52	0.00	0.00	--	--	--	--	--	--	--	--	--
09/10/01	5.26	1.08	4.18	0.00	0.00	SAMPLED ANNUALLY		--	--	--	--	--	--	--
12/03/01	5.26	4.20	1.06	0.00	0.00	SAMPLED ANNUALLY		--	--	--	--	--	--	--
03/04/02	5.26	3.76	1.50	0.00	0.00	<50	<50	<0.50	<0.50	<0.50	<1.5	<2.5	--	--
05/30/02	5.26	2.51	2.75	0.00	0.00	SAMPLED ANNUALLY		--	--	--	--	--	--	--
09/03/02	5.26	2.24	3.02	0.00	0.00	SAMPLED ANNUALLY		--	--	--	--	--	--	--
12/09/02	5.26	2.41	2.85	0.00	0.00	SAMPLED ANNUALLY		--	--	--	--	--	--	--
03/10/03	5.26	3.32	1.94	0.00	0.00	85	<50	<0.50	<0.50	<0.50	<1.5	<2.5	--	--
06/09/03	5.26	2.72	2.54	0.00	0.00	SAMPLED ANNUALLY		--	--	--	--	--	--	--
09/08/03	5.26	2.66	2.60	0.00	0.00	SAMPLED ANNUALLY		--	--	--	--	--	--	--
12/08/03	5.26	2.81	2.45	0.00	0.00	SAMPLED ANNUALLY		--	--	--	--	--	--	--
03/09/04 ^{1R}	5.26	4.53	0.73	0.00	0.00	230	<50	<0.5	<0.5	<0.5	<0.5	<0.5	<50	--
06/17/04	5.26	INACCESSIBLE - DUE TO ROAD WORK			--	--	--	--	--	--	--	--	--	--
09/15/04	5.26	INACCESSIBLE - DUE TO ROAD WORK			--	--	--	--	--	--	--	--	--	--
12/23/04	5.26	UNABLE TO LOCATE			--	--	--	--	--	--	--	--	--	--
MW-8														
06/23/92	8.94	-15.20	24.14	--	--	<50	<50	<0.5	<0.5	<0.5	<0.5	--	--	--
08/24/92	8.94	0.34	8.60	--	--	--	--	--	--	--	--	--	--	--

Table 1
Groundwater Monitoring Data and Analytical Results
Chevron Service Station #9-0121
3026 Lakeshore Avenue
Oakland, California

WELL ID/ DATE	TOC (ft.)	GWE (msl)	DTW (ft.)	SPHT (ft.)	SPH REMOVED (gallons)	TPH-D (ppb)	TPH-G (ppb)	B (ppb)	T (ppb)	E (ppb)	X (ppb)	MTBE (ppb)	ETHANOL ♦ (ppb)	TDS (ppb)
MW-8 (cont)														
09/21/92	8.94	0.55	8.39	--	--	<50	94	<0.5	<0.5	<0.5	<0.5	--	--	--
10/26/92	8.94	-0.18	9.12	--	--	--	--	--	--	--	--	--	--	--
12/23/92	8.94	0.83	8.11	--	--	79	<50	0.7	5.0	0.7	2.9	--	--	--
01/08/93	8.94	--	--	--	--	--	--	--	--	--	--	--	--	--
03/25/93	8.94	--	--	--	--	--	--	--	--	--	--	--	--	--
06/11/93	8.94	0.55	8.39	--	--	--	<50	<0.5	<0.5	<0.5	<0.5	--	--	3,500
09/29/93	8.94	0.69	8.25	--	--	<10	<50	<0.5	<0.5	<0.5	<0.5	--	--	--
12/20/93	8.94	0.48	8.46	--	--	<10	<50	<0.5	0.6	<0.5	1.0	--	--	--
03/07/94	8.94	0.28	8.66	--	--	<10	<50	<0.5	<0.5	<0.5	<0.5	--	--	--
06/17/94	8.94	0.12	8.82	--	--	<50	<50	<0.5	<0.5	<0.5	<0.5	--	--	--
09/12/94	8.94	0.11	8.83	--	--	<50	<50	<0.5	<0.5	<0.5	0.8	<5.0	--	--
11/30/94	8.94	0.31	8.63	--	--	120 ¹	<50	<0.5	<0.5	<0.5	<0.5	--	--	--
03/24/95	8.94	0.43	8.51	--	--	110 ²	<50	<0.5	<0.5	<0.5	<0.5	--	--	--
06/27/95	8.94	-0.03	8.97	--	--	67 ²	<50	<0.5	<0.5	<0.5	<0.5	--	--	--
09/28/95	8.94	0.04	8.90	--	--	91 ²	<50	<0.5	<0.5	<0.5	<0.5	--	--	--
12/19/95	8.94	0.54	8.40	--	--	76 ²	<50	<0.5	<0.5	<0.5	<0.5	<2.5	--	--
02/28/96	8.94	0.50	8.44	--	--	<50	<50	<0.5	<0.5	<0.5	<0.5	<2.5	--	--
06/25/96	8.94	0.05	8.89	--	--	80 ²	<50	<0.5	<0.5	<0.5	<0.5	<2.5	--	--
12/17/96	8.94	0.49	8.45	--	--	79 ²	<50	<0.5	<0.5	<0.5	<0.5	<2.5	--	--
03/31/97	8.94	0.18	8.76	--	--	72 ²	<50	<0.5	<0.5	<0.5	<0.5	3.6	--	--
06/30/97	8.94	-0.18	9.12	--	--	SAMPLED ANNUALLY		--	--	--	--	--	--	--
09/12/97	8.94	0.13	8.81	--	--	--	--	--	--	--	--	--	--	--
12/05/97	8.94	0.59	8.35	--	--	--	--	--	--	--	--	--	--	--
02/16/98	8.94	1.00	7.94	--	--	68 ²	<50	<0.5	<0.5	<0.5	<0.5	4.3	--	--
06/17/98	8.94	0.51	8.43	--	--	--	--	--	--	--	--	--	--	--
08/31/98	8.94	0.06	8.88	--	--	--	--	--	--	--	--	--	--	--
12/28/98	8.94	0.64	8.30	--	--	--	--	--	--	--	--	--	--	--
03/04/99	8.94	0.29	8.65	--	--	106	<50	<0.5	<0.5	<0.5	<0.5	3.83	--	--
06/14/99	8.94	0.52	8.42	--	--	--	--	--	--	--	--	--	--	--
09/17/99	8.94	-0.93	9.87	--	--	--	--	--	--	--	--	--	--	--
12/20/99	8.94	0.54	8.40	--	--	--	--	--	--	--	--	--	--	--
03/20/00	8.94	0.82	8.12	--	--	82.2 ⁶	<50	<0.5	<0.5	<0.5	<0.5	3.46	--	--
06/24/00	8.94	0.31	8.63	0.00	0.00	SAMPLED ANNUALLY		--	--	--	--	--	--	--

Table 1
Groundwater Monitoring Data and Analytical Results
Chevron Service Station #9-0121
3026 Lakeshore Avenue
Oakland, California

WELL ID/ DATE	TOC (ft.)	GWE (msl)	DTW (ft.)	SPHT (ft.)	SPH REMOVED (gallons)	TPH-D (ppb)	TPH-G (ppb)	B (ppb)	T (ppb)	E (ppb)	X (ppb)	MTBE (ppb)	ETHANOL ♦ (ppb)	TDS (ppb)
MW-8 (cont)														
09/07/00	8.94	0.26	8.68	0.00	0.00	--	--	--	--	--	--	--	--	--
12/05/00	8.94	0.81	8.13	0.00	0.00	--	--	--	--	--	--	--	--	--
03/01/01	8.94	1.04	7.90	0.00	0.00	51 ¹¹	<50	<0.50	<0.50	<0.50	<0.50	<2.5	--	--
06/04/01	8.94	-0.27	9.21	0.00	0.00	--	--	--	--	--	--	--	--	--
09/10/01	8.94	0.26	8.68	0.00	0.00	SAMPLED ANNUALLY		--	--	--	--	--	--	--
12/03/01	8.94	1.12	7.82	0.00	0.00	SAMPLED ANNUALLY		--	--	--	--	--	--	--
03/04/02	8.94	1.26	7.68	0.00	0.00	82	<50	<0.50	<0.50	<0.50	<1.5	<2.5	--	--
05/30/02	8.94	INACCESSIBLE - CAR PARKED OVER WELL				--	--	--	--	--	--	--	--	--
09/03/02	8.94	-0.21	9.15	0.00	0.00	SAMPLED ANNUALLY		--	--	--	--	--	--	--
12/09/02	8.94	0.21	8.73	0.00	0.00	SAMPLED ANNUALLY		--	--	--	--	--	--	--
03/10/03	8.94	0.55	8.39	0.00	0.00	110	<50	<0.50	<0.50	<0.50	<1.5	<2.5	--	--
06/09/03	8.94	-0.03	8.97	0.00	0.00	SAMPLED ANNUALLY		--	--	--	--	--	--	--
09/08/03	8.94	0.52	8.42	0.00	0.00	SAMPLED ANNUALLY		--	--	--	--	--	--	--
12/08/03	8.94	0.77	8.17	0.00	0.00	SAMPLED ANNUALLY		--	--	--	--	--	--	--
03/09/04 ¹⁸	8.94	1.03	7.91	0.00	0.00	300	<50	<0.5	<0.5	<0.5	<0.5	3	<50	--
06/17/04	8.94	0.01	8.93	0.00	0.00	SAMPLED ANNUALLY		--	--	--	--	--	--	--
09/15/04	8.94	-0.97	9.91	0.00	0.00	SAMPLED ANNUALLY		--	--	--	--	--	--	--
12/23/04	8.94	3.20	5.74	0.00	0.00	SAMPLED ANNUALLY		--	--	--	--	--	--	--
MW-9														
04/19/99	5.87	2.71	3.16	--	--	2,600 ²	3,900 ⁶	14	6.9	14	24	140	--	--
06/14/99	5.87	1.06	4.81	--	--	2,800 ²	2,880	12.6	<10	<10	<10	138	--	--
09/17/99	5.87	1.02	4.85	--	--	1,770 ²	3,370	33.1	14.4	<5.0	<5.0	202	--	--
12/20/99	5.87	1.87	4.00	--	--	996 ²	3,970	42.2	13.5	<10	<10	311	--	--
03/20/00	5.87	2.87	3.00	--	--	2,710 ²	5,920	22.1	<5.0	6.8	<5.0	106.0	--	--
06/24/00	5.87	1.96	3.91	0.00	0.00	1,940 ⁹	2,500 ⁷	12	<10	11	<10	120	--	--
09/07/00	5.87	1.59	4.28	0.00	0.00	1,500 ⁹	3,700 ⁷	<25	<25	<25	<25	330	--	--
12/05/00	5.87	2.07	3.80	0.00	0.00	1,300 ¹²	3,470 ²	<5.00	7.64	<5.00	<5.00	177	--	--
03/01/01	5.87	3.19	2.68	0.00	0.00	960 ⁹	2,400 ⁷	11	18.0	<10	<10	250	--	--
06/04/01	5.87	1.96	3.91	0.00	0.00	1,200 ⁹	3,200 ⁷	45	17	6.1	8.9	300	--	--
09/10/01	5.87	1.18	4.69	0.00	0.00	2,000 ¹⁷	2,300	5.7	7.3	10	<5.0	200	--	--
12/03/01	5.87	2.88	2.99	0.00	0.00	2,600	3,600	14	5.4	8.2	8.5	210	--	--

Table 1
Groundwater Monitoring Data and Analytical Results
Chevron Service Station #9-0121
3026 Lakeshore Avenue
Oakland, California

WELL ID/ DATE	TOC (ft.)	GWE (msl)	DTW (ft.)	SPHT (ft.)	SPH REMOVED (gallons)	TPH-D (ppb)	TPH-G (ppb)	B (ppb)	T (ppb)	E (ppb)	X (ppb)	MTBE (ppb)	ETHANOL ♦ (ppb)	TDS (ppb)
MW-9 (cont)														
03/04/02	5.87	2.32	3.55	0.00	0.00	3,700	4,400	17	<5.0	9.2	6.4	79	--	--
05/30/02	5.87	2.22	3.65	0.00	0.00	4,600	4,300	15	3.7	5.8	6.1	110	--	--
09/03/02	5.87	1.31	4.56	0.00	0.00	2,500	3,200	5.8	2.6	3.5	5.6	84	--	--
12/09/02	5.87	1.51	4.36	0.00	0.00	2,600	3,000	6.3	3.2	3.9	6.1	110	--	--
03/10/03	5.87	2.26	3.61	0.00	0.00	1,500	3,300	11	3.7	5.4	<7.5	150	--	--
06/09/03 ^{1R}	5.87	2.29	3.58	0.00	0.00	2,700	3,500	2	2	3	2	46	--	--
09/08/03 ^{1R}	5.87	1.43	4.44	0.00	0.00	3,000	3,000	3	2	2	3	120	<50	--
12/08/03 ^{1R}	5.87	2.21	3.66	0.00	0.00	2,500	2,400	3	3	3	4	560	<50	--
03/09/04 ^{1R}	5.87	2.69	3.18	0.00	0.00	2,500	3,700	2	1	2	2	120	<50	--
06/17/04 ^{1R}	5.87	1.05	4.82	0.00	0.00	2,700	3,100	2	1	2	3	96	<50	--
09/15/04 ^{1R}	5.87	-3.16	9.03	0.00	0.00	2,600	1,200	1	<0.5	<0.5	2	190	<50	--
12/23/04 ^{1R}	5.87	1.38	4.49	0.00	0.00	3,400	2,900	4	4	4	4	93	<50	--
TRIP BLANK														
08/24/92	--	--	--	--	--	--	--	--	--	--	--	--	--	--
09/21/92	--	--	--	--	--	--	<50	<0.5	<0.5	<0.5	<0.5	--	--	--
10/26/92	--	--	--	--	--	--	--	--	--	--	--	--	--	--
12/23/92	--	--	--	--	--	--	<50	<0.5	<0.5	<0.5	<0.5	--	--	--
01/08/93	--	--	--	--	--	--	--	--	--	--	--	--	--	--
03/25/93	--	--	--	--	--	--	<50	<0.5	<0.5	<0.5	<0.5	--	--	--
06/11/93	--	--	--	--	--	--	<50	<0.5	<0.5	<0.5	<0.5	--	--	--
09/29/93	--	--	--	--	--	--	<50	<0.5	<0.5	<0.5	<0.5	--	--	--
12/20/93	--	--	--	--	--	--	<50	<0.5	<0.5	<0.5	<0.5	--	--	--
03/07/94	--	--	--	--	--	--	<50	<0.5	<0.5	<0.5	<0.5	--	--	--
06/17/94	--	--	--	--	--	--	<50	<0.5	<0.5	<0.5	<0.5	--	--	--
09/12/94	--	--	--	--	--	--	<50	<0.5	<0.5	<0.5	1.0	--	--	--
11/30/94	--	--	--	--	--	--	<50	<0.5	<0.5	<0.5	<0.5	--	--	--
03/24/95	--	--	--	--	--	--	<50	<0.5	<0.5	<0.5	<0.5	--	--	--
06/27/95	--	--	--	--	--	--	<50	<0.5	<0.5	<0.5	<0.5	--	--	--
09/28/95	--	--	--	--	--	--	<50	<0.5	<0.5	<0.5	<0.5	--	--	--
12/19/95	--	--	--	--	--	--	<50	<0.5	<0.5	<0.5	<0.5	--	--	--
02/28/96	--	--	--	--	--	--	<50	<0.5	<0.5	<0.5	<0.5	--	--	--

Table 1
Groundwater Monitoring Data and Analytical Results
Chevron Service Station #9-0121
3026 Lakeshore Avenue
Oakland, California

WELL ID/ DATE	TOC (ft.)	GWE (msl)	DTW (ft.)	SPHT (ft.)	SPH REMOVED (gallons)	TPH-D (ppb)	TPH-G (ppb)	B (ppb)	T (ppb)	E (ppb)	X (ppb)	MTBE (ppb)	ETHANOL ♦ (ppb)	TDS (ppb)
TRIP BLANK (cont)														
06/25/96	--	--	--	--	--	--	<50	<0.5	<0.5	<0.5	<0.5	--	--	--
12/17/96	--	--	--	--	--	--	<50	<0.5	<0.5	<0.5	<0.5	<2.5	--	--
03/31/97	--	--	--	--	--	--	<50	<0.5	<0.5	<0.5	<0.5	<2.5	--	--
06/30/97	--	--	--	--	--	--	<50	<0.5	<0.5	<0.5	<0.5	<2.5	--	--
09/12/97	--	--	--	--	--	--	<50	<0.5	<0.5	<0.5	<0.5	<2.5	--	--
12/05/97	--	--	--	--	--	--	<50	<0.5	<0.5	<0.5	<0.5	<2.5	--	--
02/16/98	--	--	--	--	--	--	<50	<0.5	<0.5	<0.5	<0.5	<2.5	--	--
06/17/98	--	--	--	--	--	--	<50	<0.5	<0.5	<0.5	<0.5	<2.5	--	--
08/31/98	--	--	--	--	--	--	<50	<0.5	<0.5	<0.5	<0.5	<2.5	--	--
12/28/98	--	--	--	--	--	--	<50	<0.5	<0.5	<0.5	<0.5	<2.5	--	--
03/04/99	--	--	--	--	--	--	<50	<0.5	<0.5	<0.5	<0.5	<2.0	--	--
06/14/99	--	--	--	--	--	--	<50	<0.5	<0.5	<0.5	<0.5	<2.5	--	--
09/17/99	--	--	--	--	--	--	<50	<0.5	<0.5	<0.5	<0.5	<2.5	--	--
12/20/99	--	--	--	--	--	--	<50	<0.5	<0.5	<0.5	<0.5	<2.5	--	--
03/20/00	--	--	--	--	--	--	<50	<0.5	<0.5	<0.5	<0.5	<2.5	--	--
06/24/00	--	--	--	--	--	--	<50	<0.50	<0.50	<0.50	<0.50	<2.5	--	--
09/07/00	--	--	--	--	--	--	<50	<0.50	<0.50	<0.50	<0.50	<2.5	--	--
12/05/00	--	--	--	--	--	--	<50	<0.500	<0.500	<0.500	<0.500	<2.5	--	--
03/01/01	--	--	--	--	--	--	<50	<0.50	<0.50	<0.50	<0.50	<2.5	--	--
06/04/01	--	--	--	--	--	--	<50	<0.50	<0.50	<0.50	<0.50	<2.5	--	--
09/10/01	--	--	--	--	--	--	<50	<0.50	<0.50	<0.50	<0.50	<2.5	--	--
QA														
12/03/01	--	--	--	--	--	--	<50	<0.50	<0.50	<0.50	<1.5	<2.5	--	--
03/04/02	--	--	--	--	--	--	<50	<0.50	<0.50	<0.50	<1.5	<2.5	--	--
05/30/02	--	--	--	--	--	--	<50	<0.50	<0.50	<0.50	<1.5	<2.5	--	--
09/03/02	--	--	--	--	--	--	<50	<0.50	<0.50	<0.50	<1.5	<2.5	--	--
12/09/02	--	--	--	--	--	--	<50	<0.50	<0.50	<0.50	<1.5	<2.5	--	--
03/10/03	--	--	--	--	--	--	<50	<0.50	<0.50	<0.50	<1.5	<2.5	--	--
06/09/03 ^{1R}	--	--	--	--	--	--	<50	<0.5	<0.5	<0.5	<0.5	<0.5	--	--
09/08/03 ^{1R}	--	--	--	--	--	--	<50	<0.5	<0.5	<0.5	<0.5	<0.5	--	--
12/08/03 ^{1R}	--	--	--	--	--	--	<50	<0.5	<0.5	<0.5	<0.5	<0.5	--	--
03/09/04 ^{1R}	--	--	--	--	--	--	<50	<0.5	<0.5	<0.5	<0.5	<0.5	--	--

Table 1
Groundwater Monitoring Data and Analytical Results
 Chevron Service Station #9-0121
 3026 Lakeshore Avenue
 Oakland, California

WELL ID/ DATE	TOC (<i>µ</i> L)	GWE (msl)	DTW (<i>ft.</i>)	SPHT (<i>ft.</i>)	SPH REMOVED (gallons)	TPH-D (ppb)	TPH-G (ppb)	B (ppb)	T (ppb)	E (ppb)	X (ppb)	MTBE (ppb)	ETHANOL ♦ (ppb)	TDS (ppb)
QA (cont)														
06/17/04 ^{1R}	--	--	--	--	--	--	<50	<0.5	<0.5	<0.5	<0.5	<0.5	--	--
09/15/04 ^{1R}	--	--	--	--	--	--	<50	<0.5	<0.5	<0.5	<0.5	<0.5	--	--
12/23/04 ^{1R}	--	--	--	--	--	--	<50	<0.5	<0.5	<0.5	<0.5	<0.5	--	--

Table 1
Groundwater Monitoring Data and Analytical Results
Chevron Service Station #9-0121
3026 Lakeshore Avenue
Oakland, California

EXPLANATIONS:

Groundwater monitoring data and laboratory analytical results prior to June 24, 2000, were compiled from reports prepared by Blaine Tech Services, Inc.

TOC = Top of Casing

(ft.) = Feet

GWE = Groundwater Elevation

(msl) = Mean sea level

DTW = Depth to Water

SPHT = Separate Phase Hydrocarbon Thickness

TPH-D = Total Petroleum Hydrocarbons as Diesel

TPH-G = Total Petroleum Hydrocarbons as Gasoline

B = Benzene

T = Toluene

E = Ethylbenzene

X = Xylenes

TDS = Total Dissolved Solids

(ppb) = Parts per billion

-- = Not Measured/Not Analyzed

QA = Quality Assurance/Trip Blank

◆ Ethanol by EPA Method 8260.

¹ Chromatogram pattern indicates a non-diesel mix.

² Chromatogram pattern indicates an unidentified hydrocarbon.

³ Chromatogram pattern indicates an unidentified hydrocarbon and weathered diesel.

⁴ Confirmation run.

⁵ ORC present in well.

⁶ Laboratory report indicates gasoline and unidentified hydrocarbons >10.

⁷ Laboratory report indicates gasoline C6-C12.

⁸ Laboratory report indicates this sample was analyzed outside of the EPA recommended holding time.

⁹ Laboratory report indicates unidentified hydrocarbons C9-C24.

¹⁰ Laboratory report indicates unidentified hydrocarbons C10-C24.

¹¹ Laboratory report indicates unidentified hydrocarbons >C16.

¹² Laboratory report indicates unidentified hydrocarbons C9-C40.

¹³ Laboratory report indicates diesel C9-C24 + unidentified hydrocarbons <C16.

¹⁴ Laboratory report indicates weathered gasoline C6-C12.

¹⁵ Laboratory report indicates unidentified hydrocarbons C6-C12.

¹⁶ Laboratory report indicates hydrocarbon pattern is present in the requested fuel quantitation range but does not resemble the pattern of the requested fuel.

¹⁷ Laboratory report indicates hydrocarbon pattern is present in the requested fuel quantitation range but does not resemble the pattern of the requested fuel. The pattern more closely resembles that of a heavier hydrocarbon mix.

¹⁸ BTEX and MTBE by EPA Method 8260.

¹⁹ Laboratory report indicates the observed sample pattern is not typical of diesel/#2 fuel oil.

²⁰ ORC removed from well.

Table 2
Dissolved Oxygen Concentrations
 Chevron Service Station #9-0121
 3026 Lakeshore Avenue
 Oakland, California

WELL ID	DATE	Before Purging (mg/L)	After Purging (mg/L)
MW-1	06/24/00 ¹	5.30	--
	09/07/00 ¹	4.02	--
	12/05/00 ¹	3.86	--
	03/01/01 ¹	3.04	--
	06/04/01 ¹	2.70	--
	09/10/01 ¹	2.40	--
	12/03/01 ¹	0.70	--
	03/04/02 ¹	1.10	--
	05/30/02 ¹	0.90	--
	09/03/02 ¹	1.20	--
	12/09/02 ¹	0.90	--
	03/10/03 ¹	1.00	--
	06/09/03 ¹	0.80	--
	09/08/03 ¹	0.60	--
	12/08/03 ¹	2.00	--

EXPLANATIONS:

(mg/L) = Milligrams per liter

-- = Not Measured

¹ ORC present in well.

Table 3
Groundwater Analytical Results
 Chevron Service Station #9-0121
 3026 Lakeshore Avenue
 Oakland, California

WELL ID/ DATE	Total Alkalinity (ppb)	Ferrous Iron (ppb)	Sulfate (ppb)	Nitrate (ppb)
MW-1 12/28/98	390,000	4,900	<1,000	<1,000
MW-3 12/28/98	980,000	4,500	390,000	<1,000
MW-4 12/28/98	670,000	3,500	6,800	<1,000
MW-5 12/28/98	480,000	15	51,000	<1,000
MW-6 12/28/98	2,400,000	810	110,000	<1,000
MW-7 12/28/98	350,000	12,000	79,000	<1,000
MW-8 12/28/98	1,100,000	45	87,000	<1,000

EXPLANATIONS:

Groundwater laboratory analytical results were compiled from reports prepared by Blaine Tech Services, Inc.

(ppb) = Parts per billion

STANDARD OPERATING PROCEDURE - GROUNDWATER SAMPLING

Gettler-Ryan Inc. field personnel adhere to the following procedures for the collection and handling of groundwater samples prior to analysis by the analytical laboratory. Prior to sample collection, the type of analysis to be performed is determined. Loss prevention of volatile compounds is controlled and sample preservation for subsequent analysis is maintained.

Prior to sampling, the presence or absence of free-phase hydrocarbons is determined using an interface probe. Product thickness, if present, is measured to the nearest 0.01 foot and is noted in the field notes. In addition, all depth to water level measurements are collected with a static water level indicator and are also recorded in the field notes, prior to purging and sampling any wells.

After water levels are collected and prior to sampling, if purging is to occur, each well is purged a minimum of three well casing volumes of water using pre-cleaned pumps (stack, suction, Grundfos), or disposable bailers. Temperature, pH and electrical conductivity are measured a minimum of three times during the purging. Purging continues until these parameters stabilize.

Groundwater samples are collected using disposable bailers. The water samples are transferred from the bailer into appropriate containers. Pre-preserved containers, supplied by analytical laboratories, are used when possible. When pre-preserved containers are not available, the laboratory is instructed to preserve the sample as appropriate. Duplicate samples are collected for the laboratory to use in maintaining quality assurance/quality control standards. The samples are labeled to include the job number, sample identification, collection date and time, analysis, preservation (if any), and the sample collector's initials. The water samples are placed in a cooler, maintained at 4°C for transport to the laboratory. Once collected in the field, all samples are maintained under chain of custody until delivered to the laboratory.

The chain of custody document includes the job number, type of preservation, if any, analysis requested, sample identification, date and time collected, and the sample collector's name. The chain of custody is signed and dated (including time of transfer) by each person who receives or surrenders the samples, beginning with the field personnel and ending with the laboratory personnel.

A laboratory supplied trip blank accompanies each sampling set. For sampling sets greater than 20 samples, 5% trip blanks are included. The trip blank is analyzed for some or all of the same compounds as the groundwater samples.

As requested by ChevronTexaco Company, the purge water and decontamination water generated during sampling activities is transported by JWM to McKittrick Waste Management located in McKittrick, California.



GETTLER-RYAN INC.

WELL MONITORING/SAMPLING FIELD DATA SHEET

Client/Facility #: ChevronTexaco #9-0121 Job Number: 386462
 Site Address: 3026 Lakeshore Avenue Event Date: 12/23/04 (inclusive)
 City: Oakland, CA Sampler: A. Smith

Well ID: MW-1 Date Monitored: 12/23/04 Well Condition: OK
 Well Diameter: 2 1/4 in.
 Total Depth: 19.30 ft.
 Depth to Water: 5.54 ft.
13.76 xVF 0.66 = 9.08 x3 case volume = Estimated Purge Volume: 27.24 gal.

Volume	3/4"= 0.02	1"= 0.04	2"= 0.17	3"= 0.38
Factor (VF)	4"= 0.66	5"= 1.02	6"= 1.50	12"= 5.80

Purge Equipment:
 Disposable Bailer _____
 Stainless Steel Bailer _____
 Stack Pump
 Suction Pump _____
 Grundfos _____
 Other: _____

Sampling Equipment:
 Disposable Bailer
 Pressure Bailer _____
 Discrete Bailer _____
 Other: _____

Time Started: _____ (2400 hrs)
 Time Completed: _____ (2400 hrs)
 Depth to Product: _____ ft
 Depth to Water: _____ ft
 Hydrocarbon Thickness: _____ ft
 Visual Confirmation/Description: _____
 Skimmer / Absorbant Sock (circle one)
 Amt Removed from Skimmer: _____ gal
 Amt Removed from Well: _____ gal
 Water Removed: _____
 Product Transferred to: _____

Start Time (purge): 1110 Weather Conditions: Sunny
 Sample Time/Date: 1135 12/23/04 Water Color: Cloudy Grey Odor: Yes
 Purging Flow Rate: 2 gpm. Sediment Description: S. H
 Did well de-water? NO If yes, Time: 0 Volume: 0 gal.

Time (2400 hr.)	Volume (gal.)	pH	Conductivity (u mhos/cm)	Temperature (C/F)	D.O. (mg/L)	ORP (mV)
<u>1114</u>	<u>8</u>	<u>7.01</u>	<u>981</u>	<u>19.5</u>		
<u>1118</u>	<u>16</u>	<u>7.15</u>	<u>995</u>	<u>19.7</u>		
<u>1125</u>	<u>23</u>	<u>7.09</u>	<u>998</u>	<u>19.8</u>		

LABORATORY INFORMATION

SAMPLE ID	(#) CONTAINER	REFRIG.	PRESERV. TYPE	LABORATORY	ANALYSES
<u>MW-1</u>	<u>6</u> x vov vial	<u>YES</u>	<u>HCL</u>	<u>LANCASTER</u>	<u>TPH-G(8015)/BTEX+MTBE(8260)/ETHANOL(8260)</u>
<u>↓</u>	<u>2</u> x Amber	<u>YES</u>	<u>NP</u>	<u>LANCASTER</u>	<u>TPH-D</u>

COMMENTS: _____

Add/Replaced Lock: _____ Add/Replaced Plug: _____ Size: _____



GETTLER-RYAN INC.

WELL MONITORING/SAMPLING FIELD DATA SHEET

Client/Facility #: ChevronTexaco #9-0121 Job Number: 386462
 Site Address: 3026 Lakeshore Avenue Event Date: 12/23/04 (inclusive)
 City: Oakland, CA Sampler: A. Smith

Well ID: MW-2A Date Monitored: 12/23/04 Well Condition: OK

Well Diameter: 214 in.

Total Depth: 16.75 ft.

Depth to Water: 5.85 ft.

Volume	3/4"= 0.02	1"= 0.04	2"= 0.17	3"= 0.38
Factor (VF)	4"= 0.66	5"= 1.02	6"= 1.50	12"= 5.80

10.90 xyF 0.17 = 1.85 x3 case volume= Estimated Purge Volume: 5.56 gal.

Purge Equipment:
 Disposable Bailer
 Stainless Steel Bailer _____
 Stack Pump _____
 Suction Pump _____
 Grundfos _____
 Other: _____

Sampling Equipment:
 Disposable Bailer
 Pressure Bailer _____
 Discrete Bailer _____
 Other: _____

Time Started: _____ (2400 hrs)
 Time Completed: _____ (2400 hrs)
 Depth to Product: _____ ft
 Depth to Water: _____ ft
 Hydrocarbon Thickness: _____ ft
 Visual Confirmation/Description: _____
 Skimmer / Absorbant Sock (circle one)
 Amt Removed from Skimmer: _____ gal
 Amt Removed from Well: _____ gal
 Water Removed: _____
 Product Transferred to: _____

Start Time (purge): 1030 Weather Conditions: Sunny
 Sample Time/Date: 1055 12/23/04 Water Color: Clear Odor: Yes
 Purging Flow Rate: NA gpm. Sediment Description: None
 Did well de-water? No If yes, Time: 0 Volume: 0 gal.

Time (2400 hr.)	Volume (gal.)	pH	Conductivity (umhos/cm)	Temperature (C/F)	D.O. (mg/L)	ORP (mV)
<u>1037</u>	<u>2</u>	<u>6.81</u>	<u>1181</u>	<u>19.1</u>		
<u>1041</u>	<u>4</u>	<u>6.51</u>	<u>1127</u>	<u>19.8</u>		
<u>1047</u>	<u>6</u>	<u>6.71</u>	<u>1159</u>	<u>19.5</u>		

LABORATORY INFORMATION

SAMPLE ID	(#) CONTAINER	REFRIG.	PRESERV. TYPE	LABORATORY	ANALYSES
<u>MW-2A</u>	<u>2</u> x vov vial	<u>YES</u>	<u>HCL</u>	<u>LANCASTER</u>	<u>TPH-G(8015)/BTEX+MTBE(8260)/ETHANOL(8260)</u>
<u>↓</u>	<u>2</u> x Amber	<u>YES</u>	<u>NP</u>	<u>LANCASTER</u>	<u>TPH-D</u>

COMMENTS: _____

Add/Replaced Lock: _____ Add/Replaced Plug: _____ Size: _____



GETTLER - RYAN INC.

WELL MONITORING/SAMPLING FIELD DATA SHEET

Client/Facility #: ChevronTexaco #9-0121
 Site Address: 3026 Lakeshore Avenue
 City: Oakland, CA

Job Number: 386462
 Event Date: 12/23/04 (inclusive)
 Sampler: A. Smith

Well ID: MW-3A
 Well Diameter: 2 1/4 in.
 Total Depth: 18.05 ft.
 Depth to Water: 8.76 ft.
9.29 x VF 0.17 = 1.58

Date Monitored: 12/23/04 Well Condition: OK

Volume	3/4"= 0.02	1"= 0.04	2"= 0.17	3"= 0.38
Factor (VF)	4"= 0.66	5"= 1.02	6"= 1.50	12"= 5.80

x3 case volume = Estimated Purge Volume: 4.74 gal.

Purge Equipment:
 Disposable Bailer
 Stainless Steel Bailer _____
 Stack Pump _____
 Suction Pump _____
 Grundfos _____
 Other: _____

Sampling Equipment:
 Disposable Bailer
 Pressure Bailer _____
 Discrete Bailer _____
 Other: _____

Time Started: _____ (2400 hrs)
 Time Completed: _____ (2400 hrs)
 Depth to Product: _____ ft
 Depth to Water: _____ ft
 Hydrocarbon Thickness: _____ ft
 Visual Confirmation/Description: _____
 Skimmer / Absorbant Sock (circle one)
 Amt Removed from Skimmer: _____ gal
 Amt Removed from Well: _____ gal
 Water Removed: _____
 Product Transferred to: _____

Start Time (purge): 1150 Weather Conditions: Sunny
 Sample Time/Date: 1210 12/23/04 Water Color: Clear Odor: none
 Purging Flow Rate: NA gpm. Sediment Description: none
 Did well de-water? NO If yes, Time: 0 Volume: 0 gal.

Time (2400 hr.)	Volume (gal.)	pH	Conductivity (umhos/cm)	Temperature (C/F)	D.O. (mg/L)	ORP (mV)
<u>1154</u>	<u>2</u>	<u>6.87</u>	<u>798</u>	<u>20.1</u>	_____	_____
<u>1159</u>	<u>4</u>	<u>6.91</u>	<u>809</u>	<u>19.7</u>	_____	_____
<u>1203</u>	<u>5</u>	<u>6.98</u>	<u>837</u>	<u>19.5</u>	_____	_____
_____	_____	_____	_____	_____	_____	_____

LABORATORY INFORMATION

SAMPLE ID	(#) CONTAINER	REFRIG.	PRESERV. TYPE	LABORATORY	ANALYSES
<u>MW-3A</u>	<u>6</u> x vov vial	<u>YES</u>	<u>HCL</u>	<u>LANCASTER</u>	<u>TPH-G(8015)/BTEX+MTBE(8260)/ETHANOL(8260)</u>
<u>↓</u>	<u>2</u> x Amber	<u>YES</u>	<u>NP</u>	<u>LANCASTER</u>	<u>TPH-D</u>
_____	_____	_____	_____	_____	_____

COMMENTS: _____

Add/Replaced Lock: _____ Add/Replaced Plug: _____ Size: _____



GETTLER-RYAN INC.

WELL MONITORING/SAMPLING FIELD DATA SHEET

Client/Facility #: ChevronTexaco #9-0121
 Site Address: 3026 Lakeshore Avenue
 City: Oakland, CA

Job Number: 386462
 Event Date: 12/23/04 (inclusive)
 Sampler: A. Smith

Well ID: MW-4A
 Well Diameter: 21.4 in.
 Total Depth: 18.55 ft.
 Depth to Water: 6.26 ft.
12.29 xVF 0.17 = 2.09

Date Monitored: 12/23/04 Well Condition: OK

Volume	3/4" = 0.02	1" = 0.04	2" = 0.17	3" = 0.38
Factor (VF)	4" = 0.66	5" = 1.02	6" = 1.50	12" = 5.80

Purge Equipment:
 Disposable Bailer
 Stainless Steel Bailer _____
 Stack Pump _____
 Suction Pump _____
 Grundfos _____
 Other: _____

Sampling Equipment:
 Disposable Bailer
 Pressure Bailer _____
 Discrete Bailer _____
 Other: _____

Time Started: _____ (2400 hrs)
 Time Completed: _____ (2400 hrs)
 Depth to Product: _____ ft
 Depth to Water: _____ ft
 Hydrocarbon Thickness: _____ ft
 Visual Confirmation/Description: _____
 Skimmer / Absorbant Sock (circle one)
 Amt Removed from Skimmer: _____ gal
 Amt Removed from Well: _____ gal
 Water Removed: _____
 Product Transferred to: _____

Start Time (purge): 1220 Weather Conditions: Sunny
 Sample Time/Date: 1245 12/23/04 Water Color: yellowish Odor: yes
 Purging Flow Rate: NA gpm. Sediment Description: none
 Did well de-water? NO If yes, Time: 0 Volume: 0 gal.

Time (2400 hr.)	Volume (gal.)	pH	Conductivity (umhos/cm)	Temperature (C/F)	D.O. (mg/L)	ORP (mV)
<u>1226</u>	<u>2</u>	<u>6.21</u>	<u>1191</u>	<u>19.6</u>		
<u>1233</u>	<u>4</u>	<u>6.28</u>	<u>1205</u>	<u>20.0</u>		
<u>1239</u>	<u>6</u>	<u>6.34</u>	<u>1217</u>	<u>20.0</u>		

LABORATORY INFORMATION

SAMPLE ID	(#) CONTAINER	REFRIG.	PRESERV. TYPE	LABORATORY	ANALYSES
<u>MW-4A</u>	<u>2</u> x vov vial	YES	HCL	LANCASTER	TPH-G(8015)/BTEX+MTBE(8260)/ETHANOL(8260)
<u>↓</u>	<u>2</u> x Amber	YES	NP	LANCASTER	TPH-D

COMMENTS: _____

Add/Replaced Lock: _____ Add/Replaced Plug: _____ Size: _____



GETTLER - RYAN INC.

WELL MONITORING/SAMPLING FIELD DATA SHEET

Client/Facility #: ChevronTexaco #9-0121
 Site Address: 3026 Lakeshore Avenue
 City: Oakland, CA

Job Number: 386462
 Event Date: 12/23/04 (inclusive)
 Sampler: A. Smith

Well ID: MW-5 Date Monitored: 12/23/04 Well Condition: OK
 Well Diameter: 2 1/4 in.
 Total Depth: 32.81 ft.
 Depth to Water: 12.40 ft. (12.20) xVF 0.17 = _____ x3 case volume = Estimated Purge Volume: _____ gal.

Volume	3/4"= 0.02	1"= 0.04	2"= 0.17	3"= 0.38
Factor (VF)	4"= 0.66	5"= 1.02	6"= 1.50	12"= 5.80

Purge Equipment:
 Disposable Bailer _____
 Stainless Steel Bailer _____
 Stack Pump _____
 Suction Pump _____
 Grundfos _____
 Other: _____

Sampling Equipment:
 Disposable Bailer _____
 Pressure Bailer _____
 Discrete Bailer _____
 Other: _____

Time Started: _____ (2400 hrs)
 Time Completed: _____ (2400 hrs)
 Depth to Product: _____ ft
 Depth to Water: _____ ft
 Hydrocarbon Thickness: _____ ft
 Visual Confirmation/Description: _____
 Skimmer / Absorbant Sock (circle one)
 Amt Removed from Skimmer: _____ gal
 Amt Removed from Well: _____ gal
 Water Removed: _____
 Product Transferred to: _____

Monitor Only

Start Time (purge): _____ Weather Conditions: _____
 Sample Time/Date: 1 Water Color: _____ Odor: _____
 Purging Flow Rate: _____ gpm. Sediment Description: _____
 Did well de-water? _____ If yes, Time: _____ Volume: _____ gal.

Time (2400 hr.)	Volume (gal.)	pH	Conductivity (umhos/cm)	Temperature (C/F)	D.O. (mg/L)	ORP (mV)

LABORATORY INFORMATION

SAMPLE ID	(#) CONTAINER	REFRIG.	PRESERV. TYPE	LABORATORY	ANALYSES
MW-	x vov vial	YES	HCL	LANCASTER	TPH-G(8015)/BTEX+MTBE(8260)/ETHANOL(8260)
	x Amber	YES	NP	LANCASTER	TPH-D

COMMENTS: _____

Add/Replaced Lock: _____

Add/Replaced Plug: _____ Size: _____



GETTLER - RYAN INC.

WELL MONITORING/SAMPLING FIELD DATA SHEET

Client/Facility #: ChevronTexaco #9-0121 Job Number: 386462
 Site Address: 3026 Lakeshore Avenue Event Date: 12/23/04 (inclusive)
 City: Oakland, CA Sampler: A. Smith

Well ID: MW-6 Date Monitored: 12/23/04 Well Condition: OK
 Well Diameter: 21.4 in.
 Total Depth: 18.41 ft.
 Depth to Water: 5.76 ft.
 xVF 0.17 = _____ x3 case volume = Estimated Purge Volume: _____ gal.

Volume	3/4"= 0.02	1"= 0.04	2"= 0.17	3"= 0.38
Factor (VF)	4"= 0.66	5"= 1.02	6"= 1.50	12"= 5.80

Purge Equipment:

Disposable Bailer _____
 Stainless Steel Bailer _____
 Stack Pump _____
 Suction Pump _____
 Grundfos _____
 Other: _____

Sampling Equipment:

Disposable Bailer _____
 Pressure Bailer _____
 Discrete Bailer _____
 Other: _____

Time Started: _____ (2400 hrs)
 Time Completed: _____ (2400 hrs)
 Depth to Product: _____ ft
 Depth to Water: _____ ft
 Hydrocarbon Thickness: _____ ft
 Visual Confirmation/Description: _____
 Skimmer / Absorbant Sock (circle one)
 Amt Removed from Skimmer: _____ gal
 Amt Removed from Well: _____ gal
 Water Removed: _____
 Product Transferred to: _____

Monitor Only

Start Time (purge): _____ Weather Conditions: _____
 Sample Time/Date: 11 Water Color: _____ Odor: _____
 Purging Flow Rate: _____ gpm. Sediment Description: _____
 Did well de-water? _____ If yes, Time: _____ Volume: _____ gal.

Time (2400 hr.)	Volume (gal.)	pH	Conductivity (umhos/cm)	Temperature (C/F)	D.O. (mg/L)	ORP (mV)
_____	_____	_____	_____	_____	_____	_____
_____	_____	_____	_____	_____	_____	_____
_____	_____	_____	_____	_____	_____	_____
_____	_____	_____	_____	_____	_____	_____

LABORATORY INFORMATION

SAMPLE ID	(#) CONTAINER	REFRIG.	PRESERV. TYPE	LABORATORY	ANALYSES
MW-	x vob vial	YES	HCL	LANCASTER	TPH-G(8015)/BTEX+MTBE(8260)/ETHANOL(8260)
	x Amber	YES	NP	LANCASTER	TPH-D

COMMENTS:

Add/Replaced Lock: _____ Add/Replaced Plug: _____ Size: _____



GETTLER-RYAN INC.

WELL MONITORING/SAMPLING FIELD DATA SHEET

Client/Facility #: ChevronTexaco #9-0121
 Site Address: 3026 Lakeshore Avenue
 City: Oakland, CA

Job Number: 386462
 Event Date: 12/23/04 (inclusive)
 Sampler: A. Smith

Well ID: MW-7
 Well Diameter: 2 1/4 in.
 Total Depth: 14.05 ft.
 Depth to Water: _____ ft.

Date Monitored: 12/23/04 Well Condition: OK U/L

Volume	3/4"= 0.02	1"= 0.04	2"= 0.17	3"= 0.38
Factor (VF)	4"= 0.66	5"= 1.02	6"= 1.50	12"= 5.80

xVF 0.17 = _____ x3 case volume= Estimated Purge Volume: _____ gal.

Purge Equipment:

Disposable Bailer _____
 Stainless Steel Bailer _____
 Stack Pump _____
 Suction Pump _____
 Grundfos _____
 Other: _____

Sampling Equipment:

Disposable Bailer _____
 Pressure Bailer _____
 Discrete Bailer _____
 Other: _____

Time Started: _____ (2400 hrs)
 Time Completed: _____ (2400 hrs)
 Depth to Product: _____ ft
 Depth to Water: _____ ft
 Hydrocarbon Thickness: _____ ft
 Visual Confirmation/Description: _____
 Skimmer / Absorbant Sock (circle one)
 Amt Removed from Skimmer: _____ gal
 Amt Removed from Well: _____ gal
 Water Removed: _____
 Product Transferred to: _____

Monitor Only

Start Time (purge): _____ Weather Conditions: _____
 Sample Time/Date: _____ / _____ Water Color: _____ Odor: _____
 Purging Flow Rate: _____ gpm. Sediment Description: _____
 Did well de-water? _____ If yes, Time: _____ Volume: _____ gal.

Time (2400 hr.)	Volume (gal.)	pH	Conductivity (umhos/cm)	Temperature (C/F)	D.O. (mg/L)	ORP (mV)

LABORATORY INFORMATION

SAMPLE ID	(#) CONTAINER	REFRIG.	PRESERV. TYPE	LABORATORY	ANALYSES
MW-	x vob vial	YES	HCL	LANCASTER	TPH-G(8015)/BTEX+MTBE(8260)/ETHANOL(8260)
	x Amber	YES	NP	LANCASTER	TPH-D

COMMENTS: U/L

Add/Replaced Lock: _____ Add/Replaced Plug: _____ Size: _____



GETTLER - RYAN INC.

WELL MONITORING/SAMPLING FIELD DATA SHEET

Client/Facility #: ChevronTexaco #9-0121
 Site Address: 3026 Lakeshore Avenue
 City: Oakland, CA

Job Number: 386462
 Event Date: 12/23/04 (inclusive)
 Sampler: A. Smith

Well ID: MW-8
 Well Diameter: 214 in.
 Total Depth: 24.92 ft.
 Depth to Water: 5.74 ft.

Date Monitored: 12/23/04 Well Condition: OK

Volume	3/4"= 0.02	1"= 0.04	2"= 0.17	3"= 0.38
Factor (VF)	4"= 0.66	5"= 1.02	6"= 1.50	12"= 5.80

xVF 0.17 = _____ x3 case volume= Estimated Purge Volume: _____ gal.

Purge Equipment:
 Disposable Bailer _____
 Stainless Steel Bailer _____
 Stack Pump _____
 Suction Pump _____
 Grundfos _____
 Other: _____

Sampling Equipment:
 Disposable Bailer _____
 Pressure Bailer _____
 Discrete Bailer _____
 Other: _____

Time Started: _____ (2400 hrs)
 Time Completed: _____ (2400 hrs)
 Depth to Product: _____ ft
 Depth to Water: _____ ft
 Hydrocarbon Thickness: _____ ft
 Visual Confirmation/Description: _____
 Skimmer / Absorbent Sock (circle one)
 Amt Removed from Skimmer: _____ gal
 Amt Removed from Well: _____ gal
 Water Removed: _____
 Product Transferred to: _____

Monitor Only

Start Time (purge): _____ Weather Conditions: _____
 Sample Time/Date: 1 Water Color: _____ Odor: _____
 Purging Flow Rate: _____ gpm. Sediment Description: _____
 Did well de-water? _____ If yes, Time: _____ Volume: _____ gal.

Time (2400 hr.)	Volume (gal.)	pH	Conductivity (umhos/cm)	Temperature (C/F)	D.O. (mg/L)	ORP (mV)
_____	_____	_____	_____	_____	_____	_____
_____	_____	_____	_____	_____	_____	_____
_____	_____	_____	_____	_____	_____	_____
_____	_____	_____	_____	_____	_____	_____

LABORATORY INFORMATION

SAMPLE ID	(#) CONTAINER	REFRIG.	PRESERV. TYPE	LABORATORY	ANALYSES
MW-	x vva vial	YES	HCL	LANCASTER	TPH-G(8015)/BTEX+MTBE(8260)/ETHANOL(8260)
	x Amber	YES	NP	LANCASTER	TPH-D

COMMENTS: _____

Add/Replaced Lock: _____ Add/Replaced Plug: _____ Size: _____



GETTLER - RYAN INC.

WELL MONITORING/SAMPLING FIELD DATA SHEET

Client/Facility #: ChevronTexaco #9-0121 Job Number: 386462
 Site Address: 3026 Lakeshore Avenue Event Date: 12/23/04 (inclusive)
 City: Oakland, CA Sampler: A. Smith

Well ID: MW-9 Date Monitored: 12/23/04 Well Condition: OK
 Well Diameter: 214 in.
 Total Depth: 15.65 ft.
 Depth to Water: 4.49 ft.
11.16 xVF 0.17 = 1.90 x3 case volume = Estimated Purge Volume: 5.69 gal.

Volume	3/4"= 0.02	1"= 0.04	2"= 0.17	3"= 0.38
Factor (VF)	4"= 0.66	5"= 1.02	6"= 1.50	12"= 5.80

Purge Equipment:
 Disposable Bailer
 Stainless Steel Bailer _____
 Stack Pump _____
 Suction Pump _____
 Grundfos _____
 Other: _____

Sampling Equipment:
 Disposable Bailer
 Pressure Bailer _____
 Discrete Bailer _____
 Other: _____

Time Started: _____ (2400 hrs)
 Time Completed: _____ (2400 hrs)
 Depth to Product: _____ ft
 Depth to Water: _____ ft
 Hydrocarbon Thickness: _____ ft
 Visual Confirmation/Description: _____
 Skimmer / Absorbent Sock (circle one)
 Amt Removed from Skimmer: _____ gal
 Amt Removed from Well: _____ gal
 Water Removed: _____
 Product Transferred to: _____

Start Time (purge): 1000 Weather Conditions: Sunny
 Sample Time/Date: 1020 12/23/04 Water Color: clear Odor: yes
 Purging Flow Rate: NA gpm. Sediment Description: none
 Did well de-water? NO If yes, Time: 0 Volume: 0 gal.

Time (2400 hr.)	Volume (gal.)	pH	Conductivity (umhos/cm)	Temperature (°F)	D.O. (mg/L)	ORP (mV)
<u>1004</u>	<u>2</u>	<u>6.91</u>	<u>827</u>	<u>19.1</u>		
<u>1010</u>	<u>4</u>	<u>6.94</u>	<u>831</u>	<u>19.1</u>		
<u>1017</u>	<u>6</u>	<u>6.97</u>	<u>849</u>	<u>19.0</u>		

LABORATORY INFORMATION

SAMPLE ID	(#) CONTAINER	REFRIG.	PRESERV. TYPE	LABORATORY	ANALYSES
<u>MW-9</u>	<u>6</u> x vov vial	YES	HCL	LANCASTER	TPH-G(8015)/BTEX+MTBE(8260)/ETHANOL(8260)
<u>↓</u>	<u>2</u> x Amber	YES	NP	LANCASTER	TPH-D

COMMENTS: _____

Add/Replaced Lock: _____ Add/Replaced Plug: _____ Size: _____

Chevron California Region Analysis Request/Chain of Custody



122704-01

For Lancaster Laboratories use only
 Acct #: 10904 Sample #: 4437829-34/926478 SCR#:

Facility #: SS#9-0121 G-R#386462 Global ID#T0600100328
 Site Address: 3026 LAKESHORE AVENUE, OAKLAND, CA
 Chevron P#: KS Lead Consultant: CAMBRIA
 Consultant/Office: G-R, Inc., 6747 Sierra Court, Suite J, Dublin, Ca. 94568
 Consultant Prj. Mgr.: Deanna L. Harding (deanna@grinc.com)
 Consultant Phone 925-551-7555 Fax # 925-551-7899
 Sampler: Andrew Smith
 Service Order #: _____ Non SAR:

Matrix		Analyses Requested									
		Preservation Codes									
Soil	Potable Water	<input type="checkbox"/>	<input type="checkbox"/>	<input type="checkbox"/>	<input type="checkbox"/>	<input type="checkbox"/>	<input type="checkbox"/>	<input type="checkbox"/>	<input type="checkbox"/>	<input type="checkbox"/>	<input type="checkbox"/>
	Oil	<input type="checkbox"/>	<input type="checkbox"/>	<input type="checkbox"/>	<input type="checkbox"/>	<input type="checkbox"/>	<input type="checkbox"/>	<input type="checkbox"/>	<input type="checkbox"/>	<input type="checkbox"/>	<input type="checkbox"/>
Total Number of Containers		BTEX + MTBE 8260	TPH 8015 MOD GRO	TPH 8015 MOD DRO	8260 full scan	Origenates	Lead 1420	1421	Ethanol (8260)		
		<input checked="" type="checkbox"/>	<input checked="" type="checkbox"/>	<input checked="" type="checkbox"/>	<input checked="" type="checkbox"/>	<input checked="" type="checkbox"/>	<input checked="" type="checkbox"/>	<input checked="" type="checkbox"/>	<input checked="" type="checkbox"/>		

Preservative Codes
 H = HCl T = Thiosulfate
 N = HNO₃ B = NaOH
 S = H₂SO₄ O = Other

J-value reporting needed
 Must meet lowest detection limits possible for 8260 compounds

8021 MTBE Confirmation
 Confirm highest hit by 8260
 Confirm all hits by 8260
 Run ___ oxy s on highest hit
 Run ___ oxy s on all hits

Sample Identification	Date Collected	Time Collected	Grab	Composite	Soil	Water	Oil	Air	Total Number of Containers	BTEX + MTBE 8260	TPH 8015 MOD GRO	TPH 8015 MOD DRO	8260 full scan	Origenates	Lead 1420	1421	Ethanol (8260)
QA	12/23/04		X			X			2	X	X						
MW-1	12/23/04	1135	X			X			8	X	X	X					X
MW-2A	12/23/04	1055	X			X			8	X	X	X					X
MW-3A	12/23/04	1210	X			X			8	X	X	X					X
MW-4A	12/23/04	1245	X			X			8	X	X	X					X
MW-9	12/23/04	1020	X			X			8	X	X	X					X

Comments / Remarks

Turnaround Time Requested (TAT) (please circle)

STD. TAT 72 hour 48 hour
 24 HOUR 4 day 5 day

Data Package Options (please circle if required)

QC Summary Type I — Full
 Type VI (Raw Data) Coelt Deliverable not needed
 WIP (RWQCB)
 Disk

Relinquished by: <u>[Signature]</u>	Date: <u>12/23/04</u>	Time: <u>1400</u>	Received by:	Date:	Time:
Relinquished by: <u>[Signature]</u>	Date: <u>12/27/04</u>	Time: <u>1345</u>	Received by: <u>[Signature]</u>	Date: <u>12/27/04</u>	Time: <u>1345</u>
Relinquished by: <u>[Signature]</u>	Date: <u>12/27/04</u>	Time: <u>1530</u>	Received by: <u>Fed Ex</u>	Date: <u>12/27/04</u>	Time:
Relinquished by Commercial Carrier: <u>UPS</u>	Temperature Upon Receipt: <u>10-2.1 °C</u>		Received by: <u>[Signature]</u>	Date: <u>12/28/04</u>	Time: <u>0930</u>
			Custody Seals Intact?	Yes	No



Analysis Report

2425 New Holland Pike, PO Box 12425, Lancaster, PA 17605-2425 • 717-656-2300 Fax: 717-656-2681 • www.lancasterlabs.com

ANALYTICAL RESULTS

Prepared for:

ChevronTexaco
6001 Bollinger Canyon Rd L4310
San Ramon CA 94583

925-842-8582

Prepared by:

Lancaster Laboratories
2425 New Holland Pike
Lancaster, PA 17605-2425

SAMPLE GROUP

The sample group for this submittal is 926478. Samples arrived at the laboratory on Tuesday, December 28, 2004. The PO# for this group is 99011184 and the release number is STREICH.

<u>Client Description</u>		<u>Lancaster Labs Number</u>
QA-T-041223	NA Water	4437829
MW-1-W-041223	Grab Water	4437830
MW-2A-W-041223	Grab Water	4437831
MW-3A-W-041223	Grab Water	4437832
MW-4A-W-041223	Grab Water	4437833
MW-9-W-041223	Grab Water	4437834

1 COPY TO Cambria C/O Gettler- Ryan
ELECTRONIC Gettler-Ryan
COPY TO

Attn: Deanna L. Harding
Attn: Cheryl Hansen



Analysis Report

2425 New Holland Pike, PO Box 12425, Lancaster, PA 17605-2425 • 717-656-2300 Fax: 717-656-2681 • www.lancasterlabs.com

Questions? Contact your Client Services Representative
Megan A Moeller at (717) 656-2300.

Respectfully Submitted,

A handwritten signature in cursive script that reads "Robin C. Runkle".

Robin C. Runkle
Senior Chemist



Analysis Report

2425 New Holland Pike, PO Box 12425, Lancaster, PA 17605-2425 • 717-656-2300 Fax: 717-656-2681 • www.lancasterlabs.com

Page 1 of 1

Lancaster Laboratories Sample No. WW 4437829

QA-T-041223 NA Water
Facility# 90121 Job# 386462 GRD
3026 Lakeshore - Oakland T0600100328 QA
Collected: 12/23/2004

Account Number: 10904

Submitted: 12/28/2004 09:30
Reported: 01/06/2005 at 23:39
Discard: 02/06/2005

ChevronTexaco
6001 Bollinger Canyon Rd L4310
San Ramon CA 94583

LAKEQ

CAT No.	Analysis Name	CAS Number	As Received Result	As Received Method Detection Limit	Units	Dilution Factor
01728	TPH-GRO - Waters	n.a.	N.D.	50.	ug/l	1
The reported concentration of TPH-GRO does not include MTBE or other gasoline constituents eluting prior to the C6 (n-hexane) TPH-GRO range start time.						
The analysis was performed from a previously opened vial and the results are therefore estimated.						
06054	BTEX+MTBE by 8260B					
02010	Methyl Tertiary Butyl Ether	1634-04-4	N.D.	0.5	ug/l	1
05401	Benzene	71-43-2	N.D.	0.5	ug/l	1
05407	Toluene	108-88-3	N.D.	0.5	ug/l	1
05415	Ethylbenzene	100-41-4	N.D.	0.5	ug/l	1
06310	Xylene (Total)	1330-20-7	N.D.	0.5	ug/l	1

State of California Lab Certification No. 2116

Laboratory Chronicle

CAT No.	Analysis Name	Method	Trial#	Analysis Date and Time	Analyst	Dilution Factor
01728	TPH-GRO - Waters	N. CA LUFT Gasoline Method	1	01/03/2005 10:34	Linda C Pape	1
06054	BTEX+MTBE by 8260B	SW-846 8260B	1	01/01/2005 12:41	Anita M Dale	1
01146	GC VOA Water Prep	SW-846 5030B	1	01/03/2005 10:34	Linda C Pape	1
01163	GC/MS VOA Water Prep	SW-846 5030B	1	01/01/2005 12:41	Anita M Dale	n.a.

Lancaster Laboratories Sample No. WW 4437830

MW-1-W-041223 Grab Water
 Facility# 90121 Job# 386462 GRD
 3026 Lakeshore - Oakland T0600100328 MW-1
 Collected: 12/23/2004 11:35 by AS

Account Number: 10904

Submitted: 12/28/2004 09:30
 Reported: 01/06/2005 at 23:39
 Discard: 02/06/2005

ChevronTexaco
 6001 Bollinger Canyon Rd L4310
 San Ramon CA 94583

LAKE1

CAT No.	Analysis Name	CAS Number	As Received Result	As Received		Dilution Factor
				Method	Detection Limit	
01728	TPH-GRO - Waters	n.a.	1,800.	50.	ug/l	1
	The reported concentration of TPH-GRO does not include MTBE or other gasoline constituents eluting prior to the C6 (n-hexane) TPH-GRO range start time.					
06609	TPH-DRO CALUFT (Waters)	n.a.	3,000.	660.	ug/l	25
01594	BTEX+5 Oxygenates+EDC+EDB+ETOH					
01587	Ethanol	64-17-5	N.D.	50.	ug/l	1
02010	Methyl Tertiary Butyl Ether	1634-04-4	120.	0.5	ug/l	1
05401	Benzene	71-43-2	120.	0.5	ug/l	1
05407	Toluene	108-88-3	3.	0.5	ug/l	1
05415	Ethylbenzene	100-41-4	5.	0.5	ug/l	1
06310	Xylene (Total)	1330-20-7	5.	0.5	ug/l	1

State of California Lab Certification No. 2116

Laboratory Chronicle

CAT No.	Analysis Name	Method	Analysis		Analyst	Dilution Factor
			Trial#	Date and Time		
01728	TPH-GRO - Waters	N. CA LUFT Gasoline Method	1	01/03/2005 04:08	Linda C Pape	1
06609	TPH-DRO CALUFT (Waters)	CALUFT-DRO/8015B, Modified	1	12/31/2004 19:30	Tracy A Cole	25
01594	BTEX+5 Oxygenates+EDC+EDB+ETOH	SW-846 8260B	1	01/03/2005 10:35	Ginelle L Haines	1
01146	GC VOA Water Prep	SW-846 5030B	1	01/03/2005 04:08	Linda C Pape	1
01163	GC/MS VOA Water Prep	SW-846 5030B	1	01/03/2005 10:35	Ginelle L Haines	n.a.
02135	Extraction - DRO Water Special	TPH by CA LUFT	1	12/29/2004 02:30	Felix C Arroyo	1



Analysis Report

2425 New Holland Pike, PO Box 12425, Lancaster, PA 17605-2425 • 717-656-2300 Fax: 717-656-2681 • www.lancasterlabs.com

Page 1 of 1

Lancaster Laboratories Sample No. WW 4437831

MW-2A-W-041223 Grab Water
Facility# 90121 Job# 386462 GRD
3026 Lakeshore - Oakland T0600100328 MW-2A
Collected: 12/23/2004 10:55 by AS

Account Number: 10904

Submitted: 12/28/2004 09:30
Reported: 01/06/2005 at 23:39
Discard: 02/06/2005

ChevronTexaco
6001 Bollinger Canyon Rd L4310
San Ramon CA 94583

LAKE2

CAT No.	Analysis Name	CAS Number	As Received Result	As Received		Dilution Factor
				Method	Units	
01728	TPH-GRO - Waters	n.a.	430.	Detection Limit 250.	ug/l	5
The reported concentration of TPH-GRO does not include MTBE or other gasoline constituents eluting prior to the C6 (n-hexane) TPH-GRO range start time.						
06609	TPH-DRO CALUFT(Waters)	n.a.	2,200.	270.	ug/l	10
01594	BTEX+5 Oxygenates+EDC+EDB+ETOH					
01587	Ethanol	64-17-5	N.D.	250.	ug/l	5
02010	Methyl Tertiary Butyl Ether	1634-04-4	5,100.	25.	ug/l	50
05401	Benzene	71-43-2	6.	3.	ug/l	5
05407	Toluene	108-88-3	N.D.	3.	ug/l	5
05415	Ethylbenzene	100-41-4	N.D.	3.	ug/l	5
06310	Xylene (Total)	1330-20-7	N.D.	3.	ug/l	5

Due to the level of methyl tertiary butyl ether, the reporting limits for all GC/MS volatile compounds were raised.

State of California Lab Certification No. 2116

Laboratory Chronicle

CAT No.	Analysis Name	Method	Trial#	Analysis		Analyst	Dilution Factor
				Date	Time		
01728	TPH-GRO - Waters	N. CA LUFT Gasoline	1	01/03/2005	04:40	Linda C Pape	5
06609	TPH-DRO CALUFT(Waters)	Method CALUFT-DRO/8015B, Modified	1	12/31/2004	19:56	Tracy A Cole	10
01594	BTEX+5 Oxygenates+EDC+EDB+ETOH	SW-846 8260B	1	01/03/2005	11:25	Ginelle L Haines	5
01594	BTEX+5 Oxygenates+EDC+EDB+ETOH	SW-846 8260B	1	01/03/2005	11:49	Ginelle L Haines	50
01146	GC VOA Water Prep	SW-846 5030B	1	01/03/2005	04:40	Linda C Pape	5
01163	GC/MS VOA Water Prep	SW-846 5030B	1	01/03/2005	11:25	Ginelle L Haines	n.a.
01163	GC/MS VOA Water Prep	SW-846 5030B	2	01/03/2005	11:49	Ginelle L Haines	n.a.
02135	Extraction - DRO Water Special	TPH by CA LUFT	1	12/29/2004	02:30	Felix C Arroyo	1

Lancaster Laboratories Sample No. WW 4437832

 MW-3A-W-041223 Grab Water
 Facility# 90121 Job# 386462 GRD
 3026 Lakeshore - Oakland T0600100328 MW-3A
 Collected: 12/23/2004 12:10 by AS

Account Number: 10904

 Submitted: 12/28/2004 09:30
 Reported: 01/06/2005 at 23:39
 Discard: 02/06/2005

 ChevronTexaco
 6001 Bollinger Canyon Rd L4310
 San Ramon CA 94583

LAKE3

CAT No.	Analysis Name	CAS Number	As Received		Units	Dilution Factor
			As Received Result	Method Detection Limit		
01728	TPH-GRO - Waters	n.a.	76.	50.	ug/l	1
	The reported concentration of TPH-GRO does not include MTBE or other gasoline constituents eluting prior to the C6 (n-hexane) TPH-GRO range start time.					
06609	TPH-DRO CALUFT(Waters)	n.a.	330.	50.	ug/l	1
01594	BTEX+5 Oxygenates+EDC+EDB+ETOH					
01587	Ethanol	64-17-5	N.D.	50.	ug/l	1
02010	Methyl Tertiary Butyl Ether	1634-04-4	5.	0.5	ug/l	1
05401	Benzene	71-43-2	N.D.	0.5	ug/l	1
05407	Toluene	108-88-3	N.D.	0.5	ug/l	1
05415	Ethylbenzene	100-41-4	N.D.	0.5	ug/l	1
06310	Xylene (Total)	1330-20-7	N.D.	0.5	ug/l	1

State of California Lab Certification No. 2116

Laboratory Chronicle

CAT No.	Analysis Name	Method	Analysis		Analyst	Dilution Factor
			Trial#	Date and Time		
01728	TPH-GRO - Waters	N. CA LUFT Gasoline	1	01/03/2005 05:12	Linda C Pape	1
06609	TPH-DRO CALUFT(Waters)	Method CALUFT-DRO/8015B, Modified	1	12/31/2004 18:38	Tracy A Cole	1
01594	BTEX+5 Oxygenates+EDC+EDB+ETOH	SW-846 8260B	1	01/03/2005 12:14	Ginelle L Haines	1
01146	GC VOA Water Prep	SW-846 5030B	1	01/03/2005 05:12	Linda C Pape	1
01163	GC/MS VOA Water Prep	SW-846 5030B	1	01/03/2005 12:14	Ginelle L Haines	n.a.
02135	Extraction - DRO Water Special	TPH by CA LUFT	1	12/29/2004 02:30	Felix C Arroyo	1



Analysis Report

2425 New Holland Pike, PO Box 12425, Lancaster, PA 17605-2425 • 717-656-2300 Fax: 717-656-2681 • www.lancasterlabs.com

Page 1 of 1

Lancaster Laboratories Sample No. WW 4437833

MW-4A-W-041223 Grab Water
 Facility# 90121 Job# 386462 GRD
 3026 Lakeshore - Oakland T0600100328 MW-4A
 Collected: 12/23/2004 12:45 by AS

Account Number: 10904

Submitted: 12/28/2004 09:30
 Reported: 01/06/2005 at 23:39
 Discard: 02/06/2005

ChevronTexaco
 6001 Bollinger Canyon Rd L4310
 San Ramon CA 94583

LAKE4

CAT No.	Analysis Name	CAS Number	As Received		Units	Dilution Factor
			As Received Result	Method Detection Limit		
01728	TPH-GRO - Waters	n.a.	1,500.	250.	ug/l	5
	The reported concentration of TPH-GRO does not include MTBE or other gasoline constituents eluting prior to the C6 (n-hexane) TPH-GRO range start time.					
06609	TPH-DRO CALUFT (Waters)	n.a.	2,800.	260.	ug/l	10
01594	BTEX+5 Oxygenates+EDC+EDB+ETOH					
01587	Ethanol	64-17-5	N.D.	100.	ug/l	2
02010	Methyl Tertiary Butyl Ether	1634-04-4	3,000.	10.	ug/l	20
05401	Benzene	71-43-2	7.	1.	ug/l	2
05407	Toluene	108-88-3	3.	1.	ug/l	2
05415	Ethylbenzene	100-41-4	4.	1.	ug/l	2
06310	Xylene (Total)	1330-20-7	4.	1.	ug/l	2

Due to the level of methyl tertiary butyl ether, the reporting limits for all GC/MS volatile compounds were raised.

State of California Lab Certification No. 2116

Laboratory Chronicle

CAT No.	Analysis Name	Method	Analysis		Analyst	Dilution Factor
			Trial#	Date and Time		
01728	TPH-GRO - Waters	N. CA LUFT Gasoline	1	01/03/2005 05:44	Linda C Pape	5
06609	TPH-DRO CALUFT (Waters)	CALUFT-DRO/8015B, Modified	1	12/31/2004 20:22	Tracy A Cole	10
01594	BTEX+5 Oxygenates+EDC+EDB+ETOH	SW-846 8260B	1	01/03/2005 13:29	Ginelle L Haines	2
01594	BTEX+5 Oxygenates+EDC+EDB+ETOH	SW-846 8260B	1	01/03/2005 13:53	Ginelle L Haines	20
01146	GC VOA Water Prep	SW-846 5030B	1	01/03/2005 05:44	Linda C Pape	5
01163	GC/MS VOA Water Prep	SW-846 5030B	1	01/03/2005 13:29	Ginelle L Haines	n.a.
01163	GC/MS VOA Water Prep	SW-846 5030B	2	01/03/2005 13:53	Ginelle L Haines	n.a.
02135	Extraction - DRO Water Special	TPH by CA LUFT	1	12/29/2004 02:30	Felix C Arroyo	1



Analysis Report

2425 New Holland Pike, PO Box 12425, Lancaster, PA 17605-2425 • 717-656-2300 Fax: 717-656-2681 • www.lancasterlabs.com

Page 1 of 1

Lancaster Laboratories Sample No. **WW 4437834**

MW-9-W-041223 Grab Water
 Facility# 90121 Job# 386462 GRD
 3026 Lakeshore - Oakland T0600100328 MW-9
 Collected: 12/23/2004 10:20 by AS

Account Number: 10904

Submitted: 12/28/2004 09:30
 Reported: 01/06/2005 at 23:39
 Discard: 02/06/2005

ChevronTexaco
 6001 Bollinger Canyon Rd L4310
 San Ramon CA 94583

LAKE9

CAT No.	Analysis Name	CAS Number	As Received Result	As Received	Units	Dilution Factor
				Method		
01728	TPH-GRO - Waters	n.a.	2,900.	250.	ug/l	5
	The reported concentration of TPH-GRO does not include MTBE or other gasoline constituents eluting prior to the C6 (n-hexane) TPH-GRO range start time.					
06609	TPH-DRO CALUFT(Waters)	n.a.	3,400.	260.	ug/l	10
01594	BTEX+5 Oxygenates+EDC+EDB+ETOH					
01587	Ethanol	64-17-5	N.D.	50.	ug/l	1
02010	Methyl Tertiary Butyl Ether	1634-04-4	93.	0.5	ug/l	1
05401	Benzene	71-43-2	4.	0.5	ug/l	1
05407	Toluene	108-88-3	4.	0.5	ug/l	1
05415	Ethylbenzene	100-41-4	4.	0.5	ug/l	1
06310	Xylene (Total)	1330-20-7	4.	0.5	ug/l	1

State of California Lab Certification No. 2116

Laboratory Chronicle

CAT No.	Analysis Name	Method	Trial#	Analysis	Analyst	Dilution Factor
				Date and Time		
01728	TPH-GRO - Waters	N. CA LUFT Gasoline	1	01/03/2005 06:17	Linda C Pape	5
06609	TPH-DRO CALUFT(Waters)	CALUFT-DRO/8015B, Modified	1	12/31/2004 20:47	Tracy A Cole	10
01594	BTEX+5 Oxygenates+EDC+EDB+ETOH	SW-846 8260B	1	01/03/2005 14:18	Ginelle L Haines	1
01146	GC VOA Water Prep	SW-846 5030B	1	01/03/2005 06:17	Linda C Pape	5
01163	GC/MS VOA Water Prep	SW-846 5030B	1	01/03/2005 14:18	Ginelle L Haines	n.a.
02135	Extraction - DRO Water Special	TPH by CA LUFT	1	12/29/2004 02:30	Felix C Arroyo	1

Quality Control Summary

 Client Name: ChevronTexaco
 Reported: 01/06/05 at 11:39 PM

Group Number: 926478

Matrix QC may not be reported if site-specific QC samples were not submitted. In these situations, to demonstrate precision and accuracy at a batch level, a LCS/LCSD was performed, unless otherwise specified in the method.

Laboratory Compliance Quality Control

Analysis Name	Blank Result	Blank MDL	Report Units	LCS %REC	LCSD %REC	LCS/LCSD Limits	RPD	RPD Max
Batch number: 043630007A TPH-DRO CALUPT (Waters)	N.D.	50.	ug/l	84	89	61-126	6	20
Batch number: 04365A53C TPH-GRO - Waters	N.D.	50.	ug/l	102	101	70-130	1	30
Batch number: Z050012AA Methyl Tertiary Butyl Ether	N.D.	0.5	ug/l	96		77-127		
Benzene	N.D.	0.5	ug/l	103		85-117		
Toluene	N.D.	0.5	ug/l	103		85-115		
Ethylbenzene	N.D.	0.5	ug/l	104		82-119		
Xylene (Total)	N.D.	0.5	ug/l	101		83-113		
Batch number: Z050031AA Ethanol	N.D.	50.	ug/l	92		46-145		
Methyl Tertiary Butyl Ether	N.D.	0.5	ug/l	97		77-127		
Benzene	N.D.	0.5	ug/l	102		85-117		
Toluene	N.D.	0.5	ug/l	102		85-115		
Ethylbenzene	N.D.	0.5	ug/l	104		82-119		
Xylene (Total)	N.D.	0.5	ug/l	102		83-113		

Sample Matrix Quality Control

Analysis Name	MS %REC	MSD %REC	MS/MSD Limits	RPD	RPD MAX	BKG Conc	DUP Conc	DUP RPD	Dup RPD Max
Batch number: 04365A53C TPH-GRO - Waters	90		63-154						
Batch number: Z050012AA Methyl Tertiary Butyl Ether	87	91	69-134	1	30				
Benzene	108	104	83-128	3	30				
Toluene	108	106	83-127	2	30				
Ethylbenzene	109	107	82-129	2	30				
Xylene (Total)	106	103	82-130	3	30				
Batch number: Z050031AA Ethanol	96	99	33-153	3	30				
Methyl Tertiary Butyl Ether	109	97	69-134	9	30				
Benzene	108	109	83-128	1	30				
Toluene	107	109	83-127	2	30				
Ethylbenzene	110	111	82-129	1	30				

*- Outside of specification

- (1) The result for one or both determinations was less than five times the LOQ.
- (2) The background result was more than four times the spike added.

Quality Control Summary

 Client Name: ChevronTexaco
 Reported: 01/06/05 at 11:39 PM

Group Number: 926478

Sample Matrix Quality Control

Analysis Name	MS %REC	MSD %REC	MS/MSD Limits	RPD	RPD MAX	BKG Conc	DUP Conc	DUP RPD	Dup RPD Max
Xylene (Total)	107	108	82-130	1	30				

Surrogate Quality Control

 Analysis Name: TPH-DRO CALUFT (Waters)
 Batch number: 043630007A
 Orthoterphenyl

4437830	106
4437831	87
4437832	86
4437833	83
4437834	100
Blank	90
LCS	108
LCSD	112

Limits: 57-128

 Analysis Name: TPH-GRO - Waters
 Batch number: 04365A53C
 Trifluorotoluene-F

4437829	94
4437830	136
4437831	96
4437832	97
4437833	98
4437834	112
Blank	94
LCS	94
LCSD	94
MS	93

Limits: 57-146

 Analysis Name: BTEX+MTBE by 8260B
 Batch number: Z050012AA

	Dibromofluoromethane	1,2-Dichloroethane-d4	Toluene-d8	4-Bromofluorobenzene
4437829	102	103	107	102
Blank	103	102	107	103
LCS	103	102	106	103
MS	102	103	107	103
MSD	103	103	106	104

Limits: 81-120 82-112 85-112 83-113

 Analysis Name: BTEX+5 Oxygenates+EDC+EDE+ETOH
 Batch number: Z050031AA

	Dibromofluoromethane	1,2-Dichloroethane-d4	Toluene-d8	4-Bromofluorobenzene
4437829	102	103	107	102
Blank	103	102	107	103
LCS	103	102	106	103
MS	102	103	107	103
MSD	103	103	106	104

*- Outside of specification

- (1) The result for one or both determinations was less than five times the LOQ.
- (2) The background result was more than four times the spike added.

Quality Control Summary

Client Name: ChevronTexaco
Reported: 01/06/05 at 11:39 PM

Group Number: 926478

Surrogate Quality Control

4437830	102	101	103	105
4437831	103	100	103	100
4437832	102	101	104	102
4437833	102	101	104	102
4437834	101	101	105	106
Blank	102	101	104	101
LCS	102	102	104	102
MS	103	101	104	103
MSD	103	100	103	103
Limits:	81-120	82-112	85-112	83-113

*- Outside of specification

- (1) The result for one or both determinations was less than five times the LOQ.
- (2) The background result was more than four times the spike added.

Explanation of Symbols and Abbreviations

The following defines common symbols and abbreviations used in reporting technical data:

N.D.	none detected	BMQL	Below Minimum Quantitation Level
TNTC	Too Numerous To Count	MPN	Most Probable Number
IU	International Units	CP Units	cobalt-chloroplatinate units
umhos/cm	micromhos/cm	NTU	nephelometric turbidity units
C	degrees Celsius	F	degrees Fahrenheit
meq	milliequivalents	lb.	pound(s)
g	gram(s)	kg	kilogram(s)
ug	microgram(s)	mg	milligram(s)
ml	milliliter(s)	l	liter(s)
m3	cubic meter(s)	ul	microliter(s)
<	less than - The number following the sign is the <u>limit of quantitation</u> , the smallest amount of analyte which can be reliably determined using this specific test.		
>	greater than		
J	estimated value - The result is \geq the Method Detection Limit (MDL) and $<$ the Limit of Quantitation (LOQ).		
ppm	parts per million - One ppm is equivalent to one milligram per kilogram (mg/kg), or one gram per million grams. For aqueous liquids, ppm is usually taken to be equivalent to milligrams per liter (mg/l), because one liter of water has a weight very close to a kilogram. For gases or vapors, one ppm is equivalent to one microliter of gas per liter of gas.		
ppb	parts per billion		
Dry weight basis	Results printed under this heading have been adjusted for moisture content. This increases the analyte weight concentration to approximate the value present in a similar sample without moisture. All other results are reported on an as-received basis.		

U.S. EPA CLP Data Qualifiers:

Organic Qualifiers

A	TIC is a possible aldol-condensation product
B	Analyte was also detected in the blank
C	Pesticide result confirmed by GC/MS
D	Compound quantitated on a diluted sample
E	Concentration exceeds the calibration range of the instrument
N	Presumptive evidence of a compound (TICs only)
P	Concentration difference between primary and confirmation columns >25%
U	Compound was not detected
X,Y,Z	Defined in case narrative

Inorganic Qualifiers

B	Value is $<$ CRDL, but \geq IDL
E	Estimated due to interference
M	Duplicate injection precision not met
N	Spike sample not within control limits
S	Method of standard additions (MSA) used for calculation
U	Compound was not detected
W	Post digestion spike out of control limits
*	Duplicate analysis not within control limits
+	Correlation coefficient for MSA $<$ 0.995

Analytical test results for methods listed on the laboratories' accreditation scope meet all requirements of NELAC unless otherwise noted under the individual analysis.

Measurement uncertainty values, as applicable, are available upon request.

Tests results relate only to the sample tested. Clients should be aware that a critical step in a chemical or microbiological analysis is the collection of the sample. Unless the sample analyzed is truly representative of the bulk of material involved, the test results will be meaningless. If you have questions regarding the proper techniques of collecting samples, please contact us. We cannot be held responsible for sample integrity, however, unless sampling has been performed by a member of our staff. This report shall not be reproduced except in full, without the written approval of the laboratory.

WARRANTY AND LIMITS OF LIABILITY - In accepting analytical work, we warrant the accuracy of test results for the sample as submitted. THE FOREGOING EXPRESS WARRANTY IS EXCLUSIVE AND IS GIVEN IN LIEU OF ALL OTHER WARRANTIES, EXPRESSED OR IMPLIED. WE DISCLAIM ANY OTHER WARRANTIES, EXPRESSED OR IMPLIED, INCLUDING A WARRANTY OF FITNESS FOR PARTICULAR PURPOSE AND WARRANTY OF MERCHANTABILITY. IN NO EVENT SHALL LANCASTER LABORATORIES BE LIABLE FOR INDIRECT, SPECIAL, CONSEQUENTIAL, OR INCIDENTAL DAMAGES INCLUDING, BUT NOT LIMITED TO, DAMAGES FOR LOSS OF PROFIT OR GOODWILL REGARDLESS OF (A) THE NEGLIGENCE (EITHER SOLE OR CONCURRENT) OF LANCASTER LABORATORIES AND (B) WHETHER LANCASTER LABORATORIES HAS BEEN INFORMED OF THE POSSIBILITY OF SUCH DAMAGES. We accept no legal responsibility for the purposes for which the client uses the test results. No purchase order or other order for work shall be accepted by Lancaster Laboratories which includes any conditions that vary from the Standard Terms and Conditions of Lancaster Laboratories and we hereby object to any conflicting terms contained in any acceptance or order submitted by client.