

Environmental Management
Company
6001 Bollinger Canyon Rd, L4050
P.O. Box 6012
San Ramon, CA 94583-2324
Tel 925-842-1589
Fax 925-842-8370

Karen Streich
Project Manager

R0284

April 28, 2004

ChevronTexaco

Alameda County Health Care Services
1131 Harbor Bay Parkway, Suite 250
Alameda, CA 94502-6577

Re: Chevron Service Station # 9-0121

Address: 3026 Lakeshore Avenue, Oakland, CA

I have reviewed the attached routine groundwater monitoring report dated April 8, 2004.

I agree with the conclusions and recommendations presented in the referenced report. The information in this report is accurate to the best of my knowledge and all local Agency/Regional Board guidelines have been followed. This report was prepared by Gettler-Ryan, Inc., upon whose assistance and advice I have relied.

This letter is submitted pursuant to the requirements of California Water Code Section 13267(b)(1) and the regulating implementation entitled Appendix A pertaining thereto.

I declare under penalty of perjury that the foregoing is true and correct.

Sincerely,



Karen Streich
Project Manager

Enclosure: Report

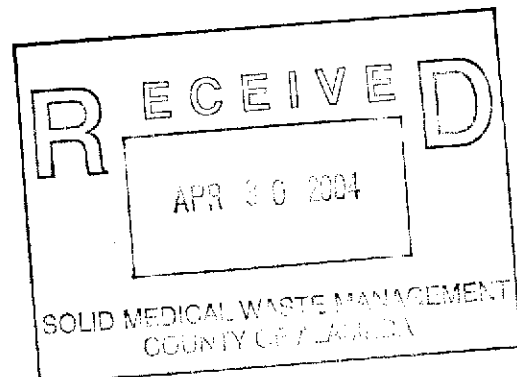



GETTLER-RYAN INC.

TRANSMITTAL

April 8, 2004
G-R #386462

TO: Mr. Tom Sparrowe
Cambria Environmental Technology, Inc.
5900 Hollis Street, Suite A
Emeryville, CA 94608

CC: Ms. Karen Streich
ChevronTexaco Company
P.O. Box 6004
San Ramon, California 94583

FROM: Deanna L. Harding
Project Coordinator
Gettler-Ryan Inc.
6747 Sierra Court, Suite J
Dublin, California 94568

RE: **Chevron Service Station
#9-0121
3026 Lakeshore Avenue
Oakland, California**

WE HAVE ENCLOSED THE FOLLOWING:

COPIES	DATED	DESCRIPTION
1	April 1, 2004	Groundwater Monitoring and Sampling Report First Quarter - Event of March 9, 2004

COMMENTS:

Please provide any comments/changes and propose any groundwater monitoring modifications for the next event prior to *April 27, 2004*, at which time the final report will be distributed to the following:

cc: Ms. Eva Chu, Alameda County Health Care Services, Dept. of Environmental Health, 1131 Harbor Bay Parkway, Suite 250, Alameda, CA 94502-6577

Enclosures

trans/9-0121-KS



GETTLER - RYAN INC.

April 1, 2004
G-R Job #386462

Ms. Karen Streich
ChevronTexaco Company
P.O. Box 6004
San Ramon, CA 94583

RE: First Quarter Event of March 9, 2004
Groundwater Monitoring & Sampling Report
Chevron Service Station #9-0121
3026 Lakeshore Avenue
Oakland, California

Dear Ms. Streich:

This report documents the most recent groundwater monitoring and sampling event performed by Gettler-Ryan Inc. (G-R) at the referenced site. All field work was conducted in accordance with G-R Standard Operating Procedure - Groundwater Sampling (attached).

Static groundwater levels were measured and the wells were checked for the presence of separate-phase hydrocarbons. Static water level data, groundwater elevations, and separate-phase hydrocarbon thickness (if any) are presented in the attached Table 1. A Potentiometric Map is included as Figure 1. Dissolved Oxygen concentrations are presented in Table 2.

Groundwater samples were collected from the monitoring wells and submitted to a state certified laboratory for analyses. The field data sheets for this event are attached. Analytical results are presented in the table(s) listed below. The chain of custody document and laboratory analytical report are also attached.

Please call if you have any questions or comments regarding this report. Thank you.

Sincerely,

Deanna L. Harding
Project Coordinator

Hagop Kevork
P.E. No. C55734



- Figure 1: Potentiometric Map
- Table 1: Groundwater Monitoring Data and Analytical Results
- Table 2: Dissolved Oxygen Concentrations
- Table 3: Groundwater Analytical Results
- Attachments: Standard Operating Procedure - Groundwater Sampling
Field Data Sheets
Chain of Custody Document and Laboratory Analytical Reports

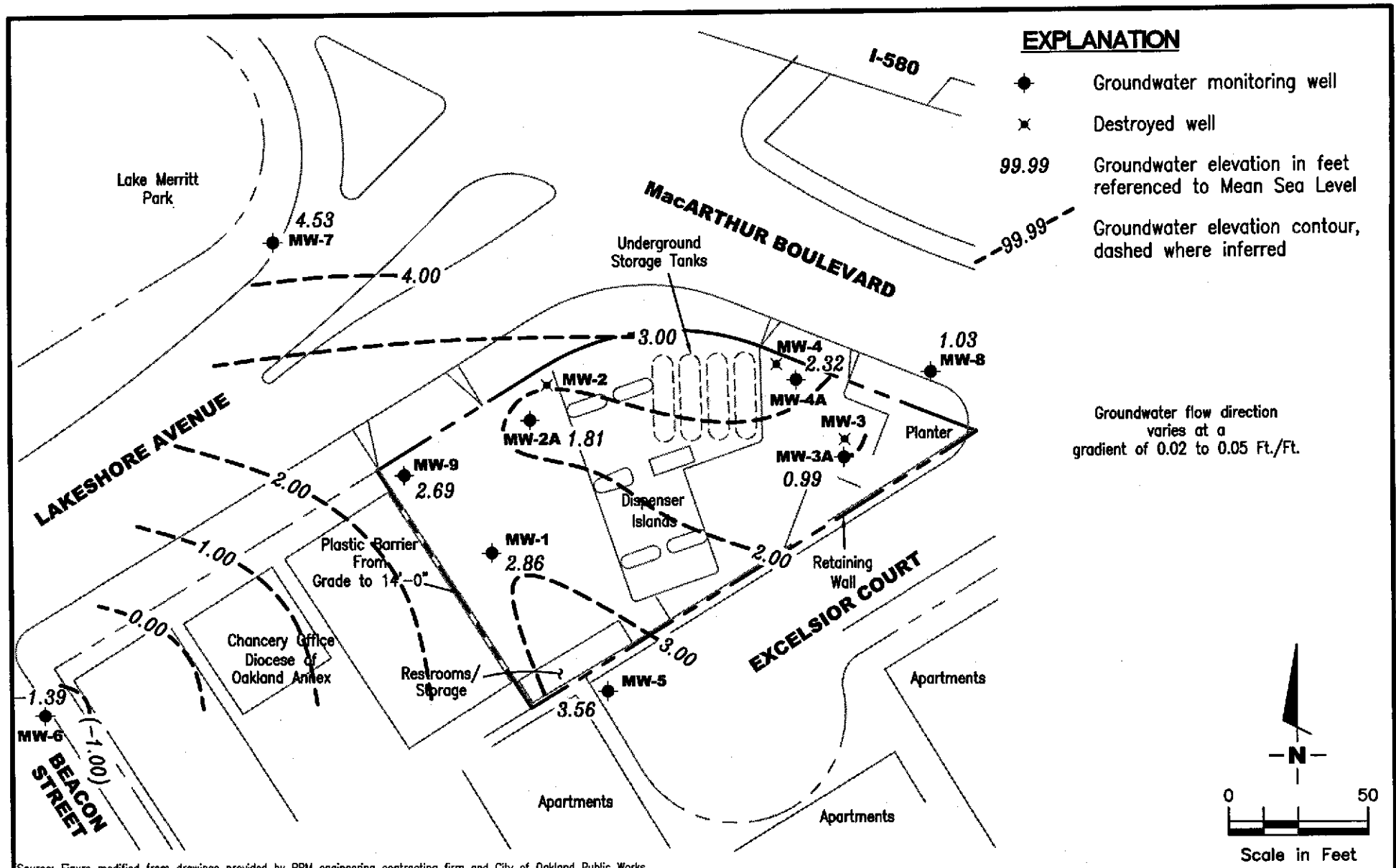

Source: Figure modified from drawings provided by RRM engineering contracting firm and City of Oakland Public Works.

GETTLER - RYAN INC.
 6747 Sierra Court, Suite J
 Dublin, CA 94568 (925) 551-7555

POTENTIOMETRIC MAP
 Chevron Service Station #9-0121
 3026 Lakeshore Avenue
 Oakland, California

FIGURE

1

PROJECT NUMBER
 386462

REVIEWED BY

DATE
 March 9, 2004

REVISED DATE

Table 1
Groundwater Monitoring Data and Analytical Results
Chevron Service Station #9-0121
3026 Lakeshore Avenue
Oakland, California

WELL ID/ DATE	TOC (ft.)	GWE (msl)	DTW (ft.)	SPHT (ft.)	SPH REMOVED (gallons)	TPH-D (ppb)	TPH-G (ppb)	B (ppb)	T (ppb)	E (ppb)	X (ppb)	MTBE (ppb)	ETHANOL (ppb)	TDS (ppb)
MW-1														
08/20/91	6.82	1.62	5.20	--	--	260	5,100	1,700	21	220	34	--	--	--
09/30/91	6.82	1.15	5.67	Sheen	--	--	--	--	--	--	--	--	--	--
10/28/91	6.82	1.50	5.30	0.03	--	--	--	--	--	--	--	--	--	--
01/08/92	6.82	1.67	5.15	Sheen	--	4,400	5,400	770	13	95	31	--	--	--
01/13/92	6.82	--	--	--	--	--	--	--	--	--	--	--	--	--
06/23/92	6.89	1.48	5.41	--	--	2,000	7,700	1,500	40	230	100	--	--	--
08/24/92	6.89	1.12	5.77	--	--	--	--	--	--	--	--	--	--	--
09/21/92	6.89	1.00	5.89	--	--	<50	3,500	1,700	28	190	78	--	--	--
10/26/92	6.89	0.95	5.94	--	--	--	--	--	--	--	--	--	--	--
12/23/92	6.89	2.18	4.71	--	--	5,500	60,000	7,100	240	2,000	1,300	--	--	--
01/08/93	6.89	--	--	--	--	--	--	--	--	--	--	--	--	--
03/25/93	6.89	2.17	4.72	--	--	<10	530	1,100	41	67	79	--	--	--
06/11/93	6.89	5.37	5.07	--	--	--	7,000	1,900	33	120	69	9,600	--	840
09/29/93	6.89	1.13	5.76	--	--	<10	6,600	1,600	28	43	74	--	--	--
12/20/93	6.89	1.74	5.15	--	--	<10	6,300	1,900	36	82	65	--	--	--
03/07/94	6.89	2.21	4.68	--	--	<10	7,700	1,100	55	66	38	12,000	--	--
06/17/94	6.89	1.83	5.06	--	--	2,200	4,300	710	12	90	38	--	--	--
09/12/94	6.89	1.24	5.65	--	--	2,500	6,400	1,500	<25	180	<25	12,000	--	--
11/30/94	6.89	2.32	4.57	--	--	2,300 ¹	4,900	690	26	97	60	3,900	--	--
03/24/95	6.89	3.91	2.98	--	--	1,400 ²	1,800	160	7.3	11	14	1,300	--	--
06/27/95	6.89	1.87	5.02	--	--	2,300 ²	4,600	1,300	11	97	13	5,100	--	--
09/28/95	6.89	1.59	5.30	--	--	3,900 ²	6,600	1,500	<20	<20	<20	5,800	--	--
12/19/95	6.89	2.21	4.68	--	--	2,600 ²	3,800	930	<10	100	<10	6,300	--	--
02/28/96	6.89	3.27	3.62	--	--	1,800 ²	3,600	280	<5.0	18	5.5	2,200	--	--
06/25/96	6.89	1.87	5.02	--	--	3,000	4,700	1,600	36	150	31	3,000	--	--
12/17/96	6.89	2.23	4.66	--	--	2,700 ³	7,800	1,000	28	340	63	1,200	--	--
03/31/97	6.89	2.01	4.88	--	--	2,200 ²	5,300	590	55	210	53	950	--	--
06/30/97	6.89	1.32	5.57	--	--	2,200 ²	4,400	350	<10	<10	11	580	--	--
09/12/97	6.89	1.56	5.33	--	--	2,300 ²	3,400	220	9.5	15	11	460	--	--
12/05/97	6.89	2.44	4.45	--	--	1,900 ²	4,700	870	21	120	18	750	--	--
02/16/98	6.89	3.52	3.37	--	--	1,600 ²	4,400	120	12	11	7.7	270	--	--
06/17/98	6.89	2.24	4.65	--	--	1,300 ²	7,800	<25	50	34	650	650	--	--

Table 1
Groundwater Monitoring Data and Analytical Results
Chevron Service Station #9-0121
3026 Lakeshore Avenue
Oakland, California

WELL ID/ DATE	TOC (ft.)	GWE (msl)	DTW (ft.)	SPHT (ft.)	SPH REMOVED (gallons)	TPH-D (ppb)	TPH-G (ppb)	B (ppb)	T (ppb)	E (ppb)	X (ppb)	MTBE (ppb)	ETHANOL (ppb)	TDS (ppb)
MW-1 (cont)														
08/31/98	6.89	1.70	5.19	--	--	2,400 ²	3,700	620	17	120	31	380	--	--
12/28/98	6.89	1.94	4.95	--	--	1,500 ²	3,800	250	14	28	15	330	--	--
03/04/99	6.89	3.24	3.65	--	--	1,070 ²	1,560	17.9	<0.5	4.17	1.05	70.4	--	--
06/14/99	6.89	1.89	5.00	--	--	2,500 ²	<10,000	820	240	320	640	<500	--	--
09/17/99	6.89	0.30	6.59	--	--	2,110 ²	3,300	141	12.3	<10	<10	238	--	--
12/20/99	6.89	1.92	4.97	--	--	1,840 ²	2,990	218	16.3	20	<10	232	--	--
03/20/00	6.89	3.11	3.78	--	--	938 ²	1,340	20	3.07	1.87	1.87	29.1	--	--
06/24/00 ⁵	6.89	2.45	4.44	0.00	0.00	1,680 ⁹	1,500 ⁷	12	5.3	<2.5	7.9	190	--	--
09/07/00 ⁵	6.89	1.74	5.15	0.00	0.00	1,500 ⁹	3,100 ⁷	190	13	14	<10	210	--	--
12/05/00 ⁵	6.89	2.16	4.73	0.00	0.00	970 ¹³	2,140 ¹⁴	248	<5.00	20.5	<5.00	<25.0	--	--
03/01/01 ⁵	6.89	3.33	3.56	0.00	0.00	610 ⁹	1,000 ⁷	21	<10	<10	<10	280	--	--
06/04/01 ⁵	6.89	2.13	4.76	0.00	0.00	1,100 ⁹	2,800 ⁷	310	23	11	15	470	--	--
09/10/01 ⁵	6.89	1.28	5.61	0.00	0.00	2,600	2,500 ¹⁶	<20	26	<20	<20	310	--	--
12/03/01 ⁵	6.89	3.31	3.58	0.00	0.00	2,700	2,400	30	7.3	7.0	6.5	160	--	--
03/04/02 ⁵	6.89	2.36	4.53	0.00	0.00	2,700	3,300	120	17	22	9.0	110	--	--
05/30/02 ⁵	6.89	2.41	4.48	0.00	0.00	2,700	4,100	110	9.3	22	11	100	--	--
09/03/02 ⁵	6.89	1.42	5.47	0.00	0.00	2,900	3,700	<5.0	7.8	3.2	10	130	--	--
12/09/02 ⁵	6.89	1.61	5.28	0.00	0.00	3,000	2,900	35	5.1	5.5	8.3	170	--	--
03/10/03 ⁵	6.89	2.50	4.39	0.00	0.00	1,600	3,000	42	5.0	8.2	8.7	110	--	--
06/09/03 ^{5,18}	6.89	2.53	4.36	0.00	0.00	2,000	5,200	140	16	20	15	100	--	--
09/08/03 ^{5,18}	6.89	1.52	5.37	0.00	0.00	2,100	3,500	4	10	2	11	200	<50	--
12/08/03 ^{5,18}	6.89	2.44	4.45	0.00	0.00	3,400	2,200	8	4	3	8	160	<50	--
03/09/04 ^{18,20}	6.89	2.86	4.03	0.00	0.00	3,300	1,500	16	3	5	4	99	<130	--
MW-2														
08/20/91	6.27	1.92	4.35	--	--	600	9,300	3,700	55	530	75	--	--	--
09/30/91	6.27	1.28	4.99	--	--	--	3,500	2,600	47	440	68	--	--	--
10/28/91	6.27	1.36	4.91	--	--	--	4,600	1,800	29	290	53	--	--	--
01/08/92	6.27	1.63	4.64	Sheen	--	--	14,000	4,300	70	<25	130	--	--	--
01/13/92	6.27	--	--	--	--	38,000	--	--	--	--	--	--	--	--
06/23/92	6.27	1.63	4.64	0.02	--	--	--	--	--	--	--	--	--	--

Table 1
Groundwater Monitoring Data and Analytical Results
Chevron Service Station #9-0121
3026 Lakeshore Avenue
Oakland, California

WELL ID/ DATE	TOC (ft.)	GWE (msl)	DTW (ft.)	SPHT (ft.)	SPH REMOVED (gallons)	TPH-D (ppb)	TPH-G (ppb)	B (ppb)	T (ppb)	E (ppb)	X (ppb)	MTBE (ppb)	ETHANOL (ppb)	TDS (ppb)
MW-2 (cont)														
08/24/92	6.27	1.34	4.94	0.02	--	--	--	--	--	--	--	--	--	--
09/21/92	6.27	1.20	5.08	0.01	--	--	--	--	--	--	--	--	--	--
10/26/92	6.27	0.34	5.93	--	--	--	--	--	--	--	--	--	--	--
12/23/92	6.27	--	--	--	--	160,000	21,000	5,400	59	1,300	160	--	--	--
01/08/93	6.27	2.57	3.70	--	--	--	--	--	--	--	--	--	--	--
03/25/93	6.27	2.89	3.38	Sheen	--	--	--	--	--	--	--	--	--	--
06/11/93	6.27	2.09	4.18	--	--	--	5,900	1,100	23	240	51	--	--	2,300
09/29/93	6.27	0.07	6.20	--	--	--	--	--	--	--	--	--	--	--
12/20/93	6.27	1.94	4.35	0.02	--	--	--	--	--	--	--	--	--	--
03/07/94	6.27	2.60	3.67	--	--	<10	26,000	5,700	170	1,000	150	--	--	--
06/17/94	6.27	2.25	4.02	Sheen	--	--	--	--	--	--	--	--	--	--
09/12/94	6.27	1.45	4.83	0.01	--	--	--	--	--	--	--	--	--	--
11/30/94	6.27	2.27	4.00	--	--	INACCESSIBLE			--	--	--	--	--	--
03/24/95	6.27	2.73	4.01	0.59	--	--	--	--	--	--	--	--	--	--
06/27/95	6.27	1.71	4.96	0.50	0.013	--	--	--	--	--	--	--	--	--
09/28/95	6.27	2.62	4.25	0.75	0.013	--	--	--	--	--	--	--	--	--
12/19/95	6.27	1.99	4.76	0.60	0.010	--	--	--	--	--	--	--	--	--
02/28/96	6.27	1.99	4.58	0.38	0.008	--	--	--	--	--	--	--	--	--
06/25/96	6.27	2.36	4.29	0.47	0.030	--	--	--	--	--	--	--	--	--
12/17/96	6.27	2.22	4.16	0.14	--	--	--	--	--	--	--	--	--	--
03/31/97	6.27	2.34	4.07	0.18	0.030	--	--	--	--	--	--	--	--	--
06/30/97	6.27	2.06	4.32	0.14	0.030	--	--	--	--	--	--	--	--	--
09/12/97	6.27	2.00	4.38	0.14	--	--	--	--	--	--	--	--	--	--
12/05/97	6.27	2.51	3.78	0.02	--	--	--	--	--	--	--	--	--	--
02/16/98	6.27	3.08	3.29	0.12	0.007	--	--	--	--	--	--	--	--	--
06/17/98	6.27	2.35	4.00	0.10	0.010	--	--	--	--	--	--	--	--	--
08/31/98	6.27	0.65	5.71	0.11	0.008	--	--	--	--	--	--	--	--	--
12/28/98	6.27	1.75	4.60	0.10	0.005	--	--	--	--	--	--	--	--	--
03/04/99	6.27	2.58	3.73	0.05	0.200	--	--	--	--	--	--	--	--	--
DESTROYED														

Table 1
Groundwater Monitoring Data and Analytical Results
Chevron Service Station #9-0121
3026 Lakeshore Avenue
Oakland, California

WELL ID/ DATE	TOC (ft.)	GWE (msl)	DTW (ft.)	SPHT (ft.)	SPH REMOVED (gallons)	TPH-D (ppb)	TPH-G (ppb)	B (ppb)	T (ppb)	E (ppb)	X (ppb)	MTBE (ppb)	ETHANOL (ppb)	TDS (ppb)
MW-2A														
04/19/99	6.53	1.67	4.86	--	--	820 ²	<2,000	<20	<20	<20	<20	9,200	--	--
06/14/99	6.53	1.23	5.30	--	--	2,000 ²	<5,000	89	<50	66	<50	10,000	--	--
09/17/99	6.53	0.69	5.84	--	--	1,050 ²	903	42	1.63	22.8	7.74	11,400	--	--
12/20/99	6.53	-0.07	6.60	--	--	2,820 ²	2,280	115	<10	87.2	27.2	14,000	--	--
03/20/00	6.53	1.74	4.79	--	--	1,220 ²	1,040	54.3	<5.0	33.8	12.1	10,900 ²	--	--
06/24/00	6.53	1.28	5.25	0.00	0.00	1,300 ⁹	690 ⁷	50	2.5	18	9.5	15,000 ⁸	--	--
09/07/00	6.53	1.09	5.44	0.00	0.00	770 ⁹	310 ⁷	6.7	1.4	1.6	3.8	16,000	--	--
12/05/00	6.53	1.16	5.37	0.00	0.00	810 ¹³	414 ¹⁴	32.4	<0.500	7.49	5.96	8,910 ⁸	--	--
03/01/01	6.53	2.03	4.50	0.00	0.00	590 ⁹	370 ⁷	30	4.0	12	9.2	8,200	--	--
06/04/01	6.53	1.36	5.17	0.00	0.00	930 ⁹	<500	19	<5.0	<5.0	<5.0	7,800	--	--
09/10/01	6.53	0.79	5.74	0.00	0.00	2,400	<5,000	<50	<50	<50	<50	9,700	--	--
12/03/01	6.53	1.46	5.07	0.00	0.00	2,500	480	4.5	<1.0	1.1	<3.0	10,000	--	--
03/04/02	6.53	1.52	5.01	0.00	0.00	2,300	630	5.4	1.5	2.9	2.3	7,000	--	--
05/30/02	6.53	1.66	4.87	0.00	0.00	2,100	520	6.1	<1.0	2.6	5.4	7,100	--	--
09/03/02	6.53	1.03	5.50	0.00	0.00	2,600	590	7.8	0.98	2.9	7.8	7,800	--	--
12/09/02	6.53	1.06	5.47	0.00	0.00	1,900	670	7.9	0.88	2.1	5.0	8,300	--	--
03/10/03	6.53	1.52	5.01	0.00	0.00	1,700	640	8.0	0.76	2.6	4.1	7,500	--	--
06/09/03 ¹⁸	6.53	1.77	4.76	0.00	0.00	1,900	540	3	<3	<3	<3	6,800	--	--
09/08/03 ¹⁸	6.53	1.16	5.37	0.00	0.00	2,000	540	3	0.7	0.7	3	7,000	<50	--
12/08/03 ¹⁸	6.53	1.34	5.19	0.00	0.00	3,100	480	<5	<5	<5	<5	6,500	<500	--
03/09/04 ¹⁸	6.53	1.81	4.72	0.00	0.00	1,200	1,300	44	2	15	10	2,900	<130	--
MW-3														
08/20/91	8.71	0.26	8.45	--	--	200	3,100	200	13	15	12	--	--	--
09/30/91	8.71	-0.03	8.74	--	--	--	1,000	150	8.3	13	6.7	--	--	--
10/28/91	8.71	-0.05	8.76	--	--	--	1,200	120	6.7	11	7.5	--	--	--
01/08/92	8.71	-0.06	8.77	--	--	--	410	120	0.9	4.1	3.4	--	--	--
01/13/92	8.71	--	--	--	--	220	--	--	--	--	--	--	--	--
06/23/92	8.71	0.03	8.68	--	--	<50	630	43	0.8	8.2	3.4	--	--	--
08/24/92	8.71	-0.14	8.85	--	--	--	--	--	--	--	--	--	--	--
09/21/92	8.71	-0.23	8.94	--	--	<50	1,800	730	1.4	66	39	--	--	--

Table 1
Groundwater Monitoring Data and Analytical Results
Chevron Service Station #9-0121
3026 Lakeshore Avenue
Oakland, California

WELL ID/ DATE	TOC (ft.)	GWE (mst)	DTW (ft.)	SPHT (ft.)	SPH REMOVED (gallons)	TPH-D (ppb)	TPH-G (ppb)	B (ppb)	T (ppb)	E (ppb)	X (ppb)	MTBE (ppb)	ETHANOL (ppb)	TDS (ppb)
MW-3 (cont)														
10/26/92	8.71	-0.36	9.07	--	--	--	--	--	--	--	--	--	--	--
12/23/92	8.71	--	--	--	--	850	840	270	3.4	15	4.2	--	--	--
01/08/93	8.71	1.02	7.69	--	--	--	--	--	--	--	--	--	--	--
03/25/93	8.71	0.97	7.74	--	--	<10	760	270	4.0	10	5.0	--	--	--
06/11/93	8.71	0.19	8.52	--	--	--	200	32	1.0	5.0	2.0	--	--	5,600
09/29/93	8.71	2.66	6.05	--	--	--	9,300	2,800	60	270	62	--	--	--
12/20/93	8.71	-0.12	8.83	--	--	<10	460	250	4.0	8.0	4.0	--	--	--
03/07/94	8.71	0.64	8.07	--	--	<10	2,400	260	13	35	18	--	--	--
06/17/94	8.71	0.19	8.52	--	--	<50	1,000	200	4.0	6.6	6.7	--	--	--
09/12/94	8.71	-0.21	8.92	--	--	<50	360	130	3.4	4.8	3.3	130	--	--
11/30/94	8.71	0.58	8.13	--	--	INACCESSIBLE		--	--	--	--	--	--	--
03/24/95	8.71	1.93	6.78	--	--	1,200 ²	4,100	920	<10	23	<10	70	--	--
06/27/95	8.71	0.49	8.22	--	--	1,000 ²	3,100	640	16	31	<10	<50	--	--
09/28/95	8.71	-0.14	8.85	--	--	460 ²	490	78	3.4	4.4	2.4	38	--	--
12/19/95	8.71	0.69	8.02	--	--	650 ²	2,600	580	<10	25	<10	<50	--	--
02/28/96	8.71	1.16	7.55	--	--	780 ²	1,500	510	<5.0	9.9	<5.0	<25	--	--
06/25/96	8.71	0.34	8.37	--	--	1,200 ²	1,300	390	7.8	14	6.5	31	--	--
12/17/96	8.71	0.41	8.30	--	--	1,100 ²	760	85	<1.2	5.9	5.1	<6.2	--	--
03/31/97	8.71	0.52	8.19	--	--	1,300 ²	2,000	380	12	24	12	<25	--	--
06/30/97	8.71	0.00	8.71	--	--	620 ²	1,900	340	9.9	23	6.1	<25	--	--
09/12/97	8.71	1.07	7.64	--	--	400 ²	1,200	200	4.6	14	4.8	3.9	--	--
12/05/97	8.71	0.46	8.25	--	--	190 ²	460	72	2.7	5.2	1.7	<5.0	--	--
02/16/98	8.71	1.71	7.00	--	--	1,000 ²	6,200	1,100	20	34	12	<50	--	--
06/17/98	8.71	0.71	8.00	--	--	1,100 ²	3,000	350	<10	<10	<10	120	--	--
08/31/98	8.71	0.08	8.63	--	--	790 ²	430	100	2.6	8.6	6.0	<12	--	--
12/28/98	8.71	-0.02	8.73	--	--	180 ²	1,400	220	<10	12	<10	<50	--	--
03/04/99	8.71	1.06	7.65	--	--	763 ²	2,880	355	9.15	19	<5.0	<20	--	--

DESTROYED

Table 1
Groundwater Monitoring Data and Analytical Results
 Chevron Service Station #9-0121
 3026 Lakeshore Avenue
 Oakland, California

WELL ID/ DATE	TOC (<i>ft.</i>)	GWE (<i>mst</i>)	DTW (<i>ft.</i>)	SPHT (<i>ft.</i>)	SPH REMOVED (<i>gallons</i>)	TPH-D (<i>ppb</i>)	TPH-G (<i>ppb</i>)	B (<i>ppb</i>)	T (<i>ppb</i>)	E (<i>ppb</i>)	X (<i>ppb</i>)	MTBE (<i>ppb</i>)	ETHANOL (<i>ppb</i>)	TDS (<i>ppb</i>)
MW-3A														
04/19/99	8.70	1.00	7.70	--	--	93 ²	<50	<0.5	<0.5	<0.5	<0.5	3.1	--	--
06/14/99	8.70	0.50	8.20	--	--	160 ²	148	4.55	0.82	0.53	1.1	3.7	--	--
09/17/99	8.70	-0.02	8.72	--	--	101 ²	169	6.02	0.806	0.515	0.786	4.68	--	--
12/20/99	8.70	-0.22	8.92	--	--	153 ²	<50	1.82	<0.5	<0.5	<0.5	11	--	--
03/20/00	8.70	1.06	7.64	--	--	223 ²	140	5.08	0.695	<0.5	<0.5	10.1	--	--
06/24/00	8.70	0.32	8.38	0.00	0.00	128 ⁹	<50	0.74	<0.50	<0.50	<0.50	34	--	--
09/07/00	8.70	-0.09	8.79	0.00	0.00	<50	<50	1.4	<0.50	<0.50	<0.50	15	--	--
12/05/00	8.70	0.02	8.68	0.00	0.00	<50	<50.0	1.39	<0.500	<0.500	<0.500	12.9	--	--
03/01/01	8.70	0.88	7.82	0.00	0.00	66 ¹¹	<50	1.0	<0.50	<0.50	<0.50	19	--	--
06/04/01	8.70	0.25	8.45	0.00	0.00	69 ⁹	<50	2.0	<0.50	<0.50	<0.50	37	--	--
09/10/01	8.70	-0.40	9.10	0.00	0.00	<50	<50	3.9	<0.50	<0.50	<0.50	19	--	--
12/03/01	8.70	0.62	8.08	0.00	0.00	56	<50	<0.50	<0.50	<0.50	<1.5	19	--	--
03/04/02	8.70	-0.24	8.94	0.00	0.00	85	<50	<0.50	<0.50	<0.50	<1.5	26	--	--
05/30/02	8.70	-0.08	8.78	0.00	0.00	210	<50	<0.50	<0.50	<0.50	<1.5	22	--	--
09/03/02	8.70	-0.28	8.98	0.00	0.00	89	<50	<0.50	<0.50	<0.50	<1.5	24	--	--
12/09/02	8.70	-0.20	8.90	0.00	0.00	110	<50	<0.50	<0.50	<0.50	<1.5	22	--	--
03/10/03	8.70	0.58	8.12	0.00	0.00	66	<50	<0.50	<0.50	<0.50	<1.5	40	--	--
06/09/03 ¹⁸	8.70	0.47	8.23	0.00	0.00	82	<50	<0.5	0.5	<0.5	<0.5	35	--	--
09/08/03 ¹⁸	8.70	-0.06	8.76	0.00	0.00	110	<50	<0.5	<0.5	<0.5	<0.5	27	<50	--
12/08/03 ¹⁸	8.70	0.20	8.50	0.00	0.00	74 ¹⁹	<50	<0.5	<0.5	<0.5	<0.5	23	<50	--
03/09/04 ¹⁸	8.70	0.99	7.71	0.00	0.00	410	53	1	<0.5	<0.5	<0.5	28	<50	--
MW-4														
08/20/91	7.37	1.32	5.05	--	--	160	1,800	870	4.0	3.0	9.0	--	--	--
09/30/91	7.37	1.70	5.67	--	--	--	670	830	5.5	2.7	12	--	--	--
10/28/91	7.37	1.56	5.81	--	--	--	2,800	990	5.8	4.8	19	--	--	--
01/08/92	7.37	2.03	5.34	--	--	--	2,900	1,200	10	7.0	18	--	--	--
01/13/92	7.37	--	--	--	--	1,000	--	--	--	--	--	--	--	--
06/23/92	7.37	2.00	5.37	--	--	<50	1,600	380	6.5	3.0	12	--	--	--
08/24/92	7.37	1.62	5.75	--	--	--	--	--	--	--	--	--	--	--
09/21/92	7.37	1.42	5.95	--	--	<50	1,200	480	5.6	3.7	11	--	--	--

Table 1
Groundwater Monitoring Data and Analytical Results
Chevron Service Station #9-0121
3026 Lakeshore Avenue
Oakland, California

WELL ID/ DATE	TOC (ft.)	GWE (msl)	DTW (ft.)	SPHT (ft.)	SPH REMOVED (gallons)	TPH-D (ppb)	TPH-G (ppb)	B (ppb)	T (ppb)	E (ppb)	X (ppb)	MTBE (ppb)	ETHANOL (ppb)	TDS (ppb)
MW-4 (cont)														
10/26/92	7.37	1.41	5.96	--	--	--	--	--	--	--	--	--	--	--
12/23/92	7.37	--	--	--	--	1,800	1,500	700	3.6	3.2	11	--	--	--
01/08/93	7.37	2.73	4.64	--	--	--	--	--	--	--	--	--	--	--
03/25/93	7.37	2.95	4.42	--	--	<10	520	160	3.0	1.0	4.0	--	--	2,600
06/11/93	7.37	2.25	5.12	--	--	--	1,200	430	5.0	6.0	11	--	--	--
09/29/93	7.37	1.57	5.80	--	--	--	1,300	210	8.0	2.0	14	--	--	--
12/20/93	7.37	2.27	5.10	--	--	3,900	570	230	5.0	4.0	8.0	--	--	--
03/07/94	7.37	2.36	5.01	--	--	2,600	2,200	290	18	2.5	11	22,000	--	--
06/17/94	7.37	1.55	5.82	--	--	2,800	2,100	480	11	4.3	9.5	--	--	--
09/12/94	7.37	1.73	5.64	--	--	3,000	1,700	340	6.1	2.7	9.7	63,000	--	--
11/30/94	7.37	1.79	5.58	--	--	INACCESSIBLE		--	--	--	--	--	--	--
03/24/95	7.37	2.42	4.95	--	--	3,000 ²	1,500	280	<5.0	<5.0	6.9	12,000	--	--
06/27/95	7.37	-1.42	8.79	--	--	3,100 ²	<10,000	310	<100	<100	<100	32,000	--	--
09/28/95	7.37	1.52	5.85	--	--	6,300 ²	330	64	1.1	<0.5	<0.5	630	--	--
12/19/95	7.37	1.87	5.50	--	--	3,400 ²	3,000	520	<25	<25	<25	44,000	--	--
02/28/96	7.37	2.27	5.10	--	--	4,700 ²	<10,000	230	<100	<100	<100	32,000	--	--
06/25/96	7.37	1.59	5.78	--	--	3,100	<10,000	160	<100	<100	<100	31,000	--	--
12/17/96	7.37	1.42	5.95	--	--	3,600 ³	<5,000	110	<50	<50	<50	22,000	--	--
03/31/97	7.37	1.75	5.62	--	--	2,700 ²	<2,500	130	<25	<25	<25	16,000	--	--
06/30/97	7.37	1.34	6.03	--	--	2,700 ²	<2,500	130	<25	<25	<25	14,000	--	--
09/12/97	7.37	1.68	5.69	--	--	2,100 ²	<5,000	63	<50	<50	<50	15,000	--	--
12/05/97	7.37	2.22	5.15	--	--	2,600 ²	1,300	120	<5.0	<5.0	8.5	15,000	--	--
02/16/98	7.37	1.11	6.26	--	--	1,300 ²	1,200	57	4.5	<2.5	7.0	12,000	--	--
06/17/98	7.37	2.41	4.96	--	--	530 ²	5,300	390	290	28	150	17,000	--	--
08/31/98	7.37	1.46	5.91	--	--	2,400 ²	<50	89	<0.5	<0.5	<0.5	14,000/16,000 ⁴	--	--
12/28/98	7.37	1.96	5.41	--	--	2,900 ²	1,000	52	5.6	4.6	9.1	8,400	--	--
03/04/99	7.37	2.17	5.20	--	--	4,490 ²	<2,500	85.5	40.9	<25	<25	11,400	--	--
DESTROYED														

Table 1
Groundwater Monitoring Data and Analytical Results
Chevron Service Station #9-0121
3026 Lakeshore Avenue
Oakland, California

WELL ID/ DATE	TOC (ft.)	GWE (msl)	DTW (ft.)	SPHT (ft.)	SPH		TPH-D (ppb)	TPH-G (ppb)	B (ppb)	T (ppb)	E (ppb)	X (ppb)	MTBE (ppb)	ETHANOL (ppb)	TDS (ppb)
					REMOVED (gallons)										
MW-4A															
04/19/99	7.69	2.78	4.91	--	--	370 ²	<500	<5.0	<5.0	<5.0	<5.0	1,600	--	--	--
06/14/99	7.69	2.44	5.25	--	--	2,500 ²	5,360	312	<20	44	<20	2,880	--	--	--
09/17/99	7.69	0.32	7.37	--	--	1,430 ²	1,290	38.6	<5.0	7.01	<5.0	1,780	--	--	--
12/20/99	7.69	1.39	6.30	--	--	7,480 ²	852	43.5	4.63	9.18	4.36	1,070	--	--	--
03/20/99	7.69	2.07	5.62	--	--	1,280 ²	1,370	129	8.6	18.3	7.3	2,110	--	--	--
06/24/00	7.69	1.57	6.12	0.00	0.00	1,190 ⁹	190 ⁷	1.4	1.7	1.7	3.3	3,900 ⁷	--	--	--
09/07/00	7.69	1.43	6.26	0.00	0.00	740 ⁹	490 ⁷	15	1.9	1.1	3.9	3,300	--	--	--
12/05/00	7.69	1.70	5.99	0.00	0.00	560 ¹²	<500	<5.00	<5.00	<5.00	<5.00	3,380 ⁸	--	--	--
03/01/01	7.69	2.01	5.68	0.00	0.00	600 ⁹	<1,000	10	<10	<10	<10	4,600	--	--	--
06/04/01	7.69	1.09	6.60	0.00	0.00	770 ⁹	390 ¹⁵	8.4	3.8	<2.5	3.0	3,800	--	--	--
09/10/01	7.69	1.12	6.57	0.00	0.00	810	<500	13	<5.0	22	<5.0	4,900	--	--	--
12/03/01	7.69	1.74	5.95	0.00	0.00	2,100	<250	1.5	<1.0	<1.0	<3.0	3,800	--	--	--
03/04/02	7.69	-1.19	8.88	0.00	0.00	2,400	2,500	49	6.8	21	9.5	2,600	--	--	--
05/30/02	7.69	1.49	6.20	0.00	0.00	2,600	430	4.6	<1.0	2.0	<3.0	3,700	--	--	--
09/03/02	7.69	1.20	6.49	0.00	0.00	3,200	<500	4.5	<2.0	3.5	7.5	3,800	--	--	--
12/09/02	7.69	1.43	6.26	0.00	0.00	1,600	440	1.1	<0.50	0.71	<5.0	4,000	--	--	--
03/10/03	7.69	1.86	5.83	0.00	0.00	1,700	710	14	2.2	4.2	<10	4,100	--	--	--
06/09/03 ¹⁸	7.69	1.25	6.44	0.00	0.00	3,200	400	3	<1	2	<1	4,100	--	--	--
09/08/03 ¹⁸	7.69	1.83	5.86	0.00	0.00	3,900	1,300	28	4	4	<3	2,900	<250	--	--
12/08/03 ¹⁸	7.69	1.57	6.12	0.00	0.00	2,500	360	3	<3	<3	<3	3,200	<250	--	--
03/09/04 ¹⁸	7.69	2.32	5.37	0.00	0.00	4,300	1,400	28	5	10	3	3,200	<250	--	--
MW-5															
06/23/92	14.14	1.90	12.24	--	--	<50	<50	<0.5	<0.5	<0.5	<0.5	--	--	--	--
08/24/92	14.14	1.85	12.29	--	--	--	--	--	--	--	--	--	--	--	--
09/21/92	14.14	1.68	12.46	--	--	60	<50	<0.5	<0.5	<0.5	<0.5	--	--	--	--
10/26/92	14.14	1.62	12.52	--	--	--	--	--	--	--	--	--	--	--	--
12/23/92	14.14	3.02	11.12	--	--	--	--	--	--	--	--	--	--	--	--
01/08/93	14.14	--	--	--	--	--	--	--	--	--	--	--	--	--	--
03/25/93	14.14	4.40	9.74	--	--	<10	<50	<0.5	<0.5	<0.5	0.9	--	--	--	--
06/11/93	14.14	3.70	10.44	--	--	--	<50	<0.5	<0.5	<0.5	<0.5	--	--	--	770

Table 1
Groundwater Monitoring Data and Analytical Results
Chevron Service Station #9-0121
3026 Lakeshore Avenue
Oakland, California

WELL ID/ DATE	TOC (ft.)	GWE (msl)	DTW (ft.)	SPHT (ft.)	SPH REMOVED (gallons)	TPH-D (ppb)	TPH-G (ppb)	B (ppb)	T (ppb)	E (ppb)	X (ppb)	MTBE (ppb)	ETHANOL (ppb)	TDS (ppb)
MW-5 (cont)														
09/29/93	14.14	2.22	11.92	--	--	<10	<50	<0.5	0.6	<0.5	0.6	--	--	--
12/20/93	14.14	--	--	--	--	--	--	--	--	--	--	--	--	--
03/07/94	14.14	2.80	11.34	--	--	<10	<50	<0.5	<0.5	<0.5	<0.5	--	--	--
06/17/94	14.14	2.87	11.27	--	--	<50	<50	<0.5	<0.5	<0.5	<0.5	--	--	--
09/12/94	14.14	1.28	12.86	--	--	<50	<50	<0.5	<0.5	<0.5	<0.5	<5.0	--	--
11/30/94	14.14	2.23	11.91	--	--	99 ²	<50	<0.5	<0.5	<0.5	<0.5	--	--	--
03/24/95	14.14	4.38	9.76	--	--	<50	<50	<0.5	<0.5	<0.5	<0.5	--	--	--
06/27/95	14.14	2.74	11.40	--	--	55 ³	<50	<0.5	<0.5	<0.5	<0.5	--	--	--
09/28/95	14.14	2.24	11.90	--	--	300 ²	<50	<0.5	<0.5	<0.5	<0.5	--	--	--
12/19/95	14.14	1.56	12.58	--	--	53 ²	<50	<0.5	<0.5	<0.5	<0.5	3.1	--	--
02/28/96	14.14	2.44	11.70	--	--	<50	<50	<0.5	<0.5	<0.5	<0.5	<2.5	--	--
06/25/96	14.14	2.71	11.43	--	--	120 ²	<50	<0.5	<0.5	<0.5	<0.5	36	--	--
12/17/96	14.14	2.74	11.40	--	--	89 ²	<50	<0.5	<0.5	<0.5	<0.5	<2.5	--	--
03/31/97	14.14	2.04	12.10	--	--	150 ²	<50	<0.5	<0.5	<0.5	<0.5	<2.5	--	--
06/30/97	14.14	1.36	12.78	--	--	SAMPLED SEMI-ANNUALLY			--	--	--	--	--	--
09/12/97	14.14	0.46	13.68	--	--	<50	<50	<0.5	<0.5	<0.5	<0.5	<2.5	--	--
12/05/97	14.14	1.11	13.03	--	--	--	--	--	--	--	--	--	--	--
02/16/98	14.14	4.17	9.97	--	--	62 ²	<50	<0.5	<0.5	<0.5	<0.5	<2.5	--	--
06/17/98	14.14	2.29	11.85	--	--	--	--	--	--	--	--	--	--	--
08/31/98	14.14	1.32	12.82	--	--	<50	<50	<0.5	<0.5	<0.5	<0.5	<2.5	--	--
12/28/98	14.14	0.71	13.43	--	--	--	--	--	--	--	--	--	--	--
03/04/99	14.14	0.39	13.75	--	--	70.5	<50	<0.5	<0.5	<0.5	<0.5	3.34	--	--
06/14/99	14.14	0.04	14.10	--	--	--	--	--	--	--	--	--	--	--
09/17/99	14.14	-0.04	14.18	--	--	<50	<50	<0.5	<0.5	<0.5	<0.5	<2.5	--	--
12/20/99	14.14	0.44	13.70	--	--	--	--	--	--	--	--	--	--	--
03/20/00	14.14	1.50	12.64	--	--	115 ³	<50	<0.5	<0.5	<0.5	<0.5	<2.5	--	--
06/24/00	14.14	1.10	13.04	0.00	0.00	--	--	--	--	--	--	--	--	--
09/07/00	14.14	0.97	13.17	0.00	0.00	<50	<50	<0.50	<0.50	<0.50	<0.50	5.0	--	--
12/05/00	14.14	2.86	11.28	0.00	0.00	--	--	--	--	--	--	--	--	--
03/01/01	14.14	3.84	10.30	0.00	0.00	<50	<50	<0.50	<0.50	<0.50	<0.50	<2.5	--	--
06/04/01	14.14	2.83	11.31	0.00	0.00	SAMPLED SEMI-ANNUALLY			--	--	--	--	--	--
09/10/01	14.14	1.98	12.16	0.00	0.00	<50	<50	<0.50	<0.50	<0.50	<0.50	<2.5	--	--

Table 1
Groundwater Monitoring Data and Analytical Results
Chevron Service Station #9-0121
3026 Lakeshore Avenue
Oakland, California

WELL ID/ DATE	TOC (fL)	GWE (msl)	DTW (ft.)	SPHT (ft.)	SPH		TPH-D (ppb)	TPH-G (ppb)	B (ppb)	T (ppb)	E (ppb)	X (ppb)	MTBE (ppb)	ETHANOL (ppb)	TDS (ppb)
					REMOVED (gallons)										
MW-5 (cont)															
12/03/01	14.14	5.52	8.62	0.00	0.00	SAMPLED SEMI-ANNUALLY			--	--	--	--	--	--	--
03/04/02	14.14	4.29	9.85	0.00	0.00	78	<50	<0.50	<0.50	<0.50	<1.5	<2.5	--	--	--
05/30/02	14.14	3.31	10.83	0.00	0.00	SAMPLED SEMI-ANNUALLY			--	--	--	--	--	--	--
09/03/02	14.14	INACCESSIBLE - CAR PARKED OVER WELL					--	--	--	--	--	--	--	--	--
12/09/02	14.14	2.78	11.36	0.00	0.00	SAMPLED SEMI-ANNUALLY			--	--	--	--	--	--	--
03/10/03	14.14	2.95	11.19	0.00	0.00	100	<50	<0.50	<0.50	<0.50	<1.5	8.2	--	--	--
06/09/03	14.14	1.57	12.57	0.00	0.00	SAMPLED SEMI-ANNUALLY			--	--	--	--	--	--	--
09/08/03 ¹⁸	14.14	2.13	12.01	0.00	0.00	65	<50	<0.5	<0.5	<0.5	<0.5	8	<50	--	--
12/08/03	14.14	3.01	11.13	0.00	0.00	SAMPLED SEMI-ANNUALLY			--	--	--	--	--	--	--
03/09/04 ¹⁸	14.14	3.56	10.58	0.00	0.00	110	<50	<0.5	<0.5	<0.5	<0.5	4	<50	--	--
MW-6															
06/23/92	4.46	-0.68	5.14	--	--	120	<50	4.3	<0.5	0.8	0.9	--	--	--	--
08/24/92	4.46	-0.49	4.95	--	--	--	--	--	--	--	--	--	--	--	--
09/21/92	4.46	-0.44	4.90	--	--	<50	<250	<2.5	<2.5	<2.5	<2.5	--	--	--	--
10/26/92	4.46	-1.06	5.52	--	--	--	--	--	--	--	--	--	--	--	--
12/23/92	4.46	-0.94	5.40	--	--	81	<50	<0.5	<0.5	<0.5	<0.5	--	--	--	--
01/08/93	4.46	--	--	--	--	--	--	--	--	--	--	--	--	--	--
03/25/93	4.46	-1.64	6.10	--	--	<10	<50	<0.5	<0.5	<0.5	0.7	--	--	--	--
06/11/93	4.46	-2.10	6.56	--	--	--	<50	<0.5	<0.5	<0.5	<0.5	--	--	--	15,000
09/29/93	4.46	-0.71	5.17	--	--	<10	<50	<0.5	<0.5	<0.5	<0.5	--	--	--	--
12/20/93	4.46	-1.47	5.93	--	--	<10	<50	<0.5	<0.5	<0.5	<0.5	--	--	--	--
03/07/94	4.46	-0.81	5.27	--	--	<10	54	<0.5	<0.5	<0.5	0.6	--	--	--	--
06/17/94	4.46	--	--	--	--	--	--	--	--	--	--	--	--	--	--
09/12/94	4.46	-0.64	5.10	--	--	<50	<50	<0.5	<0.5	<0.5	<0.5	<50	--	--	--
11/30/94	4.46	-1.12	5.58	--	--	800 ¹	<50	<0.5	<0.5	<0.5	<0.5	--	--	--	--
03/24/95	4.46	-1.87	6.33	--	--	490 ²	<50	<0.5	<0.5	<0.5	<0.5	--	--	--	--
06/27/95	4.46	-3.74	8.20	--	--	300 ²	<50	<0.5	<0.5	<0.5	<0.5	--	--	--	--
09/28/95	4.46	-0.19	4.65	--	--	1,200 ²	120	1.1	<0.5	<0.5	<0.5	--	--	--	--
12/19/95	4.46	-1.58	6.04	--	--	820 ²	<50	<0.5	<0.5	<0.5	<0.5	<2.5	--	--	--
02/28/96	4.46	-1.54	6.00	--	--	270 ²	<50	<0.5	<0.5	<0.5	<0.5	<2.5	--	--	--

Table 1
Groundwater Monitoring Data and Analytical Results
Chevron Service Station #9-0121
3026 Lakeshore Avenue
Oakland, California

WELL ID/ DATE	TOC (ft.)	GWE (msl)	DTW (ft.)	SPHT (ft.)	SPH REMOVED (gallons)	TPH-D (ppb)	TPH-G (ppb)	B (ppb)	T (ppb)	E (ppb)	X (ppb)	MTBE (ppb)	ETHANOL (ppb)	TDS (ppb)	
MW-6 (cont)															
06/25/96	4.46	-1.71	6.17	--	--	750 ²	97	<0.5	<0.5	<0.5	0.71	<2.5	--	--	
12/17/96	4.46	-1.67	6.13	--	--	540 ²	65	<0.5	<0.5	<0.5	<0.5	<2.5	--	--	
03/31/97	4.46	-2.23	6.69	--	--	780 ²	65	<0.5	<0.5	<0.5	<0.5	<2.5	--	--	
06/30/97	4.46	-2.62	7.08	--	--	SAMPLED SEMI-ANNUALLY			--	--	--	--	--	--	
09/12/97	4.46	-0.95	5.41	--	--	270 ²	65	<0.5	<0.5	<0.5	<0.5	<2.5	--	--	
12/05/97	4.46	-1.96	6.42	--	--	--	--	--	--	--	--	--	--	--	
02/16/98	4.46	-0.30	4.76	--	--	330 ²	140	<0.5	<0.5	<0.5	<0.5	<2.5	--	--	
06/17/98	4.46	-1.54	6.00	--	--	--	--	--	--	--	--	--	--	--	
08/31/98	4.46	-0.64	5.10	--	--	270 ¹	<50	<0.5	<0.5	<0.5	<0.5	<2.5	--	--	
12/28/98	4.46	-2.04	6.50	--	--	--	--	--	--	--	--	--	--	--	
03/04/99	4.46	-1.35	5.81	--	--	638 ¹	95.5	<0.5	<0.5	<0.5	<0.5	<2.0	--	--	
06/14/99	4.46	-0.97	5.43	--	--	--	--	--	--	--	--	--	--	--	
09/17/99	4.46	-1.74	6.20	--	--	258 ¹	<50	<0.5	<0.5	<0.5	<0.5	<2.5	--	--	
12/20/99	4.46	-2.31	6.77	--	--	--	--	--	--	--	--	--	--	--	
03/20/00	4.46	-2.12	6.58	--	--	257 ²	<50	<0.5	<0.5	<0.5	<0.5	<2.5	--	--	
06/24/00	4.46	-2.52	6.98	0.00	0.00	SAMPLED SEMI-ANNUALLY			--	--	--	--	--	--	
09/07/00	4.46	-0.46	4.92	0.00	0.00	98 ¹¹	<50	<0.50	<0.50	<0.50	<0.50	<2.5	--	--	
12/05/00	4.46	-0.64	5.10	0.00	0.00	--	--	--	--	--	--	--	--	--	
03/01/01	4.46	-0.43	4.89	0.00	0.00	190 ⁹	<50	<0.50	<0.50	<0.50	<0.50	<2.5	--	--	
06/04/01	4.46	-0.75	5.21	0.00	0.00	SAMPLED SEMI-ANNUALLY			--	--	--	--	--	--	
09/10/01	4.46	-0.65	5.11	0.00	0.00	140 ¹⁷	<50	<0.50	<0.50	<0.50	<0.50	<2.5	--	--	
12/03/01	4.46	-0.57	5.03	0.00	0.00	SAMPLED SEMI-ANNUALLY			--	--	--	--	--	--	
03/04/02	4.46	INACCESSIBLE - CAR PARKED OVER WELL				--	--	--	--	--	--	--	--	--	--
05/30/02	4.46	-1.65	6.11	0.00	0.00	SAMPLED SEMI-ANNUALLY			--	--	--	--	--	--	
09/03/02	4.46	-0.82	5.28	0.00	0.00	340	<500	<2.0	<2.0	<2.0	<6.0	<3.0	--	--	
12/09/02	4.46	-0.66	5.12	0.00	0.00	SAMPLED SEMI-ANNUALLY			--	--	--	--	--	--	
03/10/03	4.46	-1.80	6.26	0.00	0.00	420	<50	<0.50	<0.50	<0.50	<1.5	<2.5	--	--	
06/09/03	4.46	-1.45	5.91	0.00	0.00	SAMPLED SEMI-ANNUALLY			--	--	--	--	--	--	
09/08/03 ¹⁸	4.46	-0.19	4.65	0.00	0.00	230	<50	<0.5	<0.5	<0.5	<0.5	<0.5	<50	--	
12/08/03	4.46	-0.78	5.24	0.00	0.00	SAMPLED SEMI-ANNUALLY			--	--	--	--	--	--	
03/09/04 ¹⁸	4.46	-1.39	5.85	0.00	0.00	1,500	<50	<0.5	<0.5	<0.5	<0.5	<0.5	<50	--	

Table 1
Groundwater Monitoring Data and Analytical Results
Chevron Service Station #9-0121
3026 Lakeshore Avenue
Oakland, California

WELL ID/ DATE	TOC (ft.)	GWE (mst)	DTW (ft.)	SPHT (ft.)	SPH		TPH-D (ppb)	TPH-G (ppb)	B (ppb)	T (ppb)	E (ppb)	X (ppb)	MTBE (ppb)	ETHANOL (ppb)	TDS (ppb)	
					REMOVED (gallons)											
MW-7																
08/24/92	5.26	-0.29	5.55	--	--	--	--	--	--	--	--	--	--	--	--	--
09/21/92	5.26	-0.39	5.65	--	--	<50	<50	<0.5	<0.5	<0.5	<0.5	--	--	--	--	--
10/26/92	5.26	-0.25	5.51	--	--	--	--	--	--	--	--	--	--	--	--	--
12/23/92	5.26	1.31	3.95	--	--	60	<50	2.9	<0.5	<0.5	<0.5	--	--	--	--	--
01/08/93	5.26	--	--	--	--	--	--	--	--	--	--	--	--	--	--	--
03/25/93	5.26	2.76	2.50	--	--	<10	<50	<0.5	<0.5	<0.5	<0.5	--	--	--	--	--
06/11/93	5.26	1.80	3.46	--	--	--	<50	0.6	<0.5	<0.5	<0.5	--	--	--	2,200	--
09/29/93	5.26	-0.26	5.52	--	--	<10	<50	2.0	1.0	1.0	7.0	--	--	--	--	--
12/20/93	5.26	0.85	4.41	--	--	<10	<50	2.0	<0.5	<0.5	<0.5	--	--	--	--	--
03/07/94	5.26	2.64	2.62	--	--	<10	<50	<0.5	<0.5	<0.5	<0.5	--	--	--	--	--
06/17/94	5.26	1.99	3.27	--	--	<50	<50	<0.5	<0.5	<0.5	<0.5	--	--	--	--	--
09/12/94	5.26	1.15	4.11	--	--	<50	<50	<0.5	<0.5	<0.5	<0.5	<5.0	--	--	--	--
11/30/94	5.26	2.50	2.76	--	--	92 ¹	<50	<0.5	<0.5	<0.5	<0.5	--	--	--	--	--
03/24/95	5.26	3.06	2.20	--	--	<50	<50	<0.5	<0.5	<0.5	<0.5	--	--	--	--	--
06/27/95	5.26	1.36	3.90	--	--	69 ²	<50	<0.5	<0.5	<0.5	<0.5	--	--	--	--	--
09/28/95	5.26	0.41	4.85	--	--	84 ²	<50	<0.5	<0.5	<0.5	<0.5	--	--	--	--	--
12/19/95	5.26	2.24	3.02	--	--	84 ²	<50	<0.5	<0.5	<0.5	<0.5	<2.5	--	--	--	--
02/28/96	5.26	3.83	1.43	--	--	99 ²	<50	<0.5	<0.5	<0.5	<0.5	<2.5	--	--	--	--
06/25/96	5.26	0.97	4.29	--	--	110 ²	<50	<0.5	<0.5	<0.5	<0.5	<2.5	--	--	--	--
12/17/96	5.26	3.08	2.18	--	--	54 ²	<50	<0.5	<0.5	<0.5	<0.5	<2.5	--	--	--	--
03/31/97	5.26	2.32	2.94	--	--	100 ²	<50	<0.5	<0.5	<0.5	<0.5	<2.5	--	--	--	--
06/30/97	5.26	1.68	3.58	--	--	SAMPLED ANNUALLY		--	--	--	--	--	--	--	--	--
09/12/97	5.26	1.85	3.41	--	--	--	--	--	--	--	--	--	--	--	--	--
12/05/97	5.26	3.37	1.89	--	--	--	--	--	--	--	--	--	--	--	--	--
02/16/98	5.26	3.43	1.83	--	--	77 ²	<50	<0.5	<0.5	<0.5	<0.5	<2.5	--	--	--	--
06/17/98	5.26	3.32	1.94	--	--	--	--	--	--	--	--	--	--	--	--	--
08/31/98	5.26	1.07	4.19	--	--	--	--	--	--	--	--	--	--	--	--	--
12/28/98	5.26	0.79	4.47	--	--	--	--	--	--	--	--	--	--	--	--	--
03/04/99	5.26	3.51	1.75	--	--	73.4	<50	<0.5	<0.5	<0.5	<0.5	<2.0	--	--	--	--
06/14/99	5.26	3.64	1.62	--	--	--	--	--	--	--	--	--	--	--	--	--
09/17/99	5.26	0.42	4.84	--	--	--	--	--	--	--	--	--	--	--	--	--
12/20/99	5.26	0.45	4.81	--	--	--	--	--	--	--	--	--	--	--	--	--

Table 1
Groundwater Monitoring Data and Analytical Results
Chevron Service Station #9-0121
3026 Lakeshore Avenue
Oakland, California

WELL ID/ DATE	TOC (ft.)	GWE (msl)	DTW (ft.)	SPHT (ft.)	SPH REMOVED (gallons)	TPH-D (ppb)	TPH-G (ppb)	B (ppb)	T (ppb)	E (ppb)	X (ppb)	MTBE (ppb)	ETHANOL (ppb)	TDS (ppb)
MW-7 (cont)														
03/20/00	5.26	3.41	1.85	--	--	<50	<50	<0.5	<0.5	<0.5	<0.5	<2.5	--	--
06/24/00	5.26	3.05	2.21	0.00	0.00	--	--	--	--	--	--	--	--	--
09/07/00	5.26	1.61	3.65	0.00	0.00	--	--	--	--	--	--	--	--	--
12/05/00	5.26	2.31	2.95	0.00	0.00	--	--	--	--	--	--	--	--	--
03/01/01	5.26	4.61	0.65	0.00	0.00	<50	<50	<0.50	<0.50	<0.50	<0.50	<2.5	--	--
06/04/01	5.26	3.74	1.52	0.00	0.00	--	--	--	--	--	--	--	--	--
09/10/01	5.26	1.08	4.18	0.00	0.00	SAMPLED ANNUALLY		--	--	--	--	--	--	--
12/03/01	5.26	4.20	1.06	0.00	0.00	SAMPLED ANNUALLY		--	--	--	--	--	--	--
03/04/02	5.26	3.76	1.50	0.00	0.00	<50	<50	<0.50	<0.50	<0.50	<1.5	<2.5	--	--
05/30/02	5.26	2.51	2.75	0.00	0.00	SAMPLED ANNUALLY		--	--	--	--	--	--	--
09/03/02	5.26	2.24	3.02	0.00	0.00	SAMPLED ANNUALLY		--	--	--	--	--	--	--
12/09/02	5.26	2.41	2.85	0.00	0.00	SAMPLED ANNUALLY		--	--	--	--	--	--	--
03/10/03	5.26	3.32	1.94	0.00	0.00	85	<50	<0.50	<0.50	<0.50	<1.5	<2.5	--	--
06/09/03	5.26	2.72	2.54	0.00	0.00	SAMPLED ANNUALLY		--	--	--	--	--	--	--
09/08/03	5.26	2.66	2.60	0.00	0.00	SAMPLED ANNUALLY		--	--	--	--	--	--	--
12/08/03	5.26	2.81	2.45	0.00	0.00	SAMPLED ANNUALLY		--	--	--	--	--	--	--
03/09/04 ¹⁸	5.26	4.53	0.73	0.00	0.00	230	<50	<0.5	<0.5	<0.5	<0.5	<0.5	<50	--
MW-8														
06/23/92	8.94	-15.20	24.14	--	--	<50	<50	<0.5	<0.5	<0.5	<0.5	--	--	--
08/24/92	8.94	0.34	8.60	--	--	--	--	--	--	--	--	--	--	--
09/21/92	8.94	0.55	8.39	--	--	<50	94	<0.5	<0.5	<0.5	<0.5	--	--	--
10/26/92	8.94	-0.18	9.12	--	--	--	--	--	--	--	--	--	--	--
12/23/92	8.94	0.83	8.11	--	--	79	<50	0.7	5.0	0.7	2.9	--	--	--
01/08/93	8.94	--	--	--	--	--	--	--	--	--	--	--	--	--
03/25/93	8.94	--	--	--	--	--	--	--	--	--	--	--	--	--
06/11/93	8.94	0.55	8.39	--	--	--	<50	<0.5	<0.5	<0.5	<0.5	--	--	3,500
09/29/93	8.94	0.69	8.25	--	--	<10	<50	<0.5	<0.5	<0.5	<0.5	--	--	--
12/20/93	8.94	0.48	8.46	--	--	<10	<50	<0.5	0.6	<0.5	1.0	--	--	--
03/07/94	8.94	0.28	8.66	--	--	<10	<50	<0.5	<0.5	<0.5	<0.5	--	--	--
06/17/94	8.94	0.12	8.82	--	--	<50	<50	<0.5	<0.5	<0.5	<0.5	--	--	--

Table 1
Groundwater Monitoring Data and Analytical Results
Chevron Service Station #9-0121
3026 Lakeshore Avenue
Oakland, California

WELL ID/ DATE	TOC (ft.)	GWE (msl)	DTW (ft.)	SPHT (ft.)	SPH		TPH-D (ppb)	TPH-G (ppb)	B (ppb)	T (ppb)	E (ppb)	X (ppb)	MTBE (ppb)	ETHANOL (ppb)	TDS (ppb)
					REMOVED (gallons)										
MW-8 (cont)															
09/12/94	8.94	0.11	8.83	--	--	<50	<50	<0.5	<0.5	<0.5	0.8	<5.0	--	--	--
11/30/94	8.94	0.31	8.63	--	--	120 ¹	<50	<0.5	<0.5	<0.5	<0.5	--	--	--	--
03/24/95	8.94	0.43	8.51	--	--	110 ²	<50	<0.5	<0.5	<0.5	<0.5	--	--	--	--
06/27/95	8.94	-0.03	8.97	--	--	67 ²	<50	<0.5	<0.5	<0.5	<0.5	--	--	--	--
09/28/95	8.94	0.04	8.90	--	--	91 ²	<50	<0.5	<0.5	<0.5	<0.5	--	--	--	--
12/19/95	8.94	0.54	8.40	--	--	76 ²	<50	<0.5	<0.5	<0.5	<0.5	<2.5	--	--	--
02/28/96	8.94	0.50	8.44	--	--	<50	<50	<0.5	<0.5	<0.5	<0.5	<2.5	--	--	--
06/25/96	8.94	0.05	8.89	--	--	80 ²	<50	<0.5	<0.5	<0.5	<0.5	<2.5	--	--	--
12/17/96	8.94	0.49	8.45	--	--	79 ²	<50	<0.5	<0.5	<0.5	<0.5	<2.5	--	--	--
03/31/97	8.94	0.18	8.76	--	--	72 ²	<50	<0.5	<0.5	<0.5	<0.5	3.6	--	--	--
06/30/97	8.94	-0.18	9.12	--	--	SAMPLED ANNUALLY		--	--	--	--	--	--	--	--
09/12/97	8.94	0.13	8.81	--	--	--	--	--	--	--	--	--	--	--	--
12/05/97	8.94	0.59	8.35	--	--	--	--	--	--	--	--	--	--	--	--
02/16/98	8.94	1.00	7.94	--	--	68 ²	<50	<0.5	<0.5	<0.5	<0.5	4.3	--	--	--
06/17/98	8.94	0.51	8.43	--	--	--	--	--	--	--	--	--	--	--	--
08/31/98	8.94	0.06	8.88	--	--	--	--	--	--	--	--	--	--	--	--
12/28/98	8.94	0.64	8.30	--	--	--	--	--	--	--	--	--	--	--	--
03/04/99	8.94	0.29	8.65	--	--	106	<50	<0.5	<0.5	<0.5	<0.5	3.83	--	--	--
06/14/99	8.94	0.52	8.42	--	--	--	--	--	--	--	--	--	--	--	--
09/17/99	8.94	-0.93	9.87	--	--	--	--	--	--	--	--	--	--	--	--
12/20/99	8.94	0.54	8.40	--	--	--	--	--	--	--	--	--	--	--	--
03/20/00	8.94	0.82	8.12	--	--	82.2 ⁶	<50	<0.5	<0.5	<0.5	<0.5	3.46	--	--	--
06/24/00	8.94	0.31	8.63	0.00	0.00	SAMPLED ANNUALLY		--	--	--	--	--	--	--	--
09/07/00	8.94	0.26	8.68	0.00	0.00	--	--	--	--	--	--	--	--	--	--
12/05/00	8.94	0.81	8.13	0.00	0.00	--	--	--	--	--	--	--	--	--	--
03/01/01	8.94	1.04	7.90	0.00	0.00	51 ¹¹	<50	<0.50	<0.50	<0.50	<0.50	<2.5	--	--	--
06/04/01	8.94	-0.27	9.21	0.00	0.00	--	--	--	--	--	--	--	--	--	--
09/10/01	8.94	0.26	8.68	0.00	0.00	SAMPLED ANNUALLY		--	--	--	--	--	--	--	--
12/03/01	8.94	1.12	7.82	0.00	0.00	SAMPLED ANNUALLY		--	--	--	--	--	--	--	--
03/04/02	8.94	1.26	7.68	0.00	0.00	82	<50	<0.50	<0.50	<0.50	<1.5	<2.5	--	--	--
05/30/02	8.94	INACCESSIBLE - CAR PARKED OVER WELL				--	--	--	--	--	--	--	--	--	--
09/03/02	8.94	-0.21	9.15	0.00	0.00	SAMPLED ANNUALLY		--	--	--	--	--	--	--	--

Table 1
Groundwater Monitoring Data and Analytical Results
Chevron Service Station #9-0121
3026 Lakeshore Avenue
Oakland, California

WELL ID/ DATE	TOC (ft.)	GWE (msl)	DTW (ft.)	SPHT (ft.)	SPH REMOVED (gallons)	TPH-D (ppb)	TPH-G (ppb)	B (ppb)	T (ppb)	E (ppb)	X (ppb)	MTBE (ppb)	ETHANOL (ppb)	TDS (ppb)
MW-8 (cont)														
12/09/02	8.94	0.21	8.73	0.00	0.00	SAMPLED ANNUALLY		--	--	--	--	--	--	--
03/10/03	8.94	0.55	8.39	0.00	0.00	110	<50	<0.50	<0.50	<0.50	<1.5	<2.5	--	--
06/09/03	8.94	-0.03	8.97	0.00	0.00	SAMPLED ANNUALLY		--	--	--	--	--	--	--
09/08/03	8.94	0.52	8.42	0.00	0.00	SAMPLED ANNUALLY		--	--	--	--	--	--	--
12/08/03	8.94	0.77	8.17	0.00	0.00	SAMPLED ANNUALLY		--	--	--	--	--	--	--
03/09/04 ¹⁸	8.94	1.03	7.91	0.00	0.00	300	<50	<0.5	<0.5	<0.5	<0.5	3	<50	--
MW-9														
04/19/99	5.87	2.71	3.16	--	--	2,600 ²	3,900 ⁶	14	6.9	14	24	140	--	--
06/14/99	5.87	1.06	4.81	--	--	2,800 ²	2,880	12.6	<10	<10	<10	138	--	--
09/17/99	5.87	1.02	4.85	--	--	1,770 ²	3,370	33.1	14.4	<5.0	<5.0	202	--	--
12/20/99	5.87	1.87	4.00	--	--	996 ²	3,970	42.2	13.5	<10	<10	311	--	--
03/20/00	5.87	2.87	3.00	--	--	2,710 ²	5,920	22.1	<5.0	6.8	<5.0	106.0	--	--
06/24/00	5.87	1.96	3.91	0.00	0.00	1,940 ⁹	2,500 ⁷	12	<10	11	<10	120	--	--
09/07/00	5.87	1.59	4.28	0.00	0.00	1,500 ⁹	3,700 ⁷	<25	<25	<25	<25	330	--	--
12/05/00	5.87	2.07	3.80	0.00	0.00	1,300 ¹²	3,470 ²	<5.00	7.64	<5.00	<5.00	177	--	--
03/01/01	5.87	3.19	2.68	0.00	0.00	960 ⁹	2,400 ⁷	11	18.0	<10	<10	250	--	--
06/04/01	5.87	1.96	3.91	0.00	0.00	1,200 ⁹	3,200 ⁷	45	17	6.1	8.9	300	--	--
09/10/01	5.87	1.18	4.69	0.00	0.00	2,000 ¹⁷	2,300	5.7	7.3	10	<5.0	200	--	--
12/03/01	5.87	2.88	2.99	0.00	0.00	2,600	3,600	14	5.4	8.2	8.5	210	--	--
03/04/02	5.87	2.32	3.55	0.00	0.00	3,700	4,400	17	<5.0	9.2	6.4	79	--	--
05/30/02	5.87	2.22	3.65	0.00	0.00	4,600	4,300	15	3.7	5.8	6.1	110	--	--
09/03/02	5.87	1.31	4.56	0.00	0.00	2,500	3,200	5.8	2.6	3.5	5.6	84	--	--
12/09/02	5.87	1.51	4.36	0.00	0.00	2,600	3,000	6.3	3.2	3.9	6.1	110	--	--
03/10/03	5.87	2.26	3.61	0.00	0.00	1,500	3,300	11	3.7	5.4	<7.5	150	--	--
06/09/03 ¹⁸	5.87	2.29	3.58	0.00	0.00	2,700	3,500	2	2	3	2	46	--	--
09/08/03 ¹⁸	5.87	1.43	4.44	0.00	0.00	3,000	3,000	3	2	2	3	120	<50	--
12/08/03 ¹⁸	5.87	2.21	3.66	0.00	0.00	2,500	2,400	3	3	3	4	560	<50	--
03/09/04 ¹⁸	5.87	2.69	3.18	0.00	0.00	2,500	3,700	2	1	2	2	120	<50	--

Table 1
Groundwater Monitoring Data and Analytical Results
 Chevron Service Station #9-0121
 3026 Lakeshore Avenue
 Oakland, California

WELL ID/ DATE	TOC (ft.)	GWE (msl)	DTW (ft.)	SPHT (ft.)	SPH REMOVED (gallons)	TPH-D (ppb)	TPH-G (ppb)	B (ppb)	T (ppb)	E (ppb)	X (ppb)	MTBE (ppb)	ETHANOL (ppb)	TDS (ppb)
TRIP BLANK														
08/24/92	--	--	--	--	--	--	--	--	--	--	--	--	--	--
09/21/92	--	--	--	--	--	--	<50	<0.5	<0.5	<0.5	<0.5	--	--	--
10/26/92	--	--	--	--	--	--	--	--	--	--	--	--	--	--
12/23/92	--	--	--	--	--	--	<50	<0.5	<0.5	<0.5	<0.5	--	--	--
01/08/93	--	--	--	--	--	--	--	--	--	--	--	--	--	--
03/25/93	--	--	--	--	--	--	<50	<0.5	<0.5	<0.5	<0.5	--	--	--
06/11/93	--	--	--	--	--	--	<50	<0.5	<0.5	<0.5	<0.5	--	--	--
09/29/93	--	--	--	--	--	--	<50	<0.5	<0.5	<0.5	<0.5	--	--	--
12/20/93	--	--	--	--	--	--	<50	<0.5	<0.5	<0.5	<0.5	--	--	--
03/07/94	--	--	--	--	--	--	<50	<0.5	<0.5	<0.5	<0.5	--	--	--
06/17/94	--	--	--	--	--	--	<50	<0.5	<0.5	<0.5	<0.5	--	--	--
09/12/94	--	--	--	--	--	--	<50	<0.5	<0.5	<0.5	1.0	--	--	--
11/30/94	--	--	--	--	--	--	<50	<0.5	<0.5	<0.5	<0.5	--	--	--
03/24/95	--	--	--	--	--	--	<50	<0.5	<0.5	<0.5	<0.5	--	--	--
06/27/95	--	--	--	--	--	--	<50	<0.5	<0.5	<0.5	<0.5	--	--	--
09/28/95	--	--	--	--	--	--	<50	<0.5	<0.5	<0.5	<0.5	--	--	--
12/19/95	--	--	--	--	--	--	<50	<0.5	<0.5	<0.5	<0.5	--	--	--
02/28/96	--	--	--	--	--	--	<50	<0.5	<0.5	<0.5	<0.5	--	--	--
06/25/96	--	--	--	--	--	--	<50	<0.5	<0.5	<0.5	<0.5	--	--	--
12/17/96	--	--	--	--	--	--	<50	<0.5	<0.5	<0.5	<0.5	<2.5	--	--
03/31/97	--	--	--	--	--	--	<50	<0.5	<0.5	<0.5	<0.5	<2.5	--	--
06/30/97	--	--	--	--	--	--	<50	<0.5	<0.5	<0.5	<0.5	<2.5	--	--
09/12/97	--	--	--	--	--	--	<50	<0.5	<0.5	<0.5	<0.5	<2.5	--	--
12/05/97	--	--	--	--	--	--	<50	<0.5	<0.5	<0.5	<0.5	<2.5	--	--
02/16/98	--	--	--	--	--	--	<50	<0.5	<0.5	<0.5	<0.5	<2.5	--	--
06/17/98	--	--	--	--	--	--	<50	<0.5	<0.5	<0.5	<0.5	<2.5	--	--
08/31/98	--	--	--	--	--	--	<50	<0.5	<0.5	<0.5	<0.5	<2.5	--	--
12/28/98	--	--	--	--	--	--	<50	<0.5	<0.5	<0.5	<0.5	<2.5	--	--
03/04/99	--	--	--	--	--	--	<50	<0.5	<0.5	<0.5	<0.5	<2.0	--	--
06/14/99	--	--	--	--	--	--	<50	<0.5	<0.5	<0.5	<0.5	<2.5	--	--
09/17/99	--	--	--	--	--	--	<50	<0.5	<0.5	<0.5	<0.5	<2.5	--	--
12/20/99	--	--	--	--	--	--	<50	<0.5	<0.5	<0.5	<0.5	<2.5	--	--

Table 1
Groundwater Monitoring Data and Analytical Results
Chevron Service Station #9-0121
3026 Lakeshore Avenue
Oakland, California

WELL ID/ DATE	TOC (ft.)	GWE (msl)	DTW (ft.)	SPHT (ft.)	SPH REMOVED (gallons)	TPH-D (ppb)	TPH-G (ppb)	B (ppb)	T (ppb)	E (ppb)	X (ppb)	MTBE (ppb)	ETHANOL (ppb)	TDS (ppb)
TRIP BLANK (cont)														
03/20/00	--	--	--	--	--	--	<50	<0.5	<0.5	<0.5	<0.5	<2.5	--	--
06/24/00	--	--	--	--	--	--	<50	<0.50	<0.50	<0.50	<0.50	<2.5	--	--
09/07/00	--	--	--	--	--	--	<50	<0.50	<0.50	<0.50	<0.50	<2.5	--	--
12/05/00	--	--	--	--	--	--	<50	<0.500	<0.500	<0.500	<0.500	<2.5	--	--
03/01/01	--	--	--	--	--	--	<50	<0.50	<0.50	<0.50	<0.50	<2.5	--	--
06/04/01	--	--	--	--	--	--	<50	<0.50	<0.50	<0.50	<0.50	<2.5	--	--
09/10/01	--	--	--	--	--	--	<50	<0.50	<0.50	<0.50	<0.50	<2.5	--	--
QA														
12/03/01	--	--	--	--	--	--	<50	<0.50	<0.50	<0.50	<1.5	<2.5	--	--
03/04/02	--	--	--	--	--	--	<50	<0.50	<0.50	<0.50	<1.5	<2.5	--	--
05/30/02	--	--	--	--	--	--	<50	<0.50	<0.50	<0.50	<1.5	<2.5	--	--
09/03/02	--	--	--	--	--	--	<50	<0.50	<0.50	<0.50	<1.5	<2.5	--	--
12/09/02	--	--	--	--	--	--	<50	<0.50	<0.50	<0.50	<1.5	<2.5	--	--
03/10/03	--	--	--	--	--	--	<50	<0.50	<0.50	<0.50	<1.5	<2.5	--	--
06/09/03 ¹⁸	--	--	--	--	--	--	<50	<0.5	<0.5	<0.5	<0.5	<0.5	--	--
09/08/03 ¹⁸	--	--	--	--	--	--	<50	<0.5	<0.5	<0.5	<0.5	<0.5	--	--
12/08/03 ¹⁸	--	--	--	--	--	--	<50	<0.5	<0.5	<0.5	<0.5	<0.5	--	--
03/09/04 ¹⁸	--	--	--	--	--	--	<50	<0.5	<0.5	<0.5	<0.5	<0.5	--	--

Table 1
Groundwater Monitoring Data and Analytical Results
Chevron Service Station #9-0121
3026 Lakeshore Avenue
Oakland, California

EXPLANATIONS:

Groundwater monitoring data and laboratory analytical results prior to June 24, 2000, were compiled from reports prepared by Blaine Tech Services, Inc.

TOC = Top of Casing

(ft.) = Feet

GWE = Groundwater Elevation

(msl) = Mean sea level

DTW = Depth to Water

SPHT = Separate Phase Hydrocarbon Thickness

TPH-D = Total Petroleum Hydrocarbons as Diesel

TPH-G = Total Petroleum Hydrocarbons as Gasoline

B = Benzene

T = Toluene

E = Ethylbenzene

X = Xylenes

TDS = Total Dissolved Solids

(ppb) = Parts per billion

-- = Not Measured/Not Analyzed

QA = Quality Assurance/Trip Blank

- ¹ Chromatogram pattern indicates a non-diesel mix.
- ² Chromatogram pattern indicates an unidentified hydrocarbon.
- ³ Chromatogram pattern indicates an unidentified hydrocarbon and weathered diesel.
- ⁴ Confirmation run.
- ⁵ ORC present in well.
- ⁶ Laboratory report indicates gasoline and unidentified hydrocarbons >10.
- ⁷ Laboratory report indicates gasoline C6-C12.
- ⁸ Laboratory report indicates this sample was analyzed outside of the EPA recommended holding time.
- ⁹ Laboratory report indicates unidentified hydrocarbons C9-C24.
- ¹⁰ Laboratory report indicates unidentified hydrocarbons C10-C24.
- ¹¹ Laboratory report indicates unidentified hydrocarbons >C16.
- ¹² Laboratory report indicates unidentified hydrocarbons C9-C40.
- ¹³ Laboratory report indicates diesel C9-C24 + unidentified hydrocarbons <C16.
- ¹⁴ Laboratory report indicates weathered gasoline C6-C12.
- ¹⁵ Laboratory report indicates unidentified hydrocarbons C6-C12.
- ¹⁶ Laboratory report indicates hydrocarbon pattern is present in the requested fuel quantitation range but does not resemble the pattern of the requested fuel.
- ¹⁷ Laboratory report indicates hydrocarbon pattern is present in the requested fuel quantitation range but does not resemble the pattern of the requested fuel. The pattern more closely resembles that of a heavier hydrocarbon mix.
- ¹⁸ BTEX and MTBE by EPA Method 8260.
- ¹⁹ Laboratory report indicates the observed sample pattern is not typical of diesel/#2 fuel oil.
- ²⁰ ORC removed from well.

Table 2
Dissolved Oxygen Concentrations
 Chevron Service Station #9-0121
 3026 Lakeshore Avenue
 Oakland, California

WELL ID	DATE	Before Purging (mg/L)	After Purging (mg/L)
MW-1	06/24/00 ¹	5.30	--
	09/07/00 ¹	4.02	--
	12/05/00 ¹	3.86	--
	03/01/01 ¹	3.04	--
	06/04/01 ¹	2.70	--
	09/10/01 ¹	2.40	--
	12/03/01 ¹	0.70	--
	03/04/02 ¹	1.10	--
	05/30/02 ¹	0.90	--
	09/03/02 ¹	1.20	--
	12/09/02 ¹	0.90	--
	03/10/03 ¹	1.00	--
	06/09/03 ¹	0.80	--
	09/08/03 ¹	0.60	--
12/08/03 ¹	2.00	--	

EXPLANATIONS:

(mg/L) = Milligrams per liter

-- = Not Measured

¹ ORC present in well.

Table 3
Groundwater Analytical Results
Chevron Service Station #9-0121
3026 Lakeshore Avenue
Oakland, California

WELL ID/ DATE	Total Alkalinity (ppb)	Ferrous Iron (ppb)	Sulfate (ppb)	Nitrate (ppb)
MW-1 12/28/98	390,000	4,900	<1,000	<1,000
MW-3 12/28/98	980,000	4,500	390,000	<1,000
MW-4 12/28/98	670,000	3,500	6,800	<1,000
MW-5 12/28/98	480,000	15	51,000	<1,000
MW-6 12/28/98	2,400,000	810	110,000	<1,000
MW-7 12/28/98	350,000	12,000	79,000	<1,000
MW-8 12/28/98	1,100,000	45	87,000	<1,000

EXPLANATIONS:

Groundwater laboratory analytical results were compiled from reports prepared by Blaine Tech Services, Inc.

(ppb) = Parts per billion

STANDARD OPERATING PROCEDURE - GROUNDWATER SAMPLING

Gettler-Ryan Inc. field personnel adhere to the following procedures for the collection and handling of groundwater samples prior to analysis by the analytical laboratory. Prior to sample collection, the type of analysis to be performed is determined. Loss prevention of volatile compounds is controlled and sample preservation for subsequent analysis is maintained.

Prior to sampling, the presence or absence of free-phase hydrocarbons is determined using an interface probe. Product thickness, if present, is measured to the nearest 0.01 foot and is noted in the field notes. In addition, all depth to water level measurements are collected with a static water level indicator and are also recorded in the field notes, prior to purging and sampling any wells.

After water levels are collected and prior to sampling, if purging is to occur, each well is purged a minimum of three well casing volumes of water using pre-cleaned pumps (stack, suction, Grundfos), or disposable bailers. Temperature, pH and electrical conductivity are measured a minimum of three times during the purging. Purging continues until these parameters stabilize.

Groundwater samples are collected using disposable bailers. The water samples are transferred from the bailer into appropriate containers. Pre-preserved containers, supplied by analytical laboratories, are used when possible. When pre-preserved containers are not available, the laboratory is instructed to preserve the sample as appropriate. Duplicate samples are collected for the laboratory to use in maintaining quality assurance/quality control standards. The samples are labeled to include the job number, sample identification, collection date and time, analysis, preservation (if any), and the sample collector's initials. The water samples are placed in a cooler, maintained at 4°C for transport to the laboratory. Once collected in the field, all samples are maintained under chain of custody until delivered to the laboratory.

The chain of custody document includes the job number, type of preservation, if any, analysis requested, sample identification, date and time collected, and the sample collector's name. The chain of custody is signed and dated (including time of transfer) by each person who receives or surrenders the samples, beginning with the field personnel and ending with the laboratory personnel.

A laboratory supplied trip blank accompanies each sampling set. For sampling sets greater than 20 samples, 5% trip blanks are included. The trip blank is analyzed for some or all of the same compounds as the groundwater samples.

As requested by ChevronTexaco Company, the purge water and decontamination water generated during sampling activities is transported by IWM to McKittrick Waste Management located in McKittrick, California.



GETTLER-RYAN INC.

WELL MONITORING/SAMPLING FIELD DATA SHEET

Client/Facility #: ChevronTexaco #9-0121
 Site Address: 3026 Lakeshore Avenue
 City: Oakland, CA

Job Number: 386462
 Event Date: 3/9/04 (inclusive)
 Sampler: HAIG K.

Well ID: MW-1
 Well Diameter: 2 4 in.
 Total Depth: 19.24 ft.
 Depth to Water: 4.03 ft.

Date Monitored: 3/9/04 Well Condition: OK

Volume	3/4"= 0.02	1"= 0.04	2"= 0.17	3"= 0.38
Factor (VF)	4"= 0.66	5"= 1.02	6"= 1.50	12"= 5.80

15.21 xVF 0.66 = 10 x3 (case volume) = Estimated Purge Volume: 30 gal.

Purge Equipment:

Disposable Bailer _____
 Stainless Steel Bailer _____
 Stack Pump _____
 Suction Pump _____
 Grundfos _____
 Other: _____

Sampling Equipment:

Disposable Bailer _____
 Pressure Bailer _____
 Discrete Bailer _____
 Other: _____

Time Started: _____ (2400 hrs)
 Time Bailed: _____ (2400 hrs)
 Depth to Product: _____ ft
 Depth to Water: _____ ft
 Hydrocarbon Thickness: _____ ft
 Visual Confirmation/Description: _____
 Skimmer / Absorbant Sock (circle one)
 Amt Removed from Skimmer: _____ gal
 Amt Removed from Well: _____ gal
 Product Transferred to: _____

Start Time (purge): 1113 Weather Conditions: SUNNY
 Sample Time/Date: 1135/3/9/04 Water Color: CLEAR Odor: YES
 Purging Flow Rate: 2 gpm. Sediment Description: _____
 Did well de-water? NO If yes, Time: _____ Volume: _____ gal.

Time (2400 hr.)	Volume (gal.)	pH	Conductivity (u mhos/cm)	Temperature (C/F)	D.O. (mg/L)	ORP (mV)
<u>1118</u>	<u>10</u>	<u>6.73</u>	<u>925</u>	<u>18.5</u>		
<u>1125</u>	<u>20</u>	<u>6.68</u>	<u>883</u>	<u>18.8</u>		
<u>1129</u>	<u>30</u>	<u>6.70</u>	<u>892</u>	<u>19.0</u>		

LABORATORY INFORMATION

SAMPLE ID	(#) CONTAINER	REFRIG.	PRESERV. TYPE	LABORATORY	ANALYSES
MW-1	<u>6</u> x voa vial	YES	HCL	LANCASTER	TPH-G(8015)/BTEX+MTBE(8260)/ETHANOL(8260)
MW-1	<u>2</u> x amber	YES	NP	LANCASTER	TPH-D

COMMENTS:

Add/Replaced Lock: _____ Add/Replaced Plug: _____ Size: _____



GETTLER-RYAN INC.

WELL MONITORING/SAMPLING FIELD DATA SHEET

Client/Facility #: ChevronTexaco #9-0121
 Site Address: 3026 Lakeshore Avenue
 City: Oakland, CA

Job Number: 386462
 Event Date: 3/9/04 (inclusive)
 Sampler: HAIG K.

Well ID: MW-2A Date Monitored: 3/9/04 Well Condition: OK

Well Diameter: 2.0 in.
 Total Depth: 16.17 ft.
 Depth to Water: 4.12 ft.

Volume Factor (VF)	3/4" = 0.02	1" = 0.04	2" = 0.17	3" = 0.38
	4" = 0.66	5" = 1.02	6" = 1.50	12" = 5.80

12.05 x VF 0.17 = 2 x3 (case volume) = Estimated Purge Volume: 6 gal.

Purge Equipment:
 Disposable Bailer
 Stainless Steel Bailer
 Stack Pump
 Suction Pump
 Grundfos
 Other:

Sampling Equipment:
 Disposable Bailer
 Pressure Bailer
 Discrete Bailer
 Other:

Time Started: _____ (2400 hrs)
 Time Bailed: _____ (2400 hrs)
 Depth to Product: _____ ft
 Depth to Water: _____ ft
 Hydrocarbon Thickness: 0 ft
 Visual Confirmation/Description: _____
 Skimmer / Absorbant Sock (circle one)
 Amt Removed from Skimmer: _____ gal
 Amt Removed from Well: _____ gal
 Product Transferred to: _____

Start Time (purge): 1042 Weather Conditions: SUNNY
 Sample Time/Date: 1100/3/9/04 Water Color: CLOUDY (LIGHT YELLO) odor: YES
 Purging Flow Rate: _____ gpm. Sediment Description: _____
 Did well de-water? NO If yes, Time: _____ Volume: _____ gal.

Time (2400 hr.)	Volume (gal.)	pH	Conductivity (u mhos/cm)	Temperature (C/F)	D.O. (mg/L)	ORP (mV)
<u>1046</u>	<u>2</u>	<u>6.90</u>	<u>2996</u>	<u>18.1</u>		
<u>1050</u>	<u>4</u>	<u>6.76</u>	<u>2758</u>	<u>18.4</u>		
<u>1053</u>	<u>6</u>	<u>6.81</u>	<u>2781</u>	<u>18.1</u>		

LABORATORY INFORMATION

SAMPLE ID	(#) CONTAINER	REFRIG.	PRESERV. TYPE	LABORATORY	ANALYSES
MW-2A	6 x voa vial	YES	HCL	LANCASTER	TPH-G(8015)/BTEX+MTBE(8260)/ETHANOL(8260)
MW-2A	2 x amber	YES	NP	LANCASTER	TPH-D

COMMENTS: _____

Add/Replaced Lock: _____ Add/Replaced Plug: _____ Size: _____



GETTLER - RYAN INC.

WELL MONITORING/SAMPLING FIELD DATA SHEET

Client/Facility #: ChevronTexaco #9-0121 Job Number: 386462
 Site Address: 3026 Lakeshore Avenue Event Date: 3/9/04 (inclusive)
 City: Oakland, CA Sampler: HAIG R.

Well ID: MW-3A Date Monitored: 3/9/04 Well Condition: OK

Well Diameter: 2 1/8 in.
 Total Depth: 18.05 ft.
 Depth to Water: 7.71 ft.

Volume	3/4"= 0.02	1"= 0.04	2"= 0.17	3"= 0.38
Factor (VF)	4"= 0.66	5"= 1.02	6"= 1.50	12"= 5.80

Estimated Purge Volume: $10.34 \times VF \ 0.17 = 1.7 \times 3 \text{ (case volume)} = 5.1 \text{ gal.}$

Purge Equipment:
 Disposable Bailer
 Stainless Steel Bailer _____
 Stack Pump _____
 Suction Pump _____
 Grundfos _____
 Other: _____

Sampling Equipment:
 Disposable Bailer
 Pressure Bailer _____
 Discrete Bailer _____
 Other: _____

Time Started:	_____ (2400 hrs)
Time Bailed:	_____ (2400 hrs)
Depth to Product:	_____ ft
Depth to Water:	_____ ft
Hydrocarbon Thickness:	_____ ft
Visual Confirmation/Description:	_____
Skimmer / Absorbant Sock (circle one)	
Amt Removed from Skimmer:	_____ gal
Amt Removed from Well:	_____ gal
Product Transferred to:	_____

Start Time (purge): 1008 Weather Conditions: SUNNY
 Sample Time/Date: 1025/3/9/04 Water Color: CLEAR Odor: NO
 Purging Flow Rate: _____ gpm. Sediment Description: _____
 Did well de-water? NO If yes, Time: _____ Volume: _____ gal.

Time (2400 hr.)	Volume (gal.)	pH	Conductivity (u mhos/cm)	Temperature (C/F)	D.O. (mg/L)	ORP (mV)
<u>1011</u>	<u>2</u>	<u>6.68</u>	<u>2309</u>	<u>18.7</u>		
<u>1013</u>	<u>3.5</u>	<u>6.54</u>	<u>2238</u>	<u>19.5</u>		
<u>1016</u>	<u>5</u>	<u>6.65</u>	<u>2192</u>	<u>19.3</u>		

LABORATORY INFORMATION

SAMPLE ID	(#) CONTAINER	REFRIG.	PRESERV. TYPE	LABORATORY	ANALYSES
<u>MW-3A</u>	<u>6</u> x voa vial	<u>YES</u>	<u>HCL</u>	<u>LANCASTER</u>	<u>TPH-G(8015)/BTEX+MTBE(8260)/ETHANOL(8260)</u>
<u>MW-3A</u>	<u>2</u> x amber	<u>YES</u>	<u>NP</u>	<u>LANCASTER</u>	<u>TPH-D</u>

COMMENTS: _____

Add/Replaced Lock: _____ Add/Replaced Plug: _____ Size: _____



GETTLER - RYAN INC.

WELL MONITORING/SAMPLING FIELD DATA SHEET

Client/Facility #: ChevronTexaco #9-0121
 Site Address: 3026 Lakeshore Avenue
 City: Oakland, CA

Job Number: 386462
 Event Date: 3/9/04 (inclusive)
 Sampler: HAIG R.

Well ID: MW-4A Date Monitored: 3/9/04 Well Condition: OK

Well Diameter: (2) in.
 Total Depth: 18.51 ft.
 Depth to Water: 5.37 ft.

Volume	3/4"= 0.02	1"= 0.04	2"= 0.17	3"= 0.38
Factor (VF)	4"= 0.66	5"= 1.02	6"= 1.50	12"= 5.80

13.14 x VF 0.17 = 2 x3 (case volume) = Estimated Purge Volume: 6 gal.

Purge Equipment:

Disposable Bailer
 Stainless Steel Bailer _____
 Stack Pump _____
 Suction Pump _____
 Grundfos _____
 Other: _____

Sampling Equipment:

Disposable Bailer
 Pressure Bailer _____
 Discrete Bailer _____
 Other: _____

Time Started:	_____ (2400 hrs)
Time Bailed:	_____ (2400 hrs)
Depth to Product:	_____ ft
Depth to Water:	_____ ft
Hydrocarbon Thickness:	_____ ft
Visual Confirmation/Description:	_____
Skimmer / Absorbant Sock (circle one)	
Amt Removed from Skimmer:	_____ gal
Amt Removed from Well:	_____ gal
Product Transferred to:	_____

Start Time (purge): 1148 Weather Conditions: SUNNY
 Sample Time/Date: 1205/3/9/04 Water Color: CLOUDY Odor: YES
 Purging Flow Rate: _____ gpm. Sediment Description: _____
 Did well de-water? NO If yes, Time: _____ Volume: _____ gal.

Time (2400 hr.)	Volume (gal.)	pH	Conductivity (u mhos/cm)	Temperature (C/F)	D.O. (mg/L)	ORP (mV)
<u>1151</u>	<u>2</u>	<u>6.97</u>	<u>2648</u>	<u>18.9</u>		
<u>1154</u>	<u>4</u>	<u>6.92</u>	<u>2762</u>	<u>18.2</u>		
<u>1158</u>	<u>6</u>	<u>6.90</u>	<u>2736</u>	<u>19.1</u>		

LABORATORY INFORMATION

SAMPLE ID	(#) CONTAINER	REFRIG.	PRESERV. TYPE	LABORATORY	ANALYSES
<u>MW-4A</u>	<u>6</u> x voa vial	<u>YES</u>	<u>HCL</u>	<u>LANCASTER</u>	<u>TPH-G(8015)/BTEX+MTBE(8260)/ETHANOL(8260)</u>
<u>MW-4A</u>	<u>2</u> x amber	<u>YES</u>	<u>NP</u>	<u>LANCASTER</u>	<u>TPH-D</u>

COMMENTS:

Add/Replaced Lock: _____ Add/Replaced Plug: _____ Size: _____



GETTLER - RYAN INC.

WELL MONITORING/SAMPLING FIELD DATA SHEET

Client/Facility #: ChevronTexaco #9-0121
 Site Address: 3026 Lakeshore Avenue
 City: Oakland, CA

Job Number: 386462
 Event Date: 3/9/04 (inclusive)
 Sampler: HAIG K.

Well ID: MW-5
 Well Diameter: (2) 4 in.
 Total Depth: 32.76 ft.
 Depth to Water: 10.58 ft.
22.18

Date Monitored: 3/9/04 Well Condition: OK

Volume	3/4"= 0.02	1"= 0.04	2"= 0.17	3"= 0.38
Factor (VF)	4"= 0.66	5"= 1.02	6"= 1.50	12"= 5.80

$0.17 \times 3 \text{ (case volume)} = 3.7$ Estimated Purge Volume: 11.1 gal.

Purge Equipment:

Disposable Bailer _____
 Stainless Steel Bailer _____
 Stack Pump _____
 Suction Pump _____
 Grundfos _____
 Other: _____

Sampling Equipment:

Disposable Bailer _____
 Pressure Bailer _____
 Discrete Bailer _____
 Other: _____

Time Started: _____ (2400 hrs)
 Time Bailed: _____ (2400 hrs)
 Depth to Product: _____ ft
 Depth to Water: _____ ft
 Hydrocarbon Thickness: _____ ft
 Visual Confirmation/Description: _____
 Skimmer / Absorbant Sock (circle one)
 Amt Removed from Skimmer: _____ gal
 Amt Removed from Well: _____ gal
 Product Transferred to: _____

Start Time (purge): 0937 Weather Conditions: SUNNY
 Sample Time/Date: 0955 3/9/04 Water Color: CLEAR Odor: NO
 Purging Flow Rate: 172 gpm. Sediment Description: _____
 Did well de-water? NO If yes, Time: _____ Volume: _____ gal.

Time (2400 hr.)	Volume (gal.)	pH	Conductivity (umhos/cm)	Temperature (C/F)	D.O. (mg/L)	ORP (mV)
<u>0940</u>	<u>4</u>	<u>6.78</u>	<u>984</u>	<u>18.3</u>		
<u>0943</u>	<u>8</u>	<u>6.75</u>	<u>942</u>	<u>19.2</u>		
<u>0945</u>	<u>11</u>	<u>6.76</u>	<u>953</u>	<u>19.6</u>		

LABORATORY INFORMATION

SAMPLE ID	(#) CONTAINER	REFRIG.	PRESERV. TYPE	LABORATORY	ANALYSES
MW-5	6 x vov vial	YES	HCL	LANCASTER	TPH-G(8015)/BTEX+MTBE(8260)/ETHANOL(8260)
MW-5	2 x amber	YES	NP	LANCASTER	TPH-D

COMMENTS:

Add/Replaced Lock: _____

Add/Replaced Plug: _____ Size: _____



GETTLER - RYAN INC.

WELL MONITORING/SAMPLING FIELD DATA SHEET

Client/Facility #: ChevronTexaco #9-0121 Job Number: 386462
 Site Address: 3026 Lakeshore Avenue Event Date: 3/9/04 (inclusive)
 City: Oakland, CA Sampler: HAIG K

Well ID: MW-6 Date Monitored: 3/9/04 Well Condition: OK

Well Diameter: 2 1/4 in.
 Total Depth: 18.41 ft.
 Depth to Water: 5.85 ft.
~~12.56~~ xVF 0.17 = 2 x3 (case volume) = Estimated Purge Volume: 6 gal.

Volume	3/4"= 0.02	1"= 0.04	2"= 0.17	3"= 0.38
Factor (VF)	4"= 0.66	5"= 1.02	6"= 1.50	12"= 5.80

Purge Equipment:
 Disposable Bailer
 Stainless Steel Bailer _____
 Stack Pump _____
 Suction Pump _____
 Grundfos _____
 Other: _____

Sampling Equipment:
 Disposable Bailer
 Pressure Bailer _____
 Discrete Bailer _____
 Other: _____

Time Started: _____ (2400 hrs)
 Time Bailed: _____ (2400 hrs)
 Depth to Product: _____ ft
 Depth to Water: _____ ft
 Hydrocarbon Thickness: 0.0 ft
 Visual Confirmation/Description: _____
 Skimmer / Absorbant Sock (circle one)
 Amt Removed from Skimmer: _____ gal
 Amt Removed from Well: _____ gal
 Product Transferred to: _____

Start Time (purge): 1347 Weather Conditions: SUNNY
 Sample Time/Date: 1415 3/9/04 Water Color: LIGHT YELLOW Odor: SLIGHT
 Purging Flow Rate: _____ gpm. Sediment Description: _____
 Did well de-water? NO If yes, Time: _____ Volume: _____ gal.

Time (2400 hr.)	Volume (gal.)	pH	Conductivity (u mhos/cm)	Temperature (C/F)	D.O. (mg/L)	ORP (mV)
<u>1351</u>	<u>2</u>	<u>7.08</u>	<u>980</u>	<u>19.3</u>		
<u>1356</u>	<u>4</u>	<u>7.02</u>	<u>1022</u>	<u>20.1</u>		
<u>1359</u>	<u>6</u>	<u>7.06</u>	<u>1040</u>	<u>19.8</u>		

LABORATORY INFORMATION

SAMPLE ID	(#) CONTAINER	REFRIG.	PRESERV. TYPE	LABORATORY	ANALYSES
MW-6	6 x voa vial	YES	HCL	LANCASTER	TPH-G(8015)/BTEX+MTBE(8260)/ETHANOL(8260)
MW-6	2 x amber	YES	NP	LANCASTER	TPH-D

COMMENTS: _____

Add/Replaced Lock: _____ Add/Replaced Plug: _____ Size: _____



GETTLER - RYAN INC.

WELL MONITORING/SAMPLING FIELD DATA SHEET

Client/Facility #: ChevronTexaco #9-0121 Job Number: 386462
 Site Address: 3026 Lakeshore Avenue Event Date: 3/9/04 (inclusive)
 City: Oakland, CA Sampler: HAIG K.

Well ID: MW-7 Date Monitored: 3/9/04 Well Condition: OK

Well Diameter: 2 1/4 in.
 Total Depth: 14.05 ft.
 Depth to Water: 0.73 ft.

Volume	3/4"= 0.02	1"= 0.04	2"= 0.17	3"= 0.38
Factor (VF)	4"= 0.66	5"= 1.02	6"= 1.50	12"= 5.80

13.32 x VF 0.17 = 2 x3 (case volume) = Estimated Purge Volume: 6 gal.

Purge Equipment:

Disposable Bailer
 Stainless Steel Bailer _____
 Stack Pump _____
 Suction Pump _____
 Grundfos _____
 Other: _____

Sampling Equipment:

Disposable Bailer
 Pressure Bailer _____
 Discrete Bailer _____
 Other: _____

Time Started: _____ (2400 hrs)
 Time Bailed: _____ (2400 hrs)
 Depth to Product: _____ ft.
 Depth to Water: _____ ft.
 Hydrocarbon Thickness: 0.06 ft.
 Visual Confirmation/Description: _____
 Skimmer / Absorbant Sock (circle one)
 Amt Removed from Skimmer: _____ gal
 Amt Removed from Well: _____ gal
 Product Transferred to: _____

Start Time (purge): 0833 Weather Conditions: SUNNY
 Sample Time/Date: 0850 3/9/04 Water Color: CLEAR Odor: NO
 Purging Flow Rate: _____ gpm. Sediment Description: _____
 Did well de-water? NO If yes, Time: _____ Volume: _____ gal.

Time (2400 hr.)	Volume (gal.)	pH	Conductivity (u mhos/cm)	Temperature (C/F)	D.O. (mg/L)	ORP (mV)
<u>0836</u>	<u>2</u>	<u>6.80</u>	<u>793</u>	<u>19.1</u>		
<u>0840</u>	<u>4</u>	<u>6.75</u>	<u>762</u>	<u>19.4</u>		
<u>0843</u>	<u>6</u>	<u>6.75</u>	<u>755</u>	<u>19.5</u>		

LABORATORY INFORMATION

SAMPLE ID	(#) CONTAINER	REFRIG.	PRESERV. TYPE	LABORATORY	ANALYSES
MW- <u>7</u>	<u>6</u> x voa vial	YES	HCL	LANCASTER	TPH-G(8015)/BTEX+MTBE(8260)/ETHANOL(8260)
MW- <u>7</u>	<u>2</u> x amber	YES	NP	LANCASTER	TPH-D

COMMENTS:

Add/Replaced Lock: _____

Add/Replaced Plug: _____ Size: _____



GETTLER - RYAN INC.

WELL MONITORING/SAMPLING FIELD DATA SHEET

Client/Facility #: ChevronTexaco #9-0121 Job Number: 386462
 Site Address: 3026 Lakeshore Avenue Event Date: 3/19/04 (inclusive)
 City: Oakland, CA Sampler: HAIG R

Well ID: MW-8 Date Monitored: 3/19/04 Well Condition: OK
 Well Diameter: 20 in.
 Total Depth: 24.85 ft.
 Depth to Water: 1.91 ft.
 $16.94 \times VF \ 0.17 = 2.8 \times 3 \text{ (case volume)} = \text{Estimated Purge Volume: } 8.4 \text{ gal.}$

Volume	3/4"= 0.02	1"= 0.04	2"= 0.17	3"= 0.38
Factor (VF)	4"= 0.66	5"= 1.02	6"= 1.50	12"= 5.80

Purge Equipment:
 Disposable Bailer _____
 Stainless Steel Bailer _____
 Stack Pump _____
 Suction Pump _____
 Grundfos _____
 Other: _____

Sampling Equipment:
 Disposable Bailer _____
 Pressure Bailer _____
 Discrete Bailer _____
 Other: _____

Time Started: _____ (2400 hrs)
 Time Bailed: _____ (2400 hrs)
 Depth to Product: _____ ft
 Depth to Water: _____ ft
 Hydrocarbon Thickness: 0 ft
 Visual Confirmation/Description: _____
 Skimmer / Absorbant Sock (circle one)
 Amt Removed from Skimmer: _____ gal
 Amt Removed from Well: _____ gal
 Product Transferred to: _____

Start Time (purge): 0907 Weather Conditions: SUNNY
 Sample Time/Date: 0920/3/19/04 Water Color: CLEAR Odor: NO
 Purging Flow Rate: 1.42 gpm. Sediment Description: _____
 Did well de-water? NO If yes, Time: _____ Volume: _____ gal.

Time (2400 hr.)	Volume (gal.)	pH	Conductivity (u mhos/cm)	Temperature (C/F)	D.O. (mg/L)	ORP (mV)
<u>0909</u>	<u>3</u>	<u>6.90</u>	<u>1380</u>	<u>17.5</u>		
<u>0911</u>	<u>6</u>	<u>6.83</u>	<u>1324</u>	<u>17.3</u>		
<u>0913</u>	<u>8</u>	<u>6.85</u>	<u>1336</u>	<u>17.6</u>		

LABORATORY INFORMATION

SAMPLE ID	(#) CONTAINER	REFRIG.	PRESERV. TYPE	LABORATORY	ANALYSES
MW- <u>8</u>	<u>6</u> x voa vial	YES	HCL	LANCASTER	TPH-G(8015)/BTEX+MTBE(8260)/ETHANOL(8260)
MW- <u>8</u>	<u>2</u> x amber	YES	NP	LANCASTER	TPH-D

COMMENTS: _____

Add/Replaced Lock: _____

Add/Replaced Plug: _____ Size: _____



GETTLER - RYAN INC.

WELL MONITORING/SAMPLING FIELD DATA SHEET

Client/Facility #: ChevronTexaco #9-0121
 Site Address: 3026 Lakeshore Avenue
 City: Oakland, CA

Job Number: 386462
 Event Date: 3/9/04 (inclusive)
 Sampler: HAIG R.

Well ID: MW-9
 Well Diameter: (2) 1/8 in.
 Total Depth: 15.64 ft.
 Depth to Water: 3.18 ft.

Date Monitored: 3/9/04 Well Condition: OK

Volume	3/4" = 0.02	1" = 0.04	2" = 0.17	3" = 0.38
Factor (VF)	4" = 0.66	5" = 1.02	6" = 1.50	12" = 5.80

12.46 x VF 0.17 = 2 x3 (case volume) = Estimated Purge Volume: 6 gal.

Purge Equipment:

Disposable Bailer
 Stainless Steel Bailer _____
 Stack Pump _____
 Suction Pump _____
 Grundfos _____
 Other: _____

Sampling Equipment:

Disposable Bailer
 Pressure Bailer _____
 Discrete Bailer _____
 Other: _____

Time Started: _____ (2400 hrs)
 Time Bailed: _____ (2400 hrs)
 Depth to Product: _____ ft
 Depth to Water: _____ ft
 Hydrocarbon Thickness: 0 ft
 Visual Confirmation/Description: _____
 Skimmer / Absorbant Sock (circle one)
 Amt Removed from Skimmer: _____ gal
 Amt Removed from Well: _____ gal
 Product Transferred to: _____

Start Time (purge): 1220 Weather Conditions: SUNNY
 Sample Time/Date: 24013/9/04 Water Color: CLOUDY Odor: YES
 Purging Flow Rate: _____ gpm. Sediment Description: _____
 Did well de-water? NO If yes, Time: _____ Volume: _____ gal.

Time (2400 hr.)	Volume (gal.)	pH	Conductivity (umhos/cm)	Temperature (C/F)	D.O (mg/L)	ORP (mV)
<u>1224</u>	<u>2</u>	<u>6.86</u>	<u>821</u>	<u>18.0</u>		
<u>1227</u>	<u>4</u>	<u>6.83</u>	<u>788</u>	<u>17.7</u>		
<u>1231</u>	<u>6</u>	<u>6.82</u>	<u>764</u>	<u>18.4</u>		

LABORATORY INFORMATION

SAMPLE ID	(#) CONTAINER	REFRIG.	PRESERV. TYPE	LABORATORY	ANALYSES
MW-9	6 x voa vial	YES	HCL	LANCASTER	TPH-G(8015)/BTEX+MTBE(8260)/ETHANOL(8260)
MW-9	2 x amber	YES	NP	LANCASTER	TPH-D

COMMENTS:

Add/Replaced Lock: _____

Add/Replaced Plug: _____ Size: _____

Chevron California Region Analysis Request/Chain of Custody



Grp # 887688
For Lancaster Laboratories use only

Acct. #: 10904

Sample #: 423137423

SCR#:

030904-04

Facility #: SS# 0121 G-R#386462 Global ID#T0600100028
Site Address: 3026 LAKESHORE AVENUE, OAKLAND, CA
Chevron PM: KS **Lead Consultant:** CAMBRIA
Consultant/Office: G-R, Inc., 6747 Sierra Court, Suite J, Dublin, Ca. 94568
Consultant Prj. Mgr.: Deanna L. Harding (deanna@grinc.com)
Consultant Phone #: 925-551-7555 **Fax #:** 925-551-7899
Sampler: HAIG KEVORK
Service Order #: _____ Non SAR: _____

Matrix		Analyses Requested									
		Preservation Codes									
<input type="checkbox"/> Potable <input type="checkbox"/> NPDES <input type="checkbox"/> Water <input type="checkbox"/> Air	<input type="checkbox"/> Soil <input type="checkbox"/> Oil	Total Number of Containers									
		BTEX + MTBE 8260	TPH 8015 MOD	TPH 8015 MOD DRO	8260 full scan	Oxygenates	Lead 7420	7421	ETHANOL 8260		

Preservative Codes
 H = HCl T = Thiosulfate
 N = HNO₃ B = NaOH
 S = H₂SO₄ O = Other

- J value reporting needed
 Must meet lowest detection limits possible for 8260 compounds
 8021 MTBE Confirmation
 Confirm highest hit by 8260
 Confirm all hits by 8260
 Run ___ oxy s on highest hit
 Run ___ oxy s on all hits

Sample Identification	Date Collected	Time Collected	Grab	Composite	Soil	Water	Oil	Air	Total Number of Containers	BTEX + MTBE 8260	TPH 8015 MOD	TPH 8015 MOD DRO	8260 full scan	Oxygenates	Lead 7420	7421	ETHANOL 8260
GA	3/9/04																
MW-1		1135	X		X	X	X	X	X	X	X	X	X	X	X	X	X
MW-2A		1100	X		X	X	X	X	X	X	X	X	X	X	X	X	X
MW-3A		1025	X		X	X	X	X	X	X	X	X	X	X	X	X	X
MW-4A		1205	X		X	X	X	X	X	X	X	X	X	X	X	X	X
MW-5		0955	X		X	X	X	X	X	X	X	X	X	X	X	X	X
MW-6		1415	X		X	X	X	X	X	X	X	X	X	X	X	X	X
MW-7		0850	X		X	X	X	X	X	X	X	X	X	X	X	X	X
MW-8		0920	X		X	X	X	X	X	X	X	X	X	X	X	X	X
MW-9		1240	X		X	X	X	X	X	X	X	X	X	X	X	X	X

Comments / Remarks

Turnaround Time Requested (TAT) (please circle):
 STD. TAT 72 hour 48 hour
 24 hour 4 day 5 day

Data Package Options (please circle if required)
 QC Summary Type I — Full
 Type VI (Raw Data) Coelt Deliverable not needed
 WIP (RWQCB)
 Disk

Relinquished by: <u>[Signature]</u>	Date: <u>3/9/04</u>	Time: <u>1645</u>	Received by: <u>[Signature]</u>	Date: <u>3/9/04</u>	Time: <u>1645</u>
Relinquished by: <u>[Signature]</u>	Date: <u>3/9/04</u>	Time: <u>1650</u>	Received by: <u>Airborne/DHL</u>	Date: <u>3/9/04</u>	Time: <u></u>
Relinquished by: _____	Date: _____	Time: _____	Received by: _____	Date: _____	Time: _____
Relinquished by Commercial Carrier: UPS FedEx Other <u>Airborne</u>	Temperature Upon Receipt: <u>2.5°C</u>		Received by: <u>[Signature]</u>	Date: <u>3/10/04</u>	Time: <u>0920</u>
Custody Seals Intact? <u>Yes</u> No					

ANALYTICAL RESULTS

Prepared for:

ChevronTexaco
6001 Bollinger Canyon Rd L4310
San Ramon CA 94583

925-842-8582

Prepared by:

Lancaster Laboratories
2425 New Holland Pike
Lancaster, PA 17605-2425

SAMPLE GROUP

The sample group for this submittal is 887688. Samples arrived at the laboratory on Wednesday, March 10, 2004. The PO# for this group is 99011184 and the release number is STREICH.

<u>Client Description</u>			<u>Lancaster Labs Number</u>
QA-T-040309	NA	Water	4231374
MW-1-W-040309	Grab	Water	4231375
MW-2A-W-040309	Grab	Water	4231376
MW-3A-W-040309	Grab	Water	4231377
MW-4A-W-040309	Grab	Water	4231378
MW-5-W-040309	Grab	Water	4231379
MW-6-W-040309	Grab	Water	4231380
MW-7-W-040309	Grab	Water	4231381
MW-8-W-040309	Grab	Water	4231382
MW-9-W-040309	Grab	Water	4231383

1 COPY TO
ELECTRONIC
COPY TO

Cambria C/O Gettler- Ryan
Gettler-Ryan

Attn: Deanna L. Harding
Attn: Cheryl Hansen

Questions? Contact your Client Services Representative
Teresa L. Cunningham at (717) 656-2300.

Respectfully Submitted,

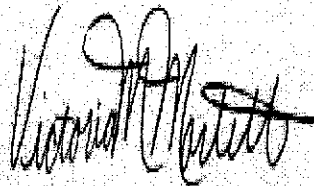

Victoria M. Martell
Chemist

Lancaster Laboratories Sample No. **WW 4231374**

 QA-T-040309 NA Water
 Facility# 90121 Job# 386462 GRD
 3026 L Shore Ave Oakland T0600100328 QA
 Collected: 03/09/2004

Account Number: 10904

 Submitted: 03/10/2004 09:20
 Reported: 03/21/2004 at 09:04
 Discard: 04/21/2004

 ChevronTexaco
 6001 Bollinger Canyon Rd L4310
 San Ramon CA 94583

LSAQA

CAT No.	Analysis Name	CAS Number	As Received Result	As Received		Units	Dilution Factor
				Method	Detection Limit		
01728	TPH-GRO - Waters	n.a.	N.D.		50.	ug/l	1
	The reported concentration of TPH-GRO does not include MTBE or other gasoline constituents eluting prior to the C6 (n-hexane) TPH-GRO range start time.						
06054	BTEX+MTBE by 8260B						
02010	Methyl Tertiary Butyl Ether	1634-04-4	N.D.		0.5	ug/l	1
05401	Benzene	71-43-2	N.D.		0.5	ug/l	1
05407	Toluene	108-88-3	N.D.		0.5	ug/l	1
05415	Ethylbenzene	100-41-4	N.D.		0.5	ug/l	1
06310	Xylene (Total)	1330-20-7	N.D.		0.5	ug/l	1

State of California Lab Certification No. 2116

Laboratory Chronicle

CAT No.	Analysis Name	Method	Trial#	Analysis		Analyst	Dilution Factor
				Date	Time		
01728	TPH-GRO - Waters	N. CA LUFT Gasoline Method	1	03/12/2004	02:02	Victoria M Martell	1
06054	BTEX+MTBE by 8260B	SW-846 8260B	1	03/16/2004	08:58	Elizabeth M Taylor	1
01146	GC VOA Water Prep	SW-846 5030B	1	03/12/2004	02:02	Victoria M Martell	n.a.
01163	GC/MS VOA Water Prep	SW-846 5030B	1	03/16/2004	08:58	Elizabeth M Taylor	n.a.

Lancaster Laboratories Sample No. WW 4231375

 MW-1-W-040309 Grab Water GRD
 Facility# 90121 Job# 386462
 3026 L Shore Ave Oakland T0600100328 MW-1
 Collected: 03/09/2004 11:35 by HK

Account Number: 10904

 Submitted: 03/10/2004 09:20
 Reported: 03/21/2004 at 09:04
 Discard: 04/21/2004

 ChevronTexaco
 6001 Bollinger Canyon Rd L4310
 San Ramon CA 94583

1LSAC

CAT No.	Analysis Name	CAS Number	As Received Result	As Received Method Detection Limit	Units	Dilution Factor
01728	TPH-GRO - Waters	n.a.	1,500.	50.	ug/l	1
	The reported concentration of TPH-GRO does not include MTBE or other gasoline constituents eluting prior to the C6 (n-hexane) TPH-GRO range start time.					
05553	TPH - DRO CA LUFT (Waters)	n.a.	3,300.	250.	ug/l	10
	According to the California LUFT Protocol, the quantitation for Diesel Range Organics was performed by peak area comparison of the sample pattern to that of our #2 fuel oil reference standard (between C10 and C28 normal hydrocarbons).					
01594	BTEX+5 Oxygenates+EDC+EDB+ETOH					
01587	Ethanol	64-17-5	N.D.	130.	ug/l	2.5
02010	Methyl Tertiary Butyl Ether	1634-04-4	99.	1.	ug/l	2.5
05401	Benzene	71-43-2	16.	1.	ug/l	2.5
05407	Toluene	108-88-3	3.	1.	ug/l	2.5
05415	Ethylbenzene	100-41-4	5.	1.	ug/l	2.5
06310	Xylene (Total)	1330-20-7	4.	1.	ug/l	2.5
	The reporting limits for the GC/MS volatile compounds were raised due to sample foaming.					

State of California Lab Certification No. 2116

Laboratory Chronicle

CAT No.	Analysis Name	Method	Trial#	Analysis Date and Time	Analyst	Dilution Factor
01728	TPH-GRO - Waters	N. CA LUFT Gasoline Method	1	03/11/2004 20:54	Martha L Seidel	1
05553	TPH - DRO CA LUFT (Waters)	CALUFT-DRO/8015B, Modified	1	03/16/2004 09:16	Tracy A Cole	10
01594	BTEX+5 Oxygenates+EDC+EDB+ETOH	SW-846 8260B	1	03/18/2004 08:22	Elizabeth M Taylor	2.5
01146	GC VOA Water Prep	SW-846 5030B	1	03/11/2004 20:54	Martha L Seidel	n.a.
01163	GC/MS VOA Water Prep	SW-846 5030B	1	03/18/2004 08:22	Elizabeth M Taylor	n.a.
02135	Extraction - DRO Water Special	TPH by CA LUFT	1	03/11/2004 17:00	JoElla L Rice	1



Analysis Report

2425 New Holland Pike, PO Box 12425, Lancaster, PA 17605-2425 • 717-656-2300 Fax: 717-656-2681 • www.lancasterlabs.com

Lancaster Laboratories Sample No. **WW 4231376**

MW-2A-W-040309 Grab Water
 Facility# 90121 Job# 386462 GRD
 3026 L Shore Ave Oakland T0600100328 MW-2A
 Collected: 03/09/2004 11:00 by HK

Account Number: 10904

Submitted: 03/10/2004 09:20
 Reported: 03/21/2004 at 09:04
 Discard: 04/21/2004

ChevronTexaco
 6001 Bollinger Canyon Rd L4310
 San Ramon CA 94583

2LSAC

CAT No.	Analysis Name	CAS Number	As Received Result	As Received Method Detection Limit	Units	Dilution Factor
01728	TPH-GRO - Waters	n.a.	1,300.	50.	ug/l	1
<p>The reported concentration of TPH-GRO does not include MTBE or other gasoline constituents eluting prior to the C6 (n-hexane) TPH-GRO range start time. Due to the nature of the sample matrix, the surrogate standard recovery is above the range of specifications.</p>						
05553	TPH - DRO CA LUFT (Waters)	n.a.	1,200.	250.	ug/l	10
<p>According to the California LUFT Protocol, the quantitation for Diesel Range Organics was performed by peak area comparison of the sample pattern to that of our #2 fuel oil reference standard (between C10 and C28 normal hydrocarbons).</p>						
01594	BTEX+5 Oxygenates+EDC+EDB+ETOH					
01587	Ethanol	64-17-5	N.D.	130.	ug/l	2.5
02010	Methyl Tertiary Butyl Ether	1634-04-4	2,900.	13.	ug/l	25
05401	Benzene	71-43-2	44.	1.	ug/l	2.5
05407	Toluene	108-88-3	2.	1.	ug/l	2.5
05415	Ethylbenzene	100-41-4	15.	1.	ug/l	2.5
06310	Xylene (Total)	1330-20-7	10.	1.	ug/l	2.5
<p>The reporting limits for the GC/MS volatile compounds were raised because sample dilution was necessary to bring target compounds into the calibration range of the system.</p>						

State of California Lab Certification No. 2116

Laboratory Chronicle

CAT No.	Analysis Name	Method	Analysis		Analyst	Dilution Factor
			Trial#	Date and Time		
01728	TPH-GRO - Waters	N. CA LUFT Gasoline	1	03/11/2004 23:44	Martha L Seidel	1
05553	TPH - DRO CA LUFT (Waters)	Method CALUFT-DRO/8015B, Modified	1	03/16/2004 09:39	Tracy A Cole	10
01594	BTEX+5	SW-846 8260B	1	03/18/2004 08:48	Elizabeth M Taylor	2.5
01594	Oxygenates+EDC+EDB+ETOH	SW-846 8260B	1	03/18/2004 09:15	Elizabeth M Taylor	25
01146	BTEX+5	SW-846 5030B	1	03/11/2004 23:44	Martha L Seidel	n.a.
01163	GC VOA Water Prep	SW-846 5030B	1	03/18/2004 08:48	Elizabeth M Taylor	n.a.
02135	GC/MS VOA Water Prep	TPH by CA LUFT	1	03/11/2004 17:00	JoElla L Rice	1
	Extraction - DRO Water Special					



Analysis Report

2425 New Holland Pike, PO Box 12425, Lancaster, PA 17605-2425 • 717-656-2300 Fax: 717-656-2681 • www.lancasterlabs.com

Page 2 of 2

Lancaster Laboratories Sample No. WW 4231376

MW-2A-W-040309 Grab Water
Facility# 90121 Job# 386462 GRD
3026 L Shore Ave Oakland T0600100328 MW-2A
Collected: 03/09/2004 11:00 by HK

Account Number: 10904

Submitted: 03/10/2004 09:20
Reported: 03/21/2004 at 09:04
Discard: 04/21/2004

ChevronTexaco
6001 Bollinger Canyon Rd L4310
San Ramon CA 94583

2LSAC

Lancaster Laboratories Sample No. WW 4231377
MW-3A-W-040309 Grab Water GRD
Facility# 90121 Job# 386462
3026 L Shore Ave Oakland T0600100328 MW-3A
Collected: 03/09/2004 10:25 by HK
Account Number: 10904
Submitted: 03/10/2004 09:20
Reported: 03/21/2004 at 09:04
Discard: 04/21/2004
ChevronTexaco
6001 Bollinger Canyon Rd L4310
San Ramon CA 94583
3ALSA

CAT No.	Analysis Name	CAS Number	As Received Result	As Received Method Detection Limit	Units	Dilution Factor
01728	TPH-GRO - Waters The reported concentration of TPH-GRO does not include MTBE or other gasoline constituents eluting prior to the C6 (n-hexane) TPH-GRO range start time.	n.a.	53.	50.	ug/l	1
05553	TPH - DRO CA LUFT (Waters) According to the California LUFT Protocol, the quantitation for Diesel Range Organics was performed by peak area comparison of the sample pattern to that of our #2 fuel oil reference standard (between C10 and C28 normal hydrocarbons).	n.a.	410.	26.	ug/l	1
01594	BTEX+5 Oxygenates+EDC+EDB+ETOH					
01587	Ethanol	64-17-5	N.D.	50.	ug/l	1
02010	Methyl Tertiary Butyl Ether	1634-04-4	28.	0.5	ug/l	1
05401	Benzene	71-43-2	1.	0.5	ug/l	1
05407	Toluene	108-88-3	N.D.	0.5	ug/l	1
05415	Ethylbenzene	100-41-4	N.D.	0.5	ug/l	1
06310	Xylene (Total)	1330-20-7	N.D.	0.5	ug/l	1

State of California Lab Certification No. 2116

Laboratory Chronicle

CAT No.	Analysis Name	Method	Analysis		Analyst	Dilution Factor
			Trial#	Date and Time		
01728	TPH-GRO - Waters	N. CA LUFT Gasoline Method	1	03/12/2004 00:24	Martha L Seidel	1
05553	TPH - DRO CA LUFT (Waters)	CALUFT-DRO/8015B, Modified	1	03/16/2004 05:53	Tracy A Cole	1
01594	BTEX+5 Oxygenates+EDC+EDB+ETOH	SW-846 8260B	1	03/18/2004 09:41	Elizabeth M Taylor	1
01146	GC VOA Water Prep	SW-846 5030B	1	03/12/2004 00:24	Martha L Seidel	n.a.
01163	GC/MS VOA Water Prep	SW-846 5030B	1	03/18/2004 09:41	Elizabeth M Taylor	n.a.
02135	Extraction - DRO Water Special	TPH by CA LUFT	1	03/11/2004 17:00	JoElla L Rice	1

Lancaster Laboratories Sample No. WW 4231378

 MW-4A-W-040309 Grab Water
 Facility# 90121 Job# 386462 GRD
 3026 L Shore Ave Oakland T0600100328 MW-4A
 Collected: 03/09/2004 12:05 by HK

Account Number: 10904

 Submitted: 03/10/2004 09:20
 Reported: 03/21/2004 at 09:04
 Discard: 04/21/2004

 ChevronTexaco
 6001 Bollinger Canyon Rd L4310
 San Ramon CA 94583

4ALSA

CAT No.	Analysis Name	CAS Number	As Received Result	As Received		Units	Dilution Factor
				Method	Detection Limit		
01728	TPH-GRO - Waters	n.a.	1,400.	50.		ug/l	1
	The reported concentration of TPH-GRO does not include MTBE or other gasoline constituents eluting prior to the C6 (n-hexane) TPH-GRO range start time.						
05553	TPH - DRO CA LUFT (Waters)	n.a.	4,300.	240.		ug/l	10
	According to the California LUFT Protocol, the quantitation for Diesel Range Organics was performed by peak area comparison of the sample pattern to that of our #2 fuel oil reference standard (between C10 and C28 normal hydrocarbons).						
01594	BTEX+5 Oxygenates+EDC+EDB+ETOH						
01587	Ethanol	64-17-5	N.D.	250.		ug/l	5
02010	Methyl Tertiary Butyl Ether	1634-04-4	3,200.	13.		ug/l	25
05401	Benzene	71-43-2	28.	3.		ug/l	5
05407	Toluene	108-88-3	5.	3.		ug/l	5
05415	Ethylbenzene	100-41-4	10.	3.		ug/l	5
06310	Xylene (Total)	1330-20-7	3.	3.		ug/l	5
	The reporting limits for the GC/MS volatile compounds were raised because sample dilution was necessary to bring target compounds into the calibration range of the system.						

State of California Lab Certification No. 2116

Laboratory Chronicle

CAT No.	Analysis Name	Method	Trial#	Analysis		Analyst	Dilution Factor
				Date	Time		
01728	TPH-GRO - Waters	N. CA LUFT Gasoline Method	1	03/12/2004	01:05	Martha L Seidel	1
05553	TPH - DRO CA LUFT (Waters)	CALUFT-DRO/8015B, Modified	1	03/16/2004	10:02	Tracy A Cole	10
01594	BTEX+5 Oxygenates+EDC+EDB+ETOH	SW-846 8260B	1	03/18/2004	13:49	Carrie J McCullough	5
01594	BTEX+5 Oxygenates+EDC+EDB+ETOH	SW-846 8260B	1	03/18/2004	14:16	Carrie J McCullough	25
01146	GC VOA Water Prep	SW-846 5030B	1	03/12/2004	01:05	Martha L Seidel	n.a.
01163	GC/MS VOA Water Prep	SW-846 5030B	1	03/18/2004	13:49	Carrie J McCullough	n.a.
02135	Extraction - DRO Water Special	TPH by CA LUFT	1	03/11/2004	17:00	JoElla L Rice	1

Lancaster Laboratories Sample No. **WW 4231379**

 MW-5-W-040309 Grab Water
 Facility# 90121 Job# 386462 GRD
 3026 L Shore Ave Oakland T0600100328 MW-5
 Collected: 03/09/2004 09:55 by HK

Account Number: 10904

 Submitted: 03/10/2004 09:20
 Reported: 03/21/2004 at 09:04
 Discard: 04/21/2004

 ChevronTexaco
 6001 Bollinger Canyon Rd L4310
 San Ramon CA 94583

5LSAC

CAT No.	Analysis Name	CAS Number	As Received Result	As Received Method Detection Limit	Units	Dilution Factor
01728	TPH-GRO - Waters	n.a.	N.D.	50.	ug/l	1
The reported concentration of TPH-GRO does not include MTBE or other gasoline constituents eluting prior to the C6 (n-hexane) TPH-GRO range start time.						
05553	TPH - DRO CA LUFT (Waters)	n.a.	110.	50.	ug/l	1
According to the California LUFT Protocol, the quantitation for Diesel Range Organics was performed by peak area comparison of the sample pattern to that of our #2 fuel oil reference standard (between C10 and C28 normal hydrocarbons).						
01594	BTEX+5 Oxygenates+EDC+EDB+ETOH					
01587	Ethanol	64-17-5	N.D.	50.	ug/l	1
02010	Methyl Tertiary Butyl Ether	1634-04-4	4.	0.5	ug/l	1
05401	Benzene	71-43-2	N.D.	0.5	ug/l	1
05407	Toluene	108-88-3	N.D.	0.5	ug/l	1
05415	Ethylbenzene	100-41-4	N.D.	0.5	ug/l	1
06310	Xylene (Total)	1330-20-7	N.D.	0.5	ug/l	1

State of California Lab Certification No. 2116

Laboratory Chronicle

CAT No.	Analysis Name	Method	Analysis		Analyst	Dilution Factor
			Trial#	Date and Time		
01728	TPH-GRO - Waters	N. CA LUFT Gasoline Method	1	03/12/2004 03:19	Martha L Seidel	1
05553	TPH - DRO CA LUFT (Waters)	CALUFT-DRO/8015B, Modified	1	03/16/2004 06:15	Tracy A Cole	1
01594	BTEX+5 Oxygenates+EDC+EDB+ETOH	SW-846 8260B	1	03/18/2004 12:03	Carrie J McCullough	1
01146	GC VOA Water Prep	SW-846 5030B	1	03/12/2004 03:19	Martha L Seidel	n.a.
01163	GC/MS VOA Water Prep	SW-846 5030B	1	03/18/2004 12:03	Carrie J McCullough	n.a.
02135	Extraction - DRO Water Special	TPH by CA LUFT	1	03/11/2004 17:00	JoElla L Rice	1

Lancaster Laboratories Sample No. WW 4231380

 MW-6-W-040309 Grab Water
 Facility# 90121 Job# 386462 GRD
 3026 L Shore Ave Oakland T0600100328 MW-6
 Collected: 03/09/2004 14:15 by HK

Account Number: 10904

 Submitted: 03/10/2004 09:20
 Reported: 03/21/2004 at 09:04
 Discard: 04/21/2004

 ChevronTexaco
 6001 Bollinger Canyon Rd L4310
 San Ramon CA 94583

6LSAC

CAT No.	Analysis Name	CAS Number	As Received Result	As Received Method Detection Limit	Units	Dilution Factor
01728	TPH-GRO - Waters	n.a.	N.D.	50.	ug/l	1
	The reported concentration of TPH-GRO does not include MTBE or other gasoline constituents eluting prior to the C6 (n-hexane) TPH-GRO range start time.					
05553	TPH - DRO CA LUFT (Waters)	n.a.	1,500.	260.	ug/l	10
	According to the California LUFT Protocol, the quantitation for Diesel Range Organics was performed by peak area comparison of the sample pattern to that of our #2 fuel oil reference standard (between C10 and C28 normal hydrocarbons).					
01594	BTEX+5 Oxygenates+EDC+EDB+ETOH					
01587	Ethanol	64-17-5	N.D.	50.	ug/l	1
02010	Methyl Tertiary Butyl Ether	1634-04-4	N.D.	0.5	ug/l	1
05401	Benzene	71-43-2	N.D.	0.5	ug/l	1
05407	Toluene	108-88-3	N.D.	0.5	ug/l	1
05415	Ethylbenzene	100-41-4	N.D.	0.5	ug/l	1
06310	Xylene (Total)	1330-20-7	N.D.	0.5	ug/l	1

State of California Lab Certification No. 2116

Laboratory Chronicle

CAT No.	Analysis Name	Method	Trial#	Analysis Date and Time	Analyst	Dilution Factor
01728	TPH-GRO - Waters	N. CA LUFT Gasoline Method	1	03/12/2004 03:53	Martha L Seidel	1
05553	TPH - DRO CA LUFT (Waters)	CALUFT-DRO/8015B, Modified	1	03/16/2004 10:24	Tracy A Cole	10
01594	BTEX+5 Oxygenates+EDC+EDB+ETOH	SW-846 8260B	1	03/18/2004 12:30	Carrie J McCullough	1
01146	GC VOA Water Prep	SW-846 5030B	1	03/12/2004 03:53	Martha L Seidel	n.a.
01163	GC/MS VOA Water Prep	SW-846 5030B	1	03/18/2004 12:30	Carrie J McCullough	n.a.
02135	Extraction - DRO Water Special	TPH by CA LUFT	1	03/11/2004 17:00	JoElla L Rice	1

Lancaster Laboratories Sample No. WW 4231381

 MW-7-W-040309 Grab Water
 Facility# 90121 Job# 386462 GRD
 3026 L Shore Ave Oakland T0600100328 MW-7
 Collected: 03/09/2004 08:50 by HK

Account Number: 10904

 Submitted: 03/10/2004 09:20
 Reported: 03/21/2004 at 09:04
 Discard: 04/21/2004

 ChevronTexaco
 6001 Bollinger Canyon Rd L4310
 San Ramon CA 94583

7LSAC

CAT No.	Analysis Name	CAS Number	As Received Result	As Received Method Detection Limit	Units	Dilution Factor
01728	TPH-GRO - Waters	n.a.	N.D.	50.	ug/l	1
	The reported concentration of TPH-GRO does not include MTBE or other gasoline constituents eluting prior to the C6 (n-hexane) TPH-GRO range start time.					
05553	TPH - DRO CA LUFT (Waters)	n.a.	230.	50.	ug/l	1
	According to the California LUFT Protocol, the quantitation for Diesel Range Organics was performed by peak area comparison of the sample pattern to that of our #2 fuel oil reference standard (between C10 and C28 normal hydrocarbons).					
01594	BTEX+5 Oxygenates+EDC+EDB+ETOH					
01587	Ethanol	64-17-5	N.D.	50.	ug/l	1
02010	Methyl Tertiary Butyl Ether	1634-04-4	N.D.	0.5	ug/l	1
05401	Benzene	71-43-2	N.D.	0.5	ug/l	1
05407	Toluene	108-88-3	N.D.	0.5	ug/l	1
05415	Ethylbenzene	100-41-4	N.D.	0.5	ug/l	1
06310	Xylene (Total)	1330-20-7	N.D.	0.5	ug/l	1

State of California Lab Certification No. 2116

Laboratory Chronicle

CAT No.	Analysis Name	Method	Trial#	Analysis Date and Time	Analyst	Dilution Factor
01728	TPH-GRO - Waters	N. CA LUFT Gasoline Method	1	03/12/2004 04:28	Linda C Pape	1
05553	TPH - DRO CA LUFT (Waters)	CALUFT-DRO/8015B, Modified	1	03/16/2004 06:38	Tracy A Cole	1
01594	BTEX+5 Oxygenates+EDC+EDB+ETOH	SW-846 8260B	1	03/18/2004 14:42	Carrie J McCullough	1
01146	GC VOA Water Prep	SW-846 5030B	1	03/12/2004 04:28	Linda C Pape	n.a.
01163	GC/MS VOA Water Prep	SW-846 5030B	1	03/18/2004 14:42	Carrie J McCullough	n.a.
02135	Extraction - DRO Water Special	TPH by CA LUFT	1	03/11/2004 17:00	JoElla L Rice	1

Lancaster Laboratories Sample No. WW 4231382

 MW-8-W-040309 Grab Water GRD
 Facility# 90121 Job# 386462
 3026 L Shore Ave Oakland T0600100328 MW-8
 Collected: 03/09/2004 09:20 by HK

Account Number: 10904

 Submitted: 03/10/2004 09:20
 Reported: 03/21/2004 at 09:04
 Discard: 04/21/2004

 ChevronTexaco
 6001 Bollinger Canyon Rd L4310
 San Ramon CA 94583

8LSAC

CAT No.	Analysis Name	CAS Number	As Received Result	As Received Method Detection Limit	Units	Dilution Factor
01728	TPH-GRO - Waters	n.a.	N.D.	50.	ug/l	1
	The reported concentration of TPH-GRO does not include MTBE or other gasoline constituents eluting prior to the C6 (n-hexane) TPH-GRO range start time.					
05553	TPH - DRO CA LUFT (Waters)	n.a.	300.	50.	ug/l	1
	According to the California LUFT Protocol, the quantitation for Diesel Range Organics was performed by peak area comparison of the sample pattern to that of our #2 fuel oil reference standard (between C10 and C28 normal hydrocarbons).					
01594	BTEX+5 Oxygenates+EDC+EDB+ETOH					
01587	Ethanol	64-17-5	N.D.	50.	ug/l	1
02010	Methyl Tertiary Butyl Ether	1634-04-4	3.	0.5	ug/l	1
05401	Benzene	71-43-2	N.D.	0.5	ug/l	1
05407	Toluene	108-88-3	N.D.	0.5	ug/l	1
05415	Ethylbenzene	100-41-4	N.D.	0.5	ug/l	1
06310	Xylene (Total)	1330-20-7	N.D.	0.5	ug/l	1

State of California Lab Certification No. 2116

Laboratory Chronicle

CAT No.	Analysis Name	Method	Trial#	Analysis Date and Time	Analyst	Dilution Factor
01728	TPH-GRO - Waters	N. CA LUFT Gasoline Method	1	03/12/2004 05:03	Linda C Pape	1
05553	TPH - DRO CA LUFT (Waters)	CALUFT-DRO/8015B, Modified	1	03/16/2004 07:00	Tracy A Cole	1
01594	BTEX+5 Oxygenates+EDC+EDB+ETOH	SW-846 8260B	1	03/18/2004 15:09	Carrie J McCullough	1
01146	GC VOA Water Prep	SW-846 5030B	1	03/12/2004 05:03	Linda C Pape	n.a.
01163	GC/MS VOA Water Prep	SW-846 5030B	1	03/18/2004 15:09	Carrie J McCullough	n.a.
02135	Extraction - DRO Water Special	TPH by CA LUFT	1	03/11/2004 17:00	JoElla L Rice	1

Lancaster Laboratories Sample No. **WW 4231383**

 MW-9-W-040309 **Grab Water**
 Facility# 90121 Job# 386462 **GRD**
 3026 L Shore Ave Oakland T0600100328 MW-9
 Collected: 03/09/2004 12:40 by HK

Account Number: 10904

 Submitted: 03/10/2004 09:20
 Reported: 03/21/2004 at 09:04
 Discard: 04/21/2004

 ChevronTexaco
 6001 Bollinger Canyon Rd L4310
 San Ramon CA 94583

9LSAC

CAT No.	Analysis Name	CAS Number	As Received Result	As Received Method Detection Limit	Units	Dilution Factor
01728	TPH-GRO - Waters	n.a.	3,700.	50.	ug/l	1
	The reported concentration of TPH-GRO does not include MTBE or other gasoline constituents eluting prior to the C6 (n-hexane) TPH-GRO range start time. Due to the nature of the sample matrix, the surrogate standard recovery is above the range of specifications.					
05553	TPH - DRO CA LUFT (Waters)	n.a.	2,500.	130.	ug/l	5
	According to the California LUFT Protocol, the quantitation for Diesel Range Organics was performed by peak area comparison of the sample pattern to that of our #2 fuel oil reference standard (between C10 and C28 normal hydrocarbons).					
01594	BTEX+5 Oxygenates+EDC+EDB+ETOH					
01587	Ethanol	64-17-5	N.D.	50.	ug/l	1
02010	Methyl Tertiary Butyl Ether	1634-04-4	120.	0.5	ug/l	1
05401	Benzene	71-43-2	2.	0.5	ug/l	1
05407	Toluene	108-88-3	1.	0.5	ug/l	1
05415	Ethylbenzene	100-41-4	2.	0.5	ug/l	1
06310	Xylene (Total)	1330-20-7	2.	0.5	ug/l	1

State of California Lab Certification No. 2116

Laboratory Chronicle

CAT No.	Analysis Name	Method	Analysis		Analyst	Dilution Factor
			Trial#	Date and Time		
01728	TPH-GRO - Waters	N. CA LUFT Gasoline Method	1	03/12/2004 05:38	Linda C Pape	1
05553	TPH - DRO CA LUFT (Waters)	CALUFT-DRO/8015B, Modified	1	03/16/2004 10:46	Tracy A Cole	5
01594	BTEX+5 Oxygenates+EDC+EDB+ETOH	SW-846 8260B	1	03/18/2004 15:35	Carrie J McCullough	1
01146	GC VOA Water Prep	SW-846 5030B	1	03/12/2004 05:38	Linda C Pape	n.a.
01163	GC/MS VOA Water Prep	SW-846 5030B	1	03/18/2004 15:35	Carrie J McCullough	n.a.
02135	Extraction - DRO Water Special	TPH by CA LUFT	1	03/11/2004 17:00	JoElla L Rice	1

Quality Control Summary

 Client Name: ChevronTexaco
 Reported: 03/21/04 at 09:04 AM

Group Number: 887688

Matrix QC may not be reported if site-specific QC samples were not submitted. In these situations, to demonstrate precision and accuracy at a batch level, a LCS/LCSD was performed, unless otherwise specified in the method.

Laboratory Compliance Quality Control

Analysis Name	Blank Result	Blank MDL	Report Units	LCS %REC	LCSD %REC	LCS/LCSD Limits	RPD	RPD Max
Batch number: 040710006A TPH - DRO CA LUFT (Waters)	N.D.	25.	ug/l	91	93	61-126	1	20
Batch number: 04071A56A TPH-GRO - Waters	N.D.	50.	ug/l	128	103	70-130	22	30
Batch number: 04072A08C TPH-GRO - Waters	N.D.	50.	ug/l	116	119	70-130	3	30
Batch number: P040754AA Methyl Tertiary Butyl Ether	N.D.	0.5	ug/l	98		77-127		
Benzene	N.D.	0.5	ug/l	98		85-117		
Toluene	N.D.	0.5	ug/l	101		85-115		
Ethylbenzene	N.D.	0.5	ug/l	98		82-119		
Xylene (Total)	N.D.	0.5	ug/l	100		84-120		
Batch number: P040774AA Ethanol	N.D.	50.	ug/l	81		46-145		
Methyl Tertiary Butyl Ether	N.D.	0.5	ug/l	99		77-127		
Benzene	N.D.	0.5	ug/l	97		85-117		
Toluene	N.D.	0.5	ug/l	97		85-115		
Ethylbenzene	N.D.	0.5	ug/l	97		82-119		
Xylene (Total)	N.D.	0.5	ug/l	98		84-120		
Batch number: P040782AA Ethanol	N.D.	50.	ug/l	89		46-145		
Methyl Tertiary Butyl Ether	N.D.	0.5	ug/l	97		77-127		
Benzene	N.D.	0.5	ug/l	98		85-117		
Toluene	N.D.	0.5	ug/l	96		85-115		
Ethylbenzene	N.D.	0.5	ug/l	97		82-119		
Xylene (Total)	N.D.	0.5	ug/l	98		84-120		

Sample Matrix Quality Control

Analysis Name	MS %REC	MSD %REC	MS/MSD Limits	RPD	BKG MAX	DUP CONC	DUP RPD	Dup RPD Max
Batch number: 04071A56A TPH-GRO - Waters	108		63-154					
Batch number: 04072A08C TPH-GRO - Waters	135		63-154					

*- Outside of specification

- (1) The result for one or both determinations was less than five times the LOQ.
- (2) The background result was more than four times the spike added.

Quality Control Summary

Client Name: ChevronTexaco
Reported: 03/21/04 at 09:04 AM

Group Number: 887688

Sample Matrix Quality Control

Analysis Name	MS	MSD	MS/MSD	RPD	BKG	DUP	DUP	Dup
	%REC	%REC	Limits	RPD	MAX	Conc	RPD	RPD Max
Batch number: P040754AA	Sample number(s): 4231374							
Methyl Tertiary Butyl Ether	103	102	69-134	1	30			
Benzene	107	107	83-128	0	30			
Toluene	104	106	83-127	1	30			
Ethylbenzene	106	106	82-129	0	30			
Xylene (Total)	105	107	82-130	1	30			
Batch number: P040774AA	Sample number(s): 4231375-4231377							
Ethanol	84	87	41-155	4	30			
Methyl Tertiary Butyl Ether	102	101	69-134	1	30			
Benzene	109	106	83-128	2	30			
Toluene	106	103	83-127	3	30			
Ethylbenzene	107	105	82-129	2	30			
Xylene (Total)	106	105	82-130	1	30			
Batch number: P040782AA	Sample number(s): 4231378-4231383							
Ethanol	81	93	41-155	13	30			
Methyl Tertiary Butyl Ether	98	99	69-134	1	30			
Benzene	102	106	83-128	4	30			
Toluene	102	104	83-127	3	30			
Ethylbenzene	104	106	82-129	2	30			
Xylene (Total)	103	106	82-130	2	30			

Surrogate Quality Control

Analysis Name: TPH - DRO CA LUFT (Waters)
Batch number: 040710006A
Orthoterphenyl

4231375	100
4231376	99
4231377	97
4231378	84
4231379	95
4231380	94
4231381	90
4231382	94
4231383	102
Blank	92
LCS	114
LCSD	115

Limits: 57-128

Analysis Name: TPH-GRO - Waters
Batch number: 04071A56A
Trifluorotoluene-F

4231375	145
4231376	149*
4231377	107

*- Outside of specification

- (1) The result for one or both determinations was less than five times the LOQ.
- (2) The background result was more than four times the spike added.

Quality Control Summary

 Client Name: ChevronTexaco
 Reported: 03/21/04 at 09:04 AM

Group Number: 887688

Surrogate Quality Control

4231378	133
4231379	106
4231380	104
4231381	106
4231382	105
4231383	180*
Blank	106
LCS	119
LCSD	116
MS	112

Limits: 57-146

 Analysis Name: TPH-GRO - Waters
 Batch number: 04072A08C
 Trifluorotoluene-F

4231374	112
Blank	106
LCS	112
LCSD	116
MS	140

Limits: 57-146

 Analysis Name: BTEX+MTBE by 8260B
 Batch number: P040754AA

	Dibromofluoromethane	1,2-Dichloroethane-d4	Toluene-d8	4-Bromofluorobenzene
4231374	100	97	95	94
Blank	99	97	98	95
LCS	99	96	99	96
MS	102	99	97	95
MSD	101	97	97	95

Limits: 81-120 82-112 85-112 83-113

 Analysis Name: BTEX+5 Oxygenates+EDC+EDB+ETOH
 Batch number: P040774AA

	Dibromofluoromethane	1,2-Dichloroethane-d4	Toluene-d8	4-Bromofluorobenzene
4231375	100	99	97	97
4231376	100	99	98	97
4231377	100	99	98	96
Blank	100	98	98	96
LCS	99	97	98	96
MS	101	98	97	96
MSD	100	99	97	96

Limits: 81-120 82-112 85-112 83-113

 Analysis Name: BTEX+5 Oxygenates+EDC+EDB+ETOH
 Batch number: P040782AA

	Dibromofluoromethane	1,2-Dichloroethane-d4	Toluene-d8	4-Bromofluorobenzene
4231378	100	99	96	97
4231379	99	98	97	95
4231380	100	97	97	96
4231381	100	99	97	96

*- Outside of specification

- (1) The result for one or both determinations was less than five times the LOQ.
- (2) The background result was more than four times the spike added.

Quality Control Summary

Client Name: ChevronTexaco
Reported: 03/21/04 at 09:04 AM

Group Number: 887688

Surrogate Quality Control

4231382	100	97	96	95
4231383	101	99	97	98
Blank	100	98	97	95
LCS	101	98	98	95
MS	101	97	98	96
MSD	101	97	97	96
<hr/>				
Limits:	81-120	82-112	85-112	83-113

*- Outside of specification

- (1) The result for one or both determinations was less than five times the LOQ.
- (2) The background result was more than four times the spike added.