

Environmental Management
Company
6001 Bollinger Canyon Rd, L4050
P.O. Box 6012
San Ramon, CA 94583-2324
Tel 925-842-1589
Fax 925-842-8370

Karen Streich
Project Manager

RO 284

January 29, ^{JCH} 200~~3~~

ChevronTexaco

Alameda County Health Care Services
1131 Harbor Bay Parkway, Suite 250
Alameda, CA 94502-6577

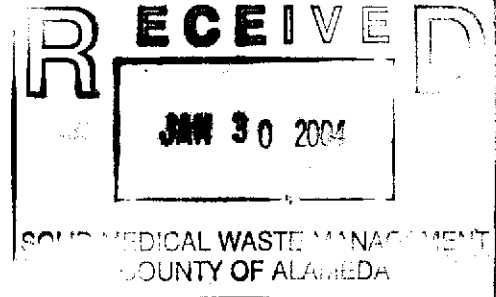

Re: Chevron Service Station # 9-0121

Address: 3026 Lakeshore Avenue, Oakland, California

January 14, 2004

I have reviewed the attached routine groundwater monitoring report dated _____.

I agree with the conclusions and recommendations presented in the referenced report. The information in this report is accurate to the best of my knowledge and all local Agency/Regional Board guidelines have been followed. This report was prepared by Gettler-Ryan, Inc., upon whose assistance and advice I have relied.

This letter is submitted pursuant to the requirements of California Water Code Section 13267(b)(1) and the regulating implementation entitled Appendix A pertaining thereto.

I declare under penalty of perjury that the foregoing is true and correct.

Sincerely,

Karen Streich
Project Manager

Enclosure: Report

2/8/03
MW2A
6,500 mtbe

RECEIVED
MAY 19 1964

RO 284
DH



GETTLER-RYAN INC.

TRANSMITTAL

January 14, 2004
G-R #386462

TO: Mr. Robert Foss
Cambria Environmental Technology, Inc.
5900 Hollis Street, Suite A
Emeryville, CA 94608

CC: Ms. Karen Streich
Chevron Products Company
P.O. Box 6004
San Ramon, California 94583

FROM: Deanna L. Harding
Project Coordinator
Gettler-Ryan Inc.
6747 Sierra Court, Suite J
Dublin, California 94568

RE: **Chevron Service Station**
#9-0121
3026 Lakeshore Avenue
Oakland, California

WE HAVE ENCLOSED THE FOLLOWING:

COPIES	DATED	DESCRIPTION
1	January 12, 2004	Groundwater Monitoring and Sampling Report Fourth Quarter - Event of December 8, 2003

COMMENTS:

Please provide any comments/changes and propose any groundwater monitoring modifications for the next event prior to **January 28, 2004**, at which time the final report will be distributed to the following:

cc: Ms. Eva Chu, Alameda County Health Care Services, Dept. of Environmental Health, 1131 Harbor Bay Parkway, Suite 250, Alameda, CA 94502-6577

Enclosures

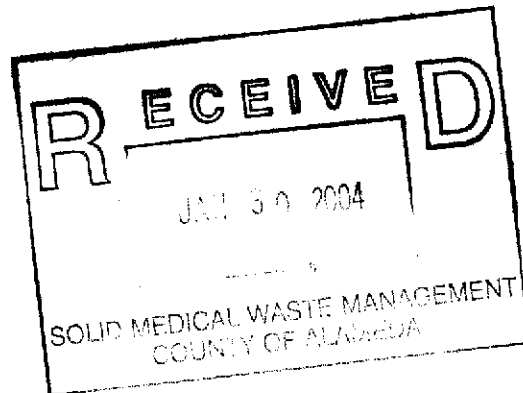

trans/9-0121-KS



GETTLER-RYAN INC.

January 12, 2004
G-R Job #386462

Ms. Karen Streich
Chevron Products Company
P.O. Box 6004
San Ramon, CA 94583

RE: Fourth Quarter Event of December 8, 2003
Groundwater Monitoring & Sampling Report
Chevron Service Station #9-0121
3026 Lakeshore Avenue
Oakland, California

Dear Ms. Streich:

This report documents the most recent groundwater monitoring and sampling event performed by Gettler-Ryan Inc. (G-R) at the referenced site. All field work was conducted in accordance with G-R Standard Operating Procedure - Groundwater Sampling (attached).

Static groundwater levels were measured and the wells were checked for the presence of separate-phase hydrocarbons. Static water level data, groundwater elevations, and separate-phase hydrocarbon thickness (if any) are presented in the attached Table 1. A Potentiometric Map is included as Figure 1. Dissolved Oxygen concentrations are presented in Table 2.

Groundwater samples were collected from the monitoring wells and submitted to a state certified laboratory for analyses. The field data sheets for this event are attached. Analytical results are presented in the table(s) listed below. The chain of custody document and laboratory analytical report are also attached.

Please call if you have any questions or comments regarding this report. Thank you.

Sincerely,

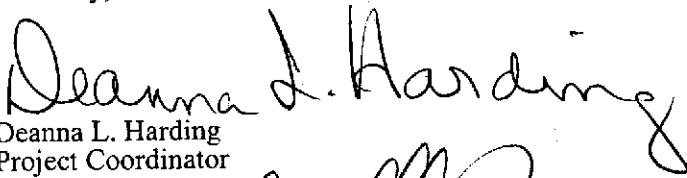

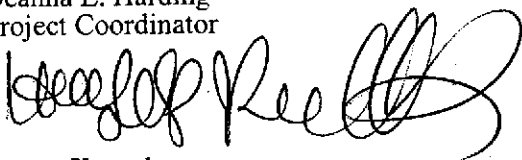
Deanna L. Harding
Project Coordinator



Hagop Kevork
P.E. No. C55734

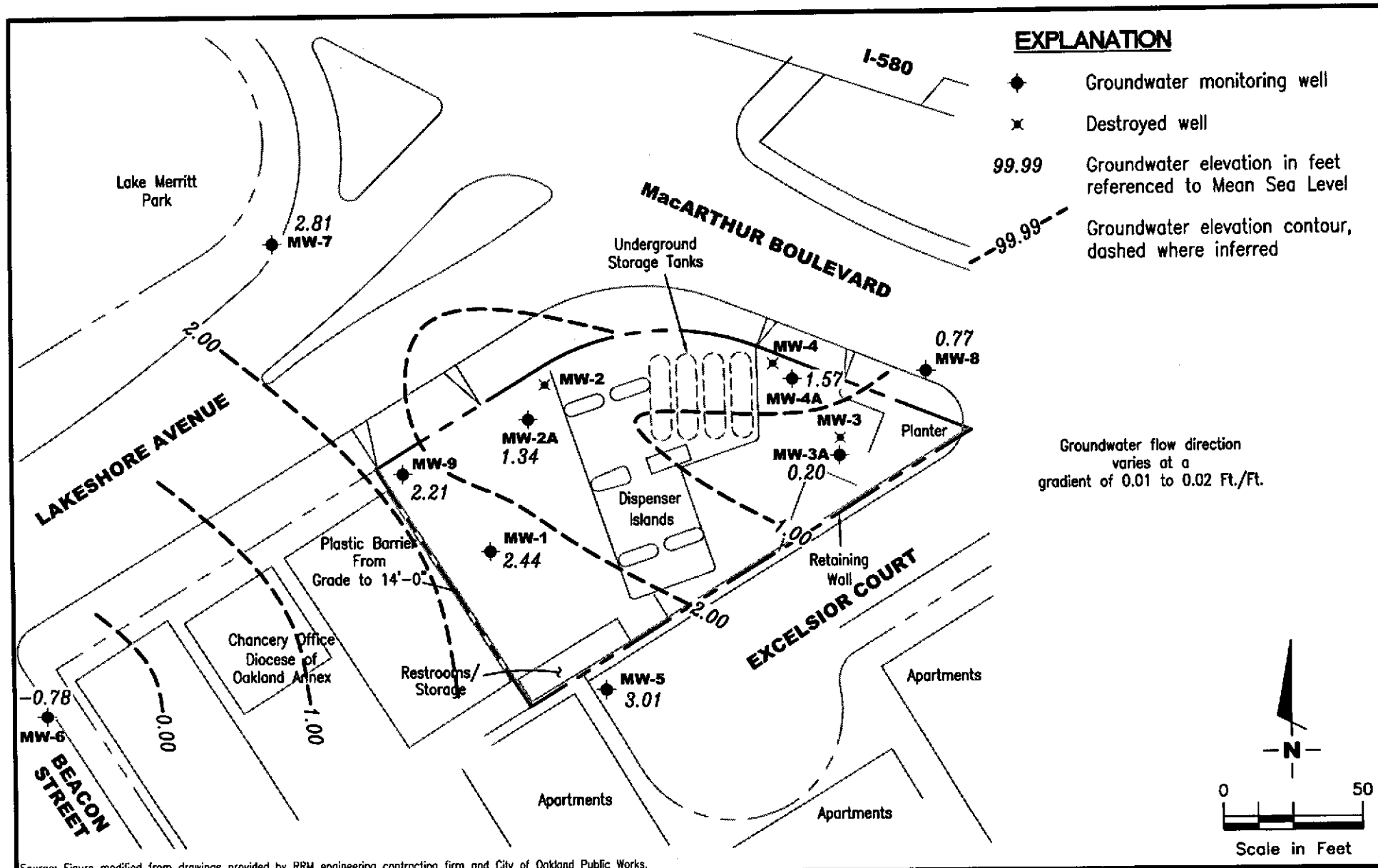

Figure 1: Potentiometric Map
Table 1: Groundwater Monitoring Data and Analytical Results
Table 2: Dissolved Oxygen Concentrations
Table 3: Groundwater Analytical Results
Attachments: Standard Operating Procedure - Groundwater Sampling
Field Data Sheets
Chain of Custody Document and Laboratory Analytical Reports



Source: Figure modified from drawings provided by RRM engineering contracting firm and City of Oakland Public Works.

GETTLER - RYAN INC.
 6747 Sierra Ct., Suite J
 Dublin, CA 94568 (925) 551-7555

POTENTIOMETRIC MAP
 Chevron Service Station #9-0121
 3026 Lakeshore Avenue
 Oakland, California

FIGURE
1

PROJECT NUMBER 386462	REVIEWED BY	DATE December 8, 2003	REVISED DATE
--------------------------	-------------	--------------------------	--------------

Table 1
Groundwater Monitoring Data and Analytical Results
Chevron Service Station #9-0121
3026 Lakeshore Avenue
Oakland, California

WELL ID/ DATE	TOC (ft.)	GWE (msl)	DTW (ft.)	SPHT (ft.)	SPH REMOVED (gallons)	TPH-D (ppb)	TPH-G (ppb)	B (ppb)	T (ppb)	E (ppb)	X (ppb)	MTBE (ppb)	TDS (ppb)
MW-1													
08/20/91	6.82	1.62	5.20	--	--	260	5,100	1,700	21	220	34	--	--
09/30/91	6.82	1.15	5.67	Sheen	--	--	--	--	--	--	--	--	--
10/28/91	6.82	1.50	5.30	0.03	--	--	--	--	--	--	--	--	--
01/08/92	6.82	1.67	5.15	Sheen	--	4,400	5,400	770	13	95	31	--	--
01/13/92	6.82	--	--	--	--	--	--	--	--	--	--	--	--
06/23/92	6.89	1.48	5.41	--	--	2,000	7,700	1,500	40	230	100	--	--
08/24/92	6.89	1.12	5.77	--	--	--	--	--	--	--	--	--	--
09/21/92	6.89	1.00	5.89	--	--	<50	3,500	1,700	28	190	78	--	--
10/26/92	6.89	0.95	5.94	--	--	--	--	--	--	--	--	--	--
12/23/92	6.89	2.18	4.71	--	--	5,500	60,000	7,100	240	2,000	1,300	--	--
01/08/93	6.89	--	--	--	--	--	--	--	--	--	--	--	--
03/25/93	6.89	2.17	4.72	--	--	<10	530	1,100	41	67	79	--	--
06/11/93	6.89	5.37	5.07	--	--	--	7,000	1,900	33	120	69	9,600	840
09/29/93	6.89	1.13	5.76	--	--	<10	6,600	1,600	28	43	74	--	--
12/20/93	6.89	1.74	5.15	--	--	<10	6,300	1,900	36	82	65	--	--
03/07/94	6.89	2.21	4.68	--	--	<10	7,700	1,100	55	66	38	12,000	--
06/17/94	6.89	1.83	5.06	--	--	2,200	4,300	710	12	90	38	--	--
09/12/94	6.89	1.24	5.65	--	--	2,500	6,400	1,500	<25	180	<25	12,000	--
11/30/94	6.89	2.32	4.57	--	--	2,300 ¹	4,900	690	26	97	60	3,900	--
03/24/95	6.89	3.91	2.98	--	--	1,400 ²	1,800	160	7.3	11	14	1,300	--
06/27/95	6.89	1.87	5.02	--	--	2,300 ²	4,600	1,300	11	97	13	5,100	--
09/28/95	6.89	1.59	5.30	--	--	3,900 ²	6,600	1,500	<20	<20	<20	5,800	--
12/19/95	6.89	2.21	4.68	--	--	2,600 ²	3,800	930	<10	100	<10	6,300	--
02/28/96	6.89	3.27	3.62	--	--	1,800 ²	3,600	280	<5.0	18	5.5	2,200	--
06/25/96	6.89	1.87	5.02	--	--	3,000	4,700	1,600	36	150	31	3,000	--
12/17/96	6.89	2.23	4.66	--	--	2,700 ³	7,800	1,000	28	340	63	1,200	--
03/31/97	6.89	2.01	4.88	--	--	2,200 ²	5,300	590	55	210	53	950	--
06/30/97	6.89	1.32	5.57	--	--	2,200 ²	4,400	350	<10	<10	11	580	--
09/12/97	6.89	1.56	5.33	--	--	2,300 ²	3,400	220	9.5	15	11	460	--
12/05/97	6.89	2.44	4.45	--	--	1,900 ²	4,700	870	21	120	18	750	--
02/16/98	6.89	3.52	3.37	--	--	1,600 ²	4,400	120	12	11	7.7	270	--
06/17/98	6.89	2.24	4.65	--	--	1,300 ²	7,800	<25	50	34	650	650	--

Table 1
Groundwater Monitoring Data and Analytical Results
Chevron Service Station #9-0121
3026 Lakeshore Avenue
Oakland, California

WELL ID/ DATE	TOC (ft.)	GWE (msl)	DTW (ft.)	SPHT (ft.)	SPH REMOVED (gallons)	TPH-D (ppb)	TPH-G (ppb)	B (ppb)	T (ppb)	E (ppb)	X (ppb)	MTBE (ppb)	TDS (ppb)
MW-1 (cont)													
08/31/98	6.89	1.70	5.19	--	--	2,400 ²	3,700	620	17	120	31	380	--
12/28/98	6.89	1.94	4.95	--	--	1,500 ²	3,800	250	14	28	15	330	--
03/04/99	6.89	3.24	3.65	--	--	1,070 ²	1,560	17.9	<0.5	4.17	1.05	70.4	--
06/14/99	6.89	1.89	5.00	--	--	2,500 ²	<10,000	820	240	320	640	<500	--
09/17/99	6.89	0.30	6.59	--	--	2,110 ²	3,300	141	12.3	<10	<10	238	--
12/20/99	6.89	1.92	4.97	--	--	1,840 ²	2,990	218	16.3	20	<10	232	--
03/20/00	6.89	3.11	3.78	--	--	938 ²	1,340	20	3.07	1.87	1.87	29.1	--
06/24/00 ⁵	6.89	2.45	4.44	0.00	0.00	1,680 ⁹	1,500 ⁷	12	5.3	<2.5	7.9	190	--
09/07/00 ⁵	6.89	1.74	5.15	0.00	0.00	1,500 ⁹	3,100 ⁷	190	13	14	<10	210	--
12/05/00 ⁵	6.89	2.16	4.73	0.00	0.00	970 ¹³	2,140 ¹⁴	248	<5.00	20.5	<5.00	<25.0	--
03/01/01 ⁵	6.89	3.33	3.56	0.00	0.00	610 ⁹	1,000 ⁷	21	<10	<10	<10	280	--
06/04/01 ⁵	6.89	2.13	4.76	0.00	0.00	1,100 ⁹	2,800 ⁷	310	23	11	15	470	--
09/10/01 ⁵	6.89	1.28	5.61	0.00	0.00	2,600	2,500 ¹⁶	<20	26	<20	<20	310	--
12/03/01 ⁵	6.89	3.31	3.58	0.00	0.00	2,700	2,400	30	7.3	7.0	6.5	160	--
03/04/02 ⁵	6.89	2.36	4.53	0.00	0.00	2,700	3,300	120	17	22	9.0	110	--
05/30/02 ⁵	6.89	2.41	4.48	0.00	0.00	2,700	4,100	110	9.3	22	11	100	--
09/03/02 ⁵	6.89	1.42	5.47	0.00	0.00	2,900	3,700	<5.0	7.8	3.2	10	130	--
12/09/02 ⁵	6.89	1.61	5.28	0.00	0.00	3,000	2,900	35	5.1	5.5	8.3	170	--
03/10/03 ⁵	6.89	2.50	4.39	0.00	0.00	1,600	3,000	42	5.0	8.2	8.7	110	--
06/09/03 ^{5,18}	6.89	2.53	4.36	0.00	0.00	2,000	5,200	140	16	20	15	100	--
09/08/03 ^{5,18,19}	6.89	1.52	5.37	0.00	0.00	2,100	3,500	4	10	2	11	200	--
12/08/03 ^{5,18,19}	6.89	2.44	4.45	0.00	0.00	3,400	2,200	8	4	3	8	160	--
MW-2													
08/20/91	6.27	1.92	4.35	--	--	600	9,300	3,700	55	530	75	--	--
09/30/91	6.27	1.28	4.99	--	--	--	3,500	2,600	47	440	68	--	--
10/28/91	6.27	1.36	4.91	--	--	--	4,600	1,800	29	290	53	--	--
01/08/92	6.27	1.63	4.64	Sheen	--	--	14,000	4,300	70	<25	130	--	--
01/13/92	6.27	--	--	--	--	38,000	--	--	--	--	--	--	--
06/23/92	6.27	1.63	4.64	0.02	--	--	--	--	--	--	--	--	--
08/24/92	6.27	1.34	4.94	0.02	--	--	--	--	--	--	--	--	--

Table 1
Groundwater Monitoring Data and Analytical Results
Chevron Service Station #9-0121
3026 Lakeshore Avenue
Oakland, California

WELL ID/ DATE	TOC (ft.)	GWE (msl)	DTW (ft.)	SPHT (ft.)	SPH REMOVED (gallons)	TPH-D (ppb)	TPH-G (ppb)	B (ppb)	T (ppb)	E (ppb)	X (ppb)	MTBE (ppb)	TDS (ppb)
MW-2 (cont)													
09/21/92	6.27	1.20	5.08	0.01	--	--	--	--	--	--	--	--	--
10/26/92	6.27	0.34	5.93	--	--	--	--	--	--	--	--	--	--
12/23/92	6.27	--	--	--	--	160,000	21,000	5,400	59	1,300	160	--	--
01/08/93	6.27	2.57	3.70	--	--	--	--	--	--	--	--	--	--
03/25/93	6.27	2.89	3.38	Sheen	--	--	--	--	--	--	--	--	--
06/11/93	6.27	2.09	4.18	--	--	--	5,900	1,100	23	240	51	--	2,300
09/29/93	6.27	0.07	6.20	--	--	--	--	--	--	--	--	--	--
12/20/93	6.27	1.94	4.35	0.02	--	--	--	--	--	--	--	--	--
03/07/94	6.27	2.60	3.67	--	--	<10	26,000	5,700	170	1,000	150	--	--
06/17/94	6.27	2.25	4.02	Sheen	--	--	--	--	--	--	--	--	--
09/12/94	6.27	1.45	4.83	0.01	--	--	--	--	--	--	--	--	--
11/30/94	6.27	2.27	4.00	--	--	INACCESSIBLE		--	--	--	--	--	--
03/24/95	6.27	2.73	4.01	0.59	--	--	--	--	--	--	--	--	--
06/27/95	6.27	1.71	4.96	0.50	0.013	--	--	--	--	--	--	--	--
09/28/95	6.27	2.62	4.25	0.75	0.013	--	--	--	--	--	--	--	--
12/19/95	6.27	1.99	4.76	0.60	0.010	--	--	--	--	--	--	--	--
02/28/96	6.27	1.99	4.58	0.38	0.008	--	--	--	--	--	--	--	--
06/25/96	6.27	2.36	4.29	0.47	0.030	--	--	--	--	--	--	--	--
12/17/96	6.27	2.22	4.16	0.14	--	--	--	--	--	--	--	--	--
03/31/97	6.27	2.34	4.07	0.18	0.030	--	--	--	--	--	--	--	--
06/30/97	6.27	2.06	4.32	0.14	0.030	--	--	--	--	--	--	--	--
09/12/97	6.27	2.00	4.38	0.14	--	--	--	--	--	--	--	--	--
12/05/97	6.27	2.51	3.78	0.02	--	--	--	--	--	--	--	--	--
02/16/98	6.27	3.08	3.29	0.12	0.007	--	--	--	--	--	--	--	--
06/17/98	6.27	2.35	4.00	0.10	0.010	--	--	--	--	--	--	--	--
08/31/98	6.27	0.65	5.71	0.11	0.008	--	--	--	--	--	--	--	--
12/28/98	6.27	1.75	4.60	0.10	0.005	--	--	--	--	--	--	--	--
03/04/99	6.27	2.58	3.73	0.05	0.200	--	--	--	--	--	--	--	--
DESTROYED													

Table 1
Groundwater Monitoring Data and Analytical Results
Chevron Service Station #9-0121
3026 Lakeshore Avenue
Oakland, California

WELL ID/ DATE	TOC (ft.)	GWE (msl)	DTW (ft.)	SPHT (ft.)	SPH REMOVED (gallons)	TPH-D (ppb)	TPH-G (ppb)	B (ppb)	T (ppb)	E (ppb)	X (ppb)	MTBE (ppb)	TDS (ppb)
MW-2A													
04/19/99	6.53	1.67	4.86	--	--	820 ²	<2,000	<20	<20	<20	<20	9,200	--
06/14/99	6.53	1.23	5.30	--	--	2,000 ²	<5,000	89	<50	66	<50	10,000	--
09/17/99	6.53	0.69	5.84	--	--	1,050 ²	903	42	1.63	22.8	7.74	11,400	--
12/20/99	6.53	-0.07	6.60	--	--	2,820 ²	2,280	115	<10	87.2	27.2	14,000	--
03/20/00	6.53	1.74	4.79	--	--	1,220 ²	1,040	54.3	<5.0	33.8	12.1	10,900 ²	--
06/24/00	6.53	1.28	5.25	0.00	0.00	1,300 ⁹	690 ⁷	50	2.5	18	9.5	15,000 ⁸	--
09/07/00	6.53	1.09	5.44	0.00	0.00	770 ⁹	310 ⁷	6.7	1.4	1.6	3.8	16,000	--
12/05/00	6.53	1.16	5.37	0.00	0.00	810 ¹³	414 ¹⁴	32.4	<0.500	7.49	5.96	8,910 ⁸	--
03/01/01	6.53	2.03	4.50	0.00	0.00	590 ⁹	370 ⁷	30	4.0	12	9.2	8,200	--
06/04/01	6.53	1.36	5.17	0.00	0.00	930 ⁹	<500	19	<5.0	<5.0	<5.0	7,800	--
09/10/01	6.53	0.79	5.74	0.00	0.00	2,400	<5,000	<50	<50	<50	<50	9,700	--
12/03/01	6.53	1.46	5.07	0.00	0.00	2,500	480	4.5	<1.0	1.1	<3.0	10,000	--
03/04/02	6.53	1.52	5.01	0.00	0.00	2,300	630	5.4	1.5	2.9	2.3	7,000	--
05/30/02	6.53	1.66	4.87	0.00	0.00	2,100	520	6.1	<1.0	2.6	5.4	7,100	--
09/03/02	6.53	1.03	5.50	0.00	0.00	2,600	590	7.8	0.98	2.9	7.8	7,800	--
12/09/02	6.53	1.06	5.47	0.00	0.00	1,900	670	7.9	0.88	2.1	5.0	8,300	--
03/10/03	6.53	1.52	5.01	0.00	0.00	1,700	640	8.0	0.76	2.6	4.1	7,500	--
06/09/03 ¹⁸	6.53	1.77	4.76	0.00	0.00	1,900	540	3	<3	<3	<3	6,800	--
09/08/03 ^{18,19}	6.53	1.16	5.37	0.00	0.00	2,000	540	3	0.7	0.7	3	7,000	--
12/08/03 ^{18,21}	6.53	1.34	5.19	0.00	0.00	3,100	480	<5	<5	<5	<5	6,500	--
MW-3													
08/20/91	8.71	0.26	8.45	--	--	200	3,100	200	13	15	12	--	--
09/30/91	8.71	-0.03	8.74	--	--	--	1,000	150	8.3	13	6.7	--	--
10/28/91	8.71	-0.05	8.76	--	--	--	1,200	120	6.7	11	7.5	--	--
01/08/92	8.71	-0.06	8.77	--	--	--	410	120	0.9	4.1	3.4	--	--
01/13/92	8.71	--	--	--	--	220	--	--	--	--	--	--	--
06/23/92	8.71	0.03	8.68	--	--	<50	630	43	0.8	8.2	3.4	--	--
08/24/92	8.71	-0.14	8.85	--	--	--	--	--	--	--	--	--	--
09/21/92	8.71	-0.23	8.94	--	--	<50	1,800	730	1.4	66	39	--	--
10/26/92	8.71	-0.36	9.07	--	--	--	--	--	--	--	--	--	--

Table I
Groundwater Monitoring Data and Analytical Results
Chevron Service Station #9-0121
3026 Lakeshore Avenue
Oakland, California

WELL ID/ DATE	TOC (ft.)	GWE (msl)	DTW (ft.)	SPHT (ft.)	SPH REMOVED (gallons)	TPH-D (ppb)	TPH-G (ppb)	B (ppb)	T (ppb)	E (ppb)	X (ppb)	MTBE (ppb)	TDS (ppb)
MW-3 (cont)													
12/23/92	8.71	--	--	--	--	850	840	270	3.4	15	4.2	--	--
01/08/93	8.71	1.02	7.69	--	--	--	--	--	--	--	--	--	--
03/25/93	8.71	0.97	7.74	--	--	<10	760	270	4.0	10	5.0	--	--
06/11/93	8.71	0.19	8.52	--	--	--	200	32	1.0	5.0	2.0	--	5,600
09/29/93	8.71	2.66	6.05	--	--	--	9,300	2,800	60	270	62	--	--
12/20/93	8.71	-0.12	8.83	--	--	<10	460	250	4.0	8.0	4.0	--	--
03/07/94	8.71	0.64	8.07	--	--	<10	2,400	260	13	35	18	--	--
06/17/94	8.71	0.19	8.52	--	--	<50	1,000	200	4.0	6.6	6.7	--	--
09/12/94	8.71	-0.21	8.92	--	--	<50	360	130	3.4	4.8	3.3	130	--
11/30/94	8.71	0.58	8.13	--	--	INACCESSIBLE		--	--	--	--	--	--
03/24/95	8.71	1.93	6.78	--	--	1,200 ²	4,100	920	<10	23	<10	70	--
06/27/95	8.71	0.49	8.22	--	--	1,000 ²	3,100	640	16	31	<10	<50	--
09/28/95	8.71	-0.14	8.85	--	--	460 ²	490	78	3.4	4.4	2.4	38	--
12/19/95	8.71	0.69	8.02	--	--	650 ²	2,600	580	<10	25	<10	<50	--
02/28/96	8.71	1.16	7.55	--	--	780 ²	1,500	510	<5.0	9.9	<5.0	<25	--
06/25/96	8.71	0.34	8.37	--	--	1,200 ²	1,300	390	7.8	14	6.5	31	--
12/17/96	8.71	0.41	8.30	--	--	1,100 ²	760	85	<1.2	5.9	5.1	<6.2	--
03/31/97	8.71	0.52	8.19	--	--	1,300 ²	2,000	380	12	24	12	<25	--
06/30/97	8.71	0.00	8.71	--	--	620 ²	1,900	340	9.9	23	6.1	<25	--
09/12/97	8.71	1.07	7.64	--	--	400 ²	1,200	200	4.6	14	4.8	3.9	--
12/05/97	8.71	0.46	8.25	--	--	190 ²	460	72	2.7	5.2	1.7	<5.0	--
02/16/98	8.71	1.71	7.00	--	--	1,000 ²	6,200	1,100	20	34	12	<50	--
06/17/98	8.71	0.71	8.00	--	--	1,100 ²	3,000	350	<10	<10	<10	120	--
08/31/98	8.71	0.08	8.63	--	--	790 ²	430	100	2.6	8.6	6.0	<12	--
12/28/98	8.71	-0.02	8.73	--	--	180 ²	1,400	220	<10	12	<10	<50	--
03/04/99	8.71	1.06	7.65	--	--	763 ²	2,880	355	9.15	19	<5.0	<20	--
DESTROYED													

Table 1
Groundwater Monitoring Data and Analytical Results
Chevron Service Station #9-0121
3026 Lakeshore Avenue
Oakland, California

WELL ID/ DATE	TOC (ft.)	GWE (msl)	DTW (ft.)	SPHT (ft.)	SPH REMOVED (gallons)	TPH-D (ppb)	TPH-G (ppb)	B (ppb)	T (ppb)	E (ppb)	X (ppb)	MTBE (ppb)	TDS (ppb)
MW-3A													
04/19/99	8.70	1.00	7.70	--	--	93 ²	<50	<0.5	<0.5	<0.5	<0.5	3.1	--
06/14/99	8.70	0.50	8.20	--	--	160 ²	148	4.55	0.82	0.53	1.1	3.7	--
09/17/99	8.70	-0.02	8.72	--	--	101 ²	169	6.02	0.806	0.515	0.786	4.68	--
12/20/99	8.70	-0.22	8.92	--	--	153 ²	<50	1.82	<0.5	<0.5	<0.5	11	--
03/20/00	8.70	1.06	7.64	--	--	223 ²	140	5.08	0.695	<0.5	<0.5	10.1	--
06/24/00	8.70	0.32	8.38	0.00	0.00	128 ⁹	<50	0.74	<0.50	<0.50	<0.50	34	--
09/07/00	8.70	-0.09	8.79	0.00	0.00	<50	<50	1.4	<0.50	<0.50	<0.50	15	--
12/05/00	8.70	0.02	8.68	0.00	0.00	<50	<50.0	1.39	<0.500	<0.500	<0.500	12.9	--
03/01/01	8.70	0.88	7.82	0.00	0.00	66 ¹¹	<50	1.0	<0.50	<0.50	<0.50	19	--
06/04/01	8.70	0.25	8.45	0.00	0.00	69 ⁹	<50	2.0	<0.50	<0.50	<0.50	37	--
09/10/01	8.70	-0.40	9.10	0.00	0.00	<50	<50	3.9	<0.50	<0.50	<0.50	19	--
12/03/01	8.70	0.62	8.08	0.00	0.00	56	<50	<0.50	<0.50	<0.50	<1.5	19	--
03/04/02	8.70	-0.24	8.94	0.00	0.00	85	<50	<0.50	<0.50	<0.50	<1.5	26	--
05/30/02	8.70	-0.08	8.78	0.00	0.00	210	<50	<0.50	<0.50	<0.50	<1.5	22	--
09/03/02	8.70	-0.28	8.98	0.00	0.00	89	<50	<0.50	<0.50	<0.50	<1.5	24	--
12/09/02	8.70	-0.20	8.90	0.00	0.00	110	<50	<0.50	<0.50	<0.50	<1.5	22	--
03/10/03	8.70	0.58	8.12	0.00	0.00	66	<50	<0.50	<0.50	<0.50	<1.5	40	--
06/09/03 ¹⁸	8.70	0.47	8.23	0.00	0.00	82	<50	<0.5	0.5	<0.5	<0.5	35	--
09/08/03 ^{18,19}	8.70	-0.06	8.76	0.00	0.00	110	<50	<0.5	<0.5	<0.5	<0.5	27	--
12/08/03 ^{18,19}	8.70	0.20	8.50	0.00	0.00	74 ²²	<50	<0.5	<0.5	<0.5	<0.5	23	--
MW-4													
08/20/91	7.37	1.32	5.05	--	--	160	1,800	870	4.0	3.0	9.0	--	--
09/30/91	7.37	1.70	5.67	--	--	--	670	830	5.5	2.7	12	--	--
10/28/91	7.37	1.56	5.81	--	--	--	2,800	990	5.8	4.8	19	--	--
01/08/92	7.37	2.03	5.34	--	--	--	2,900	1,200	10	7.0	18	--	--
01/13/92	7.37	--	--	--	--	1,000	--	--	--	--	--	--	--
06/23/92	7.37	2.00	5.37	--	--	<50	1,600	380	6.5	3.0	12	--	--
08/24/92	7.37	1.62	5.75	--	--	--	--	--	--	--	--	--	--
09/21/92	7.37	1.42	5.95	--	--	<50	1,200	480	5.6	3.7	11	--	--
10/26/92	7.37	1.41	5.96	--	--	--	--	--	--	--	--	--	--

Table 1
Groundwater Monitoring Data and Analytical Results
Chevron Service Station #9-0121
3026 Lakeshore Avenue
Oakland, California

WELL ID/ DATE	TOC (ft.)	GWE (msl)	DTW (ft.)	SPHT (ft.)	SPH REMOVED (gallons)	TPH-D (ppb)	TPH-G (ppb)	B (ppb)	T (ppb)	E (ppb)	X (ppb)	MTBE (ppb)	TDS (ppb)
MW-4 (cont)													
12/23/92	7.37	--	--	--	--	1,800	1,500	700	3.6	3.2	11	--	--
01/08/93	7.37	2.73	4.64	--	--	--	--	--	--	--	--	--	--
03/25/93	7.37	2.95	4.42	--	--	<10	520	160	3.0	1.0	4.0	--	--
06/11/93	7.37	2.25	5.12	--	--	--	1,200	430	5.0	6.0	11	--	2,600
09/29/93	7.37	1.57	5.80	--	--	--	1,300	210	8.0	2.0	14	--	--
12/20/93	7.37	2.27	5.10	--	--	3,900	570	230	5.0	4.0	8.0	--	--
03/07/94	7.37	2.36	5.01	--	--	2,600	2,200	290	18	2.5	11	22,000	--
06/17/94	7.37	1.55	5.82	--	--	2,800	2,100	480	11	4.3	9.5	--	--
09/12/94	7.37	1.73	5.64	--	--	3,000	1,700	340	6.1	2.7	9.7	63,000	--
11/30/94	7.37	1.79	5.58	--	--	INACCESSIBLE		--	--	--	--	--	--
03/24/95	7.37	2.42	4.95	--	--	3,000 ²	1,500	280	<5.0	<5.0	6.9	12,000	--
06/27/95	7.37	-1.42	8.79	--	--	3,100 ²	<10,000	310	<100	<100	<100	32,000	--
09/28/95	7.37	1.52	5.85	--	--	6,300 ²	330	64	1.1	<0.5	<0.5	630	--
12/19/95	7.37	1.87	5.50	--	--	3,400 ²	3,000	520	<25	<25	<25	44,000	--
02/28/96	7.37	2.27	5.10	--	--	4,700 ²	<10,000	230	<100	<100	<100	32,000	--
06/25/96	7.37	1.59	5.78	--	--	3,100	<10,000	160	<100	<100	<100	31,000	--
12/17/96	7.37	1.42	5.95	--	--	3,600 ³	<5,000	110	<50	<50	<50	22,000	--
03/31/97	7.37	1.75	5.62	--	--	2,700 ²	<2,500	130	<25	<25	<25	16,000	--
06/30/97	7.37	1.34	6.03	--	--	2,700 ²	<2,500	130	<25	<25	<25	14,000	--
09/12/97	7.37	1.68	5.69	--	--	2,100 ²	<5,000	63	<50	<50	<50	15,000	--
12/05/97	7.37	2.22	5.15	--	--	2,600 ²	1,300	120	<5.0	<5.0	8.5	15,000	--
02/16/98	7.37	1.11	6.26	--	--	1,300 ²	1,200	57	4.5	<2.5	7.0	12,000	--
06/17/98	7.37	2.41	4.96	--	--	530 ²	5,300	390	290	28	150	17,000	--
08/31/98	7.37	1.46	5.91	--	--	2,400 ²	<50	89	<0.5	<0.5	<0.5	14,000/16,000 ⁴	--
12/28/98	7.37	1.96	5.41	--	--	2,900 ²	1,000	52	5.6	4.6	9.1	8,400	--
03/04/99	7.37	2.17	5.20	--	--	4,490 ²	<2,500	85.5	40.9	<25	<25	11,400	--
DESTROYED													

Table 1
Groundwater Monitoring Data and Analytical Results
Chevron Service Station #9-0121
3026 Lakeshore Avenue
Oakland, California

WELL ID/ DATE	TOC (ft.)	GWE (msl)	DTW (ft.)	SPHT (ft.)	SPH REMOVED (gallons)	TPH-D (ppb)	TPH-G (ppb)	B (ppb)	T (ppb)	E (ppb)	X (ppb)	MTBE (ppb)	TDS (ppb)
MW-4A													
04/19/99	7.69	2.78	4.91	--	--	370 ²	<500	<5.0	<5.0	<5.0	<5.0	1,600	--
06/14/99	7.69	2.44	5.25	--	--	2,500 ²	5,360	312	<20	44	<20	2,880	--
09/17/99	7.69	0.32	7.37	--	--	1,430 ²	1,290	38.6	<5.0	7.01	<5.0	1,780	--
12/20/99	7.69	1.39	6.30	--	--	7,480 ²	852	43.5	4.63	9.18	4.36	1,070	--
03/20/99	7.69	2.07	5.62	--	--	1,280 ²	1,370	129	8.6	18.3	7.3	2,110	--
06/24/00	7.69	1.57	6.12	0.00	0.00	1,190 ⁹	190 ⁷	1.4	1.7	1.7	3.3	3,900 ⁷	--
09/07/00	7.69	1.43	6.26	0.00	0.00	740 ⁹	490 ⁷	15	1.9	1.1	3.9	3,300	--
12/05/00	7.69	1.70	5.99	0.00	0.00	560 ¹²	<500	<5.00	<5.00	<5.00	<5.00	3,380 ⁸	--
03/01/01	7.69	2.01	5.68	0.00	0.00	600 ⁹	<1,000	10	<10	<10	<10	4,600	--
06/04/01	7.69	1.09	6.60	0.00	0.00	770 ⁹	390 ¹⁵	8.4	3.8	<2.5	3.0	3,800	--
09/10/01	7.69	1.12	6.57	0.00	0.00	810	<500	13	<5.0	22	<5.0	4,900	--
12/03/01	7.69	1.74	5.95	0.00	0.00	2,100	<250	1.5	<1.0	<1.0	<3.0	3,800	--
03/04/02	7.69	-1.19	8.88	0.00	0.00	2,400	2,500	49	6.8	21	9.5	2,600	--
05/30/02	7.69	1.49	6.20	0.00	0.00	2,600	430	4.6	<1.0	2.0	<3.0	3,700	--
09/03/02	7.69	1.20	6.49	0.00	0.00	3,200	<500	4.5	<2.0	3.5	7.5	3,800	--
12/09/02	7.69	1.43	6.26	0.00	0.00	1,600	440	1.1	<0.50	0.71	<5.0	4,000	--
03/10/03	7.69	1.86	5.83	0.00	0.00	1,700	710	14	2.2	4.2	<10	4,100	--
06/09/03 ¹⁸	7.69	1.25	6.44	0.00	0.00	3,200	400	3	<1	2	<1	4,100	--
09/08/03 ^{18,20}	7.69	1.83	5.86	0.00	0.00	3,900	1,300	28	4	4	<3	2,900	--
12/08/03 ^{18,20}	7.69	1.57	6.12	0.00	0.00	2,500	360	3	<3	<3	<3	3,200	--
MW-5													
06/23/92	14.14	1.90	12.24	--	--	<50	<50	<0.5	<0.5	<0.5	<0.5	--	--
08/24/92	14.14	1.85	12.29	--	--	--	--	--	--	--	--	--	--
09/21/92	14.14	1.68	12.46	--	--	60	<50	<0.5	<0.5	<0.5	<0.5	--	--
10/26/92	14.14	1.62	12.52	--	--	--	--	--	--	--	--	--	--
12/23/92	14.14	3.02	11.12	--	--	--	--	--	--	--	--	--	--
01/08/93	14.14	--	--	--	--	--	--	--	--	--	--	--	--
03/25/93	14.14	4.40	9.74	--	--	<10	<50	<0.5	<0.5	<0.5	0.9	--	--
06/11/93	14.14	3.70	10.44	--	--	--	<50	<0.5	<0.5	<0.5	<0.5	--	770
09/29/93	14.14	2.22	11.92	--	--	<10	<50	<0.5	0.6	<0.5	0.6	--	--

Table 1
Groundwater Monitoring Data and Analytical Results
Chevron Service Station #9-0121
3026 Lakeshore Avenue
Oakland, California

WELL ID/ DATE	TOC (ft.)	GWE (msl)	DTW (ft.)	SPHT (ft.)	SPH REMOVED (gallons)	TPH-D (ppb)	TPH-G (ppb)	B (ppb)	T (ppb)	E (ppb)	X (ppb)	MTBE (ppb)	TDS (ppb)
MW-5 (cont)													
12/20/93	14.14	--	--	--	--	--	--	--	--	--	--	--	--
03/07/94	14.14	2.80	11.34	--	--	<10	<50	<0.5	<0.5	<0.5	<0.5	--	--
06/17/94	14.14	2.87	11.27	--	--	<50	<50	<0.5	<0.5	<0.5	<0.5	--	--
09/12/94	14.14	1.28	12.86	--	--	<50	<50	<0.5	<0.5	<0.5	<0.5	<5.0	--
11/30/94	14.14	2.23	11.91	--	--	99 ²	<50	<0.5	<0.5	<0.5	<0.5	--	--
03/24/95	14.14	4.38	9.76	--	--	<50	<50	<0.5	<0.5	<0.5	<0.5	--	--
06/27/95	14.14	2.74	11.40	--	--	55 ³	<50	<0.5	<0.5	<0.5	<0.5	--	--
09/28/95	14.14	2.24	11.90	--	--	300 ²	<50	<0.5	<0.5	<0.5	<0.5	--	--
12/19/95	14.14	1.56	12.58	--	--	53 ²	<50	<0.5	<0.5	<0.5	<0.5	3.1	--
02/28/96	14.14	2.44	11.70	--	--	<50	<50	<0.5	<0.5	<0.5	<0.5	<2.5	--
06/25/96	14.14	2.71	11.43	--	--	120 ²	<50	<0.5	<0.5	<0.5	<0.5	36	--
12/17/96	14.14	2.74	11.40	--	--	89 ²	<50	<0.5	<0.5	<0.5	<0.5	<2.5	--
03/31/97	14.14	2.04	12.10	--	--	150 ²	<50	<0.5	<0.5	<0.5	<0.5	<2.5	--
06/30/97	14.14	1.36	12.78	--	--	SAMPLED SEMI-ANNUALLY			--	--	--	--	--
09/12/97	14.14	0.46	13.68	--	--	<50	<50	<0.5	<0.5	<0.5	<0.5	<2.5	--
12/05/97	14.14	1.11	13.03	--	--	--	--	--	--	--	--	--	--
02/16/98	14.14	4.17	9.97	--	--	62 ²	<50	<0.5	<0.5	<0.5	<0.5	<2.5	--
06/17/98	14.14	2.29	11.85	--	--	--	--	--	--	--	--	--	--
08/31/98	14.14	1.32	12.82	--	--	<50	<50	<0.5	<0.5	<0.5	<0.5	<2.5	--
12/28/98	14.14	0.71	13.43	--	--	--	--	--	--	--	--	--	--
03/04/99	14.14	0.39	13.75	--	--	70.5	<50	<0.5	<0.5	<0.5	<0.5	3.34	--
06/14/99	14.14	0.04	14.10	--	--	--	--	--	--	--	--	--	--
09/17/99	14.14	-0.04	14.18	--	--	<50	<50	<0.5	<0.5	<0.5	<0.5	<2.5	--
12/20/99	14.14	0.44	13.70	--	--	--	--	--	--	--	--	--	--
03/20/00	14.14	1.50	12.64	--	--	115 ³	<50	<0.5	<0.5	<0.5	<0.5	<2.5	--
06/24/00	14.14	1.10	13.04	0.00	0.00	--	--	--	--	--	--	--	--
09/07/00	14.14	0.97	13.17	0.00	0.00	<50	<50	<0.50	<0.50	<0.50	<0.50	5.0	--
12/05/00	14.14	2.86	11.28	0.00	0.00	--	--	--	--	--	--	--	--
03/01/01	14.14	3.84	10.30	0.00	0.00	<50	<50	<0.50	<0.50	<0.50	<0.50	<2.5	--
06/04/01	14.14	2.83	11.31	0.00	0.00	SAMPLED SEMI-ANNUALLY			--	--	--	--	--
09/10/01	14.14	1.98	12.16	0.00	0.00	<50	<50	<0.50	<0.50	<0.50	<0.50	<2.5	--
12/03/01	14.14	5.52	8.62	0.00	0.00	SAMPLED SEMI-ANNUALLY			--	--	--	--	--

Table 1
Groundwater Monitoring Data and Analytical Results
Chevron Service Station #9-0121
3026 Lakeshore Avenue
Oakland, California

WELL ID/ DATE	TOC (ft.)	GWE (msl)	DTW (ft.)	SPHT (ft.)	SPH REMOVED (gallons)	TPH-D (ppb)	TPH-G (ppb)	B (ppb)	T (ppb)	E (ppb)	X (ppb)	MTBE (ppb)	TDS (ppb)	
MW-5 (cont)														
03/04/02	14.14	4.29	9.85	0.00	0.00	78	<50	<0.50	<0.50	<0.50	<1.5	<2.5	--	
05/30/02	14.14	3.31	10.83	0.00	0.00	SAMPLED SEMI-ANNUALLY		--	--	--	--	--	--	
09/03/02	14.14	INACCESSIBLE - CAR PARKED OVER WELL					--	--	--	--	--	--	--	--
12/09/02	14.14	2.78	11.36	0.00	0.00	SAMPLED SEMI-ANNUALLY		--	--	--	--	--	--	
03/10/03	14.14	2.95	11.19	0.00	0.00	100	<50	<0.50	<0.50	<0.50	<1.5	8.2	--	
06/09/03	14.14	1.57	12.57	0.00	0.00	SAMPLED SEMI-ANNUALLY		--	--	--	--	--	--	
09/08/03 ^{18,19}	14.14	2.13	12.01	0.00	0.00	65	<50	<0.5	<0.5	<0.5	<0.5	8	--	
12/08/03	14.14	3.01	11.13	0.00	0.00	SAMPLED SEMI-ANNUALLY		--	--	--	--	--	--	
MW-6														
06/23/92	4.46	-0.68	5.14	--	--	120	<50	4.3	<0.5	0.8	0.9	--	--	
08/24/92	4.46	-0.49	4.95	--	--	--	--	--	--	--	--	--	--	
09/21/92	4.46	-0.44	4.90	--	--	<50	<250	<2.5	<2.5	<2.5	<2.5	--	--	
10/26/92	4.46	-1.06	5.52	--	--	--	--	--	--	--	--	--	--	
12/23/92	4.46	-0.94	5.40	--	--	81	<50	<0.5	<0.5	<0.5	<0.5	--	--	
01/08/93	4.46	--	--	--	--	--	--	--	--	--	--	--	--	
03/25/93	4.46	-1.64	6.10	--	--	<10	<50	<0.5	<0.5	<0.5	0.7	--	--	
06/11/93	4.46	-2.10	6.56	--	--	--	<50	<0.5	<0.5	<0.5	<0.5	--	15,000	
09/29/93	4.46	-0.71	5.17	--	--	<10	<50	<0.5	<0.5	<0.5	<0.5	--	--	
12/20/93	4.46	-1.47	5.93	--	--	<10	<50	<0.5	<0.5	<0.5	<0.5	--	--	
03/07/94	4.46	-0.81	5.27	--	--	<10	54	<0.5	<0.5	<0.5	0.6	--	--	
06/17/94	4.46	--	--	--	--	--	--	--	--	--	--	--	--	
09/12/94	4.46	-0.64	5.10	--	--	<50	<50	<0.5	<0.5	<0.5	<0.5	<50	--	
11/30/94	4.46	-1.12	5.58	--	--	800 ¹	<50	<0.5	<0.5	<0.5	<0.5	--	--	
03/24/95	4.46	-1.87	6.33	--	--	490 ²	<50	<0.5	<0.5	<0.5	<0.5	--	--	
06/27/95	4.46	-3.74	8.20	--	--	300 ²	<50	<0.5	<0.5	<0.5	<0.5	--	--	
09/28/95	4.46	-0.19	4.65	--	--	1,200 ²	120	1.1	<0.5	<0.5	<0.5	--	--	
12/19/95	4.46	-1.58	6.04	--	--	820 ²	<50	<0.5	<0.5	<0.5	<0.5	<2.5	--	
02/28/96	4.46	-1.54	6.00	--	--	270 ²	<50	<0.5	<0.5	<0.5	<0.5	<2.5	--	
06/25/96	4.46	-1.71	6.17	--	--	750 ²	97	<0.5	<0.5	<0.5	0.71	<2.5	--	
12/17/96	4.46	-1.67	6.13	--	--	540 ²	65	<0.5	<0.5	<0.5	<0.5	<2.5	--	

Table 1
Groundwater Monitoring Data and Analytical Results
Chevron Service Station #9-0121
3026 Lakeshore Avenue
Oakland, California

WELL ID/ DATE	TOC (ft.)	GWE (msl)	DTW (ft.)	SPHT (ft.)	SPH REMOVED (gallons)	TPH-D (ppb)	TPH-G (ppb)	B (ppb)	T (ppb)	E (ppb)	X (ppb)	MTBE (ppb)	TDS (ppb)	
MW-6 (cont)						780 ²	65	<0.5	<0.5	<0.5	<0.5	<2.5	--	
03/31/97	4.46	-2.23	6.69	--	--								--	
06/30/97	4.46	-2.62	7.08	--	--	SAMPLED SEMI-ANNUALLY							--	
09/12/97	4.46	-0.95	5.41	--	--	270 ²	65	<0.5	<0.5	<0.5	<0.5	<2.5	--	
12/05/97	4.46	-1.96	6.42	--	--	--	--	--	--	--	--	--	--	
02/16/98	4.46	-0.30	4.76	--	--	330 ²	140	<0.5	<0.5	<0.5	<0.5	<2.5	--	
06/17/98	4.46	-1.54	6.00	--	--	--	--	--	--	--	--	--	--	
08/31/98	4.46	-0.64	5.10	--	--	270 ¹	<50	<0.5	<0.5	<0.5	<0.5	<2.5	--	
12/28/98	4.46	-2.04	6.50	--	--	--	--	--	--	--	--	--	--	
03/04/99	4.46	-1.35	5.81	--	--	638 ¹	95.5	<0.5	<0.5	<0.5	<0.5	<2.0	--	
06/14/99	4.46	-0.97	5.43	--	--	--	--	--	--	--	--	--	--	
09/17/99	4.46	-1.74	6.20	--	--	258 ¹	<50	<0.5	<0.5	<0.5	<0.5	<2.5	--	
12/20/99	4.46	-2.31	6.77	--	--	--	--	--	--	--	--	--	--	
03/20/00	4.46	-2.12	6.58	--	--	257 ²	<50	<0.5	<0.5	<0.5	<0.5	<2.5	--	
06/24/00	4.46	-2.52	6.98	0.00	0.00	SAMPLED SEMI-ANNUALLY							--	
09/07/00	4.46	-0.46	4.92	0.00	0.00	98 ¹¹	<50	<0.50	<0.50	<0.50	<0.50	<2.5	--	
12/05/00	4.46	-0.64	5.10	0.00	0.00	--	--	--	--	--	--	--	--	
03/01/01	4.46	-0.43	4.89	0.00	0.00	190 ⁹	<50	<0.50	<0.50	<0.50	<0.50	<2.5	--	
06/04/01	4.46	-0.75	5.21	0.00	0.00	SAMPLED SEMI-ANNUALLY							--	
09/10/01	4.46	-0.65	5.11	0.00	0.00	140 ¹⁷	<50	<0.50	<0.50	<0.50	<0.50	<2.5	--	
12/03/01	4.46	-0.57	5.03	0.00	0.00	SAMPLED SEMI-ANNUALLY							--	
03/04/02	4.46	INACCESSIBLE - CAR PARKED OVER WELL					--	--	--	--	--	--	--	--
05/30/02	4.46	-1.65	6.11	0.00	0.00	SAMPLED SEMI-ANNUALLY							--	
09/03/02	4.46	-0.82	5.28	0.00	0.00	340	<500	<2.0	<2.0	<2.0	<6.0	<3.0	--	
12/09/02	4.46	-0.66	5.12	0.00	0.00	SAMPLED SEMI-ANNUALLY							--	
03/10/03	4.46	-1.80	6.26	0.00	0.00	420	<50	<0.50	<0.50	<0.50	<1.5	<2.5	--	
06/09/03	4.46	-1.45	5.91	0.00	0.00	SAMPLED SEMI-ANNUALLY							--	
09/08/03 ^{18,19}	4.46	-0.19	4.65	0.00	0.00	230	<50	<0.5	<0.5	<0.5	<0.5	<0.5	--	
12/08/03	4.46	-0.78	5.24	0.00	0.00	SAMPLED SEMI-ANNUALLY							--	

Table 1
Groundwater Monitoring Data and Analytical Results
Chevron Service Station #9-0121
3026 Lakeshore Avenue
Oakland, California

WELL ID/ DATE	TOC (ft.)	GWE (msl)	DTW (ft.)	SPHT (ft.)	SPH REMOVED (gallons)	TPH-D (ppb)	TPH-G (ppb)	B (ppb)	T (ppb)	E (ppb)	X (ppb)	MTBE (ppb)	TDS (ppb)
MW-7													
08/24/92	5.26	-0.29	5.55	--	--	--	--	--	--	--	--	--	--
09/21/92	5.26	-0.39	5.65	--	--	<50	<50	<0.5	<0.5	<0.5	<0.5	--	--
10/26/92	5.26	-0.25	5.51	--	--	--	--	--	--	--	--	--	--
12/23/92	5.26	1.31	3.95	--	--	60	<50	2.9	<0.5	<0.5	<0.5	--	--
01/08/93	5.26	--	--	--	--	--	--	--	--	--	--	--	--
03/25/93	5.26	2.76	2.50	--	--	<10	<50	<0.5	<0.5	<0.5	<0.5	--	--
06/11/93	5.26	1.80	3.46	--	--	--	<50	0.6	<0.5	<0.5	<0.5	--	2,200
09/29/93	5.26	-0.26	5.52	--	--	<10	<50	2.0	1.0	1.0	7.0	--	--
12/20/93	5.26	0.85	4.41	--	--	<10	<50	2.0	<0.5	<0.5	<0.5	--	--
03/07/94	5.26	2.64	2.62	--	--	<10	<50	<0.5	<0.5	<0.5	<0.5	--	--
06/17/94	5.26	1.99	3.27	--	--	<50	<50	<0.5	<0.5	<0.5	<0.5	--	--
09/12/94	5.26	1.15	4.11	--	--	<50	<50	<0.5	<0.5	<0.5	<0.5	<5.0	--
11/30/94	5.26	2.50	2.76	--	--	92 ¹	<50	<0.5	<0.5	<0.5	<0.5	--	--
03/24/95	5.26	3.06	2.20	--	--	<50	<50	<0.5	<0.5	<0.5	<0.5	--	--
06/27/95	5.26	1.36	3.90	--	--	69 ²	<50	<0.5	<0.5	<0.5	<0.5	--	--
09/28/95	5.26	0.41	4.85	--	--	84 ²	<50	<0.5	<0.5	<0.5	<0.5	--	--
12/19/95	5.26	2.24	3.02	--	--	84 ²	<50	<0.5	<0.5	<0.5	<0.5	<2.5	--
02/28/96	5.26	3.83	1.43	--	--	99 ²	<50	<0.5	<0.5	<0.5	<0.5	<2.5	--
06/25/96	5.26	0.97	4.29	--	--	110 ²	<50	<0.5	<0.5	<0.5	<0.5	<2.5	--
12/17/96	5.26	3.08	2.18	--	--	54 ²	<50	<0.5	<0.5	<0.5	<0.5	<2.5	--
03/31/97	5.26	2.32	2.94	--	--	100 ²	<50	<0.5	<0.5	<0.5	<0.5	<2.5	--
06/30/97	5.26	1.68	3.58	--	--	SAMPLED ANNUALLY		--	--	--	--	--	--
09/12/97	5.26	1.85	3.41	--	--	--	--	--	--	--	--	--	--
12/05/97	5.26	3.37	1.89	--	--	--	--	--	--	--	--	--	--
02/16/98	5.26	3.43	1.83	--	--	77 ²	<50	<0.5	<0.5	<0.5	<0.5	<2.5	--
06/17/98	5.26	3.32	1.94	--	--	--	--	--	--	--	--	--	--
08/31/98	5.26	1.07	4.19	--	--	--	--	--	--	--	--	--	--
12/28/98	5.26	0.79	4.47	--	--	--	--	--	--	--	--	--	--
03/04/99	5.26	3.51	1.75	--	--	73.4	<50	<0.5	<0.5	<0.5	<0.5	<2.0	--
06/14/99	5.26	3.64	1.62	--	--	--	--	--	--	--	--	--	--
09/17/99	5.26	0.42	4.84	--	--	--	--	--	--	--	--	--	--
12/20/99	5.26	0.45	4.81	--	--	--	--	--	--	--	--	--	--

Table 1
Groundwater Monitoring Data and Analytical Results
Chevron Service Station #9-0121
3026 Lakeshore Avenue
Oakland, California

WELL ID/ DATE	TOC (ft.)	GWE (msl)	DTW (ft.)	SPHT (ft.)	SPH REMOVED (gallons)	TPH-D (ppb)	TPH-G (ppb)	B (ppb)	T (ppb)	E (ppb)	X (ppb)	MTBE (ppb)	TDS (ppb)
MW-7 (cont)													
03/20/00	5.26	3.41	1.85	--	--	<50	<50	<0.5	<0.5	<0.5	<0.5	<2.5	--
06/24/00	5.26	3.05	2.21	0.00	0.00	--	--	--	--	--	--	--	--
09/07/00	5.26	1.61	3.65	0.00	0.00	--	--	--	--	--	--	--	--
12/05/00	5.26	2.31	2.95	0.00	0.00	--	--	--	--	--	--	--	--
03/01/01	5.26	4.61	0.65	0.00	0.00	<50	<50	<0.50	<0.50	<0.50	<0.50	<2.5	--
06/04/01	5.26	3.74	1.52	0.00	0.00	--	--	--	--	--	--	--	--
09/10/01	5.26	1.08	4.18	0.00	0.00	SAMPLED ANNUALLY		--	--	--	--	--	--
12/03/01	5.26	4.20	1.06	0.00	0.00	SAMPLED ANNUALLY		--	--	--	--	--	--
03/04/02	5.26	3.76	1.50	0.00	0.00	<50	<50	<0.50	<0.50	<0.50	<1.5	<2.5	--
05/30/02	5.26	2.51	2.75	0.00	0.00	SAMPLED ANNUALLY		--	--	--	--	--	--
09/03/02	5.26	2.24	3.02	0.00	0.00	SAMPLED ANNUALLY		--	--	--	--	--	--
12/09/02	5.26	2.41	2.85	0.00	0.00	SAMPLED ANNUALLY		--	--	--	--	--	--
03/10/03	5.26	3.32	1.94	0.00	0.00	85	<50	<0.50	<0.50	<0.50	<1.5	<2.5	--
06/09/03	5.26	2.72	2.54	0.00	0.00	SAMPLED ANNUALLY		--	--	--	--	--	--
09/08/03	5.26	2.66	2.60	0.00	0.00	SAMPLED ANNUALLY		--	--	--	--	--	--
12/08/03	5.26	2.81	2.45	0.00	0.00	SAMPLED ANNUALLY		--	--	--	--	--	--
MW-8													
06/23/92	8.94	-15.20	24.14	--	--	<50	<50	<0.5	<0.5	<0.5	<0.5	--	--
08/24/92	8.94	0.34	8.60	--	--	--	--	--	--	--	--	--	--
09/21/92	8.94	0.55	8.39	--	--	<50	94	<0.5	<0.5	<0.5	<0.5	--	--
10/26/92	8.94	-0.18	9.12	--	--	--	--	--	--	--	--	--	--
12/23/92	8.94	0.83	8.11	--	--	79	<50	0.7	5.0	0.7	2.9	--	--
01/08/93	8.94	--	--	--	--	--	--	--	--	--	--	--	--
03/25/93	8.94	--	--	--	--	--	--	--	--	--	--	--	--
06/11/93	8.94	0.55	8.39	--	--	--	<50	<0.5	<0.5	<0.5	<0.5	--	3,500
09/29/93	8.94	0.69	8.25	--	--	<10	<50	<0.5	<0.5	<0.5	<0.5	--	--
12/20/93	8.94	0.48	8.46	--	--	<10	<50	<0.5	0.6	<0.5	1.0	--	--
03/07/94	8.94	0.28	8.66	--	--	<10	<50	<0.5	<0.5	<0.5	<0.5	--	--
06/17/94	8.94	0.12	8.82	--	--	<50	<50	<0.5	<0.5	<0.5	<0.5	--	--
09/12/94	8.94	0.11	8.83	--	--	<50	<50	<0.5	<0.5	<0.5	0.8	<5.0	--

Table I
Groundwater Monitoring Data and Analytical Results
Chevron Service Station #9-0121
3026 Lakeshore Avenue
Oakland, California

WELL ID/ DATE	TOC (ft.)	GWE (msl)	DTW (ft.)	SPHT (ft.)	SPH REMOVED (gallons)	TPH-D (ppb)	TPH-G (ppb)	B (ppb)	T (ppb)	E (ppb)	X (ppb)	MTBE (ppb)	TDS (ppb)	
MW-8 (cont)														
11/30/94	8.94	0.31	8.63	--	--	120 ¹	<50	<0.5	<0.5	<0.5	<0.5	--	--	
03/24/95	8.94	0.43	8.51	--	--	110 ²	<50	<0.5	<0.5	<0.5	<0.5	--	--	
06/27/95	8.94	-0.03	8.97	--	--	67 ²	<50	<0.5	<0.5	<0.5	<0.5	--	--	
09/28/95	8.94	0.04	8.90	--	--	91 ²	<50	<0.5	<0.5	<0.5	<0.5	--	--	
12/19/95	8.94	0.54	8.40	--	--	76 ²	<50	<0.5	<0.5	<0.5	<0.5	<2.5	--	
02/28/96	8.94	0.50	8.44	--	--	<50	<50	<0.5	<0.5	<0.5	<0.5	<2.5	--	
06/25/96	8.94	0.05	8.89	--	--	80 ²	<50	<0.5	<0.5	<0.5	<0.5	<2.5	--	
12/17/96	8.94	0.49	8.45	--	--	79 ²	<50	<0.5	<0.5	<0.5	<0.5	<2.5	--	
03/31/97	8.94	0.18	8.76	--	--	72 ²	<50	<0.5	<0.5	<0.5	<0.5	3.6	--	
06/30/97	8.94	-0.18	9.12	--	--	SAMPLED ANNUALLY		--	--	--	--	--	--	
09/12/97	8.94	0.13	8.81	--	--	--	--	--	--	--	--	--	--	
12/05/97	8.94	0.59	8.35	--	--	--	--	--	--	--	--	--	--	
02/16/98	8.94	1.00	7.94	--	--	68 ²	<50	<0.5	<0.5	<0.5	<0.5	4.3	--	
06/17/98	8.94	0.51	8.43	--	--	--	--	--	--	--	--	--	--	
08/31/98	8.94	0.06	8.88	--	--	--	--	--	--	--	--	--	--	
12/28/98	8.94	0.64	8.30	--	--	--	--	--	--	--	--	--	--	
03/04/99	8.94	0.29	8.65	--	--	106	<50	<0.5	<0.5	<0.5	<0.5	3.83	--	
06/14/99	8.94	0.52	8.42	--	--	--	--	--	--	--	--	--	--	
09/17/99	8.94	-0.93	9.87	--	--	--	--	--	--	--	--	--	--	
12/20/99	8.94	0.54	8.40	--	--	--	--	--	--	--	--	--	--	
03/20/00	8.94	0.82	8.12	--	--	82.2 ⁶	<50	<0.5	<0.5	<0.5	<0.5	3.46	--	
06/24/00	8.94	0.31	8.63	0.00	0.00	SAMPLED ANNUALLY		--	--	--	--	--	--	
09/07/00	8.94	0.26	8.68	0.00	0.00	--	--	--	--	--	--	--	--	
12/05/00	8.94	0.81	8.13	0.00	0.00	--	--	--	--	--	--	--	--	
03/01/01	8.94	1.04	7.90	0.00	0.00	51 ¹¹	<50	<0.50	<0.50	<0.50	<0.50	<2.5	--	
06/04/01	8.94	-0.27	9.21	0.00	0.00	--	--	--	--	--	--	--	--	
09/10/01	8.94	0.26	8.68	0.00	0.00	SAMPLED ANNUALLY		--	--	--	--	--	--	
12/03/01	8.94	1.12	7.82	0.00	0.00	SAMPLED ANNUALLY		--	--	--	--	--	--	
03/04/02	8.94	1.26	7.68	0.00	0.00	82	<50	<0.50	<0.50	<0.50	<1.5	<2.5	--	
05/30/02	8.94	INACCESSIBLE - CAR PARKED OVER WELL					--	--	--	--	--	--	--	--
09/03/02	8.94	-0.21	9.15	0.00	0.00	SAMPLED ANNUALLY		--	--	--	--	--	--	
12/09/02	8.94	0.21	8.73	0.00	0.00	SAMPLED ANNUALLY		--	--	--	--	--	--	

Table 1
Groundwater Monitoring Data and Analytical Results
Chevron Service Station #9-0121
3026 Lakeshore Avenue
Oakland, California

WELL ID/ DATE	TOC (ft.)	GWE (msl)	DTW (ft.)	SPHT (ft.)	SPH REMOVED (gallons)	TPH-D (ppb)	TPH-G (ppb)	B (ppb)	T (ppb)	E (ppb)	X (ppb)	MTBE (ppb)	TDS (ppb)
MW-8 (cont)													
03/10/03	8.94	0.55	8.39	0.00	0.00	110	<50	<0.50	<0.50	<0.50	<1.5	<2.5	--
06/09/03	8.94	-0.03	8.97	0.00	0.00	SAMPLED ANNUALLY		--	--	--	--	--	--
09/08/03	8.94	0.52	8.42	0.00	0.00	SAMPLED ANNUALLY		--	--	--	--	--	--
12/08/03	8.94	0.77	8.17	0.00	0.00	SAMPLED ANNUALLY		--	--	--	--	--	--
MW-9													
04/19/99	5.87	2.71	3.16	--	--	2,600 ²	3,900 ⁶	14	6.9	14	24	140	--
06/14/99	5.87	1.06	4.81	--	--	2,800 ²	2,880	12.6	<10	<10	<10	138	--
09/17/99	5.87	1.02	4.85	--	--	1,770 ²	3,370	33.1	14.4	<5.0	<5.0	202	--
12/20/99	5.87	1.87	4.00	--	--	996 ²	3,970	42.2	13.5	<10	<10	311	--
03/20/00	5.87	2.87	3.00	--	--	2,710 ²	5,920	22.1	<5.0	6.8	<5.0	106.0	--
06/24/00	5.87	1.96	3.91	0.00	0.00	1,940 ⁹	2,500 ⁷	12	<10	11	<10	120	--
09/07/00	5.87	1.59	4.28	0.00	0.00	1,500 ⁹	3,700 ⁷	<25	<25	<25	<25	330	--
12/05/00	5.87	2.07	3.80	0.00	0.00	1,300 ¹²	3,470 ²	<5.00	7.64	<5.00	<5.00	177	--
03/01/01	5.87	3.19	2.68	0.00	0.00	960 ⁹	2,400 ⁷	11	18.0	<10	<10	250	--
06/04/01	5.87	1.96	3.91	0.00	0.00	1,200 ⁹	3,200 ⁷	45	17	6.1	8.9	300	--
09/10/01	5.87	1.18	4.69	0.00	0.00	2,000 ¹⁷	2,300	5.7	7.3	10	<5.0	200	--
12/03/01	5.87	2.88	2.99	0.00	0.00	2,600	3,600	14	5.4	8.2	8.5	210	--
03/04/02	5.87	2.32	3.55	0.00	0.00	3,700	4,400	17	<5.0	9.2	6.4	79	--
05/30/02	5.87	2.22	3.65	0.00	0.00	4,600	4,300	15	3.7	5.8	6.1	110	--
09/03/02	5.87	1.31	4.56	0.00	0.00	2,500	3,200	5.8	2.6	3.5	5.6	84	--
12/09/02	5.87	1.51	4.36	0.00	0.00	2,600	3,000	6.3	3.2	3.9	6.1	110	--
03/10/03	5.87	2.26	3.61	0.00	0.00	1,500	3,300	11	3.7	5.4	<7.5	150	--
06/09/03 ¹⁸	5.87	2.29	3.58	0.00	0.00	2,700	3,500	2	2	3	2	46	--
09/08/03 ^{18,19}	5.87	1.43	4.44	0.00	0.00	3,000	3,000	3	2	2	3	120	--
12/08/03 ^{18,19}	5.87	2.21	3.66	0.00	0.00	2,500	2,400	3	3	3	4	560	--

Table 1
Groundwater Monitoring Data and Analytical Results
Chevron Service Station #9-0121
3026 Lakeshore Avenue
Oakland, California

WELL ID/ DATE	TOC (ft.)	GWE (msl)	DTW (ft.)	SPHT (ft.)	SPH REMOVED (gallons)	TPH-D (ppb)	TPH-G (ppb)	B (ppb)	T (ppb)	E (ppb)	X (ppb)	MTBE (ppb)	TDS (ppb)
TRIP BLANK													
08/24/92	--	--	--	--	--	--	--	--	--	--	--	--	--
09/21/92	--	--	--	--	--	--	<50	<0.5	<0.5	<0.5	<0.5	--	--
10/26/92	--	--	--	--	--	--	--	--	--	--	--	--	--
12/23/92	--	--	--	--	--	--	<50	<0.5	<0.5	<0.5	<0.5	--	--
01/08/93	--	--	--	--	--	--	--	--	--	--	--	--	--
03/25/93	--	--	--	--	--	--	<50	<0.5	<0.5	<0.5	<0.5	--	--
06/11/93	--	--	--	--	--	--	<50	<0.5	<0.5	<0.5	<0.5	--	--
09/29/93	--	--	--	--	--	--	<50	<0.5	<0.5	<0.5	<0.5	--	--
12/20/93	--	--	--	--	--	--	<50	<0.5	<0.5	<0.5	<0.5	--	--
03/07/94	--	--	--	--	--	--	<50	<0.5	<0.5	<0.5	<0.5	--	--
06/17/94	--	--	--	--	--	--	<50	<0.5	<0.5	<0.5	<0.5	--	--
09/12/94	--	--	--	--	--	--	<50	<0.5	<0.5	<0.5	1.0	--	--
11/30/94	--	--	--	--	--	--	<50	<0.5	<0.5	<0.5	<0.5	--	--
03/24/95	--	--	--	--	--	--	<50	<0.5	<0.5	<0.5	<0.5	--	--
06/27/95	--	--	--	--	--	--	<50	<0.5	<0.5	<0.5	<0.5	--	--
09/28/95	--	--	--	--	--	--	<50	<0.5	<0.5	<0.5	<0.5	--	--
12/19/95	--	--	--	--	--	--	<50	<0.5	<0.5	<0.5	<0.5	--	--
02/28/96	--	--	--	--	--	--	<50	<0.5	<0.5	<0.5	<0.5	--	--
06/25/96	--	--	--	--	--	--	<50	<0.5	<0.5	<0.5	<0.5	--	--
12/17/96	--	--	--	--	--	--	<50	<0.5	<0.5	<0.5	<0.5	<2.5	--
03/31/97	--	--	--	--	--	--	<50	<0.5	<0.5	<0.5	<0.5	<2.5	--
06/30/97	--	--	--	--	--	--	<50	<0.5	<0.5	<0.5	<0.5	<2.5	--
09/12/97	--	--	--	--	--	--	<50	<0.5	<0.5	<0.5	<0.5	<2.5	--
12/05/97	--	--	--	--	--	--	<50	<0.5	<0.5	<0.5	<0.5	<2.5	--
02/16/98	--	--	--	--	--	--	<50	<0.5	<0.5	<0.5	<0.5	<2.5	--
06/17/98	--	--	--	--	--	--	<50	<0.5	<0.5	<0.5	<0.5	<2.5	--
08/31/98	--	--	--	--	--	--	<50	<0.5	<0.5	<0.5	<0.5	<2.5	--
12/28/98	--	--	--	--	--	--	<50	<0.5	<0.5	<0.5	<0.5	<2.5	--
03/04/99	--	--	--	--	--	--	<50	<0.5	<0.5	<0.5	<0.5	<2.0	--
06/14/99	--	--	--	--	--	--	<50	<0.5	<0.5	<0.5	<0.5	<2.5	--
09/17/99	--	--	--	--	--	--	<50	<0.5	<0.5	<0.5	<0.5	<2.5	--
12/20/99	--	--	--	--	--	--	<50	<0.5	<0.5	<0.5	<0.5	<2.5	--

Table 1
Groundwater Monitoring Data and Analytical Results
 Chevron Service Station #9-0121
 3026 Lakeshore Avenue
 Oakland, California

WELL ID/ DATE	TOC (ft.)	GWE (msl)	DTW (ft.)	SPHT (ft.)	SPH REMOVED (gallons)	TPH-D (ppb)	TPH-G (ppb)	B (ppb)	T (ppb)	E (ppb)	X (ppb)	MTBE (ppb)	TDS (ppb)
TRIP BLANK (cont)													
03/20/00	--	--	--	--	--	--	<50	<0.5	<0.5	<0.5	<0.5	<2.5	--
06/24/00	--	--	--	--	--	--	<50	<0.50	<0.50	<0.50	<0.50	<2.5	--
09/07/00	--	--	--	--	--	--	<50	<0.500	<0.500	<0.500	<0.500	<2.5	--
12/05/00	--	--	--	--	--	--	<50	<0.50	<0.50	<0.50	<0.50	<2.5	--
03/01/01	--	--	--	--	--	--	<50	<0.50	<0.50	<0.50	<0.50	<2.5	--
06/04/01	--	--	--	--	--	--	<50	<0.50	<0.50	<0.50	<0.50	<2.5	--
09/10/01	--	--	--	--	--	--	<50	<0.50	<0.50	<0.50	<0.50	<2.5	--
QA													
12/03/01	--	--	--	--	--	--	<50	<0.50	<0.50	<0.50	<1.5	<2.5	--
03/04/02	--	--	--	--	--	--	<50	<0.50	<0.50	<0.50	<1.5	<2.5	--
05/30/02	--	--	--	--	--	--	<50	<0.50	<0.50	<0.50	<1.5	<2.5	--
09/03/02	--	--	--	--	--	--	<50	<0.50	<0.50	<0.50	<1.5	<2.5	--
12/09/02	--	--	--	--	--	--	<50	<0.50	<0.50	<0.50	<1.5	<2.5	--
03/10/03	--	--	--	--	--	--	<50	<0.5	<0.5	<0.5	<0.5	<0.5	--
06/09/03 ^{1R}	--	--	--	--	--	--	<50	<0.5	<0.5	<0.5	<0.5	<0.5	--
09/08/03 ^{1R}	--	--	--	--	--	--	<50	<0.5	<0.5	<0.5	<0.5	<0.5	--
12/08/03 ^{1R}	--	--	--	--	--	--	<50	<0.5	<0.5	<0.5	<0.5	<0.5	--

Table 1
Groundwater Monitoring Data and Analytical Results
Chevron Service Station #9-0121
3026 Lakeshore Avenue
Oakland, California

EXPLANATIONS:

Groundwater monitoring data and laboratory analytical results prior to June 24, 2000, were compiled from reports prepared by Blaine Tech Services, Inc.

TOC = Top of Casing

(ft.) = Feet

GWE = Groundwater Elevation

(msl) = Mean sea level

DTW = Depth to Water

SPHT = Separate Phase Hydrocarbon Thickness

TPH-D = Total Petroleum Hydrocarbons as Diesel

TPH-G = Total Petroleum Hydrocarbons as Gasoline

B = Benzene

T = Toluene

E = Ethylbenzene

X = Xylenes

TDS = Total Dissolved Solids

(ppb) = Parts per billion

-- = Not Measured/Not Analyzed

QA = Quality Assurance/Trip Blank

- 1 Chromatogram pattern indicates a non-diesel mix.
- 2 Chromatogram pattern indicates an unidentified hydrocarbon.
- 3 Chromatogram pattern indicates an unidentified hydrocarbon and weathered diesel.
- 4 Confirmation run.
- 5 ORC present in well.
- 6 Laboratory report indicates gasoline and unidentified hydrocarbons >10.
- 7 Laboratory report indicates gasoline C6-C12.
- 8 Laboratory report indicates this sample was analyzed outside of the EPA recommended holding time.
- 9 Laboratory report indicates unidentified hydrocarbons C9-C24.
- 10 Laboratory report indicates unidentified hydrocarbons C10-C24.
- 11 Laboratory report indicates unidentified hydrocarbons >C16.
- 12 Laboratory report indicates unidentified hydrocarbons C9-C40.
- 13 Laboratory report indicates diesel C9-C24 + unidentified hydrocarbons <C16.
- 14 Laboratory report indicates weathered gasoline C6-C12.
- 15 Laboratory report indicates unidentified hydrocarbons C6-C12.
- 16 Laboratory report indicates hydrocarbon pattern is present in the requested fuel quantitation range but does not resemble the pattern of the requested fuel.
- 17 Laboratory report indicates hydrocarbon pattern is present in the requested fuel quantitation range but does not resemble the pattern of the requested fuel. The pattern more closely resembles that of a heavier hydrocarbon mix.
- 18 BTEX and MTBE by EPA Method 8260.
- 19 Ethanol by EPA Method 8260 was reported as <50 ppb.
- 20 Ethanol by EPA Method 8260 was reported as <250 ppb.
- 21 Ethanol by EPA Method 8260 was reported as <500 ppb.
- 22 Laboratory report indicates the observed sample pattern is not typical of diesel/#2 fuel oil.

Table 2
Dissolved Oxygen Concentrations
Chevron Service Station #9-0121
3026 Lakeshore Avenue
Oakland, California

WELL ID	DATE	Before Purging (mg/L)	After Purging (mg/L)
MW-1	06/24/00 ¹	5.30	--
	09/07/00 ¹	4.02	--
	12/05/00 ¹	3.86	--
	03/01/01 ¹	3.04	--
	06/04/01 ¹	2.70	--
	09/10/01 ¹	2.40	--
	12/03/01 ¹	0.70	--
	03/04/02 ¹	1.10	--
	05/30/02 ¹	0.90	--
	09/03/02 ¹	1.20	--
	12/09/02 ¹	0.90	--
	03/10/03 ¹	1.00	--
	06/09/03 ¹	0.80	--
	09/08/03 ¹	0.60	--
12/08/03 ¹	2.00	--	

EXPLANATIONS:

(mg/L) = Milligrams per liter

-- = Not Measured

¹ ORC present in well.

Table 3
Groundwater Analytical Results
 Chevron Service Station #9-0121
 3026 Lakeshore Avenue
 Oakland, California

WELL ID/ DATE	Total Alkalinity (ppb)	Ferrous Iron (ppb)	Sulfate (ppb)	Nitrate (ppb)
MW-1 12/28/98	390,000	4,900	<1,000	<1,000
MW-3 12/28/98	980,000	4,500	390,000	<1,000
MW-4 12/28/98	670,000	3,500	6,800	<1,000
MW-5 12/28/98	480,000	15	51,000	<1,000
MW-6 12/28/98	2,400,000	810	110,000	<1,000
MW-7 12/28/98	350,000	12,000	79,000	<1,000
MW-8 12/28/98	1,100,000	45	87,000	<1,000

EXPLANATIONS:

Groundwater laboratory analytical results were compiled from reports prepared by Blaine Tech Services, Inc.

(ppb) = Parts per billion

STANDARD OPERATING PROCEDURE - GROUNDWATER SAMPLING

Gettler-Ryan Inc. field personnel adhere to the following procedures for the collection and handling of groundwater samples prior to analysis by the analytical laboratory. Prior to sample collection, the type of analysis to be performed is determined. Loss prevention of volatile compounds is controlled and sample preservation for subsequent analysis is maintained.

Prior to sampling, the presence or absence of free-phase hydrocarbons is determined using an interface probe. Product thickness, if present, is measured to the nearest 0.01 foot and is noted in the field notes. In addition, all depth to water level measurements are collected with a static water level indicator and are also recorded in the field notes, prior to purging and sampling any wells.

After water levels are collected and prior to sampling, if purging is to occur, each well is purged a minimum of three well casing volumes of water using pre-cleaned pumps (stack, suction, Grundfos), or disposable bailers. Temperature, pH and electrical conductivity are measured a minimum of three times during the purging. Purging continues until these parameters stabilize.

Groundwater samples are collected using disposable bailers. The water samples are transferred from the bailer into appropriate containers. Pre-preserved containers, supplied by analytical laboratories, are used when possible. When pre-preserved containers are not available, the laboratory is instructed to preserve the sample as appropriate. Duplicate samples are collected for the laboratory to use in maintaining quality assurance/quality control standards. The samples are labeled to include the job number, sample identification, collection date and time, analysis, preservation (if any), and the sample collector's initials. The water samples are placed in a cooler, maintained at 4°C for transport to the laboratory. Once collected in the field, all samples are maintained under chain of custody until delivered to the laboratory.

The chain of custody document includes the job number, type of preservation, if any, analysis requested, sample identification, date and time collected, and the sample collector's name. The chain of custody is signed and dated (including time of transfer) by each person who receives or surrenders the samples, beginning with the field personnel and ending with the laboratory personnel.

A laboratory supplied trip blank accompanies each sampling set. For sampling sets greater than 20 samples, 5% trip blanks are included. The trip blank is analyzed for some or all of the same compounds as the groundwater samples.

As requested by Chevron Products Company, the purge water and decontamination water generated during sampling activities is transported by IWM to McKittrick Waste Management located in McKittrick, California.



GETTLER - RYAN INC.

WELL MONITORING/SAMPLING FIELD DATA SHEET

Client/Facility #: ChevronTexaco #9-0121 Job Number: 386462
 Site Address: 3026 Lakeshore Avenue Event Date: 12/8/03 (inclusive)
 City: Oakland, CA Sampler: K. Kelly

Well ID: MW-1 Date Monitored: 12/8/03 Well Condition: OK
 Well Diameter: 2 1/4 in.
 Total Depth: 19.30 ft.
 Depth to Water: 4.45 ft.
14.85 xVF 0.66 = 9.80 x3 (case volume) = Estimated Purge Volume: 29.40 gal.

Volume	3/4" = 0.02	1" = 0.04	2" = 0.17	3" = 0.38
Factor (VF)	4" = 0.66	5" = 1.02	6" = 1.50	12" = 5.80

Purge Equipment:
 Disposable Bailer _____
 Stainless Steel Bailer _____
 Stack Pump _____
 Suction Pump
 Grundfos _____
 Other: _____

Sampling Equipment:
 Disposable Bailer
 Pressure Bailer _____
 Discrete Bailer _____
 Other: _____

Time Started: _____ (2400 hrs)
 Time Bailed: _____ (2400 hrs)
 Depth to Product: _____ ft
 Depth to Water: _____ ft
 Hydrocarbon Thickness: 0 ft
 Visual Confirmation/Description: _____
 Skimmer / Absorbant Sock (circle one) .
 Amt Removed from Skimmer: _____ gal
 Amt Removed from Well: _____ gal
 Product Transferred to: _____

Start Time (purge): 1456 Weather Conditions: Clear
 Sample Time/Date: 1515 12/8/03 Water Color: Clear Odor: Yes
 Purging Flow Rate: 5 gpm. Sediment Description: Floating black specs
 Did well de-water? No If yes, Time: _____ Volume: _____ gal.

Time (2400 hr.)	Volume (gal.)	pH	Conductivity (umhos/cm)	Temperature (°F)	D.O. (mg/L)	ORP (mV)
<u>1458</u>	<u>10.0</u>	<u>7.53</u>	<u>1388</u>	<u>19.0</u>	<u>2.0</u>	
<u>1501</u>	<u>20.0</u>	<u>7.40</u>	<u>1374</u>	<u>18.5</u>		
<u>1503</u>	<u>30.0</u>	<u>7.13</u>	<u>1485</u>	<u>19.1</u>		

LABORATORY INFORMATION

SAMPLE ID	(#) CONTAINER	REFRIG.	PRESERV. TYPE	LABORATORY	ANALYSES
MW-1	<u>6</u> x voc vial	YES	HCL	LANCASTER	TPH-G(8015)/BTEX+MTBE(8260)/ETHANOL(8260)
MW-1	<u>2</u> x amber	YES	NP	LANCASTER	TPH-D

COMMENTS: ORC in well

Add/Replaced Lock: _____ Add/Replaced Plug: _____ Size: _____



GETTLER - RYAN INC.

WELL MONITORING/SAMPLING FIELD DATA SHEET

Client/Facility #: ChevronTexaco #9-0121 Job Number: 386462
 Site Address: 3026 Lakeshore Avenue Event Date: 12/8/03 (inclusive)
 City: Oakland, CA Sampler: K. Kelly

Well ID: MW-2A Date Monitored: 12/8/03 Well Condition: OK
 Well Diameter: 2 1/4 in.
 Total Depth: 16.75 ft.
 Depth to Water: 5.19 ft.
11.56 xVF 0.17 = 1.96 x3 (case volume) = Estimated Purge Volume: 5.89 gal.

Volume	3/4" = 0.02	1" = 0.04	2" = 0.17	3" = 0.38
Factor (VF)	4" = 0.66	5" = 1.02	6" = 1.50	12" = 5.80

Purge Equipment:

Disposable Bailer
 Stainless Steel Bailer _____
 Stack Pump _____
 Suction Pump _____
 Grundfos _____
 Other: _____

Sampling Equipment:

Disposable Bailer
 Pressure Bailer _____
 Discrete Bailer _____
 Other: _____

Time Started: _____ (2400 hrs)
 Time Bailed: _____ (2400 hrs)
 Depth to Product: _____ ft
 Depth to Water: _____ ft
 Hydrocarbon Thickness: 0 ft
 Visual Confirmation/Description: _____
 Skimmer / Absorbant Sock (circle one)
 Amt Removed from Skimmer: _____ gal
 Amt Removed from Well: _____ gal
 Product Transferred to: _____

Start Time (purge): 1352 Weather Conditions: clear
 Sample Time/Date: 1405 12/8/03 Water Color: light yellow Odor: yes
 Purging Flow Rate: _____ gpm. Sediment Description: _____
 Did well de-water? no If yes, Time: _____ Volume: _____ gal.

Time (2400 hr.)	Volume (gal.)	pH	Conductivity (umhos/cm)	Temperature (°F)	D.O. (mg/L)	ORP (mV)
<u>1355</u>	<u>2.0</u>	<u>8.30</u>	<u>3999</u>	<u>18.3</u>	_____	_____
<u>1357</u>	<u>4.0</u>	<u>7.74</u>	<u>3999</u>	<u>18.6</u>	_____	_____
<u>1400</u>	<u>6.0</u>	<u>7.50</u>	<u>3999</u>	<u>18.7</u>	_____	_____
_____	_____	_____	_____	_____	_____	_____

LABORATORY INFORMATION

SAMPLE ID	(#) CONTAINER	REFRIG.	PRESERV. TYPE	LABORATORY	ANALYSES
<u>MW-2A</u>	<u>6</u> x vov vial	YES	HCL	LANCASTER	TPH-G(8015)/BTEX+MTBE(8260)/ETHANOL(8260)
<u>MW-2A</u>	<u>2</u> x amber	YES	NP	LANCASTER	TPH-D
_____	_____	_____	_____	_____	_____
_____	_____	_____	_____	_____	_____

COMMENTS:

Add/Replaced Lock: _____ Add/Replaced Plug: _____ Size: _____



GETTLER - RYAN INC.

WELL MONITORING/SAMPLING FIELD DATA SHEET

Client/Facility #: ChevronTexaco #9-0121 Job Number: 386462
 Site Address: 3026 Lakeshore Avenue Event Date: 12/8/03 (inclusive)
 City: Oakland, CA Sampler: K. Kelly

Well ID: MW-3A Date Monitored: 12/8/03 Well Condition: OK
 Well Diameter: 21.4 in.
 Total Depth: 18.05 ft.
 Depth to Water: 8.50 ft.
9.55 xVF 0.17 = 1.61 x3 (case volume) = Estimated Purge Volume: 4.84 gal.

Volume	3/4"= 0.02	1"= 0.04	2"= 0.17	3"= 0.38
Factor (VF)	4"= 0.66	5"= 1.02	6"= 1.50	12"= 5.80

Purge Equipment:
 Disposable Bailer
 Stainless Steel Bailer _____
 Stack Pump _____
 Suction Pump _____
 Grundfos _____
 Other: _____

Sampling Equipment:
 Disposable Bailer
 Pressure Bailer _____
 Discrete Bailer _____
 Other: _____

Time Started: _____ (2400 hrs)
 Time Bailed: _____ (2400 hrs)
 Depth to Product: _____ ft
 Depth to Water: _____ ft
 Hydrocarbon Thickness: 0 ft
 Visual Confirmation/Description: _____
 Skimmer / Absorbant Sock (circle one)
 Amt Removed from Skimmer: _____ gal
 Amt Removed from Well: _____ gal
 Product Transferred to: _____

Start Time (purge): 1249 Weather Conditions: clear
 Sample Time/Date: 1300 12/8/03 Water Color: clear Odor: NO
 Purging Flow Rate: _____ gpm. Sediment Description: _____
 Did well de-water? NO If yes, Time: _____ Volume: _____ gal.

Time (2400 hr.)	Volume (gal.)	pH	Conductivity (umhos/cm)	Temperature (°F)	D.O. (mg/L)	ORP (mV)
<u>1251</u>	<u>1.5</u>	<u>6.90</u>	<u>3999</u>	<u>16.6</u>	_____	_____
<u>1253</u>	<u>3.0</u>	<u>6.49</u>	<u>3999</u>	<u>19.0</u>	_____	_____
<u>1255</u>	<u>5.0</u>	<u>6.36</u>	<u>3999</u>	<u>19.8</u>	_____	_____
_____	_____	_____	_____	_____	_____	_____

LABORATORY INFORMATION

SAMPLE ID	(#) CONTAINER	REFRIG.	PRESERV. TYPE	LABORATORY	ANALYSES
<u>MW-3A</u>	<u>6</u> x voa vial	<u>YES</u>	<u>HCL</u>	<u>LANCASTER</u>	<u>TPH-G(8015)/BTX+MTBE(8260)/ETHANOL(8260)</u>
<u>MW-3A</u>	<u>2</u> x amber	<u>YES</u>	<u>NP</u>	<u>LANCASTER</u>	<u>TPH-D</u>
_____	_____	_____	_____	_____	_____
_____	_____	_____	_____	_____	_____

COMMENTS: _____

Add/Replaced Lock: Add/Replaced Plug: Size: 2"



GETTLER - RYAN INC.

WELL MONITORING/SAMPLING FIELD DATA SHEET

Client/Facility #: ChevronTexaco #9-0121 Job Number: 386462
 Site Address: 3026 Lakeshore Avenue Event Date: 12/8/03 (inclusive)
 City: Oakland, CA Sampler: R. Kelly

Well ID: MW-4A Date Monitored: 12/8/03 Well Condition: OK
 Well Diameter: 2 1/4 in.
 Total Depth: 18.55 ft.
 Depth to Water: 6.12 ft.
12.43 xVF 0.17 = 2.11 x3 (case volume) = Estimated Purge Volume: 6.33 gal.

Volume	3/4"= 0.02	1"= 0.04	2"= 0.17	3"= 0.38
Factor (VF)	4"= 0.66	5"= 1.02	6"= 1.50	12"= 5.80

Purge Equipment:
 Disposable Bailer
 Stainless Steel Bailer _____
 Stack Pump _____
 Suction Pump _____
 Grundfos _____
 Other: _____

Sampling Equipment:
 Disposable Bailer
 Pressure Bailer _____
 Discrete Bailer _____
 Other: _____

Time Started: _____ (2400 hrs)
 Time Bailed: _____ (2400 hrs)
 Depth to Product: _____ ft
 Depth to Water: _____ ft
 Hydrocarbon Thickness: 0 ft
 Visual Confirmation/Description: _____
 Skimmer / Absorbant Sock (circle one)
 Amt Removed from Skimmer: _____ gal
 Amt Removed from Well: _____ gal
 Product Transferred to: _____

Start Time (purge): 1325 Weather Conditions: clear
 Sample Time/Date: 1340 12/8/03 Water Color: light yellow Odor: YES
 Purging Flow Rate: _____ gpm. Sediment Description: _____
 Did well de-water? no If yes, Time: _____ Volume: _____ gal.

Time (2400 hr.)	Volume (gal.)	pH	Conductivity (u mhos/cm)	Temperature (°F)	D.O. (mg/L)	ORP (mV)
<u>1327</u>	<u>2.0</u>	<u>7.56</u>	<u>3999</u>	<u>17.0</u>	_____	_____
<u>1330</u>	<u>4.0</u>	<u>7.32</u>	<u>3999</u>	<u>17.1</u>	_____	_____
<u>1334</u>	<u>6.5</u>	<u>7.21</u>	<u>3999</u>	<u>15.7</u>	_____	_____
_____	_____	_____	_____	_____	_____	_____

LABORATORY INFORMATION

SAMPLE ID	(#) CONTAINER	REFRIG.	PRESERV. TYPE	LABORATORY	ANALYSES
<u>MW-4A</u>	<u>6</u> x vva vial	<u>YES</u>	<u>HCL</u>	<u>LANCASTER</u>	<u>TPH-G(8015)/BTEX+MTBE(8260)/ETHANOL(8260)</u>
<u>MW-4A</u>	<u>2</u> x amber	<u>YES</u>	<u>NP</u>	<u>LANCASTER</u>	<u>TPH-D</u>
_____	_____	_____	_____	_____	_____
_____	_____	_____	_____	_____	_____

COMMENTS: _____

Add/Replaced Lock: _____ Add/Replaced Plug: _____ Size: _____



GETTLER-RYAN INC.

WELL MONITORING/SAMPLING FIELD DATA SHEET

Client/Facility #: ChevronTexaco #9-0121 Job Number: 386462
 Site Address: 3026 Lakeshore Avenue Event Date: 12/8/03 (inclusive)
 City: Oakland, CA Sampler: K. Kelly

Well ID: MW-5 Date Monitored: 12/8/03 Well Condition: OK

Well Diameter: 2 1/4 in.
 Total Depth: 32.81 ft.
 Depth to Water: 11.13 ft.

Volume	3/4"= 0.02	1"= 0.04	2"= 0.17	3"= 0.38
Factor (VF)	4"= 0.66	5"= 1.02	6"= 1.50	12"= 5.80

xVF _____ = _____ x3 (case volume) = Estimated Purge Volume: _____ gal.

Purge Equipment:

Disposable Bailer _____
 Stainless Steel Bailer _____
 Stack Pump _____
 Suction Pump _____
 Grundfos _____
 Other: _____

Sampling Equipment:

Disposable Bailer _____
 Pressure Bailer _____
 Discrete Bailer _____
 Other: _____

Time Started: _____ (2400 hrs)
 Time Bailed: _____ (2400 hrs)
 Depth to Product: _____ ft
 Depth to Water: _____ ft
 Hydrocarbon Thickness: _____ ft
 Visual Confirmation/Description: _____
 Skimmer / Absorbant Sock (circle one)
 Amt Removed from Skimmer: _____ gal
 Amt Removed from Well: _____ gal
 Product Transferred to: _____

Start Time (purge): _____ Weather Conditions: Clear
 Sample Time/Date: 1 Water Color: _____ Odor: _____
 Purging Flow Rate: _____ gpm. Sediment Description: _____
 Did well de-water? _____ If yes, Time: _____ Volume: _____ gal.

Time (2400 hr.)	Volume (gal.)	pH	Conductivity (umhos/cm)	Temperature (C/F)	D.O. (mg/L)	ORP (mV)

LABORATORY INFORMATION

SAMPLE ID	(#) CONTAINER	REF.BJG.	PRESERV. TYPE	LABORATORY	ANALYSES
MW-	x voa vial	YES	HCL	LANCASTER	TPH-G(8015)/BTEX+MTBE(8260)/ETHANOL(8260)
MW-	x amber	YES	NP	LANCASTER	TPH-D

COMMENTS: M. Kelly

Add/Replaced Lock:

Add/Replaced Plug: _____ Size: _____



GETTLER - RYAN INC.

WELL MONITORING/SAMPLING FIELD DATA SHEET

Client/Facility #: ChevronTexaco #9-0121
 Site Address: 3026 Lakeshore Avenue
 City: Oakland, CA

Job Number: 386462
 Event Date: 12/8/03 (inclusive)
 Sampler: R. Kelly

Well ID: MW-6
 Well Diameter: 2 1/4 in.
 Total Depth: 18.41 ft.
 Depth to Water: 5.24 ft.

Date Monitored: 12/8/03 Well Condition: OK - See Picture -

Volume	3/4" = 0.02	1" = 0.04	2" = 0.17	3" = 0.38
Factor (VF)	4" = 0.66	5" = 1.02	6" = 1.50	12" = 5.80

xVF _____ = _____ x3 (case volume) = Estimated Purge Volume: _____ gal.

Purge Equipment:

Disposable Bailer _____
 Stainless Steel Bailer _____
 Stack Pump _____
 Suction Pump _____
 Grundfos _____
 Other: _____

Sampling Equipment:

Disposable Bailer _____
 Pressure Bailer _____
 Discrete Bailer _____
 Other: _____

Time Started: _____ (2400 hrs)
 Time Bailed: _____ (2400 hrs)
 Depth to Product: _____ ft
 Depth to Water: _____ ft
 Hydrocarbon Thickness: 0 ft
 Visual Confirmation/Description:
 Skimmer / Absorbant Sock (circle one)
 Amt Removed from Skimmer: _____ gal
 Amt Removed from Well: _____ gal
 Product Transferred to: _____

Start Time (purge): _____ Weather Conditions: clear
 Sample Time/Date: 1 Water Color: _____ Odor: _____
 Purging Flow Rate: gpm. Sediment Description: _____
 Did well de-water? _____ If yes, Time: _____ Volume: _____ gal.

Time (2400 hr.)	Volume (gal.)	pH	Conductivity (umhos/cm)	Temperature (C/F)	D.O. (mg/L)	ORP (mV)
_____	_____	_____	_____	_____	_____	_____
_____	_____	_____	_____	_____	_____	_____
_____	_____	_____	_____	_____	_____	_____
_____	_____	_____	_____	_____	_____	_____

LABORATORY INFORMATION

SAMPLE ID	(#) CONTAINER	REFRIG.	PRESERV. TYPE	LABORATORY	ANALYSES
MW-	x vial	YES	HCL	LANCASTER	TPH-G(8015)/BTEX+MTBE(8260)/ETHANOL(8260)
MW-	x amber	YES	NP	LANCASTER	TPH-D

COMMENTS: M. Kelly See Picture well is cut too flush with bottom of well box casing

Add/Replaced Lock: _____ Add/Replaced Plug: _____ Size: _____



GETTLER - RYAN INC.

WELL MONITORING/SAMPLING FIELD DATA SHEET

Client/Facility #: ChevronTexaco #9-0121
 Site Address: 3026 Lakeshore Avenue
 City: Oakland, CA

Job Number: 386462
 Event Date: 12/8/03 (inclusive)
 Sampler: K. Kelly

Well ID: MW-7
 Well Diameter: 2 1/4 in.
 Total Depth: 14.05 ft.
 Depth to Water: 2.45 ft.

Date Monitored: 12/8/03

Well Condition: OK

Volume	3/4"= 0.02	1"= 0.04	2"= 0.17	3"= 0.38
Factor (VF)	4"= 0.66	5"= 1.02	6"= 1.50	12"= 5.80

xVF _____ = _____ x3 (case volume) = Estimated Purge Volume: _____ gal.

Purge Equipment:

- Disposable Bailer _____
- Stainless Steel Bailer _____
- Stack Pump _____
- Suction Pump _____
- Grundfos _____
- Other: _____

Sampling Equipment:

- Disposable Bailer _____
- Pressure Bailer _____
- Discrete Bailer _____
- Other: _____

Time Started:	_____ (2400 hrs)
Time Bailed:	_____ (2400 hrs)
Depth to Product:	_____ ft
Depth to Water:	_____ ft
Hydrocarbon Thickness:	_____ ft
Visual Confirmation/Description:	_____
Skimmer / Absorbant Sock (circle one)	_____
Amt Removed from Skimmer:	_____ gal
Amt Removed from Well:	_____ gal
Product Transferred to:	_____

Start Time (purge): _____ Weather Conditions: clear
 Sample Time/Date: _____ / _____ Water Color: _____ Odor: _____
 Purging Flow Rate: _____ gpm. Sediment Description: _____
 Did well de-water? _____ If yes, Time: _____ Volume: _____ gal.

Time (2400 hr.)	Volume (gal.)	pH	Conductivity (umhos/cm)	Temperature (C/F)	D.O. (mg/L)	ORP (mV)
_____	_____	_____	_____	_____	_____	_____
_____	_____	_____	_____	_____	_____	_____
_____	_____	_____	_____	_____	_____	_____
_____	_____	_____	_____	_____	_____	_____
_____	_____	_____	_____	_____	_____	_____

LABORATORY INFORMATION

SAMPLE ID	(#) CONTAINER	REFRIG.	PRESERV. TYPE	LABORATORY	ANALYSES
MW-	x voa vial	YES	HCL	LANCASTER	TPH-G(8015)/BTEX+MTBE(8260)/ETHANOL(8260)
MW-	x amber	YES	NP	LANCASTER	TPH-D

COMMENTS: M. Kelly

Add/Replaced Lock: _____

Add/Replaced Plug: _____ Size: _____



GETTLER - RYAN INC.

WELL MONITORING/SAMPLING FIELD DATA SHEET

Client/Facility #: ChevronTexaco #9-0121 Job Number: 386462
 Site Address: 3026 Lakeshore Avenue Event Date: 12/8/03 (inclusive)
 City: Oakland, CA Sampler: K. Kelly

Well ID: MW-8 Date Monitored: 12/8/03 Well Condition: OK
 Well Diameter: 2 1/4 in. Total Depth: 24.92 ft. Depth to Water: 8.17 ft.

Volume	3/4"= 0.02	1"= 0.04	2"= 0.17	3"= 0.38
Factor (VF)	4"= 0.66	5"= 1.02	6"= 1.50	12"= 5.80

xVF _____ = _____ x3 (case volume) = Estimated Purge Volume: _____ gal.

Purge Equipment:

Disposable Bailer _____
 Stainless Steel Bailer _____
 Stack Pump _____
 Suction Pump _____
 Grundfos _____
 Other: _____

Sampling Equipment:

Disposable Bailer _____
 Pressure Bailer _____
 Discrete Bailer _____
 Other: _____

Time Started:	_____ (2400 hrs)
Time Bailed:	_____ (2400 hrs)
Depth to Product:	_____ ft
Depth to Water:	_____ ft
Hydrocarbon Thickness:	<u>0</u> ft
Visual Confirmation/Description:	_____
Skimmer / Absorbant Sock (circle one)	_____
Amt Removed from Skimmer:	_____ gal
Amt Removed from Well:	_____ gal
Product Transferred to:	_____

Start Time (purge): _____ Weather Conditions: clear
 Sample Time/Date: / Water Color: _____ Odor: _____
 Purging Flow Rate: _____ gpm. Sediment Description: _____
 Did well de-water? _____ If yes, Time: _____ Volume: _____ gal.

Time (2400 hr.)	Volume (gal.)	pH	Conductivity (u mhos/cm)	Temperature (C/F)	D.O. (mg/L)	ORP (mV)
_____	_____	_____	_____	_____	_____	_____
_____	_____	_____	_____	_____	_____	_____
_____	_____	_____	_____	_____	_____	_____
_____	_____	_____	_____	_____	_____	_____

LABORATORY INFORMATION

SAMPLE ID	(#) CONTAINER	REFRIG.	PRESERV. TYPE	LABORATORY	ANALYSES
MW-	x voa vial	YES	HCL	LANCASTER	TPH-G(8015)/BTEX+MTBE(8260)/ETHANOL(8260)
MW-	x amber	YES	NP	LANCASTER	TPH-D

COMMENTS: M. Kelly

Add/Replaced Lock: _____ Add/Replaced Plug: _____ Size: _____



GETTLER-RYAN INC.

WELL MONITORING/SAMPLING FIELD DATA SHEET

Client/Facility #: ChevronTexaco #9-0121 Job Number: 386462
 Site Address: 3026 Lakeshore Avenue Event Date: 12/8/03 (inclusive)
 City: Oakland, CA Sampler: K. Kelly

Well ID: MW-9 Date Monitored: 12/8/03 Well Condition: OK
 Well Diameter: (2) 1 4 in.
 Total Depth: 15.65 ft.
 Depth to Water: 3.66 ft.
11.99 xVF 0.17 = 2.03 x3 (case volume) = Estimated Purge Volume: 6.11 gal.

Volume	3/4"= 0.02	1"= 0.04	2"= 0.17	3"= 0.38
Factor (VF)	4"= 0.66	5"= 1.02	6"= 1.50	12"= 5.80

Purge Equipment:
 Disposable Bailer
 Stainless Steel Bailer _____
 Stack Pump _____
 Suction Pump _____
 Grundfos _____
 Other: _____

Sampling Equipment:
 Disposable Bailer
 Pressure Bailer _____
 Discrete Bailer _____
 Other: _____

Time Started: _____ (2400 hrs)
 Time Bailed: _____ (2400 hrs)
 Depth to Product: _____ ft
 Depth to Water: _____ ft
 Hydrocarbon Thickness: 0 ft
 Visual Confirmation/Description:
 Skimmer / Absorbant Sock (circle one)
 Amt Removed from Skimmer: _____ gal
 Amt Removed from Well: _____ gal
 Product Transferred to: _____

Start Time (purge): 1416 Weather Conditions: clear
 Sample Time/Date: 1430 12/8/03 Water Color: clear Odor: yes
 Purging Flow Rate: _____ gpm. Sediment Description: _____
 Did well de-water? no If yes, Time: _____ Volume: _____ gal.

Time (2400 hr.)	Volume (gal.)	pH	Conductivity (umhos/cm)	Temperature (°F)	D.O. (mg/L)	ORP (mV)
<u>1418</u>	<u>2.0</u>	<u>8.56</u>	<u>1386</u>	<u>17.2</u>	_____	_____
<u>1422</u>	<u>4.0</u>	<u>7.10</u>	<u>1254</u>	<u>16.7</u>	_____	_____
<u>1425</u>	<u>6.0</u>	<u>7.71</u>	<u>1458</u>	<u>15.4</u>	_____	_____
_____	_____	_____	_____	_____	_____	_____
_____	_____	_____	_____	_____	_____	_____

LABORATORY INFORMATION

SAMPLE ID	(#) CONTAINER	REFRIG.	PRESERV. TYPE	LABORATORY	ANALYSES
<u>MW-9</u>	<u>6</u> x vov vial	<u>YES</u>	<u>HCL</u>	<u>LANCASTER</u>	<u>TPH-G(8015)/BTEX+MTBE(8260)/ETHANOL(8260)</u>
<u>MW-9</u>	<u>2</u> x amber	<u>YES</u>	<u>NP</u>	<u>LANCASTER</u>	<u>TPH-D</u>
_____	_____	_____	_____	_____	_____
_____	_____	_____	_____	_____	_____

COMMENTS: _____

Add/Replaced Lock: _____ Add/Replaced Plug: _____ Size: _____

Chevron California Region Analysis Request/Chain of Custody



120803-010

Acct. #: 10904 For Lancaster Laboratories use only
 Sample #: 41-79-109-14

SCR#: Gr # 877642

Facility #: SS#9-0121 G-R#386462 Global ID#T0600100328
 Site Address: 3026 LAKESHORE AVENUE, OAKLAND, CA
 Chevron PM: KS Lead Consultant: CAMBRIA
 Consultant/Office: G-R, Inc., 6747 Sierra Court, Suite J, Dublin, Ca. 94568
 Consultant Prj. Mgr.: Deanna L. Harding (deanna@grinc.com)
 Consultant Phone #: 925-551-7555 Fax #: 925-551-7899
 Sampler: Kristina Kelly
 Service Order #: _____ Non SAR: _____

Matrix		Analyses Requested									
Potable	NPDES	Preservation Codes									
<input type="checkbox"/>	<input type="checkbox"/>	<u>H</u>	<u>H</u>								
<input type="checkbox"/>	<input type="checkbox"/>	BTEX + MTBE 8260 <input checked="" type="checkbox"/>	TPH 8015 MOD GRO	TPH 8015 MOD DRO	<input type="checkbox"/> Silica Gel Cleanup	8260 Full scan	Oxygenates	Lead 7420 <input type="checkbox"/>	7421 <input type="checkbox"/>	<u>ETHANOL (P260)</u>	

Preservative Codes
 H = HCl T = Thiosulfate
 N = HNO₃ B = NaOH
 S = H₂SO₄ O = Other

J value reporting needed
 Must meet lowest detection limits possible for 8260 compounds

8021 MTBE Confirmation
 Confirm highest hit by 8260
 Confirm all hits by 8260
 Run ___ oxy s on highest hit
 Run ___ oxy s on all hits

Sample Identification	Date Collected	Time Collected	Grab	Composite	Soil	Water	Oil	Air	Total Number of Containers	BTEX + MTBE 8260	TPH 8015 MOD GRO	TPH 8015 MOD DRO	8260 Full scan	Oxygenates	Lead 7420	7421
<u>QA</u>	<u>12-8-03</u>					<u>W</u>			<u>2</u>	<u>X</u>	<u>X</u>					
<u>MW-1</u>		<u>1515</u>	<u>X</u>						<u>8</u>	<u>X</u>	<u>X</u>	<u>X</u>				<u>X</u>
<u>MW-2A</u>		<u>1405</u>	<u>X</u>						<u>8</u>	<u>X</u>	<u>X</u>	<u>X</u>				<u>X</u>
<u>MW-3A</u>		<u>1300</u>	<u>X</u>						<u>8</u>	<u>X</u>	<u>X</u>	<u>X</u>				<u>X</u>
<u>MW-4A</u>		<u>1340</u>	<u>X</u>						<u>8</u>	<u>X</u>	<u>X</u>	<u>X</u>				<u>X</u>
<u>MW-9</u>	<u>✓</u>	<u>1430</u>	<u>X</u>						<u>8</u>	<u>X</u>	<u>X</u>	<u>X</u>				<u>X</u>

Comments / Remarks

Turnaround Time Requested (TAT) (please circle)
 STD TAT 72 hour 48 hour
 24 hour 4 day 5 day

Data Package Options (please circle if required)
 QC Summary Type I — Full
 Type VI (Raw Data) Coelt Deliverable not needed
 WIP (RWQCB)
 Disk

Relinquished by: <u>Kristina Kelly</u>	Date: <u>12/8/03</u>	Time: <u>1600</u>	Received by: <u>Bernardo Amaya</u>	Date: <u>12/8/03</u>	Time: <u>1605</u>
Relinquished by: <u>Bernardo Amaya</u>	Date: <u>12/8/03</u>	Time: <u>1730</u>	Received by: <u>Airborne</u>	Date: <u>12/8/03</u>	Time: _____
Relinquished by: _____	Date: _____	Time: _____	Received by: _____	Date: _____	Time: _____
Relinquished by Commercial Carrier: UPS FedEx Other: <u>Airborne</u>	Received by: <u>Deni ytkan</u>			Date: <u>12/18/03</u>	Time: <u>1000</u>
Temperature Upon Receipt: <u>2.5°C</u>	Custody Seals Intact? <input checked="" type="checkbox"/> Yes <input type="checkbox"/> No				

ANALYTICAL RESULTS

Prepared for:

ChevronTexaco
6001 Bollinger Canyon Rd L4310
San Ramon CA 94583

925-842-8582

Prepared by:

Lancaster Laboratories
2425 New Holland Pike
Lancaster, PA 17605-2425

SAMPLE GROUP

The sample group for this submittal is 877642. Samples arrived at the laboratory on Tuesday, December 09, 2003. The PO# for this group is 99011184 and the release number is STREICH.

<u>Client Description</u>			<u>Lancaster Labs Number</u>
QA-T-031208	NA	Water	4179709
MW-1-W-031208	Grab	Water	4179710
MW-2A-W-031208	Grab	Water	4179711
MW-3A-W-031208	Grab	Water	4179712
MW-4A-W-031208	Grab	Water	4179713
MW-9-W-031208	Grab	Water	4179714

1 COPY TO
ELECTRONIC
COPY TO

Cambria C/O Gettler- Ryan
Gettler-Ryan

Attn: Deanna L. Harding
Attn: Cheryl Hansen

Questions? Contact your Client Services Representative
Teresa L. Cunningham at (717) 656-2300.

Respectfully Submitted,



Susan M. Croyle
Senior Chemist, Coordinator

Lancaster Laboratories Sample No. **WW 4179709**

 QA-T-031208 NA Water
 Facility# 90121 Job# 386462 GRD
 3026 Lakeshore, Oakland T0600100328 QA
 Collected: 12/08/2003 00:00

Account Number: 10904

 Submitted: 12/09/2003 10:10
 Reported: 12/23/2003 at 16:30
 Discard: 01/23/2004

 ChevronTexaco
 6001 Bollinger Canyon Rd L4310
 San Ramon CA 94583

LAKEQ

CAT No.	Analysis Name	CAS Number	As Received Result	As Received Method Detection Limit	Units	Dilution Factor
01728	TPH-GRO - Waters	n.a.	N.D.	50.	ug/l	1
The reported concentration of TPH-GRO does not include MTBE or other gasoline constituents eluting prior to the C6 (n-hexane) TPH-GRO range start time.						
06054	BTEX+MTBE by 8260B					
02010	Methyl Tertiary Butyl Ether	1634-04-4	N.D.	0.5	ug/l	1
05401	Benzene	71-43-2	N.D.	0.5	ug/l	1
05407	Toluene	108-88-3	N.D.	0.5	ug/l	1
05415	Ethylbenzene	100-41-4	N.D.	0.5	ug/l	1
06310	Xylene (Total)	1330-20-7	N.D.	0.5	ug/l	1
A site-specific MSD sample was not submitted for the project. A LCS/LCSD was performed to demonstrate precision and accuracy at a batch level.						

State of California Lab Certification No. 2116

Laboratory Chronicle

CAT No.	Analysis Name	Method	Trial#	Analysis		Analyst	Dilution Factor
				Date and Time			
01728	TPH-GRO - Waters	N. CA LUFT Gasoline	1	12/10/2003	20:04	Michael F Barrow	1
06054	BTEX+MTBE by 8260B	SW-846 8260B	1	12/13/2003	09:25	Anastasia Papadopoulos	1
01146	GC VOA Water Prep	SW-846 5030B	1	12/10/2003	20:04	Michael F Barrow	n.a.
01163	GC/MS VOA Water Prep	SW-846 5030B	1	12/13/2003	09:25	Anastasia Papadopoulos	n.a.

Lancaster Laboratories Sample No. WW 4179710

 MW-1-W-031208 Grab Water
 Facility# 90121 Job# 386462 GRD
 3026 Lakeshore, Oakland T0600100328 MW-1
 Collected: 12/08/2003 15:15 by KK

Account Number: 10904

 Submitted: 12/09/2003 10:10
 Reported: 12/23/2003 at 16:30
 Discard: 01/23/2004

 ChevronTexaco
 6001 Bollinger Canyon Rd L4310
 San Ramon CA 94583

LAKE1

CAT No.	Analysis Name	CAS Number	As Received Result	As Received Method Detection Limit	Units	Dilution Factor
01728	TPH-GRO - Waters	n.a.	2,200.	50.	ug/l	1
The reported concentration of TPH-GRO does not include MTBE or other gasoline constituents eluting prior to the C6 (n-hexane) TPH-GRO range start time. An elevated surrogate recovery was observed. The analysis was repeated and an elevated surrogate recovery was again observed indicating a significant matrix effect.						
05553	TPH - DRO CA LUFT (Waters)	n.a.	3,400.	250.	ug/l	10
According to the California LUFT Protocol, the quantitation for Diesel Range Organics was performed by peak area comparison of the sample pattern to that of our #2 fuel oil reference standard (between C10 and C28 normal hydrocarbons). Site-specific MS/MSD samples were not submitted for the project. A LCS/LCSD was performed to demonstrate precision and accuracy at a batch level.						
01594	BTEX+5 Oxygenates+EDC+EDB+ETOH					
01587	Ethanol	64-17-5	N.D.	50.	ug/l	1
02010	Methyl Tertiary Butyl Ether	1634-04-4	160.	0.5	ug/l	1
05401	Benzene	71-43-2	8.	0.5	ug/l	1
05407	Toluene	108-88-3	4.	0.5	ug/l	1
05415	Ethylbenzene	100-41-4	3.	0.5	ug/l	1
06310	Xylene (Total)	1330-20-7	8.	0.5	ug/l	1

State of California Lab Certification No. 2116

Laboratory Chronicle

CAT No.	Analysis Name	Method	Trial#	Analysis Date and Time	Analyst	Dilution Factor
01728	TPH-GRO - Waters	N. CA LUFT Gasoline Method	1	12/10/2003 21:11	Michael F Barrow	1
05553	TPH - DRO CA LUFT (Waters)	CALUFT-DRO/8015B, Modified	1	12/19/2003 04:14	Tracy A Cole	10
01594	BTEX+5 Oxygenates+EDC+EDB+ETOH	SW-846 8260B	1	12/12/2003 00:58	Elizabeth M Taylor	1
01146	GC VOA Water Prep	SW-846 5030B	1	12/10/2003 21:11	Michael F Barrow	n.a.
01163	GC/MS VOA Water Prep	SW-846 5030B	1	12/12/2003 00:58	Elizabeth M Taylor	n.a.
02135	Extraction - DRO Water Special	TPH by CA LUFT	1	12/10/2003 10:45	Danette S Blystone	1

Lancaster Laboratories Sample No. **WW 4179711**

 MW-2A-W-031208 **Grab** **Water**
 Facility# 90121 Job# 386462 **GRD**
 3026 Lakeshore, Oakland T0600100328 MW-2A
 Collected: 12/08/2003 14:05 by KK

Account Number: 10904

 Submitted: 12/09/2003 10:10
 Reported: 12/23/2003 at 16:30
 Discard: 01/23/2004

 ChevronTexaco
 6001 Bollinger Canyon Rd L4310
 San Ramon CA 94583

LAK2A

CAT No.	Analysis Name	CAS Number	As Received Result	As Received Method Detection Limit	Units	Dilution Factor
01728	TPH-GRO - Waters	n.a.	480.	100.	ug/l	2
The reported concentration of TPH-GRO does not include MTBE or other gasoline constituents eluting prior to the C6 (n-hexane) TPH-GRO range start time.						
05553	TPH - DRO CA LUFT (Waters)	n.a.	3,100.	240.	ug/l	10
According to the California LUFT Protocol, the quantitation for Diesel Range Organics was performed by peak area comparison of the sample pattern to that of our #2 fuel oil reference standard (between C10 and C28 normal hydrocarbons). Site-specific MS/MSD samples were not submitted for the project. A LCS/LCSD was performed to demonstrate precision and accuracy at a batch level.						
01594	BTEX+5 Oxygenates+EDC+EDB+ETOH					
01587	Ethanol	64-17-5	N.D.	500.	ug/l	10
02010	Methyl Tertiary Butyl Ether	1634-04-4	6,500.	50.	ug/l	100
05401	Benzene	71-43-2	N.D.	5.	ug/l	10
05407	Toluene	108-88-3	N.D.	5.	ug/l	10
05415	Ethylbenzene	100-41-4	N.D.	5.	ug/l	10
06310	Xylene (Total)	1330-20-7	N.D.	5.	ug/l	10
Due to the level of methyl tertiary butyl ether, the reporting limits for all GC/MS volatile compounds were raised.						

State of California Lab Certification No. 2116

Laboratory Chronicle

CAT No.	Analysis Name	Method	Trial#	Analysis		Analyst	Dilution Factor
				Date and Time			
01728	TPH-GRO - Waters	N. CA LUFT Gasoline Method	1	12/10/2003	20:37	Michael F Barrow	2
05553	TPH - DRO CA LUFT (Waters)	CALUFT-DRO/8015B, Modified	1	12/19/2003	04:36	Tracy A Cole	10
01594	BTEX+5 Oxygenates+EDC+EDB+ETOH	SW-846 8260B	1	12/12/2003	01:40	Elizabeth M Taylor	10
01594	BTEX+5 Oxygenates+EDC+EDB+ETOH	SW-846 8260B	1	12/12/2003	02:02	Elizabeth M Taylor	100
01146	GC VOA Water Prep	SW-846 5030B	1	12/10/2003	20:37	Michael F Barrow	n.a.
01163	GC/MS VOA Water Prep	SW-846 5030B	1	12/12/2003	01:40	Elizabeth M Taylor	n.a.
02135	Extraction - DRO Water Special	TPH by CA LUFT	1	12/10/2003	10:45	Danette S Blystone	1

Lancaster Laboratories Sample No. WW 4179712

 MW-3A-W-031208 Grab Water GRD
 Facility# 90121 Job# 386462
 3026 Lakeshore, Oakland T0600100328 MW-3A
 Collected: 12/08/2003 13:00 by KK

Account Number: 10904

 Submitted: 12/09/2003 10:10
 Reported: 12/23/2003 at 16:30
 Discard: 01/23/2004

 ChevronTexaco
 6001 Bollinger Canyon Rd L4310
 San Ramon CA 94583

LAK3A

CAT No.	Analysis Name	CAS Number	As Received Result	As Received Method Detection Limit	Units	Dilution Factor
01728	TPH-GRO - Waters	n.a.	N.D.	50.	ug/l	1
The reported concentration of TPH-GRO does not include MTBE or other gasoline constituents eluting prior to the C6 (n-hexane) TPH-GRO range start time.						
05553	TPH - DRO CA LUFT (Waters)	n.a.	74.	50.	ug/l	1
According to the California LUFT Protocol, the quantitation for Diesel Range Organics was performed by peak area comparison of the sample pattern to that of our #2 fuel oil reference standard (between C10 and C28 normal hydrocarbons). Site-specific MS/MSD samples were not submitted for the project. A LCS/LCSD was performed to demonstrate precision and accuracy at a batch level. The observed sample pattern is not typical of diesel/#2 fuel oil.						
01594	BTEX+5 Oxygenates+EDC+EDB+ETOH					
01587	Ethanol	64-17-5	N.D.	50.	ug/l	1
02010	Methyl Tertiary Butyl Ether	1634-04-4	23.	0.5	ug/l	1
05401	Benzene	71-43-2	N.D.	0.5	ug/l	1
05407	Toluene	108-88-3	N.D.	0.5	ug/l	1
05415	Ethylbenzene	100-41-4	N.D.	0.5	ug/l	1
06310	Xylene (Total)	1330-20-7	N.D.	0.5	ug/l	1

State of California Lab Certification No. 2116

Laboratory Chronicle

CAT No.	Analysis Name	Method	Trial#	Analysis Date and Time	Analyst	Dilution Factor
01728	TPH-GRO - Waters	N. CA LUFT Gasoline	1	12/11/2003 06:07	Todd T Smythe	1
05553	TPH - DRO CA LUFT (Waters)	Method CALUFT-DRO/8015B, Modified	1	12/19/2003 00:08	Tracy A Cole	1
01594	BTEX+5 Oxygenates+EDC+EDB+ETOH	SW-846 8260B	1	12/12/2003 02:23	Elizabeth M Taylor	1
01146	GC VOA Water Prep	SW-846 5030B	1	12/11/2003 06:07	Todd T Smythe	n.a.
01163	GC/MS VOA Water Prep	SW-846 5030B	1	12/12/2003 02:23	Elizabeth M Taylor	n.a.
02135	Extraction - DRO Water Special	TPH by CA LUFT	1	12/10/2003 10:45	Danette S Blystone	1

Lancaster Laboratories Sample No. **WW 4179713**

 MW-4A-W-031208 Grab Water
 Facility# 90121 Job# 386462 GRD
 3026 Lakeshore, Oakland T0600100328 MW-4A
 Collected: 12/08/2003 13:40 by KK

Account Number: 10904

 Submitted: 12/09/2003 10:10
 Reported: 12/23/2003 at 16:30
 Discard: 01/23/2004

 ChevronTexaco
 6001 Bollinger Canyon Rd L4310
 San Ramon CA 94583

LAK4A

CAT No.	Analysis Name	CAS Number	As Received Result	As Received Method Detection Limit	Units	Dilution Factor
01728	TPH-GRO - Waters	n.a.	360.	50.	ug/l	1
	The reported concentration of TPH-GRO does not include MTBE or other gasoline constituents eluting prior to the C6 (n-hexane) TPH-GRO range start time.					
05553	TPH - DRO CA LUFT (Waters)	n.a.	2,500.	120.	ug/l	5
	According to the California LUFT Protocol, the quantitation for Diesel Range Organics was performed by peak area comparison of the sample pattern to that of our #2 fuel oil reference standard (between C10 and C28 normal hydrocarbons). Site-specific MS/MSD samples were not submitted for the project. A LCS/LCSD was performed to demonstrate precision and accuracy at a batch level.					
01594	BTEX+5 Oxygenates+EDC+EDB+ETOH					
01587	Ethanol	64-17-5	N.D.	250.	ug/l	5
02010	Methyl Tertiary Butyl Ether	1634-04-4	3,200.	25.	ug/l	50
05401	Benzene	71-43-2	3.	3.	ug/l	5
05407	Toluene	108-88-3	N.D.	3.	ug/l	5
05415	Ethylbenzene	100-41-4	N.D.	3.	ug/l	5
06310	Xylene (Total)	1330-20-7	N.D.	3.	ug/l	5
	Due to the level of methyl tertiary butyl ether, the reporting limits for all GC/MS volatile compounds were raised.					

State of California Lab Certification No. 2116

Laboratory Chronicle

CAT No.	Analysis Name	Method	Trial#	Analysis Date and Time	Analyst	Dilution Factor
01728	TPH-GRO - Waters	N. CA LUFT Gasoline	1	12/11/2003 06:40	Todd T Smythe	1
05553	TPH - DRO CA LUFT (Waters)	Method CALUFT-DRO/8015B, Modified	1	12/19/2003 12:36	Tracy A Cole	5
01594	BTEX+5 Oxygenates+EDC+EDB+ETOH	SW-846 8260B	1	12/12/2003 02:44	Elizabeth M Taylor	5
01594	BTEX+5 Oxygenates+EDC+EDB+ETOH	SW-846 8260B	1	12/12/2003 03:05	Elizabeth M Taylor	50
01146	GC VOA Water Prep	SW-846 5030B	1	12/11/2003 06:40	Todd T Smythe	n.a.
01163	GC/MS VOA Water Prep	SW-846 5030B	1	12/12/2003 02:44	Elizabeth M Taylor	n.a.
02135	Extraction - DRO Water Special	TPH by CA LUFT	1	12/10/2003 10:45	Danette S Blystone	1

Lancaster Laboratories Sample No. **WW 4179714**

 MW-9-W-031208 **Grab Water**
 Facility# 90121 Job# 386462 **GRD**
 3026 Lakeshore, Oakland T0600100328 MW-9
 Collected: 12/08/2003 14:30 by KK

Account Number: 10904

 Submitted: 12/09/2003 10:10
 Reported: 12/23/2003 at 16:30
 Discard: 01/23/2004

 ChevronTexaco
 6001 Bollinger Canyon Rd L4310
 San Ramon CA 94583

LAKE9

CAT No.	Analysis Name	CAS Number	As Received Result	As Received Method Detection Limit	Units	Dilution Factor
01728	TPH-GRO - Waters	n.a.	2,400.	250.	ug/l	5
	The reported concentration of TPH-GRO does not include MTBE or other gasoline constituents eluting prior to the C6 (n-hexane) TPH-GRO range start time.					
05553	TPH - DRO CA LUFT (Waters)	n.a.	2,500.	250.	ug/l	10
	According to the California LUFT Protocol, the quantitation for Diesel Range Organics was performed by peak area comparison of the sample pattern to that of our #2 fuel oil reference standard (between C10 and C28 normal hydrocarbons). Site-specific MS/MSD samples were not submitted for the project. A LCS/LCSD was performed to demonstrate precision and accuracy at a batch level.					
01594	BTEX+5 Oxygenates+EDC+EDB+ETOH					
01587	Ethanol	64-17-5	N.D.	50.	ug/l	1
02010	Methyl Tertiary Butyl Ether	1634-04-4	560.	5.	ug/l	10
05401	Benzene	71-43-2	3.	0.5	ug/l	1
05407	Toluene	108-88-3	3.	0.5	ug/l	1
05415	Ethylbenzene	100-41-4	3.	0.5	ug/l	1
06310	Xylene (Total)	1330-20-7	4.	0.5	ug/l	1

State of California Lab Certification No. 2116

Laboratory Chronicle

CAT No.	Analysis Name	Method	Trial#	Analysis Date and Time	Analyst	Dilution Factor
01728	TPH-GRO - Waters	N. CA LUFT Gasoline	1	12/11/2003 07:13	Todd T Smythe	5
05553	TPH - DRO CA LUFT (Waters)	Method CALUFT-DRO/8015B, Modified	1	12/19/2003 17:19	Tracy A Cole	10
01594	ETEX+5 Oxygenates+EDC+EDB+ETOH	SW-846 8260B	1	12/12/2003 03:26	Elizabeth M Taylor	1
01594	ETEX+5 Oxygenates+EDC+EDB+ETOH	SW-846 8260B	1	12/12/2003 03:48	Elizabeth M Taylor	10
01146	GC VOA Water Prep	SW-846 5030B	1	12/11/2003 07:13	Todd T Smythe	n.a.
01163	GC/MS VOA Water Prep	SW-846 5030B	1	12/12/2003 03:26	Elizabeth M Taylor	n.a.
02135	Extraction - DRO Water Special	TPH by CA LUFT	1	12/12/2003 08:30	Danette S Blystone	1

Quality Control Summary

 Client Name: ChevronTexaco
 Reported: 12/23/03 at 04:30 PM

Group Number: 877642

Laboratory Compliance Quality Control

<u>Analysis Name</u>	<u>Blank Result</u>	<u>Blank MDL</u>	<u>Report Units</u>	<u>LCS %REC</u>	<u>LCSD %REC</u>	<u>LCS/LCSD Limits</u>	<u>RPD</u>	<u>RPD Max</u>
Batch number: 033430022A TPH - DRO CA LUFT (Waters)	Sample number(s): 4179710-4179713 N.D.	50.	ug/l	76	83	61-126	8	20
Batch number: 033450020A TPH - DRO CA LUFT (Waters)	Sample number(s): 4179714 N.D.	50.	ug/l	78	83	61-126	6	20
Batch number: 03345A07B TPH-GRO - Waters	Sample number(s): 4179709-4179711 N.D.	50.	ug/l	87		70-130		
Batch number: 03345A07C TPH-GRO - Waters	Sample number(s): 4179712-4179714 N.D.	50.	ug/l	87		70-130		
Batch number: P033452AA Ethanol	Sample number(s): 4179710-4179714 N.D.	50.	ug/l	144		46-145		
Methyl Tertiary Butyl Ether	N.D.	0.5	ug/l	88		77-127		
Benzene	N.D.	0.5	ug/l	88		85-117		
Toluene	N.D.	0.5	ug/l	86		85-115		
Ethylbenzene	N.D.	0.5	ug/l	88		82-119		
Xylene (Total)	N.D.	0.5	ug/l	87		84-120		
Batch number: W033462AA Methyl Tertiary Butyl Ether	Sample number(s): 4179709 N.D.	0.5	ug/l	99	98	77-127	2	30
Benzene	N.D.	0.5	ug/l	96	94	85-117	2	30
Toluene	N.D.	0.5	ug/l	97	94	85-115	3	30
Ethylbenzene	N.D.	0.5	ug/l	95	93	82-119	2	30
Xylene (Total)	N.D.	0.5	ug/l	96	94	84-120	2	30

Sample Matrix Quality Control

<u>Analysis Name</u>	<u>MS %REC</u>	<u>MSD %REC</u>	<u>MS/MSD Limits</u>	<u>RPD</u>	<u>MAX</u>	<u>Conc</u>	<u>DUP</u>	<u>DUP RPD</u>	<u>Dup RPD Max</u>
Batch number: 03345A07B TPH-GRO - Waters	Sample number(s): 4179709-4179711 96	101	63-154	5	30				
Batch number: 03345A07C TPH-GRO - Waters	Sample number(s): 4179712-4179714 96	101	63-154	5	30				
Batch number: P033452AA Ethanol	Sample number(s): 4179710-4179714 154*	151*	38-149	2	30				
Methyl Tertiary Butyl Ether	89	89	69-134	1	30				
Benzene	94	92	83-128	2	30				
Toluene	95	92	83-127	3	30				
Ethylbenzene	95	94	82-129	1	30				
Xylene (Total)	93	92	82-130	1	30				
Batch number: W033462AA Methyl Tertiary Butyl Ether	Sample number(s): 4179709 102		69-134						
Benzene	103		83-128						
Toluene	102		83-127						
Ethylbenzene	102		82-129						
Xylene (Total)	101		82-130						

*- Outside of specification

- (1) The result for one or both determinations was less than five times the LOQ.
- (2) The background result was more than four times the spike added.

Quality Control Summary

Client Name: ChevronTexaco
Reported: 12/23/03 at 04:30 PM

Group Number: 877642

Surrogate Quality Control

Analysis Name: TPH - DRO CA LUFT (Waters)
Batch number: 033430022A
Orthoterphenyl

4179710	77
4179711	94
4179712	83
4179713	75
Blank	82
LCS	79
LCSD	83

Limits: 59-139

Analysis Name: TPH - DRO CA LUFT (Waters)
Batch number: 033450020A
Orthoterphenyl

4179714	73
Blank	83
LCS	80
LCSD	84

Limits: 59-139

Analysis Name: TPH-GRO - Waters
Batch number: 03345A07B
Trifluorotoluene-F

4179709	76
4179710	160*
4179711	98
Blank	77
LCS	95
MS	99
MSD	101

Limits: 57-146

Analysis Name: TPH-GRO - Waters
Batch number: 03345A07C
Trifluorotoluene-F

4179712	76
4179713	90
4179714	106
Blank	76
LCS	95
MS	99
MSD	101

Limits: 57-146

Analysis Name: BTEX+5 Oxygenates+EDC+EDB+ETOH
Batch number: P033452AA
Dibromofluoromethane

1,2-Dichloroethane-d4

Toluene-d8

4-Bromofluorobenzene

*- Outside of specification

- (1) The result for one or both determinations was less than five times the LOQ.
- (2) The background result was more than four times the spike added.

Quality Control Summary

 Client Name: ChevronTexaco
 Reported: 12/23/03 at 04:30 PM

Group Number: 877642

Surrogate Quality Control

4179710	103	99	102	102
4179711	101	100	102	98
4179712	101	101	103	99
4179713	101	102	102	98
4179714	101	100	102	100
Blank	99	99	103	97
LCS	100	101	103	99
MS	101	103	104	101
MSD	100	101	104	100
<hr/>				
Limits:	81-120	82-112	85-112	83-113

Analysis Name: BTEX+MTBE by 8260B

Batch number: W033462AA

	Dibromofluoromethane	1,2-Dichloroethane-d4	Toluene-d8	4-Bromofluorobenzene
4179709	93	91	91	91
Blank	92	89	92	91
LCS	92	96	92	93
LCSD	93	89	92	92
MS	94	90	91	93
<hr/>				
Limits:	81-120	82-112	85-112	83-113

*- Outside of specification

- (1) The result for one or both determinations was less than five times the LOQ.
- (2) The background result was more than four times the spike added.

Explanation of Symbols and Abbreviations

The following defines common symbols and abbreviations used in reporting technical data:

N.D.	none detected	BMQL	Below Minimum Quantitation Level
TNTC	Too Numerous To Count	MPN	Most Probable Number
IU	International Units	CP Units	cobalt-chloroplatinate units
umhos/cm	micromhos/cm	NTU	nephelometric turbidity units
C	degrees Celsius	F	degrees Fahrenheit
meq	milliequivalents	lb.	pound(s)
g	gram(s)	kg	kilogram(s)
ug	microgram(s)	mg	milligram(s)
ml	milliliter(s)	l	liter(s)
m3	cubic meter(s)	ul	microliter(s)

< less than - The number following the sign is the limit of quantitation, the smallest amount of analyte which can be reliably determined using this specific test.

> greater than

J estimated value - The result falls within the Method Detection Limit (MDL) and Limit of Quantitation (LOQ).

ppm parts per million - One ppm is equivalent to one milligram per kilogram (mg/kg), or one gram per million grams. For aqueous liquids, ppm is usually taken to be equivalent to milligrams per liter (mg/l), because one liter of water has a weight very close to a kilogram. For gases or vapors, one ppm is equivalent to one microliter of gas per liter of gas.

ppb parts per billion

Dry weight basis Results printed under this heading have been adjusted for moisture content. This increases the analyte weight concentration to approximate the value present in a similar sample without moisture. All other results are reported on an as-received basis.

U.S. EPA CLP Data Qualifiers:

Organic Qualifiers		Inorganic Qualifiers	
A	TIC is a possible aldol-condensation product	B	Value is <CRDL, but ≥IDL
B	Analyte was also detected in the blank	E	Estimated due to interference
C	Pesticide result confirmed by GC/MS	M	Duplicate injection precision not met
D	Compound quantitated on a diluted sample	N	Spike sample not within control limits
E	Concentration exceeds the calibration range of the instrument	S	Method of standard additions (MSA) used for calculation
N	Presumptive evidence of a compound (TICs only)	U	Compound was not detected
P	Concentration difference between primary and confirmation columns >25%	W	Post digestion spike out of control limits
U	Compound was not detected	*	Duplicate analysis not within control limits
X,Y,Z	Defined in case narrative	+	Correlation coefficient for MSA <0.995

Analytical test results for methods listed on the laboratories' accreditation scope meet all requirements of NELAC unless otherwise noted under the individual analysis.

Measurement uncertainty values, as applicable, are available upon request.

Tests results relate only to the sample tested. Clients should be aware that a critical step in a chemical or microbiological analysis is the collection of the sample. Unless the sample analyzed is truly representative of the bulk of material involved, the test results will be meaningless. If you have questions regarding the proper techniques of collecting samples, please contact us. We cannot be held responsible for sample integrity, however, unless sampling has been performed by a member of our staff. This report shall not be reproduced except in full, without the written approval of the laboratory.

WARRANTY AND LIMITS OF LIABILITY - In accepting analytical work, we warrant the accuracy of test results for the sample as submitted. THE FOREGOING EXPRESS WARRANTY IS EXCLUSIVE AND IS GIVEN IN LIEU OF ALL OTHER WARRANTIES, EXPRESSED OR IMPLIED. WE DISCLAIM ANY OTHER WARRANTIES, EXPRESSED OR IMPLIED, INCLUDING A WARRANTY OF FITNESS FOR PARTICULAR PURPOSE AND WARRANTY OF MERCHANTABILITY. IN NO EVENT SHALL LANCASTER LABORATORIES BE LIABLE FOR INDIRECT, SPECIAL, CONSEQUENTIAL, OR INCIDENTAL DAMAGES INCLUDING, BUT NOT LIMITED TO, DAMAGES FOR LOSS OF PROFIT OR GOODWILL REGARDLESS OF (A) THE NEGLIGENCE (EITHER SOLE OR CONCURRENT) OF LANCASTER LABORATORIES AND (B) WHETHER LANCASTER LABORATORIES HAS BEEN INFORMED OF THE POSSIBILITY OF SUCH DAMAGES. We accept no legal responsibility for the purposes for which the client uses the test results. No purchase order or other order for work shall be accepted by Lancaster Laboratories which includes any conditions that vary from the Standard Terms and Conditions of Lancaster Laboratories and we hereby object to any conflicting terms contained in any acceptance or order submitted by client.