

Chevron



**Chevron**

ENVIRONMENTAL  
PROTECTION

99 OCT 12 PM 4:25

Chevron U.S.A. Products Company  
6001 Bollinger Canyon Rd. Bldg. L  
P. O. Box 6004  
San Ramon, CA 94583-0804

Site Assessment and  
Remediation Group  
Phone (510) 842-9500  
Fax (510) 842-8370

Date: September 30, 1999  
To: Distribution  
Re: Groundwater Monitoring Report , 9-0121

The enclosed groundwater monitoring report has been properly reviewed by a Chevron authorized representative. Agency guidelines have been followed. Blaine Tech Services is authorized to distribute the report directly to interested parties.

If you have any questions, please call me at (510) 842-8695.

Sincerely,

Brett Hunter  
Site Assessment and Remediation  
Project Manager

*slight increase in [HCL] in  
all replacement wells (MW-1, MW-2A,  
MW-4A)*

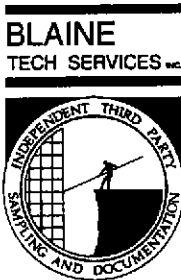

1680 ROGERS AVENUE  
SAN JOSE, CALIFORNIA 95112-1105  
(408) 573-7771 FAX  
(408) 573-0555 PHONE

September 2, 1999

Brett Hunter  
Chevron U.S.A. Products Company  
P.O. Box 6004  
San Ramon, CA 94583-0904

### 2nd Quarter 1999 Monitoring at 9-0121

Second Quarter 1999 Groundwater Monitoring at  
Chevron Service Station Number 9-0121  
3026 Lakeshore Avenue  
Oakland, CA

Monitoring Performed on June 14, 1999

---

### Groundwater Sampling Report 990614-M-1

This report covers the routine monitoring of groundwater wells at this Chevron facility. Blaine Tech Services, Inc.'s work at the site includes inspection, gauging, evacuation, purgewater containment, sample collection and sample handling in accordance with standard procedures that conform to Regional Water Quality Control Board requirements.

Routine field data collection includes depth to water, total well depth, thickness of any separate immiscible layer, water column volume, calculated volume of a three-case volume purge, elapsed evacuation time, total volume of water removed, and standard water parameter instrument readings. Sample material is collected, contained, stored, and transported to the laboratory in conformance with EPA standards. Purgewater is, likewise, collected and transported to McKittrick Waste Treatment Site for disposal.

Basic field information is presented alongside analytical values excerpted from the laboratory report in the cumulative table of **WELL DATA AND ANALYTICAL RESULTS**. The full analytical report for the most recent samples is located in the **Analytical Appendix**. The table also contains new groundwater elevation calculations taken from the computer plotted gradient

map which is located in the **Professional Engineering Appendix**.

At a minimum, Blaine Tech Services, Inc. field personnel are certified upon completion of a forty-hour Hazardous Materials and Emergency Response training course per 29 CFR 1910.120. Field personnel are also enrolled in annual eight hour refresher courses.

Blaine Tech Services, Inc. conducts sampling and documentation assignments of this type as an independent third party. In order to avoid compromising the objectivity necessary for the proper and disinterested performance of this work, Blaine Tech Services, Inc. concentrates on objective data collection and does not participate in the interpretation of analytical results, the definition of geological or hydrological conditions, the formulation of recommendations, or the marketing of remedial systems.

Please call if you have any questions.

Yours truly,



Christine Lillie  
Project Coordinator

CAL/sb

attachments: Professional Engineering Appendix  
Cumulative Table of Well Data and Analytical Results  
Analytical Appendix  
Field Data Sheets

cc: Eva Chu, Alameda County Health Services  
Greg Gurs, Gettler-Ryan, Inc.  
Bill Scudder, Chevron (w/o enclosure)

# **Professional Engineering Appendix**

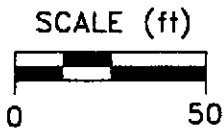
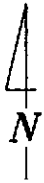

**EXPLANATION**

- ⊙ MONITORING WELL LOCATION
- ∅ DESTROYED WELL LOCATION
- 0.97 GROUNDWATER ELEVATION (FT, MSL)
- 2.00 — GROUNDWATER ELEVATION CONTOUR (FT, MSL)
- ↙ APPROXIMATE GROUNDWATER FLOW DIRECTION;  
APPROXIMATE GRADIENT = 0.02

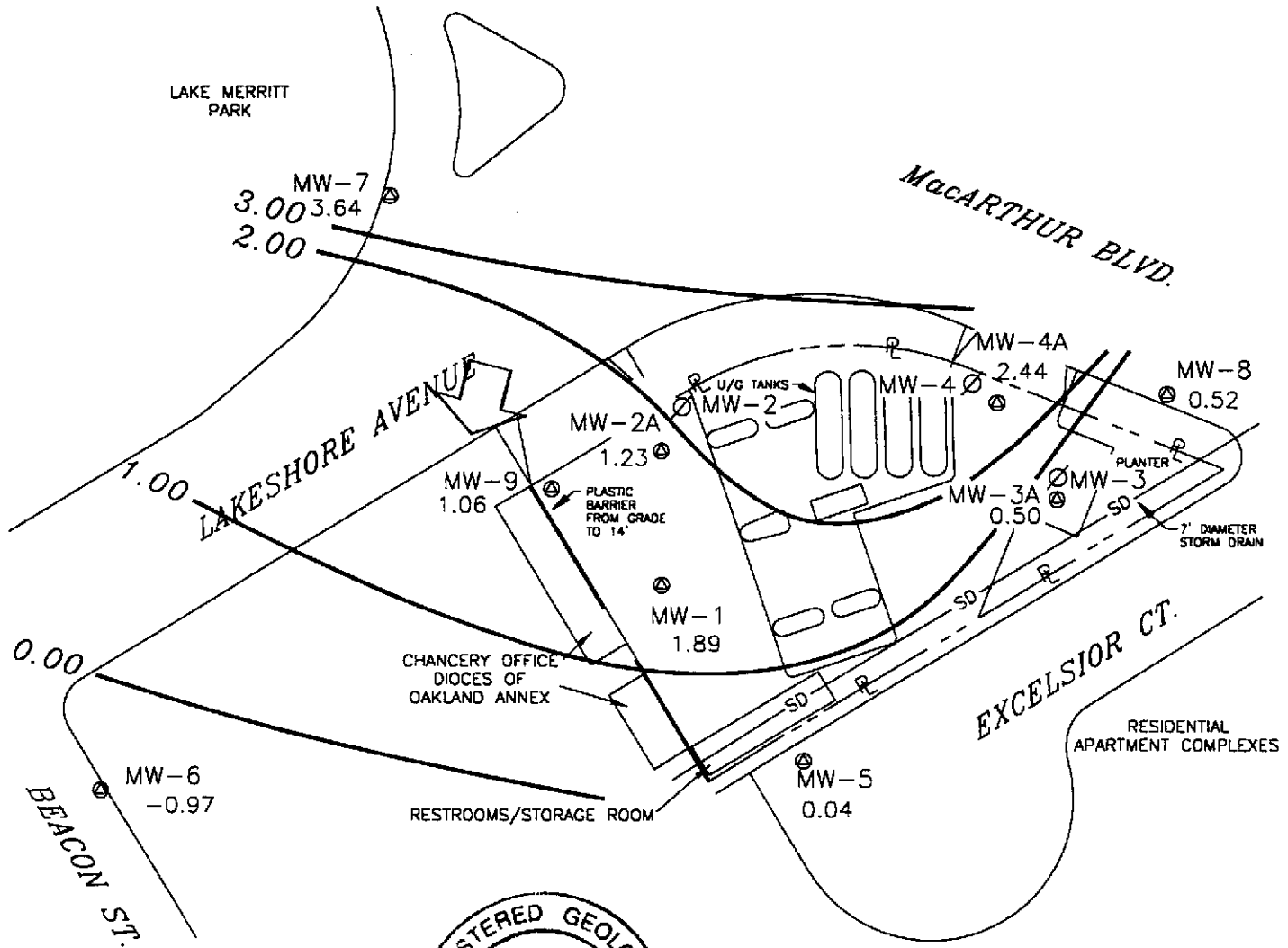

Basemap from Geoconsultants, Inc.

PREPARED BY



**Chevron Station 9-0121**  
3026 Lakeshore Avenue  
Oakland, California

**GROUNDWATER ELEVATION CONTOUR MAP,**  
JUNE 14, 1999

FIGURE:

**1**

PROJECT:  
DAC04

# **Table of Well Data and Analytical Results**

## Cumulative Table of Well Data and Analytical Results

Vertical Measurements are in feet.

Volumetric Measurements are in gallons.

Analytical results are in parts per billion (ppb)

DATE	Well Head Elev.	Ground Water Elev.	Depth To Water	SPH Thickness	SPH Removed	Total SPH Removed	Notes	TPH-Gasoline	Benzene	Toluene	Ethyl-Benzene	Xylene	TPH-Diesel	TDS	MTBE
<b>MW-1</b>															
08/20/91	6.82	1.62	5.20	--	--	--	--	5100	1700	21	220	34	260	--	--
09/30/91	6.82	1.15	5.67	Sheen	--	--	--	--	--	--	--	--	--	--	--
10/28/91	6.82	1.50	5.30	0.03	--	--	--	--	--	--	--	--	--	--	--
01/08/92	6.82	1.67	5.15	Sheen	--	--	--	5400	770	13	95	31	4400	--	--
01/13/92	6.82	--	--	--	--	--	--	--	--	--	--	--	--	--	--
06/23/92	6.89	1.48	5.41	--	--	--	--	7700	1500	40	230	100	2000	--	--
08/24/92	6.89	1.12	5.77	--	--	--	--	--	--	--	--	--	--	--	--
09/21/92	6.89	1.00	5.89	--	--	--	--	3500	1700	28	190	78	<50	--	--
10/26/92	6.89	0.95	5.94	--	--	--	--	--	--	--	--	--	--	--	--
12/23/92	6.89	2.18	4.71	--	--	--	--	60,000	7100	240	2000	1300	5500	--	--
01/08/93	6.89	--	--	--	--	--	--	--	--	--	--	--	--	--	--
03/25/93	6.89	2.17	4.72	--	--	--	--	530	1100	41	67	79	<10	--	--
06/11/93	6.89	5.37	5.07	--	--	--	--	7000	1900	33	120	69	--	840	9600
09/29/93	6.89	1.13	5.76	--	--	--	--	6600	1600	28	43	74	<10	--	--
12/20/93	6.89	1.74	5.15	--	--	--	--	6300	1900	36	82	65	<10	--	--
03/07/94	6.89	2.21	4.68	--	--	--	--	7700	1100	55	66	38	<10	--	12,000
06/17/94	6.89	1.83	5.06	--	--	--	--	4300	710	12	90	38	2200	--	--
09/12/94	6.89	1.24	5.65	--	--	--	--	6400	1500	<25	180	<25	2500	--	12,000
11/30/94	6.89	2.32	4.57	--	--	--	--	4900	690	26	97	60	2300*	--	3900
03/24/95	6.89	3.91	2.98	--	--	--	--	1800	160	7.3	11	14	1400**	--	1300
06/27/95	6.89	1.87	5.02	--	--	--	--	4600	1300	11	97	13	2300**	--	5100
09/28/95	6.89	1.59	5.30	--	--	--	--	6600	1500	<20	<20	<20	3900**	--	5800
12/19/95	6.89	2.21	4.68	--	--	--	--	3800	930	<10	100	<10	2600**	--	6300
02/28/96	6.89	3.27	3.62	--	--	--	--	3600	280	<5.0	18	5.5	1800**	--	2200
06/25/96	6.89	1.87	5.02	--	--	--	--	4700	1600	36	150	31	3000	--	3000
12/17/96	6.89	2.23	4.66	--	--	--	--	7800	1000	28	340	63	2700***	--	1200
03/31/97	6.89	2.01	4.88	--	--	--	--	5300	590	55	210	53	2200**	--	950
06/30/97	6.89	1.32	5.57	--	--	--	--	4400	350	<10	<10	11	2200**	--	580
09/12/97	6.89	1.56	5.33	--	--	--	--	3400	220	9.5	15	11	2300**	--	460
12/05/97	6.89	2.44	4.45	--	--	--	--	4700	870	21	120	18	1900**	--	750
02/16/98	6.89	3.52	3.37	--	--	--	--	4400	120	12	11	7.7	1600**	--	270
06/17/98	6.89	2.24	4.65	--	--	--	--	7800	<25	50	34	650	1300**	--	650
08/31/98	6.89	1.70	5.19	--	--	--	--	3700	620	17	120	31	2400**	--	380
12/28/98	6.89	1.94	4.95	--	--	--	+	3800	250	14	28	15	1500**	--	330

CONTINUED ON NEXT PAGE

\* Chromatogram pattern indicates a non-diesel mix.

\*\* Chromatogram pattern indicates an unidentified hydrocarbon.

\*\*\* Chromatogram pattern indicates an unidentified hydrocarbon and weathered diesel.

+ See Table of Additional Analyses.

## Cumulative Table of Well Data and Analytical Results

Vertical Measurements are in feet.

Volumetric Measurements are in gallons.

Analytical results are in parts per billion (ppb)

DATE	Well Head Elev.	Ground Water Elev.	Depth To Water	SPH Thickness	SPH Removed	Total SPH Removed	Notes	TPH-Gasoline	Benzene	Toluene	Ethyl-Benzene	Xylene	TPH-Diesel	TDS	MTBE
<b>MW-1 (CONT'D)</b>															
03/04/99	6.89	3.24	3.65	--	--	--	--	1560	17.9	<0.5	4.17	1.05	1070**	--	70.4
06/14/99	6.89	1.89	5.00	--	--	--	--	<10,000	820	240	320	640	2500**	--	<500

\*\* Chromatogram pattern indicates an unidentified hydrocarbon.



## Cumulative Table of Well Data and Analytical Results

Vertical Measurements are in feet.

Volumetric Measurements are in gallons.

Analytical results are in parts per billion (ppb)

DATE	Well Head Elev.	Ground Water Elev.	Depth To Water	SPH Thickness	SPH Removed	Total SPH Removed	Notes	TPH-Gasoline	Benzene	Toluene	Ethyl-Benzene	Xylene	TPH-Diesel	TDS	MTBE
<b>MW-2</b>															
08/20/91	6.27	1.92	4.35	--	--	--	--	9300	3700	55	530	75	600	--	--
09/30/91	6.27	1.28	4.99	--	--	--	--	3500	2600	47	440	68	--	--	--
10/28/91	6.27	1.36	4.91	--	--	--	--	4600	1800	29	290	53	--	--	--
01/08/92	6.27	1.63	4.64	Sheen	--	--	--	14,000	4300	70	<25	130	--	--	--
01/13/92	6.27	--	--	--	--	--	--	--	--	--	--	--	38,000	--	--
06/23/92	6.27	1.63	4.64	0.02	--	--	--	--	--	--	--	--	--	--	--
08/24/92	6.27	1.34	4.94	0.02	--	--	--	--	--	--	--	--	--	--	--
09/21/92	6.27	1.20	5.08	0.01	--	--	--	--	--	--	--	--	--	--	--
10/26/92	6.27	0.34	5.93	--	--	--	--	--	--	--	--	--	--	--	--
12/23/92	6.27	--	--	--	--	--	--	21,000	5400	59	1300	160	160,000	--	--
01/08/93	6.27	2.57	3.70	--	--	--	--	--	--	--	--	--	--	--	--
03/25/93	6.27	2.89	3.38	Sheen	--	--	--	--	--	--	--	--	--	--	--
06/11/93	6.27	2.09	4.18	--	--	--	--	5900	1100	23	240	51	--	2300	--
09/29/93	6.27	0.07	6.20	--	--	--	--	--	--	--	--	--	--	--	--
12/20/93	6.27	1.94	4.35	0.02	--	--	--	--	--	--	--	--	--	--	--
03/07/94	6.27	2.60	3.67	--	--	--	--	26,000	5700	170	1000	150	<10	--	--
06/17/94	6.27	2.25	4.02	Sheen	--	--	--	--	--	--	--	--	--	--	--
09/12/94	6.27	1.45	4.83	0.01	--	--	--	--	--	--	--	--	--	--	--
11/30/94	6.27	2.27	4.00	--	--	--	Inaccessible	--	--	--	--	--	--	--	--
03/24/95	6.27	2.73	4.01	0.59	--	--	--	--	--	--	--	--	--	--	--
06/27/95	6.27	1.71	4.96	0.50	0.013	0.013	--	--	--	--	--	--	--	--	--
09/28/95	6.27	2.62	4.25	0.75	0.013	0.026	--	--	--	--	--	--	--	--	--
12/19/95	6.27	1.99	4.76	0.60	0.010	0.036	--	--	--	--	--	--	--	--	--
02/28/96	6.27	1.99	4.58	0.38	0.008	0.044	--	--	--	--	--	--	--	--	--
06/25/96	6.27	2.36	4.29	0.47	0.030	0.074	--	--	--	--	--	--	--	--	--
12/17/96	6.27	2.22	4.16	0.14	--	0.074	--	--	--	--	--	--	--	--	--
03/31/97	6.27	2.34	4.07	0.18	0.030	0.104	--	--	--	--	--	--	--	--	--
06/30/97	6.27	2.06	4.32	0.14	0.030	0.134	--	--	--	--	--	--	--	--	--
09/12/97	6.27	2.00	4.38	0.14	--	0.134	--	--	--	--	--	--	--	--	--
12/05/97	6.27	2.51	3.78	0.02	--	0.134	--	--	--	--	--	--	--	--	--
02/16/98	6.27	3.08	3.29	0.12	0.007	0.141	--	--	--	--	--	--	--	--	--
06/17/98	6.27	2.35	4.00	0.10	0.010	0.151	--	--	--	--	--	--	--	--	--
08/31/98	6.27	0.65	5.71	0.11	0.008	0.159	--	--	--	--	--	--	--	--	--
12/28/98	6.27	1.75	4.60	0.10	0.005	0.164	--	--	--	--	--	--	--	--	--
03/04/99	6.27	2.58	3.73	0.05	0.200	0.364	--	--	--	--	--	--	--	--	--

NO LONGER MONITORED OR SAMPLED

### Cumulative Table of Well Data and Analytical Results

Vertical Measurements are in feet.

Volumetric Measurements are in gallons.

Analytical results are in parts per billion (ppb)

DATE	Well Head Elev.	Ground Water Elev.	Depth To Water	SPH Thickness	SPH Removed	Total SPH Removed	Notes	TPH-Gasoline	Benzene	Toluene	Ethyl-Benzene	Xylene	TPH-Diesel	TDS	MTBE
<b>MW-2A</b>															
04/19/99	6.53	1.67	4.86	--	--	--	--	<2000	<20	<20	<20	<20	820*	--	9200
06/14/99	6.53	1.23	5.30	--	--	--	--	<5000	89	<50	66	<50	2000*	--	10,000

\* Chromatogram pattern indicates an unidentified hydrocarbon.

## Cumulative Table of Well Data and Analytical Results

Vertical Measurements are in feet.

Volumetric Measurements are in gallons.

Analytical results are in parts per billion (ppb)

DATE	Well Head Elev.	Ground Water Elev.	Depth To Water	SPH Thickness	SPH Removed	Total SPH Removed	Notes	TPH-Gasoline	Benzene	Toluene	Ethyl-Benzene	Xylene	TPH-Diesel	TDS	MTBE
<b>MW-3</b>															
08/20/91	8.71	0.26	8.45	--	--	--	--	3100	200	13	15	12	200	--	--
09/30/91	8.71	-0.03	8.74	--	--	--	--	1000	150	8.3	13	6.7	--	--	--
10/28/91	8.71	-0.05	8.76	--	--	--	--	1200	120	6.7	11	7.5	--	--	--
01/08/92	8.71	-0.06	8.77	--	--	--	--	410	120	0.9	4.1	3.4	--	--	--
01/13/92	8.71	--	--	--	--	--	--	--	--	--	--	--	220	--	--
06/23/92	8.71	0.03	8.68	--	--	--	--	630	43	0.8	8.2	3.4	<50	--	--
08/24/92	8.71	-0.14	8.85	--	--	--	--	--	--	--	--	--	--	--	--
09/21/92	8.71	-0.23	8.94	--	--	--	--	1800	730	1.4	66	39	<50	--	--
10/26/92	8.71	-0.36	9.07	--	--	--	--	--	--	--	--	--	--	--	--
12/23/92	8.71	--	--	--	--	--	--	840	270	3.4	15	4.2	850	--	--
01/08/93	8.71	1.02	7.69	--	--	--	--	--	--	--	--	--	--	--	--
03/25/93	8.71	0.97	7.74	--	--	--	--	760	270	4.0	10	5.0	<10	--	--
06/11/93	8.71	0.19	8.52	--	--	--	--	200	32	1.0	5.0	2.0	--	5600	--
09/29/93	8.71	2.66	6.05	--	--	--	--	9300	2800	60	270	62	--	--	--
12/20/93	8.71	-0.12	8.83	--	--	--	--	460	250	4.0	8.0	4.0	<10	--	--
03/07/94	8.71	0.64	8.07	--	--	--	--	2400	260	13	35	18	<10	--	--
06/17/94	8.71	0.19	8.52	--	--	--	--	1000	200	4.0	6.6	6.7	<50	--	--
09/12/94	8.71	-0.21	8.92	--	--	--	--	360	130	3.4	4.8	3.3	<50	--	130
11/30/94	8.71	0.58	8.13	--	--	--	Inaccessible	--	--	--	--	--	--	--	--
03/24/95	8.71	1.93	6.78	--	--	--	--	4100	920	<10	23	<10	1200*	--	70
06/27/95	8.71	0.49	8.22	--	--	--	--	3100	640	16	31	<10	1000*	--	<50
09/28/95	8.71	-0.14	8.85	--	--	--	--	490	78	3.4	4.4	2.4	460*	--	38
12/19/95	8.71	0.69	8.02	--	--	--	--	2600	580	<10	25	<10	650*	--	<50
02/28/96	8.71	1.16	7.55	--	--	--	--	1500	510	<5.0	9.9	<5.0	780*	--	<25
06/25/96	8.71	0.34	8.37	--	--	--	--	1300	390	7.8	14	6.5	1200*	--	31
12/17/96	8.71	0.41	8.30	--	--	--	--	760	85	<1.2	5.9	5.1	1100*	--	<6.2
03/31/97	8.71	0.52	8.19	--	--	--	--	2000	380	12	24	12	1300*	--	<25
06/30/97	8.71	0.00	8.71	--	--	--	--	1900	340	9.9	23	6.1	620*	--	<25
09/12/97	8.71	1.07	7.64	--	--	--	--	1200	200	4.6	14	4.8	400*	--	3.9
12/05/97	8.71	0.46	8.25	--	--	--	--	460	72	2.7	5.2	1.7	190*	--	<5.0
02/16/98	8.71	1.71	7.00	--	--	--	--	6200	1100	20	34	12	1000*	--	<50
06/17/98	8.71	0.71	8.00	--	--	--	--	3000	350	<10	<10	<10	1100*	--	120
08/31/98	8.71	0.08	8.63	--	--	--	--	430	100	2.6	8.6	6.0	790*	--	<12
12/28/98	8.71	-0.02	8.73	--	--	--	+	1400	220	<10	12	<10	180*	--	<50
03/04/99	8.71	1.06	7.65	--	--	--	--	2880	355	9.15	19	<5.0	763*	--	<20

NO LONGER MONITORED OR SAMPLED

\* Chromatogram pattern indicates an unidentified hydrocarbon.

+ See Additional Analyses.

## Cumulative Table of Well Data and Analytical Results

Vertical Measurements are in feet.

Volumetric Measurements are in gallons.

Analytical results are in parts per billion (ppb)

DATE	Well Head Elev.	Ground Water Elev.	Depth To Water	SPH Thickness	SPH Removed	Total SPH Removed	Notes	TPH-Gasoline	Benzene	Toluene	Ethyl-Benzene	Xylene	TPH-Diesel	TDS	MTBE
<b>MW-3A</b>															
04/19/99	8.70	1.00	7.70	--	--	--	--	<50	<0.5	<0.5	<0.5	<0.5	93*	--	3.1
06/14/99	8.70	0.50	8.20	--	--	--	--	148	4.55	0.82	0.53	1.1	160*	--	3.7

\* Chromatogram pattern indicates an unidentified hydrocarbon.

## Cumulative Table of Well Data and Analytical Results

Vertical Measurements are in feet.

Volumetric Measurements are in gallons.

Analytical results are in parts per billion (ppb)

DATE	Well Head Elev.	Ground Water Elev.	Depth To Water	SPH Thickness	SPH Removed	Total SPH Removed	Notes	TPH- Gasoline	Benzene	Toluene	Ethyl- Benzene	Xylene	TPH- Diesel	TDS	MTBE
<b>MW-4</b>															
08/20/91	7.37	1.32	5.05	--	--	--	--	1800	870	4.0	3.0	9.0	160	--	--
09/30/91	7.37	1.70	5.67	--	--	--	--	670	830	5.5	2.7	12	--	--	--
10/28/91	7.37	1.56	5.81	--	--	--	--	2800	990	5.8	4.8	19	--	--	--
01/08/92	7.37	2.03	5.34	--	--	--	--	2900	1200	10	7.0	18	--	--	--
01/13/92	7.37	--	--	--	--	--	--	--	--	--	--	--	1000	--	--
06/23/92	7.37	2.00	5.37	--	--	--	--	1600	380	6.5	3.0	12	<50	--	--
08/24/92	7.37	1.62	5.75	--	--	--	--	--	--	--	--	--	--	--	--
09/21/92	7.37	1.42	5.95	--	--	--	--	1200	480	5.6	3.7	11	<50	--	--
10/26/92	7.37	1.41	5.96	--	--	--	--	--	--	--	--	--	--	--	--
12/23/92	7.37	--	--	--	--	--	--	1500	700	3.6	3.2	11	1800	--	--
01/08/93	7.37	2.73	4.64	--	--	--	--	--	--	--	--	--	--	--	--
03/25/93	7.37	2.95	4.42	--	--	--	--	520	160	3.0	1.0	4.0	<10	--	--
06/11/93	7.37	2.25	5.12	--	--	--	--	1200	430	5.0	6.0	11	--	2800	--
09/29/93	7.37	1.57	5.80	--	--	--	--	1300	210	8.0	2.0	14	--	--	--
12/20/93	7.37	2.27	5.10	--	--	--	--	570	230	5.0	4.0	8.0	3900	--	--
03/07/94	7.37	2.36	5.01	--	--	--	--	2200	290	18	2.5	11	2600	--	22,000
06/17/94	7.37	1.55	5.82	--	--	--	--	2100	480	11	4.3	9.5	2800	--	--
09/12/94	7.37	1.73	5.64	--	--	--	--	1700	340	6.1	2.7	9.7	3000	--	63,000
11/30/94	7.37	1.79	5.58	--	--	--	Inaccessible	--	--	--	--	--	--	--	--
03/24/95	7.37	2.42	4.95	--	--	--	--	1500	280	<5.0	<5.0	6.9	3000*	--	12,000
06/27/95	7.37	-1.42	8.79	--	--	--	--	<10,000	310	<100	<100	<100	3100*	--	32,000
09/28/95	7.37	1.52	5.85	--	--	--	--	330	64	1.1	<0.5	<0.5	6300*	--	630
12/19/95	7.37	1.87	5.50	--	--	--	--	3000	520	<25	<25	<25	3400*	--	44,000
02/28/96	7.37	2.27	5.10	--	--	--	--	<10,000	230	<100	<100	<100	4700*	--	32,000
06/25/96	7.37	1.59	5.78	--	--	--	--	<10,000	160	<100	<100	<100	3100	--	31,000
12/17/96	7.37	1.42	5.95	--	--	--	--	<5000	110	<50	<50	<50	3600**	--	22,000
03/31/97	7.37	1.75	5.62	--	--	--	--	<2500	130	<25	<25	<25	2700*	--	16,000
06/30/97	7.37	1.34	6.03	--	--	--	--	<2500	130	<25	<25	<25	2700*	--	14,000
09/12/97	7.37	1.68	5.69	--	--	--	--	<5000	63	<50	<50	<50	2100*	--	15,000
12/05/97	7.37	2.22	5.15	--	--	--	--	1300	120	<5.0	<5.0	8.5	2600*	--	15,000
02/16/98	7.37	1.11	6.26	--	--	--	--	1200	57	4.5	<2.5	7.0	1300*	--	12,000
06/17/98	7.37	2.41	4.96	--	--	--	--	5300	390	290	28	150	530*	--	17,000
08/31/98	7.37	1.46	5.91	--	--	--	--	<50	89	<0.5	<0.5	<0.5	2400*	--	14,000
08/31/98	7.37	1.46	5.91	--	--	--	Confirmation run	--	--	--	--	--	--	--	16,000
12/28/98	7.37	1.96	5.41	--	--	--	+	1000	52	5.6	4.6	9.1	2900*	--	8400
03/04/99	7.37	2.17	5.20	--	--	--	--	<2500	85.5	40.9	<25	<25	4490*	--	11,400

NO LONGER MONITORED OR SAMPLED

\* Chromatogram pattern indicates an unidentified hydrocarbon.

\*\* Chromatogram pattern indicates an unidentified hydrocarbon and weathered diesel.

+ See Additional Analyses.

### Cumulative Table of Well Data and Analytical Results

Vertical Measurements are in feet.

Volumetric Measurements are in gallons.

Analytical results are in parts per billion (ppb)

DATE	Well Head Elev.	Ground Water Elev.	Depth To Water	SPH Thickness	SPH Removed	Total SPH Removed	Notes	TPH-Gasoline	Benzene	Toluene	Ethyl-Benzene	Xylene	TPH-Diesel	TDS	MTBE
<b>MW-4A</b>															
04/19/99	7.69	2.78	4.91	--	--	--	--	<500	<5.0	<5.0	<5.0	<5.0	370*	--	1600
06/14/99	7.69	2.44	5.25	--	--	--	--	5360	312	<20	44	<20	2500*	--	2880

\* Chromatogram pattern indicates an unidentified hydrocarbon.

## Cumulative Table of Well Data and Analytical Results

Vertical Measurements are in feet.

Volumetric Measurements are in gallons.

Analytical results are in parts per billion (ppb)

DATE	Well Head Elev.	Ground Water Elev.	Depth To Water	SPH Thickness	SPH Removed	Total SPH Removed	Notes	TPH-Gasoline	Benzene	Toluene	Ethyl-Benzene	Xylene	T' H-Diesel	TDS	MTBE
<b>MW-5</b>															
06/23/92	14.14	1.90	12.24	--	--	--	--	<50	<0.5	<0.5	<0.5	<0.5	<50	--	--
08/24/92	14.14	1.85	12.29	--	--	--	--	--	--	--	--	--	--	--	--
09/21/92	14.14	1.68	12.46	--	--	--	--	<50	<0.5	<0.5	<0.5	<0.5	60	--	--
10/26/92	14.14	1.62	12.52	--	--	--	--	--	--	--	--	--	--	--	--
12/23/92	14.14	3.02	11.12	--	--	--	--	--	--	--	--	--	--	--	--
01/08/93	14.14	--	--	--	--	--	--	--	--	--	--	--	--	--	--
03/25/93	14.14	4.40	9.74	--	--	--	--	<50	<0.5	<0.5	<0.5	0.9	<10	--	--
06/11/93	14.14	3.70	10.44	--	--	--	--	<50	<0.5	<0.5	<0.5	<0.5	--	770	--
09/29/93	14.14	2.22	11.92	--	--	--	--	<50	<0.5	0.6	<0.5	0.6	<10	--	--
12/20/93	14.14	--	--	--	--	--	--	--	--	--	--	--	--	--	--
03/07/94	14.14	2.80	11.34	--	--	--	--	<50	<0.5	<0.5	<0.5	<0.5	<10	--	--
06/17/94	14.14	2.87	11.27	--	--	--	--	<50	<0.5	<0.5	<0.5	<0.5	<50	--	--
09/12/94	14.14	1.28	12.86	--	--	--	--	<50	<0.5	<0.5	<0.5	<0.5	<50	--	<5.0
11/30/94	14.14	2.23	11.91	--	--	--	--	<50	<0.5	<0.5	<0.5	<0.5	99*	--	--
03/24/95	14.14	4.38	9.76	--	--	--	--	<50	<0.5	<0.5	<0.5	<0.5	<50	--	--
06/27/95	14.14	2.74	11.40	--	--	--	--	<50	<0.5	<0.5	<0.5	<0.5	55**	--	--
09/28/95	14.14	2.24	11.90	--	--	--	--	<50	<0.5	<0.5	<0.5	<0.5	300**	--	--
12/19/95	14.14	1.56	12.58	--	--	--	--	<50	<0.5	<0.5	<0.5	<0.5	53**	--	3.1
02/28/96	14.14	2.44	11.70	--	--	--	--	<50	<0.5	<0.5	<0.5	<0.5	<50	--	<2.5
06/25/96	14.14	2.71	11.43	--	--	--	--	<50	<0.5	<0.5	<0.5	<0.5	120**	--	36
12/17/96	14.14	2.74	11.40	--	--	--	--	<50	<0.5	<0.5	<0.5	<0.5	89**	--	<2.5
03/31/97	14.14	2.04	12.10	--	--	--	--	<50	<0.5	<0.5	<0.5	<0.5	150**	--	<2.5
06/30/97	14.14	1.36	12.78	--	--	--	Sampled biannually	--	--	--	--	--	--	--	--
09/12/97	14.14	0.46	13.68	--	--	--	--	<50	<0.5	<0.5	<0.5	<0.5	<50	--	<2.5
12/05/97	14.14	1.11	13.03	--	--	--	--	--	--	--	--	--	--	--	--
02/16/98	14.14	4.17	9.97	--	--	--	--	<50	<0.5	<0.5	<0.5	<0.5	62**	--	<2.5
06/17/98	14.14	2.29	11.85	--	--	--	--	--	--	--	--	--	--	--	--
08/31/98	14.14	1.32	12.82	--	--	--	--	<50	<0.5	<0.5	<0.5	<0.5	<50	--	<2.5
12/28/98	14.14	0.71	13.43	--	--	--	+	--	--	--	--	--	--	--	--
03/04/99	14.14	0.39	13.75	--	--	--	--	<50	<0.5	<0.5	<0.5	<0.5	70.5	--	3.34
06/14/99	14.14	0.04	14.10	--	--	--	--	--	--	--	--	--	--	--	--

\* Chromatogram pattern indicates an unidentified hydrocarbon.

\*\* Chromatogram pattern indicates an unidentified hydrocarbon and weathered diesel.

+ See Additional Analyses.

## Cumulative Table of Well Data and Analytical Results

Vertical Measurements are in feet.

Volumetric Measurements are in gallons.

Analytical results are in parts per billion (ppb)

DATE	Well Head Elev.	Ground Water Elev.	Depth To Water	SPH Thickness	SPH Removed	Total SPH Removed	Notes	TPH-Gasoline	Benzene	Toluene	Ethyl-Benzene	Xylene	TPH-Diesel	TDS	MTBE
<b>MW-6</b>															
08/23/92	4.46	-0.68	5.14	--	--	--	--	<50	4.3	<0.5	0.8	0.9	120	--	--
08/24/92	4.46	-0.49	4.95	--	--	--	--	--	--	--	--	--	--	--	--
09/21/92	4.46	-0.44	4.90	--	--	--	--	<250	<2.5	<2.5	<2.5	<2.5	<50	--	--
10/26/92	4.46	-1.06	5.52	--	--	--	--	--	--	--	--	--	--	--	--
12/23/92	4.46	-0.94	5.40	--	--	--	--	<50	<0.5	<0.5	<0.5	<0.5	81	--	--
01/08/93	4.46	--	--	--	--	--	--	--	--	--	--	--	--	--	--
03/25/93	4.46	-1.64	6.10	--	--	--	--	<50	<0.5	<0.5	<0.5	0.7	<10	--	--
06/11/93	4.46	-2.10	6.56	--	--	--	--	<50	<0.5	<0.5	<0.5	<0.5	--	15,000	--
09/29/93	4.46	-0.71	5.17	--	--	--	--	<50	<0.5	<0.5	<0.5	<0.5	<10	--	--
12/20/93	4.46	-1.47	5.93	--	--	--	--	<50	<0.5	<0.5	<0.5	<0.5	<10	--	--
03/07/94	4.46	-0.81	5.27	--	--	--	--	54	<0.5	<0.5	<0.5	0.6	<10	--	--
06/17/94	4.46	--	--	--	--	--	--	--	--	--	--	--	--	--	--
09/12/94	4.46	-0.64	5.10	--	--	--	--	<50	<0.5	<0.5	<0.5	<0.5	<50	--	<50
11/30/94	4.46	-1.12	5.58	--	--	--	--	<50	<0.5	<0.5	<0.5	<0.5	800*	--	--
03/24/95	4.46	-1.87	6.33	--	--	--	--	<50	<0.5	<0.5	<0.5	<0.5	490**	--	--
06/27/95	4.46	-3.74	8.20	--	--	--	--	<50	<0.5	<0.5	<0.5	<0.5	300**	--	--
09/28/95	4.46	-0.19	4.65	--	--	--	--	120	1.1	<0.5	<0.5	<0.5	1200**	--	--
12/19/95	4.46	-1.58	6.04	--	--	--	--	<50	<0.5	<0.5	<0.5	<0.5	820**	--	<2.5
02/28/96	4.46	-1.54	6.00	--	--	--	--	<50	<0.5	<0.5	<0.5	<0.5	270**	--	<2.5
06/25/96	4.46	-1.71	6.17	--	--	--	--	97	<0.5	<0.5	<0.5	0.71	750**	--	<2.5
12/17/96	4.46	-1.67	6.13	--	--	--	--	65	<0.5	<0.5	<0.5	<0.5	540**	--	<2.5
03/31/97	4.46	-2.23	6.69	--	--	--	--	65	<0.5	<0.5	<0.5	<0.5	780**	--	<2.5
06/30/97	4.46	-2.62	7.08	--	--	--	Sampled biannually	--	--	--	--	--	--	--	--
09/12/97	4.46	-0.95	5.41	--	--	--	--	65	<0.5	<0.5	<0.5	<0.5	270**	--	<2.5
12/05/97	4.46	-1.96	6.42	--	--	--	--	--	--	--	--	--	--	--	--
02/16/98	4.46	-0.30	4.76	--	--	--	--	140	<0.5	<0.5	<0.5	<0.5	330**	--	<2.5
06/17/98	4.46	-1.54	6.00	--	--	--	--	--	--	--	--	--	--	--	--
08/31/98	4.46	-0.64	5.10	--	--	--	--	<50	<0.5	<0.5	<0.5	<0.5	270*	--	<2.5
12/28/98	4.46	-2.04	6.50	--	--	--	+	--	--	--	--	--	--	--	--
03/04/99	4.46	-1.35	5.81	--	--	--	--	95.5	<0.5	<0.5	<0.5	<0.5	638*	--	<2.0
06/14/99	4.46	-0.97	5.43	--	--	--	--	--	--	--	--	--	--	--	--

\* Chromatogram pattern indicates a non-diesel mix.

\*\* Chromatogram pattern indicates an unidentified hydrocarbon.

+ See Additional Analyses.



### Cumulative Table of Well Data and Analytical Results

Vertical Measurements are in feet.

Volumetric Measurements are in gallons.

Analytical results are in parts per billion (ppb)

DATE	Well Head Elev.	Ground Water Elev.	Depth To Water	SPH Thickness	SPH Removed	Total SPH Removed	Notes	TPH-Gasoline	Benzene	Toluene	Ethyl-Benzene	Xylene	TPH-Diesel	TDS	MTBE
<b>MW-7</b>															
08/24/92	5.26	-0.29	5.55	--	--	--	--	--	--	--	--	--	--	--	--
09/21/92	5.26	-0.39	5.65	--	--	--	--	<50	<0.5	<0.5	<0.5	<0.5	<50	--	--
10/26/92	5.26	-0.25	5.51	--	--	--	--	--	--	--	--	--	--	--	--
12/23/92	5.26	1.31	3.95	--	--	--	--	<50	2.9	<0.5	<0.5	<0.5	60	--	--
01/08/93	5.26	--	--	--	--	--	--	--	--	--	--	--	--	--	--
03/25/93	5.26	2.76	2.50	--	--	--	--	<50	<0.5	<0.5	<0.5	<0.5	<10	--	--
06/11/93	5.26	1.80	3.46	--	--	--	--	<50	0.6	<0.5	<0.5	<0.5	--	2200	--
09/29/93	5.26	-0.26	5.52	--	--	--	--	<50	2.0	1.0	1.0	7.0	<10	--	--
12/20/93	5.26	0.85	4.41	--	--	--	--	<50	2.0	<0.5	<0.5	<0.5	<10	--	--
03/07/94	5.26	2.64	2.62	--	--	--	--	<50	<0.5	<0.5	<0.5	<0.5	<10	--	--
06/17/94	5.26	1.99	3.27	--	--	--	--	<50	<0.5	<0.5	<0.5	<0.5	<50	--	--
09/12/94	5.26	1.15	4.11	--	--	--	--	<50	<0.5	<0.5	<0.5	<0.5	<50	--	<5.0
11/30/94	5.26	2.50	2.76	--	--	--	--	<50	<0.5	<0.5	<0.5	<0.5	92*	--	--
03/24/95	5.26	3.06	2.20	--	--	--	--	<50	<0.5	<0.5	<0.5	<0.5	<50	--	--
06/27/95	5.26	1.36	3.90	--	--	--	--	<50	<0.5	<0.5	<0.5	<0.5	69**	--	--
09/28/95	5.26	0.41	4.85	--	--	--	--	<50	<0.5	<0.5	<0.5	<0.5	84**	--	--
12/19/95	5.26	2.24	3.02	--	--	--	--	<50	<0.5	<0.5	<0.5	<0.5	84**	--	<2.5
02/28/96	5.26	3.83	1.43	--	--	--	--	<50	<0.5	<0.5	<0.5	<0.5	99**	--	<2.5
06/25/96	5.26	0.97	4.29	--	--	--	--	<50	<0.5	<0.5	<0.5	<0.5	110**	--	<2.5
12/17/96	5.26	3.08	2.18	--	--	--	--	<50	<0.5	<0.5	<0.5	<0.5	54**	--	<2.5
03/31/97	5.26	2.32	2.94	--	--	--	--	<50	<0.5	<0.5	<0.5	<0.5	100**	--	<2.5
06/30/97	5.26	1.68	3.58	--	--	--	Sampled annually	--	--	--	--	--	--	--	--
09/12/97	5.26	1.85	3.41	--	--	--	--	--	--	--	--	--	--	--	--
12/05/97	5.26	3.37	1.89	--	--	--	--	--	--	--	--	--	--	--	--
02/16/98	5.26	3.43	1.83	--	--	--	--	--	--	--	--	--	--	--	--
06/17/98	5.26	3.32	1.94	--	--	--	--	<50	<0.5	<0.5	<0.5	<0.5	77**	--	<2.5
08/31/98	5.26	1.07	4.19	--	--	--	--	--	--	--	--	--	--	--	--
12/28/98	5.26	0.79	4.47	--	--	--	+	--	--	--	--	--	--	--	--
03/04/99	5.26	3.51	1.75	--	--	--	--	<50	<0.5	<0.5	<0.5	<0.5	73.4	--	<2.0
06/14/99	5.26	3.64	1.62	--	--	--	--	--	--	--	--	--	--	--	--

\* Chromatogram pattern indicates a non-diesel mix.

\*\* Chromatogram pattern indicates an unidentified hydrocarbon.

+ See Additional Analyses.

## Cumulative Table of Well Data and Analytical Results

Vertical Measurements are in feet.

Volumetric Measurements are in gallons.

Analytical results are in parts per billion (ppb)

DATE	Well Head Elev.	Ground Water Elev.	Depth To Water	SPH Thickness	SPH Removed	Total SPH Removed	Notes	TPH-Gasoline	Benzene	Toluene	Ethyl-Benzene	Xylene	TPH-Diesel	TDS	MTBE
<b>MW-8</b>															
06/23/92	8.94	-15.20	24.14	--	--	--	--	<50	<0.5	<0.5	<0.5	<0.5	<50	--	--
08/24/92	8.94	0.34	8.60	--	--	--	--	--	--	--	--	--	--	--	--
09/21/92	8.94	0.55	8.39	--	--	--	--	94	<0.5	<0.5	<0.5	<0.5	<50	--	--
10/26/92	8.94	-0.18	9.12	--	--	--	--	--	--	--	--	--	--	--	--
12/23/92	8.94	0.83	8.11	--	--	--	--	<50	0.7	5.0	0.7	2.9	79	--	--
01/08/93	8.94	--	--	--	--	--	--	--	--	--	--	--	--	--	--
03/25/93	8.94	--	--	--	--	--	--	--	--	--	--	--	--	--	--
06/11/93	8.94	0.55	8.39	--	--	--	--	<50	<0.5	<0.5	<0.5	<0.5	--	3500	--
09/29/93	8.94	0.69	8.25	--	--	--	--	<50	<0.5	<0.5	<0.5	<0.5	<10	--	--
12/20/93	8.94	0.48	8.46	--	--	--	--	<50	<0.5	0.6	<0.5	1.0	<10	--	--
03/07/94	8.94	0.28	8.66	--	--	--	--	<50	<0.5	<0.5	<0.5	<0.5	<10	--	--
06/17/94	8.94	0.12	8.82	--	--	--	--	<50	<0.5	<0.5	<0.5	<0.5	<50	--	--
09/12/94	8.94	0.11	8.83	--	--	--	--	<50	<0.5	<0.5	<0.5	0.8	<50	--	<5.0
11/30/94	8.94	0.31	8.63	--	--	--	--	<50	<0.5	<0.5	<0.5	<0.5	120*	--	--
03/24/95	8.94	0.43	8.51	--	--	--	--	<50	<0.5	<0.5	<0.5	<0.5	110**	--	--
06/27/95	8.94	-0.03	8.97	--	--	--	--	<50	<0.5	<0.5	<0.5	<0.5	67**	--	--
09/28/95	8.94	0.04	8.90	--	--	--	--	<50	<0.5	<0.5	<0.5	<0.5	91**	--	--
12/19/95	8.94	0.54	8.40	--	--	--	--	<50	<0.5	<0.5	<0.5	<0.5	76**	--	<2.5
02/28/96	8.94	0.50	8.44	--	--	--	--	<50	<0.5	<0.5	<0.5	<0.5	<50	--	<2.5
06/25/96	8.94	0.05	8.89	--	--	--	--	<50	<0.5	<0.5	<0.5	<0.5	80**	--	<2.5
12/17/96	8.94	0.49	8.45	--	--	--	--	<50	<0.5	<0.5	<0.5	<0.5	79**	--	<2.5
03/31/97	8.94	0.18	8.76	--	--	--	--	<50	<0.5	<0.5	<0.5	<0.5	72**	--	3.6
06/30/97	8.94	-0.18	9.12	--	--	--	Sampled annually	--	--	--	--	--	--	--	--
09/12/97	8.94	0.13	8.81	--	--	--	--	--	--	--	--	--	--	--	--
12/05/97	8.94	0.59	8.35	--	--	--	--	--	--	--	--	--	--	--	--
02/16/98	8.94	1.00	7.94	--	--	--	--	<50	<0.5	<0.5	<0.5	<0.5	68**	--	4.3
06/17/98	8.94	0.51	8.43	--	--	--	--	--	--	--	--	--	--	--	--
08/31/98	8.94	0.06	8.88	--	--	--	--	--	--	--	--	--	--	--	--
12/28/98	8.94	0.64	8.30	--	--	--	+	--	--	--	--	--	--	--	--
03/04/99	8.94	0.29	8.65	--	--	--	--	<50	<0.5	<0.5	<0.5	<0.5	106	--	3.83
06/14/99	8.94	0.52	8.42	--	--	--	--	--	--	--	--	--	--	--	--

\* Chromatogram pattern indicates a non-diesel mix.

\*\* Chromatogram pattern indicates an unidentified hydrocarbon.

+ See Additional Analyses.

### Cumulative Table of Well Data and Analytical Results

Vertical Measurements are in feet.

Volumetric Measurements are in gallons.

Analytical results are in parts per billion (ppb)

DATE	Well Head Elev.	Ground Water Elev.	Depth To Water	SPH Thickness	SPH Removed	Total SPH Removed	Notes	TPH-Gasoline	Benzene	Toluene	Ethyl-Benzene	Xylene	TPH-Diesel	TDS	MTBE
<b>MW-9</b>															
04/19/99	5.87	2.71	3.16	--	--	--	--	3900**	14	6.9	14	24	2600*	--	140
06/14/99	5.87	1.06	4.81	--	--	--	--	2880	12.6	<10	<10	<10	2800*	--	138

\* Chromatogram pattern indicates an unidentified hydrocarbon.

\*\* Laboratory report indicates gasoline and unidentified hydrocarbons >10.

## Cumulative Table of Well Data and Analytical Results

Vertical Measurements are in feet.

Volumetric Measurements are in gallons.

Analytical results are in parts per billion (ppb)

DATE	Well Head Elev.	Ground Water Elev.	Depth To Water	SPH Thickness	SPH Removed	Total SPH Removed	Notes	TPH-Gasoline	Benzene	Toluene	Ethyl-Benzene	Xylene	TPH-Diesel	TDS	MTBE
<b>TRIP BLANK</b>															
08/24/92	--	--	--	--	--	--	--	--	--	--	--	--	--	--	--
09/21/92	--	--	--	--	--	--	--	<50	<0.5	<0.5	<0.5	<0.5	--	--	--
10/26/92	--	--	--	--	--	--	--	--	--	--	--	--	--	--	--
12/23/92	--	--	--	--	--	--	--	<50	<0.5	<0.5	<0.5	<0.5	--	--	--
01/08/93	--	--	--	--	--	--	--	--	--	--	--	--	--	--	--
03/25/93	--	--	--	--	--	--	--	<50	<0.5	<0.5	<0.5	<0.5	--	--	--
06/11/93	--	--	--	--	--	--	--	<50	<0.5	<0.5	<0.5	<0.5	--	--	--
09/29/93	--	--	--	--	--	--	--	<50	<0.5	<0.5	<0.5	<0.5	--	--	--
12/20/93	--	--	--	--	--	--	--	<50	<0.5	<0.5	<0.5	<0.5	--	--	--
03/07/94	--	--	--	--	--	--	--	<50	<0.5	<0.5	<0.5	<0.5	--	--	--
06/17/94	--	--	--	--	--	--	--	<50	<0.5	<0.5	<0.5	<0.5	--	--	--
09/12/94	--	--	--	--	--	--	--	<50	<0.5	<0.5	<0.5	<0.5	1.0	--	--
11/30/94	--	--	--	--	--	--	--	<50	<0.5	<0.5	<0.5	<0.5	--	--	--
03/24/95	--	--	--	--	--	--	--	<50	<0.5	<0.5	<0.5	<0.5	--	--	--
06/27/95	--	--	--	--	--	--	--	<50	<0.5	<0.5	<0.5	<0.5	--	--	--
09/28/95	--	--	--	--	--	--	--	<50	<0.5	<0.5	<0.5	<0.5	--	--	--
12/19/95	--	--	--	--	--	--	--	<50	<0.5	<0.5	<0.5	<0.5	--	--	--
02/28/96	--	--	--	--	--	--	--	<50	<0.5	<0.5	<0.5	<0.5	--	--	--
06/25/96	--	--	--	--	--	--	--	<50	<0.5	<0.5	<0.5	<0.5	--	--	--
12/17/96	--	--	--	--	--	--	--	<50	<0.5	<0.5	<0.5	<0.5	--	--	<2.5
03/31/97	--	--	--	--	--	--	--	<50	<0.5	<0.5	<0.5	<0.5	--	--	<2.5
06/30/97	--	--	--	--	--	--	--	<50	<0.5	<0.5	<0.5	<0.5	--	--	<2.5
09/12/97	--	--	--	--	--	--	--	<50	<0.5	<0.5	<0.5	<0.5	--	--	<2.5
12/05/97	--	--	--	--	--	--	--	<50	<0.5	<0.5	<0.5	<0.5	--	--	<2.5
02/16/98	--	--	--	--	--	--	--	<50	<0.5	<0.5	<0.5	<0.5	--	--	<2.5
06/17/98	--	--	--	--	--	--	--	<50	<0.5	<0.5	<0.5	<0.5	--	--	<2.5
08/31/98	--	--	--	--	--	--	--	<50	<0.5	<0.5	<0.5	<0.5	--	--	<2.5
12/28/98	--	--	--	--	--	--	--	<50	<0.5	<0.5	<0.5	<0.5	--	--	<2.5
03/04/99	--	--	--	--	--	--	--	<50	<0.5	<0.5	<0.5	<0.5	--	--	<2.0
06/14/99	--	--	--	--	--	--	--	<50	<0.5	<0.5	<0.5	<0.5	--	--	<2.5

## Cumulative Table of Well Data and Analytical Results

### ADDITIONAL ANALYSES

Analytical values are in parts per billion (ppb)

DATE	Notes	Total Alkalinity	Ferrous Iron	Sulfate	Nitrate
<b>MW-1</b>					
12/28/98	--	390,000	4900	<1000	<1000
<b>MW-3</b>					
12/28/98	--	980,000	4500	390,000	<1000
<b>MW-4</b>					
12/28/98	--	670,000	3500	6800	<1000
<b>MW-5</b>					
12/28/98	--	480,000	15	51,000	<1000
<b>MW-6</b>					
12/28/98	--	2,400,000	810	110,000	<1000
<b>MW-7</b>					
12/28/98	--	350,000	12,000	79,000	<1000
<b>MW-8</b>					
12/28/98	--	1,100,000	45	87,000	<1000

Note: Blaine Tech Services, Inc. began routine monitoring of the groundwater wells at this site on November 1, 1994.  
 Earlier field data and analytical results are drawn from the September 27, 1994 Groundwater Technology, Inc. report.  
 Wells MW-2A, MW-3A, MW-4A and MW-9 were surveyed on April 12, 1999 by Virgil Chavez of Vallejo, California.

#### ABBREVIATIONS:

TPH = Total Petroleum Hydrocarbons  
 TDS = Total Dissolved Solids  
 MTBE = Methyl-tert-butyl Ether  
 SPH = Separate Phase Hydrocarbons

# Analytical Appendix



July 27, 1999

Christine Lillie  
Blaine Tech Services (Chev)  
1680 Rogers Avenue  
San Jose, CA 95112

RE: Chevron/M906289

Dear Christine Lillie

Enclosed are the results of analyses for sample(s) received by the laboratory on June 15, 1999. If you have any questions concerning this report, please feel free to contact me.

Sincerely,

Anne Fowler  
Project Manager

CA ELAP Certificate Number 1210





Blaine Tech Services (Chev) 1680 Rogers Avenue San Jose, CA 95112	Project: Chevron Project Number: 9-0121 Project Manager: Christine Lillie	Sampled: 6/14/99 Received: 6/15/99 Reported: 7/27/99
---	---	--

## ANALYTICAL REPORT FOR M906289

Sample Description	Laboratory Sample Number	Sample Matrix	Date Sampled
MW-1	M906289-01	Water	6/14/99
MW-2A	M906289-02	Water	6/14/99
MW-3A	M906289-03	Water	6/14/99
MW-4A	M906289-04	Water	6/14/99
MW9	M906289-05	Water	6/14/99
TB	M906289-06	Water	6/14/99







Blaine Tech Services (Chev) 1680 Rogers Avenue San Jose, CA 95112	Project: Chevron Project Number: 9-0121 Project Manager: Christine Lillie	Sampled: 6/14/99 Received: 6/15/99 Reported: 7/27/99
---	---	--

**Total Purgeable Hydrocarbons (C6-C12), BTEX and MTBE by DHS LUFT  
Sequoia Analytical - Morgan Hill**

Analyte	Batch Number	Date Prepared	Date Analyzed	Surrogate Limits	Reporting Limit	Result	Units	Notes*
<b>MW-1</b>			<b>M906289-01</b>			<b>Water</b>		
Purgeable Hydrocarbons	9060478	6/23/99	6/23/99		10000	ND	ug/l	D
Benzene	"	"	"		100	820	"	D
Toluene	"	"	"		100	240	"	D
Ethylbenzene	"	"	"		100	320	"	D
Xylenes (total)	"	"	"		100	640	"	D
Methyl tert-butyl ether	"	"	"		500	ND	"	D
Surrogate: a,a,a-Trifluorotoluene	"	"	"	70.0-130		96.0	%	
<b>MW-2A</b>			<b>M906289-02</b>			<b>Water</b>		
Purgeable Hydrocarbons	9060478	6/23/99	6/23/99		5000	ND	ug/l	D
Benzene	"	"	"		50.0	89.0	"	D
Toluene	"	"	"		50.0	ND	"	D
Ethylbenzene	"	"	"		50.0	66.0	"	D
Xylenes (total)	"	"	"		50.0	ND	"	D
Methyl tert-butyl ether	"	"	"		250	10000	"	D
Surrogate: a,a,a-Trifluorotoluene	"	"	"	70.0-130		91.0	%	
<b>MW-3A</b>			<b>M906289-03</b>			<b>Water</b>		
Purgeable Hydrocarbons	9060478	6/23/99	6/23/99		50.0	148	ug/l	
Benzene	"	"	"		0.500	4.55	"	
Toluene	"	"	"		0.500	0.820	"	
Ethylbenzene	"	"	"		0.500	0.530	"	
Xylenes (total)	"	"	"		0.500	1.10	"	
Methyl tert-butyl ether	"	"	"		2.50	3.70	"	
Surrogate: a,a,a-Trifluorotoluene	"	"	"	70.0-130		111	%	
<b>MW-4A</b>			<b>M906289-04</b>			<b>Water</b>		
Purgeable Hydrocarbons	9060478	6/23/99	6/23/99		2000	5360	ug/l	D
Benzene	"	"	"		20.0	312	"	D
Toluene	"	"	"		20.0	ND	"	D
Ethylbenzene	"	"	"		20.0	44.0	"	D
Xylenes (total)	"	"	"		20.0	ND	"	D
Methyl tert-butyl ether	"	"	"		100	2880	"	D
Surrogate: a,a,a-Trifluorotoluene	"	"	"	70.0-130		162	%	
<b>MW9</b>			<b>M906289-05</b>			<b>Water</b>		
Purgeable Hydrocarbons	9060483	6/22/99	6/24/99		1000	2880	ug/l	1,D
Benzene	"	"	"		10.0	12.6	"	D
Toluene	"	"	"		10.0	ND	"	D
Ethylbenzene	"	"	"		10.0	ND	"	D
Xylenes (total)	"	"	"		10.0	ND	"	D





Blaine Tech Services (Chev) 1680 Rogers Avenue San Jose, CA 95112	Project: Chevron Project Number: 9-0121 Project Manager: Christine Lillie	Sampled: 6/14/99 Received: 6/15/99 Reported: 7/27/99
---	---	--

**Total Purgeable Hydrocarbons (C6-C12), BTEX and MTBE by DHS LUFT  
Sequoia Analytical - Morgan Hill**

Analyte	Batch Number	Date Prepared	Date Analyzed	Surrogate Limits	Reporting Limit	Result	Units	Notes*
<b>MW9 (continued)</b>				<b>M906289-05</b>			<b>Water</b>	
Methyl tert-butyl ether	9060483	6/22/99	6/24/99		50.0	138	ug/l	D
Surrogate: <i>a,a,a</i> -Trifluorotoluene	"	"	"	70.0-130		88.0	%	
<b>TB</b>				<b>M906289-06</b>			<b>Water</b>	
Purgeable Hydrocarbons	9060478	6/23/99	6/23/99		50.0	ND	ug/l	
Benzene	"	"	"		0.500	ND	"	
Toluene	"	"	"		0.500	ND	"	
Ethylbenzene	"	"	"		0.500	ND	"	
Xylenes (total)	"	"	"		0.500	ND	"	
Methyl tert-butyl ether	"	"	"		2.50	ND	"	
Surrogate: <i>a,a,a</i> -Trifluorotoluene	"	"	"	70.0-130		96.0	%	





Blaine Tech Services (Chev) 1680 Rogers Avenue San Jose, CA 95112	Project: Chevron Project Number: 9-0121 Project Manager: Christine Lillie	Sampled: 6/14/99 Received: 6/15/99 Reported: 7/27/99
---	---	--

**Diesel Hydrocarbons (C9-C24) by DHS LUFT  
Sequoia Analytical - Morgan Hill**

Analyte	Batch Number	Date Prepared	Date Analyzed	Surrogate Limits	Reporting Limit	Result	Units	Notes*
<u>MW-1</u> Diesel Range Hydrocarbons	9060234	6/21/99	6/24/99	<u>M906289-01</u>	0.0500	2.50	<u>Water</u> mg/l	2
Surrogate: n-Pentacosane	"	"	"	50.0-150		120	%	
<u>MW-2A</u> Diesel Range Hydrocarbons	9060234	6/21/99	6/24/99	<u>M906289-02</u>	0.0500	2.00	<u>Water</u> mg/l	2
Surrogate: n-Pentacosane	"	"	"	50.0-150		104	%	
<u>MW-3A</u> Diesel Range Hydrocarbons	9060234	6/21/99	6/24/99	<u>M906289-03</u>	0.0500	0.160	<u>Water</u> mg/l	2
Surrogate: n-Pentacosane	"	"	"	50.0-150		99.0	%	
<u>MW-4A</u> Diesel Range Hydrocarbons	9060234	6/21/99	6/24/99	<u>M906289-04</u>	0.0500	2.50	<u>Water</u> mg/l	2
Surrogate: n-Pentacosane	"	"	"	50.0-150		98.0	%	
<u>MW9</u> Diesel Range Hydrocarbons	9060234	6/21/99	6/24/99	<u>M906289-05</u>	0.0500	2.80	<u>Water</u> mg/l	2
Surrogate: n-Pentacosane	"	"	"	50.0-150		77.0	%	





Blaine Tech Services (Chev) 1680 Rogers Avenue San Jose, CA 95112	Project: Chevron Project Number: 9-0121 Project Manager: Christine Lillie	Sampled: 6/14/99 Received: 6/15/99 Reported: 7/27/99
---	---	--

**Total Purgeable Hydrocarbons (C6-C12), BTEX and MTBE by DHS LUFT/Quality Control  
Sequoia Analytical - Morgan Hill**

Analyte	Date Analyzed	Spike Level	Sample Result	QC Result	Units	Reporting Limit Recov. Limits	Recov. %	RPD Limit	RPD %	Notes*
<b>Batch: 9060478</b>		<b>Date Prepared: 6/23/99</b>		<b>Extraction Method: EPA 5030B [P/T]</b>						
<b>Blank</b>		<b>9060478-BLK1</b>								
Purgeable Hydrocarbons	6/23/99			ND	ug/l	50.0				
Benzene	"			ND	"	0.500				
Toluene	"			ND	"	0.500				
Ethylbenzene	"			ND	"	0.500				
Xylenes (total)	"			ND	"	0.500				
Methyl tert-butyl ether	"			ND	"	2.50				
Surrogate: a,a,a-Trifluorotoluene	"	10.0		9.50	"	70.0-130	95.0			
<b>LCS</b>		<b>9060478-BS1</b>								
Purgeable Hydrocarbons	6/23/99	250		273	ug/l	70.0-130	109			
Surrogate: a,a,a-Trifluorotoluene	"	10.0		13.1	"	70.0-130	131			3
<b>LCS</b>		<b>9060478-BS2</b>								
Benzene	6/23/99	10.0		9.30	ug/l	70.0-130	93.0			
Toluene	"	10.0		10.8	"	70.0-130	108			
Ethylbenzene	"	10.0		10.8	"	70.0-130	108			
Xylenes (total)	"	30.0		32.6	"	70.0-130	109			
Surrogate: a,a,a-Trifluorotoluene	"	10.0		10.6	"	70.0-130	106			
<b>LCS Dup</b>		<b>9060478-BSD1</b>								
Purgeable Hydrocarbons	6/23/99	250		294	ug/l	70.0-130	118	25.0	7.93	
Surrogate: a,a,a-Trifluorotoluene	"	10.0		12.5	"	70.0-130	125			
<b>LCS Dup</b>		<b>9060478-BSD2</b>								
Benzene	6/23/99	10.0		9.30	ug/l	70.0-130	93.0	25.0	0	
Toluene	"	10.0		10.8	"	70.0-130	108	25.0	0	
Ethylbenzene	"	10.0		10.8	"	70.0-130	108	25.0	0	
Xylenes (total)	"	30.0		32.6	"	70.0-130	109	25.0	0	
Surrogate: a,a,a-Trifluorotoluene	"	10.0		10.6	"	70.0-130	106			
<b>Batch: 9060483</b>		<b>Date Prepared: 6/22/99</b>		<b>Extraction Method: EPA 5030B [P/T]</b>						
<b>Blank</b>		<b>9060483-BLK1</b>								
Purgeable Hydrocarbons	6/22/99			ND	ug/l	50.0				
Benzene	"			ND	"	0.500				
Toluene	"			ND	"	0.500				
Ethylbenzene	"			ND	"	0.500				
Xylenes (total)	"			ND	"	0.500				
Methyl tert-butyl ether	"			ND	"	2.50				
Surrogate: a,a,a-Trifluorotoluene	"	10.0		9.90	"	70.0-130	99.0			





Blaine Tech Services (Chev) 1680 Rogers Avenue San Jose, CA 95112	Project: Chevron Project Number: 9-0121 Project Manager: Christine Lillie	Sampled: 6/14/99 Received: 6/15/99 Reported: 7/27/99
---	---	--

**Total Purgeable Hydrocarbons (C6-C12), BTEX and MTBE by DHS-EUFI/Quality Control**  
**Sequoia Analytical - Morgan Hill**

Analyte	Date Analyzed	Spike Level	Sample Result	QC Result	Units	Reporting Limit Recov. Limits	Recov. %	RPD Limit	RPD %	Notes*
<b>LCS 9060483-BS1</b>										
Benzene	6/22/99	10.0		10.1	ug/l	70.0-130	101			
Toluene	"	10.0		10.0	"	70.0-130	100			
Ethylbenzene	"	10.0		10.0	"	70.0-130	100			
Xylenes (total)	"	30.0		30.0	"	70.0-130	100			
Surrogate: a,a,a-Trifluorotoluene	"	10.0		9.60	"	70.0-130	96.0			
<b>LCS 9060483-BS2</b>										
Purgeable Hydrocarbons	6/24/99	250		290	ug/l	70.0-130	116			
Surrogate: a,a,a-Trifluorotoluene	"	10.0		11.1	"	70.0-130	111			
<b>LCS Dup 9060483-BSD2</b>										
Purgeable Hydrocarbons	6/24/99	250		260	ug/l	70.0-130	104	25.0	10.9	
Surrogate: a,a,a-Trifluorotoluene	"	10.0		10.5	"	70.0-130	105			
<b>Matrix Spike 9060483-MS1 M906018-08</b>										
Benzene	6/22/99	10.0	ND	9.80	ug/l	60.0-140	98.0			
Toluene	"	10.0	ND	9.70	"	60.0-140	97.0			
Ethylbenzene	"	10.0	ND	10.0	"	60.0-140	100			
Xylenes (total)	"	30.0	ND	31.0	"	60.0-140	103			
Surrogate: a,a,a-Trifluorotoluene	"	10.0		ND	"	70.0-130	ND			4
<b>Matrix Spike Dup 9060483-MSD1 M906018-08</b>										
Benzene	6/22/99	10.0	ND	10.0	ug/l	60.0-140	100	25.0	2.02	
Toluene	"	10.0	ND	9.90	"	60.0-140	99.0	25.0	2.04	
Ethylbenzene	"	10.0	ND	10.1	"	60.0-140	101	25.0	0.995	
Xylenes (total)	"	30.0	ND	31.0	"	60.0-140	103	25.0	0	
Surrogate: a,a,a-Trifluorotoluene	"	10.0		ND	"	70.0-130	ND			5





Blaine Tech Services (Chev) 1680 Rogers Avenue San Jose, CA 95112	Project: Chevron Project Number: 9-0121 Project Manager: Christine Lillie	Sampled: 6/14/99 Received: 6/15/99 Reported: 7/27/99
---	---	--

**Diesel Hydrocarbons (C9-C24) by DHS LUFT/Quality Control  
Sequoia Analytical - Morgan Hill**

Analyte	Date Analyzed	Spike Level	Sample Result	QC Result	Units	Reporting Limit Recov. Limits	Recov. %	RPD Limit	RPD %	Notes*
<b>Batch: 9060234</b>			<b>Date Prepared: 6/21/99</b>			<b>Extraction Method: EPA 3510B</b>				
<b>Blank</b>			<b>9060234-BLK1</b>							
Diesel Range Hydrocarbons	6/24/99			ND	mg/l	0.0500				
Surrogate: <i>n</i> -Pentacosane	"	0.100		0.0960	"	50.0-150	96.0			
<b>LCS</b>			<b>9060234-BS1</b>							
Diesel Range Hydrocarbons	6/24/99	1.00		0.890	mg/l	60.0-140	89.0			
Surrogate: <i>n</i> -Pentacosane	"	0.100		0.0970	"	50.0-150	97.0			
<b>Matrix Spike</b>			<b>9060234-MS1 M906278-01</b>							
Diesel Range Hydrocarbons	6/24/99	1.00	0.270	1.10	mg/l	50.0-150	83.0			
Surrogate: <i>n</i> -Pentacosane	"	0.100		0.0950	"	50.0-150	95.0			
<b>Matrix Spike Dup</b>			<b>9060234-MSD1 M906278-01</b>							
Diesel Range Hydrocarbons	6/24/99	1.00	0.270	1.10	mg/l	50.0-150	83.0	50.0	0	
Surrogate: <i>n</i> -Pentacosane	"	0.100		0.109	"	50.0-150	109			





Blaine Tech Services (Chev) 1680 Rogers Avenue San Jose, CA 95112	Project: Chevron Project Number: 9-0121 Project Manager: Christine Lillie	Sampled: 6/14/99 Received: 6/15/99 Reported: 7/27/99
---	---	--

**Notes and Definitions**

#	Note
---	------

- D Data reported from a dilution.
- 1 Chromatogram Pattern: Weathered Gasoline C6-C12
- 2 Chromatogram Pattern: Unidentified Hydrocarbons C9-C24
- 3 The surrogate recovery for this sample is outside of established control limits due to a sample matrix effect.
- 4 MS sample was inadvertently not spiked with surrogate. All analytes are in range. Lcs and Lcs Dup validate QC batch.
- 5 MSD sample was inadvertently not spiked with surrogate. All analytes are in range. Lcs and Lcs Dup validate QC batch.
- DET Analyte DETECTED
- ND Analyte NOT DETECTED at or above the reporting limit
- NR Not Reported
- dry Sample results reported on a dry weight basis
- Recov. Recovery
- RPD Relative Percent Difference



# **Field Data Sheets**





## CHEVRON WELL MONITORING DATA SHEET

Project #: <u>990614-MT</u>	Station #: <u>9-0121</u>
Sampler: <u>MT</u>	Date: <u>6-14-99</u>
Well I.D.: <u>MW-1</u>	Well Diameter: 2 3 <u>4</u> 6 8
Total Well Depth: <u>19.15</u>	Depth to Water: <u>5.00</u>
Depth to Free Product:	Thickness of Free Product (feet):
Referenced to: PVC Grade	D.O. Meter (if req'd): YSI HACH

Well Diameter	Multiplier	Well Diameter	Multiplier
2"	0.16	5"	1.02
3"	0.37	6"	1.47
4"	0.65	Other	radius <sup>2</sup> * 0.163

Purge Method:  Bailer      Sampling Method:  Bailer  
 Disposable Bailer       Disposable Bailer  
 Middleburg       Extraction Port  
DO\*  Electric Submersible  
 Extraction Pump      Other: \_\_\_\_\_

<u>9.1</u>	x	<u>3</u>	=	<u>27.3</u>	Gals.
1 Case Volume (Gals.)		Specified Volumes		Calculated Volume	

Time	Temp (°F)	pH	Cond.	Gals. Removed	Observations
<u>11:00</u>	<u>66.0</u>	<u>6.8</u>	<u>8900</u>	<u>10</u>	
<u>11:02</u>	<u>66.4</u>	<u>7.6</u>	<u>4700</u>	<u>19</u>	
<u>11:03</u>	<u>66.9</u>	<u>7.8</u>	<u>1341</u>	<u>27.5</u>	
<u>11:04</u>	<u>66.8</u>	<u>7.9</u>	<u>1263</u>	<u>38.5</u>	

Did well dewater? Yes  No  Gallons actually evacuated: 27.3 38.5

Sampling Time: 11:12      Sampling Date: 6-14-99

Sample I.D.: MW-1      Laboratory: Sequoia CORE N. Creek Assoc. Labs

Analyzed for: TPH-G BTEX MTBE TPH-D Other: \_\_\_\_\_

Duplicate I.D.: \_\_\_\_\_ Analyzed for: TPH-G BTEX MTBE TPH-D Other: \_\_\_\_\_

D.O. (if req'd):	Pre-purge: <u>1.3</u> mg/L	Post-purge: _____ mg/L
O.R.P. (if req'd):	Pre-purge: _____ mV	Post-purge: _____ mV

## CHEVRON WELL MONITORING DATA SHEET

Project #: 990614-m1	Station #: 9-0121
Sampler: MT	Date: 6-14-99
Well I.D.: MW-2A	Well Diameter: ② 3 4 6 8
Total Well Depth: 17.10	Depth to Water: 8.30
Depth to Free Product:	Thickness of Free Product (feet):
Referenced to: PVC Grade	D.O. Meter (if req'd): YSI HACH

Well Diameter	Multiplier	Well Diameter	Multiplier
2"	0.16	5"	1.02
3"	0.37	6"	1.47
4"	0.65	Other	radius <sup>2</sup> * 0.163

Purge Method:

Bailer  
 Disposable Bailer  
 Middleburg  
 Electric Submersible  
 Extraction Pump

Sampling Method:

Bailer  
 Disposable Bailer  
 Extraction Port  
 Other: \_\_\_\_\_

Other: \_\_\_\_\_

1.8	x	3	=	5.4	Gals.
1 Case Volume (Gals.)		Specified Volumes		Calculated Volume	

Time	Temp (°F)	pH	Cond.	Gals. Removed	Observations
11:25	67.7	7.3	6100	2	
11:27	66.3	7.4	7067	4	
11:30	66.4	7.4	7102	5.5	

Did well dewater? Yes  No  Gallons actually evacuated: 5.5

Sampling Time: 11:34 Sampling Date: 6-14-99

Sample I.D.: MW-2A Laboratory: Sequoia CORE N. Creek Assoc. Labs

Analyzed for: TPH-G BTEX MTBE TPH-D Other: \_\_\_\_\_

Duplicate I.D.: \_\_\_\_\_ Analyzed for: TPH-G BTEX MTBE TPH-D Other: \_\_\_\_\_

D.O. (if req'd): Pre-purge: \_\_\_\_\_ mg/L Post-purge: \_\_\_\_\_ mg/L

O.R.P. (if req'd): Pre-purge: \_\_\_\_\_ mV Post-purge: \_\_\_\_\_ mV

## CHEVRON WELL MONITORING DATA SHEET

Project #: <u>990614-m1</u>	Station #: <u>9-0121</u>
Sampler: <u>MT</u>	Date: <u>6-14-99</u>
Well I.D.: <u>MW-3A</u>	Well Diameter: <u>(2)</u> 3 4 6 8 _____
Total Well Depth: <u>17.75</u>	Depth to Water: <u>8.20</u>
Depth to Free Product:	Thickness of Free Product (feet):
Referenced to: PVC Grade	D.O. Meter (if req'd): YSI HACH

Well Diameter	Multiplier	Well Diameter	Multiplier
2"	0.16	5"	1.02
3"	0.37	6"	1.47
4"	0.65	Other	radius <sup>2</sup> * 0.165

Purge Method: Bailer  
~~Disposable Bailer~~  
 Middleburg  
 Electric Submersible  
 Extraction Pump  
 Other: \_\_\_\_\_

Sampling Method: Bailer  
~~Disposable Bailer~~  
 Extraction Port  
 Other: \_\_\_\_\_

<u>1.5</u>	<u>x</u>	<u>3</u>	<u>=</u>	<u>4.5</u>	Gals.
1 Case Volume (Gals.)		Specified Volumes		Calculated Volume	

Time	Temp (°F)	pH	Cond.	Gals. Removed	Observations
<u>10:20</u>	<u>66.3</u>	<u>7.8</u>	<u>5900</u>	<u>1.5</u>	
<u>10:22</u>	<u>65.8</u>	<u>7.4</u>	<u>6500</u>	<u>3</u>	
<u>10:24</u>	<u>65.5</u>	<u>7.3</u>	<u>6595</u>	<u>4.5</u>	

Did well dewater? Yes  No  Gallons actually evacuated: 4.5

Sampling Time: 10:30 Sampling Date: 6-14-99

Sample I.D.: MW3A Laboratory: Sequoia CORE N. Creek Assoc. Labs

Analyzed for: ~~TPH-G BTEX MTBE TPH-D~~ Other: \_\_\_\_\_

Duplicate I.D.: \_\_\_\_\_ Analyzed for: TPH-G BTEX MTBE TPH-D Other: \_\_\_\_\_

D.O. (if req'd):	Pre-purge:	mg/L	Post-purge:	mg/L
O.R.P. (if req'd):	Pre-purge:	mV	Post-purge:	mV

## CHEVRON WELL MONITORING DATA SHEET

Project #: <u>990614-m1</u>	Station #: <u>9-0121</u>
Sampler: <u>MT</u>	Date: <u>6-14-99</u>
Well I.D.: <u>MW-4A</u>	Well Diameter: <u>(2)</u> 3 4 6 8 _____
Total Well Depth: <u>18.25</u>	Depth to Water: <u>5.25</u>
Depth to Free Product:	Thickness of Free Product (feet):
Referenced to: PVC Grade	D.O. Meter (if req'd): YSI HACH

Well Diameter	Multiplier	Well Diameter	Multiplier
2"	0.16	3"	1.02
3"	0.37	6"	1.47
4"	0.65	Other	radius <sup>2</sup> * 0.165

Purge Method: Bailer  
~~Disposable Bailer~~  
 Middleburg  
 Electric Submersible  
 Extraction Pump  
 Other: \_\_\_\_\_

Sampling Method: Bailer  
~~Disposable Bailer~~  
 Extraction Port  
 Other: \_\_\_\_\_

<u>2.0</u>	x	<u>3</u>	=	<u>6</u>	Gals.
1 Case Volume (Gals.)		Specified Volumes		Calculated Volume	

Time	Temp (°F)	pH	Cond.	Gals. Removed	Observations
<u>10:38</u>	<u>67.6</u>	<u>8.2</u>	<u>3643</u>	<u>2</u>	
<u>10:41</u>	<u>67.6</u>	<u>7.7</u>	<u>3000</u>	<u>4</u>	
<u>10:43</u>	<u>67.0</u>	<u>7.6</u>	<u>3127</u>	<u>6</u>	

Did well dewater? Yes  No  Gallons actually evacuated: 6

Sampling Time: 10:50 Sampling Date: 6-14-99

Sample I.D.: MW-4A Laboratory: Sequera CORE N. Creek Assoc. Labs

Analyzed for: TPH-G BTEX MTBE TPH-D Other: \_\_\_\_\_

Duplicate I.D.: \_\_\_\_\_ Analyzed for: TPH-G BTEX MTBE TPH-D Other: \_\_\_\_\_

D.O. (if req'd):	Pre-purge:	mg/L	Post-purge:	mg/L
D.R.P. (if req'd):	Pre-purge:	mV	Post-purge:	mV

## CHEVRON WELL MONITORING DATA SHEET

Project #: <u>990614-M1</u>	Station #: <u>9-0121</u>
Sampler: <u>MT</u>	Date: <u>6-14-99</u>
Well I.D.: <u>MW-9</u>	Well Diameter: <u>(2)</u> 3 4 6 8
Total Well Depth: <u>16.40</u>	Depth to Water: <u>4.81</u>
Depth to Free Product:	Thickness of Free Product (feet):
Referenced to: PVC Grade	D.O. Meter (if req'd): YSI HACH

Well Diameter	Multiplier	Well Diameter	Multiplier
2"	0.16	5"	1.02
3"	0.37	6"	1.47
4"	0.65	Other	radius <sup>2</sup> * 0.163

Purge Method: <u>Bailer</u> <u>Disposable Bailer</u> Middleburg Electric Submersible Extraction Pump Other: _____	Sampling Method: <u>Bailer</u> <u>Disposable Bailer</u> Extraction Port Other: _____
--	---

<u>1.8</u>	<u>x</u>	<u>3</u>	<u>=</u>	<u>5.4</u>	Gals.
1 Case Volume (Gals.)		Specified Volumes		Calculated Volume	

Time	Temp (°F)	pH	Cond.	Gals. Removed	Observations
<u>11:45</u>	<u>66.9</u>	<u>8.7</u>	<u>1406</u>	<u>2.0</u>	
<u>11:47</u>	<u>66.8</u>	<u>8.5</u>	<u>1044</u>	<u>4.0</u>	
<u>11:50</u>	<u>66.8</u>	<u>8.5</u>	<u>1038</u>	<u>5.5</u>	

Did well dewater? Yes <input checked="" type="checkbox"/> No <input checked="" type="checkbox"/>	Gallons actually evacuated: <u>5.5</u>
Sampling Time: <u>11:55</u>	Sampling Date: <u>6-14-99</u>
Sample I.D.: <u>MW-9</u>	Laboratory: <u>Sequoia</u> CORE N. Creek Assoc. Labs
Analyzed for: <u>TPH-G BTEX MTBE TPH-D</u> Other: _____	
Duplicate I.D.: _____	Analyzed for: TPH-G BTEX MTBE TPH-D Other: _____
D.O. (if req'd):	Pre-purge: <u>mg/L</u> Post-purge: <u>mg/L</u>
D.R.P. (if req'd):	Pre-purge: <u>mV</u> Post-purge: <u>mV</u>