



Chevron

PROTECTION

59 FEB 23 PM 4:59

Chevron Products Company
6001 Bollinger Canyon Road
Building L, Room 1110
PO Box 6004
San Ramon, CA 94583-0904

Philip R. Briggs
Project Manager
Site Assessment & Remediation
Phone 925 842-9136
Fax 925 842-8370

February 19, 1999

Ms. Eva Chu
Alameda County Health Care Services
Department of Environmental Health
1131 Harbor Bay Parkway, Suite 250
Alameda, CA 94502-6577

Re: Chevron Service Station #9-0121
3026 Lakeshore Avenue
Oakland, California

Dear Ms. Chu:

Enclosed is the Fourth Quarter Groundwater Monitoring Report for 1998, prepared by our consultant Blaine Tech Services, Inc. for the above noted site. The groundwater samples were analyzed for the presence of TPH-g, TPH-d, BTEX and MtBE constituents. Monitoring wells MW-5 and MW-6 are sampled semi-annually (1st and 3rd quarters), while wells MW-7 and MW-8 are sampled annually (1st quarter). The remaining four wells are sampled quarterly. All wells are measured for groundwater depth.

Monitoring wells MW-1 and MW-4 showed a decline in the benzene constituent from the previous sampling event, while it increased in well MW-3. A small amount of **separate phase hydrocarbon (0.10 feet) was detected in monitoring well MW-2 with 0.005 gals of hydrocarbons removed.**

For the record, note that the diameter of monitoring wells MW-2, MW-3 and MW-4 is only 3/4 inch. The chromatogram pattern for the TPH-d constituents detected in wells MW-1, MW-3 and MW-4 indicated an unidentified hydrocarbon.

Depth to groundwater varied from 4.47 feet to 13.43 feet below grade with a direction of flow varying southwesterly.

February 19, 1999
Ms. Eva Chu
Chevron Service Station #9-0121
Page 2

Chevron believes it would be appropriate to replace the existing 3/4 inch diameter monitoring wells MW-2, MW-3 and MW-4 with 2-inch diameter wells. This would provide the flexibility for installing Oxygen Releasing Compounds (ORC's) or other options in which to address the hydrocarbons that are presently being detected in these wells. In the course of installing the replacement wells, Chevron will take samples that can be utilized for developing a Risk Based Corrective Action (RBCA) for the site. A work plan has been submitted to your office for approval to replace the wells, however, the approval was placed on hold until bio-parameters were analyzed for.

Therefore, **bio-parameters were taken** in this sampling event with the results noted in the Cumulative Table of Well Data and Analytical Results. Dissolved Oxygen (DO) and Oxygen Reduction Potential (ORP) was also measured for each well, with the DO and ORP results shown on the Well Monitoring Data Sheets.

I did a rough analysis to see if bio-remediation was occurring at the site and ~~three of the six~~ parameters were **positive for bio-remediation**. This was using wells MW-3 and MW-4 as upgradient wells to the downgradient MW-1 well. Therefore, it appears that some bio-remediation is occurring at the site. However, **the DO reading in all wells was very low and increasing the oxygen concentration will improve any bio-remediation that is now occurring at the site.**

which 3, I only see 2.

Chevron will continue to monitor the wells in the sampling frequency as noted above. If you have any questions or comments, please call me at (925) 842-9136.

Sincerely,
CHEVRON PRODUCTS COMPANY



Philip R. Briggs
Site Assessment and Remediation Project Manager

Enclosure

Cc. Mr. Bill Scudder, Chevron

BLAINE
TECH SERVICES INC.



1680 ROGERS AVENUE
SAN JOSE, CA 95112-1105
(408) 573-7771 FAX
(408) 573-0555 PHONE

February 15, 1999

Phil Briggs
Chevron U.S.A. Products Company
P.O. Box 6004
San Ramon, CA 94583-0904

4th Quarter 1998 Monitoring at 9-0121

Fourth Quarter 1998 Groundwater Monitoring at
Chevron Service Station Number 9-0121
3026 Lakeshore Avenue
Oakland, CA

Monitoring Performed on December 28, 1998

Groundwater Sampling Report 981228-G-2

This report covers the routine monitoring of groundwater wells at this Chevron facility. Blaine Tech Services, Inc.'s work at the site includes inspection, gauging, evacuation, purgewater containment, sample collection and sample handling in accordance with standard procedures that conform to Regional Water Quality Control Board requirements.

Routine field data collection includes depth to water, total well depth, thickness of any separate immiscible layer, water column volume, calculated volume of a three-case volume purge, elapsed evacuation time, total volume of water removed, and standard water parameter instrument readings. Sample material is collected, contained, stored, and transported to the laboratory in conformance with EPA standards. Purgewater is, likewise, collected and transported to McKittrick Waste Treatment Site for disposal.

Basic field information is presented alongside analytical values excerpted from the laboratory report in the cumulative table of **WELL DATA AND ANALYTICAL RESULTS**. The full analytical report for the most recent samples is located in the **Analytical Appendix**. The table also contains new groundwater elevation calculations taken from the computer plotted gradient

map which is located in the **Professional Engineering Appendix**.

At a minimum, Blaine Tech Services, Inc. field personnel are certified upon completion of a forty-hour Hazardous Materials and Emergency Response training course per 29 CFR 1910.120. Field personnel are also enrolled in annual eight hour refresher courses.

Blaine Tech Services, Inc. conducts sampling and documentation assignments of this type as an independent third party. In order to avoid compromising the objectivity necessary for the proper and disinterested performance of this work, Blaine Tech Services, Inc. concentrates on objective data collection and does not participate in the interpretation of analytical results, the definition of geological or hydrological conditions, the formulation of recommendations, or the marketing of remedial systems.

Please call if you have any questions.

Yours truly,

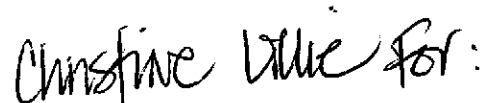

Francis Thie
Vice President

FPT/dg

attachments: Professional Engineering Appendix
Cumulative Table of Well Data and Analytical Results
Analytical Appendix
Field Data Sheets

Professional Engineering Appendix

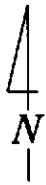

SCALE (ft)



EXPLANATION

- ⊙ MONITORING WELL LOCATION
- 0.79 GROUNDWATER ELEVATION (FT, MSL)
- 1.00 — GROUNDWATER ELEVATION CONTOUR (FT, MSL)
- ⇐ APPROXIMATE GROUNDWATER FLOW DIRECTION;
APPROXIMATE GRADIENT = 0.01

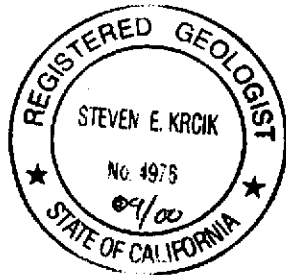
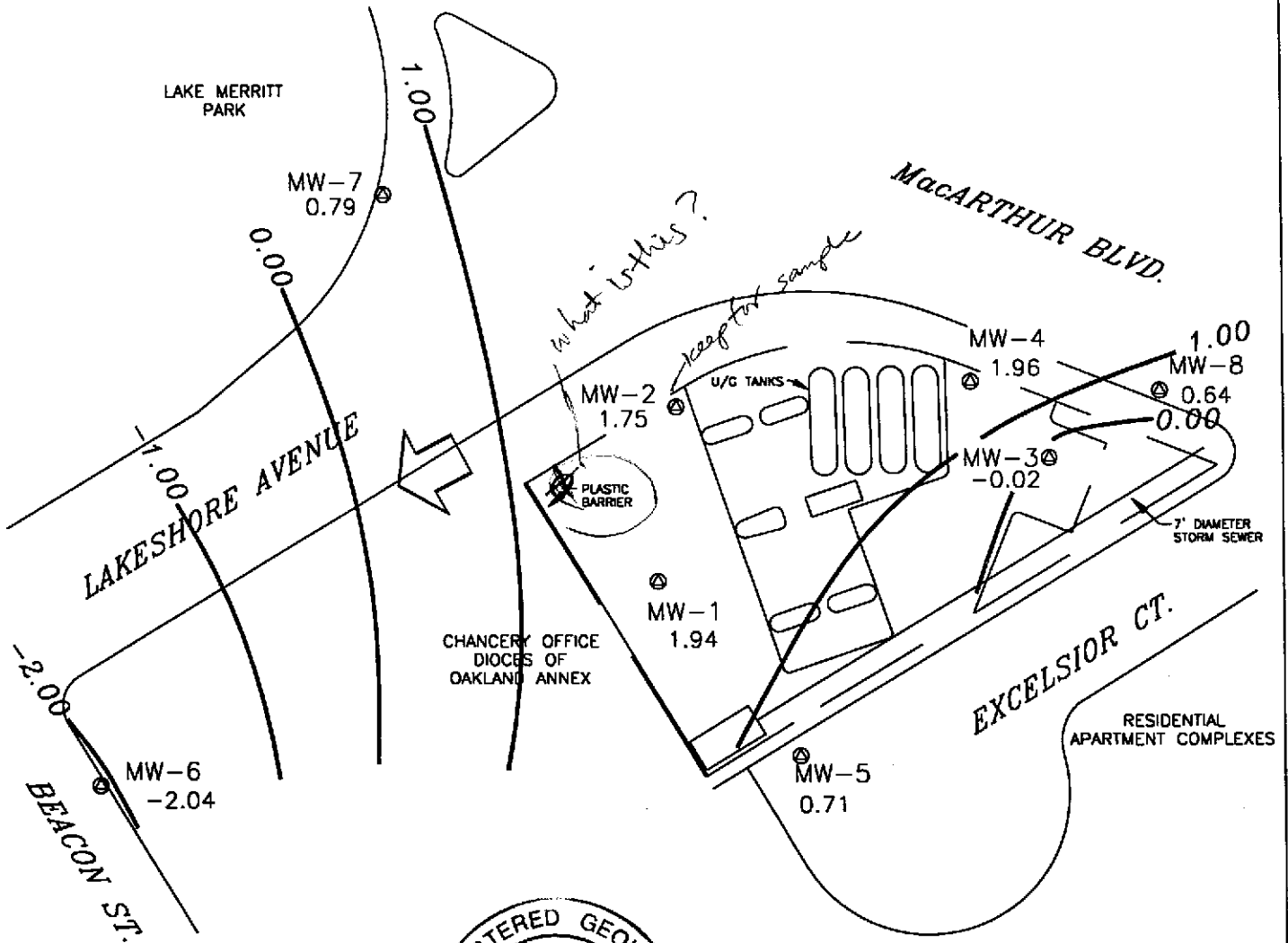

Basemap from Geoconsultants, Inc.

PREPARED BY



Chevron Station 9-0121
3026 Lakeshore Avenue
Oakland, California

GROUNDWATER ELEVATION CONTOUR MAP,
DECEMBER 28, 1998

FIGURE:
1
PROJECT:
DAC04

Table of Well Data and Analytical Results

Cumulative Table of Well Data and Analytical Results

Vertical Measurements are in feet.

Volumetric Measurements are in gallons.

Analytical results are in parts per billion (ppb)

DATE	Vertical Measurements are in feet.			Volumetric Measurements are in gallons.				Analytical results are in parts per billion (ppb)							
	Well Head Elev.	Ground Water Elev.	Depth To Water	SPH Thickness	SPH Removed	Total SPH Removed	Notes	TPH-Gasoline	Benzene	Toluene	Ethyl-Benzene	Xylene	TPH-Diesel	TDS	MTBE
MW-1															
08/20/91	6.82	1.62	5.20	--	--	--	--	5100	1700	21	220	34	260	--	--
09/30/91	6.82	1.15	5.67	Sheen	--	--	--	--	--	--	--	--	--	--	--
10/28/91	6.82	1.50	5.30	0.03	--	--	--	--	--	--	--	--	--	--	--
01/08/92	6.82	1.67	5.15	Sheen	--	--	--	5400	770	13	95	31	4400	--	--
01/13/92	6.82	--	--	--	--	--	--	--	--	--	--	--	--	--	--
06/23/92	6.89	1.48	5.41	--	--	--	--	7700	1500	40	230	100	2000	--	--
08/24/92	6.89	1.12	5.77	--	--	--	--	--	--	--	--	--	--	--	--
09/21/92	6.89	1.00	5.89	--	--	--	--	3500	1700	28	190	78	<50	--	--
10/26/92	6.89	0.95	5.94	--	--	--	--	--	--	--	--	--	--	--	--
12/23/92	6.89	2.18	4.71	--	--	--	--	60,000	7100	240	2000	1300	5500	--	--
01/08/93	6.89	--	--	--	--	--	--	--	--	--	--	--	--	--	--
03/25/93	6.89	2.17	4.72	--	--	--	--	530	1100	41	67	79	<10	--	--
06/11/93	6.89	5.37	5.07	--	--	--	--	7000	1900	33	120	69	--	840	9600
09/29/93	6.89	1.13	5.76	--	--	--	--	6600	1600	28	43	74	<10	--	--
12/20/93	6.89	1.74	5.15	--	--	--	--	6300	1900	36	82	65	<10	--	--
03/07/94	6.89	2.21	4.68	--	--	--	--	7700	1100	55	66	38	<10	--	12,000
06/17/94	6.89	1.83	5.06	--	--	--	--	4300	710	12	90	38	2200	--	--
09/12/94	6.89	1.24	5.65	--	--	--	--	6400	1500	<25	180	<25	2500	--	12,000
11/30/94	6.89	2.32	4.57	--	--	--	--	4900	690	26	97	60	2300*	--	3900
03/24/95	6.89	3.91	2.98	--	--	--	--	1800	160	7.3	11	14	1400**	--	1300
06/27/95	6.89	1.87	5.02	--	--	--	--	4600	1300	11	97	13	2300**	--	5100
09/28/95	6.89	1.59	5.30	--	--	--	--	6600	1500	<20	<20	<20	3900**	--	5800
12/19/95	6.89	2.21	4.68	--	--	--	--	3800	930	<10	100	<10	2600**	--	6300
02/28/96	6.89	3.27	3.62	--	--	--	--	3600	280	<5.0	18	5.5	1800**	--	2200
06/25/96	6.89	1.87	5.02	--	--	--	--	4700	1600	36	150	31	3000	--	3000
12/17/96	6.89	2.23	4.66	--	--	--	--	7800	1000	28	340	63	2700***	--	1200
03/31/97	6.89	2.01	4.88	--	--	--	--	5300	590	55	210	53	2200**	--	950
06/30/97	6.89	1.32	5.57	--	--	--	--	4400	350	<10	<10	11	2200**	--	580
09/12/97	6.89	1.56	5.33	--	--	--	--	3400	220	9.5	15	11	2300**	--	460
12/05/97	6.89	2.44	4.45	--	--	--	--	4700	870	21	120	18	1900**	--	750

CONTINUED ON NEXT PAGE

* Chromatogram pattern indicates a non-diesel mix.

** Chromatogram pattern indicates an unidentified hydrocarbon.

*** Chromatogram pattern indicates an unidentified hydrocarbon and weathered diesel.

Cumulative Table of Well Data and Analytical Results

Vertical Measurements are in feet.			Volumetric Measurements are in gallons.				Analytical results are in parts per billion (ppb)								
DATE	Well Head Elev.	Ground Water Elev.	Depth To Water	SPH Thickness	SPH Removed	Total SPH Removed	Notes	TPH-Gasoline	Benzene	Toluene	Ethyl-Benzene	Xylene	TPH-Diesel	TDS	MTBE
MW-1 (CONT'D)															
02/16/98	6.89	3.52	3.37	--	--	--	--	4400	120	12	11	7.7	1600**	--	270
06/17/98	6.89	2.24	4.65	--	--	--	--	7800	<25	50	34	650	1300**	--	650
08/31/98	6.89	1.70	5.19	--	--	--	--	3700	620	17	120	31	2400**	--	380
12/28/98	6.89	1.94	4.95	--	--	--	*	3800	250	14	28	15	1500**	--	330

* See Table of Additional Analyses

** Chromatogram pattern indicates an unidentified hydrocarbon.

Cumulative Table of Well Data and Analytical Results

Vertical Measurements are in feet.

Volumetric Measurements are in gallons.

Analytical results are in parts per billion (ppb)

DATE	Well Head Elev.	Ground Water Elev.	Depth To Water	feet SPH Thickness	gallon SPH Removed	Total SPH Removed	Notes	TPH- Gasoline	Benzene	Toluene	Ethyl- Benzene	Xylene	TPH- Diesel	TDS	MTBE
MW-2						<i>gallons</i>									
08/20/91	6.27	1.92	4.35	--	--	--	--	9300	3700	55	530	75	600	--	--
09/30/91	6.27	1.28	4.99	--	--	--	--	3500	2600	47	440	68	--	--	--
10/28/91	6.27	1.36	4.91	--	--	--	--	4600	1800	29	290	53	--	--	--
01/08/92	6.27	1.63	4.64	Sheen	--	--	--	14,000	4300	70	<25	130	--	--	--
01/13/92	6.27	--	--	--	--	--	--	--	--	--	--	--	38,000	--	--
06/23/92	6.27	1.63	4.64	0.02	--	--	--	--	--	--	--	--	--	--	--
08/24/92	6.27	1.34	4.94	0.02	--	--	--	--	--	--	--	--	--	--	--
09/21/92	6.27	1.20	5.08	0.01	--	--	--	--	--	--	--	--	--	--	--
10/26/92	6.27	0.34	5.93	--	--	--	--	--	--	--	--	--	--	--	--
12/23/92	6.27	--	--	--	--	--	--	21,000	5400	59	1300	160	160,000	--	--
01/08/93	6.27	2.57	3.70	--	--	--	--	--	--	--	--	--	--	--	--
03/25/93	6.27	2.89	3.38	Sheen	--	--	--	--	--	--	--	--	--	--	--
06/11/93	6.27	2.09	4.18	--	--	--	--	5900	1100	23	240	51	--	2300	--
09/29/93	6.27	0.07	6.20	--	--	--	--	--	--	--	--	--	--	--	--
12/20/93	6.27	1.94	4.35	0.02	--	--	--	--	--	--	--	--	--	--	--
03/07/94	6.27	2.60	3.67	--	--	--	--	26,000	5700	170	1000	150	<10	--	--
06/17/94	6.27	2.25	4.02	Sheen	--	--	--	--	--	--	--	--	--	--	--
09/12/94	6.27	1.45	4.83	0.01	--	--	--	--	--	--	--	--	--	--	--
11/30/94	6.27	2.27	4.00	--	--	--	Inaccessible	--	--	--	--	--	--	--	--
03/24/95	6.27	2.73	4.01	0.59	--	--	--	--	--	--	--	--	--	--	--
06/27/95	6.27	1.71	4.96	0.50	0.013	0.013	--	--	--	--	--	--	--	--	--
09/28/95	6.27	2.62	4.25	0.75	0.013	0.026	--	--	--	--	--	--	--	--	--
12/19/95	6.27	1.99	4.76	0.60	0.010	0.036	--	--	--	--	--	--	--	--	--
02/28/96	6.27	1.99	4.58	0.38	0.008	0.044	--	--	--	--	--	--	--	--	--
06/25/96	6.27	2.36	4.29	0.47	0.030	0.074	--	--	--	--	--	--	--	--	--
12/17/96	6.27	2.22	4.16	0.14	--	0.074	--	--	--	--	--	--	--	--	--
03/31/97	6.27	2.34	4.07	0.18	0.030	0.104	--	--	--	--	--	--	--	--	--
06/30/97	6.27	2.06	4.32	0.14	0.030	0.134	--	--	--	--	--	--	--	--	--
09/12/97	6.27	2.00	4.38	0.14	--	0.134	--	--	--	--	--	--	--	--	--
12/05/97	6.27	2.51	3.78	0.02	--	0.134	--	--	--	--	--	--	--	--	--
02/16/98	6.27	3.08	3.29	0.12	0.007	0.141	--	--	--	--	--	--	--	--	--
06/17/98	6.27	2.35	4.00	0.10	0.010	0.151	--	--	--	--	--	--	--	--	--
08/31/98	6.27	0.65	5.71	0.11	0.008	0.159	--	--	--	--	--	--	--	--	--
12/28/98	6.27	1.75	4.60	0.10	0.005	0.164	--	--	--	--	--	--	--	--	--

Cumulative Table of Well Data and Analytical Results

Vertical Measurements are in feet.

Volumetric Measurements are in gallons.

Analytical results are in parts per billion (ppb)

DATE	Well Head Elev.	Ground Water Elev.	Depth To Water	SPH Thickness	SPH Removed	Total SPH Removed	Notes	TPH-Gasoline	Benzene	Toluene	Ethyl-Benzene	Xylene	TPH-Diesel	TDS	MTBE
MW-3															
08/20/91	8.71	0.26	8.45	--	--	--	--	3100	200	13	15	12	200	--	--
09/30/91	8.71	-0.03	8.74	--	--	--	--	1000	150	8.3	13	6.7	--	--	--
10/28/91	8.71	-0.05	8.76	--	--	--	--	1200	120	6.7	11	7.5	--	--	--
01/08/92	8.71	-0.06	8.77	--	--	--	--	410	120	0.9	4.1	3.4	--	--	--
01/13/92	8.71	--	--	--	--	--	--	--	--	--	--	--	220	--	--
06/23/92	8.71	0.03	8.68	--	--	--	--	630	43	0.8	8.2	3.4	<50	--	--
08/24/92	8.71	-0.14	8.85	--	--	--	--	--	--	--	--	--	--	--	--
09/21/92	8.71	-0.23	8.94	--	--	--	--	1800	730	1.4	66	39	<50	--	--
10/26/92	8.71	-0.36	9.07	--	--	--	--	--	--	--	--	--	--	--	--
12/23/92	8.71	--	--	--	--	--	--	840	270	3.4	15	4.2	850	--	--
01/08/93	8.71	1.02	7.69	--	--	--	--	--	--	--	--	--	--	--	--
03/25/93	8.71	0.97	7.74	--	--	--	--	760	270	4.0	10	5.0	<10	--	--
06/11/93	8.71	0.19	8.52	--	--	--	--	200	32	1.0	5.0	2.0	--	5600	--
09/29/93	8.71	2.66	6.05	--	--	--	--	9300	2800	60	270	62	--	--	--
12/20/93	8.71	-0.12	8.83	--	--	--	--	460	250	4.0	8.0	4.0	<10	--	--
03/07/94	8.71	0.64	8.07	--	--	--	--	2400	260	13	35	18	<10	--	--
06/17/94	8.71	0.19	8.52	--	--	--	--	1000	200	4.0	6.6	6.7	<50	--	--
09/12/94	8.71	-0.21	8.92	--	--	--	--	360	130	3.4	4.8	3.3	<50	--	130
11/30/94	8.71	0.58	8.13	--	--	--	Inaccessible	--	--	--	--	--	--	--	--
03/24/95	8.71	1.93	6.78	--	--	--	--	4100	920	<10	23	<10	1200*	--	70
06/27/95	8.71	0.49	8.22	--	--	--	--	3100	640	16	31	<10	1000*	--	<50
09/28/95	8.71	-0.14	8.85	--	--	--	--	490	78	3.4	4.4	2.4	460*	--	38
12/19/95	8.71	0.69	8.02	--	--	--	--	2600	580	<10	25	<10	650*	--	<50
02/28/96	8.71	1.16	7.55	--	--	--	--	1500	510	<5.0	9.9	<5.0	780*	--	<25
06/25/96	8.71	0.34	8.37	--	--	--	--	1300	390	7.8	14	6.5	1200*	--	31
12/17/96	8.71	0.41	8.30	--	--	--	--	760	85	<1.2	5.9	5.1	1100*	--	<6.2
03/31/97	8.71	0.52	8.19	--	--	--	--	2000	380	12	24	12	1300*	--	<25
06/30/97	8.71	0.00	8.71	--	--	--	--	1900	340	9.9	23	6.1	620*	--	<25
09/12/97	8.71	1.07	7.64	--	--	--	--	1200	200	4.6	14	4.8	400*	--	3.9
12/05/97	8.71	0.46	8.25	--	--	--	--	460	72	2.7	5.2	1.7	190*	--	<5.0
02/16/98	8.71	1.71	7.00	--	--	--	--	6200	1100	20	34	12	1000*	--	<50
06/17/98	8.71	0.71	8.00	--	--	--	--	3000	350	<10	<10	<10	1100*	--	120
08/31/98	8.71	0.08	8.63	--	--	--	--	430	100	2.6	8.6	6.0	790*	--	<12
12/28/98	8.71	-0.02	8.73	--	--	--	****	1400	220	<10	12	<10	180*	--	<50

* Chromatogram pattern indicates an unidentified hydrocarbon.

****See Additional Analyses

Cumulative Table of Well Data and Analytical Results

Vertical Measurements are in feet.

Volumetric Measurements are in gallons.

Analytical results are in parts per billion (ppb)

DATE	Well Head Elev.	Ground Water Elev.	Depth To Water	SPH Thickness	SPH Removed	Total SPH Removed	Notes	TPH-Gasoline	Benzene	Toluene	Ethyl-Benzene	Xylene	TPH-Diesel	TDS	MTBE
MW-4															
08/20/91	7.37	1.32	5.05	--	--	--	--	1800	870	4.0	3.0	9.0	160	--	--
09/30/91	7.37	1.70	5.67	--	--	--	--	670	830	5.5	2.7	12	--	--	--
10/28/91	7.37	1.56	5.81	--	--	--	--	2800	990	5.8	4.8	19	--	--	--
01/08/92	7.37	2.03	5.34	--	--	--	--	2900	1200	10	7.0	18	--	--	--
01/13/92	7.37	--	--	--	--	--	--	--	--	--	--	--	1000	--	--
06/23/92	7.37	2.00	5.37	--	--	--	--	1600	380	6.5	3.0	12	<50	--	--
08/24/92	7.37	1.62	5.75	--	--	--	--	--	--	--	--	--	--	--	--
09/21/92	7.37	1.42	5.95	--	--	--	--	1200	480	5.6	3.7	11	<50	--	--
10/26/92	7.37	1.41	5.96	--	--	--	--	--	--	--	--	--	--	--	--
12/23/92	7.37	--	--	--	--	--	--	1500	700	3.6	3.2	11	1800	--	--
01/08/93	7.37	2.73	4.64	--	--	--	--	--	--	--	--	--	--	--	--
03/25/93	7.37	2.95	4.42	--	--	--	--	520	160	3.0	1.0	4.0	<10	--	--
06/11/93	7.37	2.25	5.12	--	--	--	--	1200	430	5.0	6.0	11	--	2600	--
09/29/93	7.37	1.57	5.80	--	--	--	--	1300	210	8.0	2.0	14	--	--	--
12/20/93	7.37	2.27	5.10	--	--	--	--	570	230	5.0	4.0	8.0	3900	--	--
03/07/94	7.37	2.36	5.01	--	--	--	--	2200	290	18	2.5	11	2600	--	22,000
06/17/94	7.37	1.55	5.82	--	--	--	--	2100	480	11	4.3	9.5	2800	--	--
09/12/94	7.37	1.73	5.64	--	--	--	--	1700	340	6.1	2.7	9.7	3000	--	63,000
11/30/94	7.37	1.79	5.58	--	--	--	Inaccessible	--	--	--	--	--	--	--	--
03/24/95	7.37	2.42	4.95	--	--	--	--	1500	280	<5.0	<5.0	6.9	3000*	--	12,000
06/27/95	7.37	-1.42	8.79	--	--	--	--	<10,000	310	<100	<100	<100	3100*	--	32,000
09/28/95	7.37	1.52	5.85	--	--	--	--	330	64	1.1	<0.5	<0.5	6300*	--	630
12/19/95	7.37	1.87	5.50	--	--	--	--	3000	520	<25	<25	<25	3400*	--	44,000
02/28/96	7.37	2.27	5.10	--	--	--	--	<10,000	230	<100	<100	<100	4700*	--	32,000
06/25/96	7.37	1.59	5.78	--	--	--	--	<10000	160	<100	<100	<100	3100	--	31,000
12/17/96	7.37	1.42	5.95	--	--	--	--	<5000	110	<50	<50	<50	3600**	--	22,000
03/31/97	7.37	1.75	5.62	--	--	--	--	<2500	130	<25	<25	<25	2700*	--	16,000
06/30/97	7.37	1.34	6.03	--	--	--	--	<2500	130	<25	<25	<25	2700*	--	14,000
09/12/97	7.37	1.68	5.69	--	--	--	--	<5000	63	<50	<50	<50	2100*	--	15,000
12/05/97	7.37	2.22	5.15	--	--	--	--	1300	120	<5.0	<5.0	8.5	2600*	--	15,000
02/16/98	7.37	1.11	6.26	--	--	--	--	1200	57	4.5	<2.5	7.0	1300*	--	12,000
06/17/98	7.37	2.41	4.96	--	--	--	--	5300	390	290	28	150	530*	--	17,000
08/31/98	7.37	1.46	5.91	--	--	--	--	<50	89	<0.5	<0.5	<0.5	2400*	--	14,000
08/31/98	7.37	1.46	5.91	--	--	--	Confirmation run	--	--	--	--	--	--	--	16,000
12/28/98	7.37	1.96	5.41	--	--	--	****	1000	52	5.6	4.6	9.1	2900*	--	8400

* Chromatogram pattern indicates an unidentified hydrocarbon

** Chromatogram pattern indicates an unidentified hydrocarbon and weathered diesel.

**** See Additional Analyses

Cumulative Table of Well Data and Analytical Results

Vertical Measurements are in feet.				Volumetric Measurements are in gallons.			Analytical results are in parts per billion (ppb)								
DATE	Well Head Elev.	Ground Water Elev.	Depth To Water	SPH Thickness	SPH Removed	Total SPH Removed	Notes	TPH-Gasoline	Benzene	Toluene	Ethyl-Benzene	Xylene	TPH-Diesel	TDS	MTBE
MW-5															
06/23/92	14.14	1.90	12.24	--	--	--	--	<50	<0.5	<0.5	<0.5	<0.5	<50	--	--
08/24/92	14.14	1.85	12.29	--	--	--	--	--	--	--	--	--	--	--	--
09/21/92	14.14	1.68	12.46	--	--	--	--	<50	<0.5	<0.5	<0.5	<0.5	60	--	--
10/26/92	14.14	1.62	12.52	--	--	--	--	--	--	--	--	--	--	--	--
12/23/92	14.14	3.02	11.12	--	--	--	--	--	--	--	--	--	--	--	--
01/08/93	14.14	--	--	--	--	--	--	--	--	--	--	--	--	--	--
03/25/93	14.14	4.40	9.74	--	--	--	--	<50	<0.5	<0.5	<0.5	0.9	<10	--	--
06/11/93	14.14	3.70	10.44	--	--	--	--	<50	<0.5	<0.5	<0.5	<0.5	--	770	--
09/29/93	14.14	2.22	11.92	--	--	--	--	<50	<0.5	0.6	<0.5	0.6	<10	--	--
12/20/93	14.14	--	--	--	--	--	--	--	--	--	--	--	--	--	--
03/07/94	14.14	2.80	11.34	--	--	--	--	<50	<0.5	<0.5	<0.5	<0.5	<10	--	--
06/17/94	14.14	2.87	11.27	--	--	--	--	<50	<0.5	<0.5	<0.5	<0.5	<50	--	--
09/12/94	14.14	1.28	12.86	--	--	--	--	<50	<0.5	<0.5	<0.5	<0.5	<50	--	<5.0
11/30/94	14.14	2.23	11.91	--	--	--	--	<50	<0.5	<0.5	<0.5	<0.5	99*	--	--
03/24/95	14.14	4.38	9.76	--	--	--	--	<50	<0.5	<0.5	<0.5	<0.5	<50	--	--
06/27/95	14.14	2.74	11.40	--	--	--	--	<50	<0.5	<0.5	<0.5	<0.5	55**	--	--
09/28/95	14.14	2.24	11.90	--	--	--	--	<50	<0.5	<0.5	<0.5	<0.5	300**	--	--
12/19/95	14.14	1.56	12.58	--	--	--	--	<50	<0.5	<0.5	<0.5	<0.5	53**	--	3.1
02/28/96	14.14	2.44	11.70	--	--	--	--	<50	<0.5	<0.5	<0.5	<0.5	<50	--	<2.5
06/25/96	14.14	2.71	11.43	--	--	--	--	<50	<0.5	<0.5	<0.5	<0.5	120**	--	36
12/17/96	14.14	2.74	11.40	--	--	--	--	<50	<0.5	<0.5	<0.5	<0.5	89**	--	<2.5
03/31/97	14.14	2.04	12.10	--	--	--	--	<50	<0.5	<0.5	<0.5	<0.5	150**	--	<2.5
06/30/97	14.14	1.36	12.78	--	--	--	Sampled biannual	--	--	--	--	--	--	--	--
09/12/97	14.14	0.46	13.68	--	--	--	--	<50	<0.5	<0.5	<0.5	<0.5	<50	--	<2.5
12/05/97	14.14	1.11	13.03	--	--	--	--	--	--	--	--	--	--	--	--
02/16/98	14.14	4.17	9.97	--	--	--	--	<50	<0.5	<0.5	<0.5	<0.5	62**	--	<2.5
06/17/98	14.14	2.29	11.85	--	--	--	--	--	--	--	--	--	--	--	--
08/31/98	14.14	1.32	12.82	--	--	--	--	<50	<0.5	<0.5	<0.5	<0.5	<50	--	<2.5
12/28/98	14.14	0.71	13.43	--	--	--	****	--	--	--	--	--	--	--	--

**** See Additional Analyses

* Chromatogram pattern indicates a non-diesel mix.

** Chromatogram pattern indicates an unidentified hydrocarbon.

Cumulative Table of Well Data and Analytical Results

Vertical Measurements are in feet.				Volumetric Measurements are in gallons.				Analytical results are in parts per billion (ppb)							
DATE	Well Head Elev.	Ground Water Elev.	Depth To Water	SPH Thickness	SPH Removed	Total SPH Removed	Notes	TPH-Gasoline	Benzene	Toluene	Ethyl-Benzene	Xylene	TPH-Diesel	TDS	MTBE
MW-6															
06/23/92	4.46	-0.68	5.14	--	--	--	--	<50	4.3	<0.5	0.8	0.9	120	--	--
08/24/92	4.46	-0.49	4.95	--	--	--	--	--	--	--	--	--	--	--	--
09/21/92	4.46	-0.44	4.90	--	--	--	--	<250	<2.5	<2.5	<2.5	<2.5	<50	--	--
10/26/92	4.46	-1.06	5.52	--	--	--	--	--	--	--	--	--	--	--	--
12/23/92	4.46	-0.94	5.40	--	--	--	--	<50	<0.5	<0.5	<0.5	<0.5	81	--	--
01/08/93	4.46	--	--	--	--	--	--	--	--	--	--	--	--	--	--
03/25/93	4.46	-1.64	6.10	--	--	--	--	<50	<0.5	<0.5	<0.5	0.7	<10	--	--
06/11/93	4.46	-2.10	6.56	--	--	--	--	<50	<0.5	<0.5	<0.5	<0.5	--	15,000	--
09/29/93	4.46	-0.71	5.17	--	--	--	--	<50	<0.5	<0.5	<0.5	<0.5	<10	--	--
12/20/93	4.46	-1.47	5.93	--	--	--	--	<50	<0.5	<0.5	<0.5	<0.5	<10	--	--
03/07/94	4.46	-0.81	5.27	--	--	--	--	54	<0.5	<0.5	<0.5	0.6	<10	--	--
06/17/94	4.46	--	--	--	--	--	--	--	--	--	--	--	--	--	--
09/12/94	4.46	-0.64	5.10	--	--	--	--	<50	<0.5	<0.5	<0.5	<0.5	<50	--	<50
11/30/94	4.46	-1.12	5.58	--	--	--	--	<50	<0.5	<0.5	<0.5	<0.5	800*	--	--
03/24/95	4.46	-1.87	6.33	--	--	--	--	<50	<0.5	<0.5	<0.5	<0.5	490**	--	--
06/27/95	4.46	-3.74	8.20	--	--	--	--	<50	<0.5	<0.5	<0.5	<0.5	300**	--	--
09/28/95	4.46	-0.19	4.65	--	--	--	--	120	1.1	<0.5	<0.5	<0.5	1200**	--	--
12/19/95	4.46	-1.58	6.04	--	--	--	--	<50	<0.5	<0.5	<0.5	<0.5	820**	--	<2.5
02/28/96	4.46	-1.54	6.00	--	--	--	--	<50	<0.5	<0.5	<0.5	<0.5	270**	--	<2.5
06/25/96	4.46	-1.71	6.17	--	--	--	--	97	<0.5	<0.5	<0.5	0.71	750**	--	<2.5
12/17/96	4.46	-1.67	6.13	--	--	--	--	65	<0.5	<0.5	<0.5	<0.5	540**	--	<2.5
03/31/97	4.46	-2.23	6.69	--	--	--	--	65	<0.5	<0.5	<0.5	<0.5	780**	--	<2.5
06/30/97	4.46	-2.62	7.08	--	--	--	Sampled biannual	--	--	--	--	--	--	--	--
09/12/97	4.46	-0.95	5.41	--	--	--	--	65	<0.5	<0.5	<0.5	<0.5	270**	--	<2.5
12/05/97	4.46	-1.96	6.42	--	--	--	--	--	--	--	--	--	--	--	--
02/16/98	4.46	-0.30	4.76	--	--	--	--	140	<0.5	<0.5	<0.5	<0.5	330**	--	<2.5
06/17/98	4.46	-1.54	6.00	--	--	--	--	--	--	--	--	--	--	--	--
08/31/98	4.46	-0.64	5.10	--	--	--	--	<50	<0.5	<0.5	<0.5	<0.5	270*	--	<2.5
12/28/98	4.46	-2.04	6.50	--	--	--	****	--	--	--	--	--	--	--	--

**** See Additional Analysis

* Chromatogram pattern indicates a non-diesel mix.

** Chromatogram pattern indicates an unidentified hydrocarbon.

Cumulative Table of Well Data and Analytical Results

Vertical Measurements are in feet.				Volumetric Measurements are in gallons.				Analytical results are in parts per billion (ppb)							
DATE	Well Head Elev.	Ground Water Elev.	Depth To Water	SPH Thickness	SPH Removed	Total SPH Removed	Notes	TPH-Gasoline	Benzene	Toluene	Ethyl-Benzene	Xylene	TPH-Diesel	TDS	MTBE
MW-7															
06/23/92	5.26	0.88	4.38	--	--	--	--	<50	4.7	<0.5	<0.5	<0.5	<50	--	--
08/24/92	5.26	-0.29	5.55	--	--	--	--	--	--	--	--	--	--	--	--
09/21/92	5.26	-0.39	5.65	--	--	--	--	<50	<0.5	<0.5	<0.5	<0.5	<50	--	--
10/26/92	5.26	-0.25	5.51	--	--	--	--	--	--	--	--	--	--	--	--
12/23/92	5.26	1.31	3.95	--	--	--	--	<50	2.9	<0.5	<0.5	<0.5	60	--	--
01/08/93	5.26	--	--	--	--	--	--	--	--	--	--	--	--	--	--
03/25/93	5.26	2.76	2.50	--	--	--	--	<50	<0.5	<0.5	<0.5	<0.5	<10	--	--
06/11/93	5.26	1.80	3.46	--	--	--	--	<50	0.6	<0.5	<0.5	<0.5	--	2200	--
09/29/93	5.26	-0.26	5.52	--	--	--	--	<50	2.0	1.0	1.0	7.0	<10	--	--
12/20/93	5.26	0.85	4.41	--	--	--	--	<50	2.0	<0.5	<0.5	<0.5	<10	--	--
03/07/94	5.26	2.64	2.62	--	--	--	--	<50	<0.5	<0.5	<0.5	<0.5	<10	--	--
06/17/94	5.26	1.99	3.27	--	--	--	--	<50	<0.5	<0.5	<0.5	<0.5	<50	--	--
09/12/94	5.26	1.15	4.11	--	--	--	--	<50	<0.5	<0.5	<0.5	<0.5	<50	--	<5.0
11/30/94	5.26	2.50	2.76	--	--	--	--	<50	<0.5	<0.5	<0.5	<0.5	<50	--	--
03/24/95	5.26	3.06	2.20	--	--	--	--	<50	<0.5	<0.5	<0.5	<0.5	<50	--	--
06/27/95	5.26	1.36	3.90	--	--	--	--	<50	<0.5	<0.5	<0.5	<0.5	69**	--	--
09/28/95	5.26	0.41	4.85	--	--	--	--	<50	<0.5	<0.5	<0.5	<0.5	84**	--	--
12/19/95	5.26	2.24	3.02	--	--	--	--	<50	<0.5	<0.5	<0.5	<0.5	84**	--	<2.5
02/28/96	5.26	3.83	1.43	--	--	--	--	<50	<0.5	<0.5	<0.5	<0.5	99**	--	<2.5
06/25/96	5.26	0.97	4.29	--	--	--	--	<50	<0.5	<0.5	<0.5	<0.5	110**	--	<2.5
12/17/96	5.26	3.08	2.18	--	--	--	--	<50	<0.5	<0.5	<0.5	<0.5	54**	--	<2.5
03/31/97	5.26	2.32	2.94	--	--	--	--	<50	<0.5	<0.5	<0.5	<0.5	100**	--	<2.5
06/30/97	5.26	1.68	3.58	--	--	--	Sampled annually	--	--	--	--	--	--	--	--
09/12/97	5.26	1.85	3.41	--	--	--	--	--	--	--	--	--	--	--	--
12/05/97	5.26	3.37	1.89	--	--	--	--	--	--	--	--	--	--	--	--
02/16/98	5.26	3.43	1.83	--	--	--	--	<50	<0.5	<0.5	<0.5	<0.5	77**	--	<2.5
06/17/98	5.26	3.32	1.94	--	--	--	--	--	--	--	--	--	--	--	--
08/31/98	5.26	1.07	4.19	--	--	--	--	--	--	--	--	--	--	--	--
12/28/98	5.26	0.79	4.47	--	--	--	****	--	--	--	--	--	--	--	--

**** See Additional Analysis

* Chromatogram pattern indicates a non-diesel mix.

** Chromatogram pattern indicates an unidentified hydrocarbon.

Cumulative Table of Well Data and Analytical Results

Vertical Measurements are in feet.

Volumetric Measurements are in gallons.

Analytical results are in parts per billion (ppb)

DATE	Well Head Elev.	Ground Water Elev.	Depth To Water	SPH Thickness	SPH Removed	Total SPH Removed	Notes	TPH-Gasoline	Benzene	Toluene	Ethyl-Benzene	Xylene	TPH-Diesel	TDS	MTBE
MW-8															
06/23/92	8.94	-15.20	24.14	--	--	--	--	<50	<0.5	<0.5	<0.5	<0.5	<50	--	--
08/24/92	8.94	0.34	8.60	--	--	--	--	--	--	--	--	--	--	--	--
09/21/92	8.94	0.55	8.39	--	--	--	--	94	<0.5	<0.5	<0.5	<0.5	<50	--	--
10/26/92	8.94	-0.18	9.12	--	--	--	--	--	--	--	--	--	--	--	--
12/23/92	8.94	0.83	8.11	--	--	--	--	<50	0.7	5.0	0.7	2.9	79	--	--
01/08/93	8.94	--	--	--	--	--	--	--	--	--	--	--	--	--	--
03/25/93	8.94	--	--	--	--	--	--	--	--	--	--	--	--	--	--
06/11/93	8.94	0.55	8.39	--	--	--	--	<50	<0.5	<0.5	<0.5	<0.5	--	3500	--
09/29/93	8.94	0.69	8.25	--	--	--	--	<50	<0.5	<0.5	<0.5	<0.5	<10	--	--
12/20/93	8.94	0.48	8.46	--	--	--	--	<50	<0.5	0.6	<0.5	1.0	<10	--	--
03/07/94	8.94	0.28	8.66	--	--	--	--	<50	<0.5	<0.5	<0.5	<0.5	<10	--	--
06/17/94	8.94	0.12	8.82	--	--	--	--	<50	<0.5	<0.5	<0.5	<0.5	<50	--	--
09/12/94	8.94	0.11	8.83	--	--	--	--	<50	<0.5	<0.5	<0.5	0.8	<50	--	<5.0
11/30/94	8.94	0.31	8.63	--	--	--	--	<50	<0.5	<0.5	<0.5	<0.5	120*	--	--
03/24/95	8.94	0.43	8.51	--	--	--	--	<50	<0.5	<0.5	<0.5	<0.5	110**	--	--
06/27/95	8.94	-0.03	8.97	--	--	--	--	<50	<0.5	<0.5	<0.5	<0.5	67**	--	--
09/28/95	8.94	0.04	8.90	--	--	--	--	<50	<0.5	<0.5	<0.5	<0.5	91**	--	--
12/19/95	8.94	0.54	8.40	--	--	--	--	<50	<0.5	<0.5	<0.5	<0.5	76**	--	<2.5
02/28/96	8.94	0.50	8.44	--	--	--	--	<50	<0.5	<0.5	<0.5	<0.5	<50	--	<2.5
06/25/96	8.94	0.05	8.89	--	--	--	--	<50	<0.5	<0.5	<0.5	<0.5	80**	--	<2.5
12/17/96	8.94	0.49	8.45	--	--	--	--	<50	<0.5	<0.5	<0.5	<0.5	79**	--	<2.5
03/31/97	8.94	0.18	8.76	--	--	--	--	<50	<0.5	<0.5	<0.5	<0.5	72**	--	3.6
06/30/97	8.94	-0.18	9.12	--	--	--	Sampled annually	--	--	--	--	--	--	--	--
09/12/97	8.94	0.13	8.81	--	--	--	--	--	--	--	--	--	--	--	--
12/05/97	8.94	0.59	8.35	--	--	--	--	--	--	--	--	--	--	--	--
02/16/98	8.94	1.00	7.94	--	--	--	--	<50	<0.5	<0.5	<0.5	<0.5	68**	--	4.3
06/17/98	8.94	0.51	8.43	--	--	--	--	--	--	--	--	--	--	--	--
08/31/98	8.94	0.06	8.88	--	--	--	--	--	--	--	--	--	--	--	--
12/28/98	8.94	0.64	8.30	--	--	--	****	--	--	--	--	--	--	--	--

**** See Additional Analysis

* Chromatogram pattern indicates a non-diesel mix.

** Chromatogram pattern indicates an unidentified hydrocarbon.

Cumulative Table of Well Data and Analytical Results

Vertical Measurements are in feet.				Volumetric Measurements are in gallons.				Analytical results are in parts per billion (ppb)							
DATE	Well Head Elev.	Ground Water Elev.	Depth To Water	SPH Thickness	SPH Removed	Total SPH Removed	Notes	TPH-Gasoline	Benzene	Toluene	Ethyl-Benzene	Xylene	TPH-Diesel	TDS	MTBE
TRIP BLANK															
08/24/92	--	--	--	--	--	--	--	--	--	--	--	--	--	--	--
09/21/92	--	--	--	--	--	--	--	<50	<0.5	<0.5	<0.5	<0.5	--	--	--
10/26/92	--	--	--	--	--	--	--	--	--	--	--	--	--	--	--
12/23/92	--	--	--	--	--	--	--	<50	<0.5	<0.5	<0.5	<0.5	--	--	--
01/08/93	--	--	--	--	--	--	--	--	--	--	--	--	--	--	--
03/25/93	--	--	--	--	--	--	--	<50	<0.5	<0.5	<0.5	<0.5	--	--	--
06/11/93	--	--	--	--	--	--	--	<50	<0.5	<0.5	<0.5	<0.5	--	--	--
09/29/93	--	--	--	--	--	--	--	<50	<0.5	<0.5	<0.5	<0.5	--	--	--
12/20/93	--	--	--	--	--	--	--	<50	<0.5	<0.5	<0.5	<0.5	--	--	--
03/07/94	--	--	--	--	--	--	--	<50	<0.5	<0.5	<0.5	<0.5	--	--	--
06/17/94	--	--	--	--	--	--	--	<50	<0.5	<0.5	<0.5	<0.5	--	--	--
09/12/94	--	--	--	--	--	--	--	<50	<0.5	<0.5	<0.5	1.0	--	--	--
11/30/94	--	--	--	--	--	--	--	<50	<0.5	<0.5	<0.5	<0.5	--	--	--
03/24/95	--	--	--	--	--	--	--	<50	<0.5	<0.5	<0.5	<0.5	--	--	--
06/27/95	--	--	--	--	--	--	--	<50	<0.5	<0.5	<0.5	<0.5	--	--	--
09/28/95	--	--	--	--	--	--	--	<50	<0.5	<0.5	<0.5	<0.5	--	--	--
12/19/95	--	--	--	--	--	--	--	<50	<0.5	<0.5	<0.5	<0.5	--	--	--
02/28/96	--	--	--	--	--	--	--	<50	<0.5	<0.5	<0.5	<0.5	--	--	--
06/25/96	--	--	--	--	--	--	--	<50	<0.5	<0.5	<0.5	<0.5	--	--	--
12/17/96	--	--	--	--	--	--	--	<50	<0.5	<0.5	<0.5	<0.5	--	--	<2.5
03/31/97	--	--	--	--	--	--	--	<50	<0.5	<0.5	<0.5	<0.5	--	--	<2.5
06/30/97	--	--	--	--	--	--	--	<50	<0.5	<0.5	<0.5	<0.5	--	--	<2.5
09/12/97	--	--	--	--	--	--	--	<50	<0.5	<0.5	<0.5	<0.5	--	--	<2.5
12/05/97	--	--	--	--	--	--	--	<50	<0.5	<0.5	<0.5	<0.5	--	--	<2.5
02/16/98	--	--	--	--	--	--	--	<50	<0.5	<0.5	<0.5	<0.5	--	--	<2.5
06/17/98	--	--	--	--	--	--	--	<50	<0.5	<0.5	<0.5	<0.5	--	--	<2.5
08/31/98	--	--	--	--	--	--	--	<50	<0.5	<0.5	<0.5	<0.5	--	--	<2.5
12/28/98	--	--	--	--	--	--	--	<50	<0.5	<0.5	<0.5	<0.5	--	--	<2.5

Note: Blaine Tech Services, Inc. began routine monitoring of the groundwater wells at this site on November 1, 1994.
 Earlier field data and analytical results are drawn from the September 27, 1994 Groundwater Technology, Inc. report.

ABBREVIATIONS:

TPH = Total Petroleum Hydrocarbons
 TDS = Total Dissolved Solids
 MTBE = Methyl-tert-butyl Ether

Cumulative Table of Well Data and Analytical Results

ADDITIONAL ANALYSES

Analytical values are in parts per billion (ppb)

DATE	Notes	Total Alkalinity	Ferrous Iron	Sulfate	Nitrate
MW-1					
12/28/98	--	390,000	4900	<1000	<1000
MW-3					
12/28/98	--	980,000	4500	390,000	<1000
MW-4					
12/28/98	--	670,000	3500	6800	<1000
MW-5					
12/28/98	--	480,000	15	51,000	<1000
MW-6					
12/28/98	--	2,400,000	810	110,000	<1000
MW-7					
12/28/98	--	350,000	12,000	79,000	<1000
MW-8					
12/28/98	--	1,100,000	45	87,000	<1000

Analytical Appendix



Sequoia
Analytical

680 Chesapeake Drive
404 N. Wiget Lane
819 Striker Avenue, Suite 8
1455 McDowell Blvd. North, Ste. D

Redwood City, CA 94063
Walnut Creek, CA 94598
Sacramento, CA 95834
Petaluma, CA 94954

(650) 364-9600
(925) 988-9600
(916) 921-9600
(707) 792-1865

FAX (650) 364-9233
FAX (925) 988-9673
FAX (916) 921-0100
FAX (707) 792-0342

January 15, 1999

Christine Lillie
Blaine Tech/Chevron
1680 Rogers Ave.
San Jose, CA 95112

RE: Chevron/P901062

Dear Christine Lillie

Enclosed are the results of analyses for sample(s) received by the laboratory on January 6, 1999. If you have any questions concerning this report, please feel free to contact me.

Sincerely,

Matt Sakai
Project Manager

CA ELAP Certificate Number 2245





Sequoia Analytical

680 Chesapeake Drive
404 N. Wiget Lane
819 Striker Avenue, Suite 8
1455 McDowell Blvd. North, Ste. D

Redwood City, CA 94063
Walnut Creek, CA 94598
Sacramento, CA 95834
Petaluma, CA 94954

(650) 364-9600
(925) 988-9600
(916) 921-9600
(707) 792-1865

FAX (650) 364-9233
FAX (925) 988-9673
FAX (916) 921-0100
FAX (707) 792-0342

Blaine Tech/Chevron 1680 Rogers Ave. San Jose, CA 95112	Project: Chevron Project Number: 9-8270/990105/K3 Project Manager: Christine Lillie	Sampled: 1/5/99 Received: 1/6/99 Reported: 1/15/99
---	---	--

ANALYTICAL REPORT FOR P901062

Sample Description	Laboratory Sample Number	Sample Matrix	Date Sampled
MW-1	P901062-01	Water	1/5/99
MW-2	P901062-02	Water	1/5/99
MW-3A	P901062-03	Water	1/5/99
MW-4	P901062-04	Water	1/5/99
MW-5	P901062-05	Water	1/5/99
TB	P901062-06	Water	1/5/99





**Sequoia
Analytical**

680 Chesapeake Drive
404 N. Wiget Lane
819 Striker Avenue, Suite 8
1455 McDowell Blvd. North, Ste. D

Redwood City, CA 94063
Walnut Creek, CA 94598
Sacramento, CA 95834
Petaluma, CA 94954

(650) 364-9600
(925) 988-9600
(916) 921-9600
(707) 792-1865

FAX (650) 364-9233
FAX (925) 988-9673
FAX (916) 921-0100
FAX (707) 792-0342

Blaine Tech Services
1680 Rogers Avenue
San Jose, CA 95112

Client Proj. ID: Chevron 9-0121/981228-G2

Sampled: 12/28/98
Received: 12/29/98
Analyzed: see below

Lab Proj. ID: 9812G89-01
Sample Descript: LIQUID,MW-1

Attention: Christine Lillie

Reported: 01/15/99

LABORATORY ANALYSIS

Analyte	Units	Detection Limit	Method	Analyst	Date Analyzed	Sample Results
Alkalinity: Total	mg CaCO ₃ /L	40	SM 2320	KC	12/31/98	390
Ferrous iron	mg/L	0.010	3500A Mod	RD	01/06/99	4.9
Nitrate as Nitrate	mg/L	1.0	EPA 300.0	GF	12/30/98	N.D.
Sulfate	mg/L	1.0	EPA 300.0	GF	12/30/98	N.D.

Analytes reported as N.D. were not present above the stated limit of detection.

SEQUOIA ANALYTICAL - ELAP #1210

Project Manager

Please Note:

This sample was preserved in accordance with EPA approved preservation methods.





**Sequoia
Analytical**

680 Chesapeake Drive
404 N. Wiget Lane
819 Striker Avenue, Suite B
1455 McDowell Blvd. North, Ste. D

Redwood City, CA 94063
Walnut Creek, CA 94598
Sacramento, CA 95834
Petaluma, CA 94954

(650) 364-9600
(925) 988-9600
(916) 921-9600
(707) 792-1865

FAX (650) 364-9233
FAX (925) 988-9673
FAX (916) 921-0100
FAX (707) 792-0342

Blaine Tech Services 1680 Rogers Avenue San Jose, CA 95112	Client Proj. ID: Chevron 9-0121/981228-G2	Sampled: 12/28/98 Received: 12/29/98 Analyzed: see below
Attention: Christine Lillie	Lab Proj. ID: 9812G89-02 Sample Descript: LIQUID,MW-3	Reported: 01/15/99

LABORATORY ANALYSIS

Analyte	Units	Detection Limit	Method	Analyst	Date Analyzed	Sample Results
Alkalinity: Total	mg CaCO ₃ /L	40	SM 2320	KC	12/31/98	980
Ferrous Iron	mg/L	0.010	3500A Mod	RD	01/06/99	4.5
Nitrate as Nitrate	mg/L	1.0	EPA 300.0	GF	12/30/98	N.D.
Sulfate	mg/L	10	EPA 300.0	GF	12/30/98	390

Analytes reported as N.D. were not present above the stated limit of detection.

SEQUOIA ANALYTICAL - ELAP #1210

Project Manager

Please Note:
This sample was preserved in accordance with EPA approved preservation methods.





**Sequoia
Analytical**

680 Chesapeake Drive
404 N. Wiger Lane
819 Striker Avenue, Suite 8
1455 McDowell Blvd. North, Ste. D

Redwood City, CA 94063
Walnut Creek, CA 94598
Sacramento, CA 95834
Petaluma, CA 94954

(650) 364-9600
(925) 988-9600
(916) 921-9600
(707) 792-1865

FAX (650) 364-9233
FAX (925) 988-9673
FAX (916) 921-0100
FAX (707) 792-0342

Blaine Tech Services
1680 Rogers Avenue
San Jose, CA 95112

Attention: Christine Lillie

Client Proj. ID: Chevron 9-0121/981228-G2

Lab Proj. ID: 9812G89-03
Sample Descript: LIQUID, MW-4

Sampled: 12/28/98

Received: 12/29/98

Analyzed: see below

Reported: 01/15/99

LABORATORY ANALYSIS

Analyte	Units	Detection Limit	Method	Analyst	Date Analyzed	Sample Results
Alkalinity: Total	mg CaCO ₃ /L	40	SM 2320	KC	12/31/98	670
Ferrous Iron	mg/L	0.010	3500A Mod	RD	01/06/99	3.5
Nitrate as Nitrate	mg/L	1.0	EPA 300.0	GF	12/30/98	N.D.
Sulfate	mg/L	1.0	EPA 300.0	GF	12/30/98	6.8

Analytes reported as N.D. were not present above the stated limit of detection.

SEQUOIA ANALYTICAL - ELAP #1210

Project Manager

Please Note:
This sample was preserved in accordance with EPA approved preservation methods.





**Sequoia
Analytical**

680 Chesapeake Drive
404 N. Wiget Lane
819 Striker Avenue, Suite 8
1455 McDowell Blvd. North, Ste. D

Redwood City, CA 94063
Walnut Creek, CA 94598
Sacramento, CA 95834
Petaluma, CA 94954

(650) 364-9600
(925) 988-9600
(916) 921-9600
(707) 792-1865

FAX (650) 364-9233
FAX (925) 988-9673
FAX (916) 921-0100
FAX (707) 792-0342

Blaine Tech Services
1680 Rogers Avenue
San Jose, CA 95112

Client Proj. ID: Chevron 9-0121/981228-G2

Sampled: 12/28/98

Lab Proj. ID: 9812G89-04
Sample Descript: LIQUID,MW-5

Received: 12/29/98

Analyzed: see below

Attention: Christine Lillie

Reported: 01/15/99

LABORATORY ANALYSIS

Analyte	Units	Detection Limit	Method	Analyst	Date Analyzed	Sample Results
Alkalinity: Total	mg CaCO ₃ /L	40	SM 2320	KC	12/31/98	480
Ferrous Iron	mg/L	0.010	3500A Mod	CM	01/05/99	0.015
Nitrate as Nitrate	mg/L	1.0	EPA 300.0	GF	12/30/98	N.D.
Sulfate	mg/L	1.0	EPA 300.0	GF	12/30/98	51

Analytes reported as N.D. were not present above the stated limit of detection.

SEQUOIA ANALYTICAL - ELAP #1210

Project Manager

Please Note:

This sample was preserved in accordance with EPA approved preservation methods.





Blaine Tech Services
1680 Rogers Avenue
San Jose, CA 95112

Client Proj. ID: Chevron 9-0121/981228-G2

Sampled: 12/28/98

Received: 12/29/98

Lab Proj. ID: 9812G89-05
Sample Descript: LIQUID,MW-6

Analyzed: see below

Attention: Christine Lillie

Reported: 01/15/99

LABORATORY ANALYSIS

Analyte	Units	Detection Limit	Method	Analyst	Date Analyzed	Sample Results
Alkalinity: Total	mg CaCO ₃ /L	200	SM 2320	KC	12/31/98	2400
Ferrous Iron	mg/L	0.010	3500A Mod	RD	01/06/99	0.81
Nitrate as Nitrate	mg/L	1.0	EPA 300.0	GF	12/30/98	N.D.
Sulfate	mg/L	1.0	EPA 300.0	GF	12/30/98	110

Analytes reported as N.D. were not present above the stated limit of detection.

SEQUOIA ANALYTICAL - ELAP #1210

Project Manager

Please Note:

This sample was preserved in accordance with EPA approved preservation methods.





Blaine Tech Services
1680 Rogers Avenue
San Jose, CA 95112

Attention: Christine Lillie

Client Proj. ID: Chevron 9-0121/981228-G2

Lab Proj. ID: 9812G89-06
Sample Descript: LIQUID,MW-7

Sampled: 12/28/98

Received: 12/29/98

Analyzed: see below

Reported: 01/15/99

LABORATORY ANALYSIS

Analyte	Units	Detection Limit	Method	Analyst	Date Analyzed	Sample Results
Alkalinity: Total	mg CaCO ₃ /L	40	SM 2320	KC	12/31/98	350
Ferrous Iron	mg/L	0.010	3500A Mod	RD	01/06/99	12
Nitrate as Nitrate	mg/L	1.0	EPA 300.0	GF	12/30/98	N.D.
Sulfate	mg/L	1.0	EPA 300.0	GF	12/30/98	79

Analytes reported as N.D. were not present above the stated limit of detection.

SEQUOIA ANALYTICAL - ELAP #1210

Project Manager

Please Note:

This sample was preserved in accordance with EPA approved preservation methods.





**Sequoia
Analytical**

680 Chesapeake Drive
404 N. Wiget Lane
819 Striker Avenue, Suite 8
1455 McDowell Blvd. North, Ste. D

Redwood City, CA 94063
Walnut Creek, CA 94598
Sacramento, CA 95834
Petaluma, CA 94954

(650) 364-9600
(925) 988-9600
(916) 921-9600
(707) 792-1865

FAX (650) 364-9233
FAX (925) 988-9673
FAX (916) 921-0100
FAX (707) 792-0342

Blaine Tech Services
1680 Rogers Avenue
San Jose, CA 95112

Client Proj. ID: Chevron 9-0121/981228-G2

Sampled: 12/28/98

Lab Proj. ID: 9812G89-07

Received: 12/29/98

Sample Descript: LIQUID,MW-8

Analyzed: see below

Attention: Christine Lillie

Reported: 01/15/99

LABORATORY ANALYSIS

Analyte	Units	Detection Limit	Method	Analyst	Date Analyzed	Sample Results
Alkalinity: Total	mg CaCO ₃ /L	120	SM 2320	KC	12/31/98	1100
Ferrous Iron	mg/L	0.010	3500A Mod	RD	01/06/99	0.045
Nitrate as Nitrate	mg/L	1.0	EPA 300.0	GF	12/30/98	N.D.
Sulfate	mg/L	1.0	EPA 300.0	GF	12/30/98	87

Analytes reported as N.D. were not present above the stated limit of detection.

SEQUOIA ANALYTICAL - ELAP #1210

Project Manager

Please Note:

This sample was preserved in accordance with EPA approved preservation methods.





Blaine Tech Services 1680 Rogers Avenue San Jose, CA 95112	Client Proj. ID: Chevron 9-0121/981228-G2 Sample Descript: MW-1 Matrix: LIQUID Analysis Method: EPA 8015 Mod Lab Number: 9812G89-01	Sampled: 12/28/98 Received: 12/29/98 Extracted: 01/05/99 Analyzed: 01/07/99 Reported: 01/15/99
Attention: Christine Lillie		

QC Batch Number: GC0105990HBPEXA
Instrument ID: GCHP4B

Total Extractable Petroleum Hydrocarbons (TEPH)

Analyte	Detection Limit ug/L	Sample Results ug/L
TEPH as Diesel Chromatogram Pattern:	50 C9-C24	1500 Unid.-HC
Surrogates n-Pentacosane (C25)	Control Limits % 50 150	% Recovery 119

Analytes reported as N.D. were not present above the stated limit of detection.

SEQUOIA ANALYTICAL - ELAP #1210

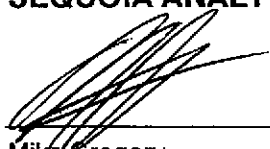

Mike Gregory
Project Manager





Blaine Tech Services
1680 Rogers Avenue
San Jose, CA 95112

Client Proj. ID: Chevron 9-0121/981228-G2
Sample Descript: MW-1
Matrix: LIQUID
Analysis Method: 8015Mod/8020
Lab Number: 9812G89-01

Sampled: 12/28/98
Received: 12/29/98
Analyzed: 01/11/99
Reported: 01/15/99

Attention: Christine Lillie

QC Batch Number: GC011199802004A

Instrument ID: HP4

Total Purgeable Hydrocarbons (TPPH) with BTEX and MTBE

Analyte	Detection Limit ug/L	Sample Results ug/L
TPPH as Gas	1000	3800
Methyl t-Butyl Ether	50	330
Benzene	10	250
Toluene	10	14
Ethyl Benzene	10	28
Xylenes (Total)	10	15
Chromatogram Pattern:		GAS

Surrogates	Control Limits %	% Recovery
Trifluorotoluene	70 130	94

Analytes reported as N.D. were not present above the stated limit of detection.

SEQUOIA ANALYTICAL - ELAP #1271

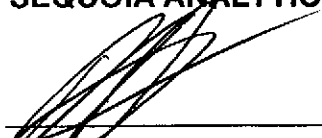

Mike Gregory
Project Manager





**Sequoia
Analytical**

680 Chesapeake Drive
404 N. Wiget Lane
819 Striker Avenue, Suite 8
1455 McDowell Blvd. North, Ste. D

Redwood City, CA 94063
Walnut Creek, CA 94598
Sacramento, CA 95834
Petaluma, CA 94954

(650) 364-9600
(925) 988-9600
(916) 921-9600
(707) 792-1865

FAX (650) 364-9233
FAX (925) 988-9673
FAX (916) 921-0100
FAX (707) 792-0342

Blaine Tech Services
1680 Rogers Avenue
San Jose, CA 95112

Attention: Christine Lillie

Client Proj. ID: Chevron 9-0121/981228-G2
Sample Descript: MW-3
Matrix: LIQUID
Analysis Method: EPA 8015 Mod
Lab Number: 9812G89-02

Sampled: 12/28/98
Received: 12/29/98
Extracted: 01/05/99
Analyzed: 01/07/99
Reported: 01/15/99

QC Batch Number: GC0105990HBPEXA
Instrument ID: GCHP4B

Total Extractable Petroleum Hydrocarbons (TEPH)

Analyte	Detection Limit ug/L	Sample Results ug/L
TEPH as Diesel Chromatogram Pattern:	50 C9-C24	180 Unid.-HC
Surrogates n-Pentacosane (C25)	Control Limits % 50 150	% Recovery 85

Analytes reported as N.D. were not present above the stated limit of detection.

SEQUOIA ANALYTICAL - ELAP #1210

Mike Gregory
Project Manager





Blaine Tech Services 1680 Rogers Avenue San Jose, CA 95112	Client Proj. ID: Chevron 9-0121/981228-G2 Sample Descript: MW-3 Matrix: LIQUID Analysis Method: 8015Mod/8020 Lab Number: 9812G89-02	Sampled: 12/28/98 Received: 12/29/98 Analyzed: 01/11/99 Reported: 01/15/99
Attention: Christine Lillie		

QC Batch Number: GC011199802004A
Instrument ID: HP4

Total Purgeable Hydrocarbons (TPPH) with BTEX and MTBE

Analyte	Detection Limit ug/L	Sample Results ug/L
TPPH as Gas	1000	1400
Methyl t-Butyl Ether	50	N.D.
Benzene	10	220
Toluene	10	N.D.
Ethyl Benzene	10	12
Xylenes (Total)	10	N.D.
Chromatogram Pattern:		GAS
Surrogates	Control Limits %	% Recovery
Trifluorotoluene	70 130	100

Analytes reported as N.D. were not present above the stated limit of detection.

SEQUOIA ANALYTICAL - ELAP #1271

Mike Gregory
Project Manager





Blaine Tech Services 1680 Rogers Avenue San Jose, CA 95112	Client Proj. ID: Chevron 9-0121/981228-G2 Sample Descript: MW-4 Matrix: LIQUID Analysis Method: EPA 8015 Mod Lab Number: 9812G89-03	Sampled: 12/28/98 Received: 12/29/98 Extracted: 01/05/99 Analyzed: 01/07/99 Reported: 01/15/99
Attention: Christine Lillie		

QC Batch Number: GC0105990HBPEXA
Instrument ID: GCHP4B

Total Extractable Petroleum Hydrocarbons (TEPH)

Analyte	Detection Limit ug/L	Sample Results ug/L
TEPH as Diesel Chromatogram Pattern:	50 C9-C24	2900 Unid.-HC
Surrogates n-Pentacosane (C25)	Control Limits % 50 150	% Recovery 171 Q

Analytes reported as N.D. were not present above the stated limit of detection.

SEQUOIA ANALYTICAL - ELAP #1210

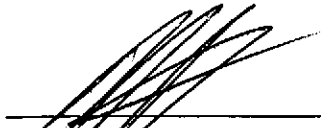

Mike Gregory
Project Manager





Blaine Tech Services 1680 Rogers Avenue San Jose, CA 95112	Client Proj. ID: Chevron 9-0121/981228-G2 Sample Descript: MW-4 Matrix: LIQUID Analysis Method: 8015Mod/8020 Lab Number: 9812G89-03	Sampled: 12/28/98 Received: 12/29/98 Analyzed: 01/11/99 Reported: 01/15/99
Attention: Christine Lillie		

QC Batch Number: GC011199802004A
Instrument ID: HP4

Total Purgeable Hydrocarbons (TPPH) with BTEX and MTBE

Analyte	Detection Limit ug/L	Sample Results ug/L
TPPH as Gas	250	1000
Methyl t-Butyl Ether	250	8400
Benzene	2.5	52
Toluene	2.5	5.6
Ethyl Benzene	2.5	4.6
Xylenes (Total)	2.5	9.1
Chromatogram Pattern:		GAS

Surrogates	Control Limits %	% Recovery
Trifluorotoluene	70 130	90

Analytes reported as N.D. were not present above the stated limit of detection.

SEQUOIA ANALYTICAL - ELAP #1271



Mike Gregory
Project Manager





Blaine Tech Services 1680 Rogers Avenue San Jose, CA 95112	Client Proj. ID: Chevron 9-0121/981228-G2 Sample Descript: TB Matrix: LIQUID Analysis Method: 8015Mod/8020 Lab Number: 9812G89-08	Sampled: 12/28/98 Received: 12/29/98 Analyzed: 01/11/99 Reported: 01/15/99
Attention: Christine Lillie		

QC Batch Number: GC011199802004A
Instrument ID: HP4

Total Purgeable Hydrocarbons (TPPH) with BTEX and MTBE

Analyte	Detection Limit ug/L	Sample Results ug/L
TPPH as Gas	50	N.D.
Methyl t-Butyl Ether	2.5	N.D.
Benzene	0.50	N.D.
Toluene	0.50	N.D.
Ethyl Benzene	0.50	N.D.
Xylenes (Total)	0.50	N.D.
Chromatogram Pattern:		
Surrogates	Control Limits %	% Recovery
Trifluorotoluene	70 130	99

Analytes reported as N.D. were not present above the stated limit of detection.

SEQUOIA ANALYTICAL - ELAP #1271

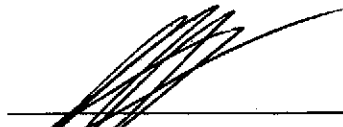

Mike Gregory
Project Manager





Sequoia
Analytical

680 Chesapeake Drive
404 N. Wiger Lane
819 Striker Avenue, Suite 8
1455 McDowell Blvd. North, Ste. D

Redwood City, CA 94063
Walnut Creek, CA 94598
Sacramento, CA 95834
Petaluma, CA 94954

(650) 364-9600
(925) 988-9600
(916) 921-9600
(707) 792-1865

FAX (650) 364-9233
FAX (925) 988-9673
FAX (916) 921-0100
FAX (707) 792-0342

Blaine Tech Services
1680 Rogers Avenue
San Jose, CA 95112
Attention: Christine Lillie

Client Proj. ID: Chevron 9-0121/981228-G2

Received: 12/29/98

Lab Proj. ID: 9812G89

Reported: 01/15/99

LABORATORY NARRATIVE

In order to properly interpret this report, it must be reproduced in its entirety. This report contains a total of 17 pages including the laboratory narrative, sample results, quality control, and related documents as required (cover page, COC, raw data, etc.).

TPH-GAS/BTEX:

Sample 9812G89-01 was diluted 20-fold.
Sample 9812G89-02 was diluted 20-fold.
Sample 9812G89-03 was diluted 5-fold.

#Q - Surrogate coelution was confirmed.

SEQUOIA ANALYTICAL

Mike Gregory
Project Manager





Sequoia Analytical

680 Chesapeake Drive
404 N. Wiger Lane
819 Striker Avenue, Suite 8
1455 McDowell Blvd. North, Ste. D

Redwood City, CA 94063
Walnut Creek, CA 94598
Sacramento, CA 95834
Petaluma, CA 94954

(650) 364-9600
(925) 988-9600
(916) 921-9600
(707) 792-1865

FAX (650) 364-9233
FAX (925) 988-9673
FAX (916) 921-0100
FAX (707) 792-0342

Blaine Tech Services
1680 Rogers Avenue
San Jose, CA 95112
Attention: Christine Lillie

Client Project ID: Chevron 9-0121/981228-G2

QC Sample Group: 9812G89-01-07

Reported: Jan 15, 1999

QUALITY CONTROL DATA REPORT

Matrix: Liquid
Method: EPA 310.2
Analyst: K. Cesar

ANALYTE Alkalinity

QC Batch #: IN1231983102FIA

Sample No.: 9812G90-1
Date Prepared: 12/31/98
Date Analyzed: 12/31/98
Instrument I.D.#: FIA

Sample Conc., mg/L: 830
Conc. Spiked, mg/L: 100

Matrix Spike, mg/L: 930
% Recovery: 100

Matrix
Spike Duplicate, mg/L: 920
% Recovery: 90

Relative % Difference: 11

RPD Control Limits: 0-20

LCS Batch#: LCS123198

Date Prepared: 12/31/98
Date Analyzed: 12/31/98
Instrument I.D.#: FIA

Conc. Spiked, mg/L: 200

LCS Recovery, mg/L: 220
LCS % Recovery: 110

Percent Recovery Control Limits:

MS/MSD 75-125
LCS 80-120

Quality Assurance Statement: All standard operating procedures and quality control requirements have been met.

Please Note:

The LCS is a control sample of known, interferent free matrix that is analyzed using the same reagents, preparation, and analytical methods employed for the samples. The matrix spike is an aliquot of sample fortified with known quantities of specific compounds and subjected to the entire analytical procedure. If the recovery of analytes from the matrix spike does not fall within specified control limits due to matrix interference, the LCS recovery is to be used to validate the batch.

SEQUOIA ANALYTICAL

Mike Gregory
Project Manager





**Sequoia
Analytical**

680 Chesapeake Drive
404 N. Wiget Lane
819 Striker Avenue, Suite 8
1455 McDowell Blvd. North, Ste. D

Redwood City, CA 94063
Walnut Creek, CA 94598
Sacramento, CA 95834
Petaluma, CA 94954

(650) 364-9600
(925) 988-9600
(916) 921-9600
(707) 792-1865

FAX (650) 364-9233
FAX (925) 988-9673
FAX (916) 921-0100
FAX (707) 792-0342

Blaine Tech Services
1680 Rogers Avenue
San Jose, CA 95112
Attention: Christine Lillie

Client Project ID: Chevron 9-0121/981228-G2

QC Sample Group: 9812G89-01-03

Reported: Jan 15, 1999

QUALITY CONTROL DATA REPORT

Matrix: Liquid
Method: EPA 8015A
Analyst: A. PORTER

ANALYTE Diesel

QC Batch #: GC0105990HBPEXA

Sample No.: 9812G76-03

Date Prepared: 1/5/99

Date Analyzed: 1/6/99

Instrument I.D.#: GCHP5B

Sample Conc., ug/L: N.D.

Conc. Spiked, ug/L: 1000

Matrix Spike, ug/L: 650

% Recovery: 65

Matrix

Spike Duplicate, ug/L: 780

% Recovery: 78

Relative % Difference: 18

RPD Control Limits: 0-50

LCS Batch#: BLK010599AS

Date Prepared: 1/5/99

Date Analyzed: 1/6/99

Instrument I.D.#: GCHP5B

Conc. Spiked, ug/L: 1000

Recovery, ug/L: 760

LCS % Recovery: 76

Percent Recovery Control Limits:

MS/MSD 50-150

LCS 60-140

Quality Assurance Statement: All standard operating procedures and quality control requirements have been met.

SEQUOIA ANALYTICAL

Mike Gregory
Project Manager

Please Note:

The LCS is a control sample of known, interferent free matrix that is analyzed using the same reagents, preparation, and analytical methods employed for the samples. The matrix spike is an aliquot of sample fortified with known quantities of specific compounds and subjected to the entire analytical procedure. If the recovery of analytes from the matrix spike does not fall within specified control limits due to matrix interference, the LCS recovery is to be used to validate the batch.





Sequoia Analytical

680 Chesapeake Drive
404 N. Wiget Lane
819 Striker Avenue, Suite 8
1455 McDowell Blvd. North, Ste. D

Redwood City, CA 94063
Walnut Creek, CA 94598
Sacramento, CA 95834
Petaluma, CA 94954

(650) 364-9600
(925) 988-9600
(916) 921-9600
(707) 792-1865

FAX (650) 364-9233
FAX (925) 988-9673
FAX (916) 921-0100
FAX (707) 792-0342

Blaine Tech Services
1680 Rogers Avenue
San Jose, CA 95112
Attention: Christine Lillie

Client Project ID: Chevron 9-0121/981228-G2

QC Sample Group: 9812G89-01-07

Reported: Jan 15, 1999

QUALITY CONTROL DATA REPORT

Matrix:	Liquid						
Method:	EPA 300.0						
Analyst:	G. Fish						
ANALYTE	Fluoride	Chloride	Nitrite	Bromide	Nitrate	Phosphate	Sulfate

QC Batch #: 1230983000ACB

Sample No.:	9812G89-4						
Date Prepared:	12/30/98	12/30/98	12/30/98	12/30/98	12/30/98	12/30/98	12/30/98
Date Analyzed:	12/30/98	12/30/98	12/30/98	12/30/98	12/30/98	12/30/98	12/30/98
Instrument I.D.#:	INAC1	INAC1	INAC1	INAC1	INAC1	INAC1	INAC1
Sample Conc., mg/L:	N.D.	100	N.D.	N.D.	N.D.	N.D.	51
Conc. Spiked, mg/L:	100	100	100	100	100	100	100
Matrix Spike, mg/L:	110	210	98	91	93	83	150
% Recovery:	110	110	98	91	93	83	99
Matrix Spike Duplicate, mg/L:	110	200	98	91	93	85	150
% Recovery:	110	100	98	91	93	85	99
Relative % Difference:	0.0	9.5	0.0	0.0	0.0	2.4	0.0

RPD Control Limits:

LCS Batch#: LCS1230983000ACB

Date Prepared:	12/30/98	12/30/98	12/30/98	12/30/98	12/30/98	12/30/98	12/30/98
Date Analyzed:	12/30/98	12/30/98	12/30/98	12/30/98	12/30/98	12/30/98	12/30/98
Instrument I.D.#:	INAC1	INAC1	INAC1	INAC1	INAC1	INAC1	INAC1
Conc. Spiked, mg/L:	10	10	10	10	10	10	10
LCS Recovery, mg/L:	11	9.4	9.5	9.2	9.2	9.7	9.3
LCS % Recovery:	108	94	95	92	92	97	93

Percent Recovery Control Limits:

MS/MSD	75-125	75-125	75-125	75-125	75-125	75-125	75-125
LCS	90-110	90-110	90-110	90-110	90-110	90-110	90-110

Quality Assurance Statement: All standard operating procedures and quality control requirements have been met.

Please Note:

The LCS is a control sample of known, interferent free matrix that is analyzed using the same reagents, preparation, and analytical methods employed for the samples. The matrix spike is an aliquot of sample fortified with known quantities of specific compounds and subjected to the entire analytical procedure. If the recovery of analytes from the matrix spike does not fall within specified control limits due to matrix interference, the LCS recovery is to be used to validate the batch.

SEQUOIA ANALYTICAL

Mike Gregory
Project Manager





Sequoia Analytical

680 Chesapeake Drive
404 N. Wiget Lane
819 Striker Avenue, Suite B
1455 McDowell Blvd. North, Ste. D

Redwood City, CA 94063
Walnut Creek, CA 94598
Sacramento, CA 95834
Petaluma, CA 94954

(650) 364-9600
(925) 988-9600
(916) 921-9600
(707) 792-1865

FAX (650) 364-9233
FAX (925) 988-9673
FAX (916) 921-0100
FAX (707) 792-0342

Blaine Tech Services, Inc.
1680 Rogers Ave.
San Jose, CA 95112
Attention: Christine Lillie

Client Project ID: Chevron 9-0121/981228-G2
Matrix: Liquid

Work Order #: 9812G89 -01-03, 08

Reported: Jan 18, 1999

QUALITY CONTROL DATA REPORT

Analyte:	Benzene	Toluene	Ethyl Benzene	Xylenes	BTEX as TPH
QC Batch#:	GC011199802004A	GC011199802004A	GC011199802004A	GC011199802004A	GC011199802004A
Analy. Method:	EPA 8020	EPA 8020	EPA 8020	EPA 8020	EPA 8015M
Prep. Method:	EPA 5030	EPA 5030	EPA 5030	EPA 5030	EPA 5030

Analyst:	D. Newcomb	D. Newcomb	D. Newcomb	D. Newcomb	D. Newcomb
MS/MSD #:	8122519	8122519	8122519	8122519	8122519
Sample Conc.:	N.D.	N.D.	N.D.	N.D.	N.D.
Prepared Date:	1/11/99	1/11/99	1/11/99	1/11/99	1/11/99
Analyzed Date:	1/11/99	1/11/99	1/11/99	1/11/99	1/11/99
Instrument I.D.#:	HP4	HP4	HP4	HP4	HP4
Conc. Spiked:	20 µg/L	20 µg/L	20 µg/L	60 µg/L	360 µg/L
Result:	20	18	19	67	290
MS % Recovery:	100	90	95	112	81
Dup. Result:	21	18	19	67	290
MSD % Recov.:	105	90	95	112	81
RPD:	4.9	0.0	0.0	0.0	0.0
RPD Limit:	0-20	0-20	0-20	0-20	0-50

LCS #:	LCS011199	LCS011199	LCS011199	LCS011199	LCS011199
Prepared Date:	1/11/99	1/11/99	1/11/99	1/11/99	1/11/99
Analyzed Date:	1/11/99	1/11/99	1/11/99	1/11/99	1/11/99
Instrument I.D.#:	HP4	HP4	HP4	HP4	HP4
Conc. Spiked:	20 µg/L	20 µg/L	20 µg/L	60 µg/L	360 µg/L
LCS Result:	19	17	18	63	340
LCS % Recov.:	95	85	90	105	94

MS/MSD	60-140	60-140	60-140	60-140	
LCS	70-130	70-130	70-130	70-130	50-150
Control Limits					

SEQUOIA ANALYTICAL
Elap #1271

Mike Gregory
Project Manager

Please Note:

The LCS is a control sample of known, interferent-free matrix that is analyzed using the same reagents, preparation, and analytical methods employed for the samples. The matrix spike is an aliquot of sample fortified with known quantities of specific compounds and subjected to the entire analytical procedure. If the recovery of analytes from the matrix spike does not fall within specified control limits due to matrix interference, the LCS recovery is to be used to validate the batch.

** MS= Matrix Spike, MSD=MS Duplicate, RPD= Relative % Difference

9812G89.BLA <1>





Blaine Tech Services, Inc.
1680 Rogers Ave.
San Jose, CA 95112
Attention: Christine Lillie

Client Project ID: Chevron 9-0121/981228-G2
Matrix: Liquid

Work Order #: 9812G89-01-03, 05-07

Reported: Jan 18, 1999

QUALITY CONTROL DATA REPORT

Analyte:	Beryllium	Cadmium	Chromium	Nickel
QC Batch#:	ME0104996010MDG	ME0104996010MDG	ME0104996010MDG	ME0104996010MDG
Analy. Method:	EPA 6010	EPA 6010	EPA 6010	EPA 6010
Prep. Method:	EPA 3010	EPA 3010	EPA 3010	EPA 3010

Analyst:	R. Dave	R. Dave	R. Dave	R. Dave
MS/MSD #:	9812H6801	9812H6801	9812H6801	9812H6801
Sample Conc.:	N.D.	N.D.	N.D.	N.D.
Prepared Date:	1/4/99	1/4/99	1/4/99	1/4/99
Analyzed Date:	1/6/99	1/6/99	1/6/99	1/6/99
Instrument I.D.#:	MTJA5	MTJA5	MTJA5	MTJA5
Conc. Spiked:	1.0 mg/L	1.0 mg/L	1.0 mg/L	1.0 mg/L
Result:	1.0	1.0	1.0	1.0
MS % Recovery:	100	100	100	100
Dup. Result:	1.0	1.0	1.0	1.0
MSD % Recov.:	100	100	100	100
RPD:	0.0	0.0	0.0	0.0
RPD Limit:	0-20	0-20	0-20	0-20

LCS #:	LCS010499	LCS010499	LCS010499	LCS010499
Prepared Date:	1/4/99	1/4/99	1/4/99	1/4/99
Analyzed Date:	1/6/99	1/6/99	1/6/99	1/6/99
Instrument I.D.#:	MTJA5	MTJA5	MTJA5	MTJA5
Conc. Spiked:	1.0 mg/L	1.0 mg/L	1.0 mg/L	1.0 mg/L
LCS Result:	1.0	1.0	1.0	1.0
LCS % Recov.:	100	100	100	100

MS/MSD	80-120	80-120	80-120	80-120
LCS	80-120	80-120	80-120	80-120
Control Limits				

SEQUOIA ANALYTICAL

Mike Gregory
Project Manager

Please Note:

The LCS is a control sample of known, interferent-free matrix that is analyzed using the same reagents, preparation, and analytical methods employed for the samples. The matrix spike is an aliquot of sample fortified with known quantities of specific compounds and subjected to the entire analytical procedure. If the recovery of analytes from the matrix spike does not fall within specified control limits due to matrix interference, the LCS recovery is to be used to validate the batch.

** MS= Matrix Spike, MSD=MS Duplicate, RPD=Relative % Difference

9812G89.BLA <2>





Sequoia Analytical

680 Chesapeake Drive
404 N. Wiget Lane
819 Striker Avenue, Suite 8
1455 McDowell Blvd. North, Ste. D

Redwood City, CA 94063
Walnut Creek, CA 94598
Sacramento, CA 95834
Petaluma, CA 94954

(650) 364-9600
(925) 988-9600
(916) 921-9600
(707) 792-1865

FAX (650) 364-9233
FAX (925) 988-9673
FAX (916) 921-0100
FAX (707) 792-0342

Blaine Tech Services, Inc.
1680 Rogers Ave.
San Jose, CA 95112
Attention: Christine Lillie

Client Project ID: Chevron 9-0121/981228-G2
Matrix: Liquid

Work Order #: 9812G89-04

Reported: Jan 18, 1999

QUALITY CONTROL DATA REPORT

Analyte:	Beryllium	Cadmium	Chromium	Nickel
QC Batch#:	ME0104996010MDH	ME0104996010MDH	ME0104996010MDH	ME0104996010MDH
Analy. Method:	EPA 6010	EPA 6010	EPA 6010	EPA 6010
Prep. Method:	EPA 3010	EPA 3010	EPA 3010	EPA 3010

Analyst:	C. Medefesser	C. Medefesser	C. Medefesser	C. Medefesser
MS/MSD #:	9812H5001	9812H5001	9812H5001	9812H5001
Sample Conc.:	N.D.	N.D.	0.014	0.41
Prepared Date:	1/4/99	1/4/99	1/4/99	1/4/99
Analyzed Date:	1/5/99	1/5/99	1/5/99	1/5/99
Instrument I.D.#:	MTJA5	MTJA5	MTJA5	MTJA5
Conc. Spiked:	1.0 mg/L	1.0 mg/L	1.0 mg/L	1.0 mg/L
Result:	0.92	1.0	0.98	1.4
MS % Recovery:	92	100	97	99
Dup. Result:	0.91	1.0	1.0	1.4
MSD % Recov.:	91	100	99	99
RPD:	1.1	0.0	2.0	0.0
RPD Limit:	0-20	0-20	0-20	0-20

LCS #:	LCS010499	LCS010499	LCS010499	LCS010499
Prepared Date:	1/4/99	1/4/99	1/4/99	1/4/99
Analyzed Date:	1/5/99	1/5/99	1/5/99	1/5/99
Instrument I.D.#:	MTJA5	MTJA5	MTJA5	MTJA5
Conc. Spiked:	1.0 mg/L	1.0 mg/L	1.0 mg/L	1.0 mg/L
LCS Result:	0.99	1.0	1.0	1.0
LCS % Recov.:	99	100	100	100

MS/MSD	80-120	80-120	80-120	80-120
LCS	80-120	80-120	80-120	80-120
Control Limits				

SEQUOIA ANALYTICAL

Mike Gregory
Project Manager

Please Note:

The LCS is a control sample of known, interferent-free matrix that is analyzed using the same reagents, preparation, and analytical methods employed for the samples. The matrix spike is an aliquot of sample fortified with known quantities of specific compounds and subjected to the entire analytical procedure. If the recovery of analytes from the matrix spike does not fall within specified control limits due to matrix interference, the LCS recovery is to be used to validate the batch.

** MS=Matrix Spike, MSD=MS Duplicate, RPD=Relative % Difference

9812G89.BLA <3>



Chevron U.S.A. Inc.
P.O. BOX 5004
San Ramon, CA 94583
FAX (415)842-9591

Chevron Facility Number 9-0121
Facility Address 3026 Lakeshore Ave., Oakland, CA
Consultant Project Number 981228-62
Consultant Name Blaine Tech Services, Inc.
Address 1680 Rogers Ave., San Jose, CA 95112
Project Contact (Name) Fran Thie
(Phone) (408)573-0555 (Fax Number) (408)573-7771

Chevron Contact (Name) Phil Briggs
(Phone) (510) 842-9136
Laboratory Name Sequoia
Laboratory Release Number 9029940
Samples Collected by (Name) Morgan Gillies
Collection Date 12/28/98
Signature [Signature]

Sample Number	Lab Sample Number	Number of Containers	Matrix S = Soil W = Water A = Air C = Charcoal	Type G = Grab C = Composite D = Discrete	Time	Sample Preservation	Iced (Yes or No)	Analyses To Be Performed										DO NOT BILL FOR TB-LB <u>9812G89</u> Remarks			
								BTEX + TPH GAS (8020 + 8015)	TPH Diesel (8015)	Oil and Grease (5520)	Purgeable Halocarbons (8010)	Purgeable Aromatics (8020)	Purgeable Organics (8240)	Extractable Organics (8270)	Metals Cd, Cr, Pb, Zn, Ni (CAP or AA)	Alkalinity Sulfate	N. Nitrate		Ferrous Iron		
MW-1		8	W		1541		Yes	X	X											61	
MW-3		7			1400			X	X												62
MW-4		7			1500			X	X												63
MW-5		3			1137																64
MW-6		3			1310																65
MW-7		3			1240																66
MW-8		3			1210																67
TB		2						X													68

Relinquished By (Signature) <u>[Signature]</u>	Organization <u>BTS</u>	Date/Time <u>12-29-98 1045</u>	Received By (Signature) <u>[Signature]</u>	Organization <u>SEQUOIA</u>	Date/Time <u>12-29-98 1045</u>	Turn Around Time (Circle Choice) 24 Hrs. 48 Hrs. 5 Days 10 Days As Contracted
Relinquished By (Signature) <u>[Signature]</u>	Organization <u>SEQUOIA</u>	Date/Time <u>12-29-98</u>	Received By (Signature) <u>[Signature]</u>	Organization	Date/Time	
Relinquished By (Signature)	Organization	Date/Time	Received For Laboratory By (Signature) <u>[Signature]</u>		Date/Time <u>12/29/98 1304</u>	

COC-3.DWG/03 91/HCH

Field Data Sheets

CHEVRON WELL MONITORING DATA SHEET

Project #: 981228-62	Station #: 9-0121
Sampler: MB	Date: 12/28/98
Well I.D.: MW-1	Well Diameter: 2 3 <u>4</u> 6 8
Total Well Depth: 19.13	Depth to Water: 4.95
Depth to Free Product:	Thickness of Free Product (feet):
Referenced to: <u>PVC</u> Grade	D.O. Meter (if req'd): <u>YSI</u> HACH

Well Diameter	Multiplier	Well Diameter	Multiplier
2"	0.16	5"	1.02
3"	0.37	6"	1.47
4"	0.65	Other	radius ² * 0.163

Purge Method: <input type="checkbox"/> Bailer <input type="checkbox"/> Disposable Bailer <input type="checkbox"/> Middleburg <input checked="" type="checkbox"/> Electric Submersible <input type="checkbox"/> Extraction Pump Other: _____	Sampling Method: <input type="checkbox"/> Bailer <input checked="" type="checkbox"/> Disposable Bailer <input type="checkbox"/> Extraction Port Other: _____
--	---

<u>9.2</u>	x	<u>3</u>	=	<u>27.6</u>	Gals.
1 Case Volume (Gals.)		Specified Volumes		Calculated Volume	

Time	Temp (°F)	pH	Cond.	Gals. Removed	Observations
1532	62.0	7.4	1240	10	Odor
1534	62.3	7.3	1240	20	↓
1536	62.1	7.3	1180	30	

Did well dewater? Yes <input type="checkbox"/> <u>No</u> <input checked="" type="checkbox"/>	Gallons actually evacuated: <u>30</u>	
Sampling Time: <u>1541</u>	Sampling Date: <u>12/28/98</u>	
Sample I.D.: <u>MW-1</u>	Laboratory: <u>Sequidia</u> GTEL N. Creek Assoc. Labs	
Analyzed for: <u>TPH-G BTEX MTBE TPH-D</u>	Other: <u>Biosurite</u>	
Duplicate I.D.:	Analyzed for: TPH-G BTEX MTBE TPH-D Other:	
D.O. (if req'd):	Pre-purge: <u>1.2</u> mg/L	Post-purge: <u>1.4</u> mg/L
O.R.P. (if req'd):	Pre-purge: <u>-69</u> mV	Post-purge: <u>-78</u> mV

CHEVRON WELL MONITORING DATA SHEET

Project #: <u>981228-62</u> Station #: <u>9-0121</u>	
Sampler: <u>M6</u>	Start Date: <u>12/28/98</u>
Well I.D.: <u>MW-2</u>	Well Diameter: (circle one) 2 3 4 6 <u>3/4"</u>
Total Well Depth: Before <u>—</u> After	Depth to Water: Before <u>4.60</u> After
Depth to Free Product: <u>4.50</u>	Thickness of Free Product (feet): <u>0.10</u>
Measurements referenced to: <u>PVC</u>	Grade Other:

Well Diameter	VCF	Well Diameter	VCF
1"	0.04	6"	1.47
2"	0.16	8"	2.61
3"	0.37	10"	4.08
4"	0.65	12"	5.87
5"	1.02	16"	10.43

_____ x _____ = _____ gallons

1 Case Volume Specified Volumes

Purging: Bailer Disposable Bailer Middleburg Electric Submersible Extraction Pump Other: <u>Pin Bailer</u>	Sampling: Bailer Disposable Bailer Extraction Port Other: _____
---	--

TIME	TEMP. (F)	pH	COND.	TURBIDITY:	VOLUME REMOVED:	OBSERVATIONS:
						<u>FP - No Sample - 20 mL FP removed.</u>

Did Well Dewater? If yes, gals. Gallons Actually Evacuated:

Sampling Time: Sampling Date:

Sample I.D.: Laboratory:

Analyzed for: TPH-G BTEX TPH-D OTHER:
(Circle)

Duplicate I.D.: Cleaning Blank I.D.:

Analyzed for: TPH-G BTEX TPH-D OTHER:
(Circle)

CHEVRON WELL MONITORING DATA SHEET

Project #: <u>981228-62</u>	Station #: <u>9-0121</u>
Sampler: <u>MB</u>	Date: <u>12/28/98</u>
Well I.D.: <u>MW-3</u>	Well Diameter: 2 3 4 6 8 <u>7/4"</u>
Total Well Depth: <u>17.41</u>	Depth to Water: <u>8.73</u>
Depth to Free Product:	Thickness of Free Product (feet):
Referenced to: <u>(PVC)</u> Grade	D.O. Meter (if req'd): <u>(YSI)</u> HACH

Well Diameter	Multiplier	Well Diameter	Multiplier
2"	0.16	5"	1.02
3"	0.37	6"	1.47
4"	0.65	Other	radius ² * 0.163

~~3/4" = 0.1875~~
3/4" = 0.02

Purge Method:	Sampling Method:
Bailer	Bailer
Disposable Bailer	Disposable Bailer
Middleburg	Extraction Port
Electric Submersible	Other: <u>Pin Bailer</u>
Extraction Pump	
Other: <u>Pin Bailer</u>	

<u>0.17</u> 0.02	x	<u>3</u>	=	<u>0.51</u> 0.06	Gals.
1 Case Volume (Gals.)		Specified Volumes		Calculated Volume	

Time	Temp (°F)	pH	Cond.	Gals. Removed	Observations
<u>1340</u>	<u>63.4</u>	<u>6.8</u>	<u>7160</u>	<u>0.25</u>	
<u>1345</u>	<u>63.9</u>	<u>6.8</u>	<u>7120</u>	<u>0.50</u>	
<u>1350</u>	<u>64.2</u>	<u>6.8</u>	<u>7090</u>	<u>0.75</u>	

Did well dewater? Yes <input type="checkbox"/> No <input checked="" type="checkbox"/>	Gallons actually evacuated: <u>0.75</u>
Sampling Time: <u>1400</u>	Sampling Date: <u>12/28/98</u>
Sample I.D.: <u>MW-3</u>	Laboratory: <u>(Sequoia)</u> GTEL N. Creek Assoc. Labs

Analyzed for: <u>(TPH-G BTEX MTBE TPH-D)</u> Other: <u>Bioscrite</u>
Duplicate I.D.: _____ Analyzed for: TPH-G BTEX MTBE TPH-D Other: _____
D.O. (if req'd): Pre-purge: <u>1.8</u> mg/L Post-purge: <u>4.2</u> mg/L
O.R.P. (if req'd): Pre-purge: <u>0.6</u> mV Post-purge: <u>0.0</u> mV

CHEVRON WELL MONITORING DATA SHEET

Project #: <u>981228-62</u>	Station #: <u>9-0121</u>
Sampler: <u>MG</u>	Date: <u>12/28/88</u>
Well I.D.: <u>MW-4</u>	Well Diameter: 2 3 4 6 8 <u>3/4"</u>
Total Well Depth: <u>14.06</u>	Depth to Water: <u>5.41</u>
Depth to Free Product:	Thickness of Free Product (feet):
Referenced to: <u>PVC</u> Grade	D.O. Meter (if req'd): <u>YSI</u> HACH

Well Diameter	Multiplier	Well Diameter	Multiplier
2"	0.16	5"	1.02
3"	0.37	6"	1.47
4"	0.65	Other	radius ² * 0.163

3/4" = 0.02

Purge Method: Bailer Sampling Method: Bailer

Disposable Bailer Disposable Bailer
 Middleburg Extraction Port
 Electric Submersible Other: Pin Bailer
 Extraction Pump

Other: Pin Bailer

<u>0.17</u>	x	<u>3</u>	=	<u>0.51</u>	Gals.
1 Case Volume (Gals.)		Specified Volumes		Calculated Volume	

Time	Temp (°F)	pH	Cond.	Gals. Removed	Observations
14:35	64.6	7.3	3470	0.25	
14:40	65.1	7.2	3420	0.50	
14:45	65.0	7.2	3430	0.75	

Did well dewater? Yes <input checked="" type="checkbox"/> No	Gallons actually evacuated: <u>0.75</u>
Sampling Time: <u>15:00</u>	Sampling Date: <u>12/28/88</u>
Sample I.D.: <u>MW-4</u>	Laboratory: <u>Sequoia</u> GTEL N. Creek Assoc. Labs
Analyzed for: <u>TPH-G BTEX MTBE TPH-D</u>	Other: <u>Biosolite</u>
Duplicate I.D.:	Analyzed for: TPH-G BTEX MTBE TPH-D Other:
D.O. (if req'd):	Pre-purge: <u>0.8</u> mg/L Post-purge: <u>1.4</u> mg/L
O.R.P. (if req'd):	Pre-purge: <u>-57</u> mV Post-purge: <u>-75</u> mV

CHEVRON WELL MONITORING DATA SHEET

Project #: <u>981228-62</u>	Station #: <u>9-0121</u>
Sampler: <u>MB</u>	Date: <u>12/28/98</u>
Well I.D.: <u>MW-5</u>	Well Diameter: <u>2</u> 3 4 6 8 _____
Total Well Depth: <u>32.72</u>	Depth to Water: <u>13.43</u>
Depth to Free Product:	Thickness of Free Product (feet):
Referenced to: <u>PVC</u> Grade	D.O. Meter (if req'd): <u>YSI</u> HACH

Well Diameter	Multiplier	Well Diameter	Multiplier
2"	0.16	5"	1.02
3"	0.37	6"	1.47
4"	0.65	Other	radius ² * 0.163

Purge Method: <input type="checkbox"/> Bailer <input checked="" type="checkbox"/> Disposable Bailer <input type="checkbox"/> Middleburg <input type="checkbox"/> Electric Submersible <input type="checkbox"/> Extraction Pump Other: _____	Sampling Method: <input type="checkbox"/> Bailer <input checked="" type="checkbox"/> Disposable Bailer <input type="checkbox"/> Extraction Port Other: _____
--	---

<u>3.1</u>	<u>x</u>	<u>3</u>	<u>=</u>	<u>9.3</u>	Gals.
1 Case Volume (Gals.)		Specified Volumes		Calculated Volume	

Time	Temp (°F)	pH	Cond.	Gals. Removed	Observations
<u>1120</u>	<u>64.2</u>	<u>6.9</u>	<u>1140</u>	<u>3.25</u>	
<u>1126</u>	<u>64.4</u>	<u>7.0</u>	<u>1200</u>	<u>6.5</u>	
<u>1132</u>	<u>64.8</u>	<u>7.0</u>	<u>1210</u>	<u>9.5</u>	

Did well dewater? Yes <input type="checkbox"/> No <input checked="" type="checkbox"/>	Gallons actually evacuated: <u>9.5</u>
Sampling Time: <u>1137</u>	Sampling Date: <u>12/28/98</u>
Sample I.D.: <u>MW-5</u>	Laboratory: <u>Sequoia</u> CORE N. Creek Assoc. Labs
Analyzed for: TPH-G BTEX MTBE TPH-D Other: <u>Biosuite</u>	
Duplicate I.D.:	Analyzed for: TPH-G BTEX MTBE TPH-D Other:
D.O. (if req'd):	Pre-purge: <u>1.6</u> mg/L Post-purge: <u>1.8</u> mg/L
O.R.P. (if req'd):	Pre-purge: <u>-120</u> mV Post-purge: <u>-53</u> mV

CHEVRON WELL MONITORING DATA SHEET

Project #: 981228-62	Station #: 9-0121
Sampler: M6	Date: 12/28/98
Well I.D.: MW-6	Well Diameter: (2) 3 4 6 8
Total Well Depth: 18.71	Depth to Water: 6.50
Depth to Free Product:	Thickness of Free Product (feet):
Referenced to: (PVC) Grade	D.O. Meter (if req'd): (YSI) HACH

Well Diameter	Multiplier	Well Diameter	Multiplier
2"	0.16	5"	1.02
3"	0.37	6"	1.47
4"	0.65	Other	radius ² * 0.163

Purge Method: <input type="checkbox"/> Bailer <input checked="" type="checkbox"/> Disposable Bailer <input type="checkbox"/> Middleburg <input type="checkbox"/> Electric Submersible <input type="checkbox"/> Extraction Pump Other: _____	Sampling Method: <input type="checkbox"/> Bailer <input checked="" type="checkbox"/> Disposable Bailer <input type="checkbox"/> Extraction Port Other: _____
--	---

2.0	x	3	=	6.0	Gals.
1 Case Volume (Gals.)		Specified Volumes		Calculated Volume	

Time	Temp (°F)	pH	Cond.	Gals. Removed	Observations
1255	67.4	6.9	13,800	2.25	H ₂ S odor / Black
1300	67.9	7.0	14,000	4.5	
1305	68.3	7.0	14,300	6.5	↓ ↓

Did well dewater? Yes <input type="checkbox"/> <input checked="" type="checkbox"/> No	Gallons actually evacuated: 6.5
Sampling Time: 1310	Sampling Date: 12/28/98
Sample I.D.: MW-6	Laboratory: Sequoia CORE N. Creek Assoc. Labs
Analyzed for: TPH-G BTEX MTBE TPH-D Other: Biogenic Fe	
Duplicate I.D.:	Analyzed for: TPH-G BTEX MTBE TPH-D Other:
D.O. (if req'd):	Pre-purge: 0.4 mg/L Post-purge: 0.2 mg/L
O.R.P. (if req'd):	Pre-purge: 66 mV Post-purge: -130 mV

-92 mV

CHEVRON WELL MONITORING DATA SHEET

Project #: <u>981228-62</u>	Station #: <u>9-0121</u>
Sampler: <u>MG</u>	Date: <u>12/28/98</u>
Well I.D.: <u>MW-7</u>	Well Diameter: <u>(2)</u> 3 4 6 8 <u> </u>
Total Well Depth: <u>14.82</u>	Depth to Water: <u>4.47</u>
Depth to Free Product:	Thickness of Free Product (feet):
Referenced to: <u>(PVC)</u> Grade	D.O. Meter (if req'd): <u>(YSI)</u> HACH

Well Diameter	Multiplier	Well Diameter	Multiplier
2"	0.16	5"	1.02
3"	0.37	6"	1.47
4"	0.65	Other	radius ² * 0.163

Purge Method: <input type="checkbox"/> Bailer <input checked="" type="checkbox"/> Disposable Bailer <input type="checkbox"/> Middleburg <input type="checkbox"/> Electric Submersible <input type="checkbox"/> Extraction Pump Other: _____	Sampling Method: <input type="checkbox"/> Bailer <input checked="" type="checkbox"/> Disposable Bailer <input type="checkbox"/> Extraction Port Other: _____
--	---

<u>1.7</u>	<u>x</u>	<u>3</u>	<u>=</u>	<u>5.1</u>	Gals.
1 Case Volume (Gals.)		Specified Volumes		Calculated Volume	

Time	Temp (°F)	pH	Cond.	Gals. Removed	Observations
<u>1225</u>	<u>66.3</u>	<u>6.7</u>	<u>1800</u>	<u>1.75</u>	
<u>1230</u>	<u>66.7</u>	<u>6.6</u>	<u>1760</u>	<u>3.5</u>	
<u>1235</u>	<u>67.0</u>	<u>6.6</u>	<u>1860</u>	<u>5.5</u>	

Did well dewater? Yes <input type="checkbox"/> No <input checked="" type="checkbox"/>	Gallons actually evacuated: <u>5.5</u>	
Sampling Time: <u>1240</u>	Sampling Date: <u>12/28/98</u>	
Sample I.D.: <u>MW-7</u>	Laboratory: <u>(Sequoia)</u> CORE N. Creek Assoc. Labs	
Analyzed for: TPH-G BTEX MTBE TPH-D Other: <u>Biosuite</u>		
Duplicate I.D.:	Analyzed for: TPH-G BTEX MTBE TPH-D Other:	
D.O. (if req'd):	Pre-purge: <u>1.2</u> mg/L	Post-purge: <u>1.6</u> mg/L
O.R.P. (if req'd):	Pre-purge: <u>-66</u> mV	Post-purge: <u>-55</u> mV

CHEVRON WELL MONITORING DATA SHEET

Project #: <u>981228-62</u>	Station #: <u>9-0121</u>
Sampler: <u>ML</u>	Date: <u>12/28/98</u>
Well I.D.: <u>MW-8</u>	Well Diameter: <u>(2)</u> 3 4 6 8 <u> </u>
Total Well Depth: <u>25.00</u>	Depth to Water: <u>8.30</u>
Depth to Free Product:	Thickness of Free Product (feet):
Referenced to: <u>(PVC)</u> Grade	D.O. Meter (if req'd): <u>(YSI)</u> HACH

Well Diameter	Multiplier	Well Diameter	Multiplier
2"	0.16	5"	1.02
3"	0.37	6"	1.47
4"	0.65	Other	radius ² * 0.163

Purge Method: <input type="checkbox"/> Bailer <input checked="" type="checkbox"/> Disposable Bailer <input type="checkbox"/> Middleburg <input type="checkbox"/> Electric Submersible <input type="checkbox"/> Extraction Pump Other: _____	Sampling Method: <input type="checkbox"/> Bailer <input checked="" type="checkbox"/> Disposable Bailer <input type="checkbox"/> Extraction Port Other: _____
--	---

<u>2.7</u>	<u>x</u>	<u>3</u>	<u>=</u>	<u>8.1</u>	Gals.
1 Case Volume (Gals.)		Specified Volumes		Calculated Volume	

Time	Temp (°F)	pH	Cond.	Gals. Removed	Observations
<u>1155</u>	<u>63.4</u>	<u>7.1</u>	<u>1920</u>	<u>2.75</u>	
<u>1200</u>	<u>63.7</u>	<u>7.1</u>	<u>2180</u>	<u>5.5</u>	
<u>1205</u>	<u>63.8</u>	<u>7.1</u>	<u>2130</u>	<u>8.5</u>	

Did well dewater? Yes <input type="checkbox"/> <u>(No)</u>	Gallons actually evacuated: <u>8.5</u>
Sampling Time: <u>1210</u>	Sampling Date: <u>12/28/98</u>
Sample I.D.: <u>MW-8</u>	Laboratory: <u>(Sequoia)</u> CORE N. Creek Assoc. Labs
Analyzed for: TPH-G BTEX MTBE TPH-D Other: <u>Bioguite</u>	
Duplicate I.D.:	Analyzed for: TPH-G BTEX MTBE TPH-D Other:
D.O. (if req'd):	Pre-purge: <u>0.8</u> mg/L Post-purge: <u>1.4</u> mg/L
O.R.P. (if req'd):	Pre-purge: <u>0</u> mV Post-purge: <u>-21</u> mV