



Chevron

571
: 10

May 11, 1993

Chevron U.S.A. Products Company
2410 Camino Ramon
San Ramon, CA 94583

Marketing Department
Phone 510 842 9500

Ms. Jennifer Eberle
Alameda County Health Care Services
Department of Environmental Health
80 Swan Way, Room 200
Oakland, CA 94621

3628

**Re: Chevron Service Station #9-0121
3026 Lakeshore Avenue, Oakland, CA**

Dear Ms. Eberle:

Enclosed is the **Groundwater Monitoring and Sampling Report** dated April 20, 1993, prepared by our consultant Groundwater Technology Inc. for the above referenced site. As indicated in the report, ground water samples collected were analyzed for total petroleum hydrocarbons as gasoline, total petroleum hydrocarbons as diesel, and BTEX. **Benzene** was detected only in monitor wells MW-1, MW-3, and MW-4 at concentrations of **1100 ppb, 270 ppb, and 160 ppb**, respectively. Depth to ground water was measured at approximately 2.5 feet to 9.7 feet below grade and the **direction of flow is to the west**.

As communicated in a telephone message to you on May 6, 1993, **Chevron will pursue a remedial approach involving alternative points of compliance along the guidelines of the amended Basin Plan of the Regional Water Quality Control Board - San Francisco Bay Region**. Briefly, alternative points of compliance at this site is anticipated to involve continued sampling of ground water monitor wells to assure that dissolved hydrocarbons are not migrating in ground water. I understand this is a relatively new concept and I would like to set up a time to discuss a realistic time frame for submittal of a formal proposal. I will contact you by phone within the next week to discuss possible meeting times and locations. Currently, Chevron's consultant is reviewing the site history to begin formulation of an appropriate work plan.

Chevron will continue to monitor and sample all wells at this site and report findings on a quarterly basis.

If you have any questions or comments, please do not hesitate to contact me at (510) 842-8134.

Very truly yours,
CHEVRON U.S.A. PRODUCTS COMPANY

Mark A. Miller
Site Assessment and Remediation Engineer

Enclosure

cc: Mr. Rich Hiatt, RWQCB - Bay Area
Mr. S.A. Willer
File (9-0121 QM3)

APR 22 '93 J.M.M.

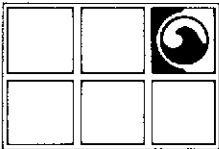

GROUNDWATER TECHNOLOGY, INC.

4057 Port Chicago Highway, Concord, CA 94520 (415) 671-2387

FAX: (415) 685-9148

April 20, 1993

Project No. 020302090

Mr. Mark Miller
Chevron U.S.A. Products Company
PO Box 5004
San Ramon, CA 94583-0804

SUBJECT: Groundwater Monitoring and Sampling Report
Chevron Service Station No. 9-0121
3026 Lakeshore Avenue, Oakland, California

Dear Mr Miller:

Groundwater Technology, Inc. presents the attached quarterly groundwater monitoring and sampling data collected on **March 25, 1993**. Seven of the eight monitoring wells at this site were gauged to measure depth to groundwater (DTW) and to check for separate-phase hydrocarbons. ~~A separate-phase hydrocarbon sheen was detected in monitoring well MW-2.~~ A potentiometric surface (Figure 1) and a summary of groundwater monitoring data (Table 1) are presented in Attachments 1 and 2, respectively. After the DTW was measured, each monitoring well was purged and sampled except well MW-8. ~~Monitoring well MW-8 was not sampled because a vehicle was parked over the well.~~ The groundwater samples were analyzed for benzene, toluene, ethylbenzene, and xylenes; total petroleum hydrocarbons-as-gasoline (TPH-G), and total petroleum hydrocarbons-as-diesel fuel. Results of the chemical analyses are summarized in Table 1. The laboratory report and chain-of-custody record are included in Attachment 3. Figures 2 and 3 present TPH-G and benzene concentration maps of samples collected on March 25, 1993. Monitoring well purge water was removed by Groundwater Technology and transported to the Chevron terminal in Richmond, California for recycling.

Groundwater Technology is pleased to assist Chevron on this project. If you have any questions or comments, please call our Concord office at (510) 671-2387.

Sincerely,
Groundwater Technology, Inc.
Written/Submitted by

Groundwater Technology, Inc.
Reviewed/Approved by



Tim Watchers
Project Geologist



David R. Kleesattel
Registered Geologist
No. 5136

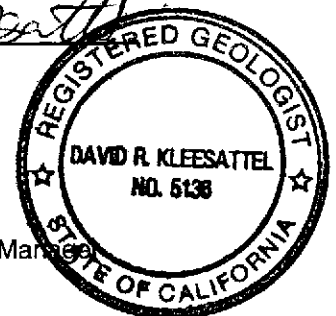

Attachment 1 Figure
Attachment 2 Table
Attachment 3 Laboratory Report

For:
John S. Gaines
Vice President, General Manager
West Region

LR2090A3.NM

ATTACHMENT 1

FIGURE

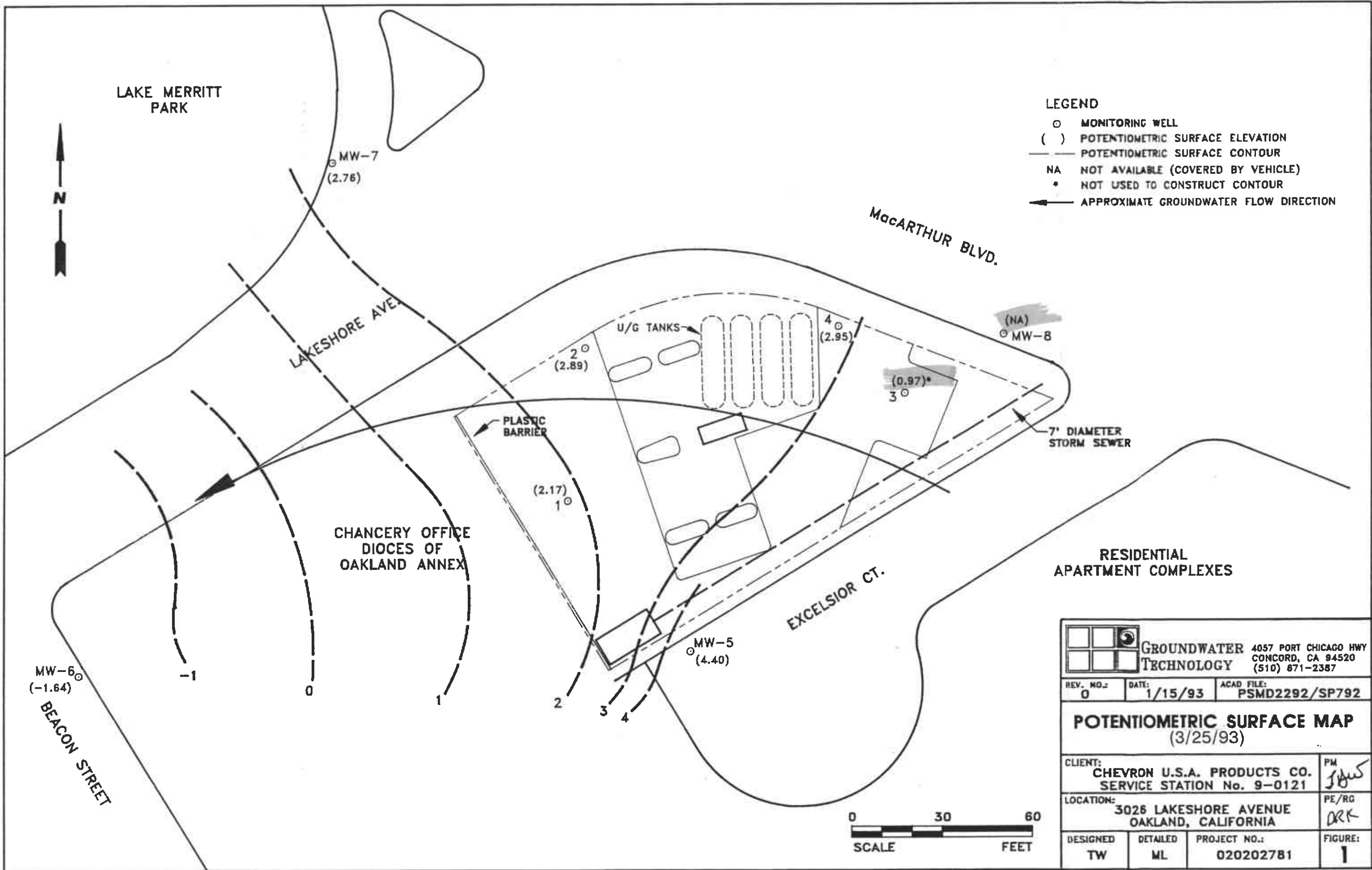

LAKE MERRITT
PARK



MW-7
(<50)

LEGEND

- MONITORING WELL
- () TPH-G CONCENTRATION (ppb)
- TPH-G CONCENTRATION CONTOUR
- NA NOT AVAILABLE
- MISC. PEAK NOT INCLUDED IN GASOLINE TOTAL
- (SHEEN) PRODUCT SHEEN IN MONITORING WELL (NOT SAMPLED)

MacARTHUR BLVD.

LAKESHORE AVE.

U/G TANKS

2 ○ (SHEEN)

4 ○ (520)*

(NA)
○ MW-8

(760)
3 ○

PLASTIC BARRIER

7" DIAMETER
STORM SEWER

10,000

(530)*
1 ○

1,000

100

CHANDERY OFFICE
DIOCES OF
OAKLAND ANNEX

<50

EXCELSIOR CT.

RESIDENTIAL
APARTMENT COMPLEXES

MW-5
(<50)

MW-6 ○
(<50)

BEACON STREET

		GROUNDWATER TECHNOLOGY 4037 PORT CHICAGO HWY CONCORD, CA 94520 (510) 871-2387	
REV. NO.:	DATE:	ACAD FILE:	
1	4/15/93	CONC394	
TPH-G CONCENTRATION MAP (3/25/93)			
CLIENT: CHEVRON U.S.A. PRODUCTS CO. SERVICE STATION No. 9-0121			PM <i>JAW</i>
LOCATION: 3026 LAKESHORE AVENUE OAKLAND, CALIFORNIA			PE/RG DKK
DESIGNED	DETAILED	PROJECT NO.:	FIGURE:
TW	CY	020202781	2

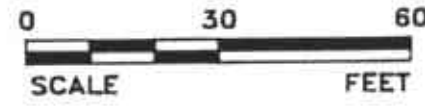

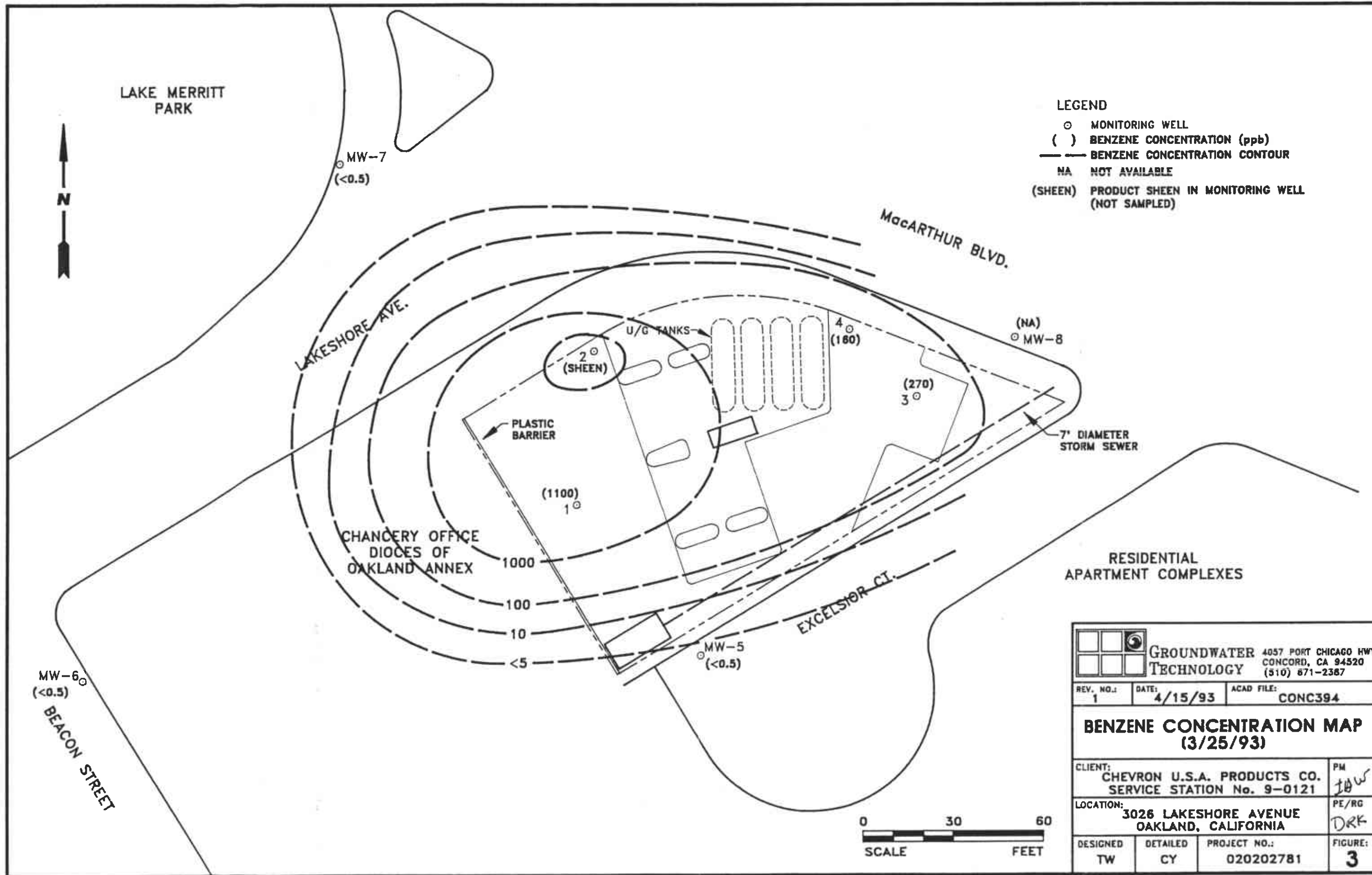

LEGEND

- MONITORING WELL
- () BENZENE CONCENTRATION (ppb)
- BENZENE CONCENTRATION CONTOUR
- NA NOT AVAILABLE
- (SHEEN) PRODUCT SHEEN IN MONITORING WELL (NOT SAMPLED)

		4057 PORT CHICAGO HWY CONCORD, CA 94520 (510) 871-2367	
REV. NO.:	DATE:	ACAD FILE:	
1	4/15/93	CONC394	
BENZENE CONCENTRATION MAP (3/25/93)			
CLIENT: CHEVRON U.S.A. PRODUCTS CO. SERVICE STATION No. 9-0121			PM <i>JW</i>
LOCATION: 3026 LAKESHORE AVENUE OAKLAND, CALIFORNIA			PE/RG DRK
DESIGNED	DETAILED	PROJECT NO.:	FIGURE:
TW	CY	020202781	3

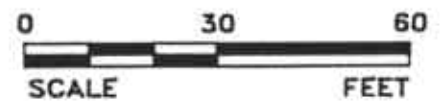

ATTACHMENT 2

TABLE

TABLE 1
HISTORICAL GROUNDWATER ANALYTICAL RESULTS AND MONITORING DATA
(Results in parts per billion)

Well No.	Casing Elev.	Date	TPH as-Gasoline	Benzene	Toluene	Ethyl-benzene	Xylene	TPH as-Diesel	DTW (ft)	SPT (ft)	GWE (ft)
MW-1		08/20/91	5,100	1,700	21	220	34	260	5.20	0.00	1.62
	6.82	09/30/91	Separate-phase hydrocarbons present						5.67	Sheen	1.15
		10/28/91							5.30	0.03	1.50
	6.89	01/08/92	5,400	770	13	95	31	---	5.15	Sheen	1.67
		01/13/92	---	---	---	---	---	*4,400	---	---	---
		06/23/92	7,700	1,500	40	230	100	*2,000	5.41	0.00	1.48
		08/24/92	---	---	---	---	---	---	5.77	0.00	1.12
		09/21/92	3,500	1,700	28	190	78	<50	5.89	0.00	1.00
		10/26/92	---	---	---	---	---	---	5.94	0.00	.95
		12/23/92	60,000	7,100	240	2,000	1,300	*5,500	4.71	0.00	2.18
01/08/93		---	---	---	---	---	---	---	---	---	
03/25/93	***530	1,100	41	67	79	<10	4.72	0.00	2.17		
MW-2	6.27	08/20/91	9,300	3,700	55	530	75	600	4.35	0.00	1.92
		09/30/91	3,500	2,600	47	440	68	---	4.99	0.00	1.28
		10/28/91	4,600	1,800	29	290	53	---	4.91	0.00	1.36
		01/08/92	14,000	4,300	70	<25	130	---	4.64	Sheen	1.63
		01/13/92	---	---	---	---	---	*38,000	---	---	---
		06/23/92	---	---	---	---	---	---	4.64	0.02	1.63
		08/24/92	Separate-phase hydrocarbons present						4.94	0.02	1.34
		09/21/92							5.08	0.01	1.20
		10/26/92	---	---	---	---	---	---	5.93	0.00	.34
		12/23/92	21,000	5,400	59	1,300	160	160,000	---	---	---
	01/08/93	---	---	---	---	---	---	3.70	0.00	2.57	
	03/25/93	---	---	---	---	---	---	3.38	Sheen	2.89	
MW-3	8.71	08/20/91	3,100	200	13	15	12	200	8.45	0.00	0.26
		09/30/91	1,000	150	8.3	13	6.7	---	8.74	0.00	-0.03
		10/28/91	1,200	120	6.7	11	7.5	---	8.76	0.00	-0.05
		01/08/92	410	120	0.9	4.1	3.4	---	8.77	0.00	-0.06
		01/13/92	---	---	---	---	---	*220	---	---	---
		06/23/92	630	43	0.8	8.2	3.4	<50	8.68	0.00	0.03
		08/24/92	---	---	---	---	---	---	8.85	0.00	-0.14
		09/21/92	1,800	730	1.4	66	39	<50	8.94	0.00	-0.23
		10/26/92	---	---	---	---	---	---	9.07	0.00	-0.36
		12/23/92	840	270	3.4	15	4.2	*850	---	---	---
01/08/93	---	---	---	---	---	---	7.69	0.00	1.02		
03/25/93	760	270	4	10	5	<10	7.74	0.00	0.97		
MW-4	7.37	08/20/91	1,800	870	4	3	9	160	5.05	0.00	1.32
		09/30/91	670	830	5.5	2.7	12	---	5.67	0.00	1.70
		10/28/91	2,800	990	5.8	4.8	19	---	5.81	0.00	1.56
		01/08/92	2,900	1,200	10	7	18	---	5.34	0.00	2.03
		01/13/92	---	---	---	---	---	*1,000	---	---	---
		06/23/92	1,600	380	6.5	3	12	<50	5.37	0.00	2.00
		08/24/92	---	---	---	---	---	---	5.75	0.00	1.62
		09/21/92	1,200	480	5.6	3.7	11	<50	5.95	0.00	1.42
		10/26/92	---	---	---	---	---	---	5.96	0.00	1.41
		12/23/92	1,500	700	3.6	3.2	11	*1,800	---	---	---
01/08/93	---	---	---	---	---	---	4.64	0.00	2.73		
03/25/93	***520	160	3	1	4	<10	4.42	0.00	2.95		

TABLE 1
HISTORICAL GROUNDWATER ANALYTICAL RESULTS AND MONITORING DATA
 (Results in parts per billion)

Well No.	Casing Elev.	Date	TPH-as-Gasoline	Benzene	Toluene	Ethylbenzene	Xylene	TPH-as-Diesel	DTW (ft)	SPT (ft)	GWE (ft)
MW-5	14.14	06/23/92	<50	<0.5	<0.5	<0.5	<0.5	<50	12.24	0.00	1.90
		08/24/92	---	---	---	---	---	---	12.29	0.00	1.85
		09/21/92	<50	<0.5	<0.5	<0.5	<0.5	*60	12.46	0.00	1.68
		10/26/92	---	---	---	---	---	---	12.52	0.00	1.62
		12/23/92	---	---	---	---	---	---	11.12	0.00	3.02
		01/08/93	---	---	---	---	---	---	---	---	---
		03/25/93	<50	<0.5	<0.5	<0.5	0.9	<10	9.74	0.00	4.40
MW-6	4.46	06/23/92	<50	4.3	<0.5	0.8	0.9	120	5.14	0.00	-0.68
		08/24/92	---	---	---	---	---	---	4.95	0.00	-0.49
		09/21/92	<250	<2.5	<2.5	<2.5	<2.5	<50	4.90	0.00	-0.44
		10/26/92	---	---	---	---	---	---	5.52	0.00	-1.06
		12/23/92	<50	<0.5	<0.5	<0.5	<0.5	81	5.40	0.00	-0.94
		01/08/93	---	---	---	---	---	---	---	---	---
		03/25/93	<50	<0.5	<0.5	<0.5	0.7	<10	6.10	0.00	-1.64
MW-7	5.26	06/23/92	<50	4.7	<0.5	<0.5	<0.5	<50	4.38	0.00	0.88
		08/24/92	---	---	---	---	---	---	5.55	0.00	-0.29
		09/21/92	<50	<0.5	<0.5	<0.5	<0.5	<50	5.65	0.00	-0.39
		10/26/92	---	---	---	---	---	---	5.51	0.00	-0.25
		12/23/92	<50	2.9	<0.5	<0.5	<0.5	60	3.95	0.00	1.31
		01/08/93	---	---	---	---	---	---	---	---	---
		03/25/93	<50	<0.5	<0.5	<0.5	<0.5	<10	2.50	0.00	2.76
MW-8	8.94	06/23/92	<50	<0.5	<0.5	<0.5	<0.5	<50	24.14	0.00	-15.20
		08/24/92	---	---	---	---	---	---	8.60	0.00	0.34
		09/21/92	**94	<0.5	<0.5	<0.5	<0.5	<50	8.39	0.00	0.55
		10/26/92	---	---	---	---	---	---	9.12	0.00	-0.18
		12/23/92	<50	0.7	5.0	0.7	2.9	79	8.11	0.00	0.83
		01/08/93	---	---	---	---	---	---	---	---	---
		03/25/93	---	---	---	---	---	---	---	---	---
Trip Blank		08/24/92	---	---	---	---	---	---	---	---	---
		09/21/92	<50	<0.5	<0.5	<0.5	<0.5	---	---	---	---
		10/26/92	---	---	---	---	---	---	---	---	---
		12/23/92	<50	<0.5	<0.5	<0.5	<0.5	---	---	---	---
		01/08/93	---	---	---	---	---	---	---	---	---
03/25/93	<50	<0.5	<0.5	<0.5	<0.5	<0.5	---	---	---	---	

- DTW = Depth to groundwater
 GWE = Groundwater elevation in feet above mean sea level
 SPT = Separate-phase hydrocarbon thickness
 * = Diesel fuel range concentration reported. The laboratory reported that the majority of peaks were observed in the gasoline range of the chromatogram, or that the pattern observed in the chromatogram was not typical of diesel fuel.
 ** = Gasoline range concentration reported. A nonstandard gasoline pattern was observed in the chromatogram.
 *** = Miscellaneous peak not included in gasoline total.
 --- = Not applicable, not analyzed, not measured

ATTACHMENT 3
LABORATORY ANALYTICAL REPORT

LR2090A3.NM



GTEL

ENVIRONMENTAL
LABORATORIES, INC.

Northwest Region

4080-C Pike Lane
Concord, CA 94520
(510) 685-7852
(800) 544-3422 from inside California
(800) 423-7143 from outside California
(510) 825-0720 (FAX)

Client Number: 020302090
Consultant Project Number: 020302090.061004
Project ID: Chevron, 3026 Lakeshore Ave.
Work Order Number: C3-03-0432

April 8, 1993

Sandra Lindsey
Groundwater Technology, Inc.
4057 Port Chicago Hwy.
Concord, CA 94520

Enclosed please find the analytical results for samples received by GTEL Environmental Laboratories, Inc. on 03/25/93.

A formal Quality Assurance/Quality Control (QA/QC) program is maintained by GTEL, which is designed to meet or exceed the EPA requirements. Analytical work for this project met QA/QC criteria, unless otherwise stated in the footnotes.

GTEL is certified by the California State Department of Health Services, Laboratory certificate numbers 194 and 1075, to perform analyses for drinking water, wastewater, and hazardous waste materials according to EPA protocols.

If you have any questions concerning this analysis or if we can be of further assistance, please call our Customer Service Representative.

Sincerely,
GTEL Environmental Laboratories, Inc.

Eileen F. Bullen
Laboratory Director

Client Number: 020302090
 Consultant Project Number: 020302090.061004
 Project ID: Chevron, 3026 Lakeshore Ave.
 Work Order Number: C3-03-0432

ANALYTICAL RESULTS

TPH as Diesel in Water

Method: Modified EPA 8015a

GTEL Sample Number		03	05	07	09
Client Identification		MW5	MW7	MW6	MW3
Date Sampled		03/25/93	03/25/93	03/25/93	03/25/93
Date Analyzed		04/01/93	04/01/93	04/01/93	04/01/93
Analyte	Detection Limit, ug/L	Concentration, ug/L			
TPH as diesel	10	<10	<10	<10	<10
Detection Limit Multiplier		1	1	1	1
OTP surrogate, % recovery		135	108	90	93

- a. O-Terphenyl surrogate recovery acceptability limits of 50-150% are derived from the 99% confidence interval of all samples during the previous quarter. Expected surrogate value is 10 ug/L.

Client Number: 020302090
 Consultant Project Number: 020302090.061004
 Project ID: Chevron, 3026 Lakeshore Ave.
 Work Order Number: C3-03-0432

ANALYTICAL RESULTS

TPH as Diesel in Water

Method: Modified EPA 8015^a

GTEL Sample Number		11	13	GC-1	
Client Identification		MW-4	MW-1	METHOD BLANK	
Date Sampled		03/25/93	03/25/93	--	
Date Analyzed		04/01/93	04/01/93	04/01/93	
Analyte	Detection Limit, ug/L	Concentration, ug/L			
TPH as diesel	10	<10	<10	<10	
Detection Limit Multiplier		1	1	1	
OTP surrogate, % recovery		108	92	103	

- a. O-Terphenyl surrogate recovery acceptability limits of 50-150% are derived from the 99% confidence interval of all samples during the previous quarter. Expected surrogate value is 10 ug/L.

Client Number: 020302090
 Consultant Project Number: 020302090.061004
 Project ID: Chevron, 3026 Lakeshore Ave.
 Work Order Number: C3-03-0432

QC Matrix Spike and Duplicate Spike Results

Matrix: Water

Analyte	Sample ID	Spike Amount	Units	Recovery, %	Duplicate Recovery, %	RPD, %	Control Limits
Modified EPA 8020:							
Benzene	C3030422-04	20.0	ug/L	110	114	3.05	55 - 129
Toluene	C3030422-04	20.0	ug/L	96.0	98.5	2.15	72 - 149
Ethylbenzene	C3030422-04	20.0	ug/L	103	106	2.95	75 - 138
Xylene, total	C3030422-04	60.0	ug/L	113	116	1.43	74 - 147
GC-FID:							
Diesel	DI Water Spike	1081	ug/L	108	117	8.0	63 - 127

Client Number: 020302090
 Consultant Project Number: 020302090.061004
 Project ID: Chevron, 3026 Lakeshore Ave.
 Work Order Number: C3-03-0432

Table 1

ANALYTICAL RESULTS

**Aromatic Volatile Organics and
 Total Petroleum Hydrocarbons as Gasoline in Water**

EPA Methods 5030, 8020, and Modified 8015^a

GTEL Sample Number		01	02	03	05
Client Identification		TB-LB	RBMW5	MW5	MW7
Date Sampled		03/25/93	03/25/93	03/25/93	03/25/93
Date Analyzed		04/01/93	04/01/93	04/02/93	04/01/93
Analyte	Detection Limit, ug/L	Concentration, ug/L			
Benzene	0.5	<0.5	<0.5	<0.5	<0.5
Toluene	0.5	<0.5	<0.5	<0.5	<0.5
Ethylbenzene	0.5	<0.5	<0.5	<0.5	<0.5
Xylene, total	0.5	<0.5	<0.5	0.9	<0.5
BTEX, total	--	--	--	--	--
TPH as Gasoline	50	<50	<50	<50	<50
Detection Limit Multiplier		1	1	1	1
BFB surrogate, % recovery		91.4	75.4	116	86.6

a. Test Methods for Evaluating Solid Waste, SW-846, Third Edition, Revision 0, US EPA November 1986. Modification for TPH as gasoline as per California State Water Resources Control Board LUFT Manual protocols, May 1988 revision.

Client Number: 020302090
 Consultant Project Number: 020302090.061004
 Project ID: Chevron, 3026 Lakeshore Ave.
 Work Order Number: C3-03-0432

Table 1 (Continued)
ANALYTICAL RESULTS

**Aromatic Volatile Organics and
 Total Petroleum Hydrocarbons as Gasoline in Water**
 EPA Methods 5030, 8020, and Modified 8015^a

GTEL Sample Number		07	09	11	13
Client Identification		MW6	MW3	MW4	MW1
Date Sampled		03/25/93	03/25/93	03/25/93	03/25/93
Date Analyzed		04/02/93	04/05/93	04/02/93	04/01/93
Analyte	Detection Limit, ug/L	Concentration, ug/L			
Benzene	0.5	<0.5	270	160	1100
Toluene	0.5	<0.5	4	3	41
Ethylbenzene	0.5	<0.5	10	1	67
Xylene, total	0.5	0.7	5	4	79
BTEX, total	-	0.7	290	170	1300
TPH as Gasoline	50	<50	760	520*	530*
Detection Limit Multiplier		1	1	1	1
BFB surrogate, % recovery		110	113	120	105

- a. Test Methods for Evaluating Solid Waste, SW-846, Third Edition, Revision 0, US EPA November 1986. Modification for TPH as gasoline as per California State Water Resources Control Board LUFT Manual protocols, May 1988 revision.
 * Miscellaneous peak not included in gasoline total.

Client Number: 020302090
 Consultant Project Number: 020302090.061004
 Project ID: Chevron, 3026 Lakeshore Ave.
 Work Order Number: C3-03-0432

Table 1 (Continued)

ANALYTICAL RESULTS

**Aromatic Volatile Organics and
 Total Petroleum Hydrocarbons as Gasoline in Water**

EPA Methods 5030, 8020, and Modified 8015^a

GTEL Sample Number		040193 BTEX-1			
Client Identification		METHOD BLANK			
Date Sampled		--			
Date Analyzed		04/01/93			
Analyte	Detection Limit, ug/L	Concentration, ug/L			
Benzene	0.5	<0.5			
Toluene	0.5	<0.5			
Ethylbenzene	0.5	<0.5			
Xylene, total	0.5	<0.5			
BTEX, total	--	--			
TPH as Gasoline	50	<50			
Detection Limit Multiplier		1			
BFB surrogate, % recovery		108			

a. Test Methods for Evaluating Solid Waste, SW-846, Third Edition, Revision 0, US EPA November 1986. Modification for TPH as gasoline as per California State Water Resources Control Board LUFT Manual protocols, May 1988 revision.

of Lab Report and COC to Chevron Contact: No

Chain-of-Custody-Record

Chevron U.S.A. Inc.
P.O. BOX 5004
San Ramon, CA 94583
FAX (415)842-9591

Chevron Facility Number 9-0121
 Facility Address 3026 Lakeshore Avenue
 Consultant Project Number 020302090.061004
 Consultant Name Groundwater Technology, Inc.
 Address 4057 Port Chicago Hwy, Concord, CA
 Project Contact (Name) Ms, Sandra L. Lindsey
 (Phone) 671-2387 (Fax Number) 685-9148

Chevron Contact (Name) Mr. Mark Miller
 (Phone) 510-842-8134
 Laboratory Name Superior Analytical GTEL
 Laboratory Release Number 440-3170 876-6900
 Sample Collected by (Name) Hector MBE
 Collection Date 3/25/93
 Signature [Signature]

Sample Number	Lab Sample Number	Number of Containers	Matrix S = Soil A = Air W = Water C = Chevron	Type G = Grab C = Composite D = Discrete	Time	Sample Preservative	Lead (Yes or No)	Analyses To Be Performed										Remarks					
								BTEX + TPH GAS (8020 + 8015)	TPH Diesel (8015)	Oil and Grease (8520)	Purgeable Hydrocarbons (8010)	Purgeable Aromatics (8020)	Purgeable Organics (8240)	Extractable Organics (8270)	Metals Cd, Cr, Pb, Zn, Hg (324P or AA)								
TB-LB	1	1	W	G		HCY	Y		X														
RBMW5	2	1			2:00	NONE	Y		X														
MW5	3	3			2:00				X														
MW5	4	1			2:00				X														
RBMW7	5	1			2:10				X														
MW7	6	3			2:10				X														
MW7	7	1			2:10				X														
RBMW6	8	1			2:20				X														
MW6	9	4			2:20				X														
RBMW3	10	1			2:30				X														
MW3	11	4			2:30				X														
RBMW4	12	1			2:40				X														
MW4	13	4			2:40				X														
RBMW1	14	1			2:50				X														

Seal intact
7.6°C
Remarks

Relinquished By (Signature)	Organization	Date/Time	Received By (Signature)	Organization	Date/Time	Turn Around Time (Circle Choice)
			Received By (Signature)	Organization	Date/Time	
			Received For Laboratory By (Signature)	Organization	Date/Time	

Relinquished By (Signature) [Signature]
 Organization GTEL
 Date/Time 3/23/93

Received By (Signature) [Signature]
 Organization GTEL
 Date/Time 3/25/93

Received For Laboratory By (Signature) Jamie Davis
 Organization GTEL
 Date/Time 3/25/93 2:45

Turn Around Time (Circle Choice):
 24 Hrs.
 48 Hrs.
 5 Days
 10 Days
 As Contracted