

Atlantic Richfield Company

Shannon Couch
Operations Project Manager

RECEIVED

11:12 am, Aug 01, 2011

Alameda County
Environmental Health

PO Box 1257
San Ramon, CA 94583
Phone: (925) 275-3804
Fax: (925) 275-3815
E-Mail: shannon.couch@bp.com

July 29, 2011

Re: Second Quarter 2011 Monitoring Report
Former BP Service Station #11104
1716 Webster Street
Alameda, California
ACEH Case #RO0000281

"I declare, that to the best of my knowledge at the present time, that the information and/or recommendations contained in the attached document are true and correct.

Submitted by,



Shannon Couch
Operations Project Manager

Attachment

July 29, 2011

Project No. 06-88-644

Atlantic Richfield Company
P.O. Box 1257
San Ramon, CA 94583
Submitted via ENFOS

Attn.: Ms. Shannon Couch

Re: Second Quarter 2011 Status Report, Former Atlantic Richfield Company Station #11104,
1716 Webster Street, Alameda, Alameda County, California; ACEH Case #RO0000281

Dear Ms. Couch:

Attached is the *Second Quarter 2011 Status Report* for Former Atlantic Richfield Company Station #11104 located at 1716 Webster Street, Alameda, Alameda County, California (Site). This report presents a summary of current developments at the Site through the Second Quarter of 2011. Should you have questions regarding the work performed or results obtained, please do not hesitate to contact us at (707) 455-7290.

Sincerely,
BROADBENT & ASSOCIATES, INC.



James C. Ramos, E.I.T.
Staff Engineer



Thomas A. Sparrowe, P.G. (exp. date 12/31/12)
Senior Geologist

Enclosures

cc: Mr. Paresh Khatri, Alameda County Environmental Health (submitted via ACEH ftp site)
Ms. Shelby Lathrop, ConocoPhillips, 76 Broadway, Sacramento, California 95818
Electronic copy uploaded to GeoTracker

**SECOND QUARTER 2011
STATUS REPORT
STATION #11104, ALAMEDA, CALIFORNIA**

Broadbent & Associates, Inc. (BAI) is pleased to present this *Second Quarter 2011 Status Report* on behalf of Atlantic Richfield Company (a BP affiliated company) for the former Service Station #11104 (Site) located in Alameda, Alameda County, California. Monitoring activities at the site were performed in accordance with the reporting requirements issued by the Alameda County Environmental Health (ACEH). Details of work performed, discussion of results, and recommendations are provided below.

Facility Name / Address:	<u>Former Service Station #11104 / 1716 Webster Street, Alameda, CA</u>
Client Project Manager / Title:	<u>Ms. Shannon Couch / Operations Project Manager</u>
BAI Contact:	<u>Tom Sparrowe, P.G., (707) 455-7290</u>
BAI Project No.:	<u>06-88-644</u>
Primary Regulatory Agency / ID No.:	<u>Alameda County Environmental Health (ACEH) / Case #RO0000281</u>
Current phase of project:	<u>Monitoring</u>
List of Acronyms / Abbreviations:	<u>See end of report text for list of acronyms/abbreviations used in report.</u>

WORK PERFORMED THIS QUARTER (Second Quarter 2011):

1. Submitted *First Quarter 2011 Monitoring Report* on April 29, 2011.
2. No environmental field work was completed during Second Quarter 2011.

WORK SCHEDULED FOR NEXT QUARTER (Third Quarter 2011):

1. Submit *Second Quarter 2011 Status Report* (contained herein).
2. Conduct groundwater monitoring for Third Quarter 2011.

GROUNDWATER MONITORING PLAN SUMMARY:

Groundwater level gauging:	<u>MW-1 through MW-5 and RW-1</u>	(1Q & 3Q)
Groundwater sample collection:	<u>MW-1 through MW-5 and RW-1</u>	(1Q & 3Q)
Biodegradation indicator parameter monitoring:	<u>None</u>	

QUARTERLY RESULTS SUMMARY:

LNAPL

LNAPL observed this quarter:	<u>N/A</u>	(yes/no)
LNAPL recovered this quarter:	<u>N/A</u>	(gal)
Cumulative LNAPL recovered:	<u>N/A</u>	(gal)

Groundwater Elevation and Gradient:

Depth to groundwater:	<u>N/A</u>	(ft below TOC)
Gradient direction:	<u>N/A</u>	(compass direction)
Gradient magnitude:	<u>N/A</u>	(ft/ft)
Average change in elevation:	<u>N/A</u>	(ft since last measurement)

Laboratory Analytical Data

Summary:	<u>No environmental work was conducted for Second Quarter 2011.</u>
----------	---

DISCUSSION:

No environmental field work was conducted by Broadbent & Associates at the Site during the Second Quarter of 2011. The most recent groundwater monitoring/sampling occurred during the First Quarter of 2011, the results of which are contained within the *First Quarter 2011 Monitoring Report* (BAI, 04/29/11). For immediate reference, a site location map is provided as Drawing 1 and a groundwater elevation and analytical summary map, dated February 17, 2011, is provided as Drawing 2.

LIMITATIONS:

The findings presented in this report are based upon observations of field personnel, points investigated, results of laboratory tests performed by Calscience Environmental Laboratories, Inc. (Garden Grove, California), and our understanding of ACEH requirements. Our services were performed in accordance with the generally accepted standard of practice at the time this report was written. No other warranty, expressed or implied was made. This report has been prepared for the exclusive use of the Atlantic Richfield Company. It is possible that variations in soil or groundwater conditions could exist beyond points explored in this investigation. Also, changes in site conditions could occur in the future due to variations in rainfall, temperature, regional water usage, or other factors.

ATTACHMENTS:

Drawing 1: Site Location Map, Station #11104, 1716 Webster Street, Alameda, California

Drawing 2: Groundwater Elevation Contours and Analytical Summary Map, April 28, 2011, Station #11104, 1716 Webster Street, Alameda, California

LIST OF COMMONLY USED ACCRONYMS/ABBREVIATIONS:

ACEH: Alameda County Environmental Health
BAI: Broadbent & Associates, Inc.
ft/ft: feet per foot
gal: gallons
LNAPL: Light Non-Aqueous Phase Liquid
TOC: Top of Casing

DRAWINGS

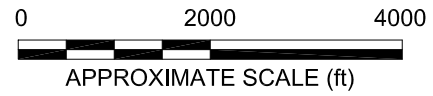
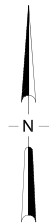
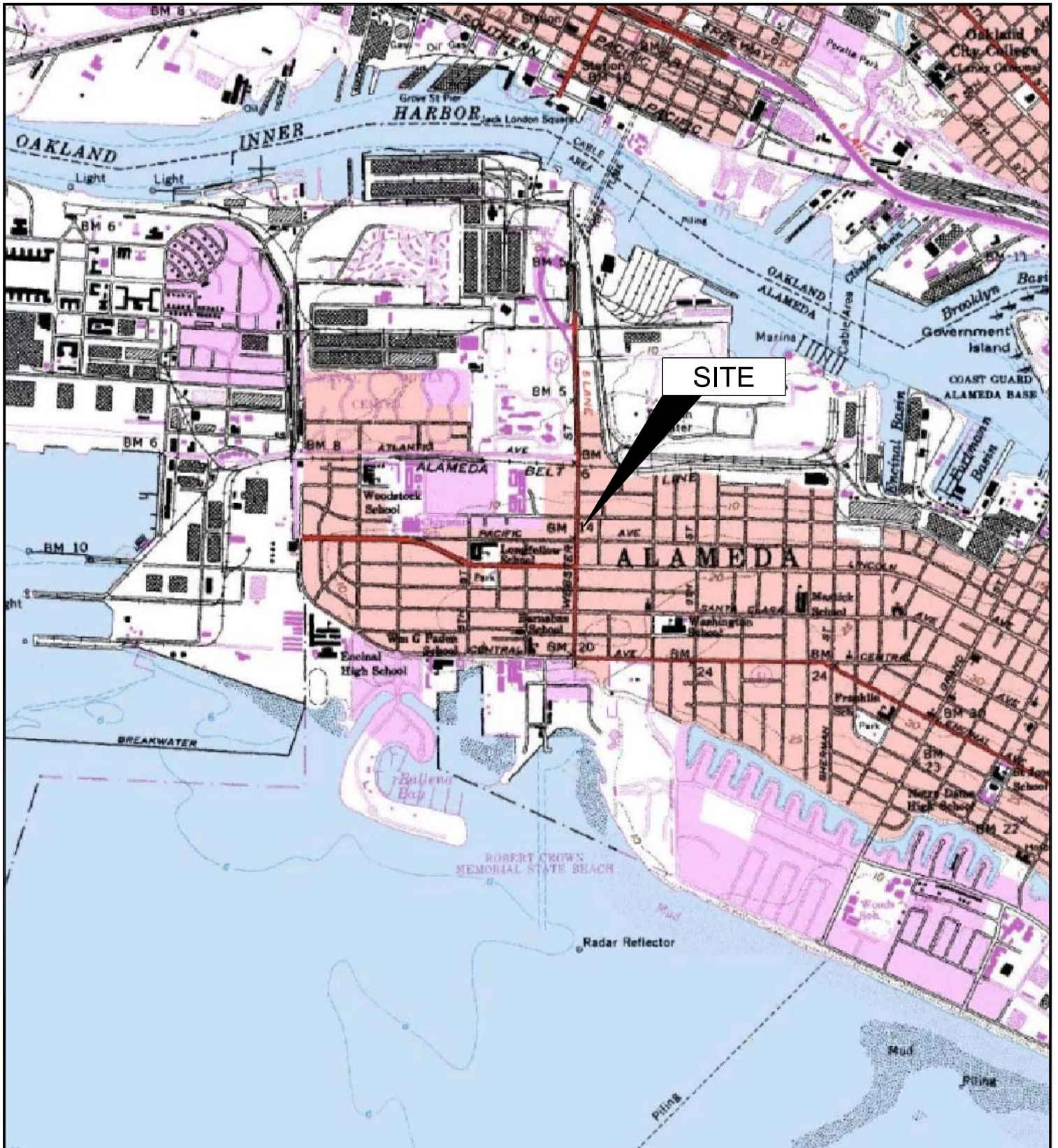

IMAGE SOURCE: USGS

BROADBENT & ASSOCIATES, INC
 ENGINEERING, WATER RESOURCES & ENVIRONMENTAL
 1324 Mangrove Ave. Suite 212, Chico, CA 95926
 Project No.: 06-88-644 Date: 9/1/09

Station #11104
 1716 Webster Street
 Alameda, California

Site Location Map

Drawing
1

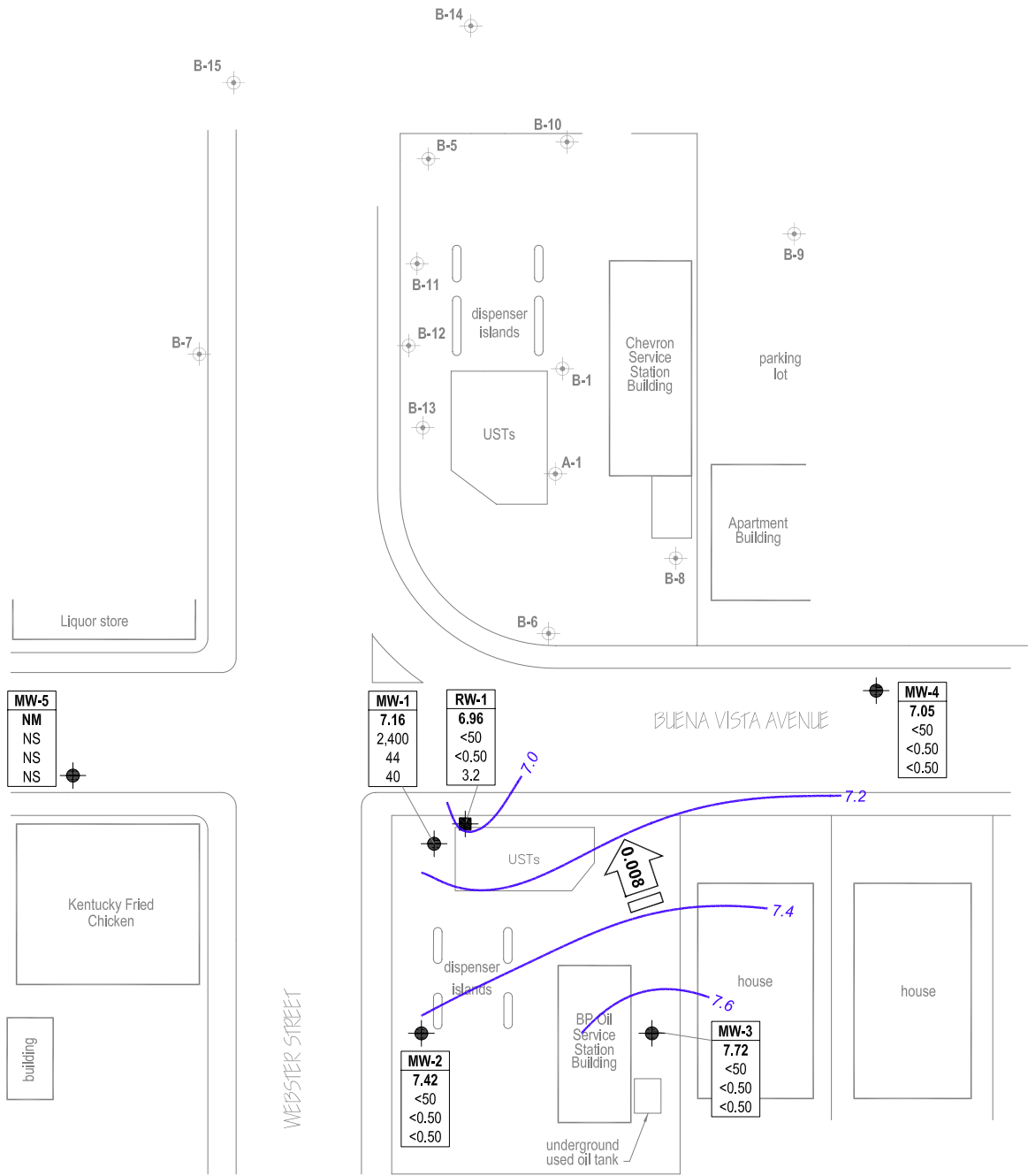

LEGEND

- Monitoring well
- Groundwater recovery well
- Chevron monitoring well
- Groundwater flow direction and gradient (ft/MSL)
- Groundwater elevation contour (Feet above site datum)

Well	Well designation
ELEV	Groundwater elevation (ft/MSL)
GRO	GRO, Benzene and MTBE concentrations in ground water (µg/L)
Benzene	
MTBE	
<	Not detected at or above laboratory reporting limits
NM/NS	Not Measured/Not sampled
NA	Not Analyzed
*	Elevation not used for contouring

NOTE: SITE MAP ADAPTED FROM CAMBRIA ENVIRONMENTAL FIGURES. SITE DIMENSIONS AND FACILITY LOCATIONS NOT VERIFIED.



BROADBENT & ASSOCIATES, INC.
 ENGINEERING, WATER RESOURCES & ENVIRONMENTAL
 1324 Mangrove Ave. Suite 212, Chico, California
 Project No.: 06-88-644 Date: 4/28/2011

Station #11104
 1716 Webster Street
 Alameda, California

Ground-Water Elevation Contour
 and Analytical Summary Map
 February 17, 2011