



Atlantic Richfield Company
(a BP affiliated company)

P.O. Box 1257
San Ramon, California 94583
Phone: (925) 275-3801
Fax: (925) 275-3815

RECEIVED

2:47 pm, Jan 25, 2008

Alameda County
Environmental Health



18 January 2008

Re: Fourth Quarter 2007 Status Report
Former BP Service Station #11104
1716 Webster Street
Alameda, California
ACEH Case #RO0000281

"I declare, that to the best of my knowledge at the present time, that the information and/or recommendations contained in the attached document are true and correct."

Submitted by:

Paul Supple
Environmental Business Manager

Broadbent & Associates, Inc.
1324 Mangrove Ave., Suite 212
Chico, CA 95926
Voice (530) 566-1400
Fax (530) 566-1401



18 January 2008

Project No. 06-08-644

Atlantic Richfield Company
P.O. Box 1257
San Ramon, California 94583
Submitted via ENFOS

Attn.: Mr. Paul Supple

Re: Fourth Quarter 2007 Status Report, Former BP Service Station #11104, 1716 Webster Street, Alameda, Alameda County, California; ACEH Case #RO0000281

Dear Mr. Supple:

Provided herein is the *Fourth Quarter 2007 Status Report* for Former BP Service Station #11104 (herein referred to as Station #11104) located at 1716 Webster Street, Alameda, California (Site). This report presents a summary of current developments at the Site through Fourth Quarter 2007.

Should you have questions regarding the work performed or results obtained, please do not hesitate to contact us at (530) 566-1400.

Sincerely,

BROADBENT & ASSOCIATES, INC.

Thomas A. Venus, P.E.
Senior Engineer

Robert H. Miller, P.G., C.HG.
Principal Hydrogeologist

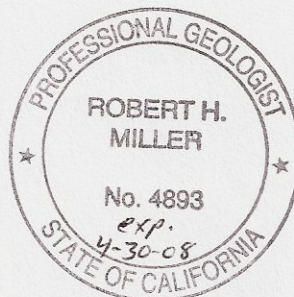

Enclosures

cc: Mr. Steven Plunkett, Alameda County Environmental Health (Submitted via ACEH ftp Site)
Ms. Shelby Lathrop, ConocoPhillips, 76 Broadway, Sacramento, California 95818
Electronic copy uploaded to GeoTracker

STATION #11104 QUARTERLY STATUS REPORT

| | |
|-------------------------------------|--|
| Facility: #11104 | Address: 1716 Webster Street, Alameda |
| Environmental Business Manager: | Mr. Paul Supple |
| Consulting Co./Contact Persons: | Broadbent & Associates, Inc.(BAI)/Rob Miller & Tom Venus (530) 566-1400 |
| Primary Agency/Regulatory ID No.: | Alameda County Environmental Health (ACEH) ACEH Case #RO0000281 |
| Consultant Project No.: | 06-08-644 |
| Facility Permits/Permitting Agency: | NA |

WORK PERFORMED THIS QUARTER (Fourth Quarter 2007):

1. Prepared and submitted Third Quarter 2007 Semi-Annual Ground-Water Monitoring Report.
2. No environmental work was conducted at the Site during the Fourth Quarter of 2007.

WORK PROPOSED FOR NEXT QUARTER (First Quarter 2008):

1. Prepared and submitted this Fourth Quarter 2007 Status Report (contained herein).
2. Conduct semi-annual ground-water monitoring/sampling for First Quarter 2008.

QUARTERLY RESULTS SUMMARY:

| | |
|---------------------------------------|--|
| Current phase of project: | Ground-Water Monitoring/Sampling |
| Frequency of ground-water monitoring: | Semi-Annually (1Q & 3Q): Wells MW-1, MW-2, MW-3, MW-4, MW-5, RW-1 |
| Frequency of ground-water sampling: | Semi-Annually (1Q & 3Q): Wells MW-1 and RW-1 Annually (3Q): Wells MW-2 through MW-5 |
| Is free product (FP) present on-site: | No |
| FP recovered this quarter: | NA |
| Current remediation techniques: | NA |
| Depth to ground water (below TOC): | NA |
| General ground-water flow direction: | NA |
| Approximate hydraulic gradient: | NA |

DISCUSSION:

No environmental activities took place at the Site during this quarter. The most recent quarterly data can be referenced in the Third Quarter 2007 Semi-Annual Ground-Water Monitoring Report for the Site. A Ground-Water Elevation Contour and Analytical Summary Map from Third Quarter 2007 is provided as Drawing 1.

ATTACHMENTS:

Drawing 1. Ground-Water Elevation Contour and Analytical Summary Map, 8 August 2007, Station #11104, 1716 Webster Street, Alameda, California

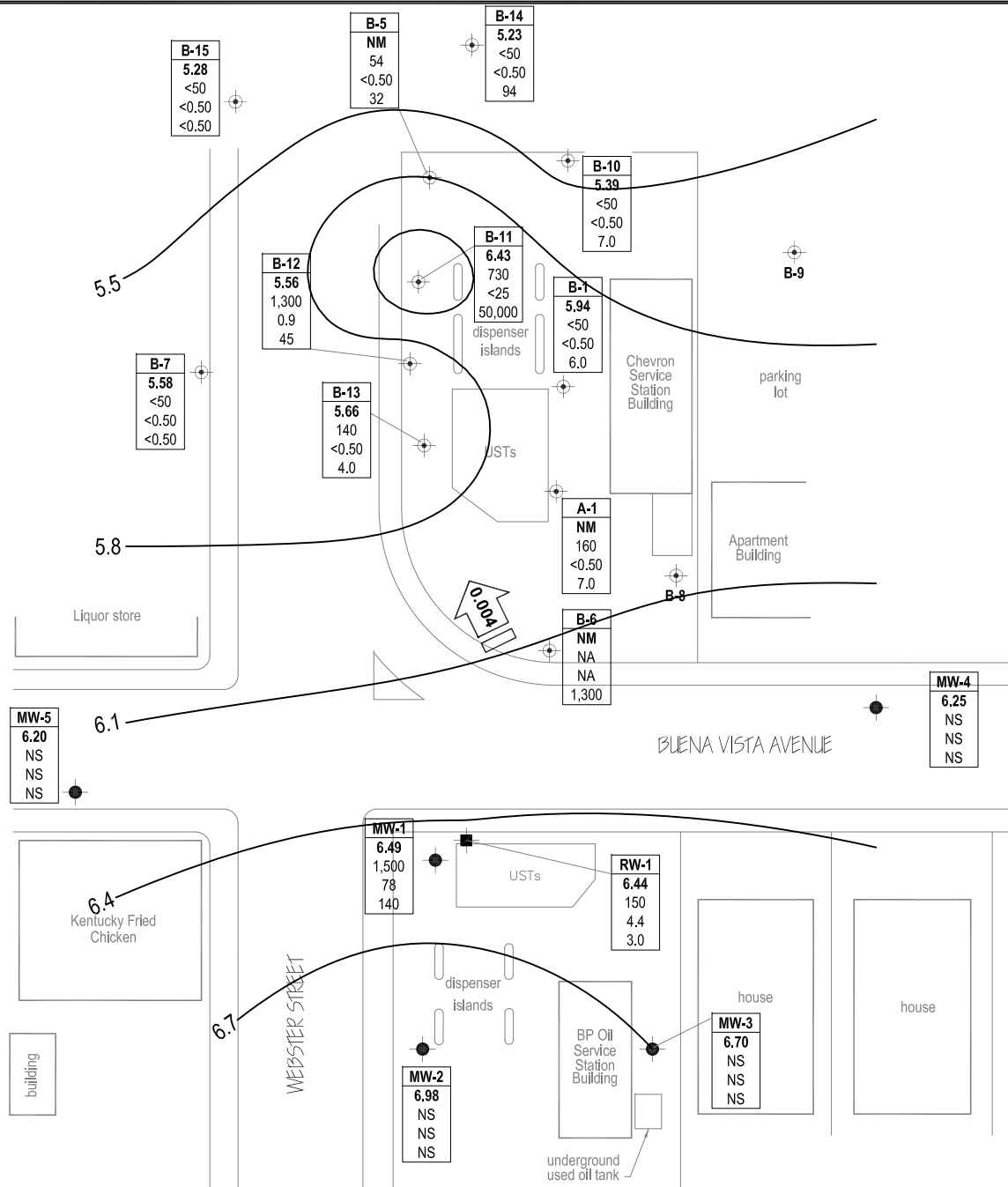

LEGEND

- Monitoring well
- Ground-water recovery well
- Chevron monitoring well
- Ground-water flow direction and gradient (ft/MSL)
- 5.8 Ground-water elevation contour (Feet above site datum)

| Well | Well designation |
|---------|---|
| ELEV | Ground-water elevation (ft/MSL) |
| GRO | GRO, Benzene and MTBE concentrations in ground water (µg/L) |
| Benzene | |
| MTBE | |
| < | Not detected at or above laboratory reporting limits |
| NM/NS | Not Measured/Not sampled |
| NA | Not Analyzed |

NOTE: SITE MAP ADAPTED FROM CAMBRIA ENVIRONMENTAL FIGURES. SITE DIMENSIONS AND FACILITY LOCATIONS NOT VERIFIED.

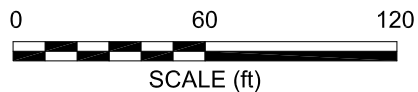

BROADBENT & ASSOCIATES, INC.
 ENGINEERING, WATER RESOURCES & ENVIRONMENTAL
 1324 Mangrove Ave. Suite 212, Chico, California
 Project No.: 06-08-644 Date: 10/17/07

Station #11104
 1716 Webster Street
 Alameda, California

Ground-Water Elevation Contour
 and Analytical Summary Map
 8 August 2007

Drawing

1