

June 29, 1992

Ms. Juliet Shin
Alameda County Department of Environmental Health
Division of Hazardous Materials
80 Swan Way, Room 358
Oakland, CA 94621

Re: BP No. 11104, 1716 Webster St., Alameda

Dear Juliet,

It was a pleasure meeting with you last week. As you requested, I have enclosed a copy of the KEI soil sampling report for the referenced site.

If you have questions concerning this report, or if you need any additional assistance, please do not hesitate to call.

Sincerely,
HYDRO-ENVIRONMENTAL TECHNOLOGIES, INC.

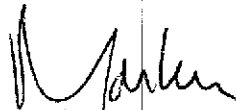

Markus Niebanck
Western Region Manager



SEQUOIA ANALYTICAL

1900 Bates Avenue • Suite LM • Concord, California 94520
 (415) 686-9600 • FAX (415) 686-9689

Kaprealian Engineering, Inc. P.O. Box 996 Benicia, CA 94510 Attention: Mardo Kaprealian, P.E.	Client Project ID: BP Station, 1716 Webster St., Alameda Matrix Descript: Soil Analysis Method: EPA 5030/8015/8020 First Sample #: 009-0378	Sampled: Sep 19, 1990 Received: Sep 20, 1990 Analyzed: Sep 20, 1990 Reported: Sep 21, 1990
--	---	---

TOTAL PETROLEUM FUEL HYDROCARBONS with BTEX DISTINCTION (EPA 8015/8020)

Sample Number	Sample Description	Low/Medium B.P. Hydrocarbons mg/kg (ppm)	Benzene mg/kg (ppm)	Toluene mg/kg (ppm)	Ethyl Benzene mg/kg (ppm)	Xylenes mg/kg (ppm)
009-0378	P1	3,500	3.9	120	55	340
009-0379	P2	4.0	N.D.	0.040	0.029	0.19
009-0380	D1	3,000	0.60	32	35	75
009-0381	D2	1,800	0.27	3.5	4.6	110
009-0382	D3	3,000	0.63	17	20	170

Detection Limits:	1.0	0.0050	0.0050	0.0050	0.0050
-------------------	-----	--------	--------	--------	--------

Low to Medium Boiling Point Hydrocarbons are quantitated against a gasoline standard.
 Analytes reported as N.D. were not present above the stated limit of detection.

SEQUOIA ANALYTICAL

Belinda C. Vega

Belinda C. Vega
 Laboratory Director



SEQUOIA ANALYTICAL

1900 Bates Avenue • Suite LM • Concord, California 94520
 (415) 686-9600 • FAX (415) 686-9689

Kapreallan Engineering, Inc. P.O. Box 996 Benicia, CA 94510 Attention: Mardo Kapreallan, P.E.	Client Project ID: BP Station, 1716 Webster St., Alameda Sample Descript: Soil Analysis for: Total Lead First Sample #: 009-0378	Sampled: Sep 19, 1990 Received: Sep 20, 1990 Extracted: Sep 20, 1990 Analyzed: Sep 20, 1990 Reported: Sep 21, 1990
--	---	--

LABORATORY ANALYSIS FOR: Total Lead

Sample Number	Sample Description	Detection Limit mg/kg	Sample Result mg/kg
009-0378	P1	0.25	7.5
009-0379	P2	0.25	4.0
009-0380	D1	0.25	4.5
009-0381	D2	0.25	30
009-0382	D3	0.25	21

Analytes reported as N.D. were not present above the stated limit of detection.

SEQUOIA ANALYTICAL

Belinda C. Vega
 Belinda C. Vega
 Laboratory Director



KAPREALIAN ENGINEERING, INC.

CHAIN OF CUSTODY

SAMPLER <i>Hand</i>		SITE NAME & ADDRESS <i>BP station - ALAMEDA</i>			ANALYSES REQUESTED			TURN AROUND TIME: <i>24 Hrs</i>
WITNESSING AGENCY		<i>1716 WEBSTER STREET</i>			<i>TPH-G</i>	<i>BTXE</i>	<i>Total Lead</i>	<i>Priority</i>

SAMPLE ID NO.	DATE	TIME	SOIL	WATER	GRAB	COMP	NO. OF CONT.	SAMPLING LOCATION	ANALYSES REQUESTED			REMARKS
									TPH-G	BTXE	Total Lead	
<i>P1</i>	<i>9/19/90</i>		<input checked="" type="checkbox"/>		<input checked="" type="checkbox"/>		<i>1</i>	<i>Pipe Trench</i>	<input checked="" type="checkbox"/>	<input checked="" type="checkbox"/>	<input checked="" type="checkbox"/>	<i>380-378 the rest 380 381 382</i>
<i>P2</i>	<i>9/19/90</i>		<input checked="" type="checkbox"/>		<input checked="" type="checkbox"/>		<i>1</i>	<i>Pipe Trench</i>	<input checked="" type="checkbox"/>	<input checked="" type="checkbox"/>	<input checked="" type="checkbox"/>	
<i>D1</i>	<i>9/19/90</i>		<input checked="" type="checkbox"/>		<input checked="" type="checkbox"/>		<i>1</i>	<i>Beneath Dispenser</i>	<input checked="" type="checkbox"/>	<input checked="" type="checkbox"/>	<input checked="" type="checkbox"/>	
<i>D2</i>	<i>9/19/90</i>		<input checked="" type="checkbox"/>		<input checked="" type="checkbox"/>		<i>1</i>	<i>Beneath Dispenser</i>	<input checked="" type="checkbox"/>	<input checked="" type="checkbox"/>	<input checked="" type="checkbox"/>	
<i>D3</i>	<i>9/19/90</i>		<input checked="" type="checkbox"/>		<input checked="" type="checkbox"/>		<i>1</i>	<i>Beneath Dispenser</i>	<input checked="" type="checkbox"/>	<input checked="" type="checkbox"/>	<input checked="" type="checkbox"/>	

Relinquished by: (Signature) <i>Maggie Kewell</i>	Date/Time <i>9-20-90 8:30</i>	Received by: (Signature) <i>[Signature]</i>
Relinquished by: (Signature)	Date/Time	Received by: (Signature)
Relinquished by: (Signature)	Date/Time	Received by: (Signature)
Relinquished by: (Signature)	Date/Time	Received by: (Signature)

The following MUST BE completed by the laboratory accepting samples for analysis:

- Have all samples received for analysis been stored in ice?
- Will samples remain refrigerated until analyzed?
- Did any samples received for analysis have head space? *NO*
- Were samples in appropriate containers and properly packaged?

Signature: *[Signature]* Title: *[Signature]* Date: *9/20*

SEQUOIA ANALYTICAL 6869689

Col A

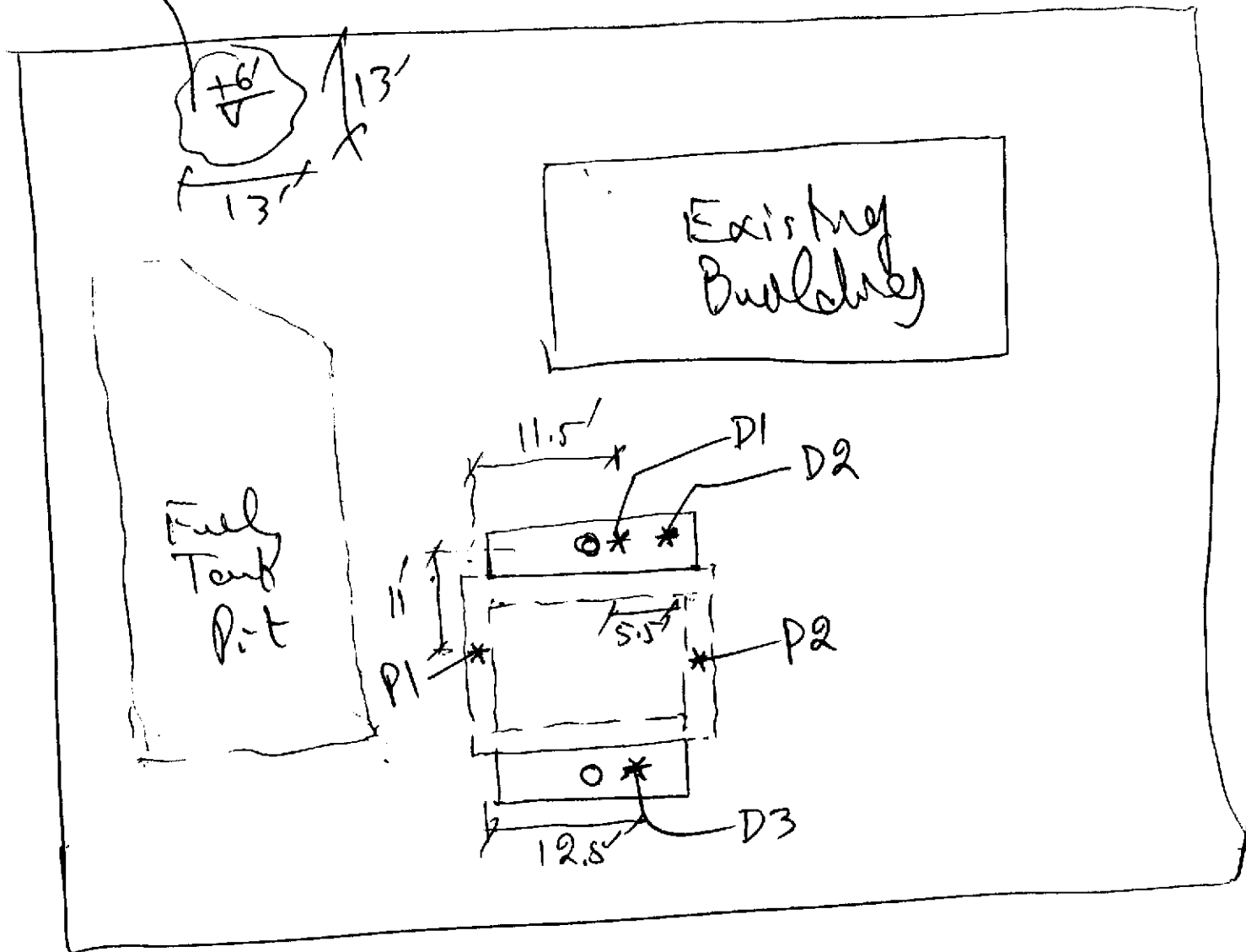



KAPREALIAN ENGINEERING, INC.

CHAIN OF CUSTODY

SAMPLER Haig		SITE NAME & ADDRESS BP Station - ALAMEDA							ANALYSES REQUESTED			TURN AROUND TIME: 24 Hrs	
WITNESSING AGENCY		1716 WEBSTER STREET							TPH-G	BTXE	Total lead		
SAMPLE ID NO.	DATE	TIME	SOIL	WATER	GRAB	COMP	NO. OF CONT.	SAMPLING LOCATION	TPH-G	BTXE	Total lead	REMARKS	
1. B1	9/26		✓		✓		1	Pipe Trench (Bottom)	✓	✓	✓	Please Fax the results	
2. B1 (8.5)	9/26		✓		✓			✓	✓	✓			
3. B2	9/26		✓		✓			✓	✓	✓			
4. B3	9/26		✓		✓			✓	✓	✓			
5. B4	9/26		✓		✓			✓	✓	✓			
6. B5	9/26		✓		✓			✓	✓	✓			
7. B6	9/26		✓		✓			✓	✓	✓			
Relinquished by: (Signature) Haig		Date/Time 9/27/90 8:25		Received by: (Signature) Tim M. Lee		The following MUST BE completed by the laboratory accepting samples for analysis: 1. Have all samples received for analysis been stored in ice? <u>Yes</u> 2. Will samples remain refrigerated until analyzed? <u>Yes</u> 3. Did any samples received for analysis have head space? <u>No</u> 4. Were samples in appropriate containers and properly packaged? <u>Yes</u>							
Relinquished by: (Signature) Tim M. Lee		Date/Time 9/27/90		Received by: (Signature) B.D.V.									
Relinquished by: (Signature)		Date/Time		Received by: (Signature)									
Relinquished by: (Signature)		Date/Time		Received by: (Signature)									
						Signature B.D.V.		Title Lab Director		Date 9/27/90			



SEQUOIA ANALYTICAL

1900 Bates Avenue • Suite LM • Concord, California 94520
 (415) 686-9600 • FAX (415) 686-9689

Kapreallan Engineering, Inc.	Client Project ID:	BP Station, 1716 Webster St., Alameda	Sampled:	Sep 26, 1990
P.O. Box 996	Sample Descript:	Soil	Received:	Sep 27, 1990
Benicia, CA 94510	Analysis for:	Total Lead	Extracted:	Sep 27, 1990
Attention: Mardo Kapreallan, P.E.	First Sample #:	009-0779	Analyzed:	Sep 27, 1990
			Reported:	Sep 28, 1990

LABORATORY ANALYSIS FOR: Total Lead

Sample Number	Sample Description	Detection Limit mg/kg	Sample Result mg/kg
009-0779	B1	0.25	N.D.
009-0780	B1(8.5)	0.25	N.D.
009-0781	B2	0.25	N.D.
009-0782	B3	0.25	N.D.
009-0783	B4	0.25	N.D.
009-0784	B5	0.25	N.D.
009-0785	B6	0.25	N.D.

Analytes reported as N.D. were not present above the stated limit of detection.

SEQUOIA ANALYTICAL

Belinda C. Vega

Belinda C. Vega
 Laboratory Director



SEQUOIA ANALYTICAL

1900 Bates Avenue • Suite LM • Concord, California 94520
 (415) 686-9600 • FAX (415) 686-9689

Kaprealian Engineering, Inc.	Client Project ID: BP Station, 1716 Webster St., Alameda	Sampled: Sep 26, 1990
P.O. Box 996	Matrix Descript: Soil	Received: Sep 27, 1990
Benicia, CA 94510	Analysis Method: EPA 5030/8015/8020	Analyzed: Sep 27, 1990
Attention: Mardo Kaprealian, P.E.	First Sample #: 009-0779	Reported: Sep 28, 1990

TOTAL PETROLEUM FUEL HYDROCARBONS with BTEX DISTINCTION (EPA 8015/8020)

Sample Number	Sample Description	Low/Medium B.P. Hydrocarbons mg/kg (ppm)	Benzene mg/kg (ppm)	Toluene mg/kg (ppm)	Ethyl Benzene mg/kg (ppm)	Xylenes mg/kg (ppm)
009-0779	B1	110	1.9	3.7	2.3	10
009-0780	B1(B.5)	3.7	0.38	0.048	0.10	0.19
009-0781	B2	6.0	0.22	0.027	0.15	0.73
009-0782	B3	1.7	0.24	0.21	0.030	0.17
009-0783	B4	25	1.6	1.8	0.57	2.8
009-0784	B5	6.7	0.25	0.21	0.14	0.45
009-0785	B6	280	0.63	8.0	5.1	26

Detection Limits:	1.0	0.0050	0.0050	0.0050	0.0050
--------------------------	------------	---------------	---------------	---------------	---------------

Low to Medium Boiling Point Hydrocarbons are quantitated against a gasoline standard.
 Analytes reported as N.D. were not present above the stated limit of detection.

SEQUOIA ANALYTICAL

Belinda C. Vega
 Laboratory Director



KAPREALIAN ENGINEERING, INC.

CHAIN OF CUSTODY

SAMPLER Haig		SITE NAME & ADDRESS BP Station - ALAMEDA				ANALYSES REQUESTED			TURN AROUND TIME: 24 Hrs
WITNESSING AGENCY		1716 WEBSTER STREET				TPH-G	BTXE	Total lead	Priority

SAMPLE ID NO.	DATE	TIME	SOIL	WATER	DRAB	COMP	CONT.	NO. OF	SAMPLING LOCATION	TPH-G	BTXE	Total lead		REMARKS
SW1	9/26		✓	✓				1	Pipe Trench Sidewalk	✓	✓	✓	0090761	Please Fax the results
SW2	9/26		✓	✓				1	↓	✓	✓	✓	0090762	
SW3	9/26		✓	✓				1	↓	✓	✓	✓	0090763	

Relinquished by: (Signature) Haig	Date/Time 9/27/90 8:25	Received by: (Signature) Tom McLean	The following MUST BE completed by the laboratory accepting samples for analysis: 1. Have all samples received for analysis been stored in ice? <u>Yes</u> 2. Will samples remain refrigerated until analyzed? <u>Yes</u> 3. Did any samples received for analysis have head space? <u>No</u> 4. Were samples in appropriate containers and properly packaged? <u>Yes</u>
Relinquished by: (Signature) Tom McLean	Date/Time 9/27/90 9:00	Received by: (Signature) B.W.	
Relinquished by: (Signature)	Date/Time	Received by: (Signature)	
Relinquished by: (Signature)	Date/Time	Received by: (Signature)	
Relinquished by: (Signature)	Date/Time	Received by: (Signature)	Signature: J.S. [Signature] Title: Lab Director Date: 9/27/90

6869689
SEQUOIA ANALYTICAL



SEQUOIA ANALYTICAL

1900 Bates Avenue • Suite LM • Concord, California 94520
 (415) 686-9600 • FAX (415) 686-9689

Kapreallan Engineering, Inc.	Client Project ID: BP Station, 1716 Webster St., Alameda	Sampled: Sep 26, 1990
P.O. Box 996	Sample Descript: Soil	Received: Sep 27, 1990
Benicia, CA 94510	Analysis for: Total Lead	Extracted: Sep 27, 1990
Attention: Mardo Kapreallan, P.E.	First Sample #: 009-0761	Analyzed: Sep 27, 1990
		Reported: Sep 28, 1990

LABORATORY ANALYSIS FOR: Total Lead

Sample Number	Sample Description	Detection Limit mg/kg	Sample Result mg/kg
009-0761	SW1	0.25	45
009-0762	SW2	0.25	N.D.
009-0763	SW3	0.25	N.D.

Analytes reported as N.D. were not present above the stated limit of detection.

SEQUOIA ANALYTICAL

Belinda C. Vega
 Belinda C. Vega
 Laboratory Director



SEQUOIA ANALYTICAL

1900 Bales Avenue • Suite LM • Concord, California 94520
 (415) 686-9600 • FAX (415) 686-9689

Kapreallan Engineering, Inc.	Client Project ID:	BP Station, 1718 Webster St., Alameda	Sampled:	Sep 26, 1990
P.O. Box 996	Matrix Descript:	Soil	Received:	Sep 27, 1990
Benicia, CA 94510	Analysis Method:	EPA 5030/8015/8020	Analyzed:	Sep 27, 1990
Attention: Mardo Kapreallan, P.E.	First Sample #:	009-0761	Reported:	Sep 28, 1990

TOTAL PETROLEUM FUEL HYDROCARBONS with BTEX DISTINCTION (EPA 8015/8020)

Sample Number	Sample Description	Low/Medium B.P. Hydrocarbons mg/kg (ppm)	Benzene mg/kg (ppm)	Toluene mg/kg (ppm)	Ethyl Benzene mg/kg (ppm)	Xylenes mg/kg (ppm)
009-0761	SW1	7,500	9.9	82	98	560
009-0762	SW2	73	N.D.	0.016	0.030	0.46
009-0763	SW3	N.D.	N.D.	N.D.	N.D.	N.D.

Detection Limits:	1.0	0.0050	0.0050	0.0050	0.0050
--------------------------	------------	---------------	---------------	---------------	---------------

Low to Medium Boiling Point Hydrocarbons are quantitated against a gasoline standard.
 Analytes reported as N.D. were not present above the stated limit of detection.

SEQUOIA ANALYTICAL

Belinda C. Vega
 Laboratory Director



SEQUOIA ANALYTICAL

1900 Bates Avenue • Suite LM • Concord, California 94520
 (415) 686-9600 • FAX (415) 686-9689

Kaprelian Engineering, Inc.	Client Project ID: BP Station, 1716 Webster St., Alameda	Sampled: Sep 19, 1990
P.O. Box 996	Sample Descript.: Soil, Composite A	Received: Sep 20, 1990
Benicia, CA 94510	Analysis Method: EPA 5030/8015/8020	Analyzed: Sep 21, 1990
Attention: Mardo Kaprelian, P.E.	Lab Number: 009-0388	Reported: Sep 21, 1990

TOTAL PETROLEUM FUEL HYDROCARBONS WITH BTEX DISTINCTION (EPA 8015/8020)

Analyte	Detection Limit mg/kg (ppm)	Sample Results mg/kg (ppm)
Low to Medium Boiling Point Hydrocarbons	1.0	210
Benzene	0.0050	N.D.
Toluene	0.0050	0.17
Ethyl Benzene	0.0050	0.018
Xylenes	0.0050	0.50

Low to Medium Boiling Point Hydrocarbons are quantitated against a gasoline standard.
 Analytes reported as N.D. were not present above the stated limit of detection.

SEQUOIA ANALYTICAL

Belinda C. Vega
 Belinda C. Vega
 Laboratory Director

Please Note:
 The above sample does not appear to contain gasoline.



SEQUOIA ANALYTICAL

1900 Bates Avenue • Suite LM • Concord, California 94520
(415) 686-9600 • FAX (415) 686-9689

Kaprelian Engineering, Inc.	Client Project ID: BP Station, 1716 Webster St., Alameda	Sampled: Sep 19, 1990
P.O. Box 996	Sample Descript: Soil, Composite A	Received: Sep 20, 1990
Benicia, CA 94510		Extracted: Sep 20, 1990
Attention: Mardo Kaprelian, P.E.	Lab Number: 009-0388	Analyzed: Sep 20, 1990
		Reported: Sep 21, 1990

LABORATORY ANALYSIS

Analyte	Detection Limit mg/kg	Sample Results mg/kg
Total Lead	0.25	0.5

Analytes reported as N.D. were not present above the stated limit of detection.

SEQUOIA ANALYTICAL

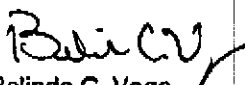
Belinda C. Vega
Laboratory Director



KAPREALIAN ENGINEERING, INC.

CHAIN OF CUSTODY

SEQUOIA ANALYTICAL
6869689

SAMPLER <i>Houig</i>	SITE NAME & ADDRESS BP Station - ALAMEDA 1716 WEBSTER STREET		ANALYSES REQUESTED TPH-G BTXE Total Lead	TURN AROUND TIME: 24 Hrs
WITNESSING AGENCY				

SAMPLE NO.	DATE	TIME	SOIL	WATER	GRAB	COMP	NO. OF CONT.	SAMPLING LOCATION	TPH-G	BTXE	Total Lead	REMARKS
Comp A	9/19/90		✓				2	STOCKPILE 0090388	✓	✓	✓	Please Fax the results

Relinquished by: (Signature) <i>Houig Kewell</i>	Date/Time 9-20-90 8:35	Received by: (Signature) <i>[Signature]</i>	The following MUST BE completed by the laboratory accepting samples for analysis: 1. Have all samples received for analysis been stored in ice? <input checked="" type="checkbox"/> 2. Will samples remain refrigerated until analyzed? <input checked="" type="checkbox"/> 3. Did any samples received for analysis have head space? <input checked="" type="checkbox"/> 4. Were samples in appropriate containers and properly packaged? <input checked="" type="checkbox"/>
Relinquished by: (Signature)	Date/Time	Received by: (Signature)	
Relinquished by: (Signature)	Date/Time	Received by: (Signature)	
Relinquished by: (Signature)	Date/Time	Received by: (Signature)	
Signature <i>[Signature]</i>	Title LO	Date 9/20	



SEQUOIA ANALYTICAL

1900 Bates Avenue • Suite LM • Concord, California 94520
 (415) 686-9600 • FAX (415) 686-9689

Kaprelian Engineering, Inc.	Client Project ID: BP Station, 1716 Webster St., Alameda	Sampled: Sep 28, 1990
P.O. Box 996	Matrix Descript: Soil	Received: Oct 1, 1990
Benicia, CA 94510	Analysis Method: EPA 5030/8015/8020	Analyzed: Oct 1, 1990
Attention: Mardo Kaprelian, P.E.	First Sample #: 010-0001 A-B	Reported: Oct 2, 1990

TOTAL PETROLEUM FUEL HYDROCARBONS with BTEX DISTINCTION (EPA 8015/8020)

Sample Number	Sample Description	Low/Medium B.P. Hydrocarbons				
		Benzene mg/kg (ppm)	Toluene mg/kg (ppm)	Ethyl Benzene mg/kg (ppm)	Xylenes mg/kg (ppm)	
010-0001 A-B	Comp B	510	0.072	4.2	5.8	42
010-0002 A-B	Comp C	340	0.075	0.39	0.11	17
010-0003 A-B	Comp D	1,200	1.3	19	15	93
010-0004 A-B	Comp E	1,200	1.3	11	6.4	130
010-0005 A-B	Comp F	560	0.56	5.0	1.8	52
010-0006 A-B	Comp G	850	0.38	1.0	0.21	54

Detection Limits:	1.0	0.0050	0.0050	0.0050	0.0050
-------------------	-----	--------	--------	--------	--------

Low to Medium Boiling Point Hydrocarbons are quantitated against a gasoline standard.
 Analytes reported as N.D. were not present above the stated limit of detection.

SEQUOIA ANALYTICAL

Belinda C. Vega
 Belinda C. Vega
 Laboratory Director



KAPREALIAN ENGINEERING, INC.

CHAIN OF CUSTODY

SAMPLER <i>Haig</i>		SITE NAME & ADDRESS BP station - ALAMEDA 1716 WEBSTER ST.				ANALYSES REQUESTED TPT-G BTXE				TURN AROUND TIME: <u>24 Hrs</u>
WITNESSING AGENCY										

SAMPLE ID NO.	DATE	TIME	SOIL	WATER	GRAB	COMP	CONT.	NO. OF	SAMPLING LOCATION	TPT-G	BTXE	ANALYSES REQUESTED		REMARKS
Comp B	9/28		✓			✓	2		STOCKPILE	✓	✓	01000001	DB0090820 AB	
Comp C	9/28		✓			✓	2			✓	✓	002		821
Comp D	9/28		✓			✓	2			✓	✓	003		822
Comp E	9/28		✓			✓	2			✓	✓	004		823
Comp F	9/28		✓			✓	2			✓	✓	005		824
Comp G	9/28		✓			✓	2			✓	✓	006		825

Relinquished by: (Signature) <i>Heather K...</i>	Date/Time 10-90 10:10	Received by: (Signature) <i>[Signature]</i>
Relinquished by: (Signature)	Date/Time	Received by: (Signature)
Relinquished by: (Signature)	Date/Time	Received by: (Signature)
Relinquished by: (Signature)	Date/Time	Received by: (Signature)

The following MUST BE completed by the laboratory accepting samples for analysis:

- Have all samples received for analysis been stored in ice?
- Will samples remain refrigerated until analyzed?
- Did any samples received for analysis have head space?
no
- Were samples in appropriate containers and properly packaged?

Signature: *[Signature]* Title: *SE* Date: *10/11*

686989

SEQUOIA ANALYTICAL



SEQUOIA ANALYTICAL

1900 Bates Avenue • Suite LM • Concord, California 94520
(415) 686-9600 • FAX (415) 686-9689

Kaprealian Engineering, Inc.
P.O. Box 996
Benicia, CA 94510
Attention: Mardo Kaprealian, P.E.

Client Project ID: BP Station, 1716 Webster St., Alameda
Sample Descript.: Soil, Composite A
Analysis Method: EPA 5030/8015/8020
Lab Number: 009-0388

Sampled: Sep 19, 1990
Received: Sep 20, 1990
Analyzed: Sep 21, 1990
Reported: Sep 21, 1990

TOTAL PETROLEUM FUEL HYDROCARBONS WITH BTEX DISTINCTION (EPA 8015/8020)

Analyte	Detection Limit mg/kg (ppm)	Sample Results mg/kg (ppm)
Low to Medium Boiling Point Hydrocarbons.....	1.0	210
Benzene.....	0.0050	N.D.
Toluene.....	0.0050	0.17
Ethyl Benzene.....	0.0050	0.018
Xylenes.....	0.0050	0.50

Low to Medium Boiling Point Hydrocarbons are quantitated against a gasoline standard.
Analytes reported as N.D. were not present above the stated limit of detection.

SEQUOIA ANALYTICAL

Belinda C. Vega
Belinda C. Vega
Laboratory Director

Please Note:
The above sample does not appear to contain gasoline.



SEQUOIA ANALYTICAL

1900 Bates Avenue • Suite LM • Concord, California 94520
(415) 686-9600 • FAX (415) 686-9689

Kaprealian Engineering, Inc. P.O. Box 996 Benicia, CA 94510 Attention: Mardo Kaprealian, P.E.	Client Project ID: BP Station, 1716 Webster St., Alamed Sample Descript: Soil, Composite A Lab Number: 009-0388	Sampled: Sep 19, 1990 Received: Sep 20, 1990 Extracted: Sep 20, 1990 Analyzed: Sep 20, 1990 Reported: Sep 21, 1990
--	---	--

LABORATORY ANALYSIS

Analyte	Detection Limit mg/kg	Sample Results mg/kg
Total Lead	0.25	9.5

Analytes reported as N.D. were not present above the stated limit of detection.

SEQUOIA ANALYTICAL

Belinda C. Vega
Laboratory Director



KAPREALIAN ENGINEERING, INC.

CHAIN OF CUSTODY

SAMPLER <u>Haug</u>		SITE NAME & ADDRESS					ANALYSES REQUESTED			TURN AROUND TIME:
WITNESSING AGENCY		<u>BP Station - ALAMEDA</u> <u>1716 WEBSTER STREET</u>					<u>TPH-C</u> <u>BTXE</u> <u>Total lead</u>			<u>24 Hrs</u>
SAMPLE ID NO.	DATE	TIME	SOIL	WATER	GRAB	COMP				CONT.
<u>CompA</u>	<u>9/19/90</u>		<input checked="" type="checkbox"/>				<u>2</u>	<u>STOCKPILE</u> <u>0090388</u>	<u>Please Fax the results</u>	

Relinquished by: (Signature) <u>Haug</u>	Date/Time <u>9/20/90 8:35</u>	Received by: (Signature) <u>[Signature]</u>	The following MUST BE completed by the laboratory accepting samples for analysis: 1. Have all samples received for analysis been stored in ice? <input checked="" type="checkbox"/> 2. Will samples remain refrigerated until analyzed? <input checked="" type="checkbox"/> 3. Did any samples received for analysis have head space? <input checked="" type="checkbox"/> 4. Were samples in appropriate containers and properly packaged? <input checked="" type="checkbox"/>
Relinquished by: (Signature)	Date/Time	Received by: (Signature)	
Relinquished by: (Signature)	Date/Time	Received by: (Signature)	
Relinquished by: (Signature)	Date/Time	Received by: (Signature)	
Signature <u>[Signature]</u>	Title <u>SE</u>	Date <u>9/20</u>	

October 4, 1990
(Water)

Uno-Alameda
1716 Webster St.

	<u>TPH-G</u>	<u>B</u>	<u>T</u>	<u>E</u>	<u>X</u>
W1	38000ppb	4900	2200	940	5300

(Soil)

B6(9.25)	1.7 ppm	0.41	0.23	0.065	0.11
----------	---------	------	------	-------	------



SEQUOIA ANALYTICAL

1900 Bates Avenue • Suite LM • Concord, California 94520
 (415) 686-9600 • FAX (415) 686-9689

Kaprealian Engineering, Inc.	Client Project ID: BP Station, 1716 Webster St., Alameda	Sampled: Oct 2, 1990
P.O. Box 996	Sample Descript.: Soil, B6 (9.25)	Received: Oct 3, 1990
Benicia, CA 94510	Analysis Method: EPA 5030/8015/8020	Analyzed: Oct 3, 1990
Attention: Mardo Kaprealian, P.E.	Lab Number: 010-0083	Reported: Oct 4, 1990

TOTAL PETROLEUM FUEL HYDROCARBONS WITH BTEX DISTINCTION (EPA 8015/8020)

Analyte	Detection Limit mg/kg (ppm)	Sample Results mg/kg (ppm)
Low to Medium Boiling Point Hydrocarbons	1.0	1.7
Benzene	0.0050	0.41
Toluene	0.0050	0.23
Ethyl Benzene	0.0050	0.065
Xylenes	0.0050	0.11

Low to Medium Boiling Point Hydrocarbons are quantitated against a gasoline standard.
 Analytes reported as N.D. were not present above the stated limit of detection.

SEQUOIA ANALYTICAL

Belinda C. Vega
 Laboratory Director



SEQUOIA ANALYTICAL

1900 Bates Avenue • Suite LM • Concord, California 94520
 (415) 686-9600 • FAX (415) 686-9889

Kaprealian Engineering, Inc.	Client Project ID:	BP Station, 1716 Webster St., Alameda	Sampled:	Oct 2, 1990
P.O. Box 996	Sample Descript:	Soil, B6 (9.25)	Received:	Oct 3, 1990
Benicia, CA 94510			Extracted:	Oct 4, 1990
Attention: Mardo Kapreallan, P.E.	Lab Number:	010-0083	Analyzed:	Oct 4, 1990
			Reported:	Oct 4, 1990

LABORATORY ANALYSIS

Analyte	Detection Limit mg/kg	Sample Results mg/kg
Total Lead	0.25	9.0

Analytes reported as N.D. were not present above the stated limit of detection.

SEQUOIA ANALYTICAL

Belinda C. Vega
 Laboratory Director



KAPREALIAN ENGINEERING, INC.

CHAIN OF CUSTODY

SAMPLER <i>Haring</i>		SITE NAME & ADDRESS <i>BP Station - ALAMEDA 1716 WEBSTER ST.</i>							ANALYSES REQUESTED <i>TPH-C BTXE Total Lead</i>				TURN AROUND TIME: <i>24 Hrs</i>
WITNESSING AGENCY													
SAMPLE ID NO.	DATE	TIME	SOIL	WATER	GRAB	COMP	NO. OF CONT.	SAMPLING LOCATION					REMARKS
<i>B6(9.25)</i>	<i>10/2</i>		<input checked="" type="checkbox"/>		<input checked="" type="checkbox"/>		<i>1</i>	<i>Pipe Trench</i>	<input checked="" type="checkbox"/>	<input checked="" type="checkbox"/>	<input checked="" type="checkbox"/>		Check <i>the results</i>

Relinquished by: (Signature) <i>Morgan Revell</i>	Date/Time <i>10/2/90 5:00</i>	Received by: (Signature) <i>Tom McSary</i>
Relinquished by: (Signature) <i>Tom McSary</i>	Date/Time <i>10/2/90 5:30</i>	Received by: (Signature) <i>Robert D.D.</i>
Relinquished by: (Signature)	Date/Time	Received by: (Signature)
Relinquished by: (Signature)	Date/Time	Received by: (Signature)

The following MUST BE completed by the laboratory accepting samples for analysis:

- Have all samples received for analysis been stored in ice?
- Will samples remain refrigerated until analyzed?
- Did any samples received for analysis have head space?
NO
- Were samples in appropriate containers and properly packaged?

Signature: *[Signature]* Title: *SE* Date: *10/9*

SEQUOIA ANALYTICAL. 6869689



SEQUOIA ANALYTICAL

1900 Bates Avenue • Suite LM • Concord, California 94520
 (415) 686-9600 • FAX (415) 686-9689

Kapreallan Engineering, Inc.	Client Project ID: BP Station, 1716 Webster St., Alameda	Sampled: Oct 2, 1990
P.O. Box 996	Sample Descript.: Water, W-1	Received: Oct 3, 1990
Benicia, CA 94510	Analysis Method: EPA 5030/ 8015/8020	Analyzed: Oct 3, 1990
Attention: Mardo Kapreallan, P.E.	Lab Number: 010-0084 A-B	Reported: Oct 4, 1990

TOTAL PETROLEUM FUEL HYDROCARBONS WITH BTEX DISTINCTION (EPA 8015/8020)

Analyte	Detection Limit µg/L (ppb)	Sample Results µg/L (ppb)
Low to Medium Boiling Point Hydrocarbons	30	38,000
Benzene	0.30	4,900
Toluene	0.30	2,200
Ethyl Benzene	0.30	940
Xylenes	0.30	5,300

Low to Medium Boiling Point Hydrocarbons are quantitated against a gasoline standard.
 Analytes reported as N.D. were not present above the stated limit of detection.

SEQUOIA ANALYTICAL

Belinda C. Vega
 Belinda C. Vega
 Laboratory Director



SEQUOIA ANALYTICAL

1900 Bates Avenue • Suite LM • Concord, California 94520
 (415) 686-9600 • FAX (415) 686-9689

Kaprealian Engineering, Inc.	Client Project ID: BP Station, 1716 Webster St., Alameda	Sampled: Oct 2, 1990
P.O. Box 996	Sample Descript: Water, W-1	Received: Oct 3, 1990
Benicia, CA 94510		Analyzed: Oct 4, 1990
Attention: Mardo Kaprealian, P.E.	Lab Number: 010-0084 C-F	Reported: Oct 4, 1990

LABORATORY ANALYSIS

Analyte	Detection Limit mg/L	Sample Results mg/L
Total Lead	0.0050	0.16

Analytes reported as N.D. were not present above the stated limit of detection.

SEQUOIA ANALYTICAL

Belinda C. Vega
 Belinda C. Vega
 Laboratory Director



KAPREALIAN ENGINEERING, INC.

CHAIN OF CUSTODY

P. 07

6869689

SEQUOIA ANALYTICAL.

SAMPLER <i>Hand</i>		SITE NAME & ADDRESS <i>BP Station - ALAMEDA</i> <i>1716 WEBSTER ST.</i>					ANALYSES REQUESTED <i>TPH-G</i> <i>BTEX</i> <i>Total Lead</i>			TURN AROUND TIME: <i>24 Hrs</i>
WITNESSING AGENCY										REMARKS
SAMPLE ID NO.	DATE	TIME	SOIL	WATER	GRAB	NO. OF CONT.	NO. OF CONT.	SAMPLING LOCATION		<i>Recheck the results</i>
<i>W1</i>	<i>10/2</i>		<input checked="" type="checkbox"/>	<input checked="" type="checkbox"/>		<i>6 YEARS</i>		<i>Pipe Trench</i>	<input checked="" type="checkbox"/> <input checked="" type="checkbox"/> <input checked="" type="checkbox"/>	
Relinquished by: (Signature)		Date/Time	Received by: (Signature)		The following MUST BE completed by the laboratory accepting samples for analysis: 1. Have all samples received for analysis been stored in ice? <input checked="" type="checkbox"/> 2. Will samples remain refrigerated until analyzed? <input checked="" type="checkbox"/> 3. Did any samples received for analysis have head space? <i>NO</i> 4. Were samples in appropriate containers and properly packaged? <input checked="" type="checkbox"/>					
<i>Hand</i>	<i>Kew</i>	<i>10/2/90</i>	<i>Tom McLean</i>							
Relinquished by: (Signature)		Date/Time	Received by: (Signature)							
<i>Tom McLean</i>		<i>10/2/90</i>	<i>Nikolai D. D.H.</i>							
Relinquished by: (Signature)		Date/Time	Received by: (Signature)		Signature: _____ Title: <i>SR</i> Date: <i>10/3</i>					
Relinquished by: (Signature)		Date/Time	Received by: (Signature)							

Buena Vista Ave

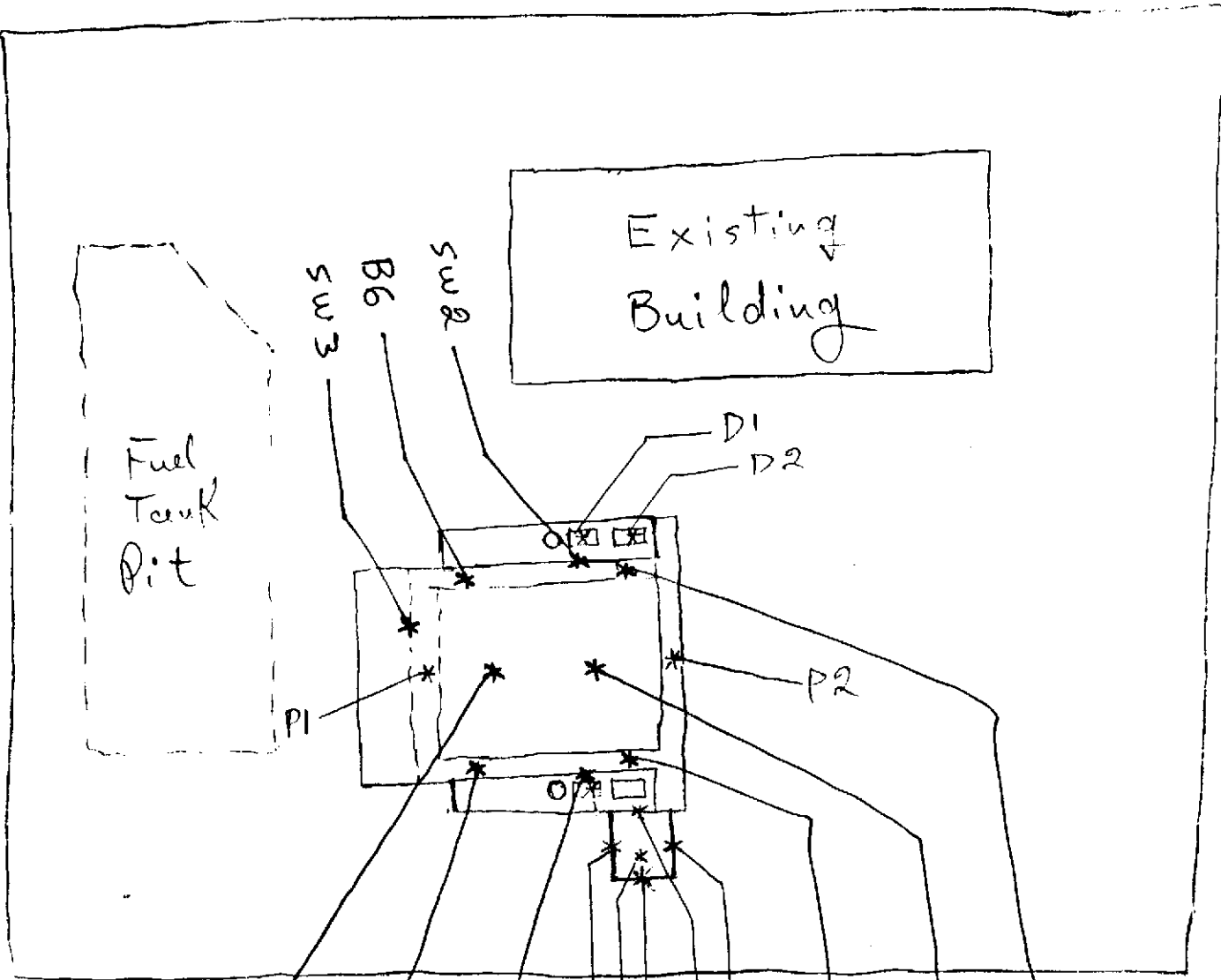

Webster Street

10 Samps
9/26/91



SEQUOIA ANALYTICAL

1900 Bates Avenue • Suite LM • Concord, California 94520
(415) 686-9600 • FAX (415) 686-9689

For H.D.

Kaprealian Engineering, Inc.	Client Project ID: BP, 1716 Webster St., Alameda	Sampled: Oct 4, 1990
P.O. Box 996	Matrix Descript: Soil	Received: Oct 4, 1990
Benicia, CA 94510	Analysis Method: EPA 5030/8015/8020	Analyzed: Oct 5, 1990
Attention: Mardo Kaprealian, P.E.	First Sample #: 010-0170	Reported: Oct 8, 1990

TOTAL PETROLEUM FUEL HYDROCARBONS with BTEX DISTINCTION (EPA 8015/8020)

Sample Number	Sample Description	Low/Medium B.P. Hydrocarbons mg/kg (ppm)	Benzene mg/kg (ppm)	Toluene mg/kg (ppm)	Ethyl Benzene mg/kg (ppm)	Xylenes mg/kg (ppm)
010-0170	SW1 (S)	2,100	4.3	24	36	190
010-0171	SW1 (N)	9.3	N.D.	0.073	0.056	0.32
010-0172	SW1 (E)	3,400	0.18	17	19	130
010-0173	SW1 (W)	N.D.	N.D.	0.010	N.D.	N.D.
010-0174	SW1 - B	N.D.	0.0060	0.022	0.016	0.018

Detection Limits:	1.0	0.0050	0.0050	0.0050	0.0050
--------------------------	------------	---------------	---------------	---------------	---------------

Low to Medium Boiling Point Hydrocarbons are quantitated against a gasoline standard.
Analytes reported as N.D. were not present above the stated limit of detection.

SEQUOIA ANALYTICAL

Belinda C. Vega

Belinda C. Vega
Laboratory Director