

R0275

Review  
(12) papers to



# GETTLER-RYAN INC.

1/29/02  
JAN 17 2002 *(Signature)*

## TRANSMITTAL

TO: Mr. Thomas Bauhs  
Chevron Products Company  
P.O. Box 6004  
San Ramon, California 94583

DATE: January 14, 2002  
PROJ. #: DG92960H.4CT1  
SUBJECT: Former Chevron Station #9-2960  
2416 Grove Way  
Castro Valley, California

FROM:

Tony P. Mikacich  
Project Geologist  
Gettler-Ryan Inc.  
3140 Gold Camp Drive, Suite 170  
Rancho Cordova, California 95670

WE ARE SENDING YOU:

COPIES	DATED	DESCRIPTION
1	January 14, 2002	Work Plan Addendum #2, dated January 14, 2002.

THESE ARE TRANSMITTED as checked below:

- For review and comment     Approved as submitted     Resubmit \_\_ copies for approval
- As requested     Approved as noted     Submit \_\_ copies for distribution
- For approval     Return for corrections     Return \_\_ corrected prints
- For your files

COMMENTS:

Copies of the above referenced document will be distributed to the following:

- Mr. Amir Gholami, Alameda County Health Care Services Agency, 1131 Harbor Bay Parkway, Suite 250, Alameda, CA 94502-6577
- Mr. Dean Nielsen, First Presbyterian Church, 2490 Grove Way, Castro Valley, CA 94546
- Mr. James Brownell, Delta Environmental Consultants, Inc., 3164 Gold Camp Dr., Suite 200, Rancho Cordova, CA 95670-6021

If you have any questions please call us in Rancho Cordova at 916.631.1300.



8164 Gold Camp Drive  
Suite 200  
Rancho Cordova, California 95670-6021  
916/638-2015  
FAX: 916/638-8385

JAN 17 2002

January 14, 2002

Mr. Thomas Bauhs  
Chevron Products Company  
P.O. Box 6004  
San Ramon, California 94583-0904

**Subject: Work Plan Addendum #2 for Monitoring Well Installation and Soil Boring**  
Former Chevron Station #9-2960  
2416 Grove Way, Castro Valley, CA  
DG92960H.4CT1

Dear Mr. Bauhs:

At the request of Chevron Products Company (Chevron), Delta Environmental Consultants, Inc. (Delta) network associate Gettler-Ryan Inc. (GR) is submitting this work plan addendum #2 for the above mentioned site (Figure 1), as requested by Alameda County Health Care Service Agency (ACHCSA) personnel during a phone conversation on December 20, 2001 and in letter dated, December 20, 2001. The proposed changes are in reference to the previously submitted Delta report, *Work Plan Addendum for Monitoring Well Installation and Soil Boring*, dated December 13, 2001.

- In an effort to evaluate the dissolved hydrocarbon plume in the area of the former UST complex, dispenser islands, and near former groundwater monitoring wells C-1 and C-2; GR proposes moving groundwater monitoring well C-8 southwest (downgradient) of former well C-1,
- GR proposes to advance one soil boring to groundwater and collect a grab groundwater sample at a location between former wells C-1 and C-2 as presented in Figure 2, and
- Finally, GR proposes two soil borings to groundwater and collection of grab groundwater samples at locations north of the property boundary (upgradient of former well C-2) and southwest (downgradient) of the former dispenser island located near Grove Way.

If you have any additional questions, please do not hesitate to call me in our Rancho Cordova office at (916) 631-1300.

Mr. Thomas Bauhs  
January 14, 2002  
Page 2

Sincerely,

DELTA ENVIRONMENTAL CONSULTANTS, INC.  
Network Associate GETTLER-RYAN INC.

JAN 17 2002

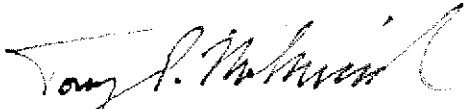

Tony P. Mikacich  
Project Geologist

Attachment: Figure 2: Site Plan

CC: Mr. Amir Gholami, Alameda County Health Care Services Agency, 1131 Harbor Bay Parkway, Suite 250, Alameda, CA 94502-6577  
Mr. Dean Nielsen, Business Administrator, First Presbyterian Church, 2490 Grove Way, Castro Valley, CA 94546  
Mr. James Brownell, Delta Environmental Consultants, Inc., 3164 Gold Camp Drive, Suite 200, Rancho Cordova, CA 95670

**EXPLANATION**

- ◆ Groundwater monitoring well
- ✕ Well unable to locate
- ⊗ Destroyed well
- ⊕ Proposed groundwater monitoring well
- Proposed soil boring

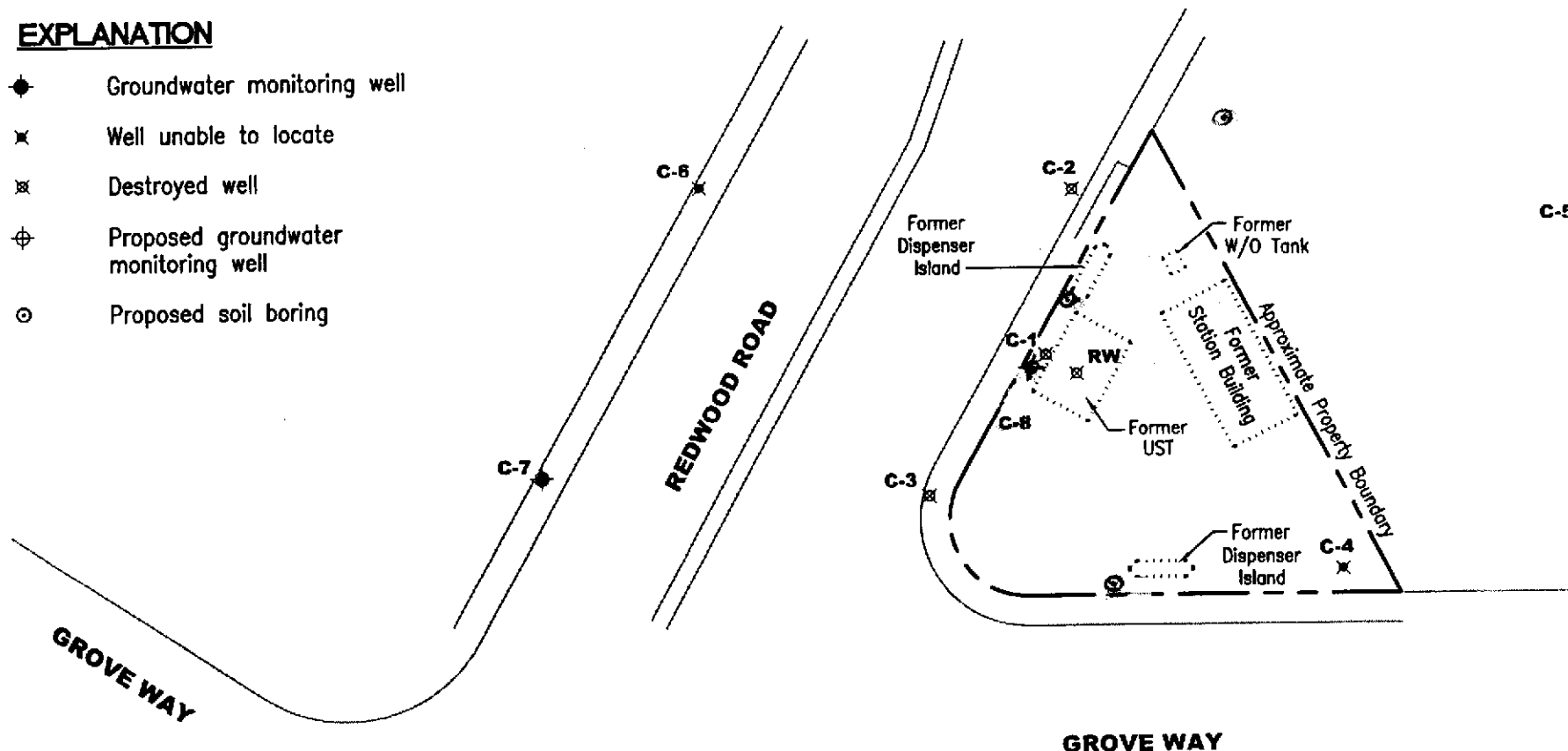

2002.1.1 NHP

Source: Figure modified from drawing provided by RRM engineering contracting firm.

**GETTLER - RYAN INC.**  
 6747 Sierra Ct., Suite J  
 Dublin, CA 94568 (925) 551-7555

**SITE PLAN**  
 Former Chevron Service Station No. 9-2960  
 2416 Grove Way  
 Castro Valley, California

FIGURE

2

PROJECT NUMBER  
 DG92960G.3C01

REVIEWED BY

DATE  
 11/01

REVISED DATE  
 01/19/02 - TFM



# GETTLER-RYAN INC.

SPD 656 ✓

## TRANSMITTAL

DEC 18 2001

TO: Mr. Thomas Bauhs  
Chevron Products Company  
P.O. Box 6004  
San Ramon, California 94583

DATE: December 13, 2001  
PROJ. #: DG92960C.3C01  
SUBJECT: Former Chevron Station #9-2960  
2416 Grove Way  
Castro Valley, California

FROM:

Tony P. Mikacich  
Project Geologist  
Gettler-Ryan Inc.  
3140 Gold Camp Drive, Suite 170  
Rancho Cordova, California 95670

(916) 631-1329

WE ARE SENDING YOU:

COPIES	DATED	DESCRIPTION
1	December 13, 2001	Work Plan Addendum for Monitoring Well Installation and Soil Boring, dated December 13, 2001.

THESE ARE TRANSMITTED as checked below:

- For review and comment     Approved as submitted     Resubmit \_\_ copies for approval
- As requested     Approved as noted     Submit \_\_ copies for distribution
- For approval     Return for corrections     Return \_\_ corrected prints
- For your files

COMMENTS:

Copies of the above referenced document will be distributed to the following:

- Mr. Amir Gholami, Alameda County Health Care Services, Dept. of Environmental Health, 1131 Harbor Bay Parkway, Alameda, CA 94502-6577
- Mr. Dean Nielsen, Business Administrator, First Presbyterian Church, 2490 Grove Way, Castro Valley, CA 94546
- Mr. James Brownell, Delta Environmental Consultants, Inc., 3164 Gold Camp Dr., Suite 200, Rancho Cordova, CA 95670-6021

If you have any questions please call us in Rancho Cordova at 916.631.1300.

**GETTLER - RYAN INC.**

3140 GOLD CAMP DRIVE, SUITE 170  
RANCHO CORDOVA, CALIFORNIA 95670  
PHONE: (916) 631-1300  
FAX: (916) 631-1317

*5712 656*  
*you only FAS*

# Fax

**To:** Mr. Amir Gholami **From:** Tony P. Mikacich

---

**Of:** Alameda County Health Care Services **Of:** GETTLER-RYAN INC.

---

**Fax:** (510) 337-9335 **Pages:** 4

---

**Phone:** **Date:** 01/14/02

---

**Re:** Chevron #9-2960, 2416 Grove Way, **CC:**  
Castro Valley, CA

Urgent     For Review     Please Comment     Please Reply     Request

**• Comments:**

Amir,

The following is a work plan addendum for the above mentioned site, based on changes we discussed during our December 20, 2001 phone conversation. Please do not hesitate to call if you have any questions or comments. Hard copy to follow in the mail.

Thank you,

Tony

If you have any questions or have trouble receiving this FAX, please call me at (916) 631-1300.



# GETTLER-RYAN INC.

---

January 14, 2002

Mr. Thomas Bauhs  
Chevron Products Company  
P.O. Box 6004  
San Ramon, California 94583-0904

**Subject: Work Plan Addendum #2 for Monitoring Well Installation and Soil Boring**  
Former Chevron Station #9-2960  
2416 Grove Way, Castro Valley, CA  
DG92960H.4CT1

Dear Mr. Bauhs:

At the request of Chevron Products Company (Chevron), Delta Environmental Consultants, Inc. (Delta) network associate Gettler-Ryan Inc. (GR) is submitting this work plan addendum #2 for the above mentioned site (Figure 1), as requested by Alameda County Health Care Service Agency (ACHCSA) personnel during a phone conversation on December 20, 2001 and in letter dated, December 20, 2001. The proposed changes are in reference to the previously submitted Delta report, *Work Plan Addendum for Monitoring Well Installation and Soil Boring*, dated December 13, 2001.

- In an effort to evaluate the dissolved hydrocarbon plume in the area of the former UST complex, dispenser islands, and near former groundwater monitoring wells C-1 and C-2; GR proposes moving groundwater monitoring well C-8 southwest (downgradient) of former well C-1.
- GR proposes to advance one soil boring to groundwater and collect a grab groundwater sample at a location between former wells C-1 and C-2 as presented in Figure 2, and
- Finally, GR proposes two soil borings to groundwater and collection of grab groundwater samples at locations north of the property boundary (upgradient of former well C-2) and southwest (downgradient) of the former dispenser island located near Grove Way.

If you have any additional questions, please do not hesitate to call me in our Rancho Cordova office at (916) 631-1300.

Mr. Thomas Bauhs  
January 14, 2002  
Page 2

Sincerely,

**DELTA ENVIRONMENTAL CONSULTANTS, INC.**  
Network Associate **GETTLER-RYAN INC.**



Tony P. Mikacich  
Project Geologist

Attachment: Figure 2: Site Plan

CC: Mr. Amir Gholami, Alameda County Health Care Services Agency, 1131 Harbor Bay Parkway, Suite 250, Alameda, CA 94502-6577  
Mr. Dean Nielsen, Business Administrator, First Presbyterian Church, 2490 Grove Way, Castro Valley, CA 94546  
Mr. James Brownell, Delta Environmental Consultants, Inc., 3164 Gold Camp Drive, Suite 200, Rancho Cordova, CA 95670



**EXPLANATION**

- ◆ Groundwater monitoring well
- × Well unable to locate
- ⊠ Destroyed well
- ⊕ Proposed groundwater monitoring well
- Proposed Soil Boring

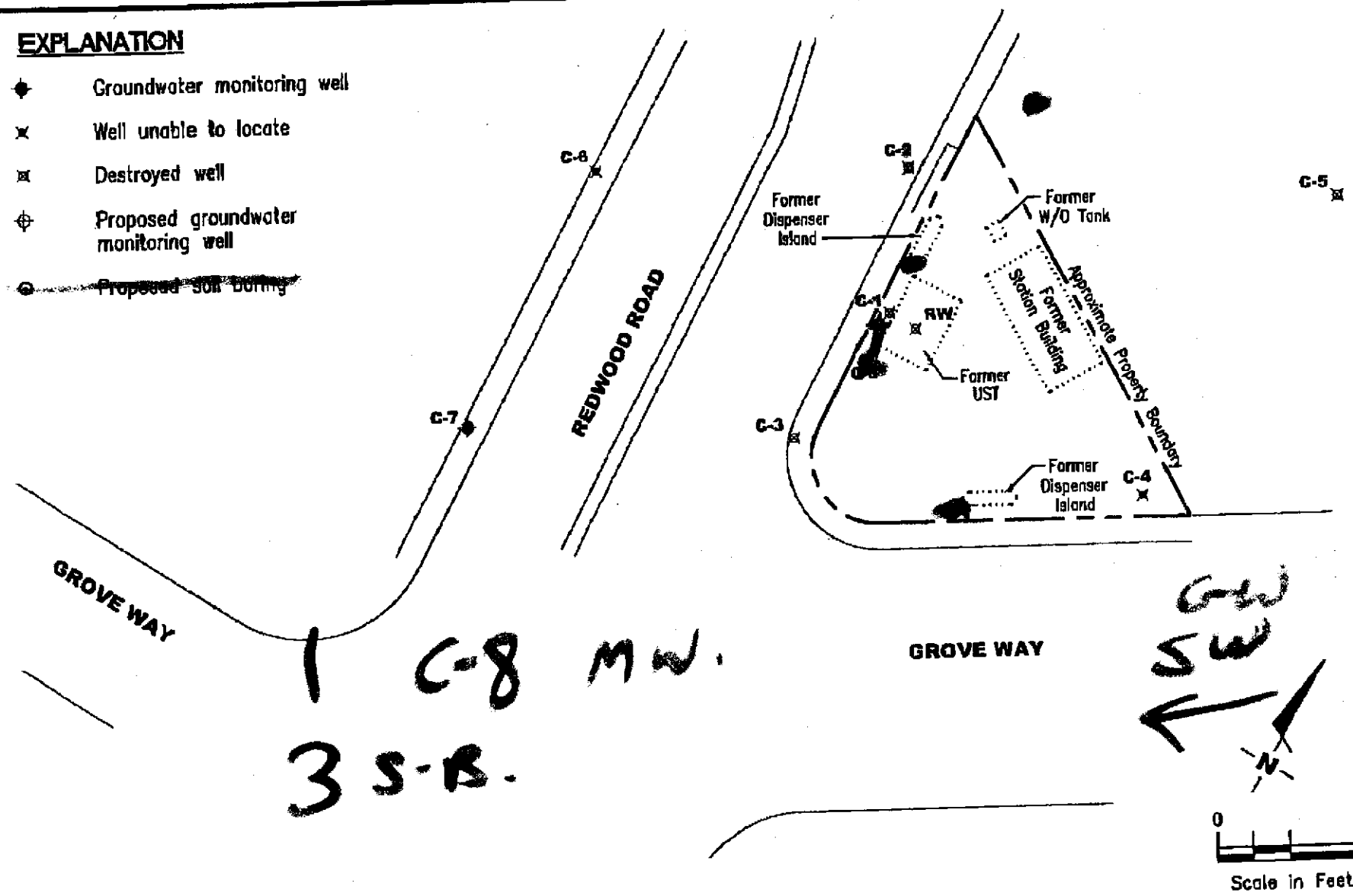

Source: Figure modified from drawing provided by ARM engineering contracting firm.

**GETTLER - RYAN INC.**  
 6747 Sierra Ct., Suite J  
 Dublin, CA 94568 (925) 551-7555

**SITE PLAN**  
 Former Chevron Service Station No. 9-2960  
 2416 Grove Way  
 Castro Valley, California

FIGURE  
**2**