

Environmental Management
Company
6001 Bollinger Canyon Rd, L4050
P.O. Box 6012
San Ramon, CA 94583-2324
Tel 925-842-1589
Fax 925-842-8370

Karen Streich
Project Manager

10275 ✓

August 19, 2004

ChevronTexaco

Alameda County Health Care Services
1131 Harbor Bay Parkway, Suite 250
Alameda, CA 94502-6577

Alameda County
AUG 22 2004
RECEIVED

Re: Chevron Service Station # 9-2950

Address: 2416 Grove Way, Castro Valley, California

I have reviewed the attached routine groundwater monitoring report dated July 22, 2004.

I agree with the conclusions and recommendations presented in the referenced report. The information in this report is accurate to the best of my knowledge and all local Agency/Regional Board guidelines have been followed. This report was prepared by Gettler-Ryan, Inc., upon whose assistance and advice I have relied.

This letter is submitted pursuant to the requirements of California Water Code Section 13267(b)(1) and the regulating implementation entitled Appendix A pertaining thereto.

I declare under penalty of perjury that the foregoing is true and correct.

Sincerely,



Karen Streich
Project Manager

Enclosure: Report



GETTLER-RYAN INC.

TRANSMITTAL

July 22, 2004
G-R #386365

TO: Mr. Bruce H. Eppler
Cambria Environmental Technology, Inc.
4111 Citrus Avenue, Suite 12
Rocklin, California 95677

RECEIVED
AUG 28 2004
Environmental Services

FROM: Deanna L. Harding
Project Coordinator
Gettler-Ryan Inc.
6747 Sierra Court, Suite J
Dublin, California 94568

RE: **Former Chevron Service Station
#9-2960
2416 Grove Way
Castro Valley, California
MTI: 61D-1964**

WE HAVE ENCLOSED THE FOLLOWING:

COPIES	DATED	DESCRIPTION
2	July 19, 2004	Groundwater Monitoring and Sampling Report Second Quarter - Event of June 28, 2004

COMMENTS:

Pursuant to your request, we are providing you with copies of the above referenced report for **your use and distribution to the following:**

Ms. Karen Streich, ChevronTexaco Company, P.O. Box 6012, Room K2256, San Ramon, CA 94583

Please provide any comments/changes and propose any groundwater monitoring modifications for the next event prior to **August 18, 2004**, at which time the final report will be distributed to the following:

cc: Mr. Barney Chan, Alameda County Health Care Services, Dept. of Environmental Health, 1131 Harbor Bay Parkway, Suite 250, Alameda, CA 94502-6577
Mr. Phil Conley, President Board of Trustees, First Presbyterian Church, 2490 Grove Way, Castro Valley, CA 94546

Enclosures

trans/9-2960-KS

6747 Sierra Court, Suite J • Dublin, CA 94568 • (925) 551-7555 • Fax (925) 551-7888
3140 Gold Camp Drive, Suite 170 • Rancho Cordova, CA 95670 • (916) 631-1300 • Fax (916) 631-1317
1364 N. McDowell Blvd., Suite B2 • Petaluma, CA 94954 • (707) 789-3255 • Fax (707) 789-3218



GETTLER-RYAN INC.

July 19, 2004
G-R Job #386365

Ms. Karen Streich
ChevronTexaco Company
P.O. Box 6012, Room K2256
San Ramon, CA 94583

RE: Second Quarter Event of June 28, 2004
Groundwater Monitoring & Sampling Report
Former Chevron Service Station #9-2960
2416 Grove Way
Castro Valley, California

Dear Ms. Streich:

This report documents the most recent groundwater monitoring and sampling event performed by Gettler-Ryan Inc. (G-R) at the referenced site. All field work was conducted in accordance with G-R Standard Operating Procedure - Groundwater Sampling (attached).

The static groundwater level was measured and the well was checked for the presence of separate-phase hydrocarbons. Static water level data, groundwater elevations, and separate-phase hydrocarbon thickness (if any) are presented in the attached Table 1. A Groundwater Elevation Map is included as Figure 1.

Groundwater samples were collected from the monitoring well and submitted to a state certified laboratory for analyses. The field data sheets for this event are attached. Analytical results are presented in the table(s) listed below. The chain of custody document and laboratory analytical report are also attached.

Please call if you have any questions or comments regarding this report. Thank you.

Sincerely,

Deanna L. Harding
Project Coordinator

Hagop Kevork
P.E. No. C55734



Figure 1: Groundwater Elevation Map
Table 1: Groundwater Monitoring Data and Analytical Results
Table 2: Groundwater Analytical Results - Oxygenate Compounds
Attachments: Standard Operating Procedure - Groundwater Sampling
Field Data Sheets
Chain of Custody Document and Laboratory Analytical Reports

EXPLANATION

- ◆ Groundwater monitoring well
- ✕ Abandoned well
- 99.99 Groundwater elevation in feet referenced to Mean Sea Level
- P/O Paved Over
- * Discontinued from monitoring/sampling program

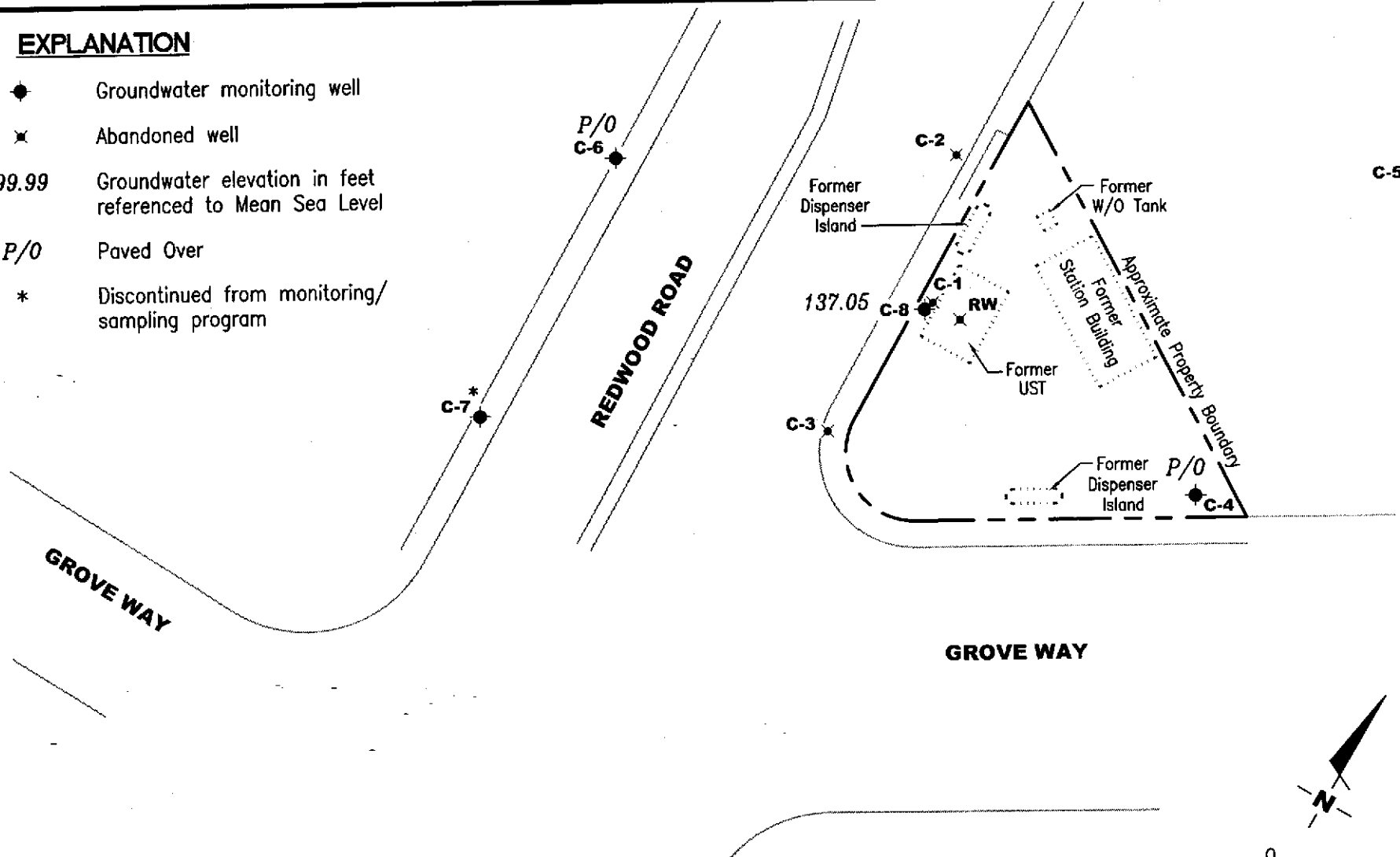

Source: Figure modified from drawing provided by RRM engineering contracting firm.

GETTLER - RYAN INC.
 6747 Sierra Ct., Suite J
 Dublin, CA 94568 (925) 551-7555

GROUNDWATER ELEVATION MAP
 Former Chevron Service Station #9-2960
 2416 Grove Way
 Castro Valley, California

FIGURE
1

PROJECT NUMBER
386365

REVIEWED BY

DATE
 June 28, 2004

REVISED DATE

Table 1
Groundwater Monitoring Data and Analytical Results
Former Chevron Service Station #9-2960
2416 Grove Way
Castro Valley, California

WELL ID/ DATE	TOC+ (<i>ft.</i>)	GWE (<i>mst</i>)	DTW (<i>ft.</i>)	SPHT (<i>ft.</i>)	SPH REMOVED (<i>gallons</i>)	TPH-G (<i>ppb</i>)	B (<i>ppb</i>)	T (<i>ppb</i>)	E (<i>ppb</i>)	X (<i>ppb</i>)	MTBE (<i>ppb</i>)
C-1											
10/23/86	153.36	--	--	--	--	3,100	6,400	3,700	--	4,300	--
09/10/87	153.36	--	--	--	--	120,000	25,000	60,000	13,000	56,000	--
10/03/90	153.36	134.69	18.67	--	--	--	--	--	--	--	--
10/25/90	153.36	135.22	18.71	0.71	--	--	--	--	--	--	--
01/22/91	153.36	135.22	18.70	0.70	--	--	--	--	--	--	--
02/21/91	153.36	135.44	18.62	0.88	--	--	--	--	--	--	--
04/01/91	153.36	136.47	16.91	0.03	--	--	--	--	--	--	--
04/11/91	153.36	136.49	16.90	0.04	--	--	--	--	--	--	--
07/01/91	153.36	135.75	17.61	0.00	--	--	--	--	--	--	--
09/24/91	153.36	135.17	18.98	0.99	--	--	--	--	--	--	--
10/23/91	153.36	135.03	19.32	1.24	--	--	--	--	--	--	--
11/22/91	153.36	134.53	18.83	0.97	--	--	--	--	--	--	--
01/09/92	153.36	136.10	17.26	--	--	--	--	--	--	--	--
03/06/92	153.36	137.16	16.69	0.61	--	--	--	--	--	--	--
06/04/92	153.36	136.44	17.10	0.22	--	--	--	--	--	--	--
09/28/92	153.36	--	18.71	0.77	--	--	--	--	--	--	--
12/17/92	153.36	--	17.54	0.45	--	--	--	--	--	--	--
04/29/93	153.36	137.50	16.40	0.68	--	--	--	--	--	--	--
07/26/93	153.36	136.92	16.85	0.51	--	--	--	--	--	--	--
10/22/93	153.36	135.55	17.83	0.03	--	--	--	--	--	--	--
01/24/94	153.36	--	--	--	--	--	--	--	--	--	--
04/11/94	153.36	136.01	17.76	0.51	--	--	--	--	--	--	--
07/01/94	153.36	135.95	17.46	0.06	--	--	--	--	--	--	--
10/06/94	153.36	135.24	18.18	0.08	--	--	--	--	--	--	--
01/11/95	153.36	136.63	16.79	0.08	0.039	--	--	--	--	--	--
04/07/95	153.36	139.23	14.13	--	--	44,000	410	100	130	5,400	--
07/20/95	153.36	136.84	16.52	--	--	16,000	96	81	53	1,000	--
09/22/95	153.36	137.22	16.14	--	--	59,000	150	36	16	56	--
01/02/96	153.36	137.43	15.93	--	--	29,000	4,500	1,100	520	1,900	<250
04/26/96	153.36	137.31	16.05	--	--	7,200	1,300	340	130	390	--
07/22/96	153.36	143.14	10.22	--	--	7,300	2,500	170	360	520	--
10/17/96	153.36	137.64	15.72	--	--	19,000	3,400	59	360	430	--

Table 1
Groundwater Monitoring Data and Analytical Results
Former Chevron Service Station #9-2960
2416 Grove Way
Castro Valley, California

WELL ID/ DATE	TOC+ (ft.)	GWE (msl)	DTW (ft.)	SPHT (ft.)	SPH REMOVED (gallons)	TPH-G (ppb)	B (ppb)	T (ppb)	E (ppb)	X (ppb)	MTBE (ppb)
C-1 (cont)											
01/23/97	153.36	138.91	14.45	--	--	15,000	2,900	390	250	480	--
07/10/97	153.36	137.19	16.17	--	--	13,000	2,100	69	200	380	--
01/15/98	153.36	INACCESSIBLE		--	--	--	--	--	--	--	--
01/16/98	153.36	138.63	14.73	--	--	4,700	1,200	<20	140	40	--
07/09/98	153.36	138.14	15.22	--	--	9,900	1,500	60	150	170	--
ABANDONED											
C-2											
10/23/86	151.84	--	--	--	--	30,000	2,700	1,900	--	1,500	--
09/10/87	151.84	--	--	--	--	14,000	2,600	2,900	500	1,200	--
10/16/89	151.84	--	--	--	--	600	260	34	1.7	41	--
01/04/90	151.84	--	--	--	--	2,600	470	150	23	130	--
04/05/90	151.84	--	--	--	--	500	280	29	6.3	19	--
07/02/90	151.84	--	--	--	--	2,400	670	110	17	76	--
10/03/90	151.84	--	--	--	--	--	--	--	--	--	--
10/25/90	151.84	135.24	16.60	--	--	1,300	390	47	9.0	58	--
01/22/91	151.84	135.15	16.69	--	--	2,600	680	88	29	130	--
02/21/91	151.84	135.53	16.31	--	--	--	--	--	--	--	--
04/01/91	151.84	136.76	15.08	--	--	--	--	--	--	--	--
04/11/91	151.84	136.61	15.23	--	--	--	--	--	--	--	--
07/01/91	151.84	135.88	15.96	--	--	--	--	--	--	--	--
09/24/91	151.84	135.33	16.51	--	--	3,600	1,400	63	6.9	63	--
10/23/91	151.84	135.18	16.66	--	--	--	--	--	--	--	--
11/22/91	151.84	135.47	16.37	--	--	--	--	--	--	--	--
01/09/92	151.84	136.28	15.56	--	--	7,100	770	740	190	690	--
03/06/92	151.84	137.47	14.37	--	--	3,200	250	230	59	220	--
06/04/92	151.84	136.80	15.04	--	--	1,500	<0.5	180	42	130	--
09/28/92	151.84	135.44	16.40	--	--	6,400	940	230	57	220	--
12/17/92	151.84	136.46	15.38	--	--	1,500	370	160	6.0	25	--
04/29/93	151.84	136.87	14.97	--	--	1,800	690	120	74	140	--
07/29/93	151.84	136.92	14.92	--	--	4,300	1,500	96	29	96	--

Table 1
Groundwater Monitoring Data and Analytical Results
Former Chevron Service Station #9-2960
2416 Grove Way
Castro Valley, California

WELL ID/ DATE	TOC* (ft.)	GWE (msl)	DTW (ft.)	SPHT (ft.)	SPH REMOVED (gallons)	TPH-G (ppb)	B (ppb)	T (ppb)	E (ppb)	X (ppb)	MTBE (ppb)
C-2 (cont)											
10/22/93	151.84	136.03	15.81	--	--	820	560	57	15	58	--
01/24/94	151.84	--	--	--	--	--	--	--	--	--	--
04/11/94	151.84	136.49	15.35	--	--	2,000	240	48	36	110	--
07/01/94	151.84	136.44	15.40	--	--	370	55	12	3.1	8.6	--
10/06/94	151.84	135.84	16.00	--	--	150	47	4.8	1.8	5.4	--
01/11/95	151.84	137.06	14.78	--	--	52	0.65	<0.5	<0.5	<0.5	--
04/07/95	151.84	138.93	12.91	--	--	1,500	260	64	52	85	--
07/20/95	151.84	136.81	15.03	--	--	3,000	500	100	96	110	--
09/22/95	151.84	137.05	14.79	--	--	2,000	630	120	20	79	--
01/02/96	151.84	137.37	14.47	--	--	1,900	240	110	58	180	<12
04/26/96	151.84	137.97	13.87	--	--	1,300	340	190	44	120	--
07/22/96	151.84	136.73	15.11	--	--	3,700	1,100	140	150	330	--
10/17/96	151.84	136.80	15.04	--	--	22,000	3,900	1,600	350	1,800	--
01/23/97	151.84	138.86	12.98	--	--	2,000	260	48	76	94	--
07/10/97	151.84	137.21	14.63	--	--	5,100	710	200	190	380	--
01/15/98	153.36	INACCESSIBLE		--	--	--	--	--	--	--	--
01/16/98	151.84	138.61	13.23	--	--	7,600	1,600	130	320	650	--
07/09/98	151.84	138.17	13.67	--	--	10,000	1,100	410	180	410	--
ABANDONED											
C-3											
10/23/86	154.13	--	--	--	--	3,300	49	24	--	20	--
09/10/87	154.13	--	--	--	--	200	110	2.6	<2.0	<2.0	--
10/16/89	154.13	--	--	--	--	900	640	4.2	1.6	16	--
01/04/90	154.13	--	--	--	--	920	430	7.0	6.0	7.0	--
04/05/90	154.13	--	--	--	--	930	690	3.4	5.1	4.8	--
07/02/90	154.13	--	--	--	--	1,700	590	11	4.8	9.4	--
10/03/90	154.13	134.97	19.16	--	--	--	--	--	--	--	--
10/25/90	154.13	134.85	19.28	--	--	750	510	2.0	6.0	5.0	--
01/22/91	154.13	134.95	19.18	--	--	430	260	2.0	2.0	5.0	--
01/22/91	154.13	134.95	19.18	--	--	400	250	2.0	2.0	5.0	--

Table 1
Groundwater Monitoring Data and Analytical Results
Former Chevron Service Station #9-2960
2416 Grove Way
Castro Valley, California

WELL ID/ DATE	TOC* (ft.)	GWE (msl)	DTW (ft.)	SPHT (ft.)	SPH REMOVED (gallons)	TPH-G (ppb)	B (ppb)	T (ppb)	E (ppb)	X (ppb)	MTBE (ppb)
C-3 (cont)											
02/21/91	154.13	135.25	18.88	--	--	--	--	--	--	--	--
04/01/91	154.13	136.54	17.59	--	--	--	--	--	--	--	--
04/11/91	154.13	136.32	17.81	--	--	--	--	--	--	--	--
07/01/91	154.13	135.57	18.56	--	--	--	--	--	--	--	--
09/24/91	154.13	135.01	19.12	--	--	260	52	0.7	0.8	2.2	--
10/23/91	154.13	134.89	19.24	--	--	--	--	--	--	--	--
11/22/91	154.13	135.10	19.03	--	--	--	--	--	--	--	--
01/09/92	154.13	135.90	18.23	--	--	240	120	0.9	<0.5	1.6	--
03/06/92	154.13	137.09	17.04	--	--	230	68	1.2	1.2	1.3	--
06/04/92	154.13	136.34	17.79	--	--	80	36	0.6	0.5	0.7	--
09/28/92	154.13	135.13	19.00	--	--	84	49	<0.5	<0.5	1.5	--
12/17/92	154.13	135.95	18.18	--	--	220	30	<0.5	<0.5	<0.5	--
04/29/93	154.13	135.35	18.78	--	--	380	12	0.6	<0.5	<1.5	--
07/26/93	154.13	136.41	17.72	--	--	800	38	1.1	<0.5	<1.5	--
10/22/93	154.13	135.63	18.50	--	--	200	64	0.6	<0.5	<1.5	--
01/24/94	154.13	135.62	18.51	--	--	<50	<0.5	<0.5	<0.5	<0.5	--
04/11/94	154.13	136.09	18.04	--	--	100	3.6	2.1	<0.5	2.3	--
07/01/94	154.13	136.01	18.12	--	--	140	3.7	1.2	<0.5	1.0	--
10/06/94	154.13	135.50	18.63	--	--	<50	<0.5	<0.5	<0.5	<0.5	--
01/11/95	154.13	137.01	17.12	--	--	<50	<0.5	<0.5	<0.5	<0.5	--
04/07/95	154.13	138.34	15.79	--	--	<50	<0.5	<0.5	<0.5	<0.5	--
07/20/95	154.13	136.37	17.76	--	--	<50	1.5	1.9	<0.5	3.5	--
09/22/95	154.13	136.58	17.55	--	--	<50	<0.5	<0.5	<0.5	<0.5	--
01/02/96	154.13	136.88	17.25	--	--	<50	<0.5	<0.5	<0.5	1.1	<2.5
04/26/96	154.13	137.42	16.71	--	--	<50	<0.5	<0.5	<0.5	<0.5	--
07/22/96	154.13	136.50	17.63	--	--	<50	<0.5	<0.5	<0.5	<0.5	--
10/17/96	154.13	136.33	17.80	--	--	<50	<0.5	<0.5	<0.5	<0.5	--
01/23/97	154.13	138.33	15.80	--	--	<50	<0.5	<0.5	<0.5	<0.5	--
07/10/97	154.13	136.63	17.50	--	--	<50	<0.5	<0.5	<0.5	<0.5	--
01/15/98	154.13	137.98	16.15	--	--	<50	<0.5	<0.5	<0.5	<0.5	--

Table 1
Groundwater Monitoring Data and Analytical Results
Former Chevron Service Station #9-2960
2416 Grove Way
Castro Valley, California

WELL ID/ DATE	TOC* (ft.)	GWE (msl)	DTW (ft.)	SPHT (ft.)	SPH REMOVED (gallons)	TPH-G (ppb)	B (ppb)	T (ppb)	E (ppb)	X (ppb)	MTBE (ppb)
C-3 (cont)											
01/16/98	154.13	138.04	16.09	--	--	REGAUGE	--	--	--	--	--
07/09/98	154.13	137.57	16.56	--	--	<50	<0.5	<0.5	<0.5	<0.5	--
ABANDONED											
C-4											
10/23/86	156.00	--	--	--	--	570	3.0	4.0	--	5.0	--
09/10/87	156.00	--	--	--	--	500	3.0	<0.5	<0.5	<0.5	--
10/16/89	156.00	--	--	--	--	<500	12	1.0	<0.5	0.8	--
01/04/90	156.00	--	--	--	--	<500	5.0	<0.5	<0.5	0.9	--
04/05/90	156.00	--	--	--	--	<50	6.6	<0.5	<0.5	0.7	--
07/02/90	156.00	--	--	--	--	71	4.1	<0.5	<0.5	<0.5	--
10/03/90	156.00	--	--	--	--	--	--	--	--	--	--
10/25/90	156.00	135.57	20.43	--	--	<50	2.0	<0.5	<0.5	<0.5	--
01/22/91	156.00	135.50	20.50	--	--	<50	3.0	<0.5	<0.5	<0.5	--
02/21/91	156.00	135.77	20.23	--	--	--	--	--	--	--	--
04/01/91	156.00	136.97	19.03	--	--	--	--	--	--	--	--
04/11/91	156.00	136.95	19.05	--	--	--	--	--	--	--	--
07/01/91	156.00	136.10	19.90	--	--	--	--	--	--	--	--
09/24/91	156.00	135.59	20.41	--	--	87	1.6	<0.5	<0.5	<0.5	--
10/23/91	156.00	135.47	20.53	--	--	--	--	--	--	--	--
11/22/91	156.00	135.65	20.35	--	--	--	--	--	--	--	--
01/09/92	156.00	136.46	19.54	--	--	51	4.3	<0.5	<0.5	<0.5	--
01/09/92	156.00	136.46	19.54	--	--	<50	4.8	<0.5	<0.5	<0.5	--
03/06/92	156.00	137.74	18.26	--	--	<50	0.8	<0.5	<0.5	<0.5	--
06/04/92	156.00	137.08	18.92	--	--	<50	<0.5	<0.5	<0.5	0.7	--
09/28/92	156.00	135.69	20.31	--	--	<50	<0.5	<0.5	<0.5	<0.5	--
12/17/92	156.00	136.43	19.57	--	--	<50	<0.5	<0.5	<0.5	<0.5	--
04/29/93	156.00	138.22	17.78	--	--	<50	<0.5	<0.5	<0.5	<1.5	--
07/26/93	156.00	--	--	--	--	--	--	--	--	--	--
08/18/93	156.00	137.09	18.91	--	--	<50	<0.5	<0.5	<0.5	<1.5	--
10/22/93	156.00	136.61	19.39	--	--	<50	2.9	2.1	1.1	4.3	--

Table 1
Groundwater Monitoring Data and Analytical Results
Former Chevron Service Station #9-2960
2416 Grove Way
Castro Valley, California

WELL ID/ DATE	TOC* (ft.)	GWE (msl)	DTW (ft.)	SPHT (ft.)	SPH REMOVED (gallons)	TPH-G (ppb)	B (ppb)	T (ppb)	E (ppb)	X (ppb)	MTBE (ppb)
C-4 (cont)											
01/24/94	156.00	136.58	19.42	--	--	<50	<0.5	<0.5	<0.5	<0.5	--
04/11/94	156.00	136.86	19.14	--	--	<50	<0.5	0.6	<0.5	0.5	--
07/01/94	156.00	136.80	19.20	--	--	<50	<0.5	<0.5	<0.5	<0.5	--
10/06/94	156.00	136.26	19.74	--	--	<50	<0.5	<0.5	<0.5	<0.5	--
01/11/95	156.00	139.70	16.30	--	--	<50	<0.5	<0.5	<0.5	<0.5	--
04/07/95	156.00	139.49	16.51	--	--	<50	<0.5	<0.5	<0.5	<0.5	--
07/20/95	156.00	137.20	18.80	--	--	<50	<0.5	<0.5	<0.5	<0.5	--
09/22/95	156.00	137.26	18.74	--	--	<50	<0.5	<0.5	<0.5	<0.5	--
01/02/96	156.00	137.65	18.35	--	--	<50	1.6	1.8	0.95	4.1	<2.5
04/26/96	156.00	138.43	17.57	--	--	<50	<0.5	<0.5	<0.5	<0.5	--
07/22/96	156.00	137.00	19.00	--	--	<50	<0.5	<0.5	<0.5	<0.5	--
10/17/96	156.00	136.96	19.04	--	--	<50	<0.5	<0.5	<0.5	<0.5	--
01/23/97	156.00	139.31	16.69	--	--	<50	<0.5	<0.5	<0.5	<0.5	--
07/10/97	156.00	137.46	18.54	--	--	SAMPLED ANNUALLY	--	--	--	--	--
01/15/98	156.00	143.92	12.08	--	--	<50	1.0	1.4	<0.5	3.5	--
01/16/98	156.00	138.84	17.16	--	--	REGAUGE	--	--	--	--	--
07/09/98	156.00	138.29	17.71	--	--	--	--	--	--	--	--
01/08/99	156.00	139.19	16.81	--	--	<50	<0.5	<0.5	<0.5	<0.5	--
07/09/99	156.00	UNABLE TO LOCATE		--	--	--	--	--	--	--	--
02/01/00	156.00	UNABLE TO LOCATE		--	--	--	--	--	--	--	--
08/21/00	156.00	UNABLE TO LOCATE - PAVED OVER		--	--	--	--	--	--	--	--
01/25/01	156.00	UNABLE TO LOCATE - PAVED OVER		--	--	--	--	--	--	--	--
07/10/01	156.00	UNABLE TO LOCATE - PAVED OVER		--	--	--	--	--	--	--	--
01/08/02	156.00	UNABLE TO LOCATE - PAVED OVER		--	--	--	--	--	--	--	--
03/26/02	156.00	UNABLE TO LOCATE - PAVED OVER		--	--	--	--	--	--	--	--
06/17/02	156.00	UNABLE TO LOCATE - PAVED OVER		--	--	--	--	--	--	--	--
PAVED OVER											

Table 1
Groundwater Monitoring Data and Analytical Results
Former Chevron Service Station #9-2960
2416 Grove Way
Castro Valley, California

WELL ID/ DATE	TOC* (ft.)	GWE (msl)	DTW (ft.)	SPHT (ft.)	SPH REMOVED (gallons)	TPH-G (ppb)	B (ppb)	T (ppb)	E (ppb)	X (ppb)	MTBE (ppb)
C-5											
10/03/90	153.38	135.60	17.78	--	--	<50	<0.5	<0.5	<0.5	<0.5	--
10/25/90	153.38	135.46	17.92	--	--	<50	<0.5	<0.5	<0.5	<0.5	--
11/09/90	153.38	135.46	17.92	--	--	<50	<0.5	<0.5	<0.5	<0.5	--
01/22/91	153.38	135.58	17.80	--	--	<50	<0.5	<0.5	<0.5	<0.5	--
02/21/91	153.38	135.87	17.51	--	--	--	--	--	--	--	--
04/01/91	153.38	137.07	16.31	--	--	--	--	--	--	--	--
04/11/91	153.38	137.02	16.36	--	--	--	--	--	--	--	--
07/01/91	153.38	136.26	17.12	--	--	--	--	--	--	--	--
09/24/91	153.38	135.68	17.70	--	--	<50	<0.5	<0.5	<0.5	<0.5	--
09/24/91	153.38	135.68	17.70	--	--	<50	<0.5	<0.5	<0.5	<0.5	--
10/23/91	153.38	135.56	17.82	--	--	--	--	--	--	--	--
11/22/91	153.38	135.77	17.61	--	--	--	--	--	--	--	--
01/09/92	153.38	136.34	17.04	--	--	<50	<0.5	0.7	<0.5	<0.5	--
03/06/92	153.38	137.62	15.76	--	--	<50	<0.5	<0.5	<0.5	<0.5	--
06/04/92	153.38	136.98	16.40	--	--	<50	<0.5	<0.5	<0.5	<0.5	--
09/28/92	153.38	135.80	17.58	--	--	<50	<0.5	<0.5	<0.5	<0.5	--
12/17/92	153.38	136.56	16.82	--	--	<50	<0.5	<0.5	<0.5	<0.5	--
04/29/93	153.38	138.14	15.24	--	--	<50	<0.5	<0.5	<0.5	<1.5	--
07/26/93	153.38	137.08	16.30	--	--	<50	<0.5	<0.5	<0.5	<1.5	--
10/22/93	153.38	136.30	17.08	--	--	52	2.3	2.7	1.1	5.2	--
01/24/94	153.38	136.25	17.13	--	--	<50	<0.5	<0.5	<0.5	<0.5	--
04/11/94	153.38	136.75	16.63	--	--	<50	<0.5	0.7	<0.5	0.6	--
07/01/94	153.38	136.73	16.65	--	--	<50	<0.5	<0.5	<0.5	<0.5	--
10/06/94	153.38	136.16	17.22	--	--	<50	<0.5	<0.5	<0.5	<0.5	--
01/11/95	153.38	137.41	15.97	--	--	<50	<0.5	<0.5	<0.5	<0.5	--
04/07/95	153.38	139.37	14.01	--	--	<50	<0.5	<0.5	<0.5	<0.5	--
07/20/95	153.38	137.17	16.21	--	--	<50	<0.5	<0.5	<0.5	0.61	--
09/22/95	153.38	137.07	16.31	--	--	62	<0.5	<0.5	<0.5	<0.5	--
01/02/96	153.38	137.56	15.82	--	--	<50	<0.5	<0.5	<0.5	<0.5	<2.5
04/26/96	153.38	138.41	14.97	--	--	<50	<0.5	<0.5	<0.5	<0.5	--
07/22/96	153.38	137.06	16.32	--	--	<50	<0.5	<0.5	<0.5	<0.5	--

Table 1
Groundwater Monitoring Data and Analytical Results
Former Chevron Service Station #9-2960
2416 Grove Way
Castro Valley, California

WELL ID/ DATE	TOC* (ft.)	GWE (msl)	DTW (ft.)	SPHT (ft.)	SPH		B (ppb)	T (ppb)	E (ppb)	X (ppb)	MTBE (ppb)
					REMOVED (gallons)	TPH-G (ppb)					
C-5 (cont)											
10/17/96	153.38	136.88	16.50	--	--	<50	<0.5	<0.5	<0.5	<0.5	--
01/23/97	153.38	139.18	14.20	--	--	<50	<0.5	<0.5	<0.5	<0.5	--
ABANDONED											
C-6											
10/03/90	152.84	134.70	18.14	--	--	<50	<0.5	<0.5	<0.5	<0.5	--
10/25/90	152.84	134.55	18.29	--	--	<50	<0.5	1.0	<0.5	<0.5	--
11/09/90	152.84	134.58	18.26	--	--	<50	<0.5	<0.5	<0.5	<0.5	--
01/22/91	152.84	134.69	18.15	--	--	<50	<0.5	<0.5	<0.5	<0.5	--
02/21/91	152.84	134.92	17.92	--	--	--	--	--	--	--	--
04/01/91	152.84	135.73	17.11	--	--	--	--	--	--	--	--
04/11/91	152.84	135.83	17.01	--	--	--	--	--	--	--	--
07/01/91	152.84	135.12	17.72	--	--	--	--	--	--	--	--
09/24/91	152.84	135.72	17.12	--	--	<50	<0.5	<0.5	<0.5	<0.5	--
10/23/91	152.84	134.59	18.25	--	--	--	--	--	--	--	--
11/22/91	152.84	134.79	18.05	--	--	--	--	--	--	--	--
01/09/92	152.84	135.42	17.42	--	--	<50	<0.5	<0.5	<0.5	<0.5	--
03/06/92	152.84	136.33	16.51	--	--	<50	<0.5	<0.5	<0.5	<0.5	--
06/04/92	152.84	135.83	17.01	--	--	<50	<0.5	<0.5	<0.5	<0.5	--
09/28/92	152.84	134.84	18.00	--	--	<50	<0.5	<0.5	<0.5	<0.5	--
12/17/92	152.84	135.58	17.26	--	--	<50	<0.5	<0.5	<0.5	<0.5	--
04/29/93	152.84	136.61	16.23	--	--	<50	<0.5	<0.5	<0.5	<1.5	--
07/29/93	152.84	135.88	16.96	--	--	<50	<0.5	<0.5	<0.5	<1.5	--
10/22/93	152.84	135.38	17.46	--	--	74	7.4	6.1	3.3	9.7	--
01/24/94	152.84	135.38	17.46	--	--	<50	<0.5	<0.5	<0.5	<0.5	--
04/11/94	152.84	135.64	17.20	--	--	<50	<0.5	<0.5	<0.5	<0.5	--
07/01/94	152.84	135.66	17.18	--	--	<50	<0.5	<0.5	<0.5	<0.5	--
10/06/94	152.84	135.19	17.65	--	--	<50	<0.5	<0.5	<0.5	<0.5	--
01/11/95	152.84	136.18	16.66	--	--	<50	<0.5	<0.5	<0.5	<0.5	--
04/07/95	152.84	137.25	15.59	--	--	<50	<0.5	<0.5	<0.5	<0.5	--
07/20/95	152.84	135.80	17.04	--	--	<50	<0.5	<0.5	<0.5	<0.5	--

Table 1
Groundwater Monitoring Data and Analytical Results
Former Chevron Service Station #9-2960
2416 Grove Way
Castro Valley, California

WELL ID/ DATE	TOC* (ft.)	GWE (msl)	DTW (ft.)	SPHT (ft.)	SPH REMOVED (gallons)	TPH-G (ppb)	B (ppb)	T (ppb)	E (ppb)	X (ppb)	MTBE (ppb)
C-6 (cont)											
09/22/95	152.84	135.74	17.10	--	--	<50	<0.5	<0.5	<0.5	<0.5	--
01/02/96	152.84	136.08	16.76	--	--	<50	<0.5	<0.5	<0.5	<0.5	<2.5
04/26/96	152.84	136.64	16.20	--	--	<50	<0.5	<0.5	<0.5	<0.5	--
07/22/96	152.84	135.79	17.05	--	--	<50	<0.5	<0.5	<0.5	<0.5	--
10/17/96	152.84	135.62	17.22	--	--	<50	<0.5	<0.5	<0.5	<0.5	--
01/23/97	152.84	136.99	15.85	--	--	<50	<0.5	<0.5	<0.5	<0.5	--
07/10/97	152.84	135.95	16.89	--	--	<50	<0.5	<0.5	<0.5	<0.5	--
01/15/98	152.84	136.64	16.20	--	--	<50	<0.5	<0.5	<0.5	<0.5	--
01/16/98	152.84	136.74	16.10	--	--	REGAUGE	--	--	--	--	--
07/09/98	152.84	136.71	16.13	--	--	<50	<0.5	<0.5	<0.5	<0.5	--
01/08/99	152.84	137.57	15.27	--	--	<50	<0.5	<0.5	<0.5	<0.5	--
07/09/99	152.84	136.60	16.24	--	--	<50	<0.5	<0.5	<0.5	<0.5	<5.0
02/01/00	152.84	136.57	16.27	--	--	<50	<0.5	<0.5	<0.5	<0.5	<5.0
08/21/00	152.84	UNABLE TO LOCATE - PAVED OVER				--	--	--	--	--	--
01/25/01	152.84	UNABLE TO LOCATE - PAVED OVER				--	--	--	--	--	--
07/10/01	152.84	UNABLE TO LOCATE - PAVED OVER				--	--	--	--	--	--
01/08/02	152.84	UNABLE TO LOCATE - PAVED OVER				--	--	--	--	--	--
03/26/02	152.84	UNABLE TO LOCATE - PAVED OVER				--	--	--	--	--	--
06/17/02	152.84	UNABLE TO LOCATE - PAVED OVER				--	--	--	--	--	--
PAVED OVER											
C-7											
10/03/90	155.34	134.52	20.82	--	--	<50	<0.5	<0.5	<0.5	<0.5	--
10/25/90	155.34	134.43	20.91	--	--	<50	<0.5	1.0	<0.5	<0.5	--
11/09/90	155.34	134.40	20.94	--	--	<50	<0.5	<0.5	<0.5	<0.5	--
01/22/91	155.34	133.84	21.50	--	--	<50	4.0	<0.5	<0.5	<0.5	--
02/21/91	155.34	134.63	20.71	--	--	--	--	--	--	--	--
04/01/91	155.34	135.34	20.00	--	--	--	--	--	--	--	--
04/11/91	155.34	135.29	20.05	--	--	--	--	--	--	--	--
07/01/91	155.34	134.82	20.52	--	--	--	--	--	--	--	--
09/24/91	155.34	134.52	20.82	--	--	<50	<0.5	<0.5	<0.5	<0.5	--

Table 1
Groundwater Monitoring Data and Analytical Results
Former Chevron Service Station #9-2960
2416 Grove Way
Castro Valley, California

WELL ID/ DATE	TOC* (ft.)	GWE (msl)	DTW (ft.)	SPHT (ft.)	SPH REMOVED (gallons)	TPH-G (ppb)	B (ppb)	T (ppb)	E (ppb)	X (ppb)	MTBE (ppb)
C-7 (cont)											
10/23/91	155.34	134.43	20.91	--	--	--	--	--	--	--	--
11/22/91	155.34	134.55	20.79	--	--	--	--	--	--	--	--
01/09/92	155.34	135.18	20.16	--	--	<50	<0.5	<0.5	<0.5	0.9	--
03/06/92	155.34	135.92	19.42	--	--	<50	<0.5	<0.5	<0.5	<0.5	--
06/04/92	155.34	135.53	19.81	--	--	250	<0.5	<0.5	<0.5	<0.5	--
09/28/92	155.34	134.69	20.65	--	--	<50	<0.5	<0.5	<0.5	<0.5	--
12/17/92	155.34	135.32	20.02	--	--	<50	<0.5	<0.5	<0.5	<0.5	--
04/29/93	155.34	136.19	19.15	--	--	<50	<0.5	<0.5	<0.5	<1.5	--
07/26/93	155.34	135.57	19.77	--	--	<50	<0.5	<0.5	<0.5	<1.5	--
10/22/93	155.34	135.17	20.17	--	--	--	--	--	--	--	--
01/24/94	155.34	135.11	20.23	--	--	<50	<0.5	<0.5	<0.5	<0.5	--
04/11/94	155.34	135.39	19.95	--	--	<50	<0.5	<0.5	<0.5	<0.5	--
07/01/94	155.34	135.42	19.92	--	--	<50	<0.5	<0.5	<0.5	<0.5	--
10/06/94	155.34	135.03	20.31	--	--	<50	<0.5	<0.5	<0.5	<0.5	--
01/11/95	155.34	135.98	19.36	--	--	<50	<0.5	<0.5	<0.5	<0.5	--
04/07/95	155.34	136.84	18.50	--	--	<50	<0.5	<0.5	<0.5	<0.5	--
07/20/95	155.34	135.46	19.88	--	--	<50	<0.5	<0.5	<0.5	<0.5	--
09/22/95	155.34	135.38	19.96	--	--	<50	<0.5	<0.5	<0.5	<0.5	--
01/02/96	155.34	135.64	19.70	--	--	<50	<0.5	<0.5	<0.5	<0.5	<2.5
04/26/96	155.34	136.17	19.17	--	--	<50	<0.5	<0.5	<0.5	<0.5	--
07/22/96	155.34	135.49	19.85	--	--	<50	<0.5	<0.5	<0.5	<0.5	--
10/17/96	155.34	135.34	20.00	--	--	<50	<0.5	<0.5	<0.5	<0.5	--
01/23/97	155.34	136.44	18.90	--	--	<50	<0.5	<0.5	<0.5	<0.5	--
07/10/97	155.34	135.58	19.76	--	--	<50	<0.5	<0.5	<0.5	<0.5	--
01/15/98	155.34	136.02	19.32	--	--	<50	<0.5	<0.5	<0.5	<0.5	--
01/16/98	155.34	136.14	19.20	--	--	REGAUGE	--	--	--	--	--
07/09/98	155.34	136.02	19.32	--	--	<50	<0.5	<0.5	<0.5	<0.5	--
01/08/99	155.34	136.83	18.51	--	--	<50	<0.5	<0.5	<0.5	<0.5	--
07/09/99	155.34	136.16	19.18	--	--	<50	<0.5	<0.5	<0.5	<0.5	<5.0
02/01/00	155.34	136.21	19.13	--	--	<50	<0.5	<0.5	<0.5	<0.5	<5.0
08/21/00	155.34	136.16	19.18	0.00	0.00	<50	<0.50	<0.50	<0.50	<0.50	<2.5
01/25/01	155.34	136.09	19.25	0.00	0.00	<50.0	<0.500	<0.500	<0.500	<0.500	<2.50

Table 1
Groundwater Monitoring Data and Analytical Results
Former Chevron Service Station #9-2960
2416 Grove Way
Castro Valley, California

WELL ID/ DATE	TOC+ (ft.)	GWE (msl)	DTW (ft.)	SPHT (ft.)	SPH REMOVED (gallons)	TPH-G (ppb)	B (ppb)	T (ppb)	E (ppb)	X (ppb)	MTBE (ppb)
C-7 (cont)											
07/10/01	155.34	136.17	19.17	0.00	0.00	<50	<0.50	<0.50	<0.50	<0.50	<2.5/<2.0 ¹
01/08/02	155.34	136.31	19.03	0.00	0.00	<50	<0.50	<0.50	<0.50	<1.5	<2.5
03/26/02	155.08	--	--	--	--	--	--	--	--	--	--
NOT MONITORED/SAMPLED											
C-8											
03/26/02 ²	153.41	137.96	15.45	0.00	0.00	11,000	380	130	120	530	<25/<2 ¹
06/17/02	153.41	137.03	16.38	0.00	0.00	11,000	490	65	170	470	<20/<2 ¹
09/17/02	153.41	136.71	16.70	0.00	0.00	6,800	410	12	70	130	46/<2 ¹
12/02/02	153.41	136.61	16.80	0.00	0.00	7,200	440	14	75	140	<20/<2 ¹
03/03/03	153.41	137.61	15.80	0.00	0.00	7,000	330	16	62	110	<10/<0.5 ¹
06/16/03 ³	153.41	137.52	15.89	0.00	0.00	7,400	400	17	71	120	<0.5
09/15/03 ⁴	153.41	136.87	16.54	0.00	0.00	2,500	200	5	56	16	<0.5
12/15/03 ⁴	153.41	137.07	16.34	0.00	0.00	5,900	320	18	51	140	<0.5
03/01/04 ⁴	153.41	138.55	14.86	0.00	0.00	7,800	250	14	61	55	<0.5
06/28/04 ⁴	153.41	137.05	16.36	0.00	0.00	5,700	280	11	46	53	<0.5
TRIP BLANK											
10/03/90	--	--	--	--	--	<50	<0.5	<0.5	<0.5	<0.5	--
10/25/90	--	--	--	--	--	<50	<0.5	<0.5	<0.5	<0.5	--
11/09/90	--	--	--	--	--	<50	<0.5	<0.5	<0.5	<0.5	--
01/22/91	--	--	--	--	--	<50	<0.5	<0.5	<0.5	<0.5	--
09/24/91	--	--	--	--	--	<50	<0.5	<0.5	<0.5	<0.5	--
01/09/92	--	--	--	--	--	<50	<0.5	<0.5	<0.5	<0.5	--
03/06/92	--	--	--	--	--	<50	<0.5	<0.5	<0.5	<0.5	--
06/04/92	--	--	--	--	--	<50	<0.5	<0.5	<0.5	<0.5	--
09/28/92	--	--	--	--	--	<50	<0.5	<0.5	<0.5	<0.5	--
12/17/92	--	--	--	--	--	<50	<0.5	<0.5	<0.5	<0.5	--
04/29/93	--	--	--	--	--	<50	<0.5	<0.5	<0.5	<1.5	--
07/26/93	--	--	--	--	--	<50	<0.5	<0.5	<0.5	<1.5	--

Table 1
Groundwater Monitoring Data and Analytical Results
Former Chevron Service Station #9-2960
2416 Grove Way
Castro Valley, California

WELL ID/ DATE	TOC* (<i>ft.</i>)	GWE (<i>mst</i>)	DTW (<i>ft.</i>)	SPHT (<i>ft.</i>)	SPH REMOVED (<i>gallons</i>)	TPH-G (<i>ppb</i>)	B (<i>ppb</i>)	T (<i>ppb</i>)	E (<i>ppb</i>)	X (<i>ppb</i>)	MTBE (<i>ppb</i>)
TRIP BLANK (cont)											
10/22/93	--	--	--	--	--	<50	<0.5	<0.5	<0.5	<1.5	--
01/24/94	--	--	--	--	--	<50	<0.5	<0.5	<0.5	<0.5	--
04/11/94	--	--	--	--	--	<50	<0.5	<0.5	<0.5	<0.5	--
07/01/94	--	--	--	--	--	<50	<0.5	<0.5	<0.5	<0.5	--
10/06/94	--	--	--	--	--	<50	<0.5	<0.5	<0.5	<0.5	--
01/11/95	--	--	--	--	--	<50	<0.5	<0.5	<0.5	<0.5	--
04/07/95	--	--	--	--	--	<50	<0.5	<0.5	<0.5	<0.5	--
07/20/95	--	--	--	--	--	<50	<0.5	<0.5	<0.5	<0.5	--
09/22/95	--	--	--	--	--	<50	<0.5	<0.5	<0.5	<0.5	--
01/02/96	--	--	--	--	--	<50	<0.5	<0.5	<0.5	<0.5	--
04/26/96	--	--	--	--	--	<50	<0.5	<0.5	<0.5	<0.5	--
07/22/96	--	--	--	--	--	<50	<0.5	<0.5	<0.5	<0.5	--
10/17/96	--	--	--	--	--	<50	<0.5	<0.5	<0.5	<0.5	--
01/23/97	--	--	--	--	--	<50	<0.5	<0.5	<0.5	<0.5	--
07/10/97	--	--	--	--	--	<50	<0.5	<0.5	<0.5	<0.5	--
01/15/98	--	--	--	--	--	<50	<0.5	<0.5	<0.5	<0.5	--
07/09/98	--	--	--	--	--	<50	<0.5	<0.5	<0.5	<0.5	--
01/08/99	--	--	--	--	--	<50	<0.5	<0.5	<0.5	<0.5	--
02/01/00	--	--	--	--	--	<50	<0.5	<0.5	<0.5	<0.5	<5.0
08/21/00	--	--	--	--	--	<50	<0.50	<0.50	<0.50	<0.50	<2.5
01/25/01	--	--	--	--	--	<50.0	<0.500	<0.500	<0.500	<0.500	<2.50
07/10/01	--	--	--	--	--	<50	<0.50	<0.50	<0.50	<0.50	<2.5
QA											
01/08/02	--	--	--	--	--	<50	<0.50	<0.50	<0.50	<1.5	<2.5
03/26/02	--	--	--	--	--	<50	<0.50	<0.50	<0.50	<1.5	<2.5
06/17/02	--	--	--	--	--	<50	<0.50	<0.50	<0.50	<1.5	<2.5
09/17/02	--	--	--	--	--	<50	<0.50	<0.50	<0.50	<1.5	<2.5
12/02/02	--	--	--	--	--	<50	<0.50	<0.50	<0.50	<1.5	<2.5
03/03/03	--	--	--	--	--	<50	<0.50	<0.50	<0.50	<1.5	<2.5
06/16/03	--	--	--	--	--	<50	<0.5	<0.5	<0.5	<0.5	<0.5

Table 1
Groundwater Monitoring Data and Analytical Results
Former Chevron Service Station #9-2960
2416 Grove Way
Castro Valley, California

WELL ID/ DATE	TOC* (ft.)	GWE (msl)	DTW (ft.)	SPHT (ft.)	SPH REMOVED (gallons)	TPH-G (ppb)	B (ppb)	T (ppb)	E (ppb)	X (ppb)	MTBE (ppb)
QA (cont)											
09/15/03 ⁴	--	--	--	--	--	<50	<0.5	<0.5	<0.5	<0.5	<0.5
12/15/03 ⁴	--	--	--	--	--	<50	<0.5	<0.5	<0.5	<0.5	<0.5
03/01/04 ⁴	--	--	--	--	--	<50	<0.5	<0.5	<0.5	<0.5	<0.5
06/28/04 ⁴	--	--	--	--	--	<50	<0.5	<0.5	<0.5	<0.5	<0.5

Table 1
Groundwater Monitoring Data and Analytical Results
Former Chevron Service Station #9-2960
2416 Grove Way
Castro Valley, California

EXPLANATIONS:

Groundwater monitoring data and laboratory analytical results prior to August 21, 2000, were compiled from reports prepared by Blaine Tech Services, Inc.

TOC = Top of Casing

(ft.) = Feet

GWE = Groundwater Elevation

(msl) = Mean sea level

DTW = Depth to Water

SPHT = Separate Phase Hydrocarbons Thickness

TPH-G = Total Petroleum Hydrocarbons as Gasoline

B = Benzene

T = Toluene

E = Ethylbenzene

X = Xylenes

MTBE = Methyl tertiary butyl ether

(ppb) = Parts per billion

-- = Not Measured/Not Analyzed

QA = Quality Assurance/Trip Blank

* TOC elevations were surveyed in April 2002, by Morrow Surveying. Elevations are based on Alameda County Benchmark No. 259, brass disc top of concrete guard rail & retaining wall abutment along east side "A" Street and on CL + N. 5th Street extended, (Elevation = 138.79 feet).

¹ MTBE by EPA Method 8260.

² Well development performed.

³ TPH-G, BTEX and MTBE by EPA Method 8260.

⁴ BTEX and MTBE by EPA Method 8260.

Table 2
Groundwater Analytical Results - Oxygenate Compounds
Former Chevron Service Station #9-2960
2416 Grove Way
Castro Valley, California

WELL ID	DATE	TBA (ppb)	MTBE (ppb)	DIPE (ppb)	ETBE (ppb)	TAME (ppb)
C-7	07/10/01	<20	<2.0	<2.0	<2.0	<2.0
C-8	03/26/02	<100	<2	<2	<2	<2
	06/17/02	<100	<2	<2	<2	<2
	09/17/02	<100	<2	<2	<2	<2
	12/02/02	<100	<2	<2	<2	<2
	03/03/03	<5	<0.5	<0.5	<0.5	<0.5
	06/16/03	<5	<0.5	<0.5	<0.5	<0.5
	09/15/03	5	<0.5	<0.5	<0.5	<0.5
	12/15/03	<5	<0.5	<0.5	<0.5	<0.5
	03/01/04	<5	<0.5	<0.5	<0.5	<0.5
	06/28/04	<5	<0.5	<0.5	<0.5	<0.5

EXPLANATIONS:

TBA = Tertiary butyl alcohol
MTBE = Methyl tertiary butyl ether
DIPE = Di-isopropyl ether
ETBE = Ethyl tertiary butyl ether
TAME = Tertiary amyl methyl ether
(ppb) = Parts per billion

ANALYTICAL METHOD:

EPA Method 8260 for Oxygenate Compounds

STANDARD OPERATING PROCEDURE - GROUNDWATER SAMPLING

Gettler-Ryan Inc. field personnel adhere to the following procedures for the collection and handling of groundwater samples prior to analysis by the analytical laboratory. Prior to sample collection, the type of analysis to be performed is determined. Loss prevention of volatile compounds is controlled and sample preservation for subsequent analysis is maintained.

Prior to sampling, the presence or absence of free-phase hydrocarbons is determined using an interface probe. Product thickness, if present, is measured to the nearest 0.01 foot and is noted in the field notes. In addition, all depth to water level measurements are collected with a static water level indicator and are also recorded in the field notes, prior to purging and sampling any wells.

After water levels are collected and prior to sampling, if purging is to occur, each well is purged a minimum of three well casing volumes of water using pre-cleaned pumps (stack, suction, Grundfos), or disposable bailers. Temperature, pH and electrical conductivity are measured a minimum of three times during the purging. Purging continues until these parameters stabilize.

Groundwater samples are collected using disposable bailers. The water samples are transferred from the bailer into appropriate containers. Pre-preserved containers, supplied by analytical laboratories, are used when possible. When pre-preserved containers are not available, the laboratory is instructed to preserve the sample as appropriate. Duplicate samples are collected for the laboratory to use in maintaining quality assurance/quality control standards. The samples are labeled to include the job number, sample identification, collection date and time, analysis, preservation (if any), and the sample collector's initials. The water samples are placed in a cooler, maintained at 4°C for transport to the laboratory. Once collected in the field, all samples are maintained under chain of custody until delivered to the laboratory.

The chain of custody document includes the job number, type of preservation, if any, analysis requested, sample identification, date and time collected, and the sample collector's name. The chain of custody is signed and dated (including time of transfer) by each person who receives or surrenders the samples, beginning with the field personnel and ending with the laboratory personnel.

A laboratory supplied trip blank accompanies each sampling set. For sampling sets greater than 20 samples, 5% trip blanks are included. The trip blank is analyzed for some or all of the same compounds as the groundwater samples.

As requested by ChevronTexaco Company, the purge water and decontamination water generated during sampling activities is transported by IWM to McKittrick Waste Management located in McKittrick, California.



GETTLER - RYAN INC.

WELL MONITORING/SAMPLING FIELD DATA SHEET

Client/Facility #: ChevronTexaco #9-2960 Job Number: 386365
 Site Address: 2416 Grove Way Event Date: 6/28/04 (inclusive)
 City: Castro Valley, CA Sampler: Jim Herrew

Well ID: C-8 Date Monitored: 6/28/04 Well Condition: OK
 Well Diameter: 2 in.
 Total Depth: 24.45 ft.
 Depth to Water: 16.36 ft.
8.09 xVF .17 = 1.37 x3 case volume = Estimated Purge Volume: 4.12 gal.

Volume	3/4"= 0.02	1"= 0.04	2"= 0.17	3"= 0.38
Factor (VF)	4"= 0.66	5"= 1.02	6"= 1.50	12"= 5.80

Purge Equipment:
 Disposable Bailer X
 Stainless Steel Bailer _____
 Stack Pump _____
 Suction Pump _____
 Grundfos _____
 Other: _____

Sampling Equipment:
 Disposable Bailer X
 Pressure Bailer _____
 Discrete Bailer _____
 Other: _____

Time Started: _____ (2400 hrs)
 Time Bailed: _____ (2400 hrs)
 Depth to Product: _____ ft
 Depth to Water: _____ ft
 Hydrocarbon Thickness: _____ ft
 Visual Confirmation/Description: _____
 Skimmer / Absorbant Sock (circle one)
 Amt Removed from Skimmer: _____ gal
 Amt Removed from Well: _____ gal
 Water Removed: _____
 Product Transferred to: _____

Start Time (purge): 1315 Weather Conditions: clear
 Sample Time/Date: 1335 / 6/28/04 Water Color: cloudy Odor: no
 Purging Flow Rate: _____ gpm. Sediment Description: light
 Did well de-water? no If yes, Time: _____ Volume: _____ gal.

Time (2400 hr.)	Volume (gal.)	pH	Conductivity (umhos/cm)	Temperature (C/F)	D.O. (mg/L)	ORP (mV)
<u>1319</u>	<u>1</u>	<u>7.05</u>	<u>1211</u>	<u>21.7</u>	_____	_____
<u>1322</u>	<u>2</u>	<u>6.87</u>	<u>1252</u>	<u>21.5</u>	_____	_____
<u>1326</u>	<u>3</u>	<u>6.72</u>	<u>1267</u>	<u>21.0</u>	_____	_____
_____	_____	_____	_____	_____	_____	_____

LABORATORY INFORMATION

SAMPLE ID	(#) CONTAINER	REFRIG.	PRESERV. TYPE	LABORATORY	ANALYSES
C-8	<u>6</u> x voa vial	YES	HCL	LANCASTER	TPH-G(8015)/BTEX+MTBE(8260)/ 5 OXYS(8260)

COMMENTS:

Add/Replaced Lock: _____ Add/Replaced Plug: _____ Size: _____



Analysis Report

2425 New Holland Pike, PO Box 12425, Lancaster, PA 17605-2425 • 717-656-2300 Fax: 717-656-2661 • www.lancasterlabs.com

ANALYTICAL RESULTS

Prepared for:

ChevronTexaco c/o Cambria
Suite 9
4111 Citrus Avenue
Rocklin CA 95677
916-630-1855

Prepared by:

Lancaster Laboratories
2425 New Holland Pike
Lancaster, PA 17605-2425

W. P. STEWART
K. M. HIGLEY
GETTLER-RYAN, INC.
GENERAL CONTRACTORS

SAMPLE GROUP

The sample group for this submittal is 902139. Samples arrived at the laboratory on Thursday, July 01, 2004. The PO# for this group is 99011184 and the release number is MT1.

Client Description

QA-T-040628	NA	Water
C-8-W-040628	Grab	Water

Lancaster Labs Number

4303592
4303593

1 COPY TO
ELECTRONIC
COPY TO

Cambria C/O Gettler- Ryan
Gettler-Ryan

Attn: Deanna L. Harding
Attn: Cheryl Hansen

Questions? Contact your Client Services Representative
Teresa L Cunningham at (717) 656-2300.

Respectfully Submitted,



Victoria M. Martell
Chemist

Lancaster Laboratories Sample No. WW 4303592

QA-T-040628 NA Water
 Facility# 92960 Job# 386365 MTI# 61D-1964 GRD
 2416 Grove-Castro Valley T0600100318 QA
 Collected: 06/28/2004

Account Number: 10904

Submitted: 07/01/2004 08:40
 Reported: 07/12/2004 at 15:55
 Discard: 08/12/2004

ChevronTexaco c/o Cambria
 Suite 9
 4111 Citrus Avenue
 Rocklin CA 95677

VALQA

CAT No.	Analysis Name	CAS Number	As Received Result	As Received Method Detection Limit	Units	Dilution Factor
01728	TPH-GRO - Waters The reported concentration of TPH-GRO does not include MTBE or other gasoline constituents eluting prior to the C6 (n-hexane) TPH-GRO range start time.	n.a.	N.D.	50.	ug/l	1
06054	BTEX+MTBE by 8260B					
02010	Methyl Tertiary Butyl Ether	1634-04-4	N.D.	0.5	ug/l	1
05401	Benzene	71-43-2	N.D.	0.5	ug/l	1
05407	Toluene	108-88-3	N.D.	0.5	ug/l	1
05415	Ethylbenzene	100-41-4	N.D.	0.5	ug/l	1
06310	Xylene (Total)	1330-20-7	N.D.	0.5	ug/l	1

State of California Lab Certification No. 2116

Laboratory Chronicle

CAT No.	Analysis Name	Method	Analysis		Analyst	Dilution Factor
			Trial#	Date and Time		
01728	TPH-GRO - Waters	N. CA LUFT Gasoline Method	1	07/06/2004 10:46	Linda C Pape	1
06054	BTEX+MTBE by 8260B	SW-846 8260B	1	07/07/2004 16:00	Shawn J Rice	1
01146	GC VOA Water Prep	SW-846 5030B	1	07/06/2004 10:46	Linda C Pape	n.a.
01163	GC/MS VOA Water Prep	SW-846 5030B	1	07/07/2004 16:00	Shawn J Rice	n.a.



Analysis Report

2425 New Holland Pike, PO Box 12425, Lancaster, PA 17605-2425 • 717-656-2300 Fax: 717-656-2681 • www.lancasterlabs.com

Page 1 of 1

Lancaster Laboratories Sample No. WW 4303593

C-8-W-040628 Grab Water
 Facility# 92960 Job# 386365 MTI# 61D-1964 GRD
 2416 Grove-Castro Valley T0600100318 C-8
 Collected: 06/28/2004 13:35 by JH

Account Number: 10904

Submitted: 07/01/2004 08:40
 Reported: 07/12/2004 at 15:55
 Discard: 08/12/2004

ChevronTexaco c/o Cambria
 Suite 2
 4111 Citrus Avenue
 Rocklin CA 95677

VALC8

CAT No.	Analysis Name	CAS Number	As Received Result	As Received Method Detection Limit	Units	Dilution Factor
01728	TPH-GRO - Waters	n.a.	5,700.	500.	ug/l	10
The reported concentration of TPH-GRO does not include MTBE or other gasoline constituents eluting prior to the C6 (n-hexane) TPH-GRO range start time.						
06056	BTEX+5 Oxygenates by 8260B					
02010	Methyl Tertiary Butyl Ether	1634-04-4	N.D.	0.5	ug/l	1
02011	di-Isopropyl ether	108-20-3	N.D.	0.5	ug/l	1
02013	Ethyl t-butyl ether	637-92-3	N.D.	0.5	ug/l	1
02014	t-Amyl methyl ether	994-05-8	N.D.	0.5	ug/l	1
02015	t-Butyl alcohol	75-65-0	N.D.	5.	ug/l	1
05401	Benzene	71-43-2	280.	5.	ug/l	10
05407	Toluene	108-88-3	11.	0.5	ug/l	1
05415	Ethylbenzene	100-41-4	46.	0.5	ug/l	1
06310	Xylene (Total)	1330-20-7	53.	0.5	ug/l	1

State of California Lab Certification No. 2116

Laboratory Chronicle

CAT No.	Analysis Name	Method	Analysis		Analyst	Dilution Factor
			Trial#	Date and Time		
01728	TPH-GRO - Waters	N. CA LUFT Gasoline Method	1	07/06/2004 17:50	Michael F Barrow	10
06056	BTEX+5 Oxygenates by 8260B	SW-846 8260B	1	07/08/2004 07:31	Marc S Neal	1
06056	BTEX+5 Oxygenates by 8260B	SW-846 8260B	1	07/08/2004 07:58	Marc S Neal	10
01146	GC VOA Water Prep	SW-846 5030B	1	07/06/2004 17:50	Michael F Barrow	n.a.
01163	GC/MS VOA Water Prep	SW-846 5030B	1	07/08/2004 07:31	Marc S Neal	n.a.

Quality Control Summary

 Client Name: ChevronTexaco c/o Cambria
 Reported: 07/12/04 at 03:55 PM

Group Number: 902139

Matrix QC may not be reported if site-specific QC samples were not submitted. In these situations, to demonstrate precision and accuracy at a batch level, a LCS/LCSD was performed, unless otherwise specified in the method.

Laboratory Compliance Quality Control

Analysis Name	Blank Result	Blank MDL	Report Units	LCS %REC	LCSD %REC	LCS/LCSD Limits	RPD	RPD Max
Batch number: 04188A08B TPH-GRO - Waters	N.D.	50.	Sample number(s): 4303593 ug/l	102	106	70-130	5	30
Batch number: 04188A51A TPH-GRO - Waters	N.D.	50.	Sample number(s): 4303592 ug/l	100	103	70-130	3	30
Batch number: P041891AA Methyl Tertiary Butyl Ether	N.D.	0.5	Sample number(s): 4303592 ug/l	98		77-127		
Benzene	N.D.	0.5	ug/l	98		85-117		
Toluene	N.D.	0.5	ug/l	100		85-115		
Ethylbenzene	N.D.	0.5	ug/l	101		82-119		
Xylene (Total)	N.D.	0.5	ug/l	101		84-120		
Batch number: Z041894AA Methyl Tertiary Butyl Ether	N.D.	0.5	Sample number(s): 4303593 ug/l	105		77-127		
di-Isopropyl ether	N.D.	0.5	ug/l	108		67-130		
Ethyl t-butyl ether	N.D.	0.5	ug/l	100		74-120		
t-Amyl methyl ether	N.D.	0.5	ug/l	92		79-113		
t-Butyl alcohol	N.D.	5.	ug/l	91		57-141		
Benzene	N.D.	0.5	ug/l	102		85-117		
Toluene	N.D.	0.5	ug/l	100		85-115		
Ethylbenzene	N.D.	0.5	ug/l	97		82-119		
Xylene (Total)	N.D.	0.5	ug/l	93		84-120		

Sample Matrix Quality Control

Analysis Name	MS %REC	MSD %REC	MS/MSD Limits	RPD	RPD MAX	BKG Conc	DUP Conc	DUP RPD	Dup RPD Max
Batch number: 04188A08B TPH-GRO - Waters			Sample number(s): 4303593 116 63-154						
Batch number: 04188A51A TPH-GRO - Waters			Sample number(s): 4303592 116 63-154						
Batch number: P041891AA Methyl Tertiary Butyl Ether	97	96	69-134	1	30				
Benzene	104	102	83-128	2	30				
Toluene	106	104	83-127	2	30				
Ethylbenzene	105	105	82-129	0	30				
Xylene (Total)	106	105	82-130	1	30				

*- Outside of specification

- (1) The result for one or both determinations was less than five times the LOQ.
- (2) The background result was more than four times the spike added.

Quality Control Summary

 Client Name: ChevronTexaco c/o Cambria
 Reported: 07/12/04 at 03:55 PM

Group Number: 902139

Sample Matrix Quality Control

Analysis Name	MS %REC	MCD %REC	MS/MCD Limits	RPD	RPD MAX	BYC Conc	PNP Conc	MPD RPD	MPD Max
Batch number: Z041894AA	Sample number(s): 4303593								
Methyl Tertiary Butyl Ether	105	104	69-134	0	30				
di-Isopropyl ether	110	107	75-130	2	30				
Ethyl t-butyl ether	100	100	78-119	0	30				
t-Amyl methyl ether	94	93	77-117	0	30				
t-Butyl alcohol	89	88	51-147	2	30				
Benzene	104	102	83-128	1	30				
Toluene	101	100	83-127	2	30				
Ethylbenzene	98	97	82-129	1	30				
Xylene (Total)	93	93	82-130	1	30				

Surrogate Quality Control

 Analysis Name: TPH-GRO - Waters
 Batch number: 04188A08E
 Trifluorotoluene-F

4303593	118
Blank	104
LCS	108
LCSD	106
MS	112

Limits: 57-146

 Analysis Name: TPH-GRO - Waters
 Batch number: 04188A51A
 Trifluorotoluene-F

4303592	105
Blank	106
LCS	112
LCSD	108
MS	111

Limits: 57-146

 Analysis Name: BTEX+MTBE by 8260B
 Batch number: P041891AA
 Dibromofluoromethane 1,2-Dichloroethane-d4 Toluene-d8 4-Bromofluorobenzene

4303592	106	104	109	102
Blank	106	104	109	103
LCS	110	110	112	105
MS	107	105	110	103
MSD	107	106	108	104

Limits: 61-120 82-112 85-112 83-113

 Analysis Name: BTEX+5 Oxygenates by 8260B
 Batch number: Z041894AA
 Dibromofluoromethane 1,2-Dichloroethane-d4 Toluene-d8 4-Bromofluorobenzene

*- Outside of specification

- (1) The result for one or both determinations was less than five times the LOQ.
- (2) The background result was more than four times the spike added.

Quality Control Summary

Client Name: ChevronTexaco c/o Cambria
Reported: 07/12/04 at 03:55 PM

Group Number: 902139

Surrogate Quality Control

4303E93	99	99	107	102
Blank	99	97	105	92
LCS	99	98	105	94
MS	98	96	105	94
MSD	98	97	105	95
Limits:	81-120	82-112	85-112	83-113

*- Outside of specification

- (1) The result for one or both determinations was less than five times the LOQ.
- (2) The background result was more than four times the spike added.

Explanation of Symbols and Abbreviations

The following defines common symbols and abbreviations used in reporting technical data:

N.D.	none detected	BMQL	Below Minimum Quantitation Level
TNTC	Too Numerous To Count	MPN	Most Probable Number
IU	International Units	CP Units	cobalt-chloroplatinate units
umhos/cm	micromhos/cm	NTU	nephelometric turbidity units
C	degrees Celsius	F	degrees Fahrenheit
meq	milliequivalents	lb.	pound(s)
g	gram(s)	kg	kilogram(s)
ug	microgram(s)	mg	milligram(s)
ml	milliliter(s)	l	liter(s)
m3	cubic meter(s)	ul	microliter(s)
<	less than - The number following the sign is the <u>limit of quantitation</u> , the smallest amount of analyte which can be reliably determined using this specific test.		
>	greater than		
J	estimated value - The result is \geq the Method Detection Limit (MDL) and $<$ the Limit of Quantitation (LOQ).		
ppm	parts per million - One ppm is equivalent to one milligram per kilogram (mg/kg), or one gram per million grams. For aqueous liquids, ppm is usually taken to be equivalent to milligrams per liter (mg/l), because one liter of water has a weight very close to a kilogram. For gases or vapors, one ppm is equivalent to one microliter of gas per liter of gas.		
ppb	parts per billion		
Dry weight basis	Results printed under this heading have been adjusted for moisture content. This increases the analyte weight concentration to approximate the value present in a similar sample without moisture. All other results are reported on an as-received basis.		

U.S. EPA CLP Data Qualifiers:

Organic Qualifiers	Inorganic Qualifiers
A TIC is a possible aldol-condensation product	B Value is $<$ CRDL, but \geq IDL
B Analyte was also detected in the blank	E Estimated due to interference
C Pesticide result confirmed by GC/MS	M Duplicate injection precision not met
D Compound quantitated on a diluted sample	N Spike sample not within control limits
E Concentration exceeds the calibration range of the instrument	S Method of standard additions (MSA) used for calculation
N Presumptive evidence of a compound (TICs only)	U Compound was not detected
P Concentration difference between primary and confirmation columns $>$ 25%	W Post digestion spike out of control limits
U Compound was not detected	* Duplicate analysis not within control limits
X,Y,Z Defined in case narrative	+ Correlation coefficient for MSA $<$ 0.995

Analytical test results for methods listed on the laboratories' accreditation scope meet all requirements of NELAC unless otherwise noted under the individual analysis.

Measurement uncertainty values, as applicable, are available upon request.

Tests results relate only to the sample tested. Clients should be aware that a critical step in a chemical or microbiological analysis is the collection of the sample. Unless the sample analyzed is truly representative of the bulk of material involved, the test results will be meaningless. If you have questions regarding the proper techniques of collecting samples, please contact us. We cannot be held responsible for sample integrity, however, unless sampling has been performed by a member of our staff. This report shall not be reproduced except in full, without the written approval of the laboratory.

WARRANTY AND LIMITS OF LIABILITY - In accepting analytical work, we warrant the accuracy of test results for the sample as submitted. THE FOREGOING EXPRESS WARRANTY IS EXCLUSIVE AND IS GIVEN IN LIEU OF ALL OTHER WARRANTIES, EXPRESSED OR IMPLIED. WE DISCLAIM ANY OTHER WARRANTIES, EXPRESSED OR IMPLIED, INCLUDING A WARRANTY OF FITNESS FOR PARTICULAR PURPOSE AND WARRANTY OF MERCHANTABILITY. IN NO EVENT SHALL LANCASTER LABORATORIES BE LIABLE FOR INDIRECT, SPECIAL, CONSEQUENTIAL, OR INCIDENTAL DAMAGES INCLUDING, BUT NOT LIMITED TO, DAMAGES FOR LOSS OF PROFIT OR GOODWILL REGARDLESS OF (A) THE NEGLIGENCE (EITHER SOLE OR CONCURRENT) OF LANCASTER LABORATORIES AND (B) WHETHER LANCASTER LABORATORIES HAS BEEN INFORMED OF THE POSSIBILITY OF SUCH DAMAGES. We accept no legal responsibility for the purposes for which the client uses the test results. No purchase order or other order for work shall be accepted by Lancaster Laboratories which includes any conditions that vary from the Standard Terms and Conditions of Lancaster Laboratories and we hereby object to any conflicting terms contained in any acceptance or order submitted by client.