

10-275



GETTLER-RYAN INC.

TRANSMITTAL

Alameda County

January 9, 2003

G-R #386365

JAN 29 2003

Environmental Health

CC: Ms. Karen Streich
Chevron Products Company
P.O. Box 6004
San Ramon, California 94583

TO: Mr. James Brownell
Delta Environmental Consultants, Inc.
3164 Gold Camp Drive, Suite 200
Rancho Cordova, California 95670

FROM: Deanna L. Harding
Project Coordinator
Gettler-Ryan Inc.
6747 Sierra Court, Suite J
Dublin, California 94568

RE: Former Chevron Service Station
#9-2960
2416 Grove Way
Castro Valley, California

WE HAVE ENCLOSED THE FOLLOWING:

COPIES	DATED	DESCRIPTION
1	January 3, 2003	Groundwater Monitoring and Sampling Report Fourth Quarter - Event of December 2, 2002

COMMENTS:

Please provide any comments/changes and propose any groundwater monitoring modifications for the next event prior to **January 23, 2003**, at which time the final report will be distributed to the following:

- cc: Mr. Amir Gholami, Alameda County Health Care Services, Dept. of Environmental Health, 1181 Harbor Bay Parkway, Suite 250, Alameda, CA 94502-6577
 Mr. Phil Conley, President Board of Trustees, First Presbyterian Church, 2490 Grove Way, Castro Valley, CA 94546
 Mr. Greg Gurss, Gettler-Ryan Inc., 3140 Gold Camp Drive, Suite 170, Rancho Cordova, CA 95670

Enclosures



GETTLER-RYAN INC.

January 3, 2003
G-R Job #386365

Ms. Karen Streich
Chevron Products Company
P.O. Box 6004
San Ramon, CA 94583

RE: Fourth Quarter Event of December 2, 2002
Groundwater Monitoring & Sampling Report
Former Chevron Service Station #9-2960
2416 Grove Way
Castro Valley, California

Dear Ms. Streich:

This report documents the most recent groundwater monitoring and sampling event performed by Gettler-Ryan Inc. (G-R) at the referenced site. All field work was conducted in accordance with G-R Standard Operating Procedure - Groundwater Sampling (attached).

The static groundwater level was measured and the well was checked for the presence of separate-phase hydrocarbons. Static water level data, groundwater elevations, and separate-phase hydrocarbon thickness (if any) are presented in the attached Table 1. A Groundwater Elevation Map is included as Figure 1.

Groundwater samples were collected from the monitoring well and submitted to a state certified laboratory for analyses. The field data sheets for this event are attached. Analytical results are presented in the table(s) listed below. The chain of custody document and laboratory analytical report are also attached.

Please call if you have any questions or comments regarding this report. Thank you.

Sincerely,

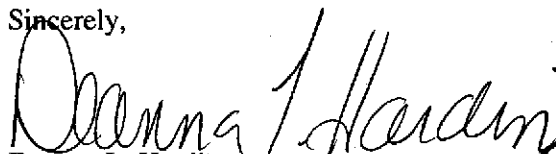
Deanna L. Harding
Project Coordinator

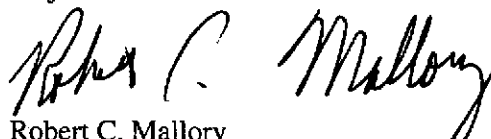
Robert C. Mallory
Registered Geologist No. 7285

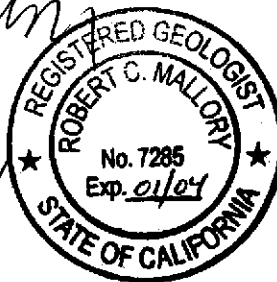
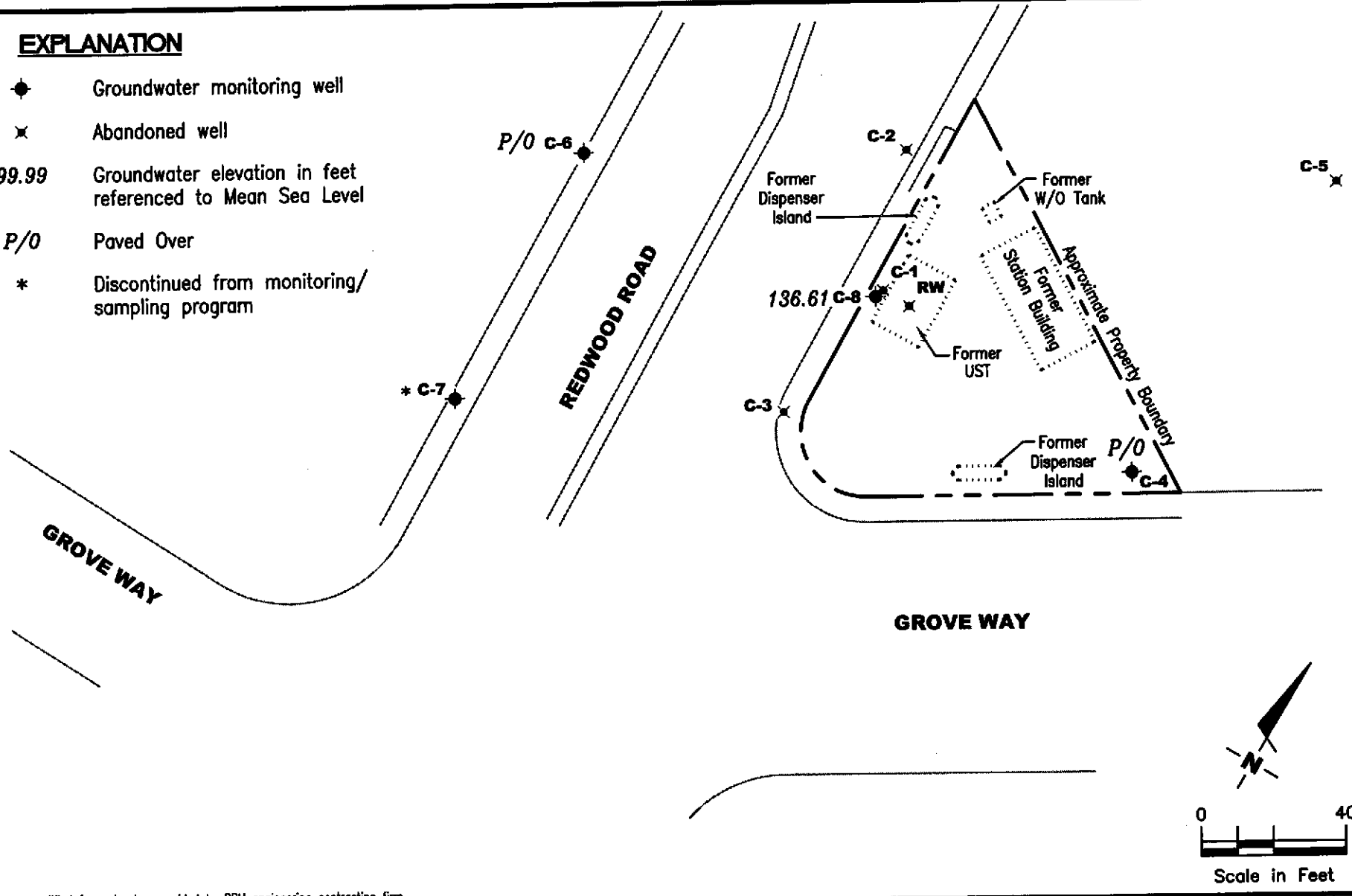

Figure 1: Groundwater Elevation Map
Table 1: Groundwater Monitoring Data and Analytical Results
Table 2: Groundwater Analytical Results - Oxygenate Compounds
Attachments: Standard Operating Procedure - Groundwater Sampling
Field Data Sheets
Chain of Custody Document and Laboratory Analytical Reports

EXPLANATION

- ◆ Groundwater monitoring well
- ✕ Abandoned well
- 99.99 Groundwater elevation in feet referenced to Mean Sea Level
- P/O Paved Over
- * Discontinued from monitoring/sampling program



Source: Figure modified from drawing provided by RRM engineering contracting firm.

GETTLER - RYAN INC.
 6747 Sierra Ct., Suite J
 Dublin, CA 94568 (925) 551-7555

GROUNDWATER ELEVATION MAP
 Former Chevron Service Station #9-2960
 2416 Grove Way
 Castro Valley, California

FIGURE
1

PROJECT NUMBER
386365

REVIEWED BY

DATE
 December 2, 2002

REVISED DATE

Table 1
Groundwater Monitoring Data and Analytical Results
Former Chevron Service Station #9-2960
2416 Grove Way
Castro Valley, California

WELL ID/ DATE	TOC* (ft.)	GWE (msl)	DTW (ft.)	SPHT (ft.)	SPH REMOVED (gallons)	TPH-G (ppb)	B (ppb)	T (ppb)	E (ppb)	X (ppb)	MTBE (ppb)
TRIP BLANK (cont)											
03/06/92	--	--	--	--	--	<50	<0.5	<0.5	<0.5	<0.5	--
06/04/92	--	--	--	--	--	<50	<0.5	<0.5	<0.5	<0.5	--
09/28/92	--	--	--	--	--	<50	<0.5	<0.5	<0.5	<0.5	--
12/17/92	--	--	--	--	--	<50	<0.5	<0.5	<0.5	<0.5	--
04/29/93	--	--	--	--	--	<50	<0.5	<0.5	<0.5	<1.5	--
07/26/93	--	--	--	--	--	<50	<0.5	<0.5	<0.5	<1.5	--
10/22/93	--	--	--	--	--	<50	<0.5	<0.5	<0.5	<0.5	--
01/24/94	--	--	--	--	--	<50	<0.5	<0.5	<0.5	<0.5	--
04/11/94	--	--	--	--	--	<50	<0.5	<0.5	<0.5	<0.5	--
07/01/94	--	--	--	--	--	<50	<0.5	<0.5	<0.5	<0.5	--
10/06/94	--	--	--	--	--	<50	<0.5	<0.5	<0.5	<0.5	--
01/11/95	--	--	--	--	--	<50	<0.5	<0.5	<0.5	<0.5	--
04/07/95	--	--	--	--	--	<50	<0.5	<0.5	<0.5	<0.5	--
07/20/95	--	--	--	--	--	<50	<0.5	<0.5	<0.5	<0.5	--
09/22/95	--	--	--	--	--	<50	<0.5	<0.5	<0.5	<0.5	--
01/02/96	--	--	--	--	--	<50	<0.5	<0.5	<0.5	<0.5	--
04/26/96	--	--	--	--	--	<50	<0.5	<0.5	<0.5	<0.5	--
07/22/96	--	--	--	--	--	<50	<0.5	<0.5	<0.5	<0.5	--
10/17/96	--	--	--	--	--	<50	<0.5	<0.5	<0.5	<0.5	--
01/23/97	--	--	--	--	--	<50	<0.5	<0.5	<0.5	<0.5	--
07/10/97	--	--	--	--	--	<50	<0.5	<0.5	<0.5	<0.5	--
01/15/98	--	--	--	--	--	<50	<0.5	<0.5	<0.5	<0.5	--
07/09/98	--	--	--	--	--	<50	<0.5	<0.5	<0.5	<0.5	--
01/08/99	--	--	--	--	--	<50	<0.5	<0.5	<0.5	<0.5	--
02/01/00	--	--	--	--	--	<50	<0.5	<0.5	<0.5	<0.5	<5.0
08/21/00	--	--	--	--	--	<50	<0.50	<0.50	<0.50	<0.50	<2.5
01/25/01	--	--	--	--	--	<50.0	<0.500	<0.500	<0.500	<0.500	<2.50
07/10/01	--	--	--	--	--	<50	<0.50	<0.50	<0.50	<0.50	<2.5
QA											
01/08/02	--	--	--	--	--	<50	<0.50	<0.50	<0.50	<1.5	<2.5
03/26/02	--	--	--	--	--	<50	<0.50	<0.50	<0.50	<1.5	<2.5

Table 1
Groundwater Monitoring Data and Analytical Results
Former Chevron Service Station #9-2960
2416 Grove Way
Castro Valley, California

WELL ID/ DATE	TOC* (ft.)	GWE (msl)	DTW (ft.)	SPHT (ft.)	SPH REMOVED (gallons)	TPH-G (ppb)	B (ppb)	T (ppb)	E (ppb)	X (ppb)	MTBE (ppb)
C-7 (cont)											
10/17/96	155.34	135.34	20.00	--	--	<50	<0.5	<0.5	<0.5	<0.5	--
01/23/97	155.34	136.44	18.90	--	--	<50	<0.5	<0.5	<0.5	<0.5	--
07/10/97	155.34	135.58	19.76	--	--	<50	<0.5	<0.5	<0.5	<0.5	--
01/15/98	155.34	136.02	19.32	--	--	<50	<0.5	<0.5	<0.5	<0.5	--
01/16/98	155.34	136.14	19.20	--	--	REGAUGE	--	--	--	--	--
07/09/98	155.34	136.02	19.32	--	--	<50	<0.5	<0.5	<0.5	<0.5	--
01/08/99	155.34	136.83	18.51	--	--	<50	<0.5	<0.5	<0.5	<0.5	<5.0
07/09/99	155.34	136.16	19.18	--	--	<50	<0.5	<0.5	<0.5	<0.5	<5.0
02/01/00	155.34	136.21	19.13	--	--	<50	<0.5	<0.5	<0.5	<0.5	<2.5
08/21/00	155.34	136.16	19.18	0.00	0.00	<50	<0.50	<0.50	<0.50	<0.50	<2.5
01/25/01	155.34	136.09	19.25	0.00	0.00	<50.0	<0.500	<0.500	<0.500	<0.500	<2.50
07/10/01	155.34	136.17	19.17	0.00	0.00	<50	<0.50	<0.50	<0.50	<0.50	<2.5/<2.0 ¹
01/08/02	155.34	136.31	19.03	0.00	0.00	<50	<0.50	<0.50	<0.50	<1.5	<2.5
03/26/02	155.08	--	--	--	--	--	--	--	--	--	--
NOT MONITORED / SAMPLED											
C-8											
03/26/02 ²	153.41	137.96	15.45	0.00	0.00	11,000	380	130	120	530	<25/<2 ¹
06/17/02	153.41	137.03	16.38	0.00	0.00	11,000	490	65	170	470	<20/<2 ¹
09/17/02	153.41	136.71	16.70	0.00	0.00	6,800	410	12	70	130	46/<2 ¹
12/02/02	153.41	136.61	16.80	0.00	0.00	7,200	440	14	75	140	<20/<2 ¹
TRIP BLANK											
10/03/90	--	--	--	--	--	<50	<0.5	<0.5	<0.5	<0.5	--
10/25/90	--	--	--	--	--	<50	<0.5	<0.5	<0.5	<0.5	--
11/09/90	--	--	--	--	--	<50	<0.5	<0.5	<0.5	<0.5	--
01/22/91	--	--	--	--	--	<50	<0.5	<0.5	<0.5	<0.5	--
09/24/91	--	--	--	--	--	<50	<0.5	<0.5	<0.5	<0.5	--
01/09/92	--	--	--	--	--	<50	<0.5	<0.5	<0.5	<0.5	--

Table 1
Groundwater Monitoring Data and Analytical Results
Former Chevron Service Station #9-2960
2416 Grove Way
Castro Valley, California

WELL ID/ DATE	TOC* (ft.)	GWE (msl)	DTW (ft.)	SPHT (ft.)	SPH REMOVED (gallons)	TPH-G (ppb)	B (ppb)	T (ppb)	E (ppb)	X (ppb)	MTBE (ppb)
C-7											
10/03/90	155.34	134.52	20.82	--	--	<50	<0.5	<0.5	<0.5	<0.5	--
10/25/90	155.34	134.43	20.91	--	--	<50	<0.5	1.0	<0.5	<0.5	--
11/09/90	155.34	134.40	20.94	--	--	<50	<0.5	<0.5	<0.5	<0.5	--
01/22/91	155.34	133.84	21.50	--	--	<50	4.0	<0.5	<0.5	<0.5	--
02/21/91	155.34	134.63	20.71	--	--	--	--	--	--	--	--
04/01/91	155.34	135.34	20.00	--	--	--	--	--	--	--	--
04/11/91	155.34	135.29	20.05	--	--	--	--	--	--	--	--
07/01/91	155.34	134.82	20.52	--	--	--	--	--	--	--	--
09/24/91	155.34	134.52	20.82	--	--	<50	<0.5	<0.5	<0.5	<0.5	--
10/23/91	155.34	134.43	20.91	--	--	--	--	--	--	--	--
11/22/91	155.34	134.55	20.79	--	--	--	--	--	--	--	--
01/09/92	155.34	135.18	20.16	--	--	<50	<0.5	<0.5	<0.5	0.9	--
03/06/92	155.34	135.92	19.42	--	--	<50	<0.5	<0.5	<0.5	<0.5	--
06/04/92	155.34	135.53	19.81	--	--	250	<0.5	<0.5	<0.5	<0.5	--
09/28/92	155.34	134.69	20.65	--	--	<50	<0.5	<0.5	<0.5	<0.5	--
12/17/92	155.34	135.32	20.02	--	--	<50	<0.5	<0.5	<0.5	<0.5	--
04/29/93	155.34	136.19	19.15	--	--	<50	<0.5	<0.5	<0.5	<1.5	--
07/26/93	155.34	135.57	19.77	--	--	<50	<0.5	<0.5	<0.5	<1.5	--
10/22/93	155.34	135.17	20.17	--	--	--	--	--	--	--	--
01/24/94	155.34	135.11	20.23	--	--	<50	<0.5	<0.5	<0.5	<0.5	--
04/11/94	155.34	135.39	19.95	--	--	<50	<0.5	<0.5	<0.5	<0.5	--
07/01/94	155.34	135.42	19.92	--	--	<50	<0.5	<0.5	<0.5	<0.5	--
10/06/94	155.34	135.03	20.31	--	--	<50	<0.5	<0.5	<0.5	<0.5	--
01/11/95	155.34	135.98	19.36	--	--	<50	<0.5	<0.5	<0.5	<0.5	--
04/07/95	155.34	136.84	18.50	--	--	<50	<0.5	<0.5	<0.5	<0.5	--
07/20/95	155.34	135.46	19.88	--	--	<50	<0.5	<0.5	<0.5	<0.5	--
09/22/95	155.34	135.38	19.96	--	--	<50	<0.5	<0.5	<0.5	<0.5	--
01/02/96	155.34	135.64	19.70	--	--	<50	<0.5	<0.5	<0.5	<0.5	<2.5
04/26/96	155.34	136.17	19.17	--	--	<50	<0.5	<0.5	<0.5	<0.5	--
07/22/96	155.34	135.49	19.85	--	--	<50	<0.5	<0.5	<0.5	<0.5	--

Table 1
Groundwater Monitoring Data and Analytical Results
Former Chevron Service Station #9-2960
2416 Grove Way
Castro Valley, California

WELL ID/ DATE	TOC* (ft.)	GWE (msl)	DTW (ft.)	SPHT (ft.)	SPH REMOVED (gallons)	TPH-G (ppb)	B (ppb)	T (ppb)	E (ppb)	X (ppb)	MTBE (ppb)
C-6 (cont)											
12/17/92	152.84	135.58	17.26	--	--	<50	<0.5	<0.5	<0.5	<0.5	--
04/29/93	152.84	136.61	16.23	--	--	<50	<0.5	<0.5	<0.5	<1.5	--
07/29/93	152.84	135.88	16.96	--	--	<50	<0.5	<0.5	<0.5	<1.5	--
10/22/93	152.84	135.38	17.46	--	--	74	7.4	6.1	3.3	9.7	--
01/24/94	152.84	135.38	17.46	--	--	<50	<0.5	<0.5	<0.5	<0.5	--
04/11/94	152.84	135.64	17.20	--	--	<50	<0.5	<0.5	<0.5	<0.5	--
07/01/94	152.84	135.66	17.18	--	--	<50	<0.5	<0.5	<0.5	<0.5	--
10/06/94	152.84	135.19	17.65	--	--	<50	<0.5	<0.5	<0.5	<0.5	--
01/11/95	152.84	136.18	16.66	--	--	<50	<0.5	<0.5	<0.5	<0.5	--
04/07/95	152.84	137.25	15.59	--	--	<50	<0.5	<0.5	<0.5	<0.5	--
07/20/95	152.84	135.80	17.04	--	--	<50	<0.5	<0.5	<0.5	<0.5	--
09/22/95	152.84	135.74	17.10	--	--	<50	<0.5	<0.5	<0.5	<0.5	--
01/02/96	152.84	136.08	16.76	--	--	<50	<0.5	<0.5	<0.5	<0.5	<2.5
04/26/96	152.84	136.64	16.20	--	--	<50	<0.5	<0.5	<0.5	<0.5	--
07/22/96	152.84	135.79	17.05	--	--	<50	<0.5	<0.5	<0.5	<0.5	--
10/17/96	152.84	135.62	17.22	--	--	<50	<0.5	<0.5	<0.5	<0.5	--
01/23/97	152.84	136.99	15.85	--	--	<50	<0.5	<0.5	<0.5	<0.5	--
07/10/97	152.84	135.95	16.89	--	--	<50	<0.5	<0.5	<0.5	<0.5	--
01/15/98	152.84	136.64	16.20	--	--	<50	<0.5	<0.5	<0.5	<0.5	--
01/16/98	152.84	136.74	16.10	--	--	REGAUGE	--	--	--	--	--
07/09/98	152.84	136.71	16.13	--	--	<50	<0.5	<0.5	<0.5	<0.5	--
01/08/99	152.84	137.57	15.27	--	--	<50	<0.5	<0.5	<0.5	<0.5	--
07/09/99	152.84	136.60	16.24	--	--	<50	<0.5	<0.5	<0.5	<0.5	<5.0
02/01/00	152.84	136.57	16.27	--	--	<50	<0.5	<0.5	<0.5	<0.5	<5.0
08/21/00	152.84	UNABLE TO LOCATE - PAVED OVER				--	--	--	--	--	--
01/25/01	152.84	UNABLE TO LOCATE - PAVED OVER				--	--	--	--	--	--
07/10/01	152.84	UNABLE TO LOCATE - PAVED OVER				--	--	--	--	--	--
01/08/02	152.84	UNABLE TO LOCATE - PAVED OVER				--	--	--	--	--	--
03/26/02	152.84	UNABLE TO LOCATE - PAVED OVER				--	--	--	--	--	--
06/17/02	152.84	UNABLE TO LOCATE - PAVED OVER				--	--	--	--	--	--
PAVED OVER											

Table 1
Groundwater Monitoring Data and Analytical Results
Former Chevron Service Station #9-2960
2416 Grove Way
Castro Valley, California

WELL ID/ DATE	TOC* (ft.)	GWE (msl)	DTW (ft.)	SPHT (ft.)	SPH REMOVED (gallons)	TPH-G (ppb)	B (ppb)	T (ppb)	E (ppb)	X (ppb)	MTBE (ppb)
C-5 (cont)											
07/01/94	153.38	136.73	16.65	--	--	<50	<0.5	<0.5	<0.5	<0.5	--
10/06/94	153.38	136.16	17.22	--	--	<50	<0.5	<0.5	<0.5	<0.5	--
01/11/95	153.38	137.41	15.97	--	--	<50	<0.5	<0.5	<0.5	<0.5	--
04/07/95	153.38	139.37	14.01	--	--	<50	<0.5	<0.5	<0.5	<0.5	--
07/20/95	153.38	137.17	16.21	--	--	<50	<0.5	<0.5	<0.5	0.61	--
09/22/95	153.38	137.07	16.31	--	--	62	<0.5	<0.5	<0.5	<0.5	--
01/02/96	153.38	137.56	15.82	--	--	<50	<0.5	<0.5	<0.5	<0.5	<2.5
04/26/96	153.38	138.41	14.97	--	--	<50	<0.5	<0.5	<0.5	<0.5	--
07/22/96	153.38	137.06	16.32	--	--	<50	<0.5	<0.5	<0.5	<0.5	--
10/17/96	153.38	136.88	16.50	--	--	<50	<0.5	<0.5	<0.5	<0.5	--
01/23/97	153.38	139.18	14.20	--	--	<50	<0.5	<0.5	<0.5	<0.5	--
ABANDONED											
C-6											
10/03/90	152.84	134.70	18.14	--	--	<50	<0.5	<0.5	<0.5	<0.5	--
10/25/90	152.84	134.55	18.29	--	--	<50	<0.5	1.0	<0.5	<0.5	--
11/09/90	152.84	134.58	18.26	--	--	<50	<0.5	<0.5	<0.5	<0.5	--
01/22/91	152.84	134.69	18.15	--	--	<50	<0.5	<0.5	<0.5	<0.5	--
02/21/91	152.84	134.92	17.92	--	--	--	--	--	--	--	--
04/01/91	152.84	135.73	17.11	--	--	--	--	--	--	--	--
04/11/91	152.84	135.83	17.01	--	--	--	--	--	--	--	--
07/01/91	152.84	135.12	17.72	--	--	--	--	--	--	--	--
09/24/91	152.84	135.72	17.12	--	--	<50	<0.5	<0.5	<0.5	<0.5	--
10/23/91	152.84	134.59	18.25	--	--	--	--	--	--	--	--
11/22/91	152.84	134.79	18.05	--	--	--	--	--	--	--	--
01/09/92	152.84	135.42	17.42	--	--	<50	<0.5	<0.5	<0.5	<0.5	--
03/06/92	152.84	136.33	16.51	--	--	<50	<0.5	<0.5	<0.5	<0.5	--
06/04/92	152.84	135.83	17.01	--	--	<50	<0.5	<0.5	<0.5	<0.5	--
09/28/92	152.84	134.84	18.00	--	--	<50	<0.5	<0.5	<0.5	<0.5	--

Table 1
Groundwater Monitoring Data and Analytical Results
Former Chevron Service Station #9-2960
2416 Grove Way
Castro Valley, California

WELL ID/ DATE	TOC* (ft.)	GWE (msl)	DTW (ft.)	SPHT (ft.)	SPH REMOVED (gallons)	TPH-G (ppb)	B (ppb)	T (ppb)	E (ppb)	X (ppb)	MTBE (ppb)
C-4 (cont)											
01/25/01	156.00	UNABLE TO LOCATE - PAVED OVER				--	--	--	--	--	--
07/10/01	156.00	UNABLE TO LOCATE - PAVED OVER				--	--	--	--	--	--
01/08/02	156.00	UNABLE TO LOCATE - PAVED OVER				--	--	--	--	--	--
03/26/02	156.00	UNABLE TO LOCATE - PAVED OVER				--	--	--	--	--	--
06/17/02	156.00	UNABLE TO LOCATE - PAVED OVER				--	--	--	--	--	--
PAVED OVER											
C-5											
10/03/90	153.38	135.60	17.78	--	--	<50	<0.5	<0.5	<0.5	<0.5	--
10/25/90	153.38	135.46	17.92	--	--	<50	<0.5	<0.5	<0.5	<0.5	--
11/09/90	153.38	135.46	17.92	--	--	<50	<0.5	<0.5	<0.5	<0.5	--
01/22/91	153.38	135.58	17.80	--	--	<50	<0.5	<0.5	<0.5	<0.5	--
02/21/91	153.38	135.87	17.51	--	--	--	--	--	--	--	--
04/01/91	153.38	137.07	16.31	--	--	--	--	--	--	--	--
04/11/91	153.38	137.02	16.36	--	--	--	--	--	--	--	--
07/01/91	153.38	136.26	17.12	--	--	--	--	--	--	--	--
09/24/91	153.38	135.68	17.70	--	--	<50	<0.5	<0.5	<0.5	<0.5	--
09/24/91	153.38	135.68	17.70	--	--	<50	<0.5	<0.5	<0.5	<0.5	--
10/23/91	153.38	135.56	17.82	--	--	--	--	--	--	--	--
11/22/91	153.38	135.77	17.61	--	--	--	--	--	--	--	--
01/09/92	153.38	136.34	17.04	--	--	<50	<0.5	0.7	<0.5	<0.5	--
03/06/92	153.38	137.62	15.76	--	--	<50	<0.5	<0.5	<0.5	<0.5	--
06/04/92	153.38	136.98	16.40	--	--	<50	<0.5	<0.5	<0.5	<0.5	--
09/28/92	153.38	135.80	17.58	--	--	<50	<0.5	<0.5	<0.5	<0.5	--
12/17/92	153.38	136.56	16.82	--	--	<50	<0.5	<0.5	<0.5	<0.5	--
04/29/93	153.38	138.14	15.24	--	--	<50	<0.5	<0.5	<0.5	<1.5	--
07/26/93	153.38	137.08	16.30	--	--	<50	<0.5	<0.5	<0.5	<1.5	--
10/22/93	153.38	136.30	17.08	--	--	52	2.3	2.7	1.1	5.2	--
01/24/94	153.38	136.25	17.13	--	--	<50	<0.5	<0.5	<0.5	<0.5	--
04/11/94	153.38	136.75	16.63	--	--	<50	<0.5	0.7	<0.5	0.6	--

Table 1
Groundwater Monitoring Data and Analytical Results
Former Chevron Service Station #9-2960
2416 Grove Way
Castro Valley, California

WELL ID/ DATE	TOC* (ft.)	GWE (msl)	DTW (ft.)	SPHT (ft.)	SPH REMOVED (gallons)	TPH-G (ppb)	B (ppb)	T (ppb)	E (ppb)	X (ppb)	MTBE (ppb)
C-4 (cont)											
03/06/92	156.00	137.74	18.26	--	--	<50	0.8	<0.5	<0.5	<0.5	--
06/04/92	156.00	137.08	18.92	--	--	<50	<0.5	<0.5	<0.5	0.7	--
09/28/92	156.00	135.69	20.31	--	--	<50	<0.5	<0.5	<0.5	<0.5	--
12/17/92	156.00	136.43	19.57	--	--	<50	<0.5	<0.5	<0.5	<0.5	--
04/29/93	156.00	138.22	17.78	--	--	<50	<0.5	<0.5	<0.5	<1.5	--
07/26/93	156.00	--	--	--	--	--	--	--	--	--	--
08/18/93	156.00	137.09	18.91	--	--	<50	<0.5	<0.5	<0.5	<1.5	--
10/22/93	156.00	136.61	19.39	--	--	<50	2.9	2.1	1.1	4.3	--
01/24/94	156.00	136.58	19.42	--	--	<50	<0.5	<0.5	<0.5	<0.5	--
04/11/94	156.00	136.86	19.14	--	--	<50	<0.5	0.6	<0.5	0.5	--
07/01/94	156.00	136.80	19.20	--	--	<50	<0.5	<0.5	<0.5	<0.5	--
10/06/94	156.00	136.26	19.74	--	--	<50	<0.5	<0.5	<0.5	<0.5	--
01/11/95	156.00	139.70	16.30	--	--	<50	<0.5	<0.5	<0.5	<0.5	--
04/07/95	156.00	139.49	16.51	--	--	<50	<0.5	<0.5	<0.5	<0.5	--
07/20/95	156.00	137.20	18.80	--	--	<50	<0.5	<0.5	<0.5	<0.5	--
09/22/95	156.00	137.26	18.74	--	--	<50	<0.5	<0.5	<0.5	<0.5	--
01/02/96	156.00	137.65	18.35	--	--	<50	1.6	1.8	0.95	4.1	<2.5
04/26/96	156.00	138.43	17.57	--	--	<50	<0.5	<0.5	<0.5	<0.5	--
07/22/96	156.00	137.00	19.00	--	--	<50	<0.5	<0.5	<0.5	<0.5	--
10/17/96	156.00	136.96	19.04	--	--	<50	<0.5	<0.5	<0.5	<0.5	--
01/23/97	156.00	139.31	16.69	--	--	<50	<0.5	<0.5	<0.5	<0.5	--
07/10/97	156.00	137.46	18.54	--	--	SAMPLED ANNUALLY	--	--	--	--	--
01/15/98	156.00	143.92	12.08	--	--	<50	1.0	1.4	<0.5	3.5	--
01/16/98	156.00	138.84	17.16	--	--	REGAUGE	--	--	--	--	--
07/09/98	156.00	138.29	17.71	--	--	--	--	--	--	--	--
01/08/99	156.00	139.19	16.81	--	--	<50	<0.5	<0.5	<0.5	<0.5	--
07/09/99	156.00	UNABLE TO LOCATE	--	--	--	--	--	--	--	--	--
02/01/00	156.00	UNABLE TO LOCATE	--	--	--	--	--	--	--	--	--
08/21/00	156.00	UNABLE TO LOCATE - PAVED OVER	--	--	--	--	--	--	--	--	--

Table 1
Groundwater Monitoring Data and Analytical Results
Former Chevron Service Station #9-2960
2416 Grove Way
Castro Valley, California

WELL ID/ DATE	TOC* (ft.)	GWE (msl)	DTW (ft.)	SPHT (ft.)	SPH REMOVED (gallons)	TPH-G (ppb)	B (ppb)	T (ppb)	E (ppb)	X (ppb)	MTBE (ppb)
C-3 (cont)											
04/26/96	154.13	137.42	16.71	--	--	<50	<0.5	<0.5	<0.5	<0.5	--
07/22/96	154.13	136.50	17.63	--	--	<50	<0.5	<0.5	<0.5	<0.5	--
10/17/96	154.13	136.33	17.80	--	--	<50	<0.5	<0.5	<0.5	<0.5	--
01/23/97	154.13	138.33	15.80	--	--	<50	<0.5	<0.5	<0.5	<0.5	--
07/10/97	154.13	136.63	17.50	--	--	<50	<0.5	<0.5	<0.5	<0.5	--
01/15/98	154.13	137.98	16.15	--	--	<50	<0.5	<0.5	<0.5	<0.5	--
01/16/98	154.13	138.04	16.09	--	--	REGAUGE	--	--	--	--	--
07/09/98	154.13	137.57	16.56	--	--	<50	<0.5	<0.5	<0.5	<0.5	--
ABANDONED											
C-4											
10/23/86	156.00	--	--	--	--	570	3.0	4.0	--	5.0	--
09/10/87	156.00	--	--	--	--	500	3.0	<0.5	<0.5	<0.5	--
10/16/89	156.00	--	--	--	--	<500	12	1.0	<0.5	0.8	--
01/04/90	156.00	--	--	--	--	<500	5.0	<0.5	<0.5	0.9	--
04/05/90	156.00	--	--	--	--	<50	6.6	<0.5	<0.5	0.7	--
07/02/90	156.00	--	--	--	--	71	4.1	<0.5	<0.5	<0.5	--
10/03/90	156.00	--	--	--	--	--	--	--	--	--	--
10/25/90	156.00	135.57	20.43	--	--	<50	2.0	<0.5	<0.5	<0.5	--
01/22/91	156.00	135.50	20.50	--	--	<50	3.0	<0.5	<0.5	<0.5	--
02/21/91	156.00	135.77	20.23	--	--	--	--	--	--	--	--
04/01/91	156.00	136.97	19.03	--	--	--	--	--	--	--	--
04/11/91	156.00	136.95	19.05	--	--	--	--	--	--	--	--
07/01/91	156.00	136.10	19.90	--	--	--	--	--	--	--	--
09/24/91	156.00	135.59	20.41	--	--	87	1.6	<0.5	<0.5	<0.5	--
10/23/91	156.00	135.47	20.53	--	--	--	--	--	--	--	--
11/22/91	156.00	135.65	20.35	--	--	--	--	--	--	--	--
01/09/92	156.00	136.46	19.54	--	--	51	4.3	<0.5	<0.5	<0.5	--
01/09/92	156.00	136.46	19.54	--	--	<50	4.8	<0.5	<0.5	<0.5	--

Table 1
Groundwater Monitoring Data and Analytical Results
Former Chevron Service Station #9-2960
2416 Grove Way
Castro Valley, California

WELL ID/ DATE	TOC* (ft.)	GWE (msl)	DTW (ft.)	SPHT (ft.)	SPH REMOVED (gallons)	TPH-G (ppb)	B (ppb)	T (ppb)	E (ppb)	X (ppb)	MTBE (ppb)
C-3 (cont)											
04/05/90	154.13	--	--	--	--	930	690	3.4	5.1	4.8	--
07/02/90	154.13	--	--	--	--	1,700	590	11	4.8	9.4	--
10/03/90	154.13	134.97	19.16	--	--	--	--	--	--	--	--
10/25/90	154.13	134.85	19.28	--	--	750	510	2.0	6.0	5.0	--
01/22/91	154.13	134.95	19.18	--	--	430	260	2.0	2.0	5.0	--
01/22/91	154.13	134.95	19.18	--	--	400	250	2.0	2.0	5.0	--
02/21/91	154.13	135.25	18.88	--	--	--	--	--	--	--	--
04/01/91	154.13	136.54	17.59	--	--	--	--	--	--	--	--
04/11/91	154.13	136.32	17.81	--	--	--	--	--	--	--	--
07/01/91	154.13	135.57	18.56	--	--	--	--	--	--	--	--
09/24/91	154.13	135.01	19.12	--	--	260	52	0.7	0.8	2.2	--
10/23/91	154.13	134.89	19.24	--	--	--	--	--	--	--	--
11/22/91	154.13	135.10	19.03	--	--	--	--	--	--	--	--
01/09/92	154.13	135.90	18.23	--	--	240	120	0.9	<0.5	1.6	--
03/06/92	154.13	137.09	17.04	--	--	230	68	1.2	1.2	1.3	--
06/04/92	154.13	136.34	17.79	--	--	80	36	0.6	0.5	0.7	--
09/28/92	154.13	135.13	19.00	--	--	84	49	<0.5	<0.5	1.5	--
12/17/92	154.13	135.95	18.18	--	--	220	30	<0.5	<0.5	<0.5	--
04/29/93	154.13	135.35	18.78	--	--	380	12	0.6	<0.5	<1.5	--
07/26/93	154.13	136.41	17.72	--	--	800	38	1.1	<0.5	<1.5	--
10/22/93	154.13	135.63	18.50	--	--	200	64	0.6	<0.5	<1.5	--
01/24/94	154.13	135.62	18.51	--	--	<50	<0.5	<0.5	<0.5	<0.5	--
04/11/94	154.13	136.09	18.04	--	--	100	3.6	2.1	<0.5	2.3	--
07/01/94	154.13	136.01	18.12	--	--	140	3.7	1.2	<0.5	1.0	--
10/06/94	154.13	135.50	18.63	--	--	<50	<0.5	<0.5	<0.5	<0.5	--
01/11/95	154.13	137.01	17.12	--	--	<50	<0.5	<0.5	<0.5	<0.5	--
04/07/95	154.13	138.34	15.79	--	--	<50	<0.5	<0.5	<0.5	<0.5	--
07/20/95	154.13	136.37	17.76	--	--	<50	1.5	1.9	<0.5	3.5	--
09/22/95	154.13	136.58	17.55	--	--	<50	<0.5	<0.5	<0.5	<0.5	--
01/02/96	154.13	136.88	17.25	--	--	<50	<0.5	<0.5	<0.5	1.1	<2.5

Table 1
Groundwater Monitoring Data and Analytical Results
Former Chevron Service Station #9-2960
2416 Grove Way
Castro Valley, California

WELL ID/ DATE	TOC* (ft.)	GWE (msl)	DTW (ft.)	SPHT (ft.)	SPH REMOVED (gallons)	TPH-G (ppb)	B (ppb)	T (ppb)	E (ppb)	X (ppb)	MTBE (ppb)
C-2 (cont)											
09/28/92	151.84	135.44	16.40	--	--	6,400	940	230	57	220	--
12/17/92	151.84	136.46	15.38	--	--	1,500	370	160	6.0	25	--
04/29/93	151.84	136.87	14.97	--	--	1,800	690	120	74	140	--
07/29/93	151.84	136.92	14.92	--	--	4,300	1,500	96	29	96	--
10/22/93	151.84	136.03	15.81	--	--	820	560	57	15	58	--
01/24/94	151.84	--	--	--	--	--	--	--	--	--	--
04/11/94	151.84	136.49	15.35	--	--	2,000	240	48	36	110	--
07/01/94	151.84	136.44	15.40	--	--	370	55	12	3.1	8.6	--
10/06/94	151.84	135.84	16.00	--	--	150	47	4.8	1.8	5.4	--
01/11/95	151.84	137.06	14.78	--	--	52	0.65	<0.5	<0.5	<0.5	--
04/07/95	151.84	138.93	12.91	--	--	1,500	260	64	52	85	--
07/20/95	151.84	136.81	15.03	--	--	3,000	500	100	96	110	--
09/22/95	151.84	137.05	14.79	--	--	2,000	630	120	20	79	--
01/02/96	151.84	137.37	14.47	--	--	1,900	240	110	58	180	<12
04/26/96	151.84	137.97	13.87	--	--	1,300	340	190	44	120	--
07/22/96	151.84	136.73	15.11	--	--	3,700	1,100	140	150	330	--
10/17/96	151.84	136.80	15.04	--	--	22,000	3,900	1,600	350	1,800	--
01/23/97	151.84	138.86	12.98	--	--	2,000	260	48	76	94	--
07/10/97	151.84	137.21	14.63	--	--	5,100	710	200	190	380	--
01/15/98	153.36	INACCESSIBLE	--	--	--	--	--	--	--	--	--
01/16/98	151.84	138.61	13.23	--	--	7,600	1,600	130	320	650	--
07/09/98	151.84	138.17	13.67	--	--	10,000	1,100	410	180	410	--
ABANDONED											
C-3											
10/23/86	154.13	--	--	--	--	3,300	49	24	--	20	--
09/10/87	154.13	--	--	--	--	200	110	2.6	<2.0	<2.0	--
10/16/89	154.13	--	--	--	--	900	640	4.2	1.6	16	--
01/04/90	154.13	--	--	--	--	920	430	7.0	6.0	7.0	--

Table 1
Groundwater Monitoring Data and Analytical Results
Former Chevron Service Station #9-2960
2416 Grove Way
Castro Valley, California

WELL ID/ DATE	TOC* (ft.)	GWE (msl)	DTW (ft.)	SPHT (ft.)	SPH REMOVED (gallons)	TPH-G (ppb)	B (ppb)	T (ppb)	E (ppb)	X (ppb)	MTBE (ppb)
C-1 (cont)											
07/22/96	153.36	143.14	10.22	--	--	7,300	2,500	170	360	520	--
10/17/96	153.36	137.64	15.72	--	--	19,000	3,400	59	360	430	--
01/23/97	153.36	138.91	14.45	--	--	15,000	2,900	390	250	480	--
07/10/97	153.36	137.19	16.17	--	--	13,000	2,100	69	200	380	--
01/15/98	153.36	INACCESSIBLE		--	--	--	--	--	--	--	--
01/16/98	153.36	138.63	14.73	--	--	4,700	1,200	<20	140	40	--
07/09/98	153.36	138.14	15.22	--	--	9,900	1,500	60	150	170	--
ABANDONED											
C-2											
10/23/86	151.84	--	--	--	--	30,000	2,700	1,900	--	1,500	--
09/10/87	151.84	--	--	--	--	14,000	2,600	2,900	500	1,200	--
10/16/89	151.84	--	--	--	--	600	260	34	1.7	41	--
01/04/90	151.84	--	--	--	--	2,600	470	150	23	130	--
04/05/90	151.84	--	--	--	--	500	280	29	6.3	19	--
07/02/90	151.84	--	--	--	--	2,400	670	110	17	76	--
10/03/90	151.84	--	--	--	--	--	--	--	--	--	--
10/25/90	151.84	135.24	16.60	--	--	1,300	390	47	9.0	58	--
01/22/91	151.84	135.15	16.69	--	--	2,600	680	88	29	130	--
02/21/91	151.84	135.53	16.31	--	--	--	--	--	--	--	--
04/01/91	151.84	136.76	15.08	--	--	--	--	--	--	--	--
04/11/91	151.84	136.61	15.23	--	--	--	--	--	--	--	--
07/01/91	151.84	135.88	15.96	--	--	--	--	--	--	--	--
09/24/91	151.84	135.33	16.51	--	--	3,600	1,400	63	6.9	63	--
10/23/91	151.84	135.18	16.66	--	--	--	--	--	--	--	--
11/22/91	151.84	135.47	16.37	--	--	--	--	--	--	--	--
01/09/92	151.84	136.28	15.56	--	--	7,100	770	740	190	690	--
03/06/92	151.84	137.47	14.37	--	--	3,200	250	230	59	220	--
06/04/92	151.84	136.80	15.04	--	--	1,500	<0.5	180	42	130	--

Table 1
Groundwater Monitoring Data and Analytical Results
Former Chevron Service Station #9-2960
2416 Grove Way
Castro Valley, California

WELL ID/ DATE	TOC* (ft.)	GWE (msl)	DTW (ft.)	SPHT (ft.)	SPH REMOVED (gallons)	TPH-G (ppb)	B (ppb)	T (ppb)	E (ppb)	X (ppb)	MTBE (ppb)
C-1						3,100	6,400	3,700	--	4,300	--
10/23/86	153.36	--	--	--	--	120,000	25,000	60,000	13,000	56,000	--
09/10/87	153.36	--	--	--	--	--	--	--	--	--	--
10/03/90	153.36	134.69	18.67	--	--	--	--	--	--	--	--
10/25/90	153.36	135.22	18.71	0.71	--	--	--	--	--	--	--
01/22/91	153.36	135.22	18.70	0.70	--	--	--	--	--	--	--
02/21/91	153.36	135.44	18.62	0.88	--	--	--	--	--	--	--
04/01/91	153.36	136.47	16.91	0.03	--	--	--	--	--	--	--
04/11/91	153.36	136.49	16.90	0.04	--	--	--	--	--	--	--
07/01/91	153.36	135.75	17.61	0.00	--	--	--	--	--	--	--
09/24/91	153.36	135.17	18.98	0.99	--	--	--	--	--	--	--
10/23/91	153.36	135.03	19.32	1.24	--	--	--	--	--	--	--
11/22/91	153.36	134.53	18.83	0.97	--	--	--	--	--	--	--
01/09/92	153.36	136.10	17.26	--	--	--	--	--	--	--	--
03/06/92	153.36	137.16	16.69	0.61	--	--	--	--	--	--	--
06/04/92	153.36	136.44	17.10	0.22	--	--	--	--	--	--	--
09/28/92	153.36	--	18.71	0.77	--	--	--	--	--	--	--
12/17/92	153.36	--	17.54	0.45	--	--	--	--	--	--	--
04/29/93	153.36	137.50	16.40	0.68	--	--	--	--	--	--	--
07/26/93	153.36	136.92	16.85	0.51	--	--	--	--	--	--	--
10/22/93	153.36	135.55	17.83	0.03	--	--	--	--	--	--	--
01/24/94	153.36	--	--	--	--	--	--	--	--	--	--
04/11/94	153.36	136.01	17.76	0.51	--	--	--	--	--	--	--
07/01/94	153.36	135.95	17.46	0.06	--	--	--	--	--	--	--
10/06/94	153.36	135.24	18.18	0.08	--	--	--	--	--	--	--
01/11/95	153.36	136.63	16.79	0.08	0.039	--	--	--	--	--	--
04/07/95	153.36	139.23	14.13	--	--	44,000	410	100	130	5,400	--
07/20/95	153.36	136.84	16.52	--	--	16,000	96	81	53	1,000	--
09/22/95	153.36	137.22	16.14	--	--	59,000	150	36	16	56	--
01/02/96	153.36	137.43	15.93	--	--	29,000	4,500	1,100	520	1,900	<250
04/26/96	153.36	137.31	16.05	--	--	7,200	1,300	340	130	390	--

Table 1
Groundwater Monitoring Data and Analytical Results
 Former Chevron Service Station #9-2960
 2416 Grove Way
 Castro Valley, California

WELL ID/ DATE	TOC* (ft.)	GWE (msl)	DTW (ft.)	SPHT (ft.)	SPH REMOVED (gallons)	TPH-G (ppb)	B (ppb)	T (ppb)	E (ppb)	X (ppb)	MTBE (ppb)
06/17/02	--	--	--	--	--	<50	<0.50	<0.50	<0.50	<1.5	<2.5
09/17/02	--	--	--	--	--	<50	<0.50	<0.50	<0.50	<1.5	<2.5
12/02/02	--	--	--	--	--	<50	<0.50	<0.50	<0.50	<1.5	<2.5

Table 1
Groundwater Monitoring Data and Analytical Results
Former Chevron Service Station #9-2960
2416 Grove Way
Castro Valley, California

EXPLANATIONS:

Groundwater monitoring data and laboratory analytical results prior to August 21, 2000, were compiled from reports prepared by Blaine Tech Services, Inc.

TOC = Top of Casing

(ft.) = Feet

GWE = Groundwater Elevation

(msl) = Mean sea level

DTW = Depth to Water

SPHT = Separate Phase Hydrocarbons Thickness

TPH-G = Total Petroleum Hydrocarbons as Gasoline

B = Benzene

T = Toluene

E = Ethylbenzene

X = Xylenes

MTBE = Methyl tertiary butyl ether

(ppb) = Parts per billion

-- = Not Measured/Not Analyzed

QA = Quality Assurance/Trip Blank

* TOC elevations were surveyed in April 2002, by Morrow Surveying. Elevations are based on Alameda County Benchmark No. 259, brass disc top of concrete guard rail & retaining wall abutment along east side "A" Street and on CL + N. 5th Street extended, (Elevation = 138.79 feet).

¹ MTBE by EPA Method 8260.

² Well development performed.

Table 2
Groundwater Analytical Results - Oxygenate Compounds
Former Chevron Service Station #9-2960
2416 Grove Way
Castro Valley, California

WELL ID	DATE	TBA (ppb)	MTBE (ppb)	DIPE (ppb)	ETBE (ppb)	TAME (ppb)
C-7	07/10/01	<20	<2.0	<2.0	<2.0	<2.0
C-8	03/26/02	<100	<2	<2	<2	<2
	06/17/02	<100	<2	<2	<2	<2
	09/17/02	<100	<2	<2	<2	<2
	12/02/02	<100	<2	<2	<2	<2

EXPLANATIONS:

TBA = Tertiary butyl alcohol
MTBE = Methyl tertiary butyl ether
DIPE = Di-isopropyl ether
ETBE = Ethyl tertiary butyl ether
TAME = Tertiary amyl methyl ether
(ppb) = Parts per billion

ANALYTICAL METHOD:

EPA Method 8260 for Oxygenate Compounds

STANDARD OPERATING PROCEDURE - GROUNDWATER SAMPLING

Gettler-Ryan Inc. field personnel adhere to the following procedures for the collection and handling of groundwater samples prior to analysis by the analytical laboratory. Prior to sample collection, the type of analysis to be performed is determined. Loss prevention of volatile compounds is controlled and sample preservation for subsequent analysis is maintained.

Prior to sampling, the presence or absence of free-phase hydrocarbons is determined using an interface probe. Product thickness, if present, is measured to the nearest 0.01 foot and is noted in the field notes. In addition, all depth to water level measurements are collected with a static water level indicator and are also recorded in the field notes, prior to purging and sampling any wells.

After water levels are collected and prior to sampling, each well is purged a minimum of three well casing volumes of water using pre-cleaned pumps (stack, suction, Grundfos), or disposable bailers. Temperature, pH and electrical conductivity are measured a minimum of three times during the purging. Purging continues until these parameters stabilize.

Groundwater samples are collected using disposable bailers. The water samples are transferred from the bailer into appropriate containers. Pre-preserved containers, supplied by analytical laboratories, are used when possible. When pre-preserved containers are not available, the laboratory is instructed to preserve the sample as appropriate. Duplicate samples are collected for the laboratory to use in maintaining quality assurance/quality control standards. The samples are labeled to include the job number, sample identification, collection date and time, analysis, preservation (if any), and the sample collector's initials. The water samples are placed in a cooler, maintained at 4°C for transport to the laboratory. Once collected in the field, all samples are maintained under chain of custody until delivered to the laboratory.

The chain of custody document includes the job number, type of preservation, if any, analysis requested, sample identification, date and time collected, and the sample collector's name. The chain of custody is signed and dated (including time of transfer) by each person who receives or surrenders the samples, beginning with the field personnel and ending with the laboratory personnel.

A laboratory supplied trip blank accompanies each sampling set. For sampling sets greater than 20 samples, 5% trip blanks are included. The trip blank is analyzed for some or all of the same compounds as the groundwater samples.

As requested by Chevron Products Company, the purge water and decontamination water generated during sampling activities is transported by IWM to McKittrick Waste Management located in McKittrick, California.



GETTLER-RYAN INC.

WELL MONITORING/SAMPLING FIELD DATA SHEET

Client/Facility #: ChevronTexaco #9-2960 Job Number: 386365
 Site Address: 2416 Grove Way Event Date: 12.2.02
 City: Castro Valley, CA Sampler: ET

Well ID: C-8 Well Condition: GOOD
 Well Diameter: 2 in.
 Total Depth: 24.65 ft.
 Depth to Water: 16.80 ft.
7.85 x VF .17 = 1.33 x3 (case volume) = Estimated Purge Volume: 4.00 gal.

Volume	3/4"= 0.02	1"= 0.04	2"= 0.17	3"= 0.38
Factor (VF)	4"= 0.66	5"= 1.02	6"= 1.50	12"= 5.80

Purge Equipment:
 Disposable Bailer
 Stainless Steel Bailer _____
 Stack Pump _____
 Suction Pump _____
 Grundfos _____
 Other: _____

Sampling Equipment:
 Disposable Bailer
 Pressure Bailer _____
 Discrete Bailer _____
 Other: _____

Time Started: _____ (2400 hrs)
 Time Bailed: _____ (2400 hrs)
 Depth to Product: _____ ft
 Depth to Water: _____ ft
 Hydrocarbon Thickness: _____ ft
 Visual Confirmation/Description: _____
 Skimmer / Absorbant Sock (circle one)
 Amt Removed from Skimmer: _____ gal
 Amt Removed from Well: _____ gal
 Product Transferred to: _____

Start Time (purge): 12:36 Weather Conditions: SUNNY
 Sample Time/Date: 12:50 / 12.2.02 Water Color: CLOUDY / GREY Odor: YES / STRONG
 Purging Flow Rate: ✓ gpm. Sediment Description: SILTY
 Did well de-water? NO If yes, Time: _____ Volume: _____ gal.

Time (2400 hr.)	Volume (gal.)	pH	Conductivity (u mhos/cm)	Temperature (F)	D.O. (mg/L)	ORP (mV)
<u>12:39</u>	<u>1.5</u>	<u>7.09</u>	<u>83.4</u>	<u>66.4</u>	_____	_____
<u>12:42</u>	<u>3.0</u>	<u>7.03</u>	<u>78.6</u>	<u>64.7</u>	_____	_____
<u>12:45</u>	<u>4.0</u>	<u>6.96</u>	<u>69.4</u>	<u>64.1</u>	_____	_____
_____	_____	_____	_____	_____	_____	_____

LABORATORY INFORMATION

SAMPLE ID	(#) CONTAINER	REFRIG.	PRESERV. TYPE	LABORATORY	ANALYSES
<u>C-8</u>	<u>6</u> x voa vial	<u>YES</u>	<u>HCL</u>	<u>LANCASTER</u>	<u>TPH-G(8015)/BTEX+MTBE(8021)/ 5 OXYS(8260)</u>
_____	_____	_____	_____	_____	_____
_____	_____	_____	_____	_____	_____

COMMENTS: _____

Add/Replaced Lock: _____ Add/Replaced Plug: _____ Size: _____

Chevron California Region Analysis Request/Chain of Custody



For Lancaster Laboratories use only
 Acct. #: 10905 Sample #: 3 955134-5 SCR#: _____

12 0402 - 001

gr # 33498

Facility #: 9-2960 Job #386365 Global ID#T0600100318
 Site Address: 2416 GROVE WAY, CASTRO VALLEY, CA
 Chevron PM: KS Lead Consultant: Delta/G-R
 Consultant/Office: G-R, Inc., 6747 Sierra Court, Dublin, Ca 94568
 Consultant Prj. Mgr.: Deanna L. Harding (Deanna@grinc.com)
 Consultant Phone #: 925-551-7555 Fax #: 925-551-7899
 Sampler: FRANK TERLINONI
 Service Order #: _____ Non SAR: _____

Matrix		Analyses Requested									
Soil	Water	Preservation Codes									
<input type="checkbox"/> Potable <input type="checkbox"/> NPDES	<input type="checkbox"/> Air	#	#	#	#	#	#	#	#	#	#
<input type="checkbox"/> Total Number of Containers	<input type="checkbox"/> BTEX + MTBE 8260 <input type="checkbox"/> 8020	<input checked="" type="checkbox"/>	<input type="checkbox"/>	<input type="checkbox"/>	<input type="checkbox"/>	<input type="checkbox"/>	<input type="checkbox"/>	<input type="checkbox"/>	<input type="checkbox"/>	<input type="checkbox"/>	<input type="checkbox"/>
<input type="checkbox"/>	<input type="checkbox"/> TPH 8015 MOD GRO	<input type="checkbox"/>	<input type="checkbox"/>	<input type="checkbox"/>	<input type="checkbox"/>	<input type="checkbox"/>	<input type="checkbox"/>	<input type="checkbox"/>	<input type="checkbox"/>	<input type="checkbox"/>	<input type="checkbox"/>
<input type="checkbox"/>	<input type="checkbox"/> TPH 8015 MOD DRO <input type="checkbox"/> Silica Gel Cleanup	<input type="checkbox"/>	<input type="checkbox"/>	<input type="checkbox"/>	<input type="checkbox"/>	<input type="checkbox"/>	<input type="checkbox"/>	<input type="checkbox"/>	<input type="checkbox"/>	<input type="checkbox"/>	<input type="checkbox"/>
<input type="checkbox"/>	<input type="checkbox"/> 8260 full scan	<input type="checkbox"/>	<input type="checkbox"/>	<input type="checkbox"/>	<input type="checkbox"/>	<input type="checkbox"/>	<input type="checkbox"/>	<input type="checkbox"/>	<input type="checkbox"/>	<input type="checkbox"/>	<input type="checkbox"/>
<input type="checkbox"/>	<input checked="" type="checkbox"/> Oxygenates (8260)	<input type="checkbox"/>	<input type="checkbox"/>	<input type="checkbox"/>	<input type="checkbox"/>	<input type="checkbox"/>	<input type="checkbox"/>	<input type="checkbox"/>	<input type="checkbox"/>	<input type="checkbox"/>	<input type="checkbox"/>
<input type="checkbox"/>	<input type="checkbox"/> Lead 7420 <input type="checkbox"/> 7421	<input type="checkbox"/>	<input type="checkbox"/>	<input type="checkbox"/>	<input type="checkbox"/>	<input type="checkbox"/>	<input type="checkbox"/>	<input type="checkbox"/>	<input type="checkbox"/>	<input type="checkbox"/>	<input type="checkbox"/>

Preservative Codes
 H = HCl T = Thiosulfate
 N = HNO₃ B = NaOH
 S = H₂SO₄ O = Other

- J value reporting needed
- Must meet lowest detection limits possible for 8260 compounds
- 8021 MTBE Confirmation
- Confirm highest hit by 8260
- Confirm all hits by 8260
- Run ___ oxy s on highest hit
- Run ___ oxy s on all hits

Sample Identification	Date Collected	Time Collected	Grab	Composite	Soil	Water	Oil	Air	Total Number of Containers	BTEX + MTBE 8260 <input type="checkbox"/> 8020 <th style="width: 5%;">TPH 8015 MOD GRO <th style="width: 5%;">TPH 8015 MOD DRO <input type="checkbox"/> Silica Gel Cleanup <th style="width: 5%;">8260 full scan <th style="width: 5%;">Oxygenates (8260) <th style="width: 5%;">Lead 7420 <input type="checkbox"/> 7421 </th></th></th></th></th>	TPH 8015 MOD GRO <th style="width: 5%;">TPH 8015 MOD DRO <input type="checkbox"/> Silica Gel Cleanup <th style="width: 5%;">8260 full scan <th style="width: 5%;">Oxygenates (8260) <th style="width: 5%;">Lead 7420 <input type="checkbox"/> 7421 </th></th></th></th>	TPH 8015 MOD DRO <input type="checkbox"/> Silica Gel Cleanup <th style="width: 5%;">8260 full scan <th style="width: 5%;">Oxygenates (8260) <th style="width: 5%;">Lead 7420 <input type="checkbox"/> 7421 </th></th></th>	8260 full scan <th style="width: 5%;">Oxygenates (8260) <th style="width: 5%;">Lead 7420 <input type="checkbox"/> 7421 </th></th>	Oxygenates (8260) <th style="width: 5%;">Lead 7420 <input type="checkbox"/> 7421 </th>	Lead 7420 <input type="checkbox"/> 7421
QA	12-2-02				W				2	X					
C-8	↓	1250	X		↓				6	X				X	

Comments / Remarks

Turnaround Time Requested (TAT) (please circle)
 STD. TAT 72 hour 48 hour
 24 hour 4 day 5 day

Data Package Options (please circle if required)
 QC Summary Type I — Full
 Type VI (Raw Data) Coelt Deliverable not needed
 WIP (RWQCB)
 Disk

Relinquished by: <u>Frank Terlinoni</u>	Date: <u>12-2-02</u>	Time: <u>1535</u>	Received by: <u>D. Vargo</u>	Date: <u>12/4/02</u>	Time: <u>1200</u>
Relinquished by: <u>Frank Terlinoni</u>	Date: <u>12/4/02</u>	Time: <u>1200</u>	Received by: <u>Andrew May</u>	Date: <u>12-4-02</u>	Time: <u>1200</u>
Relinquished by: <u>Andrew May</u>	Date: <u>12-4-02</u>	Time: <u>1600</u>	Received by: <u>Air borne</u>	Date: <u>12-4-02</u>	Time: <u> </u>
Relinquished by Commercial Carrier: <u>Air borne</u>	UPS FedEx <input checked="" type="radio"/> Other		Received by: <u>Andrew May</u>	Date: <u>12/4/02</u>	Time: <u> </u>
Temperature Upon Receipt: <u>15</u> °C	Custody Seals Intact? <input checked="" type="radio"/> Yes <input type="radio"/> No		Time: <u>1250</u>		



ANALYTICAL RESULTS

Prepared for:

ChevronTexaco
6001 Bollinger Canyon Rd L4310
San Ramon CA 94583

925-842-8582

Prepared by:

Lancaster Laboratories
2425 New Holland Pike
Lancaster, PA 17605-2425

RECEIVED

DEC 20 2002

GETTLER RYAN INC
GENERAL CONTRACTOR

SAMPLE GROUP

The sample group for this submittal is 833498. Samples arrived at the laboratory on Friday, December 06, 2002. The PO# for this group is 99011184 and the release number is STREICH.

<u>Client Description</u>			<u>Lancaster Labs Number</u>
QA-T-021202	NA	Water	3955134
C-8-W-021202	Grab	Water	3955135

1 COPY TO

Delta C/O Gettler-Ryan

Attn: Deanna L. Harding

Questions? Contact your Client Services Representative
Teresa L Cunningham at (717) 656-2300.

Respectfully Submitted,

Robert E. Mellinger
Sr Chemist/Coordinator

Analysis Report



Lancaster Laboratories Sample No. WW 3955134

Collected: 12/02/2002 00:00

Account Number: 10905

Submitted: 12/06/2002 12:00

ChevronTexaco

Reported: 12/18/2002 at 16:11

6001 Bollinger Canyon Rd L4310

Discard: 01/18/2003

San Ramon CA 94583

QA-T-021202 NA Water

Facility# 92960 Job# 386365 GRD

2416 Grove Way T0600100318 QA

CAT No.	Analysis Name	CAS Number	As Received Result	As Received Method Detection Limit	Units	Dilution Factor
01729	TPH-GRO - Waters					
01730	TPH-GRO - Waters	n.a.	N.D.	50.	ug/l	1
The reported concentration of TPH-GRO does not include MTBE or other gasoline constituents eluting prior to the C6 (n-hexane) TPH-GRO range start time. A site-specific MSD sample was not submitted for the project. A LCS/LCSD was performed to demonstrate precision and accuracy at a batch level.						
08214	BTEX, MTBE (8021)					
00776	Benzene	71-43-2	N.D.	0.50	ug/l	1
00777	Toluene	108-88-3	N.D.	0.50	ug/l	1
00778	Ethylbenzene	100-41-4	N.D.	0.50	ug/l	1
00779	Total Xylenes	1330-20-7	N.D.	1.5	ug/l	1
00780	Methyl tert-Butyl Ether	1634-04-4	N.D.	2.5	ug/l	1
A site-specific MSD sample was not submitted for the project. A LCS/LCSD was performed to demonstrate precision and accuracy at a batch level.						

State of California Lab Certification No. 2116

Laboratory Chronicle

CAT No.	Analysis Name	Method	Trial#	Analysis Date and Time	Analyst	Dilution Factor
01729	TPH-GRO - Waters	N. CA LUFT Gasoline Method	1	12/09/2002 15:26	Melissa D Mann	1
08214	BTEX, MTBE (8021)	SW-846 8021B	1	12/09/2002 15:26	Melissa D Mann	1
01146	GC VOA Water Prep	SW-846 5030B	1	12/09/2002 15:26	Melissa D Mann	n.a.

#=Laboratory Method Detection Limit exceeded target detection limit

N.D.=Not detected above the Reporting Limit



2425 New Holland Pike
Lancaster, PA 17605-2425
717-656-2300 Fax: 717-656-2681



Lancaster Laboratories Sample No. WW 3955135

Collected: 12/02/2002 12:50 by FT

Account Number: 10905

Submitted: 12/06/2002 12:00
 Reported: 12/18/2002 at 16:11
 Discard: 01/18/2003

ChevronTexaco
 6001 Bollinger Canyon Rd L4310
 San Ramon CA 94583

C-8-W-021202 Grab Water
 Facility# 92960 Job# 386365 GRD
 2416 Grove Way T0600100318 C-8

C8GRO

CAT No.	Analysis Name	CAS Number	As Received Result	As Received Method Detection Limit	Units	Dilution Factor
01729	TPH-GRO - Waters					
01730	TPH-GRO - Waters	n.a.	7,200.	250.	ug/l	5
The reported concentration of TPH-GRO does not include MTBE or other gasoline constituents eluting prior to the C6 (n-hexane) TPH-GRO range start time. A site-specific MSD sample was not submitted for the project. A LCS/LCSD was performed to demonstrate precision and accuracy at a batch level.						
08214	BTEX, MTBE (8021)					
00776	Benzene	71-43-2	440.	1.0	ug/l	5
00777	Toluene	108-88-3	14.	1.0	ug/l	5
00778	Ethylbenzene	100-41-4	75.	1.0	ug/l	5
00779	Total Xylenes	1330-20-7	140.	3.0	ug/l	5
00780	Methyl tert-Butyl Ether	1634-04-4	N.D. #	20.	ug/l	5
A site-specific MSD sample was not submitted for the project. A LCS/LCSD was performed to demonstrate precision and accuracy at a batch level.						
Due to the presence of an interferent near its retention time, the normal reporting limit was not attained for the compound listed below. The presence or concentration of this compound cannot be determined due to the presence of this interferent. METHYL T-BUTYL ETHER						
01595	Oxygenates by 8260B					
02010	Methyl t-butyl ether	1634-04-4	N.D.	2.	ug/l	1
02011	di-Isopropyl ether	108-20-3	N.D.	2.	ug/l	1
02013	Ethyl t-butyl ether	637-92-3	N.D.	2.	ug/l	1
02014	t-Amyl methyl ether	994-05-8	N.D.	2.	ug/l	1
02015	t-Butyl alcohol	75-65-0	N.D.	100.	ug/l	1

State of California Lab Certification No. 2116

Laboratory Chronicle

#=Laboratory Method Detection Limit exceeded target detection limit
 N.D.=Not detected above the Reporting Limit



2425 New Holland Pike
 PO Box 12425
 Lancaster, PA 17605-2425
 717-656-2300 Fax: 717-656-2681

Analysis Report



Page 2 of 2

Lancaster Laboratories Sample No. WW 3955135

Collected: 12/02/2002 12:50 by FT

Account Number: 10905

Submitted: 12/06/2002 12:00

ChevronTexaco

Reported: 12/18/2002 at 16:11

6001 Bollinger Canyon Rd L4310

Discard: 01/18/2003

San Ramon CA 94583

C-8-W-021202 Grab Water

Facility# 92960 Job# 386365 GRD

2416 Grove Way T0600100318 C-8

C8GRO

CAT

No.	Analysis Name	Method	Trial#	Analysis Date and Time	Analyst	Dilution Factor
01729	TPH-GRO - Waters	N. CA LUFT Gasoline Method	1	12/10/2002 00:13	Melissa D Mann	5
08214	BTEX, MTBE (8021)	SW-846 8021B	1	12/10/2002 00:13	Melissa D Mann	5
01595	Oxygenates by 8260B	SW-846 8260B	1	12/12/2002 07:44	Marla S Lord	1
01146	GC VOA Water Prep	SW-846 5030B	1	12/10/2002 00:13	Melissa D Mann	n.a.
01163	GC/MS VOA Water Prep	SW-846 5030B	1	12/12/2002 07:44	Marla S Lord	n.a.

#=Laboratory Method Detection Limit exceeds target detection limit

N.D.=Not detected above the Reporting Limit



2425 New Holland Pike
Lancaster, PA 17605-2425
717-656-2300 Fax: 717-656-2681



Quality Control Summary

Client Name: ChevronTexaco
 Reported: 12/18/02 at 04:11 PM

Group Number: 833498

Laboratory Compliance Quality Control

<u>Analysis Name</u>	<u>Blank Result</u>	<u>Blank MDL</u>	<u>Report Units</u>	<u>LCS %REC</u>	<u>LCSD %REC</u>	<u>LCS/LCSD Limits</u>	<u>RPD</u>	<u>RPD Max</u>
Batch number: 02343A56A	Sample number(s): 3955134-3955135							
Benzene	N.D.	.2	ug/l	82	91	80-118	10	30
Toluene	N.D.	.2	ug/l	100	110	82-119	9	30
Ethylbenzene	N.D.	.2	ug/l	99	109	81-119	9	30
Total Xylenes	N.D.	.6	ug/l	100	110	82-120	9	30
Methyl tert-Butyl Ether	N.D.	.3	ug/l	92	102	79-127	10	30
TPH-GRO - Waters	N.D.	50.	ug/l	111	111	74-116	0	30
Batch number: N023452AA	Sample number(s): 3955135							
Methyl t-butyl ether	N.D.	.5	ug/l	89		77-127		
di-Isopropyl ether	N.D.	.5	ug/l	83		74-125		
Ethyl t-butyl ether	N.D.	.5	ug/l	98		74-120		
t-Amyl methyl ether	N.D.	.5	ug/l	92		71-114		
t-Butyl alcohol	N.D.	5.	ug/l	103		59-139		

Sample Matrix Quality Control

<u>Analysis Name</u>	<u>MS %REC</u>	<u>MSD %REC</u>	<u>MS/MSD Limits</u>	<u>RPD</u>	<u>BKG MAX</u>	<u>Conc</u>	<u>DUP Conc</u>	<u>DUP RPD</u>	<u>Dup RPD Max</u>
Batch number: 02343A56A	Sample number(s): 3955134-3955135								
Benzene	83		83-130						
Toluene	97		87-129						
Ethylbenzene	102		86-133						
Total Xylenes	103		86-132						
Methyl tert-Butyl Ether	81		66-140						
TPH-GRO - Waters	108		74-132						
Batch number: N023452AA	Sample number(s): 3955135								
Methyl t-butyl ether	93	98	69-134	2	30				
di-Isopropyl ether	84	85	68-133	1	30				
Ethyl t-butyl ether	99	101	73-123	2	30				
t-Amyl methyl ether	93	94	69-118	1	30				
t-Butyl alcohol	103	100	51-148	3	30				

Surrogate Quality Control

Analysis Name: BTEX, MTBE (8021)
 Batch number: 02343A56A

	Trifluorotoluene-F	Trifluorotoluene-P
3955134	102	94
3955135	140	121
Blank	103	93
LCS	115	93
LCSD	114	95
MS	103	91
Limits:	57-146	71-130

*- Outside of specification

- (1) The result for one or both determinations was less than five times the LOQ.
- (2) The background result was more than four times the spike added.





Quality Control Summary

Client Name: ChevronTexaco
Reported: 12/18/02 at 04:11 PM

Group Number: 833498

Surrogate Quality Control

Analysis Name: Oxygenates by 8260B
Batch number: N023452AA

	Dibromofluoromethane	1,2-Dichloroethane-d4	Toluene-d8	4-Bromofluorobenzene
3955135	100	102	102	104
Blank	103	102	101	99
LCS	103	105	102	101
MS	103	103	102	102
MSD	102	105	102	101
Limits:	86-118	80-120	88-110	86-115

*- Outside of specification

- (1) The result for one or both determinations was less than five times the LOQ.
- (2) The background result was more than four times the spike added.



Lancaster Laboratories, Inc.
2425 New Holland Pike
PO Box 12425
Lancaster, PA 17605-2425
717-656-2300 Fax: 717-656-2681