



GETTLER-RYAN INC.

TRANSMITTAL

snb 656
to 275 ✓
AUG 16 2002

ROZTS

July 30, 2002
G-R #386365

TO: Mr. James Brownell
Delta Environmental Consultants, Inc.
3164 Gold Camp Drive, Suite 200
Rancho Cordova, California 95670

CC: Ms. Karen Streich
Chevron Products Company
P.O. Box 6004
San Ramon, California 94583

FROM: Deanna L. Harding
Project Coordinator
Gettler-Ryan Inc.
6747 Sierra Court, Suite J
Dublin, California 94568

RE: **Former Chevron Service Station
#9-2960
2416 Grove Way
Castro Valley, California**

WE HAVE ENCLOSED THE FOLLOWING:

COPIES	DATED	DESCRIPTION
1	July 25, 2002	Groundwater Monitoring and Sampling Report Second Quarter - Event of June 17, 2002

COMMENTS:

Please provide any comments/changes and propose any groundwater monitoring modifications for the next event prior to **August 13, 2002**, at which time the final report will be distributed to the following:

- cc: Mr. Amir Gholami, Alameda County Health Care Services, Dept. of Environmental Health, 1131 Harbor Bay Parkway, Suite 250, Alameda, CA 94502-6577
- Mr. Phil Conley, President Board of Trustees, First Presbyterian Church, 2490 Grove Way, Castro Valley, CA 94546
- Mr. Greg Gurss, Gettler-Ryan Inc., 3140 Gold Camp Drive, Suite 170, Rancho Cordova, CA 95670

Enclosures



GETTLER-RYAN INC.

July 25, 2002
G-R Job #386365

Ms. Karen Streich
Chevron Products Company
P.O. Box 6004
San Ramon, CA 94583

RE: Second Quarter Event of June 17, 2002
Groundwater Monitoring & Sampling Report
Former Chevron Service Station #9-2960
2416 Grove Way
Castro Valley, California

Dear Ms. Streich:

This report documents the most recent groundwater monitoring and sampling event performed by Gettler-Ryan Inc. (G-R) at the referenced site. All field work was conducted in accordance with G-R Standard Operating Procedure - Groundwater Sampling (attached).

Static groundwater level was measured and the well was checked for the presence of separate-phase hydrocarbons. Static water level data, groundwater elevations, and separate-phase hydrocarbon thickness (if any) are presented in the attached Table 1. A Groundwater Elevation Map is included as Figure 1.

Groundwater samples were collected from the monitoring well and submitted to a state certified laboratory for analyses. The field data sheets for this event are attached. Analytical results are presented in the table(s) listed below. The chain of custody document and laboratory analytical report are also attached.

Please call if you have any questions or comments regarding this report. Thank you.

Sincerely,

Deanna L. Harding
Project Coordinator

Hagop Kevork
P.E. No. C55734



Figure 1: Groundwater Elevation Map
Table 1: Groundwater Monitoring Data and Analytical Results
Table 2: Groundwater Analytical Results - Oxygenate Compounds
Attachments: Standard Operating Procedure - Groundwater Sampling
Field Data Sheets
Chain of Custody Document and Laboratory Analytical Reports

EXPLANATION

- ◆ Groundwater monitoring well
- ✕ Abandoned well
- 99.99 Groundwater elevation in feet referenced to Mean Sea Level
- NM Not Monitored
- P/O Paved Over

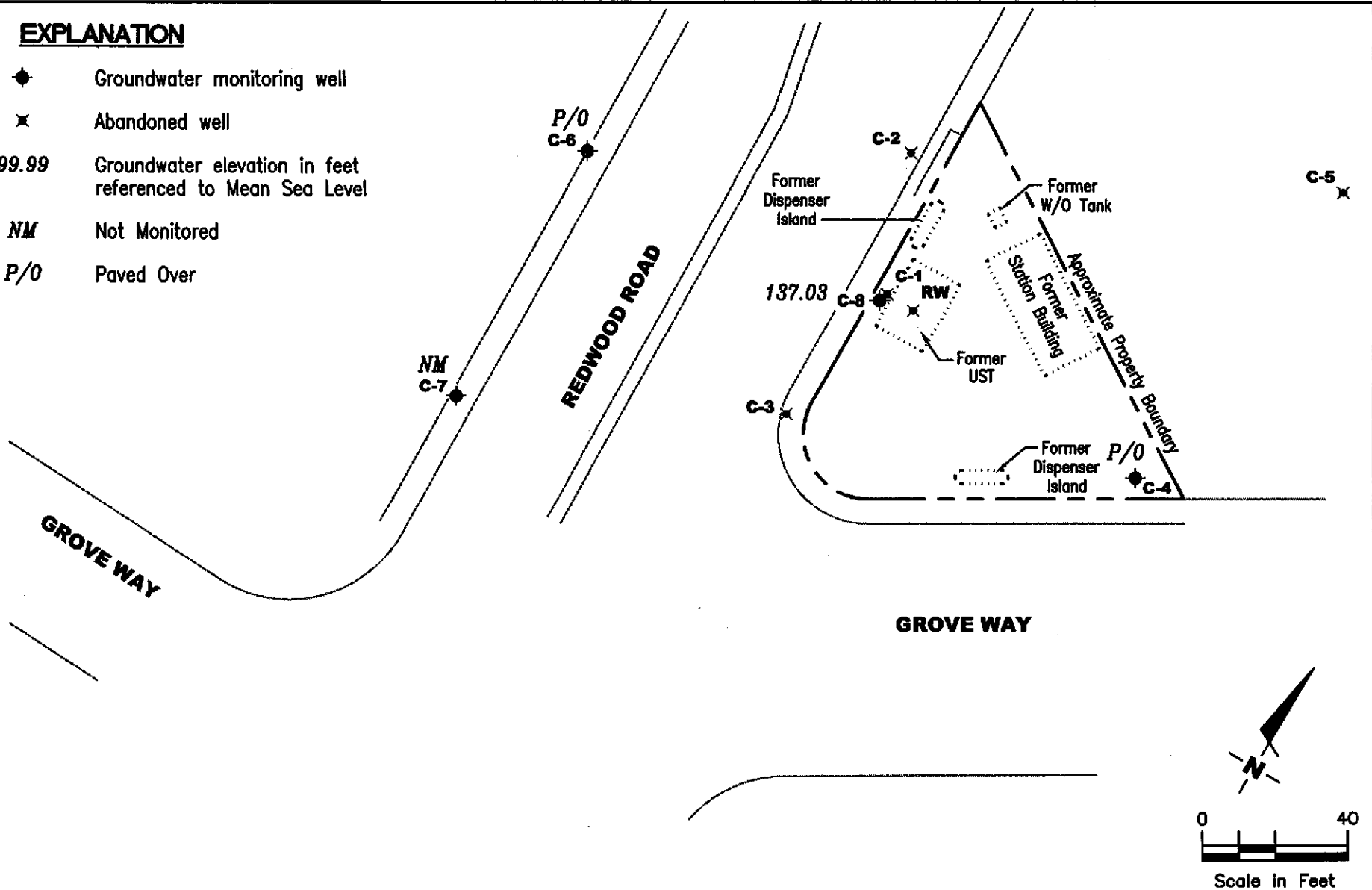

Source: Figure modified from drawing provided by RRM engineering contracting firm.

GETTLER - RYAN INC.
 6747 Sierra Ct., Suite J
 Dublin, CA 94568 (925) 551-7555

GROUNDWATER ELEVATION MAP
 Former Chevron Service Station #9-2960
 2416 Grove Way
 Castro Valley, California

FIGURE
1

PROJECT NUMBER
386365

REVIEWED BY

DATE
 June 17, 2002

REVISED DATE

Table 1
Groundwater Monitoring Data and Analytical Results
Former Chevron Service Station #9-2960
2416 Grove Way
Castro Valley, California

WELL ID/ DATE	TOC* (ft.)	GWE (msl)	DTW (ft.)	SPHT (ft.)	SPH REMOVED (gallons)	TPH-G (ppb)	B (ppb)	T (ppb)	E (ppb)	X (ppb)	MTBE (ppb)
C-1											
10/23/86	153.36	--	--	--	--	3,100	6,400	3,700	--	4,300	--
09/10/87	153.36	--	--	--	--	120,000	25,000	60,000	13,000	56,000	--
10/03/90	153.36	134.69	18.67	--	--	--	--	--	--	--	--
10/25/90	153.36	135.22	18.71	0.71	--	--	--	--	--	--	--
01/22/91	153.36	135.22	18.70	0.70	--	--	--	--	--	--	--
02/21/91	153.36	135.44	18.62	0.88	--	--	--	--	--	--	--
04/01/91	153.36	136.47	16.91	0.03	--	--	--	--	--	--	--
04/11/91	153.36	136.49	16.90	0.04	--	--	--	--	--	--	--
07/01/91	153.36	135.75	17.61	0.00	--	--	--	--	--	--	--
09/24/91	153.36	135.17	18.98	0.99	--	--	--	--	--	--	--
10/23/91	153.36	135.03	19.32	1.24	--	--	--	--	--	--	--
11/22/91	153.36	134.53	18.83	0.97	--	--	--	--	--	--	--
01/09/92	153.36	136.10	17.26	--	--	--	--	--	--	--	--
03/06/92	153.36	137.16	16.69	0.61	--	--	--	--	--	--	--
06/04/92	153.36	136.44	17.10	0.22	--	--	--	--	--	--	--
09/28/92	153.36	--	18.71	0.77	--	--	--	--	--	--	--
12/17/92	153.36	--	17.54	0.45	--	--	--	--	--	--	--
04/29/93	153.36	137.50	16.40	0.68	--	--	--	--	--	--	--
07/26/93	153.36	136.92	16.85	0.51	--	--	--	--	--	--	--
10/22/93	153.36	135.55	17.83	0.03	--	--	--	--	--	--	--
01/24/94	153.36	--	--	--	--	--	--	--	--	--	--
04/11/94	153.36	136.01	17.76	0.51	--	--	--	--	--	--	--
07/01/94	153.36	135.95	17.46	0.06	--	--	--	--	--	--	--
10/06/94	153.36	135.24	18.18	0.08	--	--	--	--	--	--	--
01/11/95	153.36	136.63	16.79	0.08	0.039	--	--	--	--	--	--
04/07/95	153.36	139.23	14.13	--	--	44,000	410	100	130	5,400	--
07/20/95	153.36	136.84	16.52	--	--	16,000	96	81	53	1,000	--
09/22/95	153.36	137.22	16.14	--	--	59,000	150	36	16	56	--
01/02/96	153.36	137.43	15.93	--	--	29,000	4,500	1,100	520	1,900	<250
04/26/96	153.36	137.31	16.05	--	--	7,200	1,300	340	130	390	--

Table 1
Groundwater Monitoring Data and Analytical Results
Former Chevron Service Station #9-2960
2416 Grove Way
Castro Valley, California

WELL ID/ DATE	TOC* (ft.)	GWE (msl)	DTW (ft.)	SPHT (ft.)	SPH REMOVED (gallons)	TPH-G (ppb)	B (ppb)	T (ppb)	E (ppb)	X (ppb)	MTBE (ppb)
C-1 (cont)											
07/22/96	153.36	143.14	10.22	--	--	7,300	2,500	170	360	520	--
10/17/96	153.36	137.64	15.72	--	--	19,000	3,400	59	360	430	--
01/23/97	153.36	138.91	14.45	--	--	15,000	2,900	390	250	480	--
07/10/97	153.36	137.19	16.17	--	--	13,000	2,100	69	200	380	--
01/15/98	153.36	INACCESSIBLE		--	--	--	--	--	--	--	--
01/16/98	153.36	138.63	14.73	--	--	4,700	1,200	<20	140	40	--
07/09/98	153.36	138.14	15.22	--	--	9,900	1,500	60	150	170	--
ABANDONED											
C-2											
10/23/86	151.84	--	--	--	--	30,000	2,700	1,900	--	1,500	--
09/10/87	151.84	--	--	--	--	14,000	2,600	2,900	500	1,200	--
10/16/89	151.84	--	--	--	--	600	260	34	1.7	41	--
01/04/90	151.84	--	--	--	--	2,600	470	150	23	130	--
04/05/90	151.84	--	--	--	--	500	280	29	6.3	19	--
07/02/90	151.84	--	--	--	--	2,400	670	110	17	76	--
10/03/90	151.84	--	--	--	--	--	--	--	--	--	--
10/25/90	151.84	135.24	16.60	--	--	1,300	390	47	9.0	58	--
01/22/91	151.84	135.15	16.69	--	--	2,600	680	88	29	130	--
02/21/91	151.84	135.53	16.31	--	--	--	--	--	--	--	--
04/01/91	151.84	136.76	15.08	--	--	--	--	--	--	--	--
04/11/91	151.84	136.61	15.23	--	--	--	--	--	--	--	--
07/01/91	151.84	135.88	15.96	--	--	--	--	--	--	--	--
09/24/91	151.84	135.33	16.51	--	--	3,600	1,400	63	6.9	63	--
10/23/91	151.84	135.18	16.66	--	--	--	--	--	--	--	--
11/22/91	151.84	135.47	16.37	--	--	--	--	--	--	--	--
01/09/92	151.84	136.28	15.56	--	--	7,100	770	740	190	690	--
03/06/92	151.84	137.47	14.37	--	--	3,200	250	230	59	220	--
06/04/92	151.84	136.80	15.04	--	--	1,500	<0.5	180	42	130	--

Table 1
Groundwater Monitoring Data and Analytical Results
Former Chevron Service Station #9-2960
2416 Grove Way
Castro Valley, California

WELL ID/ DATE	TOC* (ft.)	GWE (msl)	DTW (ft.)	SPHT (ft.)	SPH REMOVED (gallons)	TPH-G (ppb)	B (ppb)	T (ppb)	E (ppb)	X (ppb)	MTBE (ppb)
C-2 (cont)											
09/28/92	151.84	135.44	16.40	--	--	6,400	940	230	57	220	--
12/17/92	151.84	136.46	15.38	--	--	1,500	370	160	6.0	25	--
04/29/93	151.84	136.87	14.97	--	--	1,800	690	120	74	140	--
07/29/93	151.84	136.92	14.92	--	--	4,300	1,500	96	29	96	--
10/22/93	151.84	136.03	15.81	--	--	820	560	57	15	58	--
01/24/94	151.84	--	--	--	--	--	--	--	--	--	--
04/11/94	151.84	136.49	15.35	--	--	2,000	240	48	36	110	--
07/01/94	151.84	136.44	15.40	--	--	370	55	12	3.1	8.6	--
10/06/94	151.84	135.84	16.00	--	--	150	47	4.8	1.8	5.4	--
01/11/95	151.84	137.06	14.78	--	--	52	0.65	<0.5	<0.5	<0.5	--
04/07/95	151.84	138.93	12.91	--	--	1,500	260	64	52	85	--
07/20/95	151.84	136.81	15.03	--	--	3,000	500	100	96	110	--
09/22/95	151.84	137.05	14.79	--	--	2,000	630	120	20	79	--
01/02/96	151.84	137.37	14.47	--	--	1,900	240	110	58	180	<12
04/26/96	151.84	137.97	13.87	--	--	1,300	340	190	44	120	--
07/22/96	151.84	136.73	15.11	--	--	3,700	1,100	140	150	330	--
10/17/96	151.84	136.80	15.04	--	--	22,000	3,900	1,600	350	1,800	--
01/23/97	151.84	138.86	12.98	--	--	2,000	260	48	76	94	--
07/10/97	151.84	137.21	14.63	--	--	5,100	710	200	190	380	--
01/15/98	153.36	INACCESSIBLE		--	--	--	--	--	--	--	--
01/16/98	151.84	138.61	13.23	--	--	7,600	1,600	130	320	650	--
07/09/98	151.84	138.17	13.67	--	--	10,000	1,100	410	180	410	--
ABANDONED											
C-3											
10/23/86	154.13	--	--	--	--	3,300	49	24	--	20	--
09/10/87	154.13	--	--	--	--	200	110	2.6	<2.0	<2.0	--
10/16/89	154.13	--	--	--	--	900	640	4.2	1.6	16	--
01/04/90	154.13	--	--	--	--	920	430	7.0	6.0	7.0	--

Table 1
Groundwater Monitoring Data and Analytical Results
Former Chevron Service Station #9-2960
2416 Grove Way
Castro Valley, California

WELL ID/ DATE	TOC* (ft.)	GWE (msl)	DTW (ft.)	SPHT (ft.)	SPH REMOVED (gallons)	TPH-G (ppb)	B (ppb)	T (ppb)	E (ppb)	X (ppb)	MTBE (ppb)
C-3 (cont)											
04/05/90	154.13	--	--	--	--	930	690	3.4	5.1	4.8	--
07/02/90	154.13	--	--	--	--	1,700	590	11	4.8	9.4	--
10/03/90	154.13	134.97	19.16	--	--	--	--	--	--	--	--
10/25/90	154.13	134.85	19.28	--	--	750	510	2.0	6.0	5.0	--
01/22/91	154.13	134.95	19.18	--	--	430	260	2.0	2.0	5.0	--
01/22/91	154.13	134.95	19.18	--	--	400	250	2.0	2.0	5.0	--
02/21/91	154.13	135.25	18.88	--	--	--	--	--	--	--	--
04/01/91	154.13	136.54	17.59	--	--	--	--	--	--	--	--
04/11/91	154.13	136.32	17.81	--	--	--	--	--	--	--	--
07/01/91	154.13	135.57	18.56	--	--	--	--	--	--	--	--
09/24/91	154.13	135.01	19.12	--	--	260	52	0.7	0.8	2.2	--
10/23/91	154.13	134.89	19.24	--	--	--	--	--	--	--	--
11/22/91	154.13	135.10	19.03	--	--	--	--	--	--	--	--
01/09/92	154.13	135.90	18.23	--	--	240	120	0.9	<0.5	1.6	--
03/06/92	154.13	137.09	17.04	--	--	230	68	1.2	1.2	1.3	--
06/04/92	154.13	136.34	17.79	--	--	80	36	0.6	0.5	0.7	--
09/28/92	154.13	135.13	19.00	--	--	84	49	<0.5	<0.5	1.5	--
12/17/92	154.13	135.95	18.18	--	--	220	30	<0.5	<0.5	<0.5	--
04/29/93	154.13	135.35	18.78	--	--	380	12	0.6	<0.5	<1.5	--
07/26/93	154.13	136.41	17.72	--	--	800	38	1.1	<0.5	<1.5	--
10/22/93	154.13	135.63	18.50	--	--	200	64	0.6	<0.5	<1.5	--
01/24/94	154.13	135.62	18.51	--	--	<50	<0.5	<0.5	<0.5	<0.5	--
04/11/94	154.13	136.09	18.04	--	--	100	3.6	2.1	<0.5	2.3	--
07/01/94	154.13	136.01	18.12	--	--	140	3.7	1.2	<0.5	1.0	--
10/06/94	154.13	135.50	18.63	--	--	<50	<0.5	<0.5	<0.5	<0.5	--
01/11/95	154.13	137.01	17.12	--	--	<50	<0.5	<0.5	<0.5	<0.5	--
04/07/95	154.13	138.34	15.79	--	--	<50	<0.5	<0.5	<0.5	<0.5	--
07/20/95	154.13	136.37	17.76	--	--	<50	1.5	1.9	<0.5	3.5	--
09/22/95	154.13	136.58	17.55	--	--	<50	<0.5	<0.5	<0.5	<0.5	--
01/02/96	154.13	136.88	17.25	--	--	<50	<0.5	<0.5	<0.5	1.1	<2.5

Table 1
Groundwater Monitoring Data and Analytical Results
Former Chevron Service Station #9-2960
2416 Grove Way
Castro Valley, California

WELL ID/ DATE	TOC* (ft.)	GWE (msl)	DTW (ft.)	SPHT (ft.)	SPH REMOVED (gallons)	TPH-G (ppb)	B (ppb)	T (ppb)	E (ppb)	X (ppb)	MTBE (ppb)
C-3 (cont)											
04/26/96	154.13	137.42	16.71	--	--	<50	<0.5	<0.5	<0.5	<0.5	--
07/22/96	154.13	136.50	17.63	--	--	<50	<0.5	<0.5	<0.5	<0.5	--
10/17/96	154.13	136.33	17.80	--	--	<50	<0.5	<0.5	<0.5	<0.5	--
01/23/97	154.13	138.33	15.80	--	--	<50	<0.5	<0.5	<0.5	<0.5	--
07/10/97	154.13	136.63	17.50	--	--	<50	<0.5	<0.5	<0.5	<0.5	--
01/15/98	154.13	137.98	16.15	--	--	<50	<0.5	<0.5	<0.5	<0.5	--
01/16/98	154.13	138.04	16.09	--	--	REGAUGE	--	--	--	--	--
07/09/98	154.13	137.57	16.56	--	--	<50	<0.5	<0.5	<0.5	<0.5	--
ABANDONED											
C-4											
10/23/86	156.00	--	--	--	--	570	3.0	4.0	--	5.0	--
09/10/87	156.00	--	--	--	--	500	3.0	<0.5	<0.5	<0.5	--
10/16/89	156.00	--	--	--	--	<500	12	1.0	<0.5	0.8	--
01/04/90	156.00	--	--	--	--	<500	5.0	<0.5	<0.5	0.9	--
04/05/90	156.00	--	--	--	--	<50	6.6	<0.5	<0.5	0.7	--
07/02/90	156.00	--	--	--	--	71	4.1	<0.5	<0.5	<0.5	--
10/03/90	156.00	--	--	--	--	--	--	--	--	--	--
10/25/90	156.00	135.57	20.43	--	--	<50	2.0	<0.5	<0.5	<0.5	--
01/22/91	156.00	135.50	20.50	--	--	<50	3.0	<0.5	<0.5	<0.5	--
02/21/91	156.00	135.77	20.23	--	--	--	--	--	--	--	--
04/01/91	156.00	136.97	19.03	--	--	--	--	--	--	--	--
04/11/91	156.00	136.95	19.05	--	--	--	--	--	--	--	--
07/01/91	156.00	136.10	19.90	--	--	--	--	--	--	--	--
09/24/91	156.00	135.59	20.41	--	--	87	1.6	<0.5	<0.5	<0.5	--
10/23/91	156.00	135.47	20.53	--	--	--	--	--	--	--	--
11/22/91	156.00	135.65	20.35	--	--	--	--	--	--	--	--
01/09/92	156.00	136.46	19.54	--	--	51	4.3	<0.5	<0.5	<0.5	--
01/09/92	156.00	136.46	19.54	--	--	<50	4.8	<0.5	<0.5	<0.5	--

Table 1
Groundwater Monitoring Data and Analytical Results
Former Chevron Service Station #9-2960
2416 Grove Way
Castro Valley, California

WELL ID/ DATE	TOC* (ft.)	GWE (msl)	DTW (ft.)	SPHT (ft.)	SPH		B (ppb)	T (ppb)	E (ppb)	X (ppb)	MTBE (ppb)
					REMOVED (gallons)	TPH-G (ppb)					
C-4 (cont)											
03/06/92	156.00	137.74	18.26	--	--	<50	0.8	<0.5	<0.5	<0.5	--
06/04/92	156.00	137.08	18.92	--	--	<50	<0.5	<0.5	<0.5	0.7	--
09/28/92	156.00	135.69	20.31	--	--	<50	<0.5	<0.5	<0.5	<0.5	--
12/17/92	156.00	136.43	19.57	--	--	<50	<0.5	<0.5	<0.5	<0.5	--
04/29/93	156.00	138.22	17.78	--	--	<50	<0.5	<0.5	<0.5	<1.5	--
07/26/93	156.00	--	--	--	--	--	--	--	--	--	--
08/18/93	156.00	137.09	18.91	--	--	<50	<0.5	<0.5	<0.5	<1.5	--
10/22/93	156.00	136.61	19.39	--	--	<50	2.9	2.1	1.1	4.3	--
01/24/94	156.00	136.58	19.42	--	--	<50	<0.5	<0.5	<0.5	<0.5	--
04/11/94	156.00	136.86	19.14	--	--	<50	<0.5	0.6	<0.5	0.5	--
07/01/94	156.00	136.80	19.20	--	--	<50	<0.5	<0.5	<0.5	<0.5	--
10/06/94	156.00	136.26	19.74	--	--	<50	<0.5	<0.5	<0.5	<0.5	--
01/11/95	156.00	139.70	16.30	--	--	<50	<0.5	<0.5	<0.5	<0.5	--
04/07/95	156.00	139.49	16.51	--	--	<50	<0.5	<0.5	<0.5	<0.5	--
07/20/95	156.00	137.20	18.80	--	--	<50	<0.5	<0.5	<0.5	<0.5	--
09/22/95	156.00	137.26	18.74	--	--	<50	<0.5	<0.5	<0.5	<0.5	--
01/02/96	156.00	137.65	18.35	--	--	<50	1.6	1.8	0.95	4.1	<2.5
04/26/96	156.00	138.43	17.57	--	--	<50	<0.5	<0.5	<0.5	<0.5	--
07/22/96	156.00	137.00	19.00	--	--	<50	<0.5	<0.5	<0.5	<0.5	--
10/17/96	156.00	136.96	19.04	--	--	<50	<0.5	<0.5	<0.5	<0.5	--
01/23/97	156.00	139.31	16.69	--	--	<50	<0.5	<0.5	<0.5	<0.5	--
07/10/97	156.00	137.46	18.54	--	--	SAMPLED ANNUALLY		--	--	--	--
01/15/98	156.00	143.92	12.08	--	--	<50	1.0	1.4	<0.5	3.5	--
01/16/98	156.00	138.84	17.16	--	--	REGAUGE		--	--	--	--
07/09/98	156.00	138.29	17.71	--	--	--	--	--	--	--	--
01/08/99	156.00	139.19	16.81	--	--	<50	<0.5	<0.5	<0.5	<0.5	--
07/09/99	156.00	UNABLE TO LOCATE		--	--	--	--	--	--	--	--
02/01/00	156.00	UNABLE TO LOCATE		--	--	--	--	--	--	--	--
08/21/00	156.00	UNABLE TO LOCATE - PAVED OVER				--	--	--	--	--	--

Table 1
Groundwater Monitoring Data and Analytical Results
Former Chevron Service Station #9-2960
2416 Grove Way
Castro Valley, California

WELL ID/ DATE	TOC* (ft.)	GWE (msl)	DTW (ft.)	SPHT (ft.)	SPH REMOVED (gallons)	TPH-G (ppb)	B (ppb)	T (ppb)	E (ppb)	X (ppb)	MTBE (ppb)
C-4 (cont)											
01/25/01	156.00	UNABLE TO LOCATE - PAVED OVER				--	--	--	--	--	--
07/10/01	156.00	UNABLE TO LOCATE - PAVED OVER				--	--	--	--	--	--
01/08/02	156.00	UNABLE TO LOCATE - PAVED OVER				--	--	--	--	--	--
03/26/02	156.00	UNABLE TO LOCATE - PAVED OVER				--	--	--	--	--	--
06/17/02	156.00	UNABLE TO LOCATE - PAVED OVER				--	--	--	--	--	--
C-5											
10/03/90	153.38	135.60	17.78	--	--	<50	<0.5	<0.5	<0.5	<0.5	--
10/25/90	153.38	135.46	17.92	--	--	<50	<0.5	<0.5	<0.5	<0.5	--
11/09/90	153.38	135.46	17.92	--	--	<50	<0.5	<0.5	<0.5	<0.5	--
01/22/91	153.38	135.58	17.80	--	--	<50	<0.5	<0.5	<0.5	<0.5	--
02/21/91	153.38	135.87	17.51	--	--	--	--	--	--	--	--
04/01/91	153.38	137.07	16.31	--	--	--	--	--	--	--	--
04/11/91	153.38	137.02	16.36	--	--	--	--	--	--	--	--
07/01/91	153.38	136.26	17.12	--	--	--	--	--	--	--	--
09/24/91	153.38	135.68	17.70	--	--	<50	<0.5	<0.5	<0.5	<0.5	--
09/24/91	153.38	135.68	17.70	--	--	<50	<0.5	<0.5	<0.5	<0.5	--
10/23/91	153.38	135.56	17.82	--	--	--	--	--	--	--	--
11/22/91	153.38	135.77	17.61	--	--	--	--	--	--	--	--
01/09/92	153.38	136.34	17.04	--	--	<50	<0.5	0.7	<0.5	<0.5	--
03/06/92	153.38	137.62	15.76	--	--	<50	<0.5	<0.5	<0.5	<0.5	--
06/04/92	153.38	136.98	16.40	--	--	<50	<0.5	<0.5	<0.5	<0.5	--
09/28/92	153.38	135.80	17.58	--	--	<50	<0.5	<0.5	<0.5	<0.5	--
12/17/92	153.38	136.56	16.82	--	--	<50	<0.5	<0.5	<0.5	<0.5	--
04/29/93	153.38	138.14	15.24	--	--	<50	<0.5	<0.5	<0.5	<1.5	--
07/26/93	153.38	137.08	16.30	--	--	<50	<0.5	<0.5	<0.5	<1.5	--
10/22/93	153.38	136.30	17.08	--	--	52	2.3	2.7	1.1	5.2	--
01/24/94	153.38	136.25	17.13	--	--	<50	<0.5	<0.5	<0.5	<0.5	--
04/11/94	153.38	136.75	16.63	--	--	<50	<0.5	0.7	<0.5	0.6	--

Table 1
Groundwater Monitoring Data and Analytical Results
Former Chevron Service Station #9-2960
2416 Grove Way
Castro Valley, California

WELL ID/ DATE	TOC* (ft.)	GWE (msl)	DTW (ft.)	SPHT (ft.)	SPH		B (ppb)	T (ppb)	E (ppb)	X (ppb)	MTBE (ppb)
					REMOVED (gallons)	TPH-G (ppb)					
C-5 (cont)											
07/01/94	153.38	136.73	16.65	--	--	<50	<0.5	<0.5	<0.5	<0.5	--
10/06/94	153.38	136.16	17.22	--	--	<50	<0.5	<0.5	<0.5	<0.5	--
01/11/95	153.38	137.41	15.97	--	--	<50	<0.5	<0.5	<0.5	<0.5	--
04/07/95	153.38	139.37	14.01	--	--	<50	<0.5	<0.5	<0.5	<0.5	--
07/20/95	153.38	137.17	16.21	--	--	<50	<0.5	<0.5	<0.5	0.61	--
09/22/95	153.38	137.07	16.31	--	--	62	<0.5	<0.5	<0.5	<0.5	--
01/02/96	153.38	137.56	15.82	--	--	<50	<0.5	<0.5	<0.5	<0.5	<2.5
04/26/96	153.38	138.41	14.97	--	--	<50	<0.5	<0.5	<0.5	<0.5	--
07/22/96	153.38	137.06	16.32	--	--	<50	<0.5	<0.5	<0.5	<0.5	--
10/17/96	153.38	136.88	16.50	--	--	<50	<0.5	<0.5	<0.5	<0.5	--
01/23/97	153.38	139.18	14.20	--	--	<50	<0.5	<0.5	<0.5	<0.5	--
ABANDONED											
C-6											
10/03/90	152.84	134.70	18.14	--	--	<50	<0.5	<0.5	<0.5	<0.5	--
10/25/90	152.84	134.55	18.29	--	--	<50	<0.5	1.0	<0.5	<0.5	--
11/09/90	152.84	134.58	18.26	--	--	<50	<0.5	<0.5	<0.5	<0.5	--
01/22/91	152.84	134.69	18.15	--	--	<50	<0.5	<0.5	<0.5	<0.5	--
02/21/91	152.84	134.92	17.92	--	--	--	--	--	--	--	--
04/01/91	152.84	135.73	17.11	--	--	--	--	--	--	--	--
04/11/91	152.84	135.83	17.01	--	--	--	--	--	--	--	--
07/01/91	152.84	135.12	17.72	--	--	--	--	--	--	--	--
09/24/91	152.84	135.72	17.12	--	--	<50	<0.5	<0.5	<0.5	<0.5	--
10/23/91	152.84	134.59	18.25	--	--	--	--	--	--	--	--
11/22/91	152.84	134.79	18.05	--	--	--	--	--	--	--	--
01/09/92	152.84	135.42	17.42	--	--	<50	<0.5	<0.5	<0.5	<0.5	--
03/06/92	152.84	136.33	16.51	--	--	<50	<0.5	<0.5	<0.5	<0.5	--
06/04/92	152.84	135.83	17.01	--	--	<50	<0.5	<0.5	<0.5	<0.5	--
09/28/92	152.84	134.84	18.00	--	--	<50	<0.5	<0.5	<0.5	<0.5	--

Table 1
Groundwater Monitoring Data and Analytical Results
Former Chevron Service Station #9-2960
2416 Grove Way
Castro Valley, California

WELL ID/ DATE	TOC* (ft.)	GWE (msl)	DTW (ft.)	SPHT (ft.)	SPH		B (ppb)	T (ppb)	E (ppb)	X (ppb)	MTBE (ppb)
					REMOVED (gallons)	TPH-G (ppb)					
C-6 (cont)											
12/17/92	152.84	135.58	17.26	--	--	<50	<0.5	<0.5	<0.5	<0.5	--
04/29/93	152.84	136.61	16.23	--	--	<50	<0.5	<0.5	<0.5	<1.5	--
07/29/93	152.84	135.88	16.96	--	--	<50	<0.5	<0.5	<0.5	<1.5	--
10/22/93	152.84	135.38	17.46	--	--	74	7.4	6.1	3.3	9.7	--
01/24/94	152.84	135.38	17.46	--	--	<50	<0.5	<0.5	<0.5	<0.5	--
04/11/94	152.84	135.64	17.20	--	--	<50	<0.5	<0.5	<0.5	<0.5	--
07/01/94	152.84	135.66	17.18	--	--	<50	<0.5	<0.5	<0.5	<0.5	--
10/06/94	152.84	135.19	17.65	--	--	<50	<0.5	<0.5	<0.5	<0.5	--
01/11/95	152.84	136.18	16.66	--	--	<50	<0.5	<0.5	<0.5	<0.5	--
04/07/95	152.84	137.25	15.59	--	--	<50	<0.5	<0.5	<0.5	<0.5	--
07/20/95	152.84	135.80	17.04	--	--	<50	<0.5	<0.5	<0.5	<0.5	--
09/22/95	152.84	135.74	17.10	--	--	<50	<0.5	<0.5	<0.5	<0.5	--
01/02/96	152.84	136.08	16.76	--	--	<50	<0.5	<0.5	<0.5	<0.5	<2.5
04/26/96	152.84	136.64	16.20	--	--	<50	<0.5	<0.5	<0.5	<0.5	--
07/22/96	152.84	135.79	17.05	--	--	<50	<0.5	<0.5	<0.5	<0.5	--
10/17/96	152.84	135.62	17.22	--	--	<50	<0.5	<0.5	<0.5	<0.5	--
01/23/97	152.84	136.99	15.85	--	--	<50	<0.5	<0.5	<0.5	<0.5	--
07/10/97	152.84	135.95	16.89	--	--	<50	<0.5	<0.5	<0.5	<0.5	--
01/15/98	152.84	136.64	16.20	--	--	<50	<0.5	<0.5	<0.5	<0.5	--
01/16/98	152.84	136.74	16.10	--	--	REGAUGE	--	--	--	--	--
07/09/98	152.84	136.71	16.13	--	--	<50	<0.5	<0.5	<0.5	<0.5	--
01/08/99	152.84	137.57	15.27	--	--	<50	<0.5	<0.5	<0.5	<0.5	--
07/09/99	152.84	136.60	16.24	--	--	<50	<0.5	<0.5	<0.5	<0.5	<5.0
02/01/00	152.84	136.57	16.27	--	--	<50	<0.5	<0.5	<0.5	<0.5	<5.0
08/21/00	152.84	UNABLE TO LOCATE - PAVED OVER				--	--	--	--	--	--
01/25/01	152.84	UNABLE TO LOCATE - PAVED OVER				--	--	--	--	--	--
07/10/01	152.84	UNABLE TO LOCATE - PAVED OVER				--	--	--	--	--	--
01/08/02	152.84	UNABLE TO LOCATE - PAVED OVER				--	--	--	--	--	--
03/26/02	152.84	UNABLE TO LOCATE - PAVED OVER				--	--	--	--	--	--
06/17/02	152.84	UNABLE TO LOCATE - PAVED OVER				--	--	--	--	--	--

Table 1
Groundwater Monitoring Data and Analytical Results
Former Chevron Service Station #9-2960
2416 Grove Way
Castro Valley, California

WELL ID/ DATE	TOC* (ft.)	GWE (msl)	DTW (ft.)	SPHT (ft.)	SPH		B (ppb)	T (ppb)	E (ppb)	X (ppb)	MTBE (ppb)
					REMOVED (gallons)	TPH-G (ppb)					
C-7											
10/03/90	155.34	134.52	20.82	--	--	<50	<0.5	<0.5	<0.5	<0.5	--
10/25/90	155.34	134.43	20.91	--	--	<50	<0.5	1.0	<0.5	<0.5	--
11/09/90	155.34	134.40	20.94	--	--	<50	<0.5	<0.5	<0.5	<0.5	--
01/22/91	155.34	133.84	21.50	--	--	<50	4.0	<0.5	<0.5	<0.5	--
02/21/91	155.34	134.63	20.71	--	--	--	--	--	--	--	--
04/01/91	155.34	135.34	20.00	--	--	--	--	--	--	--	--
04/11/91	155.34	135.29	20.05	--	--	--	--	--	--	--	--
07/01/91	155.34	134.82	20.52	--	--	--	--	--	--	--	--
09/24/91	155.34	134.52	20.82	--	--	<50	<0.5	<0.5	<0.5	<0.5	--
10/23/91	155.34	134.43	20.91	--	--	--	--	--	--	--	--
11/22/91	155.34	134.55	20.79	--	--	--	--	--	--	--	--
01/09/92	155.34	135.18	20.16	--	--	<50	<0.5	<0.5	<0.5	0.9	--
03/06/92	155.34	135.92	19.42	--	--	<50	<0.5	<0.5	<0.5	<0.5	--
06/04/92	155.34	135.53	19.81	--	--	250	<0.5	<0.5	<0.5	<0.5	--
09/28/92	155.34	134.69	20.65	--	--	<50	<0.5	<0.5	<0.5	<0.5	--
12/17/92	155.34	135.32	20.02	--	--	<50	<0.5	<0.5	<0.5	<0.5	--
04/29/93	155.34	136.19	19.15	--	--	<50	<0.5	<0.5	<0.5	<1.5	--
07/26/93	155.34	135.57	19.77	--	--	<50	<0.5	<0.5	<0.5	<1.5	--
10/22/93	155.34	135.17	20.17	--	--	--	--	--	--	--	--
01/24/94	155.34	135.11	20.23	--	--	<50	<0.5	<0.5	<0.5	<0.5	--
04/11/94	155.34	135.39	19.95	--	--	<50	<0.5	<0.5	<0.5	<0.5	--
07/01/94	155.34	135.42	19.92	--	--	<50	<0.5	<0.5	<0.5	<0.5	--
10/06/94	155.34	135.03	20.31	--	--	<50	<0.5	<0.5	<0.5	<0.5	--
01/11/95	155.34	135.98	19.36	--	--	<50	<0.5	<0.5	<0.5	<0.5	--
04/07/95	155.34	136.84	18.50	--	--	<50	<0.5	<0.5	<0.5	<0.5	--
07/20/95	155.34	135.46	19.88	--	--	<50	<0.5	<0.5	<0.5	<0.5	--
09/22/95	155.34	135.38	19.96	--	--	<50	<0.5	<0.5	<0.5	<0.5	--
01/02/96	155.34	135.64	19.70	--	--	<50	<0.5	<0.5	<0.5	<0.5	<2.5
04/26/96	155.34	136.17	19.17	--	--	<50	<0.5	<0.5	<0.5	<0.5	--
07/22/96	155.34	135.49	19.85	--	--	<50	<0.5	<0.5	<0.5	<0.5	--

Table 1
Groundwater Monitoring Data and Analytical Results
Former Chevron Service Station #9-2960
2416 Grove Way
Castro Valley, California

WELL ID/ DATE	TOC* (ft.)	GWE (msl)	DTW (ft.)	SPHT (ft.)	SPH REMOVED (gallons)	TPH-G (ppb)	B (ppb)	T (ppb)	E (ppb)	X (ppb)	MTBE (ppb)
C-7 (cont)											
10/17/96	155.34	135.34	20.00	--	--	<50	<0.5	<0.5	<0.5	<0.5	--
01/23/97	155.34	136.44	18.90	--	--	<50	<0.5	<0.5	<0.5	<0.5	--
07/10/97	155.34	135.58	19.76	--	--	<50	<0.5	<0.5	<0.5	<0.5	--
01/15/98	155.34	136.02	19.32	--	--	<50	<0.5	<0.5	<0.5	<0.5	--
01/16/98	155.34	136.14	19.20	--	--	REGAUGE	--	--	--	--	--
07/09/98	155.34	136.02	19.32	--	--	<50	<0.5	<0.5	<0.5	<0.5	--
01/08/99	155.34	136.83	18.51	--	--	<50	<0.5	<0.5	<0.5	<0.5	--
07/09/99	155.34	136.16	19.18	--	--	<50	<0.5	<0.5	<0.5	<0.5	<5.0
02/01/00	155.34	136.21	19.13	--	--	<50	<0.5	<0.5	<0.5	<0.5	<5.0
08/21/00	155.34	136.16	19.18	0.00	0.00	<50	<0.50	<0.50	<0.50	<0.50	<2.5
01/25/01	155.34	136.09	19.25	0.00	0.00	<50.0	<0.500	<0.500	<0.500	<0.500	<2.50
07/10/01	155.34	136.17	19.17	0.00	0.00	<50	<0.50	<0.50	<0.50	<0.50	<2.5/<2.0 ¹
01/08/02	155.34	136.31	19.03	0.00	0.00	<50	<0.50	<0.50	<0.50	<1.5	<2.5
03/26/02	155.08	--	--	--	--	--	--	--	--	--	--
NOT MONITORED / SAMPLED											
C-8											
03/26/02 ²	153.41	137.96	15.45	0.00	0.00	11,000	380	130	120	530	<25/<2 ¹
06/17/02	153.41	137.03	16.38	0.00	0.00	11,000	490	65	170	470	<20/<2 ¹
TRIP BLANK											
10/03/90	--	--	--	--	--	<50	<0.5	<0.5	<0.5	<0.5	--
10/25/90	--	--	--	--	--	<50	<0.5	<0.5	<0.5	<0.5	--
11/09/90	--	--	--	--	--	<50	<0.5	<0.5	<0.5	<0.5	--
01/22/91	--	--	--	--	--	<50	<0.5	<0.5	<0.5	<0.5	--
09/24/91	--	--	--	--	--	<50	<0.5	<0.5	<0.5	<0.5	--
01/09/92	--	--	--	--	--	<50	<0.5	<0.5	<0.5	<0.5	--
03/06/92	--	--	--	--	--	<50	<0.5	<0.5	<0.5	<0.5	--

Table 1
Groundwater Monitoring Data and Analytical Results
Former Chevron Service Station #9-2960
2416 Grove Way
Castro Valley, California

WELL ID/ DATE	TOC* (ft.)	GWE (msl)	DTW (ft.)	SPHT (ft.)	SPH		B (ppb)	T (ppb)	E (ppb)	X (ppb)	MTBE (ppb)
					REMOVED (gallons)	TPH-G (ppb)					
TRIP BLANK (cont)											
06/04/92	--	--	--	--	--	<50	<0.5	<0.5	<0.5	<0.5	--
09/28/92	--	--	--	--	--	<50	<0.5	<0.5	<0.5	<0.5	--
12/17/92	--	--	--	--	--	<50	<0.5	<0.5	<0.5	<0.5	--
04/29/93	--	--	--	--	--	<50	<0.5	<0.5	<0.5	<1.5	--
07/26/93	--	--	--	--	--	<50	<0.5	<0.5	<0.5	<1.5	--
10/22/93	--	--	--	--	--	<50	<0.5	<0.5	<0.5	<1.5	--
01/24/94	--	--	--	--	--	<50	<0.5	<0.5	<0.5	<0.5	--
04/11/94	--	--	--	--	--	<50	<0.5	<0.5	<0.5	<0.5	--
07/01/94	--	--	--	--	--	<50	<0.5	<0.5	<0.5	<0.5	--
10/06/94	--	--	--	--	--	<50	<0.5	<0.5	<0.5	<0.5	--
01/11/95	--	--	--	--	--	<50	<0.5	<0.5	<0.5	<0.5	--
04/07/95	--	--	--	--	--	<50	<0.5	<0.5	<0.5	<0.5	--
07/20/95	--	--	--	--	--	<50	<0.5	<0.5	<0.5	<0.5	--
09/22/95	--	--	--	--	--	<50	<0.5	<0.5	<0.5	<0.5	--
01/02/96	--	--	--	--	--	<50	<0.5	<0.5	<0.5	<0.5	--
04/26/96	--	--	--	--	--	<50	<0.5	<0.5	<0.5	<0.5	--
07/22/96	--	--	--	--	--	<50	<0.5	<0.5	<0.5	<0.5	--
10/17/96	--	--	--	--	--	<50	<0.5	<0.5	<0.5	<0.5	--
01/23/97	--	--	--	--	--	<50	<0.5	<0.5	<0.5	<0.5	--
07/10/97	--	--	--	--	--	<50	<0.5	<0.5	<0.5	<0.5	--
01/15/98	--	--	--	--	--	<50	<0.5	<0.5	<0.5	<0.5	--
07/09/98	--	--	--	--	--	<50	<0.5	<0.5	<0.5	<0.5	--
01/08/99	--	--	--	--	--	<50	<0.5	<0.5	<0.5	<0.5	--
02/01/00	--	--	--	--	--	<50	<0.5	<0.5	<0.5	<0.5	<5.0
08/21/00	--	--	--	--	--	<50	<0.50	<0.50	<0.50	<0.50	<2.5
01/25/01	--	--	--	--	--	<50.0	<0.500	<0.500	<0.500	<0.500	<2.50
07/10/01	--	--	--	--	--	<50	<0.50	<0.50	<0.50	<0.50	<2.5

Table 1
Groundwater Monitoring Data and Analytical Results
Former Chevron Service Station #9-2960
2416 Grove Way
Castro Valley, California

WELL ID/ DATE	TOC* (ft.)	GWE (msl)	DTW (ft.)	SPHT (ft.)	SPH REMOVED (gallons)	TPH-G (ppb)	B (ppb)	T (ppb)	E (ppb)	X (ppb)	MTBE (ppb)
QA											
01/08/02	--	--	--	--	--	<50	<0.50	<0.50	<0.50	<1.5	<2.5
03/26/02	--	--	--	--	--	<50	<0.50	<0.50	<0.50	<1.5	<2.5
06/17/02	--	--	--	--	--	<50	<0.50	<0.50	<0.50	<1.5	<2.5

Table 1
Groundwater Monitoring Data and Analytical Results
Former Chevron Service Station #9-2960
2416 Grove Way
Castro Valley, California

EXPLANATIONS:

Groundwater monitoring data and laboratory analytical results prior to August 21, 2000, were compiled from reports prepared by Blaine Tech Services, Inc.

TOC = Top of Casing

(ft.) = Feet

GWE = Groundwater Elevation

(msl) = Mean sea level

DTW = Depth to Water

SPHT = Separate Phase Hydrocarbons Thickness

TPH-G = Total Petroleum Hydrocarbons as Gasoline

B = Benzene

T = Toluene

E = Ethylbenzene

X = Xylenes

MTBE = Methyl tertiary butyl ether

(ppb) = Parts per billion

-- = Not Measured/Not Analyzed

QA = Quality Assurance

* TOC elevations were surveyed in April 2002, by Morrow Surveying. Elevations are based on Alameda County Benchmark No. 259, brass disc top of concrete guard rail & retaining wall abutment along east side "A" Street and on CL + N. 5th Street extended, (Elevation = 138.79 feet).

¹ MTBE by EPA Method 8260.

² Well development performed.

Table 2
Groundwater Analytical Results - Oxygenate Compounds
Former Chevron Service Station #9-2960
2416 Grove Way
Castro Valley, California

WELL ID	DATE	TBA (ppb)	MTBE (ppb)	DIPE (ppb)	ETBE (ppb)	TAME (ppb)
C-7	07/10/01	<20	<2.0	<2.0	<2.0	<2.0
C-8	03/26/02	<100	<2	<2	<2	<2
	06/17/02	<100	<2	<2	<2	<2

EXPLANATIONS:

TBA = Tertiary butyl alcohol
MTBE = Methyl tertiary butyl ether
DIPE = Di-isopropyl ether
ETBE = Ethyl tertiary butyl ether
TAME = Tertiary amyl methyl ether
(ppb) = Parts per billion

ANALYTICAL METHOD:

EPA Method 8260 for Oxygenate Compounds

STANDARD OPERATING PROCEDURE - GROUNDWATER SAMPLING

Gettler-Ryan Inc. field personnel adhere to the following procedures for the collection and handling of groundwater samples prior to analysis by the analytical laboratory. Prior to sample collection, the type of analysis to be performed is determined. Loss prevention of volatile compounds is controlled and sample preservation for subsequent analysis is maintained.

Prior to sampling, the presence or absence of free-phase hydrocarbons is determined using an interface probe. Product thickness, if present, is measured to the nearest 0.01 foot and is noted in the field notes. In addition, static water level measurements are collected with the interface probe and are also recorded in the field notes.

After water levels are collected and prior to sampling, each well is purged a minimum of three well casing volumes of water using pre-cleaned pumps (stack, suction, Grundfos), or polyvinyl chloride bailers. Temperature, pH and electrical conductivity are measured a minimum of three times during the purging. Purging continues until these parameters stabilize.

Groundwater samples are collected using Chevron-designated disposable bailers. The water samples are transferred from the bailer into appropriate containers. Pre-preserved containers, supplied by analytical laboratories, are used when possible. When pre-preserved containers are not available, the laboratory is instructed to preserve the sample as appropriate. Duplicate samples are collected for the laboratory to use in maintaining quality assurance/quality control standards. The samples are labeled to include the job number, sample identification, collection date and time, analysis, preservation (if any), and the sample collector's initials. The water samples are placed in a cooler, maintained at 4°C for transport to the laboratory. Once collected in the field, all samples are maintained under chain of custody until delivered to the laboratory.

The chain of custody document includes the job number, type of preservation, if any, analysis requested, sample identification, date and time collected, and the sample collector's name. The chain of custody is signed and dated (including time of transfer) by each person who receives or surrenders the samples, beginning with the field personnel and ending with the laboratory personnel.

A laboratory supplied trip blank accompanies each sampling set. For sampling sets greater than 20 samples, 5% trip blanks are included. The trip blank is analyzed for some or all of the same compounds as the groundwater samples.

As requested by Chevron Products Company, the purge water and decontamination water generated during sampling activities is transported by IWM to McKittrick Waste Management located in McKittrick, California.



GETTLER-RYAN INC.

WELL MONITORING/SAMPLING FIELD DATA SHEET

Client/Facility #: Chevron/Texaco #9-2960 Job Number: 386365
 Site Address: 2416 Grove Way Event Date: 6.17.02
 City: Castro Valley, CA Sampler: FT

Well ID: C-8 Well Condition: GOOD
 Well Diameter: 2 in. Hydrocarbon Thickness: 0 ft. Amount Bailed (product/water): 0 gal.
 Total Depth: 24.65 ft. Depth to Water: 16.38 ft.
 Volume Factor (VF) table:

Volume	3/4"= 0.02	1"= 0.04	2"= 0.17	3"= 0.38
Factor (VF)	4"= 0.66	5"= 1.02	6"= 1.50	12"= 5.80

 Calculation: 8.27 x VF .17 = 1.40 x3 (case volume) = Estimated Purge Volume: 4.21 gal.

Purge Equipment: Disposable Bailer Stainless Steel Bailer _____ Stack Pump _____ Suction Pump _____ Grundfos _____ Other: _____
 Sampling Equipment: Disposable Bailer Pressure Bailer _____ Discrete Bailer _____ Other: _____

Start Time (purge): 12:33 Weather Conditions: SUNNY
 Sample Time/Date: 12:50 / 6-17-02 Water Color: CLOUDY / turbid Odor: YES / STEAM
 Purging Flow Rate: N/A gpm. Sediment Description: SILTY
 Did well de-water? NO If yes, Time: _____ Volume: _____ gal.

Time (2400 hr.)	Volume (gal.)	pH	Conductivity (u mhos/cm)	Temperature (°F)	D.O. (mg/L)	ORP (mV)
<u>12:36</u>	<u>1.5</u>	<u>7.14</u>	<u>1278</u>	<u>20.0</u>		
<u>12:40</u>	<u>3.0</u>	<u>7.21</u>	<u>1196</u>	<u>19.9</u>		
<u>12:44</u>	<u>4.0</u>	<u>7.18</u>	<u>1168</u>	<u>20.1</u>		
_____	_____	_____	_____	_____	_____	_____

LABORATORY INFORMATION

SAMPLE ID	(#) CONTAINER	REFRIG.	PRESERV. TYPE	LABORATORY	ANALYSES
<u>C-8</u>	<u>6</u> x vva vial	<u>YES</u>	<u>HCL</u>	<u>LANCASTER</u>	<u>TPH-G/BTEX/MTBE</u> <u>50%is</u>
_____	_____	_____	_____	_____	_____
_____	_____	_____	_____	_____	_____

COMMENTS: _____

Add/Replaced Lock: _____ Add/Replaced Plug: _____ Size: _____

Chevron California Region Analysis Request/Chain of Custody



For Lancaster Laboratories use only

Acct. #: 10905 Sample #: 3838856-57 SCR#: _____

061902-008

Facility #: _____
 Site Address: 92960 Job #386365 Global ID#T0600100318
 Chevron PM: 2416 GROVE WAY, CASTRO VALLEY, CA
 Consultant/Office: Karen Streich DELTA/G-R
 Consultant Prj. Mgr: G-R, Inc., 6747 Sierra Court, Dublin, Ca 94568
 Consultant Phone: Deanna L. Harding Fax: (Deanna@grinc.com)
 Sampler: 925-551-7555 FRANK Termini 925-551-7899
 Service Order #: _____ Non SAR: _____

Matrix		Analyses Requested									
		Preservation Codes									
Soil	Water	Oil	Air	Total Number of Containers	BTEX + MTBE	TPH	TPH 8015 MOD	TPH 8015 MOD DRO	8260 full scan	Oxygenates	Lead
					8260	8021	MOD GRO	Silica Gel Cleanup	(8260)	7420	7421
					<input checked="" type="checkbox"/>	<input checked="" type="checkbox"/>				<input checked="" type="checkbox"/>	
										<input checked="" type="checkbox"/>	

Preservative Codes
 H = HCl T = Thiosulfate
 N = HNO₃ B = NaOH
 S = H₂SO₄ O = Other

J value reporting needed
 Must meet lowest detection limits possible for 8260 compounds

8021 MTBE Confirmation
 Confirm highest hit by 8260
 Confirm all hits by 8260
 Run ___ oxy s on highest hit
 Run ___ oxy s on all hits

Sample Identification	Date Collected	Time Collected	Grab	Composite	Soil	Water	Oil	Air	Total Number of Containers	BTEX + MTBE	TPH	TPH 8015 MOD	TPH 8015 MOD DRO	8260 full scan	Oxygenates	Lead
QA	6-17-02								2	X	X					
C-8		1250	X						6	X	X				X	

Comments / Remarks

Turnaround Time Requested (TAT) (please circle)

STD. TAT 24 hour 72 hour 48 hour
 4 day 5 day

Data Package Options (please circle if required)

QC Summary Type I — Full
 Type VI (Raw Data) Coelt Deliverable not needed
 WIP (RWQCB)
 Disk

Relinquished by: <u>Frank Termini</u>	Date: <u>6-17-02</u>	Time: _____	Received by: <u>Deanna</u>	Date: <u>6/19/02</u>	Time: <u>1345</u>
Relinquished by: <u>Deanna</u>	Date: <u>6/19/02</u>	Time: <u>1345</u>	Received by: <u>Andrew Amaze</u>	Date: <u>6/19/02</u>	Time: <u>1345</u>
Relinquished by: <u>Andrew Amaze</u>	Date: <u>6-19-02</u>	Time: <u>1500</u>	Received by: <u>Airborne</u>	Date: <u>6/17/02</u>	Time: _____
Relinquished by Commercial Carrier: <u>Airborne</u>	UPS FedEx Other <input checked="" type="checkbox"/>	Temperature Upon Receipt: <u>2.5-9 c°</u>	Received by: <u>Deanna</u>	Date: <u>6/20/02</u>	Time: <u>0910</u>
			Custody Seals Intact? <input checked="" type="checkbox"/> Yes <input type="checkbox"/> No		



Lancaster Laboratories

Where quality is a science.

ANALYTICAL RESULTS

Prepared for:

ChevronTexaco
6001 Bollinger Canyon Rd L4310
San Ramon CA 94583

925-842-8582

Prepared by:

Lancaster Laboratories
2425 New Holland Pike
Lancaster, PA 17605-2425

RECEIVED

JUN 20 6 00 PM

GETTLER-RYAN

SAMPLE GROUP

The sample group for this submittal is 811964. Samples arrived at the laboratory on Thursday, June 20, 2002. The PO# for this group is 99011184 and the release number is STREICH.

Client Description

QA-T-020617	NA	Water
C-8-W-020617	Grab	Water

Lancaster Labs Number

3838856
3838857

METHODOLOGY

The specific methodologies used in obtaining the enclosed analytical results are indicated on the laboratory chronicles.

1 COPY TO

Delta C/O Gettler-Ryan

Attn: Deanna L. Harding

Questions? Contact your Client Services Representative
Teresa M Lis at (717) 656-2300.

Respectfully Submitted,

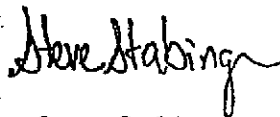
Steve Stabinger
Group Leader



Lancaster Laboratories, Inc.
2425 New Holland Pike
PO Box 12425
Lancaster, PA 17605-2425
717-656-2300 Fax: 717-656-2681



Lancaster Laboratories Sample No. WW 3838856

Collected: 06/17/2002 00:00

Account Number: 10905

Submitted: 06/20/2002 09:10
 Reported: 06/24/2002 at 15:34
 Discard: 07/25/2002

ChevronTexaco
 6001 Bollinger Canyon Rd L4310
 San Ramon CA 94583

QA-T-020617 NA Water GRD
 Facility# 92960 Job# 386365
 2416 GROVE WAY T0600100318 QA

CAT No.	Analysis Name	CAS Number	As Received Result	As Received Method Detection Limit	Units	Dilution Factor
01729	TPH-GRO - Waters					
01730	TPH-GRO - Waters	n.a.	N.D.	50.	ug/l	1
The reported concentration of TPH-GRO does not include MTBE or other gasoline constituents eluting prior to the C6 (n-hexane) TPH-GRO range start time. A site-specific MSD sample was not submitted for the project. A LCS/LCSD was performed to demonstrate precision and accuracy at a batch level.						
08214	BTEX, MTBE (8021)					
00776	Benzene	71-43-2	N.D.	0.50	ug/l	1
00777	Toluene	108-88-3	N.D.	0.50	ug/l	1
00778	Ethylbenzene	100-41-4	N.D.	0.50	ug/l	1
00779	Total Xylenes	1330-20-7	N.D.	1.5	ug/l	1
00780	Methyl tert-Butyl Ether	1634-04-4	N.D.	2.5	ug/l	1
A site-specific MSD sample was not submitted for the project. A LCS/LCSD was performed to demonstrate precision and accuracy at a batch level.						

State of California Lab Certification No. 2116

Laboratory Chronicle

CAT No.	Analysis Name	Method	Analysis		Analyst	Dilution Factor
			Trial#	Date and Time		
01729	TPH-GRO - Waters	N. CA LUFT Gasoline Method	1	06/21/2002 19:51	Melissa D Mann	1
08214	BTEX, MTBE (8021)	SW-846 8021B	1	06/21/2002 19:51	Melissa D Mann	1
01146	GC VOA Water Prep	SW-846 5030B	1	06/21/2002 19:51	Melissa D Mann	n.a.

#=Laboratory Method Detection Limit exceeded target detection limit
 N.D.=Not detected above the Reporting Limit



Lancaster, PA 17605-2425
 717-656-2300 Fax: 717-656-2681



Lancaster Laboratories Sample No. WW 3838857

Collected: 06/17/2002 12:50 by FT

Account Number: 10905

Submitted: 06/20/2002 09:10
 Reported: 06/24/2002 at 15:34
 Discard: 07/25/2002

ChevronTexaco
 6001 Bollinger Canyon Rd L4310
 San Ramon CA 94583

C-8-W-020617 Grab Water
 Facility# 92960 Job# 386365 GRD
 2416 GROVE WAY T0600100318 C-8

C8960

CAT No.	Analysis Name	CAS Number	As Received Result	As Received Method Detection Limit	Units	Dilution Factor
01729	TPH-GRO - Waters					
01730	TPH-GRO - Waters	n.a.	11,000.	250.	ug/l	5
The reported concentration of TPH-GRO does not include MTBE or other gasoline constituents eluting prior to the C6 (n-hexane) TPH-GRO range start time. A site-specific MSD sample was not submitted for the project. A LCS/LCSD was performed to demonstrate precision and accuracy at a batch level. Due to the nature of the sample matrix, the surrogate standard recovery is above the range of specifications.						
08214	BTEX, MTBE (8021)					
00776	Benzene	71-43-2	490.	1.0	ug/l	5
00777	Toluene	108-88-3	65.	1.0	ug/l	5
00778	Ethylbenzene	100-41-4	170.	1.0	ug/l	5
00779	Total Xylenes	1330-20-7	470.	3.0	ug/l	5
00780	Methyl tert-Butyl Ether	1634-04-4	N.D. #	20.	ug/l	5
A site-specific MSD sample was not submitted for the project. A LCS/LCSD was performed to demonstrate precision and accuracy at a batch level. Due to the presence of an interferent near its retention time, the normal reporting limit was not attained for MTBE. The presence or concentration of this compound cannot be determined due to the presence of this interferent.						
Due to the nature of the sample matrix, the surrogate standard recovery is above the range of specifications.						
01595	Oxygenates by 8260B					
02010	Methyl t-butyl ether	1634-04-4	N.D.	2.	ug/l	1
02011	di-Isopropyl ether	108-20-3	N.D.	2.	ug/l	1
02013	Ethyl t-butyl ether	637-92-3	N.D.	2.	ug/l	1
02014	t-Amyl methyl ether	994-05-8	N.D.	2.	ug/l	1
02015	t-Butyl alcohol	75-65-0	N.D.	100.	ug/l	1

#=Laboratory Method Detection Limit exceeded target detection limit
 N.D.=Not detected or above the Reporting Limit

MEMBER

 Lancaster Laboratories, Inc.
 2425 New Holland Pike
 Lancaster, PA 17605-2425
 717-656-2300 Fax: 717-656-2681



Lancaster Laboratories Sample No. **WW 3838857**

Collected: 06/17/2002 12:50 by **FT**

Account Number: 10905

Submitted: 06/20/2002 09:10

Reported: 06/24/2002 at 15:34

Discard: 07/25/2002

ChevronTexaco

6001 Bollinger Canyon Rd L4310

San Ramon CA 94583

C-8-W-020617 Grab Water
 Facility# 92960 Job# 386365
 2416 GROVE WAY T0600100318 C-8

GRD

C8960

CAT No.	Analysis Name	CAS Number	As Received Result	As Received Method Detection Limit	Units	Dilution Factor
---------	---------------	------------	--------------------	------------------------------------	-------	-----------------

State of California Lab Certification No. 2116

Laboratory Chronicle

CAT No.	Analysis Name	Method	Trial#	Analysis		Analyst	Dilution Factor
				Date and Time			
01729	TPH-GRO - Waters	N. CA LUFT Gasoline Method	1	06/22/2002 03:54		Melissa D Mann	5
08214	BTEX, MTBE (8021)	SW-846 8021B	1	06/22/2002 03:54		Melissa D Mann	5
01595	Oxygenates by 8260B	SW-846 8260B	1	06/22/2002 01:16		Trent S Sprenkle	1
01146	GC VOA Water Prep	SW-846 5030B	1	06/22/2002 03:54		Melissa D Mann	n.a.
01163	GC/MS VOA Water Prep	SW-846 5030B	1	06/22/2002 01:16		Trent S Sprenkle	n.a.

#=Laboratory Method Detection Limit exceeded target detection limit
 N.D.=Not detected
2425 New Holland Pike
 PO Box 12415





Lancaster Laboratories

Where quality is a science.

Quality Control Summary

Client Name: ChevronTexaco
Reported: 06/24/02 at 03:34 PM

Group Number: 811964

Laboratory Compliance Quality Control

Analysis Name	Blank Result	Blank MDL	Report Units	LCS %REC	LCSD %REC	LCS/LCSD Limits	RPD	RPD Max
Batch number: 02172A53A								
Sample number(s): 3838856								
Benzene	N.D.	0.5	ug/l	110	92	80-118	17	30
Toluene	N.D.	0.5	ug/l	109	91	82-119	18	30
Ethylbenzene	N.D.	0.5	ug/l	113	95	81-119	18	30
Total Xylenes	N.D.	1.5	ug/l	114	96	82-120	17	30
Methyl tert-Butyl Ether	N.D.	2.5	ug/l	107	99	79-127	8	30
TPH-GRO - Waters	N.D.	50.	ug/l	100	89	76-126	12	30
Batch number: 02172A53B								
Sample number(s): 3838857								
Benzene	N.D.	0.5	ug/l	110	92	80-118	17	30
Toluene	N.D.	0.5	ug/l	109	91	82-119	18	30
Ethylbenzene	N.D.	0.5	ug/l	113	95	81-119	18	30
Total Xylenes	N.D.	1.5	ug/l	114	96	82-120	17	30
Methyl tert-Butyl Ether	N.D.	2.5	ug/l	107	99	79-127	8	30
TPH-GRO - Waters	N.D.	50.	ug/l	100	89	76-126	12	30
Batch number: P021722AA								
Sample number(s): 3838857								
Methyl t-butyl ether	N.D.	2.	ug/l	116		77-127		
di-Isopropyl ether	N.D.	2.	ug/l	113		74-125		
Ethyl t-butyl ether	N.D.	2.	ug/l	105		74-120		
t-Amyl methyl ether	N.D.	2.	ug/l	94		71-114		
t-Butyl alcohol	N.D.	100.	ug/l	121		59-139		

Sample Matrix Quality Control

Analysis Name	MS %REC	MSD %REC	MS/MSD Limits	RPD	BKG MAX	DUP CONC	DUP RPD	Dup RPD Max
Batch number: 02172A53A								
Sample number(s): 3838856								
Benzene	105		77-131					
Toluene	103		80-128					
Ethylbenzene	109		76-132					
Total Xylenes	110		76-132					
Methyl tert-Butyl Ether	102		61-144					
TPH-GRO - Waters	93		74-132					
Batch number: 02172A53B								
Sample number(s): 3838857								
Benzene	105		77-131					
Toluene	103		80-128					
Ethylbenzene	109		76-132					
Total Xylenes	110		76-132					
Methyl tert-Butyl Ether	102		61-144					
TPH-GRO - Waters	93		74-132					
Batch number: P021722AA								
Sample number(s): 3838857								
Methyl t-butyl ether	110	111	69-134	0	30			
di-Isopropyl ether	115	117	68-133	2	30			
Ethyl t-butyl ether	109	112	73-123	2	30			
t-Amyl methyl ether	96	98	69-118	2	30			
t-Butyl alcohol	119	125	51-148	5	30			

Surrogate Quality Control

*. Outside of specification

- (1) The result for one or both determinations was less than five times the LOQ.
- (2) The background result was more than four times the spike added.



Lancaster Laboratories, Inc.
2425 New Holland Pike
PO Box 12425
Lancaster, PA 17605-2425
717-656-2300 Fax: 717-656-2681



Client Name: ChevronTexaco
Reported: 06/24/02 at 03:34 PM

Group Number: 811964

Surrogate Quality Control

Analysis Name: TPH-GRO - Waters
Batch number: 02172A53A

	Trifluorotoluene-F	Trifluorotoluene-P
3838856	91	91
Blank	97	94
LCS	97	95
LCSD	97	94
MS	94	96
Limits:	67-135	71-130

Analysis Name: TPH-GRO - Waters
Batch number: 02172A53B

	Trifluorotoluene-F	Trifluorotoluene-P
3838857	136*	137*
Blank	92	96
LCS	97	95
LCSD	97	94
MS	94	96
Limits:	67-135	71-130

Analysis Name: Oxygenates by 8260B
Batch number: P021722AA

	Dibromofluoromethane	1,2-Dichloroethane-d4	Toluene-d8	4-Bromofluorobenzene
3838857	95	92	101	102
Blank	102	97	98	93
LCS	99	96	101	103
MS	97	94	102	103
MSD	97	96	101	103
Limits:	86-118	80-120	88-110	86-115

*- Outside of specification

- (1) The result for one or both determinations was less than five times the LOQ.
- (2) The background result was more than four times the spike added.



Lancaster Laboratories, Inc.
2425 New Holland Pike
PO Box 12425
Lancaster, PA 17605-2425
717-656-2300 Fax: 717-656-2681