



# GETTLER-RYAN INC.

## TRANSMITTAL

570 b56 ✓

February 26, 2002

G-R #386365

MAR 14 2002

TO: Mr. James Brownell  
Delta Environmental Consultants, Inc.  
3164 Gold Camp Drive, Suite 200  
Rancho Cordova, California 95670

CC: Mr. Thomas Bauhs  
Chevron Products Company  
P.O. Box 6004  
San Ramon, California 94583

FROM: Deanna L. Harding  
Project Coordinator  
Gettler-Ryan Inc.  
6747 Sierra Court, Suite J  
Dublin, California 94568

RE: **Former Chevron Service Station  
#9-2960  
2416 Grove Way  
Castro Valley, California**

WE HAVE ENCLOSED THE FOLLOWING:

COPIES	DATED	DESCRIPTION
1	February 9, 2002	Groundwater Monitoring and Sampling Report First Semi-Annual - Event of January 8, 2002

### COMMENTS:

Please provide any comments/changes and propose any groundwater monitoring modifications for the next event prior to **March 11, 2002**, at which time the final report will be distributed to the following:

cc: Mr. Amir Gholami, Alameda County Health Care Services, Dept. of Environmental Health, 1131 Harbor Bay Parkway, Suite 250, Alameda, CA 94502-6577  
Mr. Phil Conley, President Board of Trustees, First Presbyterian Church, 2490 Grove Way, Castro Valley, CA 94546  
Mr. Greg Gurss, Gettler-Ryan Inc., 3140 Gold Camp Drive, Suite 170, Rancho Cordova, CA 95670

Enclosures



# GETTLER-RYAN INC.

February 9, 2002  
G-R Job #386365

Mr. Thomas Bauhs  
Chevron Products Company  
P.O. Box 6004  
San Ramon, CA 94583

MAR 14 2002

**RE: First Semi-Annual Event of January 8, 2002**  
Groundwater Monitoring & Sampling Report  
Former Chevron Service Station #9-2960  
2416 Grove Way  
Castro Valley, California

Dear Mr. Bauhs:

This report documents the most recent groundwater monitoring and sampling event performed by Gettler-Ryan Inc. (G-R) at the referenced site. All field work was conducted in accordance with G-R Standard Operating Procedure - Groundwater Sampling (attached).

Static groundwater level was measured and the well was checked for the presence of separate-phase hydrocarbons. Static water level data, groundwater elevations, and separate-phase hydrocarbon thickness (if any) are presented in the attached Table 1. A Groundwater Elevation Map is included as Figure 1.

Groundwater samples were collected from the monitoring well and submitted to a state certified laboratory for analyses. The field data sheets for this event are attached. Analytical results are presented in the table(s) listed below. The chain of custody document and laboratory analytical report are also attached.

Please call if you have any questions or comments regarding this report. Thank you.

Sincerely,

Deanna L. Harding  
Project Coordinator

Hagop Kevork  
P.E. No. C55734



Figure 1: Groundwater Elevation Map  
Table 1: Groundwater Monitoring Data and Analytical Results  
Table 2: Groundwater Analytical Results - Oxygenate Compounds  
Attachments: Standard Operating Procedure - Groundwater Sampling  
Field Data Sheets  
Chain of Custody Document and Laboratory Analytical Reports

**EXPLANATION**

- ◆ Groundwater monitoring well
- ✕ Abandoned well
- 99.99 Groundwater elevation in feet referenced to Mean Sea Level
- P/O Paved Over

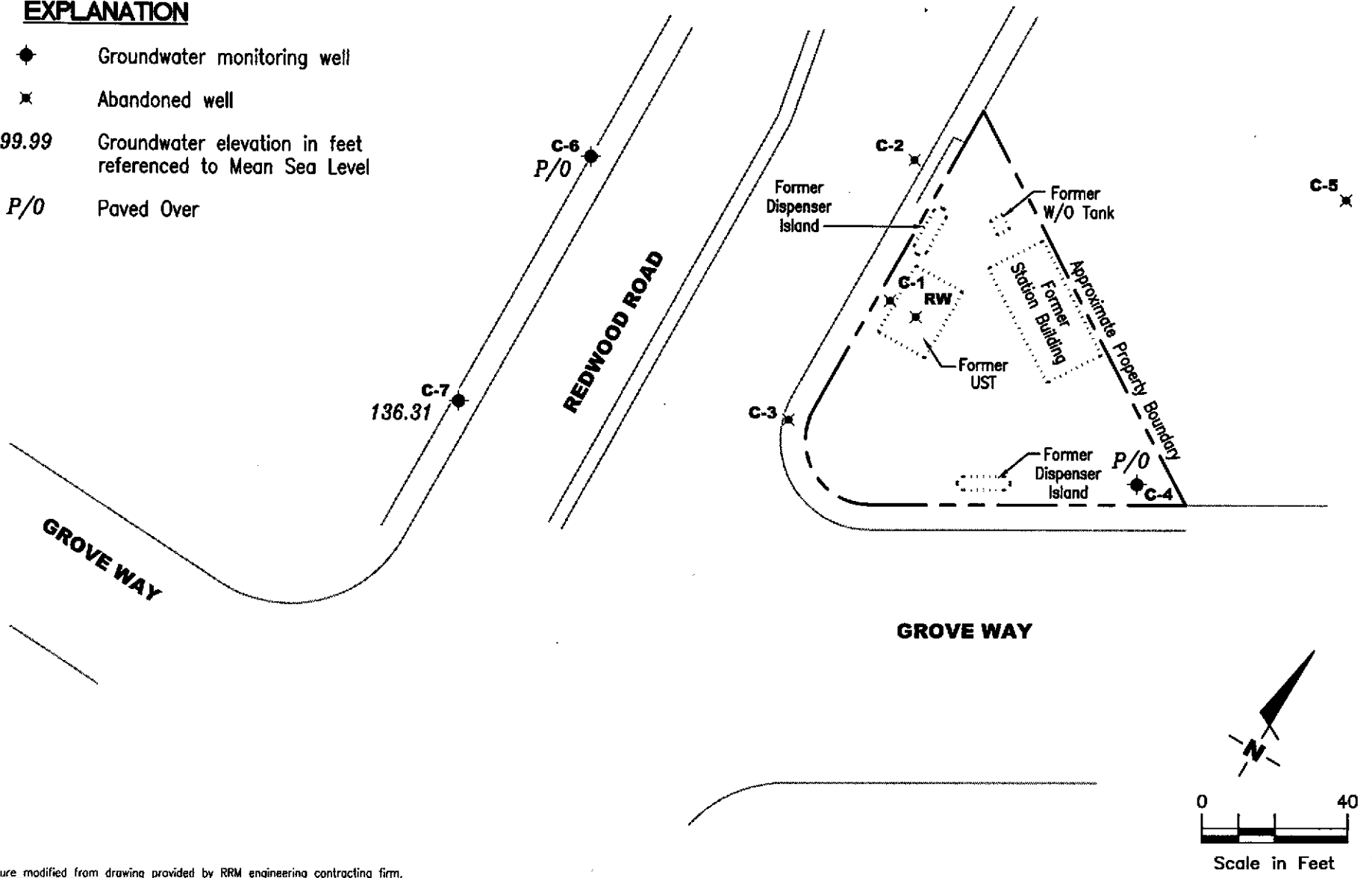

Source: Figure modified from drawing provided by RRM engineering contracting firm.

**GF GETTLER - RYAN INC.**  
 6747 Sierra Ct., Suite J  
 Dublin, CA 94568 (925) 551-7555

**GROUNDWATER ELEVATION MAP**  
 Former Chevron Service Station #9-2960  
 2416 Grove Way  
 Castro Valley, California

FIGURE

1

PROJECT NUMBER  
 386365

REVIEWED BY

DATE  
 January 8, 2002

REVISED DATE

**Table 1**  
**Groundwater Monitoring Data and Analytical Results**  
Former Chevron Service Station #9-2960  
2416 Grove Way  
Castro Valley, California

WELL ID/ DATE	TOC (ft.)	GWE (msl)	DTW (ft.)	SPHT (ft.)	SPH REMOVED (gallons)	TPH-G (ppb)	B (ppb)	T (ppb)	E (ppb)	X (ppb)	MTBE (ppb)
C-1											
10/23/86	153.36	--	--	--	--	3,100	6,400	3,700	--	4,300	--
09/10/87	153.36	--	--	--	--	120,000	25,000	60,000	13,000	56,000	--
10/03/90	153.36	134.69	18.67	--	--	--	--	--	--	--	--
10/25/90	153.36	135.22	18.71	0.71	--	--	--	--	--	--	--
01/22/91	153.36	135.22	18.70	0.70	--	--	--	--	--	--	--
02/21/91	153.36	135.44	18.62	0.88	--	--	--	--	--	--	--
04/01/91	153.36	136.47	16.91	0.03	--	--	--	--	--	--	--
04/11/91	153.36	136.49	16.90	0.04	--	--	--	--	--	--	--
07/01/91	153.36	135.75	17.61	0.00	--	--	--	--	--	--	--
09/24/91	153.36	135.17	18.98	0.99	--	--	--	--	--	--	--
10/23/91	153.36	135.03	19.32	1.24	--	--	--	--	--	--	--
11/22/91	153.36	134.53	18.83	0.97	--	--	--	--	--	--	--
01/09/92	153.36	136.10	17.26	--	--	--	--	--	--	--	--
03/06/92	153.36	137.16	16.69	0.61	--	--	--	--	--	--	--
06/04/92	153.36	136.44	17.10	0.22	--	--	--	--	--	--	--
09/28/92	153.36	--	18.71	0.77	--	--	--	--	--	--	--
12/17/92	153.36	--	17.54	0.45	--	--	--	--	--	--	--
04/29/93	153.36	137.50	16.40	0.68	--	--	--	--	--	--	--
07/26/93	153.36	136.92	16.85	0.51	--	--	--	--	--	--	--
10/22/93	153.36	135.55	17.83	0.03	--	--	--	--	--	--	--
01/24/94	153.36	--	--	--	--	--	--	--	--	--	--
04/11/94	153.36	136.01	17.76	0.51	--	--	--	--	--	--	--
07/01/94	153.36	135.95	17.46	0.06	--	--	--	--	--	--	--
10/06/94	153.36	135.24	18.18	0.08	--	--	--	--	--	--	--
01/11/95	153.36	136.63	16.79	0.08	0.039	--	--	--	--	--	--
04/07/95	153.36	139.23	14.13	--	--	44,000	410	100	130	5,400	--
07/20/95	153.36	136.84	16.52	--	--	16,000	96	81	53	1,000	--
09/22/95	153.36	137.22	16.14	--	--	59,000	150	36	16	56	--
01/02/96	153.36	137.43	15.93	--	--	29,000	4,500	1,100	520	1,900	<250
04/26/96	153.36	137.31	16.05	--	--	7,200	1,300	340	130	390	--

**Table 1**  
**Groundwater Monitoring Data and Analytical Results**  
Former Chevron Service Station #9-2960  
2416 Grove Way  
Castro Valley, California

WELL ID/ DATE	TOC (ft.)	GWE (msl)	DTW (ft.)	SPHT (ft.)	SPH		B (ppb)	T (ppb)	E (ppb)	X (ppb)	MTBE (ppb)
					REMOVED (gallons)	TPH-G (ppb)					
<b>C-1 (cont)</b>											
07/22/96	153.36	143.14	10.22	--	--	7,300	2,500	170	360	520	--
10/17/96	153.36	137.64	15.72	--	--	19,000	3,400	59	360	430	--
01/23/97	153.36	138.91	14.45	--	--	15,000	2,900	390	250	480	--
07/10/97	153.36	137.19	16.17	--	--	13,000	2,100	69	200	380	--
01/15/98	153.36	INACCESSIBLE		--	--	--	--	--	--	--	--
01/16/98	153.36	138.63	14.73	--	--	4,700	1,200	<20	140	40	--
07/09/98	153.36	138.14	15.22	--	--	9,900	1,500	60	150	170	--
ABANDONED											
<b>C-2</b>											
10/23/86	151.84	--	--	--	--	30,000	2,700	1,900	--	1,500	--
09/10/87	151.84	--	--	--	--	14,000	2,600	2,900	500	1,200	--
10/16/89	151.84	--	--	--	--	600	260	34	1.7	41	--
01/04/90	151.84	--	--	--	--	2,600	470	150	23	130	--
04/05/90	151.84	--	--	--	--	500	280	29	6.3	19	--
07/02/90	151.84	--	--	--	--	2,400	670	110	17	76	--
10/03/90	151.84	--	--	--	--	--	--	--	--	--	--
10/25/90	151.84	135.24	16.60	--	--	1,300	390	47	9.0	58	--
01/22/91	151.84	135.15	16.69	--	--	2,600	680	88	29	130	--
02/21/91	151.84	135.53	16.31	--	--	--	--	--	--	--	--
04/01/91	151.84	136.76	15.08	--	--	--	--	--	--	--	--
04/11/91	151.84	136.61	15.23	--	--	--	--	--	--	--	--
07/01/91	151.84	135.88	15.96	--	--	--	--	--	--	--	--
09/24/91	151.84	135.33	16.51	--	--	3,600	1,400	63	6.9	63	--
10/23/91	151.84	135.18	16.66	--	--	--	--	--	--	--	--
11/22/91	151.84	135.47	16.37	--	--	--	--	--	--	--	--
01/09/92	151.84	136.28	15.56	--	--	7,100	770	740	190	690	--
03/06/92	151.84	137.47	14.37	--	--	3,200	250	230	59	220	--
06/04/92	151.84	136.80	15.04	--	--	1,500	<0.5	180	42	130	--

**Table 1**  
**Groundwater Monitoring Data and Analytical Results**  
Former Chevron Service Station #9-2960  
2416 Grove Way  
Castro Valley, California

WELL ID/ DATE	TOC (ft.)	GWE (msl)	DTW (ft.)	SPHT (ft.)	SPH REMOVED (gallons)	TPH-G (ppb)	B (ppb)	T (ppb)	E (ppb)	X (ppb)	MTBE (ppb)
<b>C-2 (cont)</b>											
09/28/92	151.84	135.44	16.40	--	--	6,400	940	230	57	220	--
12/17/92	151.84	136.46	15.38	--	--	1,500	370	160	6.0	25	--
04/29/93	151.84	136.87	14.97	--	--	1,800	690	120	74	140	--
07/29/93	151.84	136.92	14.92	--	--	4,300	1,500	96	29	96	--
10/22/93	151.84	136.03	15.81	--	--	820	560	57	15	58	--
01/24/94	151.84	--	--	--	--	--	--	--	--	--	--
04/11/94	151.84	136.49	15.35	--	--	2,000	240	48	36	110	--
07/01/94	151.84	136.44	15.40	--	--	370	55	12	3.1	8.6	--
10/06/94	151.84	135.84	16.00	--	--	150	47	4.8	1.8	5.4	--
01/11/95	151.84	137.06	14.78	--	--	52	0.65	<0.5	<0.5	<0.5	--
04/07/95	151.84	138.93	12.91	--	--	1,500	260	64	52	85	--
07/20/95	151.84	136.81	15.03	--	--	3,000	500	100	96	110	--
09/22/95	151.84	137.05	14.79	--	--	2,000	630	120	20	79	--
01/02/96	151.84	137.37	14.47	--	--	1,900	240	110	58	180	<12
04/26/96	151.84	137.97	13.87	--	--	1,300	340	190	44	120	--
07/22/96	151.84	136.73	15.11	--	--	3,700	1,100	140	150	330	--
10/17/96	151.84	136.80	15.04	--	--	22,000	3,900	1,600	350	1,800	--
01/23/97	151.84	138.86	12.98	--	--	2,000	260	48	76	94	--
07/10/97	151.84	137.21	14.63	--	--	5,100	710	200	190	380	--
01/15/98	153.36	INACCESSIBLE		--	--	--	--	--	--	--	--
01/16/98	151.84	138.61	13.23	--	--	7,600	1,600	130	320	650	--
07/09/98	151.84	138.17	13.67	--	--	10,000	1,100	410	180	410	--
<b>ABANDONED</b>											
<b>C-3</b>											
10/23/86	154.13	--	--	--	--	3,300	49	24	--	20	--
09/10/87	154.13	--	--	--	--	200	110	2.6	<2.0	<2.0	--
10/16/89	154.13	--	--	--	--	900	640	4.2	1.6	16	--
01/04/90	154.13	--	--	--	--	920	430	7.0	6.0	7.0	--

**Table 1**  
**Groundwater Monitoring Data and Analytical Results**  
Former Chevron Service Station #9-2960  
2416 Grove Way  
Castro Valley, California

WELL ID/ DATE	TOC (ft.)	GWE (msl)	DTW (ft.)	SPHT (ft.)	SPH REMOVED (gallons)	TPH-G (ppb)	B (ppb)	T (ppb)	E (ppb)	X (ppb)	MTBE (ppb)
C-3 (cont)											
04/05/90	154.13	--	--	--	--	930	690	3.4	5.1	4.8	--
07/02/90	154.13	--	--	--	--	1,700	590	11	4.8	9.4	--
10/03/90	154.13	134.97	19.16	--	--	--	--	--	--	--	--
10/25/90	154.13	134.85	19.28	--	--	750	510	2.0	6.0	5.0	--
01/22/91	154.13	134.95	19.18	--	--	430	260	2.0	2.0	5.0	--
01/22/91	154.13	134.95	19.18	--	--	400	250	2.0	2.0	5.0	--
02/21/91	154.13	135.25	18.88	--	--	--	--	--	--	--	--
04/01/91	154.13	136.54	17.59	--	--	--	--	--	--	--	--
04/11/91	154.13	136.32	17.81	--	--	--	--	--	--	--	--
07/01/91	154.13	135.57	18.56	--	--	--	--	--	--	--	--
09/24/91	154.13	135.01	19.12	--	--	260	52	0.7	0.8	2.2	--
10/23/91	154.13	134.89	19.24	--	--	--	--	--	--	--	--
11/22/91	154.13	135.10	19.03	--	--	--	--	--	--	--	--
01/09/92	154.13	135.90	18.23	--	--	240	120	0.9	<0.5	1.6	--
03/06/92	154.13	137.09	17.04	--	--	230	68	1.2	1.2	1.3	--
06/04/92	154.13	136.34	17.79	--	--	80	36	0.6	0.5	0.7	--
09/28/92	154.13	135.13	19.00	--	--	84	49	<0.5	<0.5	1.5	--
12/17/92	154.13	135.95	18.18	--	--	220	30	<0.5	<0.5	<0.5	--
04/29/93	154.13	135.35	18.78	--	--	380	12	0.6	<0.5	<1.5	--
07/26/93	154.13	136.41	17.72	--	--	800	38	1.1	<0.5	<1.5	--
10/22/93	154.13	135.63	18.50	--	--	200	64	0.6	<0.5	<1.5	--
01/24/94	154.13	135.62	18.51	--	--	<50	<0.5	<0.5	<0.5	<0.5	--
04/11/94	154.13	136.09	18.04	--	--	100	3.6	2.1	<0.5	2.3	--
07/01/94	154.13	136.01	18.12	--	--	140	3.7	1.2	<0.5	1.0	--
10/06/94	154.13	135.50	18.63	--	--	<50	<0.5	<0.5	<0.5	<0.5	--
01/11/95	154.13	137.01	17.12	--	--	<50	<0.5	<0.5	<0.5	<0.5	--
04/07/95	154.13	138.34	15.79	--	--	<50	<0.5	<0.5	<0.5	<0.5	--
07/20/95	154.13	136.37	17.76	--	--	<50	1.5	1.9	<0.5	3.5	--
09/22/95	154.13	136.58	17.55	--	--	<50	<0.5	<0.5	<0.5	<0.5	--
01/02/96	154.13	136.88	17.25	--	--	<50	<0.5	<0.5	<0.5	1.1	<2.5

**Table 1**  
**Groundwater Monitoring Data and Analytical Results**  
Former Chevron Service Station #9-2960  
2416 Grove Way  
Castro Valley, California

WELL ID/ DATE	TOC (ft.)	GWE (msl)	DTW (ft.)	SPHT (ft.)	SPH		B (ppb)	T (ppb)	E (ppb)	X (ppb)	MTBE (ppb)
					REMOVED (gallons)	TPH-G (ppb)					
<b>C-3 (cont)</b>											
04/26/96	154.13	137.42	16.71	--	--	<50	<0.5	<0.5	<0.5	<0.5	--
07/22/96	154.13	136.50	17.63	--	--	<50	<0.5	<0.5	<0.5	<0.5	--
10/17/96	154.13	136.33	17.80	--	--	<50	<0.5	<0.5	<0.5	<0.5	--
01/23/97	154.13	138.33	15.80	--	--	<50	<0.5	<0.5	<0.5	<0.5	--
07/10/97	154.13	136.63	17.50	--	--	<50	<0.5	<0.5	<0.5	<0.5	--
01/15/98	154.13	137.98	16.15	--	--	<50	<0.5	<0.5	<0.5	<0.5	--
01/16/98	154.13	138.04	16.09	--	--	REGAUGE	--	--	--	--	--
07/09/98	154.13	137.57	16.56	--	--	<50	<0.5	<0.5	<0.5	<0.5	--
<b>ABANDONED</b>											
<b>C-4</b>											
10/23/86	156.00	--	--	--	--	570	3.0	4.0	--	5.0	--
09/10/87	156.00	--	--	--	--	500	3.0	<0.5	<0.5	<0.5	--
10/16/89	156.00	--	--	--	--	<500	12	1.0	<0.5	0.8	--
01/04/90	156.00	--	--	--	--	<500	5.0	<0.5	<0.5	0.9	--
04/05/90	156.00	--	--	--	--	<50	6.6	<0.5	<0.5	0.7	--
07/02/90	156.00	--	--	--	--	71	4.1	<0.5	<0.5	<0.5	--
10/03/90	156.00	--	--	--	--	--	--	--	--	--	--
10/25/90	156.00	135.57	20.43	--	--	<50	2.0	<0.5	<0.5	<0.5	--
01/22/91	156.00	135.50	20.50	--	--	<50	3.0	<0.5	<0.5	<0.5	--
02/21/91	156.00	135.77	20.23	--	--	--	--	--	--	--	--
04/01/91	156.00	136.97	19.03	--	--	--	--	--	--	--	--
04/11/91	156.00	136.95	19.05	--	--	--	--	--	--	--	--
07/01/91	156.00	136.10	19.90	--	--	--	--	--	--	--	--
09/24/91	156.00	135.59	20.41	--	--	87	1.6	<0.5	<0.5	<0.5	--
10/23/91	156.00	135.47	20.53	--	--	--	--	--	--	--	--
11/22/91	156.00	135.65	20.35	--	--	--	--	--	--	--	--
01/09/92	156.00	136.46	19.54	--	--	51	4.3	<0.5	<0.5	<0.5	--
01/09/92	156.00	136.46	19.54	--	--	<50	4.8	<0.5	<0.5	<0.5	--



**Table 1**  
**Groundwater Monitoring Data and Analytical Results**  
Former Chevron Service Station #9-2960  
2416 Grove Way  
Castro Valley, California

WELL ID/ DATE	TOC (ft.)	GWE (msl)	DTW (ft.)	SPHT (ft.)	SPH REMOVED (gallons)	TPH-G (ppb)	B (ppb)	T (ppb)	E (ppb)	X (ppb)	MTBE (ppb)
C-4 (cont)											
03/06/92	156.00	137.74	18.26	--	--	<50	0.8	<0.5	<0.5	<0.5	--
06/04/92	156.00	137.08	18.92	--	--	<50	<0.5	<0.5	<0.5	0.7	--
09/28/92	156.00	135.69	20.31	--	--	<50	<0.5	<0.5	<0.5	<0.5	--
12/17/92	156.00	136.43	19.57	--	--	<50	<0.5	<0.5	<0.5	<0.5	--
04/29/93	156.00	138.22	17.78	--	--	<50	<0.5	<0.5	<0.5	<1.5	--
07/26/93	156.00	--	--	--	--	--	--	--	--	--	--
08/18/93	156.00	137.09	18.91	--	--	<50	<0.5	<0.5	<0.5	<1.5	--
10/22/93	156.00	136.61	19.39	--	--	<50	2.9	2.1	1.1	4.3	--
01/24/94	156.00	136.58	19.42	--	--	<50	<0.5	<0.5	<0.5	<0.5	--
04/11/94	156.00	136.86	19.14	--	--	<50	<0.5	0.6	<0.5	0.5	--
07/01/94	156.00	136.80	19.20	--	--	<50	<0.5	<0.5	<0.5	<0.5	--
10/06/94	156.00	136.26	19.74	--	--	<50	<0.5	<0.5	<0.5	<0.5	--
01/11/95	156.00	139.70	16.30	--	--	<50	<0.5	<0.5	<0.5	<0.5	--
04/07/95	156.00	139.49	16.51	--	--	<50	<0.5	<0.5	<0.5	<0.5	--
07/20/95	156.00	137.20	18.80	--	--	<50	<0.5	<0.5	<0.5	<0.5	--
09/22/95	156.00	137.26	18.74	--	--	<50	<0.5	<0.5	<0.5	<0.5	--
01/02/96	156.00	137.65	18.35	--	--	<50	1.6	1.8	0.95	4.1	<2.5
04/26/96	156.00	138.43	17.57	--	--	<50	<0.5	<0.5	<0.5	<0.5	--
07/22/96	156.00	137.00	19.00	--	--	<50	<0.5	<0.5	<0.5	<0.5	--
10/17/96	156.00	136.96	19.04	--	--	<50	<0.5	<0.5	<0.5	<0.5	--
01/23/97	156.00	139.31	16.69	--	--	<50	<0.5	<0.5	<0.5	<0.5	--
07/10/97	156.00	137.46	18.54	--	--	SAMPLED ANNUALLY		--	--	--	--
01/15/98	156.00	143.92	12.08	--	--	<50	1.0	1.4	<0.5	3.5	--
01/16/98	156.00	138.84	17.16	--	--	REGAUGE		--	--	--	--
07/09/98	156.00	138.29	17.71	--	--	--	--	--	--	--	--
01/08/99	156.00	139.19	16.81	--	--	<50	<0.5	<0.5	<0.5	<0.5	--
07/09/99	156.00	UNABLE TO LOCATE		--	--	--	--	--	--	--	--
02/01/00	156.00	UNABLE TO LOCATE		--	--	--	--	--	--	--	--
08/21/00	156.00	UNABLE TO LOCATE - PAVED OVER		--	--	--	--	--	--	--	--

**Table 1**  
**Groundwater Monitoring Data and Analytical Results**  
Former Chevron Service Station #9-2960  
2416 Grove Way  
Castro Valley, California

WELL ID/ DATE	TOC (ft.)	GWE (msl)	DTW (ft.)	SPHT (ft.)	SPH REMOVED (gallons)	TPH-G (ppb)	B (ppb)	T (ppb)	E (ppb)	X (ppb)	MTBE (ppb)
<b>C-4 (cont)</b>											
01/25/01	156.00	UNABLE TO LOCATE - PAVED OVER				--	--	--	--	--	--
07/10/01	156.00	UNABLE TO LOCATE - PAVED OVER				--	--	--	--	--	--
01/08/02	156.00	UNABLE TO LOCATE - PAVED OVER				--	--	--	--	--	--
<b>C-5</b>											
10/03/90	153.38	135.60	17.78	--	--	<50	<0.5	<0.5	<0.5	<0.5	--
10/25/90	153.38	135.46	17.92	--	--	<50	<0.5	<0.5	<0.5	<0.5	--
11/09/90	153.38	135.46	17.92	--	--	<50	<0.5	<0.5	<0.5	<0.5	--
01/22/91	153.38	135.58	17.80	--	--	<50	<0.5	<0.5	<0.5	<0.5	--
02/21/91	153.38	135.87	17.51	--	--	--	--	--	--	--	--
04/01/91	153.38	137.07	16.31	--	--	--	--	--	--	--	--
04/11/91	153.38	137.02	16.36	--	--	--	--	--	--	--	--
07/01/91	153.38	136.26	17.12	--	--	--	--	--	--	--	--
09/24/91	153.38	135.68	17.70	--	--	<50	<0.5	<0.5	<0.5	<0.5	--
09/24/91	153.38	135.68	17.70	--	--	<50	<0.5	<0.5	<0.5	<0.5	--
10/23/91	153.38	135.56	17.82	--	--	--	--	--	--	--	--
11/22/91	153.38	135.77	17.61	--	--	--	--	--	--	--	--
01/09/92	153.38	136.34	17.04	--	--	<50	<0.5	0.7	<0.5	<0.5	--
03/06/92	153.38	137.62	15.76	--	--	<50	<0.5	<0.5	<0.5	<0.5	--
06/04/92	153.38	136.98	16.40	--	--	<50	<0.5	<0.5	<0.5	<0.5	--
09/28/92	153.38	135.80	17.58	--	--	<50	<0.5	<0.5	<0.5	<0.5	--
12/17/92	153.38	136.56	16.82	--	--	<50	<0.5	<0.5	<0.5	<0.5	--
04/29/93	153.38	138.14	15.24	--	--	<50	<0.5	<0.5	<0.5	<1.5	--
07/26/93	153.38	137.08	16.30	--	--	<50	<0.5	<0.5	<0.5	<1.5	--
10/22/93	153.38	136.30	17.08	--	--	52	2.3	2.7	1.1	5.2	--
01/24/94	153.38	136.25	17.13	--	--	<50	<0.5	<0.5	<0.5	<0.5	--
04/11/94	153.38	136.75	16.63	--	--	<50	<0.5	0.7	<0.5	0.6	--
07/01/94	153.38	136.73	16.65	--	--	<50	<0.5	<0.5	<0.5	<0.5	--
10/06/94	153.38	136.16	17.22	--	--	<50	<0.5	<0.5	<0.5	<0.5	--

**Table 1**  
**Groundwater Monitoring Data and Analytical Results**  
Former Chevron Service Station #9-2960  
2416 Grove Way  
Castro Valley, California

WELL ID/ DATE	TOC (ft.)	GWE (msl)	DTW (ft.)	SPHT (ft.)	SPH			B (ppb)	I (ppb)	E (ppb)	X (ppb)	MTBE (ppb)
					REMOVED (gallons)	TPH-G (ppb)						
C-5 (cont)												
01/11/95	153.38	137.41	15.97	--	--	<50	<0.5	<0.5	<0.5	<0.5	<0.5	--
04/07/95	153.38	139.37	14.01	--	--	<50	<0.5	<0.5	<0.5	<0.5	<0.5	--
07/20/95	153.38	137.17	16.21	--	--	<50	<0.5	<0.5	<0.5	<0.5	0.61	--
09/22/95	153.38	137.07	16.31	--	--	62	<0.5	<0.5	<0.5	<0.5	<0.5	--
01/02/96	153.38	137.56	15.82	--	--	<50	<0.5	<0.5	<0.5	<0.5	<0.5	<2.5
04/26/96	153.38	138.41	14.97	--	--	<50	<0.5	<0.5	<0.5	<0.5	<0.5	--
07/22/96	153.38	137.06	16.32	--	--	<50	<0.5	<0.5	<0.5	<0.5	<0.5	--
10/17/96	153.38	136.88	16.50	--	--	<50	<0.5	<0.5	<0.5	<0.5	<0.5	--
01/23/97	153.38	139.18	14.20	--	--	<50	<0.5	<0.5	<0.5	<0.5	<0.5	--
ABANDONED												
C-6												
10/03/90	152.84	134.70	18.14	--	--	<50	<0.5	<0.5	<0.5	<0.5	<0.5	--
10/25/90	152.84	134.55	18.29	--	--	<50	<0.5	1.0	<0.5	<0.5	<0.5	--
11/09/90	152.84	134.58	18.26	--	--	<50	<0.5	<0.5	<0.5	<0.5	<0.5	--
01/22/91	152.84	134.69	18.15	--	--	<50	<0.5	<0.5	<0.5	<0.5	<0.5	--
02/21/91	152.84	134.92	17.92	--	--	--	--	--	--	--	--	--
04/01/91	152.84	135.73	17.11	--	--	--	--	--	--	--	--	--
04/11/91	152.84	135.83	17.01	--	--	--	--	--	--	--	--	--
07/01/91	152.84	135.12	17.72	--	--	--	--	--	--	--	--	--
09/24/91	152.84	135.72	17.12	--	--	<50	<0.5	<0.5	<0.5	<0.5	<0.5	--
10/23/91	152.84	134.59	18.25	--	--	--	--	--	--	--	--	--
11/22/91	152.84	134.79	18.05	--	--	--	--	--	--	--	--	--
01/09/92	152.84	135.42	17.42	--	--	<50	<0.5	<0.5	<0.5	<0.5	<0.5	--
03/06/92	152.84	136.33	16.51	--	--	<50	<0.5	<0.5	<0.5	<0.5	<0.5	--
06/04/92	152.84	135.83	17.01	--	--	<50	<0.5	<0.5	<0.5	<0.5	<0.5	--
09/28/92	152.84	134.84	18.00	--	--	<50	<0.5	<0.5	<0.5	<0.5	<0.5	--
12/17/92	152.84	135.58	17.26	--	--	<50	<0.5	<0.5	<0.5	<0.5	<0.5	--
04/29/93	152.84	136.61	16.23	--	--	<50	<0.5	<0.5	<0.5	<0.5	<1.5	--

**Table 1**  
**Groundwater Monitoring Data and Analytical Results**  
Former Chevron Service Station #9-2960  
2416 Grove Way  
Castro Valley, California

WELL ID/ DATE	TOC (ft.)	GWE (msl)	DTW (ft.)	SPHT (ft.)	SPH REMOVED (gallons)	TPH-G (ppb)	B (ppb)	T (ppb)	E (ppb)	X (ppb)	MTBE (ppb)
<b>C-6 (cont)</b>											
07/29/93	152.84	135.88	16.96	--	--	<50	<0.5	<0.5	<0.5	<1.5	--
10/22/93	152.84	135.38	17.46	--	--	74	7.4	6.1	3.3	9.7	--
01/24/94	152.84	135.38	17.46	--	--	<50	<0.5	<0.5	<0.5	<0.5	--
04/11/94	152.84	135.64	17.20	--	--	<50	<0.5	<0.5	<0.5	<0.5	--
07/01/94	152.84	135.66	17.18	--	--	<50	<0.5	<0.5	<0.5	<0.5	--
10/06/94	152.84	135.19	17.65	--	--	<50	<0.5	<0.5	<0.5	<0.5	--
01/11/95	152.84	136.18	16.66	--	--	<50	<0.5	<0.5	<0.5	<0.5	--
04/07/95	152.84	137.25	15.59	--	--	<50	<0.5	<0.5	<0.5	<0.5	--
07/20/95	152.84	135.80	17.04	--	--	<50	<0.5	<0.5	<0.5	<0.5	--
09/22/95	152.84	135.74	17.10	--	--	<50	<0.5	<0.5	<0.5	<0.5	--
01/02/96	152.84	136.08	16.76	--	--	<50	<0.5	<0.5	<0.5	<0.5	<2.5
04/26/96	152.84	136.64	16.20	--	--	<50	<0.5	<0.5	<0.5	<0.5	--
07/22/96	152.84	135.79	17.05	--	--	<50	<0.5	<0.5	<0.5	<0.5	--
10/17/96	152.84	135.62	17.22	--	--	<50	<0.5	<0.5	<0.5	<0.5	--
01/23/97	152.84	136.99	15.85	--	--	<50	<0.5	<0.5	<0.5	<0.5	--
07/10/97	152.84	135.95	16.89	--	--	<50	<0.5	<0.5	<0.5	<0.5	--
01/15/98	152.84	136.64	16.20	--	--	<50	<0.5	<0.5	<0.5	<0.5	--
01/16/98	152.84	136.74	16.10	--	--	REGAUGE	--	--	--	--	--
07/09/98	152.84	136.71	16.13	--	--	<50	<0.5	<0.5	<0.5	<0.5	--
01/08/99	152.84	137.57	15.27	--	--	<50	<0.5	<0.5	<0.5	<0.5	--
07/09/99	152.84	136.60	16.24	--	--	<50	<0.5	<0.5	<0.5	<0.5	<5.0
02/01/00	152.84	136.57	16.27	--	--	<50	<0.5	<0.5	<0.5	<0.5	<5.0
08/21/00	152.84	UNABLE TO LOCATE - PAVED OVER				--	--	--	--	--	--
01/25/01	152.84	UNABLE TO LOCATE - PAVED OVER				--	--	--	--	--	--
07/10/01	152.84	UNABLE TO LOCATE - PAVED OVER				--	--	--	--	--	--
01/08/02	152.84	UNABLE TO LOCATE - PAVED OVER				--	--	--	--	--	--

**Table 1**  
**Groundwater Monitoring Data and Analytical Results**  
Former Chevron Service Station #9-2960  
2416 Grove Way  
Castro Valley, California

WELL ID/ DATE	TOC (ft.)	GWE (msl)	DTW (ft.)	SPH							MTBE (ppb)
				SPHT (ft.)	REMOVED (gallons)	TPH-G (ppb)	B (ppb)	T (ppb)	E (ppb)	X (ppb)	
C-7											
10/03/90	155.34	134.52	20.82	--	--	<50	<0.5	<0.5	<0.5	<0.5	--
10/25/90	155.34	134.43	20.91	--	--	<50	<0.5	1.0	<0.5	<0.5	--
11/09/90	155.34	134.40	20.94	--	--	<50	<0.5	<0.5	<0.5	<0.5	--
01/22/91	155.34	133.84	21.50	--	--	<50	4.0	<0.5	<0.5	<0.5	--
02/21/91	155.34	134.63	20.71	--	--	--	--	--	--	--	--
04/01/91	155.34	135.34	20.00	--	--	--	--	--	--	--	--
04/11/91	155.34	135.29	20.05	--	--	--	--	--	--	--	--
07/01/91	155.34	134.82	20.52	--	--	--	--	--	--	--	--
09/24/91	155.34	134.52	20.82	--	--	<50	<0.5	<0.5	<0.5	<0.5	--
10/23/91	155.34	134.43	20.91	--	--	--	--	--	--	--	--
11/22/91	155.34	134.55	20.79	--	--	--	--	--	--	--	--
01/09/92	155.34	135.18	20.16	--	--	<50	<0.5	<0.5	<0.5	0.9	--
03/06/92	155.34	135.92	19.42	--	--	<50	<0.5	<0.5	<0.5	<0.5	--
06/04/92	155.34	135.53	19.81	--	--	250	<0.5	<0.5	<0.5	<0.5	--
09/28/92	155.34	134.69	20.65	--	--	<50	<0.5	<0.5	<0.5	<0.5	--
12/17/92	155.34	135.32	20.02	--	--	<50	<0.5	<0.5	<0.5	<0.5	--
04/29/93	155.34	136.19	19.15	--	--	<50	<0.5	<0.5	<0.5	<1.5	--
07/26/93	155.34	135.57	19.77	--	--	<50	<0.5	<0.5	<0.5	<1.5	--
10/22/93	155.34	135.17	20.17	--	--	--	--	--	--	--	--
01/24/94	155.34	135.11	20.23	--	--	<50	<0.5	<0.5	<0.5	<0.5	--
04/11/94	155.34	135.39	19.95	--	--	<50	<0.5	<0.5	<0.5	<0.5	--
07/01/94	155.34	135.42	19.92	--	--	<50	<0.5	<0.5	<0.5	<0.5	--
10/06/94	155.34	135.03	20.31	--	--	<50	<0.5	<0.5	<0.5	<0.5	--
01/11/95	155.34	135.98	19.36	--	--	<50	<0.5	<0.5	<0.5	<0.5	--
04/07/95	155.34	136.84	18.50	--	--	<50	<0.5	<0.5	<0.5	<0.5	--
07/20/95	155.34	135.46	19.88	--	--	<50	<0.5	<0.5	<0.5	<0.5	--
09/22/95	155.34	135.38	19.96	--	--	<50	<0.5	<0.5	<0.5	<0.5	--
01/02/96	155.34	135.64	19.70	--	--	<50	<0.5	<0.5	<0.5	<0.5	<2.5
04/26/96	155.34	136.17	19.17	--	--	<50	<0.5	<0.5	<0.5	<0.5	--
07/22/96	155.34	135.49	19.85	--	--	<50	<0.5	<0.5	<0.5	<0.5	--

**Table 1**  
**Groundwater Monitoring Data and Analytical Results**  
Former Chevron Service Station #9-2960  
2416 Grove Way  
Castro Valley, California

WELL ID/ DATE	TOC (ft.)	GWE (msl)	DTW (ft.)	SPHT (ft.)	SPH REMOVED (gallons)	TPH-G (ppb)	B (ppb)	T (ppb)	E (ppb)	X (ppb)	MTBE (ppb)
<b>C-7 (cont)</b>											
10/17/96	155.34	135.34	20.00	--	--	<50	<0.5	<0.5	<0.5	<0.5	--
01/23/97	155.34	136.44	18.90	--	--	<50	<0.5	<0.5	<0.5	<0.5	--
07/10/97	155.34	135.58	19.76	--	--	<50	<0.5	<0.5	<0.5	<0.5	--
01/15/98	155.34	136.02	19.32	--	--	<50	<0.5	<0.5	<0.5	<0.5	--
01/16/98	155.34	136.14	19.20	--	--	REGAUGE	--	--	--	--	--
07/09/98	155.34	136.02	19.32	--	--	<50	<0.5	<0.5	<0.5	<0.5	--
01/08/99	155.34	136.83	18.51	--	--	<50	<0.5	<0.5	<0.5	<0.5	--
07/09/99	155.34	136.16	19.18	--	--	<50	<0.5	<0.5	<0.5	<0.5	<5.0
02/01/00	155.34	136.21	19.13	--	--	<50	<0.5	<0.5	<0.5	<0.5	<5.0
08/21/00	155.34	136.16	19.18	0.00	0.00	<50	<0.50	<0.50	<0.50	<0.50	<2.5
01/25/01	155.34	136.09	19.25	0.00	0.00	<50.0	<0.500	<0.500	<0.500	<0.500	<2.50
07/10/01	155.34	136.17	19.17	0.00	0.00	<50	<0.50	<0.50	<0.50	<0.50	<2.5/<2.0 <sup>1</sup>
01/08/02	155.34	136.31	19.03	0.00	0.00	<50	<0.50	<0.50	<0.50	<1.5	<2.5
<b>TRIP BLANK</b>											
10/03/90	--	--	--	--	--	<50	<0.5	<0.5	<0.5	<0.5	--
10/25/90	--	--	--	--	--	<50	<0.5	<0.5	<0.5	<0.5	--
11/09/90	--	--	--	--	--	<50	<0.5	<0.5	<0.5	<0.5	--
01/22/91	--	--	--	--	--	<50	<0.5	<0.5	<0.5	<0.5	--
09/24/91	--	--	--	--	--	<50	<0.5	<0.5	<0.5	<0.5	--
01/09/92	--	--	--	--	--	<50	<0.5	<0.5	<0.5	<0.5	--
03/06/92	--	--	--	--	--	<50	<0.5	<0.5	<0.5	<0.5	--
06/04/92	--	--	--	--	--	<50	<0.5	<0.5	<0.5	<0.5	--
09/28/92	--	--	--	--	--	<50	<0.5	<0.5	<0.5	<0.5	--
12/17/92	--	--	--	--	--	<50	<0.5	<0.5	<0.5	<0.5	--
04/29/93	--	--	--	--	--	<50	<0.5	<0.5	<0.5	<1.5	--
07/26/93	--	--	--	--	--	<50	<0.5	<0.5	<0.5	<1.5	--
10/22/93	--	--	--	--	--	<50	<0.5	<0.5	<0.5	<1.5	--
01/24/94	--	--	--	--	--	<50	<0.5	<0.5	<0.5	<0.5	--

**Table 1**  
**Groundwater Monitoring Data and Analytical Results**  
Former Chevron Service Station #9-2960  
2416 Grove Way  
Castro Valley, California

WELL ID/ DATE	TOC (ft.)	GWE (msl)	DTW (ft.)	SPHT (ft.)	SPH REMOVED (gallons)	TPH-G (ppb)	B (ppb)	T (ppb)	E (ppb)	X (ppb)	MTBE (ppb)
<b>TRIP BLANK (cont)</b>											
04/11/94	--	--	--	--	--	<50	<0.5	<0.5	<0.5	<0.5	--
07/01/94	--	--	--	--	--	<50	<0.5	<0.5	<0.5	<0.5	--
10/06/94	--	--	--	--	--	<50	<0.5	<0.5	<0.5	<0.5	--
01/11/95	--	--	--	--	--	<50	<0.5	<0.5	<0.5	<0.5	--
04/07/95	--	--	--	--	--	<50	<0.5	<0.5	<0.5	<0.5	--
07/20/95	--	--	--	--	--	<50	<0.5	<0.5	<0.5	<0.5	--
09/22/95	--	--	--	--	--	<50	<0.5	<0.5	<0.5	<0.5	--
01/02/96	--	--	--	--	--	<50	<0.5	<0.5	<0.5	<0.5	--
04/26/96	--	--	--	--	--	<50	<0.5	<0.5	<0.5	<0.5	--
07/22/96	--	--	--	--	--	<50	<0.5	<0.5	<0.5	<0.5	--
10/17/96	--	--	--	--	--	<50	<0.5	<0.5	<0.5	<0.5	--
01/23/97	--	--	--	--	--	<50	<0.5	<0.5	<0.5	<0.5	--
07/10/97	--	--	--	--	--	<50	<0.5	<0.5	<0.5	<0.5	--
01/15/98	--	--	--	--	--	<50	<0.5	<0.5	<0.5	<0.5	--
07/09/98	--	--	--	--	--	<50	<0.5	<0.5	<0.5	<0.5	--
01/08/99	--	--	--	--	--	<50	<0.5	<0.5	<0.5	<0.5	--
02/01/00	--	--	--	--	--	<50	<0.5	<0.5	<0.5	<0.5	<5.0
08/21/00	--	--	--	--	--	<50	<0.50	<0.50	<0.50	<0.50	<2.5
01/25/01	--	--	--	--	--	<50.0	<0.500	<0.500	<0.500	<0.500	<2.50
07/10/01	--	--	--	--	--	<50	<0.50	<0.50	<0.50	<0.50	<2.5
<b>QA</b>											
01/08/02	--	--	--	--	--	<50	<0.50	<0.50	<0.50	<1.5	<2.5

**Table 1**  
**Groundwater Monitoring Data and Analytical Results**  
Former Chevron Service Station #9-2960  
2416 Grove Way  
Castro Valley, California

---

**EXPLANATIONS:**

Groundwater monitoring data and laboratory analytical results prior to August 21, 2000, were compiled from reports prepared by Blaine Tech Services, Inc.

TOC = Top of Casing

(ft.) = Feet

GWE = Groundwater Elevation

(msl) = Mean sea level

DTW = Depth to Water

SPHT = Separate Phase Hydrocarbons Thickness

TPH-G = Total Petroleum Hydrocarbons as Gasoline

B = Benzene

T = Toluene

E = Ethylbenzene

X = Xylenes

MTBE = Methyl tertiary butyl ether

(ppb) = Parts per billion

-- = Not Measured/Not Analyzed

QA = Quality Assurance

<sup>1</sup> MTBE by EPA Method 8260.



**Table 2**  
**Groundwater Analytical Results - Oxygenate Compounds**  
 Former Chevron Service Station #9-2960  
 2416 Grove Way  
 Castro Valley, California

<b>WELL ID</b>	<b>DATE</b>	<b>TBA (ppb)</b>	<b>MTBE (ppb)</b>	<b>DIPE (ppb)</b>	<b>ETBE (ppb)</b>	<b>TAME (ppb)</b>
C-7	07/10/01	<20	<2.0	<2.0	<2.0	<2.0

**EXPLANATIONS:**

TBA = Tertiary butyl alcohol  
 MTBE = Methyl tertiary butyl ether  
 DIPE = Di-isopropyl ether  
 ETBE = Ethyl tertiary butyl ether  
 TAME = Tertiary amyl methyl ether  
 (ppb) = Parts per billion

**ANALYTICAL METHOD:**

EPA Method 8260 for Oxygenate Compounds

## STANDARD OPERATING PROCEDURE - GROUNDWATER SAMPLING

Gettler-Ryan Inc. field personnel adhere to the following procedures for the collection and handling of groundwater samples prior to analysis by the analytical laboratory. Prior to sample collection, the type of analysis to be performed is determined. Loss prevention of volatile compounds is controlled and sample preservation for subsequent analysis is maintained.

Prior to sampling, the presence or absence of free-phase hydrocarbons is determined using an interface probe. Product thickness, if present, is measured to the nearest 0.01 foot and is noted in the field notes. In addition, static water level measurements are collected with the interface probe and are also recorded in the field notes.

After water levels are collected and prior to sampling, each well is purged a minimum of three well casing volumes of water using pre-cleaned pumps (stack, suction, Grundfos), or polyvinyl chloride bailers. Temperature, pH and electrical conductivity are measured a minimum of three times during the purging. Purging continues until these parameters stabilize.

Groundwater samples are collected using Chevron-designated disposable bailers. The water samples are transferred from the bailer into appropriate containers. Pre-preserved containers, supplied by analytical laboratories, are used when possible. When pre-preserved containers are not available, the laboratory is instructed to preserve the sample as appropriate. Duplicate samples are collected for the laboratory to use in maintaining quality assurance/quality control standards. The samples are labeled to include the job number, sample identification, collection date and time, analysis, preservation (if any), and the sample collector's initials. The water samples are placed in a cooler, maintained at 4°C for transport to the laboratory. Once collected in the field, all samples are maintained under chain of custody until delivered to the laboratory.

The chain of custody document includes the job number, type of preservation, if any, analysis requested, sample identification, date and time collected, and the sample collector's name. The chain of custody is signed and dated (including time of transfer) by each person who receives or surrenders the samples, beginning with the field personnel and ending with the laboratory personnel.

A laboratory supplied trip blank accompanies each sampling set. For sampling sets greater than 20 samples, 5% trip blanks are included. The trip blank is analyzed for some or all of the same compounds as the groundwater samples.

As requested by Chevron Products Company, the purge water and decontamination water generated during sampling activities is transported by IWM to McKittrick Waste Management located in McKittrick, California.

**WELL MONITORING/SAMPLING  
FIELD DATA SHEET.**

Client/CHEVRON

Facility # 9-2960

Job#: 386363

Address: 2416 Grove Way

Date: 1-8-02

City: Castro Valley, CA

Sampler: FB

Well ID C-4

Well Condition: PAVED OVER

Well Diameter 2 in.

Hydrocarbon Thickness: \_\_\_\_\_ (feet) Amount Bailed (product/water): \_\_\_\_\_ (Gallons)

Total Depth \_\_\_\_\_ ft.

Depth to Water \_\_\_\_\_ ft.

Volume Factor (VF)	2" = 0.17	3" = 0.38	4" = 0.66
	6" = 1.50	12" = 5.80	

\_\_\_\_\_ X VF \_\_\_\_\_ = \_\_\_\_\_ X 3 (case volume) = Estimated Purge Volume: \_\_\_\_\_ (gal.)

Purge Equipment: \_\_\_\_\_  
 Disposable Bailer  
 Bailer  
 Stack  
 Suction  
 Grundfos  
 Other: \_\_\_\_\_

Sampling Equipment: \_\_\_\_\_  
 Disposable Bailer  
 Bailer  
 Pressure Bailer  
 Grab Sample  
 Other: \_\_\_\_\_

Starting Time: \_\_\_\_\_

Weather Conditions: \_\_\_\_\_

Sampling Time: \_\_\_\_\_

Water Color: \_\_\_\_\_ Odor: \_\_\_\_\_

Purging Flow Rate: \_\_\_\_\_ gpm

Sediment Description: \_\_\_\_\_

Did well de-water? \_\_\_\_\_

If yes; Time: \_\_\_\_\_ Volume: \_\_\_\_\_ (gal.)

Time	Volume (gal.)	pH	Conductivity $\mu$ mhos/cm	Temperature °F	D.O. (mg/L)	ORP (mV)	Alkalinity (ppm)

**LABORATORY INFORMATION**

SAMPLE ID	(#) - CONTAINER	REFRIG.	PRESERV. TYPE	LABORATORY	ANALYSES
		Y		LANCASTER	TPH(G)/btex/mtbe

COMMENTS: PAVED OVER

**WELL MONITORING/SAMPLING  
FIELD DATA SHEET.**

Client/CHEVRON

Facility # 9-2960

Job#: 386365

Address: 2416 Grove Way

Date: 1-8-02

City: Castro Valley, CA

Sampler: FB

Well ID C-6

Well Condition: PAVED OVER

Well Diameter 2 in.

Hydrocarbon Amount Bailed  
Thickness: \_\_\_\_\_ (feet) (product/water): \_\_\_\_\_ (Gallons)

Total Depth \_\_\_\_\_ ft.

Volume Factor (VF)	2" = 0.17	3" = 0.38	4" = 0.66
	6" = 1.50	12" = 5.80	

Depth to Water \_\_\_\_\_ ft.

\_\_\_\_\_ X VF \_\_\_\_\_ = \_\_\_\_\_ X 3 (case volume) = Estimated Purge Volume: \_\_\_\_\_ (gal.)

Purge Equipment: Disposable Bailer  
Bailer  
Stack  
Suction  
Grundfos  
Other: \_\_\_\_\_

Sampling Equipment: Disposable Bailer  
Bailer  
Pressure Bailer  
Grab Sample  
Other: \_\_\_\_\_

Starting Time: \_\_\_\_\_

Weather Conditions: \_\_\_\_\_

Sampling Time: \_\_\_\_\_

Water Color: \_\_\_\_\_ Odor: \_\_\_\_\_

Purging Flow Rate: \_\_\_\_\_ gpm.

Sediment Description: \_\_\_\_\_

Did well de-water? \_\_\_\_\_

If yes; Time: \_\_\_\_\_ Volume: \_\_\_\_\_ (gal.)

Time	Volume (gal.)	pH	Conductivity $\mu$ hos/cm	Temperature $^{\circ}$ F	D.O. (mg/L)	ORP (mV)	Alkalinity (ppm)

**LABORATORY INFORMATION**

SAMPLE ID	(#) - CONTAINER	REFRIG.	PRESERV. TYPE	LABORATORY	ANALYSES
		Y		LANCASTER	TPHIG/btex/mtbe

COMMENTS: PAVED OVER

**WELL MONITORING/SAMPLING  
FIELD DATA SHEET.**

Client/ CHEVRON  
 Facility # 9-2960  
 Address: 2416 Grove Way  
 City: Castro Valley, CA

Job#: 386365  
 Date: 1-8-02  
 Sampler: FB

Well ID: C-7 Well Condition: OK  
 Well Diameter: 2 in.  
 Total Depth: 29.86 ft.  
 Depth to Water: 19.03 ft.

Hydrocarbon Thickness:	$\phi$	Amount Bailed (product/water):	$\phi$	(Gallons)
Volume Factor (VF)	2" = 0.17	3" = 0.38	4" = 0.66	
	6" = 1.50	12" = 5.80		

10.83 X VF 17 = 1.84 X 3 (case volume) = Estimated Purge Volume: 5.5 (gal.)

Purge Equipment: Disposable Bailer  
 Bailer  
 Stack  
 Suction  
 Grundfos  
 Other: \_\_\_\_\_

Sampling Equipment: Disposable Bailer  
 Bailer  
 Pressure Bailer  
 Grab Sample  
 Other: \_\_\_\_\_

Starting Time: 1040  
 Sampling Time: 1100  
 Purging Flow Rate: \_\_\_\_\_ gpm.  
 Did well de-water? NO

Weather Conditions: cloudy  
 Water Color: cloudy Odor: NO  
 Sediment Description: \_\_\_\_\_  
 If yes; Time: \_\_\_\_\_ Volume: \_\_\_\_\_ (gal.)

Time	Volume (gal.)	pH	Conductivity $\mu$ mhos/cm	Temperature $^{\circ}$ C	D.O. (mg/L)	ORP (mV)	Alkalinity (ppm)
<u>1048</u>	<u>2</u>	<u>7.98</u>	<u>672</u>	<u>19.0</u>			
<u>1048</u>	<u>4</u>	<u>7.90</u>	<u>667</u>	<u>19.1</u>			
<u>1051</u>	<u>5.5</u>	<u>7.88</u>	<u>664</u>	<u>19.1</u>			

**LABORATORY INFORMATION**

SAMPLE ID	(#) - CONTAINER	REFRIG.	PRESERV. TYPE	LABORATORY	ANALYSES
<u>C-7</u>	<u>3 VOAS</u>	<u>Y</u>	<u>HeC</u>	<u>LANCASTER</u>	<u>TPH(G)/btex/mtbe</u>

COMMENTS: \_\_\_\_\_  
 \_\_\_\_\_  
 \_\_\_\_\_

# Chevron California Region Analysis Request/Chain of Custody



For Lancaster Laboratories use only

Acct. #: 10905 Sample #: 3756031-32 SCR#: \_\_\_\_\_

090102-009

Facility #: 9-2960 Job #386365 Global ID #T0600100318  
 Site Address: 2416 GROVE WAY, CASTRO VALLEY, CA  
 Chevron PM: Tom Bauhs Lead Consultant: Delta/G-R  
 Consultant/Office: G-R, Inc., 6747 Sierra Court, Dublin, Ca 94568  
 Consultant Prj. Mgr: Deanna L. Harding (Deanna@grinc.com)  
 Consultant Phone #: 925-551-7555 Fax #: 925-551-7899  
 Sampler: F BOHNET  
 Service Order #: \_\_\_\_\_  Non SAR: \_\_\_\_\_

Matrix		Analyses Requested													
		Preservation Codes													
Soil	Water	Oil	Air	Total Number of Containers	BTEX + MTBE	8260	8021	TPH 8015 MOD	GRO	TPH 8015 MOD DRO	Silica Gel Cleanup	8260 full scan	Oxygenates	Lead 7420	7421
										<input checked="" type="checkbox"/>	<input type="checkbox"/>	<input type="checkbox"/>			

**Preservative Codes**  
 H = HCl      T = Thiosulfate  
 N = HNO<sub>3</sub>    B = NaOH  
 S = H<sub>2</sub>SO<sub>4</sub>   O = Other

J value reporting needed  
 Must meet lowest detection limits possible for 8260 compounds

**8021 MTBE Confirmation**  
 Confirm highest hit by 8260  
 Confirm all hits by 8260  
 Run \_\_\_ oxy s on highest hit  
 Run \_\_\_ oxy s on all hits

Sample Identification	Date Collected	Time Collected	Grab	Composite
<u>QA</u>	<u>1-8-02</u>			
<u>C-9</u>	<u>1-8-02</u>	<u>1100</u>	<u>X</u>	

Soil	Water	Oil	Air	Total Number of Containers	BTEX + MTBE	8260	8021	TPH 8015 MOD	GRO	TPH 8015 MOD DRO	Silica Gel Cleanup	8260 full scan	Oxygenates	Lead 7420	7421
	X			2	X	X									
	X			3	X	X									

**Comments / Remarks**

**Turnaround Time Requested (TAT) (please circle)**

STD. TAT      72 hour      48 hour  
 24 hour      4 day      5 day

**Data Package Options (please circle if required)**

QC Summary      Type I — Full  
 Type VI (Raw Data)       Coelt Deliverable not needed  
 WIP (RWQCB)  
 Disk

Relinquished by: Frank H. Boho      Date: 1/9/02      Time: \_\_\_\_\_  
 Relinquished by: [Signature]      Date: 1/9/02      Time: 1330  
 Relinquished by: Ames Amays      Date: 1-9-02      Time: 1530  
 Relinquished by Commercial Carrier:  
 UPS      FedEx      Other Airborne  
 Temperature Upon Receipt: 3.0 °C

Received by: [Signature]      Date: 1/9/02      Time: 12:05  
 Received by: Ames Amays      Date: 1-9-02      Time: 1330  
 Received by: Airborne      Date: 1-9-02      Time: \_\_\_\_\_  
 Received by: [Signature]      Date: 1/9/02      Time: 0915  
 Custody Seals Intact? Yes      No



## ANALYTICAL RESULTS

Prepared for:

Chevron Products Company  
6001 Bollinger Canyon Road  
Building L PO Box 6004  
San Ramon CA 94583-0904  
925-842-8582

Prepared by:

Lancaster Laboratories  
2425 New Holland Pike  
Lancaster, PA 17605-2425

RECEIVED

JAN 10 2002

GETTLER-RYAN INC.  
GENERAL CONTRACTORS

### SAMPLE GROUP

The sample group for this submittal is 792847. Samples arrived at the laboratory on Thursday, January 10, 2002. The PO# for this group is 99011184 and the release number is BAUHS.

### Client Description

QA-T-020108	NA	Water
C-7-W-020108	Grab	Water

### Lancaster Labs Number

3756031
3756032

### METHODOLOGY

The specific methodologies used in obtaining the enclosed analytical results are indicated on the laboratory chronicles.

1 COPY TO Delta C/O Gettler-Ryan

Attn: Deanna L. Harding

Questions? Contact your Client Services Representative  
Teresa M. Lis at (717) 656-2300.

Respectfully Submitted,

Steve Stabinger  
Group Leader



Lancaster Laboratories, Inc.  
2425 New Holland Pike  
PO Box 12425  
Lancaster, PA 17605-2425  
717-656-2300 Fax: 717-656-2681



Lancaster Laboratories Sample No. **WW 3756031**

Collected: 01/08/2002 00:00

Account Number: 10905

Submitted: 01/10/2002 09:15  
 Reported: 01/16/2002 at 07:23  
 Discard: 02/16/2002  
 QA-T-020108                      NA                      Water

Chevron Products Company  
 6001 Bollinger Canyon Road  
 Building L PO Box 6004  
 San Ramon CA 94583-0904

Facility# 92960    Job# 386365                      GRD  
 2416 Grove-Castro Valley T0600100318 QA

CAT No.	Analysis Name	CAS Number	As Received Result	As Received Method Detection Limit	Units	Dilution Factor
01729	TPH-GRO - Waters					
01730	TPH-GRO - Waters	n.a.	N.D.	50.	ug/l	1
The reported concentration of TPH-GRO does not include MTBE or other gasoline constituents eluting prior to the C6 (n-hexane) TPH-GRO range start time. A site-specific MSD sample was not submitted for the project. A LCS/LCSD was performed to demonstrate precision and accuracy at a batch level.						
<del>08214</del>	<del>BTEX; MTBE (8021)</del>					
00776	Benzene	71-43-2	N.D.	0.50	ug/l	1
00777	Toluene	108-88-3	N.D.	0.50	ug/l	1
00778	Ethylbenzene	100-41-4	N.D.	0.50	ug/l	1
00779	Total Xylenes	1330-20-7	N.D.	1.5	ug/l	1
00780	Methyl tert-Butyl Ether	1634-04-4	N.D.	2.5	ug/l	1
A site-specific MSD sample was not submitted for the project. A LCS/LCSD was performed to demonstrate precision and accuracy at a batch level.						

State of California Lab Certification No. 2116

### Laboratory Chronicle

CAT No.	Analysis Name	Method	Trial#	Analysis Date and Time	Analyst	Dilution Factor
01729	TPH-GRO - Waters	N. CA LUFT Gasoline Method	1	01/11/2002 16:23	Melissa-Ann S. McAlpine	1
08214	BTEX, MTBE (8021)	SW-846 8021B	1	01/11/2002 16:23	Melissa-Ann S. McAlpine	1
01146	GC VOA Water Prep	SW-846 5030B	1	01/11/2002 16:23	Melissa-Ann S. McAlpine	n.a.

#=Laboratory Method Detection Limit exceeded target detection limit  
 N.D.=Not detected or above the Reporting Limit



PO Box 12425  
 Lancaster, PA 17605-2425  
 717-656-2300 Fax: 717-656-2681





Lancaster Laboratories Sample No. **WW 3756032**

Collected: 01/08/2002 11:00 by **FB**

Account Number: 10905

Submitted: 01/10/2002 09:15  
 Reported: 01/16/2002 at 07:23  
 Discard: 02/16/2002  
 C-7-W-020108

Chevron Products Company  
 6001 Bollinger Canyon Road  
 Building L PO Box 6004  
 San Ramon CA 94583-0904

Grab Water

Facility# 92960 Job# 386365 GRD  
 2416 Grove-Castro Valley T0600100318 C-7

CAT No.	Analysis Name	CAS Number	As Received Result	As Received Method Detection Limit	Units	Dilution Factor
01729	TPH-GRO - Waters					
01730	TPH-GRO - Waters	n.a.	N.D.	50.	ug/l	1
	The reported concentration of TPH-GRO does not include MTBE or other gasoline constituents eluting prior to the C6 (n-hexane) TPH-GRO range start time.					
	A site-specific MSD sample was not submitted for the project. A LCS/LCSD was performed to demonstrate precision and accuracy at a batch level.					
08214	BTEX, MTBE (8021)					
00776	Benzene	71-43-2	N.D.	0.50	ug/l	1
00777	Toluene	108-88-3	N.D.	0.50	ug/l	1
00778	Ethylbenzene	100-41-4	N.D.	0.50	ug/l	1
00779	Total Xylenes	1330-20-7	N.D.	1.5	ug/l	1
00780	Methyl tert-Butyl Ether	1634-04-4	N.D.	2.5	ug/l	1
	A site-specific MSD sample was not submitted for the project. A LCS/LCSD was performed to demonstrate precision and accuracy at a batch level.					

State of California Lab Certification No. 2116

### Laboratory Chronicle

CAT No.	Analysis Name	Method	Trial#	Analysis Date and Time	Analyst	Dilution Factor
01729	TPH-GRO - Waters	N. CA LUFT Gasoline Method	1	01/11/2002 22:15	Melissa-Ann S. McAlpine	1
08214	BTEX, MTBE (8021)	SW-846 8021B	1	01/11/2002 22:15	Melissa-Ann S. McAlpine	1
01146	GC VOA Water Prep	SW-846 5030B	1	01/11/2002 22:15	Melissa-Ann S. McAlpine	n.a.

#=Laboratory Method Detection Limit exceeded target detection limit  
 N.D.=Not detected at or above the Reporting Limit



7426 New Holland Blvd.  
 PO Box 12425  
 Lancaster, PA 17605-2425  
 717-656-2300 Fax: 717-656-2681



Client Name: Chevron Products Company  
 Reported: 01/16/02 at 07:23 AM

Group Number: 792847

### Laboratory Compliance Quality Control

<u>Analysis Name</u>	<u>Blank Result</u>	<u>Blank MDL</u>	<u>Report Units</u>	<u>LCS %REC</u>	<u>LCSD %REC</u>	<u>LCS/LCSD Limits</u>	<u>RPD</u>	<u>RPD Max</u>
Batch number: 02011A56      Sample number(s): 3756031-3756032								
Benzene	N.D.	0.5	ug/l	117	111	80-118	5	30
Toluene	N.D.	0.5	ug/l	112	107	82-119	5	30
Ethylbenzene	N.D.	0.5	ug/l	111	105	81-119	5	30
Total Xylenes	N.D.	1.5	ug/l	112	106	82-120	5	30
Methyl tert-Butyl Ether	N.D.	2.5	ug/l	114	110	79-127	3	30
TPH-GRO - Waters	N.D.	50.	ug/l	94	101	76-119	7	20

### Sample Matrix Quality Control

<u>Analysis Name</u>	<u>MS %REC</u>	<u>MSD %REC</u>	<u>MS/MSD Limits</u>	<u>RPD</u>	<u>MAX</u>	<u>BKG Conc</u>	<u>DUP Conc</u>	<u>DUP RPD</u>	<u>Dup RPD Max</u>
Batch number: 02011A56      Sample number(s): 3756031-3756032									
Benzene	117		66-140						
Toluene	114		72-138						
Ethylbenzene	113		71-138						
Total Xylenes	114		69-140						
Methyl tert-Butyl Ether	106		60-145						
TPH-GRO - Waters	109		74-132						

### Surrogate Quality Control

Analysis Name: TPH-GRO - Waters  
 Batch number: 02011A56

	Trifluorotoluene-F	Trifluorotoluene-P
3756031	91	99
3756032	89	99
Blank	90	99
LCS	104	99
LCSD	101	100
MS	102	99
Limits:	65-137	72-134

\*- Outside of specification

- (1) The result for one or both determinations was less than five times the LOQ.
- (2) The background result was more than four times the spike added.



Lancaster Laboratories, Inc.  
 2425 New Holland Pike  
 PO Box 12425  
 Lancaster, PA 17605-2425  
 717-656-2300 Fax: 717-656-2681