



Chevron

ENVIRONMENTAL
PROTECTION
99 SEP 17 PM 3:42

Chevron U.S.A. Products Company
6001 Bollinger Canyon Rd. Bldg. L
P. O. Box 6004
San Ramon, CA 94583-0804

Site Assessment and
Remediation Group
Phone (510) 842-9500
Fax (510) 842-8370

Date: September 1, 1999
To: Distribution
Re: Groundwater Monitoring Report

The enclosed groundwater monitoring report has been properly reviewed by a Chevron authorized representative. Agency guidelines have been followed. Blaine Tech Services is authorized to distribute the report directly to interested parties.

If you have any questions, please call me at ⁹²⁵~~(510)~~ 842-8695.

Sincerely,

Brett Hunter
Site Assessment and Remediation
Project Manager

BLAINE
TECH SERVICES INC.



1680 ROGERS AVENUE
SAN JOSE, CALIFORNIA 95112-1105
(408) 573-7771 FAX
(408) 573-0555 PHONE

August 31, 1999

Brett Hunter
Chevron U.S.A. Products Company
P.O. Box 6004
San Ramon, CA 94583-0904

3rd Quarter 1999 Monitoring at 9-0329

Third Quarter 1999 Groundwater Monitoring at
Chevron Service Station Number 9-0329
340 Highland Ave.
Piedmont, CA

Monitoring Performed on July 19, 1999

Groundwater Sampling Report 990719-S-1

This report covers the routine monitoring of groundwater wells at this Chevron facility. Blaine Tech Services, Inc.'s work at the site includes inspection, gauging, evacuation, purgewater containment, sample collection and sample handling in accordance with standard procedures that conform to Regional Water Quality Control Board requirements.

Routine field data collection includes depth to water, total well depth, thickness of any separate immiscible layer, water column volume, calculated volume of a three-case volume purge, elapsed evacuation time, total volume of water removed, and standard water parameter instrument readings. Sample material is collected, contained, stored, and transported to the laboratory in conformance with EPA standards. Purgewater is, likewise, collected and transported to McKittrick Waste Treatment Site for disposal.

Basic field information is presented alongside analytical values excerpted from the laboratory report in the cumulative table of **WELL DATA AND ANALYTICAL RESULTS**. The full analytical report for the most recent samples is located in the **Analytical Appendix**. The table also contains new groundwater elevation calculations taken from the computer plotted gradient

Professional Engineering Appendix

HIGHLAND WAY

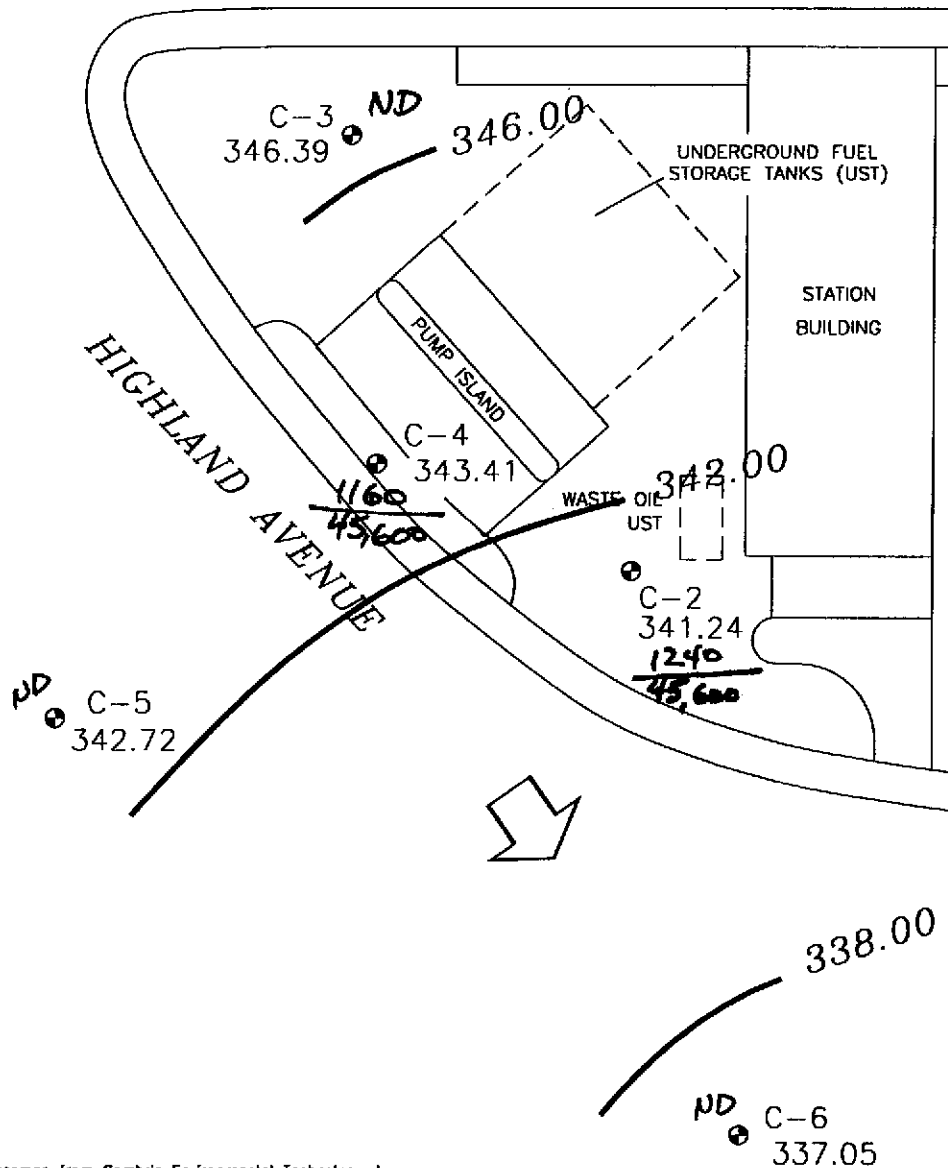
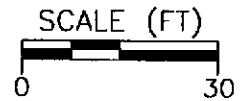

EXPLANATION

- MONITORING WELL
- 337.05 GROUNDWATER ELEVATION (FT, MSL)
- 346.00 — GROUNDWATER ELEVATION CONTOUR (FT, MSL)
- ⇩ APPROXIMATE GROUNDWATER FLOW DIRECTION; APPROXIMATE GRADIENT = 0.05

benzene (ug/l)
MTBE

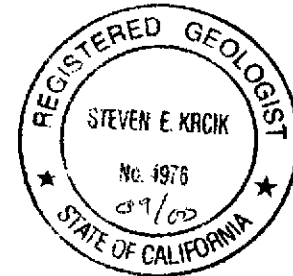

Basemap from Cambria Environmental Technology, Inc.

PREPARED BY

RRM
engineering contracting firm

Chevron Station 9-0329
340 Highland Avenue
Piedmont, California

GROUNDWATER ELEVATION CONTOUR MAP,
JULY 19, 1999

FIGURE:
1
PROJECT:
DAC04

Table of Well Data and Analytical Results

Cumulative Table of Well Data and Analytical Results

Vertical Measurements are in feet.

Analytical results are in parts per billion (ppb)

DATE	Well Head Elev.	Ground Water Elev.	Depth To Water	Notes	TPH-Gasoline	Benzene	Toluene	Ethyl-Benzene	Xylene	MTBE
C-2										
08/07/89	94.19	91.33	2.88	--	34,000	580	60	170	270	--
11/15/89	94.19	91.39	2.80	--	8100	500	36	420	180	--
02/01/91	94.19	90.41	3.75	--	6800	490	21	310	86	--
04/16/91	94.19	91.64	2.55	--	9600	810	43	550	270	--
10/16/91	94.19	90.67	3.52	--	7100	320	23	200	60	--
01/08/92	94.19	90.04	4.15	--	2400	190	9.0	83	22	--
04/10/92	94.19	91.23	2.96	--	6600	550	33	340	170	--
07/14/92	94.19	91.36	2.83	--	9000	680	330	580	690	--
10/05/92	94.19	89.81	4.38	--	5500	250	17	130	82	--
01/06/93	94.19	90.25	3.94	--	5500	190	32	41	54	--
03/29/93	94.19	92.10	2.09	--	19,000	670	40	180	370	--
07/02/93	94.19	92.10	2.09	--	8000	1100	41	420	500	--
10/11/93	94.19	91.43	2.76	--	42,000	940	34	140	87	--
01/10/94	94.19	89.37	4.82	--	12,000	770	20	220	74	--
04/06/94	94.19	91.70	2.49	--	40,000	820	33	190	110	--
07/06/94	94.19	91.72	2.47	--	8800	870	28	140	95	--
11/11/94	94.19	91.32	2.87	--	8600	460	81	180	120	--
01/06/95	94.19	91.64	2.55	--	15,000	880	48	270	140	--
04/13/95	94.19	92.13	2.06	--	56,000	2500	130	730	360	--
07/25/95	94.19	92.05	2.14	--	11,000	1000	34	540	160	--
10/05/95	94.19	91.68	2.51	--	13,000	1000	<20	160	170	--
01/02/96	94.19	91.97	2.22	--	9500	1300	<50	380	87	64,000
04/11/96	94.19	92.27	1.92	--	<10,000	1300	<100	<100	<100	74,000
07/08/96	94.19	92.14	2.05	--	<20,000	1200	<200	<200	<200	110,000
10/03/96	94.19	91.90	2.29	--	<25,000	1200	<250	<250	<250	140,000
01/23/97	343.39	341.49	1.90	--	20,000	1100	<200	460	<200	110,000
02/14/97	343.39	341.42	1.97	Confirmation run	--	--	--	--	--	150,000
04/08/97	343.39	341.12	2.27	--	<50,000	1100	<500	<500	<500	160,000
07/09/97	343.39	341.41	1.98	--	<50,000	1300	<500	<500	<500	210,000
10/08/97	343.39	341.09	2.30	--	18,000	1400	<50	300	95	160,000
01/22/98	343.39	341.71	1.68	--	10,000	860	10	140	37	70,000
04/15/98	343.39	342.19	1.20	--	<10,000	1400	<100	510	<100	46,000
07/09/98	343.39	341.92	1.47	--	33,000	1700	<50	650	<50	120,000
10/02/98	343.39	341.26	2.13	--	11,000	920	11	130	76	100,000

CONTINUED ON NEXT PAGE

Cumulative Table of Well Data and Analytical Results

Vertical Measurements are in feet.

Analytical results are in parts per billion (ppb)

DATE	Well Head Elev.	Ground Water Elev.	Depth To Water	Notes	TPH-Gasoline	Benzene	Toluene	Ethyl-Benzene	Xylene	MTBE
C-3										
08/07/89	97.65	93.36	4.29	--	<50	<0.5	<1.0	<1.0	<3.0	--
11/15/89	97.65	92.48	5.17	--	<500	<0.5	2.8	<0.5	1.1	--
02/01/91	97.65	91.27	6.38	--	<50	<0.5	<0.5	<0.5	<0.5	--
04/16/91	97.65	93.93	3.72	--	<50	<0.5	<0.5	<0.5	<0.5	--
10/16/91	97.65	89.45	8.20	--	<50	<0.5	<0.5	<0.5	<0.5	--
01/08/92	97.65	90.97	6.68	--	<50	<0.5	<0.5	<0.5	<0.5	--
04/10/92	97.65	93.15	4.50	--	<50	<0.5	<0.5	<0.5	<0.5	--
07/14/92	97.65	91.44	6.21	--	<50	<0.5	<0.5	<0.5	<0.5	--
10/05/92	97.65	88.34	9.31	--	<50	<0.5	<0.5	<0.5	<0.5	--
01/06/93	97.65	94.24	3.41	--	<50	<0.5	<0.5	<0.5	<0.5	--
03/29/93	97.65	97.15	0.50	--	<50	<0.5	<0.5	<0.5	0.8	--
07/02/93	97.65	95.06	2.59	--	<50	4.0	3.0	<0.5	3.0	--
10/11/93	97.65	92.75	4.90	--	<50	<0.5	<0.5	<0.5	<0.5	--
01/10/94	97.65	93.26	4.39	--	<50	<0.5	1.0	<0.5	0.8	--
04/06/94	97.65	94.97	2.68	--	<50	<0.5	1.0	0.7	4.5	--
07/06/94	97.65	95.55	2.10	--	<50	2.2	4.1	<0.5	2.8	--
11/11/94	97.65	96.42	1.23	--	<50	<0.5	0.8	<0.5	<0.5	--
01/06/95	97.65	97.05	0.60	--	<50	<0.5	<0.5	<0.5	<0.5	--
04/13/95	97.65	97.05	0.60	--	<50	<0.5	<0.5	<0.5	<0.5	--
07/25/95	97.65	96.00	1.65	--	<50	<0.5	<0.5	<0.5	<0.5	--
10/05/95	97.65	94.02	3.63	--	<50	<0.5	<0.5	<0.5	<0.5	--
01/02/96	97.65	94.53	3.12	--	<50	<0.5	<0.5	<0.5	<0.5	<2.5
04/11/96	97.65	96.83	0.82	--	<50	<0.5	<0.5	<0.5	<0.5	<2.5
07/08/96	97.65	96.15	1.50	--	<50	<0.5	<0.5	<0.5	<0.5	<2.5
10/03/96	97.65	95.17	2.48	--	<50	<0.5	<0.5	<0.5	<0.5	<2.5
01/23/97	347.08	346.87	0.21	--	<50	<0.5	<0.5	<0.5	<0.5	3.2
04/08/97	347.08	346.33	0.75	--	<50	<0.5	<0.5	<0.5	<0.5	<2.5
07/09/97	347.08	345.61	1.47	--	<50	<0.5	<0.5	<0.5	<0.5	<2.5
10/08/97	347.08	345.04	2.04	--	<50	<0.5	<0.5	<0.5	<0.5	<2.5

CONTINUED ON NEXT PAGE

Cumulative Table of Well Data and Analytical Results

Vertical Measurements are in feet.

Analytical results are in parts per billion (ppb)

DATE	Well Head Elev.	Ground Water Elev.	Depth To Water	Notes	TPH-Gasoline	Benzene	Toluene	Ethyl-Benzene	Xylene	MTBE
C-3 (CONT'D)										
01/22/98	347.08	347.08	0.00	Flooded	<50	<0.5	<0.5	<0.5	<0.5	40
04/15/98	347.08	347.08	0.00	Flooded	<50	<0.5	<0.5	<0.5	<0.5	<2.5
05/13/98	347.20*	--	--	--	--	--	--	--	--	--
07/09/98	347.20	346.73	0.47	--	<50	<0.5	<0.5	<0.5	<0.5	<2.5
10/02/98	347.20	346.22	0.98	--	<50	<0.5	<0.5	<0.5	<1.5	<2.5
01/18/99	347.20	346.43	0.77	--	<50	<0.5	<0.5	<0.5	<1.5	<2.0
04/19/99	347.20	346.67	0.53	--	<50	<0.5	<0.5	<0.5	<0.5	<5.0
07/19/99	347.20	346.39	0.81	--	<50	<0.5	<0.5	<0.5	<0.5	<5.0

* Well head elevation adjusted due to broken top of casing.

Cumulative Table of Well Data and Analytical Results

Vertical Measurements are in feet.

Analytical results are in parts per billion (ppb)

DATE	Well Head Elev.	Ground Water Elev.	Depth To Water	Notes	TPH-Gasoline	Benzene	Toluene	Ethyl-Benzene	Xylene	MTBE
C-4										
08/07/89	95.60	--	--	Dry	--	--	--	--	--	--
11/15/89	95.60	90.65	4.95	--	1300	2.9	310	0.5	2.9	--
02/01/91	95.60	90.82	4.78	--	72	<0.5	9.0	<0.5	<0.5	--
04/16/91	95.60	95.60	4.83	--	<50	<0.5	<0.5	<0.5	<0.5	--
10/16/91	95.60	91.37	4.23	--	<50	<0.5	<0.5	<0.5	<0.5	--
01/08/92	95.60	90.79	4.81	--	<50	<0.5	<0.5	<0.5	<0.5	--
04/10/92	95.60	91.34	4.26	--	<50	<0.5	<0.5	<0.5	<0.5	--
07/14/92	95.60	91.32	4.28	--	<50	<0.5	3.8	<0.5	<0.5	--
10/05/92	95.60	91.31	4.29	--	<50	<0.5	<0.5	<0.5	<0.5	--
01/06/93	95.60	91.31	4.29	--	<50	0.7	<0.5	<0.5	<0.5	--
03/29/93	95.60	91.30	4.30	--	<50	0.5	1.0	<0.5	2.0	--
07/02/93	95.60	91.38	4.22	--	<50	<0.5	<0.5	<0.5	<0.5	--
10/11/93	95.60	91.30	4.30	--	<50	0.6	<0.5	<0.5	<0.5	--
01/10/94	95.60	91.16	4.44	--	<50	0.7	3.0	<0.5	1.0	--
04/06/94	95.60	91.36	4.24	--	130	2.2	5.4	3.3	24	--
07/06/94	95.60	91.36	4.24	--	99	5.9	7.5	2.0	12	--
11/11/94	95.60	91.39	4.21	--	<50	<0.5	9.5	<0.5	<0.5	--
01/06/95	95.60	91.18	4.42	--	<50	0.7	1.0	<0.5	1.1	--
04/13/95	95.60	91.36	4.24	--	67	0.54	7.2	<0.5	1.1	--
07/25/95	95.60	91.36	4.24	--	390	<2.0	150	<2.0	<2.0	--
10/05/95	95.60	91.22	4.38	--	130	<0.5	66	<0.5	<0.5	--
01/02/96	95.60	91.34	4.26	--	<50	<0.5	<0.5	<0.5	<0.5	34
04/11/96	95.60	91.21	4.39	--	<50	<0.5	0.93	<0.5	<0.5	56
07/08/96	95.60	91.32	4.28	--	<50	<0.5	<0.5	<0.5	<0.5	21
10/03/96	95.60	91.38	4.22	--	80	<0.5	31	<0.5	<0.5	9.9
01/23/97	344.94	340.55	4.39	--	<50	<0.5	<0.5	<0.5	<0.5	23
04/08/97	344.94	340.69	4.25	--	87	<0.5	3.6	<0.5	1.7	7.0
07/09/97	344.94	340.73	4.21	--	93	<0.5	32	<0.5	<0.5	26
10/08/97	344.94	340.60	4.34	--	<50	<0.5	0.63	<0.5	<0.5	12
01/22/98	344.94	340.68	4.26	--	<50	<0.5	4.3	<0.5	<0.5	10
04/15/98	344.94	343.93	1.01	Sampled biannually	--	--	--	--	--	--
07/09/98	344.94	340.69	4.25	--	<50	<0.5	<0.5	<0.5	<0.5	37
10/02/98	344.94	340.59	4.35	--	--	--	--	--	--	--
01/18/99	344.94	340.73	4.21	--	<50	<0.5	<0.5	<0.5	<0.5	25.4
04/19/99	344.94	342.63	2.31	--	--	--	--	--	--	--
07/19/99	344.94	343.41	1.53	--	10,000	1160	23	178	50.4	45,600

Cumulative Table of Well Data and Analytical Results

Vertical Measurements are in feet.

Analytical results are in parts per billion (ppb)

DATE	Well Head Elev.	Ground Water Elev.	Depth To Water	Notes	TPH-Gasoline	Benzene	Toluene	Ethyl-Benzene	Xylene	MTBE
C-5										
11/25/96	--	--	3.30	--	<50	<0.5	<0.5	<0.5	<0.5	<2.5
01/23/97	345.14	343.69	1.45	--	<50	<0.5	<0.5	<0.5	<0.5	<2.5
04/08/97	345.14	342.82	2.32	--	<50	<0.5	<0.5	<0.5	<0.5	<2.5
07/09/97	345.14	342.84	2.30	--	<50	<0.5	<0.5	<0.5	<0.5	<2.5
10/08/97	345.14	342.14	3.00	--	<50	<0.5	<0.5	<0.5	<0.5	<2.5
01/22/98	345.14	344.14	1.00	--	<50	<0.5	<0.5	<0.5	<0.5	<2.5
04/15/98	345.14	341.89	3.25	Sampled annually	--	--	--	--	--	--
07/09/98	345.14	344.94	0.20	--	--	--	--	--	--	--
10/02/98	345.14	342.82	2.32	--	--	--	--	--	--	--
01/18/99	345.14	343.01	2.13	--	<50	<0.5	<0.5	<0.5	<0.5	<2.0
04/19/99	345.14	343.07	2.07	--	--	--	--	--	--	--
07/19/99	345.14	342.72	2.42	--	--	--	--	--	--	--
C-6										
11/25/96	--	--	2.13	--	<50	<0.5	<0.5	<0.5	<0.5	<2.5
01/23/97	338.61	--	0.00	Flooded	<50	<0.5	<0.5	<0.5	<0.5	<2.5
04/08/97	338.61	--	0.00	Flooded	<50	<0.5	<0.5	<0.5	<0.5	<2.5
07/09/97	338.61	335.84	2.77	--	<50	<0.5	<0.5	<0.5	<0.5	<2.5
10/08/97	338.61	337.17	1.44	--	<50	<0.5	<0.5	<0.5	<0.5	<2.5
01/22/98	338.61	337.07	1.54	--	<50	<0.5	<0.5	<0.5	<0.5	<2.5
04/15/98	338.61	337.31	1.30	--	<50	<0.5	<0.5	<0.5	<0.5	<2.5
07/09/98	338.61	338.61	0.00	Flooded	<50	<0.5	<0.5	<0.5	<0.5	<2.5
10/02/98	338.61	335.81	2.80	--	<50	<0.5	<0.5	<0.5	<1.5	<2.5
01/18/99	338.61	337.32	1.29	--	<50	<0.5	<0.5	<0.5	<0.5	<2.0
04/19/99	338.61	337.30	1.31	--	<50	<0.5	<0.5	<0.5	<0.5	<5.0
07/19/99	338.61	337.05	1.56	--	<50	<0.5	<0.5	<0.5	<0.5	<5.0

Cumulative Table of Well Data and Analytical Results

Vertical Measurements are in feet.

Analytical results are in parts per billion (ppb)

DATE	Well Head Elev.	Ground Water Elev.	Depth To Water	Notes	TPH-Gasoline	Benzene	Toluene	Ethyl-Benzene	Xylene	MTBE
Backfill Well: A										
08/07/89	--	--	2.10	--	1000	50	6.0	5.0	22	--
11/15/89	--	--	2.04	--	3700	98	2.1	4.3	55	--
02/01/91	--	--	3.05	--	36,000	1100	750	130	6100	--
04/16/91	--	--	2.01	--	8000	370	6.0	86	750	--
10/16/91	--	--	4.15	--	--	--	--	--	--	--
 Backfill Well: B										
08/07/89	--	--	4.12	--	--	--	--	--	--	--
11/15/89	--	--	--	--	--	--	--	--	--	--
02/01/91	--	--	5.03	--	--	--	--	--	--	--
04/16/91	--	--	4.00	--	--	--	--	--	--	--
10/16/91	--	--	6.24	--	--	--	--	--	--	--

Cumulative Table of Well Data and Analytical Results

Vertical Measurements are in feet.

Analytical results are in parts per billion (ppb)

DATE	Well Head Elev.	Ground Water Elev.	Depth To Water	Notes	TPH-Gasoline	Benzene	Toluene	Ethyl-Benzene	Xylene	MTBE
TRIP BLANK										
01/06/93	--	--	--	--	<50	<0.5	<0.5	<0.5	<0.5	--
03/29/93	--	--	--	--	<50	<0.5	<0.5	<0.5	1.0	--
07/02/93	--	--	--	--	<50	<0.5	<0.5	<0.5	<0.5	--
10/11/93	--	--	--	--	<50	<0.5	<0.5	<0.5	<0.5	--
01/10/94	--	--	--	--	<50	<0.5	<0.5	<0.5	<0.5	--
04/06/94	--	--	--	--	<50	<0.5	<0.5	<0.5	<0.5	--
07/06/94	--	--	--	--	<50	<0.5	<0.5	<0.5	<0.5	--
11/11/94	--	--	--	--	<50	<0.5	<0.5	<0.5	<0.5	--
01/06/95	--	--	--	--	<50	<0.5	<0.5	<0.5	<0.5	--
04/13/95	--	--	--	--	<50	<0.5	<0.5	<0.5	<0.5	--
07/25/95	--	--	--	--	<50	<0.5	<0.5	<0.5	<0.5	--
10/05/95	--	--	--	--	<50	<0.5	<0.5	<0.5	<0.5	--
01/02/96	--	--	--	--	<50	<0.5	<0.5	<0.5	<0.5	<2.5
04/11/96	--	--	--	--	<50	<0.5	<0.5	<0.5	<0.5	<2.5
07/08/96	--	--	--	--	<50	<0.5	<0.5	<0.5	<0.5	<2.5
10/03/96	--	--	--	--	<50	<0.5	<0.5	<0.5	<0.5	--
01/23/97	--	--	--	--	<50	<0.5	<0.5	<0.5	<0.5	<2.5
04/08/97	--	--	--	--	<50	<0.5	<0.5	<0.5	<0.5	<2.5
07/09/97	--	--	--	--	<50	<0.5	<0.5	<0.5	<0.5	<2.5
10/08/97	--	--	--	--	<50	<0.5	<0.5	<0.5	<0.5	<2.5
01/22/98	--	--	--	--	<50	<0.5	<0.5	<0.5	<0.5	<2.5
07/09/98	--	--	--	--	<50	<0.5	<0.5	<0.5	<0.5	<2.5
10/02/98	--	--	--	--	<50	<0.5	<0.5	<0.5	<0.5	<2.5
01/18/99	--	--	--	--	<50	<0.5	<0.5	<0.5	<0.5	<2.0
04/19/99	--	--	--	--	<50	<0.5	<0.5	<0.5	<0.5	<5.0
07/19/99	--	--	--	--	<50	<0.5	<0.5	<0.5	<0.5	<5.0

Note: Blaine Tech Services, Inc. began routine monitoring of the groundwater wells at this site on April 13, 1995.
 Earlier field data and analytical results provided by Sierra Environmental.
 Survey performed on March 20, 1997 by Ron Archer, Civil Engineer Inc.

ABBREVIATIONS:

TPH = Total Petroleum Hydrocarbons

MTBE = Methyl t-butyl ether

Analytical Appendix



August 3, 1999

Christine Lillie
Blaine Tech Services
1680 Rogers Avenue
San Jose, CA 95112

RE: L907203

Dear Christine Lillie:

Enclosed are the results of analyses for sample(s) received by the laboratory on July 20, 1999. If you have any questions concerning this report, please feel free to contact me.

Sincerely,

Wayne Stevenson
Project Manager

CA ELAP Certificate Number I-2360





Blaine Tech Services 1680 Rogers Avenue San Jose, CA 95112	Project: Chevron(8) Project Number: Chevron 9-0329, 990719-S2 Project Manager: Christine Lillie	Sampled: 7/19/99 Received: 7/20/99 Reported: 8/3/99
--	---	---

ANALYTICAL REPORT FOR L907203

Sample Description	Laboratory Sample Number	Sample Matrix	Date Sampled
C-2	L907203-01	Water	7/19/99
C-3	L907203-02	Water	7/19/99
C-4	L907203-03	Water	7/19/99
C-6	L907203-04	Water	7/19/99
TB	L907203-05	Water	7/19/99





Blaine Tech Services 1680 Rogers Avenue San Jose, CA 95112	Project: Chevron(8) Project Number: Chevron 9-0329, 990719-S2 Project Manager: Christine Lillie	Sampled: 7/19/99 Received: 7/20/99 Reported: 8/3/99
--	---	---

Sample Description: C-2
Laboratory Sample Number: L907203-01

Analyte	Batch Number	Date Prepared	Date Analyzed	Specific Method/ Surrogate Limits	Reporting Limit	Result	Units	Notes*
---------	--------------	---------------	---------------	--------------------------------------	-----------------	--------	-------	--------

Sequoia Analytical - San Carlos

Total Purgeable Hydrocarbons (C6-C12), BTEX and MTBE by DHS LUFT

Purgeable Hydrocarbons as Gasoline	9070151	7/31/99	7/31/99		1000	10500	ug/l	1
Benzene	"	"	"		10.0	1240	"	
Toluene	"	"	"		10.0	30.8	"	
Ethylbenzene	"	"	"		10.0	168	"	
Xylenes (total)	"	"	"		10.0	58.0	"	
Methyl tert-butyl ether	9080002	8/2/99	8/2/99		1000	45600	"	
Surrogate: a,a,a-Trifluorotoluene	9070151	7/31/99	7/31/99	70.0-130		103	%	





Blaine Tech Services 1680 Rogers Avenue San Jose, CA 95112	Project: Chevron(8) Project Number: Chevron 9-0329, 990719-S2 Project Manager: Christine Lillie	Sampled: 7/19/99 Received: 7/20/99 Reported: 8/3/99
--	---	---

Sample Description: C-3
Laboratory Sample Number: L907203-02

Analyte	Batch Number	Date Prepared	Date Analyzed	Specific Method/ Surrogate Limits	Reporting Limit	Result	Units	Notes*
---------	--------------	---------------	---------------	--------------------------------------	-----------------	--------	-------	--------

Sequoia Analytical - San Carlos

Total Purgeable Hydrocarbons (C6-C12), BTEX and MTBE by DHS LUFT

Purgeable Hydrocarbons as Gasoline	9070151	7/31/99	7/31/99		50.0	ND	ug/l	
Benzene	"	"	"		0.500	ND	"	
Toluene	"	"	"		0.500	ND	"	
Ethylbenzene	"	"	"		0.500	ND	"	
Xylenes (total)	"	"	"		0.500	ND	"	
Methyl tert-butyl ether	"	"	"		5.00	ND	"	
<i>Surrogate: a,a,a-Trifluorotoluene</i>	"	"	"	70.0-130		98.4	%	





Blaine Tech Services 1680 Rogers Avenue San Jose, CA 95112	Project: Chevron(8) Project Number: Chevron 9-0329, 990719-S2 Project Manager: Christine Lillie	Sampled: 7/19/99 Received: 7/20/99 Reported: 8/3/99
--	---	---

Sample Description: C-6
Laboratory Sample Number: L907203-04

Analyte	Batch Number	Date Prepared	Date Analyzed	Specific Method/ Surrogate Limits	Reporting Limit	Result	Units	Notes*
---------	--------------	---------------	---------------	--------------------------------------	-----------------	--------	-------	--------

Sequoia Analytical - San Carlos

Total Purgeable Hydrocarbons (C6-C12), BTEX and MTBE by DHS LUFT

Purgeable Hydrocarbons as Gasoline	9070151	7/31/99	7/31/99		50.0	ND	ug/l	
Benzene	"	"	"		0.500	ND	"	
Toluene	"	"	"		0.500	ND	"	
Ethylbenzene	"	"	"		0.500	ND	"	
Xylenes (total)	"	"	"		0.500	ND	"	
Methyl tert-butyl ether	"	"	"		5.00	ND	"	
Surrogate: <i>a,a,a</i> -Trifluorotoluene	"	"	"	70.0-130		93.1	%	





Blaine Tech Services 1680 Rogers Avenue San Jose, CA 95112	Project: Chevron(8) Project Number: Chevron 9-0329, 990719-S2 Project Manager: Christine Lillie	Sampled: 7/19/99 Received: 7/20/99 Reported: 8/3/99
--	---	---

Sample Description: TB
Laboratory Sample Number: L907203-05

Analyte	Batch Number	Date Prepared	Date Analyzed	Specific Method/ Surrogate Limits	Reporting Limit	Result	Units	Notes*
---------	--------------	---------------	---------------	--------------------------------------	-----------------	--------	-------	--------

Sequoia Analytical - San Carlos

Total Purgeable Hydrocarbons (C6-C12), BTEX and MTBE by DHS LUFT

Purgeable Hydrocarbons as Gasoline	9070151	7/31/99	8/1/99		50.0	ND	ug/l	
Benzene	"	"	"		0.500	ND	"	
Toluene	"	"	"		0.500	ND	"	
Ethylbenzene	"	"	"		0.500	ND	"	
Xylenes (total)	"	"	"		0.500	ND	"	
Methyl tert-butyl ether	"	"	"		5.00	ND	"	
Surrogate: <i>a,a,a</i> -Trifluorotoluene	"	"	"	70.0-130		99.0	%	





Blaine Tech Services 1680 Rogers Avenue San Jose, CA 95112	Project: Chevron(8) Project Number: Chevron 9-0329, 990719-S2 Project Manager: Christine Lillie	Sampled: 7/19/99 Received: 7/20/99 Reported: 8/3/99
--	---	---

**Total Purgeable Hydrocarbons (C6-C12), BTEX and MTBE by DHS LUFT/Quality Control
Sequoia Analytical - San Carlos**

Analyte	Date Analyzed	Spike Level	Sample Result	QC Result	Units	Reporting Limit Recov. Limits	Recov. %	RPD Limit	RPD %	Notes*
Batch: 9070151		Date Prepared: 7/31/99			Extraction Method: EPA 5030B [P/T]					
Blank										
Purgeable Hydrocarbons as Gasoline	7/31/99			ND	ug/l	50.0				
Benzene	"			ND	"	0.500				
Toluene	"			ND	"	0.500				
Ethylbenzene	"			ND	"	0.500				
Xylenes (total)	"			ND	"	0.500				
Methyl tert-butyl ether	"			ND	"	5.00				
Surrogate: a,a,a-Trifluorotoluene	"	10.0		10.5	"	70.0-130	105			
LCS										
Purgeable Hydrocarbons as Gasoline	7/31/99	250		226	ug/l	70.0-130	90.4			
Surrogate: a,a,a-Trifluorotoluene	"	10.0		9.27	"	70.0-130	92.7			
Matrix Spike										
Purgeable Hydrocarbons as Gasoline	8/1/99	250	ND	222	ug/l	60.0-140	88.8			2
Surrogate: a,a,a-Trifluorotoluene	"	10.0		8.98	"	70.0-130	89.8			
Matrix Spike Dup										
Purgeable Hydrocarbons as Gasoline	8/1/99	250	ND	211	ug/l	60.0-140	84.4	25.0	5.08	2
Surrogate: a,a,a-Trifluorotoluene	"	10.0		8.12	"	70.0-130	81.2			





Blaine Tech Services 1680 Rogers Avenue San Jose, CA 95112	Project: Chevron(8) Project Number: Chevron 9-0329, 990719-S2 Project Manager: Christine Lillie	Sampled: 7/19/99 Received: 7/20/99 Reported: 8/3/99
--	---	---

Notes and Definitions

#	Note
1	Chromatogram Pattern: Gasoline C6-C12
2	Travel Blank was used for matrix spike. The blank spike will validate the batch.
DET	Analyte DETECTED
ND	Analyte NOT DETECTED at or above the reporting limit
NR	Not Reported
dry	Sample results reported on a dry weight basis
Recov.	Recovery
RPD	Relative Percent Difference



Fax copy of Lab Report and COC to Chevron Contact: Yes No

Chain-of-Custody-Record

Chevron Products Co.
P.O. BOX 6004
San Ramon, CA 94583
FAX (925)842-8370

Chevron Facility Number 9-0329
Facility Address 340 Highland Ave., Piedmont, CA
Consultant Project Number 990719-52
Consultant Name Blaine Tech Services, Inc.
Address 1680 Rogers Ave., San Jose 95112
Project Contact (Name) Christine Lillie
(Phone) (408) 573-0555 (Fax Number) 573-7771

Chevron Contact (Name) Phil Briggs
(Phone) (925) 842-9136
Laboratory Name Sequoia
Laboratory Service Order 9144488
Laboratory Service Code ZZ02800
Samples Collected by (Name) KAS
Signature [Signature]

State Method: CA OR WA NW Series CO UT

Sample Number	Number of Containers	Matrix S = Soil A = Air W = Water C = Charcoal	Sample Preservation	Date/Time	State Method: <input type="checkbox"/> CA <input type="checkbox"/> OR <input type="checkbox"/> WA <input type="checkbox"/> NW Series <input type="checkbox"/> CO <input type="checkbox"/> UT													Remarks	
					BTEX/MTBE+TPH GAS (8020 + 8015)	BTEX + TPH GAS (8020 + 8015)	TPH Diesel (8015)	Oxygenates (8260)	Purgeable Halocarbons (8010)	Purgeable Organics (8260)	Extractable Organics (8270)	Oil and Grease (5520)	Metals (ICAP or AA) Cd,Cr,Pb,Zn,Mn	BTEX (8020)	BTEX/MTBE/Naph (8020)	TPH - HCID	TPH-D Extended		
C-2	3	W	W	7/19/99 12:35	X														1907203
C-3	1			12:00															01
C-4	1			12:15															02
C-6	1			11:15															03
IB	2																		04

SC

Relinquished By (Signature) <u>[Signature]</u>	Organization	Date/Time 7/20/99 10:35	Received By (Signature) <u>[Signature]</u>	Organization Sequoia	Date/Time 7/20/99	Lead Y/N	Turn Around Time (Circle Choice) 24 Hrs. 48 Hrs. 5 Days 10 Days As Contracted
Relinquished By (Signature) <u>[Signature]</u>	Organization	Date/Time 7/20/99	Received By (Signature) <u>[Signature]</u>	Organization	Date/Time	Lead Y/N	
Relinquished By (Signature)	Organization	Date/Time	Received For Laboratory By (Signature) <u>[Signature]</u>		Date/Time 07/20/99 14:25	Lead Y/N Y	

DWS/07-96/HCH

Field Data Sheets

CHEVRON WELL MONITORING DATA SHEET

Project #: <u>990719-S2</u>	Station #: <u>9-0329</u>
Sampler: <u>KPS</u>	Date: <u>7/19/99</u>
Well I.D.: <u>C-2</u>	Well Diameter: <u>(2)</u> 3 4 6 8
Total Well Depth: <u>14.04</u>	Depth to Water: <u>2.15</u>
Depth to Free Product: 	Thickness of Free Product (feet):
Referenced to: <u>(PVC)</u> Grade	D.O. Meter (if req'd): YSI HACH

Well Diameter	Multiplier	Well Diameter	Multiplier
2"	0.16	5"	1.02
3"	0.37	6"	1.47
4"	0.65	Other	radius ² * 0.163

Purge Method: Bailer
Disposable Bailer
 Middleburg
 Electric Submersible
 Extraction Pump
 Other: _____

Sampling Method: Bailer
Disposable Bailer
 Extraction Port
 Other: _____

<u>1.9</u>	x	<u>3</u>	=	<u>5.7</u>	Gals.
1 Case Volume (Gals.)		Specified Volumes		Calculated Volume	

Time	Temp (°F)	pH	Cond.	Gals. Removed	Observations
12:22	72.0	7.8	650	2	
12:25	79.5	7.8	687	4	
12:28	78.9	7.8	642	6	

Did well dewater? Yes No Gallons actually evacuated: 6

Sampling Time: 12:35 Sampling Date: 7/19/99

Sample I.D.: C-2 Laboratory: (Sequoia) CORE N. Creek Assoc. Labs

Analyzed for: (TPH-G BTEX MTBE) TPH-D Other: _____

Duplicate I.D.: _____ Analyzed for: TPH-G BTEX MTBE TPH-D Other: _____

D.O. (if req'd):	Pre-purge:	mg/L	Post-purge:	mg/L
O.R.P. (if req'd):	Pre-purge:	mV	Post-purge:	mV

CHEVRON WELL MONITORING DATA SHEET

Project #:	990719-S2	Station #:	9-0329
Sampler:	KPS	Date:	7/19/99
Well I.D.:	C-3	Well Diameter:	(2) 3 4 6 8
Total Well Depth:	14.09	Depth to Water:	0.81
Depth to Free Product:		Thickness of Free Product (feet):	
Referenced to:	(PVC) Grade	D.O. Meter (if req'd):	YSI HACH

Well Diameter	Multiplier	Well Diameter	Multiplier
2"	0.16	5"	1.02
3"	0.37	6"	1.47
4"	0.65	Other	radius ² * 0.163

Purge Method: Bailer
 Disposable Bailer
 Middleburg
 Electric Submersible
 Extraction Pump
 Other: _____

Sampling Method: Bailer
 Disposable Bailer
 Extraction Port
 Other: _____

$$\frac{2.2}{1 \text{ Case Volume (Gals.)}} \times \frac{3}{\text{Specified Volumes}} = \frac{6.6}{\text{Calculated Volume}} \text{ Gals.}$$

Time	Temp (°F)	pH	Cond.	Gals. Removed	Observations
11:49	73.2	7.5	506	2.5	
11:52	73.0	7.5	494	5	
11:55	72.6	7.5	499	7	

Did well dewater? Yes No

Gallons actually evacuated: 7

Sampling Time: 12:00 Sampling Date: 7/19/99

Sample I.D.: C-3 Laboratory: (Sequoia) CORE N. Creek Assoc. Labs

Analyzed for: (TPH-G BTEX MTBE) TPH-D Other: _____

Duplicate I.D.: _____ Analyzed for: TPH-G BTEX MTBE TPH-D Other: _____

D.O. (if req'd):	Pre-purge:	mg/L	Post-purge:	mg/L
O.R.P. (if req'd):	Pre-purge:	mV	Post-purge:	mV

CHEVRON WELL MONITORING DATA SHEET

Project #: <u>990719-SL</u>	Station #: <u>9-0329</u>
Sampler: <u>KPS</u>	Date: <u>7/19/99</u>
Well I.D.: <u>C-4</u>	Well Diameter: <u>(2)</u> 3 4 6 8
Total Well Depth: <u>10.21</u>	Depth to Water: <u>1.53</u>
Depth to Free Product:	Thickness of Free Product (feet):
Referenced to: <u>(PVC)</u> Grade	D.O. Meter (if req'd): YSI HACH

Well Diameter	Multiplier	Well Diameter	Multiplier
2"	0.16	5"	1.02
3"	0.37	6"	1.47
4"	0.65	Other	radius ² * 0.163

Purge Method: Bailer
Disposable Bailer
 Middleburg
 Electric Submersible
 Extraction Pump
 Other: _____

Sampling Method: Bailer
Disposable Bailer
 Extraction Port
 Other: _____

<u>1.3</u>	x	<u>3</u>	=	<u>3.9</u>	Gals.
1 Case Volume (Gals.)		Specified Volumes		Calculated Volume	

Time	Temp (°F)	pH	Cond.	Gals. Removed	Observations
<u>12:07</u>	<u>72.3</u>	<u>6.7</u>	<u>943</u>	<u>1.5</u>	
<u>12:09</u>	<u>73.4</u>	<u>6.8</u>	<u>928</u>	<u>3</u>	
<u>12:11</u>	<u>71.7</u>	<u>6.9</u>	<u>894</u>	<u>4</u>	

Did well dewater? Yes No Gallons actually evacuated: 4

Sampling Time: 12:15 Sampling Date: 7/19/99

Sample I.D.: C-4 Laboratory: (Sequoia) CORE N. Creek Assoc. Labs

Analyzed for: (TPH-G BTEX MTBE) TPH-D Other: _____

Duplicate I.D.: _____ Analyzed for: TPH-G BTEX MTBE TPH-D Other: _____

D.O. (if req'd):	Pre-purge:	mg/L	Post-purge:	mg/L
O.R.P. (if req'd):	Pre-purge:	mV	Post-purge:	mV

CHEVRON WELL MONITORING DATA SHEET

Project #: <u>990719-SL</u>	Station #: <u>9-0329</u>
Sampler: <u>KPS</u>	Date: <u>7/19/99</u>
Well I.D.: <u>C-6</u>	Well Diameter: <u>(2)</u> 3 4 6 8
Total Well Depth: <u>17.40</u>	Depth to Water: <u>1.56</u>
Depth to Free Product:	Thickness of Free Product (feet):
Referenced to: <u>(PVC)</u> Grade	D.O. Meter (if req'd): YSI HACH

Well Diameter	Multiplier	Well Diameter	Multiplier
2"	0.16	5"	1.02
3"	0.37	6"	1.47
4"	0.65	Other	radius ² * 0.163

Purge Method: Bailer
Disposable Bailer
 Middleburg
 Electric Submersible
 Extraction Pump
 Other: _____

Sampling Method: Bailer
Disposable Bailer
 Extraction Port
 Other: _____

<u>2.5</u>	x	<u>3</u>	=	<u>7.5</u>	Gals.
1 Case Volume (Gals.)		Specified Volumes		Calculated Volume	

Time	Temp (°F)	pH	Cond.	Gals. Removed	Observations
<u>11:06</u>	<u>71.2</u>	<u>7.9</u>	<u>1053</u>	<u>2.5</u>	
<u>11:08</u>	<u>70.7</u>	<u>7.8</u>	<u>619</u>	<u>5</u>	
<u>11:11</u>	<u>69.3</u>	<u>7.6</u>	<u>608</u>	<u>8</u>	

Did well dewater? Yes No Gallons actually evacuated: 8

Sampling Time: 11:15 Sampling Date: 7/19/99

Sample I.D.: C-6 Laboratory: (Sequoia) CORE N. Creek Assoc. Labs

Analyzed for: (TPH-G BTEX MIBE) TPH-D Other: _____

Duplicate I.D.: _____ Analyzed for: TPH-G BTEX MIBE TPH-D Other: _____

D.O. (if req'd):	Pre-purge:	mg/L	Post-purge:	mg/L
	Pre-purge:	mV	Post-purge:	mV