



**EXCELTECH**

**AUGUST 1991 QUARTERLY  
GROUNDWATER MONITORING  
REPORT**

**FOR**

**FORMER SHELL STATION  
7194 AMADOR VALLEY BOULEVARD  
DUBLIN, CALIFORNIA**

**Project No. 3-31000-F  
October 1991**



EXCELTECH A RESNA Company

**RESNA**

Environmental Solutions  
Through Applied Science,  
Engineering & Construction

41674 Christy Street  
Fremont, CA 94538  
Phone: (510) 659-0404  
Fax: (510) 651-4677

September 30, 1991  
Project No. 3-31000-F

Shell Oil Company  
1390 Willow Pass Road  
Suite 900  
Concord, CA 94520

Attention: Mr. Jack Brastad

Subject: August 1991 Quarterly Groundwater Monitoring Report  
Former Shell Station, 7194 Amador Valley Boulevard, Dublin, California

Dear Mr. Brastad:

This quarterly monitoring report summarizes the groundwater sampling and analyses performed during August 1991 for the subject site in the City of Dublin, Alameda County, California (Figure 1). Included are all current and past analytical data acquired during this ongoing investigation.

### **Groundwater Sampling**

Exceltech collected groundwater samples from 12 groundwater monitoring wells on and adjacent to the site (Figure 2) in accordance with Exceltech's groundwater sampling protocol.<sup>1</sup> The groundwater purged from the wells and equipment rinse water was placed in drums approved by the Department of Transportation. The drums were left on-site pending removal by a licensed hauler to the Shell refinery for recycling.

### **Laboratory Analyses**

The groundwater samples were transported to NET Pacific, Inc. (NET) located in Santa Rosa, California for analysis. NET, which is a state-certified laboratory, analyzed the samples for the presence of total petroleum hydrocarbons as gasoline (TPHG) and benzene, toluene, ethyl benzene, and total xylenes (BTEX).

---

<sup>1</sup> For Exceltech's groundwater sampling protocol refer to Appendix A in "November Quarterly Groundwater Sampling and Analysis for Former Shell Station, 7194 Amador Valley Boulevard, Dublin, California, December 20, 1991."

## Summary of Laboratory Results

The results of the groundwater sampling and analyses are summarized in Table 1. The analytical report from NET and chain-of-custody document are attached in Appendix A. Hydrocarbon constituents were detected in groundwater samples from six of the 12 monitoring wells (MW-1, MW-2, MW-3, MW-4, MW-6, and MW-13). Low concentrations of xylenes only were detected in monitoring wells MW-5, MW-11, and MW-12. Xylenes are commonly used as a laboratory cleaning agents and it is possible that these findings are due to xylenes remaining in the testing equipment.

## Discussion

A groundwater elevation contour map (Figure 2) has been generated from measurements obtained during the August 1991 sampling. The groundwater gradient varies from .0088 to .0062 with flow generally to the south-southeast. A benzene concentration contour map is presented as Figure 3. The highest concentration of benzene continues to occur at MW-13, which is located off-site on the property directly west of the site. Figures 4 through 10 are graphs representing groundwater analyses data for monitoring wells MW-1 through MW-6 and MW-13. The graphs display data collected during the first quarterly sampling up to the current quarter. In general, hydrocarbon levels in the current groundwater samples remained relatively constant when compared to last quarter's analytical results. The wells containing xylenes only will be re-evaluated next quarter. The next quarterly sampling will occur in December 1991.

## Reporting Requirements

A copy of this report will be forwarded to the following agencies:

Zone 7-Alameda County Flood Control and  
Water Conservation District  
5997 Parkside Drive  
Pleasanton, California 94566  
Attention: Mr. Craig Mayfield, Water Resources Engineer

California Regional Water Quality Control Board  
San Francisco Bay Region  
1800 Harrison Street, Suite 700  
Oakland, California 94612-3429  
Attention: Mr. Donald Dalke

Alameda County Health Care Services  
Department of Environmental Health  
Hazardous Materials Division  
80 Swan Way, Suite 200  
Oakland, California 94621  
Attention: Mr. Gil Wistar, Hazardous Materials Specialist

### Disclaimer

This report has been prepared solely for the use of Shell and any reliance on this report by third parties shall be as such party's sole risk.

### Limitations

The discussion and recommendations presented in this report are based on the following:

1. Observations by field personnel.
2. Results of laboratory analyses performed by a state-certified laboratory.
3. Our understanding of the regulations of the State of California, Alameda County, and the City of Dublin.

It is possible that variations in the soil or groundwater conditions could exist beyond the points explored in this investigation. Also, changes in the groundwater conditions could occur at some time in the future because of variations in rainfall, temperature, regional water usage, or other factors.

The service performed by Exceltech has been conducted in a manner consistent with the level of care and skill ordinarily exercised by members of our profession currently practicing under similar conditions in the Dublin area. Please note that contamination of soil and groundwater must be reported to the appropriate agencies in a timely manner. No other warranty, expressed or implied, is made.

Exceltech includes in this report chemical analytical data from a state-certified laboratory. The analytical tests are performed according to procedures suggested by the U.S. EPA and State of California. Exceltech is not responsible for laboratory errors in procedure or result reporting.

Sincerely,  
Exceltech, Inc.



Nissa L. Nack  
Staff Geologist

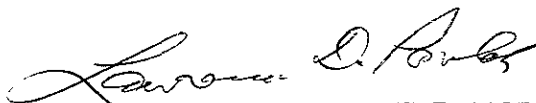

Lawrence D. Pavlak, C.E.G. 1187  
Senior Program Geologist

NLN/LDP/sw  
Enclosures

Exceltech, Inc.  
 Project No. 3-31000-F  
 September 27, 1991

Shell Oil Company  
 7194 Amador Valley Boulevard  
 Dublin, California

**TABLE 1**  
**GROUNDWATER ANALYSES DATA**

| <b>Well</b> | <b>Date</b> | <b>TPHG<br/>(ppm)</b> | <b>Benzene<br/>(ppm)</b> | <b>Toluene<br/>(ppm)</b> | <b>Ethyl<br/>Benzene<br/>(ppm)</b> | <b>Xylenes<br/>(ppm)</b> | <b>Depth To<br/>Water<br/>(ft.)</b> | <b>Well<br/>Elevation<br/>(ft.)</b> |
|-------------|-------------|-----------------------|--------------------------|--------------------------|------------------------------------|--------------------------|-------------------------------------|-------------------------------------|
| MW-1        | 05/09/88    | 0.44                  | 0.12                     | 0.05                     | N R                                | 0.12                     | 8.72                                | 334.83                              |
|             | 08/26/88    | 200                   | 4.4                      | 0.26                     | 0.30                               | 0.45                     | 9.15                                |                                     |
|             | 10/05/88    | 17                    | 6.7                      | 0.36                     | 0.21                               | 0.73                     | 8.54                                |                                     |
|             | 11/22/88    | 8                     | 3.9                      | 0.83                     | 0.25                               | 0.34                     | 9.31                                |                                     |
|             | 12/09/88    | 11                    | 0.79                     | 0.036                    | 0.0073                             | 0.068                    | 9.33                                |                                     |
|             | 01/13/89    | 8.8                   | 3.8                      | 0.11                     | 0.33                               | 0.09                     | N A                                 |                                     |
|             | 02/10/89    | 18                    | 4.7                      | 0.4                      | 0.66                               | 0.19                     | 8.51                                |                                     |
|             | 03/02/89    | 14                    | 6.1                      | 0.77                     | 0.32                               | 0.44                     | 8.71                                |                                     |
|             | 04/04/89    | 11                    | 4.8                      | 0.77                     | 0.27                               | 0.78                     | 7.93                                |                                     |
|             | 05/01/89    | 11                    | 2.8                      | 0.88                     | 0.41                               | 0.78                     | 8.43                                |                                     |
|             | 06/01/89    | N D                   | N D                      | N D                      | N D                                | N D                      | 8.56                                |                                     |
|             | 06/29/89    | 4.7                   | 0.31                     | 0.16                     | 0.075                              | 0.26                     | 8.60                                |                                     |
|             | 08/09/89    | 12                    | 1.3                      | 0.62                     | 0.83                               | 0.68                     | 8.43                                |                                     |
|             | 09/11/89    | N D                   | N D                      | N D                      | N D                                | 0.0022                   | 8.65                                |                                     |
|             | 10/10/89    | 8.7                   | 1.1                      | 0.31                     | 0.18                               | 0.59                     | 8.52                                |                                     |
|             | 10/25/89    | 7.5                   | 0.66                     | 0.25                     | 0.46                               | 0.48                     | 8.56                                |                                     |
|             | 12/20/89    | 6.2                   | 0.27                     | 0.11                     | 0.26                               | 0.22                     | 8.80                                |                                     |
| 01/17/90    | 7.4         | 0.20                  | 0.17                     | 0.16                     | 0.26                               | 8.47                     |                                     |                                     |

Exceltech, Inc.  
 Project No. 3-31000-F  
 September 27, 1991

Shell Oil Company  
 7194 Amador Valley Boulevard  
 Dublin, California

**TABLE 1**

**GROUNDWATER ANALYSES DATA**

| Well            | Date     | TPHG<br>(ppm) | Benzene<br>(ppm) | Toluene<br>(ppm) | Ethyl<br>Benzene<br>(ppm) | Xylenes<br>(ppm) | Depth To<br>Water<br>(ft.) | Well<br>Elevation<br>(ft.) |
|-----------------|----------|---------------|------------------|------------------|---------------------------|------------------|----------------------------|----------------------------|
| MW-1<br>(Con't) | 02/23/90 | 1.5           | 0.130            | 0.013            | 0.030                     | 0.024            | 8.25                       |                            |
|                 | 06/04/90 | 0.83          | 0.088            | 0.010            | 0.0026                    | 0.028            | 8.62                       |                            |
|                 | 11/20/90 | NA            | NA               | NA               | NA                        | NA               | 9.50                       |                            |
|                 | 02/12/91 | 1.5           | 0.180            | 0.039            | 0.0820                    | 0.110            | 9.51                       |                            |
|                 | 05/06/91 | 0.51          | 0.041            | 0.011            | 0.025                     | 0.035            | 8.34                       |                            |
|                 | 08/28/91 | 0.45          | 0.041            | 0.016            | 0.024                     | 0.034            | 9.28                       |                            |
|                 |          |               |                  |                  |                           |                  |                            |                            |
| MW-2            | 05/09/88 | N D           | N D              | N D              | N R                       | N D              | 10.85                      | 336.96                     |
|                 | 08/26/88 | 1.7           | 0.23             | 0.016            | 0.087                     | 0.12             | 11.29                      |                            |
|                 | 10/05/88 | 0.2           | 0.02             | 0.0023           | 0.0083                    | 0.012            | 10.83                      |                            |
|                 | 11/22/88 | 0.8           | 0.093            | 0.0016           | 0.0043                    | 0.06             | 11.42                      |                            |
|                 | 12/09/88 | 0.27          | 0.045            | 0.0036           | 0.0072                    | 0.014            | 11.45                      |                            |
|                 | 01/13/89 | 0.18          | 0.026            | 0.0023           | 0.017                     | 0.007            | N A                        |                            |
|                 | 02/10/89 | 0.32          | 0.043            | 0.0017           | 0.034                     | 0.015            | 10.74                      |                            |
|                 | 03/02/89 | 0.23          | 0.024            | 0.0009           | 0.0092                    | 0.018            | 10.91                      |                            |
|                 | 04/04/89 | 0.23          | 0.053            | 0.0023           | 0.0071                    | 0.02             | 10.06                      |                            |
|                 | 05/01/89 | N D           | 0.0027           | N D              | N D                       | N D              | 10.58                      |                            |
|                 | 05/31/89 | 0.12          | 0.014            | N D              | 0.0039                    | 0.0076           | 10.73                      |                            |

Exceltech, Inc.  
 Project No. 3-31000-F  
 September 27, 1991

Shell Oil Company  
 7194 Amador Valley Boulevard  
 Dublin, California

**TABLE 1**

**GROUNDWATER ANALYSES DATA**

| <b>Well</b>     | <b>Date</b> | <b>TPHG<br/>(ppm)</b> | <b>Benzene<br/>(ppm)</b> | <b>Toluene<br/>(ppm)</b> | <b>Ethyl<br/>Benzene<br/>(ppm)</b> | <b>Xylenes<br/>(ppm)</b> | <b>Depth To<br/>Water<br/>(ft.)</b> | <b>Well<br/>Elevation<br/>(ft.)</b> |
|-----------------|-------------|-----------------------|--------------------------|--------------------------|------------------------------------|--------------------------|-------------------------------------|-------------------------------------|
| MW-2<br>(Con't) | 06/28/89    | N D                   | 0.0041                   | N D                      | N D                                | N D                      | 10.90                               |                                     |
|                 | 08/08/89    | 0.088                 | 0.0039                   | N D                      | N D                                | N D                      | 10.78                               |                                     |
|                 | 09/08/89    | N D                   | 0.0032                   | N D                      | N D                                | N D                      | 10.97                               |                                     |
|                 | 10/09/89    | 0.11                  | 0.0067                   | N D                      | N D                                | N D                      | 10.88                               |                                     |
|                 | 10/24/89    | N D                   | 0.0025                   | N D                      | N D                                | 0.0019                   | 11.00                               |                                     |
|                 | 12/21/89    | <0.05                 | 0.0071                   | <0.0005                  | 0.005                              | 0.0098                   | 11.06                               |                                     |
|                 | 01/17/90    | <0.05                 | 0.0044                   | <0.0005                  | 0.0016                             | 0.0014                   | 10.78                               |                                     |
|                 | 02/23/90    | 0.07                  | 0.0063                   | <0.0005                  | 0.0027                             | 0.0025                   | 10.35                               |                                     |
|                 | 06/04/90    | 0.06                  | 0.0024                   | <0.0005                  | 0.0008                             | <0.0005                  | 10.72                               |                                     |
|                 | 11/20/90    | 0.06                  | 0.0056                   | <0.0005                  | <0.0005                            | <0.0005                  | 11.35                               |                                     |
|                 | 02/12/91    | 0.13                  | 0.014                    | <0.0005                  | 0.0009                             | 0.0005                   | 11.64                               |                                     |
|                 | 05/06/91    | 0.06                  | 0.0015                   | <0.0005                  | 0.005                              | <0.0005                  | 10.05                               |                                     |
|                 | 08/28/91    | 0.10                  | 0.0063                   | <0.0005                  | 0.001                              | 0.0011                   | 11.16                               |                                     |
|                 | MW-3        | 05/09/88              | 0.076                    | 0.01                     | 0.0044                             | N R                      | 0.015                               | 10.59                               |
| 08/26/88        |             | 5.2                   | 0.17                     | 0.006                    | 0.032                              | 0.054                    | 11.10                               |                                     |
| 10/05/88        |             | 0.26                  | 0.1                      | 0.0027                   | 0.0058                             | 0.007                    | 10.43                               |                                     |
| 11/22/88        |             | 0.18                  | 0.075                    | 0.0014                   | 0.0081                             | 0.004                    | 11.16                               |                                     |
| 12/09/88        |             | 0.16                  | 0.005                    | 0.0059                   | N D                                | N D                      | 11.24                               |                                     |

Exceltech, Inc.  
 Project No. 3-31000-F  
 September 27, 1991

Shell Oil Company  
 7194 Amador Valley Boulevard  
 Dublin, California

**TABLE 1**

**GROUNDWATER ANALYSES DATA**

| Well    | Date     | TPHG<br>(ppm) | Benzene<br>(ppm) | Toluene<br>(ppm) | Ethyl<br>Benzene<br>(ppm) | Xylenes<br>(ppm) | Depth To<br>Water<br>(ft.) | Well<br>Elevation<br>(ft.) |
|---------|----------|---------------|------------------|------------------|---------------------------|------------------|----------------------------|----------------------------|
| MW-3    | 01/13/89 | 0.16          | 0.036            | 0.0012           | 0.003                     | 0.002            | N A                        |                            |
| (Con't) | 02/10/89 | 0.3           | 0.083            | N D              | 0.0086                    | 0.008            | 10.43                      |                            |
|         | 03/02/89 | 0.57          | 0.16             | 0.001            | 0.017                     | 0.009            | 10.59                      |                            |
|         | 04/04/89 | 0.15          | 0.064            | 0.0008           | 0.0027                    | 0.006            | 9.45                       |                            |
|         | 05/01/89 | 0.13          | 0.048            | 0.0012           | 0.0034                    | 0.002            | 10.20                      |                            |
|         | 06/01/89 | N D           | N D              | N D              | N D                       | N D              | 10.40                      |                            |
|         | 06/28/89 | 0.09          | 0.068            | 0.0007           | N D                       | 0.0051           | 10.60                      |                            |
|         | 08/09/89 | 0.15          | 0.023            | 0.0053           | 0.0026                    | N D              | 10.64                      |                            |
|         | 09/11/89 | N D           | N D              | N D              | N D                       | N D              | 10.83                      |                            |
|         | 10/10/89 | 0.08          | 0.0064           | 0.00072          | N D                       | N D              | 10.95                      |                            |
|         | 10/26/89 | 0.15          | 0.011            | N D              | 0.0016                    | N D              | 10.86                      |                            |
|         | 12/21/89 | <0.05         | 0.0068           | <0.0005          | <0.0005                   | <0.0005          | 11.09                      |                            |
|         | 01/17/90 | <0.05         | 0.004            | <0.0005          | 0.0068                    | <0.0005          | 10.90                      |                            |
|         | 02/23/90 | 0.05          | 0.010            | <0.0005          | 0.0012                    | 0.0009           | 10.52                      |                            |
|         | 06/04/90 | 0.08          | 0.010            | <0.0005          | 0.0014                    | <0.0005          | 10.52                      |                            |
|         | 11/20/90 | 0.10          | 0.026            | 0.0007           | 0.0012                    | 0.0019           | 12.65                      |                            |
|         | 02/12/91 | 0.13          | 0.027            | <0.0005          | <0.0005                   | <0.0005          | 11.16                      |                            |
|         | 05/06/91 | 0.12          | 0.031            | 0.0008           | 0.0021                    | 0.0008           | 9.85                       | 336.93                     |
|         | 08/28/91 | 0.34          | 0.087            | 0.0011           | 0.0065                    | 0.0038           | 10.90                      |                            |



Exceltech, Inc.  
 Project No. 3-31000-F  
 September 27, 1991

Shell Oil Company  
 7194 Amador Valley Boulevard  
 Dublin, California

**TABLE 1**  
**GROUNDWATER ANALYSES DATA**

| Well | Date     | TPHG<br>(ppm) | Benzene<br>(ppm) | Toluene<br>(ppm) | Ethyl<br>Benzene<br>(ppm) | Xylenes<br>(ppm) | Depth To<br>Water<br>(ft.) | Well<br>Elevation<br>(ft.) |
|------|----------|---------------|------------------|------------------|---------------------------|------------------|----------------------------|----------------------------|
| MW-4 | 05/09/88 | 0.29          | 0.076            | 0.033            | NR                        | 0.15             | 10.88                      | 337.14                     |
|      | 08/26/88 | 0.21          | 0.64             | 0.041            | 0.11                      | 0.16             | 11.34                      |                            |
|      | 10/05/88 | 0.45          | 0.11             | 0.0063           | 0.016                     | 0.02             | 10.87                      |                            |
|      | 11/22/88 | 0.5           | 0.11             | 0.004            | 0.02                      | 0.027            | 11.41                      |                            |
|      | 12/09/88 | 0.26          | 0.92             | 0.0075           | 0.0059                    | 0.011            | 11.46                      |                            |
|      | 01/13/89 | 0.99          | 0.2              | 0.0065           | 0.046                     | 0.014            | NA                         |                            |
|      | 02/10/89 | 0.29          | 0.09             | 0.0036           | 0.0088                    | 0.009            | 10.78                      |                            |
|      | 03/02/89 | 0.63          | 0.21             | 0.0062           | 0.034                     | 0.007            | 10.92                      |                            |
|      | 04/04/89 | 0.64          | 0.34             | 0.013            | 0.025                     | 0.04             | 10.04                      |                            |
|      | 05/01/89 | 0.1           | 0.065            | 0.002            | 0.003                     | 0.004            | 10.52                      |                            |
|      | 05/31/89 | 0.06          | ND               | ND               | ND                        | ND               | 10.62                      |                            |
|      | 06/28/89 | 0.11          | 0.062            | 0.0013           | ND                        | 0.0048           | 11.00                      |                            |
|      | 08/09/89 | 0.16          | 0.11             | 0.002            | 0.0064                    | ND               | 10.92                      |                            |
|      | 09/08/89 | 0.094         | 0.045            | 0.0005           | 0.0038                    | ND               | 11.05                      |                            |
|      | 10/10/89 | 0.09          | 0.03             | 0.001            | 0.0019                    | ND               | 10.97                      |                            |
|      | 10/26/89 | ND            | 0.0034           | ND               | ND                        | ND               | 11.35                      |                            |
|      | 12/21/89 | <0.05         | 0.035            | 0.0011           | 0.0036                    | 0.0016           | 11.07                      |                            |

Exceltech, Inc.  
 Project No. 3-31000-F  
 September 27, 1991

Shell Oil Company  
 7194 Amador Valley Boulevard  
 Dublin, California

**TABLE 1**

**GROUNDWATER ANALYSES DATA**

| Well            | Date     | TPHG<br>(ppm) | Benzene<br>(ppm) | Toluene<br>(ppm) | Ethyl<br>Benzene<br>(ppm) | Xylenes<br>(ppm) | Depth To<br>Water<br>(ft.) | Well<br>Elevation<br>(ft.) |
|-----------------|----------|---------------|------------------|------------------|---------------------------|------------------|----------------------------|----------------------------|
| MW-4<br>(Con't) | 01/17/90 | <0.05         | 0.004            | <0.0005          | 0.0068                    | <0.0005          | 11.08                      |                            |
|                 | 02/23/90 | <0.05         | 0.008            | <0.0005          | 0.0011                    | 0.0007           | 10.90                      |                            |
|                 | 06/04/90 | 0.16          | 0.085            | 0.0011           | 0.0019                    | <0.0005          | 10.74                      |                            |
|                 | 11/20/90 | 0.14          | 0.052            | 0.001            | 0.0008                    | 0.0009           | 11.45                      |                            |
|                 | 02/12/91 | 0.13          | 0.048            | <0.0005          | 0.0015                    | <0.0005          | 11.50                      |                            |
|                 | 05/06/91 | 0.14          | 0.049            | 0.0013           | 0.0041                    | 0.0017           | 10.04                      |                            |
|                 | 08/28/91 | 0.09          | 0.013            | <0.0005          | 0.001                     | 0.0011           | 11.18                      |                            |
| MW-5            | 08/26/88 | 0.21          | 0.006            | 0.044            | 0.009                     | 0.019            | 9.10                       | 334.96                     |
|                 | 10/05/88 | 7.5           | 2.7              | ND               | 0.11                      | 0.59             | 9.95                       |                            |
|                 | 11/22/88 | 0.15          | 0.021            | 0.026            | 0.003                     | 0.002            | 8.93                       |                            |
|                 | 12/09/88 | 0.24          | 0.037            | 0.0022           | 0.0067                    | 0.0077           | 10.48                      |                            |
|                 | 01/13/89 | 0.08          | 0.0016           | ND               | 0.0077                    | 0.002            | N A                        |                            |
|                 | 02/10/89 | 0.06          | ND               | ND               | ND                        | ND               | 10.35                      |                            |
|                 | 03/02/89 | ND            | ND               | ND               | ND                        | ND               | 8.50                       |                            |
|                 | 04/05/89 | ND            | ND               | ND               | ND                        | ND               | 7.72                       |                            |
|                 | 05/01/89 | ND            | 0.0013           | ND               | ND                        | ND               | 8.21                       |                            |
| 06/01/89        | ND       | ND            | ND               | ND               | ND                        | 8.40             |                            |                            |

Exceltech, Inc.  
 Project No. 3-31000-F  
 September 27, 1991

Shell Oil Company  
 7194 Amador Valley Boulevard  
 Dublin, California

**TABLE 1**  
**GROUNDWATER ANALYSES DATA**

| Well             | Date     | TPHG<br>(ppm) | Benzene<br>(ppm) | Toluene<br>(ppm) | Ethyl<br>Benzene<br>(ppm) | Xylenes<br>(ppm) | Depth To<br>Water<br>(ft.) | Well<br>Elevation<br>(ft.) |
|------------------|----------|---------------|------------------|------------------|---------------------------|------------------|----------------------------|----------------------------|
| MW-5<br>(Con 't) | 06/29/89 | N D           | N D              | N D              | N D                       | N D              | 8.65                       |                            |
|                  | 08/09/89 | 0.089         | 0.0085           | 0.0018           | 0.0015                    | 0.0022           | 8.76                       |                            |
|                  | 09/11/89 | 1.1           | 0.0078           | 0.0014           | N D                       | 0.0063           | 8.80                       |                            |
|                  | 10/10/89 | N D           | N D              | N D              | N D                       | N D              | 11.92                      |                            |
|                  | 10/25/89 | N D           | 0.0014           | N D              | N D                       | 0.0016           | 9.03                       |                            |
|                  | 12/20/89 | <0.05         | <0.0005          | <0.0005          | <0.0005                   | <0.0005          | 11.26                      |                            |
|                  | 01/18/90 | <0.05         | <0.0005          | <0.0005          | <0.0005                   | <0.0005          | 9.95                       |                            |
|                  | 02/23/90 | <0.05         | <0.0005          | <0.0005          | 0.0006                    | <0.0005          | 8.30                       |                            |
|                  | 06/04/90 | <0.05         | <0.0005          | <0.0005          | <0.0005                   | <0.0005          | 8.57                       |                            |
|                  | 11/20/90 | <0.05         | <0.0005          | <0.0005          | <0.0005                   | 0.001            | 9.45                       |                            |
|                  | 02/11/91 | <0.05         | <0.0005          | <0.0005          | <0.0005                   | <0.0005          | 9.27                       |                            |
|                  | 05/06/91 | <0.05         | <0.0005          | <0.0005          | <0.0005                   | <0.0005          | 7.90                       |                            |
|                  | 08/28/91 | <0.05         | <0.0005          | <0.0005          | <0.0005                   | 0.001            | 9.28                       |                            |
| MW-6             | 08/26/88 | 15            | 0.39             | 0.39             | 0.67                      | 1.7              | 9.69                       | 335.42                     |
|                  | 10/05/88 | 2.7           | 0.13             | 0.038            | 0.96                      | 0.22             | 9.27                       |                            |
|                  | 11/22/88 | N A           | N A              | N A              | N A                       | N A              | 9.77                       |                            |
|                  | 12/09/88 | 0.54          | 0.062            | 0.003            | 0.026                     | 0.005            | 9.85                       |                            |

Exceltech, Inc.  
 Project No. 3-31000-F  
 September 27, 1991

Shell Oil Company  
 7194 Amador Valley Boulevard  
 Dublin, California

**TABLE 1**

**GROUNDWATER ANALYSES DATA**

| <b>Well</b> | <b>Date</b> | <b>TPHG<br/>(ppm)</b> | <b>Benzene<br/>(ppm)</b> | <b>Toluene<br/>(ppm)</b> | <b>Ethyl<br/>Benzene<br/>(ppm)</b> | <b>Xylenes<br/>(ppm)</b> | <b>Depth To<br/>Water<br/>(ft.)</b> | <b>Well<br/>Elevation<br/>(ft.)</b> |
|-------------|-------------|-----------------------|--------------------------|--------------------------|------------------------------------|--------------------------|-------------------------------------|-------------------------------------|
| MW-6        | 01/13/89    | 0.98                  | 0.16                     | 0.022                    | 0.12                               | 0.029                    | N A                                 |                                     |
| (Con't)     | 02/10/89    | 1.9                   | 0.29                     | 0.024                    | 0.093                              | 0.048                    | 9.10                                |                                     |
|             | 03/02/89    | 1.4                   | 0.16                     | 0.02                     | 0.13                               | 0.033                    | 9.29                                |                                     |
|             | 04/04/89    | 1.2                   | 0.22                     | 0.027                    | 0.074                              | 0.069                    | 8.48                                |                                     |
|             | 05/01/89    | 0.79                  | 0.12                     | 0.011                    | 0.025                              | 0.017                    | 8.90                                |                                     |
|             | 06/01/89    | 1.2                   | 0.049                    | 0.049                    | 0.069                              | 0.03                     | 9.16                                |                                     |
|             | 06/29/89    | 0.94                  | 0.13                     | 0.015                    | 0.069                              | 0.035                    | 9.30                                |                                     |
|             | 08/09/89    | 1.4                   | 0.28                     | 0.039                    | 0.17                               | 0.064                    | 9.30                                |                                     |
|             | 09/11/89    | N D                   | N D                      | N D                      | N D                                | N D                      | 9.31                                |                                     |
|             | 10/10/89    | 1.0                   | 0.085                    | 0.011                    | 0.012                              | 0.016                    | 9.32                                |                                     |
|             | 10/24/89    | 1.5                   | 0.067                    | 0.02                     | 0.05                               | 0.039                    | 9.30                                |                                     |
|             | 12/20/89    | <0.05                 | 0.0049                   | 0.0051                   | <0.0005                            | <0.0005                  | 9.58                                |                                     |
|             | 01/18/90    | <0.05                 | 0.067                    | 0.012                    | 0.048                              | 0.018                    | 9.46                                |                                     |
|             | 02/23/90    | 0.0010                | 0.150                    | 0.016                    | 0.047                              | 0.030                    | 8.94                                |                                     |
|             | 06/04/90    | 0.19                  | <0.0005                  | <0.0005                  | <0.0005                            | 0.0006                   | 9.22                                |                                     |
|             | 11/20/90    | 0.73                  | 0.120                    | 0.012                    | 0.039                              | 0.0210                   | 9.65                                |                                     |
|             | 02/12/91    | 0.55                  | 0.065                    | 0.010                    | 0.033                              | 0.0160                   | 9.85                                |                                     |
|             | 05/06/91    | 0.55                  | 0.072                    | 0.011                    | 0.038                              | 0.023                    | 9.12                                |                                     |
|             | 08/28/91    | 0.58                  | 0.082                    | 0.0076                   | 0.028                              | 0.0200                   | 9.68                                |                                     |



Exceltech, Inc.  
 Project No. 3-31000-F  
 September 27, 1991

Shell Oil Company  
 7194 Amador Valley Boulevard  
 Dublin, California

**TABLE 1**

**GROUNDWATER ANALYSES DATA**

| <b>Well</b>     | <b>Date</b> | <b>TPHG<br/>(ppm)</b> | <b>Benzene<br/>(ppm)</b> | <b>Toluene<br/>(ppm)</b> | <b>Ethyl<br/>Benzene<br/>(ppm)</b> | <b>Xylenes<br/>(ppm)</b> | <b>Depth To<br/>Water<br/>(ft.)</b> | <b>Well<br/>Elevation<br/>(ft.)</b> |
|-----------------|-------------|-----------------------|--------------------------|--------------------------|------------------------------------|--------------------------|-------------------------------------|-------------------------------------|
| MW-7<br>(Con't) | 11/20/90    | <0.05                 | <0.0005                  | <0.0005                  | <0.0005                            | <0.0005                  | 8.10                                |                                     |
|                 | 02/11/91    | <0.05                 | <0.0005                  | <0.0005                  | <0.0005                            | <0.0005                  | 8.04                                |                                     |
|                 | 05/06/91    | <0.05                 | <0.0005                  | <0.0005                  | <0.0005                            | <0.0005                  | 6.37                                |                                     |
|                 | 08/28/91    | <0.05                 | <0.0005                  | <0.0005                  | <0.0005                            | <0.0005                  | 7.94                                |                                     |
| MW-8            | 03/01/89    | ND                    | ND                       | ND                       | ND                                 | ND                       | 8.28                                | 335.80                              |
|                 | 04/04/89    | ND                    | ND                       | ND                       | ND                                 | ND                       | 7.31                                |                                     |
|                 | 05/01/89    | ND                    | ND                       | ND                       | ND                                 | ND                       | 8.97                                |                                     |
|                 | 05/31/89    | ND                    | ND                       | ND                       | ND                                 | ND                       | 9.17                                |                                     |
|                 | 06/28/89    | ND                    | ND                       | ND                       | ND                                 | ND                       | 9.40                                |                                     |
|                 | 08/08/89    | ND                    | ND                       | ND                       | ND                                 | ND                       | 9.42                                |                                     |
|                 | 09/07/89    | ND                    | ND                       | ND                       | ND                                 | ND                       | 8.50                                |                                     |
|                 | 10/10/89    | ND                    | ND                       | ND                       | ND                                 | ND                       | 9.46                                |                                     |
|                 | 10/26/89    | ND                    | ND                       | ND                       | ND                                 | ND                       | 9.56                                |                                     |
|                 | 12/21/89    | <0.05                 | <0.0005                  | <0.0005                  | <0.0005                            | <0.0005                  | 9.57                                |                                     |
|                 | 01/18/90    | <0.05                 | <0.0005                  | <0.0005                  | <0.0005                            | <0.0005                  | 9.29                                |                                     |
|                 | 02/26/90    | <0.05                 | <0.0005                  | <0.0005                  | <0.0005                            | <0.0005                  | 8.50                                |                                     |
|                 | 06/04/90    | <0.05                 | <0.0005                  | <0.0005                  | <0.0005                            | <0.0005                  | 9.04                                |                                     |

Exceltech, Inc.  
 Project No. 3-31000-F  
 September 27, 1991

Shell Oil Company  
 7194 Amador Valley Boulevard  
 Dublin, California

**TABLE 1**

**GROUNDWATER ANALYSES DATA**

| <b>Well</b>     | <b>Date</b> | <b>TPHG<br/>(ppm)</b> | <b>Benzene<br/>(ppm)</b> | <b>Toluene<br/>(ppm)</b> | <b>Ethyl<br/>Benzene<br/>(ppm)</b> | <b>Xylenes<br/>(ppm)</b> | <b>Depth To<br/>Water<br/>(ft.)</b> | <b>Well<br/>Elevation<br/>(ft.)</b> |
|-----------------|-------------|-----------------------|--------------------------|--------------------------|------------------------------------|--------------------------|-------------------------------------|-------------------------------------|
| MW-8<br>(Con't) | 02/11/91    | <0.05                 | <0.0005                  | <0.0005                  | <0.0005                            | <0.0005                  | 9.40                                |                                     |
|                 | 05/06/91    | <0.05                 | <0.0005                  | <0.0005                  | <0.0005                            | <0.0005                  | 8.70                                |                                     |
|                 | 08/28/91    | <0.05                 | <0.005                   | <0.0005                  | <0.0005                            | <0.0005                  | 9.68                                |                                     |
| MW-9            | 03/01/89    | ND                    | ND                       | ND                       | ND                                 | ND                       | 8.48                                | 334.57                              |
|                 | 04/04/89    | ND                    | ND                       | ND                       | ND                                 | ND                       | 7.69                                |                                     |
|                 | 05/01/89    | ND                    | ND                       | ND                       | ND                                 | ND                       | 8.20                                |                                     |
|                 | 05/31/89    | ND                    | ND                       | ND                       | ND                                 | ND                       | 8.72                                |                                     |
|                 | 06/28/89    | ND                    | ND                       | ND                       | ND                                 | ND                       | 9.00                                |                                     |
|                 | 08/08/89    | ND                    | ND                       | ND                       | ND                                 | ND                       | 8.53                                |                                     |
|                 | 09/07/89    | ND                    | ND                       | ND                       | ND                                 | ND                       | 8.99                                |                                     |
|                 | 10/09/89    | ND                    | ND                       | ND                       | ND                                 | ND                       | 8.89                                |                                     |
|                 | 10/23/89    | ND                    | ND                       | ND                       | ND                                 | ND                       | 9.02                                |                                     |
|                 | 12/21/89    | <0.05                 | <0.0005                  | <0.0005                  | <0.0005                            | <0.0005                  | 9.48                                |                                     |
|                 | 01/18/90    | <0.05                 | <0.0005                  | <0.0005                  | <0.0005                            | <0.0005                  | 8.73                                |                                     |
|                 | 02/26/90    | <0.05                 | <0.0005                  | <0.0005                  | <0.0005                            | <0.0005                  | 9.06                                |                                     |
|                 | 06/04/90    | <0.05                 | <0.0005                  | <0.0005                  | <0.0005                            | <0.0005                  | 8.64                                |                                     |

Exceltech, Inc.  
 Project No. 3-31000-F  
 September 27, 1991

Shell Oil Company  
 7194 Amador Valley Boulevard  
 Dublin, California

**TABLE 1**  
**GROUNDWATER ANALYSES DATA**

| Well            | Date     | TPHG<br>(ppm) | Benzene<br>(ppm) | Toluene<br>(ppm) | Ethyl<br>Benzene<br>(ppm) | Xylenes<br>(ppm) | Depth To<br>Water<br>(ft.) | Well<br>Elevation<br>(ft.) |  |
|-----------------|----------|---------------|------------------|------------------|---------------------------|------------------|----------------------------|----------------------------|--|
| MW-9<br>(Con't) | 11/20/90 | <0.05         | <0.0005          | <0.0005          | <0.0005                   | <0.0005          | 9.95                       |                            |  |
|                 | 02/11/91 | <0.05         | <0.0005          | <0.0005          | <0.0005                   | <0.0005          | 9.85                       |                            |  |
|                 | 05/06/91 | <0.05         | <0.0005          | <0.0005          | <0.0005                   | <0.0005          | 10.05                      |                            |  |
|                 | 08/28/91 | <0.05         | <0.0005          | <0.0005          | <0.0005                   | <0.0005          | 10.34                      |                            |  |
| MW-10           | 03/02/89 | 1             | 0.14             | 0.036            | N D                       | 0.077            | 8.95                       | 335.37                     |  |
|                 | 04/04/89 | 3.3           | 0.76             | 0.24             | 0.046                     | 0.63             | 7.89                       |                            |  |
|                 | 05/01/89 | 0.68          | 0.099            | 0.024            | 0.0081                    | 0.032            | 9.07                       |                            |  |
|                 | 06/01/89 | 1.4           | 0.12             | 0.039            | N D                       | 0.045            | 8.86                       |                            |  |
|                 | 06/29/89 | 1.3           | 0.051            | 0.0014           | 0.0061                    | 0.091            | 9.05                       |                            |  |
|                 | 08/09/89 | 0.86          | 0.31             | 0.026            | 0.045                     | 0.082            | 9.70                       |                            |  |
|                 | 09/07/89 | 0.39          | 0.055            | 0.0029           | 0.0040                    | 0.018            | 8.14                       |                            |  |
|                 | 10/10/89 | 0.46          | 0.085            | 0.0076           | 0.010                     | 0.045            | 9.21                       |                            |  |
|                 | 10/26/89 | 0.27          | 0.02             | 0.0014           | 0.0035                    | 0.0093           | 9.60                       |                            |  |
|                 | 12/20/89 | <0.05         | 0.0057           | <0.0005          | <0.0005                   | <0.0005          | 9.42                       |                            |  |
|                 | 01/18/90 | N A           | N A              | N A              | N A                       | N A              | N A                        |                            |  |
|                 | 06/04/90 | N A           | N A              | N A              | N A                       | N A              | N A                        |                            |  |
| 11/20/90        | N A      | N A           | N A              | N A              | N A                       | N A              |                            | Destroyed                  |  |



Exceltech, Inc.  
 Project No. 3-31000-F  
 September 27, 1991

Shell Oil Company  
 7194 Amador Valley Boulevard  
 Dublin, California

**TABLE 1**

**GROUNDWATER ANALYSES DATA**

| Well     | Date     | TPHG<br>(ppm) | Benzene<br>(ppm) | Toluene<br>(ppm) | Ethyl<br>Benzene<br>(ppm) | Xylenes<br>(ppm) | Depth To<br>Water<br>(ft.) | Well<br>Elevation<br>(ft.) |
|----------|----------|---------------|------------------|------------------|---------------------------|------------------|----------------------------|----------------------------|
| MW-11    | 03/02/89 | ND            | ND               | ND               | ND                        | ND               | 8.30                       | 334.20                     |
|          | 04/04/89 | ND            | ND               | ND               | ND                        | ND               | 7.52                       |                            |
|          | 05/01/89 | ND            | ND               | ND               | ND                        | ND               | 7.97                       |                            |
|          | 11/20/90 | <0.05         | <0.0005          | <0.0005          | <0.0005                   | <0.0005          | <0.0005                    |                            |
|          | 05/31/89 | ND            | ND               | ND               | ND                        | ND               | 8.13                       |                            |
|          | 06/28/89 | ND            | ND               | ND               | ND                        | ND               | 8.30                       |                            |
|          | 08/08/89 | ND            | ND               | ND               | ND                        | ND               | 8.22                       |                            |
|          | 09/07/89 | ND            | ND               | ND               | ND                        | ND               | 8.32                       |                            |
|          | 10/09/89 | ND            | ND               | ND               | ND                        | ND               | 8.28                       |                            |
|          | 10/24/89 | ND            | ND               | ND               | ND                        | ND               | 8.38                       |                            |
|          | 12/20/89 | <0.05         | <0.0005          | <0.0005          | <0.0005                   | <0.0005          | 8.48                       |                            |
|          | 01/18/90 | <0.05         | <0.0005          | <0.0005          | <0.0005                   | <0.0005          | 8.20                       |                            |
|          | 02/26/90 | <0.05         | <0.0005          | <0.0005          | <0.0005                   | <0.0005          | 7.86                       |                            |
|          | 06/04/90 | <0.05         | <0.0005          | <0.0005          | <0.0005                   | <0.0005          | 8.13                       |                            |
|          | 11/20/90 | <0.05         | <0.0005          | <0.0005          | <0.0005                   | <0.0005          | 8.83                       |                            |
|          | 02/11/91 | <0.05         | <0.0005          | <0.0005          | <0.0005                   | <0.0005          | 8.95                       |                            |
|          | 05/06/91 | <0.05         | <0.0005          | <0.0005          | <0.0005                   | <0.0005          | 7.71                       |                            |
| 08/28/91 | <0.05    | <0.0005       | <0.0005          | <0.0005          | <0.001                    | 8.62             |                            |                            |

Exceltech, Inc.  
 Project No. 3-31000-F  
 September 27, 1991

Shell Oil Company  
 7194 Amador Valley Boulevard  
 Dublin, California

**TABLE 1**

**GROUNDWATER ANALYSES DATA**

| Well     | Date     | TPHG<br>(ppm) | Benzene<br>(ppm) | Toluene<br>(ppm) | Ethyl<br>Benzene<br>(ppm) | Xylenes<br>(ppm) | Depth To<br>Water<br>(ft.) | Well<br>Elevation<br>(ft.) |
|----------|----------|---------------|------------------|------------------|---------------------------|------------------|----------------------------|----------------------------|
| MW-12    | 03/02/89 | ND            | ND               | ND               | ND                        | ND               | 6.94                       | 332.53                     |
|          | 04/04/89 | ND            | ND               | ND               | ND                        | ND               | 6.33                       |                            |
|          | 05/01/89 | ND            | ND               | ND               | ND                        | ND               | 6.62                       |                            |
|          | 06/01/89 | ND            | ND               | ND               | ND                        | ND               | 6.82                       |                            |
|          | 06/29/89 | ND            | ND               | ND               | ND                        | ND               | 7.00                       |                            |
|          | 08/09/89 | ND            | ND               | ND               | ND                        | ND               | 6.76                       |                            |
|          | 09/07/89 | ND            | ND               | ND               | ND                        | ND               | 6.81                       |                            |
|          | 10/09/89 | ND            | ND               | ND               | ND                        | ND               | 7.11                       |                            |
|          | 10/24/89 | ND            | ND               | ND               | ND                        | ND               | 7.60                       |                            |
|          | 12/20/89 | <0.05         | <0.0005          | <0.0005          | <0.0005                   | <0.0005          | 8.25                       |                            |
|          | 01/18/90 | <0.05         | <0.0005          | <0.0005          | <0.0005                   | <0.0005          | 8.23                       |                            |
|          | 02/26/90 | <0.05         | <0.0005          | <0.0005          | <0.0005                   | <0.0005          | 7.54                       |                            |
|          | 06/04/90 | <0.05         | <0.0005          | <0.0005          | <0.0005                   | <0.0005          | 7.96                       |                            |
|          | 11/20/90 | <0.05         | <0.0005          | <0.0005          | <0.0005                   | <0.0005          | 8.80                       |                            |
|          | 02/12/91 | <0.05         | <0.0005          | <0.0005          | <0.0005                   | <0.0005          | 7.85                       |                            |
|          | 05/06/91 | <0.05         | <0.0005          | <0.0005          | <0.0005                   | <0.0005          | 7.35                       |                            |
| 08/28/91 | <0.05    | <0.0005       | <0.0005          | <0.0005          | 0.001                     | 7.79             |                            |                            |
| MW-13    | 05/06/91 | 1.1           | 0.43             | 0.03             | 0.041                     | 0.13             | 8.37                       | 335.64                     |
|          | 08/28/91 | 1.0           | 0.35             | 0.0064           | 0.044                     | 0.043            | 9.82                       |                            |

Exceltech, Inc.  
 Project No. 3-31000-F  
 September 27, 1991

Shell Oil Company  
 7194 Amador Valley Boulevard  
 Dublin, California

**TABLE 1**  
**GROUNDWATER ANALYSES DATA**

| Well     | Date     | TPHG<br>(ppm) | Benzene<br>(ppm) | Toluene<br>(ppm) | Ethyl<br>Benzene<br>(ppm) | Xylenes<br>(ppm) | Depth To<br>Water<br>(ft.) | Well<br>Elevation<br>(ft.) |
|----------|----------|---------------|------------------|------------------|---------------------------|------------------|----------------------------|----------------------------|
| RW-1     | 12/09/89 | 6.8           | 0.74             | 0.005            | 0.011                     | 0.037            | 10.73                      | 336.19                     |
|          | 01/13/89 | 10            | 3.2              | 0.027            | 0.06                      | ND               | N A                        |                            |
|          | 02/10/89 | 6             | 2.8              | ND               | ND                        | ND               | 10.91                      |                            |
|          | 03/02/89 | 3.9           | 2.4              | ND               | ND                        | ND               | 10.15                      |                            |
|          | 04/05/89 | 1.7           | 1                | ND               | 0.009                     | ND               | 9.34                       |                            |
|          | 05/01/89 | 0.9           | 0.39             | 0.005            | 0.01                      | ND               | 9.85                       |                            |
|          | 06/01/89 | 1.1           | 0.0014           | 0.0033           | ND                        | 0.013            | 9.96                       |                            |
|          | 06/30/89 | 1.4           | ND               | ND               | ND                        | ND               | 9.90                       |                            |
|          | 08/09/89 | 7.5           | 1.7              | 0.21             | 0.28                      | 0.30             | 9.80                       |                            |
|          | 09/11/89 | 0.097         | 0.0017           | 0.0021           | 0.0023                    | 0.014            | 10.02                      |                            |
|          | 10/10/89 | 1.4           | 0.048            | 0.0045           | ND                        | 0.003            | 9.88                       |                            |
|          | 10/25/89 | 0.82          | 0.051            | 0.0012           | 0.025                     | 0.003            | 9.80                       |                            |
|          | 12/21/89 | 0.49          | 0.016            | 0.001            | 0.0085                    | 0.019            | 10.25                      |                            |
|          | 01/17/90 | ND            | 0.027            | 0.0017           | 0.014                     | 0.0016           | 9.80                       |                            |
|          | 02/23/90 | 0.42          | 0.042            | 0.0018           | 0.013                     | 0.0027           | 9.60                       |                            |
|          | 06/04/90 | 0.18          | 0.023            | 0.0007           | 0.0053                    | 0.0012           | 9.97                       |                            |
|          | 11/20/90 | 1.9           | 0.17             | 0.052            | 0.029                     | 0.038            | 10.50                      |                            |
| 02/11/91 | NA       | NA            | NA               | NA               | NA                        | 10.87            |                            |                            |

Exceltech, Inc.  
 Project No. 3-31000-F  
 September 27, 1991

Shell Oil Company  
 7194 Amador Valley Boulevard  
 Dublin, California

**TABLE 1**

**GROUNDWATER ANALYSES DATA**

| <b>Well</b> | <b>Date</b> | <b>TPHG<br/>(ppm)</b> | <b>Benzene<br/>(ppm)</b> | <b>Toluene<br/>(ppm)</b> | <b>Ethyl<br/>Benzene<br/>(ppm)</b> | <b>Xylenes<br/>(ppm)</b> | <b>Depth To<br/>Water<br/>(ft.)</b> | <b>Well<br/>Elevation<br/>(ft.)</b> |
|-------------|-------------|-----------------------|--------------------------|--------------------------|------------------------------------|--------------------------|-------------------------------------|-------------------------------------|
|-------------|-------------|-----------------------|--------------------------|--------------------------|------------------------------------|--------------------------|-------------------------------------|-------------------------------------|

- (a) Groundwater monitoring well MW-10 destroyed on June 13, 1990
- ppm Parts per million (mg/kg)
- TPHG Total petroleum hydrocarbons as gasoline
- N A Data not available
- N R Analysis not requested
- N D Not detected at or above laboratory listed detection limit
- <0.05 Not detected at or above the indicated detection limit
- Note: For unlisted detection limits, refer to laboratory reports

**TABLE 2**  
**GROUNDWATER SAMPLING DATA**

**Shell Oil Company**  
**7194 Amador Valley Boulevard**  
**Dublin, California**

| Well | Date    | Depth Water (ft) | Well Depth (ft) | Purge Volume (gal) | Temperature (°C) | Conductivity (µmho/cm) | pH   | Observations                 |
|------|---------|------------------|-----------------|--------------------|------------------|------------------------|------|------------------------------|
| MW-1 | 8/28/91 | 9.28             | 25.26           | 40                 | 26               | 510                    | 6.31 | Odor, cloudy                 |
|      |         |                  |                 |                    | 26               | 500                    | 6.82 |                              |
|      |         |                  |                 |                    | 24               | 490                    | 6.21 |                              |
| MW-2 | 8/28/91 | 11.16            | 24.63           | 36                 | 26               | 2770                   | 6.16 | Silty, cloudy                |
|      |         |                  |                 |                    | 25               | 2700                   | 6.37 |                              |
|      |         |                  |                 |                    | 23               | 2380                   | 6.83 |                              |
| MW-3 | 8/28/91 | 10.90            | 24.35           | 36                 | 25               | 1360                   | 6.29 | Odor, cloudy                 |
|      |         |                  |                 |                    | 25               | 1310                   | 6.04 |                              |
|      |         |                  |                 |                    | 23               | 1220                   | 6.16 |                              |
| MW-4 | 8/28/91 | 11.18            | 24.87           | 36                 | 25               | 2000                   | 7.42 | Slight odor, slightly cloudy |
|      |         |                  |                 |                    | 25               | 2050                   | 6.89 |                              |
|      |         |                  |                 |                    | 24               | 1880                   | 7.04 |                              |
| MW-5 | 8/28/91 | 9.28             | 44.84           | 25                 | 26               | 1510                   | 6.84 | Cloudy, dry at 25 gal.       |
|      |         |                  |                 |                    | 23               | 1520                   | 6.65 |                              |
| MW-6 | 8/28/91 | 9.68             | 22.95           | 36                 | 23               | 1310                   | 6.27 | Odor, cloudy                 |
|      |         |                  |                 |                    | 23               | 1260                   | 6.46 |                              |
|      |         |                  |                 |                    | 23               | 1220                   | 6.52 |                              |

**TABLE 2**  
**GROUNDWATER SAMPLING DATA**

**Shell Oil Company**  
**7194 Amador Valley Boulevard**  
**Dublin, California**

| Well  | Date    | Depth Water (ft) | Well Depth (ft) | Purge Volume (gal) | Temperature (°C) | Conductivity (µmho/cm) | pH   | Observations           |
|-------|---------|------------------|-----------------|--------------------|------------------|------------------------|------|------------------------|
| MW-7  | 8/28/91 | 7.94             | 16.32           | 12                 | 25               | 1710                   | 6.23 | Cloudy, dry at 12 gal. |
|       |         |                  |                 |                    | 25               | 1890                   | 7.95 |                        |
| MW-8  | 8/28/91 | 9.68             | 16.25           | 8                  | 26               | 2050                   | 6.65 | Cloudy, dry at 8 gal.  |
|       |         |                  |                 |                    | 25               | 1940                   | 6.35 |                        |
| MW-9  | 8/28/91 | 10.34            | 17.93           | 20                 | 24               | 2190                   | 6.54 | Cloudy                 |
|       |         |                  |                 |                    | 24               | 2190                   | 7.15 |                        |
|       |         |                  |                 |                    | 24               | 2210                   | 7.00 |                        |
| MW-10 | 8/28/91 | 8.62             | 16.51           | 20                 | 22               | 2550                   | 6.20 | Cloudy                 |
|       |         |                  |                 |                    | 22               | 2520                   | 6.12 |                        |
|       |         |                  |                 |                    | 22               | 2580                   | 6.15 |                        |
| MW-12 | 8/28/91 | 7.79             | 17.15           | 24                 | 22               | 980                    | 6.31 | Clear/yellow           |
|       |         |                  |                 |                    | 22               | 1010                   | 6.24 |                        |
|       |         |                  |                 |                    | 22               | 970                    | 6.15 |                        |
| MW-13 | 8/28/91 | 9.82             | 17.13           | 20                 | 25               | 1510                   | 5.98 | Cloudy, dry at 16 gal. |
|       |         |                  |                 |                    | 22               | 1410                   | 6.47 |                        |
|       |         |                  |                 |                    | 22               | 1380                   |      |                        |

ft.            Feet  
 gal.         Gallons  
 °C            Degrees Celcius  
 µmho/cm    Micromhos per centimeter

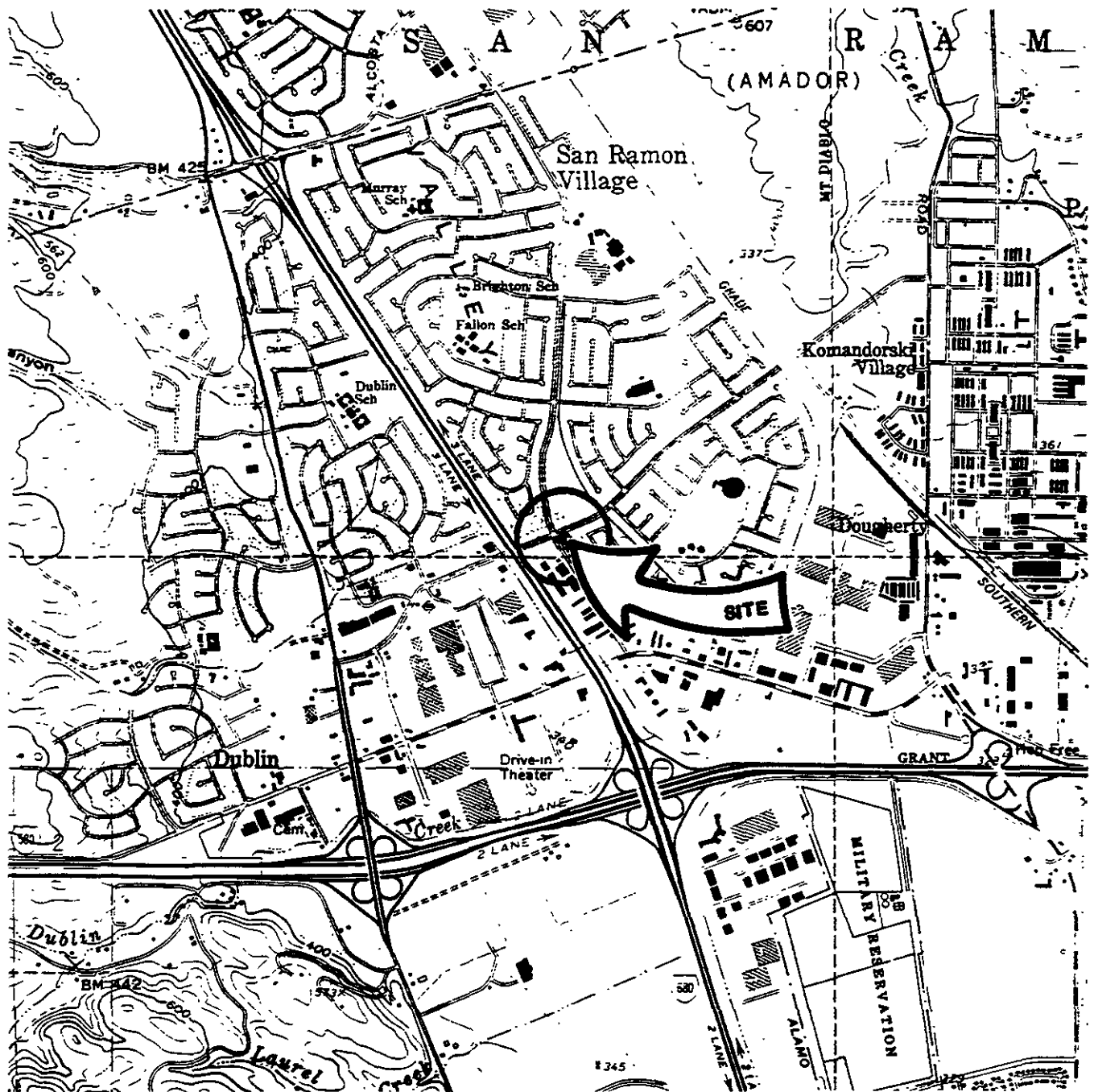

SOURCE: USGS 7.5' MAP, DUBLIN QUADRANGLE

**LEGEND**

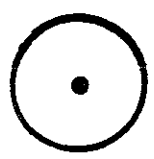

SITE LOCATION

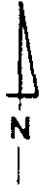

**SITE LOCATION MAP**

FORMER SHELL STATION

7194 AMADOR VALLEY BLVD

DUBLIN, CALIFORNIA

REVIEWED BY APPROVED BY

*J.P.* *[Signature]*

JOB # 3-31000-F DRAWN BY J.C.

DATE 7/18/91 DRAWING # FIG. 1

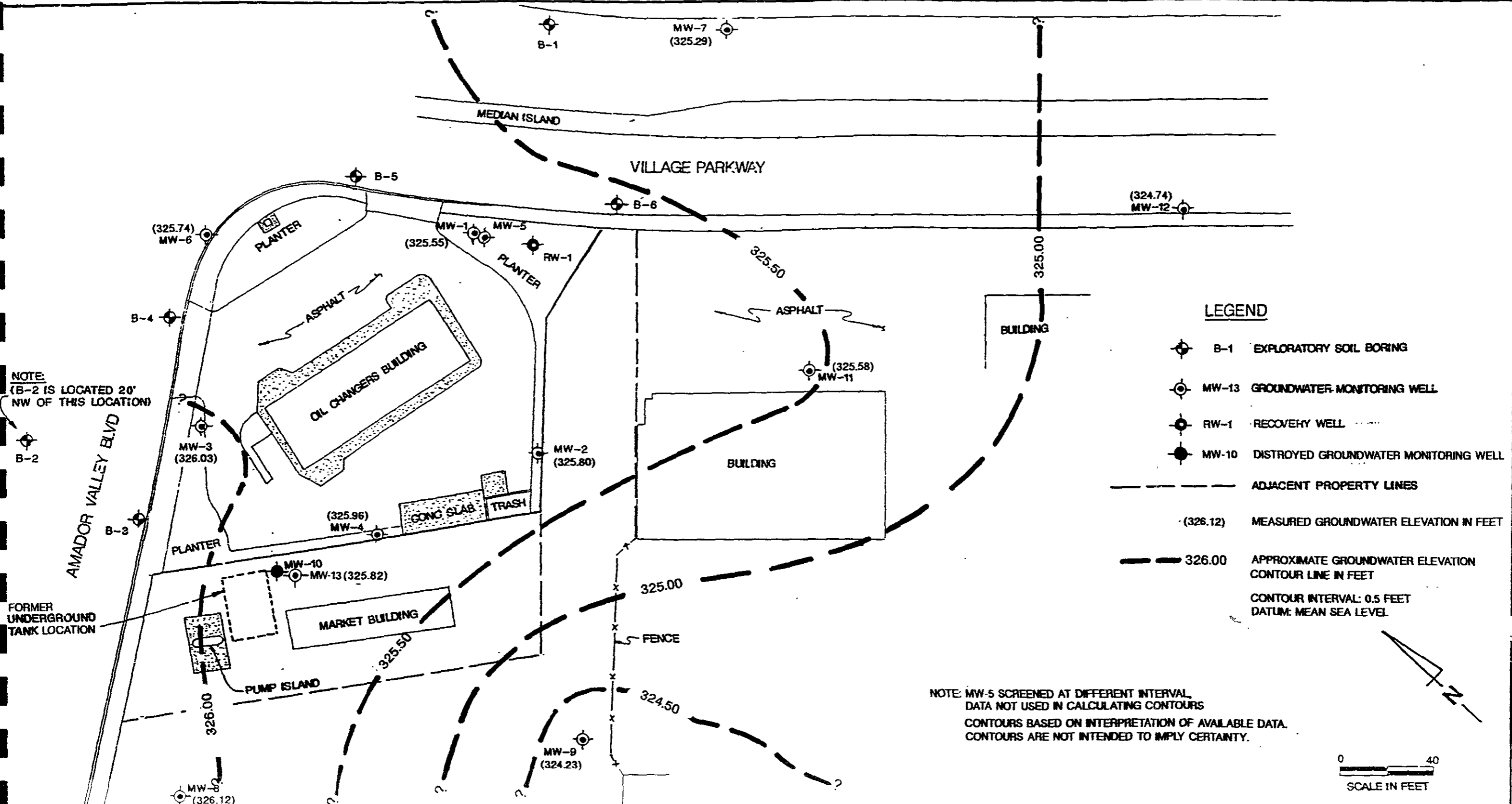

NOTE  
(B-2 IS LOCATED 20'  
NW OF THIS LOCATION)

**LEGEND**

- B-1 EXPLORATORY SOIL BORING
  - MW-13 GROUNDWATER MONITORING WELL
  - RW-1 RECOVERY WELL
  - MW-10 DESTROYED GROUNDWATER MONITORING WELL
  - ADJACENT PROPERTY LINES
  - (326.12) MEASURED GROUNDWATER ELEVATION IN FEET
  - 326.00 APPROXIMATE GROUNDWATER ELEVATION CONTOUR LINE IN FEET
- CONTOUR INTERVAL: 0.5 FEET  
DATUM: MEAN SEA LEVEL

NOTE: MW-5 SCREENED AT DIFFERENT INTERVAL  
DATA NOT USED IN CALCULATING CONTOURS  
CONTOURS BASED ON INTERPRETATION OF AVAILABLE DATA.  
CONTOURS ARE NOT INTENDED TO IMPLY CERTAINTY.

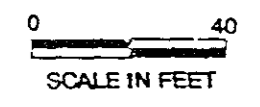



**GROUNDWATER ELEVATION CONTOUR MAP (8/28/91)**

FORMER SHELL STATION  
7194 AMADOR VALLEY BLVD  
DUBLIN, CALIFORNIA

|                     |                      |
|---------------------|----------------------|
| REVIEWED BY:<br>    | APPROVED BY:<br>     |
| JOB #:<br>3-31000-F | DRAWN BY:<br>J.D.S.  |
| DATE:<br>9/10/91    | DRAWING #:<br>FIG. 2 |

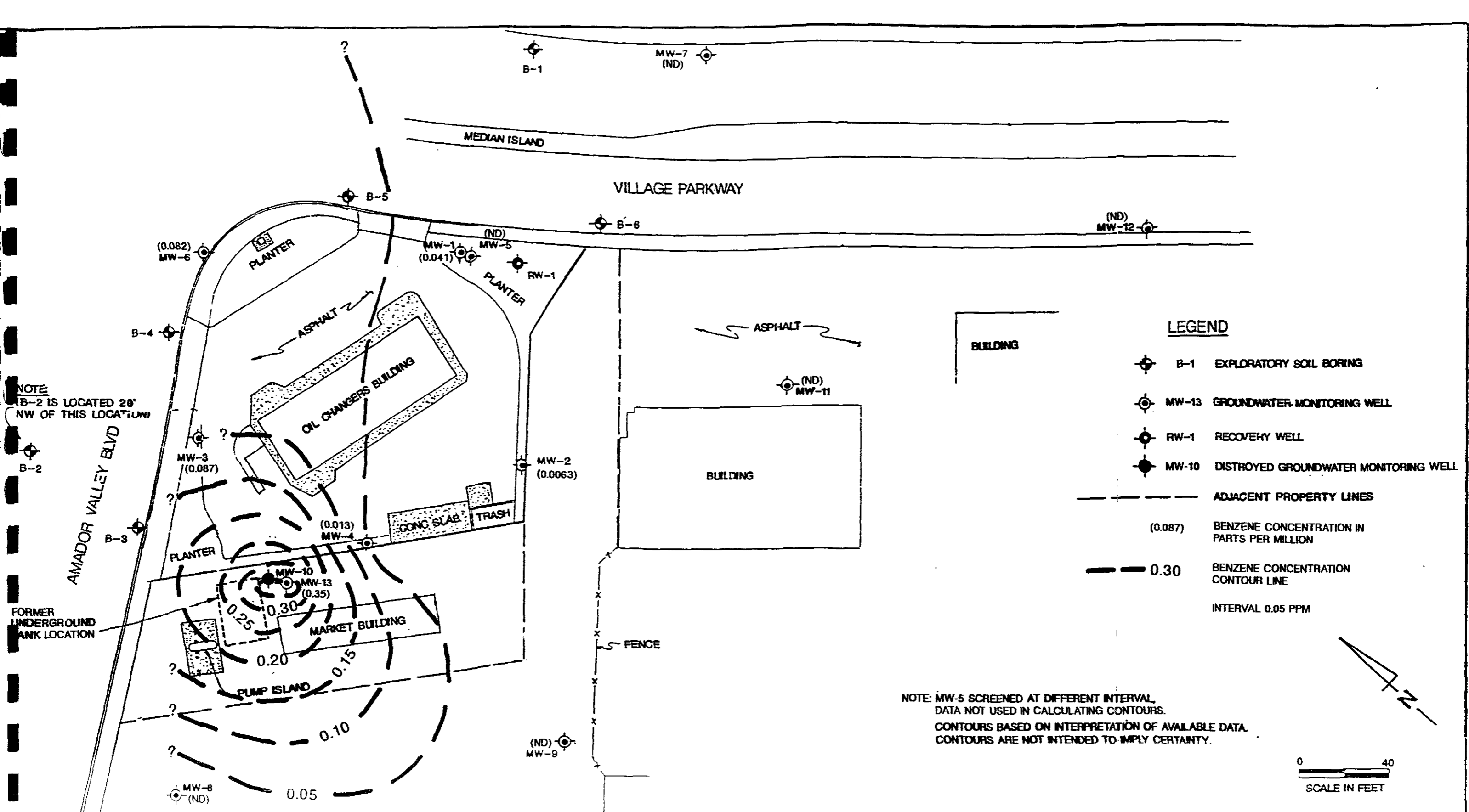



|   |  |                            |                                    |
|---|--|----------------------------|------------------------------------|
| <br><b>EXCELTECH</b> | <b>BENZENE CONCENTRATION CONTOUR MAP (8/28/91)</b> | REVIEWED BY:<br><i>WLN</i> | APPROVED BY:<br><i>[Signature]</i> |
|   | FORMER SHELL STATION                               | JOB #:<br>3-31000-F        | DRAWN BY:<br>E.C.                  |
|   | 7194 AMADOR VALLEY BLVD                            | DATE:<br>9/23/91           | DRAWING #:<br>FIG. 3               |
|   | DUBLIN, CALIFORNIA                                 |                            |                                    |

# MW-1 GROUNDWATER ANALYSES DATA

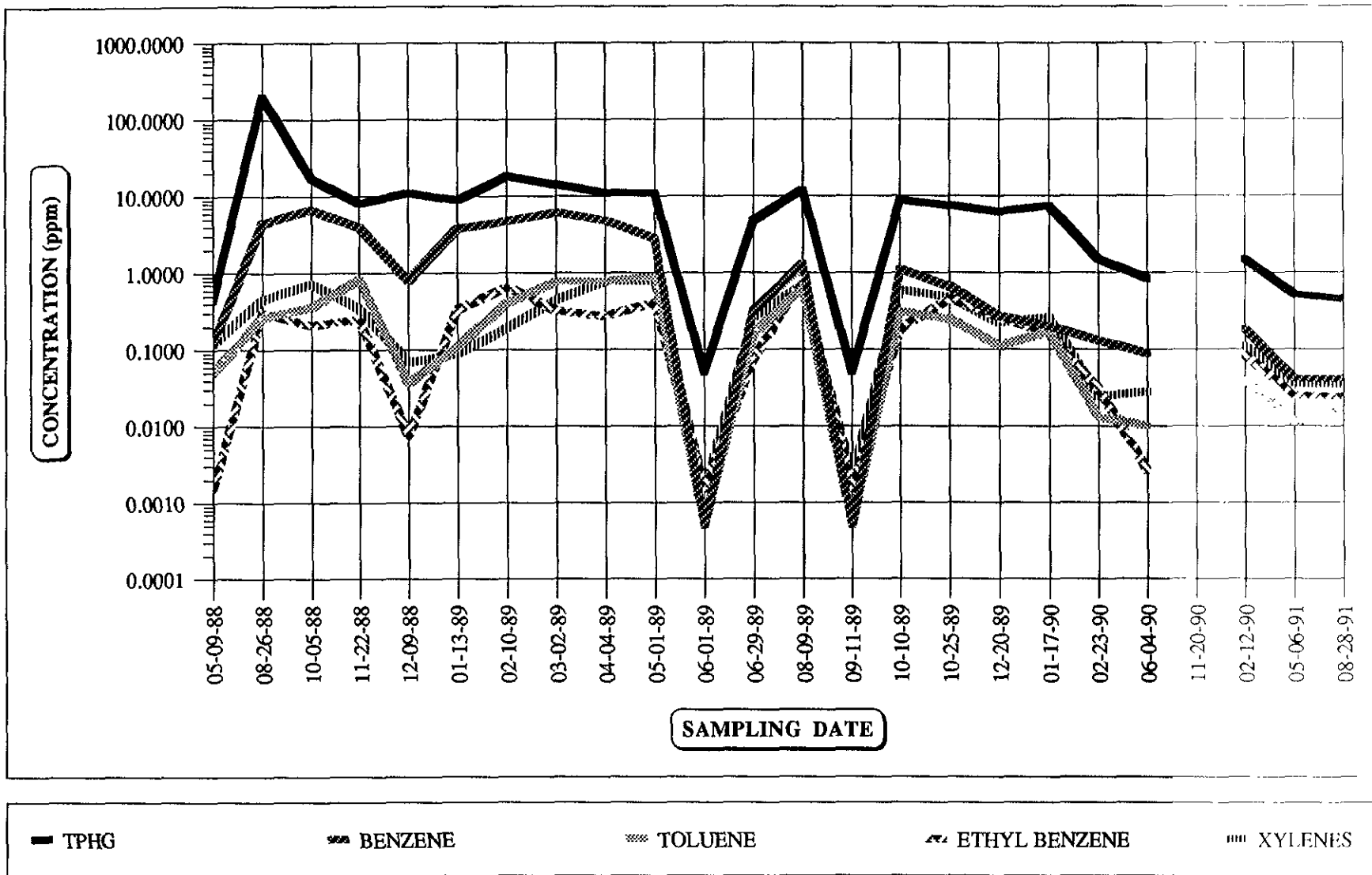

NOTE: For analytical results, refer to appended laboratory reports. Gaps on graph represent dates where no sample was collected.

# MW-2 GROUNDWATER ANALYSES DATA

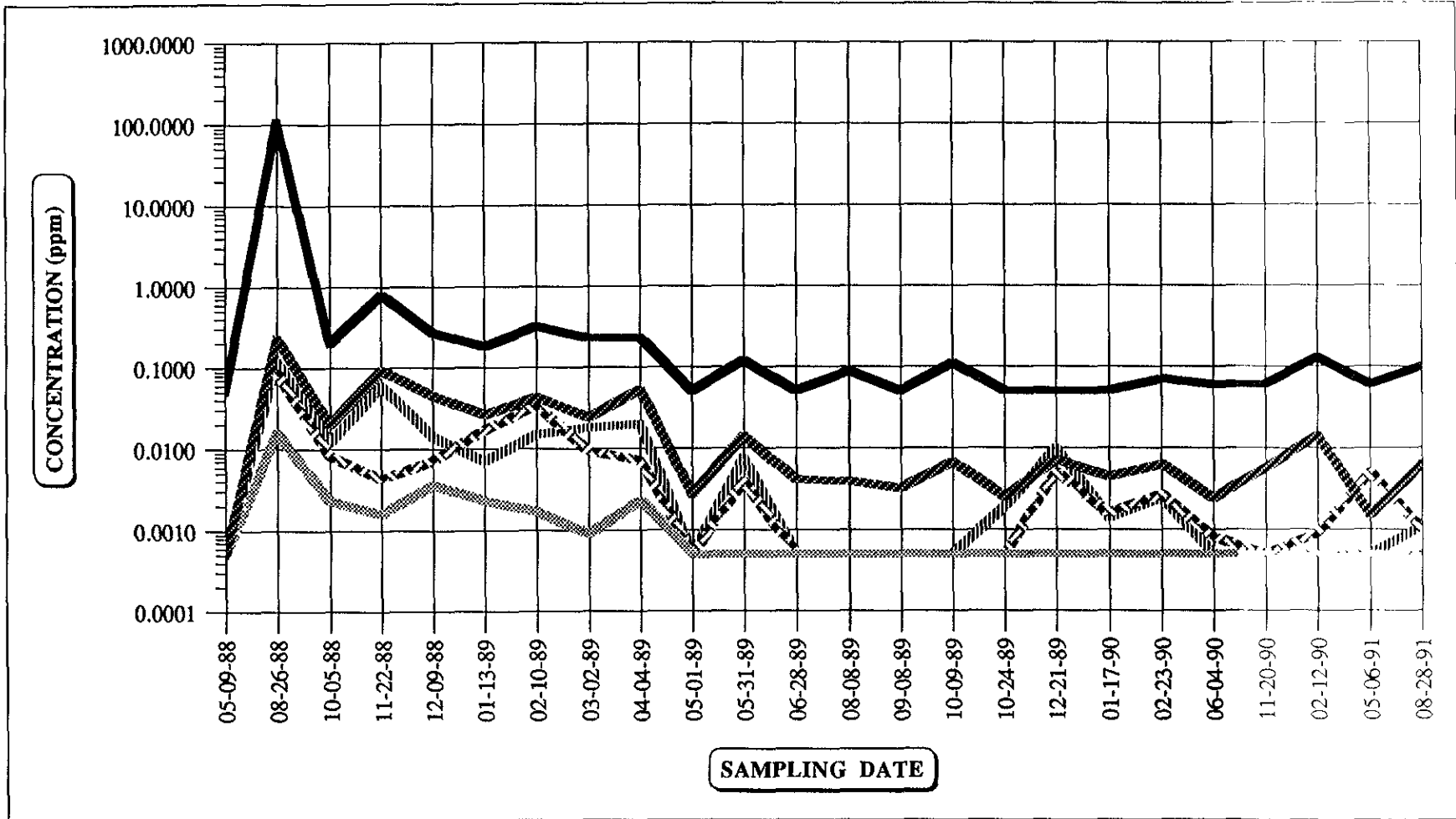

TPHG     
  BENZENE     
  TOLUENE     
  ETHYL BENZENE     
  XYLENES

NOTE: Minimum value plotted is laboratory detection limit. For analytical results, refer to appended laboratory reports.

# MW-3 GROUNDWATER ANALYSES DATA

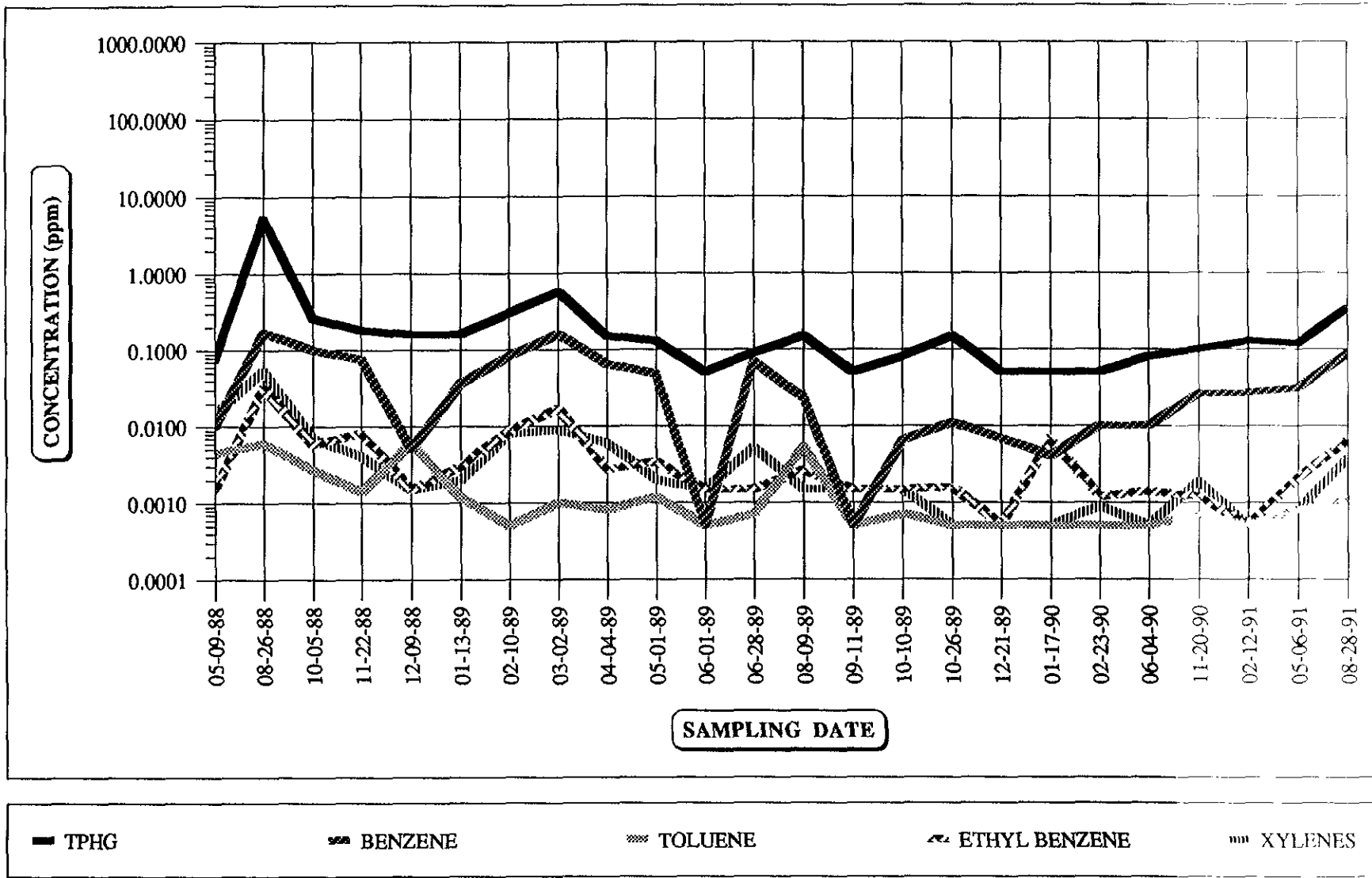

NOTE: Minimum value plotted is the laboratory detection limit. For analytical results, refer to appended laboratory reports.

# MW-4 GROUNDWATER ANALYSES DATA

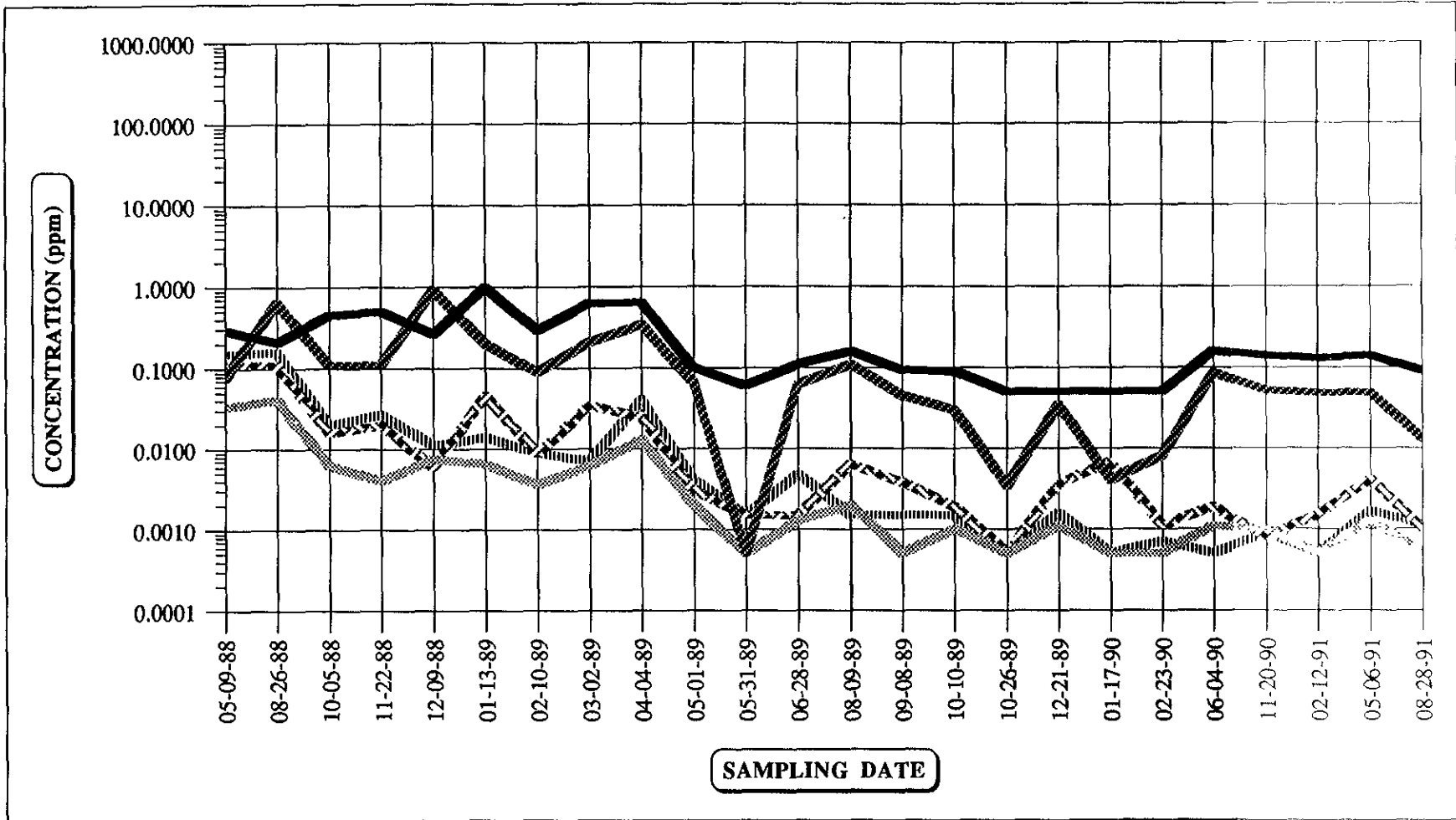

TPHG     
  BENZENE     
  TOLUENE     
  ETHYL BENZENE     
  XYLENES

NOTE: Minimum value plotted is the laboratory detection limit. For analytical results, refer to appended laboratory reports.

# MW-5 GROUNDWATER ANALYSES DATA

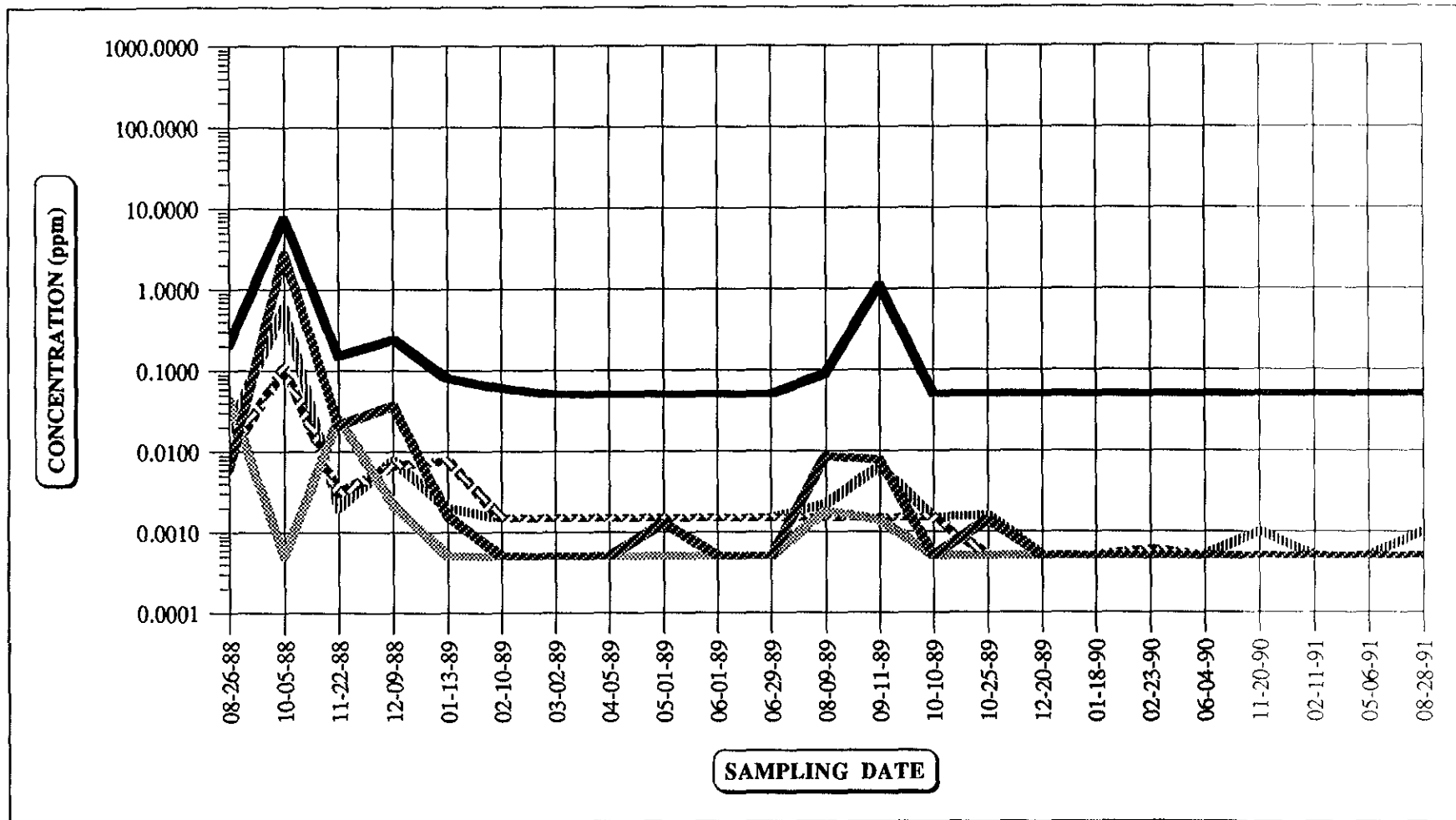

TPHG     
  BENZENE     
  TOLUENE     
  ETHYL BENZENE     
  XYLENES

NOTE: Minimum value plotted is the laboratory detection limit. For analytical results, refer to appended laboratory reports.

# MW-6 GROUNDWATER ANALYSES DATA

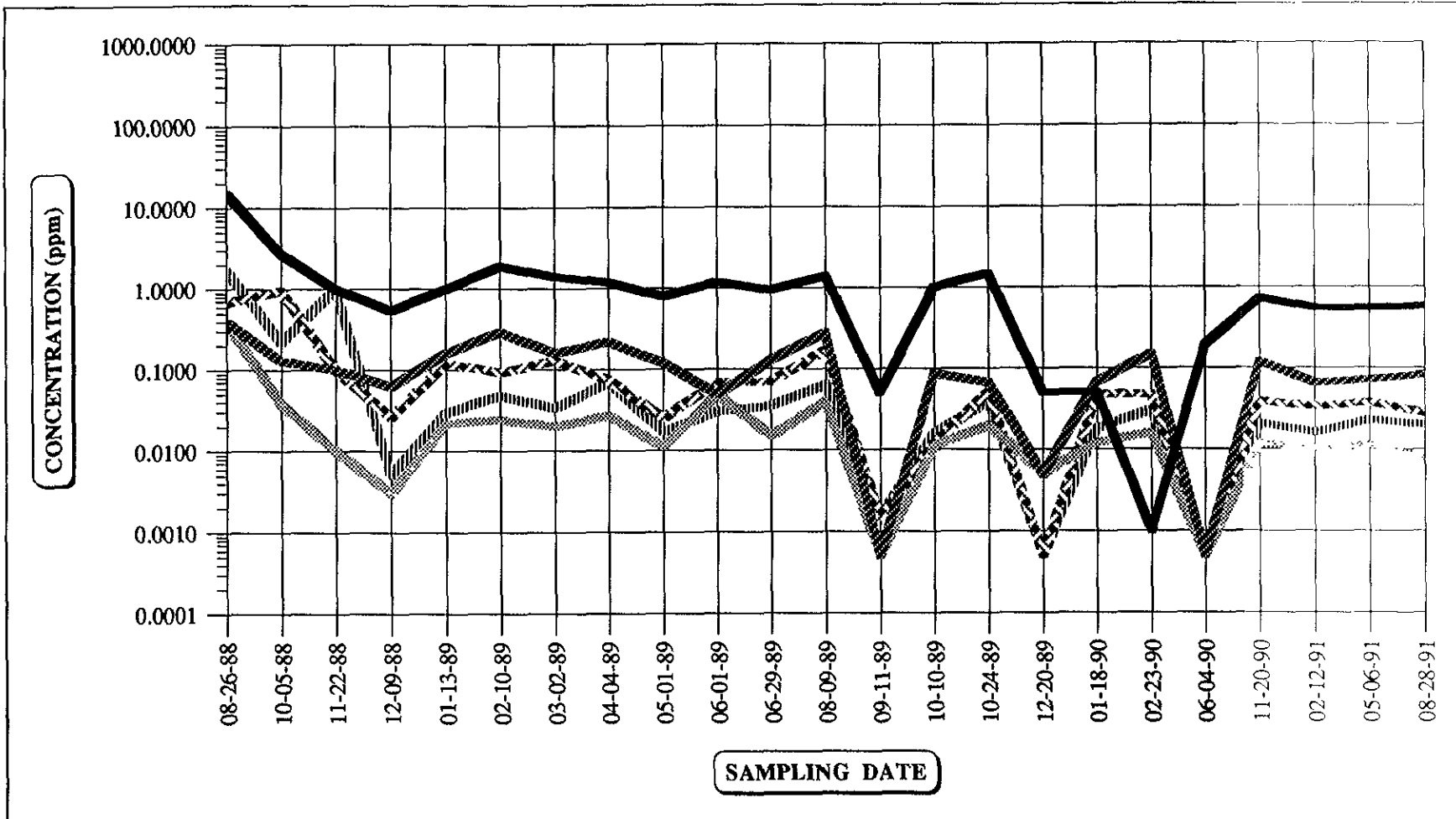

TPHG     
  BENZENE     
  TOLUENE     
  ETHYL BENZENE     
  XYLENES

NOTE: Minimum value plotted is the laboratory detection limit. For analytical results, refer to appended laboratory reports.

# MW-13 GROUNDWATER ANALYSES DATA

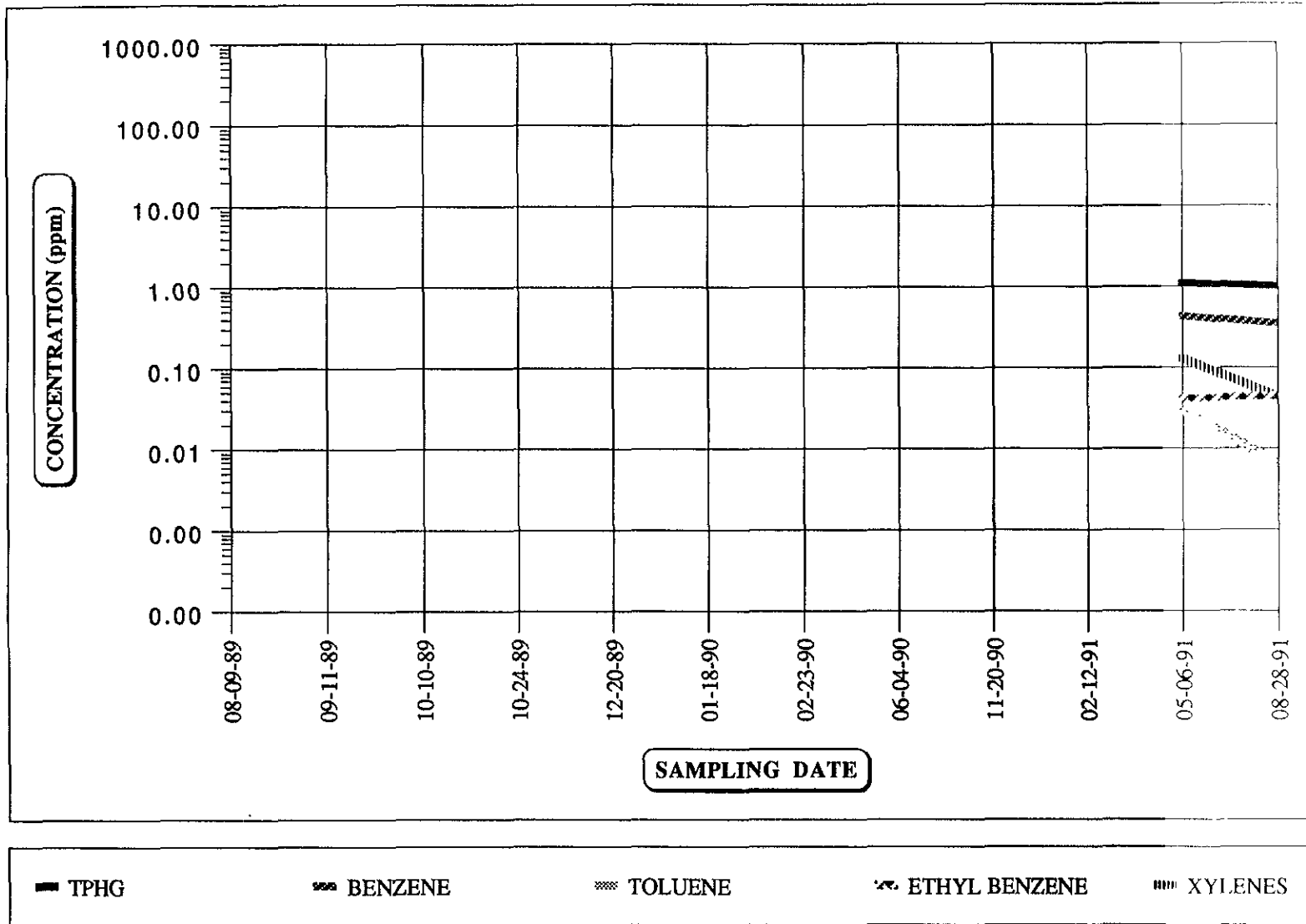

NOTE: Minimum value plotted is the laboratory detection limit. For analytical results, refer to appended laboratory reports.



---

**APPENDIX A**

**GROUNDWATER SAMPLING PROTOCOL,  
LABORATORY TEST RESULTS  
AND  
CHAIN-OF-CUSTODY REPORT**

---



NATIONAL  
ENVIRONMENTAL  
TESTING, INC.®

NET Pacific, Inc.  
435 Tesconi Circle  
Santa Rosa, CA 95401  
Tel: (707) 526-7200  
Fax: (707) 526-9623

Nissa Nack  
Exceltech  
41674 Christy St.  
Fremont, CA 94538

Date: 09-09-91  
NET Client Acct No: 18.06  
NET Pacific Log No: 9580  
Received: 08-31-91 0930

Client Reference Information

SHELL, 7194 Amador Valley Blvd., Dublin, Proj: 3-31000-F WATER

Sample analysis in support of the project referenced above has been completed and results are presented on following pages. Please refer to the enclosed "Key to Abbreviations" for definition of terms. Should you have questions regarding procedures or results, please feel welcome to contact Client Services.

Approved by:

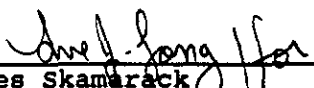
  
\_\_\_\_\_  
Jules Skamarack  
Laboratory Manager

JS:rct  
Enclosure(s)

**NET**

NET Pacific, Inc

Client No: 18.06  
Client Name: Exceltech  
NET Log No: 9580

Date: 09-09-91

Page: 2

Ref: SHELL, 7194 Amador Valley Blvd., Dublin, Proj: 3-31000-F WATER

## Descriptor, Lab No. and Results

| Parameter              | Method | Reporting<br>Limit | BB1              | MW-5             | Units |
|------------------------|--------|--------------------|------------------|------------------|-------|
|                        |        |                    | 08-28-91<br>1300 | 08-28-91<br>1345 |       |
|                        |        |                    | 96186            | 96187            |       |
| PETROLEUM HYDROCARBONS |        |                    | --               | --               |       |
| VOLATILE (WATER)       |        |                    | --               | --               |       |
| DILUTION FACTOR *      |        |                    | 1                | 1                |       |
| DATE ANALYZED          |        |                    | 09-04-91         | 09-04-91         |       |
| METHOD GC FID/5030     |        |                    | --               | --               |       |
| as Gasoline            |        | 0.05               | ND               | ND               | mg/L  |
| METHOD 602             |        |                    | --               | --               |       |
| DILUTION FACTOR *      |        |                    | 1                | 1                |       |
| DATE ANALYZED          |        |                    | 09-04-91         | 09-04-91         |       |
| Benzene                |        | 0.0005             | ND               | ND               | mg/L  |
| Ethylbenzene           |        | 0.0005             | ND               | ND               | mg/L  |
| Toluene                |        | 0.0005             | ND               | ND               | mg/L  |
| Xylenes, total         |        | 0.0005             | ND               | 0.001            | mg/L  |



NET Pacific, Inc

Client No: 18.06  
Client Name: Exceltech  
NET Log No: 9580

Date: 09-09-91

Page: 3

Ref: SHELL, 7194 Amador Valley Blvd., Dublin, Proj: 3-31000-F WATER

Descriptor, Lab No. and Results

| Parameter              | Method | Reporting<br>Limit | MW-7             | MW-8             | Units |
|------------------------|--------|--------------------|------------------|------------------|-------|
|                        |        |                    | 08-28-91<br>1445 | 08-28-91<br>1545 |       |
|                        |        |                    | 96188            | 96189            |       |
| PETROLEUM HYDROCARBONS |        |                    | --               | --               |       |
| VOLATILE (WATER)       |        |                    | --               | --               |       |
| DILUTION FACTOR *      |        |                    | 1                | 1                |       |
| DATE ANALYZED          |        |                    | 09-04-91         | 09-04-91         |       |
| METHOD GC FID/5030     |        |                    | --               | --               |       |
| as Gasoline            |        | 0.05               | ND               | ND               | mg/L  |
| METHOD 602             |        |                    | --               | --               |       |
| DILUTION FACTOR *      |        |                    | 1                | 1                |       |
| DATE ANALYZED          |        |                    | 09-04-91         | 09-04-91         |       |
| Benzene                |        | 0.0005             | ND               | ND               | mg/L  |
| Ethylbenzene           |        | 0.0005             | ND               | ND               | mg/L  |
| Toluene                |        | 0.0005             | ND               | ND               | mg/L  |
| Xylenes, total         |        | 0.0005             | ND               | ND               | mg/L  |



NET Pacific, Inc

Client No: 18.06  
Client Name: Exceltech  
NET Log No: 9580

Date: 09-09-91

Page: 4

Ref: SHELL, 7194 Amador Valley Blvd., Dublin, Proj: 3-31000-F WATER

Descriptor, Lab No. and Results

| Parameter              | Method | Reporting<br>Limit | MW-9             | MW-11            | Units |
|------------------------|--------|--------------------|------------------|------------------|-------|
|                        |        |                    | 08-28-91<br>1635 | 08-29-91<br>0800 |       |
|                        |        |                    | 96190            | 96191            |       |
| PETROLEUM HYDROCARBONS |        |                    | --               | --               |       |
| VOLATILE (WATER)       |        |                    | --               | --               |       |
| DILUTION FACTOR *      |        |                    | 1                | 1                |       |
| DATE ANALYZED          |        |                    | 09-04-91         | 09-04-91         |       |
| METHOD GC FID/5030     |        |                    | --               | --               |       |
| as Gasoline            |        | 0.05               | ND               | ND               | mg/L  |
| METHOD 602             |        |                    | --               | --               |       |
| DILUTION FACTOR *      |        |                    | 1                | 1                |       |
| DATE ANALYZED          |        |                    | 09-04-91         | 09-04-91         |       |
| Benzene                |        | 0.0005             | ND               | ND               | mg/L  |
| Ethylbenzene           |        | 0.0005             | ND               | ND               | mg/L  |
| Toluene                |        | 0.0005             | ND               | ND               | mg/L  |
| Xylenes, total         |        | 0.0005             | ND               | 0.001            | mg/L  |



NET Pacific, Inc

Client No: 18.06  
Client Name: Exceltech  
NET Log No: 9580

Date: 09-09-91

Page: 5

Ref: SHELL, 7194 Amador Valley Blvd., Dublin, Proj: 3-31000-F WATER

Descriptor, Lab No. and Results

| Parameter              | Method | Reporting<br>Limit | MW-12            | MW-2             | Units |
|------------------------|--------|--------------------|------------------|------------------|-------|
|                        |        |                    | 08-29-91<br>0900 | 08-29-91<br>1000 |       |
|                        |        |                    | 96192            | 96193            |       |
| PETROLEUM HYDROCARBONS |        |                    | --               | --               |       |
| VOLATILE (WATER)       |        |                    | --               | --               |       |
| DILUTION FACTOR *      |        |                    | 1                | 1                |       |
| DATE ANALYZED          |        |                    | 09-04-91         | 09-04-91         |       |
| METHOD GC FID/5030     |        |                    | --               | --               |       |
| as Gasoline            |        | 0.05               | ND               | 0.10             | mg/L  |
| METHOD 602             |        |                    | --               | --               |       |
| DILUTION FACTOR *      |        |                    | 1                | 1                |       |
| DATE ANALYZED          |        |                    | 09-04-91         | 09-04-91         |       |
| Benzene                |        | 0.0005             | ND               | 0.0063           | mg/L  |
| Ethylbenzene           |        | 0.0005             | ND               | 0.001            | mg/L  |
| Toluene                |        | 0.0005             | ND               | ND               | mg/L  |
| Xylenes, total         |        | 0.0005             | 0.001            | 0.0011           | mg/L  |



NET Pacific, Inc

Client No: 18.06  
\*Client Name: Exceltech  
NET Log No: 9580

Date: 09-09-91

Page: 6

Ref: SHELL, 7194 Amador Valley Blvd., Dublin, Proj: 3-31000-F WATER

Descriptor, Lab No. and Results

| Parameter              | Method | Reporting Limit | MW-3             | MW-4             | Units |
|------------------------|--------|-----------------|------------------|------------------|-------|
|                        |        |                 | 08-29-91<br>1100 | 08-29-91<br>1200 |       |
|                        |        |                 | 96194            | 96195            |       |
| PETROLEUM HYDROCARBONS |        |                 | --               | --               |       |
| VOLATILE (WATER)       |        |                 | --               | --               |       |
| DILUTION FACTOR *      |        |                 | 1                | 1                |       |
| DATE ANALYZED          |        |                 | 09-05-91         | 09-04-91         |       |
| METHOD GC FID/5030     |        |                 | --               | --               |       |
| as Gasoline            |        | 0.05            | 0.34             | 0.09             | mg/L  |
| METHOD 602             |        |                 | --               | --               |       |
| DILUTION FACTOR *      |        |                 | 1                | 1                |       |
| DATE ANALYZED          |        |                 | 09-05-91         | 09-04-91         |       |
| Benzene                |        | 0.0005          | 0.087            | 0.013            | mg/L  |
| Ethylbenzene           |        | 0.0005          | 0.0065           | 0.001            | mg/L  |
| Toluene                |        | 0.0005          | 0.0011           | ND               | mg/L  |
| Xylenes, total         |        | 0.0005          | 0.0038           | 0.0011           | mg/L  |



NET Pacific, Inc

Client No: 18.06  
Client Name: Exceltech  
NET Log No: 9580

Date: 09-09-91

Page: 7

Ref: SHELL, 7194 Amador Valley Blvd., Dublin, Proj: 3-31000-F WATER

Descriptor, Lab No. and Results

| Parameter              | Method | Reporting<br>Limit | MW-1             | MW-6             | Units |
|------------------------|--------|--------------------|------------------|------------------|-------|
|                        |        |                    | 08-29-91<br>1300 | 08-29-91<br>1400 |       |
|                        |        |                    | 96196            | 96197            |       |
| PETROLEUM HYDROCARBONS |        |                    | --               | --               |       |
| VOLATILE (WATER)       |        |                    | --               | --               |       |
| DILUTION FACTOR *      |        |                    | 1                | 1                |       |
| DATE ANALYZED          |        |                    | 09-04-91         | 09-04-91         |       |
| METHOD GC FID/5030     |        |                    | --               | --               |       |
| as Gasoline            |        | 0.05               | 0.45             | 0.58             | mg/L  |
| METHOD 602             |        |                    | --               | --               |       |
| DILUTION FACTOR *      |        |                    | 1                | 1                |       |
| DATE ANALYZED          |        |                    | 09-04-91         | 09-04-91         |       |
| Benzene                |        | 0.0005             | 0.041            | 0.082            | mg/L  |
| Ethylbenzene           |        | 0.0005             | 0.024            | 0.028            | mg/L  |
| Toluene                |        | 0.0005             | 0.016            | 0.0076           | mg/L  |
| Xylenes, total         |        | 0.0005             | 0.034            | 0.020            | mg/L  |





NET Pacific, Inc

Client No: 18.06  
Client Name: Exceltech  
NET Log No: 9580

Date: 09-09-91

Page: 8

Ref: SHELL, 7194 Amador Valley Blvd., Dublin, Proj: 3-31000-F WATER

Descriptor, Lab No. and Results

| Parameter              | Method | Reporting Limit | MW-13<br>08-29-91<br>1500<br>96198 | Units |
|------------------------|--------|-----------------|------------------------------------|-------|
| PETROLEUM HYDROCARBONS |        |                 | --                                 |       |
| VOLATILE (WATER)       |        |                 | --                                 |       |
| DILUTION FACTOR *      |        |                 | 1                                  |       |
| DATE ANALYZED          |        |                 | 09-04-91                           |       |
| METHOD GC FID/5030     |        |                 | --                                 |       |
| as Gasoline            |        | 0.05            | 1.0                                | mg/L  |
| METHOD 602             |        |                 | --                                 |       |
| DILUTION FACTOR *      |        |                 | 1                                  |       |
| DATE ANALYZED          |        |                 | 09-04-91                           |       |
| Benzene                |        | 0.0005          | 0.35                               | mg/L  |
| Ethylbenzene           |        | 0.0005          | 0.044                              | mg/L  |
| Toluene                |        | 0.0005          | 0.0064                             | mg/L  |
| Xylenes, total         |        | 0.0005          | 0.043                              | mg/L  |



Client Acct: 18.06  
 Client Name: Exceltech  
 NET Log No: 9580

Date: 09-09-91  
 Page: 9

NET Pacific, Inc

Ref: SHELL, 7194 Amador Valley Blvd., Dublin, Proj: 3-31000-F WATER

QUALITY CONTROL DATA

| Parameter | Reporting Limits | Units | Cal Verf Stand % Recovery | Blank Data | Spike % Recovery | Duplicate Spike % Recovery | RPD |
|-----------|------------------|-------|---------------------------|------------|------------------|----------------------------|-----|
| Gasoline  | 0.05             | mg/L  | 113                       | ND         | 104              | 105                        | 2.0 |
| Benzene   | 0.0005           | mg/L  | 87                        | ND         | 107              | 106                        | 1.0 |
| Toluene   | 0.0005           | mg/L  | 84                        | ND         | 100              | 100                        | < 1 |
| Gasoline  | 0.05             | mg/L  | 107                       | ND         | 105              | 100                        | 4.0 |
| Benzene   | 0.0005           | mg/L  | 91                        | ND         | 98               | 98                         | < 1 |
| Toluene   | 0.0005           | mg/L  | 91                        | ND         | 98               | 99                         | < 1 |

COMMENT: Blank Results were ND on other analytes tested.



NET Pacific, Inc

## KEY TO ABBREVIATIONS and METHOD REFERENCES

- < : Less than; When appearing in results column indicates analyte not detected at the value following. This datum supercedes the listed Reporting Limit.
- \* : Reporting Limits are a function of the dilution factor for any given sample. To obtain the actual reporting limits for this sample, multiply the stated Reporting Limits by the dilution factor (but do not multiply reported values).
- ICVS : Initial Calibration Verification Standard (External Standard).
- mean : Average; sum of measurements divided by number of measurements.
- mg/Kg (ppm) : Concentration in units of milligrams of analyte per kilogram of sample (parts per million).
- mg/L : Concentration in units of milligrams of analyte per liter of sample.
- mL/L/hr : Milliliters per liter per hour.
- MPN/100 mL : Most probable number of bacteria per one hundred milliliters of sample.
- N/A : Not applicable.
- NA : Not analyzed.
- ND : Not detected; the analyte concentration is less than applicable listed reporting limit.
- NTU : Nephelometric turbidity units.
- RPD : Relative percent difference,  $100 \text{ [Value 1 - Value 2]}/\text{mean value}$ .
- SNA : Standard not available.
- ug/Kg (ppb) : Concentration in units of micrograms of analyte per kilogram of sample (parts per billion).
- ug/L : Concentration in units of micrograms of analyte per liter of sample.
- umhos/cm : Micromhos per centimeter.

### Method References

Methods 100 through 493: see "Methods for Chemical Analysis of Water & Wastes", U.S. EPA, 600/4-79-020, rev. 1983.

Methods 601 through 625: see "Guidelines Establishing Test Procedures for the Analysis of Pollutants" U.S. EPA, 40 CFR, Part 136, rev. 1988.

Methods 1000 through 9999: see "Test Methods for Evaluating Solid Waste", U.S. EPA SW-846, 3rd edition, 1986.

SM: see "Standard Methods for the Examination of Water & Wastewater, 17th Edition, APHA, 1989.



**SHELL ENVIRONMENTAL - INVOICE "COVER" SHEET**

ATTN: (SHELL PROJ. ENGR.) Jack Bradstad

|   |                           |                        |
|---|---------------------------|------------------------|
| <b>VENDOR NAME:</b> <u>NET Pacific</u>                    |                           |                        |
| <b>INV. DATE:</b>   | <b>INV. NO:</b>           | <b>BKT PO NO:</b> MOH- |
| <b>SHELL LOC. ADDRESS:</b> <u>7194 Amador Valley Blvd</u> |                           |                        |
| <b>CITY:</b> <u>Dublin</u>                                | <b>STATE:</b> <u>CA</u>   | <b>ZIP:</b>            |
| <b>WIC:</b> <u>204-2277-0105</u>                          | <b>SPECIAL PAY TERMS:</b> |                        |

| GENERAL DESCRIPTION OF WORK                   | CIRCLE CLASS TYPE |  | \$ AMOUNT |
|---|-------------------|--|-----------|
| ENVIRONMENTAL COMPLIANCE                      | 5460              |  | \$        |
| SITE INVESTIGATION/ASSESSMENT                 | 5441              |  | \$        |
| CONTAMINATED SOIL DISPOSAL                    | 5442              |  | \$        |
| CONTAMINATED WATER DISPOSAL                   | 5443              |  | \$        |
| CONTAMINATED SOIL REMEDIATION                 | 5452              |  | \$        |
| CONTAMINATED WATER REMEDIATION                | 5453              |  | \$        |
| SITE MONITORING ONLY                          | 5461              |  | \$        |
| CAR WASH SLUDGE DISPOSAL                      | 5411              |  | \$        |
| TANK WATER BOTTOMS                            | 5406              |  | \$        |
| OTHER:  |                   |  | \$        |
| OTHER, (SAD):                                 |                   |  |           |
| CAPITAL ADC:205620 AFE NO: <u>986239</u> QTY: |                   |  | \$        |
| <b>TOTAL PAY THIS AMOUNT:</b>                 |                   |  | \$        |

|                        |
|------------------------|
| <b>VENDOR APPROVAL</b> |
| <b>PRINT NAME:</b>     |
| <b>SIGNATURE:</b>      |
| <b>DATE:</b>           |

|                       |
|-----------------------|
| <b>SHELL APPROVAL</b> |
| <b>SIGNATURE:</b>     |
| <b>DATE:</b>          |

NOTE: Vendor to staple this cover sheet on top of his invoice. (Rev 1)