



Shaw™ Shaw Environmental, Inc.

4005 Port Chicago Hwy
Concord, California 94520

Mr. Jerry Wickham
Alameda County Health Agency
1131 Harbor Bay Parkway
Alameda, California 94502

Re: **Report Transmittal
Quarterly Report
Second Quarter – 2005
76 Service Station #6034
4700 First Street
Livermore, CA**

Dear Mr. Wickham:

I declare under penalty of perjury that to the best of my knowledge the information and/or recommendations contained in the attached report is/are true and correct.

If you have any questions or need additional information, please call me at (916) 558-7609.

Sincerely,

Shelby Suzanne Lathrop
Project Manager
Shaw Environmental, Inc.
Approved service provider of ConocoPhillips -Risk Management & Remediation
Cell: 707-592-1146

Client Contact Information:
ConocoPhillips
76 Broadway
Sacramento, California 95818
Client office: 916-558-7609
Client fax: 916-558-7639

Attachment
cc: Liz Sewell, ConocoPhillips



6602 Owens Dr. Suite 100
Pleasanton, California 94588
www.atc-enviro.com
925.460.5300
Fax 925.463.2559

July 29, 2005

Mr. Jerry Wickham
Alameda County Health Care Services Agency
1131 Harbor Bay Parkway
Alameda, CA 94502-6577

Re: Quarterly Summary Report – Second Quarter 2005
76 Service Station No. 6034 / WNO 1525
4700 First Street
Livermore, California

Dear Mr. Wickham:

On behalf of ConocoPhillips Company (ConocoPhillips), ATC Associates Inc. (ATC) is forwarding the quarterly summary report for the above referenced facility.

Sincerely,
ATC ASSOCIATES INC.

A handwritten signature in black ink, appearing to read 'David A. Evans'.

for David Evans

David A. Evans
Senior Project Manager

A handwritten signature in black ink, appearing to read 'Janine Weber-Band'.

Janine Weber-Band, PhD, CEG #2286
Senior Geologist

Attachment: Site Plan
TRC Semi-annual monitoring report (July 14, 2005)

Cc: Ms. Shelby Lathrop, ConocoPhillips (electronic copy only)

QUARTERLY SUMMARY REPORT Second Quarter 2005

76 Service Station No. 6034 / WNO 1525
4700 First Street
Livermore, California

City/County ID#: Livermore
County: Alameda

SITE BACKGROUND AND ACTIVITY

August 1989: Two underground storage tanks (USTs), one waste oil UST, and the product piping were removed. Petroleum hydrocarbon levels in soil samples collected beneath the fuel USTs were non-detect to moderate. The fuel UST pit was subsequently over excavated to a depth of 17.5 feet below ground surface (bgs), where groundwater was encountered, in order to remove hydrocarbon impacted soil. Petroleum hydrocarbon levels in soil samples collected beneath the waste oil UST were non-detect.

In October 1989, four monitoring wells (MW-1 through MW-4) were installed to depths ranging from 26 to 29 feet bgs. Groundwater was encountered at depths ranging from 14.5 to 17.5 feet bgs.

In April 1991, three additional monitor wells (MW-5 through MW-7) were installed to an average depth of 25 feet bgs. Groundwater was initially encountered at depth of approximately 16 feet bgs.

In August 1995, an oxygen-releasing compound (magnesium peroxide) was placed in well MW-2 to enhance biodegradation of petroleum hydrocarbons. Also, a non-attainment zone status was sought from the regulatory agencies.

On October 30, 2003, five soil borings (SB-1 through SB-5) were completed to a depth of 20 feet bgs. Adsorbed-phase MtBE was detected in two of the four samples analyzed in concentrations ranging from 0.042 to 0.064 mg/kg, which exceed the applicable Tier 1 Environmental Screening Level (ESL) of the San Francisco Bay Regional Water Quality Control Board of 0.023 mg/kg. MtBE in groundwater collected from SB-3 was detected at 13 µg/l which exceeded the applicable ESL of 5 µg/l.

Groundwater samples collected from MW-2 over the past several quarters have MtBE concentrations ranging from 5.9 – 6.6 µg/l.

SENSITIVE RECEPTORS

The site is located adjacent to and northwest of Arroyo Seco (intermittent drainage stream). Additional receptors will be evaluated during the third quarter of 2005.

GROUNDWATER MONITORING AND SAMPLING

Groundwater beneath the site is currently monitored and sampled on a semi-annual basis during the second and fourth quarters of each year. During the second quarter sampling event maximum hydrocarbon concentrations were as follows: MtBE (2.5 µg/l, MW-2), TPPH (3,300 µg/l, MW-2) Ethylbenzene (47 µg/l, MW-2), Xylene (200 µg/l, MW-2). The gradient and groundwater flow direction was to the northwest at 0.02 ft/ft. The depth to groundwater varied from a minimum of 13.68 feet (MW-4) to a maximum of 15.49 feet (MW-1). Overall, the dissolved hydrocarbon trend is decreasing for MW-2 and MW-4.

REMEDIATION STATUS

Remediation is not currently being conducted at the site.

CHARACTERIZATION STATUS

Based on the most current groundwater and soil analytical data, the dissolved gasoline plume appears to be delineated. However, dissolved MtBE in MW-2 was most recently reported at 2.5 µg/l. Groundwater in the site area is designated as a possible drinking water source.

RECENT CORRESPONDENCE

No correspondence this quarter.

THIS QUARTER ACTIVITIES (Second Quarter 2005)

1. TRC performed monitoring and sampling of groundwater on June 13, 2005.
2. ATC sent a Work Plan to the Alameda County Environmental Health Agency titled *Work Plan – Sensitive Receptor Survey*, dated June 13, 2005, proposing a sensitive receptor survey be performed. A reply from the agency dated July 18, 2005, specified in addition to other items submittal of the Sensitive Receptor Survey Report by October 17, 2005.

WASTE DISPOSAL SUMMARY

No waste was generated this quarter.

NEXT QUARTER ACTIVITIES (Third Quarter 2005)

1. ATC will submit the Sensitive Receptor Report by October 17, 2005. In addition, ATC will review the historic analytical data and compare to the Region 5 – Central Valley – Water Board's closure standards. If appropriate, a Site Closure report will be prepared. Closure applicability and outstanding action items needed with regards to site path forward will be discussed with the lead regulatory agency.
2. The monitor well network will not be monitored and sampled by TRC this next quarter.

CONSULTANT: ATC Associates Inc.

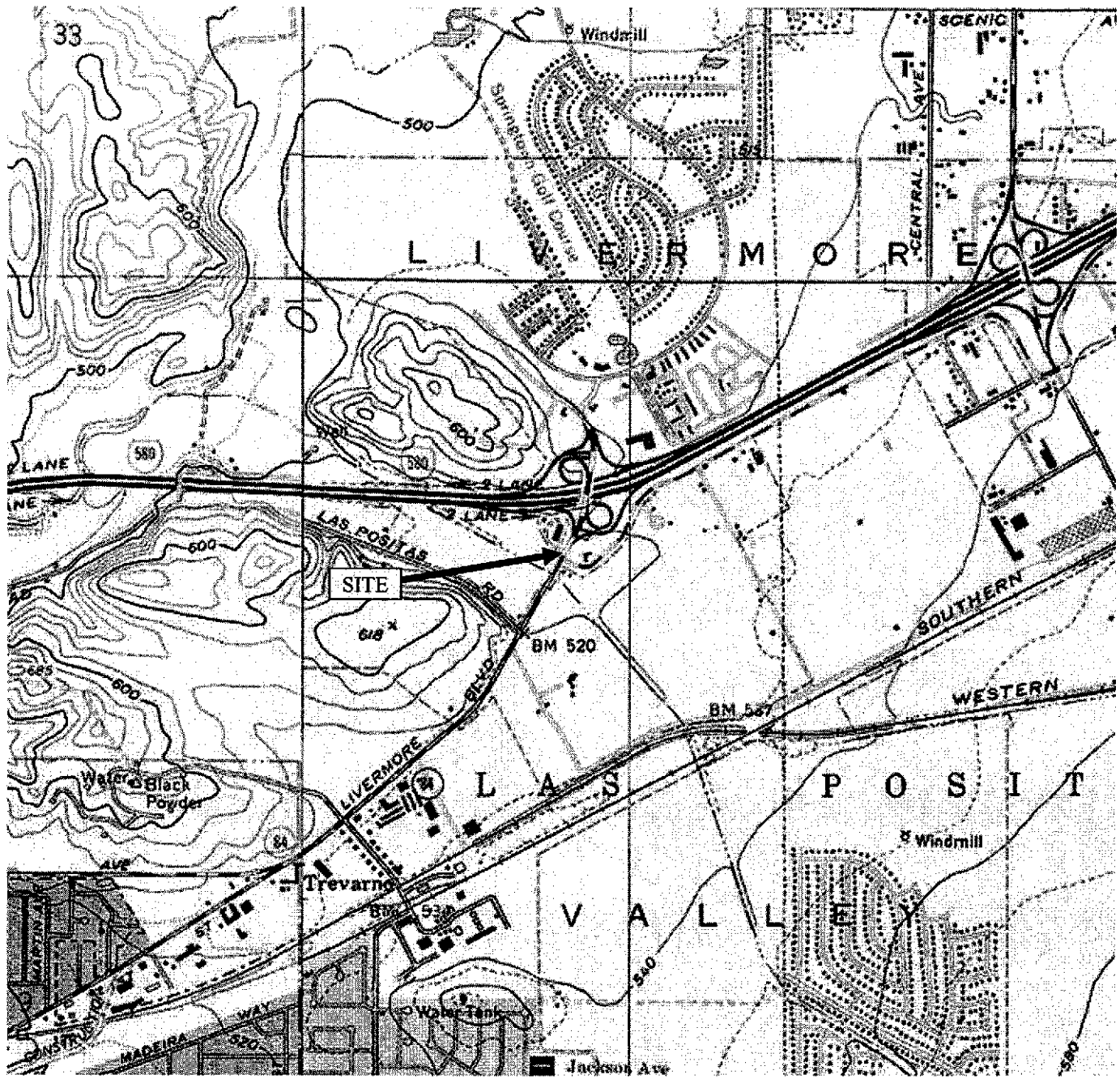

SOURCE: USGS ALTAMONT QUADRANGLE, CALIFORNIA (7.5 MINUTE SERIES) TOPOGRAPHIC MAP. OBTAINED FROM THE 2000 NATIONAL GEOGRAPHIC TOPO! SOFTWARE.



6602 Owens Drive, Suite 100
 Pleasanton, CA 94588
 (925) 460-5300

PROJECT NO: 75.75118.1525

DESIGNED BY: DE

SCALE: N/A

REVIEWED BY: DE

DRAWN BY: EC

DATE: 04/05

FILE: 6034 SITE VIC

FIGURE 1

SITE VICINITY MAP

76 STATION 6034
 4700 FIRST STREET
 LIVERMORE, CALIFORNIA

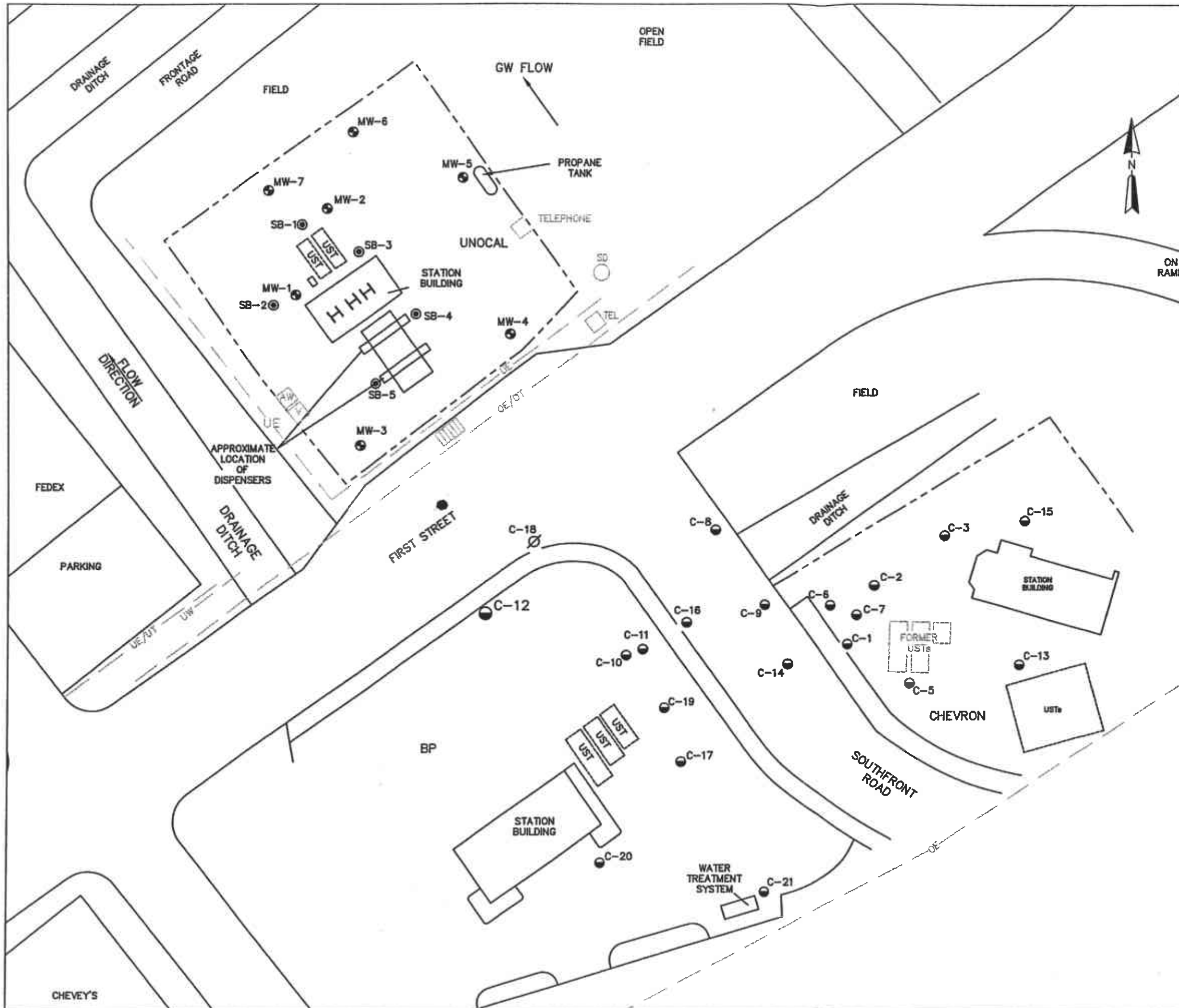

LEGEND

- PROPERTY BOUNDARY
- MW-7 ● GROUNDWATER MONITORING WELL (TOSCO)
- C-21 ● GROUNDWATER MONITORING WELL (CHEVRON)
- C-18 ∅ ABANDONED WELL
- SB-5 ● SOIL BORING
- OE/OT — OVERHEAD ELECTRIC/TELEPHONE
- UE/UT — UNDERGROUND ELECTRIC/TELEPHONE
- SD STORM DRAIN
- UW UNDERGROUND WATER
- AW AIR/WATER
- V VACUUM
- ▨ CATCHBASIN

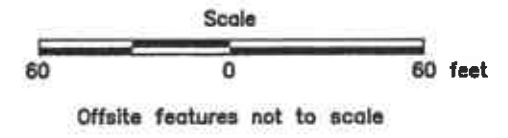

BASE MAP REFERENCE:
MODIFIED FROM SITE PLAN SUPPLIED BY
GETTLER-RYAN, NOVEMBER 2000.



6602 Owens Drive, Suite 100
Pleasanton, CA 94588
(925) 460-5300

SCALE AS SHOWN	DRAWING DATE 06/21/05	ACAD FILE 6034-alta map
-------------------	--------------------------	----------------------------

SITE MAP

CLIENT	CONOCOPHILLIPS	PM	DAE
LOCATION	76 STATION 6034 4700 FIRST STREET LIVERMORE, CALIFORNIA	PE	DA
DESIGNED	DRAWN BY: EC	PROJECT NO. 75.75118.1525	FIGURE 2

Table 1

HISTORIC FLUID LEVELS AND SELECTED ANALYTICAL RESULTS

76 Station 6034
4700 First Street, Livermore

Well No.	Monitoring Date	Depth to Water (feet)	LPH Thickness (feet)	Ground-water Elevation (feet)	Surface Elevation (feet)	Depth of Well (feet)		Benzene (µg/l)	Toluene (µg/l)	Ethyl-benzene (µg/l)	Total Xylenes (µg/l)	TPH-G (µg/l)	MTBE 8021B (µg/l)	MTBE 8260B (µg/l)	TPPH 8260B (µg/l)
MW-1	11/18/89	--	--	--	--	28.50	11.00	ND	ND	ND	ND	ND	--	--	--
	03/08/90	--	--	--	--	28.50	11.00	ND	ND	ND	ND	ND	--	--	--
	06/05/90	--	--	--	--	28.50	11.00	ND	ND	ND	ND	ND	--	--	--
	09/07/90	--	--	--	--	28.50	11.00	ND	1.20	ND	ND	ND	--	--	--
	12/24/90	--	--	--	--	28.50	11.00	ND	ND	ND	0.40	ND	--	--	--
	04/10/91	--	--	--	--	28.50	11.00	ND	ND	ND	ND	ND	--	--	--
	07/10/91	--	--	--	--	28.50	11.00	ND	ND	ND	ND	ND	--	--	--
	04/22/93	15.47	0.00	505.41	520.88	28.50	11.00	--	--	--	--	--	--	--	--
	07/20/93	18.04	0.00	502.84	520.88	28.50	11.00	--	--	--	--	--	--	--	--
	10/20/93	15.69	0.00	504.95	520.64	28.50	11.00	--	--	--	--	--	--	--	--
	01/20/94	15.65	0.00	504.99	520.64	28.50	11.00	--	--	--	--	--	--	--	--
	04/21/94	15.58	0.00	505.06	520.64	28.50	11.00	ND	ND	ND	ND	ND	--	--	--
	07/21/94	15.62	0.00	505.02	520.64	28.50	11.00	--	--	--	--	--	--	--	--
	10/19/94	15.28	0.00	505.36	520.64	28.50	11.00	--	--	--	--	--	--	--	--
	01/18/95	14.56	0.00	506.08	520.64	28.50	11.00	--	--	--	--	--	--	--	--
	04/17/95	14.82	0.00	505.82	520.64	28.50	11.00	ND	ND	ND	ND	ND	--	--	--
	07/18/95	14.78	0.00	505.86	520.64	28.50	11.00	--	--	--	--	--	--	--	--
	10/17/95	14.83	0.00	505.81	520.64	28.50	11.00	--	--	--	--	--	--	--	--
	01/17/96	14.96	0.00	505.68	520.64	28.50	11.00	--	--	--	--	--	--	--	--
	04/17/96	14.47	0.00	506.17	520.64	28.50	11.00	ND	ND	ND	ND	ND	ND	--	--
	07/16/96	14.57	0.00	506.07	520.64	28.50	11.00	--	--	--	--	--	--	--	--
	10/16/96	14.50	0.00	506.14	520.64	28.50	11.00	--	--	--	--	--	--	--	--
	04/08/97	15.05	0.00	505.59	520.64	28.50	11.00	--	--	--	--	--	--	--	--
	10/06/97	15.00	0.00	505.64	520.64	28.50	11.00	--	--	--	--	--	--	--	--
	04/02/98	14.80	0.00	505.84	520.64	28.50	11.00	--	--	--	--	--	--	--	--
	10/07/98	14.72	0.00	505.92	520.64	28.50	11.00	--	--	--	--	--	--	--	--
	04/14/99	14.89	0.00	505.75	520.64	28.50	11.00	--	--	--	--	--	--	--	--
	10/12/99	14.79	0.00	505.85	520.64	28.50	11.00	--	--	--	--	--	--	--	--
	04/10/00	14.93	0.00	505.71	520.64	28.50	11.00	--	--	--	--	--	--	--	--
	10/02/00	15.18	0.00	505.46	520.64	28.50	11.00	--	--	--	--	--	--	--	--
	04/02/01	14.72	0.00	505.92	520.64	28.50	11.00	--	--	--	--	--	--	--	--
	10/05/01	15.51	0.00	505.13	520.64	28.50	11.00	--	--	--	--	--	--	--	--
	04/01/02	15.40	0.00	505.24	520.64	28.50	11.00	--	--	--	--	--	--	--	--

Table 1

HISTORIC FLUID LEVELS AND SELECTED ANALYTICAL RESULTS

76 Station 6034

4700 First Street, Livermore

Well No.	Monitoring Date	Depth to Water (feet)	LPH Thickness (feet)	Ground-water Elevation (feet)	Surface Elevation (feet)	Depth of Well (feet)		Benzene (µg/l)	Toluene (µg/l)	Ethyl-benzene (µg/l)	Total Xylenes (µg/l)	TPH-G (µg/l)	MTBE 8021B (µg/l)	MTBE 8260B (µg/l)	TPPH 8260B (µg/l)
	10/16/02	15.54	0.00	505.10	520.64	28.50	11.00	--	--	--	--	--	--	--	--
	04/03/03	15.41	0.00	505.23	520.64	28.50	11.00	--	--	--	--	--	--	--	--
	10/02/03	15.58	0.00	505.06	520.64	28.50	11.00	--	--	--	--	--	--	--	--
	04/30/04	15.65	0.00	504.99	520.64	28.50	11.00	--	--	--	--	--	--	--	--
	12/01/04	15.81	0.00	504.83	520.64	28.50	11.00	--	--	--	--	--	--	--	--
MW-2	11/18/89	--	--	--	--	25.00	11.00	540	500.00	130.00	22000.00	53000.00	--	--	--
	03/08/90	--	--	--	--	25.00	11.00	230	410.00	1300.00	2100.00	26000.00	--	--	--
	06/05/90	--	--	--	--	25.00	11.00	250	460.00	950.00	9200.00	31000.00	--	--	--
	09/07/90	--	--	--	--	25.00	11.00	ND	1.50	ND	ND	ND	--	--	--
	12/24/90	--	--	--	--	25.00	11.00	440	340.00	460.00	13000.00	32000.00	--	--	--
	04/10/91	--	--	--	--	25.00	11.00	170	190.00	490.00	6200.00	22000.00	--	--	--
	07/10/91	--	--	--	--	25.00	11.00	70	160.00	570.00	5400.00	14000.00	--	--	--
	10/14/91	--	--	--	--	25.00	11.00	79	130.00	660.00	4700.00	11000.00	--	--	--
	01/14/92	--	--	--	--	25.00	11.00	36	120.00	450.00	2600.00	5600.00	--	--	--
	04/06/92	--	--	--	--	25.00	11.00	6.3	2.10	ND	130.00	760.00	--	--	--
	07/07/92	--	--	--	--	25.00	11.00	160	1100.00	1000.00	17000.00	44000.00	--	--	--
	10/16/92	--	--	--	--	25.00	11.00	2.3	ND	5.10	15.00	290.00	--	--	--
	01/14/93	--	--	--	--	25.00	11.00	75	430.00	900.00	8400.00	19000.00	--	--	--
	04/22/93	14.98	0.00	505.19	520.17	25.00	11.00	150	1000.00	3000.00	18000.00	49000.00	--	--	--
	07/20/93	17.41	0.00	502.76	520.17	25.00	11.00	68	94.00	1000.00	6200.00	25000.00	--	--	--
	10/20/93	15.08	0.00	504.74	519.82	25.00	11.00	27	10.00	100.00	3000.00	12000.00	--	--	--
	01/20/94	15.02	0.00	504.80	519.82	25.00	11.00	ND	ND	270.00	3300.00	20000.00	--	--	--
	04/21/94	14.96	0.00	504.86	519.82	25.00	11.00	85	65.00	880.00	5300.00	27000.00	--	--	--
	07/21/94	14.99	0.00	504.83	519.82	25.00	11.00	58	29.00	940.00	6200.00	31000.00	--	--	--
	10/19/94	14.80	0.00	505.02	519.82	25.00	11.00	16	3.50	8.60	1100.00	4100.00	--	--	--
	01/18/95	14.10	0.00	505.72	519.82	25.00	11.00	6.8	7.30	100.00	1500.00	5100.00	--	--	--
	04/17/95	14.13	0.00	505.69	519.82	25.00	11.00	1.3	0.67	6.60	74.00	320.00	--	--	--
	07/18/95	14.11	0.00	505.71	519.82	25.00	11.00	25	24.00	550.00	3700.00	12000.00	--	--	--
	10/17/95	14.15	0.00	505.67	519.82	25.00	11.00	60	58.00	760.00	8300.00	77000.00	220.00	--	--
	01/17/96	14.35	0.00	505.47	519.82	25.00	11.00	15	ND	150.00	1600.00	7000.00	370.00	--	--

Table 1

HISTORIC FLUID LEVELS AND SELECTED ANALYTICAL RESULTS

76 Station 6034

4700 First Street, Livermore

Well No.	Monitoring Date	Depth to Water (feet)	LPH Thickness (feet)	Ground-water Elevation (feet)	Surface Elevation (feet)	Depth of Well (feet)		Benzene (µg/l)	Toluene (µg/l)	Ethyl-benzene (µg/l)	Total Xylenes (µg/l)	TPH-G (µg/l)	MTBE 8021B (µg/l)	MTBE 8260B (µg/l)	TPPH 8260B (µg/l)
	04/17/96	13.93	0.00	505.89	519.82	25.00	11.00	ND	ND	600.00	4900.00	19000.00	6100.00	--	--
	07/16/96	14.00	0.00	505.82	519.82	25.00	11.00	16	22.00	900.00	4500.00	23000.00	410.00	--	--
	10/16/96	14.12	0.00	505.70	519.82	25.00	11.00	28	31.00	1600.00	6900.00	14000.00	9600.00	--	--
	01/13/97	--	--	--	519.82	25.00	11.00	12	5.00	28.00	890.00	4300.00	1300.00	--	--
	04/08/97	14.49	0.00	505.33	519.82	25.00	11.00	ND	6.50	170.00	830.00	4700.00	290.00	--	--
	10/06/97	14.41	0.00	505.41	519.82	25.00	11.00	14	ND	19.00	860.00	5800.00	570.00	--	--
	04/02/98	14.26	0.00	505.56	519.82	25.00	11.00	ND	ND	980.00	5200.00	24000.00	6800.00	--	--
	10/07/98	14.35	0.00	505.47	519.82	25.00	11.00	ND	ND	2100.00	7800.00	41000.00	3700.00	2700.00	--
	04/14/99	14.54	0.00	505.28	519.82	25.00	11.00	1.2	ND	29.00	260.00	720.00	95.00	57.00	--
	10/12/99	14.50	0.00	505.32	519.82	25.00	11.00	ND	ND	78.00	480.00	2200.00	52.00	11.00	--
	04/10/00	14.72	0.00	505.10	519.82	25.00	11.00	ND	ND	0.82	2.99	ND	28.50	40.10	--
	10/02/00	14.91	0.00	504.91	519.82	25.00	11.00	ND	ND	0.71	1.00	ND	9.20	11.00	--
	04/02/01	14.12	0.00	505.70	519.82	25.00	11.00	ND	ND	ND	ND	ND	ND	ND	--
	10/05/01	15.02	0.00	504.80	519.82	25.00	11.00	4.4	ND<2.5	29.00	79.00	1300.00	ND<25	12.00	--
	04/01/02	14.94	0.00	504.88	519.82	25.00	11.00	5.1	ND<5.0	120.00	460.00	3500.00	ND<50	14.00	--
	10/16/02	15.06	0.00	504.76	519.82	25.00	11.00	ND<0.50	ND<0.50	8.20	15.00	240.00	--	ND<2.0	--
	04/03/03	14.96	0.00	504.86	519.82	25.00	11.00	1.5	1.80	23.00	160.00	1300.00	--	6.60	--
	10/02/03	15.11	0.00	504.71	519.82	25.00	11.00	ND<13	ND<13	290.00	1400.00	--	--	ND<50	15000.00
	04/30/04	15.25	0.00	504.57	519.82	25.00	11.00	ND<13	ND<13	140.00	550.00	--	--	ND<13	8000.00
	12/01/04	15.37	0.00	504.45	519.82	25.00	11.00	ND<1.0	ND<1.0	81.00	240.00	--	--	5.90	4700.00
	06/13/05	15.12	0.00	504.70	519.82	25.00	11.00	ND<0.50	ND<0.50	47.00	200.00	--	--	2.50	3300.00
MW-3	11/18/89	--	--	--	--	25.00	11.00	0.35	ND	ND	ND	ND	--	--	--
	03/08/90	--	--	--	--	25.00	11.00	ND	ND	ND	ND	ND	--	--	--
	06/05/90	--	--	--	--	25.00	11.00	ND	ND	ND	ND	ND	--	--	--
	09/07/90	--	--	--	--	25.00	11.00	11	ND	6.60	16.00	1100.00	--	--	--
	12/24/90	--	--	--	--	25.00	11.00	ND	ND	ND	ND	ND	--	--	--
	04/10/91	--	--	--	--	25.00	11.00	ND	ND	ND	ND	ND	--	--	--
	07/10/91	--	--	--	--	25.00	11.00	ND	ND	ND	ND	ND	--	--	--
	10/14/91	--	--	--	--	25.00	11.00	ND	ND	ND	ND	ND	--	--	--
	01/14/92	--	--	--	--	25.00	11.00	ND	ND	ND	ND	ND	--	--	--

Table 1

HISTORIC FLUID LEVELS AND SELECTED ANALYTICAL RESULTS

76 Station 6034

4700 First Street, Livermore

Well No.	Monitoring Date	Depth to Water (feet)	LPH Thickness (feet)	Ground-water Elevation (feet)	Surface Elevation (feet)	Depth of Well (feet)		Benzene (µg/l)	Toluene (µg/l)	Ethyl-benzene (µg/l)	Total Xylenes (µg/l)	TPH-G (µg/l)	MTBE 8021B (µg/l)	MTBE 8260B (µg/l)	TPPH 8260B (µg/l)
	04/06/92	--	--	--	--	25.00	11.00	ND	ND	ND	ND	ND	--	--	--
	07/07/92	--	--	--	--	25.00	11.00	ND	ND	ND	ND	ND	--	--	--
	10/16/92	--	--	--	--	25.00	11.00	ND	ND	ND	ND	ND	--	--	--
	01/14/93	--	--	--	--	25.00	11.00	ND	ND	ND	ND	ND	--	--	--
	04/22/93	14.33	0.00	505.58	519.91	25.00	11.00	ND	ND	ND	ND	ND	--	--	--
	07/20/93	16.90	0.00	503.01	519.91	25.00	11.00	ND	ND	ND	ND	ND	--	--	--
	10/20/93	14.42	0.00	505.24	519.66	25.00	11.00	ND	ND	ND	ND	ND	--	--	--
	01/20/94	14.37	0.00	505.29	519.66	25.00	11.00	--	--	--	--	--	--	--	--
	04/21/94	14.30	0.00	505.36	519.66	25.00	11.00	ND	ND	ND	ND	ND	--	--	--
	07/21/94	14.34	0.00	505.32	519.66	25.00	11.00	--	--	--	--	--	--	--	--
	10/19/94	14.08	0.00	505.58	519.66	25.00	11.00	ND	0.61	ND	0.51	ND	--	--	--
	01/18/95	13.23	0.00	506.43	519.66	25.00	11.00	--	--	--	--	--	--	--	--
	04/17/95	13.20	0.00	506.46	519.66	25.00	11.00	ND	ND	ND	ND	ND	--	--	--
	07/18/95	13.19	0.00	506.47	519.66	25.00	11.00	--	--	--	--	--	--	--	--
	10/17/95	13.24	0.00	506.42	519.66	25.00	11.00	ND	ND	ND	ND	ND	ND	--	--
	01/17/96	13.68	0.00	505.98	519.66	25.00	11.00	--	--	--	--	--	--	--	--
	04/17/96	13.04	0.00	506.62	519.66	25.00	11.00	ND	ND	ND	ND	ND	ND	--	--
	07/16/96	13.24	0.00	506.42	519.66	25.00	11.00	--	--	--	--	--	--	--	--
	10/16/96	13.10	0.00	506.56	519.66	25.00	11.00	--	--	--	--	--	--	--	--
	04/08/97	13.73	0.00	505.93	519.66	25.00	11.00	--	--	--	--	--	--	--	--
	10/06/97	13.70	0.00	505.96	519.66	25.00	11.00	--	--	--	--	--	--	--	--
	04/02/98	13.43	0.00	506.23	519.66	25.00	11.00	--	--	--	--	--	--	--	--
	10/07/98	13.33	0.00	506.33	519.66	25.00	11.00	--	--	--	--	--	--	--	--
	04/14/99	13.47	0.00	506.19	519.66	25.00	11.00	--	--	--	--	--	--	--	--
	10/12/99	13.38	0.00	506.28	519.66	25.00	11.00	--	--	--	--	--	--	--	--
	04/10/00	13.51	0.00	506.15	519.66	25.00	11.00	--	--	--	--	--	--	--	--
	10/02/00	13.62	0.00	506.04	519.66	25.00	11.00	--	--	--	--	--	--	--	--
	04/02/01	13.38	0.00	506.28	519.66	25.00	11.00	--	--	--	--	--	--	--	--
	10/05/01	14.10	0.00	505.56	519.66	25.00	11.00	--	--	--	--	--	--	--	--
	04/01/02	13.98	0.00	505.68	519.66	25.00	11.00	--	--	--	--	--	--	--	--
	10/16/02	14.16	0.00	505.50	519.66	25.00	11.00	--	--	--	--	--	--	--	--
	04/03/03	13.98	0.00	505.68	519.66	25.00	11.00	--	--	--	--	--	--	--	--
	10/02/03	14.15	0.00	505.51	519.66	25.00	11.00	--	--	--	--	--	--	--	--

Table 1

HISTORIC FLUID LEVELS AND SELECTED ANALYTICAL RESULTS

76 Station 6034

4700 First Street, Livermore

Well No.	Monitoring Date	Depth to Water (feet)	LPH Thickness (feet)	Ground-water Elevation (feet)	Surface Elevation (feet)	Depth of Well (feet)		Benzene (µg/l)	Toluene (µg/l)	Ethyl-benzene (µg/l)	Total Xylenes (µg/l)	TPH-G (µg/l)	MTBE 8021B (µg/l)	MTBE 8260B (µg/l)	TPPH 8260B (µg/l)
	04/30/04	14.20	0.00	505.46	519.66	25.00	11.00	--	--	--	--	--	--	--	--
	12/01/04	14.37	0.00	505.29	519.66	25.00	11.00	--	--	--	--	--	--	--	--
MW-4	11/18/89	--	--	--	--	25.00	11.00	9.8	10.00	7.10	4.70	990.00	--	--	--
	03/08/90	--	--	--	--	25.00	11.00	18	8.40	37.00	28.00	1200.00	--	--	--
	06/05/90	--	--	--	--	25.00	11.00	1.2	4.70	24.00	12.00	1400.00	--	--	--
	09/07/90	--	--	--	--	25.00	11.00	100	140.00	210.00	4600.00	15000.00	--	--	--
	12/24/90	--	--	--	--	25.00	11.00	ND	8.70	15.00	10.00	1400.00	--	--	--
	04/10/91	--	--	--	--	25.00	11.00	0.84	4.30	9.60	5.00	950.00	--	--	--
	07/10/91	--	--	--	--	25.00	11.00	8.4	19.00	7.70	7.20	830.00	--	--	--
	10/14/91	--	--	--	--	25.00	11.00	3.8	2.20	8.60	5.80	880.00	--	--	--
	01/14/92	--	--	--	--	25.00	11.00	4.2	7.10	18.00	9.20	1500.00	--	--	--
	04/06/92	--	--	--	--	25.00	11.00	1.3	3.80	2.90	4.10	660.00	--	--	--
	07/07/92	--	--	--	--	25.00	11.00	ND	2.20	2.40	2.40	340.00	--	--	--
	10/16/92	--	--	--	--	25.00	11.00	2.1	ND	4.80	13.00	300.00	--	--	--
	01/14/93	--	--	--	--	25.00	11.00	ND	6.30	12.00	3.90	920.00	--	--	--
	04/22/93	14.30	0.00	505.82	520.12	25.00	11.00	8.8	1.00	7.20	6.00	1100.00	--	--	--
	07/20/93	16.35	0.00	503.77	520.12	25.00	11.00	--	--	--	--	--	--	--	--
	10/20/93	14.16	0.00	505.45	519.61	25.00	11.00	ND	2.50	2.30	1.90	640.00	--	--	--
	01/20/94	14.15	0.00	505.46	519.61	25.00	11.00	ND	2.60	4.70	7.40	1200.00	--	--	--
	04/21/94	14.13	0.00	505.48	519.61	25.00	11.00	0.83	1.20	1.20	1.70	380.00	--	--	--
	07/21/94	14.26	0.00	505.35	519.61	25.00	11.00	0.51	1.40	1.00	1.60	320.00	--	--	--
	10/19/94	13.95	0.00	505.66	519.61	25.00	11.00	ND	3.60	4.20	3.40	750.00	--	--	--
	01/18/95	13.16	0.00	506.45	519.61	25.00	11.00	1.5	3.30	1.20	2.60	790.00	--	--	--
	04/17/95	13.19	0.00	506.42	519.61	25.00	11.00	2.8	ND	3.30	3.90	570.00	--	--	--
	07/18/95	13.21	0.00	506.40	519.61	25.00	11.00	1	1.90	2.80	2.70	340.00	--	--	--
	10/17/95	13.22	0.00	506.39	519.61	25.00	11.00	1.1	0.57	0.69	1.60	260.00	2.00	--	--
	01/17/96	13.02	0.00	506.59	519.61	25.00	11.00	--	--	--	--	--	--	--	--
	04/17/96	13.08	0.00	506.53	519.61	25.00	11.00	3	2.60	6.10	6.90	720.00	ND	--	--
	07/16/96	12.91	0.00	506.70	519.61	25.00	11.00	--	--	--	--	--	--	--	--
	10/16/96	12.98	0.00	506.63	519.61	25.00	11.00	6.6	23.00	24.00	85.00	1100.00	15.00	--	--

Table 1

HISTORIC FLUID LEVELS AND SELECTED ANALYTICAL RESULTS

76 Station 6034

4700 First Street, Livermore

Well No.	Monitoring Date	Depth to Water (feet)	LPH Thickness (feet)	Ground-water Elevation (feet)	Surface Elevation (feet)	Depth of Well (feet)		Benzene (µg/l)	Toluene (µg/l)	Ethyl-benzene (µg/l)	Total Xylenes (µg/l)	TPH-G (µg/l)	MTBE 8021B (µg/l)	MTBE 8260B (µg/l)	TPPH 8260B (µg/l)
	01/13/97	--	--	--	519.61	25.00	11.00	--	--	--	--	--	--	--	--
	04/08/97	13.36	0.00	506.25	519.61	25.00	11.00	1.2	1.90	1.20	6.90	470.00	ND	--	--
	10/06/97	13.42	0.00	506.19	519.61	25.00	11.00	ND	0.85	0.83	2.30	240.00	ND	--	--
	04/02/98	12.76	0.00	506.85	519.61	25.00	11.00	ND	1.20	ND	4.50	270.00	10.00	--	--
	10/07/98	13.04	0.00	506.57	519.61	25.00	11.00	ND	ND	ND	4.80	350.00	ND	--	--
	04/14/99	13.21	0.00	506.40	519.61	25.00	11.00	1.6	ND	3.10	5.60	250.00	ND	16.00	--
	10/12/99	13.16	0.00	506.45	519.61	25.00	11.00	1.4	ND	2.30	3.90	200.00	ND	--	--
	04/10/00	13.48	0.00	506.13	519.61	25.00	11.00	ND	ND	ND	ND	52.80	ND	--	--
	10/02/00	13.25	0.00	506.36	519.61	25.00	11.00	ND	ND	0.50	0.90	57.00	30.00	--	--
	04/02/01	13.11	0.00	506.50	519.61	25.00	11.00	ND	ND	ND	ND	ND	ND	--	--
	10/05/01	14.04	0.00	505.57	519.61	25.00	11.00	ND<0.50	ND<0.50	ND<0.50	ND<0.50	150.00	ND<5.0	--	--
	04/01/02	13.76	0.00	505.85	519.61	25.00	11.00	ND<0.50	ND<0.50	ND<0.50	ND<0.50	130.00	ND<5.0	--	--
	10/16/02	14.10	0.00	505.51	519.61	25.00	11.00	ND<0.50	ND<0.50	ND<0.50	ND<1.0	130.00	--	3.80	--
	04/03/03	13.69	0.00	505.92	519.61	25.00	11.00	ND<0.50	ND<0.50	ND<0.50	ND<1.0	ND<50	--	3.60	--
	10/02/03	14.20	0.00	505.41	519.61	25.00	11.00	ND<0.50	0.86	4.10	9.40	--	--	ND<2.0	81.00
	04/30/04	14.12	0.00	505.49	519.61	25.00	11.00	ND<0.50	ND<0.50	ND<0.50	ND<1.0	--	--	1.50	51.00
	12/01/04	14.17	0.00	505.44	519.61	25.00	11.00	ND<0.50	ND<0.50	ND<0.50	ND<1.0	--	--	1.60	130.00
	06/13/05	13.68	0.00	505.93	519.61	25.00	11.00	ND<0.50	ND<0.50	ND<0.50	ND<1.0	--	--	0.60	69.00
MW-5	04/10/91	--	--	--	--	24.00	10.00	35	14.00	47.00	30.00	630.00	--	--	--
	07/10/91	--	--	--	--	24.00	10.00	5.1	8.70	9.10	9.70	220.00	--	--	--
	10/14/91	--	--	--	--	24.00	10.00	55	4.40	50.00	66.00	660.00	--	--	--
	01/14/92	--	--	--	--	24.00	10.00	1	1.20	ND	0.32	99.00	1.20	--	--
	04/06/92	--	--	--	--	24.00	10.00	ND	ND	0.35	ND	240.00	--	--	--
	07/07/92	--	--	--	--	24.00	10.00	0.48	1.10	0.32	1.30	76.00	1.50	--	--
	10/16/92	--	--	--	--	24.00	10.00	7.8	1.10	17.00	6.40	180.00	2.00	--	--
	01/14/93	--	--	--	--	24.00	10.00	ND	0.53	1.20	11.00	91.00	--	--	--
	04/22/93	15.24	0.00	505.34	520.58	24.00	10.00	1.2	ND	ND	1.30	94.00	0.82	--	--
	07/20/93	17.38	0.00	503.20	520.58	24.00	10.00	1.1	0.51	ND	1.80	89.00	2.20	--	--
	10/20/93	15.56	0.00	504.71	520.27	24.00	10.00	0.8	ND	ND	ND	110.00	--	--	--
	01/20/94	15.39	0.00	504.88	520.27	24.00	10.00	ND	ND	ND	ND	ND	--	--	--

Table 1

HISTORIC FLUID LEVELS AND SELECTED ANALYTICAL RESULTS

76 Station 6034
4700 First Street, Livermore

Well No.	Monitoring Date	Depth to Water (feet)	LPH Thickness (feet)	Ground-water Elevation (feet)	Surface Elevation (feet)	Depth of Well (feet)		Benzene (µg/l)	Toluene (µg/l)	Ethylbenzene (µg/l)	Total Xylenes (µg/l)	TPH-G (µg/l)	MTBE 8021B (µg/l)	MTBE 8260B (µg/l)	TPPH 8260B (µg/l)
	04/21/94	15.41	0.00	504.86	520.27	24.00	10.00	ND	ND	ND	ND	ND	--	--	--
	07/21/94	15.55	0.00	504.72	520.27	24.00	10.00	ND	ND	ND	ND	ND	--	--	--
	10/19/94	15.20	0.00	505.07	520.27	24.00	10.00	ND	0.71	ND	0.57	ND	--	--	--
	01/18/95	14.52	0.00	505.75	520.27	24.00	10.00	ND	ND	ND	ND	ND	--	--	--
	04/17/95	14.50	0.00	505.77	520.27	24.00	10.00	ND	ND	ND	ND	ND	--	--	--
	07/18/95	14.41	0.00	505.86	520.27	24.00	10.00	ND	ND	ND	1.10	ND	--	--	--
	10/17/95	14.46	0.00	505.81	520.27	24.00	10.00	ND	ND	ND	ND	ND	ND	--	--
	01/17/96	14.48	0.00	505.79	520.27	24.00	10.00	--	--	--	--	--	--	--	--
	04/17/96	14.22	0.00	506.05	520.27	24.00	10.00	ND	ND	ND	ND	ND	ND	--	--
	07/16/96	14.27	0.00	506.00	520.27	24.00	10.00	--	--	--	--	--	--	--	--
	10/16/96	14.15	0.00	506.12	520.27	24.00	10.00	--	--	--	--	--	--	--	--
	04/08/97	14.71	0.00	505.56	520.27	24.00	10.00	--	--	--	--	--	--	--	--
	10/06/97	14.71	0.00	505.56	520.27	24.00	10.00	--	--	--	--	--	--	--	--
	04/02/98	14.28	0.00	505.99	520.27	24.00	10.00	--	--	--	--	--	--	--	--
	10/07/98	14.40	0.00	505.87	520.27	24.00	10.00	--	--	--	--	--	--	--	--
	04/14/99	14.63	0.00	505.64	520.27	24.00	10.00	--	--	--	--	--	--	--	--
	10/12/99	14.48	0.00	505.79	520.27	24.00	10.00	--	--	--	--	--	--	--	--
	04/10/00	14.76	0.00	505.51	520.27	24.00	10.00	--	--	--	--	--	--	--	--
	10/02/00	14.65	0.00	505.62	520.27	24.00	10.00	--	--	--	--	--	--	--	--
	04/02/01	14.20	0.00	506.07	520.27	24.00	10.00	--	--	--	--	--	--	--	--
	10/05/01	15.47	0.00	504.80	520.27	24.00	10.00	--	--	--	--	--	--	--	--
	04/01/02	15.18	0.00	505.09	520.27	24.00	10.00	--	--	--	--	--	--	--	--
	10/16/02	15.50	0.00	504.77	520.27	24.00	10.00	--	--	--	--	--	--	--	--
	04/03/03	15.14	0.00	505.13	520.27	24.00	10.00	--	--	--	--	--	--	--	--
	10/02/03	15.66	0.00	504.61	520.27	24.00	10.00	--	--	--	--	--	--	--	--
	04/30/04	15.55	0.00	504.72	520.27	24.00	10.00	--	--	--	--	--	--	--	--
	12/01/04	15.62	0.00	504.65	520.27	24.00	10.00	--	--	--	--	--	--	--	--
MW-6	04/10/91	--	--	--	--	24.00	10.00	ND	ND	ND	ND	ND	--	--	--
	07/10/91	--	--	--	--	24.00	10.00	ND	ND	ND	ND	ND	--	--	--
	10/14/91	--	--	--	--	24.00	10.00	ND	ND	ND	ND	ND	--	--	--

Table 1

HISTORIC FLUID LEVELS AND SELECTED ANALYTICAL RESULTS

76 Station 6034

4700 First Street, Livermore

Well No.	Monitoring Date	Depth to Water (feet)	LPH Thickness (feet)	Ground-water Elevation (feet)	Surface Elevation (feet)	Depth of Well (feet)		Benzene (µg/l)	Toluene (µg/l)	Ethyl-benzene (µg/l)	Total Xylenes (µg/l)	TPH-G (µg/l)	MTBE 8021B (µg/l)	MTBE 8260B (µg/l)	TPPH 8260B (µg/l)
	01/14/92	--	--	--	--	24.00	10.00	ND	ND	ND	ND	ND	--	--	--
	04/06/92	--	--	--	--	24.00	10.00	ND	ND	ND	ND	ND	--	--	--
	07/07/92	--	--	--	--	24.00	10.00	ND	ND	ND	ND	ND	--	--	--
	10/16/92	--	--	--	--	24.00	10.00	--	--	--	--	--	--	--	--
	01/14/93	--	--	--	--	24.00	10.00	--	--	--	--	--	--	--	--
	04/22/93	--	0.00	--	519.34	24.00	10.00	--	--	--	--	--	--	--	--
	07/20/93	--	0.00	--	519.34	24.00	10.00	--	--	--	--	--	--	--	--
	10/20/93	14.20	0.00	504.55	518.75	24.00	10.00	ND	ND	ND	ND	ND	--	--	--
	01/20/94	14.14	0.00	504.61	518.75	24.00	10.00	ND	ND	ND	ND	ND	--	--	--
	04/21/94	14.10	0.00	504.65	518.75	24.00	10.00	ND	ND	ND	ND	ND	--	--	--
	07/21/94	14.12	0.00	504.63	518.75	24.00	10.00	ND	ND	ND	ND	ND	--	--	--
	10/19/94	--	--	--	518.75	24.00	10.00	--	--	--	--	--	--	--	--
	01/18/95	--	--	--	518.75	24.00	10.00	--	--	--	--	--	--	--	--
	04/17/95	13.82	0.00	504.93	518.75	24.00	10.00	ND	ND	ND	ND	ND	--	--	--
	07/18/95	13.84	0.00	504.91	518.75	24.00	10.00	ND	ND	ND	ND	ND	--	--	--
	10/17/95	13.90	0.00	504.85	518.75	24.00	10.00	ND	ND	ND	ND	ND	2.20	--	--
	01/17/96	--	--	--	518.75	24.00	10.00	--	--	--	--	--	--	--	--
	04/17/96	13.66	0.00	505.09	518.75	24.00	10.00	ND	ND	ND	ND	ND	ND	--	--
	07/16/96	--	--	--	518.75	24.00	10.00	--	--	--	--	--	--	--	--
	10/16/96	13.72	0.00	505.03	518.75	24.00	10.00	--	--	--	--	--	--	--	--
	04/08/97	--	--	--	518.75	24.00	10.00	--	--	--	--	--	--	--	--
	10/06/97	--	--	--	518.75	24.00	10.00	--	--	--	--	--	--	--	--
	04/02/98	--	--	--	518.75	24.00	10.00	--	--	--	--	--	--	--	--
	10/07/98	--	--	--	518.75	24.00	10.00	--	--	--	--	--	--	--	--
	04/14/99	13.82	0.00	504.93	518.75	24.00	10.00	--	--	--	--	--	--	--	--
	10/12/99	13.72	0.00	505.03	518.75	24.00	10.00	--	--	--	--	--	--	--	--
	04/10/00	13.40	0.00	505.35	518.75	24.00	10.00	--	--	--	--	--	--	--	--
	10/02/00	13.63	0.00	505.12	518.75	24.00	10.00	--	--	--	--	--	--	--	--
	04/02/01	13.31	0.00	505.44	518.75	24.00	10.00	--	--	--	--	--	--	--	--
	10/05/01	--	--	--	518.75	24.00	10.00	--	--	--	--	--	--	--	--
	04/01/02	--	--	--	518.75	24.00	10.00	--	--	--	--	--	--	--	--
	10/16/02	--	--	--	518.75	24.00	10.00	--	--	--	--	--	--	--	--
	04/03/03	--	--	--	518.75	24.00	10.00	--	--	--	--	--	--	--	--

Table 1

HISTORIC FLUID LEVELS AND SELECTED ANALYTICAL RESULTS

76 Station 6034

4700 First Street, Livermore

Well No.	Monitoring Date	Depth to Water (feet)	LPH Thickness (feet)	Ground-water Elevation (feet)	Surface Elevation (feet)	Depth of Well (feet)		Benzene (µg/l)	Toluene (µg/l)	Ethyl-benzene (µg/l)	Total Xylenes (µg/l)	TPH-G (µg/l)	MTBE 8021B (µg/l)	MTBE 8260B (µg/l)	TPPH 8260B (µg/l)
	10/02/03	--	--	--	518.75	24.00	10.00	--	--	--	--	--	--	--	--
	04/30/04	--	--	--	518.75	24.00	10.00	--	--	--	--	--	--	--	--
	12/01/04	--	--	--	518.75	24.00	10.00	--	--	--	--	--	--	--	--
MW-7	04/10/91	--	--	--	--	24.00	10.00	ND	ND	ND	ND	ND	--	--	--
	07/10/91	--	--	--	--	24.00	10.00	ND	ND	ND	ND	ND	--	--	--
	10/14/91	--	--	--	--	24.00	10.00	ND	ND	ND	ND	ND	--	--	--
	01/14/92	--	--	--	--	24.00	10.00	ND	ND	ND	ND	ND	--	--	--
	04/06/92	--	--	--	--	24.00	10.00	ND	ND	ND	ND	ND	--	--	--
	07/07/92	--	--	--	--	24.00	10.00	ND	ND	ND	ND	ND	--	--	--
	10/16/92	--	--	--	--	24.00	10.00	ND	ND	ND	ND	ND	--	--	--
	01/14/93	--	--	--	--	24.00	10.00	ND	ND	ND	ND	ND	--	--	--
	04/22/93	14.25	0.00	505.12	519.37	24.00	10.00	ND	ND	ND	ND	ND	--	--	--
	07/20/93	16.68	0.00	502.69	519.37	24.00	10.00	ND	ND	ND	ND	ND	--	--	--
	10/20/93	14.29	0.00	504.54	518.83	24.00	10.00	ND	ND	ND	ND	ND	--	--	--
	01/20/94	14.22	0.00	504.61	518.83	24.00	10.00	ND	ND	ND	ND	ND	--	--	--
	04/21/94	14.17	0.00	504.66	518.83	24.00	10.00	ND	ND	ND	ND	ND	--	--	--
	07/21/94	14.21	0.00	504.62	518.83	24.00	10.00	ND	ND	ND	ND	ND	--	--	--
	10/19/94	14.05	0.00	504.78	518.83	24.00	10.00	ND	0.87	ND	0.61	ND	--	--	--
	01/18/95	13.34	0.00	505.49	518.83	24.00	10.00	ND	ND	ND	ND	ND	--	--	--
	04/17/95	13.38	0.00	505.45	518.83	24.00	10.00	ND	ND	ND	ND	ND	--	--	--
	07/18/95	13.36	0.00	505.47	518.83	24.00	10.00	ND	ND	ND	ND	ND	--	--	--
	10/17/95	13.41	0.00	505.42	518.83	24.00	10.00	ND	ND	ND	ND	ND	3.50	--	--
	01/17/96	13.56	0.00	505.27	518.83	24.00	10.00	--	--	--	--	--	--	--	--
	04/17/96	13.21	0.00	505.62	518.83	24.00	10.00	ND	ND	ND	ND	ND	ND	--	--
	07/16/96	13.22	0.00	505.61	518.83	24.00	10.00	--	--	--	--	--	--	--	--
	10/16/96	13.58	0.00	505.25	518.83	24.00	10.00	--	--	--	--	--	--	--	--
	04/08/97	13.73	0.00	505.10	518.83	24.00	10.00	--	--	--	--	--	--	--	--
	10/06/97	13.65	0.00	505.18	518.83	24.00	10.00	--	--	--	--	--	--	--	--
	04/02/98	13.55	0.00	505.28	518.83	24.00	10.00	--	--	--	--	--	--	--	--
	10/07/98	13.64	0.00	505.19	518.83	24.00	10.00	--	--	--	--	--	--	--	--

Table 1

HISTORIC FLUID LEVELS AND SELECTED ANALYTICAL RESULTS

76 Station 6034
4700 First Street, Livermore

Well No.	Monitoring Date	Depth to Water (feet)	LPH Thickness (feet)	Ground-water Elevation (feet)	Surface Elevation (feet)	Depth of Well (feet)		Benzene (µg/l)	Toluene (µg/l)	Ethylbenzene (µg/l)	Total Xylenes (µg/l)	TPH-G (µg/l)	MTBE 8021B (µg/l)	MTBE 8260B (µg/l)	TPPH 8260B (µg/l)
	04/14/99	13.75	0.00	505.08	518.83	24.00	10.00	--	--	--	--	--	--	--	--
	10/12/99	13.61	0.00	505.22	518.83	24.00	10.00	--	--	--	--	--	--	--	--
	04/10/00	13.85	0.00	504.98	518.83	24.00	10.00	--	--	--	--	--	--	--	--
	10/02/00	14.19	0.00	504.64	518.83	24.00	10.00	--	--	--	--	--	--	--	--
	04/02/01	13.86	0.00	504.97	518.83	24.00	10.00	--	--	--	--	--	--	--	--
	10/05/01	14.30	0.00	504.53	518.83	24.00	10.00	--	--	--	--	--	--	--	--
	04/01/02	14.23	0.00	504.60	518.83	24.00	10.00	--	--	--	--	--	--	--	--
	10/16/02	14.30	0.00	504.53	518.83	24.00	10.00	--	--	--	--	--	--	--	--
	04/03/03	14.27	0.00	504.56	518.83	24.00	10.00	--	--	--	--	--	--	--	--
	10/02/03	14.35	0.00	504.48	518.83	24.00	10.00	--	--	--	--	--	--	--	--
	04/30/04	14.35	0.00	504.48	518.83	24.00	10.00	--	--	--	--	--	--	--	--
	12/01/04	14.66	0.00	504.17	518.83	24.00	10.00	--	--	--	--	--	--	--	--

LEGEND

- | | | | |
|-------|---|---------|--|
| -- | not analyzed, measured, or collected | PCE | tetrachloroethene |
| LPH | liquid-phase hydrocarbons | TBA | tertiary butyl alcohol |
| Trace | less than 0.01 foot of LPH in well | TCA | trichloroethane |
| µg/l | micrograms per liter | TCE | trichloroethene |
| mg/l | milligrams per liter | TPH-G | total petroleum hydrocarbons with gasoline distinction |
| ND | not detected | TPH-D | total petroleum hydrocarbons with diesel distinction |
| < | not detected at or above laboratory detection limit | TPPH | total purgeable petroleum hydrocarbons |
| TOC | top of casing | TRPH | total recoverable petroleum hydrocarbons |
| BTEX | benzene, toluene, ethylbenzene, and (total) xylenes | TAME | tertiary amyl methyl ether |
| DIPE | di-isopropyl ether | 1,1-DCA | 1,1-dichloroethane |
| ETBE | ethyl tertiary butyl ether | 1,2-DCA | 1,1-dichloroethane (same as EC, ethylene dichloride) |
| MTBE | methyl tertiary butyl ether | 1,1-DCE | 1,1-dichloroethene |
| PCB | polychlorinated biphenyls | 1,2-DCE | 1,2-dichloroethene (cis- and trans-) |



Customer-Focused Solutions

July 14, 2005

ConocoPhillips Company
76 Broadway
Sacramento, CA 95818

ATTN: MS. SHELBY LATHROP

SITE: 76 STATION 6034
4700 FIRST STREET
LIVERMORE, CALIFORNIA

RE: SEMI-ANNUAL MONITORING REPORT
JANUARY THROUGH JUNE 2005

Dear Ms. Lathrop:

Please find enclosed our Semi-Annual Monitoring Report for 76 Station 6034, located at 4700 First Street, Livermore, California. If you have any questions regarding this report, please call us at (949) 753-0101.

Sincerely,

TRC

Anju Farfan
QMS Operations Manager

CC: Mr. Dave Evans, ATC Associates Inc. (2 copies)

Enclosures
20-0400/6034R05.QMS



Customer-Focused Solutions

**SEMI-ANNUAL MONITORING REPORT
JANUARY THROUGH JUNE 2005**

76 Station 6034
4700 First Street
Livermore, California

Prepared For:

Ms. Shelby Lathrop
CONOCOPHILLIPS COMPANY
76 Broadway
Sacramento, California 95818

By:

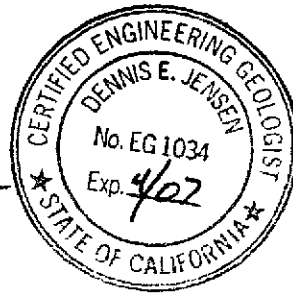

Senior Project Geologist, Irvine Operations
July 13, 2005

LIST OF ATTACHMENTS

Summary Sheet	Summary of Gauging and Sampling Activities
Tables	Table Key Table 1: Current Fluid Levels and Selected Analytical Results Table 2: Historic Fluid Levels and Selected Analytical Results Table 3: Additional Analytical Results
Figures	Figure 1: Vicinity Map Figure 2: Groundwater Elevation Contour Map Figure 3: Dissolved-Phase TPPH Concentration Map Figure 4: Dissolved-Phase Benzene Concentration Map Figure 5: Dissolved-Phase MTBE Concentration Map
Graphs	Groundwater Elevations vs. Time Benzene Concentrations vs. Time
Field Activities	General Field Procedures Groundwater Sampling Field Notes
Laboratory Reports	Official Laboratory Reports Quality Control Reports Chain of Custody Records
Statements	Purge Water Disposal Limitations

Summary of Gauging and Sampling Activities
January 2005 through June 2005
76 Station 6034
4700 First Street
Livermore, CA

Project Coordinator: **Shelby Lathrop**
Telephone: **916-558-7609**

Water Sampling Contractor: **TRC**
Compiled by: **Tim Simpkins**

Date(s) of Gauging/Sampling Event: **06/13/05**

Sample Points

Groundwater wells: **7** onsite, **0** offsite Wells gauged: **7** Wells sampled: **2**
Purging method: **Diaphragm pump**
Purge water disposal: **Onyx/Rodeo Unit 100**
Other Sample Points: **0** Type: **n/a**

Liquid Phase Hydrocarbons (LPH)

Wells with LPH: **0** Maximum thickness (feet): **n/a**
LPH removal frequency: **n/a** Method: **n/a**
Treatment or disposal of water/LPH: **n/a**

Hydrogeologic Parameters

Depth to groundwater (below TOC): Minimum: **13.68 feet** Maximum: **15.49 feet**
Average groundwater elevation (relative to available local datum): **504.96 feet**
Average change in groundwater elevation since previous event: **0.16 feet**
Interpreted groundwater gradient and flow direction:
 Current event: **0.02 ft/ft, northwest**
 Previous event: **0.007 ft/ft, northwest (12/01/04)**

Selected Laboratory Results

Wells with detected **Benzene**: **0** Wells above MCL (1.0 µg/l): **n/a**
 Maximum reported benzene concentration: **n/a**

Wells with **TPPH 8260B** **2** Maximum: **3,300 µg/l (MW-2)**
Wells with **MTBE** **2** Maximum: **2.5 µg/l (MW-2)**

Notes:

MW-1=Monitored Only, MW-3=Monitored Only, MW-5=Monitored Only, MW-6=Dry well, MW-7=Monitored Only,

TABLES

TABLE KEY

STANDARD ABBREVIATIONS

--	=	not analyzed, measured, or collected
LPH	=	liquid-phase hydrocarbons
Trace	=	less than 0.01 foot of LPH in well
µg/l	=	micrograms per liter (approx. equivalent to parts per billion, ppb)
mg/l	=	milligrams per liter (approx. equivalent to parts per million, ppm)
ND <	=	not detected at or above laboratory detection limit
TOC	=	top of casing (surveyed reference elevation)

ANALYTES

BTEX	=	benzene, toluene, ethylbenzene, and (total) xylenes
DIPE	=	di-isopropyl ether
ETBE	=	ethyl tertiary butyl ether
MTBE	=	methyl tertiary butyl ether
PCB	=	polychlorinated biphenyls
PCE	=	tetrachloroethene
TBA	=	tertiary butyl alcohol
TCA	=	trichloroethane
TCE	=	trichloroethene
TPH-G	=	total petroleum hydrocarbons with gasoline distinction
TPH-D	=	total petroleum hydrocarbons with diesel distinction
TPPH	=	total purgeable petroleum hydrocarbons
TRPH	=	total recoverable petroleum hydrocarbons
TAME	=	tertiary amyl methyl ether
1,1-DCA	=	1,1-dichloroethane
1,2-DCA	=	1,2-dichloroethane (same as EDC, ethylene dichloride)
1,1-DCE	=	1,1-dichloroethene
1,2-DCE	=	1,2-dichloroethene (cis- and trans-)

NOTES

1. Elevations are in feet above mean sea level. Depths are in feet below surveyed top-of-casing.
2. Groundwater elevations for wells with LPH are calculated as: Surface Elevation - Measured Depth to Water + (Dp x LPH Thickness), where Dp is the density of the LPH, if known. A value of 0.75 is used for gasoline and when the density is not known. A value of 0.83 is used for diesel.
3. Wells with LPH are generally not sampled for laboratory analysis (see General Field Procedures).
4. Comments shown on tables are general. Additional explanations may be included in field notes and laboratory reports, both of which are included as part of this report.
5. A "J" flag indicates that a reported analytical result is an estimated concentration value between the method detection limit (MDL) and the practical quantification limit (PQL) specified by the laboratory.
6. Other laboratory flags (qualifiers) may have been reported. See the official laboratory report (attached) for a complete list of laboratory flags.
7. Concentration graphs based on tables (presented following Figures) show non-detect results prior to the Second Quarter 2000 plotted at fixed values for graphical display. Non-detect results reported since that time are plotted at reporting limits stated in the official laboratory report.
8. Groundwater vs. Time graphs may be corrected for apparent level changes due to re-survey.
9. Historical data has been validated for this report. Values presented in the following tables supercede those from previous reports.

REFERENCE

TRC began groundwater monitoring and sampling for 76 Station 6034 in October 2003. Historical data compiled prior to that time were provided by Gettler-Ryan Inc.

Table 1
CURRENT FLUID LEVELS AND SELECTED ANALYTICAL RESULTS
June 13, 2005
76 Station 6034

Date Sampled	TOC Elevation (feet)	Depth to Water (feet)	LPH Thickness (feet)	Ground-water Elevation (feet)	Change in Elevation (feet)	TPH-G (µg/l)	TPPH 8260B (µg/l)	Benzene (µg/l)	Toluene (µg/l)	Ethylbenzene (µg/l)	Total Xylenes (µg/l)	MTBE 8021B (µg/l)	MTBE 8260B (µg/l)	Comments
MW-1	(Screen Interval in feet: 11.0-28.5)													
06/13/05	520.64	15.49	0.00	505.15	0.32	--	--	--	--	--	--	--	--	Monitored Only
MW-2	(Screen Interval in feet: 11.0-25.0)													
06/13/05	519.82	15.12	0.00	504.70	0.25	--	3300	ND<0.50	ND<0.50	47	200	--	2.5	
MW-3	(Screen Interval in feet: 11.0-25.0)													
06/13/05	519.66	13.98	0.00	505.68	0.39	--	--	--	--	--	--	--	--	Monitored Only
MW-4	(Screen Interval in feet: 11.0-25.0)													
06/13/05	519.61	13.68	0.00	505.93	0.49	--	69	ND<0.50	ND<0.50	ND<0.50	ND<1.0	--	0.60	
MW-5	(Screen Interval in feet: 10.0-24.0)													
06/13/05	520.27	15.31	0.00	504.96	0.31	--	--	--	--	--	--	--	--	Monitored Only
MW-6	(Screen Interval in feet: 10.0-24.0)													
06/13/05	518.75	--	--	--	--	--	--	--	--	--	--	--	--	Dry well
MW-7	(Screen Interval in feet: 10.0-24.0)													
06/13/05	518.83	15.47	0.00	503.36	-0.81	--	--	--	--	--	--	--	--	Monitored Only

Table 2
HISTORIC FLUID LEVELS AND SELECTED ANALYTICAL RESULTS
November 1989 Through June 2005
76 Station 6034

Date Sampled	TOC Elevation (feet)	Depth to Water (feet)	LPH Thickness (feet)	Ground-water Elevation (feet)	Change in Elevation (feet)	TPH-G (µg/l)	TPPH 8260B (µg/l)	Benzene (µg/l)	Toluene (µg/l)	Ethylbenzene (µg/l)	Total Xylenes (µg/l)	MTBE 8021B (µg/l)	MTBE 8260B (µg/l)	Comments
MW-1 (Screen Interval in feet: 11.0-28.5)														
11/18/89	--	--	--	--	--	ND	--	ND	ND	ND	ND	--	--	
03/08/90	--	--	--	--	--	ND	--	ND	ND	ND	ND	--	--	
06/05/90	--	--	--	--	--	ND	--	ND	ND	ND	ND	--	--	
09/07/90	--	--	--	--	--	ND	--	ND	1.2	ND	ND	--	--	
12/24/90	--	--	--	--	--	ND	--	ND	ND	ND	0.4	--	--	
04/10/91	--	--	--	--	--	ND	--	ND	ND	ND	ND	--	--	
07/10/91	--	--	--	--	--	ND	--	ND	ND	ND	ND	--	--	
04/22/93	520.88	15.47	0.00	505.41	--	--	--	--	--	--	--	--	--	
07/20/93	520.88	18.04	0.00	502.84	-2.57	--	--	--	--	--	--	--	--	
10/20/93	520.64	15.69	0.00	504.95	2.11	--	--	--	--	--	--	--	--	
01/20/94	520.64	15.65	0.00	504.99	0.04	--	--	--	--	--	--	--	--	
04/21/94	520.64	15.58	0.00	505.06	0.07	ND	--	ND	ND	ND	ND	--	--	
07/21/94	520.64	15.62	0.00	505.02	-0.04	--	--	--	--	--	--	--	--	Sampled Annually
10/19/94	520.64	15.28	0.00	505.36	0.34	--	--	--	--	--	--	--	--	
01/18/95	520.64	14.56	0.00	506.08	0.72	--	--	--	--	--	--	--	--	
04/17/95	520.64	14.82	0.00	505.82	-0.26	ND	--	ND	ND	ND	ND	--	--	
07/18/95	520.64	14.78	0.00	505.86	0.04	--	--	--	--	--	--	--	--	
10/17/95	520.64	14.83	0.00	505.81	-0.05	--	--	--	--	--	--	--	--	
01/17/96	520.64	14.96	0.00	505.68	-0.13	--	--	--	--	--	--	--	--	
04/17/96	520.64	14.47	0.00	506.17	0.49	ND	--	ND	ND	ND	ND	ND	--	
07/16/96	520.64	14.57	0.00	506.07	-0.10	--	--	--	--	--	--	--	--	
10/16/96	520.64	14.50	0.00	506.14	0.07	--	--	--	--	--	--	--	--	
04/08/97	520.64	15.05	0.00	505.59	-0.55	--	--	--	--	--	--	--	--	
10/06/97	520.64	15.00	0.00	505.64	0.05	--	--	--	--	--	--	--	--	Sampling Discontinued

Table 2
HISTORIC FLUID LEVELS AND SELECTED ANALYTICAL RESULTS
November 1989 Through June 2005
76 Station 6034

Date Sampled	TOC Elevation (feet)	Depth to Water (feet)	LPH Thickness (feet)	Ground-water Elevation (feet)	Change in Elevation (feet)	TPH-G (µg/l)	TPPH 8260B (µg/l)	Benzene (µg/l)	Toluene (µg/l)	Ethyl-benzene (µg/l)	Total Xylenes (µg/l)	MTBE 8021B (µg/l)	MTBE 8260B (µg/l)	Comments
MW-1 continued														
04/02/98	520.64	14.80	0.00	505.84	0.20	--	--	--	--	--	--	--	--	
10/07/98	520.64	14.72	0.00	505.92	0.08	--	--	--	--	--	--	--	--	
04/14/99	520.64	14.89	0.00	505.75	-0.17	--	--	--	--	--	--	--	--	
10/12/99	520.64	14.79	0.00	505.85	0.10	--	--	--	--	--	--	--	--	
04/10/00	520.64	14.93	0.00	505.71	-0.14	--	--	--	--	--	--	--	--	
10/02/00	520.64	15.18	0.00	505.46	-0.25	--	--	--	--	--	--	--	--	
04/02/01	520.64	14.72	0.00	505.92	0.46	--	--	--	--	--	--	--	--	
10/05/01	520.64	15.51	0.00	505.13	-0.79	--	--	--	--	--	--	--	--	
04/01/02	520.64	15.40	0.00	505.24	0.11	--	--	--	--	--	--	--	--	
10/16/02	520.64	15.54	0.00	505.10	-0.14	--	--	--	--	--	--	--	--	
04/03/03	520.64	15.41	0.00	505.23	0.13	--	--	--	--	--	--	--	--	
10/02/03	520.64	15.58	0.00	505.06	-0.17	--	--	--	--	--	--	--	--	Monitored Only
04/30/04	520.64	15.65	0.00	504.99	-0.07	--	--	--	--	--	--	--	--	Monitored only
12/01/04	520.64	15.81	0.00	504.83	-0.16	--	--	--	--	--	--	--	--	Sampled Semi-Annually
06/13/05	520.64	15.49	0.00	505.15	0.32	--	--	--	--	--	--	--	--	Monitored Only
MW-2 (Screen Interval in feet: 11.0-25.0)														
11/18/89	--	--	--	--	--	53000	--	540	500	130	22000	--	--	
03/08/90	--	--	--	--	--	26000	--	230	410	1300	2100	--	--	
06/05/90	--	--	--	--	--	31000	--	250	460	950	9200	--	--	
09/07/90	--	--	--	--	--	ND	--	ND	1.5	ND	ND	--	--	
12/24/90	--	--	--	--	--	32000	--	440	340	460	13000	--	--	
04/10/91	--	--	--	--	--	22000	--	170	190	490	6200	--	--	
07/10/91	--	--	--	--	--	14000	--	70	160	570	5400	--	--	
10/14/91	--	--	--	--	--	11000	--	79	130	660	4700	--	--	

Table 2
HISTORIC FLUID LEVELS AND SELECTED ANALYTICAL RESULTS
November 1989 Through June 2005
76 Station 6034

Date Sampled	TOC Elevation (feet)	Depth to Water (feet)	LPH Thickness (feet)	Ground-water Elevation (feet)	Change in Elevation (feet)	TPH-G (µg/l)	TPPH 8260B (µg/l)	Benzene (µg/l)	Toluene (µg/l)	Ethyl-benzene (µg/l)	Total Xylenes (µg/l)	MTBE 8021B (µg/l)	MTBE 8260B (µg/l)	Comments
MW-2 continued														
01/14/92	--	--	--	--	--	5600	--	36	120	450	2600	--	--	
04/06/92	--	--	--	--	--	760	--	6.3	2.1	ND	130	--	--	
07/07/92	--	--	--	--	--	44000	--	160	1100	1000	17000	--	--	
10/16/92	--	--	--	--	--	290	--	2.3	ND	5.1	15	--	--	
01/14/93	--	--	--	--	--	19000	--	75	430	900	8400	--	--	
04/22/93	520.17	14.98	0.00	505.19	--	49000	--	150	1000	3000	18000	--	--	
07/20/93	520.17	17.41	0.00	502.76	-2.43	25000	--	68	94	1000	6200	--	--	
10/20/93	519.82	15.08	0.00	504.74	1.98	12000	--	27	10	100	3000	--	--	
01/20/94	519.82	15.02	0.00	504.80	0.06	20000	--	ND	ND	270	3300	--	--	
04/21/94	519.82	14.96	0.00	504.86	0.06	27000	--	85	65	880	5300	--	--	
07/21/94	519.82	14.99	0.00	504.83	-0.03	31000	--	58	29	940	6200	--	--	
10/19/94	519.82	14.80	0.00	505.02	0.19	4100	--	16	3.5	8.6	1100	--	--	
01/18/95	519.82	14.10	0.00	505.72	0.70	5100	--	6.8	7.3	100	1500	--	--	
04/17/95	519.82	14.13	0.00	505.69	-0.03	320	--	1.3	0.67	6.6	74	--	--	
07/18/95	519.82	14.11	0.00	505.71	0.02	12000	--	25	24	550	3700	--	--	
10/17/95	519.82	14.15	0.00	505.67	-0.04	77000	--	60	58	760	8300	220	--	
01/17/96	519.82	14.35	0.00	505.47	-0.20	7000	--	15	ND	150	1600	370	--	
04/17/96	519.82	13.93	0.00	505.89	0.42	19000	--	ND	ND	600	4900	6100	--	
07/16/96	519.82	14.00	0.00	505.82	-0.07	23000	--	16	22	900	4500	410	--	
10/16/96	519.82	14.12	0.00	505.70	-0.12	14000	--	28	31	1600	6900	9600	--	
01/13/97	519.82	--	--	--	--	4300	--	12	5.0	28	890	1300	--	
04/08/97	519.82	14.49	0.00	505.33	--	4700	--	ND	6.5	170	830	290	--	
10/06/97	519.82	14.41	0.00	505.41	0.08	5800	--	14	ND	19	860	570	--	
04/02/98	519.82	14.26	0.00	505.56	0.15	24000	--	ND	ND	980	5200	6800	--	

Table 2
HISTORIC FLUID LEVELS AND SELECTED ANALYTICAL RESULTS
November 1989 Through June 2005
76 Station 6034

Date Sampled	TOC Elevation (feet)	Depth to Water (feet)	LPH Thickness (feet)	Ground-water Elevation (feet)	Change in Elevation (feet)	TPH-G (µg/l)	TPPH 8260B (µg/l)	Benzene (µg/l)	Toluene (µg/l)	Ethyl-benzene (µg/l)	Total Xylenes (µg/l)	MTBE 8021B (µg/l)	MTBE 8260B (µg/l)	Comments
MW-2 continued														
10/07/98	519.82	14.35	0.00	505.47	-0.09	41000	--	ND	ND	2100	7800	3700	2700	
04/14/99	519.82	14.54	0.00	505.28	-0.19	720	--	1.2	ND	29	260	95	57	
10/12/99	519.82	14.50	0.00	505.32	0.04	2200	--	ND	ND	78	480	52	11	
04/10/00	519.82	14.72	0.00	505.10	-0.22	ND	--	ND	ND	0.815	2.99	28.5	40.1	
10/02/00	519.82	14.91	0.00	504.91	-0.19	ND	--	ND	ND	0.71	1.0	9.2	11	
04/02/01	519.82	14.12	0.00	505.70	0.79	ND	--	ND	ND	ND	ND	ND	ND	
10/05/01	519.82	15.02	0.00	504.80	-0.90	1300	--	4.4	ND<2.5	29	79	ND<25	12	
04/01/02	519.82	14.94	0.00	504.88	0.08	3500	--	5.1	ND<5.0	120	460	ND<50	14	
10/16/02	519.82	15.06	0.00	504.76	-0.12	240	--	ND<0.50	ND<0.50	8.2	15	--	ND<2.0	
04/03/03	519.82	14.96	0.00	504.86	0.10	1300	--	1.5	1.8	23	160	--	6.6	
10/02/03	519.82	15.11	0.00	504.71	-0.15	--	15000	ND<13	ND<13	290	1400	--	ND<50	
04/30/04	519.82	15.25	0.00	504.57	-0.14	--	8000	ND<13	ND<13	140	550	--	ND<13	
12/01/04	519.82	15.37	0.00	504.45	-0.12	--	4700	ND<1.0	ND<1.0	81	240	--	5.9	
06/13/05	519.82	15.12	0.00	504.70	0.25	--	3300	ND<0.50	ND<0.50	47	200	--	2.5	
MW-3 (Screen Interval in feet: 11.0-25.0)														
11/18/89	--	--	--	--	--	ND	--	0.35	ND	ND	ND	--	--	
03/08/90	--	--	--	--	--	ND	--	ND	ND	ND	ND	--	--	
06/05/90	--	--	--	--	--	ND	--	ND	ND	ND	ND	--	--	
09/07/90	--	--	--	--	--	1100	--	11	ND	6.6	16	--	--	
12/24/90	--	--	--	--	--	ND	--	ND	ND	ND	ND	--	--	
04/10/91	--	--	--	--	--	ND	--	ND	ND	ND	ND	--	--	
07/10/91	--	--	--	--	--	ND	--	ND	ND	ND	ND	--	--	
10/14/91	--	--	--	--	--	ND	--	ND	ND	ND	ND	--	--	
01/14/92	--	--	--	--	--	ND	--	ND	ND	ND	ND	--	--	

Table 2
HISTORIC FLUID LEVELS AND SELECTED ANALYTICAL RESULTS
November 1989 Through June 2005
76 Station 6034

Date Sampled	TOC Elevation (feet)	Depth to Water (feet)	LPH Thickness (feet)	Ground-water Elevation (feet)	Change in Elevation (feet)	TPH-G (µg/l)	TPPH 8260B (µg/l)	Benzene (µg/l)	Toluene (µg/l)	Ethylbenzene (µg/l)	Total Xylenes (µg/l)	MTBE 8021B (µg/l)	MTBE 8260B (µg/l)	Comments
MW-3 continued														
04/06/92	--	--	--	--	--	ND	--	ND	ND	ND	ND	--	--	
07/07/92	--	--	--	--	--	ND	--	ND	ND	ND	ND	--	--	
10/16/92	--	--	--	--	--	ND	--	ND	ND	ND	ND	--	--	
01/14/93	--	--	--	--	--	ND	--	ND	ND	ND	ND	--	--	
04/22/93	519.91	14.33	0.00	505.58	--	ND	--	ND	ND	ND	ND	--	--	
07/20/93	519.91	16.90	0.00	503.01	-2.57	ND	--	ND	ND	ND	ND	--	--	
10/20/93	519.66	14.42	0.00	505.24	2.23	ND	--	ND	ND	ND	ND	--	--	
01/20/94	519.66	14.37	0.00	505.29	0.05	--	--	--	--	--	--	--	--	
04/21/94	519.66	14.30	0.00	505.36	0.07	ND	--	ND	ND	ND	ND	--	--	Sampled Annually
07/21/94	519.66	14.34	0.00	505.32	-0.04	--	--	--	--	--	--	--	--	Sampled Semi-Annually
10/19/94	519.66	14.08	0.00	505.58	0.26	ND	--	ND	0.61	ND	0.51	--	--	
01/18/95	519.66	13.23	0.00	506.43	0.85	--	--	--	--	--	--	--	--	
04/17/95	519.66	13.20	0.00	506.46	0.03	ND	--	ND	ND	ND	ND	--	--	
07/18/95	519.66	13.19	0.00	506.47	0.01	--	--	--	--	--	--	--	--	
10/17/95	519.66	13.24	0.00	506.42	-0.05	ND	--	ND	ND	ND	ND	ND	--	Sampled Annually
01/17/96	519.66	13.68	0.00	505.98	-0.44	--	--	--	--	--	--	--	--	
04/17/96	519.66	13.04	0.00	506.62	0.64	ND	--	ND	ND	ND	ND	ND	--	
07/16/96	519.66	13.24	0.00	506.42	-0.20	--	--	--	--	--	--	--	--	
10/16/96	519.66	13.10	0.00	506.56	0.14	--	--	--	--	--	--	--	--	
04/08/97	519.66	13.73	0.00	505.93	-0.63	--	--	--	--	--	--	--	--	
10/06/97	519.66	13.70	0.00	505.96	0.03	--	--	--	--	--	--	--	--	Sampling Discontinued
04/02/98	519.66	13.43	0.00	506.23	0.27	--	--	--	--	--	--	--	--	
10/07/98	519.66	13.33	0.00	506.33	0.10	--	--	--	--	--	--	--	--	
04/14/99	519.66	13.47	0.00	506.19	-0.14	--	--	--	--	--	--	--	--	

Table 2
HISTORIC FLUID LEVELS AND SELECTED ANALYTICAL RESULTS
November 1989 Through June 2005
76 Station 6034

Date Sampled	TOC Elevation (feet)	Depth to Water (feet)	LPH Thickness (feet)	Ground-water Elevation (feet)	Change in Elevation (feet)	TPH-G (µg/l)	TPPH 8260B (µg/l)	Benzene (µg/l)	Toluene (µg/l)	Ethyl-benzene (µg/l)	Total Xylenes (µg/l)	MTBE 8021B (µg/l)	MTBE 8260B (µg/l)	Comments
MW-3 continued														
10/12/99	519.66	13.38	0.00	506.28	0.09	--	--	--	--	--	--	--	--	
04/10/00	519.66	13.51	0.00	506.15	-0.13	--	--	--	--	--	--	--	--	
10/02/00	519.66	13.62	0.00	506.04	-0.11	--	--	--	--	--	--	--	--	
04/02/01	519.66	13.38	0.00	506.28	0.24	--	--	--	--	--	--	--	--	
10/05/01	519.66	14.10	0.00	505.56	-0.72	--	--	--	--	--	--	--	--	
04/01/02	519.66	13.98	0.00	505.68	0.12	--	--	--	--	--	--	--	--	
10/16/02	519.66	14.16	0.00	505.50	-0.18	--	--	--	--	--	--	--	--	
04/03/03	519.66	13.98	0.00	505.68	0.18	--	--	--	--	--	--	--	--	
10/02/03	519.66	14.15	0.00	505.51	-0.17	--	--	--	--	--	--	--	--	Monitored Only
04/30/04	519.66	14.20	0.00	505.46	-0.05	--	--	--	--	--	--	--	--	Monitored only
12/01/04	519.66	14.37	0.00	505.29	-0.17	--	--	--	--	--	--	--	--	Sampled Semi-Annually
06/13/05	519.66	13.98	0.00	505.68	0.39	--	--	--	--	--	--	--	--	Monitored Only
MW-4 (Screen Interval in feet: 11.0-25.0)														
11/18/89	--	--	--	--	--	990	--	9.8	10	7.1	4.7	--	--	
03/08/90	--	--	--	--	--	1200	--	18	8.4	37	28	--	--	
06/05/90	--	--	--	--	--	1400	--	1.2	4.7	24	12	--	--	
09/07/90	--	--	--	--	--	15000	--	100	140	210	4600	--	--	
12/24/90	--	--	--	--	--	1400	--	ND	8.7	15	10	--	--	
04/10/91	--	--	--	--	--	950	--	0.84	4.3	9.6	5.0	--	--	
07/10/91	--	--	--	--	--	830	--	8.4	19	7.7	7.2	--	--	
10/14/91	--	--	--	--	--	880	--	3.8	2.2	8.6	5.8	--	--	
01/14/92	--	--	--	--	--	1500	--	4.2	7.1	18	9.2	--	--	
04/06/92	--	--	--	--	--	660	--	1.3	3.8	2.9	4.1	--	--	
07/07/92	--	--	--	--	--	340	--	ND	2.2	2.4	2.4	--	--	

Table 2
HISTORIC FLUID LEVELS AND SELECTED ANALYTICAL RESULTS
November 1989 Through June 2005
76 Station 6034

Date Sampled	TOC Elevation (feet)	Depth to Water (feet)	LPH Thickness (feet)	Ground-water Elevation (feet)	Change in Elevation (feet)	TPH-G (µg/l)	TPPH 8260B (µg/l)	Benzene (µg/l)	Toluene (µg/l)	Ethyl-benzene (µg/l)	Total Xylenes (µg/l)	MTBE 8021B (µg/l)	MTBE 8260B (µg/l)	Comments
MW-4 continued														
10/16/92	--	--	--	--	--	300	--	2.1	ND	4.8	13	--	--	
01/14/93	--	--	--	--	--	920	--	ND	6.3	12	3.9	--	--	
04/22/93	520.12	14.30	0.00	505.82	--	1100	--	8.8	1.0	7.2	6.0	--	--	
07/20/93	520.12	16.35	0.00	503.77	-2.05	--	--	--	--	--	--	--	--	Not sampled - Sampling access denied
10/20/93	519.61	14.16	0.00	505.45	1.68	640	--	ND	2.5	2.3	1.9	--	--	
01/20/94	519.61	14.15	0.00	505.46	0.01	1200	--	ND	2.6	4.7	7.4	--	--	
04/21/94	519.61	14.13	0.00	505.48	0.02	380	--	0.83	1.2	1.2	1.7	--	--	
07/21/94	519.61	14.26	0.00	505.35	-0.13	320	--	0.51	1.4	1.0	1.6	--	--	
10/19/94	519.61	13.95	0.00	505.66	0.31	750	--	ND	3.6	4.2	3.4	--	--	
01/18/95	519.61	13.16	0.00	506.45	0.79	790	--	1.5	3.3	1.2	2.6	--	--	
04/17/95	519.61	13.19	0.00	506.42	-0.03	570	--	2.8	ND	3.3	3.9	--	--	
07/18/95	519.61	13.21	0.00	506.40	-0.02	340	--	1.0	1.9	2.8	2.7	--	--	
10/17/95	519.61	13.22	0.00	506.39	-0.01	260	--	1.1	0.57	0.69	1.6	2.0	--	
01/17/96	519.61	13.02	0.00	506.59	0.20	--	--	--	--	--	--	--	--	Sampled Semi-Annually
04/17/96	519.61	13.08	0.00	506.53	-0.06	720	--	3.0	2.6	6.1	6.9	ND	--	
07/16/96	519.61	12.91	0.00	506.70	0.17	--	--	--	--	--	--	--	--	
10/16/96	519.61	12.98	0.00	506.63	-0.07	1100	--	6.6	23	24	85	15	--	
01/13/97	519.61	--	0.00	--	--	--	--	--	--	--	--	--	--	
04/08/97	519.61	13.36	0.00	506.25	--	470	--	1.2	1.9	1.2	6.9	ND	--	
10/06/97	519.61	13.42	0.00	506.19	-0.06	240	--	ND	0.85	0.83	2.3	ND	--	
04/02/98	519.61	12.76	0.00	506.85	0.66	270	--	ND	1.2	ND	4.5	10	--	
10/07/98	519.61	13.04	0.00	506.57	-0.28	350	--	ND	ND	ND	4.8	ND	--	
04/14/99	519.61	13.21	0.00	506.40	-0.17	250	--	1.6	ND	3.1	5.6	ND	16	

Table 2
HISTORIC FLUID LEVELS AND SELECTED ANALYTICAL RESULTS
November 1989 Through June 2005
76 Station 6034

Date Sampled	TOC Elevation (feet)	Depth to Water (feet)	LPH Thickness (feet)	Ground-water Elevation (feet)	Change in Elevation (feet)	TPH-G (µg/l)	TPPH 8260B (µg/l)	Benzene (µg/l)	Toluene (µg/l)	Ethyl-benzene (µg/l)	Total Xylenes (µg/l)	MTBE 8021B (µg/l)	MTBE 8260B (µg/l)	Comments
MW-4 continued														
10/12/99	519.61	13.16	0.00	506.45	0.05	200	--	1.4	ND	2.3	3.9	ND	--	
04/10/00	519.61	13.48	0.00	506.13	-0.32	52.8	--	ND	ND	ND	ND	ND	--	
10/02/00	519.61	13.25	0.00	506.36	0.23	57	--	ND	ND	0.50	0.90	30	--	
04/02/01	519.61	13.11	0.00	506.50	0.14	ND	--	ND	ND	ND	ND	ND	--	
10/05/01	519.61	14.04	0.00	505.57	-0.93	150	--	ND<0.50	ND<0.50	ND<0.50	ND<0.50	ND<5.0	--	
04/01/02	519.61	13.76	0.00	505.85	0.28	130	--	ND<0.50	ND<0.50	ND<0.50	ND<0.50	ND<5.0	--	
10/16/02	519.61	14.10	0.00	505.51	-0.34	130	--	ND<0.50	ND<0.50	ND<0.50	ND<1.0	--	3.8	
04/03/03	519.61	13.69	0.00	505.92	0.41	ND<50	--	ND<0.50	ND<0.50	ND<0.50	ND<1.0	--	3.6	
10/02/03	519.61	14.20	0.00	505.41	-0.51	--	81	ND<0.50	0.86	4.1	9.4	--	ND<2.0	
04/30/04	519.61	14.12	0.00	505.49	0.08	--	51	ND<0.50	ND<0.50	ND<0.50	ND<1.0	--	1.5	
12/01/04	519.61	14.17	0.00	505.44	-0.05	--	130	ND<0.50	ND<0.50	ND<0.50	ND<1.0	--	1.6	
06/13/05	519.61	13.68	0.00	505.93	0.49	--	69	ND<0.50	ND<0.50	ND<0.50	ND<1.0	--	0.60	
MW-5 (Screen Interval in feet: 10.0-24.0)														
04/10/91	--	--	--	--	--	630	--	35	14	47	30	--	--	
07/10/91	--	--	--	--	--	220	--	5.1	8.7	9.1	9.7	--	--	
10/14/91	--	--	--	--	--	660	--	55	4.4	50	66	--	--	
01/14/92	--	--	--	--	--	99	--	1.0	1.2	ND	0.32	1.2	--	
04/06/92	--	--	--	--	--	240	--	ND	ND	0.35	ND	--	--	
07/07/92	--	--	--	--	--	76	--	0.48	1.1	0.32	1.3	1.5	--	
10/16/92	--	--	--	--	--	180	--	7.8	1.1	17	6.4	2.0	--	
01/14/93	--	--	--	--	--	91	--	ND	0.53	1.2	11	--	--	
04/22/93	520.58	15.24	0.00	505.34	--	94	--	1.2	ND	ND	1.3	0.82	--	
07/20/93	520.58	17.38	0.00	503.20	-2.14	89	--	1.1	0.51	ND	1.8	2.2	--	
10/20/93	520.27	15.56	0.00	504.71	1.51	110	--	0.8	ND	ND	ND	--	--	

Table 2
HISTORIC FLUID LEVELS AND SELECTED ANALYTICAL RESULTS
November 1989 Through June 2005
76 Station 6034

Date Sampled	TOC Elevation (feet)	Depth to Water (feet)	LPH Thickness (feet)	Ground-water Elevation (feet)	Change in Elevation (feet)	TPH-G (µg/l)	TPPH 8260B (µg/l)	Benzene (µg/l)	Toluene (µg/l)	Ethyl-benzene (µg/l)	Total Xylenes (µg/l)	MTBE 8021B (µg/l)	MTBE 8260B (µg/l)	Comments
MW-5 continued														
01/20/94	520.27	15.39	0.00	504.88	0.17	ND	--	ND	ND	ND	ND	--	--	
04/21/94	520.27	15.41	0.00	504.86	-0.02	ND	--	ND	ND	ND	ND	--	--	
07/21/94	520.27	15.55	0.00	504.72	-0.14	ND	--	ND	ND	ND	ND	--	--	
10/19/94	520.27	15.20	0.00	505.07	0.35	ND	--	ND	0.71	ND	0.57	--	--	
01/18/95	520.27	14.52	0.00	505.75	0.68	ND	--	ND	ND	ND	ND	--	--	
04/17/95	520.27	14.50	0.00	505.77	0.02	ND	--	ND	ND	ND	ND	--	--	
07/18/95	520.27	14.41	0.00	505.86	0.09	ND	--	ND	ND	ND	1.1	--	--	
10/17/95	520.27	14.46	0.00	505.81	-0.05	ND	--	ND	ND	ND	ND	ND	--	
01/17/96	520.27	14.48	0.00	505.79	-0.02	--	--	--	--	--	--	--	--	Sampled Annually
04/17/96	520.27	14.22	0.00	506.05	0.26	ND	--	ND	ND	ND	ND	ND	--	
07/16/96	520.27	14.27	0.00	506.00	-0.05	--	--	--	--	--	--	--	--	
10/16/96	520.27	14.15	0.00	506.12	0.12	--	--	--	--	--	--	--	--	
04/08/97	520.27	14.71	0.00	505.56	-0.56	--	--	--	--	--	--	--	--	Sampling Discontinued
10/06/97	520.27	14.71	0.00	505.56	0.00	--	--	--	--	--	--	--	--	
04/02/98	520.27	14.28	0.00	505.99	0.43	--	--	--	--	--	--	--	--	
10/07/98	520.27	14.40	0.00	505.87	-0.12	--	--	--	--	--	--	--	--	
04/14/99	520.27	14.63	0.00	505.64	-0.23	--	--	--	--	--	--	--	--	
10/12/99	520.27	14.48	0.00	505.79	0.15	--	--	--	--	--	--	--	--	
04/10/00	520.27	14.76	0.00	505.51	-0.28	--	--	--	--	--	--	--	--	
10/02/00	520.27	14.65	0.00	505.62	0.11	--	--	--	--	--	--	--	--	
04/02/01	520.27	14.20	0.00	506.07	0.45	--	--	--	--	--	--	--	--	
10/05/01	520.27	15.47	0.00	504.80	-1.27	--	--	--	--	--	--	--	--	
04/01/02	520.27	15.18	0.00	505.09	0.29	--	--	--	--	--	--	--	--	
10/16/02	520.27	15.50	0.00	504.77	-0.32	--	--	--	--	--	--	--	--	

Table 2
HISTORIC FLUID LEVELS AND SELECTED ANALYTICAL RESULTS
November 1989 Through June 2005
76 Station 6034

Date Sampled	TOC Elevation (feet)	Depth to Water (feet)	LPH Thickness (feet)	Ground-water Elevation (feet)	Change in Elevation (feet)	TPH-G (µg/l)	TPPH 8260B (µg/l)	Benzene (µg/l)	Toluene (µg/l)	Ethylbenzene (µg/l)	Total Xylenes (µg/l)	MTBE 8021B (µg/l)	MTBE 8260B (µg/l)	Comments
MW-5 continued														
04/03/03	520.27	15.14	0.00	505.13	0.36	--	--	--	--	--	--	--	--	
10/02/03	520.27	15.66	0.00	504.61	-0.52	--	--	--	--	--	--	--	--	Monitored Only
04/30/04	520.27	15.55	0.00	504.72	0.11	--	--	--	--	--	--	--	--	Monitored only
12/01/04	520.27	15.62	0.00	504.65	-0.07	--	--	--	--	--	--	--	--	Sampled Semi-Annually
06/13/05	520.27	15.31	0.00	504.96	0.31	--	--	--	--	--	--	--	--	Monitored Only
MW-6 (Screen Interval in feet: 10.0-24.0)														
04/10/91	--	--	--	--	--	ND	--	ND	ND	ND	ND	--	--	
07/10/91	--	--	--	--	--	ND	--	ND	ND	ND	ND	--	--	
10/14/91	--	--	--	--	--	ND	--	ND	ND	ND	ND	--	--	
01/14/92	--	--	--	--	--	ND	--	ND	ND	ND	ND	--	--	
04/06/92	--	--	--	--	--	ND	--	ND	ND	ND	ND	--	--	
07/07/92	--	--	--	--	--	ND	--	ND	ND	ND	ND	--	--	
10/16/92	--	--	--	--	--	--	--	--	--	--	--	--	--	Obstructed
01/14/93	--	--	--	--	--	--	--	--	--	--	--	--	--	Obstructed
04/22/93	519.34	--	0.00	--	--	--	--	--	--	--	--	--	--	Obstructed
07/20/93	519.34	--	0.00	--	--	--	--	--	--	--	--	--	--	Obstructed
10/20/93	518.75	14.20	0.00	504.55	--	ND	--	ND	ND	ND	ND	--	--	Obstructed
01/20/94	518.75	14.14	0.00	504.61	0.06	ND	--	ND	ND	ND	ND	--	--	
04/21/94	518.75	14.10	0.00	504.65	0.04	ND	--	ND	ND	ND	ND	--	--	
07/21/94	518.75	14.12	0.00	504.63	-0.02	ND	--	ND	ND	ND	ND	--	--	
10/19/94	518.75	--	--	--	--	--	--	--	--	--	--	--	--	
01/18/95	518.75	--	--	--	--	--	--	--	--	--	--	--	--	Obstructed by roots
04/17/95	518.75	13.82	0.00	504.93	--	ND	--	ND	ND	ND	ND	--	--	Obstructed by roots
07/18/95	518.75	13.84	0.00	504.91	-0.02	ND	--	ND	ND	ND	ND	--	--	

Table 2
HISTORIC FLUID LEVELS AND SELECTED ANALYTICAL RESULTS
November 1989 Through June 2005
76 Station 6034

Date Sampled	TOC Elevation (feet)	Depth to Water (feet)	LPH Thickness (feet)	Ground-water Elevation (feet)	Change in Elevation (feet)	TPH-G (µg/l)	TPPH 8260B (µg/l)	Benzene (µg/l)	Toluene (µg/l)	Ethyl-benzene (µg/l)	Total Xylenes (µg/l)	MTBE 8021B (µg/l)	MTBE 8260B (µg/l)	Comments
MW-6 continued														
10/17/95	518.75	13.90	0.00	504.85	-0.06	ND	--	ND	ND	ND	ND	2.2	--	
01/17/96	518.75	--	--	--	--	--	--	--	--	--	--	--	--	Sampled Annually - Obstructed by roots
04/17/96	518.75	13.66	0.00	505.09	--	ND	--	ND	ND	ND	ND	ND	--	
07/16/96	518.75	--	--	--	--	--	--	--	--	--	--	--	--	Obstructed by roots
10/16/96	518.75	13.72	0.00	505.03	--	--	--	--	--	--	--	--	--	
04/08/97	518.75	--	--	--	--	--	--	--	--	--	--	--	--	Obstructed by roots
10/06/97	518.75	--	--	--	--	--	--	--	--	--	--	--	--	Obstructed by roots
04/02/98	518.75	--	--	--	--	--	--	--	--	--	--	--	--	Obstructed by roots
10/07/98	518.75	--	--	--	--	--	--	--	--	--	--	--	--	Obstructed by roots
04/14/99	518.75	13.82	0.00	504.93	--	--	--	--	--	--	--	--	--	
10/12/99	518.75	13.72	0.00	505.03	0.10	--	--	--	--	--	--	--	--	
04/10/00	518.75	13.40	0.00	505.35	0.32	--	--	--	--	--	--	--	--	
10/02/00	518.75	13.63	0.00	505.12	-0.23	--	--	--	--	--	--	--	--	
04/02/01	518.75	13.31	0.00	505.44	0.32	--	--	--	--	--	--	--	--	
10/05/01	518.75	--	--	--	--	--	--	--	--	--	--	--	--	
04/01/02	518.75	--	--	--	--	--	--	--	--	--	--	--	--	Obstruction in Well
10/16/02	518.75	--	--	--	--	--	--	--	--	--	--	--	--	Obstruction in Well
04/03/03	518.75	--	--	--	--	--	--	--	--	--	--	--	--	Dry
10/02/03	518.75	--	--	--	--	--	--	--	--	--	--	--	--	Dry
04/30/04	518.75	--	--	--	--	--	--	--	--	--	--	--	--	Inaccessible
12/01/04	518.75	--	--	--	--	--	--	--	--	--	--	--	--	Unable to locate
06/13/05	518.75	--	--	--	--	--	--	--	--	--	--	--	--	Dry well
														Dry well

MW-7 (Screen Interval in feet: 10.0-24.0)

Table 2
HISTORIC FLUID LEVELS AND SELECTED ANALYTICAL RESULTS
November 1989 Through June 2005
76 Station 6034

Date Sampled	TOC Elevation (feet)	Depth to Water (feet)	LPH Thickness (feet)	Ground-water Elevation (feet)	Change in Elevation (feet)	TPH-G (µg/l)	TPPH 8260B (µg/l)	Benzene (µg/l)	Toluene (µg/l)	Ethylbenzene (µg/l)	Total Xylenes (µg/l)	MTBE 8021B (µg/l)	MTBE 8260B (µg/l)	Comments
MW-7 continued														
04/10/91	--	--	--	--	--	ND	--	ND	ND	ND	ND	--	--	
07/10/91	--	--	--	--	--	ND	--	ND	ND	ND	ND	--	--	
10/14/91	--	--	--	--	--	ND	--	ND	ND	ND	ND	--	--	
01/14/92	--	--	--	--	--	ND	--	ND	ND	ND	ND	--	--	
04/06/92	--	--	--	--	--	ND	--	ND	ND	ND	ND	--	--	
07/07/92	--	--	--	--	--	ND	--	ND	ND	ND	ND	--	--	
10/16/92	--	--	--	--	--	ND	--	ND	ND	ND	ND	--	--	
01/14/93	--	--	--	--	--	ND	--	ND	ND	ND	ND	--	--	
04/22/93	519.37	14.25	0.00	505.12	--	ND	--	ND	ND	ND	ND	--	--	
07/20/93	519.37	16.68	0.00	502.69	-2.43	ND	--	ND	ND	ND	ND	--	--	
10/20/93	518.83	14.29	0.00	504.54	1.85	ND	--	ND	ND	ND	ND	--	--	
01/20/94	518.83	14.22	0.00	504.61	0.07	ND	--	ND	ND	ND	ND	--	--	
04/21/94	518.83	14.17	0.00	504.66	0.05	ND	--	ND	ND	ND	ND	--	--	
07/21/94	518.83	14.21	0.00	504.62	-0.04	ND	--	ND	ND	ND	ND	--	--	
10/19/94	518.83	14.05	0.00	504.78	0.16	ND	--	ND	0.87	ND	0.61	--	--	
01/18/95	518.83	13.34	0.00	505.49	0.71	ND	--	ND	ND	ND	ND	--	--	
04/17/95	518.83	13.38	0.00	505.45	-0.04	ND	--	ND	ND	ND	ND	--	--	
07/18/95	518.83	13.36	0.00	505.47	0.02	ND	--	ND	ND	ND	ND	--	--	
10/17/95	518.83	13.41	0.00	505.42	-0.05	ND	--	ND	ND	ND	ND	3.5	--	
01/17/96	518.83	13.56	0.00	505.27	-0.15	--	--	--	--	--	--	--	--	
04/17/96	518.83	13.21	0.00	505.62	0.35	ND	--	ND	ND	ND	ND	ND	--	Sampled Annually
07/16/96	518.83	13.22	0.00	505.61	-0.01	--	--	--	--	--	--	--	--	
10/16/96	518.83	13.58	0.00	505.25	-0.36	--	--	--	--	--	--	--	--	
04/08/97	518.83	13.73	0.00	505.10	-0.15	--	--	--	--	--	--	--	--	Sampling Discontinued

Table 2
HISTORIC FLUID LEVELS AND SELECTED ANALYTICAL RESULTS
November 1989 Through June 2005
76 Station 6034

Date Sampled	TOC Elevation (feet)	Depth to Water (feet)	LPH Thickness (feet)	Ground-water Elevation (feet)	Change in Elevation (feet)	TPH-G (µg/l)	TPPH 8260B (µg/l)	Benzene (µg/l)	Toluene (µg/l)	Ethyl-benzene (µg/l)	Total Xylenes (µg/l)	MTBE 8021B (µg/l)	MTBE 8260B (µg/l)	Comments
MW-7 continued														
10/06/97	518.83	13.65	0.00	505.18	0.08	--	--	--	--	--	--	--	--	
04/02/98	518.83	13.55	0.00	505.28	0.10	--	--	--	--	--	--	--	--	
10/07/98	518.83	13.64	0.00	505.19	-0.09	--	--	--	--	--	--	--	--	
04/14/99	518.83	13.75	0.00	505.08	-0.11	--	--	--	--	--	--	--	--	
10/12/99	518.83	13.61	0.00	505.22	0.14	--	--	--	--	--	--	--	--	
04/10/00	518.83	13.85	0.00	504.98	-0.24	--	--	--	--	--	--	--	--	
10/02/00	518.83	14.19	0.00	504.64	-0.34	--	--	--	--	--	--	--	--	
04/02/01	518.83	13.86	0.00	504.97	0.33	--	--	--	--	--	--	--	--	Sampling Discontinued
10/05/01	518.83	14.30	0.00	504.53	-0.44	--	--	--	--	--	--	--	--	
04/01/02	518.83	14.23	0.00	504.60	0.07	--	--	--	--	--	--	--	--	
10/16/02	518.83	14.30	0.00	504.53	-0.07	--	--	--	--	--	--	--	--	
04/03/03	518.83	14.27	0.00	504.56	0.03	--	--	--	--	--	--	--	--	
10/02/03	518.83	14.35	0.00	504.48	-0.08	--	--	--	--	--	--	--	--	Monitored Only
04/30/04	518.83	14.35	0.00	504.48	0.00	--	--	--	--	--	--	--	--	Monitored only
12/01/04	518.83	14.66	0.00	504.17	-0.31	--	--	--	--	--	--	--	--	Sampled Semi-Annually
06/13/05	518.83	15.47	0.00	503.36	-0.81	--	--	--	--	--	--	--	--	Monitored Only

Table 3
ADDITIONAL ANALYTICAL RESULTS
76 Station 6034

Date Sampled	EDC (µg/l)	Chloro- form (µg/l)	TCE (µg/l)	EDB (µg/l)	Pre-Purge DO (mg/l)	Post Purge DO (mg/l)	TAME 8260B (µg/l)	TBA 8260B (µg/l)	DIPE 8260B (µg/l)	ETBE 8260B (µg/l)	Ethanol 8260B (µg/l)	TOG (mg/l)
MW-1												
03/08/90	--	ND	ND	--	--	--	--	--	--	--	--	4.7
06/05/90	--	ND	ND	--	--	--	--	--	--	--	--	ND
09/07/90	--	ND	ND	--	--	--	--	--	--	--	--	ND
12/24/90	--	ND	ND	--	--	--	--	--	--	--	--	ND
04/10/91	--	ND	ND	--	--	--	--	--	--	--	--	ND
07/10/91	--	ND	ND	--	--	--	--	--	--	--	--	ND
04/21/94	--	ND	ND	--	--	--	--	--	--	--	--	ND
04/17/95	--	0.69	ND	--	--	--	--	--	--	--	--	ND
04/17/96	--	ND	ND	--	--	--	--	--	--	--	--	ND
07/16/96	--	--	--	--	4.24	4.28	--	--	--	--	--	--
MW-2												
07/18/95	--	--	--	--	--	4.22	--	--	--	--	--	--
10/17/95	--	--	--	--	--	3.96	--	--	--	--	--	--
01/17/96	--	--	--	--	--	5.25	--	--	--	--	--	--
04/17/96	--	--	--	--	--	2.59	--	--	--	--	--	--
07/16/96	--	--	--	--	4.46	4.35	--	--	--	--	--	--
10/16/96	--	--	--	--	3.87	2.92	--	--	--	--	--	--
01/13/97	--	--	--	--	4.76	--	--	--	--	--	--	--
04/08/97	--	--	--	--	3.76	3.42	--	--	--	--	--	--
10/06/97	--	--	--	--	4.13	3.59	--	--	--	--	--	--
04/02/98	--	--	--	--	6.32	3.16	--	--	--	--	--	--
10/07/98	--	--	--	--	3.85	--	--	--	--	--	--	--
04/14/99	ND	--	--	ND	3.14	--	ND	ND	ND	ND	ND	--
10/12/99	--	--	--	--	2.96	--	ND	ND	ND	ND	ND	--
04/10/00	ND	--	--	ND	3.47	--	ND	ND	ND	ND	ND	--
10/02/00	ND	--	--	ND	3.77	--	ND	ND	ND	ND	ND	--

Table 3
ADDITIONAL ANALYTICAL RESULTS
76 Station 6034

Date Sampled	EDC (µg/l)	Chloro- form (µg/l)	TCE (µg/l)	EDB (µg/l)	Pre-Purge DO (mg/l)	Post Purge DO (mg/l)	TAME 8260B (µg/l)	TBA 8260B (µg/l)	DIPE 8260B (µg/l)	ETBE 8260B (µg/l)	Ethanol 8260B (µg/l)	TOG (mg/l)
MW-2 continued												
04/02/01	ND	--	--	ND	3.95	--	ND	ND	ND	ND	ND	--
10/05/01	ND<2	--	--	ND<2	2.89	--	ND<2	ND<100	ND<2	ND<2	ND<1000	--
04/01/02	ND<2	--	--	ND<2	3.15	--	ND<2	ND<100	ND<2	ND<2	ND<500	--
10/16/02	ND<2	--	--	ND<2	3.08	--	ND<2	ND<100	ND<2	ND<2	ND<500	--
04/03/03	ND<2	--	--	ND<2	2.60	--	ND<2	ND<100	ND<2	ND<2	ND<500	--
10/02/03	ND<50	--	--	ND<50	--	--	ND<50	ND<2500	ND<50	ND<50	ND<13000	--
04/30/04	ND<13	--	--	ND<13	--	--	ND<13	ND<130	ND<25	ND<13	ND<1300	--
12/01/04	ND<1.0	--	--	ND<1.0	--	--	ND<1.0	32	ND<2.0	ND<1.0	ND<100	--
06/13/05	ND<0.50	--	--	ND<0.50	--	--	ND<0.50	9.6	ND<0.50	ND<0.50	ND<50	--
MW-3												
07/16/96	--	--	--	--	4.19	4.20	--	--	--	--	--	--
MW-4												
07/16/96	--	--	--	--	4.25	4.30	--	--	--	--	--	--
01/13/97	--	--	--	--	4.97	--	--	--	--	--	--	--
04/14/99	ND	--	--	ND	--	--	ND	ND	ND	ND	ND	--
10/02/03	--	--	--	--	--	--	--	--	--	--	ND<500	--
04/30/04	--	--	--	--	--	--	--	--	--	--	ND<50	--
12/01/04	--	--	--	--	--	--	--	--	--	--	ND<50	--
06/13/05	--	--	--	--	--	--	--	--	--	--	ND<50	--
MW-5												
07/16/96	--	--	--	--	4.18	4.21	--	--	--	--	--	--
MW-7												
07/16/96	--	--	--	--	4.20	4.19	--	--	--	--	--	--

FIGURES

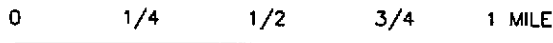
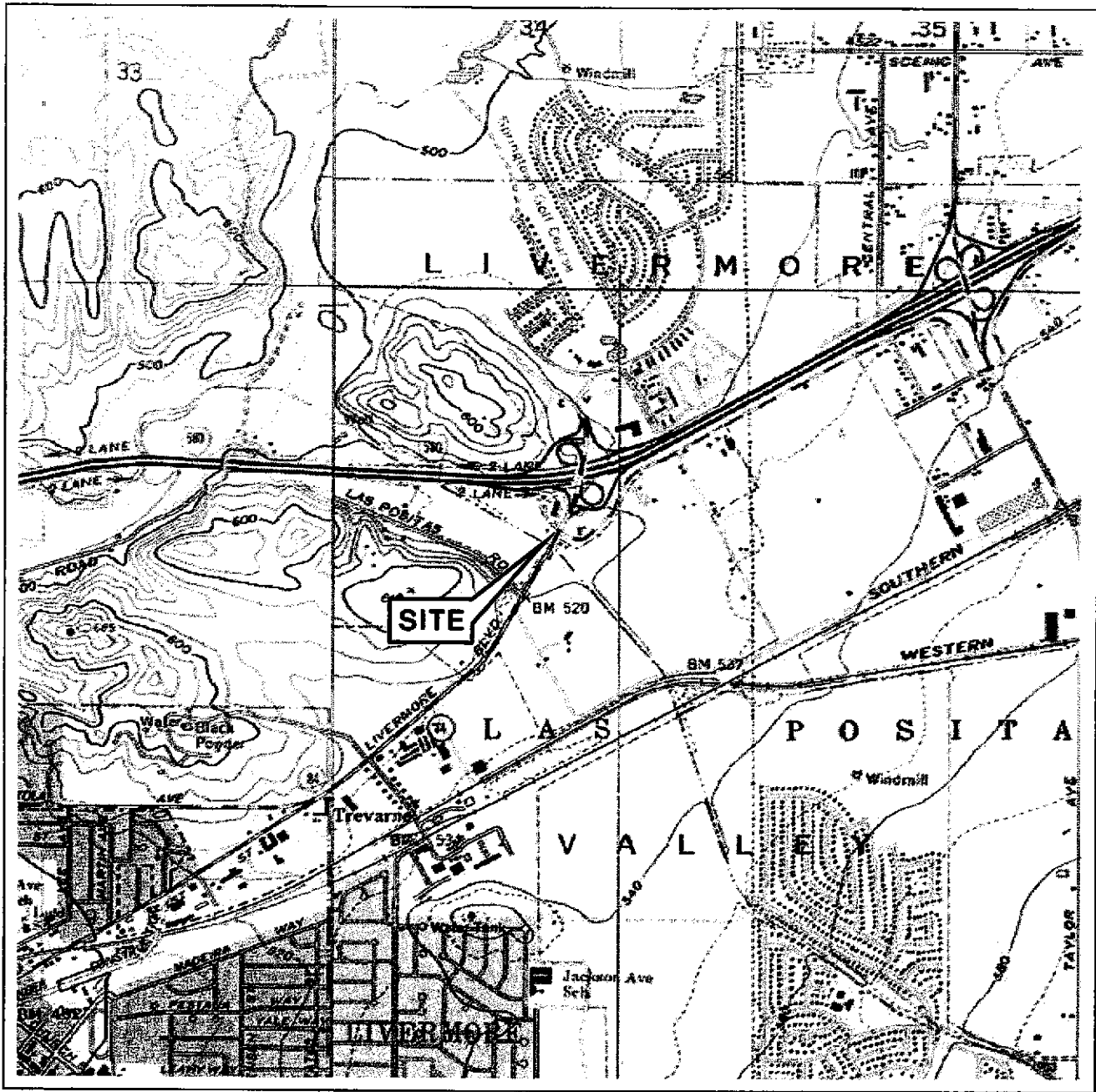

SCALE 1:24,000



SOURCE:

United States Geological Survey
7.5 Minute Topographic Map:
Livermore & Altamont Quadrangles



QUADRANGLE
LOCATION

VICINITY MAP

76 Station 6034
4700 First Street
Livermore, California

FIGURE 1

TRC

PS = 1:1

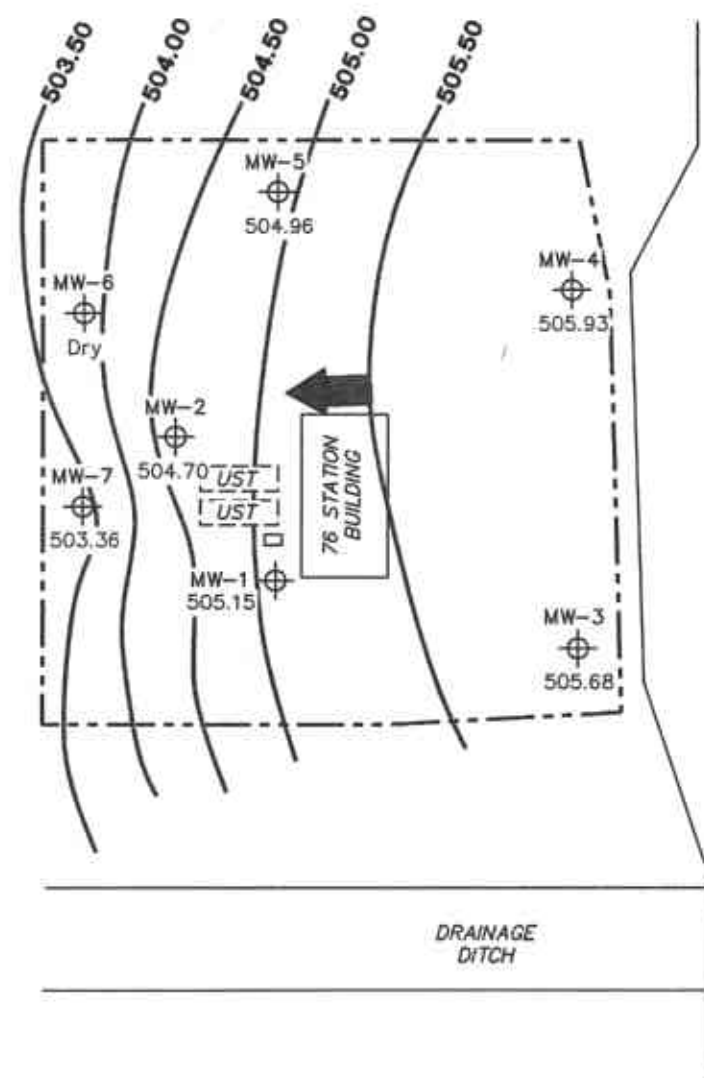

FIRST STREET

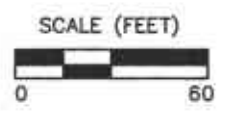
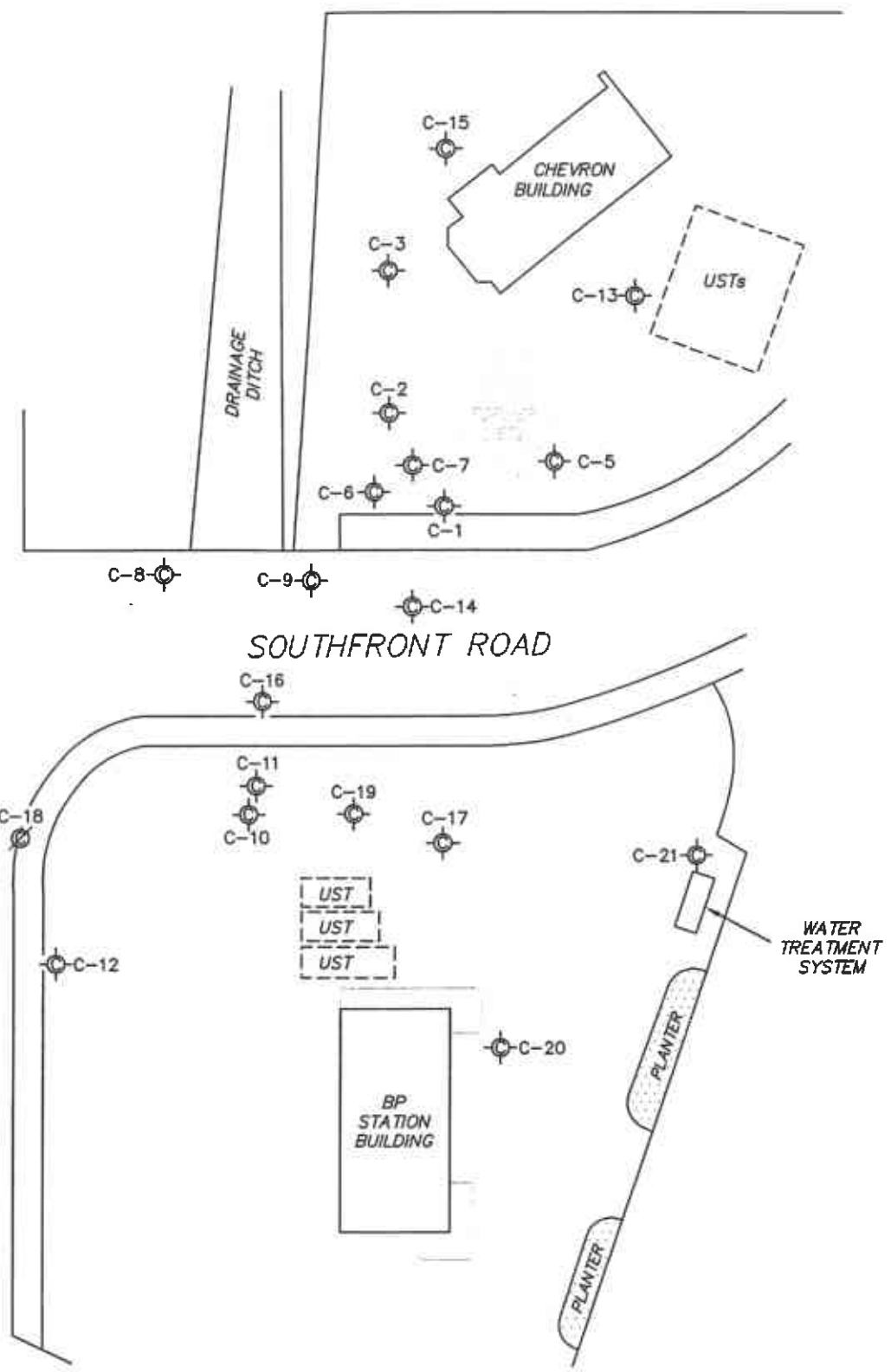

LEGEND

- MW-7 ⊕ Monitoring Well with Groundwater Elevation (feet)
- C-21 ⊕ Chevron Monitoring Well
- C-18 ⊕ Abandoned Chevron Well
- 505.50 — Groundwater Elevation Contour
- ➔ General Direction of Groundwater Flow

NOTES:
 Contour lines are interpretive and based on fluid levels measured in monitoring wells. Elevations are in feet above mean sea level. UST = underground storage tank.

GROUNDWATER ELEVATION CONTOUR MAP
 June 13, 2005

76 Station 6034
 4700 First Street
 Livermore, California

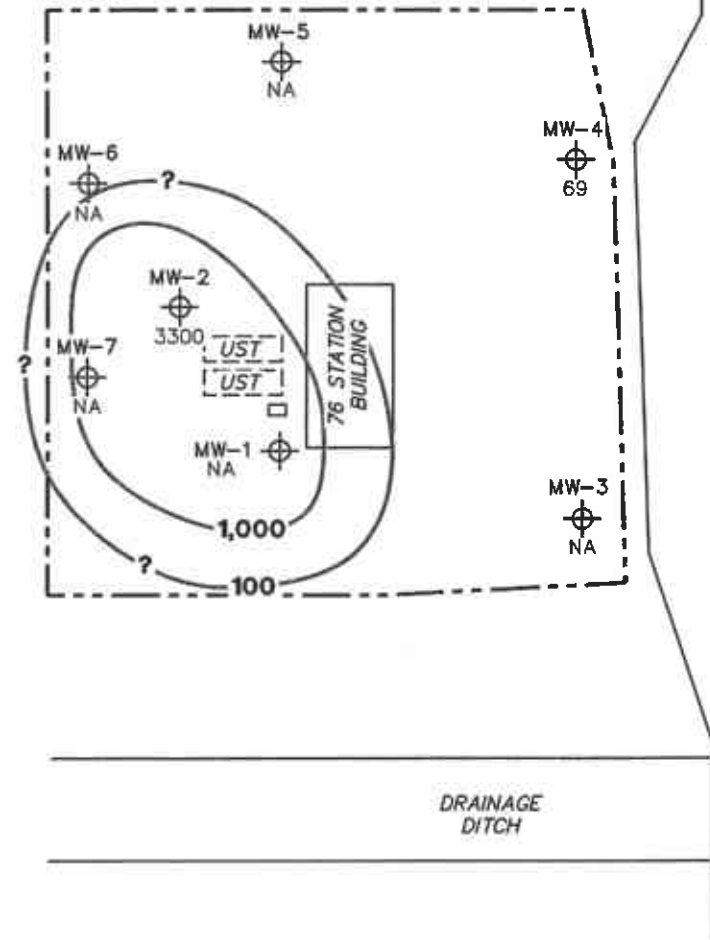

FIRST STREET

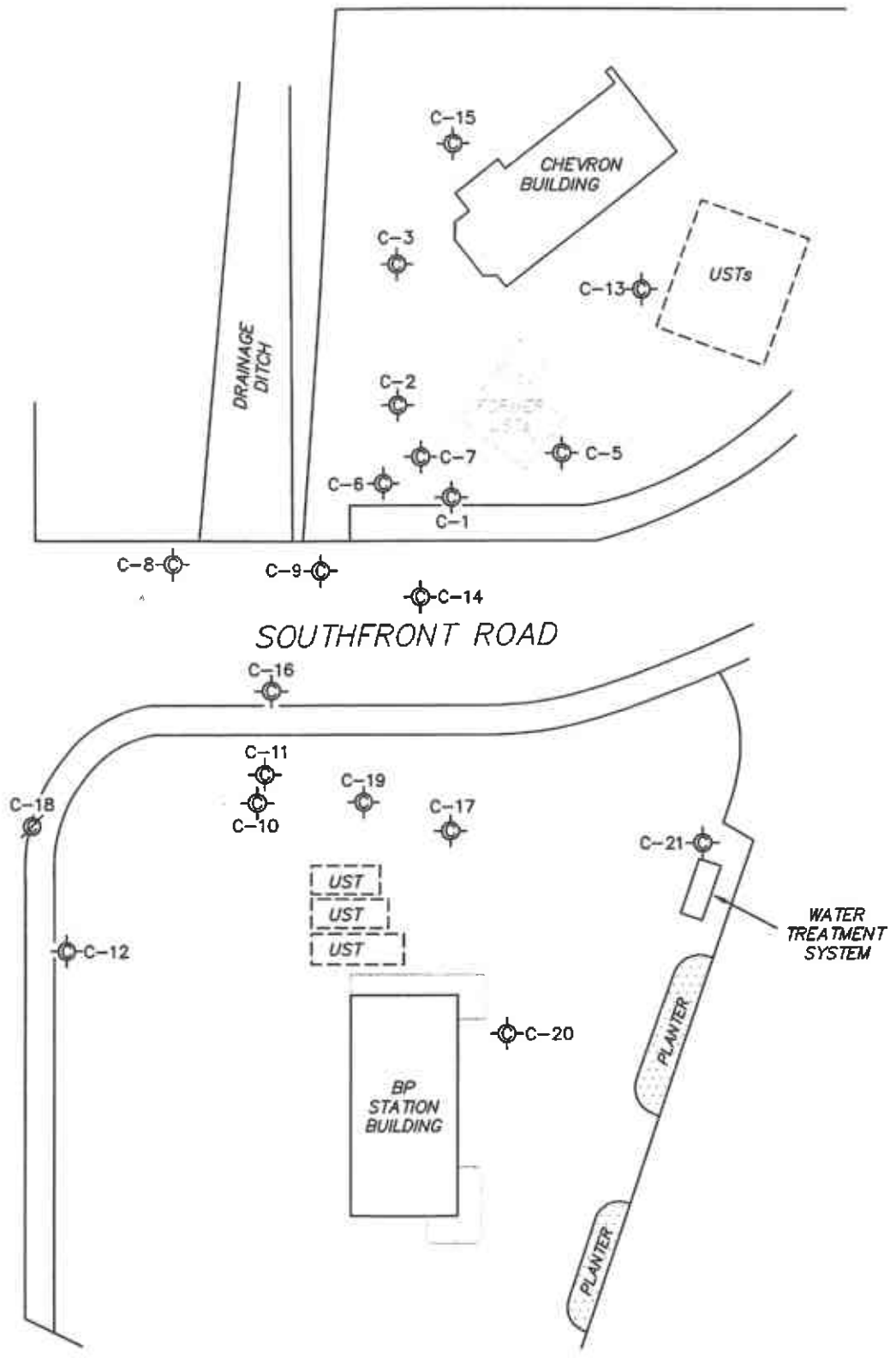

LEGEND

- MW-7 ⊕ Monitoring Well with Dissolved-Phase TPPH Concentration (µg/l)
- C-21 ⊕ Chevron Monitoring Well
- C-18 ⊕ Abandoned Chevron Well
- 1,000- Dissolved-Phase TPPH Contour (µg/l)

NOTES:
Contour lines are interpretive and based on laboratory analysis results of groundwater samples. TPPH = total purgeable petroleum hydrocarbons. µg/l = micrograms per liter. UST = underground storage tank. NA = not analyzed, measured, or collected. Results obtained using EPA Method 8260B.

DISSOLVED-PHASE TPPH CONCENTRATION MAP
June 13, 2005

76 Station 6034
4700 First Street
Livermore, California



FIGURE 3

PS=1:1 6034-003

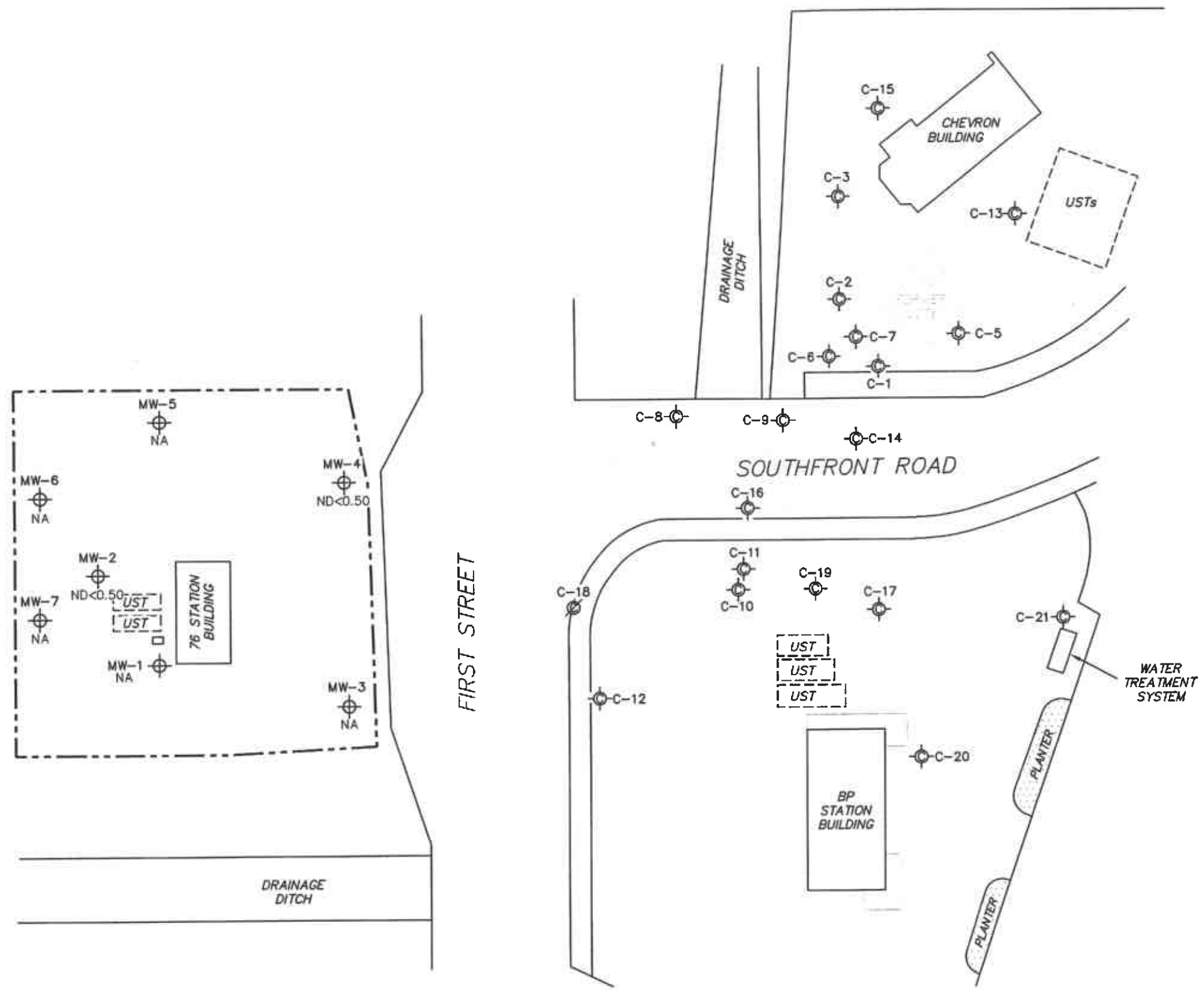

LEGEND

- MW-7 ⊕ Monitoring Well with Dissolved-Phase Benzene Concentration ($\mu\text{g}/\text{l}$)
- C-21 ⊕ Chevron Monitoring Well
- C-18 ⊗ Abandoned Chevron Well

NOTES:

$\mu\text{g}/\text{l}$ = micrograms per liter. ND = not detected at limit indicated on official laboratory report.
 NA = not analyzed, measured, or collected.
 UST = underground storage tank.

DISSOLVED-PHASE BENZENE CONCENTRATION MAP
 June 13, 2005

76 Station 6034
 4700 First Street
 Livermore, California

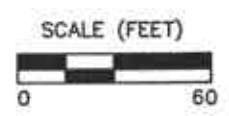

TRC

FIGURE 4

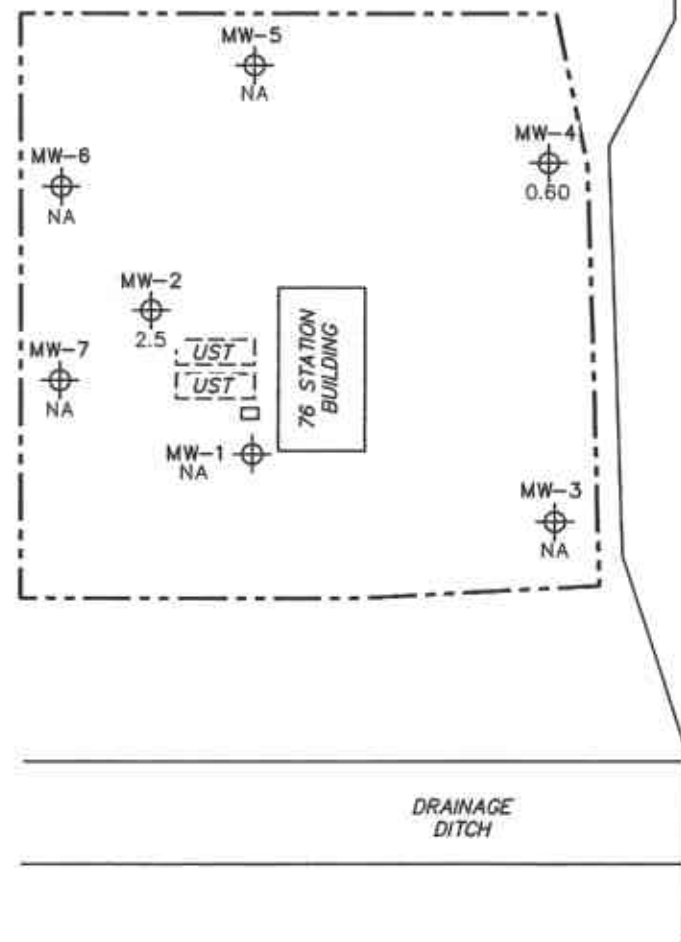

FIRST STREET

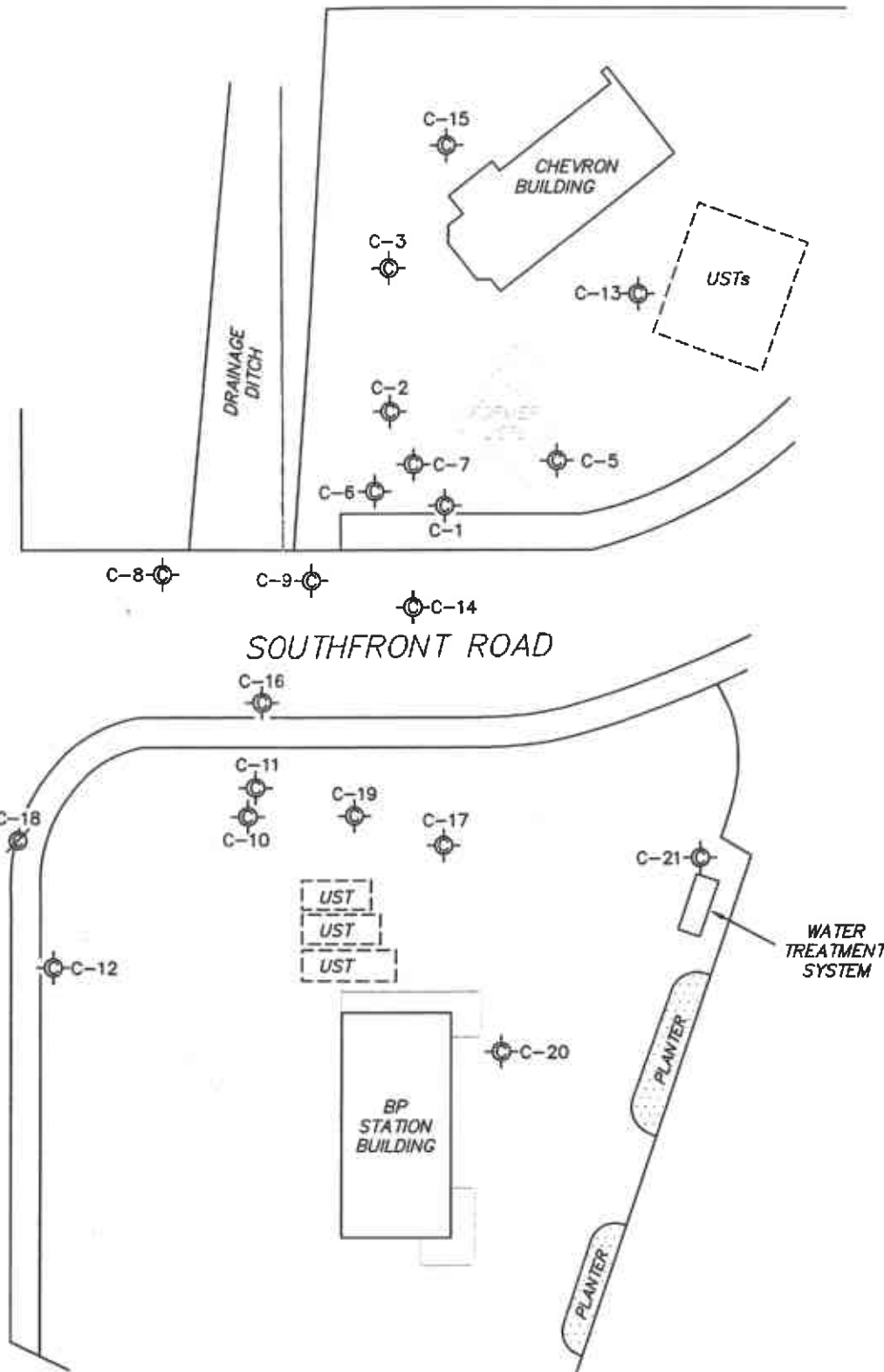

LEGEND

- MW-7 ⊕ Monitoring Well with Dissolved-Phase MTBE Concentration (µg/l)
- C-21 ⊕ Chevron Monitoring Well
- C-18 ⊗ Abandoned Chevron Well

NOTES:
 MTBE = methyl tertiary butyl ether. µg/l = micrograms per liter. NA = not analyzed, measured, or collected. UST = underground storage tank. Results obtained using EPA Method 8260B.

DISSOLVED-PHASE MTBE CONCENTRATION MAP
 June 13, 2005

76 Station 6034
 4700 First Street
 Livermore, California

TRC

FIGURE 5

PS=1:1 6034-003

GRAPHS

Groundwater Elevations vs. Time
76 Station 6034

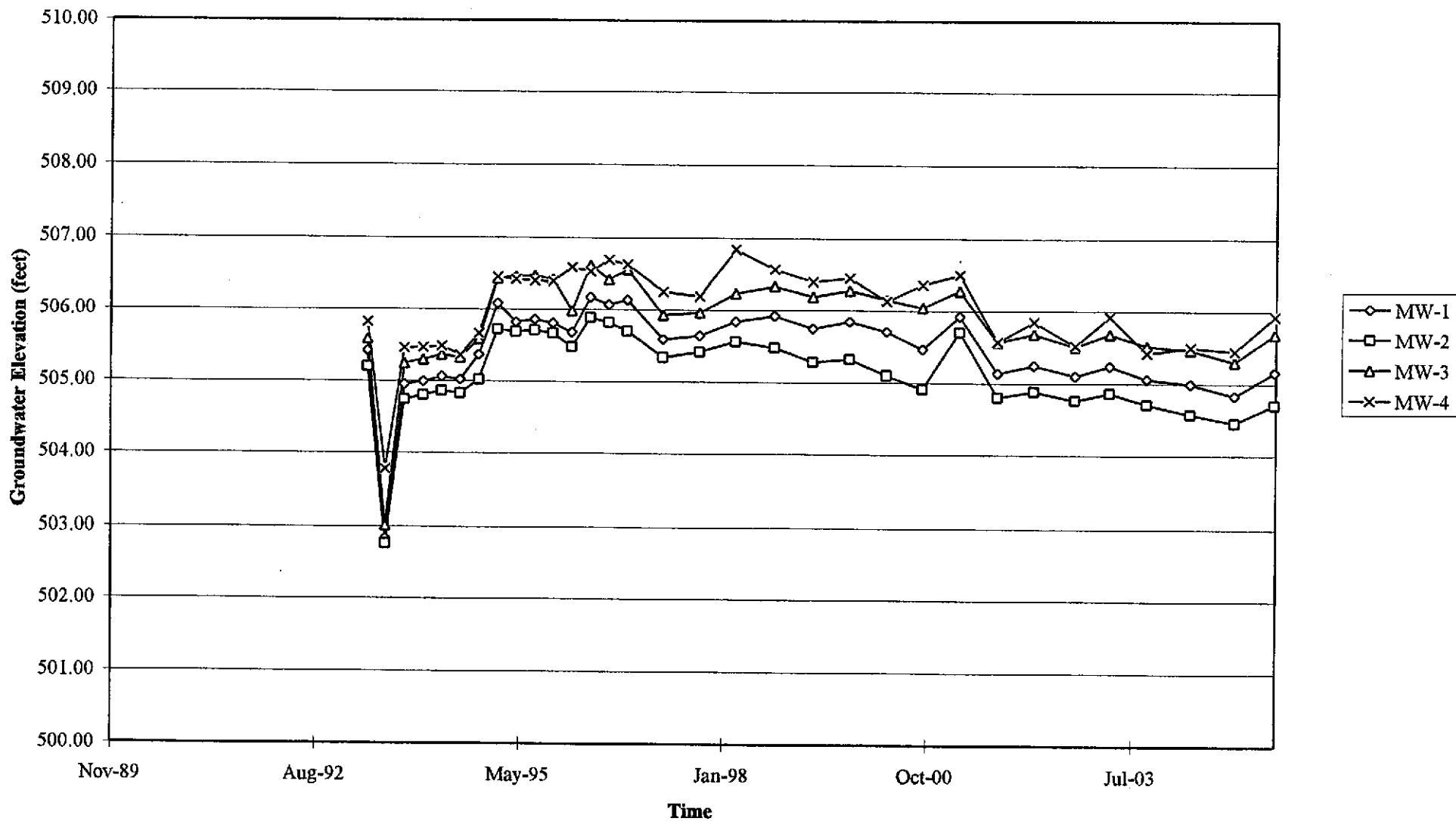

Groundwater Elevations vs. Time
76 Station 6034

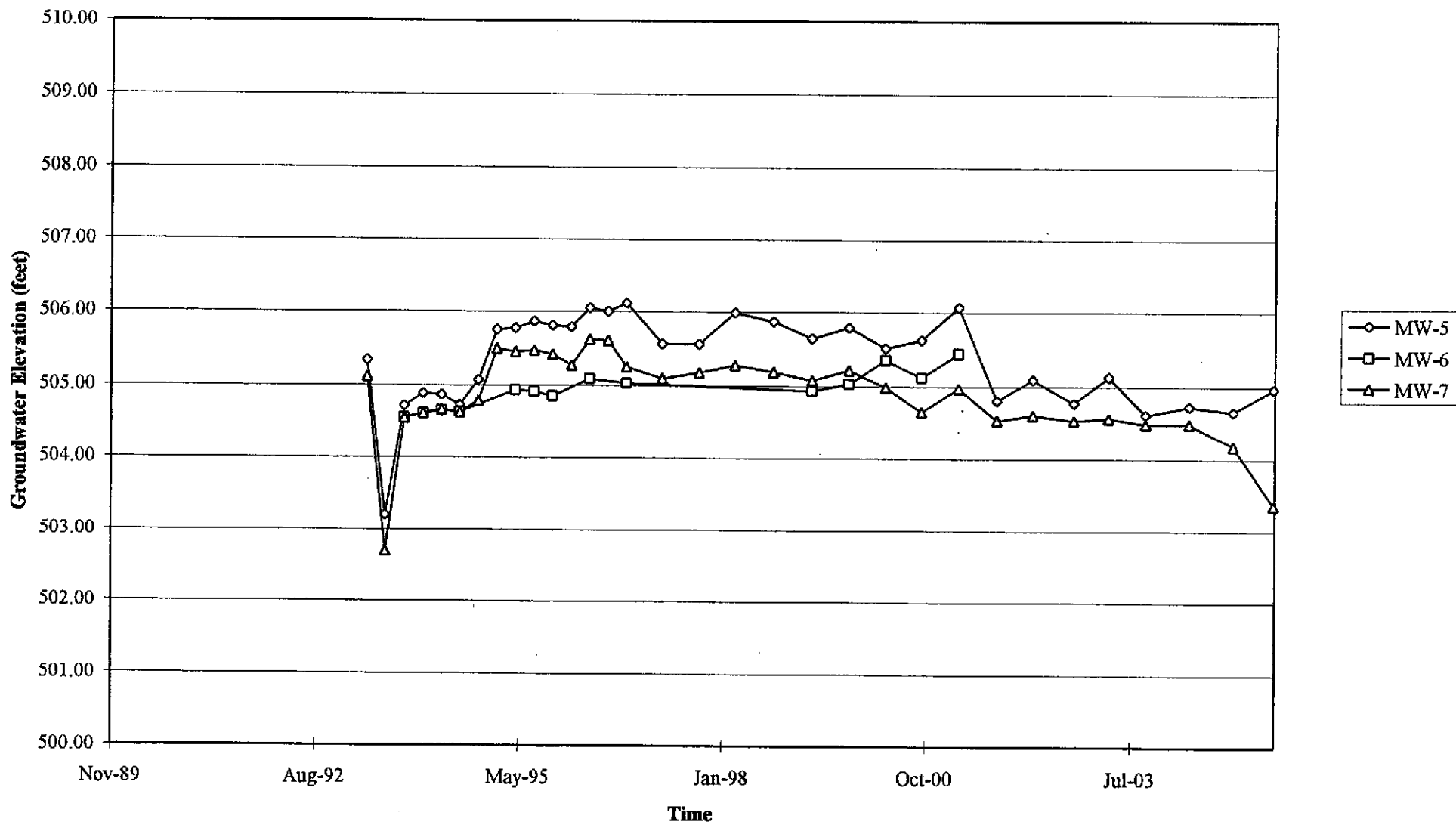

Benzene Concentrations vs Time

76 Station 6034

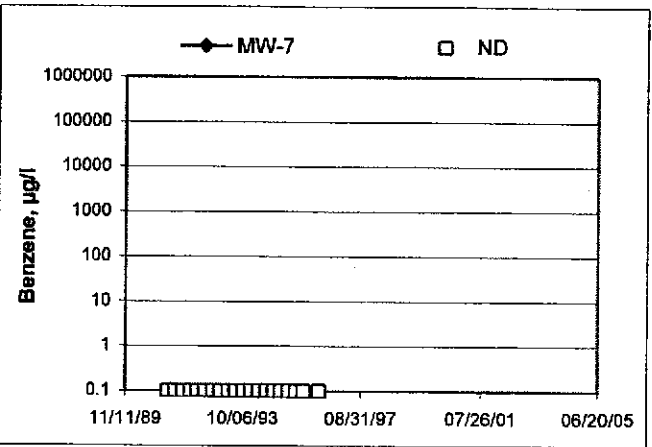
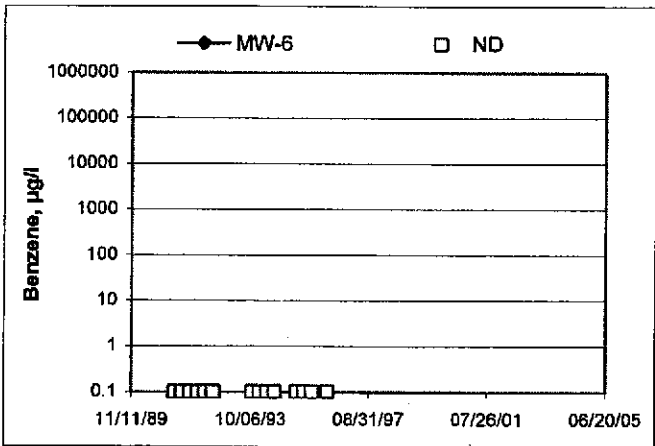
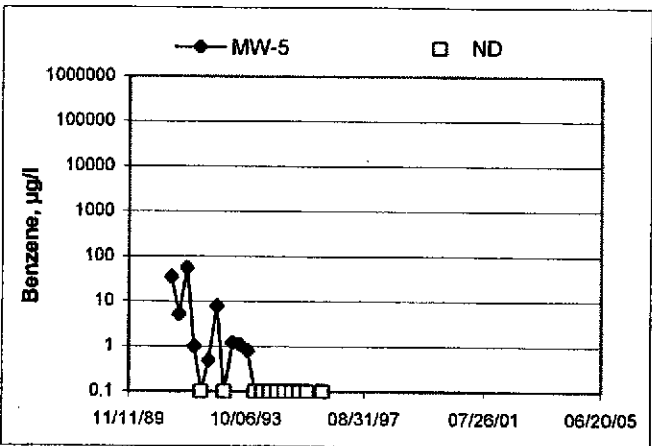
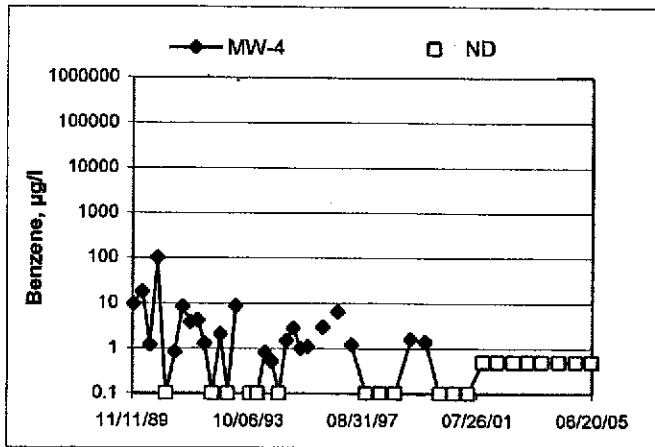
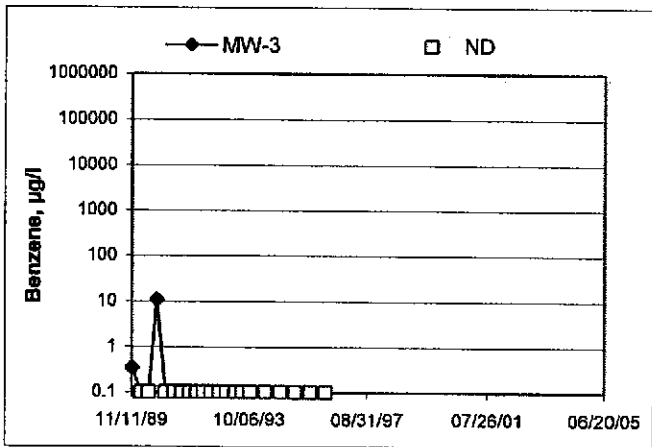
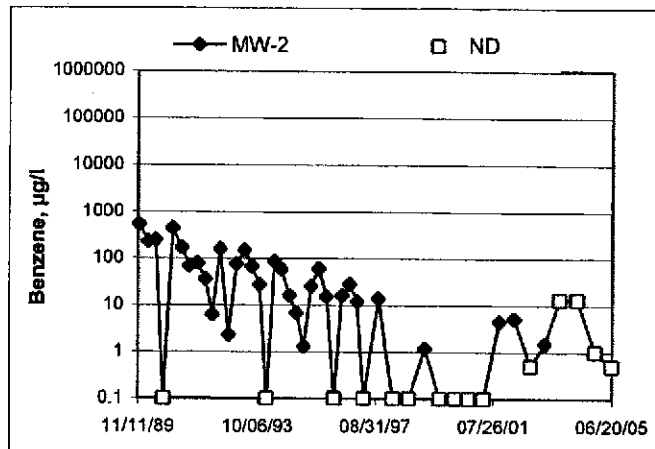
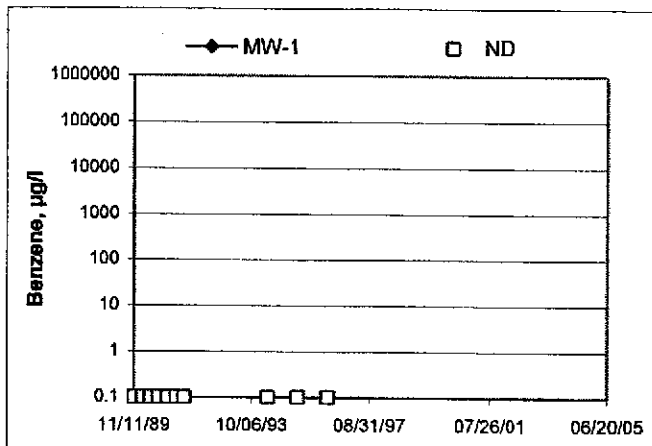

GENERAL FIELD PROCEDURES

Groundwater Monitoring and Sampling Assignments

For each site, TRC technicians are provided with a Technical Service Request (TSR) that specifies activities required to complete the groundwater monitoring and sampling assignment for the site. TSRs are based on client directives, instructions from the primary environmental consultant for the site, regulatory requirements, and TRC's previous experience with the site.

Fluid Level Measurements

Initial site activities include determination of well locations based on a site map provided with the TSR. Well boxes are opened and caps are removed. Indications of well or well box damage or of pressure buildup in the well are noted.

Fluid levels in each well are measured using a coated cloth tape equipped with an electronic interface probe, which distinguishes between liquid phase hydrocarbon (LPH) and water. The depth to LPH (if it is present), to water, and to the bottom of the well are measured from the top of the well casing (surveyors mark or notch if present) to the nearest 0.01 foot. Unless otherwise instructed, a well with less than 0.67 foot between the measured top of water and the measured bottom of the well casing is considered dry, and is not sampled. If the well contains 0.67 foot or more of water, an attempt is made to bail and/or sample as specified on the TSR.

Wells that are found to contain LPH are not purged or sampled. Instead, one casing volume of fluid is bailed from the well and the well is re-sealed. Bailed fluids are placed in a container separate from normal purge water, and properly disposed.

Purging and Groundwater Parameter Measurement

TSR instructions may specify that a well not be purged (no-purge sampling), be purged using low-flow methods, or be purged using conventional pump and/or bail methods. Conventional purging generally consists of pumping or bailing until a minimum of three casing volumes of water have been removed or until the well has been pumped dry. Pumping is generally accomplished using submersible electric or pneumatic diaphragm pumps.

During conventional purging, three groundwater parameters (temperature, pH, and conductivity) are measured after removal of each casing volume. Stabilization of these parameters, to within 10 percent, confirm that sufficient purging has been completed. In some cases, the TSR indicates that other parameters are also to be measured during purging. TRC commonly measures dissolved oxygen (DO), oxidation-reduction potential (ORP), and/or turbidity. Instruments used for groundwater parameter measurements are calibrated daily according to manufacturer's instructions.

Low-flow purging utilizes a bladder or peristaltic pump to remove water from the well at a low rate. Groundwater parameters specified by the TSR are measured continuously until they become stable in general accordance with EPA guidelines.

Purge water is generally collected in labeled drums for disposal. Drums may be left on site for disposal by others, or transported to a collection location for eventual transfer to a licensed treatment or recycling facility. In some cases, purge water may be collected directly from the site by a licensed vacuum truck company, or may be treated on site by an active remediation system, if so directed.

Groundwater Sample Collection

After wells are purged, or not purged, according to TSR instructions, samples are collected for laboratory analysis. For wells that have been purged using conventional pump or bail methods, sampling is conducted after the well has recovered to 80 percent of its original volume or after two hours if the well does not recover to at least 80 percent. If there is insufficient recharge of water in the well after two hours, the well is not sampled.

Samples are collected by lowering a new, disposable, ½-inch to 4-inch polyethylene bottom-fill bailer to just below the water level in the well. The bailer is retrieved and the water sample is carefully transferred to containers specified for the laboratory analytical methods indicated by the TSR. Particular care is given to containers for volatile organic analysis (VOAs) which require filling to zero headspace and fitting with Teflon-sealed caps.

After filling, all containers are labeled with project number (or site number), well designation, sample date, sample time, and the sampler's initials, and placed in an insulated chest with ice. Samples remain chilled prior to and during transport to a state-certified laboratory for analysis. Sample container descriptions and requested analyses are entered onto a chain-of-custody form in order to provide instructions to the laboratory. The chain-of-custody form accompanies the samples during transportation to provide a continuous record of possession from the field to the laboratory. If a freight or overnight carrier transports the samples, the carrier is noted on the form.

For wells that have been purged using low-flow methods, sample containers are filled from the effluent stream of the bladder or peristaltic pump. In some cases, if so specified by the TSR, samples are taken from the sample ports of actively pumping remediation wells.

Sequence of Gauging, Purging and Sampling

The sequence in which monitoring activities are conducted are specified on the TSR. In general, wells are gauged beginning with the least affected well and ending with the well that has the highest concentration based on previous analytic results. After all gauging for the site is completed, wells are purged and/or sampled from the least-affected to the most-affected well.

Decontamination

In order to reduce the possibility of cross contamination between wells, strict isolation and decontamination procedures are observed. Portable pumps are not used in wells with LPH. Technicians wear nitrile gloves during all gauging, purging and sampling activities. Gloves are changed between wells and more often if warranted. Any equipment that could come in contact with fluids are either dedicated to a particular wells, decontaminated prior to each use, or discarded after a single use. Decontamination consists of washing in a solution of Liqui-nox and water and rinsing twice. The final rinse is in deionized water.

Exceptions

Additional tasks or non-standard procedures, if any, that may be requested or required for a particular site, and noted on the site TSR, are documented in field notes on the following pages.

GROUNDWATER SAMPLING FIELD NOTES

Technician: PLM

Site: 0084

Project No.: 4252001

Date: 06-15-05

Well No.: MW-4
 Depth to Water (feet): 13.68
 Total Depth (feet): 25.39
 Water Column (feet): 11.71
 80% Recharge Depth (feet): 14.02

Purge Method: DM
 Depth to Product (feet): 0
 LPH & Water Recovered (gallons): 2
 Casing Diameter (Inches): 2 1/2
 1 Well Volume (gallons): 2

Time Start	Time Stop	Depth To Water (feet)	Volume Purged (gallons)	Conductivity (uS/cm)	Temperature (F. C)	pH	Turbidity	D.O.
0951			2	1142	16.9	7.66		
			4	1060	14.7	7.05		
	0955		6	1054	14.7	7.16		
Static at Time Sampled			Total Gallons Purged		Time Sampled			
= 13.98			6		100			
Comments:								

Well No.: MW-2
 Depth to Water (feet): 15.12
 Total Depth (feet): 28.58
 Water Column (feet): 10.44
 80% Recharge Depth (feet): 17.21

Purge Method: DM
 Depth to Product (feet): 0
 LPH & Water Recovered (gallons): 2
 Casing Diameter (Inches): 2 1/2
 1 Well Volume (gallons): 2

Time Start	Time Stop	Depth To Water (feet)	Volume Purged (gallons)	Conductivity (uS/cm)	Temperature (F. C)	pH	Turbidity	D.O.
1007			2	1644	15.0	7.11		5.76
			4	1555	14.9	7.13		5.32
	1011		6	1566	14.8	7.16		4.79
Static at Time Sampled			Total Gallons Purged		Time Sampled			
16.93			6		1017			
Comments:								

TRC Alton Geoscience- Irvine

June 27, 2005

21 Technology Drive
Irvine, CA 92718

Attn.: Anju Farfan

Project#: 41050001/FA20

Project: Conoco Phillips #6034

Site: 4700 First St., Livermore

Attached is our report for your samples received on 06/14/2005 12:20

This report has been reviewed and approved for release. Reproduction of this report is permitted only in its entirety.

Please note that any unused portion of the samples will be discarded after 07/29/2005 unless you have requested otherwise.

We appreciate the opportunity to be of service to you. If you have any questions, please call me at (925) 484-1919.

You can also contact me via email. My email address is: dsharma@stl-inc.com

Sincerely,



Dimple Sharma
Project Manager

Severn Trent Laboratories, Inc.

STL San Francisco * 1220 Quarry Lane, Pleasanton, CA 94566

Tel 925 484 1919 Fax 925 484 1096 * www.stl-inc.com * CA DHS ELAP# 2496

Gas/BTEX Fuel Oxygenates by 8260B

TRC Alton Geoscience- Irvine

Attn.: Anju Farfan

21 Technology Drive

Irvine, CA 92718

Phone: (949) 341-7440 Fax: (949) 753-0111

Project: 41050001/FA20

Conoco Phillips #6034

Received: 06/14/2005 12:20

Site: 4700 First St., Livermore

Samples Reported

Sample Name	Date Sampled	Matrix	Lab.#
MW-2	06/13/2005 10:17	Water	1
MW-4	06/13/2005 10:00	Water	2

Severn Trent Laboratories, Inc.

STL San Francisco * 1220 Quarry Lane, Pleasanton, CA 94566

Tel 925 484-1919 Fax 925 484 1096 * www.stl-inc.com * CA DHS ELAP# 2496

06/27/2005 15:51

Gas/BTEX Fuel Oxygenates by 8260B

TRC Alton Geoscience- Irvine

Attn.: Anju Farfan

21 Technology Drive

Irvine, CA 92718

Phone: (949) 341-7440 Fax: (949) 753-0111

Project: 41050001/FA20

Conoco Phillips #6034

Received: 06/14/2005 12:20

Site: 4700 First St., Livermore

Prep(s): 5030B	Test(s): 8260B
Sample ID: MW-2	Lab ID: 2005-06-0377 - 1
Sampled: 06/13/2005 10:17	Extracted: 6/26/2005 16:35
Matrix: Water	QC Batch#: 2005/06/26-1A.62
pH: <2	

Compound	Conc.	RL	Unit	Dilution	Analyzed	Flag
GRO (C6-C12)	3300	50	ug/L	1.00	06/26/2005 16:35	
Benzene	ND	0.50	ug/L	1.00	06/26/2005 16:35	
Toluene	ND	0.50	ug/L	1.00	06/26/2005 16:35	
Ethylbenzene	47	0.50	ug/L	1.00	06/26/2005 16:35	
Total xylenes	200	1.0	ug/L	1.00	06/26/2005 16:35	
tert-Butyl alcohol (TBA)	9.6	5.0	ug/L	1.00	06/26/2005 16:35	
Methyl tert-butyl ether (MTBE)	2.5	0.50	ug/L	1.00	06/26/2005 16:35	
Di-isopropyl Ether (DIPE)	ND	0.50	ug/L	1.00	06/26/2005 16:35	
Ethyl tert-butyl ether (ETBE)	ND	0.50	ug/L	1.00	06/26/2005 16:35	
tert-Amyl methyl ether (TAME)	ND	0.50	ug/L	1.00	06/26/2005 16:35	
1,2-DCA	ND	0.50	ug/L	1.00	06/26/2005 16:35	
EDB	ND	0.50	ug/L	1.00	06/26/2005 16:35	
Ethanol	ND	50	ug/L	1.00	06/26/2005 16:35	
Surrogate(s)						
1,2-Dichloroethane-d4	102.7	73-130	%	1.00	06/26/2005 16:35	
Toluene-d8	96.2	81-114	%	1.00	06/26/2005 16:35	

Severn Trent Laboratories, Inc.

STL San Francisco * 1220 Quarry Lane, Pleasanton, CA 94566

Tel 925 484 1919 Fax 925 484 1096 * www.stl-inc.com * CA DHS ELAP# 2496

06/27/2005 15:51

Gas/BTEX Fuel Oxygenates by 8260B

TRC Alton Geoscience- Irvine
Attn.: Anju Farfan

21 Technology Drive
Irvine, CA 92718
Phone: (949) 341-7440 Fax: (949) 753-0111

Project: 41050001/FA20
Conoco Phillips #6034

Received: 06/14/2005 12:20

Site: 4700 First St., Livermore

Prep(s): 5030B	Test(s): 8260B
Sample ID: MW-4	Lab ID: 2005-06-0377 - 2
Sampled: 06/13/2005 10:00	Extracted: 6/25/2005 10:51
Matrix: Water	QC Batch#: 2005/06/25-1A.64
pH: <2	

Compound	Conc.	RL	Unit	Dilution	Analyzed	Flag
GRO (C6-C12)	69	50	ug/L	1.00	06/25/2005 10:51	Q1
Benzene	ND	0.50	ug/L	1.00	06/25/2005 10:51	
Toluene	ND	0.50	ug/L	1.00	06/25/2005 10:51	
Ethylbenzene	ND	0.50	ug/L	1.00	06/25/2005 10:51	
Total xylenes	ND	1.0	ug/L	1.00	06/25/2005 10:51	
Methyl tert-butyl ether (MTBE)	0.60	0.50	ug/L	1.00	06/25/2005 10:51	
Ethanol	ND	50	ug/L	1.00	06/25/2005 10:51	
Surrogate(s)						
1,2-Dichloroethane-d4	92.2	73-130	%	1.00	06/25/2005 10:51	
Toluene-d8	89.0	81-114	%	1.00	06/25/2005 10:51	

Severn Trent Laboratories, Inc.

STL San Francisco * 1220 Quarry Lane, Pleasanton, CA 94566

Tel 925 484 1919 Fax 925 484 1096 * www.stl-inc.com * CA DHS ELAP# 2496

06/27/2005 15:51

Gas/BTEX Fuel Oxygenates by 8260B

TRC Alton Geoscience- Irvine

Attn.: Anju Farfan

21 Technology Drive

Irvine, CA 92718

Phone: (949) 341-7440 Fax: (949) 753-0111

Project: 41050001/FA20

Conoco Phillips #6034

Received: 06/14/2005 12:20

Site: 4700 First St., Livermore

Batch QC Report		
Prep(s): 5030B		Test(s): 8260B
Method Blank	Water	QC Batch # 2005/06/25-1A.64
MB: 2005/06/25-1A.64-049		Date Extracted: 06/25/2005 06:49

Compound	Conc.	RL	Unit	Analyzed	Flag
GRO (C6-C12)	ND	50	ug/L	06/25/2005 06:49	
Benzene	ND	0.5	ug/L	06/25/2005 06:49	
Toluene	ND	0.5	ug/L	06/25/2005 06:49	
Ethylbenzene	ND	0.5	ug/L	06/25/2005 06:49	
Total xylenes	ND	1.0	ug/L	06/25/2005 06:49	
tert-Butyl alcohol (TBA)	ND	5.0	ug/L	06/25/2005 06:49	
Methyl tert-butyl ether (MTBE)	ND	0.5	ug/L	06/25/2005 06:49	
Di-isopropyl Ether (DIPE)	ND	0.5	ug/L	06/25/2005 06:49	
Ethyl tert-butyl ether (ETBE)	ND	0.5	ug/L	06/25/2005 06:49	
tert-Amyl methyl ether (TAME)	ND	0.5	ug/L	06/25/2005 06:49	
1,2-DCA	ND	0.5	ug/L	06/25/2005 06:49	
EDB	ND	0.5	ug/L	06/25/2005 06:49	
Ethanol	ND	50	ug/L	06/25/2005 06:49	
Surrogates(s)					
1,2-Dichloroethane-d4	90.6	73-130	%	06/25/2005 06:49	
Toluene-d8	97.8	81-114	%	06/25/2005 06:49	

Gas/BTEX Fuel Oxygenates by 8260B

TRC Alton Geoscience- Irvine

Attn.: Anju Farfan

21 Technology Drive

Irvine, CA 92718

Phone: (949) 341-7440 Fax: (949) 753-0111

Project: 41050001/FA20

Conoco Phillips #6034

Received: 06/14/2005 12:20

Site: 4700 First St., Livermore

Batch QC Report					
Prep(s): 5030B		Water		Test(s): 8260B	
Method Blank				QC Batch # 2005/06/26-1A.62	
MB: 2005/06/26-1A.62-061				Date Extracted: 06/26/2005 08:29	
Compound	Conc.	RL	Unit	Analyzed	Flag
GRO (C6-C12)	ND	50	ug/L	06/26/2005 08:29	
tert-Butyl alcohol (TBA)	ND	5.0	ug/L	06/26/2005 08:29	
Methyl tert-butyl ether (MTBE)	ND	0.5	ug/L	06/26/2005 08:29	
Di-isopropyl Ether (DIPE)	ND	0.5	ug/L	06/26/2005 08:29	
Ethyl tert-butyl ether (ETBE)	ND	0.5	ug/L	06/26/2005 08:29	
tert-Amyl methyl ether (TAME)	ND	0.5	ug/L	06/26/2005 08:29	
1,2-DCA	ND	0.5	ug/L	06/26/2005 08:29	
EDB	ND	0.5	ug/L	06/26/2005 08:29	
Benzene	ND	0.5	ug/L	06/26/2005 08:29	
Toluene	ND	0.5	ug/L	06/26/2005 08:29	
Ethylbenzene	ND	0.5	ug/L	06/26/2005 08:29	
Total xylenes	ND	1.0	ug/L	06/26/2005 08:29	
Ethanol	ND	50	ug/L	06/26/2005 08:29	
Surrogates(s)					
1,2-Dichloroethane-d4	101.0	73-130	%	06/26/2005 08:29	
Toluene-d8	95.4	81-114	%	06/26/2005 08:29	

Gas/BTEX Fuel Oxygenates by 8260B

TRC Alton Geoscience- Irvine

Attn.: Anju Farfan

21 Technology Drive

Irvine, CA 92718

Phone: (949) 341-7440 Fax: (949) 753-0111

Project: 41050001/FA20

Conoco Phillips #6034

Received: 06/14/2005 12:20

Site: 4700 First St., Livermore

Batch QC Report			
Prep(s): 5030B		Test(s): 8260B	
Laboratory Control Spike		Water	QC Batch # 2005/06/25-1A.64
LCS	2005/06/25-1A.64-025	Extracted: 06/25/2005	Analyzed: 06/25/2005 06:25
LCSD			

Compound	Conc. ug/L		Exp.Conc.	Recovery %		RPD	Ctrl.Limits %		Flags	
	LCS	LCSD		LCS	LCSD		%	Rec.	RPD	LCS
Methyl tert-butyl ether (MTBE)	25.8		25	103.2			65-165	20		
Benzene	20.3		25	81.2			69-129	20		
Toluene	24.9		25	99.6			70-130	20		
Surrogates(s)										
1,2-Dichloroethane-d4	420		500	84.0			73-130			
Toluene-d8	422		500	84.4			81-114			

Gas/BTEX Fuel Oxygenates by 8260B

TRC Alton Geoscience- Irvine
Attn.: Anju Farfan

21 Technology Drive
Irvine, CA 92718
Phone: (949) 341-7440 Fax: (949) 753-0111
Project: 41050001/FA20
Conoco Phillips #6034

Received: 06/14/2005 12:20

Site: 4700 First St., Livermore

Batch QC Report			
Prep(s): 5030B			Test(s): 8260B
Laboratory Control Spike	Water		QC Batch # 2005/06/26-1A.62
LCS 2005/06/26-1A.62-060	Extracted: 06/26/2005		Analyzed: 06/26/2005 08:03
LCSD			

Compound	Conc. ug/L		Exp.Conc.	Recovery %		RPD	Ctrl.Limits %		Flags	
	LCS	LCSD		LCS	LCSD		%	Rec.	RPD	LCS
Methyl tert-butyl ether (MTBE)	23.1		125	92.4			65-165	20		
Benzene	22.9		125	91.6			69-129	20		
Toluene	22.7		125	90.8			70-130	20		
Surrogates(s)										
1,2-Dichloroethane-d4	481		500	96.2			73-130			
Toluene-d8	477		500	95.4			81-114			

Severn Trent Laboratories, Inc.

STL San Francisco * 1220 Quarry Lane, Pleasanton, CA 94566
Tel 925 484 1919 Fax 925 484 1096 * www.stl-inc.com * CA DHS ELAP# 2496

06/27/2005 15:51

Gas/BTEX Fuel Oxygenates by 8260B

TRC Alton Geoscience- Irvine

Attn.: Anju Farfan

21 Technology Drive

Irvine, CA 92718

Phone: (949) 341-7440 Fax: (949) 753-0111

Project: 41050001/FA20

Conoco Phillips #6034

Received: 06/14/2005 12:20

Site: 4700 First St., Livermore

Batch QC Report			
Prep(s):	5030B		Test(s): 8260B
Matrix Spike (MS / MSD)		Water	QC Batch # 2005/06/25-1A.64
MS/MSD			Lab ID: 2005-06-0429 - 001
MS: 2005/06/25-1A.64-002		Extracted: 06/25/2005	Analyzed: 06/25/2005 08:02
			Dilution: 1.00
MSD: 2005/06/25-1A.64-026		Extracted: 06/25/2005	Analyzed: 06/25/2005 08:26
			Dilution: 1.00

Compound	Conc. ug/L			Spk.Level	Recovery %			Limits %		Flags	
	MS	MSD	Sample		ug/L	MS	MSD	RPD	Rec.	RPD	MS
Methyl tert-butyl ether	22.6	21.9	ND	25	90.4	87.6	3.1	65-165	20		
Benzene	17.8	19.6	ND	25	71.2	78.4	9.6	69-129	20		
Toluene	21.8	23.9	ND	25	87.2	95.6	9.2	70-130	20		
Surrogate(s)											
1,2-Dichloroethane-d4	431	450		500	86.2	90.0		73-130			
Toluene-d8	412	481		500	82.5	96.2		81-114			

Severn Trent Laboratories, Inc.

STL San Francisco * 1220 Quarry Lane, Pleasanton, CA 94566

Tel 925 484 1919 Fax 925 484 1096 * www.stl-inc.com * CA DHS ELAP# 2496

06/27/2005 15:51

Gas/BTEX Fuel Oxygenates by 8260B

TRC Alton Geoscience- Irvine
Attn.: Anju Farfan

21 Technology Drive
Irvine, CA 92718
Phone: (949) 341-7440 Fax: (949) 753-0111

Project: 41050001/FA20
Conoco Phillips #6034

Received: 06/14/2005 12:20

Site: 4700 First St., Livermore

Batch QC Report			
Prep(s):	5030B		Test(s): 8260B
Matrix Spike (MS / MSD)		Water	QC Batch # 2005/06/26-1A.62
MS/MSD			Lab ID: 2005-06-0379 - 010
MS: 2005/06/26-1A.62-059		Extracted: 06/26/2005	Analyzed: 06/26/2005 09:59
			Dilution: 5.00
MSD: 2005/06/26-1A.62-025		Extracted: 06/26/2005	Analyzed: 06/26/2005 10:25
			Dilution: 5.00

Compound	Conc. ug/L			Spk.Level ug/L	Recovery %			Limits %		Flags	
	MS	MSD	Sample		MS	MSD	RPD	Rec.	RPD	MS	MSD
Methyl tert-butyl ether	84.0	84.3	ND	125	67.2	67.4	0.3	65-165	20		
Benzene	58.4	71.0	2.77	125	44.5	56.8	24.3	69-129	20	M5	R1,M5
Toluene	56.1	69.8	ND	125	44.9	55.8	21.6	70-130	20	M5	R1,M5
Surrogate(s)											
1,2-Dichloroethane-d4	535	496		500	107.0	99.2		73-130			
Toluene-d8	489	503		500	97.8	100.6		81-114			

Gas/BTEX Fuel Oxygenates by 8260B

TRC Alton Geoscience- Irvine

Attn.: Anju Farfan

21 Technology Drive

Irvine, CA 92718

Phone: (949) 341-7440 Fax: (949) 753-0111

Project: 41050001/FA20

Conoco Phillips #6034

Received: 06/14/2005 12:20

Site: 4700 First St., Livermore

Legend and Notes

Result Flag

M5

MS/MSD spike recoveries were below acceptance limits.
See blank spike (LCS).

Q1

Quantit. of unknown hydrocarbon(s) in sample based on gasoline.

R1

Analyte RPD was out of QC limits.

Severn Trent Laboratories, Inc.

STL San Francisco * 1220 Quarry Lane, Pleasanton, CA 94566

Tel 925 484 1919 Fax 925 484 1096 * www.stl-inc.com * CA DHS ELAP# 2496

06/27/2005 15:51

STL San Francisco

Sample Receipt Checklist

Submission #: 2005- 06-1377

Checklist completed by: <u>SA</u>		DATE: <u>6/1/05</u>												
Courier: <input checked="" type="checkbox"/> STL SF	Courier: <input type="checkbox"/> Fedex <input type="checkbox"/> UPS <input type="checkbox"/> Other		Client: <input type="checkbox"/>											
Log-In Details		Yes	No											
1	Custody seals intact on shipping container/samples		<input checked="" type="checkbox"/>											
2	Chain of custody present?	<input checked="" type="checkbox"/>												
3	Chain of custody signed when relinquished and received?	<input checked="" type="checkbox"/>												
4	All samples checked when COC relinquished		<input checked="" type="checkbox"/>											
5	Chain of custody agrees with sample labels?	<input checked="" type="checkbox"/>												
6	Samples in proper container/bottle?	<input checked="" type="checkbox"/>												
7	Sample containers intact?	<input checked="" type="checkbox"/>												
8	Sufficient sample volume for indicated test?	<input checked="" type="checkbox"/>												
9	All samples received within holding time?	<input checked="" type="checkbox"/>												
Cooler Temperature Compliance Check														
<table border="1"> <tr> <th>Temperature Blank Reading</th> <td rowspan="2">If no log blank is submitted individual temperatures must be taken as per SOP</td> <th colspan="4">Cooler Sample Temperature</th> </tr> <tr> <td><u>3°C</u></td> <th>#1</th> <th>#2</th> <th>#3</th> <th>Average</th> </tr> </table>		Temperature Blank Reading	If no log blank is submitted individual temperatures must be taken as per SOP	Cooler Sample Temperature				<u>3°C</u>	#1	#2	#3	Average	Samples with Temp > 5°C - Comments	
Temperature Blank Reading	If no log blank is submitted individual temperatures must be taken as per SOP	Cooler Sample Temperature												
<u>3°C</u>		#1	#2	#3	Average									
Reason for Elevated Temperature <input type="checkbox"/> Ice Melted <input type="checkbox"/> Insufficient Ice <input type="checkbox"/> <input type="checkbox"/> Samp. in boxes <input type="checkbox"/> Sampled < 4hr <input type="checkbox"/> Ice not req.														
VOA Sample Inspection														
Are bubbles present in any of the VOA vials?	Sample #	Small	Med.	Large	Samples with broken, cracked or leaking containers									
		<input type="checkbox"/>	<input type="checkbox"/>	<input type="checkbox"/>										
		<input type="checkbox"/>	<input type="checkbox"/>	<input type="checkbox"/>										
		<input type="checkbox"/>	<input type="checkbox"/>	<input type="checkbox"/>										
Water - pH acceptable upon receipt?	Yes	No	Samples with Unacceptable pH											
	<input type="checkbox"/>	<input type="checkbox"/>												
<input type="checkbox"/> pH adjusted - Preservative used: <input type="checkbox"/> HNO ₃ <input type="checkbox"/> HCl <input type="checkbox"/> H ₂ SO ₄ <input type="checkbox"/> NaOH <input type="checkbox"/> ZnOAc - Lot #(s) _____														
Comments:														
Project Management [Routing for instruction of indicated discrepancy(ies)]														
Project Manager: (Initials) _____		Date: ____/____/05		Client contacted: Yes <input type="checkbox"/> No <input checked="" type="checkbox"/>										
Summary of discussion:														
Corrective Action (per PM/Client):														

STL-San Francisco

ConocoPhillips Chain Of Custody Record

116557

1220 Quarry Lane
Pleasanton, CA 94566

ConocoPhillips Site Manager:

INVOICE/REMITTANCE ADDRESS:

CONOCOPHILLIPS
Attn: Dee Hutchinson
3611 South Harbor, Suite 200
Irvine, CA 92614

ConocoPhillips Work Order Number

152E TRC 501

DATE: 06-13-05

ConocoPhillips Cost Object

PAGE: 1 of 1

(925) 484-1919 (925) 484-1086 fax

2005-06-0377

SAMPLING COMPANY: TRC		Field Value ID: 6084	CONOCOPHILLIPS SITE NUMBER: 6084	GLOBAL ID NO.: 70600101477
ADDRESS: 21 Technology Drive, Irvine CA 92618		SITE ADDRESS (Street and City): 4700 FIRST ST. LIVERMORE		CONOCOPHILLIPS SITE MANAGER: STELSGY LATHROP
PROJECT CONTACT (See copy of PRE Report to): Anju Farfan		EDF DELIVERABLE TO (If not Pre-Ordered): Peter Thomson, TRC	PHONE NO.: 949-341-7408	LAB USE ONLY
TELEPHONE: 949-341-7440	FAX: 949-753-0111	E-MAIL: afarfan@trcsolutions.com	LAB USE ONLY	
SAMPLER NAME(S) (Print): PLU		CONSULTANT PROJECT NUMBER: 41050001FA20		

REQUESTED ANALYSES

TURNAROUND TIME (CALENDAR DAYS): <input type="checkbox"/> 14 DAYS <input type="checkbox"/> 7 DAYS <input type="checkbox"/> 72 HOURS <input type="checkbox"/> 48 HOURS <input type="checkbox"/> 24 HOURS <input type="checkbox"/> LESS THAN 24 HOURS														FIELD NOTES: Container/Preservative or PID Readings or Laboratory Notes								
SPECIAL INSTRUCTIONS OR NOTES: CHECK BOX IF EDF IS NEEDED <input checked="" type="checkbox"/>																						
* Field Point name only required if different from Sample ID																						
LAB USE ONLY	Sample Identification/Field Point Name*		SAMPLING		MATRIX	NO. OF CONT.	8015m - TPHd Extractable	9260B - TPHg/BTEX/MIBE	8260B - TPHg / BTEX / 8 Oxygenates	8260B - TPHg / BTEX / 8 oxygenates + methanol (8015M)	8260B - Full Scan VOCs (does not include oxygenates)	8270C - Semi-Volatiles	8015M / 8021B - TPHg/BTEX/MIBE	Lead	Total DDTLC DTCLP	STPH BY SCIOS	STEX / MIBF BY SCIOS	S OLYS BY SCIOS	ETHANAL BY SCIOS	TEMPERATURE ON RECEIPT °C		
	DATE	TIME	DATE	TIME																5	3	4
	PLU-2	06-13-05			Flow	5															5	3
	PLU-4		1000																			

Prepared by (Signature): <i>[Signature]</i>	Received by (Signature): <i>[Signature]</i>	Date: 06-13-05	Time: 1130
Prepared by (Signature): <i>[Signature]</i>	Received by (Signature): <i>[Signature]</i>	Date: 6-14-05	Time: 1015
Prepared by (Signature): <i>[Signature]</i>	Received by (Signature): <i>[Signature]</i>	Date: 6-14-05	Time: 1220

STATEMENTS

Purge Water Disposal

Non-hazardous groundwater produced during purging and sampling was accumulated at TRC's groundwater monitoring facility at Concord, California, for transportation by Onyx Transportation, Inc., to the ConocoPhillips Refinery at Rodeo, California. Disposal at the Rodeo facility was authorized by ConocoPhillips in accordance with "ESD Standard Operating Procedures - Water Quality and Compliance", as revised on February 7, 2003. Documentation of compliance with ConocoPhillips requirements is provided by an ESD Form R-149, which is on file at TRC's Concord Office. Purge water suspected of containing potentially hazardous material, such as liquid-phase hydrocarbons, was accumulated separately in a drum for transportation and disposal by Filter Recycling, Inc.

Limitations

The fluid level monitoring and groundwater sampling activities summarized in this report have been performed under the responsible charge of a California Registered Geologist or Registered Civil Engineer and have been conducted in accordance with current practice and the standard of care exercised by geologists and engineers performing similar tasks in this area. No warranty, express or implied, is made regarding the conclusions and professional opinions presented in this report. The conclusions are based solely upon an analysis of the observed conditions. If actual conditions differ from those described in this report, our office should be notified.