



6602 Owens Dr. Suite 100
Pleasanton, California 94588
www.atc-enviro.com
925.460.5300
Fax 925.463.2559

April 29, 2005

Mr. Robert Schultz
Alameda County Health Care Services Agency
1131 Harbor Bay Parkway
Alameda, CA 94502-6577

Re: Quarterly Summary Report – First Quarter 2005
76 Service Station No. 6034 / WNO 1525
4700 First Street
Livermore, California

Dear Mr. Schultz:

On behalf of ConocoPhillips Company (ConocoPhillips), ATC Associates Inc. (ATC) is forwarding the quarterly summary report for the above referenced facility.

Sincerely,
ATC ASSOCIATES INC.

David A. Evans
Senior Project Manager

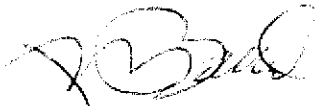
Janine Weber-Band, PhD, CEG #2286
Principal Geologist

Attachment: Site Plan

Cc: Ms. Shelby Lathrop, ConocoPhillips

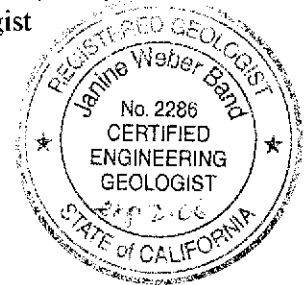

QUARTERLY SUMMARY REPORT First Quarter 2005

76 Service Station No. 6034 / WNO 1525
4700 First Street
Livermore, California

City/County ID#: Livermore
County: Alameda

PREVIOUS ASSESSMENT

The subject site is an active gasoline station and located adjacent to and northwest of the Arroyo Seco (intermittent drainage stream). Two gasoline stations are located adjacent to the site. The site is located approximately 9,000 feet northwest of Lawrence Livermore National Laboratory.

August 1989: Two underground storage tanks (USTs), one waste oil UST, and the product piping were removed. Petroleum hydrocarbon levels in soil samples collected beneath the fuel USTs were non-detect to moderate.

October 1989: Monitor wells MW-1 through MW-4 were installed.

January 1990: A monthly monitoring and quarterly sampling program was initiated.

April 1991: Monitor wells MW-5 through MW-7 were installed.

August 1995: An oxygen-releasing compound (magnesium peroxide) was placed in MW-2 to enhance biodegradation of petroleum hydrocarbons. Also, a non-attainment zone status was sought from the regulatory agencies.

October 2003: Site environmental consulting responsibilities were transferred to TRC.

January 2005: Site environmental consulting responsibilities were transferred to ATC. A comprehensive closure evaluation is ongoing to determine the most feasible and attainable route to closure.

SENSITIVE RECEPTORS

The site is located adjacent to and northwest of Arroyo Seco (intermittent drainage stream).

GROUNDWATER MONITORING AND SAMPLING

Groundwater beneath the site is currently monitored and sampled on a semi annual basis during the second and fourth quarters of each year. No sampling occurred this quarter.

REMEDIATION STATUS

Remediation is not currently being conducted at the site.

CHARACTERIZATION STATUS

Based on the most current groundwater and soil analytical data, the dissolved gasoline plume appears to be delineated. However, dissolved MtBE in MW-2 was most recently reported at 5.9 ug/l. Groundwater in the site area is designated as a possible drinking water source.

RECENT CORRESPONDENCE

No correspondence this quarter.

THIS QUARTER ACTIVITIES (First Quarter 2005)

1. ATC Associates Inc. (ATC) became the new lead consultant for the site.

WASTE DISPOSAL SUMMARY

No waste was generated this quarter.

NEXT QUARTER ACTIVITIES (Second Quarter 2005)

1. ATC will review the historic analytical data and compare to the Region 5 – Central Valley – Water Board's closure standards. If appropriate, a Site Closure report will be prepared. Closure applicability and outstanding action items needed with regards to site path forward will be discussed with the lead regulatory agency.
2. The monitor well network will be monitored and sampled by TRC.

CONSULTANT: ATC Associates Inc.



Shaw™ Shaw Environmental, Inc.

4005 Port Chicago Hwy
Concord, California 94520

Mr. Robert Schultz
Alameda County Health Agency
1131 Harbor Bay Parkway
Alameda, California 94502

Re: **Report Transmittal
Quarterly Report
First Quarter – 2005
76 Service Station #6034
4700 First Street
Livermore, CA**

Dear Mr. Schultz:

I declare under penalty of perjury that to the best of my knowledge the information and/or recommendations contained in the attached report is/are true and correct.

If you have any questions or need additional information, please call me at (916) 558-7609.

Sincerely,

Shelby Suzanne Lathrop
Project Manager
Shaw Environmental, Inc.
Approved service provider of ConocoPhillips -Risk Management & Remediation
Cell: 707-592-1146

Client Contact Information:
ConocoPhillips
76 Broadway
Sacramento, California 95818
Client office: 916-558-7609
Client fax: 916-558-7639

Attachment

cc: Liz Sewell, ConocoPhillips

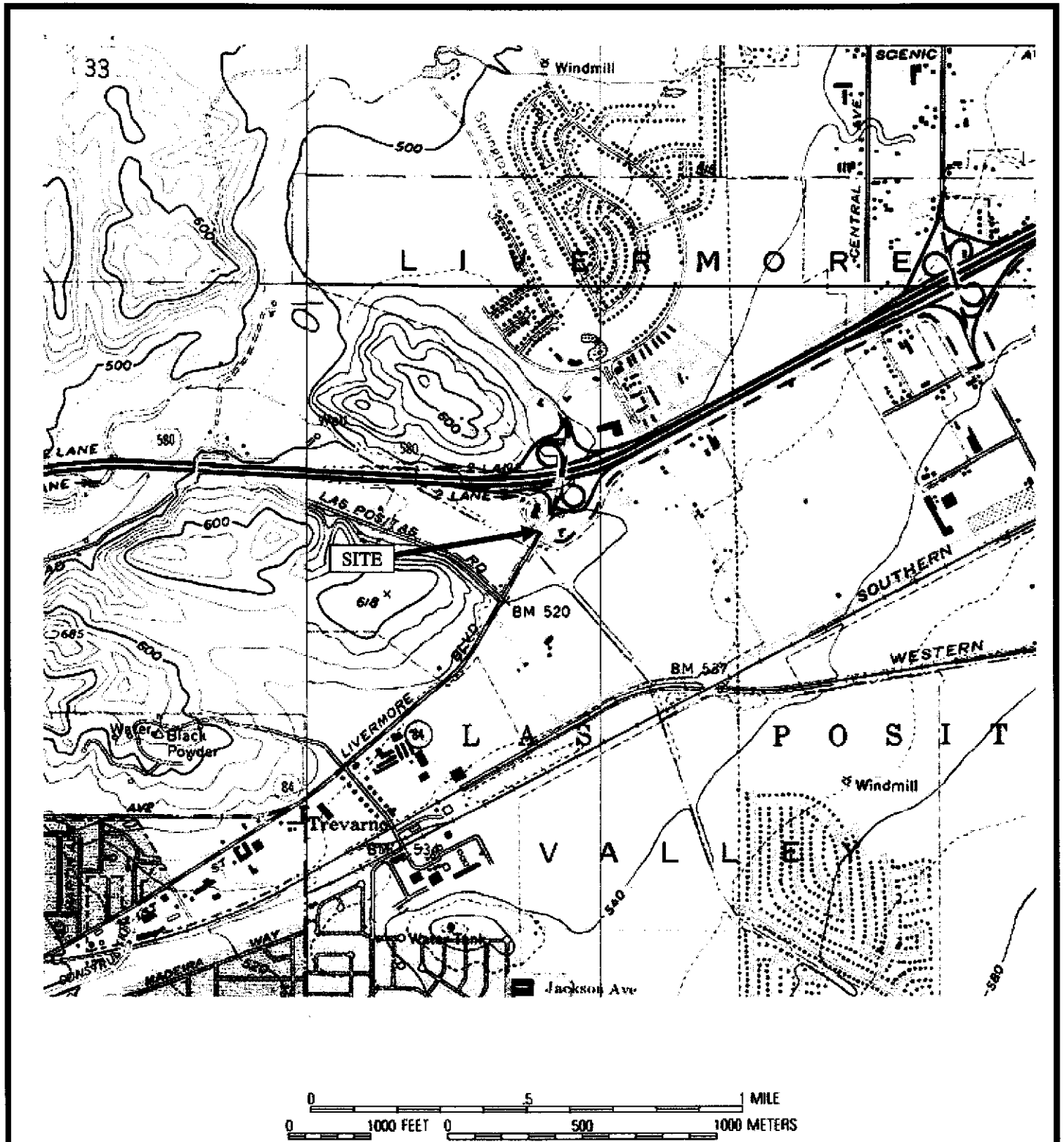

SOURCE: USGS ALTAMONT QUADRANGLE, CALIFORNIA (7.5 MINUTE SERIES) TOPOGRAPHIC MAP. OBTAINED FROM THE 2000 NATIONAL GEOGRAPHIC TOPO! SOFTWARE.



6602 Owens Drive, Suite 100
 Pleasanton, CA 94588
 (925) 460-5300

PROJECT NO: 75.75118.1525

DESIGNED BY: DE	SCALE: N/A	REVIEWED BY: DE
DRAWN BY: EC	DATE: 04/05	FILE: 6034 SITE VIC

FIGURE 1
SITE VICINITY MAP

76 STATION 6034
 4700 FIRST STREET
 LIVERMORE, CALIFORNIA

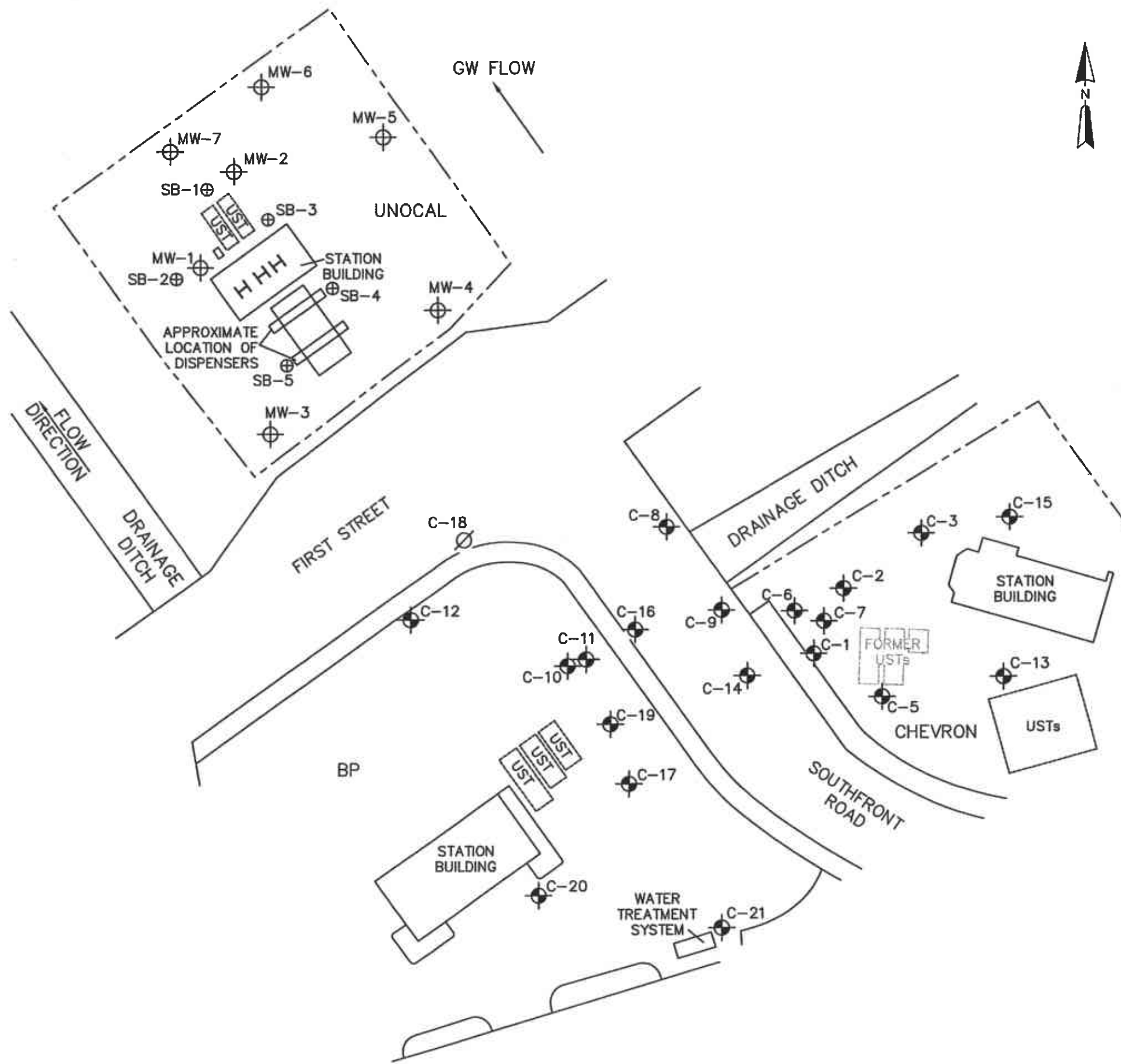

LEGEND

- PROPERTY BOUNDARY
- MW-7 ⊕ GROUNDWATER MONITORING WELL (TOSCO)
- C-21 ⊕ GROUNDWATER MONITORING WELL (CHEVRON)
- C-18 ∅ ABANDONED WELL

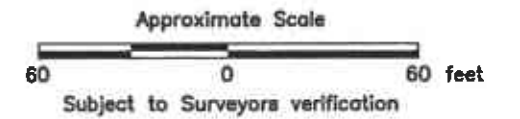

BASE MAP REFERENCE:
MODIFIED FROM SITE PLAN SUPPLIED BY
GETTLER-RYAN, NOVEMBER 2000.



6602 Owens Drive, Suite 100
Pleasanton, CA 94588
(925) 460-5300

SCALE AS SHOWN	DRAWING DATE 04/19/05	ACAD FILE 6034-site plan
-------------------	--------------------------	-----------------------------

SITE MAP

CLIENT	CONOCOPHILLIPS	PM	DAE
LOCATION	76 STATION 6034 4700 FIRST STREET LIVERMORE, CALIFORNIA	PE	DA
DESIGNED	DRAWN BY: EC	PROJECT NO. 75.75118.1525	FIGURE 2