

# Atlantic Richfield Company

**Shannon Couch**  
Operations Project Manager

PO Box 1257  
San Ramon, CA 94583  
Phone: (925) 275-3804  
Fax: (925) 275-3815  
E-Mail: shannon.couch@bp.com

July 27, 2012

Re: Second Quarter 2012 Status Report  
Atlantic Richfield Company Station #608  
17601 Hesperian Boulevard, San Lorenzo, California  
ACEH Case #RO0000255

**RECEIVED**

*10:41 am, Aug 01, 2012*

Alameda County  
Environmental Health

I declare that to the best of my knowledge at the present time, that the information and/or recommendations contained in the attached document are true and correct.

Submitted by,



Shannon Couch  
Operations Project Manager

Attachment



**BROADBENT**

1324 Mangrove Ave., Suite 212, Chico, CA 95926

[T] 530-566-1400 [F] 530-566-1401

broadbentinc.com

*Creating Solutions. Building Trust.*

July 27, 2012

Project No. 06-88-606

Atlantic Richfield Company  
P.O. Box 1257  
San Ramon, CA 94583  
Submitted via ENFOS

Attn.: Ms. Shannon Couch

Re: Second Quarter 2012 Status Report, Atlantic Richfield Company Station #608,  
17601 Hesperian Boulevard, San Lorenzo, California; ACEH Case #RO0000255

Dear Ms. Couch:

Attached is the Second Quarter 2012 Status Report for Atlantic Richfield Company Station #608 located at 17601 Hesperian Boulevard, San Lorenzo, California. This report presents a summary of current developments at the Site through the Second Quarter of 2012 regarding removal of the former remediation system and formal decommissioning of the remediation and monitoring wells associated with the case.

Should you have questions regarding this submittal, please do not hesitate to contact me at (530) 566-1400.

Sincerely,  
BROADBENT & ASSOCIATES, INC.

Thomas A. Venus, P.E.  
Senior Engineer

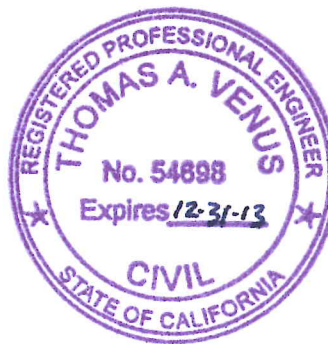

Enclosures

cc: Ms. Dilan Roe, P.E., Alameda County Environmental Health (submitted via ACEH ftp site)  
Electronic copy uploaded to GeoTracker

**SECOND QUARTER 2012  
STATUS REPORT  
ARCO STATION #608, SAN LORENZO, CALIFORNIA**

Broadbent & Associates, Inc. (Broadbent) is pleased to present this *Second Quarter 2012 Status Report* on behalf of Atlantic Richfield Company (a BP affiliated company) for ARCO Station #608 located in San Lorenzo, Alameda County, California. Quarterly reporting is being submitted to the Alameda County Environmental Health Services Agency (ACEH) consistent with their requirements under the legal authority of the California Regional Water Quality Control Board as codified by California Code of Regulations Title 23, Section 2652(d). A summary description of current developments regarding the site is provided below.

Facility Name / Address:	<u>ARCO Station #608 / 17601 Hesperian Boulevard, San Lorenzo</u>
Client Project Manager / Title:	<u>Ms. Shannon Couch / RM Operations Project Manager</u>
Broadbent Contact:	<u>Mr. Tom Venus, PE / (530) 566-1400</u>
Broadbent Project No.:	<u>06-88-606</u>
Primary Regulatory Agency / ID No.:	<u>ACEH, Case #RO0000255</u>
Current phase of project:	<u>Closure</u>
List of Acronyms / Abbreviations:	<u>See end of report text for list of acronyms/abbreviations used in report.</u>

**WORK PERFORMED THIS QUARTER (Second Quarter 2012):**

1. Submitted *First Quarter 2012 Status Report* (Broadbent, 4/5/2012).
2. Completed removal of former onsite remediation system (Broadbent & Cornerstone Environmental Contractors, 5/30/2012).

**WORK SCHEDULED FOR NEXT QUARTER (Third Quarter 2012):**

1. Decommissioned the remediation and monitoring wells associated with the case during the second week of July 2012 (Broadbent, Statewide Traffic Safety & Signs, Cascade Drilling, Cornerstone Environmental Contractors, and CalVac Paving, 7/9-13/2012).
2. Submitted *Second Quarter 2012 Status Report* (contained herein).
3. Submit Well Completion Reports (DWR Form 188's) to DWR and ACPWA.
4. Submit well decommissioning report to ACEH to receive Remedial Action Completion Certificate.

**DISCUSSION:**

The ACEH mailed to Atlantic Richfield Company a letter dated October 27, 2011 requesting that the remaining monitoring and remediation wells associated with the Site be destroyed prior to the ACEH sending a remedial action completion certificate. During the Second Quarter of 2012, Broadbent and its subcontractors completed the removal of the former onsite remediation system and finalized preparations for formal decommissioning of the existing wells associated with the case. During the first weeks of July 2012, the wells associated with the case were formally decommissioned under permit to ACPWA. The C-57 California-licensed water well drilling contractor is charged with preparing the Well Completion Reports as required under California Water Code on copies of the DWR Form 188. When completed, these forms will be submitted to DWR and ACPWA. Copies will be included in the Well Decommissioning Report to be submitted to ACEH during the early part of the Third Quarter of 2012. For reference, a Site Location Map is provided as Drawing 1, and a Site Layout Plan is provided as Drawing 2.

**ATTACHMENTS:**

- Drawing 1: Site Location Map
- Drawing 2: Site Layout Plan

**LIST OF COMMONLY USED ACCRONYMS/ABBREVIATIONS:**

ACEH:	Alameda County Environmental Health	ft/ft:	feet per foot
ACPWA:	Alameda County Public Works Agency	gal:	Gallons
BTEX:	Benzene, Toluene, Ethylbenzene, Total Xylenes	GRO:	Gasoline-Range Organics
1,2-DCA:	1,2-Dichloroethane	LNAPL:	Light Non-Aqueous Phase Liquid
DIPE:	Di-Isopropyl Ether	MTBE:	Methyl Tertiary Butyl Ether
DO:	Dissolved Oxygen	NO <sub>3</sub> :	Nitrate as Nitrogen
DRO:	Diesel-Range Organics	ppb:	parts per billion
DWR:	California Department of Water Resources	SO <sub>4</sub> :	Sulfate
Eh:	Oxidation Reduction Potential	TAME:	Tert-Amyl Methyl Ether
EPA:	Environmental Protection Agency	TBA:	Tertiary Butyl Ether
ETBE:	Ethyl Tertiary Butyl Ether	TOC:	Top of Casing
Fe <sup>2+</sup> :	Ferrous Iron	µg/L:	micrograms per liter

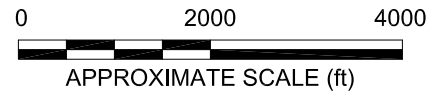
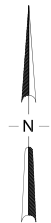
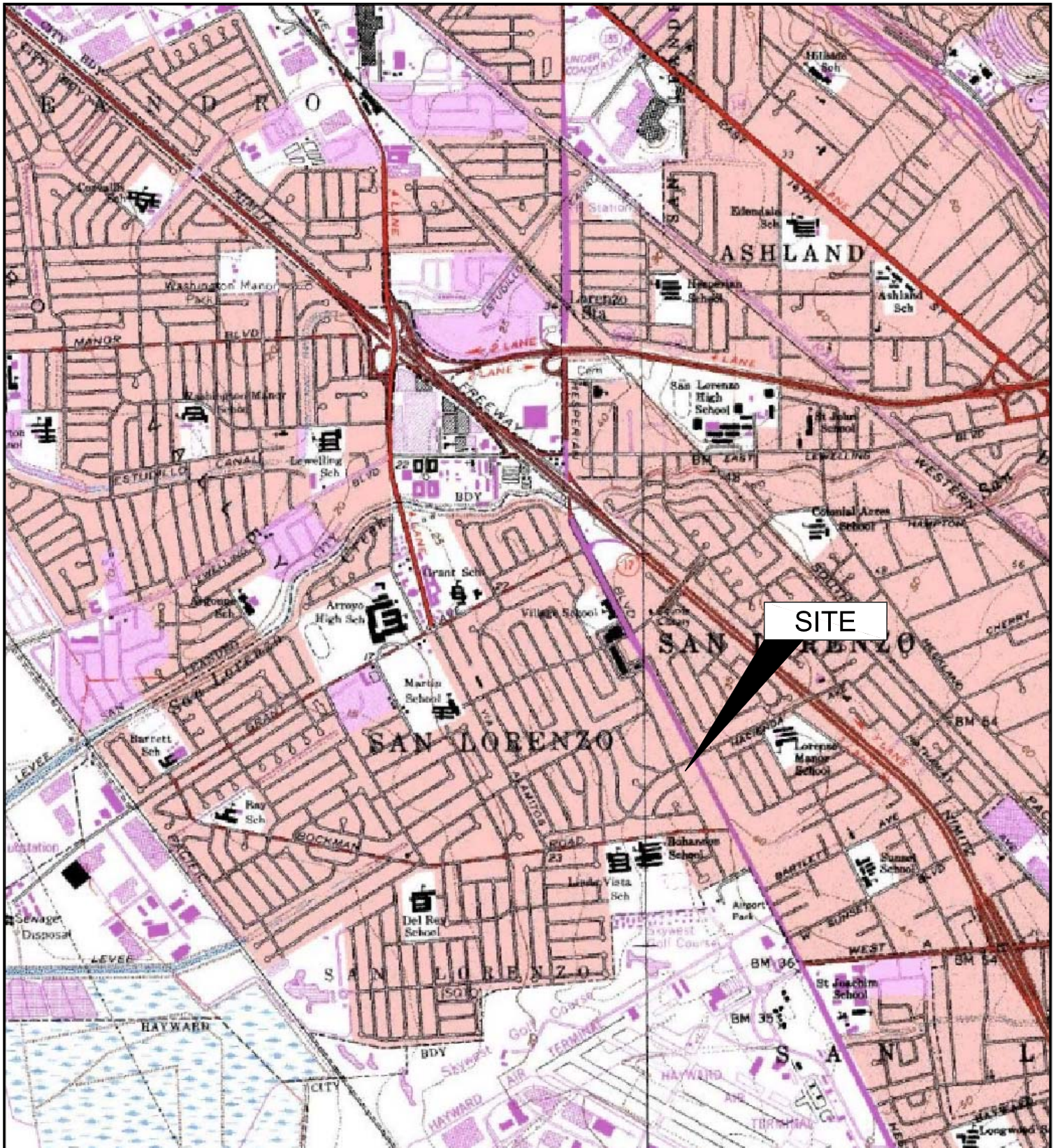

IMAGE SOURCE: USGS

**BROADBENT & ASSOCIATES, INC**  
 ENGINEERING, WATER RESOURCES & ENVIRONMENTAL  
 1324 Mangrove Ave. Suite 212, Chico, CA 95926  
 Project No.: 06-88-606 Date: 10/9/09

Station #608  
 17601 Hesperian Boulevard  
 San Lorenzo, California

Site Location Map

Drawing  
**1**

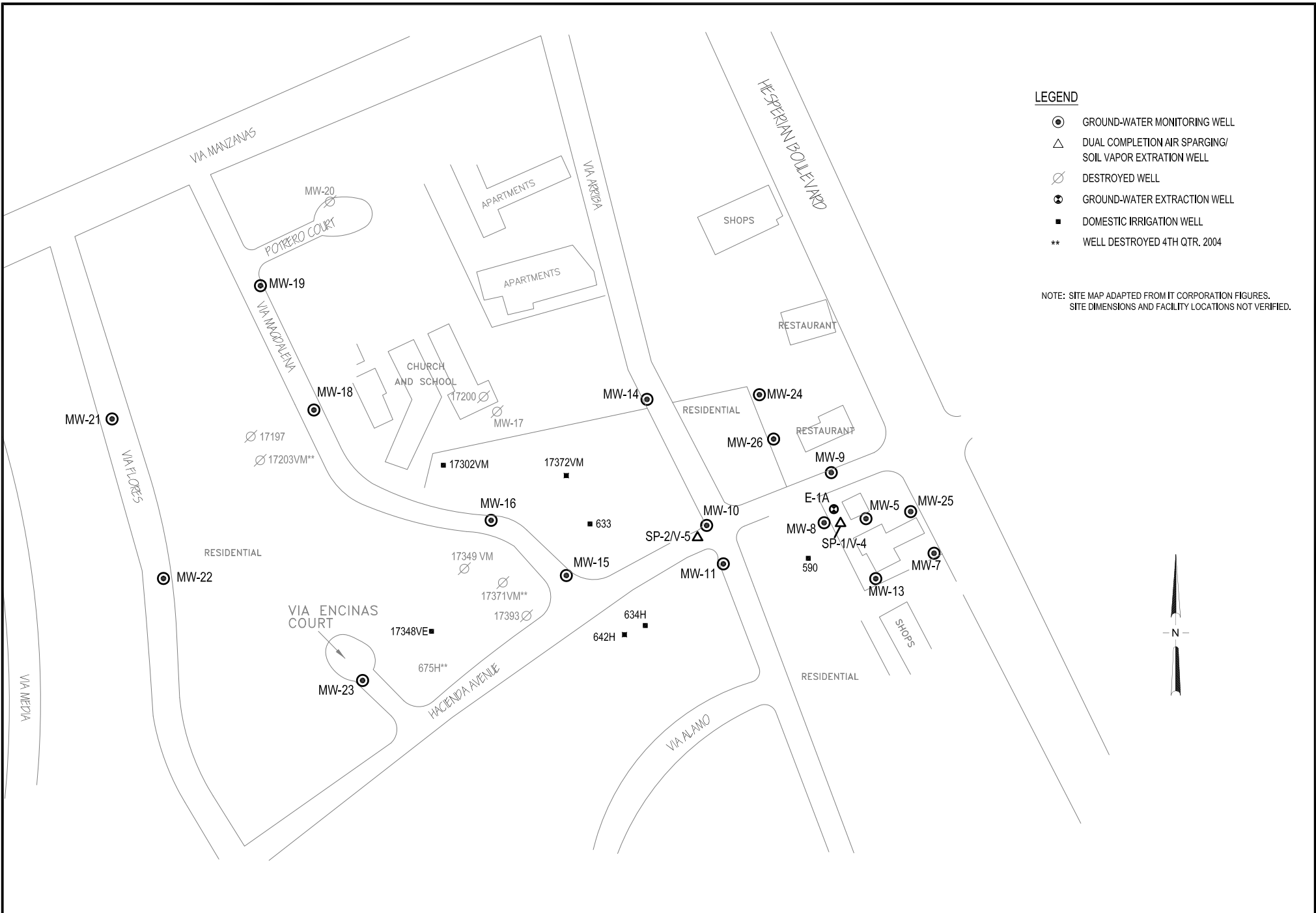

**LEGEND**

- ⊙ GROUND-WATER MONITORING WELL
- △ DUAL COMPLETION AIR SPARGING/ SOIL VAPOR EXTRACTION WELL
- ⊘ DESTROYED WELL
- ⊕ GROUND-WATER EXTRACTION WELL
- DOMESTIC IRRIGATION WELL
- \*\* WELL DESTROYED 4TH QTR. 2004

NOTE: SITE MAP ADAPTED FROM IT CORPORATION FIGURES.  
SITE DIMENSIONS AND FACILITY LOCATIONS NOT VERIFIED.



**BROADBENT & ASSOCIATES, INC.**  
ENGINEERING, WATER RESOURCES & ENVIRONMENTAL  
1324 Mangrove Ave. Suite 212, Chico, California 95926  
Project No.: 06-08-606 Date: 4/6/12

ARCO Service Station #608  
17601 Hesperian Boulevard  
San Lorenzo, California

Site Layout Plan

Drawing

2