

# Atlantic Richfield Company

**Chuck Carmel**  
Environmental Business Manager

**RECEIVED**

10:30 am, Jul 07, 2010

Alameda County  
Environmental Health

PO Box 1257  
San Ramon, CA 94583  
Phone: (925) 275-3803  
Fax: (925) 275-3815  
E-Mail: charles.carmel@bp.com

6 July 2010

Re: Second Quarter 2010 Status Report  
Atlantic Richfield Company Station #608  
17601 Hesperian Boulevard, San Lorenzo, California  
ACEH Case #RO0000255

"I declare, that to the best of my knowledge at the present time, that the information and/or recommendations contained in the attached document are true and correct.

Submitted by,



Chuck Carmel  
Environmental Business Manager

Attachment

6 July 2010

Project No. 06-88-606

Atlantic Richfield Company  
P.O. Box 1257  
San Ramon, CA 94583  
Submitted via ENFOS

Attn.: Mr. Chuck Carmel

Re: Second Quarter 2010 Status Report, Atlantic Richfield Company Station #608  
17601 Hesperian Boulevard, San Lorenzo, California; ACEH Case #RO0000255

Dear Mr. Carmel:

Attached is the *Second Quarter 2010 Status Report* for Atlantic Richfield Company (a BP affiliated company) Station #608 located at 17601 Hesperian Boulevard, San Lorenzo, Alameda County, California (Site). This report presents a summary of current developments at the Site through the Second Quarter of 2010.

Should you have questions regarding this submittal, please do not hesitate to contact me at (530) 566-1400.

Sincerely,

BROADBENT & ASSOCIATES, INC.



Thomas A. Venus, P.E.  
Senior Engineer



Enclosures

cc: Mr. Paresh Khatri, Alameda County Environmental Health (Submitted via ACEH ftp site)  
Electronic copy uploaded to GeoTracker

## STATION # 608 QUARTERLY STATUS REPORT

Facility: #608	Address: 17601 Hesperian Boulevard, San Lorenzo, California
Environmental Business Manager:	Mr. Chuck Carmel
Consulting Co./Contact Person:	Broadbent & Associates, Inc.(BAI)/Mr. Tom Venus, PE (530) 566-1400
Consultant Project No.:	06-88-606
Primary Agency/Regulatory ID No.:	Alameda County Environmental Health (ACEH) ACEH Case # RO0000255

### WORK PERFORMED THIS QUARTER (Second Quarter 2010):

1. Prepared and submitted the *First Quarter 2010 Status Report* (BAI, 4/5/2010).
2. No environmental field work was conducted at the Site during the Second Quarter of 2010.

### WORK PROPOSED FOR NEXT QUARTER (Third Quarter 2010):

1. Prepared and submitted the Second Quarter 2010 Status Report (contained herein).
2. Prepare and submit the *Case Closure Summary Report* to ACEH.
3. No environmental field work is scheduled at the Site during the Third Quarter 2010.
4. Await case closure notice from ACEH with approval to abandon wells.

### DISCUSSION:

A letter to Atlantic Richfield Company from the Alameda County Environmental Health (ACEH) dated 19 February 2009 stated that Station #608 is currently being considered for case closure. The letter further stated that BP would be notified of the results of the closure evaluation in approximately six months. Atlantic Richfield Company is currently awaiting a response from ACEH regarding case closure. On behalf of Atlantic Richfield Company, BAI is preparing a Case Closure Summary Report form to assist ACEH and hasten the closure process. Periodic ground-water monitoring has been suspended at the Site as dictated in the ACEH letter of 19 February 2009. For reference, a Site Location Map is provided as Drawing 1 and a Ground-Water Elevation Contour and Analytical Summary Map from Fourth Quarter 2008 is provided as Drawing 2.

### ATTACHMENTS:

- Drawing 1. Site Location Map, ARCO Service Station #608, 17601 Hesperian Boulevard, San Lorenzo, California
- Drawing 2. Ground-Water Elevation Contour and Analytical Summary Map, 2 December 2008, ARCO Service Station #608, 17601 Hesperian Boulevard, San Lorenzo, California



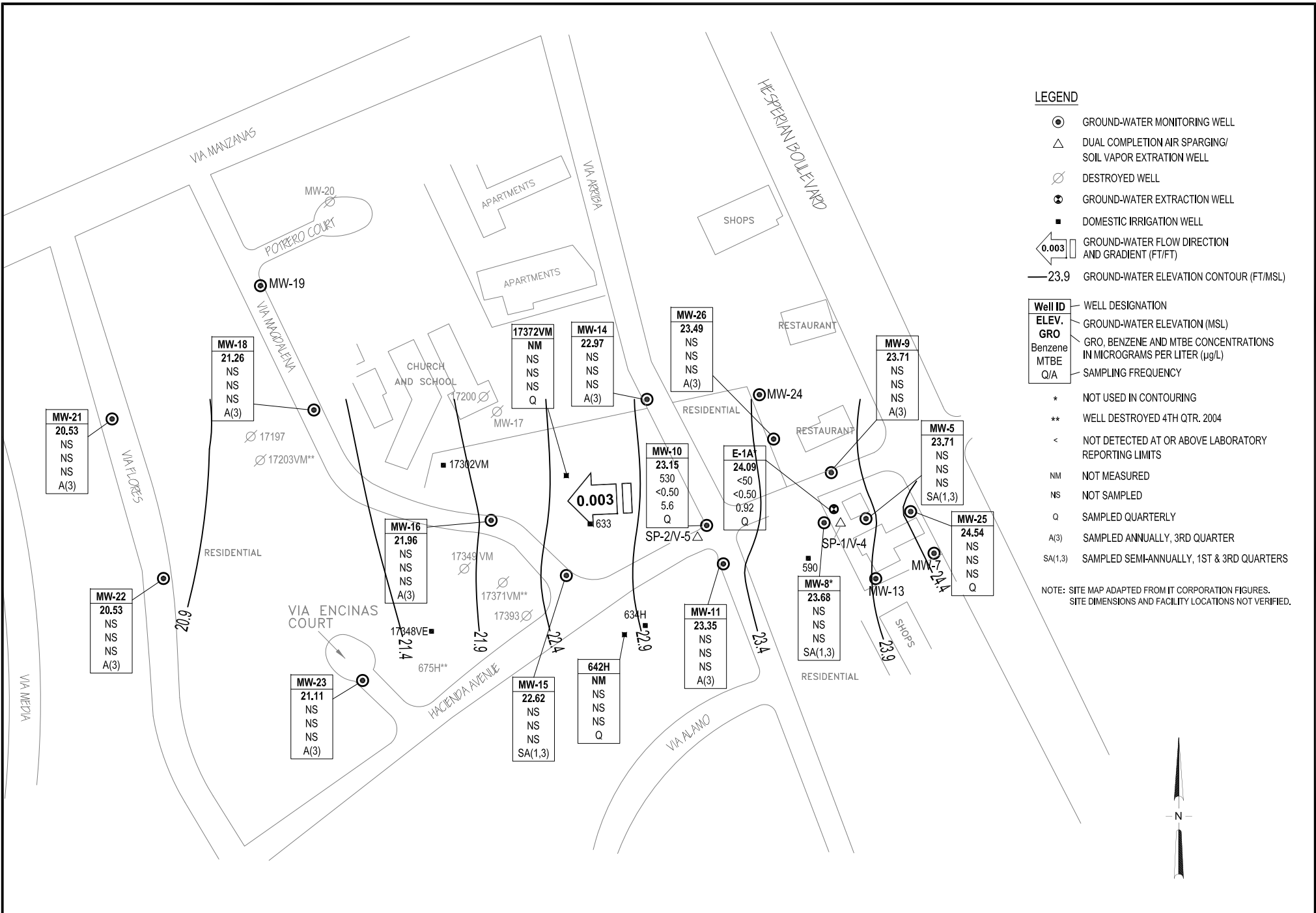

Well ID	WELL DESIGNATION
ELEV.	GROUND-WATER ELEVATION (MSL)
GRO	GRO, BENZENE AND MTBE CONCENTRATIONS IN MICROGRAMS PER LITER (µg/L)
Benzene	
MTBE	
Q/A	SAMPLING FREQUENCY

\* NOT USED IN CONTOURING  
 \*\* WELL DESTROYED 4TH QTR. 2004  
 < NOT DETECTED AT OR ABOVE LABORATORY REPORTING LIMITS  
 NM NOT MEASURED  
 NS NOT SAMPLED  
 Q SAMPLED QUARTERLY  
 A(3) SAMPLED ANNUALLY, 3RD QUARTER  
 SA(1,3) SAMPLED SEMI-ANNUALLY, 1ST & 3RD QUARTERS

NOTE: SITE MAP ADAPTED FROM IT CORPORATION FIGURES. SITE DIMENSIONS AND FACILITY LOCATIONS NOT VERIFIED.



**BROADBENT & ASSOCIATES, INC.**  
 ENGINEERING, WATER RESOURCES & ENVIRONMENTAL  
 1324 Mangrove Ave. Suite 212, Chico, California 95926  
 Project No.: 06-08-606 Date: 1/16/09

ARCO Service Station #608  
 17601 Hesperian Boulevard  
 San Lorenzo, California

Ground-Water Elevation Contours  
 and Analytical Summary Map  
 2 December 2008