

Atlantic Richfield Company

Chuck Carmel
Environmental Business Manager

RECEIVED

10:34 am, Oct 19, 2009

**Alameda County
Environmental Health**

PO Box 1257
San Ramon, CA 94583
Phone: (925) 275-3803
Fax: (925) 275-3815
E-Mail: charles.carmel @bp.com

16 October 2009

Re: Third Quarter 2009 Status Report
Atlantic Richfield Company Station #608
17601 Hesperian Boulevard, San Lorenzo, California
ACEH Case #RO0000255

"I declare, that to the best of my knowledge at the present time, that the information and/or recommendations contained in the attached document are true and correct.

Submitted by,



Chuck Carmel
Environmental Business Manager

Attachment

16 October 2009

Project No. 06-88-606

Atlantic Richfield Company
P.O. Box 1257
San Ramon, CA 94583
Submitted via ENFOS

Attn.: Mr. Chuck Carmel

Re: Third Quarter 2009 Status Report, Atlantic Richfield Company Station #608
17601 Hesperian Boulevard, San Lorenzo, California; ACEH Case #RO0000255

Dear Mr. Carmel:

Attached is the *Third Quarter 2009 Status Report* for Atlantic Richfield Company (a BP affiliated company) Station #608 located at 17601 Hesperian Boulevard, San Lorenzo, Alameda County, California. This report presents a summary of current developments at the Site through the Third Quarter of 2009.

Should you have questions regarding this submittal, please do not hesitate to contact me at (530) 566-1400.

Sincerely,
BROADBENT & ASSOCIATES, INC.



Thomas A. Venus, P.E.
Senior Engineer



Enclosures

cc: Mr. Paresh Khatri, Alameda County Environmental Health (Submitted via ACEH ftp site)
Electronic copy uploaded to GeoTracker

STATION # 608 QUARTERLY STATUS REPORT

Facility: #608	Address: 17601 Hesperian Boulevard, San Lorenzo, California
Environmental Business Manager:	Mr. Chuck Carmel
Consulting Co./Contact Persons:	Broadbent & Associates, Inc.(BAI)/Mr. Tom Venus, PE (530) 566-1400
Consultant Project No.:	06-02-606
Primary Agency/Regulatory ID No.:	Alameda County Environmental Health (ACEH) ACEH Case # RO0000255
Facility Permits/Permitting Agency:	Oro Loma Sanitary District Permit #SDP-037

WORK PERFORMED THIS QUARTER (Third Quarter 2009):

1. Prepared and submitted the *Second Quarter 2009 Status Report* (BAI, 7/7/2009).
2. No environmental work was conducted at the Site during the Third Quarter of 2009.

WORK PROPOSED FOR NEXT QUARTER (Fourth Quarter 2009):

1. Prepared and submitted the Third Quarter 2009 Status Report (contained herein).
2. No environmental field work is scheduled at the Site during the Fourth Quarter 2009.
3. Prepare and submit Case Closure Summary Report form to ACEH.

DISCUSSION:

A recent directive letter to Atlantic Richfield Company from ACEH dated 19 February 2009 stated that Station #608 is currently being considered for case closure. The letter further stated that BP would be notified of the results of the closure evaluation in approximately six months. Atlantic Richfield Company is currently awaiting a response from ACEH regarding case closure. During a telephone conversation on 11 September 2009, Mr. Paresh Khatri of ACEH informed Mr. Venus of BAI that ACEH would be receptive to receiving a draft of the Case Closure Summary Report form. On behalf of Atlantic Richfield Company, BAI has begun preparation of the Case Closure Summary Report form. Periodic ground-water monitoring has been suspended at the Site as dictated in the ACEH letter of 19 February 2009. For reference, a Site Location Map is provided as Drawing 1 and a Ground-Water Elevation Contour and Analytical Summary Map from Fourth Quarter 2008 is provided as Drawing 2.

ATTACHMENTS:

- Drawing 1. Site Location Map, ARCO Service Station #608, 17601 Hesperian Boulevard, San Lorenzo, California
- Drawing 2. Ground-Water Elevation Contour and Analytical Summary Map, 2 December 2008, ARCO Service Station #608, 17601 Hesperian Boulevard, San Lorenzo, California

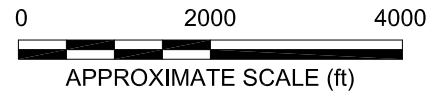
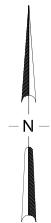
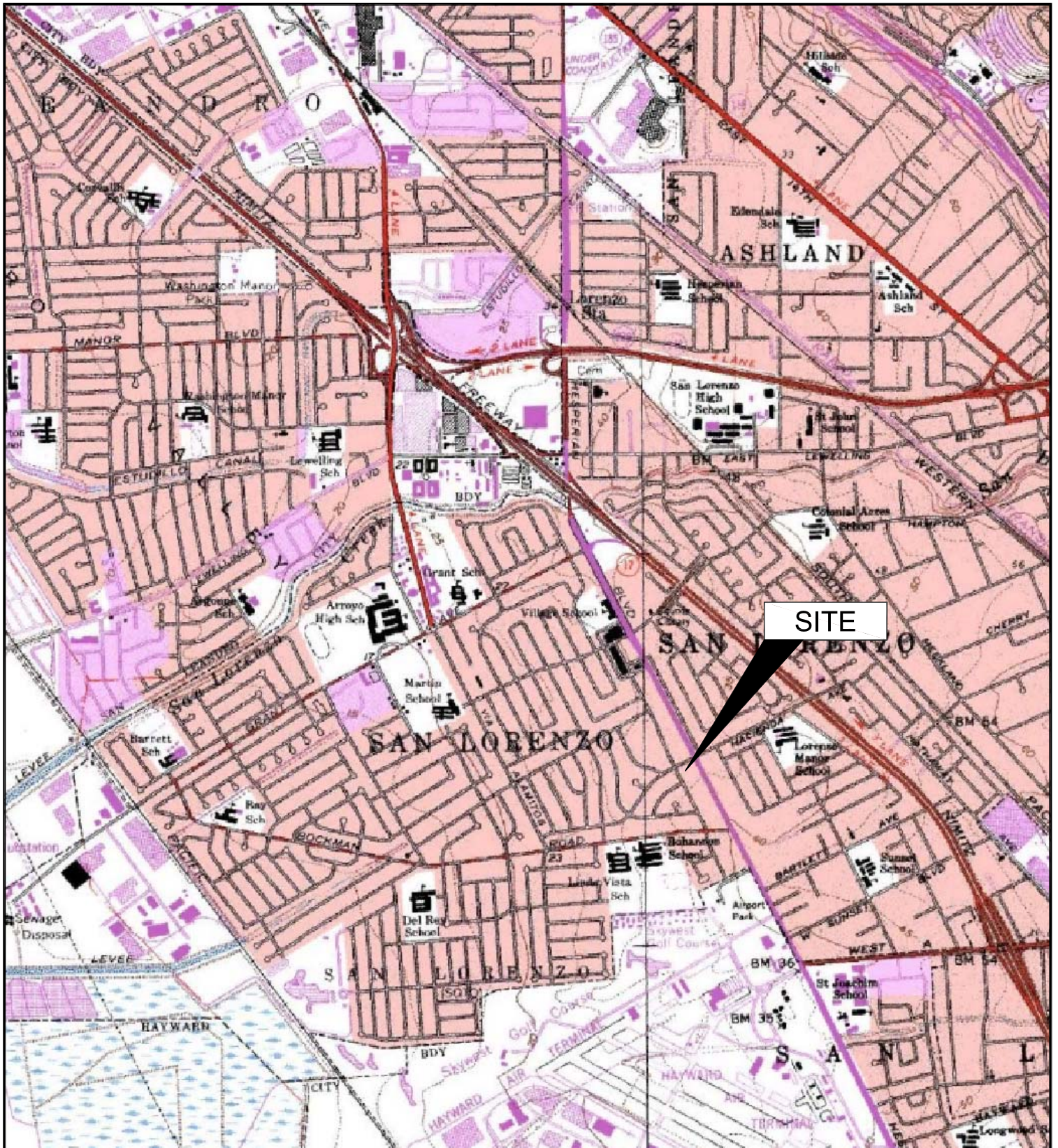
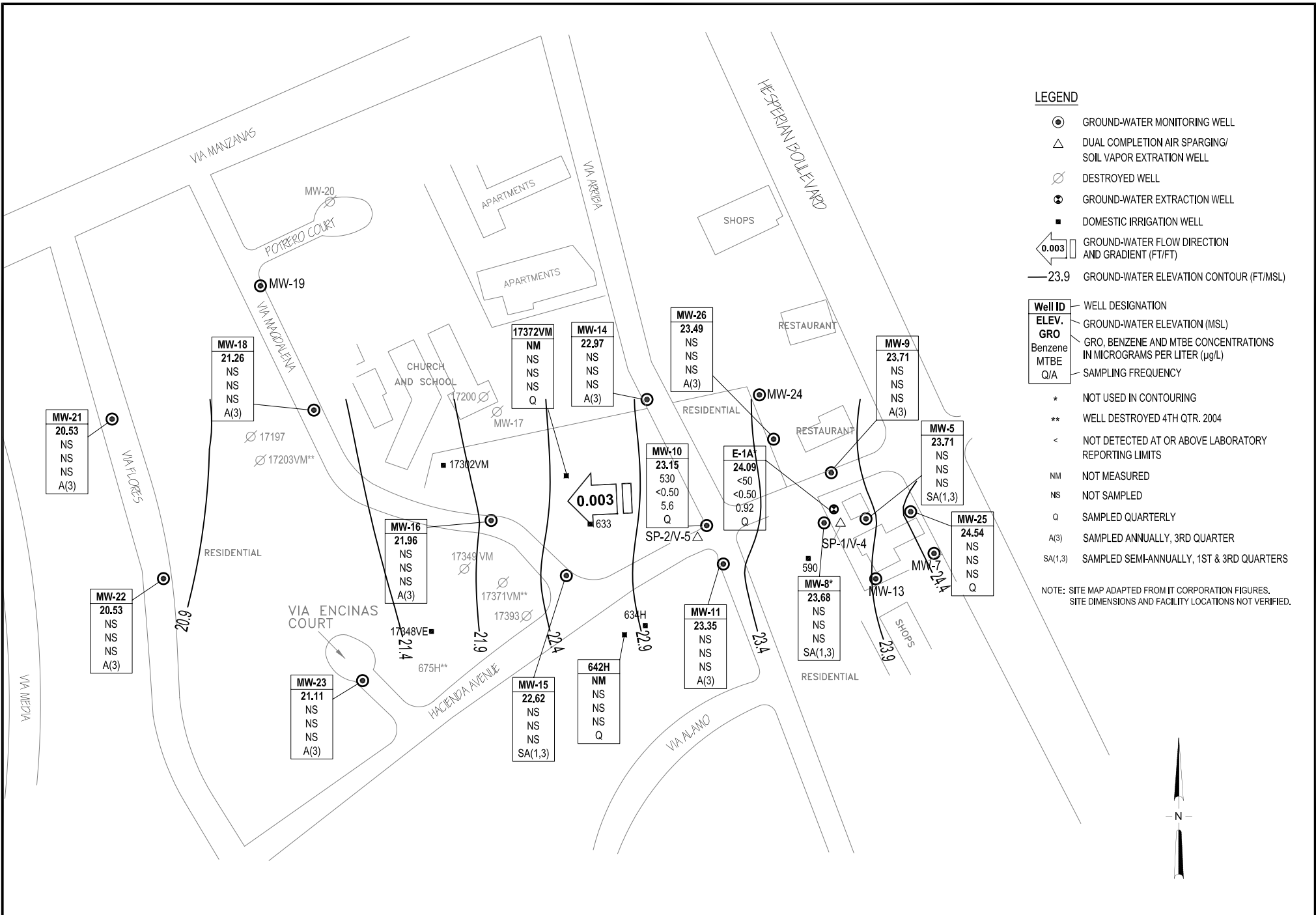

IMAGE SOURCE: USGS



Well ID	WELL DESIGNATION
ELEV.	GROUND-WATER ELEVATION (MSL)
GRO	GRO, BENZENE AND MTBE CONCENTRATIONS IN MICROGRAMS PER LITER (µg/L)
Benzene	
MTBE	
Q/A	SAMPLING FREQUENCY

* NOT USED IN CONTOURING
 ** WELL DESTROYED 4TH QTR. 2004
 < NOT DETECTED AT OR ABOVE LABORATORY REPORTING LIMITS
 NM NOT MEASURED
 NS NOT SAMPLED
 Q SAMPLED QUARTERLY
 A(3) SAMPLED ANNUALLY, 3RD QUARTER
 SA(1,3) SAMPLED SEMI-ANNUALLY, 1ST & 3RD QUARTERS

NOTE: SITE MAP ADAPTED FROM IT CORPORATION FIGURES. SITE DIMENSIONS AND FACILITY LOCATIONS NOT VERIFIED.



BROADBENT & ASSOCIATES, INC.
 ENGINEERING, WATER RESOURCES & ENVIRONMENTAL
 1324 Mangrove Ave. Suite 212, Chico, California 95926
 Project No.: 06-08-606 Date: 1/16/09

ARCO Service Station #608
 17601 Hesperian Boulevard
 San Lorenzo, California

Ground-Water Elevation Contours
 and Analytical Summary Map
 2 December 2008