



Atlantic Richfield Company
(a BP affiliated company)

P.O. Box 1257
San Ramon, CA 94583
Phone: (925) 275-3801
Fax: (925) 275-3815

30 April 2009

Re: First Quarter 2009 Status Report
Atlantic Richfield Company (a BP affiliated company) Station #608
17601 Hesperian Boulevard
San Lorenzo, California
ACEH Case #RO0000255

RECEIVED

10:13 am, May 01, 2009

Alameda County
Environmental Health



“I declare, that to the best of my knowledge at the present time, that the information and/or recommendations contained in the attached document are true and correct.”

Submitted by:

Paul Supple
Environmental Business Manger

30 April 2009

Project No. 06-08-606

Atlantic Richfield Company
P.O. Box 1257
San Ramon, CA 94583
Submitted via ENFOS

Attn.: Mr. Paul Supple

Re: First Quarter 2009 Status Report, Atlantic Richfield Company (a BP affiliated company)
Station #608, 17601 Hesperian Boulevard, San Lorenzo, California; ACEH Case
#RO0000255

Dear Mr. Supple:

Attached is the *First Quarter 2009 Status Report* for Atlantic Richfield Company Station #608 located at 17601 Hesperian Boulevard, San Lorenzo, Alameda County, California. This report presents a summary of current developments at the Site through the First Quarter of 2009.

Should you have questions regarding this submittal, please do not hesitate to contact us at (530) 566-1400.

Sincerely,
BROADBENT & ASSOCIATES, INC.



Thomas A. Venus, P.E.
Senior Engineer



Robert H. Miller, P.G., C.HG.
Principal Hydrogeologist

Enclosures

cc: Mr. Paresh Khatri, Alameda County Environmental Health (Submitted via ACEH ftp site)
Electronic copy uploaded to GeoTracker

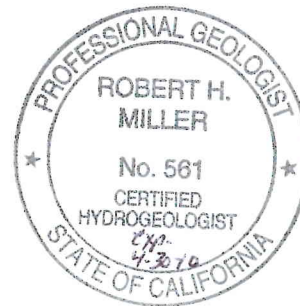

STATION # 608 QUARTERLY GROUND-WATER STATUS REPORT

Facility: #608	Address:	17601 Hesperian Boulevard, San Lorenzo, California
Environmental Business Manager:		Mr. Paul Supple
Consulting Co./Contact Persons:		Broadbent & Associates, Inc.(BAI)/Rob Miller & Tom Venus (530) 566-1400
Consultant Project No.:		06-02-606
Primary Agency/Regulatory ID No.:		Alameda County Environmental Health (ACEH) ACEH Case # RO0000255
Facility Permits/Permitting Agency:		Oro Loma Sanitary District Permit #SDP-037

WORK PERFORMED THIS QUARTER (First Quarter 2009):

1. Prepared and submitted the Fourth Quarter 2008 Ground-Water Monitoring Report.
2. No environmental work was conducted at the Site during the First Quarter of 2009.

WORK PROPOSED FOR NEXT QUARTER (Second Quarter 2009):

1. Prepared and submitted the First Quarter 2009 Status Report (contained herein).
2. No environmental work is scheduled at the Site during the Second Quarter 2009.

DISCUSSION:

A recent directive letter to Atlantic Richfield Company from ACEH dated 19 February 2009 stated that ARCO Station #608 is currently being considered for case closure. Quarterly ground-water monitoring has been suspended at the Site as dictated in the ACEH letter. BP is currently awaiting a response from ACEH regarding case closure. A Ground-Water Elevation Contour and Analytical Summary Map from Fourth Quarter 2008 is provided as Drawing 1.

ATTACHMENTS:

1. Drawing 1. Ground-Water Elevation Contour and Analytical Summary Map, 2 December 2008, ARCO Service Station #608, 17601 Hesperian Boulevard, San Lorenzo, California

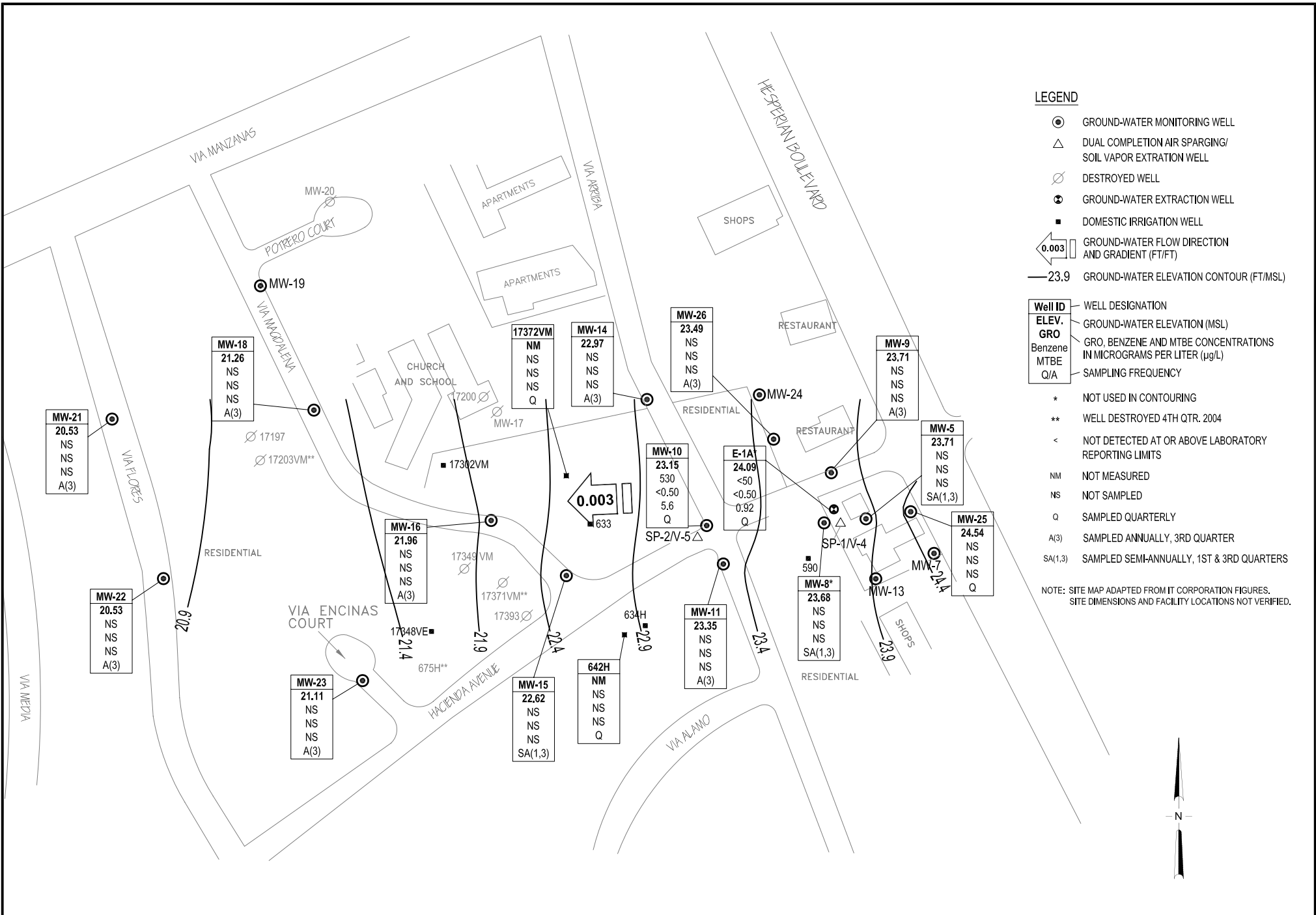

LEGEND

- ⊙ GROUND-WATER MONITORING WELL
- △ DUAL COMPLETION AIR SPARGING/ SOIL VAPOR EXTRACTION WELL
- ⊘ DESTROYED WELL
- ⊕ GROUND-WATER EXTRACTION WELL
- DOMESTIC IRRIGATION WELL
- ← 0.003 GROUND-WATER FLOW DIRECTION AND GRADIENT (FT/FT)
- 23.9 GROUND-WATER ELEVATION CONTOUR (FT/MSL)

Well ID	WELL DESIGNATION
ELEV.	GROUND-WATER ELEVATION (MSL)
GRO	GRO, BENZENE AND MTBE CONCENTRATIONS IN MICROGRAMS PER LITER (µg/L)
Benzene	
MTBE	
Q/A	SAMPLING FREQUENCY
*	NOT USED IN CONTOURING
**	WELL DESTROYED 4TH QTR. 2004
<	NOT DETECTED AT OR ABOVE LABORATORY REPORTING LIMITS
NM	NOT MEASURED
NS	NOT SAMPLED
Q	SAMPLED QUARTERLY
A(3)	SAMPLED ANNUALLY, 3RD QUARTER
SA(1,3)	SAMPLED SEMI-ANNUALLY, 1ST & 3RD QUARTERS

NOTE: SITE MAP ADAPTED FROM IT CORPORATION FIGURES. SITE DIMENSIONS AND FACILITY LOCATIONS NOT VERIFIED.



BROADBENT & ASSOCIATES, INC.
ENGINEERING, WATER RESOURCES & ENVIRONMENTAL
1324 Mangrove Ave. Suite 212, Chico, California 95926
Project No.: 06-08-606 Date: 1/16/09

ARCO Service Station #608
17601 Hesperian Boulevard
San Lorenzo, California

Ground-Water Elevation Contours
and Analytical Summary Map
2 December 2008

Drawing

1