

SITE CLOSURE REPORT  
BUILDING 12  
U.S. COAST GUARD  
COAST GUARD ISLAND  
ALAMEDA, CA

Prepared By:

Scott Vickers

RAH Environmental, Inc.

3310 Swetzer Road

Loomis, CA 95650

November 17, 1997

## **EXECUTIVE SUMMARY**

RAH Environmental, Inc. was contracted by the United States Coast Guard under contract #DTSC88-97-D-623174 to perform underground storage tank removal operations at Building 12 on Coast Guard Island in Alameda, CA. The project included the removal of one one hundred gallon gasoline storage tank and related piping that were probably used to fuel an emergency generator once located in Building 12. The necessary permits were obtained from the Alameda County Department of Environmental Health and on October 29-31, the tank and related piping were rinsed and removed. Two soil samples were collected from the tank excavation and the stockpile. The tank removal operations and the analytical results are described in detail in the following report.

### **I. INTRODUCTION**

RAH Environmental, Inc. was contracted by the United States Coast Guard under contract #DTSC88-97-B-623174 to perform underground storage tank and piping removal operations at Building 12 on Coast Guard Island in Alameda, CA. The project included the removal of one on hundred gallon gasoline storage tank and related piping.

### **II. BACKGROUND**

The project site is on Coast Guard Island, located in Alameda, CA. The underground storage tank was probably used in the past to fuel for an emergency generator in Building 12. There is no generator there currently, therefore, the tank was removed.

### **III. CONTRACTOR INFORMATION**

Prime Contractor: RAH Environmental, inc.  
3310 Swetzer Road  
Loomis, CA 95650  
(916)652-5777  
Contact: Ray Henry

Subcontractors: None

### **IV. SITE DESCRIPTION**

The underground storage tank was located in the front, or to the west of Building 12. The tank was behind and beneath three large bushes and immediately adjacent to the building. Building 12 is located in the center of the island on McCullough Drive, just south of Campbell Blvd.

## V. REMOVAL ACTIVITIES

### Notifications and Permits

An Underground Tank Closure Plan was completed and filed with Alameda County Environmental Protection Division of the Department of Environmental health, in addition to the State of California Form A and Form B. The inspector for the project is Mr. Barney Chan, who was on-site for inspection and removal of the tank. A copy of permit and the Alameda County inspection report are attached.

### Tank Preparation

On October 28, 1997, RAH Environmental, Inc. prepared to remove the underground tank by removing three bushes and excavating above and next to the tank. There was approximately 15' of supply and return piping connected to the tank that was disconnected and removed.

### Fuel and Water Removal

On October 28, 1997, approximately 50 gallons of old gasoline were pumped from the underground tank directly into a pump truck. An additional 90 gallons of water was used to rinse the tank and remove sludge. All liquid waste was transported under manifest #96412931 to B.C. Stocking in Dixon, CA for recycling.

### Tank Removal Operations

The underground tank was removed on October 29 utilizing the Bobcat excavator and placing the tank directly on the Erickson truck for transportation to Erickson Incorporated in Richmond under manifest #95593245 for destruction/recycling.

## VI. ANALYTICAL

### Soil Sampling and Analysis

On October 30, 1997, soil sampling operations were conducted at the site. One sample, labeled Bldg. 12 Pit was collected from the base of the tank excavation, and one sample, labeled Bldg. 12 Pile was collected from the excavated soil stockpile as shown in Figure 1. Both samples were analyzed for TPH gas, TPH diesel, BTEX, and total lead. The results are summarized in Table 1 below, and the complete analytical reports are included in the Site Characterization Report.

Table 1

Sample ID	TPHgas	TPHdiesel	Benzene	Toluene	Ethylbenzene	Xylene	Lead
Bldg. 12 Pit	880	<10 ppm	<1.0	<2.0	3.7	24	22 ppm
Bldg. 12 Pile	590	<10 ppm	<1.0	<2.0	2.8	18	25 ppm

All results reported in parts per billion (ug/kg), unless otherwise indicated.

## **VII. SITE RESTORATION**

On October 30, 1997, the tank, piping, and all scrap material was removed from the site, and the excavation was backfilled with the native soil and one cubic yard of clean fill and compacted. The landscaping bark was replaced and the site was cleaned and swept.

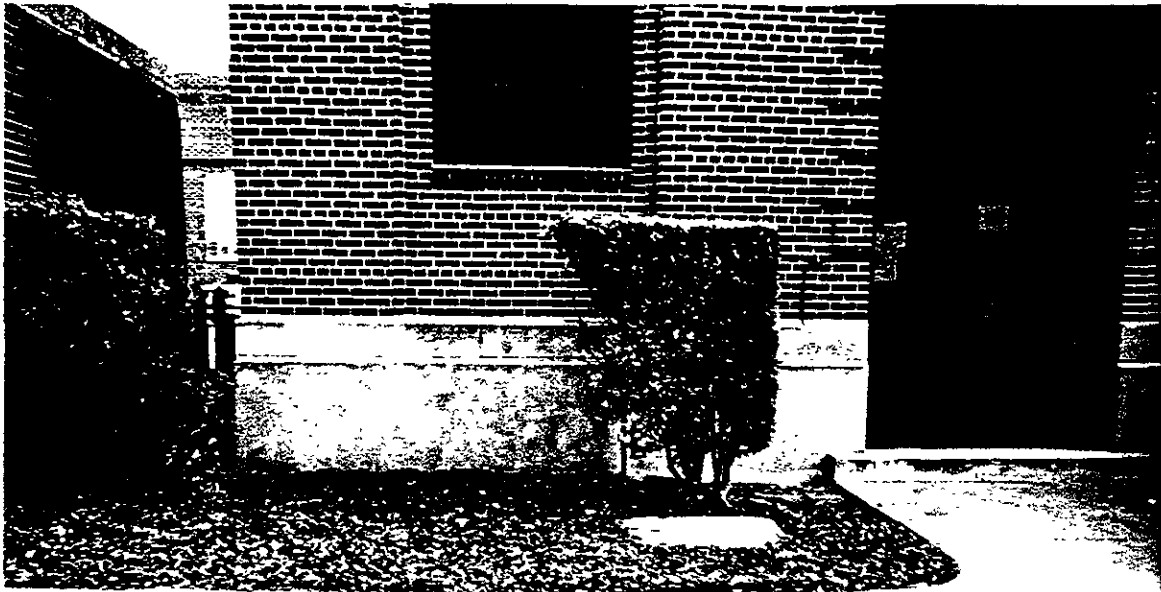

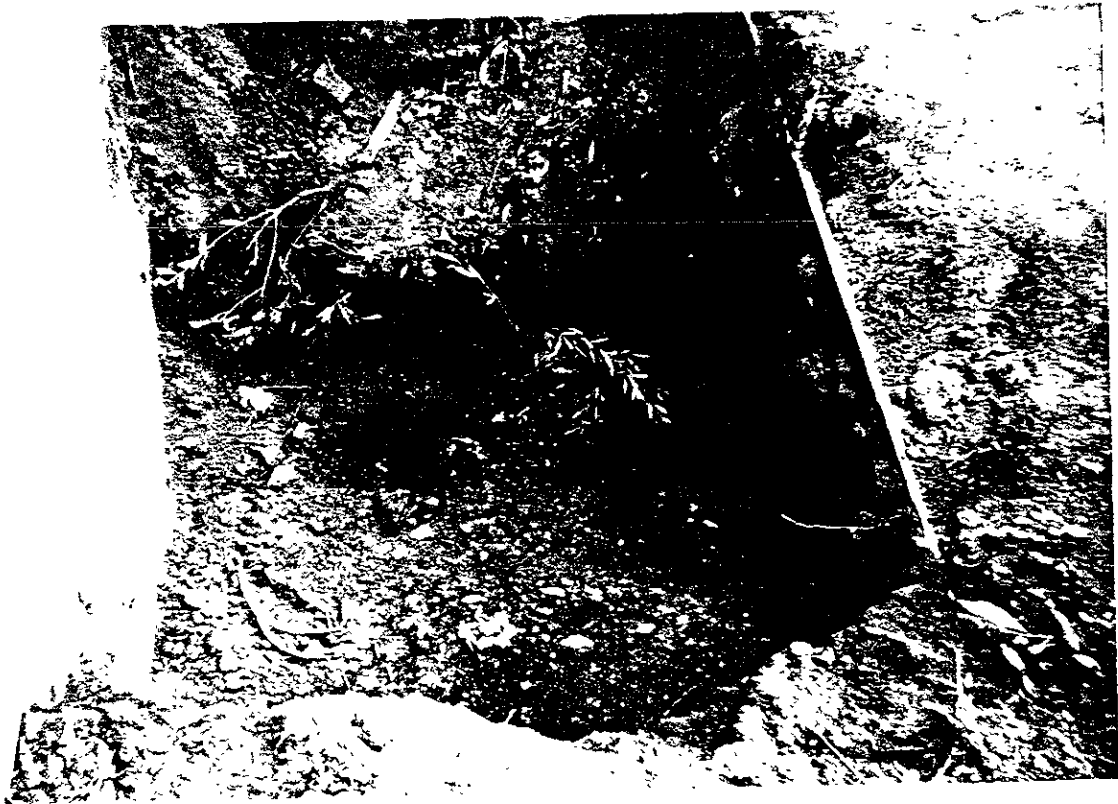

U.S.C.G. - 152 ALAMEDA  
BLDG, 12 100 GALLON TANK  
UST REMOVAL

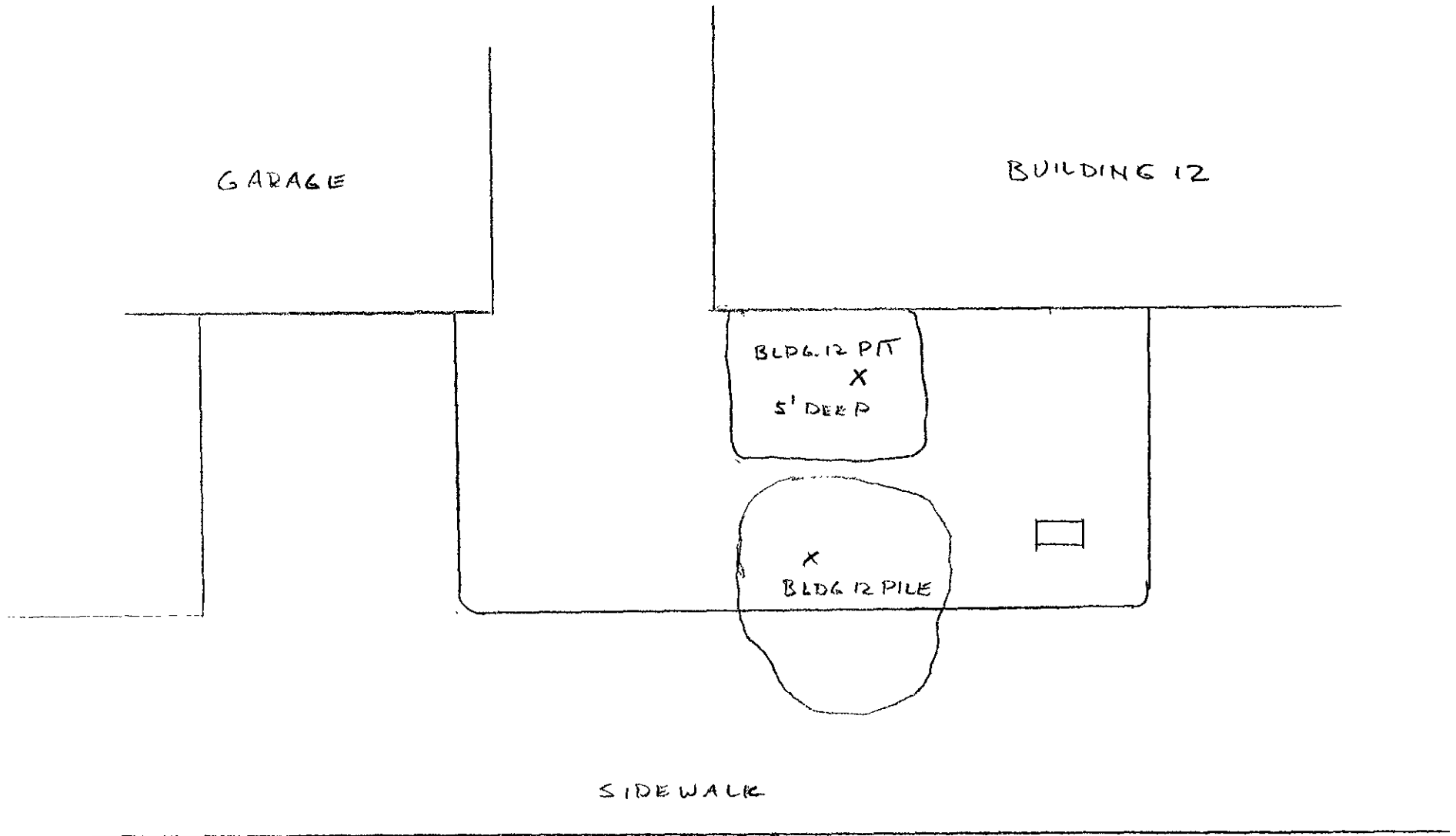

MCCULLOUGH

FIGURE 1

96412931  
 IN CASE OF EMERGENCY OR SPILL, CALL THE NATIONAL RESPONSE CENTER 1-800-424-8802; WITHIN CALIFORNIA, CALL 1-800-852-7550  
 GENERATOR FACILITY

<b>UNIFORM HAZARDOUS WASTE MANIFEST</b>		1. Generator's US EPA ID No. CA170903E0037	Manifest Document No. 1125311	2. Page 1 of 1	Information in the shaded areas is not required by Federal law.
3. Generator's Name and Mailing Address ATTN: T MADDON 15C Alameda Coast Guard Island Alameda, CA 94501		6. US EPA ID Number N/A		A. State: Manifest Document Number 95412931	
4. Generator's Phone (510)437-5725		8. US EPA ID Number		B. State: Manifest Document Number	
5. Transporter 1 Company Name Americlean INC		6. US EPA ID Number N/A 982358483		C. State: Manifest Document Number 500545-3326	
7. Transporter 2 Company Name		8. US EPA ID Number		D. State: Manifest Document Number	
9. Designated Facility Name and Site Address BC Stacking Distributing 7300 Chevron Way Dixon, Ca 95620		10. US EPA ID Number KATQ80012602		G. State: Facility Name KATQ80012602	
11. US DOT Description (including Proper Shipping Name, Hazard Class, and ID Number)		12. Containers		13. Total Quantity	
a. Non RCRA Hazardous Waste Liquid (oily water)		No. Type		14. Unit Wt/Vol	
		901 TIT		140 G	
b.					
c.					
d.					
15. Special Handling Instructions and Additional Information Wear gloves ER Guide 171 24 hr Emergency Contact (916)652-5777		16. GENERATOR'S CERTIFICATION: I hereby declare that the contents of this consignment are fully and accurately described above by proper shipping name and are classified, packed, marked, and labeled, and are in all respects in proper condition for transport by highway according to applicable international and national government regulations.  If I am a large quantity generator, I certify that I have a program in place to reduce the volume and toxicity of waste generated to the degree I have determined to be economically practicable and that I have selected the practicable method of treatment, storage, or disposal currently available to me which minimizes the present and future threat to human health and the environment; OR, if I am a small quantity generator, I have made a good faith effort to minimize my waste generation and select the best waste management method that is available to me and that I can afford.			
17. Transporter 1 Acknowledgement of Receipt of Materials		18. Transporter 2 Acknowledgement of Receipt of Materials		19. Discrepancy Indication Space	
Printed/Typed Name Tim Maddon		Signature <i>Tim Maddon</i>		Month Day Year 11 25 97	
Printed/Typed Name Mark May		Signature <i>Mark May</i>		Month Day Year 11 25 97	
Printed/Typed Name		Signature		Month Day Year	
20. Facility Owner or Operator Certification of receipt of hazardous materials covered by this manifest except as noted in item 19		Printed/Typed Name		Signature	
Printed/Typed Name		Signature		Month Day Year	

DO NOT WRITE BELOW THIS LINE.



ATTN: SCOTT

State of California - Environmental Protection Agency  
Form Approved OMB No. 2030-0039 (Expires 9-30-99)  
Please print or type. Form designed for use on other (12-pin) typewriter.

See instructions on back of page 6.

Department of Toxic Substances Control  
Sacramento, California

96412931

IN CASE OF EMERGENCY OR SPILL, CALL THE NATIONAL RESPONSE CENTER 1-800-424-8802; WITHIN CALIFORNIA, CALL 1-800-852-7550

<b>UNIFORM HAZARDOUS WASTE MANIFEST</b>		1. Generator's US EPA ID No. CA7694027KX17	Manifest Document No. 12001	2. Page 1 of 1	Information in the shaded areas is not required by Federal law.
3. Generator's Name and Mailing Address APR. TRANSPORT					
4. Generator's Phone ( ) 209-375					
5. Transporter 1 Company Name MUNICIPAL			6. US EPA ID Number MUN 772358483		
7. Transporter 2 Company Name			8. US EPA ID Number		
9. Designated Facility Name and Site Address FACILITY			10. US EPA ID Number CA7694027KX17		
11. US DOT Description (including Proper Shipping Name, Hazard Class, and ID Number)		12. Containers No. Type		13. Total Quantity	14. Unit Wt/Vol
a. (oil) (water)		19 7 T		140	G
b.					
c.					
d.					
15. Special Handling Instructions and Additional Information INJURIES 78015 5777					
16. GENERATOR'S CERTIFICATION: I hereby declare that the contents of this consignment are fully and accurately described above by proper shipping name and are classified, packed, marked, and labeled, and are in all respects in proper condition for transport by highway according to applicable international and national government regulations.  If I am a large quantity generator, I certify that I have a program in place to reduce the volume and toxicity of waste generated to the degree I have determined to be economically practicable and that I have selected the practicable method of treatment, storage, or disposal currently available to me which minimizes the present and future threat to human health and the environment; OR, if I am a small quantity generator, I have made a good faith effort to minimize my waste generation and select the best waste management method that is available to me and that I can afford.					
Printed/Typed Name TIM BAKER		Signature [Signature]		Month Day Year F R A N	
17. Transporter 1 Acknowledgement of Receipt of Materials Printed/Typed Name		Signature [Signature]		Month Day Year 1 0 2 7	
18. Transporter 2 Acknowledgement of Receipt of Materials Printed/Typed Name		Signature		Month Day Year	
19. Discrepancy Indication Space					
20. Facility Owner or Operator Certification of receipt of hazardous materials covered by this manifest except as noted in item 10 Printed/Typed Name LARRY BAKER		Signature [Signature]		Month Day Year 1 0 2 9 9	

DO NOT WRITE BELOW THIS LINE.

State of California—Environmental Protection Agency  
Form Approved OMB No. 2050-0039 (Expirs 9-30-96)  
Please print or type. Form designed for use on office (12-pitch) typewriter.

See Instructions on back of page 6.

Department of Toxic Substances Control  
Sacramento, California

95593245  
IN CASE OF EMERGENCY OR SPILL, CALL THE NATIONAL RESPONSE CENTER 1-800-424-8802; WITHIN CALIFORNIA, CALL 1-800-852-7550

<b>UNIFORM HAZARDOUS WASTE MANIFEST</b>		1. Generator's US EPA ID No. CA 17691039010879131245		Manifest Document No. 9131245		2. Page 1 of 1		Information in the shaded area is not required by Federal law.					
3. Generator's Name and Mailing Address COM. OFFICE ISC ATTENTION T. MADDER 510 437-5775						12. State Manifest/Disposal Number 95593245							
4. Generator's Phone						13. State Generator's ID							
5. Transporter 1 Company Name ERICKSON INC						14. State Transporter's ID							
6. US EPA ID Number PA100094663912						15. Transporter's Name ERICKSON							
7. Transporter 2 Company Name						16. State Transporter's ID							
8. US EPA ID Number						17. Transporter's Name							
9. Designated Facility Name and Site Address Erickson, Inc. 255 Parr Blvd. Richmond, CA. 94801						18. State Facility's ID							
10. US EPA ID Number CA 0009466392						19. Facility's Phone 910235-1390							
11. US DOT Description (including Proper Shipping Name, Hazard Class, and ID Number)						12. Containers No. Type		13. Total Quantity		14. Unit Wt/Vol		15. Waste Number	
a. NON-PCRA Hazardous Waste Solid Waste Empty Storage Tank.						0101 TP		010200		P		State: CA EPA/Other: 95593245	
b.												State: CA EPA/Other:	
c.												State: CA EPA/Other:	
d.												State: CA EPA/Other:	
16. Additional Designation for Materials Listed Above Qty. Empty Storage Tank's #2/3/4 Tank(s) have been inerted with 15 lbs. Dry Ice per 1000 Gallon Capacity.						17. Handling Codes for Waste Listed Above							
18. Special Handling Instructions and Additional Information Keep away from sources of ignition. Always wear hardhats when working around U.G.S.T.'s 24 Hr. Contact Name: MALL & Phone: 1-800-852-7550													
19. GENERATOR'S CERTIFICATION: I hereby declare that the contents of this consignment are fully and accurately described above by proper shipping name and are classified, packed, marked, and labeled, and are in all respects in proper condition for transport by highway according to applicable international and national government regulations.  If I am a large quantity generator, I certify that I have a program in place to reduce the volume and toxicity of waste generated to the degree I have determined to be economically practicable and that I have selected the practicable method of treatment, storage, or disposal currently available to me which minimizes the present and future threat to human health and the environment OR, if I am a small quantity generator, I have made a good faith effort to minimize my waste generation and select the best waste management method that is available to me and that I can afford.						Printed/Typed Name T.M. MADDER		Signature <i>[Signature]</i>		Month Day Year 10 30 97			
20. Transporter 1 Acknowledgement of Receipt of Materials						Printed/Typed Name T. C. ...		Signature <i>[Signature]</i>		Month Day Year 10 30 97			
21. Transporter 2 Acknowledgement of Receipt of Materials						Printed/Typed Name		Signature		Month Day Year			
22. Discrepancy Indication Space													
23. Facility Owner or Operator Certification of receipt of hazardous materials covered by this manifest except as noted in Item 19.						Printed/Typed Name		Signature		Month Day Year			

DO NOT WRITE BELOW THIS LINE.

**RAH**  
**ENVIRONMENTAL, INC.**

September 26, 1997

Ms. Eva Chu  
Alameda County Dept. of Environmental Health  
Environmental Protection Division  
1131 Harbor Bay Parkway, Rm 250  
Alameda, CA 94502-6577

RE: Coast Guard Island - Additional Tank Removal

Dear Ms. Chu:

As I indicated over the phone with you last week, an additional underground storage tank was located on Coast Guard Island in Alameda. The Coast Guard would like this tank to be removed, therefore, I am submitting the following information and attached Form B. A partial plot plan of the island is included to show the tank location.

The tank is estimated to be approximately 500 gallons, and currently contains about 5" of product and/or water. The product appears to be weathered gasoline.

Please amend the existing permit application to include this tank for removal, and contact me as soon as possible with any questions. We would like to plan this removal for the week of 10/6/97.

Thank you for your prompt attention.

Sincerely,



Scott Vickers

STATE OF CALIFORNIA  
STATE WATER RESOURCES CONTROL BOARD  
**UNDERGROUND STORAGE TANK PERMIT APPLICATION - FORM B**



COMPLETE A SEPARATE FORM FOR EACH TANK SYSTEM.

MARK ONLY ONE ITEM  1 NEW PERMIT  2 INTERIM PERMIT  3 RENEWAL PERMIT  4 AMENDED PERMIT  5 CHANGE OF INFORMATION  6 TEMPORARY TANK CLOSURE  7 PERMANENTLY CLOSED ON SITE  8 TANK REMOVED

DBA OR FACILITY NAME WHERE TANK IS INSTALLED: Coast Guard Island, Alameda

**I. TANK DESCRIPTION** COMPLETE ALL ITEMS - SPECIFY IF UNKNOWN

A. OWNER'S TANK I. D. # UK B. MANUFACTURED BY: UK

C. DATE INSTALLED (MO/DAY/YEAR) UK D. TANK CAPACITY IN GALLONS: Est. 500 gal.

**II. TANK CONTENTS** IF A-1 IS MARKED, COMPLETE ITEM C.

A.  1 MOTOR VEHICLE FUEL  4 OIL  2 PETROLEUM  80 EMPTY  3 CHEMICAL PRODUCT  95 UNKNOWN

B.  1 PRODUCT  2 WASTE

C.  1a REGULAR UNLEADED  3 DIESEL  6 AVIATION GAS  
 1b PREMIUM UNLEADED  4 GASAHOL  7 METHANOL  
 1c MIDGRADE UNLEADED  5 JET FUEL  8 M85  
 2 LEADED  99 OTHER (DESCRIBE IN ITEM D. BELOW)

D. IF (A.1) IS NOT MARKED, ENTER NAME OF SUBSTANCE STORED \_\_\_\_\_ C. A. S. #: \_\_\_\_\_

**III. TANK CONSTRUCTION** MARK ONE ITEM ONLY IN BOXES A, B, AND C, AND ALL THAT APPLIES IN BOX D AND E

A. TYPE OF SYSTEM  1 DOUBLE WALL  2 SINGLE WALL  3 SINGLE WALL WITH EXTERIOR LINER  4 SINGLE WALL IN A VAULT  5 INTERNAL BLADDER SYSTEM  95 UNKNOWN

B. TANK MATERIAL (Primary Tank)  1 BARE STEEL  2 STAINLESS STEEL  3 FIBERGLASS  4 STEEL CLAD W/ FIBERGLASS REINFORCED PLASTIC  
 5 CONCRETE  6 POLYVINYL CHLORIDE  7 ALUMINUM  8 100% METHANOL COMPATIBLE W/FRP  
 9 BRONZE  10 GALVANIZED STEEL  95 UNKNOWN  99 OTHER \_\_\_\_\_

C. INTERIOR LINING OR COATING  1 RUBBER LINED  2 ALKYD LINING  3 EPOXY LINING  4 PHENOLIC LINING  
 5 GLASS LINING  6 UNLINED  95 UNKNOWN  99 OTHER \_\_\_\_\_  
 IS LINING MATERIAL COMPATIBLE WITH 100% METHANOL? YES \_\_\_ NO \_\_\_

D. EXTERIOR CORROSION PROTECTION  1 POLYETHYLENE WRAP  2 COATING  3 VINYL WRAP  4 FIBERGLASS REINFORCED PLASTIC  
 5 CATHODIC PROTECTION  91 NONE  95 UNKNOWN  99 OTHER \_\_\_\_\_

E. SPILL AND OVERFILL, etc. SPILL CONTAINMENT INSTALLED (YEAR) \_\_\_\_\_ OVERFILL PREVENTION EQUIPMENT INSTALLED (YEAR) \_\_\_\_\_  
 DROP TUBE YES \_\_\_ NO  STRIKER PLATE YES \_\_\_ NO \_\_\_ DISPENSER CONTAINMENT YES \_\_\_ NO

**IV. PIPING INFORMATION** CIRCLE A IF ABOVE GROUND OR U IF UNDERGROUND, BOTH IF APPLICABLE

A. SYSTEM TYPE A U 1 SUCTION A U 2 PRESSURE A U 3 GRAVITY A U 4 FLEXIBLE PIPING A U 99 OTHER

B. CONSTRUCTION A U 1 SINGLE WALL A U 2 DOUBLE WALL A U 3 LINED TRENCH  95 UNKNOWN A U 99 OTHER

C. MATERIAL AND CORROSION PROTECTION A U 1 BARE STEEL A U 2 STAINLESS STEEL A U 3 POLYVINYL CHLORIDE (PVC) A U 4 FIBERGLASS PIPE  
 A U 5 ALUMINUM A U 6 CONCRETE A U 7 STEEL W/ COATING A U 8 100% METHANOL COMPATIBLE W/FRP  
 A U 9 GALVANIZED STEEL A U 10 CATHODIC PROTECTION  95 UNKNOWN A U 99 OTHER \_\_\_\_\_

D. LEAK DETECTION  1 MECHANICAL LINE LEAK DETECTOR  2 LINE TIGHTNESS TESTING  3 CONTINUOUS INTERSTITIAL MONITORING  4 ELECTRONIC LINE LEAK DETECTOR  5 AUTOMATIC PUMP SHUTDOWN  99 OTHER None

**V. TANK LEAK DETECTION**

1 VISUAL CHECK  2 MANUAL INVENTORY RECONCILIATION  3 VADOZE MONITORING  4 AUTOMATIC TANK GAUGING  5 GROUND WATER MONITORING  6 ANNUAL TANK TESTING  
 7 CONTINUOUS INTERSTITIAL MONITORING  8 SIR  9 WEEKLY MANUAL TANK GAUGING  10 MONTHLY TANK TESTING  95 UNKNOWN  99 OTHER

**VI. TANK CLOSURE INFORMATION** (PERMANENT CLOSURE IN-PLACE)

1. ESTIMATED DATE LAST USED (MO/DAY/YR) Unknown 2. ESTIMATED QUANTITY OF SUBSTANCE REMAINING 50 GALLONS 3. WAS TANK FILLED WITH INERT MATERIAL? YES  NO

THIS FORM HAS BEEN COMPLETED UNDER PENALTY OF PERJURY, AND TO THE BEST OF MY KNOWLEDGE, IS TRUE AND CORRECT

TANK OWNER'S NAME (PRINTED & SIGNATURE) \_\_\_\_\_ DATE \_\_\_\_\_

**LOCAL AGENCY USE ONLY** THE STATE I.D. NUMBER IS COMPOSED OF THE FOUR NUMBERS BELOW

STATE I.D.# \_\_\_\_\_ COUNTY # \_\_\_\_\_ JURISDICTION # \_\_\_\_\_ FACILITY # \_\_\_\_\_ TANK # \_\_\_\_\_

PERMIT NUMBER \_\_\_\_\_ PERMIT APPROVED BY/DATE \_\_\_\_\_ PERMIT EXPIRATION DATE \_\_\_\_\_

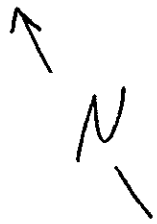
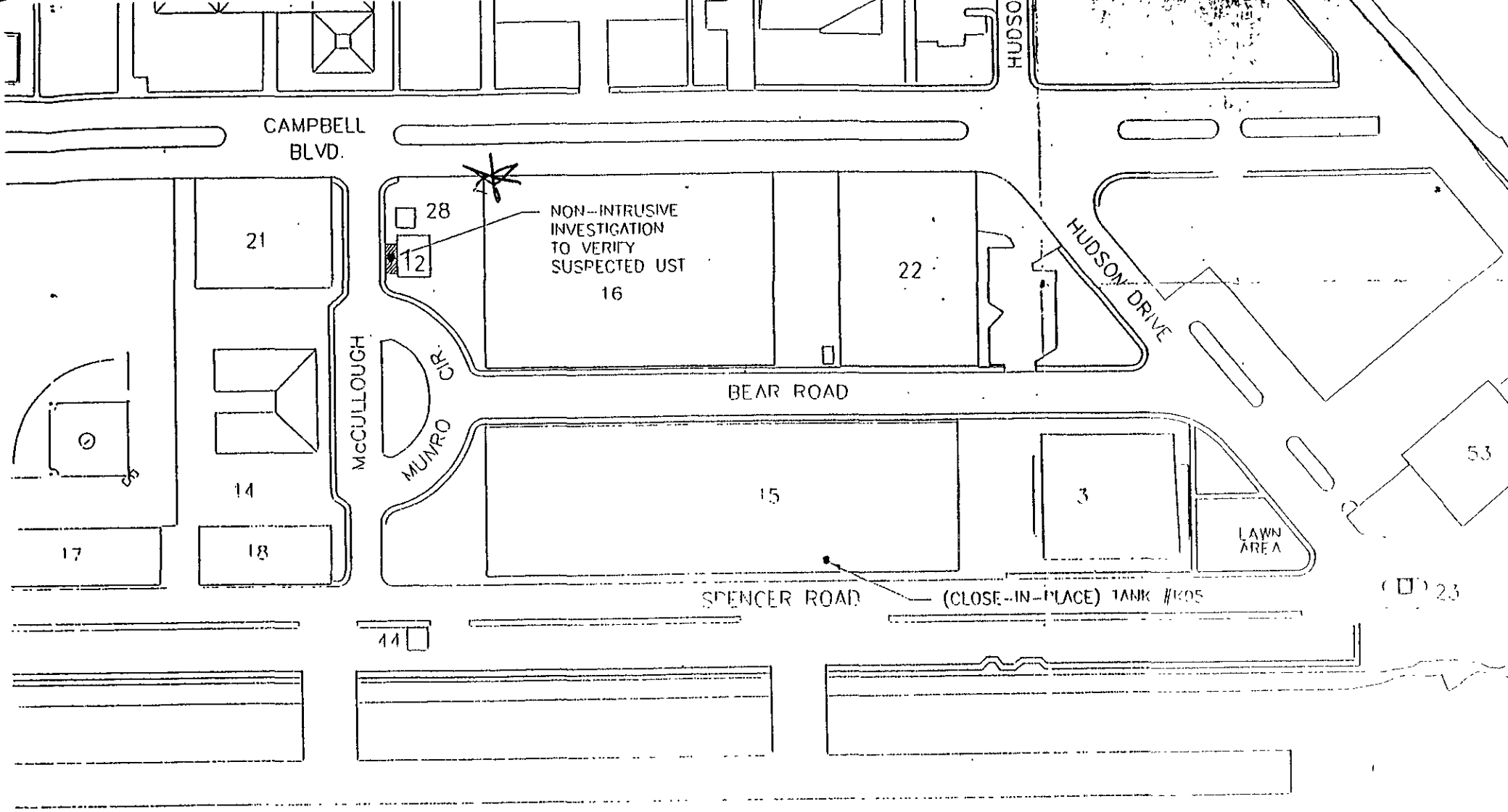

REV	DATE	APPD	DESCRIPTION
DESIGNED	MO		U.S. COAST GUARD CIVIL ENGINEER CLOSE THREE USTs, 1 INTEGRATED SUPPORT C ALAMEDA
DRAWN	CU/PBD		
EDITED			
CHECKED			
REVIEWED BY:			

white - env. health  
yellow - facility  
pink - files

# ALAMEDA COUNTY, DEPARTMENT OF ENVIRONMENTAL HEALTH

## Hazardous Materials Inspection Form

1131 Harbor Bay Pkwy  
Alameda CA 94502  
510/567-6700

II, III

Site ID # \_\_\_\_\_ Site Name Cross Island Today's Date 10/20/97  
Site Address Bed 12  
City Alameda Zip 94501 Phone \_\_\_\_\_

MAX AMT stored > 500 lbs, 55 gal., 200 cft.?  
**Inspection Categories:**  
 I. Haz. Mat/Waste GENERATOR/TRANSPORTER  
 II. Hazardous Materials Business Plan, Acutely Hazardous Materials  
 III. Under ground Storage Tanks General

\* Calif. Administration Code (CAC) or the Health & Safety Code (HS&C)

### Comments:

Prox to site a number of - large drums  
steel 11ST drums 3x20 - water with a high amount  
of solvent and some rust  
In (2) drums (100) lbs.  
Tank located in room to Bed 12  
General  
with LEL, O<sub>2</sub> - 3  
1 drum in room E. 2nd 12  
1 drum in room 2C, mainly gravel sand, silt  
and some fine particles. For more see one separate  
sample from this area taken  
10/20/97 + 10/20/97 by EPA/114-STEVE B. G.  
- 1 drum located in room 2C  
on bed with a lot of silt on nearby surfaces

Contact \_\_\_\_\_  
Title \_\_\_\_\_  
Signature [Signature]  
Inspector Jane P. Van  
Signature [Signature]

II, III

# CERTIFICATE

## CERTIFIED SERVICES COMPANY

255 Parr Boulevard • Richmond, California 94801

**NO. 28335**

CUSTOMER
R. H. ENVIRONMEN
JOB NO.
971221

FOR: ERICKSON, INC. TANK NO. 21307

LOCATION: RICHMOND DATE: 97/11/19 TIME: 09:18

TEST METHOD VISUAL GASTECH/1314 SMPN LAST PRODUCT ULG

This is to certify that I have personally determined that this tank is in accordance with the American Petroleum Institute and have found the condition to be in accordance with its assigned designation. This certificate is based on conditions existing at the time the inspection herein set forth was completed and is issued subject to compliance with all qualifications and instructions.

TANK SIZE 4000 GALLERY TANK CONDITION SAFE FOR FIRE

REMARKS: SYSTEM OF 4000 GALLON TANKS WITH 1000 GALLON  
ERICKSON, INC. HEREBY CERTIFIES THAT THE ABOVE NUMBERED TANK HAS BEEN  
TESTED, PROCESSED, AND THEREFORE DEEMED AS PER PERMITTED HAZARDOUS  
WASTE FACILITY.  
ERICKSON, INC. HAS THE APPROPRIATE PERMITS FOR AND HAS ACCEPTED THE TANK  
SHIPPED TO US FOR PROCESSING.

In the event of any physical or atmospheric changes affecting the gas-free conditions of the above tanks, or if in any doubt, immediately stop all hot work and contact the undersigned. This permit is valid for 24 hours if no physical or atmospheric changes occur.

### STANDARD SAFETY DESIGNATION

**SAFE FOR MEN:** Means that in the compartment or space so designated (a) The oxygen content of the atmosphere is at least 19.5 percent by volume; and that (b) Toxic materials in the atmosphere are within permissible concentrations; and (c) In the judgment of the Inspector, the residues are not capable of producing toxic materials under existing atmospheric conditions while maintained as directed on the Inspector's certificate.

**SAFE FOR FIRE:** Means that in the compartment so designated (a) The concentration of flammable materials in the atmosphere is below 10 percent of the lower explosive limit; and that (b) In the judgment of the Inspector, the residues are not capable of producing a higher concentration than permitted under existing atmospheric conditions in the presence of fire and while maintained as directed on the Inspector's certificate, and further, (c) All adjacent spaces have either been cleaned sufficiently to prevent the spread of fire, are satisfactorily inerted, or in the case of fuel tanks, have been treated as deemed necessary by the Inspector.

The undersigned representative acknowledges receipt of this certificate and understands the conditions and limitations under which it was issued.

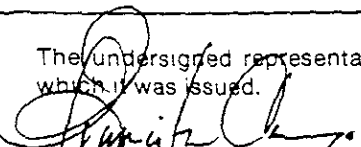
  
\_\_\_\_\_  
REPRESENTATIVE

TITLE

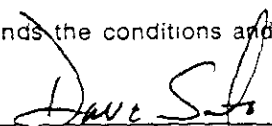
  
\_\_\_\_\_  
INSPECTOR

471221

IN CASE OF EMERGENCY OR SPILL, CALL THE NATIONAL RESPONSE CENTER 1-800-424-8802; WITHIN CALIFORNIA, CALL 1-800-852-7550

<b>UNIFORM HAZARDOUS WASTE MANIFEST</b>		1. Generator's US EPA ID No. CA 769039C03793245	Manifest Document No.		2. Page 1 of 1	Information in the shaded areas is not required by Federal law.	
3. Generator's Name and Mailing Address COM. OFFICE 19C ATTENTION T. MADDEN COAST GUARD FS LAND ALAMITOS CA 94501					A. State Manifest Document Number 95593245		
4. Generator's Phone 670 437-5775					B. State Generator's ID		
5. Transporter 1 Company Name ERICKSON INC					C. State Transporter's ID		
6. US EPA ID Number CA 0009466392					D. Transporter's Phone 1-888-888-0978		
7. Transporter 2 Company Name					E. State Transporter's ID		
8. US EPA ID Number					F. Transporter's Phone		
9. Designated Facility Name and Site Address 250 PARK BLVD ALAMITOS CA 94501					G. State Facility's ID CA 0009466392		
10. US EPA ID Number					H. Facility's Phone (510)235-1393		
11. US DOT Description (including Proper Shipping Name, Hazard Class, and ID Number)					12. Containers No. Type	13. Total Quantity	14. Unit Wt/Vol
a. Empty Storage Tank(s) #21307					001	021200	
b.							
c.							
d.							
15. Additional Descriptions for Materials Listed Above Qty: 1 Empty Storage Tank(s) #21307 Tank(s) have been inerted with 15 lbs Dry Ice Per 1000 Gallon Capacity.					K. Handling Codes for Wastes Listed Above		
					a. 01	b.	
					c.	d.	
16. GENERATOR'S CERTIFICATION: I hereby declare that the contents of this consignment are fully and accurately described above by proper shipping name and are classified, packed, marked, and labeled, and are in all respects in proper condition for transport by highway according to applicable international and national government regulations.  If I am a large quantity generator, I certify that I have a program in place to reduce the volume and toxicity of waste generated to the degree I have determined to be economically practicable and that I have selected the practicable method of treatment, storage, or disposal currently available to me which minimizes the present and future threat to human health and the environment; OR, if I am a small quantity generator, I have made a good faith effort to minimize my waste generation and select the best waste management method that is available to me and that I can afford.							
Printed/Typed Name TIM MADDEN					Signature <i>[Signature]</i>		Month Day Year 10 30 97
17. Transporter 1 Acknowledgement of Receipt of Materials Printed/Typed Name T. Julek Jr					Signature <i>[Signature]</i>		Month Day Year 10 30 97
18. Transporter 2 Acknowledgement of Receipt of Materials Printed/Typed Name					Signature		Month Day Year
19. Discrepancy Indication Space							
20. Facility Owner or Operator Certification of receipt of hazardous materials covered by this manifest except as noted in Item 19 Printed/Typed Name DAVID SATO							
Signature <i>[Signature]</i>					Month Day Year 10 30 97		

DO NOT WRITE BELOW THIS LINE.