

DEPARTMENT OF TRANSPORTATION

BOX 23660
OAKLAND, CA 94623-0660
(510) 286-4444
TDD (510) 286-4454

Wells Survey
ENVIRONMENTAL
PROTECTION

00 JAN 28 PM 2:44

January 26, 2000

STIP 6517

Mr. Tom Peacock
Alameda County Environmental Health Department
1131 Harbor Bay Parkway, Suite 250
Alameda, CA 94502-6577

Subject: Investigation at Vacant Parcel, located at the intersection of 6th and Castro Streets in Oakland, CA

Dear Mr. Peacock:

This letter is in response to Juliet Shin's letter dated November 4, 1999. Three issues were identified as needing to be addressed. Our response is as follows:

1. Please see the attached well survey table. Well data was obtained from the County of Alameda Public Works Agency, Water Resources Group (CAPWAWRG). Well data includes all wells (monitoring, domestic, extraction, etc.) from 1987 to 1998. Our contact at the CAPWAWRG, Frank Codd, was unable to decipher all of the abbreviations listed on the table under "uses" for wells identified in the survey. A VISTA database search was also performed; no Federal or State drinking water sources were located within one mile of the site.
2. ENGEO Inc.'s January 27, 1993 Phase One Assessment Report incorrectly reports the presence of a former groundwater production well. The text of the report indicates that two of the seven borings drilled by ERM-West were converted to temporary groundwater monitoring wells (p.11) and refers to Figure 2 to show approximate boring locations. On Figure 2, Boring B-5 is erroneously labeled as a groundwater production well. ERM-West's Initial Environmental Site Assessment, which is enclosed, states, "Temporary PVC monitoring well casing was placed in the three open bore holes that intersected the apparent water table (B1, B5, B6) so that groundwater samples could be collected." (p. 4) Therefore ENGEO Inc. made two mistakes in their report: 1. Three borings, not two, were converted to temporary monitoring wells and 2. Boring B-5 was not a groundwater production well.

Also in their Phase One Assessment Report, ENGEO Inc. noted during their site walk in 1993, the presence of a temporary groundwater monitoring well installed by ERM-West in 1987 on the western portion of the property. Caltrans' hazardous waste staff

visited the site on January 13, 2000, and based on the Boring Location Map (Figure 1), located borings B1, B5, and B6. All three borings appeared to be 6 inches in diameter and all three holes were grouted. See attached Pictures 1-4.

3. The third comment, requesting information on a storm drain utility trench line running along the property, is unclear to our office. NORCAL conducted a geophysical survey of the site in 1995 and located a storm drain with two utility lines connected to it (one going west toward Brush Street and one going south towards 6th Street). See Figure 2. During Caltrans' site walk, the storm drain was located at the southwestern corner of the site. Please refer to Pictures 5-7, which show the storm drain and the depth to the inlets, which is approximately 2.5 feet bgs. The average depth to groundwater at the site is 14 feet bgs. Therefore, our office concludes that the storm drain utility lines are not a conduit for contaminant plume migration at the site. However, the comment from your office refers to a storm drain utility trench line running along the property. This description appears to be referring to something else. Please clarify your request if this response does not adequately address your concern.

Enclosed please find a copy of the second quarter of groundwater monitoring at the site. The third quarter of sampling is scheduled to take place the last week of February. If there are any questions, please contact Jill Pollock (510) 286-5638.

Sincerely,

HARRY Y. YAHATA
District Director

By: *Celia McCuaig*

CELIA MCCUAIG
District Branch Chief
Office of Environmental Engineering

Attachments

cc: CM, file, chron

Well Survey
Site: 6th and Castro Streets
Oakland, CA

Address	Owner	Update	Longitude	Latitude	City	Drill Date	Elev.	Total Depth	Water Depth	Diam	Use	DIST FROM SITE
424 M. LUTHER KING JR WY	Texaco Environ. Svs. MW2	1/13/94	122279183	37800368	OAK	1/94	0	30	0	2	DES	326
11TH & MLK JR WAY	CITY OF OAKLAND	3/20/91	122277187	37802549	OAK	8/90	0	9	0	6	BOR*	703
11TH & MLK JR WAY	CITY OF OAKLAND	3/20/91	122277187	37802549	OAK	8/90	0	11	0	6	BOR*	703
11TH & MLK JR WAY	CITY OF OAKLAND	3/20/91	122277187	37802549	OAK	8/90	0	13	0	6	BOR*	703
9TH & JEFFERSON	CROSBY	10/6/89	122277187	37802549	OAK	Apr-89	0	31	25	8	BOR	703
9TH & JEFFERSON	CROSBY	10/6/89	122277187	37802549	OAK	Aug-89	0	31	27	0	MON	703
9TH & JEFFERSON	CROSBY	10/6/89	122277187	37802549	OAK	Aug-89	0	31	28	6	MON	703
11TH & MLK JR WAY	CITY OF OAKLAND	3/20/91	122277187	37802549	OAK	8/90	0	10	0	6	BOR*	732
CLAY ST	DIVISION OF HIGHWAYS	12/12/84	122276950	37799300	OAK	2/55	10	130	0	0	TES	919
CLAY ST. & 12TH-14 STS.	GENERAL SERVICES ADMIN.	10/6/89	122276950	37799300	OAK	Jun-88	0	32	30	0	BOR	919
424 M. LUTHER KING JR WY	TEXACO REF. & MARKETING	2/8/88	122277180	37799079	OAK	Aug-87	0	30	16	2	DES	944
424 M. LUTHER KING JR. WY	TEXACO REF. & MARKETING	2/8/88	122277180	37799079	OAK	08/88	0	30	13	2	DES	944
424 MARTIN LUTHER KING JR	TEXACO (2-BORINGS)	2/3/88	122277180	37799079	OAK	Aug-87	0	20	14	7	BOR	944
424 MLK JR. WAY	TEXACO REF. & MARK. INC.	6/28/89	122277180	37799079	OAK	Aug-87	0	30	15	2	DES	944
424 MLK JR. WAY	TEXACO REF. & MARK. INC.	6/28/89	122277180	37799079	OAK		0	0	0	0		944
424 MLK JR. WAY	TEXACO REF. & MARK. INC.	2/8/88	122277180	37799079	OAK	Aug-87	0	30	15	2	DES	944
7 ST	CO. COURTHOUSE (JAIL)	12/12/84	122277180	37799079	OAK	6/76	0	0	0	0	GEO*	944
7 ST	ALAMEDA CO.	12/12/84	122277180	37799079	OAK	1/79	0	0	0	0	GEO*	944
JEFFERSON & 9TH STREET	?	9/25/89	122276200	37802800	OAK	Apr-89	0	31	25	0	MON	983
901 Jefferson St	Doug and Shar Salter	10/6/97	122276215	37802958	OAK	Oct-94	0	30	25	2	MON	1015
900 JEFFERSON	CONNELLY DEVELOP.	6/15/89	122276054	37802856	OAK	Jan-89	0	40	25	2	MON	1030
715 4 ST	E.D. COAT	12/12/84	122281742	37799206	OAK	?	11	104	0	10	DES	1098
715 4 ST	E.D. COAT	8/3/84	122281742	37799206	OAK	2/78	11	108	10	10	IND	1098
WEST END OF BRUSH ST	INNER HARBOR STUDY	12/20/88	122281742	37799206	OAK	Jun-88	10	153	28	4	TES	1098
WEST END OF BRUSH ST	INNER HARBOR STUDY	12/20/88	122281742	37799206	OAK	Jun-88	10	52	5	4	TES	1098
WEST END OF BRUSH ST	INNER HARBOR STUDY	12/20/88	122281742	37799206	OAK	Jun-88	10	32	5	4	TES	1098
404 MARKET ST	SAFETY KLEEN	12/20/88	122282784	37801205	OAK	Aug-88	0	45	7	2	MON	1111
404 MARKET ST	SAFETY KLEEN	12/20/88	122282784	37801205	OAK	Aug-88	0	30	8	2	MON	1111
404 MARKET ST	SAFETY KLEEN	12/20/88	122282784	37801205	OAK	Aug-88	0	30	7	2	MON	1111
404 MARKET ST	SAFETY KLEEN	12/20/88	122282784	37801205	OAK	Aug-88	0	30	9	2	MON	1111
404 MARKET ST	SAFETY KLEEN	12/20/88	122282784	37801205	OAK	Aug-88	0	31	10	2	MON	1111
404 MARKET ST	SAFETY KLEEN	12/20/88	122282784	37801205	OAK	Aug-88	0	30	9	2	MON	1111
404 MARKET ST	SAFETY KLEEN	12/20/88	122282784	37801205	OAK	Aug-88	0	31	10	2	MON	1111
404 MARKET ST	SAFETY KLEEN	12/20/88	122282784	37801205	OAK	Aug-88	0	31	8	2	MON	1111
404 MARKET ST	SAFETY KLEEN	12/20/88	122282784	37801205	OAK	Aug-88	0	31	9	2	MON	1111
404 Market Street	Safety-Kleen	7/3/90	122282784	37801205	OAK	9/89	0	70	10	4	MON	1111
425 Market St.	D. Jaber/Wells Fargo	7/22/93	122282949	37801338	OAK	Dec-92	0	7	0	0	BOR	1159
339 3rd St	P. E. O'Hair	4/15/93	122283014	37800820	OAK	Nov-92	0	21	18	2	MON	1187

Well Survey
Site: 6th and Castro Streets
Oakland, CA

Address	Owner	Update	Longitude	Latitude	City	Drill Date	Elev.	Total Water			Use	DIST FROM SITE
								Depth	Depth	Diam		
339 3rd St	P. E. O'Hair	4/15/93	122283014	37800820	OAK	Nov-92	0	25	18	2	MON	1187
339 3rd St	P. E. O'Hair	4/15/93	122283023	37800820	OAK	Nov-92	0	21	18	2	MON	1190
333 MARKET ST	MARINE TERMINAL WAREHSE	6/1/88	122283120	37800753	OAK	Feb-88	0	26	8	2	MON	1221
333 MARKET ST	MARINE TERMINAL WAREHSE	6/1/88	122283120	37800753	OAK	Feb-88	0	23	8	2	MON	1221
333 MARKET ST	MARINE TERMINAL WAREHSE	6/1/88	122283120	37800753	OAK	Feb-88	0	23	8	2	MON	1221
333 MARKET ST.	R.S. EAGAN & CO.	2/3/88	122283120	37800753	OAK	Sep-87	0	22	12	2	MON	1221
499 5th St.	Ala. County Health MW-1	6/23/93	122275585	37798493	OAK	4/92	0	35	25	4	MON	1404
499 5th St.	Ala. County Health MW-2	6/23/93	122275585	37798493	OAK	4/92	0	35	23	4	MON	1404
499 5th St.	Ala. County Health MW-2	6/23/93	122275585	37798493	OAK	4/92	0	30	0	4	MON	1404
11th & Jefferson Streets	City Oakland, Econ. Devel	6/27/90	122275400	37804200	OAK	2/90	33	35	28	2	PIE	1496
11th & Jefferson Streets	City Oakland, Econ. Devel	6/27/90	122275400	37804200	OAK	2/90	0	27	0	8	BOR	1496
11th & Jefferson Streets	City Oakland, Econ. Devel	6/27/90	122275400	37804200	OAK	2/90	34	35	28	2	PIE	1496
11th & Jefferson Streets	City Oakland, Econ. Devel	6/27/90	122275400	37804200	OAK	2/90	32	35	27	2	PIE	1496
11TH ST.	OKLND CTY CNTR GARAGE	12/12/84	122279000	37805600	OAK	3/74	0	0	0	0	GEO*	1593
461 8th St	Shell Oil Company	10/6/97	122273493	37800733	OAK	Dec-94	0	30	16	4	MON	1598
461 8th St	Shell Oil Company	10/6/97	122273493	37800733	OAK	Dec-94	0	30	16	4	MON	1598
461 8th St	Shell Oil Company	10/6/97	122273493	37800733	OAK	Dec-94	0	37	16	4	MON	1598
51 GROVE	CHILDREN'S HOSP.	7/31/84	122281334	37797254	OAK	Nov-73	0	150	0	0	GEO	1612
11th & Clay Streets	City Oakland, Econ. Devel	6/27/90	122274300	37803700	OAK	2/90	0	27	0	8	BOR*	1625
11th & Clay Streets	City Oakland, Econ. Devel	6/27/90	122274300	37803700	OAK	2/90	35	35	29	2	PIE	1625
11th & Clay Streets	City Oakland, Econ. Devel	6/27/90	122274300	37803700	OAK	2/90	33	35	27	2	PIE	1625
11th & Clay Streets	City Oakland, Econ. Devel	6/27/90	122274300	37803700	OAK	2/90	0	27	0	8	BOR*	1625
11th & Clay Streets	City Oakland, Econ. Devel	6/27/90	122274300	37803700	OAK	2/90	34	35	27	2	PIE	1625
11TH & CLAY STREET	CITY OF OAKLAND	3/20/91	122274300	37803700	OAK	9/90	0	10	10	2	BOR*	1625
11TH & CLAY STREET	CITY OF OAKLAND	3/20/91	122274300	37803700	OAK	8/90	0	13	0	6	BOR*	1625
333 Broadway	John Leonardini	8/20/97	122275221	37797508	OAK	9/93	0	26	14	2	MON	1744
12th & Jefferson	Schnabel FDN 1	8/13/92	122274900	37804900	OAK	7/91	0	20	2	2	DEW	1783
12th & Jefferson	Schnabel FDN 2	8/13/92	122274900	37804900	OAK	7/91	0	20	2	2	DEW	1783
12th & Jefferson	Schnabel FDN 3	8/13/92	122274900	37804900	OAK	7/91	0	20	2	2	DEW	1783
12th & Jefferson	Schnabel FDN 4	8/13/92	122274900	37804900	OAK	7/91	0	20	2	2	DEW	1783
12th & Jefferson	Schnabel Fdn 6	9/30/92	122274900	37804900	OAK	Nov-91	0	20	2	2	DEW	1783
12th & Jefferson	Schnabel Fdn 7	9/30/92	122274900	37804900	OAK	Nov-91	0	20	2	2	DEW	1783
12th & Jefferson	Schnabel Fdn 8	9/30/92	122274900	37804900	OAK	Nov-91	0	20	2	2	DEW	1783
12th & Jefferson St	Schnabel Fdn 5	9/30/92	122274900	37804900	OAK	Nov-91	0	20	2	2	DEW	1783
JEFFERSON & 12TH ST.	CITY OF OAKLAND	1/17/90	122274900	37804900	OAK	Sep-89	0	29	0	8	BOR	1783
Jefferson and 12th St	Oakland Redvlpmnt Agency	8/1/91	122274900	37804900	OAK	4/91	11	9	5	2	MON	1783
Jefferson and 12th St	Oakland Redvlpmnt Agency	8/1/91	122274900	37804900	OAK	4/91	10	30	11	2	MON	1783
Jefferson and 12th St	Oakland Redvlpmnt Agency	8/1/91	122274900	37804900	OAK	5/91	0	0	0	8	BOR*	1783
1330 M. L. King Jr. Way	City of Oakland	7/11/90	122277193	37805919	OAK	Dec-89	0	50	29	2	MON	1785

Well Survey
Site: 6th and Castro Streets
Oakland, CA

Address	Owner	Update	Longitude	Latitude	City	Drill	Total Water			Use	DIST	
						Date	Elev.	Depth	Depth		Diam	FROM
											SITE	
Martin Luther King & 14th	Oakland Redevlpmnt Agency	2/27/91	122277193	37805919	OAK	Nov-90	0	30	29	2	TES	1785
Martin Luther King & 14th	Oakland Redvlpmnt Agency	3/14/91	122277193	37805919	OAK	9/90	0	0	28	8	BOR*	1785
Martin Luther King & 14th	Oakland Redvlpmnt Agency	3/14/91	122277193	37805919	OAK	Nov-90	0	30	0	2	TES	1785
110 Washington St	Port of Oakland	3/12/98	122277026	37796556	OAK	Dec-95	11	56	6	2	MON	1802
110 Washington St	Port of Oakland	3/12/98	122277026	37796556	OAK	Dec-95	12	59	7	2	MON	1802
110 Washington St	Port of Oakland	3/12/98	122277026	37796556	OAK	Dec-95	14	60	7	2	MON	1802
110 Washington St	Port of Oakland	3/12/98	122277026	37796556	OAK	Dec-95	12	58	8	2	MON	1802
110 Washington St	Port of Oakland	3/12/98	122277026	37796556	OAK	Dec-95	12	57	0	2	MON	1802
333 Filbert St.	East Bay Ford	3/12/91	122285190	37801343	OAK	9/90	0	20	7	2	MON	1810
333 FILBERT STREET	ROGER L. ERICSON	9/20/89	122285190	37801343	OAK	Jan-89	0	27	0	3	MON	1810
50 MARKET	PG&E	8/3/84	122283908	37798012	OAK	?	0	375	52	0	ABN	1860
50 Market St	PG&E	8/1/91	122283908	37798012	OAK	3/91	0	13	7	2	MON	1860
50 Market St	PG&E	8/1/91	122283908	37798012	OAK	3/91	6	6	4	2	BOR*	1860
50 Market St/100 MLK Way	PG&E	8/1/91	122283908	37798012	OAK	4/91	0	22	11	2	MON	1860
CLAY ST & 12TH ST	GENERAL SERVICES ADMIN	1/22/90	122273800	37804400	OAK	May-89	0	30	24	2	MON	1892
CLAY ST & 12TH ST	GENERAL SERVICES ADMIN	1/22/90	122273800	37804400	OAK	May-89	0	35	0	2	MON	1892
CLAY ST & 12TH ST	GENERAL SERVICES ADMIN	1/22/90	122273800	37804400	OAK	May-89	0	31	24	2	MON	1892
CRN OF 12TH & BROADWAY	APC BUILDING	12/21/88	122272599	37802549	OAK	Jul-88	0	19	0	0	BOR	1908
CRN OF 12TH & BROADWAY	APC BUILDING	12/21/88	122272599	37802549	OAK	Sep-88	0	31	0	2	MON	1908
CRN OF 12TH & BROADWAY	APC BUILDING	12/21/88	122272599	37802549	OAK	Jul-88	0	30	5	2	MON	1908
CRN OF 12TH & BROADWAY	APC BUILDING	12/21/88	122272599	37802549	OAK	Jul-88	0	30	22	2	MON	1908
FILBERT ST & FIFTH	PACIFIC GAS AND ELECTRIC	12/12/84	122285450	37800300	OAK	2/76	0	120	0	0	CAT	1916
1035 7TH ST.	DALZELL CORPORATION	6/28/89	122284921	37803630	OAK	Aug-88	0	35	18	8	BOR	1939
1035 7TH STREET	DALZELL CORP.	6/28/89	122284921	37803630	OAK	Aug-88	0	35	14	2	MON	1939
13th & Jefferson	Oakland Redevpmt Agency53	10/2/92	122274500	37805500	OAK	8/91	0	35	27	2	DES	2025
13th & Jefferson Street	City of Oakland	7/24/90	122274500	37805500	OAK	4/90	0	0	0	0	DES	2025
13th & Jefferson Streets	City of Oakland	7/11/90	122274500	37805500	OAK	3/90	0	33	26	2	MON	2025
13th & Jefferson Streets	City of Oakland	7/11/90	122274500	37805500	OAK	3/90	0	35	29	2	MON	2025
13th & Jefferson Streets	City of Oakland	7/11/90	122274500	37805500	OAK	3/90	0	35	28	2	MON	2025
13th & Jefferson Streets	City of Oakland	7/11/90	122274500	37805500	OAK	3/90	0	35	29	2	MON	2025
13th & Jefferson Streets	City of Oakland	7/11/90	122274500	37805500	OAK	3/90	0	35	29	2	MON	2025
13th & Jefferson Streets	City of Oakland Redvlpmnt	6/12/91	122274500	37805500	OAK	1/91	0	27	19	2	TES	2025
13th St. & Jefferson St.	City of Oakland	7/19/93	122274470	37805500	OAK	Dec-92	0	35	29	2	DES	2031
1 Market St	Port of Oakland	7/21/98	122284363	37797427	OAK	3/98	10	59	8	2	MON	2099
1 Market St	Port of Oakland	7/21/98	122284363	37797427	OAK	3/98	10	14	8	2	MON	2099
1 Market St	Port of Oakland	7/21/98	122284363	37797427	OAK	3/98	11	44	13	2	MON	2099
1 Market St	Port of Oakland	7/21/98	122284363	37797427	OAK	3/98	11	11	9	2	MON	2099
1 Market St	Port of Oakland	7/21/98	122284363	37797427	OAK	3/98	8	60	5	2	MON	2099
1 Market St	Port of Oakland	7/21/98	122284363	37797427	OAK	3/98	8	10	5	2	MON	2099

Well Survey
Site: 6th and Castro Streets
Oakland, CA

Address	Owner	Update	Longitude	Latitude	City	Drill	Total Water			Use	DIST	
						Date	Elev.	Depth	Depth		Diam	FROM
											SITE	
1 Market St	Port of Oakland	7/21/98	122284363	37797427	OAK	3/98	10	55	24	2	MON	2099
1 Market St	Port of Oakland	7/21/98	122284363	37797427	OAK	3/98	10	15	6	2	MON	2099
1 Market St	Port of Oakland	7/21/98	122284363	37797427	OAK	3/98	8	58	7	2	MON	2099
1 Market St	Port of Oakland	7/21/98	122284363	37797427	OAK	3/98	8	10	7	2	MON	2099
1 Market St	Port of Oakland	7/21/98	122284363	37797427	OAK	3/98	11	64	10	2	MON	2099
1 Market St	Port of Oakland	7/21/98	122284363	37797427	OAK	3/98	11	14	0	2	MON	2099
1ST & WASHINGTON STS.	PORT OF OAKLAND	2/23/88	122277174	37795656	OAK	9/87	0	45	7	2	MON	2107
1ST & WASHINGTON STS.	PORT OF OAKLAND	3/15/88	122277174	37795656	OAK	9/87	0	60	7	2	MON	2107
530 Water St (1st & Wash)	Port of Oakland	5/30/90	122277174	37795656	OAK	3/90	0	50	10	2	MON	2107
530 Water St (1st & Wash)	Port of Oakland	5/30/90	122277174	37795656	OAK	3/90	0	50	10	2	MON	2107
BOATEL & WATER STS.	PORT OF OAKLAND	3/15/88	122277174	37795656	OAK	Dec-87	0	25	5	2	MON	2107
800 FRANKLIN ST	BILL LOUIE	8/3/88	122271757	37800335	OAK	May-88	35	28	28	0	BOR	2118
800 Franklin St	Tom Chiu B-1	10/1/92	122271757	37800335	OAK	9/91	0	30	25	0	BOR*	2118
800 Franklin St	Tom Chiu MW-4	10/1/92	122271757	37800335	OAK	Oct-91	0	35	25	2	MON	2118
800 Franklin St	Tom Chiu MW-5	10/1/92	122271757	37800335	OAK	Oct-91	0	35	26	2	MON	2118
800 Franklin Street	Alex Shaw, Dynagroup	6/27/90	122271757	37800335	OAK	9/89	33	35	23	2	MON	2118
800 Franklin Street	Alex Shaw, Dynagroup	6/27/90	122271757	37800335	OAK	9/89	34	35	23	2	MON	2118
800 Franklin Street	Alex Shaw, Dynagroup	6/27/90	122271757	37800335	OAK	9/89	34	34	24	2	MON	2118
800 Franklin St	Chiu	9/19/97	122271740	37800335	OAK	5/97	0	36	23	2	MON	2123
11th Street & Broadway	City Oakland, Econ. Devel	6/27/90	122271900	37802800	OAK	2/90	0	0	0	6	BOR*	2128
11th Street & Broadway	City Oakland, Econ. Devel	6/27/90	122271900	37802800	OAK	2/90	37	35	30	2	PIE	2128
11th Street & Broadway	City Oakland, Econ. Devel	6/27/90	122271900	37802800	OAK	2/90	35	35	29	2	PIE	2128
11th Street & Broadway	City Oakland, Econ. Devel	6/27/90	122271900	37802800	OAK	2/90	35	35	28	2	PIE	2128
Broadway & 11th Streets	City Center ESA	9/11/90	122271900	37802800	OAK	Apr-90	33	21	11	3	MON	2128
1111 BROADWAY	BRAMALEA-APC	6/15/89	122271874	37803029	OAK	Dec-88	27	25	13	2	MON	2159
1111 BROADWAY	BRAMALEA-APC	6/15/89	122271874	37803029	OAK	Dec-88	25	23	12	2	MON	2159
1111 BROADWAY	BRAMALEA-APC	6/15/89	122271874	37803029	OAK	Dec-88	27	25	13	2	MON	2159
1111 Broadway	Bramalea Pacific, Inc.	1/11/91	122271874	37803029	OAK	9/90	0	35	26	2	MON	2159
1125 7 ST	WICK GLOVE CO.	12/10/84	122286180	37802676	OAK	/06	0	12	2	0	ABN	2161
330 CHESNUT ST	ARATEX SERVICES	1/24/90	122286180	37802676	OAK	Jun-89	10	25	8	2	MON	2161
330 CHESNUT ST	ARATEX SERVICES	1/24/90	122286180	37802676	OAK	Jun-89	10	27	8	2	MON	2161
330 CHESNUT ST	ARATEX SERVICES	1/24/90	122286180	37802676	OAK	Jun-89	10	24	8	2	MON	2161
330 CHESNUT ST	ARATEX SERVICES	1/24/90	122286180	37802676	OAK	Jun-89	10	27	8	2	MON	2161
2 Jack London Square	KTVU Inc	7/24/97	122277083	37795473	OAK	Nov-93	0	15	5	2	MON	2178
2 Jack London Square	KTVU Inc	7/24/97	122277083	37795473	OAK	Nov-93	0	15	4	2	MON	2178
2 Jack London Square	KTVU Inc	7/24/97	122277083	37795473	OAK	Nov-93	0	15	5	2	MON	2178
685 14th St.	Rutherford & Chekene BH1	6/22/93	122275990	37806942	OAK	7/92	0	40	0	2	BOR	2255
685 14th St.	Rutherford & Chekene BH2	6/22/93	122275990	37806942	OAK	7/92	0	42	0	2	BOR	2255
685 14th St.	Rutherford & Chekene BH3	6/22/93	122275990	37806942	OAK	7/92	0	40	0	2	BOR	2255

Well Survey
Site: 6th and Castro Streets
Oakland, CA

Address	Owner	Update	Longitude	Latitude	City	Drill Date	Elev.	Total Water			Use	DIST FROM SITE
								Depth	Depth	Diam		
330 Chestnut St	ARAMARK Uniform Services,	9/11/97	122287042	37801711	OAK	5/95	0	17	13	2	MON	2353
330 Chestnut St	ARAMARK Uniform Services,	9/11/97	122287042	37801711	OAK	5/95	0	15	10	2	MON	2353
330 Chestnut St.	Aratex Services, Inc.	3/12/91	122287059	37801711	OAK	9/90	0	23	9	2	MON	2358
1107 5th St	Rino Pacific	8/22/97	122287004	37802772	OAK	Oct-96	0	20	10	2	MON	2402
1107 5th St	Rino Pacific	8/22/97	122287004	37802772	OAK	Oct-96	0	13	8	2	MON	2402
1107 5th St	Rino Pacific	8/22/97	122287004	37802772	OAK	Oct-96	0	17	12	2	MON	2402
66 JACK LONDON SQ.	PORT OF OAKLAND	6/15/89	122274707	37795410	OAK	Jan-88	0	55	5	2	MON	2464
14TH & CLAY	CTY OF OAK	6/15/89	122272599	37805917	OAK		0	0	0	0		2517
14TH & CLAY	CTY OF OAK	6/15/89	122272599	37805917	OAK		0	0	0	0		2517
14TH & CLAY	CTY OF OAK	6/15/89	122272599	37805917	OAK	Sep-88	0	35	24	2	DES	2517
CRN OF CLAY & 14TH ST	FIVE CITY CENTER	12/20/88	122272599	37805917	OAK	Sep-88	0	30	21	2	DES	2517
CRN OF CLAY & 14TH ST	FIVE CITY CENTER	12/20/88	122272599	37805917	OAK	Sep-88	0	35	24	2	DES	2517
9th and Webster Streets	City of Oakland Redevelop	6/26/90	122270300	37800500	OAK	1/90	0	45	0	6	DES	2529
Webster & 9th St.	City of Oakland	3/8/91	122270300	37800500	OAK	1/91	0	40	19	4	MON	2529
Webster & 9th St.	City of Oakland	3/8/91	122270300	37800500	OAK	Nov-90	0	37	0	2	PIE	2529
Webster & 9th St.	City of Oakland	3/8/91	122270300	37800500	OAK	Nov-90	0	37	0	2	PIE	2529
Webster & 9th Streets	City of Oakland Redvlpmnt	3/29/91	122270300	37800500	OAK	7/90	39	37	30	4	MON	2529
Webster & 9th Streets	City of Oakland Redvlpmnt	3/29/91	122270300	37800500	OAK	8/90	0	19	15	4	MON	2529
Webster & 9th Streets	City of Oakland Redvlpmnt	3/29/91	122270300	37800500	OAK	8/90	0	19	15	4	MON	2529
Webster St. & 9th St.	City of Oakland	2/27/91	122270300	37800500	OAK	Nov-90	0	46	29	4	TES	2529
Webster St. & 9th St.	City of Oakland	2/27/91	122270300	37800500	OAK	Dec-89	37	38	28	4	MON	2529
15th St and Castro St	Dignity Housing West	8/5/91	122276100	37807800	OAK	2/91	0	0	0	0	DES	2537
690 15th St	Dignity Housing West	8/1/91	122275510	37807658	OAK	5/91	28	33	27	2	MON	2551
690 15th St	Dignity Housing West	8/1/91	122275510	37807658	OAK	4/91	0	22	7	4	MON	2551
690 15th St	Dignity Housing West	8/1/91	122275510	37807658	OAK	4/91	0	14	5	4	MON	2551
690 15th St	Dignity Housing West	8/1/91	122275510	37807658	OAK	5/91	28	35	27	2	MON	2551
WEBSTER ST & 10TH ST	OAKLAND REDEVELOP. AGENC	1/24/90	122269900	37801100	OAK	Feb-89	0	40	0	4	MON	2632
15th St. & Clay St.	City of Oakland	7/28/93	122272610	37806500	OAK	8/92	99	122	27	0	BOR	2664
125 Webster St	Bank of the Orient	12/26/97	122273621	37795301	OAK	3/94	0	35	27	2	MON	2668
125 Webster St	Bank of the Orient	9/11/97	122273611	37795297	OAK	8/94	0	35	27	2	MON	2671
1020 WEBSTER ST	WOON LOON	8/3/88	122269698	37801254	OAK	May-88	38	30	29	0	BOR	2690
387 12th St		8/4/97	122269854	37802774	OAK	6/93	0	25	18	2	MON	2703
387 12th St		8/4/97	122269854	37802774	OAK	6/93	0	25	18	2	MON	2703
387 12th St		8/4/97	122269854	37802774	OAK	6/93	0	25	18	2	MON	2703
339 THIRD STREET	P. E. O'HAIR	2/23/88	122272599	37795640	OAK	4/87	0	22	14	8	BOR	2758
706 HARRISON	?	6/15/89	122269924	37798675	OAK	Oct-88	0	15	0	0	BOR	2787
706 Harrison St	Oakland Auto Parts	8/13/97	122269907	37798675	OAK	8/93	0	15	0	2	MON	2791
706 Harrison St	Oakland Auto Parts	8/13/97	122269907	37798675	OAK	8/93	0	15	0	2	EXT	2791
726 Harrison St		12/4/97	122269834	37798771	OAK	7/97	0	28	20	2	MON	2800

Well Survey
Site: 6th and Castro Streets
Oakland, CA

Address	Owner	Update	Longitude	Latitude	City	Drill Date	Elev.	Total Depth	Water Depth	Diam	Use	DIST FROM SITE
706 Harrison St	Bo Gin	7/30/98	122269871	37798673	OAK	Nov-94	0	30	18	2	MON	2801
800 Harrison St.	Unocal #0752 MW-7	7/12/93	122269474	37799340	OAK	4/93	0	33	22	2	MON	2841
800 Harrison St.	Unocal #0752 MW-8	7/12/93	122269474	37799340	OAK	4/93	0	31	21	2	MON	2841
800 Harrison Street	Unocal Corporation MW4	7/22/93	122269464	37799340	OAK	9/92	0	33	23	2	MON	2844
800 Harrison Street	Unocal Corporation MW5	7/22/93	122269464	37799340	OAK	Oct-92	0	32	23	2	MON	2844
800 Harrison Street	Unocal Corporation MW6	7/22/93	122269464	37799340	OAK	Oct-92	0	32	22	2	MON	2844
800 Harrison St	Unocal Corp MW1	8/14/92	122269454	37799356	OAK	5/91	0	35	24	2	MON	2845
800 Harrison St	Unocal Corp MW2	8/14/92	122269454	37799356	OAK	5/91	0	33	22	2	MON	2845
800 Harrison St	Unocal Corp MW3	8/14/92	122269454	37799356	OAK	5/91	0	33	23	2	MON	2845
800 Harrison Street	Unocal Corporation	9/27/91	122269454	37799356	OAK	6/91	0	33	23	2	MON	2845
San Pablo Ave. & Broadway	Taldan Property	6/23/93	122270759	37805710	OAK	8/92	35	120	0	0	BOR	2888
San Pablo Ave. & Broadway	Taldan Property B1-P	6/23/93	122270759	37805710	OAK	8/92	35	42	26	2	PIE	2888
San Pablo Ave. & Broadway	Taldan Property B2-P	6/23/93	122270759	37805710	OAK	8/92	35	42	25	2	PIE	2888
114 Adeline St.	Nor-Cal Metal Fab. MW-1	7/23/93	122288969	37800508	OAK	Nov-92	0	17	5	2	MON	2919
320 Embarcadero	Pacific Dry Dock, Yard II	9/19/97	122272966	37794789	OAK	7/94	0	15	6	4	MON	2931
320 Embarcadero	Pacific Dry Dock, Yard II	9/19/97	122272966	37794789	OAK	7/94	0	17	11	0	MON	2931
320 Embarcadero	Pacific Dry Dock, Yard II	9/19/97	122272966	37794789	OAK	7/94	0	15	0	0	MON	2931
280 6th St		7/22/97	122269768	37797883	OAK	1/95	7	14	0	4	MON	2938
280 6th St		7/22/97	122269768	37797883	OAK	1/95	6	14	5	4	MON	2938
280 6th St		7/22/97	122269768	37797883	OAK	1/95	6	14	0	4	MON	2938
280 6th St		7/22/97	122269768	37797883	OAK	1/95	6	14	0	4	MON	2938
1225 Webster St	Bank of the Orient	7/22/97	122269041	37802873	OAK	Dec-93	0	34	30	2	MON	2942
1225 Webster St	Bank of the Orient	7/22/97	122269041	37802873	OAK	Dec-93	0	35	30	2	MON	2942
1225 Webster St	Bank of the Orient	7/22/97	122269041	37802873	OAK	Dec-93	0	35	30	2	MON	2942
1225 Webster St	Bank of the Orient	7/22/97	122269041	37802873	OAK	Dec-93	0	34	30	2	MON	2942
1225 Webster St	Bank of the Orient	7/22/97	122269041	37802873	OAK	2/94	0	34	27	2	MON	2942
1225 Webster St	Bank of the Orient	7/22/97	122269041	37802873	OAK	3/94	0	35	27	2	MON	2942
1225 Webster St	Bank of the Orient	7/22/97	122269041	37802873	OAK	3/94	0	35	27	2	MON	2942
321 Embarcadero Ave		2/4/98	122273078	37794629	OAK	9/95	0	16	6	4	MON	2960
321 Embarcadero Ave		2/4/98	122273078	37794629	OAK	9/95	0	15	4	4	MON	2960
321 Embarcadero Ave		2/4/98	122273078	37794629	OAK	9/95	0	15	7	4	MON	2960
321 Embarcadero Ave		2/4/98	122273078	37794629	OAK	9/95	0	15	4	4	MON	2960
1700 Castro St	Chevron Products Co.	3/29/98	122275142	37809142	OAK	5/97	0	31	25	2	MON	3094
1700 Castro St	Chevron Products Co.	3/29/98	122275142	37809142	OAK	5/97	0	31	25	2	MON	3094
1700 Castro St	Chevron Products Co.	3/29/98	122275142	37809142	OAK	5/97	0	31	25	2	MON	3094
1700 Jefferson (@17th)	BLUE PRINT SERVICES	2/23/88	122272770	37808224	OAK	6/87	32	34	25	4	MON	3122
1700 Jefferson (@17th)	BLUE PRINT SERVICES	2/23/88	122272770	37808224	OAK	Nov-87	31	32	27	4	DES	3122
1700 Jefferson (@17th)	BLUE PRINT SERVICES	2/23/88	122272770	37808224	OAK	6/87	31	32	25	4	MON	3122
1700 Jefferson (@17th)	BLUE PRINT SERVICES	2/23/88	122272770	37808224	OAK	1/88	31	33	25	4	MON	3122

Well Survey
Site: 6th and Castro Streets
Oakland, CA

Address	Owner	Update	Longitude	Latitude	City	Drill Date	Elev.	Total Water			Use	DIST FROM SITE
								Depth	Depth	Diam		
1700 Jefferson (@ 17th)	BLUE PRINT SERVICES	2/23/88	122272770	37808224	OAK	1/88	32	34	26	4	MON	3122
1700 Jefferson St	Blue Print Services	7/18/97	122272753	37808224	OAK	4/96	0	36	26	2	TES	3125
250 8th Street	Alice, Edward and May Lim	7/16/97	122268559	37798994	OAK	1/95	0	30	17	2	MON	3130
Union St. & 5th St.	CALTRANS CDF	6/24/93	122289465	37803237	OAK	6/92	0	8	0	0	BOR	3137
Union St. & 5th St.	CALTRANS CDF/W-2	6/24/93	122289465	37803237	OAK	6/92	0	20	6	2	MON	3137
Union St. & 5th St.	CALTRANS CDF/W-3	6/24/93	122289465	37803237	OAK	6/92	0	20	8	0	MON	3137
250 8th St	Alice, Edward and May Lim	7/28/97	122268525	37798967	OAK	1/95	0	30	18	2	MON	3142
Union St. & 5th St.	CALTRANS CDF/W-1	8/3/93	122289490	37803238	OAK	7/92	0	19	6	2	MON	3144
1221 3rd St		7/21/98	122289795	37801883	OAK	6/95	0	20	8	0	MON	3155
1221 3rd St		7/21/98	122289795	37801883	OAK	6/95	0	18	8	0	MON	3155
1221 3rd St		7/21/98	122289795	37801883	OAK	6/95	0	18	6	0	MON	3155
10th & Franklin Sts.	CITY OF OAKLAND	6/3/88	122268154	37802549	OAK	Mar-88	0	43	26	4	TES	3174
10th & Franklin Sts.	CITY OF OAKLAND	8/8/88	122268154	37802549	OAK	Apr-88	0	64	38	4	TEST	3174
10th & Webster Sts.	CITY OF OAKLAND	6/3/88	122268154	37802549	OAK	Dec-87	0	40	27	4	MON	3174
10th & Webster Sts.	CITY OF OAKLAND	6/3/88	122268154	37802549	OAK	Dec-87	0	42	26	4	MON	3174
10th & Webster Sts.	CITY OF OAKLAND	6/3/88	122268154	37802549	OAK	Mar-88	39	66	0	4	MON	3174
10th & Webster Sts.	CITY OF OAKLAND	6/3/88	122268154	37802549	OAK	Mar-88	0	40	25	4	TES	3174
11TH & FRANKLIN STS	CITY OF OAKLAND	6/3/88	122268154	37802549	OAK	Mar-88	0	40	24	4	TES	3174
11TH & WEBSTER STS	CITY OF OAKLAND	6/3/88	122268154	37802549	OAK	Dec-87	0	45	26	4	MON	3174
11TH & WEBSTER STS	CITY OF OAKLAND	6/3/88	122268154	37802549	OAK	Dec-87	0	44	26	4	MON	3174
11TH & WEBSTER STS	CITY OF OAKLAND	6/3/88	122268154	37802549	OAK	Mar-88	0	44	25	4	TES	3174
11th & WEBSTER Sts.	CITY OF OAKLAND	2/3/88	122268154	37802549	OAK	May-87	0	39	24	4	MON	3174
11th & WEBSTER St.	CITY OF OAKLAND	2/24/88	122268154	37802549	OAK	7/87	0	61	0	5	BOR	3174
13TH & HARRISON	FRANK MAR COMM. HOUSING	11/8/89	122268154	37802549	OAK		0	0	0	0		3174
13TH & HARRISON	FRANK MAR COMM. HOUSING	11/8/89	122268154	37802549	OAK		0	0	0	0		3174
HARRISON (BET. 12 & 13)	EAST BAY ASIAN LOCAL DEV-	2/23/88	122268154	37802549	OAK	Oct-87	0	36	25	8	BOR	3174
PACIFIC RENAISSANCE PLAZA	CITY OF OAKLAND	11/6/89	122268154	37802549	OAK	Jan-89	0	40	0	4	EXT	3174
PACIFIC RENAISSANCE PLAZA	CITY OF OAKLAND	11/6/89	122268154	37802549	OAK	Jan-89	0	43	0	4	EXT	3174
PACIFIC RENAISSANCE	CITY OF OAKLAND	11/6/89	122268154	37802549	OAK	Jan-89	0	43	0	4	EXT	3174
PACIFIC RENAISSANCE PLAZA	CITY OF OAKLAND	11/6/89	122268154	37802549	OAK	Jan-89	0	40	0	4	EXT	3174
PACIFIC RENAISSANCE PLAZA	CITY OF OAKLAND	11/6/89	122268154	37802549	OAK	Jan-89	0	39	0	4	EXT	3174
PACIFIC RENAISSANCE PLAZA	CITY OF OAKLAND	11/6/89	122268154	37802549	OAK	Jan-89	0	39	0	4	EXT	3174
PACIFIC RENAISSANCE PLAZA	CITY OF OAKLAND	11/6/89	122268154	37802549	OAK	Jan-89	0	38	0	4	EXT	3174
PACIFIC RENAISSANCE PLAZA	CITY OF OAKLAND	11/6/89	122268154	37802549	OAK	Jan-89	0	39	0	4	EXT	3174
PACIFIC RENAISSANCE PLAZA	CITY OF OAKLAND	11/6/89	122268154	37802549	OAK	Jan-89	0	37	0	4	EXT	3174
PACIFIC RENAISSANCE PLAZA	CITY OF OAKLAND	11/6/89	122268154	37802549	OAK	Jan-89	0	38	0	4	EXT	3174
PACIFIC RENAISSANCE PLAZA	CITY OF OAKLAND	11/6/89	122268154	37802549	OAK	Jan-89	0	38	0	4	EXT	3174
PACIFIC RENAISSANCE PLAZA	CITY OF OAKLAND	11/6/89	122268154	37802549	OAK	Jan-89	0	38	0	4	EXT	3174

Well Survey
Site: 6th and Castro Streets
Oakland, CA

Address	Owner	Update	Longitude	Latitude	City	Drill Date	Elev.	Total Depth	Water Depth	Diam	Use	DIST FROM SITE
PACIFIC RENAISSANCE PLAZA	CITY OF OAKLAND	11/6/89	122268154	37802549	OAK	Jan-89	0	38	0	4	EXT	3174
PACIFIC RENAISSANCE PLAZA	CITY OF OAKLAND	11/6/89	122268154	37802549	OAK	Jan-89	0	39	0	4	EXT	3174
PACIFIC RENAISSANCE PLAZA	CITY OF OAKLAND	11/6/89	122268154	37802549	OAK	Jan-89	0	39	0	4	EXT	3174
PACIFIC RENAISSANCE PLAZA	CITY OF OAKLAND	11/6/89	122268154	37802549	OAK	Jan-89	0	39	0	4	EXT	3174
PACIFIC RENAISSANCE PLAZA	CITY OF OAKLAND	11/6/89	122268154	37802549	OAK	Jan-89	0	43	0	4	EXT	3174
PACIFIC RENAISSANCE PLAZA	CITY OF OAKLAND	11/6/89	122268154	37802549	OAK	Jan-89	0	43	0	4	EXT	3174
PACIFIC RENAISSANCE PLAZA	CITY OF OAKLAND	11/6/89	122268154	37802549	OAK	Jan-89	0	40	0	4	EXT	3174
PACIFIC RENAISSANCE PLAZA	CITY OF OAKLAND	11/6/89	122268154	37802549	OAK	Jan-89	0	39	0	4	EXT	3174
PACIFIC RENAISSANCE PLAZA	CITY OF OAKLAND	11/6/89	122268154	37802549	OAK	Jan-89	0	40	0	4	INJ	3174
PACIFIC RENAISSANCE PLAZA	CITY OF OAKLAND	11/6/89	122268154	37802549	OAK	Jan-89	0	40	0	4	INJ	3174
PACIFIC RENAISSANCE PLAZA	CITY OF OAKLAND	11/6/89	122268154	37802549	OAK	Jan-89	0	40	0	4	INJ	3174
PACIFIC RENAISSANCE PLAZA	CITY OF OAKLAND	11/6/89	122268154	37802549	OAK	Jan-89	0	40	0	4	INJ	3174
PACIFIC RENAISSANCE PLAZA	CITY OF OAKLAND	11/6/89	122268154	37802549	OAK	Jan-89	0	0	0	0		3174
PACIFIC RENAISSANCE PLAZA	CITY OF OAKLAND	11/6/89	122268154	37802549	OAK	Jan-89	0	38	0	4	INJ	3174
PACIFIC RENAISSANCE PLAZA	CITY OF OAKLAND	11/6/89	122268154	37802549	OAK	Jan-89	0	39	0	4	INJ	3174
PACIFIC RENAISSANCE PLAZA	CITY OF OAKLAND	11/6/89	122268154	37802549	OAK	Jan-89	0	41	0	4	INJ	3174
PACIFIC RENAISSANCE PLAZA	CITY OF OAKLAND	11/6/89	122268154	37802549	OAK	Jan-89	0	38	0	4	INJ	3174
PACIFIC RENAISSANCE PLAZA	CITY OF OAKLAND	11/6/89	122268154	37802549	OAK	Jan-89	0	38	0	4	INJ	3174
PACIFIC RENAISSANCE PLAZA	CITY OF OAKLAND	11/6/89	122268154	37802549	OAK	Jan-89	0	41	0	4	INJ	3174
PACIFIC RENAISSANCE PLAZA	CITY OF OAKLAND	11/6/89	122268154	37802549	OAK	Jan-89	0	41	0	4	INJ	3174
PACIFIC RENAISSANCE PLAZA	CITY OF OAKLAND	11/6/89	122268154	37802549	OAK	Feb-89	0	43	14	4	MON	3174
PACIFIC RENAISSANCE PLAZA	CITY OF OAKLAND	11/6/89	122268154	37802549	OAK	Feb-89	0	40	32	4	MON	3174
PACIFIC RENAISSANCE PLAZA	CITY OF OAKLAND	11/6/89	122268154	37802549	OAK	Jan-89	0	38	0	4	MON	3174
PACIFIC RENAISSANCE PLAZA	CITY OF OAKLAND	11/6/89	122268154	37802549	OAK	Jan-89	0	40	32	4	MON	3174
PACIFIC RENAISSANCE PLAZA	CITY OF OAKLAND	11/6/89	122268154	37802549	OAK	Jan-89	0	40	32	4	MON	3174
PACIFIC RENAISSANCE PLAZA	CITY OF OAKLAND	11/6/89	122268154	37802549	OAK	Jan-89	0	38	32	4	MON	3174
PACIFIC RENAISSANCE PLAZA	CITY OF OAKLAND	11/6/89	122268154	37802549	OAK	Feb-89	0	40	28	4	MON	3174
WEBSTER ST & 10 ST	OAKLAND REDEVELOP. AGENC	1/24/90	122268154	37802549	OAK	Feb-89	0	40	0	4	MON	3174
1395 Middle Harbor Rd.	Port of Oakland MW-1	7/15/93	122289754	37799760	OAK	1/93	0	10	6	2	MON	3181
1395 Middle Harbor Rd.	Port of Oakland MW-2	7/15/93	122289754	37799760	OAK	1/93	0	10	7	2	MON	3181
1395 Middle Harbor Rd.	Port of Oakland MW-3	7/15/93	122289754	37799760	OAK	1/93	0	10	6	2	MON	3181
1395 Middle Harbor Rd.	Port of Oakland MW-APL	7/1/93	122289777	37799749	OAK	9/92	0	36	8	2	MON	3188
6 & HARRISON ST	PACIFIC GAS AND ELECTRIC	12/12/84	122268154	37799079	OAK	6/73	0	120	0	0	CAT	3236
545 17th St	City of Oakland Redvlpmnt	6/12/91	122271221	37807619	OAK	1/91	0	26	15	2	TES	3238
9TH ST & ALICE ST	FIRE STATION #12	1/22/90	122267900	37799500	OAK	Jun-89	100	37	22	2	MON	3274
245 8th St	Victor Lum	10/27/98	122268167	37798610	OAK	7/95	0	28	17	4	MON	3279
245 8th St	Victor Lum	10/27/98	122268167	37798610	OAK	7/95	0	28	18	4	MON	3279
CRN OF 18TH & JEFFERSON	BLUE PRINT SERVICE CO	12/20/88	122272600	37808700	OAK	Oct-88	0	41	20	2	MON	3293
324 Union St	Warehouse Investments	9/17/97	122290295	37802420	OAK	2/95	0	17	10	2	PIE	3320
324 Union St	Warehouse Investments	9/17/97	122290295	37802420	OAK	2/95	0	20	11	2	MON	3320

Well Survey
Site: 6th and Castro Streets
Oakland, CA

Address	Owner	Update	Longitude	Latitude	City	Drill		Total Water			Use	DIST FROM SITE
						Date	Elev.	Depth	Depth	Diam		
324 Union St	Warehouse Investments	9/17/97	122290295	37802420	OAK	2/95	0	20	8	2	MON	3320
310 Union St	Burke Company-McShane & F	9/17/97	122290315	37802345	OAK	Dec-93	0	6	5	2	MON	3322
310 Union St	Burke Company-McShane & F	9/17/97	122290315	37802345	OAK	Dec-93	0	6	4	2	MON	3322
310 Union St	Burke Company-McShane & F	9/17/97	122290315	37802345	OAK	Dec-93	0	8	4	2	MON	3322
310 Union St	Burke Company-McShane & F	9/17/97	122290315	37802345	OAK	Dec-93	0	8	4	2	MON	3322
310 Union St	Burke Company-McShane & F	9/17/97	122290315	37802345	OAK	Dec-93	0	8	4	2	MON	3322
310 Union St	Burke Company-McShane & F	9/17/97	122290315	37802345	OAK	Dec-93	0	8	4	2	MON	3322
310 Union St	Burke Company-McShane & F	9/17/97	122290315	37802345	OAK	Dec-93	0	18	13	2	MON	3322
310 Union St	Burke Company-McShane & F	9/17/97	122290315	37802345	OAK	Dec-93	0	15	13	2	MON	3322
310 Union St	Burke Company-McShane & F	9/17/97	122290315	37802345	OAK	Dec-93	0	15	12	2	MON	3322
S. Pablo & 18th/19th St	E.B. Galleria	7/9/91	122271800	37808400	OAK	Dec-90	0	120	0	2	CAT	3342
570 18th Street	City of Oakland Redvlpmnt	6/12/91	122271885	37808538	OAK	1/91	97	15	0	4	EXT	3367
1220 Harrison St	Frank G. Mar Assoc MW-1	9/22/92	122267300	37801825	OAK	4/92	0	36	24	2	MON	3393
509 17th St	City of Oakland Redvlpmnt	6/12/91	122270214	37807407	OAK	1/91	0	26	20	2	TES	3396
537 18th Street	City of Oakland Redvlpmnt	6/12/91	122271233	37808300	OAK	1/91	98	63	54	2	MON	3420
1384 5 ST	RED STAR YEAST CO.	12/12/84	122290625	37802676	OAK	Nov-46	10	350	43	12	IND	3428
1384 5TH ST	RED STAR YEAST	12/12/84	122290625	37802676	OAK	8/69	10	400	0	12	IND+	3428
533 KIRKHAM	GOEBEL BREWING	12/13/84	122290625	37802676	OAK	/33	0	270	89	0	ABN	3428
2nd St Near Alice St	Port of Oakland/Amtrack	2/24/98	122270818	37794444	OAK	6/95	13	17	7	2	MON	3430
2nd St Near Alice St	Port of Oakland/Amtrack	2/24/98	122270818	37794444	OAK	6/95	13	17	7	2	MON	3430
2nd St Near Alice St	Port of Oakland/Amtrack	2/24/98	122270818	37794444	OAK	6/95	13	15	5	2	MON	3430
5th St. && Union St.	CALTRANS/ WPR	6/24/93	122290442	37803500	OAK	6/92	0	8	4	0	BOR	3435
5th St && Union St	Union Pacific Railroad	7/30/97	122290457	37803493	OAK	3/95	0	13	2	2	MON	3439
5th St && Union St	Union Pacific Railroad	7/30/97	122290457	37803493	OAK	3/95	0	13	2	2	MON	3439
5th St && Union St	Union Pacific Railroad	7/30/97	122290457	37803493	OAK	3/95	0	13	2	2	MON	3439
5th St && Union St	Union Pacific Railroad	7/30/97	122290457	37803493	OAK	3/95	0	12	2	2	MON	3439
5th St && Union St	Union Pacific Railroad	7/30/97	122290457	37803493	OAK	3/95	0	12	3	2	MON	3439
1519 Franklin St	Pacific Bell	2/4/98	122268605	37805828	OAK	9/95	0	35	21	2	MON	3443
ADELINE ST(ALBINE BRIDGE)	CITY OF OAKLAND	12/12/84	122290625	37799206	OAK	?	0	0	0	0	GEO*	3468
Middle Harbour Road	S.Pacific Transportation	7/31/90	122290625	37799206	OAK	Apr-90	3	9	0	2	MON	3468
301 14th St.	Chevron VEW-3	7/13/93	122267329	37803466	OAK	3/93	0	31	22	4	MON	3474
301 14th Street	Chevron USA	9/11/90	122267311	37803466	OAK	Jun-90	31	33	23	2	MON	3479
301 14th Street	Chevron USA	9/11/90	122267311	37803466	OAK	Jun-90	0	60	49	4	MON	3479
301 14th Street	Chevron USA	9/11/90	122267311	37803466	OAK	Jun-90	31	34	19	2	MON	3479
301 14th Street	Chevron USA	9/11/90	122267311	37803466	OAK	Jun-90	31	33	23	2	MON	3479
301 14th Street	Chevron USA	9/11/90	122267311	37803466	OAK	Jun-90	31	33	22	2	MON	3479
301 14th Street	Chevron USA	3/20/91	122267311	37803466	OAK	8/90	0	15	0	4	MON	3479
301 14th Street	Chevron USA	3/20/91	122267311	37803466	OAK	Oct-90	0	32	23	2	MON	3479
301 14th Street	Chevron USA	8/1/91	122267311	37803466	OAK	4/91	0	14	8	2	MON	3479

Well Survey
Site: 6th and Castro Streets
Oakland, CA

Address	Owner	Update	Longitude	Latitude	City	Drill Date	Elev.	Total Depth	Water Depth	Diam	Use	DIST FROM SITE
301 14th Street	Chevron USA	8/1/91	122267311	37803466	OAK	2/91	0	20	3	2	MON	3479
301 14th Street	Chevron USA	8/1/91	122267311	37803466	OAK	4/91	0	30	22	2	MON	3479
301 14th Street	Chevron USA	8/1/91	122267311	37803466	OAK	4/91	0	35	22	2	MON	3479
301 14th St.	Chevron USA VEW-1	6/18/93	122267311	37803480	OAK	6/92	0	20	0	2	MON	3481
301 14th St.	Chevron USA VEW-2	6/18/93	122267311	37803480	OAK	6/92	0	20	0	2	MON	3481
301 14th Street	Chevron USA MW10	6/18/93	122267311	37803480	OAK	6/92	0	35	22	2	MON	3481
301 14th St	Chevron USA Products Co	9/11/97	122267294	37803466	OAK	4/94	0	30	20	4	MON	3484
5th St. && Union St.	CALTRANS CTF	6/24/93	122290671	37803664	OAK	6/92	0	9	4	0	BOR	3514

Key

BOR	geotechnical
MON	monitoring
TES	test well
DES	destroyed
GEO	geoprobe
IND	industrial
PIE	piezometer
DEW	??
ABN	abandoned
CAT	cathodic
EXT	extraction
INJ	injection

PICTURE 1

LOCATION OF BORING B1



Location: 40 feet north-northeast of 6th Street and 60 feet east-southeast of Brush Street

PICTURE 2

LOCATION OF BORING B6



Location: 38 feet north-northeast of 6th Street and 115 feet east-southeast of Brush Street

PICTURE 3

LOCATION OF BORING B5



Location: 96 feet north-northeast of 6th Street and 84 feet north-northwest of Castro Street

PICTURE 4

UP CLOSE OF BORING B5



PICTURE 5

LOCATION OF STORM DRAIN UTILITY LINE



PICTURE 6

VIEW FROM ABOVE STORM DRAIN



PICTURE 7

DEPTH OF STORM DRAIN (APPROX 2.5 FEET BELOW
GROUND SURFACE)

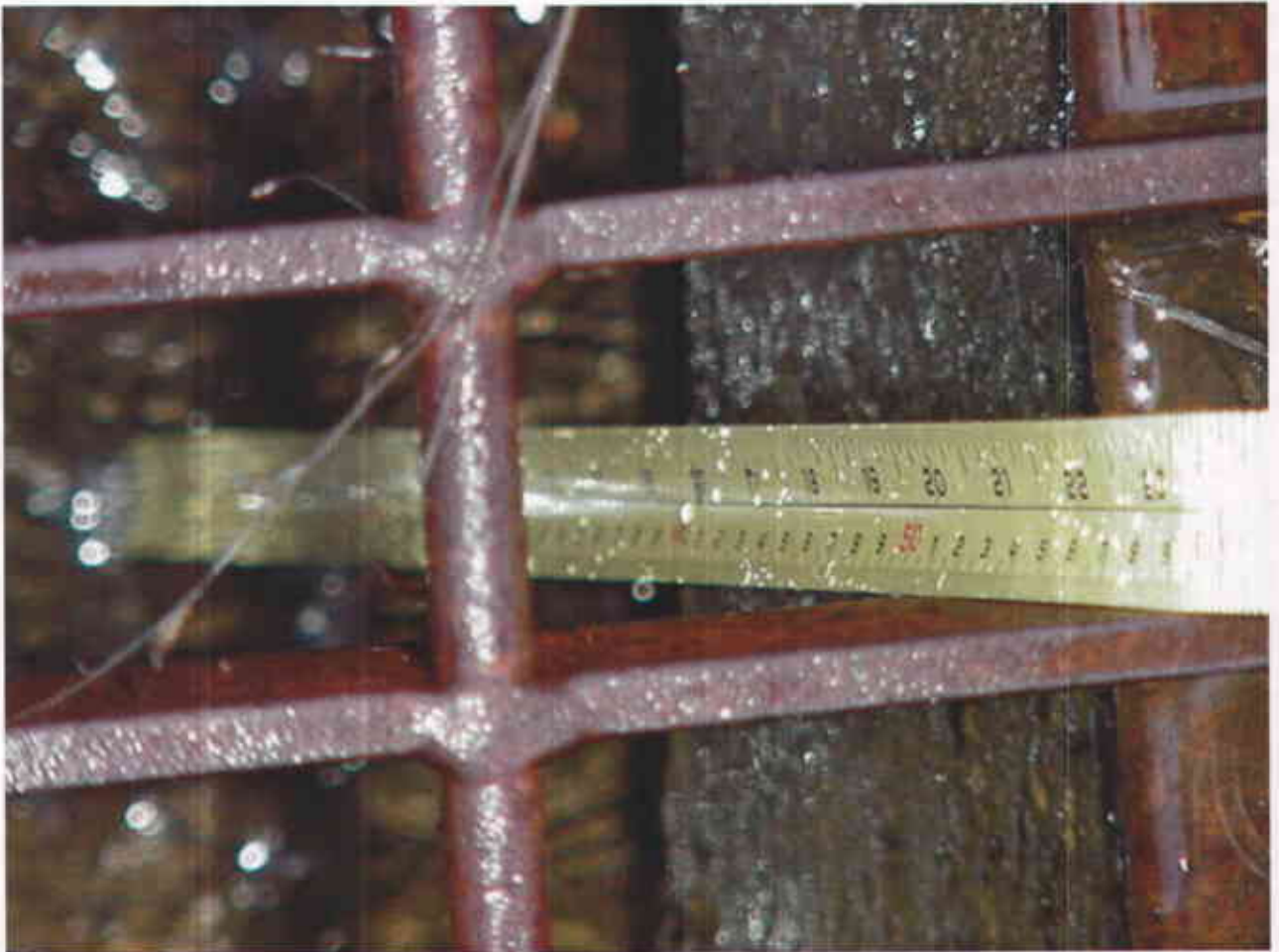
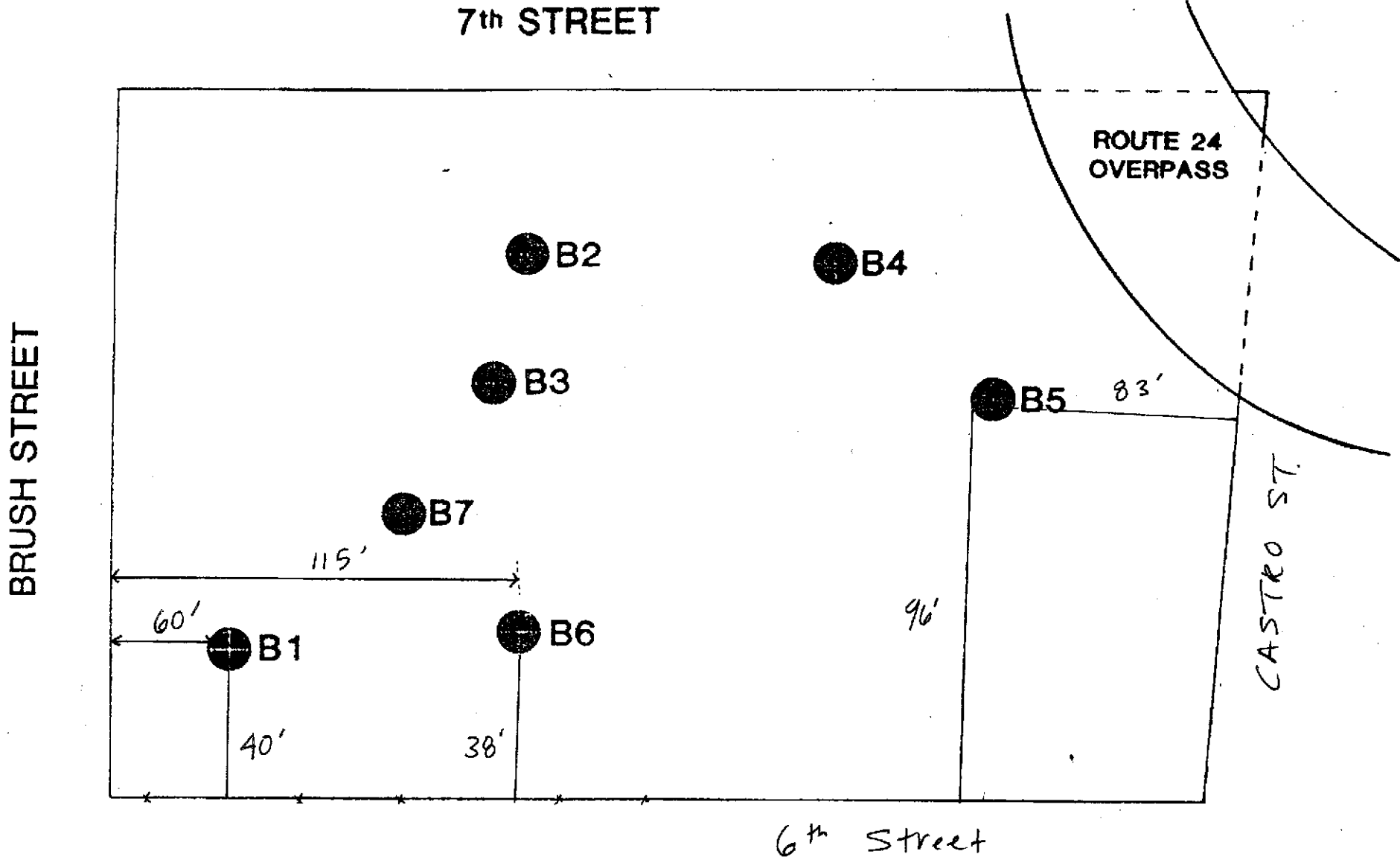


Figure 1



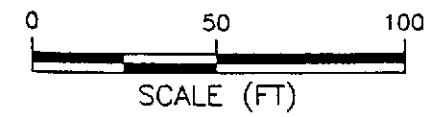
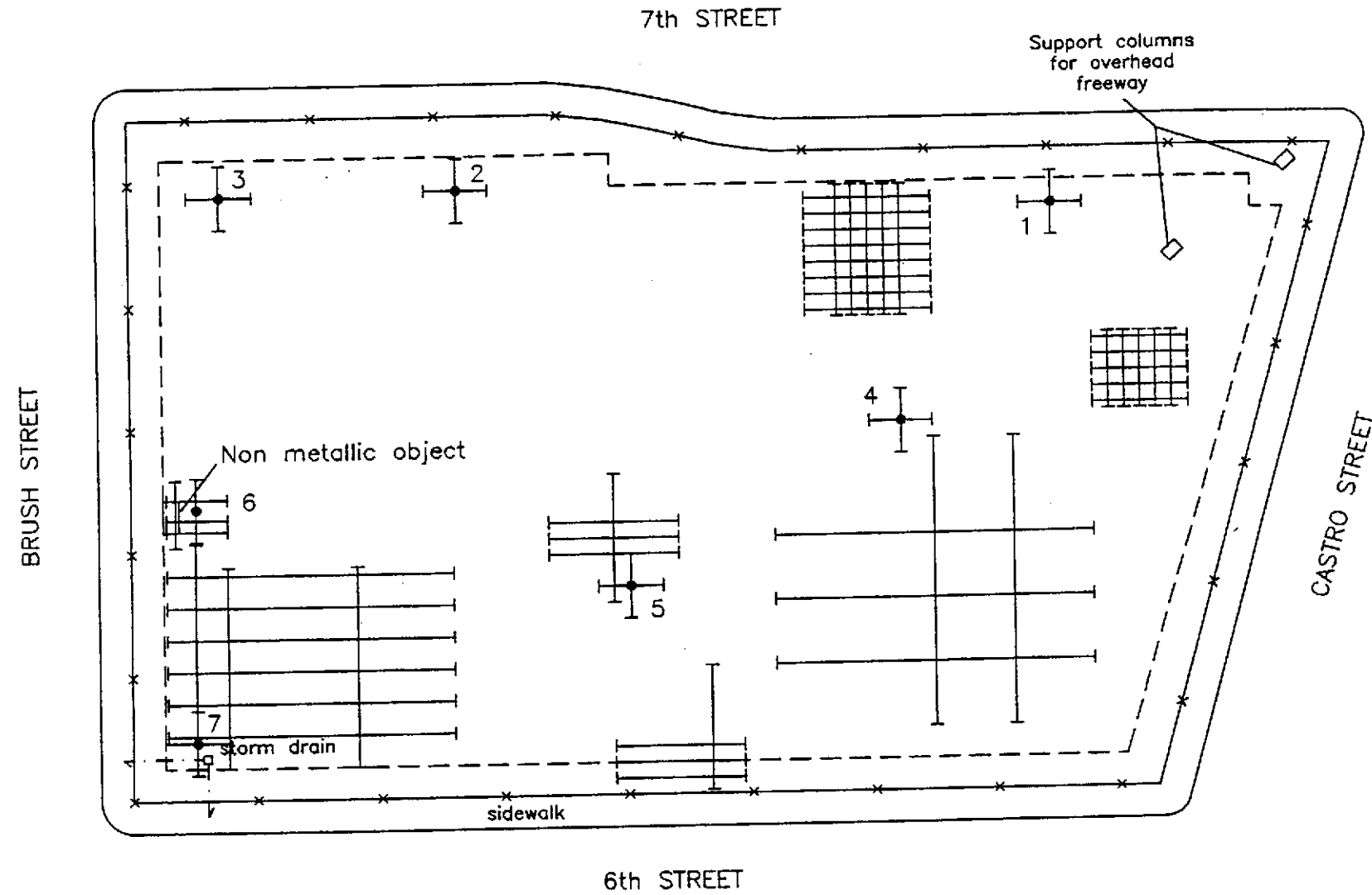
● BORING LOCATIONS




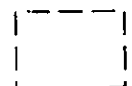



**FIGURE 1 7th AND BRUSH SITE
BORING LOCATIONS
OAKLAND, CALIFORNIA**

SCALE: 1"=40'

Figure 2



LEGEND

-  GPR Traverse
-  Extent of VMG survey
-  Utility line
-  Fence
-  1
Approximate location of proposed borings based on GEOCON site map

OAKLAND SITE LOCATION MAP

Geophysical Investigation
6th and Brush Streets
Oakland, California

NORCAL

GEOPHYSICAL
CONSULTANTS
INC.



PLATE

2

JOB: 95-285.03

APPR: DSK

DATE: 7/95