

PARADISO CONSTRUCTION CO.

GENERAL & PETROLEUM CONTRACTORS

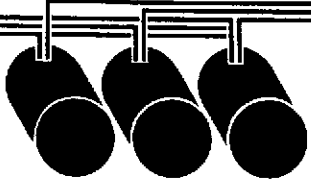
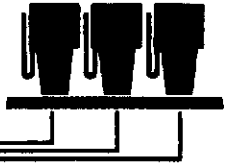

LICENSE NO. 259820

P.O. BOX 6397

9220 "G" STREET OAKLAND, CA 94603

(415) 562-5511

FAX COVER SHEET

PARADISO FAX NUMBER 415/638-8156

DATE: 8/14/90

NUMBER OF PAGES INCLUDING COVER SHEET: 18

TO: ALAMEDA ENV HEALTH ATTENTION: SUSAN HUGO

FAX NUMBER: (415) 568-3706

FROM: TONY MILLER

SUBJECT: BP
ML King Jr
Oakland

REMARKS: _____

Please call our office if you do not receive all pages.



KAPREALIAN ENGINEERING, INC.
Consulting Engineers

P.O. BOX 996 • BENICIA, CA 94510
(707) 746-6915 • (707) 746-6916 • FAX: (707) 746-5581

TRANSMITTAL PAGE

DATE: 8/13/90

TO: Mr. Tony Miller

FROM: Harvey

Number of Pages
(including cover): 17

SUBJECT: BP - Oakland - 5425 Martin Luther King Blvd.

If any problems occur in receiving, please
call the number listed above.

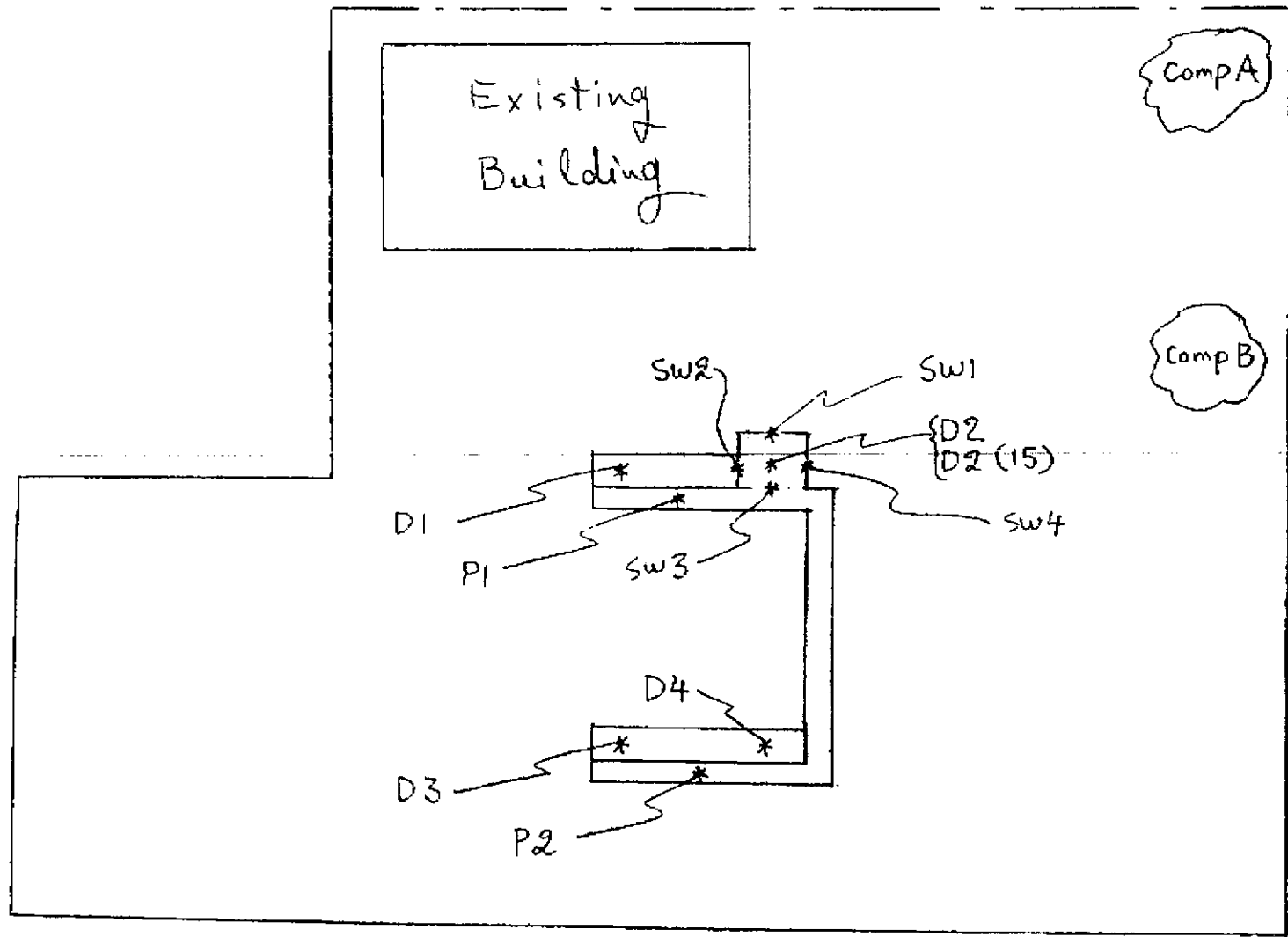

Martin Luther King Blvd

55th Street

KAPREALIAN ENGINEERING, INC.

CHAIN OF CUSTODY

NAME AGENCY		SITE NAME & ADDRESS					ANALYSES REQUESTED			MIN. HOLDING TIME:	
Harg		BP Service Station - Oakland 5425 Martin Luther King Blvd					Total Lead			24 Hrs	
REMARKS											
008 P32											
NO.	DATE	TIME	REEL	MARKED	COND	NO. OF CONT.	SAMPLE LOCATION	TPT-G	BTX-E	Total Lead	
PB	8/9/90		✓			2	STOCKPILE	✓	✓	✓	

Requested by: (Signature) <i>Harold Nevill</i>	Date/Time 8/9/90 5:30	Received by: (Signature) <i>Tim M. Lan</i>
Requested by: (Signature) <i>Tim M. Lan</i>	Date/Time	Received by: (Signature)
Requested by: (Signature)	Date/Time	Received by: (Signature)
Requested by: (Signature)	Date/Time 8/9 7:05	Received by: (Signature) <i>[Signature]</i>

The following MUST BE completed by the laboratory accepting samples for analysis:

- Have all samples received for analysis been stored in ice?
yes
- Will samples remain refrigerated until analyzed?
yes
- Did any samples received for analysis have head space?
N/A
- Were samples in appropriate containers and properly packaged?
yes

Log G
8/9

 Signature Title Date



SEQUOIA ANALYTICAL

880 Chesapeake Drive • Redwood City, CA 94063
 (415) 384-9600 • FAX (415) 384-9233

Kaprelian Engineering, Inc. P.O. Box 998 Benicia, CA 94610 Attention: Mardo Kaprelian, P.E.	Client Project ID: BP, Oakland, 5425 Martin Luther King Blvd. Matrix Descript: Soil Analysis Method: EPA 5030/8015/8020 First Sample #: 008-1721	Sampled: Aug 8, 1990 Received: Aug 9, 1990 Analyzed: Aug 9, 1990 Reported: Aug 13, 1990
------------------------------------------------------------------------------------------------------	-----------------------------------------------------------------------------------------------------------------------------------------------------------	--------------------------------------------------------------------------------------------------

TOTAL PETROLEUM FUEL HYDROCARBONS with BTEX DISTINCTION (EPA 8015/8020)

Sample Number	Sample Description	Low/Medium B.P. Hydrocarbons mg/kg (ppm)	Benzene mg/kg (ppm)	Toluene mg/kg (ppm)	Ethyl Benzene mg/kg (ppm)	Xylenes mg/kg (ppm)
008-1721	D1	N.D.	0.023	0.11	N.D.	0.016
008-1722	D2	N.D.	N.D.	0.0099	N.D.	N.D.
008-1723	D3	N.D.	0.0064	0.038	0.0064	0.038
008-1724	D4	N.D.	N.D.	0.013	N.D.	0.029
008-1725	F1	3.1	0.021	0.10	0.063	0.17
008-1726	F2	N.D.	N.D.	0.029	N.D.	0.016

Detection Limits:	1.0	0.0050	0.0050	0.0050	0.0050
-------------------	-----	--------	--------	--------	--------

Low to Medium Boiling Point Hydrocarbons are quantitated against a gasoline standard.
 Analytes reported as N.D. were not present above the stated limit of detection.

SEQUOIA ANALYTICAL

Elizabeth W. Hack
 Elizabeth W. Hack
 Project Manager



SEQUOIA ANALYTICAL

680 Chesapeake Drive • Redwood City, CA 94063
 (415) 364-9600 • FAX (415) 364-9233

Kapreallan Engineering, Inc.	Client Project ID: BP, Oakland, 5425 Martin Luther King Blvd.	Sampled: Aug 8, 1990
P.O. Box 998	Sample Descript: Soil	Received: Aug 9, 1990
Benicia, CA 94610	Analysis for: Lead	Extracted: Aug 10, 1990
Attention: Mardo Kapreallan, P.E.	First Sample #: 008-1721	Analyzed: Aug 10, 1990
		Reported: Aug 13, 1990

LABORATORY ANALYSIS FOR: Lead

Sample Number	Sample Description	Detection Limit mg/kg	Sample Result mg/kg
008-1721	D1	0.25	4.8
008-1722	D2	0.25	4.7
008-1723	D3	0.25	4.8
008-1724	D4	0.25	8.7
008-1725	P1	0.25	6.8
008-1726	P2	0.25	4.9

Analytes reported as N.D. were not present above the stated limit of detection.

SEQUOIA ANALYTICAL

Elizabeth W. Hackl
 Elizabeth W. Hackl
 Project Manager



SEQUOIA ANALYTICAL

680 Chesapeake Drive • Redwood City, CA 94063
(415) 364-9600 • FAX (415) 364-9233

Kapreallan Engineering, Inc.	Client Project ID:	BP, Oakland, 6425 Martin Luther King Blvd.	Sampled:	Aug 9, 1990
P.O. Box 898	Sample Descript:	Soil, D2 (16)	Received:	Aug 9, 1990
Benicia, CA 94510	Analysis Method:	EPA 5030/8015/8020	Analyzed:	Aug 10, 1990
Attention: Mardo Kapreallan, P.E.	Lab Number:	008-1997	Reported:	Aug 13, 1990

TOTAL PETROLEUM FUEL HYDROCARBONS WITH BTEX DISTINCTION (EPA 8015/8020)

Analyte	Detection Limit mg/kg (ppm)	Sample Results mg/kg (ppm)
Low to Medium Boiling Point Hydrocarbons		
Benzene	0.0050	N.D.
Toluene	0.0050	0.005
Ethyl Benzene	0.0050	0.005
Xylenes	0.0050	0.005

Low to Medium Boiling Point hydrocarbons are quantitated against a gasoline standard.
Analytes reported as N.D. were not present above the stated limit of detection.

SEQUOIA ANALYTICAL

Elizabeth W. Hackl
Elizabeth W. Hackl
Project Manager



SEQUOIA ANALYTICAL

680 Chesapeake Drive • Redwood City, CA 94063
(415) 364-9600 • FAX (415) 364-9233

Kaprelian Engineering, Inc. P.O. Box 968 Berkeley, CA 94710 Attention: Mardo Kaprelian, P.E.	Client Project ID: 5P, Oakland, 5426 Martin Luther King Blvd. Sample Descript: Sol, D2 (15) Lab Number: 008-1997	Sampled: Aug 8, 1990 Received: Aug 9, 1990 Extracted: Aug 10, 1990 Analyzed: Aug 10, 1990 Reported: Aug 13, 1990
-------------------------------------------------------------------------------------------------------	------------------------------------------------------------------------------------------------------------------------	------------------------------------------------------------------------------------------------------------------------------

LABORATORY ANALYSIS

Analyte	Detection Limit mg/kg	Sample Results mg/kg
---------	--------------------------	-------------------------

[Redacted area]

Analytes reported as N.D. were not present above the stated limit of detection.

SEQUOIA ANALYTICAL

Elizabeth W. Hack
Elizabeth W. Hack
Project Manager



KAPREALIAN ENGINEERING, INC.

CHAIN OF CUSTODY

Haig		SITE NAME & ADDRESS					ANALYTES REQUESTED			TIME AROUND TIME:		
BP Service Station - Oakland		5425 Martin Luther King Blvd					PHI BTX Total Lead			24 Hrs		
NO.	DATE	TIME	SOIL	WATER	GRAN	COMP	CONT.	SAMPLING LOCATION	PHI	BTX	Total Lead	REMARKS
(15)	8/9/90		✓	✓				Beneath Dispenser	✓	✓	✓	0081997

Requested by: (Signature) <i>[Signature]</i>	Date/Time 8/9/90 5:30	Received by: (Signature) <i>Tom M. [Signature]</i>
Requested by: (Signature) <i>[Signature]</i>	Date/Time	Received by: (Signature)
Requested by: (Signature)	Date/Time	Received by: (Signature)
Requested by: (Signature)	Date/Time 8/9 7:05	Received by: (Signature) <i>[Signature]</i>

- The following MUST BE completed by the Laboratory accepting samples for analysis
- Have all samples received for analysis been stored in ice? YES
 - Were samples remain refrigerated until analyzed? YES
 - Did any samples received for analysis have head space? N/A
 - Were samples in appropriate containers and properly packaged? YES
- Signature: [Signature] Date: 8/9
- Log in: [Signature] Date: 8/9

SENT BY: XEROX Telecopier 70171; 8-13-90; 2:37PM; 41538649233- 707 748 5581; # 4



KAPREALIAN ENGINEERING, INC.
Consulting Engineers

PO. BOX 996 • BENICIA, CA 94510
(707) 746-6915 • (707) 746-6916 • FAX: (707) 746-5581

TRANSMITTAL PAGE

DATE: 8/13/90

TO: Mr. Tony Miller

FROM: Harj

Number of Pages
(including cover): 17

SUBJECT: BP - Oakland - 5425 Martin Luther King Blvd

If any problems occur in receiving, please
call the number listed above.



SEQUOIA ANALYTICAL

880 Chesapeake Drive • Redwood City, CA 94063
(415) 364-9800 • FAX (415) 364-9233

Kaprealian Engineering, Inc. P.O. Box 898 Berkeley, CA 94510 Attention: Marco Kaprealian, P.E.	Client Project ID: BP, Oakland, 5425 Martin Luther King Blvd. Matrix Descript: Soil Analyse Method: EPA 8030/8015/8020 First Sample #: 008-1993	Sampled: Aug 9, 1990 Received: Aug 9, 1990 Analyzed: Aug 10, 1990 Reported: Aug 13, 1990
---------------------------------------------------------------------------------------------------------	----------------------------------------------------------------------------------------------------------------------------------------------------------	---------------------------------------------------------------------------------------------------

TOTAL PETROLEUM FUEL HYDROCARBONS with BTEX DISTINCTION (EPA 8015/8020)

Sample Number	Sample Description	Low/Medium B.P. Hydrocarbons mg/kg (ppm)	Benzene mg/kg (ppm)	Toluene mg/kg (ppm)	Ethyl Benzene mg/kg (ppm)	Xylenes mg/kg (ppm)
008-1993	8W1	75	0.063	0.17	0.35	0.90
008-1994	8W2	23	0.0084	0.031	0.010	0.071
008-1995	8W3	35	0.0099	0.031	0.014	0.31
008-1996	8W4	2.9	N.D.	0.019	0.066	0.085

Detection Limits:	1.0	0.0050	0.0050	0.0050	0.0050
-------------------	-----	--------	--------	--------	--------

Low to Medium Boiling Point Hydrocarbons are quantitated against a gasoline standard. Analytes reported as N.D. were not present above the stated limit of detection.

SEQUOIA ANALYTICAL

Elizabeth W. Hack
Elizabeth W. Hack
Project Manager



SEQUOIA ANALYTICAL

880 Chesapeake Drive • Redwood City, CA 94063
(415) 364-8600 • FAX (415) 364-9233

Kaprelian Engineering, Inc. P.O. Box 898 Benicia, CA 94510 Attention: Mardo Kaprelian, P.E.	Client Project ID: BP, Oakland, 5425 Martin Luther King Blvd. Sample Descript: Soil Analysis for: Lead First Sample #: 008-1993	Sampled: Aug 9, 1990 Received: Aug 9, 1990 Extracted: Aug 10, 1990 Analyzed: Aug 10, 1990 Reported: Aug 13, 1990
------------------------------------------------------------------------------------------------------	------------------------------------------------------------------------------------------------------------------------------------------	------------------------------------------------------------------------------------------------------------------------------

LABORATORY ANALYSIS FOR: Lead

Sample Number	Sample Description	Detection Limit mg/kg	Sample Result mg/kg
008-1993	SW1	0.25	5.3
008-1994	SW2	0.25	4.4
008-1995	SW3	0.25	5.0
008-1996	SW4	0.25	6.1

Analytes reported as N.D. were not present above the stated limit of detection.

SEQUOIA ANALYTICAL

Elizabeth W. Haid
Elizabeth W. Haid
Project Manager



KAPREALIAN ENGINEERING, INC.

CHAIN OF CUSTODY

CLIENT: Haig	SITE NAME & ADDRESS: BP Service Station - Oakland 5425 Martin Luther King Blvd	ANALYSES REQUESTED:	TURN AROUND TIME: 24 hrs
ISSUING AGENCY:			

SAMPLE NO.	DATE	TIME	NO. OF				SAMPLING LOCATION	ANALYSES REQUESTED			REMARKS
			SOIL	WATER	GRAB	CONT.		PH	PH	Total Lead	
01	8/9/90		✓	✓	1	Sidewalk	✓	✓	✓	008 1993	
02	8/9/90		✓	✓	1	↓	✓	✓	✓	009 1994	
03	8/9/90		✓	✓	1		✓	✓	✓	008 1995	
04	8/9/90		✓	✓	1		✓	✓	✓	008 1996	

Prepared by: (Signature) Agnes Kewell	Date/Time: 8/9/90 5:30	Received by: (Signature) Tim McLean	<p>The following MUST BE completed by the laboratory accepting samples for analysis:</p> <p>1. Have all samples received for analysis been stored in ice? <u>yes</u></p> <p>2. Will samples remain refrigerated until analyzed? <u>yes</u></p> <p>3. Did any samples received for analysis have head space? <u>N/A</u></p> <p>4. Were samples in appropriate containers and properly packaged? <u>yes</u></p>
Prepared by: (Signature) Tim McLean	Date/Time:	Received by: (Signature)	
Prepared by: (Signature)	Date/Time:	Received by: (Signature)	
Prepared by: (Signature)	Date/Time: 8/9 7:05	Received by: (Signature) [Signature]	
			<p>Signature: [Signature] Date: 8/9/90</p> <p>Log in Date: 8/9/90</p>

SENT BY: XEROX Telecopier 7017: 8-13-90 : 2:51PM : 4158649233- 707 748 5581: # 4



SEQUOIA ANALYTICAL

680 Chesapeake Drive • Redwood City, CA 94063
 (415) 364-9800 • FAX (415) 364-9233

Kaprealian Engineering, Inc. P.O. Box 998 Berkeley, CA 94510 Attention: Mario Kaprealian, P.E.	Client Project ID: SP, Oakland, 5425 Martin Luther King Blvd. Sample Descript.: Soil, Composite A Analysis Method: EPA 8030/8015/8020 Lab Number: 008-1719	Sampled: Aug 8, 1990 Received: Aug 9, 1990 Analyzed: Aug 10, 1990 Reported: Aug 13, 1990
---------------------------------------------------------------------------------------------------------	---------------------------------------------------------------------------------------------------------------------------------------------------------------------	---------------------------------------------------------------------------------------------------

TOTAL PETROLEUM FUEL HYDROCARBONS WITH BTEX DISTINCTION (EPA 8015/8020)

Analyte	Detection Limit mg/kg (ppm)	Sample Results mg/kg (ppm)
Low to Medium Boiling Point Hydrocarbons.....	1.0	N.D.
Benzene.....	0.0050	N.D.
Toluene.....	0.0050	N.D.
Ethyl Benzene.....	0.0050	N.D.
Xylenes.....	0.0050	N.D.

Low to Medium Boiling Point Hydrocarbons are quantitated against a gasoline standard.
 Analytes reported as N.D. were not present above the stated limit of detection.

SEQUOIA ANALYTICAL

Elizabeth W. Hack
 Elizabeth W. Hack
 Project Manager



SEQUOIA ANALYTICAL

880 Chesapeake Drive • Redwood City, CA 94063
(415) 364-9600 • FAX (415) 364-8233

Kaprelian Engineering, Inc.	Client Project ID: BP, Oakland, 5425 Martin Luther King Blvd.	Sampled: Aug 8, 1980
P.O. Box 998	Sample Descript: Soil, Composite A	Received: Aug 9, 1980
Benicia, CA 94510	Lab Number: 008-1719	Extracted: Aug 9, 1980
Attention: Mardo Kaprelian, P.E.		Analyzed: Aug 9, 1980
		Reported: Aug 13, 1980

LABORATORY ANALYSIS

Analyte	Detection Limit mg/kg	Sample Results mg/kg
---------	--------------------------	-------------------------

ND

Analytes reported as N.D. were not present above the stated limit of detection.

SEQUOIA ANALYTICAL

Elizabeth W. Hack
Elizabeth W. Hack
Project Manager



SEQUOIA ANALYTICAL

660 Chesapeake Drive • Redwood City, CA 94063
 (415) 364-9800 • FAX (415) 364-9233

Kapreallan Engineering, Inc.	Client Project ID:	BP, Oakland, 5425 Martin Luther King Blvd.	Sampled:	Aug 8, 1990
P.O. Box 996	Sample Descript:	Soil	Received:	Aug 9, 1990
Benicia, CA 94510	Analysis Method:	California LUFT Manual, 12/87	Analyzed:	Aug 10, 1990
Attention: Mardo Kapreallan, P.E.	First Sample #:	008-1719	Reported:	Aug 13, 1990

ORGANIC LEAD

Sample Number	Sample Description	Sample Results mg/kg (ppm)
008-1719	Composites A	N.D.

Detection Limits:

0.050

Analytes reported as N.D. were not present above the stated limit of detection.

SEQUOIA ANALYTICAL

Elizabeth W. Hackl
 Elizabeth W. Hackl
 Project Manager

KAPREALIAN ENGINEERING, INC.

CHAIN OF CUSTODY

SING SUBJECT		SITE NAME & ADDRESS					ANALYTES COLLECTED			MINIMUM TIME:		
Haig		BP Service Station - Oakland 5425 Martin Luther King Blvd					TPH-G	BTXE	Total Lead	24 Hrs		
FILE NO.	DATE	TIME	SOIL	WATER	ROAD	COMP	CONT.	ENGINE LOCATION	TPH-G	BTXE	Total Lead	REMARKS
1	8/8/90		✓	✓				Beneath Dispenser	✓	✓	✓	0081721
2	8/8/90		✓	✓				Beneath Dispenser	✓	✓	✓	1722
3	8/8/90		✓	✓				Beneath Dispenser	✓	✓	✓	1723
4	8/8/90		✓	✓				Beneath Dispenser	✓	✓	✓	1724
1	8/8/90		✓	✓				Pipe Trench	✓	✓	✓	1725
2	8/8/90		✓	✓				Pipe Trench	✓	✓	✓	1726

Requested by: (Signature) <i>John Kenney</i>	Date/Time 8/9/90 8:30	Received by: (Signature) <i>Tom McSain</i>
Requested by: (Signature) <i>Tom McSain</i>	Date/Time 8/9/90 10:30	Received by: (Signature) <i>Paul Head</i>
Requested by: (Signature)	Date/Time	Received by: (Signature)
Requested by: (Signature)	Date/Time	Received by: (Signature)

The following MUST BE completed by the laboratory accepting samples for analysis		
1. Have all samples received for analysis been stored in ice?	✓	
2. Will samples remain refrigerated until analyzed?	✓	
3. Did any samples received for analysis have head space?	NO	
4. Were samples in appropriate containers and properly packaged?	✓	
<i>JK</i>	<i>JK</i>	<i>8/9/90</i>
Signature	Title	Date

SENT BY: XEROX Telecopier 7017: 8-13-90 11:03AM : 4153848233- 707 748 5581: # 2



SEQUOIA ANALYTICAL

880 Chesapeake Drive • Redwood City, CA 94083
(415) 364-9800 • FAX (415) 364-9233

Kapreallan Engineering, Inc. P.O. Box 996 Benicia, CA 94510 Attention: Mardo Kapreallan, P.E.	Client Project ID: BP, Oakland, 5425 Martin Luther King Blvd. Sample Descript: Soil, Composite B Lab Number: 008-1992 A-B	Sampled: Aug 9, 1990 Received: Aug 9, 1990 Extracted: Aug 10, 1990 Analyzed: Aug 10, 1990 Reported: Aug 13, 1990
--------------------------------------------------------------------------------------------------------	---------------------------------------------------------------------------------------------------------------------------------	------------------------------------------------------------------------------------------------------------------------------

LABORATORY ANALYSIS

Analyte	Detection Limit mg/kg	Sample Results mg/kg
---------	--------------------------	-------------------------

Analytes reported as N.D. were not present above the stated limit of detection.

SEQUOIA ANALYTICAL

Elizabeth W. Hackl
Elizabeth W. Hackl
Project Manager



SEQUOIA ANALYTICAL

680 Chesapeake Drive • Redwood City, CA 94063
(415) 364-9600 • FAX (415) 364-9233

Kapreallan Engineering, Inc.	Client Project ID: 8P, Oakland, 5425 Martin Luther King Blvd.	Sampled: Aug 9, 1990
P.O. Box 568	Sample Descript: Soil, Composite B	Received: Aug 9, 1990
Benicia, CA 94510	Analysis Method: EPA 5030/8015/8020	Analyzed: Aug 10, 1990
Attention: Mardo Kapreallan, P.E.	Lab Number: 008-1992 A-B	Reported: Aug 13, 1990

TOTAL PETROLEUM FUEL HYDROCARBONS WITH BTEX DISTINCTION (EPA 8015/8020)

Analyte	Detection Limit mg/kg (ppm)	Sample Results mg/kg (ppm)
---------	--------------------------------	-------------------------------

Low to Medium Boiling Point Hydrocarbons	0.0050	
Benzene	0.0050	
Toluene	0.0050	
Ethyl Benzene	0.0050	
Xylenes	0.0050	

Low to Medium Boiling Point Hydrocarbons are quantitated against a gasoline standard.
Analytes reported as N.D. were not present above the stated limit of detection.

SEQUOIA ANALYTICAL

Elizabeth W. Heckl
Elizabeth W. Heckl
Project Manager