

EXHIBIT "A"



BROWN AND CALDWELL LABORATORIES

ANALYTICAL REPORT

1255 POWELL STREET EMERYVILLE, CA 94608 • (415) 428-2300

LOG NO: E88-04-591

Received: 25 APR 88

Reported: 18 MAY 88

JUN 17 1988

Mr. Gino Kang
Crystal Cleaners
2006 Encinal Ave.
Alameda, California 94501

Purchase Order: PAID IN FULL

REPORT OF ANALYTICAL RESULTS

Page 1

LOG NO	SAMPLE DESCRIPTION, SOIL SAMPLES	DATE SAMPLED		
04-591-1	Sample A	25 APR 88		
04-591-2	Sample B	25 APR 88		
04-591-3	Sample C	25 APR 88		
PARAMETER		04-591-1	04-591-2	04-591-3
Total Fuel Hydrocarbons, <i>ml/kg</i>				

A. D. Lessley

Sim D. Lessley, Ph.D., Laboratory Director

*Received 6/15/88
Gino Kang*

EXHIBIT "A"

EXHIBIT "B"



BROWN AND CALDWELL ANALYTICAL LABORATORIES

Field Notes 25 April 1988 Soil Collection Site Map (Not to Scale)

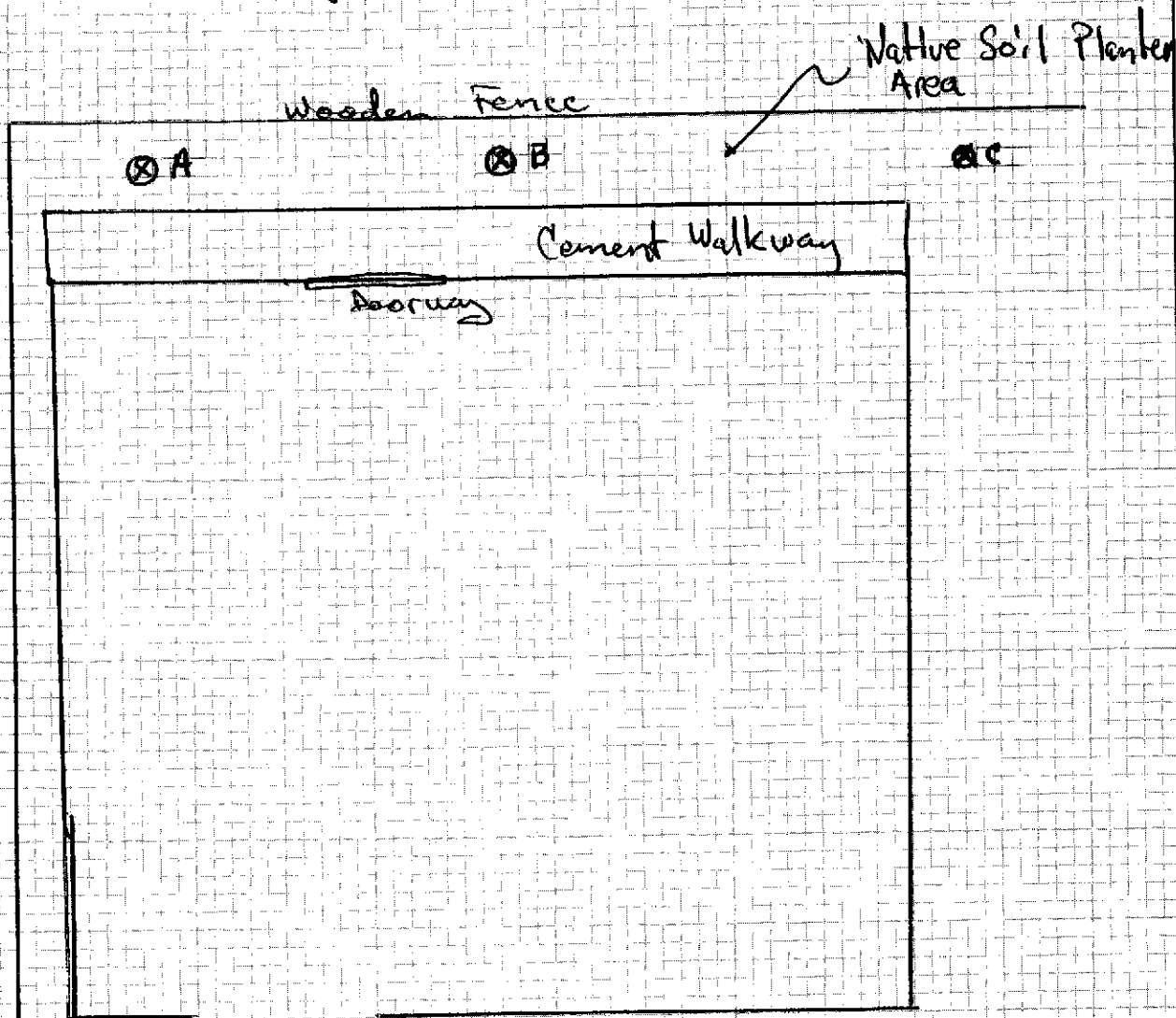

South west Building on property located at 2006 Encinal Ave Alameda, CA.

Parking Area

Encinal Avenue



→ North

3580-01
JOB NUMBER

Stoddard Solvent Spill Crystal Cleaners
SUBJECT

DATE

SHEET NO.

EXHIBIT "B"

GEN-004-3/5/85