

California

13908 San Pablo Avenue
Suite 101
San Pablo, California 94806
(510) 232-8366 FAX (510) 232-5133



ALCO
HAZMAT Oregon

94 APR 26 AM 10:09
370 West Sixth Avenue
Suite A
Eugene, Oregon 97401
(503) 342-6606 FAX (503) 342-1632

4/1/94

**SOURCE REMOVAL REPORT
PAINT THINNER TANK
HEATING OIL TANK
4529 & 4549 Horton Street
Emeryville, California**

Project No. 113093

MANAGEMENT AND CONSULTING



California Registered Environmental Assessors
California Certified Engineering Geologist
Oregon Registered Engineering Geologist
Oregon Registered UST Soil Cleanup Supervisors

SOURCE REMOVAL REPORT

**PAINT THINNER TANK
HEATING OIL TANK**

**4529 & 4549 Horton Street
Emeryville, California**

April 1, 1994

Prepared For:

Harvey M. Rifkin, Trustee of the
Harvey M. Rifkin Living Trust
Robert Rifkin, Harvey Rifkin,
as Trustee of the Estate of
Beatrice L. Rifkin, deceased,
Robert Kantor and Sandra Kantor

c/o Mr. Frank Satterwhite, Receiver
3220 Monika Lane
Hayward, California 94541

Report prepared By:

TMC Environmental, Inc.
13908 San Pablo Ave., Suite 101
San Pablo, California 94806

Mark Youngkin
Mark Youngkin, Vice President
TMC Job number 113093

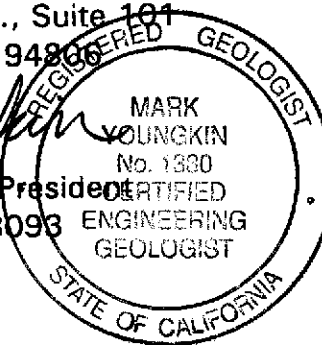

TABLE OF CONTENTS

4529 & 4549 Horton Street, Emeryville, California

SOURCE REMOVAL SUMMARY _____	1
GENERAL SITE INFORMATION _____	2
SITE LOCATION	2
SITE DESCRIPTION	2
PROPERTY OWNER	2
CONSULTANT OF RECORD	3
LEAD IMPLEMENTING AGENCY	3
RECENT TANK REMOVALS _____	3
CONDITION OF UNDERGROUND TANKS _____	4
CONDITION OF PAINT THINNER	4
CONDITION OF HEATING OIL TANK.....	4
RESULTS OF TANK REMOVAL SOIL SAMPLING _____	4
PAINT THINNER TANK SOURCE REMOVAL _____	5
OVER EXCAVATION OF PAINT THINNER TANK PIT.....	5
PAINT THINNER TANK: EXCAVATION LIMIT SAMPLING.....	6
PAINT THINNER TANK: HAND AUGURED BORINGS	7
PAINT THINNER TANK: GRAB WATER SAMPLING	7
HEATING OIL TANK SOURCE REMOVAL _____	8
OVER EXCAVATION OF HEATING OIL TANK PIT	8
HEATING OIL TANK: EXCAVATION LIMIT SAMPLING.....	8
HEATING OIL TANK: HAND AUGURED BORINGS	9
HEATING OIL TANK: GRAB WATER SAMPLING.....	10
DISPOSAL OF CONTAMINATED WASTE _____	11
LIMITATIONS _____	11

TABLES

TABLE 1 TANK REMOVAL SOIL SAMPLING.....	4
TABLE 2 PAINT THINNER TANK: INTERIM SAMPLES.....	5
TABLE 3 PAINT THINNER TANK: EXCAVATION LIMIT SAMPLES.....	6
TABLE 4 PAINT THINNER TANK: HAND AUGER SAMPLES.....	7
TABLE 5 PAINT THINNER TANK: GRAB WATER SAMPLING	8
TABLE 6 HEATING OIL TANK: EXCAVATION LIMIT SAMPLES	9
TABLE 7 HEATING OIL TANK: HAND AUGER SAMPLES	10
TABLE 8 HEATING OIL TANK: GRAB WATER SAMPLING.....	10

ILLUSTRATIONS

Plates are attached to the end of the report.

PLATE 1	SITE VICINITY MAP
PLATE 2	SITE MAP
PLATE 3	PAINT THINNER TANK SOURCE REMOVAL PLAN
PLATE 4	HEATING OIL TANK SOURCE REMOVAL PLAN
PLATE 5	PAINT THINNER TANK, EXCAVATION LIMIT DIAGRAM
PLATE 6	HEATING OIL TANK, EXCAVATION LIMIT DIAGRAM

ATTACHMENTS

ATTACHMENT 1	PAINT THINNER TANK EXCAVATION ANALYTICAL LABORATORY REPORTS, CHAIN OF CUSTODY FORMS
ATTACHMENT 2	HEATING OIL TANK EXCAVATION ANALYTICAL LABORATORY REPORTS, CHAIN OF CUSTODY FORMS
ATTACHMENT 3	GRAB GROUND WATER SAMPLES ANALYTICAL LABORATORY REPORTS, CHAIN OF CUSTODY FORMS
ATTACHMENT 4	WASTE MANIFESTS
ATTACHMENT 5	SAMPLING PROTOCOL

SOURCE REMOVAL REPORT
PAINT THINNER TANK & HEATING OIL TANK
4529 and 4549 Horton Street, Emeryville California

SOURCE REMOVAL SUMMARY

Bay Area Tank Removal, Inc. (BATR) removed a 500 gallon paint thinner tank at 4529 Horton Street and a 1500 gallon heating oil tank at 4549 Horton Street in Emeryville, California. The tanks appears to be 30-40 years old. The 1500 gallon heating oil tank was corroded with obvious holes. No soil samples were collected below the heating oil tank because of obvious soil contamination. The 500 gallon paint thinner tank was corroded with obvious holes. BATR recovered two soil samples from the paint thinner tank pit. The laboratory reported the bottom sample to have a concentration of 10,000 ppm. Following the tank removal, both the heating oil and paint thinner tank pit were left open for later source removal.

BATR over excavated contaminated soil surrounding the paint thinner tank on January 6, 1994. A backhoe removed about 72 cubic yards of sandy clay-silt from the tank pit. Paint thinner concentrations up to 3909 ppm were encountered during the excavation of soil. The majority of contaminated soil was removed during the excavation. The bottom of the excavation was at 11.5 feet below grade in gray-brown sandy clay-silt. Paint thinner concentrations of up to 2630 ppm remain on the south and west side walls of the excavation beneath utility lines. Mr. Barny Chan, inspector with Alameda County, gave permission to back fill the excavation when the majority of contaminated soil had been removed. On January 10, 1994, TMC drilled hand augered borings into the west wall of the paint thinner tank excavation. The hand augered borings indicate the extent of remaining soil contamination is limited to beneath the utility lines. Ground water occurred in the excavation at a depth of 10-11 feet below grade. The fresh ground water had no sheen or floating product. H & H Ship Service pumped out 250 gallons of water in the excavation prior to groundwater grab sampling. The grab water sampling indicates no detectable paint thinner in the groundwater.

BATR over excavated contaminated soil surrounding the heating oil tank on January 10, 1994. A backhoe removed about 36 cubic yards of sandy clay-silt from the tank pit. Heating oil concentrations up to 15,700 ppm TPH as diesel were encountered during the excavation of soil. The majority of heating oil contaminated soil was removed during the over excavation. Heating oil contaminated soil remains beneath adjacent utility lines. The bottom of the excavation was at 12 feet below grade in gray-brown sandy clay-silt. Mr. Barny Chan, inspector with Alameda County, gave permission to back fill the excavation when the majority of contaminated soil had been removed.

On January 13, 1994, TMC drilled hand augered borings into the side walls of the heating oil tank excavation limits. The hand augered borings indicate the extent of soil contamination is limited to beneath the utility lines. Ground water occurred in the

excavation at a depth of 8-10 feet below grade. The fresh ground water had no sheen or floating product. During the back filling of the excavation with imported fill material, a four inch diameter observation sump was installed in the excavation. On January 11, January 19, and February 9, 1994, H & H Ship Service pumped out 4970 gallons of pit water from the observation sump prior to groundwater grab sampling. The laboratory reported non detectable results for the grab water sampling.

Bay Area Tank Removal, Inc. filled both excavations with imported material, then resurfaced the sidewalk with concrete. Den Beste Trucking transported 72 cubic yards of paint thinner contaminated soil to Browning Ferris Industries in Livermore, California for disposal. Manley & Sons Trucking transported 36 yards of heating oil contaminated soil to Forward Inc. Landfill in Manteca, California.

GENERAL SITE INFORMATION

SITE LOCATION

The subject property, called the "Site" in this report, is at the following address:

4525-4563 Horton Street, City of Emeryville
County of Alameda, State of California
Assessor's Parcel No. 49-1041-005

The entire property is occupied by one large building. Multiple businesses and addresses occur within the building. The underground paint thinner and heating oil tanks occurred in the sidewalk at 4529 and 4549 Horton Street.

SITE DESCRIPTION

The site is on Horton Street between 53rd and 45th Streets (see Plate 1, Site Vicinity Map), and is rectangular in configuration. The site is currently developed, with an existing two story, brick walled, commercial building (see Plate 2, Site Map). The building occupies the majority of the one acre property. The Site is bordered to the north by Chiron International Research Corporation, to the south by the Sherwin Williams Paint Company, to the east by Horton Street and Chiron, and to the west by railroad tracks and the rubble of a dismantled water tank and fuel oil tank. Temescal Creek runs through a culvert beneath the building. Public utilities service the general area. Land use of the surrounding area is commercial and industrial.

PROPERTY OWNER

The property owners for this site are:

Harvey M. Rifkin, Trustee of the Harvey M. Rifkin Living Trust Dated March 11, 1987,
Robert Rifkin, Harvey Rifkin, as Trustee of the Estate of Beatrice L. Rifkin,

deceased,
Robert Kantor and Sandra Kantor

c/o Mr. Frank Satterwhite, Receiver
3220 Monika Lane
Hayward, California 94541

CONSULTANT OF RECORD

The consultant of record for this project is:

TMC Environmental Inc.
13908 San Pablo Avenue, Suite 101, San Pablo, California 94806

Mr. Tom Edwards, president or Mr. Mark Youngkin, vice president can be reached at (510) 232-8366.

LEAD IMPLEMENTING AGENCY

The lead implementing agency with jurisdiction over this site is:

County of Alameda, Health Care Services Agency
Department of Environmental Health, UST Local Oversight Program
80 Swan Way, Room 200, Oakland, California

The officer overseeing this case is Ms. Susan Hugo, who can be reached at (510) 271-4320. The agency will review the report on a case by case basis using local health regulations and guidelines specified in the Tri-Regional Board Staff Recommendations for Preliminary Evaluation and Investigation of Underground Tank Sites, California Regional Water Quality Control Board, San Francisco Bay Region. It is the responsibility of the underground tank program to issue a letter for completion or require additional investigation and clean up for this site.

RECENT TANK REMOVALS

Bay Area Tank Removal, Inc. (BATR) of San Francisco, California removed a 500 gallon paint thinner tank at 4529 Horton Street and a 1500 gallon heating oil tank at 4549 Horton Street in Emeryville, California. The age of the tanks appears to be 30-40 years. On November 24, 1993, the tanks were removed from the excavation and loaded onto trucks for transport and cleaning at the H & H transport, disposal, and storage facility in San Francisco, California.

CONDITION OF UNDERGROUND TANKS

CONDITION OF PAINT THINNER

The 500 gallon paint thinner tank was corroded with obvious holes. Obvious odor was observed in the tank pit. BATR collected two soil samples from the paint thinner tank pit, one from beneath the center of the tank and one from the northwest side wall. The laboratory reported the bottom sample to have a concentration of 10,000 ppm gasoline range hydrocarbon. No groundwater occurred in the tank pit. The tank pit was left open for source removal.

CONDITION OF HEATING OIL TANK

The 1500 gallon heating oil tank had dimensions of five feet diameter by ten feet length with a burial depth of 48 inches. A product, return, and vent line connected the tank to the building foundation. The lines were cut off and pinched at the foundation wall. The 1500 gallon heating oil tank was corroded with obvious holes. No soil samples were collected below the tank because of the obvious heating oil contamination of back fill beneath the tank. No groundwater was observed in the tank pit. The tank pit was left open for source removal.

RESULTS OF TANK REMOVAL SOIL SAMPLING

Two soil samples (2-B and 2-NW) were collected from the paint thinner tank pit, one from beneath the center of the tank (2-B) and one from the northwest side wall (2-NW). No soil samples were collected below the heating oil tank because of the obvious heating oil contamination of back fill beneath the tank.

The samples were submitted to an on site, State-certified mobile laboratory, Geochem Environmental Laboratories of San Jose, California, for chemical analysis. The soil samples were chemically analyzed for total petroleum hydrocarbons (TPH) as diesel and gasoline with benzene, toluene, ethylbenzene, and total xylenes distinction (BTEX). The two samples from the paint thinner tank pit were also analyzed for organic lead and volatile organic compounds. The sample analysis results are presented below in Table 1, Tank Removal Sample Results, and in the attachments.

TABLE 1 TANK REMOVAL SOIL SAMPLING

Underground Storage Tank Address:	4529 Horton Street
Sample collection date:	November 24, 1993
Type of soil collected in samples:	clay

Sample Label	Depth Inches	Diesel mg/Kg ppm	Gasoline mg/Kg ppm	Benzene mg/Kg ppm	Toluene mg/Kg ppm	Ethyl Benzene mg/Kg ppm	Total Xylenes mg/Kg ppm
Reporting Limit		1 ppm	1ppm	0.1 ppm	0.1 ppm	0.1 ppm	0.1 ppm
Paint Thinner Tank 2 B	84	ND	10,000	ND	4.0	12.4	12.4
Paint Thinner Tank 2 NW	72	ND	ND	0.1	ND	ND	0.4

ND = NOT REPORTED ABOVE LABORATORY REPORTING LIMIT

The soil sample, #2-B, below the paint thinner tank, was reported at a concentration of 10,000 ppm gasoline range hydrocarbon. No organic lead or volatile organic compounds were detected beneath the paint thinner tank.

PAINT THINNER TANK SOURCE REMOVAL

OVER EXCAVATION OF PAINT THINNER TANK PIT

BATR over excavated contaminated soil surrounding the paint thinner tank on January 6, 1994. An inspector, Mr. Barney Chan from Alameda County, and personnel from TMC Environmental, Inc. witnessed the excavation. A backhoe removed about 54 cubic yards of sandy clay from the side walls and bottom of the tank pit. During the over excavation, a Geochem mobile laboratory was on site to analyze soil samples. Table 2, paint thinner tank: interim samples, shows the interim sample results during the progress of the over excavation of soil. Plate 3, paint thinner tank source removal plan, shows the location of soil samplings collected during the over excavation. Paint thinner concentrations up to 3909 ppm were encountered during the excavation of soil.

TABLE 2 PAINT THINNER TANK: INTERIM SAMPLES

Underground Tank Site Address: 4529 Horton Street, Emeryville, CA
 Site Name: Rifkin Realty Partners
 Sample collection date: January 5, 1994
 Type of soil collected in samples: clay-silt

Sample ID	Depth Feet	Gasoline ppm	Benzene ppm	Toluene ppm	Ethyl benzene ppm	Total Xylenes ppm	Total Lead ppm
Detection Limit		1	0.1	0.1	0.1	0.1	1
Bottom-1	10.5	ND	ND	ND	ND	ND	13
EW-1	8.5	714	0.2	ND	1.4	2.7	15
NW-1	8.5	3909	0.7	0.1	3.2	10.0	29
SW-1	8.5	842	0.4	ND	1.6	3.2	11
WW-1	8.5	709	0.3	ND	1.7	3.0	ND

ND - not detected above laboratory reporting limit

BTEX: B-Benzene, T-Toluene, E-Ethylbenzene, X-Total Xylenes
 PPM - parts per million, mg/Kg

PAINT THINNER TANK: EXCAVATION LIMIT SAMPLING

The backhoe recovered excavation limit soil samples for laboratory analysis following the removal of soil. The bottom of the excavation was at 11.5 feet below grade in gray-brown sandy clay. Plate 3, paint thinner tank source removal plan, shows the location of the final excavation limit soil samples. The final excavation limit samples were SW-2, SW-3, EW-2, EW-3, NW-2, NW-3, WW-2, WW-3, and BOTTOM-1.

A Geochem Environmental Laboratories mobile laboratory analyzed the soil samples. The laboratory analyzed the samples for total petroleum hydrocarbons (TPH) as gasoline in soils and wastes using California DOHS/LUFT Manual October 1989 (TPH); benzene, toluene, ethylbenzene, and total xylenes (BTEX) by EPA method 8020 with extraction by EPA 5030 Purge and Trap, and selected samples for total lead. The following table shows the results of the excavation limit sampling:

TABLE 3 PAINT THINNER TANK: EXCAVATION LIMIT SAMPLES

Underground Tank Site Address: 4529 Horton Street, Emeryville, CA
 Site Name: Rifkin Realty Partners
 Sample collection date: January 6, 1994
 Type of soil collected in samples: clay-silt

Sample ID	Depth Feet	Gasoline ppm	Diesel ppm	Benzene ppm	Toluene ppm	Ethyl benzene ppm	Total Xylenes ppm	Total Lead ppm
Detection Limit		1	1	0.1	0.1	0.1	0.1	1
EW-2	8.5	254	123	ND	ND	ND	ND	4
EW-3	9	25	ND	ND	ND	ND	ND	1
NW-2	11.5	ND	ND	ND	ND	ND	ND	8
NW-3	9.5	ND	ND	ND	ND	ND	ND	3
SW-2	9	56	ND	ND	ND	ND	0.1	ND
SW-3	9	259	ND	ND	ND	0.3	0.6	ND
WW-2	10.5	349	ND	ND	ND	0.5	0.6	ND
WW-3	9	2630	ND	ND	ND	2.7	5.8	ND

ND - not detected above laboratory reporting limit

BTEX: B-Benzene, T-Toluene, E-Ethylbenzene, X-Total Xylenes
 PPM - parts per million, mg/Kg

Analysis by the on site laboratory, Geochem Environmental Laboratories of San Jose, California, reported that detectable paint thinner remains on the bottom and side walls of the excavation. The majority of contaminated soil was removed during the over excavation. Mr. Barney Chan, inspector with Alameda County, gave permission to back fill the excavation when it appeared that the majority of contaminated soil had been removed.

PAINT THINNER TANK: HAND AUGURED BORINGS

On January 10, 1994, TMC recovered hand auger samples from the west wall of the paint thinner tank excavation limits. Two hand augured borings (WW-4 and WW-5) penetrated beneath the adjacent utility lines as shown on plate 3, paint thinner tank source removal plan. Two soil samples came from each boring at two and four feet from the excavation limit at depths of 7-8 feet. The following table, paint thinner tank: hand auger samples, shows the results of the soil sampling.

TABLE 4 PAINT THINNER TANK: HAND AUGER SAMPLES

Underground Tank Site Address: 4529 Horton Street, Emeryville, CA
Site Name: Rifkin Realty Partners
Sample collection date: January 10, 1994
Type of soil collected in samples: clay-silt

Sample ID	Depth Feet	Gasoline ppm	Diesel ppm	Benzene ppm	Toluene ppm	Ethyl benzene ppm	Total Xylenes ppm	Total Lead ppm
Detection Limit		1	1	0.1	0.1	0.1	0.1	1
WW4-1	7	ND	ND	ND	ND	ND	ND	ND
WW4-2	8	ND	ND	ND	ND	0.2	0.2	ND
WW5-1	7	ND	ND	ND	ND	ND	ND	ND
WW5-2	8	ND	ND	ND	ND	ND	ND	ND

ND - not detected above laboratory reporting limit

BTEX: B-Benzene, T-Toluene, E-Ethylbenzene, X-Total Xylenes

PPM - parts per million, mg/Kg

The results indicate residual paint thinner contamination remains under the adjacent utility lines. The hand augered borings indicate the extent is limited to beneath the utility lines and does not extend under the building foundation.

PAINT THINNER TANK: GRAB WATER SAMPLING

Groundwater occurred in the excavation at a depth of 10-11 feet below grade. The fresh groundwater had no sheen or floating product. On January 5, 1994, an interim grab water sample was recovered from the pit water without purging. Sample H2O Pit-1 was obtained prior to the final excavation limits. This sample indicates contaminated pit water in contact with contaminated back fill.

On January 6, 1994, H & H Ship Service pumped out the water in the excavation prior to a second round of groundwater grab sampling. Following the completion of the excavation, H & H Ship Service pumped about 1450 gallons of water from the excavation. Another grab water sample (H2OPit-2) was collected from fresh ground water entering the excavation. Geochem Environmental Laboratories of San Jose, CA analyzed the water samples. The following table shows the results of the laboratory analysis of the grab water samples:

TABLE 5 PAINT THINNER TANK: GRAB WATER SAMPLING

Underground Tank Site Address: 4529 Horton Street, Emeryville, CA
Site Name: Rifkin Realty Partners
Sample collection date: January 5-6, 1994
Type of samples: grab ground water

Sample ID	Date	Gasoline ppb	Benzene ppb	Toluene ppb	Ethyl benzene ppb	Total Xylenes ppb	Total Lead ppm
Detection Limit		50	0.5	0.5	0.5	0.5	1 ppm
H2O Pit-1	1-5-94	535	0.129	ND	1.14	2.96	ND
H2O Pit-2	1-6-94	ND	ND	ND	ND	ND	ND

ND - not detected above laboratory reporting limit

BTEX: B-Benzene, T-Toluene, E-Ethylbenzene, X-Total Xylenes

PPM - parts per million, mg/Kg

Sample H2O Pit-2 appear to represent the condition of the groundwater interface. The grab water sampling indicates no detectable groundwater concentrations of paint thinner. No sheen or floating product was observed on the fresh ground water.

HEATING OIL TANK SOURCE REMOVAL

OVER EXCAVATION OF HEATING OIL TANK PIT

Bay Area Tank Removal, Inc. over excavated contaminated soil surrounding the heating oil tank on January 10, 1994. An inspector, Mr. Barney Chan of Alameda County, and personnel from TMC Environmental, Inc. witnessed the excavation and sampling. A backhoe removed about 36 cubic yards of sandy clay-silt from the side walls and bottom of the tank pit area. During the over excavation, a Geochem mobile laboratory was on site to analyze soil samples. Plate 4, heating oil tank source removal plan, shows the location of soil samples collected during the over excavation. Heating oil concentrations up to 15,700 ppm TPH as diesel were encountered during the excavation of soil. The majority of heating oil contaminated soil was removed during the over excavation.

HEATING OIL TANK: EXCAVATION LIMIT SAMPLING

The backhoe recovered excavation limit soil samples for laboratory analysis following the removal of soil. Plate 4, heating oil tank source removal plan, shows the location of the final excavation limit soil samples. The bottom of the excavation was at 12 feet below grade in gray-brown sandy clay. The final excavation limit samples were SW-1, SW-2, EW-1, EW-2, NW-1, NW-2, WW-1, and WW-2.

A Geochem Environmental Laboratories, Inc. mobile laboratory analyzed the soil samples. The laboratory analyzed the samples for total petroleum hydrocarbons (TPH) as diesel and gasoline in soils and wastes using California DOHS/LUFT Manual October 1989 (TPH); benzene, toluene, ethylbenzene, and total xylenes (BTEX) by EPA method 8020 with extraction by EPA 5030 Purge and Trap, and selected samples for total lead. The following table shows the results of the excavation limit sampling:

TABLE 6 HEATING OIL TANK: EXCAVATION LIMIT SAMPLES

Underground Tank Site Address: 4549 Horton Street, Emeryville, CA
 Site Name: Rifkin Realty Partners
 Sample collection date: January 10, 1994
 Type of soil collected in samples: clay-silt

Sample ID	Depth Feet	Gasoline ppm	Diesel ppm	Benzene ppm	Toluene ppm	Ethyl benzene ppm	Total Xylenes ppm	Total Lead ppm
Detection Limit		1	1	0.1	0.1	0.1	0.1	1
EW-1	6	ND	11,100	ND	ND	0.4	0.5	ND
EW-2	8	ND	15,700	ND	0.3	1.4	2.6	ND
NW-1	6	ND	4,980	ND	ND	ND	0.6	ND
NW-2	8	ND	37	ND	ND	ND	ND	ND
SW-1	6	ND	12,500	ND	0.2	0.3	0.2	ND
SW-2	8	ND	437	ND	ND	ND	ND	ND
WW-1	6	ND	4,480	ND	ND	ND	0.5	ND
WW-2	8	ND	9,940	ND	ND	ND	0.4	ND

ND - not detected above laboratory reporting limit

BTEX: B-Benzene, T-Toluene, E-Ethylbenzene, X-Total Xylenes

PPM - parts per million, mg/Kg

Analysis by the on site laboratory, Geochem Environmental Laboratories of San Jose, California, reported that heating oil contaminated soil remains beneath adjacent utility lines. Mr. Barny Chan, inspector with Alameda County, gave permission to back fill the excavation when it appeared that the majority of contaminated soil had been removed.

HEATING OIL TANK: HAND AUGERED BORINGS

On January 13, 1994, TMC recovered hand auger samples from the side walls of the heating oil tank excavation limits. Seven hand augered borings (HAEW-4, HAEW-8, HANW-4, HANW-7.5, HASW-4, HASW-7.5, and HAWW-8) penetrated beneath the adjacent utility lines as shown on plate 4, heating oil tank source removal plan. Soil samples came from each boring at various depths from the excavation limit at depths of 7-9 feet. The following table, heating oil tank: hand auger samples, shows the results of the hand auger soil sampling.

TABLE 7 HEATING OIL TANK: HAND AUGER SAMPLES

Underground Tank Site Address: 4549 Horton Street, Emeryville, CA
Site Name: Rifkin Realty Partners
Sample collection date: January 13, 1994
Type of soil collected in samples: clay-silt

Sample ID	Depth Feet	Gasoline ppm	Diesel ppm	Benzene ppm	Toluene ppm	Ethyl benzene ppm	Total Xylenes ppm	Total Lead ppm
Detection Limit		1	1	0.1	0.1	0.1	0.1	1
HAEW-4	4	33	ND	1.2	2.6	0.7	3.2	20
HAEW-8	8	ND	ND	ND	ND	ND	ND	19
HANW-4	4	ND	202	ND	ND	0.1	0.1	9
HANW-7.5	7.5	ND	104	ND	ND	0.2	0.1	9
HASW-4	4	ND	ND	ND	ND	ND	ND	159
HASW-7.5	7.5	ND	ND	ND	ND	ND	ND	ND
HAWW-8	8	ND	ND	ND	ND	ND	ND	ND

ND - not detected above laboratory reporting limit

BTEX: B-Benzene, T-Toluene, E-Ethylbenzene, X-Total Xylenes

PPM - parts per million, mg/Kg

The results indicate residual heating oil contamination remains under the adjacent utility lines. The hand augered borings indicate the extent is limited to beneath the utility lines. The majority of heating oil contaminated soil was removed during the over excavation of soil.

HEATING OIL TANK: GRAB WATER SAMPLING

Groundwater occurred in the excavation at a depth of 10-11 feet below grade, then rose in the open pit to a depth of 8 feet below grade. The fresh groundwater, entering the excavation had no sheen or floating product. During the back filling of the excavation with imported fill material, a four inch diameter observation sump was installed in heating oil pit. On January 11 and 19, 1994 and February 9, 1994, H & H Ship Service pumped out 4970 gallons of pit water from the excavation and observation sump prior to groundwater grab sampling. A disposable bailer was used to collect a sample of the water entering the sump following purging. The following table shows the results of the laboratory analysis of the grab water samples:

TABLE 8 HEATING OIL TANK: GRAB WATER SAMPLING

Underground Tank Site Address: 4549 Horton Street, Emeryville, CA
Site Name: Rifkin Realty Partners
Sample collection date: January-February, 1994
Type of samples: grab groundwater

Sample ID	Date	Diesel ppb	Gasoline ppb	Benzene ppb	Toluene ppb	Ethyl benzene ppb	Total Xylenes ppb
Detection Limit		50	50	0.5	0.5	0.5	0.5
OB-1-1	1-11-94	ND	ND	ND	ND	ND	ND
OB-1-2	1-19-94	ND	ND	ND	ND	ND	ND
OB-1A	2-09-94	ND		ND	ND	ND	ND
OB-1B	2-09-94	ND		ND	ND	ND	ND

ND - not detected above laboratory reporting limit

BTEX: B-Benzene, T-Toluene, E-Ethylbenzene, X-Total Xylenes

PPM - parts per million, mg/Kg

These grab water samples appear to represent the condition of the ground water surrounding the tank pit. The grab water sampling indicates no detectable groundwater concentrations of heating oil. No sheen or floating product was observed on the fresh ground water.

DISPOSAL OF CONTAMINATED WASTE

During the over excavation of the tank pits, 5220 gallons of petroleum contaminated pit water was pumped from the tank pit excavations by H & H Ship Service of San Francisco, California. About 72 cubic yards of excavated soil was transported by Den Beste Trucking Company to the Browning Ferris Industries (BFI) Landfill in Livermore, California for disposal. About 36 cubic yards of excavated soil was transported by Manley & Sons Trucking company to the Forward Inc. Landfill in Manteca, California for treatment and recycling. Attachment 4, waste manifests, contains the disposal documentation. The previous tank removal report contains the documentation for the tank removal and disposal of overburden soil.

LIMITATIONS

The procedures and opinions in this document agree with professional practice as provided guidelines of the California Regional Water Quality Control Board for addressing fuel leaks from underground tanks. This document is only part of the ongoing work required by the lead implementing agency at this site. The lab test results rely on limited data collected at the sampling location only. Budget constraints restrict the amount of testing allowed. The lab test results do not apply to the general site as a whole. Therefore, TMC cannot have complete knowledge of the underlying conditions at the conclusion of the work specified in the work plan. The professional opinion and judgment in the document is subject to revisions in light of new information. We do not state or imply any guarantees or warranties that the subject property is or is not free of environmental impairment.

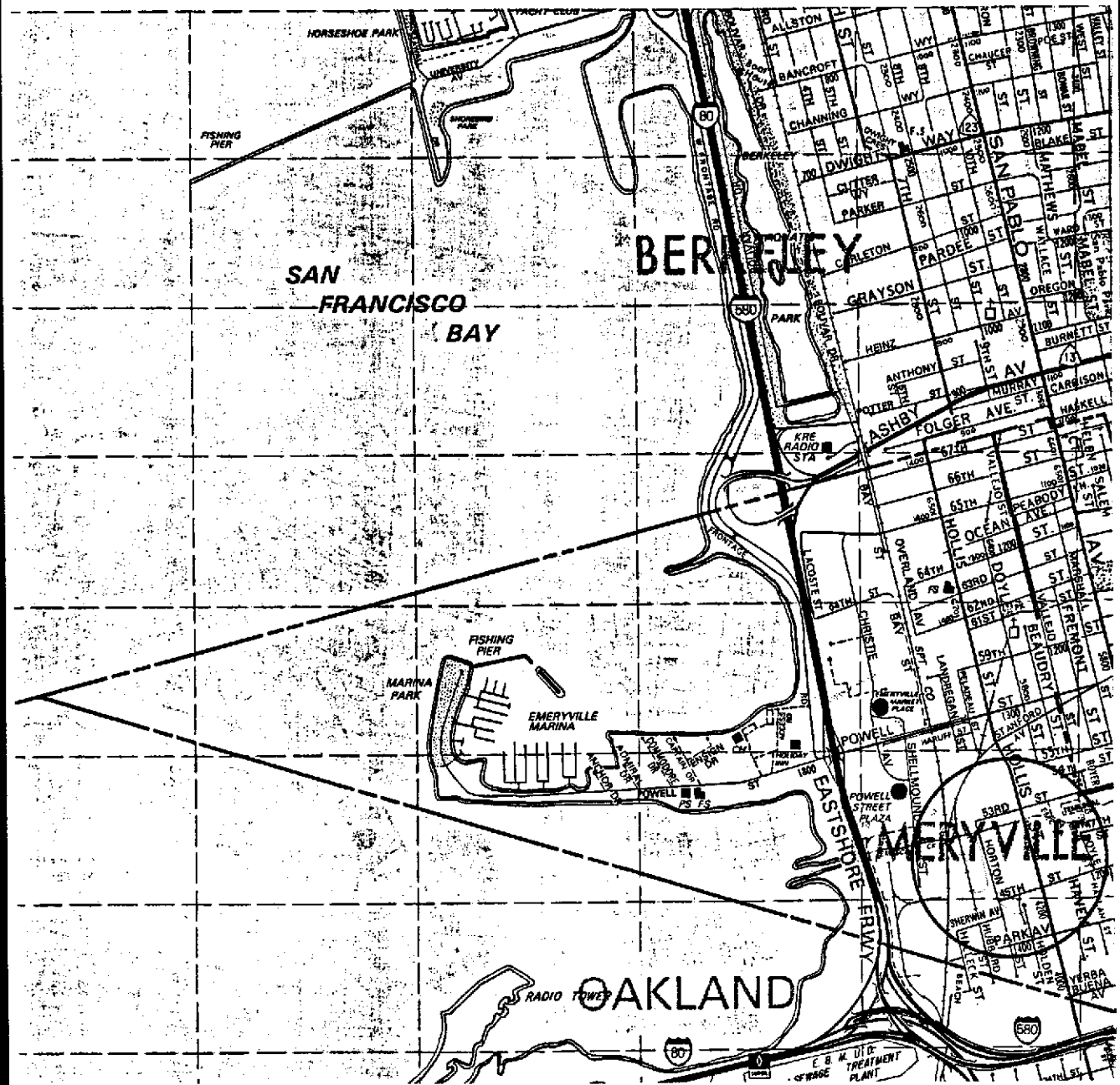

Base map from Thomas brothers Map Company, Alameda County, 1992



SITE VICINITY MAP

Tank Removal Report
 4525-4563 Horton Street
 Emeryville, California

Project No. 1-13093 February 1993

PLATE

1

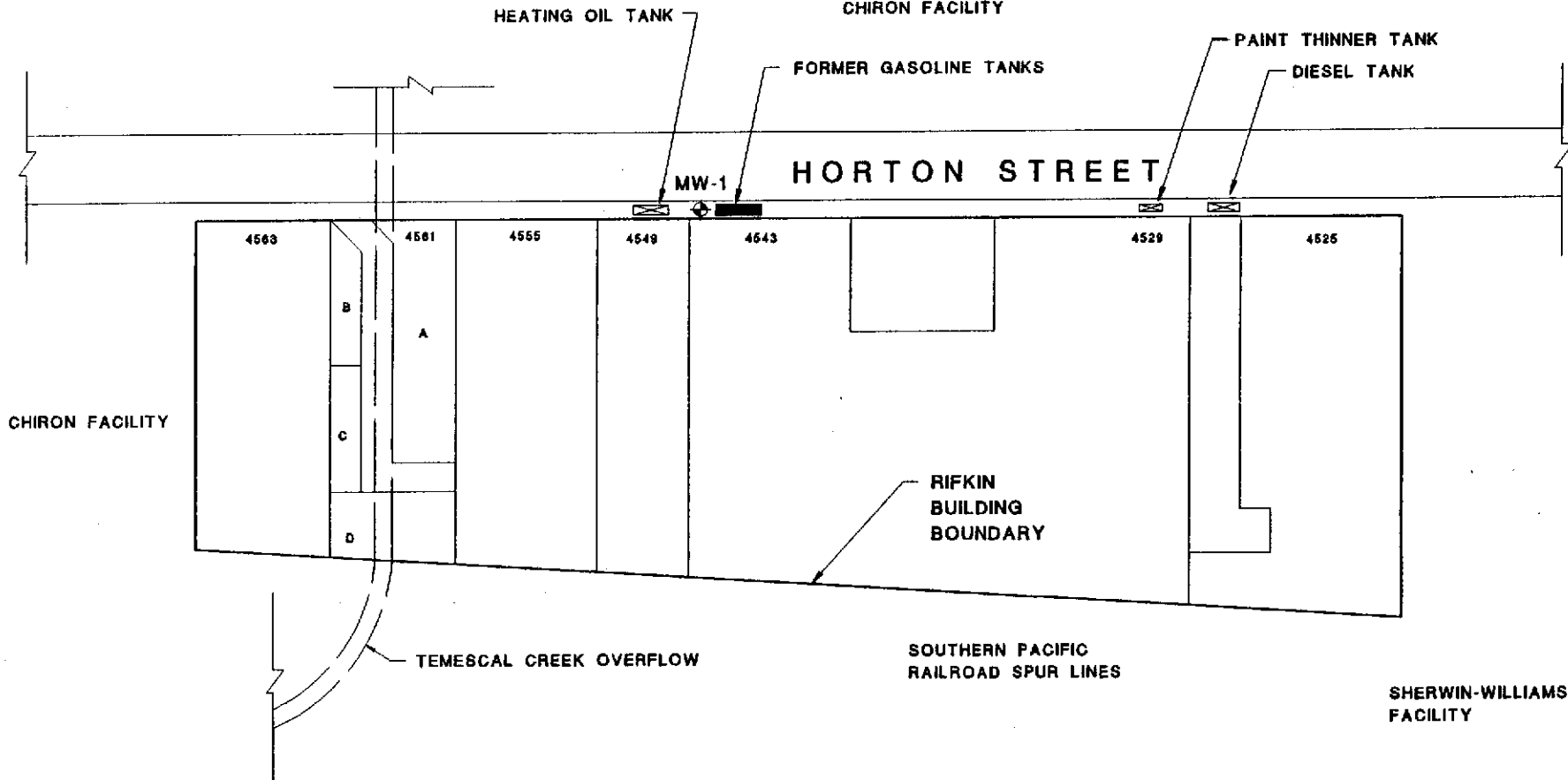

NORTH ARROW





APPROXIMATE

SCALE IN FEET



APPROXIMATE

EXPLANATION OF MAP SYMBOLS

-  MONITORING WELL MW-1
-  UNDERGROUND TANKS REMOVED IN 1993
-  FORMER GASOLINE TANKS REMOVED IN 1988



TMC ENVIRONMENTAL, INC.

13908 SAN PABLO AVENUE, SUITE 101
 SAN PABLO, CALIFORNIA 94806
 510-232-8366 FAX 510-232-5133

SITE MAP

RIFKIN PROPERTY
 EMERYVILLE, CALIFORNIA

DATE OF DRAWING: FEBRUARY, 1994 JOB NO. 113093

PLATE

2

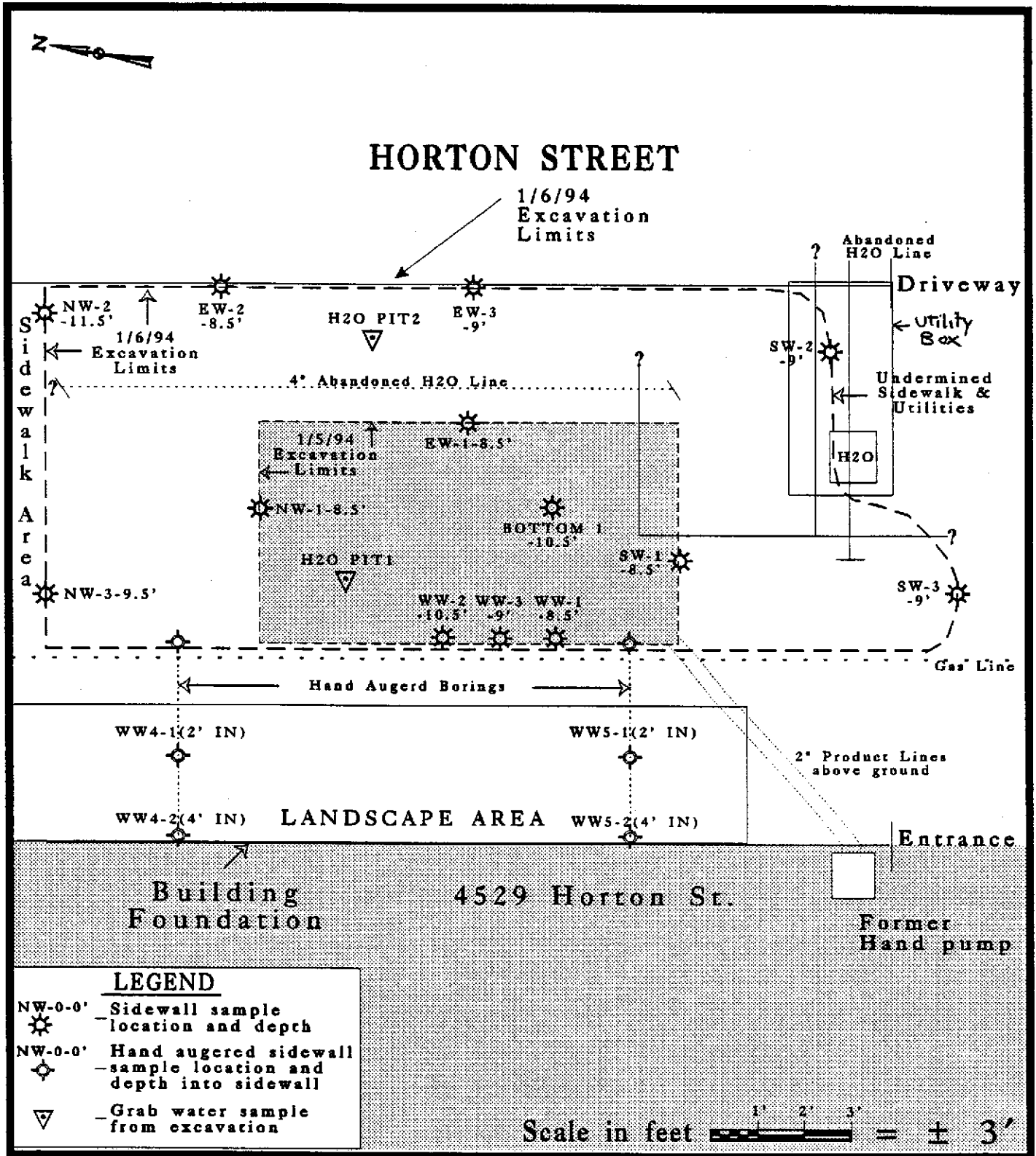

<p>PAINT THINNER TANK SOURCE REMOVAL PLAN</p> <p>Rifkin Property 4529 Horton Street Emeryville, CA</p> <p>Project No. 1-13093 February 1994</p>	<p>PLATE</p> <p style="font-size: 2em; font-family: cursive;">3</p>
---	--



HORTON STREET

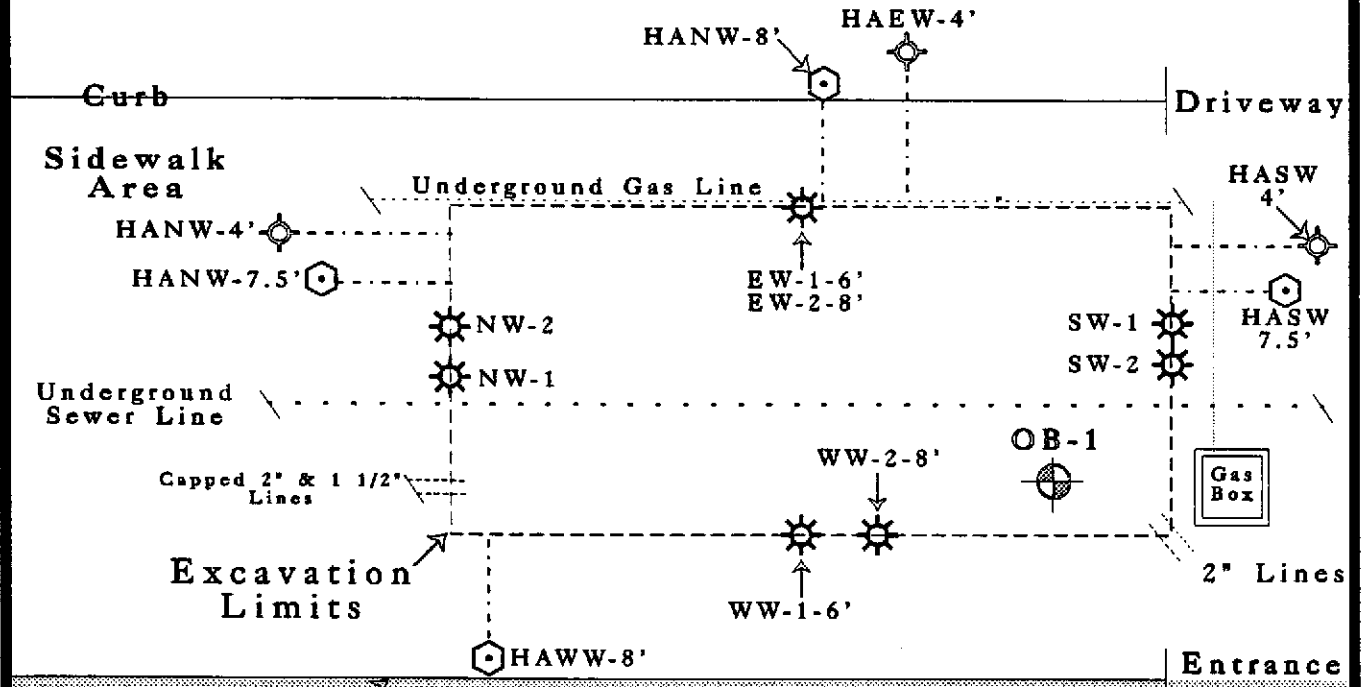

LEGEND

- OB-1 - 2" Observation Well
- NW-0-0' - Sidewall sample location and depth
- HANW-0' - Hand augered sidewall - sample location and depth 90° into sidewall
- HANW-0' - Hand augered sidewall - sample location and depth 45° into sidewall

Scale in feet = ± 4'



HEATING OIL TANK SOURCE REMOVAL PLAN

Rifkin Property
4549 Horton Street
Emeryville, CA

Project No. 1-13093 February 1994

PLATE

4

FOLD OUT DIAGRAM OF EXCAVATION SIDEWALLS

EXCAVATION DATE JANUARY 6, 1994

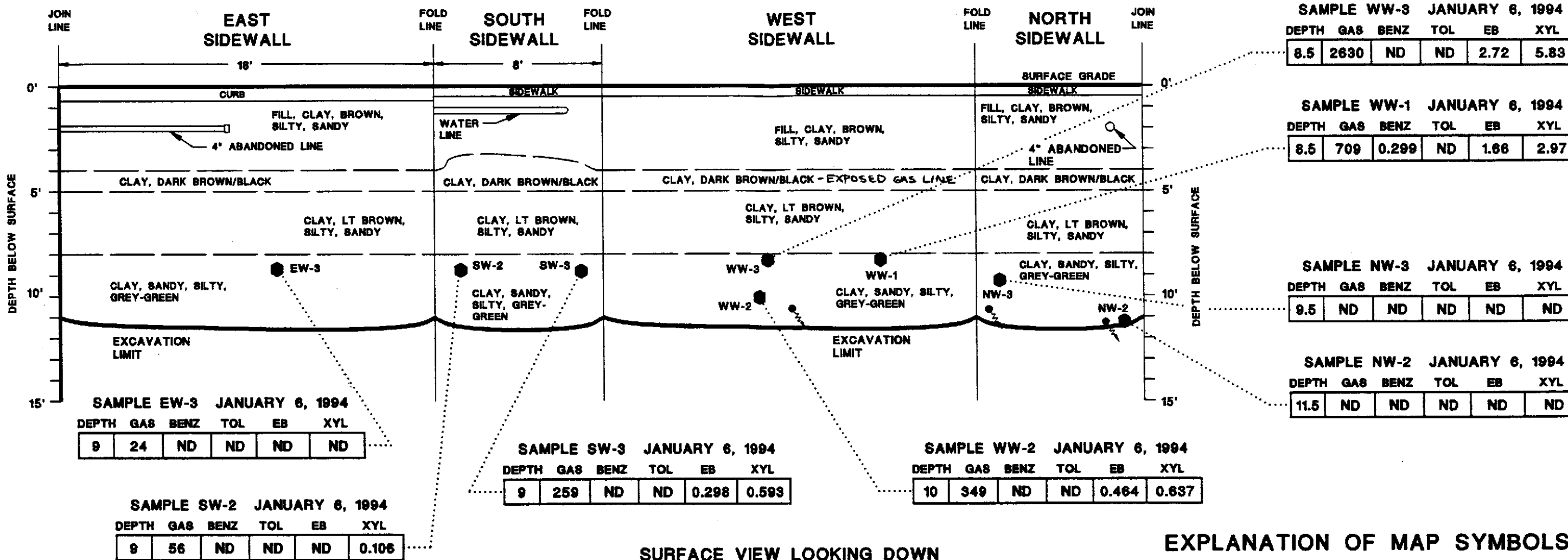

SURFACE VIEW LOOKING DOWN AT BOTTOM OF EXCAVATION

EAST SIDEWALL

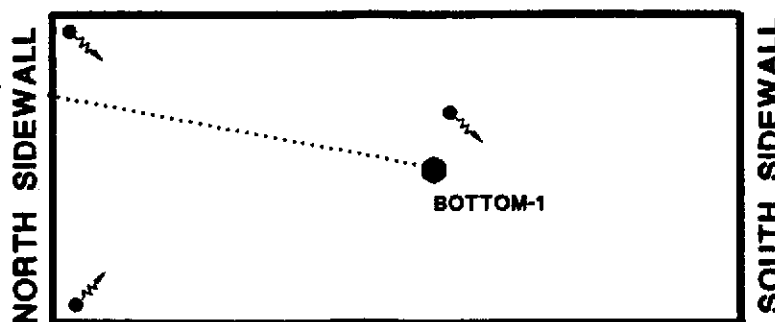

EXPLANATION OF MAP SYMBOLS

SOIL SAMPLE CHEMICAL ANALYSIS RESULTS IN MG/KG (PPM)

SAMPLE LABEL AND SAMPLE DATE

DEPTH IN FEET	TPH GAS	BENZENE	TOLUENE	ETHYL BENZENE	TOTAL XYLENES
BOT-10					

ND = NOT DETECTABLE AT OR ABOVE REPORTING LIMIT
 NA = NO LABORATORY ANALYSIS OF SOIL SAMPLE
 NL = NOT LISTED IN REPORTS

- EXCAVATION LIMIT SOIL SAMPLE WITH LABORATORY RESULTS
- - - CONTACT BETWEEN SOIL, ROCK, OR FILL MATERIALS
- ⚡ MAIN SEEPAGE POINTS FOR GROUNDWATER RECHARGE

NOTES AND LIMITATIONS

THE TABLES AND SUMMARIES OF CHEMICAL DATA PROVIDE A QUICK REFERENCE TO THE MORE COMPLETE INFORMATION IN THE TECHNICAL REPORTS AND CERTIFIED LABORATORY REPORTS.

THIS DIAGRAM WAS NOT SURVEYED OR DRAWN BY A STATE LICENSED SURVEYOR. THE PROPERTY AND OTHER BOUNDARIES THAT MAY BE SHOWN CAN NOT BE USED FOR CONSTRUCTION OR CONSTRUCTION DESIGN.

HORZ SCALE - VERT SCALE

SCALE IN FEET

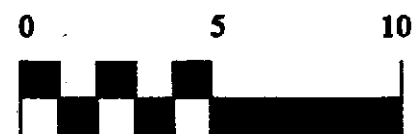

APPROXIMATE



TMC ENVIRONMENTAL, INC.

13908 SAN PABLO AVENUE, SUITE 101
 SAN PABLO, CALIFORNIA 94806
 510-232-8366 FAX 510-232-5133

EXCAVATION LIMIT DIAGRAM
 WITH SAMPLE LOCATIONS

PAINT THINNER TANK REMOVAL
 4529 HORTON ST.
 EMERYVILLE, CA

DATE OF DRAWING: JANUARY 30, 1994 JOB NO. 1-13093

PLATE

5

FOLD OUT DIAGRAM OF EXCAVATION SIDEWALLS
EXCAVATION DATE JANUARY 10, 1994

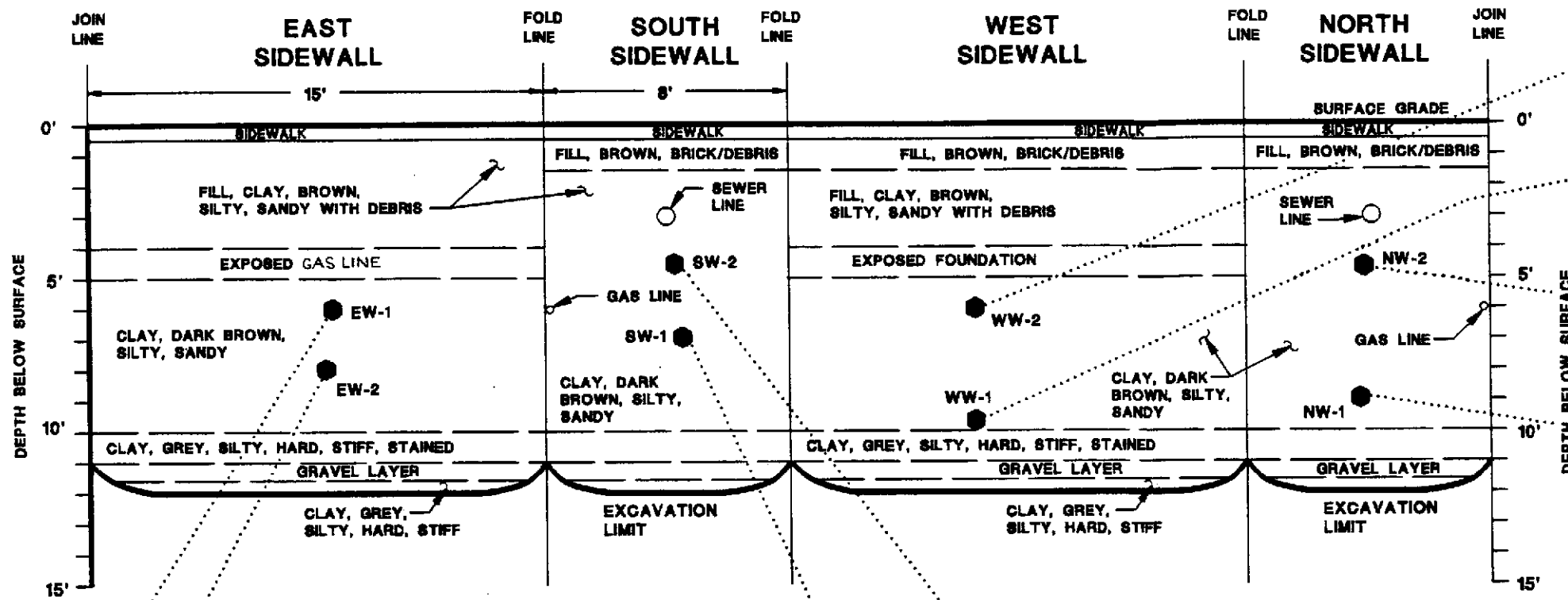

SAMPLE WW-2 JANUARY 10, 1994

DEPTH	GAS	DE	LEAD	BENZ	TOL	EB	XYL
6	ND	9490	ND	ND	ND	ND	0.35

SAMPLE WW-1 JANUARY 10, 1994

DEPTH	GAS	DE	LEAD	BENZ	TOL	EB	XYL
10.5	ND	4480	ND	ND	ND	ND	0.506

SAMPLE NW-2 JANUARY 10, 1994

DEPTH	GAS	DE	LEAD	BENZ	TOL	EB	XYL
6	ND	36.5	ND	ND	ND	ND	ND

SAMPLE NW-1 JANUARY 10, 1994

DEPTH	GAS	DE	LEAD	BENZ	TOL	EB	XYL
9	ND	4977	ND	ND	ND	ND	0.572

SAMPLE EW-2 JANUARY 10, 1994

DEPTH	GAS	DE	LEAD	BENZ	TOL	EB	XYL
6	ND	15700	ND	ND	0.302	1.4	2.57

SAMPLE SW-2 JANUARY 10, 1994

DEPTH	GAS	DE	LEAD	BENZ	TOL	EB	XYL
4.5	ND	437	ND	ND	ND	ND	ND

SAMPLE EW-1 JANUARY 10, 1994

DEPTH	GAS	DE	LEAD	BENZ	TOL	EB	XYL
6	ND	11100	ND	ND	ND	0.43	0.51

SAMPLE SW-1 JANUARY 10, 1994

DEPTH	GAS	DE	LEAD	BENZ	TOL	EB	XYL
7	ND	12544	ND	ND	0.163	0.331	0.161

EXPLANATION OF MAP SYMBOLS

- SOIL SAMPLE CHEMICAL ANALYSIS RESULTS IN MG/KG (PPM)
- SAMPLE LABEL AND SAMPLE DATE
- | DEPTH IN FEET | GAS | TPH | TPH | TOTAL LEAD | BENZENE | TOLUENE | ETHYL BENZENE | TOTAL XYLENES |
|---------------|-----|-----|-----|------------|---------|---------|---------------|---------------|
| NW-1 | | | | | | | | |
- ND - NOT DETECTABLE AT OR ABOVE REPORTING LIMIT
 - NA - NO LABORATORY ANALYSIS OF SOIL SAMPLE
 - NL - NOT LISTED IN REPORTS
 - - EXCAVATION LIMIT SOIL SAMPLE WITH LABORATORY RESULTS
 - - - - CONTACT BETWEEN SOIL, ROCK, OR FILL MATERIALS
 - ⊕ - OBSERVATION WELL

NOTES AND LIMITATIONS

THE TABLES AND SUMMARIES OF CHEMICAL DATA PROVIDE A QUICK REFERENCE TO THE MORE COMPLETE INFORMATION IN THE TECHNICAL REPORTS AND CERTIFIED LABORATORY REPORTS.

THIS DIAGRAM WAS NOT SURVEYED OR DRAWN BY A STATE LICENSED SURVEYOR. THE PROPERTY AND OTHER BOUNDARIES THAT MAY BE SHOWN CAN NOT BE USED FOR CONSTRUCTION OR CONSTRUCTION DESIGN.

SURFACE VIEW
LOOKING DOWN
AT BOTTOM OF
EXCAVATION

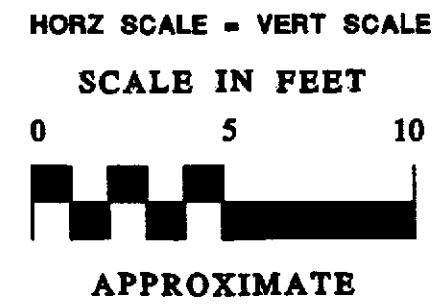
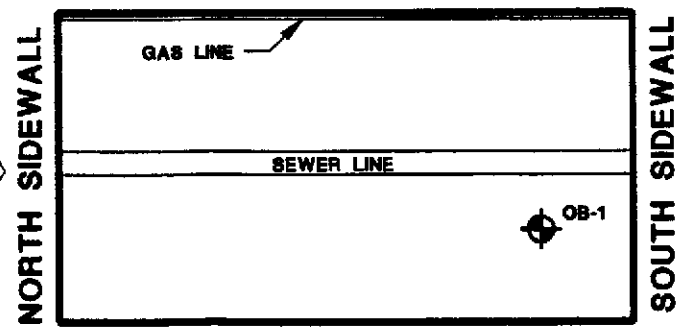

TMC ENVIRONMENTAL, INC.

13908 SAN PABLO AVENUE, SUITE 101
SAN PABLO, CALIFORNIA 94806
510-232-8366 FAX 510-232-5133

**EXCAVATION LIMIT DIAGRAM
WITH SAMPLE LOCATIONS**

**HEATING OIL TANK REMOVAL
4549 HORTON ST.
EMERYVILLE, CA**

DATE OF DRAWING: JANUARY 30, 1994 JOB NO. 1-13093

PLATE
6

**ATTACHMENT 1
PAINT THINNER TANK EXCAVATION
ANALYTICAL LABORATORY REPORTS
CHAIN-OF-CUSTODY FORMS**



Geochem ENVIRONMENTAL LABORATORIES

Mobile & In-House Laboratories Certified by State of California

Phone: (408) 955-9988 / FAX: (408) 955-9538

ANALYTICAL REPORT

Page: 1 of 1

Client: TMC Environmental	Date Sampled: 01/05/94
13908 San Pablo Ave., Ste.101	Date Received: 01/05/94
San Pablo, CA, CA 94107	Date Analyzed: 01/05/94
Attn: Mark Youngkin	Batch:SA-322 Matrix: Soil
	Conc. Unit mg/kg (ppm)

Project: 4529 Horton St.

"ND" means "not detected" at indicated detection limit.
 B:benzene, T:toluene, E:ethylbenzene & X:total xylenes.
 Samples received at job-site with a chain of custody record.

SAMPLE I.D.	Total	8015M/TPH	8020
	Lead	Gasoline	B / T / E / X
	1 ppm	1 ppm	0.1 ppm
EW-1	15	714	0.2/ ND / 1.4/ 2.7
NW-1	29	3909	0.7/ 0.1/ 3.2/ 10.0
SW-1	11	842	0.4/ ND / 1.6/ 3.2
WW-1	ND	709	0.3/ ND / 1.7/ 3.0
BOTTOM-1	13	ND	ND / ND / ND / ND

Reviewed and approved by George Tsai, Jan. 12, 1994
 George Tsai, Laboratory Director



Geochem ENVIRONMENTAL LABORATORIES

Mobile & In-House Laboratories Certified by State of California

Phone: (408) 955-9988 / FAX: (408) 955-9538

ANALYTICAL REPORT

Page: 1 of 1

Client: TMC Environmental Date Sampled: 01/05/94
13908 San Pablo Ave., Ste.101 Date Received: 01/05/94
San Pablo, CA, CA 94107 Date Analyzed: 01/05/94
Attn: Mark Youngkin Batch: SA-322 Matrix: Water
 Conc. Unit ug/L (ppb)

Project: 4529 Horton St. (T.Lead Conc.Unit mg/kg(ppm))

"ND" means "not detected" at indicated detection limit.

B:benzene, T:toluene, E:ethylbenzene & X:total xylenes.

Samples received at job-site with a chain of custody record.

SAMPLE I.D.	Total	8015M/TPH	602						
	Lead	Gasoline	B	T	E	X			

DETECTION									
LIMIT	1 ppm	50 ppb			0.5 ppb				

PIT-1	ND	535000	129	/	ND	/	1140	/	2960

Reviewed and approved by George Tsai, Laboratory Director, JAN. 12, 1994

TESTS REQUIRED

SAMPLE I.D.	LOCATION DESCRIPTION	DATE	TIME	MATRIX			NO. OF CTNR	418.1/TRPH	8010 (601)	8015 E/TPH-diesel	8015 M/TPH-gasoline	8020 (602) BTEX	7420/Total Lead	Organic Lead			Archive
				AIR	WATER	SOIL											
SW-1		01/05/93				X	1	OK			X	X	X				
EW-1						X	1	OK			X	X	X				
WW-1						X	1	OK			X	X	X				
Bottom-1						X	1	OK			X	X	X				
PIT-1	H ₂ O				X		1	OK			X	X	X				

Sampled/Relinquished by: <i>Anthony Cappella</i>	Received by: <i>2.7. Monroe</i>	Date <u>01/05/93</u>	Time
Relinquished by:	Received by:	Date	Time
Relinquished by:	Received by:	Date	Time
Turnaround time: 24 hr. 48 hr. Normal (3-5 days)	Special Instructions:		



Geochem ENVIRONMENTAL LABORATORIES

Mobile & In-House Laboratories Certified by State of California

Phone: (408) 955-9988 / FAX: (408) 955-9538

ANALYTICAL REPORT

Page: 1 of 1

Client: TMC Environmental
13908 San Pablo Ave., Ste.101
San Pablo, CA, CA 94107
Attn: Mark Youngkin

Date Sampled: 01/06/94
Date Received: 01/06/94
Date Analyzed: 01/06/94
Batch: SA-324 Matrix: Soil
Conc. Unit mg/kg (ppm)

Project: 4529 Horton St.

"ND" means "not detected" at indicated detection limit.

B:benzene, T:toluene, E:ethylbenzene & X:total xylenes.

Samples received at job-site with a chain of custody record.

SAMPLE I.D.	Total Lead	8015M/TPH Diesel	8015M/TPH Gasoline	8020 B / T / E / X
	1 ppm	1 ppm	1 ppm	0.1 ppm
EW-2	4	123	254	ND / ND / ND / ND
EW-3	1	ND	25	ND / ND / ND / ND
NW-2	8	ND	ND	ND / ND / ND / ND
NW-3	3	ND	ND	ND / ND / ND / ND
SW-2	ND	ND	56	ND / ND / ND / 0.1
SW-3	ND	ND	259	ND / ND / 0.3 / 0.6
WW-2	ND	ND	349	ND / ND / 0.5 / 0.6
WW-3	ND	ND	2630	ND / ND / 2.7 / 5.8
SP 1-4 (Comp)	3		85	ND / ND / ND / 0.2

Reviewed and approved by

George Tsai, Jan. 07, 1994
George Tsai, Laboratory Director



Geochem ENVIRONMENTAL LABORATORIES

Mobile & In-House Laboratories Certified by State of California

Phone: (408) 955-9988 / FAX: (408) 955-9538

ANALYTICAL REPORT

Page: 1 of 1

Client: TMC Environmental
13908 San Pablo Ave., Ste.101
San Pablo, CA, CA 94107
Attn: Mark Youngkin

Date Sampled: 01/06/94
Date Received: 01/06/94
Date Analyzed: 01/06/94
Batch:SA-324 Matrix:Water
Conc. Unit ug/L (ppb)

Project: 4529 Horton St.

"ND" means "not detected" at indicated detection limit.

B:benzene, T:toluene, E:ethylbenzene & X:total xylenes.

Samples received at job-site with a chain of custody record.

SAMPLE I.D.	Total Lead	8015M/TPH	8015M/TPH	602			
		Diesel	Gasoline	B	T	E	X
<hr/>							
DETECTION							
LIMIT	1 ppm	50 ppb	50 ppb	0.5 ppb			
<hr/>							
PIT-2	ND	ND	ND	ND / ND / ND / ND			

Reviewed and approved by George Tsai, JAN. 07, 1994
George Tsai, Laboratory Director

780 Montague Expressway, Suite 404, San Jose, CA 95131

TESTS REQUIRED

CLIENT <u>TMC ENVIRONMENTAL</u>		PROJECT NAME <u>HORTON STREET</u>	
ADDRESS <u>13708 SAN PABLO AVE #109</u> <u>SAN PABLO, CA. 94806</u>		PROJECT MANAGER <u>MARK YOUNGKIN</u>	
		PHONE NUMBER	

SAMPLE I.D.	LOCATION DESCRIPTION	DATE	TIME	MATRIX			NO. OF CTNR	418.1/TRPH	8010 (601)	8015 E/TPH-diesel	8015 M/TPH-gasoline	8020 (602) BTEX	7420/Total Lead	Organic Lead			Archive
				AIR	WATER	SOIL											
EW-2		1/6				X	1	---	---	X	X	X	X				
NW-2		1/6	10:42			X	1	---	---	X	X	X	X				
NW-3		1/6	10:50			X	1	---	---	X	X	X	X				
H ₂ O P/T 2		1/6	11:27		X		2	---	---	X	X	X	X				
EW-3		1/6	11:40			X	1	---		X	X	X	X				
P-1-4)	COMPOSITE	1/6	1:15			X	4	---			X	X	X				
WW-2		1/6	1:40			X	1	---		X	X	X	X				
WW-3		1/6	1:45			X	1	---		X	X	X	X				

Sampled/Relinquished by: <u>[Signature]</u>	Received by: <u>[Signature]</u>	Date <u>1/6/94</u>	Time
Relinquished by:	Received by: <u>[Signature]</u>	Date	Time
Relinquished by:	Received by:	Date	Time

Turnaround time: 24 hr. 48 hr. Normal (3-5 days)

Special Instructions:



Geochem ENVIRONMENTAL LABORATORIES

Mobile & In-House Laboratories Certified by State of California

Phone: (408) 955-9988 / FAX: (408) 955-9538

ANALYTICAL REPORT

Page: 1 of 1

 Client: TMC Environmental Date Sampled: 01/10/94
 13908 San Pablo Ave., Ste.101 Date Received: 01/10/94
 San Pablo, CA, CA 94107 Date Analyzed: 01/10/94
 Attn: Marc Edwards Batch: SA-325 Matrix: Soil
 Conc. Unit mg/kg (ppm)

Project: 4529 Horton St.

 "ND" means "not detected" at indicated detection limit.
 B:benzene, T:toluene, E:ethylbenzene & X:total xylenes.
 Samples received at job-site with a chain of custody record.

SAMPLE I.D.	Total	8015M/TPH	8015M/TPH	8020
	Lead	Diesel	Gasoline	B / T / E / X
DETECTION LIMIT				
	1 ppm	1 ppm	1 ppm	0.1 ppm
WW4-1-4'	ND	ND	ND	ND / ND / ND / ND
WW4-2-6'	ND	ND	380	ND / ND / 0.2 / 0.2
WW5-1-4'	ND	ND	ND	ND / ND / ND / ND
WW5-2-6'	ND	ND	ND	ND / ND / ND / ND

Reviewed and approved by

George Tsai, Jan. 17, 1994
 George Tsai, Laboratory Director



Geochem ENVIRONMENTAL LABORATORIES

Mobile & In-House Laboratories Certified by State of California

Phone: (408) 955-9988 / FAX: (408) 955-9538

ANALYTICAL REPORT

Page: 1 of 1

Client: TMC Environmental
13908 San Pablo Ave., Ste.101
San Pablo, CA, CA 94107
Attn: Marc Edwards

Date Sampled: 01/10/94
Date Received: 01/10/94
Date Analyzed: 01/10/94
Batch:SA-325 Matrix: Soil
Conc. Unit mg/kg (ppm)

Project: 4529 Horton St.

"ND" means "not detected" at indicated detection limit.

B:benzene, T:toluene, E:ethylbenzene & X:total xylenes.

Samples received at job-site with a chain of custody record.

EPA
SAMPLE I.D. 418.1

DETECTION
LIMIT 1 ppm

WW4-1-4'	55
WW4-2-6'	51
WW5-1-4'	42
WW5-2-6'	53

Reviewed and approved by

George Tsai, Jan. 17, 1994
George Tsai, Laboratory Director

ATTACHMENT 2
HEATING OIL TANK EXCAVATION
ANALYTICAL LABORATORY REPORTS
CHAIN-OF-CUSTODY FORMS



Geochem ENVIRONMENTAL LABORATORIES

H.O

Mobile & In-House Laboratories Certified by State of California

Phone: (408) 955-9988 / FAX: (408) 955-9538

ANALYTICAL REPORT

Page: 1 of 1

Client: TMC Environmental
 13908 San Pablo Ave., Ste.101
 San Pablo, CA, CA 94107
 Attn: Mark Youngkin

Date Sampled: 01/10/94
 Date Received: 01/10/94
 Date Analyzed: 01/10/94
 Batch:SA-326 Matrix: Soil
 Conc. Unit mg/kg (ppm)

Project: Horton St. (Proj.#1-13094)

"ND" means "not detected" at indicated detection limit.

B:benzene, T:toluene, E:ethylbenzene & X:total xylenes.

Samples received at job-site with a chain of custody record.

SAMPLE I.D.	Total Lead	8015M/TPH Diesel	8015M/TPH Gasoline	8020 B / T / E / X
	1 ppm	1 ppm	1 ppm	0.1 ppm
EXC-2 Random	ND	1130	ND	ND / ND / ND / 0.4
EXC-2 EW-1	ND	11100	ND	ND / ND / 0.4/ 0.5
EXC-2 EW-2	ND	15700	ND	ND / 0.3/ 1.4/ 2.6
EXC-2 NW-1	ND	4980	ND	ND / ND / ND / 0.6
EXC-2 NW-2	ND	37	ND	ND / ND / ND / ND
EXC-2 SW-1	ND	12500	ND	ND / 0.2/ 0.3/ 0.2
EXC-2 SW-2	ND	437	ND	ND / ND / ND / ND
EXC-2 WW-1	ND	4480	ND	ND / ND / ND / 0.5
EXC-2 WW-2	ND	9490	ND	ND / ND / ND / 0.4
EXC-2 SP(comp)		6240	ND	ND / ND / 0.2/ 0.4

Reviewed and approved by

George Tsai, JAN. 17, 1994
 George Tsai, Laboratory Director



Geochem ENVIRONMENTAL LABORATORIES

Mobile & In-House Laboratories Certified by State of California

Phone: (408) 955-9988 / FAX: (408) 955-9538

ANALYTICAL REPORT

Page: 1 of 1

Client: TMC Environmental	Date Sampled: 01/10/94
13908 San Pablo Ave., Ste.101	Date Received: 01/10/94
San Pablo, CA, CA 94107	Date Analyzed: 01/10/94
Attn: Mark Youngkin	Batch:SA-326 Matrix: Soil
	Conc. Unit mg/kg (ppm)

Project: Horton St. (Proj.#1-13094)

"ND" means "not detected" at indicated detection limit.

B:benzene, T:toluene, E:ethylbenzene & X:total xylenes.

Samples received at job-site with a chain of custody record.

	EPA
SAMPLE I.D.	418.1

DETECTION	
LIMIT	1 ppm

EXC-2 Random	4240
EXC-2 EW-1	14400
EXC-2 EW-2	13200
EXC-2 NW-1	8630
EXC-2 NW-2	87
EXC-2 SW-1	116000
EXC-2 SW-2	48
EXC-2 WW-1	3730
EXC-2 WW-2	11000
EXC-2 SP(comp)	1720

Reviewed and approved by



George Tsai JAN. 17, 1994
 George Tsai, Laboratory Director

76R # 510 110 6025

TESTS REQUIRED

CLIENT TMC		PROJECT NAME HORTON (#1-13094)		418.1/TRPH	8010 (601)	8015 E/TPH-diesel	8015 M/TPH-gasoline	8020 (602) BTEX	7420/Total Lead	Organic Lead				Archive
ADDRESS		PROJECT MANAGER MARK YOUNGKIN												
		PHONE NUMBER												

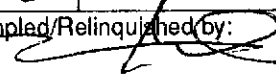
SAMPLE I.D.	LOCATION DESCRIPTION	DATE	TIME	MATRIX			NO. OF CTNR	418.1/TRPH	8010 (601)	8015 E/TPH-diesel	8015 M/TPH-gasoline	8020 (602) BTEX	7420/Total Lead	Organic Lead			Archive	
				AIR	WATER	SOIL												
Exc-2 Random	Excavation 2 - Random Pile	1/10/94				X	1	X		X	X	X	X					
WW-1	Exc. 2 - WW1 - 10.5'	1/10/94	1:30			X	1	X		X	X	X	X					
NW-1	Exc. 2 NW-1 - 9'	1/10	1:50			X	1	X		X	X	X	X					
NW-2	Exc. 2 NW-2 - 5'3"	1/10	1:55			X	1	X		X	X	X	X					
SW-1	Exc. 2 SW-1 - 8'	1/10	2:00			X	1	X		X	X	X	X					
SW-2	Exc. 2 SW-2 - 4.5'	1/10	2:05			X	1	X		X	X	X	X					
SP(1-2) Comp.	Stackpile Composite	1/10	3:40			X	2			X		X						
WW-2	Exc. 2 - WW2 - 6'	1/10	4:00			X	1	X		X	X	X	X					
EW-1	Exc. 2 EW-1 - 6'	1/10	4:05			X	1	X		X	X	X	X					
EW-2	Exc. 2 EW-2 - 8'	1/10	4:08			X	1	X		X	X	X	X					

Sampled/Relinquished by: 	Received by: 	Date: <u>1/10/94</u>	Time:
Relinquished by:	Received by:	Date:	Time:
Relinquished by:	Received by:	Date:	Time:

Turnaround time: 24 hr. 48 hr. Normal (3-5 days) Special Instructions:



Geochem ENVIRONMENTAL LABORATORIES

Mobile & In-House Laboratories Certified by State of California

Phone: (408) 955-9988 / FAX: (408) 955-9538

ANALYTICAL REPORT

Page: 1 of 1

Client: TMC Environmental	Date Sampled: 01/17/94
13908 San Pablo Ave., Ste.101	Date Received: 01/17/94
San Pablo, CA 94107	Date Analyzed: 01/19/94
Attn: Marc Edwards	Batch:SA-331 Matrix: Soil
	Conc. Unit mg/kg (ppm)

Project: 4525-4549 Horton St. (Proj.#1-13093)

"ND" means "not detected" at indicated detection limit.

B:benzene, T:toluene, E:ethylbenzene & X:total xylenes.

Samples received at job-site with a chain of custody record.

	TRPH
SAMPLE I.D.	418.1

DETECTION	
LIMIT	1 ppm

HAEW-4'	8
HAEW-8'	6
HANW-4'	1300
HANW-7.5'	901
HASW-4'	33
HASW-7.5'	6
HAWW-8'	22

Reviewed and approved by

George Tsai, Jan. 25, 1994
 George Tsai, Laboratory Director



Geochem ENVIRONMENTAL LABORATORIES

Mobile & In-House Laboratories Certified by State of California

Phone: (714) 222-1020 / FAX: (714) 222-0709

ANALYTICAL REPORT

Page: 1 of 1

 Client: TMC Environmental Date Sampled: 01/17/94
 13908 San Pablo Ave., Ste.101 Date Received: 01/17/94
 San Pablo, CA, CA 94107 Date Analyzed: 01/19/94
 Attn: Marc Edwards Batch: SA-331 Matrix: Soil
 Conc. Unit mg/kg (ppm)

Project: 4525-4549 Horton St. (Proj.#1-13093)

"ND" means "not detected" at indicated detection limit.

B:benzene, T:toluene, E:ethylbenzene & X:total xylenes.

Samples received at job-site with a chain of custody record.

SAMPLE I.D.	Total	8015M/TPH	8015M/TPH	8020
	Lead	Diesel	Gasoline	B / T / E / X
<hr/>				
DETECTION				
LIMIT	1 ppm	1 ppm	1 ppm	0.1 ppm
<hr/>				
HAEW-4'	20	ND	33	1.2/ 2.6/ 0.7/ 3.2
HAEW-8'	19	ND	ND	ND / ND / ND / ND
HANW-4'	9	202	ND	ND / ND / 0.1/ 0.1
HANW-7.5'	9	104	ND	ND / ND / 0.2/ 0.1
HASW-4'	159	ND	ND	ND / ND / ND / ND
HASW-7.5'	ND	ND	ND	ND / ND / ND / ND
HAWW-8'	ND	ND	ND	ND / ND / ND / ND

Reviewed and approved by George Tsai, Jan. 25, 1994
 George Tsai, Laboratory Director

ADDITIONAL REQUESTS:

CHAIN OF CUSTODY RECORD ANALYSIS REQUEST FORM FOR ENVIRONMENTAL SAMPLING

JOB # 1-13093	JOB ADDRESS: Emeryville 4525-4549 HORTON ST.	SAMPLER: TOM GHIGLIOTTO
LABORATORY NAME: GEOCHEM ENVIRONMENTAL LABORATORIES, SAN JOSE, CA 95131		

LAB ID NO.	SAMPLE NUMBER	SOIL	WATER	DATE	TIME	TVH-GAS BTX	TEH-DIESEL BTX	TOTAL LEAD	418.1
	Exc.2-HAEW-4'	X		1/13/94	1000	X	X	X	Y
	Exc.2-HAEW-8'	X		1/13/94	1015	X	X	X	X
	Exc.2-HANW-7.5'	X		1/13/94	1030	X	X	X	X
	Exc.2-HANW-4'	X		1/13/94	1040	X	X	X	X
	Exc.2-HASW-4'	X		1/13/94	1055	X	X	X	X
	Exc.2-HASW-7.5'	X		1/13/94	1105	Y	X	X	X
	Exc.2-HANW-8'	X		1/13/94	1132	X	X	X	X
	Exc.2-HA								

Relinquished By:		Received By:	
(Print Name) TOM GHIGLIOTTO	Date: 1/13/94	(Print Name) MARG EDWARDS	
(Signature) <i>[Signature]</i>	Time: 1150	(Signature) <i>[Signature]</i>	
(Print Name) MARG EDWARDS	Date: 1/17/94	(Print Name) E. [Signature]	
(Signature) <i>[Signature]</i>	Time: 1120	(Signature) <i>[Signature]</i>	
(Print Name)	Date:	(Print Name)	
(Signature)	Time:	(Signature)	
(Print Name)	Date:	(Print Name)	
(Signature)	Time:	(Signature)	

LABORATORY NOTES: 35 DAYS TURNAROUND TIME FOR ANALYSIS RESULTS
PLEASE INCLUDE SAMPLE CONDITION REPORT WITH RESULTS
PLEASE FAX A COPY OF THE ANALYTICAL RESULTS TO THE FOLLOWING:
BAY AREA TANK REMOVAL AT (415) 512-0680
TMC ENVIRONMENTAL, INC. AT (510) 232-5133

ATTACHMENT 3
GRAB GROUND WATER SAMPLES
ANALYTICAL LABORATORY REPORTS
CHAIN-OF-CUSTODY FORMS



Geochem ENVIRONMENTAL LABORATORIES

Mobile & In-House Laboratories Certified by State of California

Phone: (408) 955-9988 / FAX: (408) 955-9538

ANALYTICAL REPORT

Page: 1 of 1

Client: TMC Environmental	Date Sampled: 01/12/94
13908 San Pablo Ave., Ste.101	Date Received: 01/12/94
San Pablo, CA 94107	Date Analyzed: 01/23/94
Attn: Marc Edwards	Batch: B-610.5 Matrix: Water
	Conc. Unit ug/L (ppb)
Project: 4549 Horton St.	(Conc. Unit for EPA in mg/kg(ppm))

"ND" means "not detected" at indicated detection limit.
 B:benzene, T:toluene, E:ethylbenzene & X:total xylenes.
 Samples received at job-site with a chain of custody record.

	8015M/TPH
SAMPLE I.D.	Diesel

DETECTION	
LIMIT	50 ppb

OB-1-1	ND

Reviewed and approved by George Tsai, Laboratory Director, JAN. 26, 1994



Geochem ENVIRONMENTAL LABORATORIES

Mobile & In-House Laboratories Certified by State of California

Phone: (408) 955-9988 / FAX: (408) 955-9538

ANALYTICAL REPORT

Page: 1 of 1

Client: TMC Environmental
 13908 San Pablo Ave., Ste.101
 San Pablo, CA, CA 94107
 Attn: Marc Edwards

Date Sampled: 01/12/94
 Date Received: 01/12/94
 Date Analyzed: 01/12/94
 Batch: B-610 Matrix: Water
 Conc. Unit ug/L (ppb)

Project: 4549 Horton St. (Conc. Unit for EPA in mg/kg(ppm))

"ND" means "not detected" at indicated detection limit.

B:benzene, T:toluene, E:ethylbenzene & X:total xylenes.

Samples received at job-site with a chain of custody record.

SAMPLE I.D.	EPA	8015M/TPH	602	B	T	E	X
418.1	Gasoline						
DETECTION LIMIT		1 ppm	50 ppb	0.5 ppb			
OB-1-1	53	ND	ND / ND / ND / ND				

Reviewed and approved by

George Tsai, Laboratory Director
 JAN. 17, 1994

GEOCHEM Environmental Laboratories
 780 Montague Expressway, Suite 404
 San Jose, CA 95131
 (408) 955-9988 • FAX (408) 955-9538

CHAIN OF CUSTODY RECORD

Date 1/11/94 Page 1 of 1

TESTS REQUIRED

CLIENT <u>TMC ENVIRONMENTAL</u>		PROJECT NAME <u>4549 AERON STREET</u>			418.1/TRPH	8010 (601)	8015 E/TPH-diesel	8015 M/TPH-gasoline	8020 (602) BTEX	7420/Total Lead	Organic Lead			Archive
ADDRESS		PROJECT MANAGER <u>MARC EDWARDS</u>												
		PHONE NUMBER <u>(510) 232-8366</u>												

SAMPLE I.D.	LOCATION DESCRIPTION	DATE	TIME	MATRIX			NO. OF CTNR	418.1/TRPH	8010 (601)	8015 E/TPH-diesel	8015 M/TPH-gasoline	8020 (602) BTEX	7420/Total Lead	Organic Lead			Archive	
				AIR	WATER	SOIL												
<u>OB-1-1</u>		<u>1/11/94</u>	<u>8:24</u>		<u>X</u>		<u>4</u>	<u>X</u>			<u>X</u>	<u>X</u>						

Sampled/Relinquished by: <u>[Signature]</u>	Received by:	<u>1/12/94</u>	Date	<u>1:10</u>	Time
Relinquished by:	Received by:		Date		Time
Relinquished by:	Received by:		Date		Time

Turnaround time: 24 hr. 48 hr. Normal (3-5 days) Special Instructions:



Geochem ENVIRONMENTAL LABORATORIES

Mobile & In-House Laboratories Certified by State of California

Phone: (408) 955-9988 / FAX: (408) 955-9538

ANALYTICAL REPORT

Page: 1 of 1

Client: Bay Area Tank Removal
254 Clara St.
San Francisco, CA 94107
Attn: M. Youngkin

Date Sampled: 01/19/94
Date Received: 01/26/94
Date Analyzed: 01/26/94
Batch: SA-338 Matrix: Water
Conc. Unit ug/L (ppb)

Project: Horton St.

"ND" means "not detected" at indicated detection limit.

B:benzene, T:toluene, E:ethylbenzene & X:total xylenes.

Samples received at job-site with a chain of custody record.

SAMPLE I.D.	8015M/TPH	8015M/TPH	602			
	Diesel	Gasoline	B	T	E	X
	50 ppb	50 ppb	0.5 ppb			
OB-1-2	ND	ND	ND	ND	ND	ND

Reviewed and approved by

George Tsai, FEB. 01, 1994
George Tsai, Laboratory Director



TMC Environmental, Inc.
 13908 San Pablo Ave.
 Suite 101
 San Pablo, California
 (510) 232-8366

CHAIN OF CUSTODY RECORD ANALYSIS REQUEST FORM FOR ENVIRONMENTAL SAMPLING

JOB # 1-13093	JOB ADDRESS: 4549 HORTON ST. EMERYVILLE, CA.	SAMPLER: MARC EDWARDS
LABORATORY NAME: CURTIS & TOMPKINS, LTD. 2323 FIFTH STREET, BERKELEY, CA 94710		

LAB ID NO.	SAMPLE NUMBER	SOIL	WATER	DATE	TIME	TVH-GAS BTEX	TEH-DIESEL BTEX			
	0B-1-2		X	1/19/94	10:54	X	X			

Relinquished By:		Received By:	
(Print Name) Marc Edwards	Date: 1/26/94	(Print Name) E. W. ...	
(Signature) <i>[Signature]</i>	Time: 11:19a	(Signature) <i>[Signature]</i>	
(Print Name)	Date:	(Print Name)	
(Signature)	Time:	(Signature)	
(Print Name)	Date:	(Print Name)	
(Signature)	Time:	(Signature)	
(Print Name)	Date:	(Print Name)	
(Signature)	Time:	(Signature)	

LABORATORY NOTES: _____ DAYS TURNAROUND TIME FOR ANALYSIS RESULTS
 PLEASE INCLUDE SAMPLE CONDITION REPORT WITH RESULTS
 PLEASE FAX A COPY OF THE ANALYTICAL RESULTS TO THE FOLLOWING:
 BAY AREA TANK REMOVAL AT (415) 512-0680
 TMC ENVIRONMENTAL, INC. AT (510) 232-5133



Geochem ENVIRONMENTAL LABORATORIES

Mobile & In-House Laboratories Certified by State of California

Phone: (408) 955-9988 / FAX: (408) 955-9538

ANALYTICAL REPORT

Page: 1 of 1

Client: TMC Environmental
 13908 San Pablo Ave., Ste.101
 San Pablo, CA, CA 94107
 Attn: Tom Ghigliotto

Date Sampled: 02/09/94
 Date Received: 02/10/94
 Date Analyzed: 02/10/94
 Batch:SA-351 Matrix:Water
 Conc. Unit ug/L (ppb)

Project: 4525-4549 Horton St. (Proj.#1-13093)

"ND" means "not detected" at indicated detection limit.
 B:benzene, T:toluene, E:ethylbenzene & X:total xylenes.
 Samples received at job-site with a chain of custody record.

SAMPLE I.D.	8015MTPH Diesel	8015M/TPH Gasoline	602
			B / T / E / X
DETECTION LIMIT	50 ppb	50 ppb	0.5 ppb
OB-1A	ND		ND / ND / ND / ND
OB-2A		ND	ND / ND / ND / ND
OB-1B	ND		ND / ND / ND / ND
OB-2B		ND	ND / ND / ND / ND

Reviewed and approved by

George Tsai, FEB. 11, 1994
 George Tsai, Laboratory Director

ADDITIONAL REQUESTS:

CHAIN OF CUSTODY RECORD ANALYSIS REQUEST FORM FOR ENVIRONMENTAL SAMPLING

JOB # 1-13093	JOB ADDRESS: 4525-4549 HORTON ST. Emeryville, CA	SAMPLER: TOM GHIGLIOTTO
LABORATORY NAME: GEOCHEM ENVIRONMENTAL LABORATORIES, SAN JOSE, CA 95131		

LAB ID NO.	SAMPLE NUMBER	SOIL	WATER	DATE	TIME	TVH-GAS BTEX	TEH-DIESEL	TOTAL LEAD		
	1-13093-082-2/9/94		X	2/9/94	1140	X				
	EQB-1-13093		X	2/9/94	1255		HOLD			
	1-13093-081-2/9/94		X	2/9/94	1310	X	X			

Relinquished By:		Received By:	
(Print Name) Tom Ghigliotto	Date: 2/10/94	(Print Name)	
(Signature) <i>Tom Ghigliotto</i>	Time: 1110	(Signature) <i>[Signature]</i>	
(Print Name)	Date:	(Print Name)	
(Signature)	Time:	(Signature)	
(Print Name)	Date:	(Print Name)	
(Signature)	Time:	(Signature)	
(Print Name)	Date:	(Print Name)	
(Signature)	Time:	(Signature)	

LABORATORY NOTES: _____ DAYS TURNAROUND TIME FOR ANALYSIS RESULTS
PLEASE INCLUDE SAMPLE CONDITION REPORT WITH RESULTS
PLEASE FAX A COPY OF THE ANALYTICAL RESULTS TO THE FOLLOWING:
BAY AREA TANK REMOVAL AT (415) 512-0680
TMC ENVIRONMENTAL, INC. AT (510) 232-5133

ADDITIONAL REQUESTS:

CHAIN OF CUSTODY RECORD ANALYSIS REQUEST FORM FOR ENVIRONMENTAL SAMPLING

JOB # 1-13093	JOB ADDRESS: 4525-4549 Horton St. Emeryville, CA	SAMPLER: TOM GHIGLIOTTO
LABORATORY NAME: GEOCHEM ENVIRONMENTAL LABORATORIES, SAN JOSE, CA 95131		

LAB ID NO.	SAMPLE NUMBER	SOIL	WATER	DATE	TIME	TVH-GAS BTEX	TEH-DIESEL	TOTAL LEAD		
	1-13093-0B2 a		X	2/8/94	1125	X				
	EQB 1a		X	2/9/94	1235		HOLD			
	1-13093-0B2a		X	2/9/94	1245	X	X			

Relinquished By:

Received By:

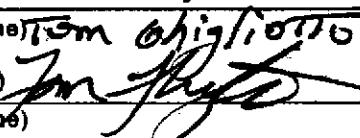
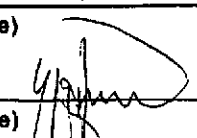
(Print Name) Tom Ghigliotto	Date: 2/9/94	(Print Name)
(Signature) 	Time: 1118	(Signature) 
(Print Name)	Date:	(Print Name)
(Signature)	Time:	(Signature)
(Print Name)	Date:	(Print Name)
(Signature)	Time:	(Signature)
(Print Name)	Date:	(Print Name)
(Signature)	Time:	(Signature)

LABORATORY NOTES: _____ DAYS TURNAROUND TIME FOR ANALYSIS RESULTS
PLEASE INCLUDE SAMPLE CONDITION REPORT WITH RESULTS

PLEASE FAX A COPY OF THE ANALYTICAL RESULTS TO THE FOLLOWING:
BAY AREA TANK REMOVAL AT (415) 512-0680
TMC ENVIRONMENTAL, INC. AT (510) 232-5133

RECORD OF WATER SAMPLE COLLECTION

WELL LABEL: OB-1	DATE COLLECTED: 1-11-94	JOB NUMBER: 1-13093
JOB NAME: RIFKIN PROPERTY		SAMPLERS NAME: TOM GHIGHLIOTTO
LOCATION: 4549 HORTON STREET, EMERYVILLE, CALIFORNIA		

WELL HEAD COND.:

TIME MEASURED
DEPTH IN FEET
(Measure to 0.01')

06:25	06:35				
8.22	8.22				

WELL PURGING RECORD

TOTAL DEPTH OF WELL: 12.80	DEPTH TO WATER: 8.22	DIAMETER: 2"
----------------------------	----------------------	--------------

PURGE VOLUME = TOTAL DEPTH - WATER DEPTH X VOLUME FACTOR X 3 VOLUMES = 1,200 GALLONS
 VOLUME FACTOR = 0.17 FOR 2" CASING; 0.65 FOR 4" CASING; 1.47 FOR 6" CASING

PURGE METHOD: H & H VACUUM TRUCK	OVA-FID VAPOR READING, ppm :
----------------------------------	------------------------------

WELL PURGING PARAMETERS

* With
Specs
pH

GALLONS	TIME	TEMPERATURE degrees F	CONDUCTIVITY x 1000	VISUAL TURBIDITY	
---------	------	--------------------------	------------------------	---------------------	--

Dewater	0	06:40			CLOUDY *	
Dewater	620	06:58			CLOUDY	
Dewater	700	07:20			CLOUDY	
Dewater	1,000	07:48			CLEAR W/*	
Dewater	1,100	08:10				
Samples						
OB-1-1	1,200	08:24	50.6	0.58	CLOUDY W/*	6.55
OB-1-2 @ 9.88	1,204	08:45	52.0	0.91	CLOUDY W/*	6.67

SAMPLING METHOD: DISPOSABLE BAILER	TIME COLLECTED: 08:24 AND 08:45
SAMPLE TURBIDITY: #156.9 #2>200 NTU	

RECORD OF WATER SAMPLE COLLECTION

WELL LABEL: OB-1	DATE COLLECTED: 1-19-94	JOB NUMBER: 1-13093
JOB NAME: RIFKIN PROPERTY		SAMPLERS NAME: TOM GHIGLIOTTO
LOCATION: 4549 HORTON STREET, EMERYVILLE, CALIFORNIA		

WELL HEAD COND.:

TIME MEASURED
DEPTH IN FEET
(Measure to 0.01')

09:00	09:45				
7.70	7.70				

WELL PURGING RECORD

TOTAL DEPTH OF WELL: 12.44	DEPTH TO WATER: 7.70	DIAMETER: 2
----------------------------	----------------------	-------------

PURGE VOLUME = TOTAL DEPTH - WATER DEPTH X VOLUME FACTOR X 3 VOLUMES = 1,300 GALLONS
 VOLUME FACTOR = 0.17 FOR 2" CASING; 0.65 FOR 4" CASING; 1.47 FOR 6" CASING

PURGE METHOD: H & H VACUUM TRUCK	OVA-FID VAPOR READING, ppm : 0'
----------------------------------	---------------------------------

WELL PURGING PARAMETERS

GALLONS	TIME	TEMPERATURE degrees F	CONDUCTIVITY x 1000	VISUAL TURBIDITY	pH
---------	------	--------------------------	------------------------	---------------------	----

0	09:45			CLEAR/SLT. CLOUDY	
950	10:15			CLEAR/SL. CLOUDY *	
1,300	10:50	59.0	1.03	CLOUDY	6.71
				>200	

SAMPLING METHOD: DISPOSABLE BAILER	TIME COLLECTED: 10:54
SAMPLE TURBIDITY: >200	

RECORD OF WATER SAMPLE COLLECTION

WELL LABEL: OB-1	DATE COLLECTED: 2-9-94	JOB NUMBER: 1-13093
JOB NAME: Rifkin Property		SAMPLERS NAME: Tom Ghigliotto
LOCATION: 4525 Horton Street, Emeryville, California		

WELL HEAD COND.:

TIME MEASURED
DEPTH IN FEET
(Measure to 0.01')

9:45	10:20	10:50			
6.28	6.28	6.30			

WELL PURGING RECORD

TOTAL DEPTH OF WELL: 12.42	DEPTH TO WATER:	DIAMETER: 4"
----------------------------	-----------------	--------------

PURGE VOLUME = TOTAL DEPTH - WATER DEPTH X VOLUME FACTOR X 3 VOLUMES = 1200 GALLONS
VOLUME FACTOR = 0.17 FOR 2" CASING; 0.65 FOR 4" CASING; 1.47 FOR 6" CASING

PURGE METHOD: H & H Vacuum Truck	OVA-FID VAPOR READING, ppm : 0
----------------------------------	--------------------------------

WELL PURGING PARAMETERS

GALLONS	TIME	TEMPERATURE degrees F	CONDUCTIVITY x 1000	VISUAL TURBIDITY	pH
0	11:45	60.4	0.94	Slit. Cloudy w/sheen	7.04
~ 400	11:52	60.8	0.96	Slightly Cloudy	7.08
~ 800	12:10	60.4	0.95	Slit. Cloudy/Clear	7.11
~ 1100	12:30	58.1	0.93	Clear	7.01
~ 1200	12:45	58.3	0.93	Clearf	6.98

SAMPLING METHOD: Disposable Bailer	TIME COLLECTED: 12:45 and 13:10
SAMPLE TURBIDITY: 31.2 and 8.6	

ATTACHMENT 4
WASTE MANIFESTS

UNIFORM HAZARDOUS WASTE MANIFEST

1. Generator's US EPA ID No. **CAC0000896208** Manifest Document No. **19979** of **1** 2. Page 1
 Information in the shaded areas is not required by Federal law.

3. Generator's Name and Mailing Address
HARVEY RIPKIN / c/o FRANK SATTERWHITE
3220 Monika Lane, Hayward, CA. 94541

A. State Manifest Document Number
92218878

4. Generator's Phone **(510) 727-0282**

B. State Generator's ID

5. Transporter 1 Company Name
H & H Ship Service Company

C. State Transporter's ID

6. US EPA ID Number
CAD004771169

D. Transporter's Phone

7. Transporter 2 Company Name

E. State Transporter's ID

9. Designated Facility Name and Site Address
PRC PATTERSON, INC.
13331 N. Highway 33
Patterson, CA. 95363

G. State Facility's ID

10. US EPA ID Number
CAD083166728

H. Facility's Name

11. US DOT Description (including Proper Shipping Name, Hazard Class, and ID Number)	12. Containers		13. Total Quantity	14. Unit Wt/Vol	15. Waste Number
	No.	Type			
a. OIL AND WATER NON-RCRA HAZARDOUS WASTE LIQUID	001	TT	01300	0	223
b.					
c.					
d.					

12. Additional Descriptions for Materials Listed Above
OIL AND WATER

13. Handling Codes for Wastes Listed Above
01

15. Special Handling Instructions and Additional Information
JOB #13884 PROFILE #A4052 **JOB SITE: HARVEY RIPKIN**
24 Hr. Emergency Contact: H & H # (415) 543-4835 **4549 Horton Street**
APPROPRIATE PROTECTIVE CLOTHING AND RESPIRATOR **Emeryville, California**

16. GENERATOR'S CERTIFICATION: I hereby declare that the contents of the consignment are fully and accurately described above by proper shipping name and are classified, packed, marked, and labeled, and are in all respects in proper condition for transport by highway according to applicable federal, state and international laws.
 If I am a large quantity generator, I certify that I have a program in place to reduce the volume and toxicity of waste generated to the degree I have determined to be economically practicable and that I have selected the practicable method of treatment, storage, or disposal currently available to me which minimizes the present and future threat to human health and the environment; OR, if I am a small quantity generator, I have made a good faith effort to minimize my waste generation and select the best waste management method that is available to me and that I can afford.

Printed/Typed Name: **Harvey Ripkin** Signature: *[Signature]* Month: **01** Day: **19** Year: **97**

17. Transporter 1 Acknowledgement of Receipt of Materials
 Printed/Typed Name: **ESTEBAN M. PENALVER** Signature: *[Signature]* Month: **01** Day: **19** Year: **97**

18. Transporter 2 Acknowledgement of Receipt of Materials
 Printed/Typed Name: _____ Signature: _____ Month: _____ Day: _____ Year: _____

19. Discrepancy Indication Space

20. Facility Owner or Operator Certification of receipt of hazardous materials covered by this manifest except as noted in Item 19.
 Printed/Typed Name: _____ Signature: _____ Month: _____ Day: _____ Year: _____

IN CASE OF EMERGENCY OR SPILL, CALL THE NATIONAL RESPONSE CENTER 1-800-424-8802; WITHIN CALIFORNIA, CALL 1-800-852-7550

DO NOT WRITE BELOW THIS LINE.

UNIFORM HAZARDOUS WASTE MANIFEST

1. Generator's US EPA ID No. CA00000866208	Manifest Document No. 118879	2. Page 1 of 1	Information in the shaded areas is not required by Federal law.
---	---------------------------------	----------------	---

3. Generator's Name and Mailing Address
HARVEY RIFKIN c/o Frank Satterwhite
3220 Monika Lane, Hayward, CA 94541

4. Generator's Phone (415) 777-8282

5. Transporter 1 Company Name
H & H Ship Service Company

6. US EPA ID Number
 CA000004771168

7. Transporter 2 Company Name

8. US EPA ID Number

9. Designated Facility Name and Site Address
PRC PATTERSON, INC.
13331 N. Highway 33
Patterson, CA. 95363

10. US EPA ID Number
 CA000003166728

11. US DOT Description (including Proper Shipping Name, Hazard Class, and ID Number)

12. Containers	13. Total Quantity	14. Unit Wt/Vol	15. Waste Name
001	T T	01200	G

a. **OIL AND WATER**
NON-RCRA HAZARDOUS WASTE LIQUID

b.

c.

d.

12. Additional Descriptions for Materials Listed Above

15. Special Handling Instructions and Additional Information
JOB #13855 **JOB SITE: Harvey Rifkin**
24 Hr. Emergency Contact: H & H # (415) 543-4835 **4549 Horton Street.**
APPROPRIATE PROTECTIVE CLOTHING AND RESPIRATOR **Emeryville, California**

16. GENERATOR'S CERTIFICATION: I hereby declare that the contents of the consignment are fully and accurately described above by proper shipping name and are classified, packed, marked, and labeled, and are in all respects in proper condition for transport by highway according to applicable federal, state and international laws.

If I am a large quantity generator, I certify that I have a program in place to reduce the volume and toxicity of waste generated to the degree I have determined to be economically practicable and that I have selected the practicable method of treatment, storage, or disposal currently available to me which minimizes the present and future threat to human health and the environment; OR, if I am a small quantity generator, I have made a good faith effort to minimize my waste generation and select the best waste management method that is available to me and that I can afford.

Printed/Typed Name: **Harvey Rifkin** Signature: *[Signature]* Month: 01 Day: 11 Year: 94

17. Transporter 1 Acknowledgement of Receipt of Materials
 Printed/Typed Name: **MARTIN J. COSTELLO** Signature: *[Signature]* Month: 01 Day: 11 Year: 94

18. Transporter 2 Acknowledgement of Receipt of Materials
 Printed/Typed Name: Signature: Month: Day: Year:

19. Discrepancy Indication Space

20. Facility Owner or Operator Certification of receipt of hazardous materials covered by this manifest except as noted in Item 19.
 Printed/Typed Name: **CLONN SH...** Signature: *[Signature]* Month: 01 Day: 11 Year: 94

DO NOT WRITE BELOW THIS LINE.

IN CASE OF EMERGENCY OR SPILL, CALL THE NATIONAL RESPONSE CENTER 1-800-424-8802; WITHIN CALIFORNIA, CALL 1-800-852-7755.

See Instructions on back of page 6.

Department of Toxic Substances Control
Sacramento, California

UNIFORM HAZARDOUS WASTE MANIFEST

1. Generator's US EPA ID No.

Manifest Document No.

2. Page 1

Information in the shaded areas is not required by Federal law.

0 0 0 0 0 0 0 0 6 2 0 0 1 1 1 1 4

of 1

3. Generator's Name and Mailing Address

HARVEY RIFKIN c/o Frank Satterwhite
3220 Monika Lane, Hayward, CA 94541

4. Generator's Phone (415) 727-0200

6. US EPA ID Number

5. Transporter 1 Company Name
H & H Ship Service Company

7. Transporter 1 US EPA ID Number
7 8 0 0 0 0 0 0 0 0 0 0 0 0 0 0

7. Transporter 2 Company Name

8. US EPA ID Number

9. Designated Facility Name and Site Address

PRC PATTERSON, INC.
13331 N. Highway 33
Patterson, CA. 95363

10. US EPA ID Number

7 8 0 0 0 0 0 0 0 0 0 0 0 0 0 0

11. US DOT Description (including Proper Shipping Name, Hazard Class, and ID Number)

12. Containers
No. Type

13. Total Quantity

14. Unit Wt/Vol

a. OIL AND WATER
NON-PCRA HAZARDOUS WASTE LIQUID

0 0 1

T T

0,1570

G

b.

c.

d.

15. Special Handling Instructions and Additional Information

JOB #13255

JOB SITE: Harvey Rifkin

24 Hr. Emergency Contact: H & H (415) 543-4835

4549 Horton Street

APPROPRIATE PROTECTIVE CLOTHING AND RESPIRATOR

Emeryville, California

16. GENERATOR'S CERTIFICATION: I hereby declare that the contents of the consignment are fully and accurately described above by proper shipping name and are classified, packed, marked, and labeled, and are in all respects in proper condition for transport by highway according to applicable federal, state and international laws.

If I am a large quantity generator, I certify that I have a program in place to reduce the volume and toxicity of waste generated to the degree I have determined to be economically practicable and that I have selected the practicable method of treatment, storage, or disposal currently available to me which minimizes the present and future threat to human health and the environment; OR, if I am a small quantity generator, I have made a good faith effort to minimize my waste generation and select the best waste management method that is available to me and that I can afford.

Printed/Typed Name
Tim Satterwhite

Signature
Tim Satterwhite

Month Day Year
0 1 1 0 9

17. Transporter 1 Acknowledgement of Receipt of Materials
Printed/Typed Name
Martin Costello

Signature
Martin Costello

Month Day Year
1 1 0 9

18. Transporter 2 Acknowledgement of Receipt of Materials
Printed/Typed Name

Signature

Month Day Year

19. Discrepancy Indication Space

Revised Hazardous Waste ID # 1212

20. Facility Owner or Operator Certification of receipt of hazardous materials covered by this manifest except as noted in Item 19.
Printed/Typed Name
Mark Serrano

Signature
Mark Serrano

Month Day Year
0 1 1 9 1

DO NOT WRITE BELOW THIS LINE.

IN CASE OF EMERGENCY OR SPILL, CALL THE NATIONAL RESPONSE CENTER 1-800-424-8802; WITHIN CALIFORNIA, CALL 1-800-852-7550

GENERATOR

FACILITY

IN CASE OF EMERGENCY OR SPILL, CALL THE NATIONAL RESPONSE CENTER 1-800-424-8802. WITHIN CALIFORNIA, CALL 1-800-852-7550.

UNIFORM HAZARDOUS WASTE MANIFEST		1. Generator's US EPA ID No. C A C 0 0 0 8 9 6 2 0 8		Manifest Document No. 1 8 8 0 5		2. Page 1 of 1		Information in the shaded areas is not required by Federal law.					
3. Generator's Name and Mailing Address HARVEY RIFKIN c/o Frank Satterwhite 3220 Monika Lane, Hayward, CA 94541				A. State Manifest Document Number 92218805									
4. Generator's Phone (510) 727-0282				B. State Generator's ID									
5. Transporter 1 Company Name H & H Ship Service Company		6. US EPA ID Number C A D 0 0 4 7 7 1 1 6 8		C. State Transporter's ID 402006		D. Transporter's Phone (415) 543-4835							
7. Transporter 2 Company Name		8. US EPA ID Number		E. State Transporter's ID		F. Transporter's Phone							
9. Designated Facility Name and Site Address PRC PATTERSON, INC. 13331 N. Highway 33 Patterson, CA. 95363				10. US EPA ID Number C A D 0 8 3 1 6 6 7 2 8		G. State Facility's ID		H. Facility's Phone (800) 874-4444					
11. US DOT Description (including Proper Shipping Name, Hazard Class, and ID Number) OIL AND WATER NON-RCRA HAZARDOUS WASTE LIQUID				12. Containers No. Type 0 0 1 T T		13. Total Quantity 00250		14. Unit G		15. Waste Number State: 223 EPA/Other:			
				b.						State:		EPA/Other:	
c.								State:		EPA/Other:			
d.								State:		EPA/Other:			
15. Special Handling Instructions and Additional Information JOB #13846 24 Hr. Emergency Contact: H & H. # (415) 543-4835 APPROPRIATE PROTECTIVE CLOTHING AND RESPIRATOR				K. Handling Codes for Wastes Listed Above:		a. 01		b.		c.			
				d.									
16. GENERATOR'S CERTIFICATION: I hereby declare that the contents of the consignment are fully and accurately described above by proper shipping name and are classified, packed, marked, and labeled, and are in all respects in proper condition for transport by highway according to applicable federal, state and international laws. If I am a large quantity generator, I certify that I have a program in place to reduce the volume and toxicity of waste generated to the degree I have determined to be economically practicable and that I have selected the practicable method of treatment, storage, or disposal currently available to me which minimizes the present and future threat to human health and the environment; OR, if I am a small quantity generator, I have made a good faith effort to minimize my waste generation and select the best waste management method that is available to me and that I can afford.				JOB SITE: HARVEY RIFKIN 4549 HORTON STREET EMERYVILLE, CA									
Printed/Typed Name MARC EDWARDS		Signature 		Month 0		Day 1		Year 0 6 9					
17. Transporter 1 Acknowledgement of Receipt of Materials Printed/Typed Name ESTEBAN M. PENALVER		Signature 		Month 4		Day 1		Year 0 6 9					
18. Transporter 2 Acknowledgement of Receipt of Materials Printed/Typed Name		Signature		Month		Day		Year					
19. Discrepancy Indication Space													
20. Facility Owner or Operator Certification of receipt of hazardous materials covered by this manifest except as noted in Item 19. Printed/Typed Name MARK SANDHU				Signature Mark Sandhu				Month 01		Day 07		Year 1994	

DO NOT WRITE BELOW THIS LINE.

130

NON-HAZARDOUS SPECIAL WASTE MANIFEST

GENERATOR

Generator Name HARVEY RIFKIN Generating Location 4525-4549 HORTON STREET
 Address 3220 MONIKA LANE Address EMERYVILLE, CA 94608
HAYWARD, CA 94541
 Phone No. 510-7270282 Phone No. 510-2328366
 BFI Waste Code CA 405 010794 64355

Description of Waste

NON-REGULATED PETROLEUM CONTAMINATED SOIL
NON DOT / RCRA REGULATED

Quantity	Units	Containers No.	Type
<u>18</u>	<u>Y</u>		

- Type
 D - Drum
 C - Carton
 B - Bag
 T - Truck
 P - Pounds
 Y - Yards
 O - Other

I hereby certify that the above named material does not contain free liquid as defined by 40 CFR Part 260.10 or any applicable state law, is not a hazardous waste as defined by 40 CFR Part 261 or any applicable state law, has been properly described, classified and packaged, and is in proper condition for transportation according to applicable regulations.

Generator Authorized Agent Name Marc Edwards Signature [Signature] Shipment Date 010794

TRANSPORTER

Truck No. 74 Phone No. (800) 838-1499
 Transporter Name DEN BESTE TRUCKING Driver Name (Print) MIKE BAXMAN
 Address 209 Maillet Vehicle License No./State SP27464
Windsor CA Vehicle Certification _____

I hereby certify that the above named material was picked up at the generator site listed above.

I hereby certify that the above named material was delivered without incident to the destination listed below.

Driver Signature Mike Beran Shipment Date 100793 Driver Signature Mike Beran Delivery Date 100795

DESTINATION

Site Name BROWNING-FERRIS INDUSTRIES Phone No. 510-4420471
 Address 4001 N. VASCO ROAD LIVERMORE CA 94550

I hereby certify that the above named material has been accepted and to the best of my knowledge the foregoing is true and accurate.

Name of Authorized Agent _____ Signature [Signature] Receipt Date 10/7/95

PASS CODE _____



BROWNING-FERRIS INDUSTRIES

NON-HAZARDOUS SPECIAL WASTE MANIFEST

No. 1024739

GENERATOR

Generator Name HARVEY RIFKIN Generating Location _____
 Address 3220 MONIKA LANE Address 4525-4549 HORTON STREET
HAYWARD, CA 94541 EMERYVILLE CA 94608
 Phone No. 510-7270282 Phone No. 510-2328366
 BFI Waste Code CA 405 010794 64355

Description of Waste	Quantity	Units	Containers		Type
			No.	Type	
NON REGULATED PETROLEUM CONTAMINATED SOIL	18	Y			D - Drum C - Carton B - Bag T - Truck P - Pounds Y - Yards O - Other
NON DOT / RCRA REGULATED					

I hereby certify that the above named material does not contain free liquid as defined by 40 CFR Part 260.10 or any applicable state law, is not a hazardous waste as defined by 40 CFR Part 261 or any applicable state law, has been properly described, classified and packaged, and is in proper condition for transportation according to applicable regulations.

Generator Authorized Agent Name MARC EDWARDS Signature [Signature] Shipment Date 010794

TRANSPORTER

Truck No. _____ Phone No. (800) 838-1477
 Transporter Name DEN BESTE TRUCKING Driver Name (Print) Steve Aiers
 Address 709 MAIL CT. Vehicle License No./State 9C40S25
WINDSOR, CA. Vehicle Certification _____

I hereby certify that the above named material was picked up at the generator site listed above. I hereby certify that the above named material was delivered without incident to the destination listed below.

Driver Signature [Signature] Shipment Date 110794 Driver Signature [Signature] Delivery Date 110794

DESTINATION

Site Name BROWNING-FERRIS INDUSTRIES Phone No. 510-4470491
 Address 4001 N. VASLO ROAD LIVERMORE CA 94550

I hereby certify that the above named material has been accepted and to the best of my knowledge the foregoing is true and accurate.

Name of Authorized Agent _____ Signature [Signature] Receipt Date 110794

PASS CODE _____

GENERATOR

Generator Name HARVEY RIFKIN Generating Location _____
 Address 3220 MONIKA LANE Address 4525-4549 HORTON STREET
HAYWARD, CA. 94541 EMERYVILLE, CA. 94608
 Phone No. 510-7270282 Phone No. 510-2328366
 BFI Waste Code CA 405 010794 64355

Description of Waste	Quantity	Units	Containers		Type
			No.	Type	
<u>NON REGULATED PETROLEUM CONTAMINATED SOIL</u>	<u>18</u>	<u>Y</u>			
<u>NON DOT/RCRA REGULATED</u>					

I hereby certify that the above named material does not contain free liquid as defined by 40 CFR Part 260.10 or any applicable state law, is not a hazardous waste as defined by 40 CFR Part 261 or any applicable state law, has been properly described, classified and packaged, and is in proper condition for transportation according to applicable regulations.

Marc Edwards  010794
 Generator Authorized Agent Name Signature Shipment Date

TRANSPORTER

Truck No. _____ Phone No. (800) 838-1477
 Transporter Name DEN BESTE TRUCKING Driver Name (Print) Steve Myers
 Address 209 MAIL CT. Vehicle License No./State 9C40525 CA
WINDSOR, CA. Vehicle Certification _____

I hereby certify that the above named material was picked up at the generator site listed above. I hereby certify that the above named material was delivered without incident to the destination listed below.

Steve Myers 010794 Steve Myers 010794
 Driver Signature Shipment Date Driver Signature Delivery Date

DESTINATION

Site Name BROWNING-FERRIS INDUSTRIES Phone No. 510-4470491
 Address 4001 NORTH VASCO ROAD LIVERMORE, CA. 94550

I hereby certify that the above named material has been accepted and to the best of my knowledge the foregoing is true and accurate.

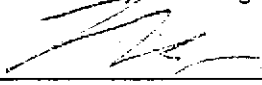
 Name of Authorized Agent Signature  010794
 Receipt Date

PASS CODE _____

NON-HAZARDOUS SPECIAL WASTE MANIFEST

GENERATOR

Generator Name HARVEY RIFKIN Generating Location _____
 Address 3220 MONIKA LANE Address 4525-4529 HORTON STREET
HAYWARD, CA. 94541 EMERYVILLE, CA. 94608
 Phone No. 510-7270282 Phone No. 510-2328366
 BFI Waste Code CA 405 010794 64355

Description of Waste	Quantity	Units	Containers		Type
			No.	Type	
NON REGULATED PETROLEUM CONTAMINATED SOIL. NON DOT/PCRA REGULATED.					D - Drum
					C - Carton
					B - Bag
					T - Truck
					P - Pounds
					Y - Yards
					O - Other

I hereby certify that the above named material does not contain free liquid as defined by 40 CFR Part 260.10 or any applicable state law, is not a hazardous waste as defined by 40 CFR Part 261 or any applicable state law, has been properly described, classified and packaged, and is in proper condition for transportation according to applicable regulations.

MARC EDWARDS [Signature] 011194
 Generator Authorized Agent Name Signature Shipment Date

TRANSPORTER

Truck No. #1 Phone No. (800) 838-1477
 Transporter Name DEN BESTE TRUCKING Driver Name (Print) TODD REIS
 Address 209 MAIL CT. Vehicle License No./State 4H87709/CA
WINDSOR, CA. Vehicle Certification TRK#1

I hereby certify that the above named material was picked up at the generator site listed above.
 I hereby certify that the above named material was delivered without incident to the destination listed below.
[Signature] 011194
 Driver Signature Shipment Date Driver Signature Delivery Date

DESTINATION

Site Name BROWNING-FERRIS INDUSTRIES Phone No. 510-4470491
 Address 4001 NORTH VASCO ROAD LIVERMORE, CA. 94550

I hereby certify that the above named material has been accepted and to the best of my knowledge the foregoing is true and accurate

 Name of Authorized Agent Signature Receipt Date

PASS CODE _____

2000

ATTACHMENT 5
EXCAVATION SOIL SAMPLING PROTOCOL

1.0 SOIL SAMPLING

1.1 The soil sampling will commence at selected depths below surface grade as decided by the supervising field geologist or agency representative. If applicable, soil samples will be recovered from lithologic changes, obvious soil contamination areas, from soil-groundwater interface, or from each side wall, and bottom face of the excavation.

1.2 Soil samples recovered from the excavation limits (bottom and side walls) of non shored excavations, are recovered in the bucket of a backhoe. Care will be taken to recover relatively non-disturbed soils from the excavation sample points. A representative bucket of soil will be brought to the surface to recover a soil sample. A clean brass liner will be driven, with a clean mallet, into relatively non-disturbed soils in the backhoe bucket. The liner will be driven into the soil materials until no head space remains in the liner. The liner will be immediately sealed with a Teflon circle (or equivalent), capped with a plastic end cap, then sealed with Teflon tape or placed in a plastic bag with a sealing top. The samples will be labeled and immediately delivered to the on site mobile analytical laboratory. Sample jars provided by the laboratory will be used in loose material.

1.3 Soil samples from weathered or fractured bedrock will be recovered with the backhoe bucket. A representative bucket of ripped bedrock will be brought to the surface to recover a soil sample. A clean metal liner tube or sample jar provided by the laboratory will be filled by hand with clay fracture filling or small pieces of rock. The liner tube will be filled with clay until no head space remains. The sample will be immediately sealed with a Teflon circle (or equivalent), capped with a plastic cap, then sealed with Teflon tape or placed in a plastic bag with a sealing top. The samples will be labeled and immediately delivered to the analytical laboratory.

1.4 A representative sample will be field screened with an organic vapor analyzer, OVA-FID. A small amount of material will be placed in a plastic bag and sealed. The material in the bag will be broken up by hand and allowed to sit for about five minutes. The probe of the OVA will penetrate the plastic bag and sample the material for hydrocarbon vapors. If vapors are detected, then a carbon filter will be placed on the instrument and the measurement repeated to test for methane gas. If a mobile laboratory is present, then the sample recovered for field screening will be immediately delivered to the laboratory for analysis of total recoverable petroleum hydrocarbons (TRPH by EPA method 418.1).

1.5 Existing tank pits are commonly found in hard and competent Franciscan Formation bedrock consisting of sandstone, shale, chert, and serpentine. When the bedrock is sufficiently fractured or weathered, soil samples will be collected with the

backhoe equipment. No samples will be recovered in hard and competent bedrock that refuses penetration of the backhoe equipment.

1.6 Soil samples from debris boxes, stockpiles, behind vault walls, and shored excavations will be recovered with hand sampling techniques. Care will be taken to recover representative samples of the stockpiled soil. A clean liner tube will be driven, with a clean mallet into the loose soil of the exterior of the pile or side walls of the excavation. The liner will be driven into the soil materials until no head space remains in the liner. The liner tube will be immediately sealed with a Teflon circle (or equivalent), capped with a plastic end cap, then sealed with aluminized tape. Samples from the interior of the pile will be recovered with a pile sampler and placed in a glass sample jar or liner tube by hand. Two to four discrete samples will be recovered from each pile, about one sample for each twenty cubic yards of soil. Samples from behind vault walls will be sampled with a 10 pound sample hammer and 2" x 3" modified California sampler. The samples will be labeled and stored on blue ice for delivery to the analytical laboratory as described above.

1.7 All samples retained for chemical analysis will be stored on blue ice in a clean, covered cooler-box for transport to the laboratory. Duplicate samples (if any) will also be transported to the laboratory and refrigerated. Samples will be delivered to the laboratory within 24 hours of sampling.

1.8 All samples submitted for analysis by a on site mobile laboratory will be immediately delivered to the lab for sample extraction. Extraction of the sample will be performed immediately. Analysis of the sample will be performed within two hours of extraction.

2.0 WATER SAMPLING FIELD PROCEDURES

2.1 The water sampling will commence at a selected depths below surface grade as determined by the supervising field geologist or agency representative according to the leaking underground fuel tank (LUFT) manual guidelines.

2.2 Water samples from the excavation bottom will be recovered in a new and disposable PVC bailer dedicated to this project. Care will be taken to recover relatively non-disturbed water from the excavation sample point. A representative bailer of water will be brought to the surface to recover a water sample. For analysis by a mobile laboratory, the water will be poured into two 40 ml VOA sample bottles with no head-space then sealed with Teflon lined caps. For analysis by an off site laboratory, then an additional one liter bottle supplied by the laboratory will be filled from the bailer. The samples will be labeled and stored on ice for delivery to the analytical laboratory.

2.3 Samples analyzed on site will immediately be delivered the mobile laboratory for extraction. All samples retained for off site chemical analysis will be stored on blue ice in a clean, covered cooler-box for transport to the laboratory. Duplicate samples (if any) will also be transported to the laboratory and refrigerated. Samples will be delivered to the laboratory within 24 hours of sampling.

3.0 SAMPLE RECORDS AND CHAIN OF CUSTODY

3.1 Sample records for each sample will contain information on sample type and source; sampling date; location; significant conditions that may impact the sampling; laboratory name; and sampling method.

3.2 A chain of positive, signature custody, and transference will be strictly maintained at all times. A hard copy of the laboratory sample results and the completed chain of custody will be provided with the technical report.