

**PERJURY STATEMENT**

Subject: RINO PACIFIC/OAKLAND TRUCK STOP  
ACEHS Fuel Leak Case No. RO0000234  
1107 5<sup>th</sup> Street, Oakland, California

" I declare under penalty of perjury, that the information and/or recommendations in the attached document or report is true or correct to the best of my knowledge"



---

Mr. Reed Rinehart  
Rino Pacific, LLC  
2401 North State Street  
Ukiah, California 95482

3/23/2011

---

Date

**RECEIVED**

2:13 pm, Jul 20, 2011

Alameda County  
Environmental Health

# Advanced GeoEnvironmental, Inc.

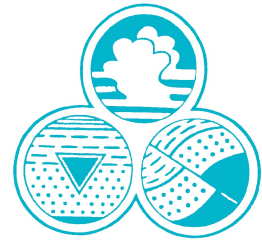

15 July 2011  
AG-NC Project No. 03-1101

Mr. Reed Rinehart  
Rinehart Oil, Inc.  
2401 North State Street  
Ukiah, California 95482

**Subject: Monitoring Well Destruction/Re-Installation Work Plan  
RINO PACIFIC/OAKLAND TRUCK STOP  
ACEHS Fuel Leak Case No. RO0000234  
1107 5<sup>th</sup> Street, Oakland, California**

Dear Mr. Rinehart:

Advanced GeoEnvironmental, Inc. has prepared the enclosed *Monitoring Well Destruction/Re-Installation Work Plan* for the above-referenced address. The scope of work includes the destruction of two ground water monitoring wells and re-installation of one ground water monitoring well. The work is being performed to destroy and re-install wells at the site that were damaged by construction activities performed by the Bay Area Rapid Transit District (BART). Copies of this work plan will be forwarded to Mr. Jerry Wickham of Alameda County Environmental Health Services (ACEHS), to Mr. Patrick Paul of R&L Brosamer, Inc. and to Mr. Ken Miller of PGH Wong Engineering, Inc.

The opportunity to provide this service is greatly appreciated. If you have any questions or comments, please contact our office at (209) 467-1006.

Sincerely,

**Advanced GeoEnvironmental, Inc.**

Brian W. Millman  
Senior Project Geologist  
California Professional Geologist No. 8574



cc: Mr. Jerry Wickham, ACEHS  
Mr. Patrick Paul, R&L Brosamer/Walsh Group  
Mr. Ken Miller, PGH Wong Engineering, Inc.

# Advanced GeoEnvironmental, Inc.

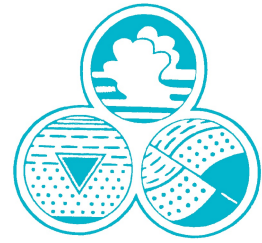

15 July 2011  
AGE-NC Project No. 03-1101

Mr. Jerry Wickham  
Alameda County Environmental Health Services  
1131 Harbor Bay Parkway, Suite 250  
Alameda, California 94502-6577

**Subject: Monitoring Well Destruction/Re-Installation Work Plan  
RINO PACIFIC/OAKLAND TRUCK STOP  
ACEHS Fuel Leak Case No. RO0000234  
1107 5<sup>th</sup> Street, Oakland, California**

Dear Mr. Wickham:

*Advanced GeoEnvironmental, Inc.* has prepared the enclosed *Monitoring Well Destruction/Re-Installation Work Plan* for the above-referenced address. The scope of work includes the destruction of two ground water monitoring wells and re-installation of one ground water monitoring well. The work is being performed to destroy and re-install wells at the site that were damaged by construction activities performed by the Bay Area Rapid Transit District (BART).

If you have any questions or require further information, please contact our office at (209) 467-1006.

Sincerely,

**Advanced GeoEnvironmental, Inc.**

Brian W. Millman  
Senior Project Geologist  
California Professional Geologist No. 8574



**Monitoring Well Destruction/Re-Installation Work Plan**  
**RINO PACIFIC/OAKLAND TRUCK STOP (ACHES Fuel Leak Case No. RO0000234)**  
**1107 5<sup>th</sup> Street, Oakland, California**

15 July 2011  
AGE-NC Project No. 03-1101

*PREPARED FOR:*

Mr. Reed Rinehart  
RINO PACIFIC, LLC

*PREPARED BY:*

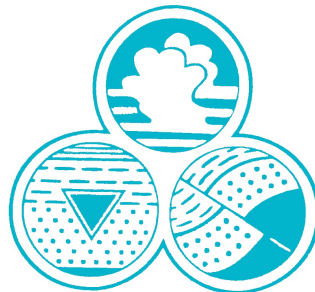

***Advanced GeoEnvironmental, Inc.***

*Stockton • Santa Rosa • Monterey • Brea • Spokane • Reno*

*(800) 511-9300*

[www.advgeoenv.com](http://www.advgeoenv.com)

**Monitoring Well Destruction/Re-Installation Work Plan  
RINO PACIFIC/OAKLAND TRUCK STOP (ACEHS Fuel Leak Case No. RO0000234)  
1107 5<sup>th</sup> Street, Oakland, California**

15 July 2011  
AGE-NC Project No. 03-1101

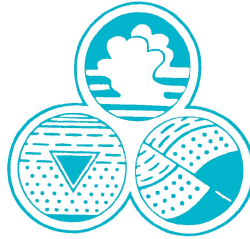

***Advanced GeoEnvironmental, Inc.***

*Stockton • Santa Rosa • Monterey • Brea • Spokane • Reno*

*(800) 511-9300*

[www.advgeoenv.com](http://www.advgeoenv.com)

**PREPARED BY:**

\_\_\_\_\_  
Brian W. Millman  
Senior Project Geologist  
California Professional Geologist No. 8574

**PROJECT MANAGER:**

\_\_\_\_\_  
Brian W. Millman  
Senior Project Geologist  
California Professional Geologist No. 8574

**REVIEWED BY:**

\_\_\_\_\_  
William R. Little  
Senior Project Geologist  
California Professional Geologist No. 7473

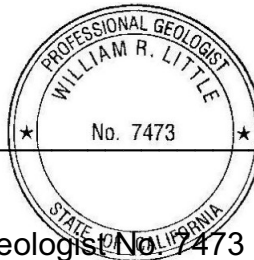

**Monitoring Well Destruction/Re-Installation Work Plan  
RINO PACIFIC/OAKLAND TRUCK STOP  
1107 5<sup>th</sup> Street, Oakland, California**

**TABLE OF CONTENTS**

| <b><u>SECTION</u></b>                                  | <b><u>PAGE</u></b> |
|--|--------------------|
| <b>1.0. INTRODUCTION.....</b>                          | <b>1</b>           |
| <b>2.0. SCOPE OF WORK AND FIELD PROCEDURES.....</b>    | <b>1</b>           |
| 2.1. PERMITTING AND PRE-FIELD WORK ACTIVITIES.....     | 2                  |
| 2.2. MONITORING WELL DESTRUCTION AND INSTALLATION..... | 2                  |
| 2.3. WELL DEVELOPMENT AND SURVEY.....                  | 3                  |
| 2.4. REPORT PREPARATION.....                           | 3                  |

**FIGURES**

- Figure 1 - *Location Map*
- Figure 2 - *Site Plan*
- Figure 3 - *Monitoring Well Design*

**TABLES**

- Table 1 - *Well Construction Details*
- Table 2 - *Ground Water Elevation Data*
- Table 3 - *Analytical Results of Ground Water Samples*

**Monitoring Well Destruction/Re-Installation Work Plan**  
**RINO PACIFIC/OAKLAND TRUCK STOP**  
**1107 5<sup>th</sup> Street, Oakland, California**

**1.0. INTRODUCTION**

*Advanced GeoEnvironmental, Inc.* has prepared the enclosed *Monitoring Well Destruction/Re-Installation Work Plan* for the above-referenced address. The scope of work includes the destruction of two ground water monitoring wells and re-installation of one ground water monitoring well. The work is being performed to destroy and re-install wells at the site that were damaged by construction activities performed by the Bay Area Rapid Transit District (BART). The site and surrounding area are illustrated in Figure 1. On-site structures, soil borings, and well locations are illustrated in Figure 2.

Between late 2010 and early 2011, construction activities were performed by BART north of the site in the location of BART's elevated tracks and off-site wells MW-12, MW-13, MW-15, and MW-16. Construction activities were performed as part of the seismic retrofit of aerial structures and stations along the Fremont Line and is part of the overall BART Earthquake Safety Program. During construction activities, monitoring well MW-16, located within the area of an expanded footing was completely removed. In addition, monitoring wells MW-12 and MW-13 were damaged to depths between 4 feet and 5 feet below surface grade (bsg) and the bentonite seals were compromised. Monitoring well MW-15 was unaffected.

AGE proposes to properly destroy wells MW-12 and MW-13 and re-install well MW-13. Based on analytical data collected from well MW-12 between October 2004 and November 2009 and from well MW-16 between January 2008 and November 2009, AGE believes additional data collected from these locations is unnecessary for site characterization. Between October 2004 and November 2009 no constituents of concern were detected in ground water samples collected from wells MW-12 and MW-16. During this same time, methyl tertiary butyl ether (MTBE) has been intermittently detected in ground water samples collected from well MW-13. AGE believes re-installing well MW-13 and continued use of existing well MW-15 will be adequate to determine ground water flow direction and gradient at the site and characterize the lateral extent of impacted ground water north of the site. Well construction details, ground water elevations, and analytical results of ground water samples are presented in Tables 1 through 3.

**2.0. SCOPE OF WORK AND FIELD PROCEDURES**

The scope of work includes the destruction of ground water monitoring wells MW-12 and MW-13 by over-drilling and re-installation of ground water monitoring well MW-13 (MW-13R). The scope of work will include the following tasks:

- Permitting and pre-field work activities;
- Destruction of two ground water monitoring wells;
- Re-Installation of one ground water monitoring well; and
- Preparation of a report of findings.

## 2.1. PERMITTING AND PRE-FIELD WORK ACTIVITIES

Applicable well destruction and installation permits will be obtained from Alameda County Public Works Agency - Water Resources Division (ACPWA-WRD). Additionally, applicable encroachment permits will be obtained from the City of Oakland. An update to the health and safety plan presently on-file will be prepared in accordance with *Occupational Safety and Health Guidance Manual for Hazardous Waste Site Activities* (National Institute for Occupational Safety and Health Administration, U.S. Coast Guard and U.S. Environmental Protection Agency, 1985). Prior to mobilization, the area of excavation will be clearly marked and a utility clearance obtained through Underground Service Alert.

## 2.2. MONITORING WELL DESTRUCTION AND INSTALLATION

Wells MW-12 and MW-13 will be over-drilled to the total depths of the wells (20 feet bsg) utilizing a CME-75 drill rig equipped with 8-inch diameter hollow stem augers. All original well construction materials will be removed (including well casing, screen, filter pack, and annular seal) to ensure that no residual contamination is sealed within the abandoned borehole. The remaining borehole for wells MW-12 and MW-13 will be backfilled to surface grade with a cement grout and covered with concrete or asphalt, depending on the surrounding surface material. Soil cuttings and rinseate generated during over-drilling activities will be containerized in properly labeled, Department of Transportation (DOT)-approved 55-gallon drums and stored on-site pending proper disposal. All down-hole and drilling equipment will be pressure washed prior to starting each boring.

Well MW-13R will be installed in a new borehole approximately three feet west of well MW-13 utilizing 2-inch diameter, Schedule 40 polyvinylchloride (PVC) blank well casing and 0.020-inch slotted well screen installed from 5 to 20 feet bsg. The pilot boring for replacement well MW-13R will be advanced utilizing a CME-75 drill rig equipped with 8-inch diameter hollow stem augers. The proposed location of well MW-13R is depicted in Figure 2. A diagram of the proposed monitoring well construction is depicted in Figure 3.

After installing the well casing a filter pack material consisting of pre-washed #2/12 Lonestar sand will be added through the augers from total depth to approximately one foot



above the screened interval. Following placement of the filter pack, the well will be surged to assist in settling the filter pack. Additional sand will be added if settling occurs.

A two-foot bentonite seal (bentonite chips) will be placed above the filter pack to minimize the potential for grout penetration into the screened section of the well. The bentonite seal will be formed by pouring bentonite chips into the annulus and allowing them to settle on the filter pack. The bentonite chips will be allowed to hydrate for a minimum of one-half hour prior to grouting. The remaining annular space will be filled to within one foot of the ground surface with a cement grout.

Grout mixtures for destruction and installation activities will consist of Type I/II portland neat cement and not more than 6 gallons of water per 94-pound sack of cement. The grout will be placed by pouring through the augers. A grouting inspection will be scheduled with ACPWA-WRD personnel prior to any application of grout.

### 2.3. WELL DEVELOPMENT AND SURVEY

Development of the proposed well will consist of a combination of bailing with a stainless steel bailer to remove the major portion of fine-grained sediment from inside the well, surging to flush out or draw in sediment from the filter pack, and additional ground water evacuation (purging) with a disposable plastic bailer or Waterra inertia pump to finish the removal of fine-grained sediment. Development activities will be continued until field parameter (pH, electrical conductivity, and temperature) readings have stabilized and purged water is visually sediment-free. Additionally, the new well-head elevation of MW-13 will be surveyed by a licensed surveyor.

### 2.4. REPORT PREPARATION

Upon completion of field work and receipt of final laboratory analysis, a report will be prepared presenting a description of the work performed and the results of the sampling and analysis. The report will be in a format acceptable to the Alameda County Environmental Health Services (ACEHS) and will be reviewed and signed by a California Professional Geologist.

# FIGURES

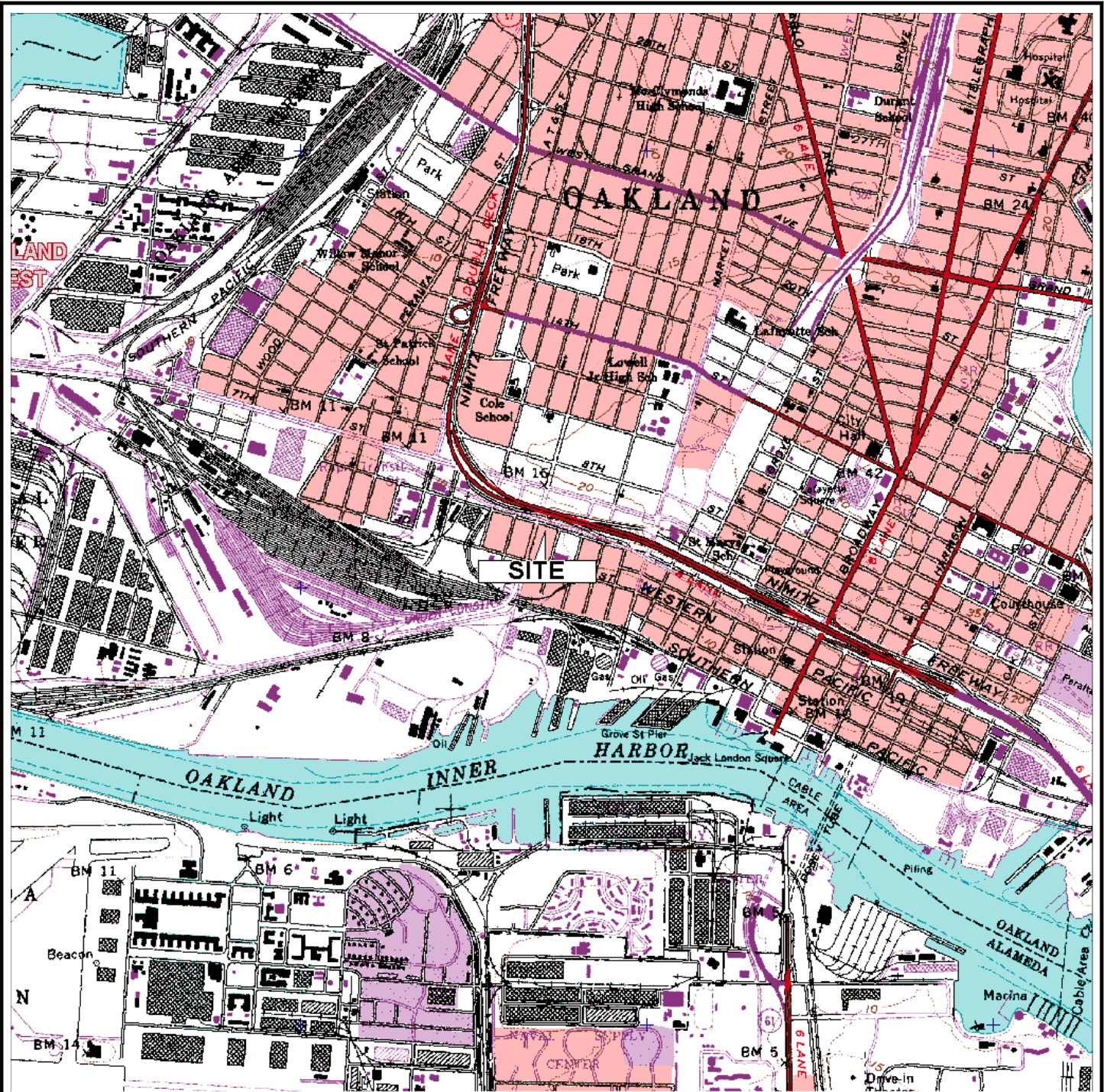

OAKLAND WEST QUADRANGLE, CALIFORNIA  
 7.5 MINUTE SERIES (U.S. GEOLOGICAL SURVEY)

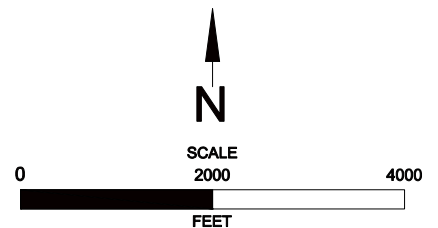

**LOCATION MAP**  
**RINO PACIFIC/OAKLAND TRUCK STOP**  
**1107 5TH STREET**  
**OAKLAND, CALIFORNIA**



*Advanced*  
**GeoEnvironmental, Inc.**  
*of Northern California*

|                            |                |         |
|----------------------------|----------------|---------|
| PROJECT NO. AGE-NC-03-1101 | FILE: LOCATION | FIGURE: |
| DATE: June 2011            | DRAWN BY: MAC  | 1       |

**SITE PLAN**  
RINO PACIFIC/OAKLAND TRUCK STOP  
1107 5TH STREET  
OAKLAND, CALIFORNIA

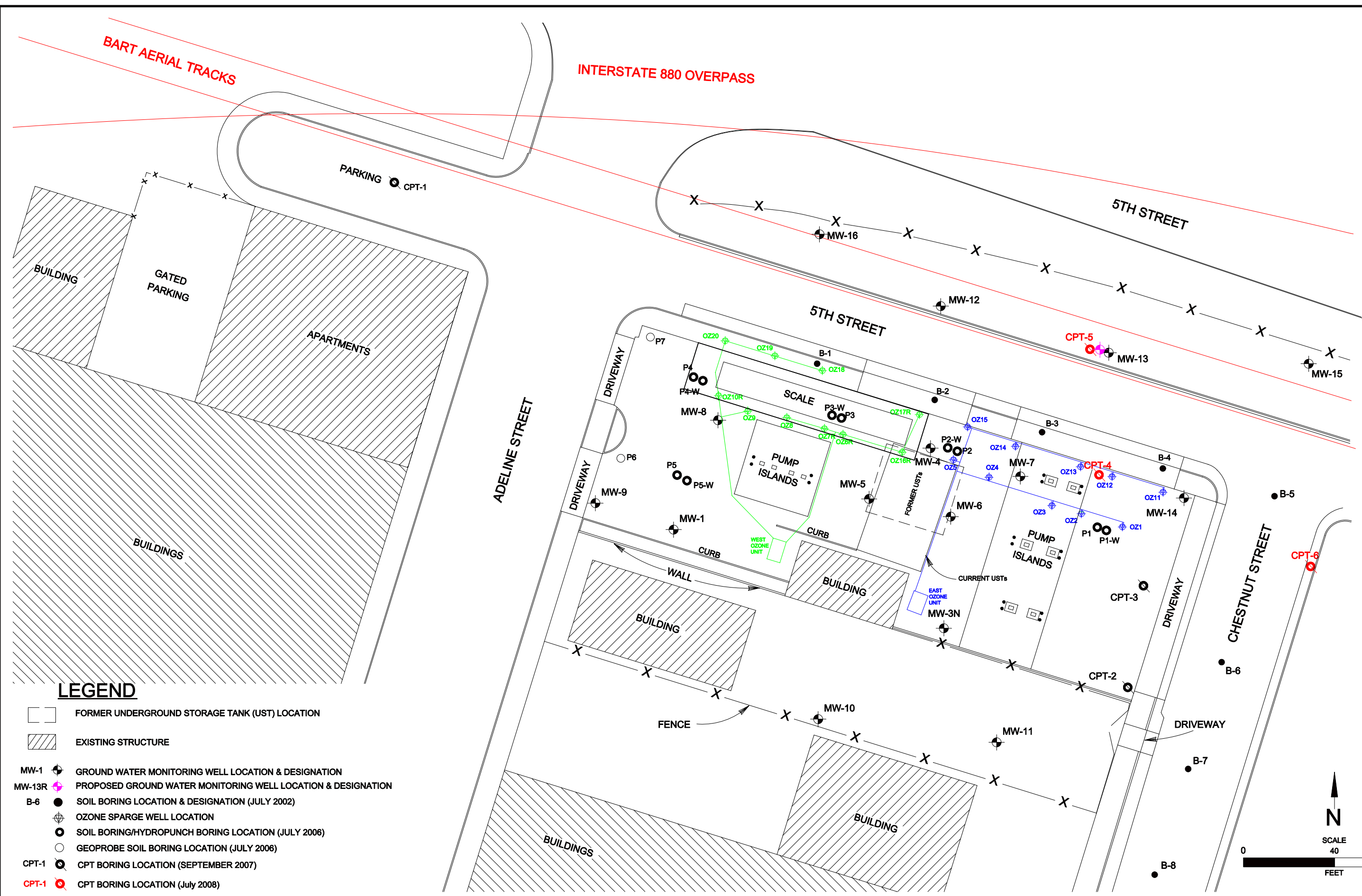

**LEGEND**

- FORMER UNDERGROUND STORAGE TANK (UST) LOCATION
- EXISTING STRUCTURE
- MW-1 

●

 GROUND WATER MONITORING WELL LOCATION & DESIGNATION
- MW-13R 

●

 PROPOSED GROUND WATER MONITORING WELL LOCATION & DESIGNATION
- B-6 

●

 SOIL BORING LOCATION & DESIGNATION (JULY 2002)
- OZONE SPARGE WELL LOCATION
- SOIL BORING/HYDROPUNCH BORING LOCATION (JULY 2006)
- GEOPROBE SOIL BORING LOCATION (JULY 2006)
- CPT-1 

●

 CPT BORING LOCATION (SEPTEMBER 2007)
- CPT-1 

●

 CPT BORING LOCATION (July 2008)

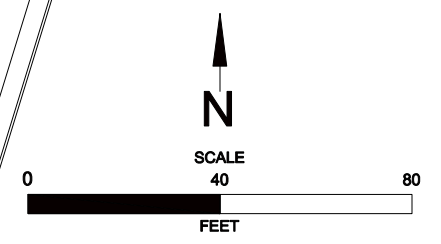



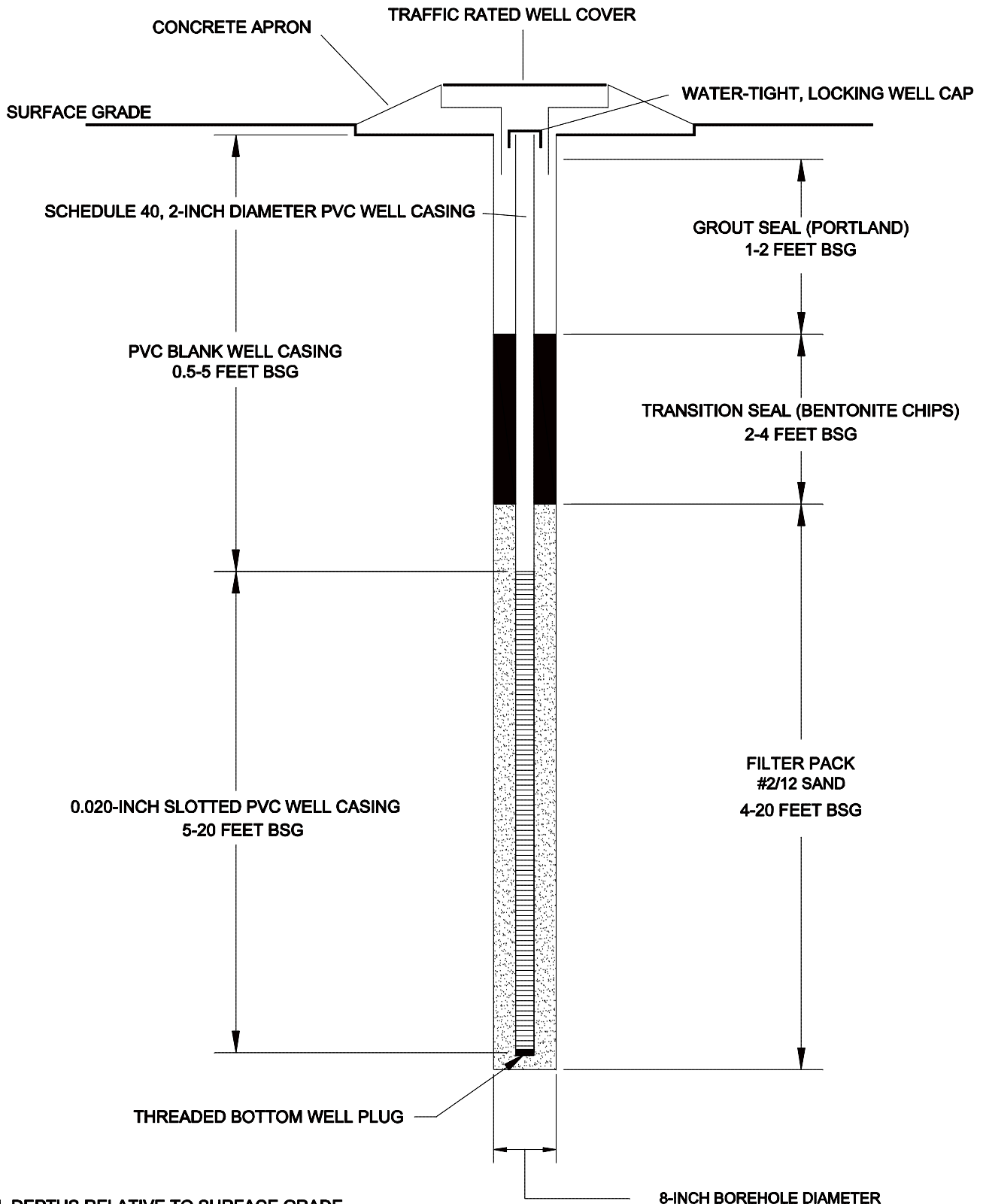

**MONITORING WELL DESIGN**  
**RINO PACIFIC/OAKLAND TRUCK STOP**  
**1107 5TH STREET**  
**OAKLAND, CALIFORNIA**



*Advanced*  
**GeoEnvironmental, Inc.**  
*of Northern California*

|                            |               |          |
|----------------------------|---------------|----------|
| PROJECT NO. AGE-NC-03-1101 | FILE: MW      | FIGURE:  |
| DATE: JULY 2011            | DRAWN BY: KMM | <b>3</b> |

# **TABLES**

**TABLE 1**  
**WELL CONSTRUCTION DETAILS**  
**Rino Pacific/Oakland Truck Stop**  
**1107 5th Street, Oakland, California**

| Well ID                              | Installation Date | Borehole Diameter (inch) | Total Depth (feet) | Casing Diameter (inch) | Casing Material | Slot Size (inch) | Filter Pack | Casing Elevation (feet MSL) <sup>1</sup> | Screen Interval (feet bsg) | Filter Pack Interval (feet bsg) | Bentonite Interval (feet bsg) | Grout Interval (feet bsg) |
|--------------------------------------|-------------------|--------------------------|--------------------|------------------------|-----------------|------------------|-------------|--|----------------------------|---------------------------------|-------------------------------|---------------------------|
| <b>GROUND WATER MONITORING WELLS</b> |                   |                          |                    |                        |                 |                  |             |  |                            |                                 |                               |                           |
| MW-1                                 | 11-1996           | 8                        | -                  | 2                      | PVC             | -                | -           | 10.02                                    | 10 to 20                   | -                               | -                             | -                         |
| MW-2                                 | 11-1996           | 8                        | -                  | 2                      | PVC             | -                | -           | -  | 12 to 17                   | -                               | -                             | -                         |
| MW-3                                 | 11-1996           | 8                        | -                  | 2                      | PVC             | -                | -           | -  | 8 to 13                    | -                               | -                             | -                         |
| MW-3N                                | 05-2002           | 8                        | 15                 | 2                      | PVC             | -                | -           | 11.36                                    | 5 to 12                    | -                               | -                             | -                         |
| MW-4                                 | 08-2000           | 8                        | 20                 | 2                      | PVC             | -                | -           | 10.16                                    | 5 to 20                    | -                               | -                             | -                         |
| MW-5                                 | 08-2000           | 8                        | -                  | 2                      | PVC             | -                | -           | 10.19                                    | 5 to 20                    | -                               | -                             | -                         |
| MW-6                                 | 08-2000           | 8                        | 20                 | 2                      | PVC             | -                | -           | 10.33                                    | 5 to 20                    | -                               | -                             | -                         |
| MW-7                                 | 08-2000           | 8                        | -                  | 2                      | PVC             | -                | -           | 11.41                                    | 5 to 20                    | -                               | -                             | -                         |
| MW-8                                 | 08-2000           | 8                        | -                  | 2                      | PVC             | -                | -           | 9.73                                     | 5 to 20                    | -                               | -                             | -                         |
| MW-9                                 | 08-2000           | 8                        | -                  | 2                      | PVC             | -                | -           | 9.73                                     | 5 to 20                    | -                               | -                             | -                         |
| MW-10                                | 05-2002           | 8                        | -                  | 2                      | PVC             | -                | -           | 9.42                                     | 5 to 12                    | -                               | -                             | -                         |
| MW-11                                | 05-2002           | 8                        | 30                 | 2                      | PVC             | -                | -           | 10.77                                    | 5 to 20                    | -                               | -                             | -                         |
| MW-12                                | 10-2004           | 8                        | 20                 | 2                      | PVC             | 0.020            | #2/12       | 10.59                                    | 5 to 20                    | 4 to 20                         | 1.5 to 4                      | 0.5 to 1.5                |
| MW-13                                | 10-2004           | 8                        | 20                 | 2                      | PVC             | 0.020            | #2/12       | 11.29                                    | 5 to 20                    | 4 to 20                         | 1.5 to 4                      | 0.5 to 1.5                |
| MW-14                                | 10-2004           | 8                        | 20                 | 2                      | PVC             | 0.020            | #2/12       | 11.39                                    | 5 to 20                    | 4 to 20                         | 1.5 to 4                      | 0.5 to 1.5                |
| MW-15                                | 09-20-2007        | 8                        | 20.5               | 2                      | PVC             | 0.010            | #2/12       | 11.38                                    | 5 to 20                    | 3 to 20.5                       | 2 to 3                        | 0.5 to 2                  |
| MW-16                                | 09-20-2007        | 8                        | 20.5               | 2                      | PVC             | 0.010            | #2/12       | 10.36                                    | 5 to 20                    | 3 to 20.5                       | 2 to 3                        | 0.5 to 2                  |

**TABLE 1**  
**WELL CONSTRUCTION DETAILS**  
 Rino Pacific/Oakland Truck Stop  
 1107 5th Street, Oakland, California

| REMEDIATION WELLS |                   |                          |             |                              |                 |                              |             |                 |                                 |                               |                           |
|-------------------|-------------------|--------------------------|-------------|------------------------------|-----------------|------------------------------|-------------|-----------------|---------------------------------|-------------------------------|---------------------------|
| Well ID           | Installation Date | Borehole Diameter (inch) | Total Depth | Blank Casing Diameter (inch) | Casing Material | Micro-sparge diameter (inch) | Filter Pack | Sparge Interval | Filter Pack Interval (feet bsg) | Bentonite Interval (feet bsg) | Grout Interval (feet bsg) |
| OZ-1 thru OZ10    | 03-2004           | 8                        | 12.5        | 1                            | PVC             | 2                            | #2/12       | 10 to 12        | 9 to 12.5                       | -                             | -                         |
| OZ-11 thru OZ20   | 10-2004           | 8                        | 15          | 1                            | PVC             | 2                            | #2/12       | 11 to 13        | 9 to 15                         | 7 to 9                        | 1.5 to 7                  |
| OZ6R              | 7/19/2007         | 8                        | 14          | 1                            | PVC             | 1                            | #3          | 11 to 13        | 9 to 14                         | 6 to 9                        | 1 to 6                    |
| OZ7R              | 7/19/2007         | 8                        | 14          | 1                            | PVC             | 1                            | #3          | 11 to 13        | 9 to 14                         | 6 to 9                        | 1 to 6                    |
| OZ10R             | 7/19/2007         | 8                        | 14          | 1                            | PVC             | 1                            | #3          | 11 to 13        | 9 to 14                         | 6 to 9                        | 1 to 6                    |
| OZ16R             | 7/19/2007         | 8                        | 14          | 1                            | PVC             | 1                            | #3          | 11 to 13        | 9 to 14                         | 6 to 9                        | 1 to 6                    |
| OZ17R             | 7/19/2007         | 8                        | 14          | 1                            | PVC             | 1                            | #3          | 11 to 13        | 9 to 14                         | 6 to 9                        | 1 to 6                    |
| DESTROYED WELLS   |                   |                          |             |                              |                 |                              |             |                 |                                 |                               |                           |
| Well ID           | Date Destroyed    |                          |             |                              |                 |                              |             |                 |                                 |                               |                           |
| MW-2              | 12-30-1998        |                          |             |                              |                 |                              |             |                 |                                 |                               |                           |
| MW-3              | 02-15-2002        |                          |             |                              |                 |                              |             |                 |                                 |                               |                           |
| OZ-6              | 04-2007           |                          |             |                              |                 |                              |             |                 |                                 |                               |                           |
| OZ-7              | 04-2007           |                          |             |                              |                 |                              |             |                 |                                 |                               |                           |
| OZ-10             | 04-2007           |                          |             |                              |                 |                              |             |                 |                                 |                               |                           |
| OZ-16             | 04-2007           |                          |             |                              |                 |                              |             |                 |                                 |                               |                           |
| OZ-17             | 04-2007           |                          |             |                              |                 |                              |             |                 |                                 |                               |                           |

Notes:

MSL: mean sea level

bsg: below surface grade

MW: monitoring well

OZ: ozone sparge well

Casing elevations re-surveyed 02/02 2007.

MW-4, MW-15 and MW-16 surveyed on 30 November 2007. Performed by Morrow Surveying, Inc. relative to vertical datum NAVD 88 from GPS observations.

- : Indicates data is not known



**TABLE 2**  
**GROUND WATER ELEVATION DATA**  
Rino Pacific/Oakland Truck Stop  
1107 5th Street, Oakland, California  
(feet)

| Well I.D. (Screen Interval)<br>Casing Elevation | Date                  | Depth to Ground Water (ft<br>btoc) | Ground Water Elevation<br>(ft MSL) |      |
|---|-----------------------|------------------------------------|------------------------------------|------|
| 10.34'  | 10/21/96              | 5.08                               | 5.26                               |      |
|   | 11/04/96              | 3.02                               | 7.32                               |      |
|   | 03/04/97              | 2.28                               | 8.06                               |      |
|   | 06/12/97              | 4.80                               | 5.54                               |      |
|   | 07/14/97              | 2.66                               | 7.68                               |      |
|   | 09/09/97              | 2.45                               | 7.89                               |      |
|   | 09/19/97              | 2.60                               | 7.74                               |      |
|   | 02/13/98              | 2.76                               | 7.58                               |      |
|   | 07/07/98              | 2.15                               | 8.19                               |      |
|   | 10/01/98              | 3.63                               | 6.71                               |      |
|   | 12/30/98              | 4.40                               | 5.94                               |      |
|   | 03/21/00              | 2.62                               | 7.72                               |      |
|   | 08/30/00              | 3.21                               | 7.13                               |      |
|   | 11/06/00              | 3.10                               | 7.24                               |      |
|   | 02/22/01              | 3.50                               | 6.84                               |      |
|   | 05/07/01              | 2.94                               | 7.40                               |      |
|   | 08/22/01              | 3.70                               | 6.64                               |      |
|   | 11/04/01              | 3.89                               | 6.45                               |      |
|   | MW-1 (10 - 20 ft bsg) | 02/15/02                           | 2.95                               | 7.39 |
|   |                       | 05/20/02                           | 3.39                               | 7.05 |
|   |                       | 08/01/02                           | 3.51                               | 6.83 |
|   |                       | 11/11/02                           | 4.00                               | 6.34 |
|   |                       | 02/12/03                           | 3.40                               | 6.94 |
|   |                       | 05/12/03                           | 3.65                               | 6.69 |
|   |                       | 08/12/03                           | 3.04                               | 7.30 |
|   |                       | 01/09/04                           | 4.64                               | 5.70 |
|   |                       | 04/14/04                           | 6.45                               | 3.89 |
| 07/21/04  |                       | 3.55                               | 6.79                               |      |
| 10/20/04  |                       | 4.00                               | 6.34                               |      |
| 03/19/05  |                       | 2.54                               | 7.80                               |      |
| 06/25/05  |                       | 2.76                               | 7.58                               |      |
| 09/17/05  |                       | 3.88                               | 6.46                               |      |
| 12/26/05  |                       | 3.83                               | 6.51                               |      |
| 03/26/06  |                       | 4.09                               | 6.25                               |      |
| 06/03/06  |                       | 2.91                               | 7.43                               |      |
| 08/30/06  |                       | 3.62                               | 6.72                               |      |
| 12/04/06  |                       | 3.98                               | 6.04                               |      |
| 10.02**   |                       | 02/28/07                           | 2.90                               | 7.12 |
|   |                       | 05/29/07                           | 3.84                               | 6.18 |
|   |                       | 08/20/07                           | 4.21                               | 5.81 |
|   |                       | 10/25/07                           | 3.75                               | 6.27 |
|   |                       | 01/25/08                           | 3.60                               | 6.42 |
|   |                       | 04/30/08                           | 3.93                               | 6.09 |
|   |                       | 07/30/08                           | 4.19                               | 5.83 |
|   |                       | 10/23/08                           | 4.57                               | 5.45 |
|   | 03/26/09              | 3.64                               | 6.38                               |      |
|   | 06/05/09              | 3.80                               | 6.22                               |      |
|   | 09/09/09              | noacc                              | -                                  |      |
|   | 11/12/09              | 3.63                               | 6.39                               |      |
|   | 02/18/10              | 3.20                               | 6.82                               |      |
|   | 05/17/10              | 3.28                               | 6.74                               |      |
|   | 11/23/10              | 3.11                               | 6.91                               |      |
| 05/20/11  | 3.47                  | 6.55                               |                                    |      |

**TABLE 2**  
**GROUND WATER ELEVATION DATA**  
 Rino Pacific/Oakland Truck Stop  
 1107 5th Street, Oakland, California  
 (feet)

| Well I.D. (Screen Interval)<br>Casing Elevation | Date     | Depth to Ground Water (ft<br>btoc) | Ground Water Elevation<br>(ft MSL) |
|---|----------|------------------------------------|------------------------------------|
| 11.67'  | 05/20/02 | 3.91                               | 7.76                               |
|   | 08/01/02 | 4.22                               | 7.45                               |
|   | 11/11/02 | 4.42                               | 7.25                               |
|   | 02/12/03 | 3.71                               | 7.96                               |
|   | 05/12/03 | 3.49                               | 8.18                               |
|   | 08/12/03 | 4.18                               | 7.49                               |
|   | 01/09/04 | 3.78                               | 7.89                               |
|   | 04/14/04 | 4.01                               | 7.66                               |
|   | 07/21/04 | 4.90                               | 6.77                               |
|   | 10/20/04 | 5.28                               | 6.39                               |
|   | 03/19/05 | 3.10                               | 8.57                               |
| MW-3N (5 - 12 ft bsg)                           | 06/25/05 | 3.10                               | 8.57                               |
|   | 06/25/05 | 3.83                               | 7.84                               |
|   | 09/17/05 | 4.94                               | 6.73                               |
|   | 12/26/05 | 3.64                               | 8.03                               |
|   | 03/23/06 | 2.86                               | 8.81                               |
|   | 06/03/06 | 3.45                               | 8.22                               |
|   | 08/30/06 | 4.78                               | 6.89                               |
|   | 12/04/06 | 4.90                               | 6.46                               |
|   | 02/28/07 | 3.36                               | 8.00                               |
|   | 05/29/07 | 4.55                               | 6.81                               |
|   | 08/20/07 | 5.40                               | 5.96                               |
| 11.36*  | 10/25/07 | 4.97                               | 6.39                               |
|   | 01/25/08 | 3.69                               | 7.67                               |
|   | 04/30/08 | 4.69                               | 6.67                               |
|   | 07/30/08 | 4.44                               | 6.92                               |
|   | 10/23/08 | 5.98                               | 5.38                               |
|   | 03/26/09 | 3.70                               | 7.66                               |
|   | 06/05/09 | 4.68                               | 6.68                               |
|   | 09/09/09 | 5.43                               | 5.93                               |
|   | 11/12/09 | 4.66                               | 6.70                               |
|   | 02/18/10 | 3.58                               | 7.78                               |
|   | 05/17/10 | 4.01                               | 7.35                               |
|   | 11/23/10 | 4.49                               | 6.87                               |
|   | 05/20/11 | 4.30                               | 7.06                               |

**TABLE 2**  
**GROUND WATER ELEVATION DATA**  
Rino Pacific/Oakland Truck Stop  
1107 5th Street, Oakland, California  
(feet)

| Well I.D. (Screen Interval)<br>Casing Elevation | Date     | Depth to Ground Water (ft<br>btoc) | Ground Water Elevation<br>(ft MSL) |
|---|----------|------------------------------------|------------------------------------|
| 10.46'  | 08/30/00 | 3.74                               | 6.72                               |
|   | 11/06/00 | 3.85                               | 6.61                               |
|   | 02/22/01 | 4.66                               | 5.80                               |
|   | 05/07/01 | 2.66                               | 7.80                               |
|   | 08/22/01 | 4.13                               | 6.33                               |
|   | 11/04/01 | 4.53                               | 5.93                               |
|   | 02/15/02 | 3.62                               | 6.84                               |
|   | 05/20/02 | 3.65                               | 6.81                               |
|   | 08/01/02 | 4.25                               | 6.21                               |
|   | 11/11/02 | 4.85                               | 5.61                               |
|   | 02/12/03 | 4.24                               | 6.22                               |
|   | 05/12/03 | 4.20                               | 6.26                               |
|   | 08/12/03 | 4.47                               | 5.99                               |
|   | 01/09/04 | 3.92                               | 6.54                               |
| MW-4 (5 - 20 ft bsg)                            | 04/14/04 | 4.04                               | 6.42                               |
|   | 07/21/04 | 4.55                               | 5.91                               |
|   | 10/20/04 | 4.89                               | 5.57                               |
|   | 03/19/05 | 3.51                               | 6.95                               |
|   | 06/25/05 | 4.58                               | 5.88                               |
|   | 09/17/05 | 4.54                               | 5.92                               |
|   | 12/26/05 | 4.66                               | 5.80                               |
|   | 03/23/06 | 3.80                               | 6.66                               |
|   | 06/03/06 | 3.84                               | 6.62                               |
|   | 08/30/06 | 4.75                               | 5.71                               |
|   | 12/04/06 | 4.91                               | 5.25                               |
|   | 02/28/07 | 4.18                               | 5.98                               |
|   | 05/29/07 | 4.28                               | 5.88                               |
|   | 08/20/07 | 4.82                               | 5.34                               |
|   | 10/25/07 | 4.36                               | 5.80                               |
| 10.16*  | 01/25/08 | 3.75                               | 6.41                               |
|   | 04/30/08 | 4.52                               | 5.64                               |
|   | 07/30/08 | 4.76                               | 5.40                               |
|   | 10/23/08 | 4.96                               | 5.20                               |
|   | 03/26/09 | 4.39                               | 5.77                               |
|   | 06/05/09 | 4.60                               | 5.56                               |
|   | 09/09/09 | 4.74                               | 5.42                               |
|   | 11/12/09 | 4.46                               | 5.70                               |
|   | 02/18/10 | 4.15                               | 6.01                               |
|   | 05/17/10 | 4.26                               | 5.90                               |
|   | 11/23/10 | 5.56                               | 4.60                               |
|   | 05/20/11 | 4.29                               | 5.87                               |

**TABLE 2**  
**GROUND WATER ELEVATION DATA**  
 Rino Pacific/Oakland Truck Stop  
 1107 5th Street, Oakland, California  
 (feet)

| Well I.D. (Screen Interval)<br>Casing Elevation | Date                 | Depth to Ground Water (ft<br>btoc) | Ground Water Elevation<br>(ft MSL) |      |
|---|----------------------|------------------------------------|------------------------------------|------|
| 10.24'  | 08/30/00             | 3.01                               | 7.23                               |      |
|   | 11/06/00             | 3.35                               | 6.89                               |      |
|   | 02/22/01             | 3.00                               | 7.24                               |      |
|   | 05/07/01             | 2.73                               | 7.51                               |      |
|   | 08/22/01             | 3.88                               | 6.36                               |      |
|   | 11/04/01             | 3.95                               | 6.29                               |      |
|   | 02/15/02             | 2.84                               | 7.40                               |      |
|   | 05/20/02             | 2.86                               | 7.38                               |      |
|   | 08/01/02             | 3.21                               | 7.03                               |      |
|   | 11/11/02             | 4.04                               | 6.20                               |      |
|   | MW-5 (5 - 20 ft bsg) | 02/12/03                           | 3.12                               | 7.12 |
|   |                      | 05/12/03                           | 3.18                               | 7.06 |
|   |                      | 08/12/03                           | 3.75                               | 6.49 |
|   |                      | 01/09/04                           | 3.18                               | 7.06 |
|   |                      | 04/14/04                           | 3.15                               | 7.09 |
|   |                      | 07/21/04                           | 4.00                               | 6.24 |
|   |                      | 10/20/04                           | 4.49                               | 5.75 |
| 03/19/05  |                      | 2.39                               | 7.85                               |      |
| 06/25/05  |                      | 2.77                               | 7.47                               |      |
| 10.19*  |                      | 09/17/05                           | 3.91                               | 6.33 |
|   |                      | 12/26/05                           | 3.46                               | 6.78 |
|   |                      | 03/23/06                           | 2.44                               | 7.80 |
|   |                      | 06/03/06                           | 2.55                               | 7.69 |
|   |                      | 08/30/06                           | 3.85                               | 6.39 |
|   |                      | 12/04/06                           | 4.37                               | 5.82 |
|   |                      | 02/28/07                           | 3.31                               | 6.88 |
|   |                      | 05/29/07                           | 4.45                               | 5.74 |
|   | 08/20/07             | 4.75                               | 5.44                               |      |
|   | 10/25/07             | 4.21                               | 5.98                               |      |
|   | 01/25/08             | 3.75                               | 6.44                               |      |
|   | 04/30/08             | 4.33                               | 5.86                               |      |
|   | 07/30/08             | 4.75                               | 5.44                               |      |
|   | 10/23/08             | 5.01                               | 5.18                               |      |
|   | 03/26/09             | 3.96                               | 6.23                               |      |
|   | 06/05/09             | 4.34                               | 5.85                               |      |
|   | 09/09/09             | 4.71                               | 5.48                               |      |
| 11/12/09  | 4.35                 | 5.84                               |                                    |      |
| 02/18/10  | 4.06                 | 6.13                               |                                    |      |
| 05/17/10  | 4.08                 | 6.11                               |                                    |      |
| 11/23/10  | 3.91                 | 6.28                               |                                    |      |
| 05/20/11  | 4.13                 | 6.06                               |                                    |      |

**TABLE 2**  
**GROUND WATER ELEVATION DATA**  
 Rino Pacific/Oakland Truck Stop  
 1107 5th Street, Oakland, California  
 (feet)

| Well I.D. (Screen Interval)<br>Casing Elevation | Date     | Depth to Ground Water (ft<br>btoc) | Ground Water Elevation<br>(ft MSL) |
|---|----------|------------------------------------|------------------------------------|
| 10.62'  | 08/30/00 | 3.40                               | 7.22                               |
|   | 11/06/00 | 3.72                               | 6.90                               |
|   | 02/22/01 | 3.34                               | 7.28                               |
|   | 05/07/01 | 3.08                               | 7.54                               |
|   | 08/22/01 | 3.77                               | 6.85                               |
|   | 11/04/01 | 4.33                               | 6.29                               |
|   | 02/15/02 | 3.22                               | 7.40                               |
|   | 05/20/02 | 3.24                               | 7.38                               |
|   | 08/01/02 | 3.60                               | 7.02                               |
|   | 11/11/02 | 4.41                               | 6.21                               |
|   | 02/12/03 | 3.52                               | 7.10                               |
|   | 05/12/03 | 3.34                               | 7.28                               |
|   | 08/12/03 | 3.91                               | 6.71                               |
|   | 01/09/04 | 3.35                               | 7.27                               |
|   | 04/14/04 | 3.40                               | 7.22                               |
|   | 07/21/04 | 4.21                               | 6.41                               |
|   | 10/20/04 | 4.63                               | 5.99                               |
|   | 03/19/05 | 2.54                               | 8.08                               |
|   | 06/25/05 | 2.92                               | 7.70                               |
|   | 09/17/05 | 4.06                               | 6.56                               |
| 12/26/05  | 3.63     | 6.99                               |                                    |
| 03/23/06  | 2.60     | 8.02                               |                                    |
| 06/03/06  | 2.71     | 7.91                               |                                    |
| 08/30/06  | 4.02     | 6.60                               |                                    |
| 12/04/06  | 4.54     | 5.79                               |                                    |
| 02/28/07  | 3.49     | 6.84                               |                                    |
| 05/29/07  | 4.60     | 5.73                               |                                    |
| 08/20/07  | 4.90     | 5.58                               |                                    |
| 10.33**   | 10/25/07 | 4.36                               | 5.97                               |
|   | 01/25/08 | 3.92                               | 6.41                               |
|   | 04/30/08 | 4.49                               | 5.84                               |
|   | 07/30/08 | 4.87                               | 5.46                               |
|   | 10/23/08 | 5.18                               | 5.15                               |
|   | 03/26/09 | 4.08                               | 6.25                               |
|   | 06/05/09 | 4.50                               | 5.83                               |
|   | 09/09/09 | 4.87                               | 5.46                               |
|   | 11/12/09 | 4.50                               | 5.83                               |
|   | 02/18/10 | 3.95                               | 6.38                               |
| 05/17/10  | 4.23     | 6.10                               |                                    |
| 05/20/11  | 4.30     | 6.03                               |                                    |

**TABLE 2**  
**GROUND WATER ELEVATION DATA**  
Rino Pacific/Oakland Truck Stop  
1107 5th Street, Oakland, California  
(feet)

| Well I.D. (Screen Interval)<br>Casing Elevation | Date     | Depth to Ground Water (ft<br>btoc) | Ground Water Elevation<br>(ft MSL) |
|---|----------|------------------------------------|------------------------------------|
| 11.69'  | 08/30/00 | 6.72                               | 4.97                               |
|   | 11/06/00 | 6.85                               | 4.84                               |
|   | 02/22/01 | 6.00                               | 5.69                               |
|   | 05/07/01 | 6.35                               | 5.34                               |
|   | 08/22/01 | 6.86                               | 4.84                               |
|   | 11/04/01 | 6.66                               | 5.03                               |
|   | 02/15/02 | 6.45                               | 5.24                               |
|   | 05/20/02 | 6.59                               | 5.10                               |
|   | 08/01/02 | 6.72                               | 4.97                               |
|   | 11/11/02 | 6.61                               | 5.08                               |
|   | 02/12/03 | 5.64                               | 6.05                               |
|   | 05/12/03 | 5.68                               | 6.01                               |
|   | 08/12/03 | 6.24                               | 5.45                               |
|   | 01/09/04 | 5.65                               | 6.04                               |
|   | 04/14/04 | 6.40                               | 5.29                               |
|   | 07/21/04 | 6.31                               | 5.38                               |
|   | 10/20/04 | 6.42                               | 5.27                               |
|   | 03/19/05 | 5.48                               | 6.21                               |
|   | 06/25/05 | 6.00                               | 5.69                               |
|   | 09/17/05 | 6.55                               | 5.14                               |
|   | 12/26/05 | 5.57                               | 6.12                               |
|   | 03/23/06 | 5.47                               | 6.22                               |
|   | 06/03/06 | 5.62                               | 6.07                               |
|   | 08/30/06 | 6.17                               | 5.52                               |
|   | 12/04/06 | 6.38                               | 5.03                               |
|   | 02/28/07 | 6.11                               | 5.30                               |
|   | 05/29/07 | 6.25                               | 5.16                               |
| 08/20/07  | 6.65     | 4.76                               |                                    |
| 11.41**   | 10/25/07 | 6.55                               | 4.86                               |
|   | 01/25/08 | 6.30                               | 5.11                               |
|   | 04/30/08 | 6.54                               | 4.87                               |
|   | 07/30/08 | 6.50                               | 4.91                               |
|   | 10/23/08 | 6.67                               | 4.74                               |
|   | 03/26/09 | 5.91                               | 5.50                               |
|   | 06/05/09 | 6.35                               | 5.06                               |
|   | 09/09/09 | 6.73                               | 4.68                               |
|   | 11/12/09 | 6.47                               | 4.94                               |
|   | 02/18/10 | 5.97                               | 5.44                               |
|   | 05/17/10 | 5.74                               | 5.67                               |
| 11/23/10  | 6.05     | 5.36                               |                                    |
| 05/20/11  | 5.65     | 5.76                               |                                    |

**TABLE 2**  
**GROUND WATER ELEVATION DATA**  
Rino Pacific/Oakland Truck Stop  
1107 5th Street, Oakland, California  
(feet)

| Well I.D. (Screen Interval)<br>Casing Elevation | Date      | Depth to Ground Water (ft<br>btoc) | Ground Water Elevation<br>(ft MSL) |
|---|-----------|------------------------------------|------------------------------------|
| 10.06'  | 08/30/00  | 3.06                               | 7.00                               |
|   | 11/06/00  | 2.98                               | 7.08                               |
|   | 02/22/01  | 2.46                               | 7.60                               |
|   | 05/07/01  | 2.76                               | 7.30                               |
|   | 08/22/01  | 3.56                               | 6.50                               |
|   | 11/04/01  | 3.76                               | 6.30                               |
|   | 02/15/02  | 2.72                               | 7.34                               |
|   | 05/20/02  | 2.82                               | 7.24                               |
|   | 08/01/02  | 3.06                               | 7.00                               |
|   | 11/11/02  | 3.54                               | 6.52                               |
| 9.73**  | 02/12/03  | 3.07                               | 6.99                               |
|   | 05/12/03  | 2.69                               | 7.37                               |
|   | 08/12/03  | 3.10                               | 6.96                               |
|   | 01/09/04  | 2.85                               | 7.21                               |
|   | 04/14/04  | 3.45                               | 6.61                               |
|   | 07/21/04  | 4.56                               | 5.50                               |
|   | 10/20/04  | 4.72                               | 5.34                               |
|   | 03/19/05  | 3.31                               | 6.75                               |
|   | 06/25/05  | 3.05                               | 7.01                               |
|   | 09/17/05  | 4.22                               | 5.84                               |
| MW-8 (5 - 20 ft bsg)                            | 12/26/05  | 3.24                               | 6.82                               |
|   | 03/23/06  | 2.67                               | 7.39                               |
|   | 06/03/06  | 2.63                               | 7.43                               |
|   | 08/30/06  | 3.56                               | 6.50                               |
|   | 12/04/06* | 3.81                               | 5.92                               |
|   | 02/28/07  | 3.06                               | 6.67                               |
|   | 05/29/07  | 3.77                               | 5.96                               |
|   | 08/20/07  | 4.21                               | 5.52                               |
|   | 10/25/07  | 3.96                               | 5.77                               |
|   | 01/25/08  | 2.97                               | 6.76                               |
| 04/30/08  | 3.85      | 5.88                               |                                    |
| 07/30/08  | 4.16      | 5.57                               |                                    |
| 10/23/08  | 4.48      | 5.25                               |                                    |
| 03/26/09  | 3.25      | 6.48                               |                                    |
| 06/05/09  | 3.70      | 6.03                               |                                    |
| 09/09/09  | 4.10      | 5.63                               |                                    |
| 11/12/09  | 3.79      | 5.94                               |                                    |
| 02/18/10  | 3.19      | 6.54                               |                                    |
| 05/17/10  | 3.30      | 6.43                               |                                    |
| 11/23/10  | 3.21      | 6.52                               |                                    |
| 05/20/11  | 3.45      | 6.28                               |                                    |

**TABLE 2**  
**GROUND WATER ELEVATION DATA**  
Rino Pacific/Oakland Truck Stop  
1107 5th Street, Oakland, California  
(feet)

| Well I.D. (Screen Interval)<br>Casing Elevation | Date     | Depth to Ground Water (ft<br>btoc) | Ground Water Elevation<br>(ft MSL) |
|---|----------|------------------------------------|------------------------------------|
| 10.03'  | 08/30/00 | 2.81                               | 7.22                               |
|   | 11/06/00 | 2.68                               | 7.35                               |
|   | 02/22/01 | 2.20                               | 7.83                               |
|   | 05/07/01 | 2.75                               | 7.28                               |
|   | 08/22/01 | 3.80                               | 6.23                               |
|   | 11/04/01 | 3.61                               | 6.42                               |
|   | 02/15/02 | 2.92                               | 7.11                               |
|   | 05/20/02 | 2.38                               | 7.65                               |
| MW-9 (5 - 20 ft bsg)                            | 08/01/02 | 2.72                               | 7.31                               |
|   | 11/11/02 | 2.87                               | 7.16                               |
|   | 02/12/03 | 2.43                               | 7.60                               |
|   | 05/12/03 | 2.41                               | 7.62                               |
|   | 08/12/03 | 2.61                               | 7.42                               |
|   | 01/09/04 | 2.87                               | 7.16                               |
|   | 04/14/04 | 3.65                               | 6.38                               |
|   | 07/21/04 | 3.70                               | 6.33                               |
| 9.73'   | 10/20/04 | 4.20                               | 5.83                               |
|   | 03/19/05 | 3.75                               | 6.28                               |
|   | 06/25/05 | 3.85                               | 6.18                               |
|   | 09/17/05 | 3.38                               | 6.65                               |
|   | 12/26/05 | 2.01                               | 8.02                               |
|   | 03/23/06 | 2.50                               | 7.53                               |
|   | 06/03/06 | 2.63                               | 7.40                               |
|   | 08/30/06 | 3.35                               | 6.68                               |
|   | 12/04/06 | 3.63                               | 6.10                               |
|   | 02/28/07 | 2.61                               | 7.12                               |
|   | 05/29/07 | 3.34                               | 6.39                               |
|   | 08/20/07 | 3.82                               | 5.91                               |
|   | 10/25/07 | 3.21                               | 6.52                               |
|   | 01/25/08 | 2.62                               | 7.11                               |
|   | 04/30/08 | 3.55                               | 6.18                               |
|   | 07/30/08 | 4.05                               | 5.68                               |
|   | 10/23/08 | 3.96                               | 5.77                               |
|   | 03/26/09 | 3.21                               | 6.52                               |
|   | 06/05/09 | 3.25                               | 6.48                               |
|   | 09/09/09 | noacc                              | -                                  |
|   | 11/12/09 | 3.19                               | 6.54                               |
|   | 02/18/10 | 2.82                               | 6.91                               |
|   | 05/17/10 | 2.79                               | 6.94                               |
|   | 11/23/10 | 2.81                               | 6.92                               |
|   | 05/20/11 | 9.24                               | 0.49                               |



**TABLE 2**  
**GROUND WATER ELEVATION DATA**  
 Rino Pacific/Oakland Truck Stop  
 1107 5th Street, Oakland, California  
 (feet)

| Well I.D. (Screen Interval)<br>Casing Elevation | Date     | Depth to Ground Water (ft<br>btoc) | Ground Water Elevation<br>(ft MSL) |
|---|----------|------------------------------------|------------------------------------|
| 11.07'  | 05/20/02 | 4.54                               | 6.53                               |
|   | 06/18/02 | 4.25                               | 6.82                               |
|   | 08/01/02 | 1.80                               | 9.27                               |
|   | 11/11/02 | 1.50                               | 9.57                               |
|   | 02/12/03 | 1.07                               | 10.00                              |
|   | 05/12/03 | 1.01                               | 10.06                              |
|   | 08/12/03 | 1.44                               | 9.63                               |
|   | 01/09/04 | 0.90                               | 10.17                              |
|   | 04/14/04 | 2.05                               | 9.02                               |
|   | 07/21/04 | 2.78                               | 8.29                               |
|   | 10/20/04 | 1.05                               | 10.02                              |
| MW-10 (5 - 12 ft bsg)                           | 03/19/05 | 0.75                               | 10.32                              |
|   | 06/25/05 | 1.91                               | 9.16                               |
|   | 09/17/05 | 2.90                               | 8.17                               |
|   | 12/26/05 | 0.32                               | 10.75                              |
|   | 03/23/06 | 0.76                               | 10.31                              |
|   | 06/03/06 | 1.65                               | 9.42                               |
|   | 08/30/06 | 2.70                               | 8.37                               |
|   | 12/04/06 | 2.41                               | 7.01                               |
|   | 02/28/07 | 0.30                               | 9.12                               |
|   | 05/29/07 | 2.17                               | 7.25                               |
|   | 08/20/07 | 3.04                               | 6.38                               |
| 9.42'   | 10/25/07 | 2.23                               | 7.19                               |
|   | 01/25/08 | 0.58                               | 8.84                               |
|   | 04/30/08 | 2.28                               | 7.14                               |
|   | 07/30/08 | 3.07                               | 6.35                               |
|   | 10/23/08 | 3.62                               | 5.80                               |
|   | 03/26/09 | 1.30                               | 8.12                               |
|   | 06/05/09 | 2.13                               | 7.29                               |
|   | 09/09/09 | 2.87                               | 6.55                               |
|   | 11/12/09 | 1.88                               | 7.54                               |
|   | 02/18/10 | 1.25                               | 8.17                               |
|   | 05/17/10 | 1.53                               | 7.89                               |
|   | 11/23/10 | noacc                              | -                                  |
|   | 05/20/11 | noacc                              | -                                  |

**TABLE 2**  
**GROUND WATER ELEVATION DATA**  
Rino Pacific/Oakland Truck Stop  
1107 5th Street, Oakland, California  
(feet)

| Well I.D. (Screen Interval)<br>Casing Elevation | Date     | Depth to Ground Water (ft<br>btoc) | Ground Water Elevation<br>(ft MSL) |
|---|----------|------------------------------------|------------------------------------|
| 9.64'   | 05/20/02 | 0.84                               | 8.80                               |
|   | 06/18/02 | 1.71                               | 7.93                               |
|   | 08/01/02 | 4.88                               | 4.76                               |
|   | 11/11/02 | 5.18                               | 4.46                               |
|   | 02/12/03 | 3.85                               | 5.79                               |
|   | 05/12/03 | 4.00                               | 5.64                               |
|   | 08/12/03 | 4.31                               | 5.33                               |
|   | 01/09/04 | 3.74                               | 5.90                               |
|   | 04/14/04 | 5.73                               | 3.91                               |
|   | 07/21/04 | 5.80                               | 3.84                               |
|   | 10/20/04 | --                                 | --                                 |
| MW-11 (5 - 20 ft bsg)                           | 03/19/05 | 4.81                               | 4.83                               |
|   | 06/25/05 | 4.56                               | 5.08                               |
|   | 09/17/05 | 5.30                               | 4.34                               |
|   | 12/26/05 | 5.11                               | 4.53                               |
|   | 03/23/06 | 3.35                               | 6.29                               |
|   | 06/03/06 | 3.65                               | 5.99                               |
|   | 08/30/06 | 4.94                               | 4.70                               |
|   | 12/04/06 | 5.43                               | 5.34                               |
|   | 02/28/07 | 4.20                               | 6.57                               |
|   | 05/29/07 | 4.75                               | 6.02                               |
|   | 08/20/07 | 5.53                               | 5.24                               |
| 10.77**   | 10/25/07 | 5.64                               | 5.06                               |
|   | 01/25/08 | 4.46                               | 6.31                               |
|   | 04/30/08 | 4.82                               | 5.95                               |
|   | 07/30/08 | 5.48                               | 5.29                               |
|   | 10/23/08 | 6.02                               | 4.75                               |
|   | 03/26/09 | 3.98                               | 6.79                               |
|   | 06/05/09 | 4.19                               | 6.58                               |
|   | 09/09/09 | 5.59                               | 5.18                               |
|   | 11/12/09 | 5.05                               | 5.72                               |
|   | 02/18/10 | 4.08                               | 6.69                               |
|   | 05/17/10 | 3.61                               | 7.16                               |
|   | 11/23/10 | noacc                              | -                                  |
|   | 05/20/11 | 3.89                               | 6.88                               |



**TABLE 2**  
**GROUND WATER ELEVATION DATA**  
Rino Pacific/Oakland Truck Stop  
1107 5th Street, Oakland, California  
(feet)

| Well I.D. (Screen Interval)<br>Casing Elevation | Date     | Depth to Ground Water (ft<br>btoc) | Ground Water Elevation<br>(ft MSL) |
|---|----------|------------------------------------|------------------------------------|
| 11.39*<br><br>MW-14 (5 - 20 ft bsg)             | 10/20/04 | 6.36                               | --                                 |
|   | 03/19/05 | 5.20                               | --                                 |
|   | 06/25/05 | 5.56                               | --                                 |
|   | 09/17/05 | 6.09                               | --                                 |
|   | 12/26/05 | 5.50                               | --                                 |
|   | 03/23/06 | 5.06                               | --                                 |
|   | 06/03/06 | 5.39                               | --                                 |
|   | 08/30/06 | 5.92                               | --                                 |
|   | 12/04/06 | 6.15                               | 5.24                               |
|   | 02/28/07 | 5.84                               | 5.55                               |
|   | 05/29/07 | 5.97                               | 5.42                               |
|   | 08/20/07 | 6.43                               | 4.96                               |
|   | 10/25/07 | 6.37                               | 5.02                               |
|   | 01/25/08 | 6.13                               | 5.26                               |
|   | 04/30/08 | 6.42                               | 4.97                               |
|   | 07/30/08 | 6.35                               | 5.04                               |
|   | 10/23/08 | 6.56                               | 4.83                               |
|   | 03/26/09 | 5.80                               | 5.59                               |
|   | 06/05/09 | 6.25                               | 5.14                               |
|   | 09/09/09 | 6.63                               | 4.76                               |
| 11/12/09  | 6.31     | 5.08                               |                                    |
| 02/18/10  | 5.75     | 5.64                               |                                    |
| 05/17/10  | 5.65     | 5.74                               |                                    |
| 11/23/10  | 6.00     | 5.39                               |                                    |
| 05/20/11  | 5.60     | 5.79                               |                                    |
| 11.38*<br><br>MW-15 (5 - 20 ft bsg)             | 10/05/07 | 6.14                               | 5.24                               |
|   | 10/25/07 | 6.00                               | 5.38                               |
|   | 01/25/08 | 5.76                               | 5.62                               |
|   | 04/30/08 | 6.01                               | 5.37                               |
|   | 07/30/08 | 5.98                               | 5.40                               |
|   | 10/23/08 | 6.20                               | 5.18                               |
|   | 03/26/09 | 5.45                               | 5.93                               |
|   | 06/05/09 | 5.90                               | 5.48                               |
|   | 09/09/09 | 6.28                               | 5.10                               |
|   | 11/12/09 | 5.97                               | 5.41                               |
|   | 02/18/10 | 5.45                               | 5.93                               |
|   | 05/17/10 | noacc                              | -                                  |
|   | 11/23/10 | noacc                              | -                                  |
| 05/20/11  | noacc    | -                                  |                                    |

**TABLE 2**  
**GROUND WATER ELEVATION DATA**  
 Rino Pacific/Oakland Truck Stop  
 1107 5th Street, Oakland, California  
 (feet)

| Well I.D. (Screen Interval)<br>Casing Elevation | Date     | Depth to Ground Water (ft<br>btoc) | Ground Water Elevation<br>(ft MSL) |
|---|----------|------------------------------------|------------------------------------|
| 10.36*  | 10/05/07 | 5.85                               | 4.51                               |
|   | 10/25/07 | 5.51                               | 4.85                               |
|   | 01/25/08 | 4.71                               | 5.65                               |
|   | 04/30/08 | 5.70                               | 4.66                               |
|   | 07/30/08 | 5.64                               | 4.72                               |
|   | 10/23/08 | 5.90                               | 4.46                               |
|   | 03/26/09 | 4.80                               | 5.56                               |
| MW-16 (5 - 20 ft bsg)                           | 06/05/09 | 5.42                               | 4.94                               |
|   | 09/09/09 | 5.70                               | 4.66                               |
|   | 11/12/09 | 5.34                               | 5.02                               |
|   | 02/18/10 | 4.72                               | 5.64                               |
|   | 05/17/10 | 4.97                               | 5.39                               |
|   | 11/23/10 | noacc                              | -                                  |
|   | 05/20/11 | noacc                              | -                                  |

Notes:

bsg: below surface grade  
 -: information not available  
 \*: Casing elevations re-surveyed 02/02 2007.  
 MW-4, MW-15 and MW-16 surveyed on  
 30 November 2007. Performed by Morrow  
 Surveying, Inc. relative to vertical datum  
 NAVD 88 from GPS observations.

**TABLE 3**  
**ANALYTICAL RESULTS OF GROUND WATER SAMPLES**  
**Rino Pacific/Oakland Truck Stop**  
**1107 5th Street, Oakland, California**  
**(µg/l)**

| Sample ID | Date     | 8015M |       | 8260B |         |         |               |               |      |      |      |      |      |         | 8021  |
|-----------|----------|-------|-------|-------|---------|---------|---------------|---------------|------|------|------|------|------|---------|-------|
|           |          | TPH-g | TPH-d | MTBE  | Benzene | Toluene | Ethyl-benzene | Total Xylenes | DIPE | ETBE | TAME | TBA  | EDB  | 1,2-DCA | MTBE  |
| MW-1      | 11/04/96 | ND    | 220   | -     | ND      | ND      | ND            | ND            | -    | -    | -    | -    | -    | -       | -     |
|           | 03/05/97 | ND    | 230   | -     | ND      | ND      | ND            | ND            | -    | -    | -    | -    | -    | -       | -     |
|           | 06/12/97 | ND    | 290   | -     | ND      | ND      | ND            | ND            | -    | -    | -    | -    | -    | -       | -     |
|           | 09/09/07 | ND    | 180   | -     | ND      | ND      | ND            | ND            | -    | -    | -    | -    | -    | -       | -     |
|           | 02/13/98 | ND    | 590   | -     | ND      | ND      | ND            | ND            | -    | -    | -    | -    | -    | -       | -     |
|           | 07/07/98 | ND    | 1,400 | 2.7   | ND      | ND      | ND            | ND            | -    | -    | -    | -    | -    | -       | -     |
|           | 10/01/98 | ND    | 1,100 | 1.8   | ND      | ND      | ND            | ND            | -    | -    | -    | -    | -    | -       | -     |
|           | 12/30/98 | ND    | 1,700 | 2.3   | ND      | ND      | ND            | ND            | -    | -    | -    | -    | -    | -       | -     |
|           | 03/21/00 | 220   | 3,100 | 4,800 | 11      | ND      | ND            | ND            | -    | -    | -    | -    | -    | -       | -     |
|           | 08/30/00 | 140   | 1,600 | -     | 5.3     | <0.5    | <0.5          | <0.5          | -    | -    | -    | -    | -    | -       | 2,900 |
|           | 11/06/00 | 51    | 1,500 | 2,100 | 1       | <0.5    | <0.5          | <0.5          | <50  | <50  | <50  | <250 | <50  | <50     | 1,700 |
|           | 02/22/01 | 140   | 3,000 | 1,100 | <0.5    | <0.5    | <0.5          | <0.5          | <20  | <20  | <20  | <100 | <20  | <20     | 100   |
|           | 05/07/01 | <50   | 3,800 | 1,100 | <0.5    | <0.5    | <0.5          | <0.5          | <20  | <20  | <20  | <100 | <20  | <20     | 780   |
|           | 08/22/01 | <110  | 1,800 | 1,600 | <0.5    | <0.5    | <0.5          | <0.5          | <25  | <25  | <25  | <130 | <25  | <25     | 1,900 |
|           | 11/04/01 | <50   | 1,300 | 1,500 | <0.5    | <0.5    | <0.5          | <0.5          | <50  | <50  | <50  | <250 | <50  | <50     | 1,600 |
|           | 02/15/02 | <50   | 2,000 | 770   | <0.5    | <0.5    | <0.5          | <0.5          | <20  | <20  | <20  | <100 | <20  | <20     | 610   |
|           | 05/20/02 | <50   | 160   | 730   | <0.5    | <0.5    | <0.5          | <0.5          | <10  | <10  | <10  | <100 | <10  | <10     | 570   |
|           | 08/01/02 | <50   | 600   | 610   | <0.5    | <0.5    | <0.5          | <0.5          | <10  | <10  | <10  | <100 | <10  | <10     | 480   |
|           | 11/11/02 | <50   | 2,200 | 600   | <0.5    | <0.5    | <0.5          | <0.5          | <10  | <10  | <10  | <100 | <10  | <10     | 510   |
|           | 02/12/03 | <50   | 1,200 | 640   | <0.5    | <0.5    | <0.5          | <0.5          | <10  | <10  | <10  | <100 | <10  | <10     | 540   |
|           | 05/12/03 | <50   | 520   | 580   | <0.5    | <0.5    | <0.5          | <0.5          | <10  | <10  | <10  | <100 | <10  | <10     | 610   |
|           | 08/11/03 | <50   | 180   | 660   | <0.5    | <0.5    | <0.5          | <0.5          | <12  | <12  | <12  | <120 | <12  | <12     | 740   |
|           | 01/09/04 | 610   | <50   | 590   | <0.5    | <0.5    | <0.5          | 4.2           | <1.0 | <1.0 | <1.0 | <10  | <1.0 | <1.0    | -     |
|           | 04/14/04 | 730   | <50   | 730   | <0.5    | <0.5    | <0.5          | <0.6          | <1.0 | <1.0 | <1.0 | <10  | <1.0 | <1.0    | -     |
|           | 07/21/04 | 900   | <50   | 620   | <0.5    | <0.5    | <0.5          | <0.6          | <1.0 | <1.0 | <1.0 | <10  | <1.0 | <1.0    | -     |
|           | 10/20/04 | <50   | <50   | 60    | <0.5    | <0.5    | <0.5          | <0.6          | <1.0 | <1.0 | <1.0 | <10  | <1.0 | <1.0    | -     |
|           | 03/19/05 | 100   | <50   | 100   | <0.5    | <0.5    | <0.5          | <0.6          | <1.0 | <1.0 | <1.0 | <10  | <1.0 | <1.0    | -     |
|           | 06/25/05 | 100   | <50   | 100   | <0.5    | <0.5    | <0.5          | <0.6          | <1.0 | <1.0 | <1.0 | <10  | <1.0 | <1.0    | -     |
|           | 09/17/05 | 100   | <50   | 83    | <0.5    | <0.5    | <0.5          | <0.6          | <1.0 | <1.0 | <1.0 | <10  | <1.0 | <1.0    | -     |
|           | 12/26/05 | 100   | <50   | 86    | <0.5    | <0.5    | <0.5          | <0.6          | <1.0 | <1.0 | <1.0 | <10  | <1.0 | <1.0    | -     |
|           | 03/23/06 | <50   | <50   | 13    | <0.5    | <0.5    | <0.5          | <0.6          | <1.0 | <1.0 | <1.0 | <10  | <0.5 | <0.5    | -     |
|           | 06/03/06 | <50   | <50   | 16    | <0.5    | <0.5    | <0.5          | <0.6          | <1.0 | <1.0 | <1.0 | <10  | <0.5 | <0.5    | -     |
| 08/30/06  | <50      | <50   | 7     | <0.5  | <0.5    | <0.5    | <0.6          | <1.0          | <1.0 | <1.0 | <10  | <0.5 | <0.5 | -       |       |
| 12/04/06  | <50      | <50   | 63    | <0.5  | <0.5    | <0.5    | <0.6          | <1.0          | <1.0 | <1.0 | 62   | <0.5 | <0.5 | -       |       |
| 02/28/07  | <50      | <50   | 11    | <0.5  | <0.5    | <0.5    | <0.6          | <1.0          | <1.0 | <1.0 | <10  | <0.5 | <0.5 | -       |       |
| 05/29/07  | <50      | <50   | 45    | <0.5  | <0.5    | <0.5    | <0.6          | <1.0          | <1.0 | <1.0 | <10  | <0.5 | <0.5 | -       |       |
| 08/20/07  | <50      | <50   | 4.9   | <0.5  | <0.5    | <0.5    | <0.6          | <1.0          | <1.0 | <1.0 | <10  | <0.5 | <0.5 | -       |       |
| 10/25/07  | <50      | <50   | 31    | <0.5  | <0.5    | <0.5    | <0.6          | <1.0          | <1.0 | <1.0 | <10  | <0.5 | <0.5 | -       |       |
| 01/25/08  | <50      | <50   | <1.0  | <0.5  | <0.5    | <0.5    | <0.6          | <1.0          | <1.0 | <1.0 | <10  | <0.5 | <0.5 | -       |       |
| 04/30/08  | <50      | 8,800 | <1.0  | <0.5  | <0.5    | <0.5    | <0.6          | <1.0          | <1.0 | <1.0 | <10  | <0.5 | <0.5 | -       |       |
| 07/30/08  | <50      | 5,700 | <1.0  | <0.5  | <0.5    | <0.5    | <0.6          | <1.0          | <1.0 | <1.0 | <10  | <0.5 | <0.5 | -       |       |
| 10/23/08  | <50      | 3,300 | <1.0  | <0.5  | <0.5    | <0.5    | <0.6          | <1.0          | <1.0 | <1.0 | <10  | <0.5 | <0.5 | -       |       |
| 11/12/09  | <50      | 1,900 | <1.0  | <0.5  | <0.5    | <0.5    | <0.6          | -             | -    | <1.0 | <10  | -    | -    | -       |       |
| 11/23/10  | <50      | <50   | <1.0  | <0.5  | <0.5    | <0.5    | <0.6          | <1.0          | <1.0 | <1.0 | <10  | <0.5 | <0.5 | -       |       |

**TABLE 3**  
**ANALYTICAL RESULTS OF GROUND WATER SAMPLES**  
**Rino Pacific/Oakland Truck Stop**  
**1107 5th Street, Oakland, California**  
**(µg/l)**

| Sample ID | Date       | 8015M        |              | 8260B        |            |            |               |               |      |      |            |            |      |         | 8021         |
|-----------|------------|--------------|--------------|--------------|------------|------------|---------------|---------------|------|------|------------|------------|------|---------|--------------|
|           |            | TPH-g        | TPH-d        | MTBE         | Benzene    | Toluene    | Ethyl-benzene | Total Xylenes | DIPE | ETBE | TAME       | TBA        | EDB  | 1,2-DCA | MTBE         |
| MW-3N     | 05/20/02   | <50          | <b>1,800</b> | <b>1,500</b> | <0.5       | <0.5       | <0.5          | <0.5          | <25  | <25  | <25        | <250       | <25  | <25     | <b>1,100</b> |
|           | 08/01/02   | <50          | <b>2,900</b> | <b>540</b>   | <0.5       | <0.5       | <0.5          | <0.5          | <10  | <10  | <b>14</b>  | <100       | <10  | <10     | <b>350</b>   |
|           | 11/11/02   | <50          | <b>1,100</b> | <b>270</b>   | <0.5       | <0.5       | <0.5          | <0.5          | <5.0 | <5.0 | <b>7.1</b> | <50        | <5.0 | <5.0    | <b>280</b>   |
|           | 02/12/03   | <50          | <b>1,300</b> | <b>410</b>   | <0.5       | <0.5       | <0.5          | <0.5          | <5.0 | <5.0 | <5.0       | <50        | <5.0 | <5.0    | <b>380</b>   |
|           | 05/12/03   | <50          | <b>1,500</b> | <b>360</b>   | <0.5       | <0.5       | <0.5          | <0.5          | <6.2 | <6.2 | <6.2       | <62        | <6.2 | <6.2    | <b>330</b>   |
|           | 08/11/03   | <50          | <b>720</b>   | <b>280</b>   | <0.5       | <0.5       | <0.5          | <0.5          | <5.0 | <5.0 | <5.0       | <50        | <5.0 | <5.0    | <b>250</b>   |
|           | 01/09/04   | <b>230</b>   | <50          | <b>230</b>   | <0.5       | <0.5       | <0.5          | <0.5          | <1.0 | <1.0 | <b>2.5</b> | <10        | <0.5 | <0.5    | -            |
|           | 04/14/04   | <b>230</b>   | <50          | <b>220</b>   | <0.5       | <0.5       | <0.5          | <0.5          | <1.0 | <1.0 | <1.0       | <10        | <0.5 | <0.5    | -            |
|           | 07/21/04   | <b>400</b>   | <50          | <b>370</b>   | <0.5       | <0.5       | <0.5          | <0.5          | <1.0 | <1.0 | <b>4.4</b> | <10        | <0.5 | <0.5    | -            |
|           | 10/20/04   | <b>190</b>   | <50          | <b>180</b>   | <b>3.5</b> | <0.5       | <0.5          | <b>5.2</b>    | <1.0 | <1.0 | <1.0       | <10        | <0.5 | <0.5    | -            |
|           | 03/19/05   | <b>300</b>   | <50          | <b>300</b>   | <b>2.6</b> | <0.5       | <0.5          | <b>5.2</b>    | <1.0 | <1.0 | <b>2.4</b> | <10        | <0.5 | <0.5    | -            |
|           | 06/25/05   | <b>1,200</b> | <50          | <b>1,100</b> | <0.5       | <0.5       | <0.5          | <0.5          | <1.0 | <1.0 | <1.0       | <b>330</b> | <0.5 | <0.5    | -            |
|           | 09/17/05   | <b>1,900</b> | <50          | <b>1,100</b> | <0.5       | <0.5       | <0.5          | <0.5          | <1.0 | <1.0 | <1.0       | <b>770</b> | <0.5 | <0.5    | -            |
|           | 12/26/05   | <b>1,500</b> | <50          | <b>930</b>   | <0.5       | <0.5       | <0.5          | <0.5          | <1.0 | <1.0 | <1.0       | <b>520</b> | <0.5 | <0.5    | -            |
|           | 03/23/06   | <b>550</b>   | <50          | <b>110</b>   | <0.5       | <b>3.6</b> | <b>13</b>     | <b>37.1</b>   | <1.0 | <1.0 | <1.0       | <10        | <0.5 | <0.5    | -            |
|           | 06/03/06   | <b>200</b>   | <50          | <b>150</b>   | <0.5       | 2.6        | <0.5          | <0.5          | <1.0 | <1.0 | <1.0       | <10        | <0.5 | <0.5    | -            |
|           | 08/30/06   | <b>160</b>   | <50          | <b>130</b>   | <0.5       | <0.5       | <0.5          | <0.5          | <1.0 | <1.0 | <1.0       | <10        | <0.5 | <0.5    | -            |
|           | 12/04/06   | <b>900</b>   | <50          | <b>790</b>   | <0.5       | <0.5       | <0.5          | <0.5          | <1.0 | <1.0 | <b>19</b>  | <b>880</b> | <0.5 | <0.5    | -            |
|           | 02/28/07   | <50          | <50          | <b>97</b>    | <0.5       | <0.5       | <0.5          | <0.5          | <1.0 | <1.0 | <1.0       | <10        | <0.5 | <0.5    | -            |
|           | 05/29/07   | <b>170</b>   | <50          | <b>160</b>   | <0.5       | <0.5       | <0.5          | <0.5          | <1.0 | <1.0 | <1.0       | <10        | <0.5 | <0.5    | -            |
|           | 08/20/07   | <50          | <50          | <b>21</b>    | <0.5       | <0.5       | <0.5          | <0.6          | <1.0 | <1.0 | <1.0       | <10        | <0.5 | <0.5    | -            |
|           | 10/25/07   | <50          | <50          | <b>40</b>    | <0.5       | <0.5       | <0.5          | <0.6          | <1.0 | <1.0 | <1.0       | <10        | <0.5 | <0.5    | -            |
|           | 01/25/08   | <50          | <50          | <b>18</b>    | <0.5       | <0.5       | <0.5          | <0.5          | <1.0 | <1.0 | <1.0       | <10        | <0.5 | <0.5    | -            |
| 04/30/08  | <b>120</b> | <50          | <b>110</b>   | <0.5         | <0.5       | <0.5       | <0.5          | <1.0          | <1.0 | <1.0 | <10        | <0.5       | <0.5 | -       |              |
| 07/30/08  | <50        | <50          | <b>40</b>    | <0.5         | <0.5       | <0.5       | <0.5          | <1.0          | <1.0 | <1.0 | <10        | <0.5       | <0.5 | -       |              |
| 10/23/08  | <50        | <50          | <1.0         | <0.5         | <0.5       | <0.5       | <0.5          | <1.0          | <1.0 | <1.0 | <10        | <0.5       | <0.5 | -       |              |
| 11/12/09  | <50        | -            | <1.0         | <0.5         | <0.5       | <0.5       | <0.6          | -             | -    | <1.0 | <10        | -          | -    | -       |              |
| 11/23/10  | <50        | -            | <1.0         | <0.5         | <0.5       | <0.5       | <0.6          | <1.0          | <1.0 | <1.0 | <10        | <0.5       | <0.5 | -       |              |

**TABLE 3**  
**ANALYTICAL RESULTS OF GROUND WATER SAMPLES**  
**Rino Pacific/Oakland Truck Stop**  
**1107 5th Street, Oakland, California**  
**(µg/l)**

| Sample ID | Date          | 8015M  |            | 8260B          |            |           |               |               |        |           |                |            |                |         | 8021           |   |
|-----------|---------------|--|------------|----------------|------------|-----------|---------------|---------------|--------|-----------|----------------|------------|----------------|---------|----------------|---|
|           |               | TPH-g  | TPH-d      | MTBE           | Benzene    | Toluene   | Ethyl-benzene | Total Xylenes | DIPE   | ETBE      | TAME           | TBA        | EDB            | 1,2-DCA | MTBE           |   |
| MW-4      | 08/30/00      | <b>1,300</b>   | <b>390</b> | -              | <b>64</b>  | <b>63</b> | <b>9.7</b>    | <b>110</b>    | -      | -         | -              | -          | -              | -       | <b>210,000</b> |   |
|           | 11/06/00      | <3,300   | <b>170</b> | <b>120,000</b> | <b>80</b>  | <4.0      | <5.0          | <3.0          | <2,500 | <2,500    | <2,500         | <13,000    | <2,500         | <2,500  | <b>130,000</b> |   |
|           | 11/06/00†     | <3,300   | -          | <b>120,000</b> | <b>86</b>  | <4.0      | <7.0          | <6.0          | <2,500 | <2,500    | <2,500         | <13,000    | <2,500         | <2,500  | <b>130,000</b> |   |
|           | 02/22/01      | <3,300   | <b>120</b> | <b>150,000</b> | <b>30</b>  | <3.0      | <3.0          | <3.0          | <2,500 | <2,500    | <2,500         | <13,000    | <2,500         | <2,500  | <b>120,000</b> |   |
|           | 05/07/01      | <4,200   | <b>240</b> | <b>200,000</b> | <20        | <10.0     | <5.0          | <5.0          | <5,000 | <5,000    | <5,000         | <25,000    | <5,000         | <5,000  | <b>150,000</b> |   |
|           | 08/22/01      | <5,400   | <b>300</b> | <b>190,000</b> | <5.0       | <5.0      | <5.0          | <5.0          | <5,000 | <5,000    | <5,000         | <25,000    | <5,000         | <5,000  | <b>160,000</b> |   |
|           | 11/04/01      | <5,000   | <b>210</b> | <b>170,000</b> | <5.0       | <5.0      | <5.0          | <5.0          | <2,500 | <2,500    | <2,500         | <13,000    | <2,500         | <2,500  | <b>130,000</b> |   |
|           | 02/15/02      | <5,000   | <b>340</b> | <b>160,000</b> | <5.0       | <5.0      | <5.0          | <5.0          | <10    | <2,500    | <2,500         | <12,500    | <2,500         | <2,500  | <b>160,000</b> |   |
|           | 05/20/02      | <2,500   | <b>200</b> | <b>130,000</b> | <25        | <25       | <25           | <25           | <1,700 | <1,700    | <1,700         | <17,000    | <1,700         | <1,700  | <b>98,000</b>  |   |
|           | 08/01/02      | <2,500   | <b>200</b> | <b>100,000</b> | <25        | <25       | <25           | <25           | <1,700 | <1,700    | <1,700         | <17,000    | <1,700         | <1,700  | <b>89,000</b>  |   |
|           | 11/11/02      | <3,000   | <b>200</b> | <b>84,000</b>  | <25        | <25       | <25           | <25           | <1,700 | <1,700    | <1,700         | <17,000    | <1,700         | <1,700  | <b>99,000</b>  |   |
|           | 02/12/03      | <2,500   | <b>88</b>  | <b>70,000</b>  | <25        | <25       | <25           | <25           | <1,700 | <1,700    | <1,700         | <17,000    | <1,700         | <1,700  | <b>78,000</b>  |   |
|           | 05/12/03      | <2,500   | <b>88</b>  | <b>86,000</b>  | <25        | <25       | <25           | <25           | <1,700 | <1,700    | <1,700         | <17,000    | <1,700         | <1,700  | <b>88,000</b>  |   |
|           | 08/11/03      | <2,500   | <b>66</b>  | <b>74,000</b>  | <25        | <25       | <25           | <25           | <1,700 | <1,700    | <1,700         | <17,000    | <1,700         | <1,700  | <b>77,000</b>  |   |
|           | 01/09/04      | <b>50,000</b>  | <50        | <b>50,000</b>  | <b>120</b> | <0.5      | <0.5          | <0.5          | <0.6   | <1.0      | <1.0           | <b>85</b>  | <10            | <0.5    | <0.5           | - |
|           | 04/14/04      | <b>27,000</b>  | <50        | <b>27,000</b>  | <b>62</b>  | <0.5      | <0.5          | <0.5          | <0.6   | <1.0      | <1.0           | <1.0       | <10            | <0.5    | <0.5           | - |
|           | 07/21/04      | <b>27,000</b>  | <50        | <b>5,300</b>   | <b>25</b>  | <0.5      | <0.5          | <0.5          | <0.6   | <1.0      | <1.0           | <b>3.6</b> | <b>150,000</b> | <0.5    | <0.5           | - |
|           | 10/20/04      | <b>22,000</b>  | <50        | <b>840</b>     | <b>25</b>  | <0.5      | <0.5          | <0.5          | <0.6   | <1.0      | <1.0           | <1.0       | <b>110,000</b> | <0.5    | <0.5           | - |
|           | 03/19/05      | <b>3,500</b>   | <0.05      | <b>900</b>     | <b>25</b>  | <0.5      | <0.5          | <0.5          | <0.6   | <1.0      | <1.0           | <b>4.6</b> | <b>2,900</b>   | <0.5    | <0.5           | - |
|           | 06/25/05      | <b>3,000</b>   | <0.05      | <b>620</b>     | <b>25</b>  | <0.5      | <0.5          | <0.5          | <0.6   | <1.0      | <1.0           | <1.0       | <b>54,000</b>  | <0.5    | <0.5           | - |
|           | 09/17/05      | <b>3,200</b>   | <0.05      | <b>370</b>     | <b>25</b>  | <0.5      | <0.5          | <0.5          | <0.6   | <1.0      | <1.0           | <1.0       | <b>180,000</b> | <0.5    | <0.5           | - |
|           | 09/24/05      | In-situ Chemical Oxidation (Ozone injection) commences |            |                |            |           |               |               |        |           |                |            |                |         |                |   |
|           | 12/26/05      | <b>3,000</b>   | <50        | <b>730</b>     | <b>4.2</b> | <0.5      | <0.5          | <0.5          | <0.6   | <1.0      | <1.0           | <1.0       | <b>76,000</b>  | <0.5    | <0.5           | - |
|           | 03/23/06      | <b>300</b>   | <50        | <b>21</b>      | <b>4.2</b> | <0.5      | <0.5          | <0.5          | <0.6   | <1.0      | <1.0           | <1.0       | <10            | <0.5    | <0.5           | - |
|           | 06/03/06      | <b>110</b>   | <50        | <b>33</b>      | <b>3.9</b> | <0.5      | <0.5          | <0.5          | <0.6   | <1.0      | <1.0           | <1.0       | <10            | <0.5    | <0.5           | - |
|           | 08/30/06      | <50  | <50        | <b>7.7</b>     | <b>2.2</b> | <0.5      | <0.5          | <0.5          | <0.6   | <1.0      | <1.0           | <1.0       | <10            | <0.5    | <0.5           | - |
|           | 12/04/06      | <b>1,100</b>   | <50        | <b>68</b>      | <b>2.2</b> | <0.5      | <0.5          | <0.5          | <0.6   | <b>18</b> | <1.0           | <1.0       | <b>6,300</b>   | <0.5    | <0.5           | - |
|           | 02/28/07      | <b>320</b>   | <50        | <b>23</b>      | <b>9.4</b> | <0.5      | <0.5          | <0.5          | <0.6   | <1.0      | <1.0           | <1.0       | <10            | <0.5    | <0.5           | - |
|           | 05/29/07      | <b>800</b>   | <50        | <b>330</b>     | <b>9.2</b> | <0.5      | <0.5          | <0.5          | <0.6   | <1.0      | <1.0           | <1.0       | <10            | <0.5    | <0.5           | - |
|           | 08/20/07      | <b>400</b>   | <50        | <b>74</b>      | <b>2.3</b> | <0.5      | <0.5          | <0.5          | <0.6   | <1.0      | <1.0           | <1.0       | <10            | <0.5    | <0.5           | - |
|           | 10/25/07      | <b>340</b>   | <50        | <b>90</b>      | <b>1.6</b> | <0.5      | <0.5          | <0.5          | <0.6   | <1.0      | <1.0           | <1.0       | <10            | <0.5    | <0.5           | - |
|           | 01/29/08      | <b>220</b>   | <50        | <b>150</b>     | <b>1.6</b> | <0.5      | <0.5          | <0.5          | <0.6   | <1.0      | <1.0           | <1.0       | <10            | <0.5    | <0.5           | - |
| 04/30/08  | <50           | <b>7,600</b>   | <1         | <0.5           | <0.5       | <0.5      | <0.6          | <1.0          | <1.0   | <1.0      | <10            | <0.5       | <0.5           | -       |                |   |
| 07/30/08  | <50           | <b>5,500</b>   | <1         | <0.5           | <0.5       | <0.5      | <0.6          | <1.0          | <1.0   | <1.0      | <10            | <0.5       | <0.5           | -       |                |   |
| 10/23/08  | <b>120</b>    | <b>3,200</b>   | <b>110</b> | <0.5           | <0.5       | <0.5      | <0.6          | <1.0          | <1.0   | <1.0      | <10            | <0.5       | <0.5           | -       |                |   |
| 11/12/09  | <b>120</b>    | -  | <1.0       | <0.5           | <0.5       | <0.5      | <0.6          | -             | -      | <1.0      | <10            | -          | -              | -       |                |   |
| 11/23/10  | <b>22,000</b> | -  | <b>86</b>  | <0.5           | <0.5       | <0.5      | <0.6          | <1.0          | <1.0   | <1.0      | <b>120,000</b> | <0.5       | <0.5           | -       |                |   |



**TABLE 3**  
**ANALYTICAL RESULTS OF GROUND WATER SAMPLES**  
**Rino Pacific/Oakland Truck Stop**  
**1107 5th Street, Oakland, California**  
**(µg/l)**

| Sample ID | Date     | 8015M  |         | 8260B  |         |         |               |               |        |        |        |        |        |         | 8021   |  |
|-----------|----------|--|---------|--------|---------|---------|---------------|---------------|--------|--------|--------|--------|--------|---------|--------|--|
|           |          | TPH-g  | TPH-d   | MTBE   | Benzene | Toluene | Ethyl-benzene | Total Xylenes | DIPE   | ETBE   | TAME   | TBA    | EDB    | 1,2-DCA | MTBE   |  |
| MW-5      | 08/30/00 | 1,000  | 450     | -      | <5.0    | <5.0    | <5.0          | <5.0          | -      | -      | -      | -      | -      | -       | 52,000 |  |
|           | 11/06/00 | <1,000   | 520     | 42,000 | <1.0    | <1.0    | <1.0          | <1.0          | <1,000 | <1,000 | <1,000 | <5,000 | <1,000 | <1,000  | 44,000 |  |
|           | 02/22/01 | <1,000   | 270     | 39,000 | <1.0    | <1.0    | <1.0          | <1.0          | <500   | <500   | <500   | <2,500 | <500   | <500    | 30,000 |  |
|           | 05/07/01 | <1,800   | 470     | 59,000 | <5.0    | <2.0    | <2.0          | <2.0          | <1,000 | <1,000 | <1,000 | <5,000 | <1,000 | <1,000  | 48,000 |  |
|           | 08/22/01 | <2,200   | 780     | 70,000 | <3.0    | <3.0    | <3.0          | <3.0          | <1,000 | <1,000 | <1,000 | <5,000 | <1,000 | <1,000  | 63,000 |  |
|           | 11/04/01 | <1,700   | 670     | 37,000 | <2.0    | <2.0    | <2.0          | <2.0          | <1,000 | <1,000 | <1,000 | <5,000 | <1,000 | <1,000  | 44,000 |  |
|           | 02/15/02 | <1,100   | 480     | 33,000 | <1.0    | <1.0    | <1.0          | <1.0          | <1,250 | <1,250 | <1,250 | <6,250 | <1,250 | <1,250  | 33,000 |  |
|           | 05/20/02 | <500   | 1,600   | 28,000 | <5.0    | <5.0    | <5.0          | <5.0          | <500   | <500   | <500   | <5,000 | <500   | <500    | 21,000 |  |
|           | 08/01/02 | <500   | 810     | 24,000 | <5.0    | <5.0    | <5.0          | <5.0          | <500   | <500   | <500   | <5,000 | <500   | <500    | 10,000 |  |
|           | 11/11/02 | <500   | 2,100   | 8,800  | <5.0    | <5.0    | <5.0          | <5.0          | <200   | <200   | <200   | 10,000 | <200   | <200    | 3,700  |  |
|           | 02/12/03 | <170   | 2,900   | 3,200  | 30      | <1.7    | <1.7          | <1.7          | <100   | <100   | <100   | 4,100  | <100   | <100    | 19,000 |  |
|           | 05/12/03 | <500   | 1,500   | 21,000 | 13      | <5.0    | <5.0          | <5.0          | <500   | <500   | <500   | 5,200  | <500   | <500    | 1,500  |  |
|           | 08/11/03 | 71   | 2,200   | 1,700  | 9.5     | <0.5    | <0.5          | <0.5          | <50    | <50    | <50    | 14,000 | <50    | <50     | 1,700  |  |
|           | 01/09/04 | 1,500  | <50     | 1,500  | <0.5    | <0.5    | <0.5          | <0.6          | <1.0   | <1.0   | <1.0   | <10    | <0.5   | <0.5    | -      |  |
|           | 04/14/04 | 500  | <50     | 430    | 20      | <0.5    | <0.5          | <0.6          | <1.0   | <1.0   | <1.0   | <10    | <0.5   | <0.5    | -      |  |
|           | 07/21/04 | 2,000  | <50     | 320    | 2.2     | <0.5    | <0.5          | <0.6          | <1.0   | <1.0   | <1.0   | 15,000 | <0.5   | <0.5    | -      |  |
|           | 10/20/04 | 1,900  | <50     | 23     | <0.5    | <0.5    | <0.5          | <0.6          | <1.0   | <1.0   | <1.0   | 11,000 | <0.5   | <0.5    | -      |  |
|           | 03/19/05 | 1,000  | 860     | 71     | 2.3     | <0.5    | 5             | 40            | <1.0   | <1.0   | <1.0   | 500    | <0.5   | <0.5    | -      |  |
|           | 06/25/05 | 1,500  | 1,200   | 54     | 11      | <0.5    | 3.6           | 37            | <1.0   | <1.0   | <1.0   | 2,700  | <0.5   | <0.5    | -      |  |
|           | 09/17/05 | 2,500  | 1,600   | 16     | 42      | <0.5    | <0.5          | 10            | <1.0   | <1.0   | <1.0   | 12,000 | <0.5   | <0.5    | -      |  |
|           | 09/24/05 | In-situ Chemical Oxidation (Ozone injection) commences |         |        |         |         |               |               |        |        |        |        |        |         |        |  |
|           | 12/26/05 | 1,500  | 1,200   | 44     | <0.5    | <0.5    | <0.5          | <0.6          | <1.0   | <1.0   | <1.0   | 2,700  | <0.5   | <0.5    | -      |  |
|           | 03/23/06 | <50  | 850     | <1.0   | <0.5    | <0.5    | <0.5          | <0.6          | <1.0   | <1.0   | <1.0   | <10    | <0.5   | <0.5    | -      |  |
|           | 06/03/06 | 400  | 900     | 280    | <0.5    | <0.5    | <0.5          | <0.6          | <1.0   | <1.0   | <1.0   | <10    | <0.5   | <0.5    | -      |  |
|           | 08/30/06 | <50  | <50     | <1.0   | <0.5    | <0.5    | <0.5          | <0.6          | <1.0   | <1.0   | <1.0   | <10    | <0.5   | <0.5    | -      |  |
|           | 12/04/06 | 1,200  | <50     | 22     | <0.5    | <0.5    | <0.5          | <0.6          | <1.0   | <1.0   | <1.0   | 2,200  | <0.5   | <0.5    | -      |  |
|           | 02/28/07 | <50  | <50     | 11     | <0.5    | <0.5    | <0.5          | <0.6          | <1.0   | <1.0   | <1.0   | <10    | <0.5   | <0.5    | -      |  |
|           | 05/29/07 | 9,000  | 240,000 | 26     | <0.5    | <0.5    | <0.5          | <0.6          | <1.0   | <1.0   | 17     | <10    | <0.5   | <0.5    | -      |  |
|           | 08/20/07 | 11,000   | 280,000 | <1.0   | <0.5    | <0.5    | <0.5          | <0.6          | <1.0   | <1.0   | <1.0   | <10    | <0.5   | <0.5    | -      |  |
|           | 10/25/07 | 14,000   | 300,000 | <1.0   | <0.5    | <0.5    | <0.5          | <0.6          | <1.0   | <1.0   | <1.0   | <10    | <0.5   | <0.5    | -      |  |
|           | 01/25/08 | 11,000   | 260,000 | <1.0   | <0.5    | <0.5    | 1.4           | 4.4           | <1.0   | <1.0   | <1.0   | <10    | <0.5   | <0.5    | -      |  |
|           | 04/30/08 | 14,000   | 73,000  | <1.0   | <0.5    | <0.5    | <0.5          | <0.6          | <1.0   | <1.0   | <1.0   | <10    | <0.5   | <0.5    | -      |  |
|           | 07/30/08 | 11,000   | 68,000  | <1.0   | <0.5    | <0.5    | <0.5          | <0.6          | <1.0   | <1.0   | <1.0   | <10    | <0.5   | <0.5    | -      |  |
| 10/23/08  | 7,600    | 63,000   | <1.0    | <0.5   | <0.5    | <0.5    | <0.6          | <1.0          | <1.0   | <1.0   | <10    | <0.5   | <0.5   | -       |        |  |
| 03/26/09  | 9,400    | 75,000   | <1.0    | <0.5   | <0.5    | <0.5    | <0.6          | -             | -      | <1.0   | 5,000  | -      | -      | -       |        |  |
| 06/05/09  | 22,000   | 95,000   | 54      | <0.5   | <0.5    | <0.5    | <0.6          | -             | -      | <1.0   | <10    | -      | -      | -       |        |  |
| 09/09/09  | 20,000   | 91,000   | <1.0    | <0.5   | <0.5    | <0.5    | <0.6          | -             | -      | <1.0   | 5,900  | -      | -      | -       |        |  |
| 11/12/09  | 6,900    | 20,000   | <1.0    | <0.5   | <0.5    | <0.5    | <0.6          | -             | -      | <1.0   | <10    | -      | -      | -       |        |  |
| 02/18/10  | 11,000   | 24,000   | <1.0    | <0.5   | <0.5    | <0.5    | <0.6          | -             | -      | <1.0   | <10    | -      | -      | -       |        |  |
| 05/17/10  | 8,200    | 19,000   | <1.0    | <0.5   | <0.5    | <0.5    | <0.6          | -             | -      | <1.0   | <10    | -      | -      | -       |        |  |
| 11/23/10  | 20,000   | 36,000   | <1.0    | <0.5   | <0.5    | <0.5    | <0.6          | <1.0          | <1.0   | <1.0   | 4,100  | <0.5   | <0.5   | -       |        |  |
| 05/20/11  | 27,000   | 41,000   | <1.0    | <0.5   | <0.5    | <0.5    | <0.5          | -             | -      | <1.0   | 7,700  | -      | -      | -       |        |  |

**TABLE 3**  
**ANALYTICAL RESULTS OF GROUND WATER SAMPLES**  
**Rino Pacific/Oakland Truck Stop**  
**1107 5th Street, Oakland, California**  
**(µg/l)**

| Sample ID | Date     | 8015M  |       | 8260B  |         |         |               |               |        |        |        |        |        |         | 8021   |
|-----------|----------|--------|-------|--------|---------|---------|---------------|---------------|--------|--------|--------|--------|--------|---------|--------|
|           |          | TPH-g  | TPH-d | MTBE   | Benzene | Toluene | Ethyl-benzene | Total Xylenes | DIPE   | ETBE   | TAME   | TBA    | EDB    | 1,2-DCA | MTBE   |
| MW-6      | 08/30/00 | 1,300  | 1,300 | -      | 55      | <0.5    | 16            | 27            | -      | -      | -      | -      | -      | -       | 23,000 |
|           | 11/06/00 | <630   | 1,100 | 27,000 | 7       | 8.1     | <3.0          | 5.2           | <630   | <630   | <630   | <3,200 | <630   | <630    | 26,000 |
|           | 02/22/01 | <200   | 420   | 8,000  | <5.0    | <5.0    | <5.0          | <5.0          | <100   | <100   | <100   | <500   | <100   | <100    | 6,500  |
|           | 05/07/01 | <1,000 | 900   | 40,000 | <2.0    | <2.0    | <1.0          | <1.0          | <500   | <500   | <500   | <2,500 | <500   | <500    | 37,000 |
|           | 08/22/01 | <350   | 520   | 8,800  | <2.0    | <1.0    | <0.5          | <0.5          | <200   | <200   | <200   | <1,000 | <200   | <200    | 8,600  |
|           | 11/04/01 | <500   | 420   | 17,000 | <2.0    | <2.0    | <0.5          | <0.5          | <250   | <250   | <250   | <1,300 | <250   | <250    | 12,000 |
|           | 02/15/02 | <960   | 910   | 26,000 | 2.6     | 4.5     | <1.0          | 4.2           | <1,000 | <1,000 | <1,000 | <5,000 | <1,000 | <1,000  | 23,000 |
|           | 05/20/02 | <620   | 690   | 37,000 | <6.2    | <6.2    | <6.2          | <6.2          | <500   | <500   | <500   | <5,000 | <500   | <500    | 25,000 |
|           | 08/01/02 | <250   | 1,100 | 9,100  | 8       | <2.5    | <2.5          | <2.5          | <170   | <170   | <170   | 3,800  | <170   | <170    | 8,100  |
|           | 11/11/02 | <500   | 970   | 11,000 | <5.0    | <5.0    | <5.0          | <5.0          | <250   | <250   | <250   | 8,600  | <250   | <250    | 11,000 |
|           | 02/12/03 | <250   | 2,100 | 8,300  | <2.5    | <2.5    | <2.5          | <2.5          | <120   | <120   | <120   | 4,600  | <120   | <120    | 7,400  |
|           | 05/12/03 | <1,000 | 630   | 29,000 | <10     | <10     | <10           | <10           | <500   | <500   | <500   | 8,700  | <500   | <500    | 32,000 |
|           | 08/11/03 | 110    | <50   | 2,300  | 6.8     | <1.0    | <1.0          | <1.0          | <100   | <100   | <100   | 27,000 | <100   | <100    | 2,800  |
|           | 01/09/04 | 700    | <50   | 690    | <0.5    | <0.5    | <0.5          | <0.6          | <1.0   | <1.0   | <1.0   | <10    | <0.5   | <0.5    | -      |
|           | 04/14/04 | 200    | <50   | 190    | <0.5    | <0.5    | <0.5          | <0.6          | <1.0   | <1.0   | <1.0   | <10    | <0.5   | <0.5    | -      |
|           | 07/21/04 | 200    | 4.5   | 140    | <0.5    | <0.5    | <0.5          | <0.6          | <1.0   | <1.0   | <1.0   | 15,000 | <0.5   | <0.5    | -      |
|           | 10/20/04 | 7,700  | 1,300 | 3,400  | <0.5    | <0.5    | <0.5          | <0.6          | <1.0   | <1.0   | <1.0   | 77,000 | <0.5   | <0.5    | -      |
|           | 03/19/05 | 1,600  | 630   | 57     | <0.5    | <0.5    | <0.5          | <0.6          | <1.0   | <1.0   | <1.0   | 1,300  | <0.5   | <0.5    | -      |
|           | 06/25/05 | 400    | 630   | 58     | <0.5    | <0.5    | <0.5          | <0.6          | <1.0   | <1.0   | <1.0   | 3,600  | <0.5   | <0.5    | -      |
|           | 09/17/05 | 590    | <50   | 28     | <0.5    | <0.5    | <0.5          | <0.6          | <1.0   | <1.0   | <1.0   | 5,300  | <0.5   | <0.5    | -      |
|           | 12/26/05 | 400    | <50   | 92     | <0.5    | <0.5    | <0.5          | <0.6          | <1.0   | <1.0   | <1.0   | 4,500  | <0.5   | <0.5    | -      |
|           | 03/23/06 | <50    | <50   | 16     | <0.5    | <0.5    | <0.5          | <0.6          | <1.0   | <1.0   | <1.0   | <10    | <0.5   | <0.5    | -      |
|           | 06/03/06 | <50    | <50   | 13     | <0.5    | <0.5    | <0.5          | <0.6          | <1.0   | <1.0   | <1.0   | <10    | <0.5   | <0.5    | -      |
|           | 08/30/06 | <50    | <50   | <1.0   | <0.5    | <0.5    | <0.5          | <0.6          | <1.0   | <1.0   | <1.0   | <10    | <0.5   | <0.5    | -      |
|           | 12/04/06 | 4,300  | <50   | 84     | <0.5    | <0.5    | <0.5          | <0.6          | 19     | <1.0   | <1.0   | 30,000 | <0.5   | <0.5    | -      |
|           | 02/28/07 | <50    | <50   | <1.0   | <0.5    | <0.5    | <0.5          | <0.6          | <1.0   | <1.0   | <1.0   | <10    | <0.5   | <0.5    | -      |
|           | 05/29/07 | <50    | <50   | <1.0   | <0.5    | <0.5    | <0.5          | <0.6          | <1.0   | <1.0   | <1.0   | <10    | <0.5   | <0.5    | -      |
|           | 08/20/07 | 4,900  | <50   | 120    | <0.5    | <0.5    | <0.5          | <0.6          | <1.0   | <1.0   | <1.0   | <10    | <0.5   | <0.5    | -      |
|           | 10/25/07 | 5,000  | 4,200 | <1.0   | <0.5    | <0.5    | <0.5          | <0.6          | <1.0   | <1.0   | <1.0   | <10    | <0.5   | <0.5    | -      |
|           | 01/25/08 | <50    | <50   | 5.8    | <0.5    | <0.5    | <0.5          | <0.6          | <1.0   | <1.0   | <1.0   | <10    | <0.5   | <0.5    | -      |
| 04/30/08  | <50      | <50    | <1.0  | <0.5   | <0.5    | <0.5    | <0.6          | <1.0          | <1.0   | <1.0   | <10    | <0.5   | <0.5   | -       |        |
| 07/30/08  | <50      | <50    | <1.0  | <0.5   | <0.5    | <0.5    | <0.6          | <1.0          | <1.0   | <1.0   | <10    | <0.5   | <0.5   | -       |        |
| 10/23/08  | 540      | <50    | 130   | <0.5   | <0.5    | <0.5    | <0.6          | <1.0          | <1.0   | <1.0   | <10    | <0.5   | <0.5   | -       |        |

**TABLE 3**  
**ANALYTICAL RESULTS OF GROUND WATER SAMPLES**  
**Rino Pacific/Oakland Truck Stop**  
**1107 5th Street, Oakland, California**  
**(µg/l)**

| Sample ID | Date      | 8015M  |         | 8260B   |         |         |               |               |         |         |         |         |         |         | 8021    |  |
|-----------|-----------|--|---------|---------|---------|---------|---------------|---------------|---------|---------|---------|---------|---------|---------|---------|--|
|           |           | TPH-g  | TPH-d   | MTBE    | Benzene | Toluene | Ethyl-benzene | Total Xylenes | DIPE    | ETBE    | TAME    | TBA     | EDB     | 1,2-DCA | MTBE    |  |
| MW-7      | 08/30/00  | 160,000  | 2,600   | -       | 28,000  | 15,000  | 1,200         | 5,900         | -       | -       | -       | -       | -       | -       | 800,000 |  |
|           | 11/06/00  | 80,000   | 1,700   | 920,000 | 23,000  | 12,000  | 1,200         | 5,000         | <13,000 | <13,000 | <13,000 | <63,000 | <13,000 | <13,000 | 540,000 |  |
|           | 02/22/01  | 80,000   | 2,000   | 460,000 | 19,000  | 12,000  | 1,100         | 3,200         | <5,000  | <5,000  | <5,000  | <2,500  | <5,000  | <5,000  | 440,000 |  |
|           | 02/22/01† | 84,000   | 2,400   | 500,000 | 20,000  | 13,000  | 1,200         | 3,400         | <5,000  | <5,000  | <5,000  | <25,000 | <5,000  | <5,000  | 400,000 |  |
|           | 05/07/01  | 100,000  | 7,600   | 520,000 | 25,000  | 16,000  | 1,700         | 6,600         | <5,000  | <5,000  | <5,000  | <2,500  | <5,000  | <5,000  | 460,000 |  |
|           | 05/07/01† | 100,000  | 8,200   | 500,000 | 25,000  | 17,000  | 1,700         | 6,700         | <5,000  | <5,000  | <5,000  | <25,000 | <5,000  | <5,000  | 530,000 |  |
|           | 08/22/01  | 110,000  | 22,000  | 250,000 | 18,000  | 12,000  | 2,000         | 9,400         | <5,000  | <5,000  | <5,000  | <25,000 | <5,000  | <5,000  | 240,000 |  |
|           | 11/04/01  | 85,000   | 6,500   | 180,000 | 17,000  | 2,700   | 2,100         | 9,700         | <5,000  | <5,000  | <5,000  | <13,000 | <5,000  | <5,000  | 150,000 |  |
|           | 02/15/02  | 96,000   | 21,000  | 200,000 | 21,000  | 7,300   | 2,600         | 13,000        | <5,000  | <5,000  | <5,000  | <25,000 | <5,000  | <5,000  | 180,000 |  |
|           | 02/15/02† | 160,000  | 29,000  | 200,000 | 30,000  | 27,000  | 3,700         | 19,000        | <5,000  | <5,000  | <5,000  | <25,000 | <5,000  | <5,000  | 170,000 |  |
|           | 05/20/02  | 140,000  | 310,000 | 220,000 | 24,000  | 21,000  | 3,800         | 20,000        | <5,000  | <5,000  | <5,000  | <50,000 | <5,000  | <5,000  | 180,000 |  |
|           | 08/01/02  | 110,000  | 160,000 | 150,000 | 15,000  | 16,000  | 4,000         | 21,000        | <2,500  | <2,500  | <2,500  | <25,000 | <2,500  | <2,500  | 120,000 |  |
|           | 11/11/02  | 110,000  | 240,000 | 77,000  | 14,000  | 11,000  | 4,100         | 19,000        | <1,200  | <1,200  | <1,200  | <12,000 | <1,200  | <1,200  | 74,000  |  |
|           | 02/12/03  | 130,000  | 75,000  | 110,000 | 25,000  | 8,900   | 3,400         | 17,000        | <1,700  | <1,700  | <1,700  | <17,000 | <1,700  | <1,700  | 87,000  |  |
|           | 05/12/03  | 98,000   | 7,100   | 220,000 | 25,000  | 520     | 2,600         | 12,000        | <5,000  | <5,000  | <5,000  | <5,000  | <5,000  | <5,000  | 140,000 |  |
|           | 08/11/03  | 90,000   | 12,000  | 140,000 | 15,000  | 1,100   | 2,600         | 12,000        | <5,000  | <5,000  | <5,000  | <5,000  | <5,000  | <5,000  | 140,000 |  |
|           | 01/09/04  | 130,000  | 18,000  | 120,000 | 9,500   | 340     | 190           | 3,700         | <1.0    | <1.0    | 900     | <10     | <0.5    | 420     | -       |  |
|           | 04/14/04  | 330,000  | 22      | 220,000 | 23,000  | 300     | 1,900         | 5,600         | <1.0    | <1.0    | 660     | <10     | <0.5    | 400     | -       |  |
|           | 07/21/04  | 120,000  | 14      | 71,000  | 11,000  | 730     | 1,000         | 1,250         | <1.0    | <1.0    | 370     | <10     | <0.5    | 300     | -       |  |
|           | 10/20/04  | 130,000  | 8.4     | 39,000  | 14,000  | 420     | 600           | 380           | <1.0    | <1.0    | 290     | <10     | <0.5    | 180     | -       |  |
|           | 03/19/05  | 130,000  | 22,000  | 40,000  | 23,000  | 1,400   | 2,200         | 6,800         | <1.0    | <1.0    | 17      | 290     | <0.5    | 29      | -       |  |
|           | 06/25/05  | 1,100,000  | 45,000  | 49,000  | 31,000  | 31,000  | 7,500         | 32,000        | <1.0    | <1.0    | 93      | 400     | <0.5    | 75      | -       |  |
|           | 09/17/05  | 100,000  | 38,000  | 28,000  | 31,000  | 16,000  | 8,500         | 31,000        | <1.0    | <1.0    | <1.0    | 7,400   | <0.5    | <0.5    | -       |  |
|           | 09/24/05  | In-situ Chemical Oxidation (Ozone injection) commences |         |         |         |         |               |               |         |         |         |         |         |         |         |  |
|           | 12/26/05  | 99,000   | 33,000  | 14,000  | 20,000  | 6,000   | 1,700         | 11,900        | <1.0    | <1.0    | <1.0    | 83,000  | <0.5    | <0.5    | -       |  |
|           | 03/23/06  | 160,000  | 48,000  | 2,400   | 23,000  | 22,000  | 13,000        | 43,000        | <1.0    | <1.0    | 44      | 14,000  | <0.5    | 330     | -       |  |
|           | 06/03/06  | 170,000  | 44,000  | 9,000   | 48,000  | 5,200   | 5,600         | 23,200        | <1.0    | <1.0    | 55      | 4,800   | <0.5    | 190     | -       |  |
|           | 08/30/06  | 240,000  | 62,000  | 3,600   | 77,000  | 12,000  | 30,000        | 63,000        | <1.0    | <1.0    | 77      | 300     | <0.5    | 21      | -       |  |
|           | 12/04/06  | 110,000  | 44,000  | 3,300   | 7,200   | 490     | 950           | 2,800         | 20      | <1.0    | 58      | 28,000  | <0.5    | 86      | -       |  |
|           | 02/28/07  | 32,000   | 16,000  | 1,600   | 1,800   | 65      | 610           | 1,249         | <1.0    | <1.0    | 12      | <10     | <0.5    | 16      | -       |  |
|           | 05/29/07  | 29,000   | 64,000  | 1,700   | 920     | 18      | 180           | 272           | <1.0    | <1.0    | 15      | <10     | <0.5    | 28      | -       |  |
|           | 08/20/07  | 33,000   | 70,000  | 760     | 2,000   | 22      | 86            | 120           | <1.0    | <1.0    | 13      | <10     | <0.5    | 45      | -       |  |
|           | 10/25/07  | 41,000   | 83,000  | 1,300   | 3,800   | 53      | 380           | 1,521         | <1.0    | <1.0    | 18      | <10     | <0.5    | 65      | -       |  |
|           | 01/25/08  | 32,000   | 48,000  | 4,500   | 3,000   | 55      | 170           | 853           | 12      | <1.0    | 56      | <10     | <0.5    | 96      | -       |  |
|           | 04/30/08  | 34,000   | 44,000  | 4,500   | 1,900   | 12      | 90            | 192.1         | 15      | <1.0    | 61      | <10     | <0.5    | 61      | -       |  |
|           | 07/30/08  | 56,000   | 54,000  | 5,100   | 3,300   | 25      | 38            | 270           | 15      | <1.0    | 67      | <10     | <0.5    | 84      | -       |  |
|           | 10/23/08  | 25,000   | 47,000  | 1,800   | 800     | 12      | 19            | 135           | <1.0    | <1.0    | 23      | <10     | <0.5    | 25      | -       |  |
|           | 03/26/09  | 64,000   | 62,000  | 5,000   | 4,300   | 48      | 21            | 266           | -       | -       | 58      | 65,000  | -       | -       | -       |  |
|           | 06/05/09  | 74,000   | 75,000  | 8,000   | 4,800   | 2.7     | 18            | 38            | -       | -       | 82      | <10     | -       | -       | -       |  |
|           | 09/09/09  | 83,000   | 94,000  | 3,600   | 2,800   | 41      | 29            | 211           | -       | -       | 290     | 310,000 | -       | -       | -       |  |
| 11/12/09  | 25,000    | 32,000   | 1,500   | 2,000   | 16      | 24      | 141           | -             | -       | 11      | <10     | -       | -       | -       |         |  |
| 02/18/10  | 39,000    | 38,000   | 2,200   | 2,800   | 24      | 47      | 101.5         | -             | -       | 49      | 36,000  | -       | -       | -       |         |  |
| 05/17/10  | 36,000    | 40,000   | 5,800   | 3,800   | 110     | 88      | 218           | -             | -       | 50      | 24,000  | -       | -       | -       |         |  |
| 11/23/10  | 48,000    | 51,000   | 4,200   | 1,600   | 77      | 34      | 371           | <1.0          | <1.0    | 13      | 78,000  | <0.5    | 27      | -       |         |  |
| 05/20/11  | 42,000    | 50,000   | 680     | 280     | 12      | 2.2     | 36            | -             | -       | 5.0     | 12,000  | -       | -       | -       |         |  |

**TABLE 3**  
**ANALYTICAL RESULTS OF GROUND WATER SAMPLES**  
**Rino Pacific/Oakland Truck Stop**  
**1107 5th Street, Oakland, California**  
**(µg/l)**

| Sample ID | Date          | 8015M  |                | 8260B          |            |            |                |               |        |        |               |               |        |         | 8021           |  |
|-----------|---------------|--|----------------|----------------|------------|------------|----------------|---------------|--------|--------|---------------|---------------|--------|---------|----------------|--|
|           |               | TPH-g  | TPH-d          | MTBE           | Benzene    | Toluene    | Ethyl-benzene  | Total Xylenes | DIPE   | ETBE   | TAME          | TBA           | EDB    | 1,2-DCA | MTBE           |  |
| MW-8      | 08/30/00      | <1,000   | <b>690</b>     | -              | <b>18</b>  | <2.0       | <1.0           | <1.0          | -      | -      | -             | -             | -      | -       | <b>28,000</b>  |  |
|           | 11/06/00      | <3,300   | <b>810</b>     | <b>76,000</b>  | <8.0       | <5.0       | <3.0           | <7.0          | <2,500 | <2,500 | <2,500        | <13,000       | <2,500 | <2,500  | <b>120,000</b> |  |
|           | 02/22/01      | <2,500   | <b>1,100</b>   | <b>130,000</b> | <b>53</b>  | <3.0       | <3.0           | <3.0          | <2,000 | <2,000 | <2,000        | <10,000       | <2,000 | <2,000  | <b>99,000</b>  |  |
|           | 05/07/01      | <5,000   | <b>1,300</b>   | <b>120,000</b> | <b>32</b>  | <10        | <5.0           | <5.0          | <2,500 | <2,500 | <2,500        | <13,000       | <2,500 | <2,500  | <b>110,000</b> |  |
|           | 08/22/01      | <4,000   | <b>1,200</b>   | <b>86,000</b>  | <5.0       | <5.0       | <5.0           | <b>16</b>     | <1,700 | <1,700 | <1,700        | <8,500        | <1,700 | <1,700  | <b>76,000</b>  |  |
|           | 11/04/01      | <b>590</b>   | <b>1,100</b>   | <b>49,000</b>  | <b>6.9</b> | <0.5       | <0.5           | <0.5          | <2,500 | <2,500 | <2,500        | <13,000       | <2,500 | <2,500  | <b>60,000</b>  |  |
|           | 02/15/02      | <3,400   | <b>1,500</b>   | <b>91,000</b>  | <5.0       | <5.0       | <5.0           | <5.0          | <2,500 | <2,500 | <2,500        | <12,500       | <2,500 | <2,500  | <b>110,000</b> |  |
|           | 05/20/02      | <1,700   | <b>2,200</b>   | <b>86,000</b>  | <17        | <17        | <17            | <17           | <1,000 | <1,000 | <1,000        | <10,000       | <1,000 | <1,000  | <1,000         |  |
|           | 08/01/02      | <1,200   | <b>2,800</b>   | <b>67,000</b>  | <12        | <12        | <12            | <12           | <1,000 | <1,000 | <1,000        | <10,000       | <1,000 | <1,000  | <b>53,000</b>  |  |
|           | 11/11/02      | <2,000   | <b>11,000</b>  | <b>51,000</b>  | <10        | <b>18</b>  | <10            | <10           | <1,000 | <1,000 | <1,000        | <10,000       | <1,000 | <1,000  | <b>48,000</b>  |  |
|           | 02/12/03      | <1,700   | <b>5,800</b>   | <b>51,000</b>  | <17        | <17        | <17            | <17           | <1,000 | <1,000 | <1,000        | <10,000       | <1,000 | <1,000  | <b>49,000</b>  |  |
|           | 05/12/03      | <2,500   | <b>4,500</b>   | <b>60,000</b>  | <b>94</b>  | <25        | <25            | <25           | <1,000 | <1,000 | <1,000        | <10,000       | <1,000 | <1,000  | <b>52,000</b>  |  |
|           | 08/11/03      | <2,500   | <b>23,000</b>  | <b>42,000</b>  | <b>92</b>  | <25        | <25            | <25           | <1,000 | <1,000 | <1,000        | <10,000       | <1,000 | <1,000  | <b>42,000</b>  |  |
|           | 01/09/04      | <b>51,000</b>  | <b>12,000</b>  | <b>50,000</b>  | <b>2.4</b> | <0.5       | <0.5           | <b>2.1</b>    | <1.0   | <1.0   | 160           | <10           | <1.0   | <1.0    | -              |  |
|           | 03/19/05      | <b>80,000</b>  | <b>100,000</b> | <b>13,000</b>  | <b>45</b>  | <b>38</b>  | <b>77</b>      | <b>530</b>    | <1.0   | <1.0   | <1.0          | <10           | <0.5   | <0.5    | -              |  |
|           | 06/25/05      | <b>60,000</b>  | <b>82,000</b>  | <b>1,600</b>   | <b>18</b>  | <b>5.9</b> | <b>3</b>       | <b>54</b>     | <1.0   | <1.0   | 12            | <b>3,700</b>  | <0.5   | <0.5    | -              |  |
|           | 09/17/05      | <b>80,000</b>  | <b>89,000</b>  | <b>1,400</b>   | <b>23</b>  | <b>2.7</b> | <b>&lt;0.5</b> | <b>25</b>     | <1.0   | <1.0   | 17            | <b>88,000</b> | <0.5   | <0.5    | -              |  |
|           | 09/24/05      | In-situ Chemical Oxidation (Ozone injection) commences |                |                |            |            |                |               |        |        |               |               |        |         |                |  |
|           | 12/26/05      | <b>24,000</b>  | <b>37,000</b>  | <b>180</b>     | <b>270</b> | <b>65</b>  | <b>14</b>      | <b>127</b>    | <1.0   | <1.0   | <1.0          | <b>11,000</b> | <0.5   | <0.5    | -              |  |
|           | 03/23/06      | <b>1,200</b>   | <b>4,000</b>   | <b>310</b>     | <0.5       | <0.5       | <0.5           | <0.6          | <1.0   | <1.0   | <1.0          | <b>880</b>    | <0.5   | <0.5    | -              |  |
|           | 06/03/06      | <b>1,800</b>   | <b>4,800</b>   | <b>390</b>     | <b>60</b>  | <b>9.9</b> | <b>7.3</b>     | <b>11.6</b>   | <1.0   | <1.0   | <b>3</b>      | <b>2,100</b>  | <0.5   | <0.5    | -              |  |
|           | 08/30/06      | <b>6,000</b>   | <b>6,200</b>   | <1.0           | <b>36</b>  | <b>6.1</b> | <b>12</b>      | <b>29.5</b>   | <1.0   | <1.0   | <1.0          | <10           | <0.5   | <0.5    | -              |  |
|           | 12/04/06      | <b>400</b>   | <b>2,800</b>   | <b>31</b>      | <0.5       | <0.5       | <0.5           | <0.6          | <1.0   | <1.0   | <1.0          | <b>2,400</b>  | <0.5   | <0.5    | -              |  |
|           | 02/28/07      | <b>3,100</b>   | <b>5,200</b>   | <b>83</b>      | <0.5       | <0.5       | <0.5           | <0.6          | <1.0   | <1.0   | <1.0          | <10           | <0.5   | <0.5    | -              |  |
|           | 05/29/07      | <b>6,000</b>   | <b>39,000</b>  | <b>54</b>      | <0.5       | <0.5       | <0.5           | <0.6          | <1.0   | <1.0   | <1.0          | <10           | <0.5   | <0.5    | -              |  |
|           | 08/20/07      | <b>11,000</b>  | <b>50,000</b>  | <b>11</b>      | <0.5       | <0.5       | <0.5           | <b>3</b>      | <1.0   | <1.0   | <1.0          | <10           | <0.5   | <0.5    | -              |  |
|           | 10/25/07      | <b>8,200</b>   | <b>44,000</b>  | <b>7.2</b>     | <0.5       | <0.5       | <0.5           | <b>3.6</b>    | <1.0   | <1.0   | <1.0          | <10           | <0.5   | <0.5    | -              |  |
|           | 01/25/08      | <b>7,400</b>   | <b>41,000</b>  | <1.0           | <0.5       | <0.5       | <0.5           | <b>3.6</b>    | <1.0   | <1.0   | <1.0          | <10           | <0.5   | <0.5    | -              |  |
|           | 04/30/08      | <b>8,000</b>   | <b>2,900</b>   | <1.0           | <0.5       | <0.5       | <0.5           | <0.6          | <1.0   | <1.0   | <1.0          | <10           | <0.5   | <0.5    | -              |  |
|           | 07/30/08      | <b>14,000</b>  | <b>4,000</b>   | <1.0           | <0.5       | <0.5       | <0.5           | <0.6          | <1.0   | <1.0   | <1.0          | <10           | <0.5   | <0.5    | -              |  |
|           | 10/23/08      | <b>20,000</b>  | <b>8,500</b>   | <b>88</b>      | <0.5       | <0.5       | <0.5           | <0.6          | <1.0   | <1.0   | <1.0          | <10           | <0.5   | <0.5    | -              |  |
|           | 03/26/09      | <b>11,000</b>  | <b>5,900</b>   | <b>36</b>      | <0.5       | <0.5       | <0.5           | <0.6          | -      | -      | <b>11</b>     | <b>14,000</b> | -      | -       | -              |  |
| 06/05/09  | <b>20,000</b> | <b>18,000</b>  | <b>65</b>      | <0.5           | <0.5       | <0.5       | <0.6           | -             | -      | <1.0   | <10           | -             | -      | -       |                |  |
| 09/09/09  | <b>14,000</b> | <b>17,000</b>  | <b>29</b>      | <0.5           | <0.5       | <0.5       | <0.6           | -             | -      | <1.0   | <b>9,200</b>  | -             | -      | -       |                |  |
| 11/12/09  | <b>5,400</b>  | <b>6,800</b>   | <1.0           | <0.5           | <0.5       | <0.5       | <0.6           | -             | -      | <1.0   | <10           | -             | -      | -       |                |  |
| 02/18/10  | <b>4,400</b>  | <b>6,000</b>   | <1.0           | <0.5           | <0.5       | <0.5       | <0.6           | -             | -      | <1.0   | <b>15,000</b> | -             | -      | -       |                |  |
| 05/17/10  | <b>4,400</b>  | <b>6,800</b>   | <b>22</b>      | <b>5.3</b>     | <0.5       | <0.5       | <0.6           | -             | -      | <1.0   | <b>11,000</b> | -             | -      | -       |                |  |
| 11/23/10  | <b>16,000</b> | <b>22,000</b>  | <1.0           | <0.5           | <0.5       | <0.5       | <0.6           | -             | -      | <1.0   | <b>3,800</b>  | -             | -      | -       |                |  |
| 05/20/11  | <b>2,800</b>  | <b>5,900</b>   | <1.0           | <0.5           | <0.5       | <0.5       | <0.5           | -             | -      | <1.0   | <10           | -             | -      | -       |                |  |

**TABLE 3**  
**ANALYTICAL RESULTS OF GROUND WATER SAMPLES**  
**Rino Pacific/Oakland Truck Stop**  
**1107 5th Street, Oakland, California**  
**(µg/l)**

| Sample ID | Date     | 8015M      |            | 8260B      |            |         |               |               |      |      |      |       |      |         | 8021       |
|-----------|----------|------------|------------|------------|------------|---------|---------------|---------------|------|------|------|-------|------|---------|------------|
|           |          | TPH-g      | TPH-d      | MTBE       | Benzene    | Toluene | Ethyl-benzene | Total Xylenes | DIPE | ETBE | TAME | TBA   | EDB  | 1,2-DCA | MTBE       |
| MW-9      | 08/30/00 | <50        | <b>770</b> | -          | <0.5       | <0.5    | <0.5          | <0.5          | -    | -    | -    | -     | -    | -       | <b>97</b>  |
|           | 11/06/00 | <50        | <b>390</b> | <b>220</b> | <0.5       | <0.5    | <0.5          | <0.5          | <25  | <25  | <25  | <125  | <5.0 | <5.0    | <b>190</b> |
|           | 02/22/01 | <50        | <b>240</b> | <b>160</b> | <0.5       | <0.5    | <0.5          | <0.5          | <2.0 | <2.0 | <2.0 | <1.0  | <2.0 | <2.0    | <b>120</b> |
|           | 05/07/01 | <50        | <b>190</b> | <b>150</b> | <0.5       | <0.5    | <0.5          | <0.5          | <2.5 | <2.5 | <2.5 | <13   | <2.5 | <2.5    | <b>120</b> |
|           | 08/22/01 | <50        | <b>120</b> | <b>120</b> | <0.5       | <0.5    | <0.5          | <0.5          | <5.0 | <5.0 | <5.0 | <25   | <5.0 | <5.0    | <b>120</b> |
|           | 11/04/01 | <50        | <b>160</b> | <b>120</b> | <0.5       | <0.5    | <0.5          | <0.5          | <5.0 | <5.0 | <5.0 | <25   | <5.0 | <5.0    | <b>130</b> |
|           | 02/15/02 | <50        | <b>150</b> | <b>98</b>  | <0.5       | <0.5    | <0.5          | <0.5          | <2.5 | <2.5 | <2.5 | <12.5 | <2.5 | <2.5    | <b>92</b>  |
|           | 05/20/02 | <50        | <b>380</b> | <b>85</b>  | <0.5       | <0.5    | <0.5          | <0.5          | <2.5 | <2.5 | <2.5 | <25   | <2.5 | <2.5    | <b>79</b>  |
|           | 08/01/02 | <50        | <b>320</b> | <b>84</b>  | <0.5       | <0.5    | <0.5          | <0.5          | <1.0 | <1.0 | <1.0 | <10   | <1.0 | <1.0    | <b>74</b>  |
|           | 11/11/02 | <50        | <b>150</b> | <b>61</b>  | <0.5       | <0.5    | <0.5          | <0.5          | <2.5 | <2.5 | <2.5 | <25   | <2.5 | <2.5    | <b>76</b>  |
|           | 02/12/03 | <50        | <b>350</b> | <b>50</b>  | <0.5       | <0.5    | <0.5          | <0.5          | <1.0 | <1.0 | <1.0 | <10   | <1.0 | <1.0    | <b>55</b>  |
|           | 05/12/03 | <50        | <b>380</b> | <b>45</b>  | <0.5       | <0.5    | <0.5          | <0.5          | <1.0 | <1.0 | <1.0 | <10   | <1.0 | <1.0    | <b>45</b>  |
|           | 08/11/03 | <50        | <b>88</b>  | <b>42</b>  | <0.5       | <0.5    | <0.5          | <0.5          | <1.0 | <1.0 | <1.0 | <10   | <1.0 | <1.0    | <b>36</b>  |
|           | 01/09/04 | <b>200</b> | <50        | <b>140</b> | <0.5       | <0.5    | <0.5          | <b>4.7</b>    | <1.0 | <1.0 | <1.0 | <10   | <0.5 | <0.5    | -          |
|           | 04/14/04 | <b>180</b> | <50        | <b>180</b> | <0.5       | <0.5    | <0.5          | <0.6          | <1.0 | <1.0 | <1.0 | <10   | <0.5 | <0.5    | -          |
|           | 07/21/04 | <50        | <50        | <b>24</b>  | <0.5       | <0.5    | <0.5          | <0.6          | <1.0 | <1.0 | <1.0 | <10   | <0.5 | <0.5    | -          |
|           | 10/20/04 | <b>80</b>  | <50        | <b>78</b>  | <0.5       | <0.5    | <0.5          | <0.6          | <1.0 | <1.0 | <1.0 | <10   | <0.5 | <0.5    | -          |
|           | 03/19/05 | <b>100</b> | <50        | <b>87</b>  | <b>10</b>  | <0.5    | <0.5          | <0.6          | <1.0 | <1.0 | <1.0 | <10   | <0.5 | <0.5    | -          |
|           | 06/25/05 | <b>100</b> | <50        | <b>92</b>  | <0.5       | <0.5    | <0.5          | <0.6          | <1.0 | <1.0 | <1.0 | <10   | <0.5 | <0.5    | -          |
|           | 09/17/05 | <b>100</b> | <50        | <b>85</b>  | <0.5       | <0.5    | <0.5          | <0.6          | <1.0 | <1.0 | <1.0 | <10   | <0.5 | <0.5    | -          |
|           | 12/26/05 | <50        | <50        | <b>19</b>  | <0.5       | <0.5    | <0.5          | <0.6          | <1.0 | <1.0 | <1.0 | <10   | <0.5 | <0.5    | -          |
|           | 03/23/06 | <50        | <50        | <b>19</b>  | <0.5       | <0.5    | <0.5          | <0.6          | <1.0 | <1.0 | <1.0 | <10   | <0.5 | <0.5    | -          |
|           | 06/03/06 | <50        | <50        | <1.0       | <b>7.7</b> | <0.5    | <0.5          | <0.6          | <1.0 | <1.0 | <1.0 | <10   | <0.5 | <0.5    | -          |
|           | 08/30/06 | <50        | <50        | <1.0       | <0.5       | <0.5    | <0.5          | <0.6          | <1.0 | <1.0 | <1.0 | <10   | <0.5 | <0.5    | -          |
|           | 12/04/06 | <50        | <50        | <b>34</b>  | <0.5       | <0.5    | <0.5          | <0.6          | <1.0 | <1.0 | <1.0 | <10   | <0.5 | <0.5    | -          |
|           | 02/28/07 | <50        | <50        | <1.0       | <0.5       | <0.5    | <0.5          | <0.6          | <1.0 | <1.0 | <1.0 | <10   | <0.5 | <0.5    | -          |
|           | 05/29/07 | <50        | <50        | <1.0       | <0.5       | <0.5    | <0.5          | <0.6          | <1.0 | <1.0 | <1.0 | <10   | <0.5 | <0.5    | -          |
|           | 08/20/07 | <50        | <50        | <b>3.8</b> | <0.5       | <0.5    | <0.5          | <0.6          | <1.0 | <1.0 | <1.0 | <10   | <0.5 | <0.5    | -          |
|           | 10/25/07 | <50        | <50        | <b>8.9</b> | <0.5       | <0.5    | <0.5          | <0.6          | <1.0 | <1.0 | <1.0 | <10   | <0.5 | <0.5    | -          |
|           | 01/25/08 | <50        | <50        | <b>3.5</b> | <0.5       | <0.5    | <0.5          | <0.6          | <1.0 | <1.0 | <1.0 | <10   | <0.5 | <0.5    | -          |
| 04/30/08  | <50      | <50        | <1.0       | <0.5       | <0.5       | <0.5    | <0.6          | <1.0          | <1.0 | <1.0 | <10  | <0.5  | <0.5 | -       |            |
| 07/30/08  | <50      | <50        | <1.0       | <0.5       | <0.5       | <0.5    | <0.6          | <1.0          | <1.0 | <1.0 | <10  | <0.5  | <0.5 | -       |            |
| 10/23/08  | <50      | <50        | <1.0       | <0.5       | <0.5       | <0.5    | <0.6          | <1.0          | <1.0 | <1.0 | <10  | <0.5  | <0.5 | -       |            |
| 11/12/09  | <50      | -          | <1.0       | <0.5       | <0.5       | <0.5    | <0.6          | -             | -    | <1.0 | <10  | -     | -    | -       |            |
| 11/23/10  | <50      | -          | <1.0       | <0.5       | <0.5       | <0.5    | <0.6          | <1.0          | <1.0 | <1.0 | <10  | <0.5  | <0.5 | -       |            |

**TABLE 3**  
**ANALYTICAL RESULTS OF GROUND WATER SAMPLES**  
**Rino Pacific/Oakland Truck Stop**  
**1107 5th Street, Oakland, California**  
**(µg/l)**

| Sample ID | Date       | 8015M |            | 8260B       |             |            |               |               |      |      |      |      |      |         | 8021 |      |
|-----------|------------|-------|------------|-------------|-------------|------------|---------------|---------------|------|------|------|------|------|---------|------|------|
|           |            | TPH-g | TPH-d      | MTBE        | Benzene     | Toluene    | Ethyl-benzene | Total Xylenes | DIPE | ETBE | TAME | TBA  | EDB  | 1,2-DCA | MTBE |      |
| MW-10     | 08/01/02   | <50   | <b>720</b> | <b>1.1</b>  | <b>1</b>    | <0.5       | <0.5          | <0.5          | <0.5 | <0.5 | <0.5 | <0.5 | <0.5 | <0.5    | <0.5 | <5.0 |
|           | 11/11/02   | <50   | <b>100</b> | <b>0.7</b>  | <b>0.72</b> | <0.5       | <0.5          | <0.5          | <0.5 | <0.5 | <0.5 | <0.5 | <5.0 | <0.5    | <0.5 | <5.0 |
|           | 02/12/03   | <50   | <b>71</b>  | <0.5        | <b>0.63</b> | <0.5       | <0.5          | <0.5          | <0.5 | <0.5 | <0.5 | <0.5 | <5.0 | <0.5    | <0.5 | <5.0 |
|           | 05/12/03   | <50   | <b>96</b>  | <b>0.59</b> | <b>0.56</b> | <0.5       | <0.5          | <0.5          | <0.5 | <0.5 | <0.5 | <0.5 | <5.0 | <0.5    | <0.5 | <5.0 |
|           | 08/11/03   | <50   | <b>110</b> | <b>0.73</b> | <b>0.93</b> | <0.5       | <0.5          | <0.5          | <0.5 | <0.5 | <0.5 | <0.5 | <5.0 | <0.5    | <0.5 | <5.0 |
|           | 01/09/04   | <50   | <50        | <1.0        | <0.5        | <0.5       | <0.5          | <0.6          | <1.0 | <1.0 | <1.0 | <1.0 | <10  | <0.5    | <0.5 | -    |
|           | 04/14/04   | <50   | <50        | <1.0        | <0.5        | <0.5       | <0.5          | <0.6          | <1.0 | <1.0 | <1.0 | <1.0 | <10  | <0.5    | <0.5 | -    |
|           | 07/21/04   | <50   | <50        | <1.0        | <0.5        | <0.5       | <0.5          | <0.6          | <1.0 | <1.0 | <1.0 | <1.0 | <10  | <0.5    | <0.5 | -    |
|           | 10/20/04   | <50   | <50        | <1.0        | <0.5        | <0.5       | <0.5          | <0.6          | <1.0 | <1.0 | <1.0 | <1.0 | <10  | <0.5    | <0.5 | -    |
|           | 03/19/05   | <50   | <50        | <1.0        | <0.5        | <0.5       | <0.5          | <0.6          | <1.0 | <1.0 | <1.0 | <1.0 | <10  | <0.5    | <0.5 | -    |
|           | 06/25/05   | <50   | <50        | <1.0        | <0.5        | <0.5       | <0.5          | <0.6          | <1.0 | <1.0 | <1.0 | <1.0 | <10  | <0.5    | <0.5 | -    |
|           | 09/17/05   | <50   | <50        | <1.0        | <0.5        | <0.5       | <0.5          | <0.6          | <1.0 | <1.0 | <1.0 | <1.0 | <10  | <0.5    | <0.5 | -    |
|           | 12/26/05   | <50   | <50        | <1.0        | <0.5        | <0.5       | <0.5          | <0.6          | <1.0 | <1.0 | <1.0 | <1.0 | <10  | <0.5    | <0.5 | -    |
|           | 03/23/06   | <50   | <50        | <1.0        | <b>8.5</b>  | <0.5       | <0.5          | <0.6          | <1.0 | <1.0 | <1.0 | <1.0 | <10  | <0.5    | <0.5 | -    |
|           | 06/03/06   | <50   | <50        | <1.0        | <b>3.9</b>  | <0.5       | <0.5          | <0.6          | <1.0 | <1.0 | <1.0 | <1.0 | <10  | <0.5    | <0.5 | -    |
|           | 08/30/06   | <50   | <50        | <1.0        | <0.5        | <0.5       | <0.5          | <0.6          | <1.0 | <1.0 | <1.0 | <1.0 | <10  | <0.5    | <0.5 | -    |
|           | 12/04/06   | <50   | <50        | <1.0        | <0.5        | <0.5       | <0.5          | <0.6          | <1.0 | <1.0 | <1.0 | <1.0 | <10  | <0.5    | <0.5 | -    |
|           | 02/28/07   | <50   | <50        | <1.0        | <0.5        | <0.5       | <0.5          | <0.6          | <1.0 | <1.0 | <1.0 | <1.0 | <10  | <0.5    | <0.5 | -    |
|           | 05/29/07   | <50   | <50        | <1.0        | <0.5        | <0.5       | <0.5          | <0.6          | <1.0 | <1.0 | <1.0 | <1.0 | <10  | <0.5    | <0.5 | -    |
|           | 08/20/07   | <50   | <50        | <1.0        | <0.5        | <0.5       | <0.5          | <0.6          | <1.0 | <1.0 | <1.0 | <1.0 | <10  | <0.5    | <0.5 | -    |
| 10/25/07  | <50        | <50   | <1.0       | <0.5        | <0.5        | <0.5       | <0.6          | <1.0          | <1.0 | <1.0 | <1.0 | <10  | <0.5 | <0.5    | -    |      |
| 01/25/08  | <50        | <50   | <1.0       | <b>3.2</b>  | <0.5        | <b>1.2</b> | <b>1.3</b>    | <1.0          | <1.0 | <1.0 | <1.0 | <10  | <0.5 | <0.5    | -    |      |
| 04/30/08  | <b>600</b> | <50   | <1.0       | <0.5        | 2.4         | <0.5       | <b>40</b>     | <1.0          | <1.0 | <1.0 | <1.0 | <10  | <0.5 | <0.5    | -    |      |
| 07/30/08  | <50        | <50   | <1.0       | <0.5        | <0.5        | <0.5       | <0.6          | <1.0          | <1.0 | <1.0 | <1.0 | <10  | <0.5 | <0.5    | -    |      |
| 10/23/08  | <50        | <50   | <1.0       | <0.5        | <0.5        | <0.5       | <0.6          | <1.0          | <1.0 | <1.0 | <1.0 | <10  | <0.5 | <0.5    | -    |      |

**TABLE 3**  
**ANALYTICAL RESULTS OF GROUND WATER SAMPLES**  
**Rino Pacific/Oakland Truck Stop**  
**1107 5th Street, Oakland, California**  
**(µg/l)**

| Sample ID | Date       | 8015M |            | 8260B      |            |             |               |               |       |       |       |       |       |         | 8021       |
|-----------|------------|-------|------------|------------|------------|-------------|---------------|---------------|-------|-------|-------|-------|-------|---------|------------|
|           |            | TPH-g | TPH-d      | MTBE       | Benzene    | Toluene     | Ethyl-benzene | Total Xylenes | DIPE  | ETBE  | TAME  | TBA   | EDB   | 1,2-DCA | MTBE       |
| MW-11     | 05/20/02   | <50   | <b>95</b>  | <b>310</b> | <b>1.5</b> | <b>3</b>    | <0.5          | <b>1.4</b>    | <5.0  | <5.0  | <5.0  | <5.0  | <5.0  | <5.0    | <b>260</b> |
|           | 08/01/02   | <50   | <b>190</b> | <b>65</b>  | <0.5       | <b>1.9</b>  | <b>0.6</b>    | <0.5          | <1.0  | <1.0  | <1.0  | <10   | <1.0  | <1.0    | <b>52</b>  |
|           | 11/11/02   | <50   | <b>140</b> | <b>15</b>  | <0.5       | <b>2.1</b>  | <b>1.1</b>    | <0.5          | <0.5  | <0.5  | <0.5  | <5.0  | <0.5  | <0.5    | <b>23</b>  |
|           | 02/12/03   | <50   | <b>86</b>  | <b>2.6</b> | <0.5       | <b>1.7</b>  | <0.5          | <0.5          | <0.5  | <0.5  | <0.5  | <5.0  | <0.5  | <0.5    | <5.0       |
|           | 05/12/03   | <50   | <b>62</b>  | <b>2.3</b> | <0.5       | <b>1.1</b>  | <0.5          | <0.5          | <0.5  | <0.5  | <0.5  | <5.0  | <0.5  | <0.5    | <5.0       |
|           | 08/11/03   | <50   | <b>72</b>  | <b>2.3</b> | <0.5       | <b>0.66</b> | <0.5          | <0.5          | <1.0  | <1.0  | <1.0  | <5.0  | <0.5  | <0.5    | <5.0       |
|           | 01/09/04   | <50   | <50        | <1.0       | <0.5       | <0.5        | <0.5          | <0.5          | <1.0  | <1.0  | <1.0  | <10   | <0.5  | <0.5    | -          |
|           | 04/14/04   | <50   | <50        | <1.0       | <0.5       | <0.5        | <0.5          | <0.5          | <1.0  | <1.0  | <1.0  | <10   | <0.5  | <0.5    | -          |
|           | 07/21/04   | <50   | <50        | <1.0       | <0.5       | <0.5        | <0.5          | <0.6          | <1.0  | <1.0  | <1.0  | <10   | <0.5  | <0.5    | -          |
|           | 10/20/04   | -     | NS         | NS         | NS         | NS          | NS            | NS            | NS    | NS    | NS    | NS    | NS    | NS      | -          |
|           | 03/19/05   | <50   | <50        | <1.0       | <0.5       | <0.5        | <0.5          | <0.6          | <1.0  | <1.0  | <1.0  | <10   | <0.5  | <0.5    | -          |
|           | 06/25/05   | <50   | <50        | <1.0       | <0.5       | <0.5        | <0.5          | <0.6          | <1.0  | <1.0  | <1.0  | <10   | <0.5  | <0.5    | -          |
|           | 09/17/05   | <50   | <50        | <1.0       | <0.5       | <0.5        | <0.5          | <0.6          | <1.0  | <1.0  | <1.0  | <10   | <0.5  | <0.5    | -          |
|           | 12/26/05   | <50   | <50        | <1.0       | <0.5       | <0.5        | <0.5          | <0.6          | <1.0  | <1.0  | <1.0  | <10   | <0.5  | <0.5    | -          |
|           | 03/23/06   | <50   | <50        | <1.0       | <0.5       | <0.5        | <0.5          | <0.6          | <1.0  | <1.0  | <1.0  | <10   | <0.5  | <0.5    | -          |
|           | 06/03/06   | <50   | <50        | <1.0       | <0.5       | <0.5        | <0.5          | <0.6          | <1.0  | <1.0  | <1.0  | <10   | <0.5  | <0.5    | -          |
|           | 08/30/06   | <50   | <50        | <1.0       | <0.5       | <0.5        | <0.5          | <0.6          | <1.0  | <1.0  | <1.0  | <10   | <0.5  | <0.5    | -          |
|           | 12/04/06   | <50   | <50        | <1.0       | <0.5       | <0.5        | <0.5          | <0.6          | <1.0  | <1.0  | <1.0  | <10   | <0.5  | <0.5    | -          |
|           | 02/28/07   | <50   | <50        | <1.0       | <0.5       | <0.5        | <0.5          | <0.6          | <1.0  | <1.0  | <1.0  | <10   | <0.5  | <0.5    | -          |
|           | 05/29/07   | <50   | <50        | <1.0       | <0.5       | <0.5        | <0.5          | <0.6          | <1.0  | <1.0  | <1.0  | <10   | <0.5  | <0.5    | -          |
| 08/20/07  | <50        | <50   | <1.0       | <0.5       | <0.5       | <0.5        | <0.6          | <1.0          | <1.0  | <1.0  | <10   | <0.5  | <0.5  | -       |            |
| 10/25/07  | <b>110</b> | <50   | <1.0       | <0.5       | <0.5       | <0.5        | <0.6          | <1.0          | <1.0  | <1.0  | <10   | <0.5  | <0.5  | -       |            |
| 01/25/08  | <50        | <50   | <1.0       | <0.5       | <0.5       | <0.5        | <0.6          | <1.0          | <1.0  | <1.0  | <10   | <0.5  | <0.5  | -       |            |
| 04/30/08  | <50        | <50   | <1.0       | <0.5       | <0.5       | <0.5        | <0.6          | <1.0          | <1.0  | <1.0  | <10   | <0.5  | <0.5  | -       |            |
| 07/30/08  | <50        | <50   | <1.0       | <0.5       | <0.5       | <0.5        | <0.6          | <1.0          | <1.0  | <1.0  | <10   | <0.5  | <0.5  | -       |            |
| 10/23/08  | <50        | <50   | <1.0       | <0.5       | <0.5       | <0.5        | <0.6          | <1.0          | <1.0  | <1.0  | <10   | <0.5  | <0.5  | -       |            |
| MW-12     | 10/20/04   | <50   | <50        | <1.0       | <0.5       | <0.5        | <0.5          | <0.6          | <1.0  | <1.0  | <1.0  | <10   | <0.5  | <0.5    | -          |
|           | 03/19/05   | <50   | <50        | <1.0       | <0.5       | <0.5        | <0.5          | <0.6          | <1.0  | <1.0  | <1.0  | <10   | <0.5  | <0.5    | -          |
|           | 06/25/05   | <50   | <50        | <1.0       | <0.5       | <0.5        | <0.5          | <0.6          | <1.0  | <1.0  | <1.0  | <10   | <0.5  | <0.5    | -          |
|           | 09/17/05   | <50   | <50        | <1.0       | <0.5       | <0.5        | <0.5          | <0.6          | <1.0  | <1.0  | <1.0  | <10   | <0.5  | <0.5    | -          |
|           | 12/26/05   | <50   | <50        | <1.0       | <0.5       | <0.5        | <0.5          | <0.6          | <1.0  | <1.0  | <1.0  | <10   | <0.5  | <0.5    | -          |
|           | 03/23/06   | <50   | <50        | <1.0       | <0.5       | <0.5        | <0.5          | <0.6          | <1.0  | <1.0  | <1.0  | <10   | <0.5  | <0.5    | -          |
|           | 06/03/06   | <50   | <50        | <1.0       | <0.5       | <0.5        | <0.5          | <0.6          | <1.0  | <1.0  | <1.0  | <10   | <0.5  | <0.5    | -          |
|           | 08/30/06   | <50   | <50        | <1.0       | <0.5       | <0.5        | <0.5          | <0.6          | <1.0  | <1.0  | <1.0  | <10   | <0.5  | <0.5    | -          |
|           | 12/04/06   | <50   | <50        | <1.0       | <0.5       | <0.5        | <0.5          | <0.6          | <1.0  | <1.0  | <1.0  | <10   | <0.5  | <0.5    | -          |
|           | 02/28/07   | <50   | <50        | <1.0       | <0.5       | <0.5        | <0.5          | <0.6          | <1.0  | <1.0  | <1.0  | <10   | <0.5  | <0.5    | -          |
|           | 05/29/07   | <50   | <50        | <1.0       | <0.5       | <0.5        | <0.5          | <0.6          | <1.0  | <1.0  | <1.0  | <10   | <0.5  | <0.5    | -          |
|           | 08/20/07   | <50   | <50        | <1.0       | <0.5       | <0.5        | <0.5          | <0.6          | <1.0  | <1.0  | <1.0  | <10   | <0.5  | <0.5    | -          |
|           | 10/25/07   | <50   | <50        | <1.0       | <0.5       | <0.5        | <0.5          | <0.6          | <1.0  | <1.0  | <1.0  | <10   | <0.5  | <0.5    | -          |
|           | 01/25/08   | <50   | <50        | <1.0       | <0.5       | <0.5        | <0.5          | <0.6          | <1.0  | <1.0  | <1.0  | <10   | <0.5  | <0.5    | -          |
| 04/30/08  | <50        | <50   | <1.0       | <0.5       | <0.5       | <0.5        | <0.6          | <1.0          | <1.0  | <1.0  | <10   | <0.5  | <0.5  | -       |            |
| 07/30/08  | <50        | <50   | <1.0       | <0.5       | <0.5       | <0.5        | <0.6          | <1.0          | <1.0  | <1.0  | <10   | <0.5  | <0.5  | -       |            |
| 10/23/08  | <50        | <50   | <1.0       | <0.5       | <0.5       | <0.5        | <0.6          | <1.0          | <1.0  | <1.0  | <10   | <0.5  | <0.5  | -       |            |
| 11/12/09  | <50        | -     | <1.0       | <0.5       | <0.5       | <0.5        | <0.6          | -             | -     | <1.0  | <10   | -     | -     | -       |            |
| 11/23/10  | NOACC      | NOACC | NOACC      | NOACC      | NOACC      | NOACC       | NOACC         | NOACC         | NOACC | NOACC | NOACC | NOACC | NOACC | NOACC   | NOACC      |

**TABLE 3**  
**ANALYTICAL RESULTS OF GROUND WATER SAMPLES**  
**Rino Pacific/Oakland Truck Stop**  
**1107 5th Street, Oakland, California**  
**(µg/l)**

| Sample ID | Date       | 8015M  |              |            |         | 8260B   |               |               |       |       |            |       |       |         |       | 8021 |
|-----------|------------|--|--------------|------------|---------|---------|---------------|---------------|-------|-------|------------|-------|-------|---------|-------|------|
|           |            | TPH-g  | TPH-d        | MTBE       | Benzene | Toluene | Ethyl-benzene | Total Xylenes | DIPE  | ETBE  | TAME       | TBA   | EDB   | 1,2-DCA | MTBE  |      |
| MW-13     | 10/20/04   | <b>100</b>   | <50          | <b>99</b>  | <0.5    | <0.5    | <0.5          | <0.6          | <1.0  | <1.0  | <1.0       | <10   | <0.5  | <0.5    | -     |      |
|           | 03/19/05   | <50  | <50          | <1.0       | <0.5    | <0.5    | <0.5          | <0.6          | <1.0  | <1.0  | <1.0       | <10   | <0.5  | <0.5    | -     |      |
|           | 06/25/05   | <50  | <50          | <b>31</b>  | <0.5    | <0.5    | <0.5          | <0.6          | <1.0  | <1.0  | <1.0       | <10   | <0.5  | <0.5    | -     |      |
|           | 09/17/05   | <50  | <50          | <b>40</b>  | <0.5    | <0.5    | <0.5          | <0.6          | <1.0  | <1.0  | <1.0       | <10   | <0.5  | <0.5    | -     |      |
|           | 12/26/05   | <50  | <50          | <b>17</b>  | <0.5    | <0.5    | <0.5          | <0.6          | <1.0  | <1.0  | <1.0       | <10   | <0.5  | <0.5    | -     |      |
|           | 03/23/06   | <50  | <50          | <1.0       | <0.5    | <0.5    | <0.5          | <0.6          | <1.0  | <1.0  | <1.0       | <10   | <0.5  | <0.5    | -     |      |
|           | 06/03/06   | <50  | <50          | <1.0       | <0.5    | <0.5    | <0.5          | <0.6          | <1.0  | <1.0  | <1.0       | <10   | <0.5  | <0.5    | -     |      |
|           | 08/30/06   | <50  | <50          | <1.0       | <0.5    | <0.5    | <0.5          | <0.6          | <1.0  | <1.0  | <1.0       | <10   | <0.5  | <0.5    | -     |      |
|           | 12/04/06   | <50  | <50          | <b>63</b>  | <0.5    | <0.5    | <0.5          | <0.6          | <1.0  | <1.0  | <1.0       | <10   | <0.5  | <0.5    | -     |      |
|           | 02/28/07   | <50  | <50          | <b>6.5</b> | <0.5    | <0.5    | <0.5          | <0.6          | <1.0  | <1.0  | <1.0       | <10   | <0.5  | <0.5    | -     |      |
|           | 05/29/07   | <50  | <50          | <b>41</b>  | <0.5    | <0.5    | <0.5          | <0.6          | <1.0  | <1.0  | <1.0       | <10   | <0.5  | <0.5    | -     |      |
|           | 08/20/07   | <50  | <50          | <b>6.7</b> | <0.5    | <0.5    | <0.5          | <0.6          | <1.0  | <1.0  | <1.0       | <10   | <0.5  | <0.5    | -     |      |
|           | 10/25/07   | <50  | <50          | <b>15</b>  | <0.5    | <0.5    | <0.5          | <0.6          | <1.0  | <1.0  | <1.0       | <10   | <0.5  | <0.5    | -     |      |
|           | 01/25/08   | <50  | <50          | <1.0       | <0.5    | <0.5    | <0.5          | <0.6          | <1.0  | <1.0  | <1.0       | <10   | <0.5  | <0.5    | -     |      |
|           | 04/30/08   | <50  | <50          | <1.0       | <0.5    | <0.5    | <0.5          | <0.6          | <1.0  | <1.0  | <1.0       | <10   | <0.5  | <0.5    | -     |      |
|           | 07/30/08   | <50  | <50          | <1.0       | <0.5    | <0.5    | <0.5          | <0.6          | <1.0  | <1.0  | <1.0       | <10   | <0.5  | <0.5    | -     |      |
| 10/23/08  | <50        | <50  | <b>64</b>    | <0.5       | <0.5    | <0.5    | <0.6          | <1.0          | <1.0  | <1.0  | <10        | -     | -     | -       |       |      |
| 11/12/09  | <50        | <50  | <b>25</b>    | <0.5       | <0.5    | <0.5    | <0.6          | -             | -     | <1.0  | <10        | -     | -     | -       |       |      |
| 11/23/10  | NOACC      | NOACC  | NOACC        | NOACC      | NOACC   | NOACC   | NOACC         | NOACC         | NOACC | NOACC | NOACC      | NOACC | NOACC | NOACC   | NOACC |      |
| MW-14     | 10/20/04   | <b>490</b>   | <50          | <b>90</b>  | <0.5    | <0.5    | <0.5          | <0.6          | <1.0  | <1.0  | <1.0       | <10   | <0.5  | <0.5    | -     |      |
|           | 03/19/05   | <50  | <50          | <1.0       | <0.5    | <0.5    | <0.5          | <0.6          | <1.0  | <1.0  | <1.0       | <10   | <0.5  | <0.5    | -     |      |
|           | 06/25/05   | <50  | <50          | <1.0       | <0.5    | <0.5    | <0.5          | <0.6          | <1.0  | <1.0  | <1.0       | <10   | <0.5  | <0.5    | -     |      |
|           | 09/17/05   | <50  | <50          | <b>12</b>  | <0.5    | <0.5    | <0.5          | <0.6          | <1.0  | <1.0  | <1.0       | <10   | <0.5  | <0.5    | -     |      |
|           | 09/24/05   | In-situ Chemical Oxidation (Ozone injection) commences |              |            |         |         |               |               |       |       |            |       |       |         |       |      |
|           | 12/26/05   | <50  | <50          | <b>6.1</b> | <0.5    | <0.5    | <0.5          | <0.6          | <1.0  | <1.0  | <1.0       | <10   | <0.5  | <0.5    | -     |      |
|           | 03/23/06   | <50  | <50          | <1.0       | <0.5    | <0.5    | <0.5          | <0.6          | <1.0  | <1.0  | <1.0       | <10   | <0.5  | <0.5    | -     |      |
|           | 06/03/06   | <50  | <50          | <1.0       | <0.5    | <0.5    | <0.5          | <0.6          | <1.0  | <1.0  | <1.0       | <10   | <0.5  | <0.5    | -     |      |
|           | 08/30/06   | <50  | <50          | <1.0       | <0.5    | <0.5    | <0.5          | <0.6          | <1.0  | <1.0  | <1.0       | <10   | <0.5  | <0.5    | -     |      |
|           | 12/04/06   | <50  | <50          | <b>36</b>  | <0.5    | <0.5    | <0.5          | <0.6          | <1.0  | <1.0  | <1.0       | <10   | <0.5  | <0.5    | -     |      |
|           | 02/28/07   | <50  | <50          | <b>8.7</b> | <0.5    | <0.5    | <0.5          | <0.6          | <1.0  | <1.0  | <1.0       | <10   | <0.5  | <0.5    | -     |      |
|           | 05/29/07   | <50  | <50          | <b>59</b>  | <0.5    | <0.5    | <0.5          | <0.6          | <1.0  | <1.0  | <1.0       | <10   | <0.5  | <0.5    | -     |      |
|           | 08/20/07   | <50  | <50          | <b>10</b>  | <0.5    | <0.5    | <0.5          | <0.6          | <1.0  | <1.0  | <1.0       | <10   | <0.5  | <0.5    | -     |      |
|           | 10/25/07   | <b>150</b>   | <50          | <b>140</b> | <0.5    | <0.5    | <0.5          | <0.6          | <1.0  | <1.0  | <1.0       | <10   | <0.5  | <0.5    | -     |      |
|           | 01/25/08   | <50  | <50          | <b>120</b> | <0.5    | <0.5    | <0.5          | <0.6          | <1.0  | <1.0  | <1.0       | <10   | <0.5  | <0.5    | -     |      |
|           | 04/30/08   | <b>220</b>   | <50          | <b>210</b> | <0.5    | <0.5    | <0.5          | <0.6          | <1.0  | <1.0  | <1.0       | <10   | <0.5  | <0.5    | -     |      |
|           | 07/30/08   | <50  | <50          | <b>41</b>  | <0.5    | <0.5    | <0.5          | <0.6          | <1.0  | <1.0  | <1.0       | <10   | <0.5  | <0.5    | -     |      |
|           | 10/23/08   | <50  | <50          | <b>36</b>  | <0.5    | <0.5    | <0.5          | <0.6          | <1.0  | <1.0  | <1.0       | <10   | <0.5  | <0.5    | -     |      |
|           | 03/26/09   | <50  | <50          | <b>26</b>  | <0.5    | <0.5    | <0.5          | <0.6          | -     | -     | <1.0       | <10   | -     | -       | -     |      |
|           | 06/05/09   | <b>500</b>   | <b>1,200</b> | <b>40</b>  | <0.5    | <0.5    | <0.5          | <0.6          | -     | -     | <1.0       | <10   | -     | -       | -     |      |
| 09/09/09  | <b>390</b> | <b>1,800</b>   | <b>160</b>   | <0.5       | <0.5    | <0.5    | <0.6          | -             | -     | <1.0  | <10        | -     | -     | -       |       |      |
| 11/12/09  | <50        | <50  | <1.0         | <0.5       | <0.5    | <0.5    | <0.6          | -             | -     | <1.0  | <10        | -     | -     | -       |       |      |
| 02/18/10  | <50        | <50  | <1.0         | <0.5       | <0.5    | <0.5    | <0.6          | -             | -     | <1.0  | <10        | -     | -     | -       |       |      |
| 05/17/10  | <50        | <50  | <1.0         | <0.5       | <0.5    | <0.5    | <0.6          | -             | -     | <1.0  | <10        | -     | -     | -       |       |      |
| 11/23/10  | <b>140</b> | <50  | <b>49</b>    | <0.5       | <0.5    | <0.5    | <0.6          | <1.0          | <1.0  | <1.0  | <b>110</b> | <0.5  | <0.5  | -       |       |      |
| 05/20/11  | <b>120</b> | <50  | <b>100</b>   | <0.5       | <0.5    | <0.5    | <0.5          | -             | -     | <1.0  | <10        | -     | -     | -       |       |      |



**TABLE 3**  
**ANALYTICAL RESULTS OF GROUND WATER SAMPLES**  
**Rino Pacific/Oakland Truck Stop**  
**1107 5th Street, Oakland, California**  
**(µg/l)**

| Sample ID | Date     | 8015M |       | 8260B |         |         |               |               |       |       |       |       |       |         | 8021  |
|-----------|----------|-------|-------|-------|---------|---------|---------------|---------------|-------|-------|-------|-------|-------|---------|-------|
|           |          | TPH-g | TPH-d | MTBE  | Benzene | Toluene | Ethyl-benzene | Total Xylenes | DIPE  | ETBE  | TAME  | TBA   | EDB   | 1,2-DCA | MTBE  |
| MW-15     | 10/25/07 | <50   | <50   | <1.0  | <0.5    | <0.5    | <0.5          | <0.6          | <1.0  | <1.0  | <1.0  | <10   | <0.5  | <0.5    | -     |
|           | 01/25/08 | <50   | <50   | <1.0  | <0.5    | <0.5    | <0.5          | <0.6          | <1.0  | <1.0  | <1.0  | <10   | <0.5  | <0.5    | -     |
|           | 04/30/08 | <50   | <50   | <1.0  | <0.5    | <0.5    | <0.5          | <0.6          | <1.0  | <1.0  | <1.0  | <10   | <0.5  | <0.5    | -     |
|           | 07/30/08 | <50   | <50   | <1.0  | <0.5    | <0.5    | <0.5          | <0.6          | <1.0  | <1.0  | <1.0  | <10   | <0.5  | <0.5    | -     |
|           | 10/23/08 | <50   | <50   | <1.0  | <0.5    | <0.5    | <0.5          | <0.6          | <1.0  | <1.0  | <1.0  | <10   | <0.5  | <0.5    | -     |
|           | 11/12/09 | <50   | -     | <1.0  | <0.5    | <0.5    | <0.5          | <0.6          | -     | -     | <1.0  | <10   | -     | -       | -     |
|           | 11/23/10 | NOACC | NOACC | NOACC | NOACC   | NOACC   | NOACC         | NOACC         | NOACC | NOACC | NOACC | NOACC | NOACC | NOACC   | NOACC |
| MW-16     | 01/25/08 | <50   | <50   | <1.0  | <0.5    | <0.5    | <0.5          | <0.6          | <1.0  | <1.0  | <1.0  | <10   | <0.5  | <0.5    | -     |
|           | 04/30/08 | <50   | <50   | <1.0  | <0.5    | <0.5    | <0.5          | <0.6          | <1.0  | <1.0  | <1.0  | <10   | <0.5  | <0.5    | -     |
|           | 07/30/08 | <50   | <50   | <1.0  | <0.5    | <0.5    | <0.5          | <0.6          | <1.0  | <1.0  | <1.0  | <10   | <0.5  | <0.5    | -     |
|           | 10/23/08 | <50   | <50   | <1.0  | <0.5    | <0.5    | <0.5          | <0.6          | <1.0  | <1.0  | <1.0  | <10   | <0.5  | <0.5    | -     |
|           | 11/12/09 | <50   | -     | <1.0  | <0.5    | <0.5    | <0.5          | <0.6          | -     | -     | <1.0  | <10   | -     | -       | -     |
|           | 11/23/10 | NOACC | NOACC | NOACC | NOACC   | NOACC   | NOACC         | NOACC         | NOACC | NOACC | NOACC | NOACC | NOACC | NOACC   | NOACC |

**Notes:**

|        |   |          |                             |        |  |
|--------|---|----------|-----------------------------|--------|--|
| µg/l:  | micrograms per liter                                | 1,2-DCA: | 1,2-dichloroethane          | ND:    | Non-detect above minimum laboratory detection levels |
| †:     | duplicate sample                                    | MTBE:    | methyl tertiary-butyl ether | NOACC: | No Access  |
| - :    | not analyzed  | DIPE:    | di-isopropyl ether          |        |  |
| TPH-d  | total petroleum hydrocarbons quantified as diesel   | ETBE:    | ethyl tertiary-butyl ether  |        |  |
| TPH-g: | total petroleum hydrocarbons quantified as gasoline | TAME:    | tertiary-amyl methyl ether  |        |  |
| EDB:   | 1,2-dibromoethane                                   | TBA:     | tertiary-butyl alcohol      |        |  |