

Advanced GeoEnvironmental, Inc.

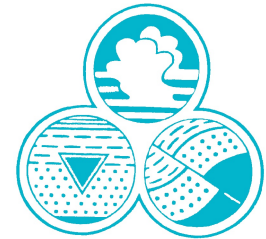

14 August 2007
AGE-NC Project No. 03-1101

Mr. Jerry Wickham
Alameda County Environmental Health Services
1131 Harbor Bay Parkway, Suite 250
Alameda, California 94502-6577

RECEIVED

1:23 pm, Aug 15, 2007

Alameda County
Environmental Health

**Subject: Soil Excavation and Ozone Well Destruction/Re-Installation Report
RINEHART OIL, INC. - OAKLAND TRUCK STOP
1107 5th Street, Oakland, California**

Dear Mr. Wickham:

Advanced GeoEnvironmental, Inc. has prepared the enclosed *Soil Excavation and Ozone Well Destruction/Re-Installation Report* for the above-referenced site. The scope of work includes the destruction of five ozone injection wells, excavation of approximately 367 cubic yards of soil surrounding the existing truck scale, and re-installation of five ozone injection wells. The work was performed as part of scale upgrade activities conducted by the property's lessee.

If you have any questions or require further information, please contact our office at (707) 570-1418.

Sincerely,

***Advanced* GeoEnvironmental, Inc.**

Jeremiah J. Puget
Project Environmental Scientist

Soil Excavation and Ozone Well Destruction/Re-Installation Report
RINEHART OIL, INC. - OAKLAND TRUCK STOP
1107 5th Street, Oakland, California

14 August 2007
AGE-NC Project No. 03-1101

PREPARED FOR:

Mr. Reed Rinehart
RINEHART OIL, INC.

PREPARED BY:

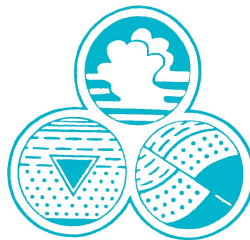

Advanced GeoEnvironmental, Inc.

381 Thor Place, Brea, California 92821 • Phone (714) 529-0200 • Fax (714) 529-0203
837 Shaw Road, Stockton, California 95215 • Phone (209) 467-1006 • Fax (209) 467-1118
2318 Fourth Street, Santa Rosa, California 95404 • Phone (707) 570-1418 • Fax (707) 570-1461
395 Del Monte Center, #111, Monterey, California 93940 • Phone (800) 511-9300 • Fax (831) 394-5979

**Soil Excavation and Ozone Well Destruction/Re-Installation Report
RINEHART OIL, INC. - OAKLAND TRUCK STOP
1107 5th Street, Oakland, California**

14 August 2007
AGE-NC Project No. 03-1101



**Advanced GeoEnvironmental, Inc.
837 Shaw Road, Stockton, California**

PREPARED BY:

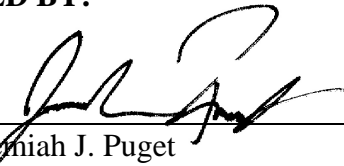

Jeremiah J. Puget
Project Environmental Scientist

PROJECT MANAGER:

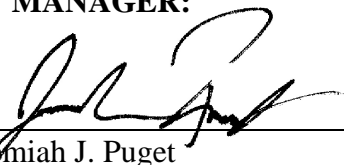

Jeremiah J. Puget
Project Environmental Scientist

REVIEWED BY:

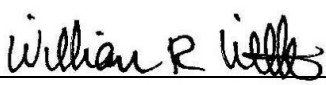

William R. Little
Senior Project Geologist
California Professional Geologist No. 7473

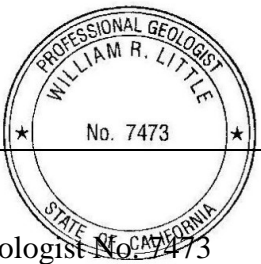

Soil Excavation and Ozone Well Destruction/Re-Installation Report
RINEHART OIL, INC. - OAKLAND TRUCK STOP
1107 5th Street, Oakland, California

TABLE OF CONTENTS

<u>SECTION</u>	<u>PAGE</u>
1.0. INTRODUCTION	1
2.0. SCOPE OF WORK	1
3.0. FIELD ACTIVITIES	1
3.1. OZONE WELL	2
3.2. SOIL EXCAVATION PROCEDURES	2
3.3. SOIL EXCAVATION SAMPLING	3
3.4. OZONE WELL DRILLING AND INSTALLATION	3
3.5. OZONE WELL PILOT SOIL BORING AND COMPLETION	4
3.6. OZONE SPARGING REMEDIATION	4
3.7. EQUIPMENT DECONTAMINATION	5
4.0. SOIL SAMPLE ANALYTICAL RESULTS	5
5.0. SUMMARY AND CONCLUSIONS	5
6.0. LIMITATIONS	6

FIGURES

Figure 1 - *Location Map*

Figure 2 - *Site Plan*

Figure 3 - *Excavation Soil Sample Location Map*

Figure 4 - *Ozone Well Construction Diagram*

TABLES

Table 1 - *Analytical Results of Soil Samples - Excavation Samples*

APPENDICES

Appendix A - *Site Background Information*

Appendix B - *Waste Disposal Manifests*

Appendix C - *Laboratory Analytical Data*

Soil Excavation and Ozone Well Destruction/Re-Installation Report
RINEHART OIL, INC. - OAKLAND TRUCK STOP
1107 5th Street, Oakland, California

1.0. INTRODUCTION

Advanced GeoEnvironmental, Inc. (AGE) has prepared this *Soil Excavation and Ozone Well Destruction /Re-Installation Report* for the site located at 1107 5th Street, Oakland, California (the site). The scope of work included the destruction of five ozone injection wells, excavation of approximately 367 cubic yards of soil surrounding the existing truck scale, and re-installation of five ozone injection wells. The work was performed as part of scale upgrade activities conducted by the property's lessee. The site and surrounding area are illustrated on Figure 1. On-site structures, soil borings, and well locations are illustrated on Figure 2. Site background information is provided in Appendix A.

2.0. SCOPE OF WORK

The work was conducted in accordance with the Soil Excavation and Ozone Well Destruction /Re-Installation Work Plan, dated 21 February 2007, and approved by the Alameda County Health Care Services (ACHCS) by letter dated 28 February 2007. The scope of work included the destruction of five ozone injection wells by over-drilling, soil excavation, and re-installation of five ozone injection wells after the completion of the truck scale upgrade activities conducted by CAT Scale and included the following tasks:

- Permitting and pre-field work activities;
- Destruction of five ozone injection wells;
- Soil excavation;
- Re-Installation of five ozone injection wells; and
- Report preparation.

3.0. FIELD ACTIVITIES

All field procedures will be overseen by an AGE representative under the supervision of a California Professional Geologist. Procedures for ozone well destructions and installations and soil excavation activities are described below. Applicable well destruction and installation permits were obtained from Alameda County Public Works Agency (ACPWA). An update to the health and safety plan presently on-file was prepared in accordance with *Occupational Safety and Health Guidance Manual for Hazardous Waste Site Activities* (National Institute for Occupational Safety and Health Administration, U.S. Coast Guard and U.S. Environmental Protection Agency, 1985). Prior to

mobilization, the area of excavation were clearly marked as required with white paint and a utility clearance obtained through Underground Service Alert.

3.1. OZONE WELL DESTRUCTION

On 13 March 2007, AGE personnel directed the destruction of five ozone injection wells (OZ6, OZ7, OZ10, OZ16 and OZ17) in preparation for truck scale upgrade activities to be performed by the property's lessee and CAT Scale. The ozone injection wells were destroyed Mitchell Drilling Environmental (MDE) of Eureka, California. Each well was over-drilled to total depth of 16 feet bsg, and were subsequently backfilled each boring with a cement grout mixture from total depth to surface grade. The locations of the destroyed ozone injection wells are depicted on Figure 2.

In preparation for destruction of ozone injection wells OZ6, OZ7, OZ10, OZ16 and OZ17 all material within the original boreholes, including the well casings, filter pack, annular seal, and well cover boxes were over-drilled utilizing a CME-HT drill rig equipt with 10-inch, hollow stem augers. Soil cuttings generated during over-drilling activities will be containerized in properly labeled, Department of Transportation (DOT)-approved 55-gallon drums and stored on-site in an area lacking public access pending disposal. Disposal alternatives will be evaluated based on the results of soil analysis.

Following over-drilling activities, each borehole was backfilled with a cement grout mixture to surface grade. The grout mixture consisted of a nominal 6 gallon to 94-pound sack portland cement ratio. The grout mixture was deployed utilizing the hollow stem augers as a tremie pipe. Grouting procedures were approved and witnessed by ACPWA personnel.

3.2. SOIL EXCAVATION PROCEDURES

Hydrocarbon-impacted soil surrounding the existing truck scale was excavated as part of truck scale removal and upgrade activities. Soil was removed to a depth of approximately six feet bsg using an excavator. Soil surrounding the existing truck scale was excavated by representatives of CAT Scale. The excavation provided the removal of a significant amount of petroleum hydrocarbon-impacted soil within the present vadose and smear zones. The soil was removed using an excavator to a total depth of approximately 6 feet bsg. While soil was excavated, trucks were immediately loaded for transportation Keller Canyon Landfill in Pittsburg, California. The impacted soil was transported by Intrinsic Transportation, Inc, of Santa Rosa, California and JT & T Enterprises of Cotati, California under non-hazardous waste manifest. According to total sum of truck weight tickets 543.76 tons or approximately 367 cubic yards of soil were disposed. Copies of the non-hazardous waste manifests and weight tickets are in Appendix B. The approximate extent of soil excavation is depicted on

Figure 2.

The excavation was backfilled with clean fill sand and pea gravel mixtures. The fill material placed in the excavation and was compacted by representatives of CAT Scale. In addition, the installation of the scale was conducted by representatives of CAT Scale.

3.3. SOIL EXCAVATION SAMPLING

A total of 13 soil samples were collected from the floor and sidewalls of the excavation for characterization and removal documentation purposes. Soil samples were collected from the bucket of the excavating equipment with a metric soil sampling hammer and one 6-inch by 2-inch brass sleeve. The exposed ends of the sample sleeve were covered with Teflon sheets, capped, and sealed with tape. Following sample collection, each sample sleeve was labeled with the sample location, depth, time, date, and sampler's initials. Appropriately sealed and labeled samples will be placed in a chilled container and transported under chain of custody procedure to a State of California Department of Health Services (DHS)-certified laboratory for analysis.

The location of the soil samples collected from the base and sidewalls of the excavation are depicted on Figure 3. The soil samples were analyzed by DHS-certified laboratory for the following constituents:

- TPH-g and TPH-d in accordance with EPA Method 8015 Modified;
- BTEX and MTBE, tertiary-butyl alcohol (TBA), di-isopropyl ether (DIPE), ethyl tertiary-butyl ether (ETBE), TAME, 1,2-DCA and 1,2-dibromoethane (EDB) in accordance with EPA Method 8260B.

The laboratory report for soil analysis, testing methods, laboratory quality assurance/quality control (QA/QC) reports, and sample chain of custody documentation are presented in Appendix C. The confirmation number for the GeoTracker submittal of laboratory electronic deliverable format (EDF) file is 3115173399.

3.4. OZONE WELL DRILLING AND INSTALLATION

After completion of the truck scale upgrade by CAT Scale, AGE personnel directed the advancement of five pilot soil borings at the site for the re-installation of ozone injection wells OZ6, OZ7, OZ10, OZ16 and OZ17. The re-installation activities were performed by MDE. The ozone well pilot soil borings were completed as single-level ozone injection wells with manufacturer-assembled, 2-inch

by 24-inch microporous sparge points set from approximately 11 feet to 13 feet bsg. An ozone injection well diagram is presented in Figure 4.

3.5. OZONE WELL PILOT SOIL BORING AND COMPLETION

Utilizing a CME-75HT truck-mounted hollow-stem drill rig equipped with 8.25-inch diameter hollow-stem augers, pilot soil borings for ozone injection wells OZ6, OZ7, OZ10, OZ16 and OZ17 were advanced to a depth of 14 feet bsg. The pilot borings will be completed with manufacturer-assembled, 2-inch by 24-inch microporous sparge points set from approximately 11 to 13 feet bsg and blank casing extending to the surface.

After installing the well casing in the pilot boring, a filter pack material consisting of pre-washed #3 Lonestar sand will be added through the augers from total depth to approximately 2 feet above the sparge point. A nominal 3-foot bentonite chip seal was placed above the filter pack to minimize the potential for grout penetration into the screened section of the wells. The bentonite seal was formed by pouring bentonite chips into the annulus and allowing them to settle on the filter pack. The bentonite chips will be allowed to hydrate for a minimum of ½-hour prior to grouting.

The remaining annular space was filled to within 1 foot of the ground surface with a cement grout. The grout mixture will consist of Type I/II portland neat cement and not more than 6 gallons of water per 94-pound sack of cement. The grout mixture was deployed utilizing the hollow stem augers as a tremie pipe. Grouting procedures were approved by ACPWA personnel.

3.6. OZONE SPARGING REMEDIATION

In-situ chemical oxidation (ozone injection) operation began at the site on 24 September 2005. From September 2005 to July 2007 the systems injected ozone for a ½-hour duration into two ozone injection points at a time.

A total of ten ozone injection wells, in conjunction with the south unit, have been on-line throughout the majority of the Second Quarter 2007. The north unit has been shut down since 13 March 2007 due to the destruction of ozone wells OZ6, OZ7, OZ10, OZ16, and OZ17; however, the north unit was brought back on-line 27 July 2007 subsequent to re-plumbing the recently installed ozone injection points. Both the north and south unit systems currently inject ozone for a 1-hour duration into one ozone injection points at a time.

Summaries of the ozone system operational parameters and activities through the Third Quarter 2007 will be included in a forthcoming report.

3.7. EQUIPMENT DECONTAMINATION

Prior to sample collection, all sampling tools used for sample collection were thoroughly washed with a solution of Alconox and rinsed with clean water. All down-hole and drilling equipment was pressure washed and steam cleaned prior to starting each boring. Cuttings and rinseate generated during drilling were containerized in properly labeled, DOT-approved 55-gallon drums and stored on-site in an area lacking public access pending disposal.

4.0. SOIL SAMPLE ANALYTICAL RESULTS

A total of 13 soil samples were collected from the sidewalls and the base of the excavation and submitted for laboratory analysis. Soil sample locations and analytical results are shown on Figure 3. A copy of the laboratory analytical report is presented in Appendix D. The confirmation number for the GeoTracker submittal of laboratory EDF file is 3115173399.

TPH-d-range petroleum hydrocarbons were detected in 10 of the 13 soil samples collected from the base and/or sidewalls of the excavation at concentrations ranging from 95 mg/kg (Floor-4) to 9,800 mg/kg {Floor-8 (Table 1)}. Petroleum hydrocarbons in the TPH-g-range were detected in 11 of the 13 soil samples collected from the excavation at concentrations ranging from 1.0 mg/kg (Floor-3) to 50 mg/kg {Exc-3 (Table 1)}.

BTEX compounds were detected in 7 of the 13 soil samples collected for analysis (Table 1). Benzene concentrations ranged from 0.020 mg/kg to 0.20 mg/kg. Toluene concentrations ranged from 0.018 mg/kg to 0.020 mg/kg. Ethylbenzene concentrations ranged from 0.014 mg/kg to 0.028 mg/kg. Total xylene concentrations ranged from 0.020 mg/kg to 0.044 mg/kg.

MTBE and TAME were the only two fuel additives detected in the soil samples collected for analysis (Table 1). MTBE was detected in 12 of the 13 soil samples at concentrations ranging from 0.030 mg/kg to 2.6 mg/kg. The reported concentrations of TAME ranged from 0.011 mg/kg to 0.90 mg/kg.

5.0. SUMMARY AND CONCLUSIONS

Ozone injection wells OZ6, OZ7, OZ10, OZ16 and OZ17 were appropriately destroyed to allow for a scale upgrade at the site. Once the former scale was removed approximately 367 cubic yards of soil were removed and disposed at the Keller Canyon Landfill in Pittsburg, California. Subsequent to installing the new scale at the site, ozone injection wells OZ6, OZ7, OZ10, OZ16 and OZ17 were re-located and re-installed at the site in the area surrounding the scale. The north ozone system was

brought back on-line and began injecting ozone into the subsurface on 27 July 2007.

TPH-d-range petroleum hydrocarbons were detected at concentrations ranging from 95 mg/kg to 9,800 mg/kg (Table 1). TPH-g-range petroleum hydrocarbons were detected at concentrations ranging from 1.0 mg/kg to 50 mg/kg (Table 1). Benzene concentrations ranged from 0.020 mg/kg to 0.20 mg/kg. Toluene concentrations ranged from 0.018 mg/kg to 0.020 mg/kg. Ethylbenzene concentrations ranged from 0.014 mg/kg to 0.028 mg/kg. Total xylene concentrations ranged from 0.020 mg/kg to 0.044 mg/kg. MTBE was detected in 12 of the 13 soil samples at concentrations ranging from 0.030 mg/kg to 2.6 mg/kg. The reported concentrations of TAME ranged from 0.011 mg/kg to 0.90 mg/kg (Table 1).

Based on the analytical results gathered from the floor and the sidewalls of the excavation, it appears that moderate to elevated levels of petroleum hydrocarbon-impacts to soil remain at depths of approximately six feet bsg on the northwest portion of the site.

6.0. LIMITATIONS

AGE's professional services were performed using that degree of care and skill ordinarily exercised by environmental consultants practicing in this or similar localities. The findings were based upon analytical results provided by an independent laboratory. Evaluations of the geologic/hydrogeologic conditions at the site for the purpose of this investigation were made from a limited number of available data points (i.e., soil samples) and subsurface conditions may vary beyond these data points. No other warranty, expressed or implied, is made as to the professional recommendations contained in this report.

FIGURES

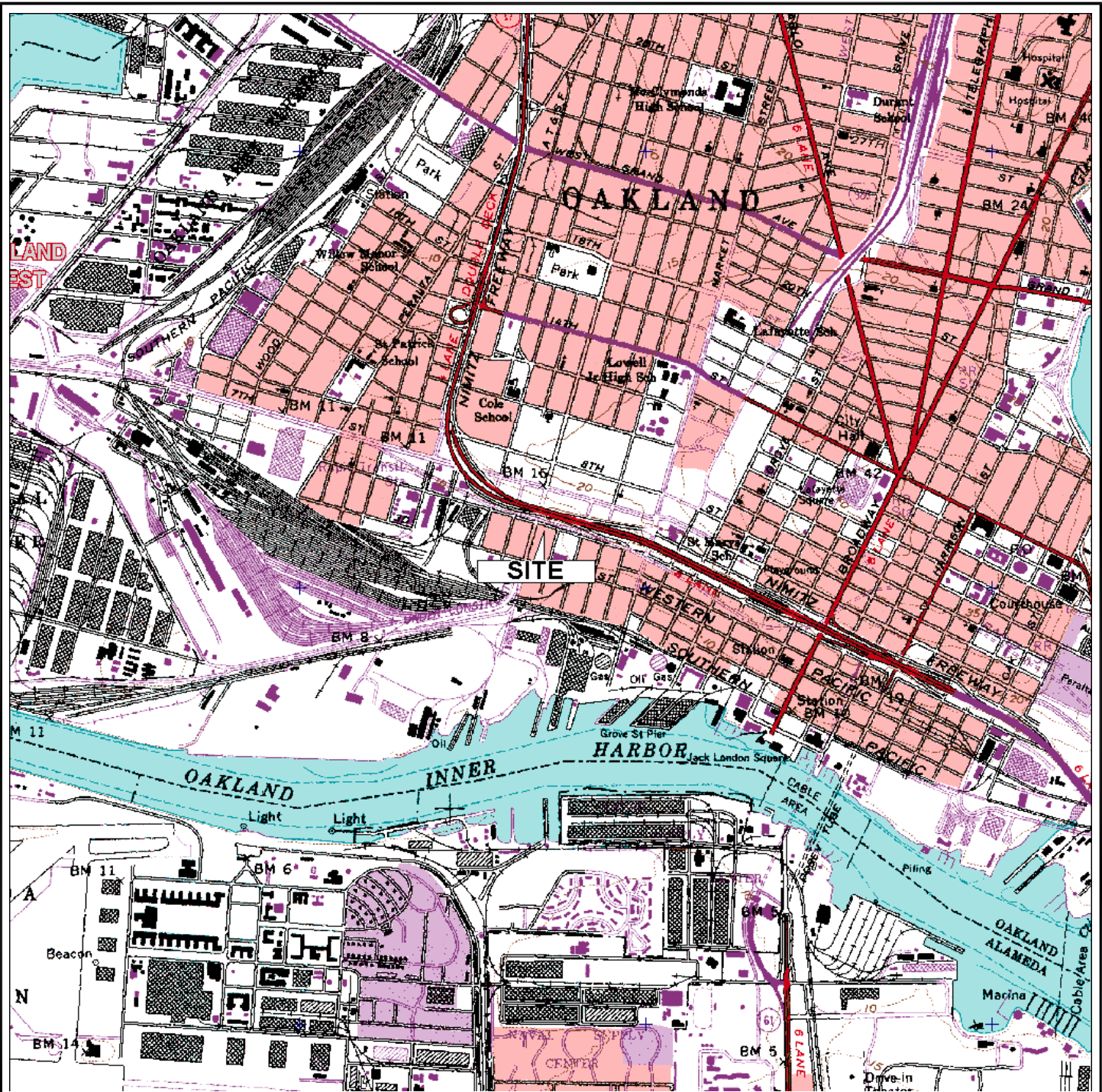

OAKLAND WEST QUADRANGLE, CALIFORNIA
 7.5 MINUTE SERIES (U.S. GEOLOGICAL SURVEY)

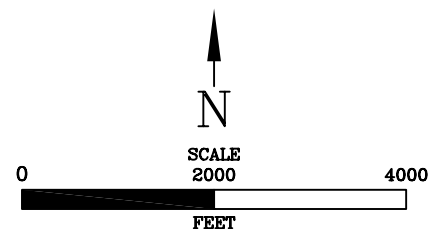

LOCATION MAP
 RINEHART – OAKLAND TRUCK STOP
 1107 5TH STREET
 OAKLAND, CALIFORNIA



Advanced
 GeoEnvironmental, Inc.
of Northern California

PROJECT NO. AGE-NC-03-1101	FILE: LOCATION	FIGURE:
DATE: 27 SEPTEMBER 2004	DRAWN BY: MAC	1

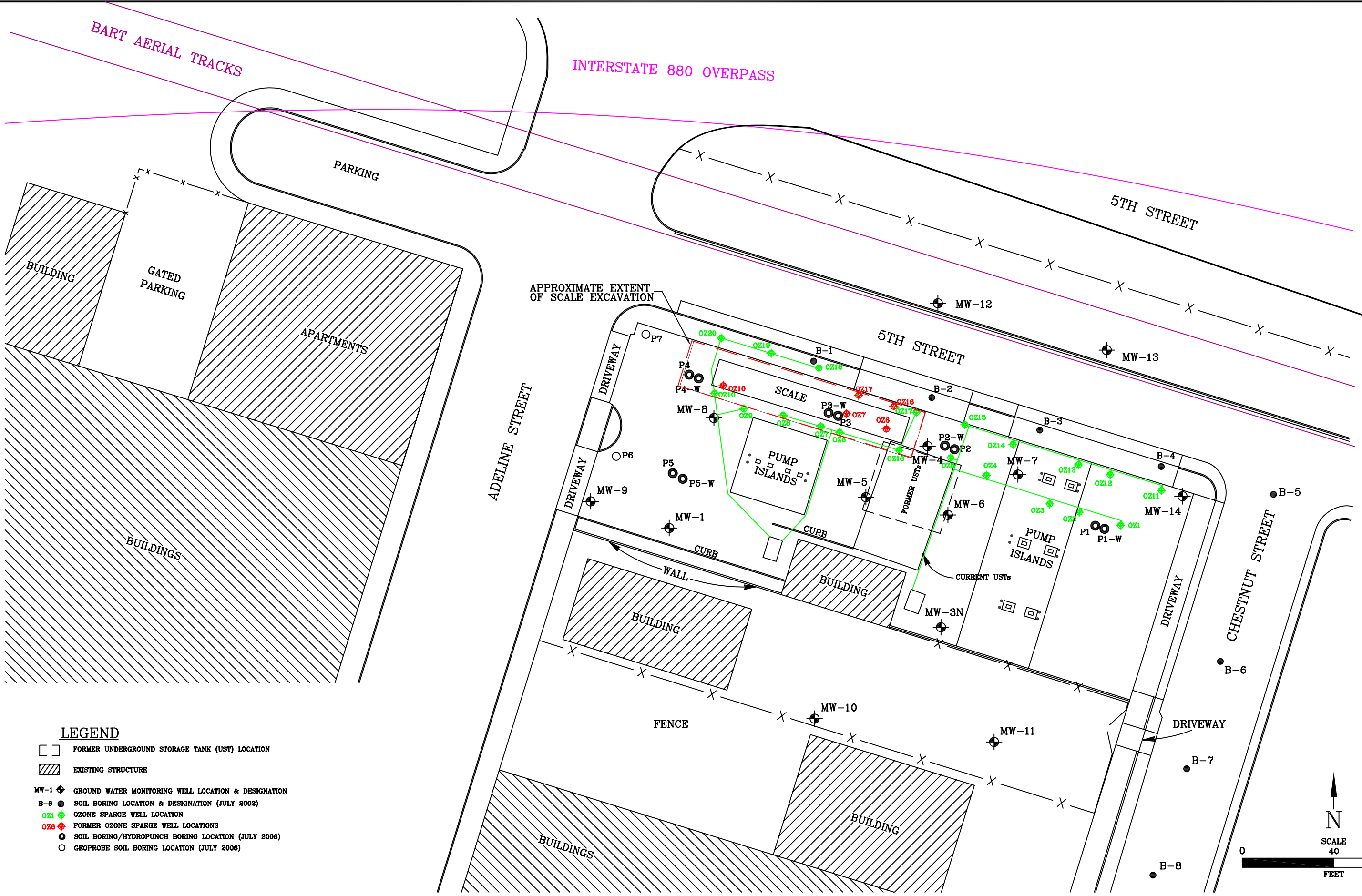

LEGEND

- FORMER UNDERGROUND STORAGE TANK (UST) LOCATION
- ▨ EXISTING STRUCTURE
- MW-1 ◈ GROUND WATER MONITORING WELL LOCATION & DESIGNATION
- B-6 ● SOIL BORING LOCATION & DESIGNATION (JULY 2002)
- OZ1 ● OZONE SPARGE WELL LOCATION
- OZ6 ● FORMER OZONE SPARGE WELL LOCATIONS
- SOIL BORING/HYDROPUNCH BORING LOCATION (JULY 2006)
- GEOPROBE SOIL BORING LOCATION (JULY 2006)

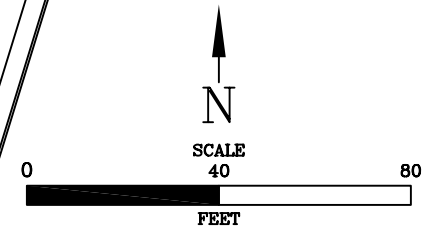

SITE PLAN
RINEHART - OAKLAND TRUCK STOP
1107 5TH STREET
OAKLAND, CALIFORNIA

APPROXIMATE EXTENT OF SCALE EXCAVATION

MW-12

MW-13

5TH STREET

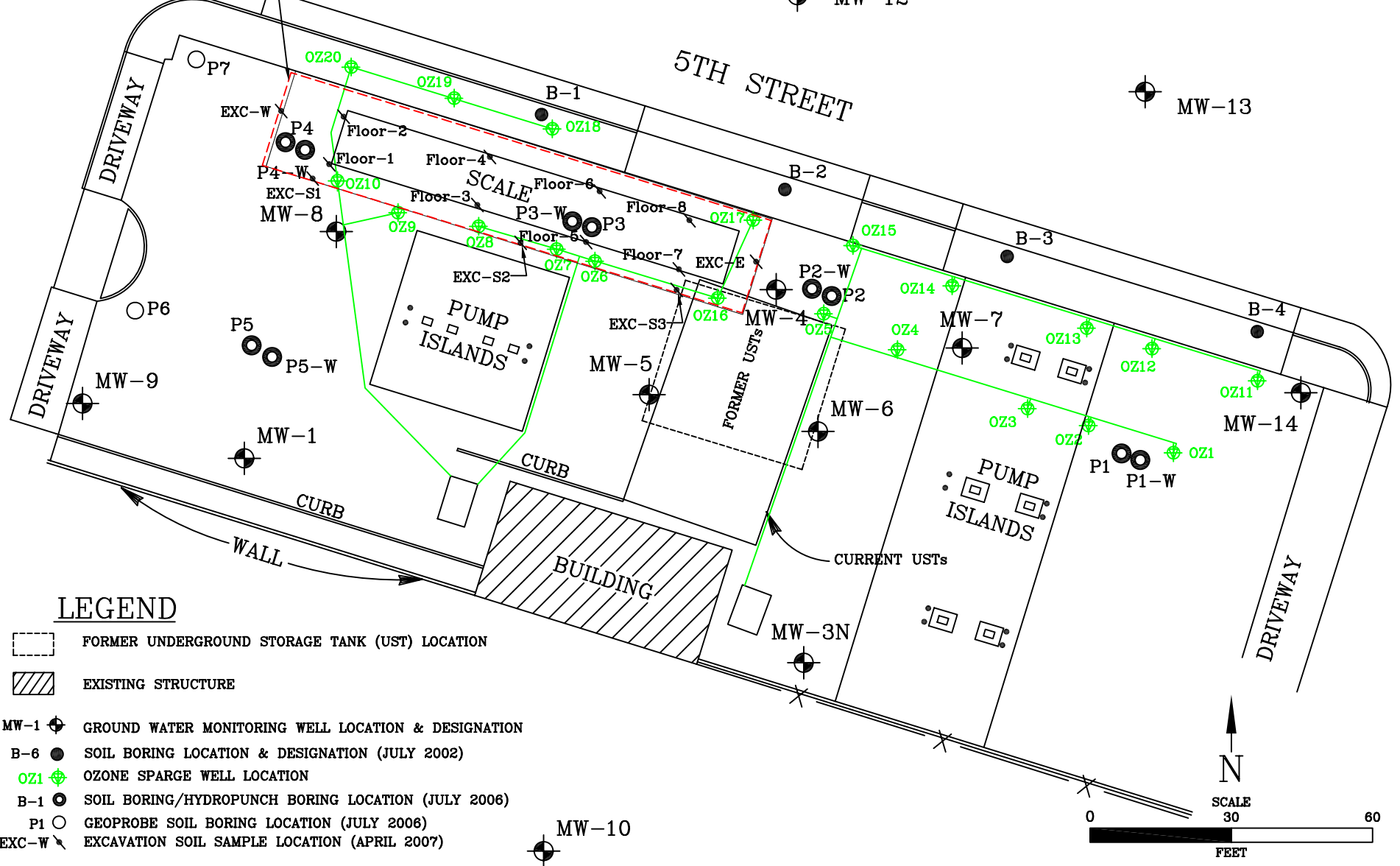

LEGEND

--- FORMER UNDERGROUND STORAGE TANK (UST) LOCATION

/// EXISTING STRUCTURE

MW-1 GROUND WATER MONITORING WELL LOCATION & DESIGNATION

B-6 SOIL BORING LOCATION & DESIGNATION (JULY 2002)

OZ1 OZONE SPARGE WELL LOCATION

B-1 SOIL BORING/HYDROPUNCH BORING LOCATION (JULY 2006)

P1 GEOPROBE SOIL BORING LOCATION (JULY 2006)

EXC-W EXCAVATION SOIL SAMPLE LOCATION (APRIL 2007)

MW-10

N

SCALE
0 30 60
FEET

EXCAVATION SOIL SAMPLE LOCATION MAP
 RINEHART - OAKLAND TRUCK STOP
 1107 5TH STREET
 OAKLAND, CALIFORNIA

 Advanced GeoEnvironmental, Inc. <i>of Northern California</i>		
PROJECT NO. AGE-SR-03-1101	FILE: Oakland EX	FIGURE: 3
DATE: August 2007	DRAWN BY: MAC	

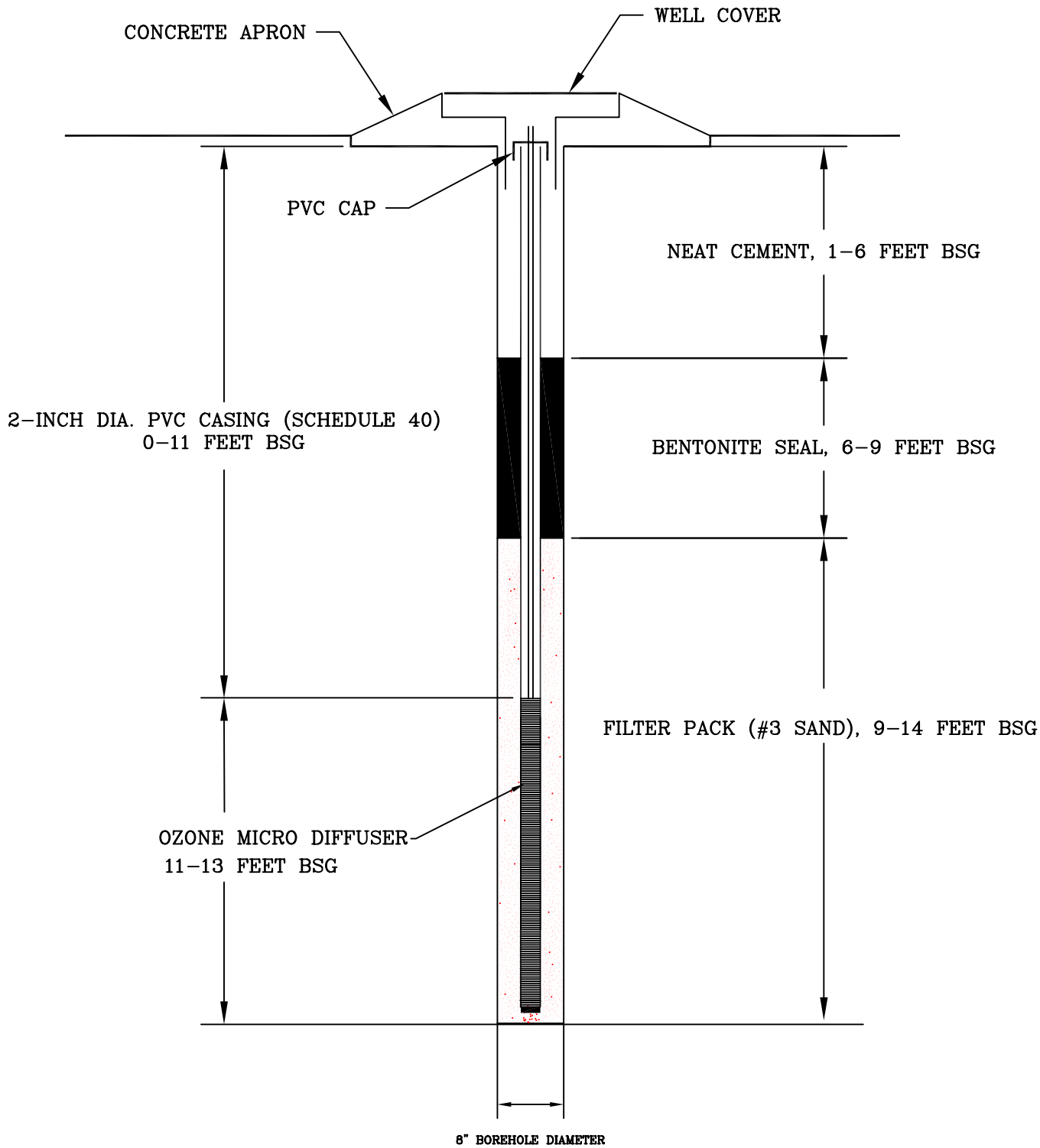

BGS - BELOW SURFACE GRADE
NOT TO SCALE

OZONE SPARGE POINT CONSTRUCTION DIAGRAM
RINEHART - OAKLAND TRUCK STOP
1107 5TH STREET
OAKLAND, CALIFORNIA



Advanced
GeoEnvironmental, Inc.
of Northern California

PROJECT NO. AGE-SR-03-1101

FILE: OaklandOSP

FIGURE:

DATE: August 2007

DRAWN BY: KMM

4

TABLES

TABLE 1
ANALYTICAL RESULTS OF SOIL SAMPLES - SCALE EXCAVATION
RINEHART OIL, INC. - OAKLAND TRUCK STOP
 1107 5th Street, Oakland, California
 (mg/kg)

Sample I.D.	Date	EPA 8015M		EPA 8260B										
		TPH-g	TPH-d	Benzene	Toluene	Ethyl-benzene	Total Xylenes	MTBE	DIPE	ETBE	TAME	TBA	1,2-DCA	EDB
Floor-1	04/04/07	1.1	370	0.20	<0.005	<0.005	<0.005	0.60	<0.01	<0.01	0.036	<0.10	<0.005	<0.005
Floor-2	04/04/07	7.0	270	<0.005	<0.005	<0.005	<0.005	0.072	<0.01	<0.01	<0.01	<0.10	<0.005	<0.005
Floor-3	04/04/07	1.0	220	<0.005	<0.005	<0.005	<0.005	0.030	<0.01	<0.01	<0.01	<0.10	<0.005	<0.005
Floor-4	04/04/07	<1.0	95	<0.005	<0.005	<0.005	<0.005	0.036	<0.01	<0.01	<0.01	<0.10	<0.005	<0.005
Floor-5	04/04/07	2.0	930	<0.005	<0.005	<0.005	<0.005	0.034	<0.01	<0.01	<0.01	<0.10	<0.005	<0.005
Floor-6	04/04/07	<1.0	<5.0	<0.005	<0.005	<0.005	<0.005	<0.005	<0.01	<0.01	<0.01	<0.10	<0.005	<0.005
Floor-7	04/04/07	1.4	<5.0	<0.005	<0.005	<0.005	<0.005	1.2	<0.01	<0.01	0.042	<0.10	<0.005	<0.005
Floor-8	04/04/07	13	9,800	<0.005	0.018	0.016	0.024	2.6	<0.01	<0.01	0.046	<0.10	<0.005	<0.005
Exc-S1	04/04/07	24	1,100	<0.005	0.018	0.014	0.020	0.040	<0.01	<0.01	<0.01	<0.10	<0.005	<0.005
Exc-S2	04/04/07	30	4,400	0.024	0.020	0.018	0.020	0.23	<0.01	<0.01	0.048	<0.10	<0.005	<0.005
Exc-S3	04/04/07	50	8,600	0.046	0.018	0.028	0.044	2.4	<0.01	<0.01	0.90	<0.10	<0.005	<0.005
Exc-W	04/04/07	36	2,300	0.020	0.020	0.014	0.020	0.13	<0.01	<0.01	0.036	<0.10	<0.005	<0.005
Exc-E	04/04/07	5.0	<5.0	0.020	0.019	0.014	0.022	2.0	<0.01	<0.01	0.011	<0.10	<0.005	<0.005

Notes:

mg/kg: milligrams per kilogram

TPH-g: total petroleum hydrocarbons quantified as gasoline

TPH-d: total petroleum hydrocarbons quantified as diesel

MTBE: methyl tertiary-butyl ether

DIPE: di-isopropyl ether

ETBE: ethyl tertiary-butyl ether

TAME: tertiary-amyl methyl ether

TBA: tertiary-butyl alcohol

1,2-DCA: 1,2-dichloroethane

EDB: 1,2-dibromoethane

APPENDIX A

APPENDIX A
Site Background Information
Rinehart Oil, Inc - Oakland Truck Stop
1107 5th Street, Oakland, California

A.1. BACKGROUND

The site is located at 1107 5th Street in a commercial and industrial area of west Oakland, California (Figure 1). The site contains a service station building, four fuel dispenser islands, a truck scale, scale house, and two underground storage tanks (USTs). The site has been operating as a truck stop for the past 40 years.

A.2. REGIONAL GEOLOGIC/HYDROGEOLOGIC SETTING

The site is situated within the Coast Range Geomorphic Province of California. This geomorphic province contains coastal foothills and mountains and extends from the Tehachapi Mountains in the south to the Klamath Mountains in the north. The western and eastern boundaries of this province are comprised of the Pacific Ocean and the Great Valley Geomorphic Province, respectively.

The site is located in the Franciscan Complex, which is subdivided into four major divisions identified as the Northern Coast Range, the Franciscan Block, the Diablo Range, and the Nacimiento Block. The site is situated within the Franciscan Block, an assemblage of variably deformed and metamorphosed rock units. The surface is composed of Quaternary alluvium; at depth, the site is underlain by rocks of the Franciscan Complex, which are composed predominately of detrital sedimentary rocks with volcanic tuffs and deep ocean marine sediments. The Franciscan lithologies typically have low porosity and permeability.

Based upon the General Soil Map from the *Soil Survey of Alameda County, Western Part*, issued by the United States Department of Agriculture Soil Conservation Service in 1981, the site area is situated within the Urban Land-Danville complex. This complex is located on low terraces and alluvial fans at an elevation of about 20 feet to 300 feet above mean sea level (MSL), and consists of approximately 60% Urban Land, 30% Danville soil, and 10% other soils. Danville soil is a silty clay loam that formed in alluvium originating primarily from sedimentary rock; Urban land consists of areas covered by roads, parking lots, and buildings. The nearest surface water feature in the vicinity of the site is the Oakland Estuary, approximately 2,400 feet to the south of the property.

Beginning in October 1996, ground water monitoring has been conducted at the site to assess the seasonal variation of elevation, gradient, and flow direction, and to define the impact of petroleum hydrocarbon compounds and fuel oxygenating compounds in shallow ground water beneath the site. Based on data from previous monitoring events, ground water at the property varies seasonally between approximately 10 inches to 6 feet below surface grade (bsg). The ground water flow has varied from southwest to north. This may be affected by changing recharge and discharge patterns, as well as leaking pipes.

A.3. UNDERGROUND STORAGE TANK REMOVAL

In March 1999, two 10,000-gallon diesel USTs, one 10,000-gallon gasoline UST, and one 8,000-gallon gasoline UST were removed from the site. The approximate location of the former USTs is shown on Figure 2.

Interim remedial action was performed during the UST removal to address contaminated soil and ground water. Approximately 2,100 tons of contaminated soil were removed from the excavation. Soil samples were collected from the excavation and stockpiles as directed by the Fire Inspector. Contaminated ground water was removed from the excavation pit; approximately 33,000 gallons of water were pumped into temporary storage tanks, which were then transported and disposed off-site. Approximately 1,700 tons of backfill was placed in the excavation. Results of the soil samples taken during the excavation are not available.

A.4. PREVIOUS SITE ASSESSMENT ACTIVITIES

In November 1996, ground water monitoring wells MW-1 through MW-3 were installed to a depth of 20 feet bsg to assess contamination from an unauthorized release of fuel, which was repaired as soon as it was discovered. Product recovery sumps equipped with skimmers were installed in the wells and approximately 6 gallons of gasoline were recovered.

Monitoring well MW-2 was destroyed in January 1999. Additional monitoring wells MW-4 through MW-9 were installed to a total depth of 20 feet bsg in August 2000. Contamination was detected in each of the wells, and free product was occasionally evident in well MW-7.

Monitoring wells MW-10 and MW-11 were installed in May 2002 to a total depth of 12 feet bsg. At this time, well MW-3 was abandoned and well MW-3N was installed to a depth of 12 feet bsg.

In July 2002, eight soil borings were advanced on 5th Street and Chestnut Street to total depths between 5 feet and 8 feet bsg to determine if contamination was migrating off-site along preferential pathways (i.e. utility trenches). Sample results indicated high methyl tertiary-butyl ether (MTBE) concentrations that ranged from 170,000 micrograms per liter ($\mu\text{g}/\text{l}$) to 460,000 $\mu\text{g}/\text{l}$ in grab ground water samples from borings drilled directly north of the site, along the 5th Street sewer line. Borings east of the site had little to no contamination.

In January 2003, a passive skimmer was placed inside monitoring well MW-7 to remove free product. During monitoring activities in April 2004, free-product was noted in MW-8. The passive skimmer in MW-7 was moved to MW-8 to remove the free product.

On 04 and 05 October 2004, a total of thirteen soil borings were advanced at the site. Boring MW-14

and the ten ozone sparge well borings were advanced at the north edge of the property to vertical depths of 20 feet and 15 feet bsg, respectively. Borings MW-12 and MW-13 were advanced in the 5th Street right of way to the north of the property to a vertical depth of 20 feet bsg. Pilot borings MW-12 through MW-14 were completed as ground water monitoring wells to a vertical depth of 20 feet bsg. The ozone sparge well soil borings were completed with manufacturer-assembled, 2-inch by 24-inch microporous sparge points and blank casing extended to the surface, with a filter pack (No. 2/12 Lonestar sand) installed from 9 feet to 13 feet bsg. A total of three soil samples, taken from the monitoring well pilot borings, were analyzed for petroleum hydrocarbon constituents. In sample MW14-10, 1.8 milligrams per kilogram (mg/kg) of total hydrocarbons as diesel (TPH-d) and 2.0 mg/kg MTBE were detected.

In July 2006, five soil borings were advanced on-site to a depth of 40 feet below bsg utilizing a CME-75 HT truck-mounted drill rig. Two additional soil borings were advanced on-site near the Adeline Street utility corridor to 20 feet bsg utilizing a van-mounted Geoprobe 5400 direct-push probing unit. All borings were continuously cored from surface grade to total depth. Soil and grab ground water samples were collected at selected intervals based on lithology encountered during drilling; grab ground water samples were collected from borings advanced immediately adjacent to P1 through P5, and at total depth in borings P6 and P7. Soil samples were collected between depths of 6 feet and 40 feet bsg from borings P1 through P7 and analyzed for petroleum hydrocarbon constituents. Total hydrocarbons as gasoline (TPH-g) was detected in soil samples P1-6, P1-21, P2-8, and P4-7 at concentrations of 210 mg/kg, 2.6 mg/kg, 110 mg/kg, and 10 mg/kg, respectively. TPH-d was detected in samples P1-6, P2-8, and P4-7 at concentrations of 7,600 mg/kg, 680 mg/kg, and 13,000 mg/kg, respectively.

Grab ground water samples were collected from soil borings advanced immediately adjacent to P1 through P5 at selected sandy zones between 10 feet and 35 feet bsg, and from borings P6 and P7 at a depth of 20 feet bsg. TPH-g was detected in boring P1 at 20 feet and 35 feet bsg, in boring P4 at 10 feet bsg, in boring P5 at 10 feet and 35 feet bsg, and in borings P6 and P7 at 20 feet bsg at concentrations ranging from 130 µg/l (P6-20-W) to 38,000 µg/l (P4-W-10). TPH-d was detected in boring P1 at 20 feet and 35 feet bsg, in boring P4 at 10 feet bsg, and in boring P7 at 20 feet bsg at concentrations ranging from 4,500 µg/l (P1-W-35) to 350,000 µg/l (P4-W-10). BTEX constituents were detected in boring P1 at 20 feet and 35 feet bsg, P5 at 10 feet and 35 feet bsg, and P6 at 20 feet bsg at maximum concentrations of 110 µg/l benzene (P1-W-20), 36 µg/l toluene (P5-W-10), 13 µg/l ethylbenzene (P1-W-35), and 17.3 µg/l total xylenes (P1-W-20). MTBE was detected in samples collected from boring P1 at 20 feet and 35 feet bsg, in boring P4 at 10 feet bsg, in boring P5 at 10 feet and 35 feet bsg, and in borings P6 and P7 at 20 feet bsg at concentrations ranging from 4.1 µg/l (P6-20-W) to 11,000 µg/l (P1-W-20). Tertiary-amyl methyl ether (TAME) was detected in boring P1 at 20 feet and 35 feet bsg, in boring P4 at 10 feet bsg, and in boring P5 at 10 feet bsg at concentrations ranging from 3.4 µg/l (P5-W-10) to 17 µg/l (P1-W-20). The lead scavenger 1,2-dichloroethane (1,2-DCA) was detected in boring P1 at 20 feet and 35 feet bsg at concentrations of 4.7 µg/l and 3.4 µg/l, respectively. Benzene was detected in sample P1-21 at a concentration of

0.014 mg/kg. Toluene, ethylbenzene, and xylenes were detected in sample P2-8 at concentrations of 0.22 mg/kg, 0.62 mg/kg, and 4.2 mg/kg, respectively.

A.5. STRATIGRAPHY

In general, a distinct zone of gray-brown to black, moist to saturated peat and clay with a strong, stale odor was encountered throughout the site west of boring P1. The top of the peat zone was encountered at depths between approximately 7 feet on the western end of the site and 12 feet on the eastern end in boring P7, with thickness ranging from approximately 7 feet in boring P2 (east) to 20 feet in boring P4 (west). Clay and sandy clay were encountered in borings P3, P4, and P7 at depths above approximately 7 feet bsg, and gray to dark brown, fine-grained and poorly graded sand and silty sand were identified east of boring P1 and throughout the remaining depth intervals in all other borings.

APPENDIX B

Keller Canyon Sanitary Landfill

901 Bailey Road
Pittsburg, CA 94565
Phone (925) 458-9800
Fax (925) 458-9891

Ox Mountain Sanitary Landfill

12310 San Mateo Road
Half Moon Bay, CA 94019
Phone (650) 726-1819
Fax (650) 726-9183

Newby Island Sanitary Landfill

1601 Dixon Landing Road
Milpitas, CA 95035
Phone (408) 945-2800
Fax (408) 262-2871

Forward Landfill

9999 S. Austin Road
Manteca, CA 95336
Phone (209) 982-4298
Fax (209) 982-1009

NON-HAZARDOUS WASTE MANIFEST

GENERATOR <i>RoadBrite, Inc</i>		WASTE ACCEPTANCE NO. - 212 774 089	
MAILING ADDRESS <i>P.O. Box 775</i>			
CITY, STATE, ZIP <i>Whitt CA 95482</i>		REQUIRED PERSONAL PROTECTIVE EQUIPMENT	
PHONE <i>(707) 967-8811</i>		<input checked="" type="checkbox"/> GLOVES <input type="checkbox"/> GOGGLES <input type="checkbox"/> RESPIRATOR <input type="checkbox"/> HARD HAT	
CONTACT PERSON <i>Ken Rodbard</i>		<input type="checkbox"/> TY-VEK <input type="checkbox"/> OTHER	
SIGNATURE OF AUTHORIZED AGENT / TITLE * <i>[Signature]</i>		SPECIAL HANDLING PROCEDURES:	
DATE <i>4-3-07</i>			
GENERATOR'S CERTIFICATION: I hereby certify that the above named material is not a hazardous waste as defined by 40 CFR Part 261 or title 22 of the California code of regulations, has been properly described, classified and packaged, and is in proper condition for transportation according to applicable regulations; AND, if the waste is a treatment residue of a previously restricted hazardous waste subject to the Land Disposal Restrictions, I certify and warrant that the waste has been treated in accordance with the requirements of 40 CFR Part 268 and is no longer a hazardous waste as defined by 40 CFR Part 261.		RECEIVING FACILITY <i>Keller Canyon</i>	
WASTE TYPE: <i>soil contaminated w/ diesel & unleaded gas</i>			
<input checked="" type="checkbox"/> DISPOSAL <input type="checkbox"/> SLUDGE <input type="checkbox"/> CONSTRUCTION <input type="checkbox"/> WOOD <input type="checkbox"/> DEBRIS <input type="checkbox"/> OTHER <input type="checkbox"/> SPECIAL WASTE			
GENERATING FACILITY <i>Oakland Truck Stop</i>			
TRANSPORTER <i>Falcons Transportation, Inc</i>		NOTES:	VEHICLE LICENSE NUMBER
ADDRESS <i>2275 Challenger Way Suite 100</i>			<i>712</i>
CITY, STATE, ZIP <i>San Jose CA 95107</i>		<i>*KTHLON 705/10/02 KTL202</i>	
PHONE <i>(707) 578-0960</i>		END DUMP	BOTTOM DUMP
SIGNATURE OF AUTHORIZED AGENT OR DRIVER * <i>[Signature]</i>		<input type="checkbox"/>	<input type="checkbox"/>
DATE <i>4/3/07</i>		ROLL-OFF(S)	VAN
		<input type="checkbox"/>	<input type="checkbox"/>
I hereby certify that the above named material has been accepted and to the best of my knowledge the foregoing is true and accurate.		CUBIC YARDS <i>2</i>	
REMARKS		DISPOSAL METHOD: (TO BE COMPLETED BY LANDFILL)	
FACILITY TICKET NUMBER		DISPOSE	
SIGNATURE OF AUTHORIZED AGENT * <i>[Signature]</i>		OTHER	
DATE		<input checked="" type="checkbox"/> SOIL	
		<input type="checkbox"/> CONSTRUCTION DEBRIS	
		<input type="checkbox"/> NON-FRIABLE ASBESTOS	
		<input type="checkbox"/> WOOD	
		<input type="checkbox"/> ASH	
		<input type="checkbox"/> SPECIAL OTHER	

SCHEDULING MUST BE MADE PRIOR TO 3:00 P.M. THE DAY PRIOR TO EXPECTED ARRIVAL • ANY UNSCHEDULED LOADS ARE SUBJECT TO REFUSAL UPON ARRIVAL. ONGOING DAILY DELIVERIES MUST BE SCHEDULED WITH THE LANDFILL THE DAY BEFORE.

MANIFEST # **53738**

141120

KELLER CANYON LANDFILL
 901 BAILEY ROAD
 PITTSBURG, CA

003780
 ADVANCED GEO ENVIRONMENTAL INC
 4005 NORTH WILSON WAY

STOCKTON, CA 95205
 Contract: #212Y74089

SITE 01	TICKET 381526	GRID
WEIGHMASTER		
FELIPE C		
DATE IN 4 April 2007	TIME IN 1:58 pm	
DATE OUT 4 April 2007	TIME OUT 1:58 pm	
VEHICLE KTL202	ROLL OFF	
REFERENCE 53738	ORIGIN OAKLAND	

Gross Weight 80,540.00 lb Inbound - SCALE TICKET
 Tare Weight 34,020.00 lb
 Net Weight 46,520.00 lb 23.26 TN

QTY.	UNIT	DESCRIPTION	RATE	EXTENSION	TAX	TOTAL
23.26	TN	SW-CONT SOIL W/FUEL				
1.00	LD	ENVIRONMENTAL FEE				
1.00	LD	FUEL RECOVERY FEE				

NET AMOUNT

Keller Canyon Sanitary Landfill
 901 Bailey Road
 Pittsburg, CA 94565
 Phone (925) 458-9800
 Fax (925) 458-9891

Ox Mountain Sanitary Landfill
 12310 San Mateo Road
 Half Moon Bay, CA 94019
 Phone (650) 726-1819
 Fax (650) 726-9183

Newby Island Sanitary Landfill
 1601 Dixon Landing Road
 Milpitas, CA 95035
 Phone (408) 945-2800
 Fax (408) 262-2871

Forward Landfill
 9999 S. Austin Road
 Manteca, CA 95336
 Phone (209) 982-4298
 Fax (209) 982-1009

NON-HAZARDOUS WASTE MANIFEST

GENERATOR *Knockout, Inc*

MAILING ADDRESS *PO Box 725*

CITY, STATE, ZIP *Ukiah, CA 95487*

PHONE *(707) 462-8811*

CONTACT PERSON *Red Pinchot*

SIGNATURE OF AUTHORIZED AGENT / TITLE *[Signature]* DATE *4-3-07*

GENERATOR'S CERTIFICATION: I hereby certify that the above named material is not a hazardous waste as defined by 40 CFR Part 261 or title 22 of the California code of regulations, has been properly described, classified and packaged, and is in proper condition for transportation according to applicable regulations; AND, if the waste is a treatment residue of a previously restricted hazardous waste subject to the Land Disposal Restrictions, I certify and warrant that the waste has been treated in accordance with the requirements of 40 CFR Part 268 and is no longer a hazardous waste as defined by 40 CFR Part 261.

WASTE TYPE: *soil contaminated w/ diesel & contained gas*

DISPOSAL SLUDGE
 CONSTRUCTION WOOD
 DEBRIS OTHER
 SPECIAL WASTE

GENERATING FACILITY *Oakland Truck Stop*

TRANSPORTER *Interior Transportation, Inc.*

ADDRESS *2225 Challenger Way, Suite 100*

CITY, STATE, ZIP *Santa Rosa, CA 95407*

PHONE *(707) 528-0960*

SIGNATURE OF AUTHORIZED AGENT OR DRIVER *[Signature]* DATE *4-4-07*

I hereby certify that the above named material has been accepted and to the best of my knowledge the foregoing is true and accurate.

REMARKS

FACILITY TICKET NUMBER

SIGNATURE OF AUTHORIZED AGENT *[Signature]* DATE

WASTE ACCEPTANCE NO.

- 212 774 089

REQUIRED PERSONAL PROTECTIVE EQUIPMENT

GLOVES GOGGLES RESPIRATOR HARD HAT
 TY-VEK OTHER

SPECIAL HANDLING PROCEDURES:

RECEIVING FACILITY *Keller Canyon*

NOTES: VEHICLE LICENSE NUMBER TRUCK NUMBER *514*

END DUMP BOTTOM DUMP TRANSFER
 ROLL-OFF(S) FLAT-BED VAN DRUMS

CUBIC YARDS

DISPOSAL METHOD: (TO BE COMPLETED BY LANDFILL)

	DISPOSE	OTHER
<input type="checkbox"/> SOIL		
<input type="checkbox"/> CONSTRUCTION DEBRIS		
<input type="checkbox"/> NON-FRIABLE ASBESTOS		
<input type="checkbox"/> WOOD		
<input type="checkbox"/> ASH		
<input type="checkbox"/> SPECIAL OTHER		

SCHEDULING MUST BE MADE PRIOR TO 3:00 P.M. THE DAY PRIOR TO EXPECTED ARRIVAL • ANY UNSCHEDULED LOADS ARE SUBJECT TO REFUSAL UPON ARRIVAL. ONGOING DAILY DELIVERIES MUST BE SCHEDULED WITH THE LANDFILL THE DAY BEFORE.

MANIFEST # **53742**

141107

KELLER CANYON LANDFILL
 901 BAILEY ROAD
 PITTSBURG, CA

003780
 ADVANCED GEO ENVIRONMENTAL INC
 4005 NORTH WILSON WAY

STOCKTON, CA 95205
 Contract: #212Y74089

SITE 01	TICKET 381514	GRID
WEIGHMASTER		
FELIPE C		
DATE IN 4 April 2007	TIME IN 1:46 pm	
DATE OUT 4 April 2007	TIME OUT 1:46 pm	
VEHICLE IT514	ROLL OFF	
REFERENCE 53742	ORIGIN OAKLAND	

02 Gross Weight 85,140.00 lb
 Stored Tare Weight 31,140.00 lb
 Net Weight 54,000.00 lb 27.00 TN

Inbound - SCALE TICKET

QTY.	UNIT	DESCRIPTION	RATE	EXTENSION	TAX	TOTAL
27.00	TN	SW-CONT SOIL W/FUEL				
1.00	LD	ENVIRONMENTAL FEE				
1.00	LD	FUEL RECOVERY FEE				

Keller Canyon Sanitary Landfill
 901 Bailey Road
 Pittsburg, CA 94565
 Phone (925) 458-9800
 Fax (925) 458-9891

Ox Mountain Sanitary Landfill
 12310 San Mateo Road
 Half Moon Bay, CA 94019
 Phone (650) 726-1819
 Fax (650) 726-9183

Newby Island Sanitary Landfill
 1601 Dixon Landing Road
 Milpitas, CA 95035
 Phone (408) 945-2800
 Fax (408) 262-2871

Forward Landfill
 9999 S. Austin Road
 Manteca, CA 95336
 Phone (209) 982-4299
 Fax (209) 982-1009

NON-HAZARDOUS WASTE MANIFEST

GENERATOR *Kimberly, Inc*

MAILING ADDRESS *P.O. Box 725*

CITY, STATE, ZIP *Oakland CA 94682*

PHONE *(707) 462-8211*

CONTACT PERSON *Wendy Brelaut*

SIGNATURE OF AUTHORIZED AGENT / TITLE *[Signature]* DATE *4-3-07*

GENERATOR'S CERTIFICATION: I hereby certify that the above named material is not a hazardous waste as defined by 40 CFR Part 261 or title 22 of the California code of regulations, has been properly described, classified and packaged, and is in proper condition for transportation according to applicable regulations; **AND, if the waste is a treatment residue of a previously restricted hazardous waste** subject to the Land Disposal Restrictions, I certify and warrant that the waste has been treated in accordance with the requirements of 40 CFR Part 268 and is no longer a hazardous waste as defined by 40 CFR Part 261.

WASTE TYPE: *oil contaminated w/ diesel & unleaded gas*

DISPOSAL SLUDGE
 CONSTRUCTION WOOD
 DEBRIS OTHER
 SPECIAL WASTE

GENERATING FACILITY *Oakland Truck Stop*

TRANSPORTER *Intrinsic Transportation, Inc.*

ADDRESS *7275 Challenge Way, Suite 100*

CITY, STATE, ZIP *Santa Rosa, CA 95407*

PHONE *(707) 578-0960*

SIGNATURE OF AUTHORIZED AGENT OR DRIVER *[Signature]* DATE *04-04-07*

I hereby certify that the above named material has been accepted and to the best of my knowledge the foregoing is true and accurate.

REMARKS

FACILITY TICKET NUMBER

SIGNATURE OF AUTHORIZED AGENT *[Signature]* DATE *4-4-07*

WASTE ACCEPTANCE NO.
SWIC-212 774 089

REQUIRED PERSONAL PROTECTIVE EQUIPMENT
 GLOVES GOGGLES RESPIRATOR HARD HAT
 TY-VEK OTHER

SPECIAL HANDLING PROCEDURES:

RECEIVING FACILITY *Keller Canyon*

NOTES:	VEHICLE LICENSE NUMBER	TRUCK NUMBER
	<i>UP45947</i>	<i>725</i>
		<i>IT 725</i>
<input type="checkbox"/> END DUMP	<input type="checkbox"/> BOTTOM DUMP	<input type="checkbox"/> TRANSFER
<input type="checkbox"/> ROLL-OFF(S)	<input type="checkbox"/> FLAT-BED	<input type="checkbox"/> VAN
<input type="checkbox"/>	<input type="checkbox"/>	<input type="checkbox"/>

CUBIC YARDS
[Handwritten]

DISPOSAL METHOD: (TO BE COMPLETED BY LANDFILL)

	DISPOSE	OTHER
<input checked="" type="checkbox"/> SOIL	<i>[Handwritten]</i>	
<input type="checkbox"/> CONSTRUCTION DEBRIS		
<input type="checkbox"/> NON-FRIABLE ASBESTOS		
<input type="checkbox"/> WOOD		
<input type="checkbox"/> ASH		
<input type="checkbox"/> SPECIAL OTHER		

SCHEDULING MUST BE MADE PRIOR TO 3:00 P.M. THE DAY PRIOR TO EXPECTED ARRIVAL • ANY UNSCHEDULED LOADS ARE SUBJECT TO REFUSAL UPON ARRIVAL. ONGOING DAILY DELIVERIES MUST BE SCHEDULED WITH THE LANDFILL THE DAY BEFORE.

MANIFEST # **53743**

141135

KELLER CANYON LANDFILL
 901 BAILEY ROAD
 PITTSBURG, CA

003780
 ADVANCED GED ENVIRONMENTAL INC
 4005 NORTH WILSON WAY

STOCKTON, CA 95205
 Contract: #212Y74089

SITE 01	TICKET 381541	GRID
WEIGHMASTER FELIPE C		
DATE IN 4 April 2007	TIME IN 2:14 pm	
DATE OUT 4 April 2007	TIME OUT 2:14 pm	
VEHICLE IT725	ROLL OFF	
REFERENCE 53743	ORIGIN OAKLAND	

00 Gross Weight 79,840.00 lb Inbound - SCALE TICKET
 Stored Tare Weight 32,060.00 lb
 Net Weight 47,780.00 lb 23.89 TN

QTY.	UNIT	DESCRIPTION	RATE	EXTENSION	TAX	TOTAL
23.89	TN	SW-CONT SOIL W/FUEL				
1.00	LD	ENVIRONMENTAL FEE				
1.00	LD	FUEL RECOVERY FEE				

NET AMOUNT

Keller Canyon Sanitary Landfill

901 Bailey Road
Pittsburg, CA 94565
Phone (925) 458-9800
Fax (925) 458-9891

Ox Mountain Sanitary Landfill

12310 San Mateo Road
Half Moon Bay, CA 94019
Phone (650) 726-1819
Fax (650) 726-9183

Newby Island Sanitary Landfill

1601 Dixon Landing Road
Milpitas, CA 95035
Phone (408) 945-2800
Fax (408) 262-2871

Forward Landfill

9999 S. Austin Road
Manteca, CA 95336
Phone (209) 982-4298
Fax (209) 982-1009

NON-HAZARDOUS WASTE MANIFEST

GENERATOR *Rinoback, Inc.*

MAILING ADDRESS *P.O. Box 725*

CITY, STATE, ZIP *Oakland CA 94612*

PHONE *(707) 462-8811*

CONTACT PERSON *Reid Rinoback*

SIGNATURE OF AUTHORIZED AGENT / TITLE *[Signature]* DATE *4-3-07*

WASTE ACCEPTANCE NO.

SWIC - 212 474 089

REQUIRED PERSONAL PROTECTIVE EQUIPMENT

GLOVES GOGGLES RESPIRATOR HARD HAT

TY-VEK OTHER

SPECIAL HANDLING PROCEDURES:

GENERATOR'S CERTIFICATION: I hereby certify that the above named material is not a hazardous waste as defined by 40 CFR Part 261 or title 22 of the California code of regulations, has been properly described, classified and packaged, and is in proper condition for transportation according to applicable regulations; AND, if the waste is a treatment residue of a previously restricted hazardous waste subject to the Land Disposal Restrictions, I certify and warrant that the waste has been treated in accordance with the requirements of 40 CFR Part 268 and is no longer a hazardous waste as defined by 40 CFR Part 261.

WASTE TYPE: *soil contaminated w/ diesel & unleaded gas*

DISPOSAL SLUDGE

CONSTRUCTION WOOD

DEBRIS OTHER

SPECIAL WASTE

GENERATING FACILITY *Oakland Truck Stop*

RECEIVING FACILITY *Keller Canyon*

TRANSPORTER *Enterprise Transportation Inc.*

ADDRESS *JTT Enterprises*

CITY, STATE, ZIP *8023 Gravenhurst Hwy*

PHONE *(707) 598-0900*

SIGNATURE OF AUTHORIZED AGENT OR DRIVER *[Signature]* DATE *4/5/07*

NOTES:	VEHICLE LICENSE NUMBER	TRUCK NUMBER
	<i>9D45332</i>	<i>025</i>
<i>JTT025</i>		
<input checked="" type="checkbox"/> END DUMP	<input type="checkbox"/> BOTTOM DUMP	<input type="checkbox"/> TRANSFER
<input type="checkbox"/> ROLL-OFF(S)	<input type="checkbox"/> FLAT-BED	<input type="checkbox"/> VAN
<input type="checkbox"/>	<input type="checkbox"/>	<input type="checkbox"/>
<input type="checkbox"/>	<input type="checkbox"/>	<input type="checkbox"/>

I hereby certify that the above named material has been accepted and to the best of my knowledge the foregoing is true and accurate.

REMARKS

FACILITY TICKET NUMBER

SIGNATURE OF AUTHORIZED AGENT *[Signature]* DATE *4-5-07*

CUBIC YARDS

20

DISPOSAL METHOD: (TO BE COMPLETED BY LANDFILL)

	DISPOSE	OTHER
<input checked="" type="checkbox"/> SOIL	<i>[initials]</i>	
<input type="checkbox"/> CONSTRUCTION DEBRIS		
<input type="checkbox"/> NON-FRIABLE ASBESTOS		
<input type="checkbox"/> WOOD		
<input type="checkbox"/> ASH		
<input type="checkbox"/> SPECIAL OTHER		

141169

KELLER CANYON LANDFILL
 901 BAILEY ROAD
 PITTSBURG, CA

003780
 ADVANCED GEO ENVIRONMENTAL INC
 4005 NORTH WILSON WAY

STOCKTON, CA 95205
 Contract: #212Y74089

SITE 01	TICKET 381573	GRID
WEIGHMASTER		
FELIPE C		
DATE IN 5 April 2007	TIME IN 7:12 am	
DATE OUT 5 April 2007	TIME OUT 7:12 am	
VEHICLE JTT025	ROLL OFF	
REFERENCE 53745	ORIGIN OAKLAND	

Gross Weight 84,220.00 lb Inbound - SCALE TICKET
 Stored Tare Weight 31,640.00 lb
 Net Weight 52,580.00 lb 26.29 TN

QTY.	UNIT	DESCRIPTION	RATE	EXTENSION	TAX	TOTAL
26.29	TN	SW-CONT SOIL W/FUEL				
1.00	LD	ENVIRONMENTAL FEE				
1.00	LD	FUEL RECOVERY FEE				

NET AMOUNT
TENDERED
CHANGE
CHECK NO.

SIGNATURE 

Keller Canyon Sanitary Landfill
 901 Bailey Road
 Pittsburg, CA 94565
 Phone (925) 458-9800
 Fax (925) 458-9891

Ox Mountain Sanitary Landfill
 12310 San Mateo Road
 Half Moon Bay, CA 94019
 Phone (650) 726-1819
 Fax (650) 726-9183

Newby Island Sanitary Landfill
 1601 Dixon Landing Road
 Milpitas, CA 95035
 Phone (408) 945-2800
 Fax (408) 262-2871

Forward Landfill
 9999 S. Austin Road
 Manteca, CA 95336
 Phone (209) 982-4298
 Fax (209) 982-1009

NON-HAZARDOUS WASTE MANIFEST

GENERATOR *San Pacific, Inc.*

MAILING ADDRESS *P.O. Box 725*

CITY, STATE, ZIP *Orland CA 95482*

PHONE *(707) 462-8511*

CONTACT PERSON *Paul R. Burt*

SIGNATURE OF AUTHORIZED AGENT / TITLE *[Signature]* DATE *4-3-07*

GENERATOR'S CERTIFICATION: I hereby certify that the above named material is not a hazardous waste as defined by 40 CFR Part 261 or title 22 of the California code of regulations, has been properly described, classified and packaged, and is in proper condition for transportation according to applicable regulations; AND, if the waste is a treatment residue of a previously restricted hazardous waste subject to the Land Disposal Restrictions, I certify and warrant that the waste has been treated in accordance with the requirements of 40 CFR Part 268 and is no longer a hazardous waste as defined by 40 CFR Part 261.

WASTE TYPE: *soil contaminated w/ diesel & volatile gas*

DISPOSAL SLUDGE
 CONSTRUCTION WOOD
 DEBRIS OTHER
 SPECIAL WASTE

GENERATING FACILITY *Orland Truck Stop*

WASTE ACCEPTANCE NO.
SWIC - 212 Y74 089

REQUIRED PERSONAL PROTECTIVE EQUIPMENT
 GLOVES GOGGLES RESPIRATOR HARD HAT
 TY-VEK OTHER

SPECIAL HANDLING PROCEDURES:

RECEIVING FACILITY *Keller Canyon*

TRANSPORTER *Interline Transportation, Inc.*

ADDRESS *2225 Challenger Way, Suite 100*

CITY, STATE, ZIP *Santa Rosa CA 95407*

PHONE *(707) 578-0960*

SIGNATURE OF AUTHORIZED AGENT OR DRIVER *[Signature]* DATE *4-5-07*

NOTES: VEHICLE LICENSE NUMBER *NW* TRUCK NUMBER *514*

END DUMP BOTTOM DUMP TRANSFER
 ROLL-OFF(S) FLAT-BED VAN DRUMS

I hereby certify that the above named material has been accepted and to the best of my knowledge the foregoing is true and accurate.

REMARKS

FACILITY TICKET NUMBER

SIGNATURE OF AUTHORIZED AGENT *[Signature]* DATE *4-5-07*

CUBIC YARDS *20*

DISPOSAL METHOD: (TO BE COMPLETED BY LANDFILL)

	DISPOSE	OTHER
<input checked="" type="checkbox"/> SOIL	<i>5</i>	
<input type="checkbox"/> CONSTRUCTION DEBRIS		
<input type="checkbox"/> NON-FRIABLE ASBESTOS		
<input type="checkbox"/> WOOD		
<input type="checkbox"/> ASH		
<input type="checkbox"/> SPECIAL OTHER		

141172

KELLER CANYON LANDFILL
 901 BAILEY ROAD
 PITTSBURG, CA

003780
 ADVANCED GEO ENVIRONMENTAL INC
 4005 NORTH WILSON WAY

STOCKTON, CA 95205
 Contract: #212Y74089

SITE 01	TICKET 381576	GRID ✓
WEIGHMASTER FELIPE C ✓		
DATE IN 5 April 2007		TIME IN 7:15 am
DATE OUT 5 April 2007		TIME OUT 7:15 am
VEHICLE IT514		ROLL OFF
REFERENCE 53744	ORIGIN OAKLAND	

Gross Weight 82,960.00 lb Inbound - SCALE TICKET
 Stored Tare Weight 31,140.00 lb
 Net Weight 51,820.00 lb 25.91 TN

QTY.	UNIT	DESCRIPTION	RATE	EXTENSION	TAX	TOTAL
25.91	TN	SW-CONT SOIL W/FUEL				
1.00	LD	ENVIRONMENTAL FEE				
1.00	LD	FUEL RECOVERY FEE				

NET AMOUNT

Keller Canyon Sanitary Landfill
 901 Bailey Road
 Pittsburg, CA 94565
 Phone (925) 458-9800
 Fax (925) 458-9891

Ox Mountain Sanitary Landfill
 12310 San Mateo Road
 Half Moon Bay, CA 94019
 Phone (650) 726-1819
 Fax (650) 726-9183

Newby Island Sanitary Landfill
 1601 Dixon Landing Road
 Milpitas, CA 95035
 Phone (408) 945-2800
 Fax (408) 262-2871

Forward Landfill
 9999 S. Austin Road
 Manteca, CA 95336
 Phone (209) 982-4298
 Fax (209) 982-1009

NON-HAZARDOUS WASTE MANIFEST

GENERATOR <i>Blue Pacific, Inc.</i>		WASTE ACCEPTANCE NO. <i>SWIC-212 774 089</i>	
MAILING ADDRESS <i>P.O. Box 725</i>			
CITY, STATE, ZIP <i>Oakland CA 94612</i>		REQUIRED PERSONAL PROTECTIVE EQUIPMENT	
PHONE <i>(707) 462-8811</i>		<input checked="" type="checkbox"/> GLOVES <input type="checkbox"/> GOGGLES <input type="checkbox"/> RESPIRATOR <input type="checkbox"/> HARD HAT <input type="checkbox"/> TY-VEK <input type="checkbox"/> OTHER	
CONTACT PERSON <i>Reed Ruckert</i>		SPECIAL HANDLING PROCEDURES:	
SIGNATURE OF AUTHORIZED AGENT / TITLE		DATE	
* <i>[Signature]</i> / <i>Staff Coordinator</i>		<i>1/3/07</i>	
GENERATOR'S CERTIFICATION: I hereby certify that the above named material is not a hazardous waste as defined by 40 CFR Part 261 or title 22 of the California code of regulations, has been properly described, classified and packaged, and is in proper condition for transportation according to applicable regulations; AND, if the waste is a treatment residue of a previously restricted hazardous waste subject to the Land Disposal Restrictions, I certify and warrant that the waste has been treated in accordance with the requirements of 40 CFR Part 268 and is no longer a hazardous waste as defined by 40 CFR Part 261.			
WASTE TYPE: <i>soil contaminated w/ diesel + unleaded gas</i>		RECEIVING FACILITY <i>Keller Canyon</i>	
<input checked="" type="checkbox"/> DISPOSAL <input type="checkbox"/> SLUDGE <input type="checkbox"/> CONSTRUCTION <input type="checkbox"/> WOOD <input type="checkbox"/> DEBRIS <input type="checkbox"/> OTHER <input type="checkbox"/> SPECIAL WASTE			
GENERATING FACILITY <i>Oakland Truck Stop</i> <i>Oakland</i>			
TRANSPORTER <i>Interstate Transportation, Inc.</i>		NOTES:	VEHICLE LICENSE NUMBER
ADDRESS <i>7775 Challenge Way Suite 100</i>			<i>NEW JT 514</i>
CITY, STATE, ZIP <i>Santa Rosa, CA 95407</i>			
PHONE <i>(707) 578-0860</i>		END DUMP	BOTTOM DUMP
SIGNATURE OF AUTHORIZED AGENT OR DRIVER		ROLL-OFF(S)	VAN
* <i>[Signature]</i>		<input type="checkbox"/>	<input type="checkbox"/>
DATE <i>4/4/07</i>		TRANSFER	DRUMS
		<input type="checkbox"/>	<input type="checkbox"/>
I hereby certify that the above named material has been accepted and to the best of my knowledge the foregoing is true and accurate.		CUBIC YARDS	
		<i>20</i>	
REMARKS		DISPOSAL METHOD: (TO BE COMPLETED BY LANDFILL)	
		DISPOSE	OTHER
FACILITY TICKET NUMBER		<input type="checkbox"/> SOIL	
SIGNATURE OF AUTHORIZED AGENT		<input type="checkbox"/> CONSTRUCTION DEBRIS	
DATE <i>4/11-07</i>		<input type="checkbox"/> NON-FRIABLE ASBESTOS	
		<input type="checkbox"/> WOOD	
		<input type="checkbox"/> ASH	
		<input type="checkbox"/> SPECIAL OTHER	

SCHEDULING MUST BE MADE PRIOR TO 3:00 P.M. THE DAY PRIOR TO EXPECTED ARRIVAL • ANY UNSCHEDULED LOADS ARE SUBJECT TO REFUSAL UPON ARRIVAL. ONGOING DAILY DELIVERIES MUST BE SCHEDULED WITH THE LANDFILL THE DAY BEFORE.

MANIFEST # **53734**

140944

KELLER CANYON LANDFILL
 901 BAILEY ROAD
 PITTSBURG, CA

003780
 ADVANCED GEO ENVIRONMENTAL INC
 4005 NORTH WILSON WAY

STOCKTON, CA 95205
 Contract: #212Y74089

SITE 01	TICKET 381353	GRID
WEIGHMASTER		
FELIPE C		
DATE IN 4 April 2007	TIME IN 7:20 am	
DATE OUT 4 April 2007	TIME OUT 7:20 am	
VEHICLE IT514	ROLL OFF	
REFERENCE 53734	ORIGIN OAKLAND	

Gross Weight 79,960.00 lb Inbound - SCALE TICKET
 Stored Tare Weight 31,140.00 lb
 Net Weight 48,820.00 lb 24.41 TN

QTY.	UNIT	DESCRIPTION	RATE	EXTENSION	TAX	TOTAL
24.41	TN	SW-CONT SOIL W/FUEL				
1.00	LD	ENVIRONMENTAL FEE				
1.00	LD	FUEL RECOVERY FEE				

NET AMOUNT

Keller Canyon Sanitary Landfill
 901 Bailey Road
 Pittsburg, CA 94565
 Phone (925) 458-9800
 Fax (925) 458-9891

Ox Mountain Sanitary Landfill
 12310 San Mateo Road
 Half Moon Bay, CA 94019
 Phone (650) 726-1819
 Fax (650) 726-9183

Newby Island Sanitary Landfill
 1601 Dixon Landing Road
 Milpitas, CA 95035
 Phone (408) 945-2800
 Fax (408) 262-2871

Forward Landfill
 9999 S. Austin Road
 Manteca, CA 95336
 Phone (209) 982-4298
 Fax (209) 982-1009

NON-HAZARDOUS WASTE MANIFEST

GENERATOR <i>Rio Pacific, Inc.</i>		WASTE ACCEPTANCE NO. <i>SWIC - 212 474 089</i>	
MAILING ADDRESS <i>P.O. Box 725</i>			
CITY, STATE, ZIP <i>Oriskany CA 95482</i>		REQUIRED PERSONAL PROTECTIVE EQUIPMENT	
PHONE <i>(707) 462-8811</i>		<input checked="" type="checkbox"/> GLOVES <input type="checkbox"/> GOGGLES <input type="checkbox"/> RESPIRATOR <input type="checkbox"/> HARD HAT	
CONTACT PERSON <i>David Pinchart</i>		<input type="checkbox"/> TY-VEK <input type="checkbox"/> OTHER	
SIGNATURE OF AUTHORIZED AGENT / TITLE		SPECIAL HANDLING PROCEDURES:	
DATE			
* <i>[Signature]</i> / <i>Staff Geologist</i>		<i>4-3-07</i>	
GENERATOR'S CERTIFICATION: I hereby certify that the above named material is not a hazardous waste as defined by 40 CFR Part 261 or title 22 of the California code of regulations, has been properly described, classified and packaged, and is in proper condition for transportation according to applicable regulations; AND, if the waste is a treatment residue of a previously restricted hazardous waste subject to the Land Disposal Restrictions, I certify and warrant that the waste has been treated in accordance with the requirements of 40 CFR Part 268 and is no longer a hazardous waste as defined by 40 CFR Part 261.			
RECEIVING FACILITY <i>Keller Canyon</i>			
WASTE TYPE: <i>soil contaminated w/ diesel & volatile gas</i>			
<input checked="" type="checkbox"/> DISPOSAL <input type="checkbox"/> SLUDGE <input type="checkbox"/> CONSTRUCTION <input type="checkbox"/> WOOD <input type="checkbox"/> DEBRIS <input type="checkbox"/> OTHER <input type="checkbox"/> SPECIAL WASTE			
GENERATING FACILITY <i>Oriskany Truck Stop</i>			
TRANSPORTER <i>Intrastate Transportation, Inc.</i>		NOTES:	VEHICLE LICENSE NUMBER
ADDRESS <i>7725 Challenge Way, Suite 100</i>			<i>0148947</i>
CITY, STATE, ZIP <i>Santa Rosa, CA 95407</i>			<i>725</i>
PHONE <i>(707) 578-0160</i>		END DUMP	BOTTOM DUMP
SIGNATURE OF AUTHORIZED AGENT OR DRIVER		<input type="checkbox"/>	<input type="checkbox"/>
DATE		ROLL-OFF(S)	VAN
* <i>[Signature]</i>		<input type="checkbox"/>	<input type="checkbox"/>
		FLAT-BED	DRUMS
		<input type="checkbox"/>	<input type="checkbox"/>
I hereby certify that the above named material has been accepted and to the best of my knowledge the foregoing is true and accurate.		CUBIC YARDS	
REMARKS		<i>20</i>	
FACILITY TICKET NUMBER		DISPOSAL METHOD: (TO BE COMPLETED BY LANDFILL)	
SIGNATURE OF AUTHORIZED AGENT		DISPOSE	
DATE		OTHER	
* <i>[Signature]</i>		<input checked="" type="checkbox"/> SOIL	
<i>4-24-07</i>		<input type="checkbox"/> CONSTRUCTION DEBRIS	
		<input type="checkbox"/> NON-FRIABLE ASBESTOS	
		<input type="checkbox"/> WOOD	
		<input type="checkbox"/> ASH	
		<input type="checkbox"/> SPECIAL OTHER	

SCHEDULING MUST BE MADE PRIOR TO 3:00 P.M. THE DAY PRIOR TO EXPECTED ARRIVAL • ANY UNSCHEDULED LOADS ARE SUBJECT TO REFUSAL UPON ARRIVAL. ONGOING DAILY DELIVERIES MUST BE SCHEDULED WITH THE LANDFILL THE DAY BEFORE.

MANIFEST # **53736**

140956

KELLER CANYON LANDFILL
 901 BAILEY ROAD
 PITTSBURG, CA

003780
 ADVANCED GEO ENVIRONMENTAL INC
 4005 NORTH WILSON WAY

STOCKTON, CA 95205
 Contract: #212Y74089

SITE 01	TICKET 381365	GRID
WEIGHMASTER		
FELIPE C		
DATE IN 4 April 2007	TIME IN 9:34 am	
DATE OUT 4 April 2007	TIME OUT 9:34 am	
VEHICLE 1T725	ROLL OFF	
REFERENCE 53736	ORIGIN OAKLAND	

01 Gross Weight 84,000.00 lb Inbound - SCALE TICKET
 Stored Tare Weight 32,060.00 lb
 Net Weight 51,940.00 lb 25.97 TN

QTY.	UNIT	DESCRIPTION	RATE	EXTENSION	TAX	TOTAL
25.97	TN	SW-CONT SOIL W/FUEL				
1.00	LD	ENVIRONMENTAL FEE				
1.00	LD	FUEL RECOVERY FEE				

NET AMOUNT

Keller Canyon Sanitary Landfill
 901 Bailey Road
 Pittsburg, CA 94565
 Phone (925) 458-9800
 Fax (925) 458-9891

Ox Mountain Sanitary Landfill
 12310 San Mateo Road
 Half Moon Bay, CA 94019
 Phone (650) 726-1819
 Fax (650) 726-9183

Newby Island Sanitary Landfill
 1601 Dixon Landing Road
 Milpitas, CA 95035
 Phone (408) 945-2800
 Fax (408) 262-2871

Forward Landfill
 9999 S. Austin Road
 Manteca, CA 95336
 Phone (209) 982-4298
 Fax (209) 982-1009

NON-HAZARDOUS WASTE MANIFEST

GENERATOR *Rin Pacific Inc.*

MAILING ADDRESS *P.O. Box 725*

CITY, STATE, ZIP *Orland, CA 95482*

PHONE *(707) 467-8811*

CONTACT PERSON *Rodrick*

SIGNATURE OF AUTHORIZED AGENT / TITLE *[Signature]* DATE *4-3-07*

*** GENERATOR'S CERTIFICATION:** I hereby certify that the above named material is not a hazardous waste as defined by 40 CFR Part 261 or title 22 of the California code of regulations, has been properly described, classified and packaged, and is in proper condition for transportation according to applicable regulations; **AND, if the waste is a treatment residue of a previously restricted hazardous waste** subject to the Land Disposal Restrictions, I certify and warrant that the waste has been treated in accordance with the requirements of 40 CFR Part 268 and is no longer a hazardous waste as defined by 40 CFR Part 261.

WASTE TYPE: *Soil contaminated w/ diesel & untreated gas*

DISPOSAL SLUDGE
 CONSTRUCTION WOOD
 DEBRIS OTHER
 SPECIAL WASTE

GENERATING FACILITY *Dakland Truck Stop*

WASTE ACCEPTANCE NO.
SWIC - 212 744 089

REQUIRED PERSONAL PROTECTIVE EQUIPMENT
 GLOVES GOGGLES RESPIRATOR HARD HAT
 TY-VEK OTHER

SPECIAL HANDLING PROCEDURES:

RECEIVING FACILITY *Keller Canyon*

TRANSPORTER *JT & T Enterprises Inc.*

ADDRESS *JT & T Enterprises Inc.*

CITY, STATE, ZIP *8023 Greenwood Hwy*

PHONE *(707) 665-0114*

SIGNATURE OF AUTHORIZED AGENT OR DRIVER *[Signature]* DATE *4/4/07*

*** I hereby certify that the above named material has been accepted and to the best of my knowledge the foregoing is true and accurate.**

NOTES: VEHICLE LICENSE NUMBER *9D45332* TRUCK NUMBER *025*

JT025

END DUMP BOTTOM DUMP TRANSFER

 ROLL-OFF(S) FLAT-BED VAN DRUMS

REMARKS

FACILITY TICKET NUMBER

SIGNATURE OF AUTHORIZED AGENT *[Signature]* DATE *4-4-07*

*** I hereby certify that the above named material has been accepted and to the best of my knowledge the foregoing is true and accurate.**

CUBIC YARDS *20*

DISPOSAL METHOD: (TO BE COMPLETED BY LANDFILL)

	DISPOSE	OTHER
<input checked="" type="checkbox"/> SOIL	<i>></i>	
<input type="checkbox"/> CONSTRUCTION DEBRIS		
<input type="checkbox"/> NON-FRIABLE ASBESTOS		
<input type="checkbox"/> WOOD		
<input type="checkbox"/> ASH		
<input type="checkbox"/> SPECIAL OTHER		

140964

KELLER CANYON LANDFILL
 901 BAILEY ROAD
 PITTSBURG, CA

003780
 ADVANCED GEO ENVIRONMENTAL INC
 4005 NORTH WILSON WAY

STOCKTON, CA 95205
 Contract: #212Y74089

SITE	TICKET	GRID
01	381373	
WEIGHMASTER		
FELIPE C		
DATE IN	TIME IN	
4 April 2007	7:46 am	
DATE OUT	TIME OUT	
4 April 2007	7:46 am	
VEHICLE	ROLL OFF	
JT1025		
REFERENCE	ORIGIN	
53737	OAKLAND	

01 Gross Weight 80,000.00 lb Inbound - SCALE TICKET
 Stored Tare Weight 31,640.00 lb
 Net Weight 48,360.00 lb 24.18 TN

QTY.	UNIT	DESCRIPTION	RATE	EXTENSION	TAX	TOTAL
24.18	TN	SW-CONT SOIL W/FUEL				
1.00	LD	ENVIRONMENTAL FEE				
1.00	LD	FUEL RECOVERY FEE				

NET AMOUNT

Keller Canyon Sanitary Landfill
 901 Bailey Road
 Pittsburg, CA 94565
 Phone (925) 458-9800
 Fax (925) 458-9891

Ox Mountain Sanitary Landfill
 12310 San Mateo Road
 Half Moon Bay, CA 94019
 Phone (650) 726-1819
 Fax (650) 726-9183

Newby Island Sanitary Landfill
 1601 Dixon Landing Road
 Milpitas, CA 95035
 Phone (408) 945-2800
 Fax (408) 262-2871

Forward Landfill
 9999 S. Austin Road
 Manteca, CA 95336
 Phone (209) 982-4298
 Fax (209) 982-1009

NON-HAZARDOUS WASTE MANIFEST

GENERATOR <i>Rimber Inc.</i>		WASTE ACCEPTANCE NO. - 212 774 089	
MAILING ADDRESS <i>P.O. Box 725</i>			
CITY, STATE, ZIP <i>Orland CA 95482</i>		REQUIRED PERSONAL PROTECTIVE EQUIPMENT	
PHONE <i>(707) 462-8811</i>		<input checked="" type="checkbox"/> GLOVES <input type="checkbox"/> GOGGLES <input type="checkbox"/> RESPIRATOR <input type="checkbox"/> HARD HAT <input type="checkbox"/> TY-VEK <input type="checkbox"/> OTHER	
CONTACT PERSON <i>Reed Rimbert</i>		SPECIAL HANDLING PROCEDURES:	
SIGNATURE OF AUTHORIZED AGENT / TITLE * <i>[Signature] / Staff Geologist</i>		DATE <i>4-3-07</i>	
<small>GENERATOR'S CERTIFICATION: I hereby certify that the above named material is not a hazardous waste as defined by 40 CFR Part 261 or title 22 of the California code of regulations, has been properly described, classified and packaged, and is in proper condition for transportation according to applicable regulations; AND, if the waste is a treatment residue of a previously restricted hazardous waste subject to the Land Disposal Restrictions, I certify and warrant that the waste has been treated in accordance with the requirements of 40 CFR Part 268 and is no longer a hazardous waste as defined by 40 CFR Part 261.</small>			
WASTE TYPE: <i>soil contaminated w/ diesel & unleaded gas</i>		RECEIVING FACILITY <i>Keller Canyon</i>	
<input checked="" type="checkbox"/> DISPOSAL <input type="checkbox"/> SLUDGE <input type="checkbox"/> CONSTRUCTION <input type="checkbox"/> WOOD <input type="checkbox"/> DEBRIS <input type="checkbox"/> OTHER <input type="checkbox"/> SPECIAL WASTE			
GENERATING FACILITY <i>Orland Truck Stop</i>			

TRANSPORTER <i>Indrairie Transportation Inc.</i>		NOTES:	VEHICLE LICENSE NUMBER	TRUCK NUMBER
ADDRESS <i>2225 Challenger Way Suite 100</i>				<i>514</i>
CITY, STATE, ZIP <i>Santa Rosa, CA 95407</i>				
PHONE <i>(707) 578-0960</i>				
SIGNATURE OF AUTHORIZED AGENT OR DRIVER * <i>[Signature]</i>		DATE <i>4-4-07</i>	<input checked="" type="checkbox"/> END DUMP <input type="checkbox"/> BOTTOM DUMP <input type="checkbox"/> TRANSFER <input type="checkbox"/> ROLL-OFF(S) <input type="checkbox"/> FLAT-BED <input type="checkbox"/> VAN <input type="checkbox"/> DRUMS	

I hereby certify that the above named material has been accepted and to the best of my knowledge the foregoing is true and accurate.		CUBIC YARDS <i>20</i>																						
REMARKS		DISPOSAL METHOD: (TO BE COMPLETED BY LANDFILL)																						
FACILITY TICKET NUMBER		<table border="1"> <tr> <td></td> <td>DISPOSE</td> <td>OTHER</td> </tr> <tr> <td><input checked="" type="checkbox"/> SOIL</td> <td><i>[mark]</i></td> <td></td> </tr> <tr> <td><input type="checkbox"/> CONSTRUCTION DEBRIS</td> <td></td> <td></td> </tr> <tr> <td><input type="checkbox"/> NON-FRIABLE ASBESTOS</td> <td></td> <td></td> </tr> <tr> <td><input type="checkbox"/> WOOD</td> <td></td> <td></td> </tr> <tr> <td><input type="checkbox"/> ASH</td> <td></td> <td></td> </tr> <tr> <td><input type="checkbox"/> SPECIAL OTHER</td> <td></td> <td></td> </tr> </table>			DISPOSE	OTHER	<input checked="" type="checkbox"/> SOIL	<i>[mark]</i>		<input type="checkbox"/> CONSTRUCTION DEBRIS			<input type="checkbox"/> NON-FRIABLE ASBESTOS			<input type="checkbox"/> WOOD			<input type="checkbox"/> ASH			<input type="checkbox"/> SPECIAL OTHER		
	DISPOSE	OTHER																						
<input checked="" type="checkbox"/> SOIL	<i>[mark]</i>																							
<input type="checkbox"/> CONSTRUCTION DEBRIS																								
<input type="checkbox"/> NON-FRIABLE ASBESTOS																								
<input type="checkbox"/> WOOD																								
<input type="checkbox"/> ASH																								
<input type="checkbox"/> SPECIAL OTHER																								
SIGNATURE OF AUTHORIZED AGENT * <i>[Signature]</i>		DATE <i>4-4-07</i>																						

141030

KELLER CANYON LANDFILL
 901 BAILEY ROAD
 PITTSBURG, CA

003780
 ADVANCED GEO ENVIRONMENTAL INC
 4005 NORTH WILSON WAY

STOCKTON, CA 95205
 Contract: #212Y74089

SITE 01	TICKET 381439	GRID
WEIGHMASTER FELIPE C		
DATE IN 4 April 2007		TIME IN 11:34 am
DATE OUT 4 April 2007		TIME OUT 11:34 am
VEHICLE IT514		ROLL OFF
REFERENCE 53739	ORIGIN OAKLAND	

Gross Weight 82,520.00 lb
 Stored Tare Weight 31,140.00 lb
 Net Weight 51,380.00 lb 25.69 TN

Inbound - SCALE TICKET

QTY.	UNIT	DESCRIPTION	RATE	EXTENSION	TAX	TOTAL
25.69	TN	SW-CONT SOIL W/FUEL				
1.00	LD	ENVIRONMENTAL FEE				
1.00	LD	FUEL RECOVERY FEE				

NET AMOUNT

Keller Canyon Sanitary Landfill
 901 Bailey Road
 Pittsburg, CA 94565
 Phone (925) 458-9800
 Fax (925) 458-9891

Ox Mountain Sanitary Landfill
 12310 San Mateo Road
 Half Moon Bay, CA 94019
 Phone (650) 726-1819
 Fax (650) 726-9183

Newby Island Sanitary Landfill
 1601 Dixon Landing Road
 Milpitas, CA 95035
 Phone (408) 945-2800
 Fax (408) 262-2871

Forward Landfill
 9999 S. Austin Road
 Manteca, CA 95336
 Phone (209) 982-4298
 Fax (209) 982-1009

NON-HAZARDOUS WASTE MANIFEST

GENERATOR <i>Pro-Brite, Inc.</i>		WASTE ACCEPTANCE NO. <i>SWIC-212 774 089</i>	
MAILING ADDRESS <i>P.O. Box 725</i>			
CITY, STATE, ZIP <i>Oriskany CA 95487</i>		REQUIRED PERSONAL PROTECTIVE EQUIPMENT	
PHONE <i>(707) 462-8811</i>		<input checked="" type="checkbox"/> GLOVES <input type="checkbox"/> GOGGLES <input type="checkbox"/> RESPIRATOR <input type="checkbox"/> HARD HAT	
CONTACT PERSON <i>Paul Robert</i>		<input type="checkbox"/> TY-VEK <input type="checkbox"/> OTHER	
SIGNATURE OF AUTHORIZED AGENT / TITLE <i>* [Signature] / Staff Geologist</i>		SPECIAL HANDLING PROCEDURES:	
DATE <i>4-3-07</i>			
GENERATOR'S CERTIFICATION: I hereby certify that the above named material is not a hazardous waste as defined by 40 CFR Part 261 or title 22 of the California code of regulations, has been properly described, classified and packaged, and is in proper condition for transportation according to applicable regulations; AND, if the waste is a treatment residue of a previously restricted hazardous waste subject to the Land Disposal Restrictions, I certify and warrant that the waste has been treated in accordance with the requirements of 40 CFR Part 268 and is no longer a hazardous waste as defined by 40 CFR Part 261.		RECEIVING FACILITY <i>Keller Canyon</i>	
WASTE TYPE: <i>soil contaminated w/ diesel & carbonated gas</i>			
<input checked="" type="checkbox"/> DISPOSAL		<input type="checkbox"/> SLUDGE	
<input type="checkbox"/> CONSTRUCTION		<input type="checkbox"/> WOOD	
<input type="checkbox"/> DEBRIS		<input type="checkbox"/> OTHER	
<input type="checkbox"/> SPECIAL WASTE			
GENERATING FACILITY <i>Oakland Truck Stop</i>			
TRANSPORTER <i>Intrinsic Transportation, Inc.</i>		NOTES:	VEHICLE LICENSE NUMBER
ADDRESS <i>2725 Challenger Way, Suite 100</i>			<i>UP45947</i>
CITY, STATE, ZIP <i>San Jose CA 95127</i>			TRUCK NUMBER <i>715</i>
PHONE <i>(707) 578-0960</i>		END DUMP	BOTTOM DUMP
SIGNATURE OF AUTHORIZED AGENT OR DRIVER <i>* [Signature] / Director</i>		<input type="checkbox"/>	<input type="checkbox"/>
DATE <i>04/04/07</i>		ROLL-OFF(S)	VAN
		<input type="checkbox"/>	DRUMS
		<input type="checkbox"/>	<input type="checkbox"/>
I hereby certify that the above named material has been accepted and to the best of my knowledge the foregoing is true and accurate.		CUBIC YARDS <i>2</i>	
		DISPOSAL METHOD: (TO BE COMPLETED BY LANDFILL)	
REMARKS		<input type="checkbox"/> SOIL	DISPOSE
FACILITY TICKET NUMBER		<input type="checkbox"/> CONSTRUCTION DEBRIS	OTHER
SIGNATURE OF AUTHORIZED AGENT <i>* [Signature]</i>		<input type="checkbox"/> NON-FRIABLE ASBESTOS	
DATE		<input type="checkbox"/> WOOD	
		<input type="checkbox"/> ASH	
		<input type="checkbox"/> SPECIAL OTHER	

SCHEDULING MUST BE MADE PRIOR TO 3:00 P.M. THE DAY PRIOR TO EXPECTED ARRIVAL • ANY UNSCHEDULED LOADS ARE SUBJECT TO REFUSAL UPON ARRIVAL. ONGOING DAILY DELIVERIES MUST BE SCHEDULED WITH THE LANDFILL THE DAY BEFORE.

141043

KELLER CANYON LANDFILL
 901 BAILEY ROAD
 PITTSBURG, CA

003780
 ADVANCED GEO ENVIRONMENTAL INC
 4005 NORTH WILSON WAY

STOCKTON, CA 95205
 Contract: #212Y74089

SITE	TICKET	GRID
01	381452	
WEIGHMASTER		
FELIPE C		
DATE IN	TIME IN	
4 April 2007	12:02 pm	
DATE OUT	TIME OUT	
4 April 2007	12:02 pm	
VEHICLE	ROLL OFF	
IT725		
REFERENCE	ORIGIN	
53740	OAKLAND	

00 Gross Weight 79,240.00 lb Inbound - SCALE TICKET
 Stored Tare Weight 32,060.00 lb
 Net Weight 47,180.00 lb 23.59 TN

QTY.	UNIT	DESCRIPTION	RATE	EXTENSION	TAX	TOTAL
23.59	TN	SW-CONT SOIL W/FUEL				
1.00	LD	ENVIRONMENTAL FEE				
1.00	LD	FUEL RECOVERY FEE				
						NET AMOUNT

Keller Canyon Sanitary Landfill
 901 Bailey Road
 Pittsburg, CA 94565
 Phone (925) 458-9800
 Fax (925) 458-9891

Ox Mountain Sanitary Landfill
 12310 San Mateo Road
 Half Moon Bay, CA 94019
 Phone (650) 726-1819
 Fax (650) 726-9183

Newby Island Sanitary Landfill
 1601 Dixon Landing Road
 Milpitas, CA 95035
 Phone (408) 945-2800
 Fax (408) 262-2871

Forward Landfill
 9999 S. Austin Road
 Manteca, CA 95336
 Phone (209) 982-4298
 Fax (209) 982-1009

NON-HAZARDOUS WASTE MANIFEST

GENERATOR <i>Ryan Barber, Inc.</i>		WASTE ACCEPTANCE NO. - 212 XXXX 774 089	
MAILING ADDRESS <i>P.O. Box 725</i>			
CITY, STATE, ZIP <i>Orland CA 95482</i>		REQUIRED PERSONAL PROTECTIVE EQUIPMENT	
PHONE <i>(707) 462-8811</i>		<input checked="" type="checkbox"/> GLOVES <input type="checkbox"/> GOGGLES <input type="checkbox"/> RESPIRATOR <input type="checkbox"/> HARD HAT <input type="checkbox"/> TY-VEK <input type="checkbox"/> OTHER	
CONTACT PERSON <i>Rod Ruckart</i>		SPECIAL HANDLING PROCEDURES:	
SIGNATURE OF AUTHORIZED AGENT / TITLE		DATE	
* <i>[Signature]</i> <i>Staff Geologist</i>		<i>4-3-07</i>	
<small>GENERATOR'S CERTIFICATION: I hereby certify that the above named material is not a hazardous waste as defined by 40 CFR Part 261 or title 22 of the California code of regulations, has been properly described, classified and packaged, and is in proper condition for transportation according to applicable regulations; AND, if the waste is a treatment residue of a previously restricted hazardous waste subject to the Land Disposal Restrictions, I certify and warrant that the waste has been treated in accordance with the requirements of 40 CFR Part 268 and is no longer a hazardous waste as defined by 40 CFR Part 261.</small>			
WASTE TYPE: <i>soil contaminated w/ diesel & vehicle gas</i>		RECEIVING FACILITY <i>Keller Canyon</i>	
<input checked="" type="checkbox"/> DISPOSAL <input type="checkbox"/> SLUDGE <input type="checkbox"/> CONSTRUCTION <input type="checkbox"/> WOOD <input type="checkbox"/> DEBRIS <input type="checkbox"/> OTHER <input type="checkbox"/> SPECIAL WASTE			
GENERATING FACILITY <i>Orland Truck Stop</i>			
TRANSPORTER <i>JT&T Enterprises, Inc.</i>		NOTES:	VEHICLE LICENSE NUMBER
ADDRESS <i>JT&T Enterprises</i>			<i>9D45332</i>
CITY, STATE, ZIP <i>Orland CA 95482</i>			<i>025</i>
PHONE <i>(707) 462-8811</i>			<i>JTTO25</i>
SIGNATURE OF AUTHORIZED AGENT OR DRIVER		END DUMP	BOTTOM DUMP
* <i>[Signature]</i>		<input checked="" type="checkbox"/>	<input type="checkbox"/>
DATE <i>4/4/07</i>		TRANSFER	ROLL-OFF(S)
		<input type="checkbox"/>	<input type="checkbox"/>
		FLAT-BED	VAN
		<input type="checkbox"/>	<input type="checkbox"/>
		DRUMS	
		<input type="checkbox"/>	<input type="checkbox"/>
I hereby certify that the above named material has been accepted and to the best of my knowledge the foregoing is true and accurate.		CUBIC YARDS <i>22</i>	
REMARKS		DISPOSAL METHOD: (TO BE COMPLETED BY LANDFILL)	
FACILITY TICKET NUMBER		DISPOSE	
SIGNATURE OF AUTHORIZED AGENT		OTHER	
DATE <i>4-4-07</i>		<input checked="" type="checkbox"/> SOIL	
		<input type="checkbox"/> CONSTRUCTION DEBRIS	
		<input type="checkbox"/> NON-FRIABLE ASBESTOS	
		<input type="checkbox"/> WOOD	
		<input type="checkbox"/> ASH	
		<input type="checkbox"/> SPECIAL OTHER	

SCHEDULING MUST BE MADE PRIOR TO 3:00 P.M. THE DAY PRIOR TO EXPECTED ARRIVAL • ANY UNSCHEDULED LOADS ARE SUBJECT TO REFUSAL UPON ARRIVAL. ONGOING DAILY DELIVERIES MUST BE SCHEDULED WITH THE LANDFILL THE DAY BEFORE.

MANIFEST # **53741**

141093

KELLER CANYON LANDFILL
 901 BAILEY ROAD
 PITTSBURG, CA

003780
 ADVANCED GEO ENVIRONMENTAL INC
 4005 NORTH WILSON WAY

STOCKTON, CA 95205
 Contract: #212Y74089

SITE 01	TICKET 381500	GRID
WEIGHMASTER		
FELIPE C		
DATE IN 4 April 2007	TIME IN 1:24 pm	
DATE OUT 4 April 2007	TIME OUT 1:24 pm	
VEHICLE JTT025	ROLL OFF	
REFERENCE 53741	ORIGIN OAKLAND	

Gross Weight 78,760.00 lb Inbound - SCALE TICKET
 Stored Tare Weight 31,640.00 lb
 Net Weight 47,120.00 lb 23.56 TN

QTY.	UNIT	DESCRIPTION	RATE	EXTENSION	TAX	TOTAL
23.56	TN	SW-CONT SOIL W/FUEL				
1.00	LD	ENVIRONMENTAL FEE				
1.00	LD	FUEL RECOVERY FEE				

NET AMOUNT

141175

KELLER CANYON LANDFILL
 901 BAILEY ROAD
 PITTSBURG, CA

003780
 ADVANCED GEO ENVIRONMENTAL INC
 4005 NORTH WILSON WAY

STOCKTON, CA 95205
 Contract: #212Y74089

SITE 01	TICKET 381579	GRID
WEIGHMASTER FELIPE C		
DATE IN 5 April 2007	TIME IN 7:17 am	
DATE OUT 5 April 2007	TIME OUT 7:17 am	
VEHICLE KTL202	ROLL OFF	
REFERENCE 53750	ORIGIN OAKLAND	

Gross Weight 68,580.00 lb Inbound - SCALE TICKET
 Stored Tare Weight 34,020.00 lb
 Net Weight 34,560.00 lb 17.28 TN

QTY.	UNIT	DESCRIPTION	RATE	EXTENSION	TAX	TOTAL
17.28	TN	SW-CONT SOIL W/FUEL				
1.00	LD	ENVIRONMENTAL FEE				
1.00	LD	FUEL RECOVERY FEE				

NET AMOUNT

Keller Canyon Sanitary Landfill
 901 Bailey Road
 Pittsburg, CA 94565
 Phone (925) 458-9800
 Fax (925) 458-9891

Ox Mountain Sanitary Landfill
 12310 San Mateo Road
 Half Moon Bay, CA 94019
 Phone (650) 726-1819
 Fax (650) 726-9183

Newby Island Sanitary Landfill
 1601 Dixon Landing Road
 Milpitas, CA 95035
 Phone (408) 945-2800
 Fax (408) 262-2871

Forward Landfill
 9999 S. Austin Road
 Manteca, CA 95336
 Phone (209) 982-4298
 Fax (209) 982-1009

NON-HAZARDOUS WASTE MANIFEST

GENERATOR <i>Rue Pacific, Inc.</i>		WASTE ACCEPTANCE NO. <i>Swic - 212 Y74089</i>	
MAILING ADDRESS <i>P.O. Box 725</i>			
CITY, STATE, ZIP <i>Ukiah, CA 95482</i>		REQUIRED PERSONAL PROTECTIVE EQUIPMENT	
PHONE <i>(707) 462-8811</i>		<input checked="" type="checkbox"/> GLOVES <input type="checkbox"/> GOGGLES <input type="checkbox"/> RESPIRATOR <input type="checkbox"/> HARD HAT <input type="checkbox"/> TY-VEK <input type="checkbox"/> OTHER	
CONTACT PERSON <i>Reed R. Christ</i>		SPECIAL HANDLING PROCEDURES:	
SIGNATURE OF AUTHORIZED AGENT / TITLE		DATE	
* <i>[Signature] / Soil Geologist</i>		<i>4-3-07</i>	
GENERATOR'S CERTIFICATION: I hereby certify that the above named material is not a hazardous waste as defined by 40 CFR Part 261 or title 22 of the California code of regulations, has been properly described, classified and packaged, and is in proper condition for transportation according to applicable regulations; AND, if the waste is a treatment residue of a previously restricted hazardous waste subject to the Land Disposal Restrictions, I certify and warrant that the waste has been treated in accordance with the requirements of 40 CFR Part 268 and is no longer a hazardous waste as defined by 40 CFR Part 261.			
WASTE TYPE: <i>Soil contaminated w/ diesel and unleaded gasoline</i>			
<input checked="" type="checkbox"/> DISPOSAL <input type="checkbox"/> SLUDGE <input type="checkbox"/> CONSTRUCTION <input type="checkbox"/> WOOD <input type="checkbox"/> DEBRIS <input type="checkbox"/> OTHER <input type="checkbox"/> SPECIAL WASTE			
GENERATING FACILITY <i>Oakland Truck Stop</i>			
TRANSPORTER <i>Intrinsic Transportation, Inc.</i>		NOTES:	VEHICLE LICENSE NUMBER
ADDRESS <i>2225 Challenger Way, Suite 100</i>			<i>WFLA 786-1</i>
CITY, STATE, ZIP <i>Santa Rosa, CA 95407</i>			<i>2-2</i>
PHONE <i>(707) 578-0960</i>		END DUMP	BOTTOM DUMP
SIGNATURE OF AUTHORIZED AGENT OR DRIVER		<input type="checkbox"/>	<input type="checkbox"/>
DATE		ROLL-OFF(S)	FLAT-BED
* <i>[Signature]</i>		<input type="checkbox"/>	<input type="checkbox"/>
		VAN	DRUMS
		<input type="checkbox"/>	<input type="checkbox"/>
I hereby certify that the above named material has been accepted and to the best of my knowledge the foregoing is true and accurate.		CUBIC YARDS	
REMARKS		<i>20</i>	
FACILITY TICKET NUMBER		DISPOSAL METHOD: (TO BE COMPLETED BY LANDFILL)	
SIGNATURE OF AUTHORIZED AGENT		DISPOSE	
DATE		OTHER	
* <i>[Signature]</i>		<input checked="" type="checkbox"/> SOIL	
<i>4-5-07</i>		<input type="checkbox"/> CONSTRUCTION DEBRIS	
		<input type="checkbox"/> NON-FRIABLE ASBESTOS	
		<input type="checkbox"/> WOOD	
		<input type="checkbox"/> ASH	
		<input type="checkbox"/> SPECIAL OTHER	

SCHEDULING MUST BE MADE PRIOR TO 3:00 P.M. THE DAY PRIOR TO EXPECTED ARRIVAL • ANY UNSCHEDULED LOADS ARE SUBJECT TO REFUSAL UPON ARRIVAL. ONGOING DAILY DELIVERIES MUST BE SCHEDULED WITH THE LANDFILL THE DAY BEFORE.

MANIFEST # **53750**

141230

KELLER CANYON LANDFILL
 901 BAILEY ROAD
 PITTSBURG, CA

003780
 ADVANCED GEO ENVIRONMENTAL INC
 4005 NORTH WILSON WAY

STOCKTON, CA 95205
 Contract: #212Y74089

SITE 01	TICKET 381634	GRID
WEIGHMASTER FELIPE C		
DATE IN 5 April 2007	TIME IN 9:30 am	
DATE OUT 5 April 2007	TIME OUT 9:30 am	
VEHICLE JTT025	ROLL OFF	
REFERENCE 53751	ORIGIN OAKLAND	

00 Gross Weight 80,420.00 lb Inbound - SCALE TICKET
 Stored Tare Weight 31,640.00 lb
 Net Weight 48,780.00 lb 24.39 TN

QTY.	UNIT	DESCRIPTION	RATE	EXTENSION	TAX	TOTAL
24.39	TN	SW-CONT SOIL W/FUEL				
1.00	LD	ENVIRONMENTAL FEE				
1.00	LD	FUEL RECOVERY FEE				

NET AMOUNT

Keller Canyon Sanitary Landfill

901 Bailey Road
Pittsburg, CA 94565
Phone (925) 458-9800
Fax (925) 458-9891

Ox Mountain Sanitary Landfill

12310 San Mateo Road
Half Moon Bay, CA 94019
Phone (650) 726-1819
Fax (650) 726-9183

Newby Island Sanitary Landfill

1601 Dixon Landing Road
Milpitas, CA 95035
Phone (408) 945-2800
Fax (408) 262-2871

Forward Landfill

9999 S. Austin Road
Mariposa, CA 95336
Phone (209) 982-4298
Fax (209) 982-1009

NON-HAZARDOUS WASTE MANIFEST

GENERATOR <i>Rio Pacific, Inc.</i>		WASTE ACCEPTANCE NO. <i>SMIC - 212-774-089</i>	
MAILING ADDRESS <i>P.O. Box 725</i>			
CITY, STATE, ZIP <i>Walsh, CA 95482</i>		REQUIRED PERSONAL PROTECTIVE EQUIPMENT	
PHONE <i>(707) 462-8811</i>		<input checked="" type="checkbox"/> GLOVES <input type="checkbox"/> GOGGLES <input type="checkbox"/> RESPIRATOR <input type="checkbox"/> HARD HAT <input type="checkbox"/> TY-VEK <input type="checkbox"/> OTHER	
CONTACT PERSON <i>Red Rindart</i>		SPECIAL HANDLING PROCEDURES:	
SIGNATURE OF AUTHORIZED AGENT / TITLE		DATE	
* <i>[Signature]</i> / <i>Staff Geologist</i>		<i>4-3-07</i>	
GENERATOR'S CERTIFICATION: I hereby certify that the above named material is not a hazardous waste as defined by 40 CFR Part 261 or title 22 of the California code of regulations, has been properly described, classified and packaged, and is in proper condition for transportation according to applicable regulations; AND, if the waste is a treatment residue of a previously restricted hazardous waste subject to the Land Disposal Restrictions, I certify and warrant that the waste has been treated in accordance with the requirements of 40 CFR Part 268 and is no longer a hazardous waste as defined by 40 CFR Part 261.			
WASTE TYPE: <i>soil contaminated w/ diesel & volatile gas</i>			
<input checked="" type="checkbox"/> DISPOSAL <input type="checkbox"/> SLUDGE <input type="checkbox"/> CONSTRUCTION <input type="checkbox"/> WOOD <input type="checkbox"/> DEBRIS <input type="checkbox"/> OTHER <input type="checkbox"/> SPECIAL WASTE			
GENERATING FACILITY <i>Oakland Tank Stop</i>			
TRANSPORTER <i>Intrinsic Transportation Inc.</i>		NOTES:	VEHICLE LICENSE NUMBER
ADDRESS <i>2225 Challenger Way, Suite 100</i>			<i>NEW</i>
CITY, STATE, ZIP <i>Santa Rosa, CA 95407</i>			<i>84</i>
PHONE <i>(707) 578-0960</i>		END DUMP	BOTTOM DUMP
SIGNATURE OF AUTHORIZED AGENT OR DRIVER		<input checked="" type="checkbox"/>	<input type="checkbox"/>
* <i>[Signature]</i>		ROLL-OFF(S)	FLAT-BED
<i>4-5-07</i>		<input type="checkbox"/>	<input type="checkbox"/>
		VAN	DRUMS
		<input type="checkbox"/>	<input type="checkbox"/>
I hereby certify that the above named material has been accepted and to the best of my knowledge the foregoing is true and accurate.		CUBIC YARDS	
		<i>20</i>	
REMARKS		DISPOSAL METHOD: (TO BE COMPLETED BY LANDFILL)	
FACILITY TICKET NUMBER		DISPOSE OTHER	
SIGNATURE OF AUTHORIZED AGENT		<input type="checkbox"/> SOIL	
DATE		<input type="checkbox"/> CONSTRUCTION DEBRIS	
* <i>[Signature]</i>		<input type="checkbox"/> NON-FRIABLE ASBESTOS	
		<input type="checkbox"/> WOOD	
		<input type="checkbox"/> ASH	
		<input type="checkbox"/> SPECIAL OTHER	

SCHEDULING MUST BE MADE PRIOR TO 3:00 P.M. THE DAY PRIOR TO EXPECTED ARRIVAL • ANY UNSCHEDULED LOADS ARE SUBJECT TO REFUSAL UPON ARRIVAL. ONGOING DAILY DELIVERIES MUST BE SCHEDULED WITH THE LANDFILL THE DAY BEFORE.

MANIFEST # **53753**

141251

KELLER CANYON LANDFILL
 901 BAILEY ROAD
 PITTSBURG, CA

003780
 ADVANCED GEO ENVIRONMENTAL INC
 4005 NORTH WILSON WAY

STOCKTON, CA 95205
 Contract: #212Y74089

SITE 01	TICKET 381655	GRID
WEIGHMASTER		
FELIPE C		
DATE IN 5 April 2007	TIME IN 10:16 am	
DATE OUT 5 April 2007	TIME OUT 10:16 am	
VEHICLE IT514	ROLL OFF	
REFERENCE 53753	ORIGIN OAKLAND	

01 Gross Weight 86,600.00 lb Inbound - SCALE TICKET
 Stored Tare Weight 31,140.00 lb
 Net Weight 55,460.00 lb 27.73 TN

QTY.	UNIT	DESCRIPTION	RATE	EXTENSION	TAX	TOTAL
27.73	TN	SW-CONT SOIL W/FUEL				
1.00	LD	ENVIRONMENTAL FEE				
1.00	LD	FUEL RECOVERY FEE				

NET AMOUNT

141268

KELLER CANYON LANDFILL
 901 BAILEY ROAD
 PITTSBURG, CA

003780
 ADVANCED GED ENVIRONMENTAL INC
 4005 NORTH WILSON WAY

STOCKTON, CA 95205
 Contract: #212Y74089

SITE 01	TICKET 381672	GRID
WEIGHMASTER		
FELIPE C		
DATE IN 5 April 2007	TIME IN 10:41 am	
DATE OUT 5 April 2007	TIME OUT 10:41 am	
VEHICLE KTL202	ROLL OFF	
REFERENCE 53752	ORIGIN OAKLAND	

00 Gross Weight 72,860.00 lb
 Stored Tare Weight 34,020.00 lb
 Net Weight 38,840.00 lb 19.42 TN

Inbound - SCALE TICKET

QTY.	UNIT	DESCRIPTION	RATE	EXTENSION	TAX	TOTAL
19.42	TN	SW-CDNT SOIL W/FUEL				
1.00	LD	ENVIRONMENTAL FEE				
1.00	LD	FUEL RECOVERY FEE				

NET AMOUNT

Keller Canyon Sanitary Landfill
 901 Bailey Road
 Pittsburg, CA 94565
 Phone (925) 458-9800
 Fax (925) 458-9891

Ox Mountain Sanitary Landfill
 12310 San Mateo Road
 Half Moon Bay, CA 94019
 Phone (650) 726-1819
 Fax (650) 726-9183

Newby Island Sanitary Landfill
 1601 Dixon Landing Road
 Milpitas, CA 95035
 Phone (408) 945-2800
 Fax (408) 262-2871

Forward Landfill
 9999 S. Austin Road
 Manteca, CA 95336
 Phone (209) 982-4298
 Fax (209) 982-1009

NON-HAZARDOUS WASTE MANIFEST

GENERATOR <i>RioPacific, Inc.</i>		WASTE ACCEPTANCE NO. <i>- 212 974 089</i>																						
MAILING ADDRESS <i>P.O. Box 725</i>																								
CITY, STATE, ZIP <i>Ukiah CA 95482</i>		REQUIRED PERSONAL PROTECTIVE EQUIPMENT																						
PHONE <i>(707) 462-8811</i>		<input checked="" type="checkbox"/> GLOVES <input type="checkbox"/> GOGGLES <input type="checkbox"/> RESPIRATOR <input type="checkbox"/> HARD HAT <input type="checkbox"/> TY-VEK <input type="checkbox"/> OTHER																						
CONTACT PERSON <i>David Reinhart</i>		SPECIAL HANDLING PROCEDURES:																						
SIGNATURE OF AUTHORIZED AGENT / TITLE	DATE																							
<i>* [Signature] / Self Geologist</i>	<i>4-3-07</i>																							
<small>GENERATOR'S CERTIFICATION: I hereby certify that the above named material is not a hazardous waste as defined by 40 CFR Part 261 or title 22 of the California code of regulations, has been properly described, classified and packaged, and is in proper condition for transportation according to applicable regulations; AND, if the waste is a treatment residue of a previously restricted hazardous waste subject to the Land Disposal Restrictions, I certify and warrant that the waste has been treated in accordance with the requirements of 40 CFR Part 268 and is no longer a hazardous waste as defined by 40 CFR Part 261.</small>		RECEIVING FACILITY <i>Keller Canyon</i>																						
WASTE TYPE: <i>soil contaminated w/ diesel & unleaded gas</i> <input checked="" type="checkbox"/> DISPOSAL <input type="checkbox"/> SLUDGE <input type="checkbox"/> CONSTRUCTION <input type="checkbox"/> WOOD <input type="checkbox"/> DEBRIS <input type="checkbox"/> OTHER <input type="checkbox"/> SPECIAL WASTE																								
GENERATING FACILITY <i>Oakland Truck Stop</i>																								
TRANSPORTER <i>Intrinsic Transportation Inc.</i>		NOTES:	VEHICLE LICENSE NUMBER																					
ADDRESS <i>2225 Challenger Way, Suite 100</i>																								
CITY, STATE, ZIP <i>Santa Rosa, CA 95407</i>																								
PHONE <i>(707) 578-0960</i>		END DUMP	BOTTOM DUMP																					
		<input type="checkbox"/>	<input type="checkbox"/>																					
SIGNATURE OF AUTHORIZED AGENT OR DRIVER		ROLL-OFF(S)	FLAT-BED																					
		<input type="checkbox"/>	<input type="checkbox"/>																					
DATE		VAN	DRUMS																					
		<input type="checkbox"/>	<input type="checkbox"/>																					
I hereby certify that the above named material has been accepted and to the best of my knowledge the foregoing is true and accurate.		CUBIC YARDS <i>20</i>																						
REMARKS		DISPOSAL METHOD: (TO BE COMPLETED BY LANDFILL)																						
FACILITY TICKET NUMBER		<table border="1"> <tr> <td></td> <td>DISPOSE</td> <td>OTHER</td> </tr> <tr> <td><input checked="" type="checkbox"/> SOIL</td> <td><i>[X]</i></td> <td></td> </tr> <tr> <td><input type="checkbox"/> CONSTRUCTION DEBRIS</td> <td></td> <td></td> </tr> <tr> <td><input type="checkbox"/> NON-FRIABLE ASBESTOS</td> <td></td> <td></td> </tr> <tr> <td><input type="checkbox"/> WOOD</td> <td></td> <td></td> </tr> <tr> <td><input type="checkbox"/> ASH</td> <td></td> <td></td> </tr> <tr> <td><input type="checkbox"/> SPECIAL OTHER</td> <td></td> <td></td> </tr> </table>			DISPOSE	OTHER	<input checked="" type="checkbox"/> SOIL	<i>[X]</i>		<input type="checkbox"/> CONSTRUCTION DEBRIS			<input type="checkbox"/> NON-FRIABLE ASBESTOS			<input type="checkbox"/> WOOD			<input type="checkbox"/> ASH			<input type="checkbox"/> SPECIAL OTHER		
	DISPOSE	OTHER																						
<input checked="" type="checkbox"/> SOIL	<i>[X]</i>																							
<input type="checkbox"/> CONSTRUCTION DEBRIS																								
<input type="checkbox"/> NON-FRIABLE ASBESTOS																								
<input type="checkbox"/> WOOD																								
<input type="checkbox"/> ASH																								
<input type="checkbox"/> SPECIAL OTHER																								
SIGNATURE OF AUTHORIZED AGENT																								
<i>* [Signature]</i>																								
DATE																								
<i>4-5-07</i>																								

SCHEDULING MUST BE MADE PRIOR TO 3:00 P.M. THE DAY PRIOR TO EXPECTED ARRIVAL • ANY UNSCHEDULED LOADS ARE SUBJECT TO REFUSAL UPON ARRIVAL. ONGOING DAILY DELIVERIES MUST BE SCHEDULED WITH THE LANDFILL THE DAY BEFORE.

141341

KELLER CANYON LANDFILL
 901 BAILEY ROAD
 PITTSBURG, CA

003780
 ADVANCED BED ENVIRONMENTAL INC
 4005 NORTH WILSON WAY

STOCKTON, CA 95205
 Contract: #212Y74089

SITE 01	TICKET 381743	GRID
WEIGHMASTER		
FELIPE C		
DATE IN 5 April 2007	TIME IN 12:51 pm	
DATE OUT 5 April 2007	TIME OUT 12:51 pm	
VEHICLE KTL202	ROLL OFF	
REFERENCE 53747	ORIGIN OAKLAND	

00 Gross Weight 84,560.00 lb Inbound - SCALE TICKET
 Stored Tare Weight 34,020.00 lb
 Net Weight 50,540.00 lb 25.27 TN

QTY.	UNIT	DESCRIPTION	RATE	EXTENSION	TAX	TOTAL
25.27	TN	SW-CONT SOIL W/FUEL				
1.00	LD	ENVIRONMENTAL FEE				
1.00	LD	FUEL RECOVERY FEE				

NET AMOUNT

Keller Canyon Sanitary Landfill
 901 Bailey Road
 Pittsburg, CA 94565
 Phone (925) 458-9800
 Fax (925) 458-9891

Ox Mountain Sanitary Landfill
 12310 San Mateo Road
 Half Moon Bay, CA 94019
 Phone (650) 726-1819
 Fax (650) 726-9183

Newby Island Sanitary Landfill
 1601 Dixon Landing Road
 Milpitas, CA 95035
 Phone (408) 945-2800
 Fax (408) 262-2871

Forward Landfill
 9999 S. Austin Road
 Manteca, CA 95336
 Phone (209) 982-4298
 Fax (209) 982-1009

NON-HAZARDOUS WASTE MANIFEST

GENERATOR <i>Rio Pacific Inc</i>		WASTE ACCEPTANCE NO. - 212 774 089	
MAILING ADDRESS <i>P.O. Box 725</i>			
CITY, STATE, ZIP <i>Whittier, CA 95482</i>		REQUIRED PERSONAL PROTECTIVE EQUIPMENT	
PHONE <i>(707) 462-8811</i>		<input checked="" type="checkbox"/> GLOVES <input type="checkbox"/> GOGGLES <input type="checkbox"/> RESPIRATOR <input type="checkbox"/> HARD HAT <input type="checkbox"/> TY-VEK <input type="checkbox"/> OTHER	
CONTACT PERSON <i>Reed Rinkert</i>		SPECIAL HANDLING PROCEDURES:	
SIGNATURE OF AUTHORIZED AGENT / TITLE * <i>[Signature]</i> / <i>Staff Geologist</i>		DATE <i>4-3-07</i>	
GENERATOR'S CERTIFICATION: I hereby certify that the above named material is not a hazardous waste as defined by 40 CFR Part 261 or title 22 of the California code of regulations, has been properly described, classified and packaged, and is in proper condition for transportation according to applicable regulations; AND, if the waste is a treatment residue of a previously restricted hazardous waste subject to the Land Disposal Restrictions, I certify and warrant that the waste has been treated in accordance with the requirements of 40 CFR Part 268 and is no longer a hazardous waste as defined by 40 CFR Part 261.		RECEIVING FACILITY <i>Keller Canyon</i>	
WASTE TYPE: <i>Soil contaminated w/ diesel oil and volatile gas</i>			
<input checked="" type="checkbox"/> DISPOSAL <input type="checkbox"/> SLUDGE <input type="checkbox"/> CONSTRUCTION <input type="checkbox"/> WOOD <input type="checkbox"/> DEBRIS <input type="checkbox"/> OTHER <input type="checkbox"/> SPECIAL WASTE			
GENERATING FACILITY <i>Oakland Truck Stop</i>			
TRANSPORTER <i>Intensive Transportation, Inc.</i>		NOTES:	VEHICLE LICENSE NUMBER
ADDRESS <i>2275 Challenger Hwy, Suite 100</i>			<i>NEW</i>
CITY, STATE, ZIP <i>Santa Rosa CA 95407</i>			<i>514</i>
PHONE <i>(707) 528-0960</i>		END DUMP	BOTTOM DUMP
SIGNATURE OF AUTHORIZED AGENT OR DRIVER * <i>[Signature]</i>		<input checked="" type="checkbox"/>	<input type="checkbox"/>
DATE <i>4-10-07</i>		TRANSFER	<input type="checkbox"/>
		ROLL-OFF(S)	FLAT-BED
		<input type="checkbox"/>	<input type="checkbox"/>
		VAN	DRUMS
		<input type="checkbox"/>	<input type="checkbox"/>
I hereby certify that the above named material has been accepted and to the best of my knowledge the foregoing is true and accurate.		CUBIC YARDS <i>20</i>	
REMARKS		DISPOSAL METHOD: (TO BE COMPLETED BY LANDFILL)	
FACILITY TICKET NUMBER		DISPOSE OTHER	
SIGNATURE OF AUTHORIZED AGENT * <i>[Signature]</i>		<input checked="" type="checkbox"/> SOIL	
DATE		<input type="checkbox"/> CONSTRUCTION DEBRIS	
		<input type="checkbox"/> NON-FRIABLE ASBESTOS	
		<input type="checkbox"/> WOOD	
		<input type="checkbox"/> ASH	
		<input type="checkbox"/> SPECIAL OTHER	

SCHEDULING MUST BE MADE PRIOR TO 3:00 P.M. THE DAY PRIOR TO EXPECTED ARRIVAL • ANY UNSCHEDULED LOADS ARE SUBJECT TO REFUSAL UPON ARRIVAL. ONGOING DAILY DELIVERIES MUST BE SCHEDULED WITH THE LANDFILL THE DAY BEFORE.

MANIFEST # **53748**

141357

KELLER CANYON LANDFILL
 901 BAILEY ROAD
 PITTSBURG, CA

003780
 ADVANCED GEO ENVIRONMENTAL INC
 4005 NORTH WILSON WAY

STOCKTON, CA 95205
 Contract: #212Y74089

SITE	TICKET	GRID
01	382349	
WEIGHMASTER		
FELIPE C		
DATE IN	TIME IN	
10 April 2007	9:21 am	
DATE OUT	TIME OUT	
10 April 2007	9:21 am	
VEHICLE	ROLL OFF	
IT514		
REFERENCE	ORIGIN	
53748	OAKLAND	

00 Gross Weight 78,280.00 lb Inbound - SCALE TICKET
 Stored Tare Weight 31,140.00 lb
 Net Weight 47,140.00 lb 23.57 TN

QTY.	UNIT	DESCRIPTION	RATE	EXTENSION	TAX	TOTAL
23.57	TN	SW-CONT SOIL W/FUEL				
1.00	LD	ENVIRONMENTAL FEE				
1.00	LD	FUEL RECOVERY FEE				

NET AMOUNT

Keller Canyon Sanitary Landfill
 901 Bailey Road
 Pittsburg, CA 94565
 Phone (925) 458-9800
 Fax (925) 458-9891

Ox Mountain Sanitary Landfill
 12310 San Mateo Road
 Half Moon Bay, CA 94019
 Phone (650) 726-1819
 Fax (650) 726-9183

Newby Island Sanitary Landfill
 1601 Dixon Landing Road
 Milpitas, CA 95035
 Phone (408) 945-2800
 Fax (408) 262-2871

Forward Landfill
 9999 S. Austin Road
 Manteca, CA 95336
 Phone (209) 982-4298
 Fax (209) 982-1009

3380

NON-HAZARDOUS WASTE MANIFEST

GENERATOR		WASTE ACCEPTANCE NO.	
MAILING ADDRESS		- 212,74089	
CITY, STATE, ZIP		REQUIRED PERSONAL PROTECTIVE EQUIPMENT	
PHONE		<input type="checkbox"/> GLOVES <input type="checkbox"/> GOGGLES <input type="checkbox"/> RESPIRATOR <input type="checkbox"/> HARD HAT <input type="checkbox"/> TY-VEK <input type="checkbox"/> OTHER	
CONTACT PERSON		SPECIAL HANDLING PROCEDURES:	
SIGNATURE OF AUTHORIZED AGENT / TITLE	DATE	RECEIVING FACILITY	
*		Keller Canyon	
GENERATOR'S CERTIFICATION: I hereby certify that the above named material is not a hazardous waste as defined by 40 CFR Part 261 or title 22 of the California code of regulations, has been properly described, classified and packaged, and is in proper condition for transportation according to applicable regulations; AND, If the waste is a treatment residue of a previously restricted hazardous waste subject to the Land Disposal Restrictions, I certify and warrant that the waste has been treated in accordance with the requirements of 40 CFR Part 268 and is no longer a hazardous waste as defined by 40 CFR Part 261.			
WASTE TYPE:			
<input type="checkbox"/> DISPOSAL <input type="checkbox"/> CONSTRUCTION <input type="checkbox"/> DEBRIS <input type="checkbox"/> SPECIAL WASTE		<input type="checkbox"/> SLUDGE <input type="checkbox"/> WOOD <input type="checkbox"/> OTHER	
GENERATING FACILITY			
TRANSPORTER		NOTES:	TRUCK NUMBER
ADDRESS		KTL202	
CITY, STATE, ZIP		END DUMP	BOTTOM DUMP
PHONE		<input type="checkbox"/>	<input type="checkbox"/>
SIGNATURE OF AUTHORIZED AGENT OR DRIVER		TRANSFER	ROLL-OFF(S)
DATE		<input type="checkbox"/>	FLAT-BED
*		<input type="checkbox"/>	VAN
		<input type="checkbox"/>	DRUMS
		<input type="checkbox"/>	<input type="checkbox"/>
I hereby certify that the above named material has been accepted and to the best of my knowledge the foregoing is true and accurate.		CUBIC YARDS	
		20	
REMARKS		DISPOSAL METHOD: (TO BE COMPLETED BY LANDFILL)	
FACILITY TICKET NUMBER		DISPOSE	OTHER
SIGNATURE OF AUTHORIZED AGENT		<input checked="" type="checkbox"/> SOIL	
DATE		<input type="checkbox"/> CONSTRUCTION DEBRIS	
*		<input type="checkbox"/> NON-FRIABLE ASBESTOS	
		<input type="checkbox"/> WOOD	
		<input type="checkbox"/> ASH	
		<input type="checkbox"/> SPECIAL OTHER	

SCHEDULING MUST BE MADE PRIOR TO 3:00 P.M. THE DAY PRIOR TO EXPECTED ARRIVAL • ANY UNSCHEDULED LOADS ARE SUBJECT TO REFUSAL UPON ARRIVAL. ONGOING DAILY DELIVERIES MUST BE SCHEDULED WITH THE LANDFILL THE DAY BEFORE.

142138

KELLER CANYON LANDFILL
 901 BAILEY ROAD
 PITTSBURG, CA

003780
 ADVANCED GEO ENVIRONMENTAL INC
 4005 NORTH WILSON WAY

STOCKTON, CA 95205
 Contract: #212Y74089

SITE 01	TICKET 382526	GRID
WEIGHMASTER		
FELIPE C		
DATE IN 11 April 2007	TIME IN 7:33 am	
DATE OUT 11 April 2007	TIME OUT 7:33 am	
VEHICLE KTL202	ROLL OFF	
REFERENCE 433274	ORIGIN OAKLAND	

Gross Weight 70,040.00 lb Inbound - SCALE TICKET
 Stored Tare Weight 34,020.00 lb
 Net Weight 36,020.00 lb 18.01 TN

QTY.	UNIT	DESCRIPTION	RATE	EXTENSION	TAX	TOTAL
18.01	TN	SW-CONT SOIL W/FUEL				
1.00	LD	ENVIRONMENTAL FEE				
1.00	LD	FUEL RECOVERY FEE				

NET AMOUNT

Keller Canyon Sanitary Landfill
 901 Bailey Road
 Pittsburg, CA 94565
 Phone (925) 458-9800
 Fax (925) 458-9891

Ox Mountain Sanitary Landfill
 12310 San Mateo Road
 Half Moon Bay, CA 94019
 Phone (650) 726-1819
 Fax (650) 726-9183

Newby Island Sanitary Landfill
 1601 Dixon Landing Road
 Milpitas, CA 95035
 Phone (408) 945-2800
 Fax (408) 262-2871

Forward Landfill
 9999 S. Austin Road
 Manteca, CA 95336
 Phone (209) 982-4298
 Fax (209) 982-1009

NON-HAZARDOUS WASTE MANIFEST

GENERATOR <i>Rock Pacific, Inc.</i>		WASTE ACCEPTANCE NO. - 212 774 089	
MAILING ADDRESS <i>P.O. Box 725</i>			
CITY, STATE, ZIP <i>Orland CA 95482</i>		REQUIRED PERSONAL PROTECTIVE EQUIPMENT	
PHONE <i>(707) 462-8811</i>		<input checked="" type="checkbox"/> GLOVES <input type="checkbox"/> GOGGLES <input type="checkbox"/> RESPIRATOR <input type="checkbox"/> HARD HAT <input type="checkbox"/> TY-VEK <input type="checkbox"/> OTHER	
CONTACT PERSON <i>David Rindler</i>		SPECIAL HANDLING PROCEDURES:	
SIGNATURE OF AUTHORIZED AGENT / TITLE * <i>[Signature]</i> / <i>Staff Geologist</i>		DATE <i>4/3/07</i>	
GENERATOR'S CERTIFICATION: I hereby certify that the above named material is not a hazardous waste as defined by 40 CFR Part 261 or title 22 of the California code of regulations, has been properly described, classified and packaged, and is in proper condition for transportation according to applicable regulations; AND, if the waste is a treatment residue of a previously restricted hazardous waste subject to the Land Disposal Restrictions, I certify and warrant that the waste has been treated in accordance with the requirements of 40 CFR Part 268 and is no longer a hazardous waste as defined by 40 CFR Part 261.		RECEIVING FACILITY <i>Keller Canyon</i>	
WASTE TYPE: <i>soil contaminated w/ diesel & unleaded gas</i>			
<input type="checkbox"/> DISPOSAL <input type="checkbox"/> SLUDGE <input type="checkbox"/> CONSTRUCTION <input type="checkbox"/> WOOD <input type="checkbox"/> DEBRIS <input type="checkbox"/> OTHER <input type="checkbox"/> SPECIAL WASTE			
GENERATING FACILITY <i>Orland Truck Stop</i>			
TRANSPORTER <i>Interline Transportation Inc.</i>		NOTES:	VEHICLE LICENSE NUMBER
ADDRESS <i>2775 Challenger Way Suite 100</i>			TRUCK NUMBER
CITY, STATE, ZIP <i>Santa Rosa CA 95407</i>			<i>UP459417</i> <i>7205</i>
PHONE <i>(707) 538-0160</i>		END DUMP	BOTTOM DUMP
SIGNATURE OF AUTHORIZED AGENT OR DRIVER * <i>[Signature]</i> / <i>Business Unit Director</i>		<input type="checkbox"/>	<input type="checkbox"/>
DATE <i>04/16/07</i>		ROLL-OFF(S)	FLAT-BED
		<input type="checkbox"/>	<input type="checkbox"/>
		VAN	TRANSFER
		<input type="checkbox"/>	<input type="checkbox"/>
		DRUMS	
		<input type="checkbox"/>	
I hereby certify that the above named material has been accepted and to the best of my knowledge the foregoing is true and accurate.		CUBIC YARDS <i>20</i>	
		DISPOSAL METHOD: (TO BE COMPLETED BY LANDFILL)	
REMARKS		DISPOSE	OTHER
FACILITY TICKET NUMBER		<input checked="" type="checkbox"/> SOIL	
SIGNATURE OF AUTHORIZED AGENT * <i>[Signature]</i>		<input type="checkbox"/> CONSTRUCTION DEBRIS	
DATE <i>4/11/07</i>		<input type="checkbox"/> NON-FRIABLE ASBESTOS	
		<input type="checkbox"/> WOOD	
		<input type="checkbox"/> ASH	
		<input type="checkbox"/> SPECIAL OTHER	

SCHEDULING MUST BE MADE PRIOR TO 3:00 P.M. THE DAY PRIOR TO EXPECTED ARRIVAL • ANY UNSCHEDULED LOADS ARE SUBJECT TO REFUSAL UPON ARRIVAL. ONGOING DAILY DELIVERIES MUST BE SCHEDULED WITH THE LANDFILL THE DAY BEFORE.

MANIFEST # **53746**

142148

KELLER CANYON LANDFILL
 901 BAILEY ROAD
 PITTSBURG, CA

003780
 ADVANCED GEO ENVIRONMENTAL INC
 4005 NORTH WILSON WAY

STOCKTON, CA 95205
 Contract: #212Y74089

SITE 01	TICKET 382536	GRID
WEIGHMASTER		
FELIPE C		
DATE IN 11 April 2007	TIME IN 7:48 am	
DATE OUT 11 April 2007	TIME OUT 7:48 am	
VEHICLE 1T725	ROLL OFF	
REFERENCE 53746	ORIGIN OAKLAND	

Gross Weight 78,740.00 lb Inbound - SCALE TICKET
 Stored Tare Weight 32,060.00 lb
 Net Weight 46,680.00 lb 23.34 TN

QTY.	UNIT	DESCRIPTION	RATE	EXTENSION	TAX	TOTAL
23.34	TN	SW-CONT SOIL W/FUEL				
1.00	LD	ENVIRONMENTAL FEE				
1.00	LD	FUEL RECOVERY FEE				

NET AMOUNT

Keller Canyon Sanitary Landfill
 901 Bailey Road
 Pittsburg, CA 94565
 Phone (925) 458-9800
 Fax (925) 458-9891

Coffin Butte Landfill
 28972 Coffin Butte Road
 Corvallis, OR 97330
 Phone (541) 745-2018
 Fax (541) 745-3826

Ox Mountain Sanitary Landfill
 12310 San Mateo Road
 Half Moon Bay, CA 94019
 Phone (650) 726-1819
 Fax (650) 726-9183

Newby Island Sanitary Landfill
 1601 Dixon Landing Road
 Milpitas, CA 95035
 Phone (408) 945-2800
 Fax (408) 262-2871

Forward Landfill
 9999 S. Austin Road
 Manteca, CA 95336
 Phone (209) 982-4298
 Fax (209) 982-1009

NON-HAZARDOUS WASTE MANIFEST

GENERATOR		WASTE ACCEPTANCE NO.			
MAILING ADDRESS		- 55-749-11			
CITY, STATE, ZIP		REQUIRED PERSONAL PROTECTIVE EQUIPMENT			
PHONE		<input type="checkbox"/> GLOVES <input type="checkbox"/> GOGGLES <input type="checkbox"/> RESPIRATOR <input type="checkbox"/> HARD HAT <input type="checkbox"/> TY-VEK <input type="checkbox"/> SAFETY VEST			
CONTACT PERSON		SPECIAL HANDLING PROCEDURES:			
SIGNATURE OF AUTHORIZED AGENT / TITLE		DATE			
* <i>[Signature]</i>		4-11-07			
<small>GENERATOR'S CERTIFICATION: I hereby certify that the above named material is not a hazardous waste as defined by 40 CFR Part 261 or title 22 of the California code of regulations, has been properly described, classified and packaged, and is in proper condition for transportation according to applicable regulations; AND, if the waste is a treatment residue of a previously restricted hazardous waste subject to the Land Disposal Restrictions, I certify and warrant that the waste has been treated in accordance with the requirements of 40 CFR Part 268 and is no longer a hazardous waste as defined by 40 CFR Part 261.</small>					
WASTE TYPE:		RECEIVING FACILITY			
<input type="checkbox"/> DISPOSAL <input type="checkbox"/> SLUDGE <input type="checkbox"/> CONSTRUCTION <input type="checkbox"/> WOOD <input type="checkbox"/> DEBRIS <input type="checkbox"/> OTHER <input type="checkbox"/> SPECIAL WASTE					
GENERATING FACILITY					
TRANSPORTER		NOTES:	VEHICLE LICENSE NUMBER	TRUCK NUMBER	
ADDRESS					
CITY, STATE, ZIP					
PHONE		END DUMP	BOTTOM DUMP	TRANSFER	
SIGNATURE OF AUTHORIZED AGENT OR DRIVER		<input type="checkbox"/>	<input type="checkbox"/>	<input type="checkbox"/>	
DATE		ROLL-OFF(S)	FLAT-BED	VAN	DRUMS
* <i>[Signature]</i>		<input type="checkbox"/>	<input type="checkbox"/>	<input type="checkbox"/>	<input type="checkbox"/>
I hereby certify that the above named material has been accepted and to the best of my knowledge the foregoing is true and accurate.		CUBIC YARDS			
		20			
REMARKS		DISPOSAL METHOD: (TO BE COMPLETED BY LANDFILL)			
			DISPOSE	OTHER	
FACILITY TICKET NUMBER		<input checked="" type="checkbox"/> SOIL	<i>x</i>		
SIGNATURE OF AUTHORIZED AGENT		<input type="checkbox"/> CONSTRUCTION DEBRIS			
DATE		<input type="checkbox"/> NON-FRIABLE ASBESTOS			
* <i>[Signature]</i>		<input type="checkbox"/> WOOD			
4/11/07		<input type="checkbox"/> ASH			
		<input type="checkbox"/> SPECIAL OTHER			

SCHEDULING MUST BE MADE PRIOR TO 3:00 P.M. THE DAY PRIOR TO EXPECTED ARRIVAL • ANY UNSCHEDULED LOADS ARE SUBJECT TO REFUSAL UPON ARRIVAL. ONGOING DAILY DELIVERIES MUST BE SCHEDULED WITH THE LANDFILL THE DAY BEFORE.

142225

KELLER CANYON LANDFILL
 901 BAILEY ROAD
 PITTSBURG, CA

003780
 ADVANCED GEO ENVIRONMENTAL INC
 4005 NORTH WILSON WAY

STOCKTON, CA 95205
 Contract: #212Y74089

SITE	TICKET	GRID
01	382613	
WEIGHMASTER		
FELIPE C		
DATE IN	TIME IN	
11 April 2007	10:33 am	
DATE OUT	TIME OUT	
11 April 2007	10:33 am	
VEHICLE	ROLL OFF	
KTL202		
REFERENCE	ORIGIN	
554642	OAKLAND	

Gross Weight 78,200.00 lb Inbound - SCALE TICKET
 Stored Tare Weight 34,020.00 lb
 Net Weight 44,180.00 lb 22.09 TN

QTY.	UNIT	DESCRIPTION	RATE	EXTENSION	TAX	TOTAL
22.09	TN	SW-CONT SOIL W/FUEL				
1.00	LD	ENVIRONMENTAL FEE				
1.00	LD	FUEL RECOVERY FEE				

- | | | | | |
|--|---|--|---|--|
| <input checked="" type="checkbox"/> Keller Canyon Sanitary Landfill
901 Bailey Road
Pittsburg, CA 94565
Phone (925) 458-9800
Fax (925) 458-9891 | <input type="checkbox"/> Coffin Butte Landfill
28972 Coffin Butte Road
Corvallis, OR 97330
Phone (541) 745-2018
Fax (541) 745-3826 | <input type="checkbox"/> Ox Mountain Sanitary Landfill
12310 San Mateo Road
Half Moon Bay, CA 94019
Phone (650) 726-1819
Fax (650) 726-9183 | <input type="checkbox"/> Newby Island Sanitary Landfill
1601 Dixon Landing Road
Milpitas, CA 95035
Phone (408) 945-2800
Fax (408) 262-2871 | <input type="checkbox"/> Forward Landfill
9999 S. Austin Road
Manteca, CA 95336
Phone (209) 982-4298
Fax (209) 982-1009 |
|--|---|--|---|--|

NON-HAZARDOUS WASTE MANIFEST

GENERATOR		WASTE ACCEPTANCE NO.		
MAILING ADDRESS		-212474089		
CITY, STATE, ZIP		REQUIRED PERSONAL PROTECTIVE EQUIPMENT		
PHONE		<input type="checkbox"/> GLOVES <input type="checkbox"/> GOGGLES <input type="checkbox"/> RESPIRATOR <input type="checkbox"/> HARD HAT <input type="checkbox"/> TY-VEK <input type="checkbox"/> SAFETY VEST		
CONTACT PERSON		SPECIAL HANDLING PROCEDURES:		
SIGNATURE OF AUTHORIZED AGENT / TITLE DATE				
* [Signature]				
<small>GENERATOR'S CERTIFICATION: I hereby certify that the above named material is not a hazardous waste as defined by 40 CFR Part 261 or title 22 of the California code of regulations, has been properly described, classified and packaged, and is in proper condition for transportation according to applicable regulations; AND, if the waste is a treatment residue of a previously restricted hazardous waste subject to the Land Disposal Restrictions, I certify and warrant that the waste has been treated in accordance with the requirements of 40 CFR Part 268 and is no longer a hazardous waste as defined by 40 CFR Part 261.</small>		RECEIVING FACILITY		
		WASTE TYPE:		
<input type="checkbox"/> DISPOSAL <input type="checkbox"/> SLUDGE <input type="checkbox"/> CONSTRUCTION <input type="checkbox"/> WOOD <input type="checkbox"/> DEBRIS <input type="checkbox"/> OTHER <input type="checkbox"/> SPECIAL WASTE				
GENERATING FACILITY				
TRANSPORTER		NOTES:	VEHICLE LICENSE NUMBER TRUCK NUMBER	
ADDRESS			9C29291 28199	
CITY, STATE, ZIP		H & D Trucking		
PHONE		END DUMP BOTTOM DUMP TRANSFER		
SIGNATURE OF AUTHORIZED AGENT OR DRIVER DATE		<input checked="" type="checkbox"/> <input type="checkbox"/> <input type="checkbox"/>		
* [Signature] 4/11/07		ROLL-OFF(S) FLAT-BED VAN DRUMS		
		<input type="checkbox"/> <input type="checkbox"/> <input type="checkbox"/> <input type="checkbox"/>		
I hereby certify that the above named material has been accepted and to the best of my knowledge the foregoing is true and accurate.		CUBIC YARDS		
		18 YRS.		
		DISPOSAL METHOD: (TO BE COMPLETED BY LANDFILL)		
			DISPOSE	OTHER
		<input type="checkbox"/> SOIL		
		<input type="checkbox"/> CONSTRUCTION DEBRIS		
		<input type="checkbox"/> NON-FRIABLE ASBESTOS		
REMARKS		<input type="checkbox"/> WOOD		
FACILITY TICKET NUMBER		<input type="checkbox"/> ASH		
SIGNATURE OF AUTHORIZED AGENT DATE		<input type="checkbox"/> SPECIAL OTHER		
* [Signature] 4-11-07				

SCHEDULING MUST BE MADE PRIOR TO 3:00 P.M. THE DAY PRIOR TO EXPECTED ARRIVAL • ANY UNSCHEDULED LOADS ARE SUBJECT TO REFUSAL UPON ARRIVAL. ONGOING DAILY DELIVERIES MUST BE SCHEDULED WITH THE LANDFILL THE DAY BEFORE.

142232

KELLER CANYON LANDFILL
 901 BAILEY ROAD
 PITTSBURG, CA

003780
 ADVANCED GEO ENVIRONMENTAL INC
 4005 NORTH WILSON WAY

STOCKTON, CA 95205
 Contract: #212Y74089

SITE 01	TICKET 382620	GRID
WEIGHMASTER FELIPE C		
DATE IN 11 April 2007	TIME IN 9:56 am	
DATE OUT 11 April 2007	TIME OUT 10:43 am	
VEHICLE HDT28199	ROLL OFF	
REFERENCE 554641	ORIGIN OAKLAND	

00 Gross Weight 83,360.00 lb Inbound - SCALE TICKET
 Stored Tare Weight 30,520.00 lb
 Net Weight 52,840.00 lb 26.42 TN

QTY	UNIT	DESCRIPTION	RATE	EXTENSION	TAX	TOTAL
26.42	TN	SW-CONT SOIL W/FUEL				
1.00	LD	ENVIRONMENTAL FEE				
1.00	LD	FUEL RECOVERY FEE				

NET AMOUNT

Keller Canyon Sanitary Landfill
 901 Bailey Road
 Pittsburg, CA 94565
 Phone (925) 458-9800
 Fax (925) 458-9891

Ox Mountain Sanitary Landfill
 12310 San Mateo Road
 Half Moon Bay, CA 94019
 Phone (650) 726-1819
 Fax (650) 726-9183

Newby Island Sanitary Landfill
 1601 Dixon Landing Road
 Milpitas, CA 95035
 Phone (408) 945-2800
 Fax (408) 262-2871

Forward Landfill
 9999 S. Austin Road
 Manteca, CA 95336
 Phone (209) 982-4298
 Fax (209) 982-1009

NON-HAZARDOUS WASTE MANIFEST

GENERATOR <i>Rio Pacific, Inc.</i>		WASTE ACCEPTANCE NO. - 212 y74 089	
MAILING ADDRESS <i>P.O. Box 725</i>			
CITY, STATE, ZIP <i>Ukiah CA 95482</i>		REQUIRED PERSONAL PROTECTIVE EQUIPMENT	
PHONE <i>(707) 462-8811</i>		<input checked="" type="checkbox"/> GLOVES <input type="checkbox"/> GOGGLES <input type="checkbox"/> RESPIRATOR <input type="checkbox"/> HARD HAT	
CONTACT PERSON <i>Ken Ruckert</i>		<input type="checkbox"/> TY-VEK <input type="checkbox"/> OTHER	
SIGNATURE OF AUTHORIZED AGENT / TITLE <i>* [Signature] / Staff Geologist</i>		SPECIAL HANDLING PROCEDURES:	
DATE <i>4-3-07</i>			
GENERATOR'S CERTIFICATION: I hereby certify that the above named material is not a hazardous waste as defined by 40 CFR Part 261 or title 22 of the California code of regulations, has been properly described, classified and packaged, and is in proper condition for transportation according to applicable regulations; AND, if the waste is a treatment residue of a previously restricted hazardous waste subject to the Land Disposal Restrictions, I certify and warrant that the waste has been treated in accordance with the requirements of 40 CFR Part 268 and is no longer a hazardous waste as defined by 40 CFR Part 261.		RECEIVING FACILITY <i>Keller Canyon</i>	
WASTE TYPE: <i>soil contaminated w/ diesel & unleaded gas</i>			
<input checked="" type="checkbox"/> DISPOSAL <input type="checkbox"/> SLUDGE			
<input type="checkbox"/> CONSTRUCTION <input type="checkbox"/> WOOD			
<input type="checkbox"/> DEBRIS <input type="checkbox"/> OTHER			
<input type="checkbox"/> SPECIAL WASTE			
GENERATING FACILITY <i>Oakland Truck Stop</i>			
TRANSPORTER <i>Intrinsic Transportation Inc.</i>		NOTES:	VEHICLE LICENSE NUMBER
ADDRESS <i>2225 Challenge Way, Suite 100</i>			<i>UP45347</i>
CITY, STATE, ZIP <i>Santa Rosa, CA 95407</i>			<i>720</i>
PHONE <i>(707) 578-0760</i>		END DUMP	BOTTOM DUMP
SIGNATURE OF AUTHORIZED AGENT OR DRIVER <i>* [Signature]</i>		<input type="checkbox"/>	<input type="checkbox"/>
DATE <i>4-11-07</i>		ROLL-OFF(S)	FLAT-BED
		<input type="checkbox"/>	<input type="checkbox"/>
			VAN
			<input type="checkbox"/>
			DRUMS
			<input type="checkbox"/>
I hereby certify that the above named material has been accepted and to the best of my knowledge the foregoing is true and accurate.		CUBIC YARDS <i>20</i>	
		DISPOSAL METHOD: (TO BE COMPLETED BY LANDFILL)	
REMARKS		DISPOSE	
		OTHER	
FACILITY TICKET NUMBER		<input checked="" type="checkbox"/> SOIL	
SIGNATURE OF AUTHORIZED AGENT <i>* [Signature]</i>		<input type="checkbox"/> CONSTRUCTION DEBRIS	
DATE		<input type="checkbox"/> NON-FRIABLE ASBESTOS	
		<input type="checkbox"/> WOOD	
		<input type="checkbox"/> ASH	
		<input type="checkbox"/> SPECIAL OTHER	

SCHEDULING MUST BE MADE PRIOR TO 3:00 P.M. THE DAY PRIOR TO EXPECTED ARRIVAL • ANY UNSCHEDULED LOADS ARE SUBJECT TO REFUSAL UPON ARRIVAL. ONGOING DAILY DELIVERIES MUST BE SCHEDULED WITH THE LANDFILL THE DAY BEFORE.

MANIFEST # **53749**

142235

KELLER CANYON LANDFILL
 901 BAILEY ROAD
 PITTSBURG, CA

003780
 ADVANCED GEO ENVIRONMENTAL INC
 4005 NORTH WILSON WAY

STOCKTON, CA 95205
 Contract: #212Y74089

SITE	TICKET	GRID
01	382623	
WEIGHMASTER		
FELIPE C		
DATE IN	TIME IN	
11 April 2007	10:52 am	
DATE OUT	TIME OUT	
11 April 2007	10:52 am	
VEHICLE	ROLL OFF	
IT725		
REFERENCE	ORIGIN	
53749	OAKLAND	

00 Gross Weight 82,900.00 lb Inbound - SCALE TICKET
 Stored Tare Weight 32,060.00 lb
 Net Weight 50,840.00 lb 25.42 TN

QTY.	UNIT	DESCRIPTION	RATE	EXTENSION	TAX	TOTAL
25.42	TN	SW-CONT SOIL W/FUEL				
1.00	LD	ENVIRONMENTAL FEE				
1.00	LD	FUEL RECOVERY FEE				

NET AMOUNT

Keller Canyon Sanitary Landfill
901 Bailey Road
Pittsburg, CA 94565
Phone (925) 458-9800
Fax (925) 458-9891



Coffin Butte Landfill
28972 Coffin Butte Road
Corvallis, OR 97330
Phone (541) 745-2018
Fax (541) 745-3826

Ox Mountain Sanitary Landfill
12310 San Mateo Road
Half Moon Bay, CA 94019
Phone (650) 726-1819
Fax (650) 726-9183

Newby Island Sanitary Landfill
1601 Dixon Landing Road
Milpitas, CA 95035
Phone (408) 945-2800
Fax (408) 262-2871

Forward Landfill
9999 S. Austin Road
Manteca, CA 95336
Phone (209) 982-4298
Fax (209) 982-1009

NON-HAZARDOUS WASTE MANIFEST

GENERATOR		WASTE ACCEPTANCE NO.		
MAILING ADDRESS		- 2112 94089		
CITY, STATE, ZIP		REQUIRED PERSONAL PROTECTIVE EQUIPMENT		
PHONE		<input type="checkbox"/> GLOVES <input type="checkbox"/> GOGGLES <input type="checkbox"/> RESPIRATOR <input type="checkbox"/> HARD HAT		
CONTACT PERSON		<input type="checkbox"/> TY-VEK <input type="checkbox"/> SAFETY VEST		
SIGNATURE OF AUTHORIZED AGENT / TITLE		SPECIAL HANDLING PROCEDURES:		
DATE				
* 				
GENERATOR'S CERTIFICATION: I hereby certify that the above named material is not a hazardous waste as defined by 40 CFR Part 261 or title 22 of the California code of regulations, has been properly described, classified and packaged, and is in proper condition for transportation according to applicable regulations; AND, if the waste is a treatment residue of a previously restricted hazardous waste subject to the Land Disposal Restrictions, I certify and warrant that the waste has been treated in accordance with the requirements of 40 CFR Part 268 and is no longer a hazardous waste as defined by 40 CFR Part 261.		RECEIVING FACILITY		
WASTE TYPE:				
<input type="checkbox"/> DISPOSAL <input type="checkbox"/> CONSTRUCTION <input type="checkbox"/> DEBRIS <input type="checkbox"/> SPECIAL WASTE		<input type="checkbox"/> SLUDGE <input type="checkbox"/> WOOD <input type="checkbox"/> OTHER		
GENERATING FACILITY				
TRANSPORTER		NOTES:	VEHICLE LICENSE NUMBER	TRUCK NUMBER
ADDRESS				
CITY, STATE, ZIP				
PHONE		END DUMP	BOTTOM DUMP	TRANSFER
SIGNATURE OF AUTHORIZED AGENT OR DRIVER		<input type="checkbox"/>	<input type="checkbox"/>	<input type="checkbox"/>
DATE		ROLL-OFF(S)	FLAT-BED	VAN
* 		<input type="checkbox"/>	<input type="checkbox"/>	<input type="checkbox"/>
I hereby certify that the above named material has been accepted and to the best of my knowledge the foregoing is true and accurate.		CUBIC YARDS		
		20		
REMARKS		DISPOSAL METHOD: (TO BE COMPLETED BY LANDFILL)		
		<input checked="" type="checkbox"/> SOIL <input type="checkbox"/> CONSTRUCTION DEBRIS <input type="checkbox"/> NON-FRIABLE ASBESTOS <input type="checkbox"/> WOOD <input type="checkbox"/> ASH <input type="checkbox"/> SPECIAL OTHER		
FACILITY TICKET NUMBER		DISPOSE		
SIGNATURE OF AUTHORIZED AGENT		OTHER		
DATE				
* 				

SCHEDULING MUST BE MADE PRIOR TO 3:00 P.M. THE DAY PRIOR TO EXPECTED ARRIVAL • ANY UNSCHEDULED LOADS ARE SUBJECT TO REFUSAL UPON ARRIVAL. ONGOING DAILY DELIVERIES MUST BE SCHEDULED WITH THE LANDFILL THE DAY BEFORE.

SALES COPY

MANIFEST # 554643

142296

KELLER CANYON LANDFILL
 901 BAILEY ROAD
 PITTSBURG, CA

003780
 ADVANCED GEO ENVIRONMENTAL INC
 4005 NORTH WILSON WAY

STOCKTON, CA 95205
 Contract: #212Y74089

SITE 01	TICKET 382684	GRID
WEIGHMASTER		
FELIFE C		
DATE IN 11 April 2007	TIME IN 12:58 pm	
DATE OUT 11 April 2007	TIME OUT 12:58 pm	
VEHICLE KTL202	ROLL OFF	
REFERENCE 554643	ORIGIN OAKLAND	

Gross Weight 69,360.00 lb Inbound - SCALE TICKET
 Stored Tare Weight 34,020.00 lb
 Net Weight 35,340.00 lb 17.67 TN

QTY.	UNIT	DESCRIPTION	RATE	EXTENSION	TAX	TOTAL
17.67	TN	SW-CONT SOIL W/FUEL				
1.00	LD	ENVIRONMENTAL FEE				
1.00	LD	FUEL RECOVERY FEE				

NET AMOUNT

APPENDIX C

CAL TECH Environmental Laboratories



6814 Rosecrans Avenue. Paramount, CA 90723-3146
 Telephone: (562) 272-2700 Fax: (562) 272-2789

ANALYTICAL RESULTS*

CTEL Project No: CT214-0704020

Client Name: Advanced Geo Environmental, Inc.
 837 Shaw Road
 Stockton, CA 95215

Phone: (209) 467-1006

Fax: (209) 467-1118

Attention: Ms. Jo'l Chapman

Project ID: Global ID: T0600102136

Project Name: Oakland Truck Stop

Date Sampled: 04/04/07 @ 11:50 am

Matrix: Soil

Date Received: 04/05/07 @ 08:30 am

Date Analyzed: 04/10/07 - 04/11/07

Laboratory ID:	0704-020-1	0704-020-2	0704-020-3	Method	Units:	Detection Limit
Client Sample ID:	Floor-1	Floor-2	Floor-3			
Dilution	1	1-10	1			
TPH - Gasoline	1.1	7.0	1.0	EPA 8015M	mg/Kg	1
TPH - Diesel	370	270	220	EPA 8015M	mg/Kg	5
VOC, 8260B						
Dilution	1	1	1			
Methyl-tert-butyl-ether(MtBE)	0.60	0.072	0.030	SW846 8260B	mg/Kg	0.005
t-Butyl Alcohol (TBA)	ND	ND	ND	SW846 8260B	mg/Kg	0.10
Diisopropyl Ether (DIPE)	ND	ND	ND	SW846 8260B	mg/Kg	0.01
Ethyl-t-butyl ether (ETBE)	ND	ND	ND	SW846 8260B	mg/Kg	0.01
t-Amyl Methyl Ether (TAME)	0.036	ND	ND	SW846 8260B	mg/Kg	0.01
1,2-Dichloroethane	ND	ND	ND	SW846 8260B	mg/Kg	0.005
1,2-Dibromoethane(EDB)	ND	ND	ND	SW846 8260B	mg/Kg	0.005
Benzene	0.020	ND	ND	SW846 8260B	mg/Kg	0.005
Toluene	ND	ND	ND	SW846 8260B	mg/Kg	0.005
Ethylbenzene	ND	ND	ND	SW846 8260B	mg/Kg	0.005
m,p-Xylene	ND	ND	ND	SW846 8260B	mg/Kg	0.005
o-Xylene	ND	ND	ND	SW846 8260B	mg/Kg	0.005

ND = Not Detected at the indicated Detection Limit

SURROGATE SPIKE	% SURROGATE RECOVERY			Control Limit
Dibromofluoromethane	103	103	94	70-130
1,2 Dichloroethane-d4	110	114	114	70-130
Toluene-d8	83	84	82	70-130
Bromofluorobenzene	114	116	129	70-130

CTEL Project No: CT214-0704020
Client Name: Advanced Geo Environmental, Inc.
 837 Shaw Road
 Stockton, CA 95215
Attention: Ms. Jo'l Chapman

Phone: (209) 467-1006
Fax: (209) 467-1118

Project ID: Global ID: T0600102136
Project Name: Oakland Truck Stop

Date Sampled: 04/04/07 @ 11:55 am
Date Received: 04/05/07 @ 08:30 am
Date Analyzed: 04/10/07 – 04/11/07

Matrix: Soil

Laboratory ID:	0704-020-4	0704-020-5	0704-020-6	Method	Units:	Detection Limit
Client Sample ID:	Floor-4	Floor-5	Floor-6			
Dilution	1	1	1			
TPH - Gasoline	ND<1	2.0	ND<1	EPA 8015M	mg/Kg	1
TPH - Diesel	95	930	ND	EPA 8015M	mg/Kg	5
VOC, 8260B						
Dilution	1	1	1			
Methyl-tert-butyl-ether(MtBE)	0.036	0.034	ND	SW846 8260B	mg/Kg	0.005
t-Butyl Alcohol (TBA)	ND	ND	ND	SW846 8260B	mg/Kg	0.10
Diisopropyl Ether (DIPE)	ND	ND	ND	SW846 8260B	mg/Kg	0.01
Ethyl-t-butyl ether (ETBE)	ND	ND	ND	SW846 8260B	mg/Kg	0.01
t-Amyl Methyl Ether (TAME)	ND	ND	ND	SW846 8260B	mg/Kg	0.01
1,2-Dichloroethane	ND	ND	ND	SW846 8260B	mg/Kg	0.005
1,2-Dibromoethane(EDB)	ND	ND	ND	SW846 8260B	mg/Kg	0.005
Benzene	ND	ND	ND	SW846 8260B	mg/Kg	0.005
Toluene	ND	ND	ND	SW846 8260B	mg/Kg	0.005
Ethylbenzene	ND	ND	ND	SW846 8260B	mg/Kg	0.005
m,p-Xylene	ND	ND	ND	SW846 8260B	mg/Kg	0.005
o-Xylene	ND	ND	ND	SW846 8260B	mg/Kg	0.005

ND = Not Detected at the indicated Detection Limit

<i>SURROGATE SPIKE</i>	% SURROGATE RECOVERY			Control Limit
Dibromofluoromethane	95	102	103	70-130
1,2 Dichloroethaned4	110	114	112	70-130
Toluene-d8	77	73	101	70-130
Bromofluorobenzene	121	107	118	70-130

CTEL Project No: CT214-0704020
Client Name: Advanced Geo Environmental, Inc.
 837 Shaw Road
 Stockton, CA 95215
Attention: Ms. Jo'l Chapman

Phone:(209) 467-1006
Fax: (209) 467-1118

Project ID: Global ID: T0600102136
Project Name: Oakland Truck Stop

Date Sampled: 04/04/07 @ 11:55 am
Date Received: 04/05/07 @ 08:30 am
Date Analyzed: 04/10/07 – 04/11/07

Matrix: Soil

Laboratory ID:	0704-020-7	0704-020-8	0704-020-9	Method	Units:	Detection Limit
Client Sample ID:	Floor-7	Floor-8	Exc-S1			
Dilution	1-10	1-10	1-10			
TPH - Gasoline	1.4	13	24	EPA 8015M	mg/Kg	1
TPH – Diesel	ND<5	9800	1100	EPA 8015M	mg/Kg	5
VOC, 8260B						
Dilution	1-10	1-10	1-10			
Methyl-tert-butyl-ether(MtBE)	1.2	2.6	0.040	SW846 8260B	mg/Kg	0.005
t-Butyl Alcohol (TBA)	ND<0.10	ND<0.10	ND<0.10	SW846 8260B	mg/Kg	0.10
Diisopropyl Ether (DIPE)	ND<0.01	ND<0.01	ND<0.01	SW846 8260B	mg/Kg	0.01
Ethyl-t-butyl ether (ETBE)	ND<0.01	ND<0.01	ND<0.01	SW846 8260B	mg/Kg	0.01
t-Amyl Methyl Ether (TAME)	0.042	0.046	ND<0.01	SW846 8260B	mg/Kg	0.01
1,2-Dichloroethane	ND<0.005	ND<0.005	ND<0.005	SW846 8260B	mg/Kg	0.005
1,2-Dibromoethane(EDB)	ND<0.005	ND<0.005	ND<0.005	SW846 8260B	mg/Kg	0.005
Benzene	ND<0.005	ND<0.005	ND<0.005	SW846 8260B	mg/Kg	0.005
Toluene	ND<0.005	0.018	0.018	SW846 8260B	mg/Kg	0.005
Ethylbenzene	ND<0.005	0.016	0.014	SW846 8260B	mg/Kg	0.005
m,p-Xylene	ND<0.005	0.024	0.020	SW846 8260B	mg/Kg	0.005
o-Xylene	ND<0.005	ND<0.005	ND<0.005	SW846 8260B	mg/Kg	0.005

ND = Not Detected at the indicated Detection Limit

SURROGATE SPIKE	% SURROGATE RECOVERY			Control Limit
Dibromofluoromethane	104	111	88	70-130
1,2 Dichloroethaned4	112	125	101	70-130
Toluene-d8	85	90	89	70-130
Bromofluorobenzene	118	123	124	70-130

CTEL Project No: CT214-0704020
Client Name: Advanced Geo Environmental, Inc.
 837 Shaw Road
 Stockton, CA 95215
Attention: Ms. Jo'l Chapman

Phone:(209) 467-1006
Fax: (209) 467-1118

Project ID: Global ID: T0600102136
Project Name: Oakland Truck Stop

Date Sampled: 04/04/07 @ 12:20 p.m.
Date Received: 04/05/07 @ 08:30 am
Date Analyzed: 04/10/07 – 04/11/07

Matrix: Soil

Laboratory ID:	0704-020-10	0704-020-11	0704-020-12	Method	Units:	Detection Limit
Client Sample ID:	Exc-S2	Exc-S3	Exc-W			
Dilution	1-10	1-10	1-10			
TPH - Gasoline	30	50	36	EPA 8015M	mg/Kg	1
TPH – Diesel	4400	8600	2300	EPA 8015M	mg/Kg	5
VOC, 8260B						
Dilution	1-10	1-10	1-10			
Methyl-tert-butyl-ether(MtBE)	0.23	2.4	0.13	SW846 8260B	mg/Kg	0.005
t-Butyl Alcohol (TBA)	ND<0.10	ND<0.10	ND<0.10	SW846 8260B	mg/Kg	0.10
Diisopropyl Ether (DIPE)	ND<0.01	ND<0.01	ND<0.01	SW846 8260B	mg/Kg	0.01
Ethyl-t-butyl ether (ETBE)	ND<0.01	ND<0.01	ND<0.01	SW846 8260B	mg/Kg	0.01
t-Amyl Methyl Ether (TAME)	0.048	0.090	0.036	SW846 8260B	mg/Kg	0.01
1,2-Dichloroethane	ND<0.005	ND<0.005	ND<0.005	SW846 8260B	mg/Kg	0.005
1,2-Dibromoethane(EDB)	ND<0.005	ND<0.005	ND<0.005	SW846 8260B	mg/Kg	0.005
Benzene	0.024	0.046	0.020	SW846 8260B	mg/Kg	0.005
Toluene	0.020	0.018	0.020	SW846 8260B	mg/Kg	0.005
Ethylbenzene	0.018	0.028	0.014	SW846 8260B	mg/Kg	0.005
m,p-Xylene	0.020	0.044	0.020	SW846 8260B	mg/Kg	0.005
o-Xylene	ND<0.005	0.030	ND<0.005	SW846 8260B	mg/Kg	0.005

ND = Not Detected at the indicated Detection Limit

SURROGATE SPIKE	% SURROGATE RECOVERY			Control Limit
Dibromofluoromethane	89	107	86	70-130
1,2 Dichloroethaned4	113	128	107	70-130
Toluene-d8	82	126	87	70-130
Bromofluorobenzene	127	127	124	70-130

CTEL Project No: CT214-0704020
Client Name: Advanced Geo Environmental, Inc.
 837 Shaw Road
 Stockton, CA 95215
Attention: Ms. Jo'l Chapman

Phone: (209) 467-1006
Fax: (209) 467-1118

Project ID: Global ID: T0600102136
Project Name: Oakland Truck Stop

Date Sampled: 04/04/07 @ 12:20 p.m.
Date Received: 04/05/07 @ 08:30 am
Date Analyzed: 04/10/07 – 04/11/07

Matrix: Soil

Laboratory ID: 0704-020-13
Client Sample ID: Exc-E
Dilution: 1-10

Method **Units:** **Detection Limit**

TPH - Gasoline 5.0
TPH - Diesel ND<5

EPA 8015M mg/Kg 1
 EPA 8015M mg/Kg 5

VOC, 8260B
Dilution 1-10

Methyl-tert-butyl-ether(MtBE) 2.0
 t-Butyl Alcohol (TBA) ND<0.10
 Diisopropyl Ether (DIPE) ND<0.01
 Ethyl-t-butyl ether (ETBE) ND<0.01
 t-Amyl Methyl Ether (TAME) 0.011
 1,2-Dichloroethane ND<0.005
 1,2-Dibromoethane(EDB) ND<0.005
 Benzene 0.020
 Toluene 0.019
 Ethylbenzene 0.014
 m,p-Xylene 0.022
 o-Xylene ND<0.005

SW846 8260B mg/Kg 0.005
 SW846 8260B mg/Kg 0.10
 SW846 8260B mg/Kg 0.01
 SW846 8260B mg/Kg 0.01
 SW846 8260B mg/Kg 0.01
 SW846 8260B mg/Kg 0.005
 SW846 8260B mg/Kg 0.005
 SW846 8260B mg/Kg 0.005
 SW846 8260B mg/Kg 0.005
 SW846 8260B mg/Kg 0.005
 SW846 8260B mg/Kg 0.005
 SW846 8260B mg/Kg 0.005

ND = Not Detected at the indicated Detection Limit

<i>SURROGATE SPIKE</i>	<i>% SURROGATE RECOVERY</i>	<i>Control Limit</i>
Dibromofluoromethane	74	70-130
1,2 Dichloroethaned4	89	70-130
Toluene-d8	79	70-130
Bromofluorobenzene	116	70-130

 Greg Tejirian
 Laboratory Director

*The results are base upon the sample received.

Cal Tech Environmental Laboratories, Inc. ELAP ID #: 2424

CAL TECH Environmental Laboratories



6814 Rosecrans Avenue, Paramount, CA 90723-3146

Telephone: (562) 272-2700 Fax: (562) 272-2789

QA/QC Report

Method: 8015M

Matrix: Soil

Date Analyzed: 4/10/07

Date Extracted: 4/10/07

Perimeters	Conc. ug/Kg		Spike Added	Recovery %		Control Limits	RPD	
	MS	MSD		MS	MSD			
TPH - Gasoline	1082	1031	1000	108	103	70-130	20	5
TPH - Diesel	1110	1088	1000	111	109	70-130	20	2

Perimeters	Method Blank	Units	Det. Limit
TPH - Gasoline	ND	ug/Kg	100
TPH - Diesel	ND	ug/Kg	100

MS: Matrix Spike

MSD: Matrix Spike Duplicate

RPD: Relative Percent Difference of MS and MSD

CAL TECH Environmental Laboratories



6814 Rosecrans Avenue. Paramount, CA 90723-3146
 Telephone: (562) 272-2700 Fax: (562) 272-2789

QA/QC Report

Method: 8260B

Matrix: Soil

Date Analyzed: 4/10/07

Date Extracted: 4/10/07

Perimeters	Conc. ug/Kg		Spike Added	Recovery %		Control Limits	RPD	
	MS	MSD		MS	MSD			
1,1-Dichloroethene	51	48	50	102	96	70-130	20	6
Benzene	54	52	50	108	104	70-130	20	4
Trichloroethene	46	45	50	92	90	70-130	20	2
Toluene	51	52	50	102	104	70-130	20	2
Chlorobenzene	47	48	50	94	96	70-130	20	2
m,p-Xylenes	103	103	100	103	103	70-130	20	0

MS: Matrix Spike

MSD: Matrix Spike Duplicate

RPD: Relative Percent Difference of MS and MSD

Perimeters	Method Blank	Units	Det. Limit
1,1-Dichloroethene	ND	ug/Kg	5
Benzene	ND	ug/Kg	5
Trichloroethene	ND	ug/Kg	5
Toluene	ND	ug/Kg	5
Chlorobenzene	ND	ug/Kg	5
m,p-Xylenes	ND	ug/Kg	5
MTBE	ND	ug/Kg	5
TBA	ND	ug/Kg	100
DIPE	ND	ug/Kg	10
ETBE	ND	ug/Kg	10
TAME	ND	ug/Kg	10
1,2-Dichloroethane	ND	ug/Kg	5
EDB	ND	ug/Kg	5
Ethylbenzene	ND	ug/Kg	5
o-Xylene	ND	ug/Kg	5

CAL TECH Environmental Laboratories



6814 Rosecrans Avenue. Paramount, CA 90723-3146
Telephone: (562) 272-2700 Fax: (562) 272-2789

QA/QC Report

Method: 8015M

Matrix: Soil

Date Analyzed: 4/11/07

Date Extracted: 4/11/07

Perimeters	Conc. ug/Kg		Spike Added	Recovery %		Control Rec.	Limits RPD	RPD
	MS	MSD		MS	MSD			
TPH - Gasoline	1036	1054	1000	104	105	70-130	20	1

Perimeters	Method Blank	Units	Det. Limit
TPH - Gasoline	ND	ug/Kg	100

MS: Matrix Spike

MSD: Matrix Spike Duplicate

RPD: Relative Percent Difference of MS and MSD

CAL TECH Environmental Laboratories



6814 Rosecrans Avenue. Paramount, CA 90723-3146
 Telephone: (562) 272-2700 Fax: (562) 272-2789

QA/QC Report

Method: 8260B

Matrix: Soil

Date Analyzed: 4/11/07

Date Extracted: 4/11/07

Perimeters	Conc. ug/Kg		Spike Added	Recovery %		Control Rec.	Limits RPD	RPD
	MS-2	MSD-2		MS	MSD			
1,1-Dichloroethene	48	50	50	96	100	70-130	20	4
Benzene	54	56	50	108	112	70-130	20	4
Trichloroethene	55	56	50	110	112	70-130	20	2
Toluene	48	50	50	96	100	70-130	20	4
Chlorobenzene	49	51	50	98	102	70-130	20	4
m,p-Xylenes	106	107	100	106	107	70-130	20	1

MS: Matrix Spike

MSD: Matrix Spike Duplicate

RPD: Relative Percent Difference of MS and MSD

Perimeters	Method Blank	Units	Det. Limit
1,1-Dichloroethene	ND	ug/Kg	5
Benzene	ND	ug/Kg	5
Trichloroethene	ND	ug/Kg	5
Toluene	ND	ug/Kg	5
Chlorobenzene	ND	ug/Kg	5
m,p-Xylenes	ND	ug/Kg	5
MTBE	ND	ug/Kg	5
TBA	ND	ug/Kg	100
DIPE	ND	ug/Kg	10
ETBE	ND	ug/Kg	10
TAME	ND	ug/Kg	10
1,2-Dichloroethane	ND	ug/Kg	5
EDB	ND	ug/Kg	5
Ethylbenzene	ND	ug/Kg	5
o-Xylene	ND	ug/Kg	5

