

9-4612  
3616 San Leandro Boulevard  
Oakland

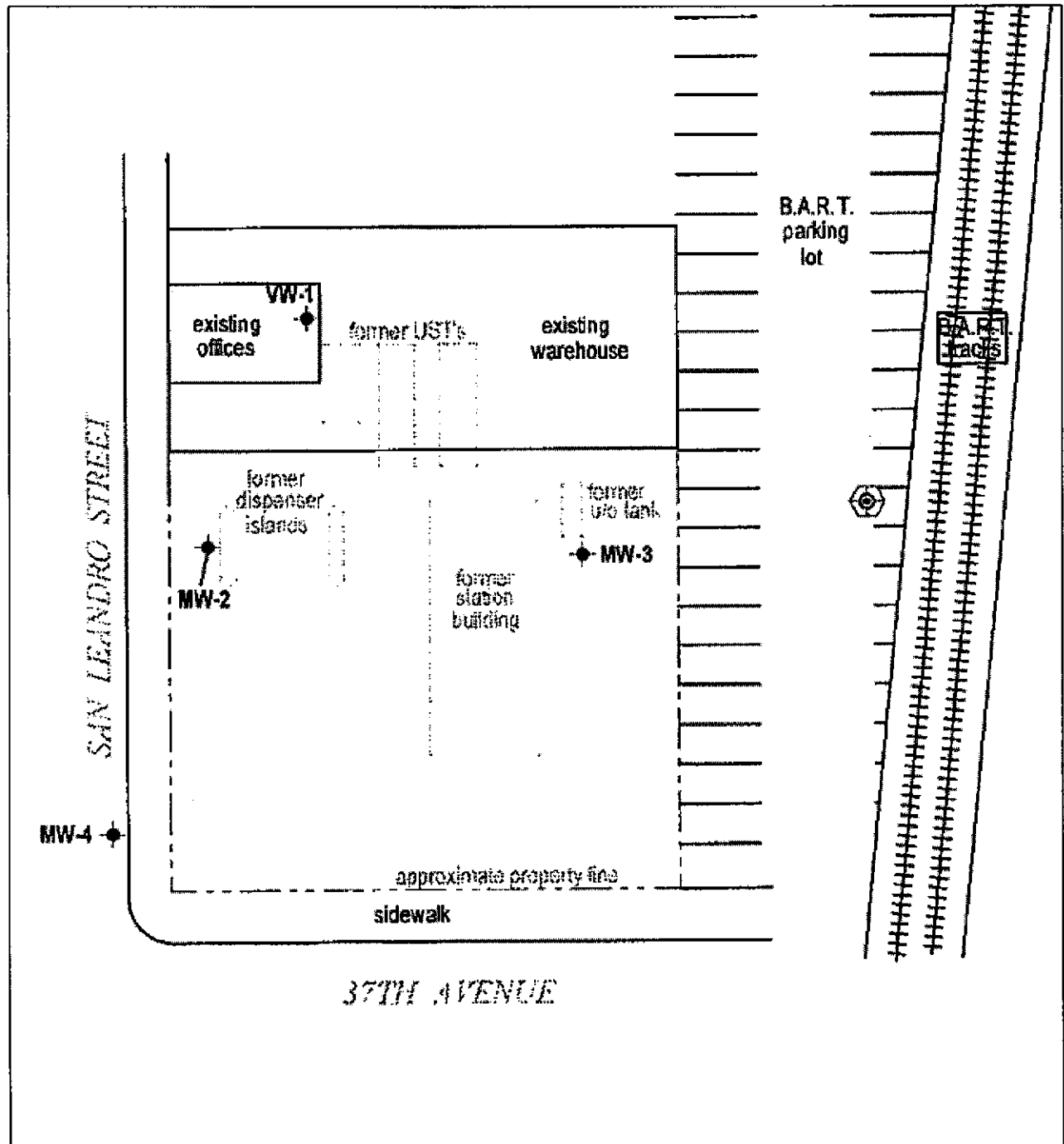

**Site Number:**

9-4612

**Site Address:**

3616 San Leandro Blvd., Oakland

**Alameda County Case Worker:**

Barney Chan

**Soil Conditions:**

Soil data from the site is limited as the only unsaturated soil samples have been collected at 5 fbg in MW-2 and MW-3 and reported no hydrocarbons. Saturated soil samples appear to have minor hydrocarbon impact.

**Groundwater Conditions:**

Total petroleum hydrocarbons as diesel (TPHd), TPHg and benzene are currently reported at maximum concentrations of 3,500 µg/L, 2,900 µg/L and 7 µg/L, respectively. MTBE is reported at a maximum concentration of 57 µg/L in monitoring well VH-1. The Chevron station was removed from the site in 1976, which predates the use of MTBE as a fuel additive. MTBE appears to be migrating through the site from an up-gradient source.

**Alameda County Actions:**

None to Date

**Pending Cambria Actions:**

None to Date

# CAMBRIA



Tony's Express Auto Service  
3609 International Blvd.

Former Chevron 9-4612  
3616 San Leandro Street

**Former Chevron Station 9-4612**  
3616 San Leandro Street  
Oakland, California

**AERIAL MAP**

**Table 1**  
**Historical Soil Chemical Analytical Results**  
**Former Chevron Service Station No. 9-4612**  
**3616 San Leandro Street**  
**Oakland, California**

Sample ID	Sample Depth (feet)	Sample Date	TPHg (ppm)	B (ppm)	T (ppm)	E (ppm)	X (ppm)	Lead (ppm)
VH-1	20.5	8/10/88	<0.5	0.042	<0.005	<0.005	<0.005	6.0
VH-1	25.5	8/10/88	<0.5	0.036	<0.005	<0.005	<0.005	6.0
MW-2	5.0	2/1/93	<1.0	<0.005	<0.005	<0.005	<0.005	NA
MW-2	10	2/1/93	<1.0	<0.005	<0.005	<0.005	<0.005	NA
MW-3	5.0	2/1/93	<1.0	<0.005	<0.005	<0.005	<0.005	NA
MW-3	10	2/1/93	<1.0	<0.005	<0.005	<0.005	<0.005	NA
MW 4-16.5	16.5	8/15/95	<1.0	<0.005	<0.005	<0.005	<0.005	NA
MW 4-21.5	21.5	8/15/95	2.0	<0.005	0.014	0.007	0.01	NA
SB 1-21.5	21.5	8/15/95	16	<0.005	0.12	0.21	1.1	NA

**EXPLANATIONS**

NA = Not Analyzed

ppm = parts per million

TPHg = Total Petroleum Hydrocarbons as gasoline

B = Benzene

T = Toluene

E = Ethylbenzene

X = Xylenes

MtBE = Methyl tert-butyl ether

**Table 2**  
**Soil Chemical Analytical Results**  
**Former Chevron Service Station No. 9-4612**  
**3616 San Leandro Street**  
**Oakland, California**

Sample ID	Sample Depth (feet)	Sample Date	TPHg (ppm)	B (ppm)	T (ppm)	E (ppm)	X (ppm)	MtBE (ppm)
GP1-6	6	7/3/01	<1.0	<0.0050	<0.0050	<0.0050	<0.0050	<0.20
GP1-9	9	7/3/01	<1.0	<0.0050	<0.0050	<0.0050	<0.0050	<0.20
GP2-6	6	7/3/01	<1.0	<0.0050	<0.0050	<0.0050	<0.0050	<0.20
GP2-8.5	8.5	7/3/01	<1.0	<0.0050	<0.0050	<0.0050	<0.0050	<0.20
GP3-5.5	5.5	7/3/01	<1.0	<0.0050	<0.0050	<0.0050	<0.0050	<0.20
GP3-8.5	8.5	7/3/01	<1.0	<0.0050	<0.0050	<0.0050	<0.0050	<0.20
HA1-5	5.0	3/5/02	<1.0	<0.0050	0.0098	0.016	0.089	<0.050
HA2-5	5.0	3/5/02	<1.0	<0.0050	<0.0050	<0.0050	<0.015	<0.050
HA3-5	5.0	3/5/02	<1.0	<0.0050	<0.0050	<0.0050	<0.015	<0.050

**Explanation**

ppm = parts per million

MtBE = Methyl-tert Butyl Ether

B = Benzene

T = Toluene

E = Ethylbenzene

X = Xylenes

TPHg = Total Petroleum Hydrocarbons as gasoline

**Analytical Laboratory**

GPs: Sequoia Analytical (ELAP# 1271)

HAs: Lancaster Laboratories (ELAP# 2116)

**Analytical Methods**

GPs: TPHg/BTEX by DHS LUFT Methods

MtBE by EPA Method 8206B

HAs: TPHg/BTEX/MtBE by EPA Methods 8015M/8021B

**Table 3**  
**Groundwater Chemical Analytical Results**  
**Former Chevron Service Station No. 9-4612**  
**3616 San Leandro Street**  
**Oakland, California**

Sample ID	Sample Date	TPHg (ppb)	B (ppb)	T (ppb)	E (ppb)	X (ppb)	MtBE (ppb)
HA-1	3/5/02	<50	<0.50	<0.50	<0.50	<1.5	<2.5
HA-2	3/5/02	<50	<0.50	<0.50	<0.50	<1.5	<2.5
HA-3	3/5/02	<50	<0.50	<0.50	<0.50	<1.5	<2.5

**Explanation**

B = Benzene

T = Toluene

E = Ethylbenzene

X = Xylenes

ppm = parts per million

MtBE = Methyl-tert Butyl Ether

TPHg = Total Petroleum Hydrocarbons as gasoline

**Analytical Laboratory**

Lancaster Laboratories (ELAP# 2116)

**Analytical Methods**

TPHg/BTEX/MtBE: EPA Methods 8015M/8021B



# GETTLER-RYAN INC.

## TRANSMITTAL

June 30, 2006

G-R #386473

TO: Mr. Bruce H. Eppler  
Cambria Environmental Technology, Inc.  
2000 Opportunity Drive, Suite 110  
Roseville, California 95678

FROM: Deanna L. Harding  
Project Coordinator  
Gettler-Ryan Inc.  
6747 Sierra Court, Suite J  
Dublin, California 94568

RE: **Former Chevron Service Station  
#9-4612  
3616 San Leandro Street  
Oakland, California  
MTI: 61H-1996  
RO 0000233**

WE HAVE ENCLOSED THE FOLLOWING:

COPIES	DATED	DESCRIPTION
2	June 30, 2006	Groundwater Monitoring and Sampling Report Second Quarter - Event of May 31, 2006

### COMMENTS:

Pursuant to your request, we are providing you with copies of the above referenced report for **your use and distribution to the following:**

Mr. Dana Thurman, Chevron Environmental Management Company, P.O. Box 6012, Room K2236,  
San Ramon, CA 94583

Please provide any comments/changes and propose any groundwater monitoring modifications for the next event prior to **July 18, 2006**, at which time the final report will be distributed to the following:

cc: Mr. Leonard B. Ratto, Ratto Land Company, P.O. Box 6104, Oakland, CA 94603-0104  
Mr. Terry McIlraith, 407 Castello Road, Lafayette, CA 94549  
Mr. Barney Chan, Alameda County Health Care Services, Dept. of Environmental Health, 1131 Harbor Bay Parkway, Suite 250, Alameda, CA 94502-6577 (No Hard Copy-UPLOAD TO ALAMEDA CO.)

Enclosures

trans/9-4612-DT

6747 Sierra Court, Suite J • Dublin, CA 94568 • (925) 551-7555 • Fax (925) 551-7888  
3140 Gold Camp Drive, Suite 170 • Rancho Cordova, CA 95670 • (916) 631-1300 • Fax (916) 631-1317  
1364 N. McDowell Blvd., Suite B2 • Petaluma, CA 94954 • (707) 789-3255 • Fax (707) 789-3218



# GETTLER - RYAN Inc.

June 30, 2006  
G-R Job #386473

Mr. Dana Thurman  
Chevron Environmental Management Company  
P.O. Box 6012, Room K2236  
San Ramon, CA 94583

**RE: Second Quarter Event of May 31, 2006**  
Groundwater Monitoring & Sampling Report  
Former Chevron Service Station #9-4612  
3616 San Leandro Street  
Oakland, California

Dear Mr. Thurman:

This report documents the most recent groundwater monitoring and sampling event performed by Gettler-Ryan Inc. (G-R) at the referenced site. All field work was conducted in accordance with G-R Standard Operating Procedure - Groundwater Sampling (attached).

Static groundwater levels were measured and the wells were checked for the presence of separate-phase hydrocarbons. Static water level data, groundwater elevations, and separate-phase hydrocarbon thickness (if any) are presented in the attached Table 1. Dissolved Oxygen Concentrations are presented in Table 2. A Potentiometric Map is included as Figure 1.

Groundwater samples were collected from the monitoring wells and submitted to a state certified laboratory for analyses. The field data sheets for this event are attached. Analytical results are presented in the table(s) listed below. The chain of custody document and laboratory analytical report are also attached.

Please call if you have any questions or comments regarding this report. Thank you.

Sincerely,

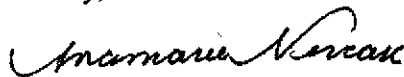
  
-FOR-

Deanna L. Harding  
Project Coordinator

  
Robert A. Lauritzen  
Senior Geologist, P.G. No. 7504



Figure 1: Potentiometric Map  
Table 1: Groundwater Monitoring Data and Analytical Results  
Table 2: Dissolved Oxygen Concentrations  
Table 3: Groundwater Analytical Results - Oxygenate Compounds  
Attachments: Standard Operating Procedure - Groundwater Sampling  
Field Data Sheets  
Chain of Custody Document and Laboratory Analytical Reports



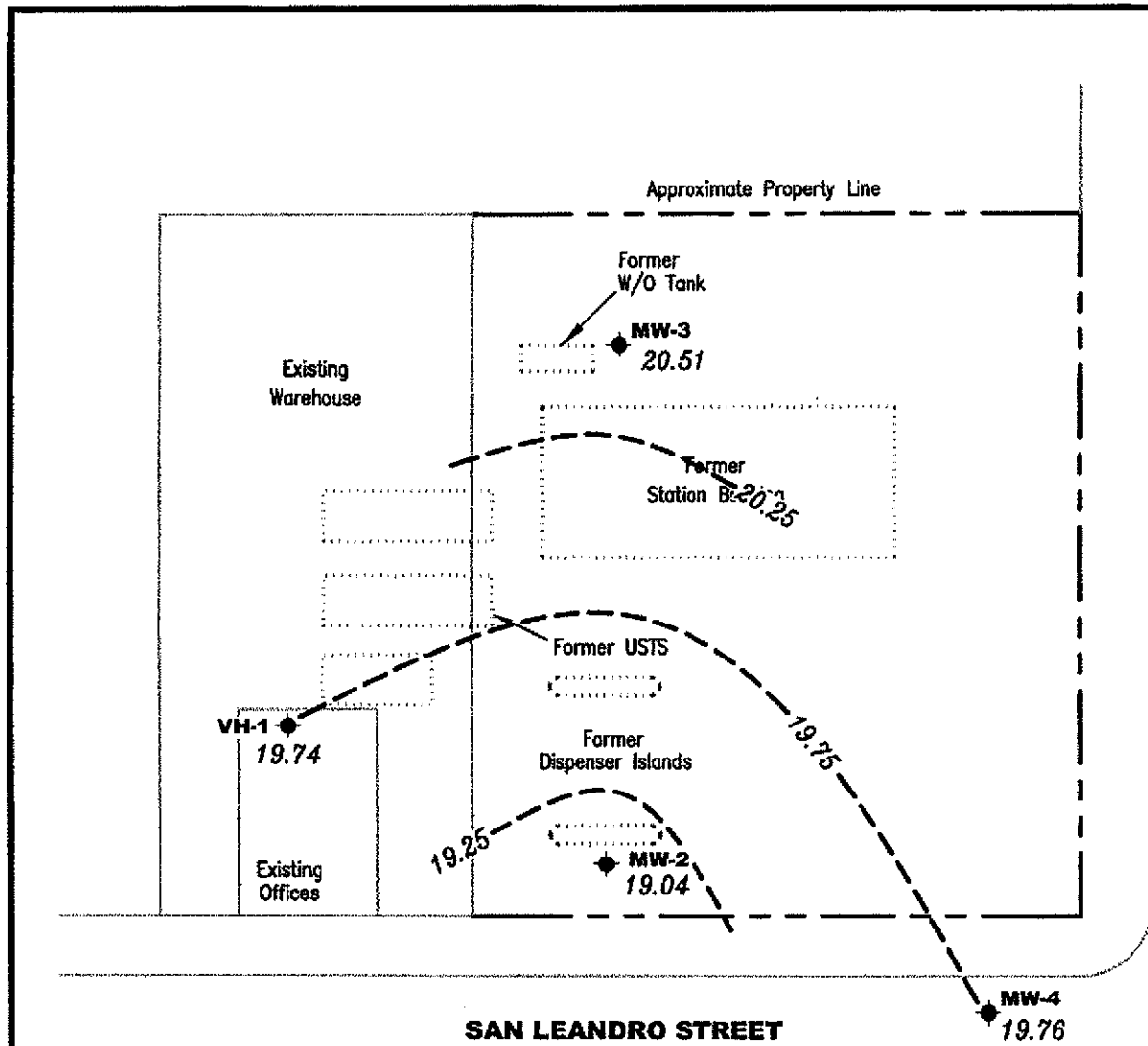

**EXPLANATION**

- ◆ Groundwater monitoring well
- 99.99 Groundwater elevation in feet referenced to Mean Sea Level
- 99.99--- Groundwater elevation contour, dashed where inferred

Approximate groundwater flow direction at a gradient of 0.02 Ft./Ft.

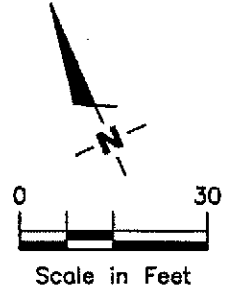

Source: Figure modified from drawing provided by RRM engineering contracting firm.

**GETTLER - RYAN INC.**  
 6747 Sierra Court, Suite J  
 Dublin, CA 94568 (925) 551-7555

**POTENTIOMETRIC MAP**  
 Former Chevron Service Station #9-4612  
 3616 San Leandro Street  
 Oakland, California

FIGURE  
**1**

PROJECT NUMBER <b>386473</b>	REVIEWED BY	DATE May 31, 2006	REVISED DATE
---------------------------------	-------------	----------------------	--------------

Table 1  
**Groundwater Monitoring Data and Analytical Results**  
 Former Chevron Service Station #9-4612  
 3616 San Leandro Street  
 Oakland, California

WELL ID/ DATE	TOC* (ft.)	GWE (msl)	DTW (ft.)	TPH-D (ppb)	TPH-G (ppb)	B (ppb)	T (ppb)	E (ppb)	X (ppb)	MTBE (ppb)	TOG (ppb)
VH-1											
08/10/88	--	--	13.00	--	11,000	3,300	200	520	540	--	--
06/01/89	--	--	10.32	--	15,000	2,200	120	540	310	--	--
09/15/89	--	--	15.69	--	5,600	1,900	90	350	160	--	--
12/08/89	--	--	14.77	--	11,000	1,900	69	270	99	--	--
03/07/91	--	--	11.26	--	4,500	820	39	120	77	--	--
09/24/91	--	--	12.98	--	3,300	520	19	39	27	--	--
01/08/92	--	--	13.77	--	5,000	600	34	81	76	--	--
04/20/92	--	--	8.18	--	7,400	670	60	110	140	--	--
03/26/93	27.85	21.14	6.71	--	4,900	600	40	72	94	--	--
05/27/93	27.85	19.27	8.58	--	13,000	1,600	120	230	220	--	--
08/18/93	27.85	17.39	10.46	--	2,700	210	10	8.1	18	--	--
11/03/93	27.85	15.28	12.57	--	4,600	680	42	35	68	--	--
02/10/94	27.85	18.77	9.08	--	1,900	260	19	22	29	--	--
05/12/94	27.85	19.76	8.09	--	2,000	390	28	3.9	29	--	--
08/26/94	27.85	17.10	10.75	--	4,900	500	<5.0	23	31	--	--
11/14/94	27.85	18.40	9.45	300	760	69	<2.0	<2.0	2.2	--	--
02/01/95	27.85	21.88	5.97	--	1,300	120	5.9	<0.5	13	--	--
05/12/95	27.85	20.14	7.71	--	4,400	460	31	45	49	--	--
08/22/95	27.85	18.59	9.26	--	2,900	310	15	28	32	--	--
12/19/95	27.85	19.05	8.80	--	930	53	<2.5	<2.5	<2.5	39	--
01/31/96	27.85	22.35	5.50	--	3,700	320	<10	41	40	180	--
04/30/96	27.85	19.81	8.04	--	3,900	270	<20	<20	<20	120	--
08/01/96	27.85	18.67	9.18	--	2,700	140	11	18	28	200	--
10/30/96	27.85	18.67	10.76	--	2,700	140	<12	<12	<12	280	--
02/07/97	27.85	19.75	8.10	--	220	13	0.6	<0.5	1.6	15	--
05/07/97	27.85	18.33	9.52	--	5,200	33	12	21	26	330	--
07/22/97	27.85	17.43	10.42	--	4,200	80	<10	16	24	400	--
11/03/97	27.85	16.85	11.00	--	2,400	150	6.8	6.5	9.5	510	--
01/28/98	27.85	20.75	7.10	--	850	69	4.8	5.0	11	38/48 <sup>12</sup>	--
05/08/98	27.85	20.14	7.71	--	4,200	200	30	40	42	310/200 <sup>12</sup>	--
07/29/98	27.85	18.40	9.45	--	3,800	54	10	27	30	35/290 <sup>12</sup>	--
11/06/98	27.85	17.15	10.70	--	4,800	100	20	12	23	360/210 <sup>12</sup>	--
02/09/99 <sup>5</sup>	27.85	21.87	5.98	--	2,950	79.5	<10	<10	<10	435/312 <sup>12</sup>	--
05/13/99	27.85	19.71	8.14	--	4,180	147	12.8	16.5	20.3	433245 <sup>12</sup>	--
09/07/99	27.85	17.94	9.91	--	2,750	57.6	<5.0	6.53	<5.0	297/233 <sup>12</sup>	--

**Table 1**  
**Groundwater Monitoring Data and Analytical Results**  
 Former Chevron Service Station #9-4612  
 3616 San Leandro Street  
 Oakland, California

WELL ID/ DATE	TOC* (ft.)	GWE (msl)	DTW (ft.)	TPH-D (ppb)	TPH-G (ppb)	B (ppb)	T (ppb)	E (ppb)	X (ppb)	MTBE (ppb)	TOG (ppb)
<b>VH-1 (cont)</b>											
11/24/99	27.85	17.36	10.49	--	2,550	38	3.18	2.54	5.21	--/216 <sup>1,12</sup>	--
02/25/00	27.85	21.20	6.65	--	120	2.7	<0.5	<0.5	<0.5	20.5/11.9 <sup>12</sup>	--
05/10/00	27.85	19.76	8.09	--	1,400 <sup>8</sup>	63	3.3	3.1	4.9	230/110 <sup>12</sup>	--
7/31/00 <sup>11</sup>	27.85	18.30	9.55	--	360 <sup>8</sup>	22	2.7	1.6	3.1	100/88 <sup>12</sup>	--
10/30/00 <sup>11</sup>	27.85	17.91	9.94	--	987 <sup>10</sup>	47.0	1.00	<0.500	1.80	153/130 <sup>12</sup>	--
02/05/01	27.91	19.23	8.68	--	2,670	42.7	<5.00	<5.00	<5.00	225/160 <sup>12</sup>	--
05/07/01 <sup>11</sup>	27.91	19.61	8.30	--	1,800 <sup>6</sup>	100	8.2	10	7.9	440/110 <sup>12</sup>	--
08/06/01 <sup>11</sup>	27.91	18.09	9.82	--	1,000 <sup>6</sup>	67	6.1	2.1	7.1	270/140 <sup>12</sup>	--
11/12/01 <sup>11</sup>	27.91	17.29	10.62	--	220	1.2	<0.50	<0.50	<1.5	63/61 <sup>12</sup>	--
02/11/02 <sup>11</sup>	27.91	19.83	8.08	--	1,700	33	<5.0	6.3	3.8	64/52 <sup>12</sup>	--
05/13/02 <sup>11</sup>	27.91	19.21	8.70	--	2,700	54	4.1	5.6	6.2	100/80 <sup>12</sup>	--
08/09/02 <sup>11</sup>	27.91	18.50	9.41	--	2,400	37	2.4	1.2	3.4	86/89 <sup>12</sup>	--
11/07/02 <sup>11</sup>	27.91	17.34	10.57	--	150	1.3	<0.50	<0.50	<1.5	56/50 <sup>12</sup>	--
02/04/03 <sup>11</sup>	27.91	19.63	8.28	--	1,700	40	3.1	7.8	5.0	100/53 <sup>12</sup>	--
05/05/03 <sup>11</sup>	27.91	20.41	7.50	--	2,100	44	3.4	3.7	5.2	96/62 <sup>12</sup>	--
09/06/03 <sup>11,14</sup>	27.91	18.31	9.60	--	690	7	0.6	<0.5	0.6	59	--
11/14/03 <sup>11,14</sup>	27.91	17.99	9.92	--	1,000	3	0.6	2	0.7	47	--
02/13/04 <sup>14,15</sup>	27.91	19.98	7.93	--	2,400	30	2	4	3	47	--
05/13/04 <sup>14</sup>	27.91	19.24	8.67	--	1,900	49	4	3	5	74	--
08/17/04 <sup>14</sup>	27.91	18.26	9.65	--	1,800	11	1	0.9	2	58	--
11/10/04	27.91	INACCESSIBLE	--	--	--	--	--	--	--	--	--
02/08/05 <sup>14</sup>	27.91	20.08	7.83	--	2,700	26	3	4	5	48	--
06/03/05 <sup>14</sup>	27.91	19.71	8.20	--	3,100	40	5	6	9	45	--
08/05/05 <sup>14</sup>	27.91	17.81	10.10	--	2,500	34	4	0.6	6	46	--
12/02/05 <sup>14</sup>	27.91	18.93	8.98	--	3,500	69	7	2	8	57	--
03/03/06 <sup>14</sup>	NP <sup>18</sup>	27.91	20.66	--	4,100	37	6	6	8	40	--
05/31/06 <sup>14</sup>	NP <sup>18</sup>	27.91	19.74	--	4,100	33	5	3	8	34	--
<b>MW-2</b>											
02/16/93	27.51	--	--	--	9,200	720	110	250	170	--	--
03/26/93	27.51	19.89	7.62	--	--	--	--	--	--	--	--
05/27/93	27.51	18.04	9.47	--	360	5.3	2.1	1.8	2.5	--	--
08/18/93	27.51	16.46	11.05	--	9,400	1,100	76	110	100	--	--
11/03/93	27.51	14.56	12.95	--	8,600	390	20	2.7	120	--	--
02/10/94	27.51	17.72	9.79	--	2,700	370	38	44	41	--	--

Table 1  
**Groundwater Monitoring Data and Analytical Results**  
 Former Chevron Service Station #9-4612  
 3616 San Leandro Street  
 Oakland, California

WELL ID/ DATE	TOC* (ft.)	GWE (nsl)	DTW (ft.)	TPH-D (ppb)	TPH-G (ppb)	B (ppb)	T (ppb)	E (ppb)	X (ppb)	MTBE (ppb)	TOG (ppb)
<b>MW-2 (cont)</b>											
05/12/94	27.51	18.59	8.92	--	3,800	650	76	15	62	--	--
08/26/94	27.51	16.14	11.37	--	16,000	1,300	270	28	120	--	--
11/14/94	27.51	17.48	10.03	--	5,100	390	10	43	27	--	--
02/01/95	27.51	20.47	7.04	--	6,900	520	82	170	110	--	--
05/12/95	27.51	18.76	8.75	--	7,700	510	83	110	100	--	--
08/22/95	27.51	17.35	10.16	--	4,500	220	16	61	47	--	--
12/19/95	27.51	18.05	9.46	--	2,900	240	<10	19	18	220	--
01/31/96	27.51	21.91	5.60	--	3,900	320	18	72	39	<25	--
04/30/96	27.51	18.68	8.83	--	5,600	200	36	55	47	170	--
08/01/96	27.51	17.25	10.26	--	6,200	190	15	62	59	220	--
10/30/96	27.51	17.25	11.48	--	5,700	190	<25	67	36	260	--
02/07/97	27.51	18.11	9.40	--	8,300	210	34	70	59	330	--
05/07/97	27.51	17.57	9.94	--	6,900	190	12	38	37	530	--
07/22/97	27.51	16.36	11.15	--	10,000	18	25	62	41	630	--
11/03/97	27.51	15.93	11.58	--	6,500	260	8.5	26	14	590/9.6 <sup>4,12</sup>	--
01/28/98	27.51	19.38	8.13	--	6,700	65	13	67	54	280/94 <sup>12</sup>	--
05/08/98	27.51	18.89	8.62	--	5,500	91	38	43	61	220/62 <sup>12</sup>	--
07/29/98	27.51	17.06	10.45	--	3,600	41	8.9	3.6	14	16/94 <sup>12</sup>	--
11/06/98	27.51	15.89	11.62	--	6,900	77	<5.0	14	17	290/110 <sup>12</sup>	--
02/09/99 <sup>5</sup>	27.51	20.61	6.90	--	8,070	75.6	<10	<10	<10	397/144 <sup>12</sup>	--
05/13/99	27.51	18.21	9.30	--	5,890	120	<5.0	12.5	26.6	401/69.4 <sup>12</sup>	--
09/07/99	27.51	16.57	10.94	--	5,820	41.2	<5.0	14.6	<5.0	260/145 <sup>12</sup>	--
11/24/99	27.51	15.98	11.53	--	5,940	40.9	<10	10.8	<10	--/120 <sup>1,12</sup>	--
02/25/00	27.51	21.00	6.51	--	6,370	101	9.37	39.8	33.2	321/121 <sup>12</sup>	--
05/10/00	27.51	18.49	9.02	--	6,100 <sup>8</sup>	110	13	27	31	560/120 <sup>12</sup>	--
07/31/00 <sup>11</sup>	27.51	17.18	10.33	--	3,000 <sup>8</sup>	75	14	28	28	200/130 <sup>12</sup>	--
10/30/00 <sup>11</sup>	27.51	16.95	10.56	--	6,810 <sup>10</sup>	162	<5.00	8.05	<15.0	372/140 <sup>12</sup>	--
02/05/01 <sup>11</sup>	28.05	18.47	9.58	--	5,860	28.4	6.86	16.2	11.8	285/140 <sup>12</sup>	--
05/07/01 <sup>11</sup>	28.05	18.85	9.20	--	4,700 <sup>6</sup>	120	15	30	42	540/88 <sup>12</sup>	--
08/06/01 <sup>11</sup>	28.05	17.31	10.74	--	3,700 <sup>6</sup>	120	<20	28	33	490/110 <sup>12</sup>	--
11/12/01 <sup>11</sup>	28.05	16.60	11.45	--	7,000	29	<10	27	22	93/98 <sup>12</sup>	--
02/11/02 <sup>11</sup>	28.05	18.99	9.06	--	5,900	43	15	24	27	90/86 <sup>12</sup>	--
05/13/02 <sup>11</sup>	28.05	18.41	9.64	--	5,500	26	5.2	23	26	120/47 <sup>12</sup>	--
08/09/02 <sup>11</sup>	28.05	17.76	10.29	--	5,700	26	3.7	26	50	100/69 <sup>12</sup>	--
11/07/02 <sup>11</sup>	28.05	16.78	11.27	--	5,900	33	4.4	23	21	<100/69 <sup>12</sup>	--
02/04/03 <sup>11</sup>	28.05	18.92	9.13	--	5,400	22	4.7	13	14	<50/55 <sup>12</sup>	--

T-1  
**Groundwater Monitoring Data and Analytical Results**  
 Former Chevron Service Station #9-4612  
 3616 San Leandro Street  
 Oakland, California

WELL ID/ DATE	TOC* (ft.)	GWE (msl)	DTW (ft.)	TPH-D (ppb)	TPH-G (ppb)	B (ppb)	T (ppb)	E (ppb)	X (ppb)	MTBE (ppb)	TOG (ppb)
<b>MW-2 (cont)</b>											
05/05/03 <sup>11</sup>	28.05	19.67	8.38	--	4,500	23	4.7	12	15	<50/31 <sup>12</sup>	--
09/06/03 <sup>11,14</sup>	28.05	17.65	10.40	--	3,200	13	2	7	7	54	--
11/14/03 <sup>11,14</sup>	28.05	17.43	10.62	--	4,000	11	2	7	6	55	--
02/13/04 <sup>14,15</sup>	28.05	19.26	8.79	--	6,200	6	2	8	8	31	--
05/13/04 <sup>14</sup>	28.05	18.49	9.56	--	3,200	6	3	13	11	34	--
08/17/04 <sup>14</sup>	28.05	17.57	10.48	--	4,300	7	1	6	5	46	--
11/10/04 <sup>14</sup>	28.05	18.52	9.53	--	3,000	5	1	6	7	37	--
02/08/05 <sup>14</sup>	28.05	19.34	8.71	--	4,700	3	2	10	8	22	--
06/03/05 <sup>14</sup>	28.05	19.04	9.01	--	4,100	4	3	15	11	23	--
08/05/05 <sup>14</sup>	28.05	18.29	9.76	--	3,500	4	1	<0.5	8	23	--
12/02/05 <sup>14</sup>	28.05	18.41	9.64	--	2,900	4	2	3	3	24	--
03/03/06 <sup>14</sup>	28.05	20.01	8.04	--	3,800	5	6	4	5	9	--
05/31/06 <sup>14</sup>	28.05	19.04	9.01	--	4,600	2	1	3	3	8	--
<b>MW-3</b>											
02/16/93	28.50	--	--	--	3,500	<0.5	8.1	4.6	7.7	--	--
03/26/93	28.50	21.32	7.18	--	--	--	--	--	--	--	--
05/27/93	28.50	19.17	9.33	--	4,200	580	84	150	100	--	--
08/18/93	28.50	16.50	12.00	1,400	910	12	3.7	6.2	3.8	--	<5,000
11/03/93	28.50	15.21	13.29	--	5,300	29	1.9	0.6	27	--	--
02/10/94	28.50	18.87	9.63	<50	63	<0.5	0.7	<0.5	<0.5	--	--
05/12/94	28.50	19.73	8.77	84	<50	<0.5	0.5	<0.5	<0.5	--	--
08/26/94	28.50	17.08	11.42	--	2,100	12	<0.5	5.0	0.5	--	--
11/14/94	28.50	18.43	10.07	--	140	0.78	<0.5	<0.5	<0.5	--	--
02/01/95	28.50	22.21	6.29	<50	<50	<0.5	<0.5	<0.5	<0.5	--	--
05/12/95	28.50	20.43	8.07	540 <sup>2</sup>	330	13	1.1	1.9	0.69	--	--
08/22/95	28.50	18.55	9.95	550 <sup>2</sup>	980	32	<1.0	<1.0	<1.0	--	--
12/19/95	28.50	19.10	9.40	<50	<50	<0.5	<0.5	<0.5	<0.5	<2.5	--
01/31/96	28.50	23.45	5.05	<50	<50	<0.5	<0.5	<0.5	<0.5	<2.5	--
04/30/96	28.50	20.10	8.40	240 <sup>2</sup>	320	2.4	<0.5	0.75	<0.5	7.8	--
08/01/96	28.50	18.70	9.80	470 <sup>2</sup>	980	9.6	<0.5	0.98	2.2	54	--
10/30/96	28.50	18.70	11.48	760 <sup>2</sup>	2,000	14	<10	<10	<10	140	--
02/07/97	28.50	19.90	8.60	61 <sup>2</sup>	200 <sup>2</sup>	<0.5	<0.5	<0.5	<0.5	8.9	--
05/07/97	28.50	19.49	9.01	550 <sup>2</sup>	3,500	14	3.9	3.6	8.0	160	--
07/22/97	28.50	17.38	11.12	800 <sup>2</sup>	3,500	55	<10	<10	<10	150	--

Table 1  
**Groundwater Monitoring Data and Analytical Results**  
 Former Chevron Service Station #9-4612  
 3616 San Leandro Street  
 Oakland, California

WELL ID/ DATE	TOC* (ft.)	GWE (msl)	DTW (ft.)	TPH-D (ppb)	TPH-C (ppb)	B (ppb)	T (ppb)	E (ppb)	X (ppb)	MTBE (ppb)	TOG (ppb)
MW-3 (cont)											
11/03/97	28.50	16.99	11.51	910 <sup>2</sup>	4,100	140	<5.0	<5.0	<5.0	380	--
01/28/98	28.50	21.16	7.34	--	1,100	24	<1.2	<1.2	2.8	33/6.1 <sup>12</sup>	--
05/08/98	28.50	20.44	8.06	250 <sup>2</sup>	990	3.6	7.7	0.7	2.2	37/7.5 <sup>12</sup>	--
07/29/98	28.50	18.25	10.25	290 <sup>2</sup>	1,200	13	<0.5	<0.5	1.4	11/28 <sup>12</sup>	--
11/06/98	28.50	17.11	11.39	390 <sup>2</sup>	2,600	5.3	<2.5	<2.5	3.0	91/41 <sup>12</sup>	--
02/09/99 <sup>5</sup>	28.50	22.40	6.10	184 <sup>2</sup>	406	<1.0	4.03	<1.0	<1.0	17.7/1.97 <sup>12</sup>	--
05/13/99	28.50	19.38	9.12	--	615	13.8	1.05	<0.5	<0.5	43.5/21.2 <sup>12</sup>	--
09/07/99	28.50	17.77	10.73	528 <sup>2</sup>	2,710	<5.0	<5.0	<5.0	<5.0	96.3/57.9 <sup>12</sup>	--
11/24/99	28.50	17.37	11.13	1,070 <sup>2</sup>	5,530	<5.0	<5.0	5.59	<5.0	--/66 <sup>1,12</sup>	--
02/25/00	28.50	22.22	6.28	--	189	4.68	<0.5	<0.5	<0.5	11.9/<2.0 <sup>12</sup>	--
03/01/00	28.50	21.80	6.70	380 <sup>2</sup>	--	--	--	--	--	--	--
05/10/00	28.50	19.90	8.60	830 <sup>7</sup>	1,600 <sup>6</sup>	22	<10	<10	<10	100/51 <sup>12</sup>	--
07/31/00 <sup>11</sup>	28.50	18.43	10.07	490 <sup>7</sup>	2,200 <sup>6</sup>	76	10	<5.0	13	230/52 <sup>12</sup>	--
10/30/00 <sup>11</sup>	28.50	17.97	10.53	580 <sup>9</sup>	3,320 <sup>10</sup>	<5.00	<5.00	<5.00	<15.0	147/64 <sup>12</sup>	--
02/05/01 <sup>11</sup>	29.04	19.78	9.26	--	3,960	<5.00	6.02	<5.00	<5.00	159/70 <sup>12</sup>	--
05/07/01 <sup>11</sup>	29.04	20.29	8.75	--	2,800 <sup>6</sup>	61	12	<10	20	230/49 <sup>12</sup>	--
05/10/01 <sup>11</sup>	29.04	20.21	8.83	390 <sup>13</sup>	--	--	--	--	--	--	--
08/06/01 <sup>11</sup>	29.04	18.59	10.45	870 <sup>7</sup>	1,600 <sup>6</sup>	39	14	1.3	5.6	130/43 <sup>12</sup>	--
11/12/01 <sup>11</sup>	29.04	17.82	11.22	1,400	3,100	3.6	23	2.3	5.6	40/46 <sup>12</sup>	--
02/11/02 <sup>11</sup>	29.04	20.66	8.38	700	4,000	10	<5.0	4.2	5.5	44/42 <sup>12</sup>	--
05/13/02 <sup>11</sup>	29.04	19.84	9.20	730	2,500	18	<5.0	<5.0	5.2	44/32 <sup>12</sup>	--
08/09/02 <sup>11</sup>	29.04	18.87	10.17	560	2,700	17	<5.0	<5.0	<10	45/33 <sup>12</sup>	--
11/07/02 <sup>11</sup>	29.04	17.91	11.13	660	2,600	24	<5.0	2.0	4.8	51/37 <sup>12</sup>	--
02/04/03 <sup>11</sup>	29.04	20.44	8.60	370	2,200	13	1.5	2.7	5.0	<50/24 <sup>12</sup>	--
05/05/03 <sup>11</sup>	29.04	21.22	7.82	580	2,100	14	1.8	2.0	3.9	<20/19 <sup>12</sup>	--
09/06/03 <sup>11,14</sup>	29.04	18.79	10.25	780	1,800	2	0.6	0.6	1	28	--
11/14/03 <sup>11,14</sup>	29.04	18.52	10.52	860	2,000	1	0.6	0.6	0.9	30	--
02/13/04 <sup>14,15</sup>	29.04	20.76	8.28	590	3,600	1	0.6	1	2	21	--
05/13/04 <sup>14</sup>	29.04	19.87	9.17	670	1,600	1	<0.5	0.5	1	20	--
08/17/04 <sup>14</sup>	29.04	18.79	10.25	900	2,500	1	<0.5	<0.5	0.7	25	--
11/10/04 <sup>14</sup>	29.04	19.81	9.23	780	1,500	1	0.6	0.5	1	27	--
02/08/05 <sup>14</sup>	29.04	20.92	8.12	530	2,500	1	0.6	2	3	11	--
06/03/05 <sup>14</sup>	29.04	20.47	8.57	600	1,700	1	<0.5	0.7	1	9	--
08/05/05 <sup>14</sup>	29.04	18.44	10.60	530 <sup>16</sup>	980	0.6	<0.5	<0.5	0.8	9	--
12/02/05 <sup>14</sup>	29.04	19.46	9.58	1,400 <sup>17</sup>	2,400	1	2	0.8	1	7	--
03/03/06 <sup>14</sup>	29.04	21.46	7.58	530	2,300	0.8	1	<0.5	1	4	--

Table I  
**Groundwater Monitoring Data and Analytical Results**  
 Former Chevron Service Station #9-4612  
 3616 San Leandro Street  
 Oakland, California

WELL ID/ DATE	TOC* (%)	GWE (mst)	DTW (ft.)	TPH-D (ppb)	TPH-G (ppb)	B (ppb)	T (ppb)	E (ppb)	X (ppb)	MTBE (ppb)	TOG (ppb)
MW-3 (cont) 05/31/06 <sup>14</sup>	29.04	20.51	8.53	480	2,700	0.6	<0.5	<0.5	0.8	4	--
MW-4											
08/22/95	27.27	18.16	9.11	--	9,600	100	<10	<10	<10	--	--
12/19/95	27.27	18.97	8.30	--	<50	<0.5	<0.5	<0.5	<0.5	<2.5	--
01/31/96	27.27	21.67	5.60	--	<50	<0.5	<0.5	<0.5	<0.5	<2.5	--
04/30/96	27.27	20.27	7.00	--	<50	<0.5	<0.5	<0.5	<0.5	<2.5	--
08/01/96	27.27	18.12	9.15	--	<50	<0.5	<0.5	<0.5	<0.5	--	--
10/30/96	27.27	18.12	10.74	--	110	<0.5	<0.5	<0.5	<0.5	<2.5	--
02/07/97	27.27	19.47	7.80	--	80	<0.5	<0.5	<0.5	<0.5	4.1	--
05/07/97	27.27	21.42	5.85	--	<50	<0.5	<0.5	<0.5	<0.5	<2.5	--
07/22/97	27.27	17.22	10.05	--	150	<0.5	<0.5	<0.5	<0.5	<2.5	--
11/03/97	27.27	16.55	10.72	--	52	0.9	<0.5	<0.5	<0.5	-- <sup>3</sup>	--
01/28/98	27.27	20.76	6.51	--	<50	<0.5	<0.5	<0.5	<0.5	<2.5/<2.0 <sup>12</sup>	--
05/08/98	27.27	20.25	7.02	--	56	<0.5	<0.5	<0.5	<0.5	<2.5/<2.0 <sup>12</sup>	--
07/29/98	27.27	18.32	8.95	--	<50	0.9	<0.5	<0.5	<0.5	<2.5/<2.0 <sup>12</sup>	--
11/06/98	27.27	16.68	10.59	--	72	<0.5	<0.5	<0.5	<0.5	<2.5/<2.0 <sup>12</sup>	--
02/09/99	27.27	21.41	5.86	--	<50	<0.5	<0.5	<0.5	<0.5	<2.0/<1.1 <sup>12</sup>	--
05/13/99	27.27	19.32	7.95	--	<50	<0.5	<0.5	<0.5	<0.5	<5.0/<2.0 <sup>12</sup>	--
09/07/99	27.27	17.79	9.48	--	70.2	<0.5	<0.5	<0.5	<0.5	<2.0/<1.0 <sup>12</sup>	--
11/24/99	27.27	17.22	10.05	--	227	<0.5	<0.5	<0.5	<0.5	--/<0.5 <sup>12</sup>	--
02/25/00	27.27	INACCESSIBLE		--	--	--	--	--	--	--	--
03/01/00	27.27	21.10	6.17	--	<50	<0.5	<0.5	<0.5	<0.5	<2.5/<2.0 <sup>12</sup>	--
05/10/00	27.27	INACCESSIBLE - CAR PARKED OVER WELL		--	--	--	--	--	--	--	--
07/31/00	27.27	17.90	9.37	--	<50	<0.50	<0.50	<0.50	<0.50	<2.5/<2.0 <sup>12</sup>	--
10/30/00	27.27	17.80	9.47	--	54.0 <sup>10</sup>	<0.500	<0.500	<0.500	<1.50	<2.50/<2.0 <sup>12</sup>	--
02/05/01	27.27	INACCESSIBLE - CAR PARKED OVER WELL		--	--	--	--	--	--	--	--
05/07/01	27.27	19.46	7.81	--	<50	<0.50	<0.50	<0.50	<0.50	<2.5/<2.0 <sup>12</sup>	--
08/06/01	27.27	17.49	9.78	--	<50	1.1	0.52	<0.50	1.1	6.0/<2.0 <sup>12</sup>	--
11/12/01	27.27	16.86	10.41	--	93	<0.50	<0.50	<0.50	<1.5	<2.5/<2 <sup>12</sup>	--
02/11/02	27.27	19.63	7.64	--	<50	<0.50	<0.50	<0.50	<1.5	<2.5/<2 <sup>12</sup>	--
05/13/02	27.27	18.95	8.32	--	54	<0.50	0.84	<0.50	<1.5	<2.5/<2 <sup>12</sup>	--
08/09/02	27.27	18.02	9.25	--	54	<0.50	<0.50	<0.50	<1.5	<2.5/<2 <sup>12</sup>	--
11/07/02	27.27	16.85	10.42	--	<50	<0.50	<0.50	<0.50	<1.5	<2.5/<2 <sup>12</sup>	--
02/04/03	27.27	19.52	7.75	--	<50	<0.50	<0.50	<0.50	<1.5	<2.5/<0.5 <sup>12</sup>	--

**Table 1**  
**Groundwater Monitoring Data and Analytical Results**  
 Former Chevron Service Station #9-4612  
 3616 San Leandro Street  
 Oakland, California

WELL ID/ DATE	TOC* (ft.)	GWE (msl)	DTW (ft.)	TPH-D (ppb)	TPH-G (ppb)	B (ppb)	T (ppb)	E (ppb)	X (ppb)	MTBE (ppb)	TOG (ppb)
<b>MW-4 (cont)</b>											
05/05/03	27.27	20.37	6.90	--	<50	<0.5	<0.5	<0.5	<1.5	<2.5/<0.5 <sup>12</sup>	--
09/06/03 <sup>14</sup>	27.27	17.77	9.50	--	<50	<0.5	<0.5	<0.5	<0.5	<0.5	--
11/14/03 <sup>14</sup>	27.27	17.47	9.80	--	<50	<0.5	<0.5	<0.5	<0.5	<0.5	--
02/13/04 <sup>14</sup>	27.27	19.91	7.36	--	<50	<0.5	<0.5	<0.5	<0.5	<0.5	--
05/13/04 <sup>14</sup>	27.27	18.99	8.28	--	<50	<0.5	<0.5	<0.5	<0.5	<0.5	--
08/17/04 <sup>14</sup>	27.27	17.64	9.63	--	<50	<0.5	<0.5	<0.5	<0.5	<0.5	--
11/10/04 <sup>14</sup>	27.27	18.81	8.46	--	52	<0.5	<0.5	<0.5	<0.5	<0.5	--
02/08/05 <sup>14</sup>	27.27	20.07	7.20	--	<50	<0.5	<0.5	<0.5	<0.5	<0.5	--
06/03/05 <sup>14</sup>	27.27	19.66	7.61	--	<50	<0.5	<0.5	<0.5	<0.5	<0.5	--
08/05/05 <sup>14</sup>	27.27	17.83	9.44	--	<50	<0.5	<0.5	<0.5	<0.5	<0.5	--
12/02/05 <sup>14</sup>	27.27	18.92	8.35	--	<50	<0.5	<0.5	<0.5	<0.5	<0.5	--
03/03/06 <sup>14</sup>	27.27	20.82	6.45	--	<50	<0.5	<0.5	<0.5	<0.5	<0.5	--
05/31/06 <sup>14</sup>	27.27	19.76	7.51	--	<50	<0.5	<0.5	<0.5	<0.5	<0.5	--
<b>TRIP BLANK</b>											
05/27/93	--	--	--	--	<50	<0.5	<0.5	<0.5	<1.5	--	--
08/18/93	--	--	--	1,400	<50	<0.5	<0.5	<0.5	<1.5	--	<5,000
11/03/93	--	--	--	--	<50	<0.5	<0.5	<0.5	<0.5	--	--
02/10/94	--	--	--	<50	<50	<0.5	<0.5	<0.5	<0.5	--	--
05/12/94	--	--	--	84	<50	<0.5	<0.5	<0.5	<0.5	--	--
08/26/94	--	--	--	--	<50	<0.5	<0.5	<0.5	<0.5	--	--
11/14/94	--	--	--	--	<50	<0.5	<0.5	<0.5	<0.5	--	--
02/01/95	--	--	--	--	<50	<0.5	<0.5	<0.5	<0.5	--	--
05/12/95	--	--	--	--	<50	<0.5	<0.5	<0.5	<0.5	--	--
08/22/95	--	--	--	--	<50	<0.5	<0.5	<0.5	<0.5	--	--
12/19/95	--	--	--	--	<50	<0.5	<0.5	<0.5	<0.5	<2.5	--
01/31/96	--	--	--	--	<50	<0.5	<0.5	<0.5	<0.5	<2.5	--
04/30/96	--	--	--	--	<50	<0.5	<0.5	<0.5	<0.5	<2.5	--
08/01/96	--	--	--	--	<50	<0.5	<0.5	<0.5	<0.5	<2.5	--
10/30/96	--	--	--	--	<50	<0.5	<0.5	<0.5	<0.5	<2.5	--
02/07/97	--	--	--	--	<50	<0.5	<0.5	<0.5	<0.5	<2.5	--
05/07/97	--	--	--	--	<50	<0.5	<0.5	<0.5	<0.5	<2.5	--
07/22/97	--	--	--	--	<50	<0.5	<0.5	<0.5	<0.5	<2.5	--
01/28/98	--	--	--	--	<50	<0.5	<0.5	<0.5	<0.5	--/ <2.0 <sup>12</sup>	--
05/08/98	--	--	--	--	--	--	--	--	--	--/ <2.0 <sup>12</sup>	--



Page 1  
**Groundwater Monitoring Data and Analytical Results**  
 Former Chevron Service Station #9-4612  
 3616 San Leandro Street  
 Oakland, California

WELL ID/ DATE	TOC* ( <i>µ</i> L)	GWE (msl)	DTW (ft.)	TPH-D (ppb)	TPH-G (ppb)	B (ppb)	T (ppb)	E (ppb)	X (ppb)	MTBE (ppb)	TOG (ppb)
<b>TRIP BLANK (cont)</b>											
07/29/98	--	--	--	--	<50	<0.5	<0.5	<0.5	<0.5	--/ <2.0 <sup>12</sup>	--
11/06/98	--	--	--	--	<50	<0.5	<0.5	<0.5	<0.5	<2.5	--
02/09/99	--	--	--	--	<50	<0.5	<0.5	<0.5	<0.5	<2.0	--
05/13/99	--	--	--	--	<50	<0.5	<0.5	<0.5	<0.5	<5.0/ <2.0 <sup>12</sup>	--
09/07/99	--	--	--	--	<50	<0.5	<0.5	<0.5	<0.5	<2.0	--
11/24/99	--	--	--	--	<50	<0.5	<0.5	<0.5	<0.5	<2.5	--
02/25/00	--	--	--	--	<50	<0.5	<0.5	<0.5	<0.5	<5.0	--
03/01/00	--	--	--	--	<50	<0.5	<0.5	<0.5	<0.5	<2.5	--
05/10/00	--	--	--	--	<50	<0.50	<0.50	<0.50	<0.50	<2.5	--
07/31/00	--	--	--	--	<50	<0.50	<0.50	<0.50	<0.50	<2.5	--
10/30/00	--	--	--	--	<50.0	<0.500	<0.500	<0.500	<1.50	<2.50	--
02/05/01	--	--	--	--	<50.0	<0.500	<0.500	<0.500	<0.500	<2.50	--
05/07/01	--	--	--	--	<50	<0.50	<0.50	<0.50	<0.50	<2.5	--
05/10/01	--	--	--	--	<50	<0.50	<0.50	<0.50	<0.50	<2.5	--
08/06/01	--	--	--	--	<50	<0.50	<0.50	<0.50	<0.50	<2.5	--
<b>QA</b>											
11/12/01	--	--	--	--	<50	<0.50	<0.50	<0.50	<1.5	<2.5	--
02/11/02	--	--	--	--	<50	<0.50	<0.50	<0.50	<1.5	<2.5	--
05/13/02	--	--	--	--	<50	<0.50	<0.50	<0.50	<1.5	<2.5	--
08/09/02	--	--	--	--	<50	<0.50	<0.50	<0.50	<1.5	<2.5	--
11/07/02	--	--	--	--	<50	<0.50	<0.50	<0.50	<1.5	<2.5	--
02/04/03	--	--	--	--	<50	<0.50	<0.50	<0.50	<1.5	<2.5	--
05/05/03	--	--	--	--	<50	<0.5	<0.5	<0.5	<1.5	<2.5	--
09/06/03 <sup>14</sup>	--	--	--	--	<50	<0.5	<0.5	<0.5	<0.5	<0.5	--
11/14/03 <sup>14</sup>	--	--	--	--	<50	<0.5	<0.5	<0.5	<0.5	<0.5	--
02/13/04 <sup>14</sup>	--	--	--	--	<50	<0.5	<0.5	<0.5	<0.5	<0.5	--
05/13/04 <sup>14</sup>	--	--	--	--	<50	<0.5	<0.5	<0.5	<0.5	<0.5	--
08/17/04 <sup>14</sup>	--	--	--	--	<50	<0.5	<0.5	<0.5	<0.5	<0.5	--
11/10/04 <sup>14</sup>	--	--	--	--	<50	<0.5	<0.5	<0.5	<0.5	<0.5	--
02/08/05 <sup>14</sup>	--	--	--	--	<50	<0.5	<0.5	<0.5	<0.5	<0.5	--
06/03/05 <sup>14</sup>	--	--	--	--	<50	<0.5	<0.5	<0.5	<0.5	<0.5	--
08/05/05 <sup>14</sup>	--	--	--	--	<50	<0.5	<0.5	<0.5	<0.5	<0.5	--
12/02/05 <sup>14</sup>	--	--	--	--	<50	<0.5	<0.5	<0.5	<0.5	<0.5	--
03/03/06 <sup>14</sup>	--	--	--	--	<50	<0.5	<0.5	<0.5	<0.5	<0.5	--
05/31/06 <sup>14</sup>	--	--	--	--	<50	<0.5	<0.5	<0.5	<0.5	<0.5	--

Table 1  
**Groundwater Monitoring Data and Analytical Results**  
Former Chevron Service Station #9-4612  
3616 San Leandro Street  
Oakland, California

---

**EXPLANATIONS:**

Groundwater monitoring data and laboratory analytical results prior to May 10, 2000, were compiled from reports prepared by Blaine Tech Services, Inc.

TOC = Top of Casing

(ft.) = Feet

GWE = Groundwater Elevation

(msl) = Mean sea level

DTW = Depth to Water

TPH-D = Total Petroleum Hydrocarbons as Diesel

TPH-G = Total Petroleum Hydrocarbons as Gasoline

B = Benzene

T = Toluene

E = Ethylbenzene

X = Xylenes

MTBE = Methyl tertiary butyl ether

TOG = Total Oil and Grease

(ppb) = Parts per billion

-- = Not Measured/Not Analyzed

QA = Quality Assurance/Trip Blank

- \* TOC elevations were re-surveyed on March 8, 2001, by Virgil Chavez Land Surveying. The benchmark for the survey was a City of Oakland benchmark, being a cut square top of curb at the centerline return at the northwest corner of East 14th and 37th Avenue, (Benchmark Elevation = 38.21 feet, NGVD 29).
- 1 Lab could not get a good ion chromatogram match for MTBE. See laboratory report.
- 2 Chromatogram pattern indicates an unidentified hydrocarbon.
- 3 No value for MTBE could be determined; see lab report for analyses.
- 4 Confirmation run.
- 5 ORC was installed.
- 6 Laboratory report indicates gasoline C6-C12.
- 7 Laboratory report indicates unidentified hydrocarbons <C16.
- 8 Laboratory report indicates gasoline C6-C12 + unidentified hydrocarbons <C6.
- 9 Laboratory report indicates unidentified hydrocarbons >C16.
- 10 Laboratory report indicates hydrocarbon pattern present in the requested fuel quantitation range but does not resemble the pattern of the requested fuel.
- 11 ORC in well.
- 12 MTBE by EPA Method 8260.
- 13 Laboratory report indicates unidentified hydrocarbons C9-C17.
- 14 BTEX and MTBE by EPA Method 8260.
- 15 ORC removed from well.
- 16 Laboratory report indicates the observed sample pattern is not typical of #2 fuel/diesel. It elutes in the DRO range earlier and later than #2 fuel.
- 17 Laboratory report indicates the observed sample pattern is not typical of #2 fuel/diesel. It elutes in the DRO range earlier than #2 fuel.
- 18 No Purge, unable to access well with truck.

**Table 2**  
**Dissolved Oxygen Concentrations**  
Former Chevron Service Station #9-4612  
3616 San Leandro Street  
Oakland, California

WELL ID	DATE	Before Purging (mg/L)	After Purging (mg/L)
VH-1	05/10/00	0.90	--
	07/31/00	1.25	--
	10/30/00	1.97	--
	05/07/01	1.10	--
	08/06/01	1.40	--
	11/12/01	0.90	--
	02/11/02	1.10	--
	05/13/02	0.70	--
MW-2	05/10/00	0.57	--
	07/31/00	1.26	--
	10/30/00	1.25	--
	05/07/01	0.90	--
	08/06/01	1.10	--
	11/12/01	0.80	--
	02/11/02	0.60	--
	05/13/02	0.80	--
MW-3	05/10/00	1.56	--
	07/31/00	1.46	--
	10/30/00	1.18	--
	05/07/01	0.70	--
	08/06/01	0.90	--
	11/12/01	0.50	--
	02/11/02	0.80	--
	05/13/02	1.80	--
MW-4	05/10/00	INACCESSIBLE - CAR PARKED OVER WELL	--
	07/31/00	0.64	--
	10/30/00	0.97	--
	02/05/01	INACCESSIBLE - CAR PARKED OVER WELL	--
	05/07/01	0.50	--
	08/06/01	0.70	--
	11/12/01	1.00	--
	02/11/02	1.00	--
05/13/02	2.90	--	

**EXPLANATIONS:**

(mg/L.) = Milligrams per liter

-- = Not Measured

Page 3  
**Groundwater Analytical Results - Oxygenate Compounds**  
 Former Chevron Service Station #9-4612  
 3616 San Leandro Street  
 Oakland, California

WELL ID	DATE	ETHANOL (ppb)	TBA (ppb)	MTBE (ppb)	DIPE (ppb)	ETBE (ppb)	TAME (ppb)
VH-1	02/05/01	<500	<50	160	<2.0	<2.0	<2.0
	05/07/01	--	--	110	--	--	--
	08/06/01	--	--	140	--	--	--
	11/12/01	--	--	61	--	--	--
	02/11/02	--	--	52	--	--	--
	05/13/02	--	--	80	--	--	--
	08/09/02	--	--	89	--	--	--
	11/07/02	--	--	50	--	--	--
	02/04/03	--	--	53	--	--	--
	05/05/03	--	--	62	--	--	--
	09/06/03	--	--	59	--	--	--
	11/14/03	--	--	47	--	--	--
	02/13/04	--	--	47	--	--	--
	05/13/04	--	--	74	--	--	--
	08/17/04	--	--	58	--	--	--
	11/10/04	INACCESSIBLE	--	--	--	--	--
	02/08/05	--	--	48	--	--	--
	06/03/05	--	--	45	--	--	--
	08/05/05	--	--	46	--	--	--
	12/02/05	--	--	57	--	--	--
03/03/06	--	--	40	--	--	--	
05/31/06	--	--	34	--	--	--	
MW-2	02/05/01	<500	<50	140	<2.0	<2.0	<2.0
	05/07/01	--	--	88	--	--	--
	08/06/01	--	--	110	--	--	--
	11/12/01	--	--	98	--	--	--
	02/11/02	--	--	86	--	--	--
	05/13/02	--	--	47	--	--	--
	08/09/02	--	--	69	--	--	--
	11/07/02	--	--	69	--	--	--
	02/04/03	--	--	55	--	--	--
	05/05/03	--	--	31	--	--	--
	09/06/03	--	--	54	--	--	--
	11/14/03	--	--	55	--	--	--
	02/13/04	--	--	31	--	--	--

T 3  
 Groundwater Analytical Results - Oxygenate Compounds  
 Former Chevron Service Station #9-4612  
 3616 San Leandro Street  
 Oakland, California

WELL ID	DATE	ETHANOL (ppb)	TBA (ppb)	MTBE (ppb)	DIPE (ppb)	ETBE (ppb)	TAME (ppb)
MW-2 (cont)	05/13/04	--	--	34	--	--	--
	08/17/04	--	--	46	--	--	--
	11/10/04	--	--	37	--	--	--
	02/08/05	--	--	22	--	--	--
	06/03/05	--	--	23	--	--	--
	08/05/05	--	--	23	--	--	--
	12/02/05	--	--	24	--	--	--
	03/03/06	--	--	9	--	--	--
	05/31/06	--	--	8	--	--	--
MW-3	02/05/01	<500	<50	70	<2.0	<2.0	<2.0
	05/07/01	--	--	49	--	--	--
	08/06/01	--	--	43	--	--	--
	11/12/01	--	--	46	--	--	--
	02/11/02	--	--	42	--	--	--
	05/13/02	--	--	32	--	--	--
	08/09/02	--	--	33	--	--	--
	11/07/02	--	--	37	--	--	--
	02/04/03	--	--	24	--	--	--
	05/05/03	--	--	19	--	--	--
	09/06/03	--	--	28	--	--	--
	11/14/03	--	--	30	--	--	--
	02/13/04	--	--	21	--	--	--
	05/13/04	--	--	20	--	--	--
	08/17/04	--	--	25	--	--	--
	11/10/04	--	--	27	--	--	--
	02/08/05	--	--	11	--	--	--
	06/03/05	--	--	9	--	--	--
	08/05/05	--	--	9	--	--	--
	12/02/05	--	--	7	--	--	--
03/03/06	--	--	4	--	--	--	
05/31/06	--	--	4	--	--	--	
MW-4	05/07/01	--	--	<2.0	--	--	--
	08/06/01	--	--	<2.0	--	--	--

T 13  
**Groundwater Analytical Results - Oxygenate Compounds**  
 Former Chevron Service Station #9-4612  
 3616 San Leandro Street  
 Oakland, California

WELL ID	DATE	ETHANOL (ppb)	TBA (ppb)	MTBE (ppb)	DIPE (ppb)	ETBE (ppb)	TAME (ppb)
MW-4	11/12/01	--	--	<2	--	--	--
(cont)	02/11/02	--	--	<2	--	--	--
	05/13/02	--	--	<2	--	--	--
	08/09/02	--	--	<2	--	--	--
	11/07/02	--	--	<2	--	--	--
	02/04/03	--	--	<0.5	--	--	--
	05/05/03	--	--	<0.5	--	--	--
	09/06/03	--	--	<0.5	--	--	--
	11/14/03	--	--	<0.5	--	--	--
	02/13/04	--	--	<0.5	--	--	--
	05/13/04	--	--	<0.5	--	--	--
	08/17/04	--	--	<0.5	--	--	--
	11/10/04	--	--	<0.5	--	--	--
	02/08/05	--	--	<0.5	--	--	--
	06/03/05	--	--	<0.5	--	--	--
	08/05/05	--	--	<0.5	--	--	--
	12/02/05	--	--	<0.5	--	--	--
	03/03/06	--	--	<0.5	--	--	--
	05/31/06	--	--	<0.5	--	--	--

T-3  
Groundwater Analytical Data - Oxygenate Compounds  
Former Chevron Service Station #9-4612  
3616 San Leandro Street  
Oakland, California

---

**EXPLANATIONS:**

TBA = Tertiary butyl alcohol  
MTBE = Methyl tertiary butyl ether  
DIPE = Di-isopropyl ether  
ETBE = Ethyl tertiary butyl ether  
TAME = Tertiary amyl methyl ether  
(ppb) = Parts per billion  
-- = Not Analyzed

**ANALYTICAL METHOD:**

EPA Method 8260 for Oxygenate Compounds