

**Chevron Environmental
Management Company**
6001 Bollinger Canyon Rd, K2236
P.O. Box 6012
San Ramon, CA 94583-2324
Tel 925-842-9559
Fax 925-842-8370

Dana Thurman
Project Manager

ChevronTexaco

September 26, 2005

Alameda County Health Care Services
1131 Harbor Bay Parkway, Suite 250
Alameda, CA 94502-6577

Re: Chevron Service Station #9-4612

Address: 3616 San Leandro Street, Oakland, California

I have reviewed the attached routine groundwater monitoring report dated September 7, 2005.

I agree with the conclusions and recommendations presented in the referenced report. The information in this report is accurate to the best of my knowledge and all local Agency/Regional Board guidelines have been followed. This report was prepared by Gettler-Ryan, Inc., upon whose assistance and advice I have relied.

This letter is submitted pursuant to the requirements of California Water Code Section 13267(b)(1) and the regulating implementation entitled Appendix A pertaining thereto.

I declare under penalty of perjury that the foregoing is true and correct.

Sincerely,



Dana Thurman
Project Manager

Enclosure: Report



GETTLER-RYAN Inc.

TRANSMITTAL

September 7, 2005
G-R #386473

TO: Mr. Bruce H. Eppler
Cambria Environmental Technology, Inc.
4111 Citrus Avenue, Suite 12
Rocklin, California 95677

FROM: Deanna L. Harding
Project Coordinator
Gettler-Ryan Inc.
6747 Sierra Court, Suite J
Dublin, California 94568

RE: **Former Chevron Service Station
#9-4612
3616 San Leandro Street
Oakland, California
MTI: 61H-1996
RO 0000233**

WE HAVE ENCLOSED THE FOLLOWING:

COPIES	DATED	DESCRIPTION
2	September 7, 2005	Groundwater Monitoring and Sampling Report Third Quarter - Event of August 5, 2005

COMMENTS:

Pursuant to your request, we are providing you with copies of the above referenced report for **your use and distribution to the following:**

Mr. Dana Thurman, ChevronTexaco Company, P.O. Box 6012, Room K2236, San Ramon, CA 94583

Please provide any comments/changes and propose any groundwater monitoring modifications for the next event prior to **September 23, 2005**, at which time the final report will be distributed to the following:

cc: Mr. Barney Chan, Alameda County Health Care Services, Dept. of Environmental Health, 1131 Harbor Bay Parkway, Suite 250, Alameda, CA 94502-6577
Mr. Leonard B. Ratto, Ratto Land Company, P.O. Box 6104, Oakland, CA 94603-0104
Mr. Terry McIlraith, 407 Castello Road, Lafayette, CA 94549

Enclosures



GETTLER - RYAN INC.

September 7, 2005
G-R Job #386473

Mr. Dana Thurman
ChevronTexaco Company
P.O. Box 6012, Room K2236
San Ramon, CA 94583

RE: Third Quarter Event of August 5, 2005
Groundwater Monitoring & Sampling Report
Former Chevron Service Station #9-4612
3616 San Leandro Street
Oakland, California

Dear Mr. Thurman:

This report documents the most recent groundwater monitoring and sampling event performed by Gettler-Ryan Inc. (G-R) at the referenced site. All field work was conducted in accordance with G-R Standard Operating Procedure - Groundwater Sampling (attached).

Static groundwater levels were measured and the wells were checked for the presence of separate-phase hydrocarbons. Static water level data, groundwater elevations, and separate-phase hydrocarbon thickness (if any) are presented in the attached Table 1. Dissolved Oxygen Concentrations are presented in Table 2. A Potentiometric Map is included as Figure 1.

Groundwater samples were collected from the monitoring wells and submitted to a state certified laboratory for analyses. The field data sheets for this event are attached. Analytical results are presented in the table(s) listed below. The chain of custody document and laboratory analytical report are also attached.

Please call if you have any questions or comments regarding this report. Thank you.

Sincerely,

Deanna L. Harding
Deanna L. Harding
Project Coordinator

Hagop Kevork
Hagop Kevork
P.E. No. C55734



Hagop Kevork
P.E. No. C55734

Figure 1: Potentiometric Map
Table 1: Groundwater Monitoring Data and Analytical Results
Table 2: Dissolved Oxygen Concentrations
Table 3: Groundwater Analytical Results - Oxygenate Compounds
Attachments: Standard Operating Procedure - Groundwater Sampling
Field Data Sheets
Chain of Custody Document and Laboratory Analytical Reports

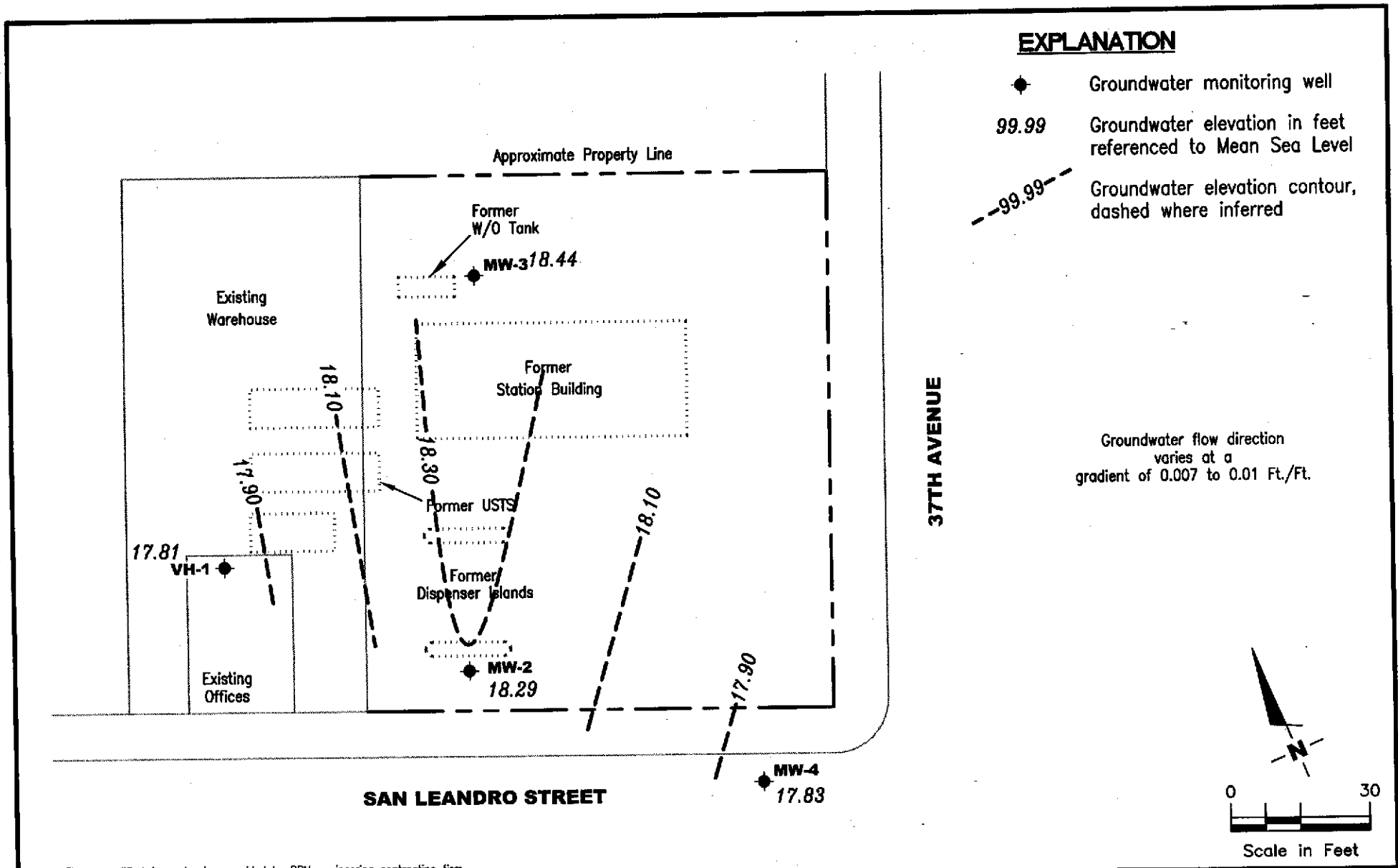

Source: Figure modified from drawing provided by RRM engineering contracting firm.

GETTLER - RYAN INC.
 6747 Sierra Court, Suite J
 Dublin, CA 94568 (925) 551-7555

POTENTIOMETRIC MAP
 Former Chevron Service Station #9-4612
 3616 San Leandro Street
 Oakland, California

FIGURE

1

PROJECT NUMBER
 386473

REVIEWED BY

DATE
 August 5, 2005

REVISED DATE

Table 1
Groundwater Monitoring Data and Analytical Results
Former Chevron Service Station #9-4612
3616 San Leandro Street
Oakland, California

WELL ID/ DATE	TOC* (%)	GWE (mst)	DTW (ft.)	TPH-D (ppb)	TPH-G (ppb)	B (ppb)	T (ppb)	E (ppb)	X (ppb)	MTBE (ppb)	TOG (ppb)
VH-1											
08/10/88	--	--	13.00	--	11,000	3,300	200	520	540	--	--
06/01/89	--	--	10.32	--	15,000	2,200	120	540	310	--	--
09/15/89	--	--	15.69	--	5,600	1,900	90	350	160	--	--
12/08/89	--	--	14.77	--	11,000	1,900	69	270	99	--	--
03/07/91	--	--	11.26	--	4,500	820	39	120	77	--	--
09/24/91	--	--	12.98	--	3,300	520	19	39	27	--	--
01/08/92	--	--	13.77	--	5,000	600	34	81	76	--	--
04/20/92	--	--	8.18	--	7,400	670	60	110	140	--	--
03/26/93	27.85	21.14	6.71	--	4,900	600	40	72	94	--	--
05/27/93	27.85	19.27	8.58	--	13,000	1,600	120	230	220	--	--
08/18/93	27.85	17.39	10.46	--	2,700	210	10	8.1	18	--	--
11/03/93	27.85	15.28	12.57	--	4,600	680	42	35	68	--	--
02/10/94	27.85	18.77	9.08	--	1,900	260	19	22	29	--	--
05/12/94	27.85	19.76	8.09	--	2,000	390	28	3.9	29	--	--
08/26/94	27.85	17.10	10.75	--	4,900	500	<5.0	23	31	--	--
11/14/94	27.85	18.40	9.45	300	760	69	<2.0	<2.0	2.2	--	--
02/01/95	27.85	21.88	5.97	--	1,300	120	5.9	<0.5	13	--	--
05/12/95	27.85	20.14	7.71	--	4,400	460	31	45	49	--	--
08/22/95	27.85	18.59	9.26	--	2,900	310	15	28	32	--	--
12/19/95	27.85	19.05	8.80	--	930	53	<2.5	<2.5	<2.5	39	--
01/31/96	27.85	22.35	5.50	--	3,700	320	<10	41	40	180	--
04/30/96	27.85	19.81	8.04	--	3,900	270	<20	<20	<20	120	--
08/01/96	27.85	18.67	9.18	--	2,700	140	11	18	28	200	--
10/30/96	27.85	18.67	10.76	--	2,700	140	<12	<12	<12	280	--
02/07/97	27.85	19.75	8.10	--	220	13	0.6	<0.5	1.6	15	--
05/07/97	27.85	18.33	9.52	--	5,200	33	12	21	26	330	--
07/22/97	27.85	17.43	10.42	--	4,200	80	<10	16	24	400	--
11/03/97	27.85	16.85	11.00	--	2,400	150	6.8	6.5	9.5	510	--
01/28/98	27.85	20.75	7.10	--	850	69	4.8	5.0	11	38/48 ¹²	--
05/08/98	27.85	20.14	7.71	--	4,200	200	30	40	42	310/200 ¹²	--
07/29/98	27.85	18.40	9.45	--	3,800	54	10	27	30	35/290 ¹²	--
11/06/98	27.85	17.15	10.70	--	4,800	100	20	12	23	360/210 ¹²	--
02/09/99 ⁵	27.85	21.87	5.98	--	2,950	79.5	<10	<10	<10	435/312 ¹²	--
05/13/99	27.85	19.71	8.14	--	4,180	147	12.8	16.5	20.3	433/245 ¹²	--
09/07/99	27.85	17.94	9.91	--	2,750	57.6	<5.0	6.53	<5.0	297/233 ¹²	--

Table 1
Groundwater Monitoring Data and Analytical Results
Former Chevron Service Station #9-4612
3616 San Leandro Street
Oakland, California

WELL ID/ DATE	TOC* (ft.)	GWE (mst)	DTW (ft.)	TPH-D (ppb)	TPH-G (ppb)	B (ppb)	T (ppb)	E (ppb)	X (ppb)	MTBE (ppb)	TOG (ppb)
VH-1 (cont)											
11/24/99	27.85	17.36	10.49	--	2,550	38	3.18	2.54	5.21	--/216 ^{1,12}	--
02/25/00	27.85	21.20	6.65	--	120	2.7	<0.5	<0.5	<0.5	20.5/11.9 ¹²	--
05/10/00	27.85	19.76	8.09	--	1,400 ⁸	63	3.3	3.1	4.9	230/110 ¹²	--
7/31/00 ¹¹	27.85	18.30	9.55	--	360 ⁸	22	2.7	1.6	3.1	100/88 ¹²	--
10/30/00 ¹¹	27.85	17.91	9.94	--	987 ¹⁰	47.0	1.00	<0.500	1.80	153/130 ¹²	--
02/05/01	27.91	19.23	8.68	--	2,670	42.7	<5.00	<5.00	<5.00	225/160 ¹²	--
05/07/01 ¹¹	27.91	19.61	8.30	--	1,800 ⁶	100	8.2	10	7.9	440/110 ¹²	--
08/06/01 ¹¹	27.91	18.09	9.82	--	1,000 ⁶	67	6.1	2.1	7.1	270/140 ¹²	--
11/12/01 ¹¹	27.91	17.29	10.62	--	220	1.2	<0.50	<0.50	<1.5	63/61 ¹²	--
02/11/02 ¹¹	27.91	19.83	8.08	--	1,700	33	<5.0	6.3	3.8	64/52 ¹²	--
05/13/02 ¹¹	27.91	19.21	8.70	--	2,700	54	4.1	5.6	6.2	100/80 ¹²	--
08/09/02 ¹¹	27.91	18.50	9.41	--	2,400	37	2.4	1.2	3.4	86/89 ¹²	--
11/07/02 ¹¹	27.91	17.34	10.57	--	150	1.3	<0.50	<0.50	<1.5	56/50 ¹²	--
02/04/03 ¹¹	27.91	19.63	8.28	--	1,700	40	3.1	7.8	5.0	100/53 ¹²	--
05/05/03 ¹¹	27.91	20.41	7.50	--	2,100	44	3.4	3.7	5.2	96/62 ¹²	--
09/06/03 ^{11,14}	27.91	18.31	9.60	--	690	7	0.6	<0.5	0.6	59	--
11/14/03 ^{11,14}	27.91	17.99	9.92	--	1,000	3	0.6	2	0.7	47	--
02/13/04 ^{14,15}	27.91	19.98	7.93	--	2,400	30	2	4	3	47	--
05/13/04 ¹⁴	27.91	19.24	8.67	--	1,900	49	4	3	5	74	--
08/17/04 ¹⁴	27.91	18.26	9.65	--	1,800	11	1	0.9	2	58	--
11/10/04	27.91	INACCESSIBLE	--	--	--	--	--	--	--	--	--
02/08/05 ¹⁴	27.91	20.08	7.83	--	2,700	26	3	4	5	48	--
06/03/05 ¹⁴	27.91	19.71	8.20	--	3,100	40	5	6	9	45	--
08/05/05 ¹⁴	27.91	17.81	10.10	--	2,500	34	4	0.6	6	46	--
MW-2											
02/16/93	27.51	--	--	--	9,200	720	110	250	170	--	--
03/26/93	27.51	19.89	7.62	--	--	--	--	--	--	--	--
05/27/93	27.51	18.04	9.47	--	360	5.3	2.1	1.8	2.5	--	--
08/18/93	27.51	16.46	11.05	--	9,400	1,100	76	110	100	--	--
11/03/93	27.51	14.56	12.95	--	8,600	390	20	2.7	120	--	--
02/10/94	27.51	17.72	9.79	--	2,700	370	38	44	41	--	--
05/12/94	27.51	18.59	8.92	--	3,800	650	76	15	62	--	--
08/26/94	27.51	16.14	11.37	--	16,000	1,300	270	28	120	--	--

Table 1
Groundwater Monitoring Data and Analytical Results
Former Chevron Service Station #9-4612
3616 San Leandro Street
Oakland, California

WELL ID/ DATE	TOC* (%)	GWE (mst)	DTW (ft.)	TPH-D (ppb)	TPH-G (ppb)	B (ppb)	T (ppb)	E (ppb)	X (ppb)	MTBE (ppb)	TOG (ppb)
MW-2 (cont)											
11/14/94	27.51	17.48	10.03	--	5,100	390	10	43	27	--	--
02/01/95	27.51	20.47	7.04	--	6,900	520	82	170	110	--	--
05/12/95	27.51	18.76	8.75	--	7,700	510	83	110	100	--	--
08/22/95	27.51	17.35	10.16	--	4,500	220	16	61	47	--	--
12/19/95	27.51	18.05	9.46	--	2,900	240	<10	19	18	220	--
01/31/96	27.51	21.91	5.60	--	3,900	320	18	72	39	<25	--
04/30/96	27.51	18.68	8.83	--	5,600	200	36	55	47	170	--
08/01/96	27.51	17.25	10.26	--	6,200	190	15	62	59	220	--
10/30/96	27.51	17.25	11.48	--	5,700	190	<25	67	36	260	--
02/07/97	27.51	18.11	9.40	--	8,300	210	34	70	59	330	--
05/07/97	27.51	17.57	9.94	--	6,900	190	12	38	37	530	--
07/22/97	27.51	16.36	11.15	--	10,000	18	25	62	41	630	--
11/03/97	27.51	15.93	11.58	--	6,500	260	8.5	26	14	590/9.6 ^{4,12}	--
01/28/98	27.51	19.38	8.13	--	6,700	65	13	67	54	280/94 ¹²	--
05/08/98	27.51	18.89	8.62	--	5,500	91	38	43	61	220/62 ¹²	--
07/29/98	27.51	17.06	10.45	--	3,600	41	8.9	3.6	14	16/94 ¹²	--
11/06/98	27.51	15.89	11.62	--	6,900	77	<5.0	14	17	290/110 ¹²	--
02/09/99 ⁵	27.51	20.61	6.90	--	8,070	75.6	<10	<10	<10	397/144 ¹²	--
05/13/99	27.51	18.21	9.30	--	5,890	120	<5.0	12.5	26.6	401/69.4 ¹²	--
09/07/99	27.51	16.57	10.94	--	5,820	41.2	<5.0	14.6	<5.0	260/145 ¹²	--
11/24/99	27.51	15.98	11.53	--	5,940	40.9	<10	10.8	<10	--/120 ^{1,12}	--
02/25/00	27.51	21.00	6.51	--	6,370	101	9.37	39.8	33.2	321/121 ¹²	--
05/10/00	27.51	18.49	9.02	--	6,100 ⁸	110	13	27	31	560/120 ¹²	--
07/31/00 ¹¹	27.51	17.18	10.33	--	3,000 ⁸	75	14	28	28	200/130 ¹²	--
10/30/00 ¹¹	27.51	16.95	10.56	--	6,810 ¹⁰	162	<5.00	8.05	<15.0	372/140 ¹²	--
02/05/01 ¹¹	28.05	18.47	9.58	--	5,860	28.4	6.86	16.2	11.8	285/140 ¹²	--
05/07/01 ¹¹	28.05	18.85	9.20	--	4,700 ⁶	120	15	30	42	540/88 ¹²	--
08/06/01 ¹¹	28.05	17.31	10.74	--	3,700 ⁶	120	<20	28	33	490/110 ¹²	--
11/12/01 ¹¹	28.05	16.60	11.45	--	7,000	29	<10	27	22	93/98 ¹²	--
02/11/02 ¹¹	28.05	18.99	9.06	--	5,900	43	15	24	27	90/86 ¹²	--
05/13/02 ¹¹	28.05	18.41	9.64	--	5,500	26	5.2	23	26	120/47 ¹²	--
08/09/02 ¹¹	28.05	17.76	10.29	--	5,700	26	3.7	26	50	100/69 ¹²	--
11/07/02 ¹¹	28.05	16.78	11.27	--	5,900	33	4.4	23	21	<100/69 ¹²	--
02/04/03 ¹¹	28.05	18.92	9.13	--	5,400	22	4.7	13	14	<50/55 ¹²	--
05/05/03 ¹¹	28.05	19.67	8.38	--	4,500	23	4.7	12	15	<50/31 ¹²	--

Table 1
Groundwater Monitoring Data and Analytical Results
Former Chevron Service Station #9-4612
3616 San Leandro Street
Oakland, California

WELL ID/ DATE	TOC* (ft.)	GWE (msl)	DTW (ft.)	TPH-D (ppb)	TPH-G (ppb)	B (ppb)	T (ppb)	E (ppb)	X (ppb)	MTBE (ppb)	TOG (ppb)
MW-2 (cont)											
09/06/03 ^{11,14}	28.05	17.65	10.40	--	3,200	13	2	7	7	54	--
11/14/03 ^{11,14}	28.05	17.43	10.62	--	4,000	11	2	7	6	55	--
02/13/04 ^{14,15}	28.05	19.26	8.79	--	6,200	6	2	8	8	31	--
05/13/04 ¹⁴	28.05	18.49	9.56	--	3,200	6	3	13	11	34	--
08/17/04 ¹⁴	28.05	17.57	10.48	--	4,300	7	1	6	5	46	--
11/10/04 ¹⁴	28.05	18.52	9.53	--	3,000	5	1	6	7	37	--
02/08/05 ¹⁴	28.05	19.34	8.71	--	4,700	3	2	10	8	22	--
06/03/05 ¹⁴	28.05	19.04	9.01	--	4,100	4	3	15	11	23	--
08/05/05 ¹⁴	28.05	18.29	9.76	--	3,500	4	1	<0.5	8	23	--
MW-3											
02/16/93	28.50	--	--	--	3,500	<0.5	8.1	4.6	7.7	--	--
03/26/93	28.50	21.32	7.18	--	--	--	--	--	--	--	--
05/27/93	28.50	19.17	9.33	--	4,200	580	84	150	100	--	--
08/18/93	28.50	16.50	12.00	1,400	910	12	3.7	6.2	3.8	--	<5,000
11/03/93	28.50	15.21	13.29	--	5,300	29	1.9	0.6	27	--	--
02/10/94	28.50	18.87	9.63	<50	63	<0.5	0.7	<0.5	<0.5	--	--
05/12/94	28.50	19.73	8.77	84	<50	<0.5	0.5	<0.5	<0.5	--	--
08/26/94	28.50	17.08	11.42	--	2,100	12	<0.5	5.0	0.5	--	--
11/14/94	28.50	18.43	10.07	--	140	0.78	<0.5	<0.5	<0.5	--	--
02/01/95	28.50	22.21	6.29	<50	<50	<0.5	<0.5	<0.5	<0.5	--	--
05/12/95	28.50	20.43	8.07	540 ²	330	13	1.1	1.9	0.69	--	--
08/22/95	28.50	18.55	9.95	550 ²	980	32	<1.0	<1.0	<1.0	--	--
12/19/95	28.50	19.10	9.40	<50	<50	<0.5	<0.5	<0.5	<0.5	<2.5	--
01/31/96	28.50	23.45	5.05	<50	<50	<0.5	<0.5	<0.5	<0.5	<2.5	--
04/30/96	28.50	20.10	8.40	240 ²	320	2.4	<0.5	0.75	<0.5	7.8	--
08/01/96	28.50	18.70	9.80	470 ²	980	9.6	<0.5	0.98	2.2	54	--
10/30/96	28.50	18.70	11.48	760 ²	2,000	14	<10	<10	<10	140	--
02/07/97	28.50	19.90	8.60	61 ²	200 ²	<0.5	<0.5	<0.5	<0.5	8.9	--
05/07/97	28.50	19.49	9.01	550 ²	3,500	14	3.9	3.6	8.0	160	--
07/22/97	28.50	17.38	11.12	800 ²	3,500	55	<10	<10	<10	150	--
11/03/97	28.50	16.99	11.51	910 ²	4,100	140	<5.0	<5.0	<5.0	380	--
01/28/98	28.50	21.16	7.34	--	1,100	24	<1.2	<1.2	2.8	33/6.1 ¹²	--
05/08/98	28.50	20.44	8.06	250 ²	990	3.6	7.7	0.7	2.2	37/7.5 ¹²	--

Table 1
Groundwater Monitoring Data and Analytical Results
Former Chevron Service Station #9-4612
3616 San Leandro Street
Oakland, California

WELL ID/ DATE	TOC* (ft.)	GWE (msl)	DTW (ft.)	TPH-D (ppb)	TPH-G (ppb)	B (ppb)	T (ppb)	E (ppb)	X (ppb)	MTBE (ppb)	TOG (ppb)
MW-3 (cont)											
07/29/98	28.50	18.25	10.25	290 ²	1,200	13	<0.5	<0.5	1.4	11/28 ¹²	--
11/06/98	28.50	17.11	11.39	390 ²	2,600	5.3	<2.5	<2.5	3.0	91/41 ¹²	--
02/09/99 ⁵	28.50	22.40	6.10	184 ²	406	<1.0	4.03	<1.0	<1.0	17.7/1.97 ¹²	--
05/13/99	28.50	19.38	9.12	--	615	13.8	1.05	<0.5	<0.5	43.5/21.2 ¹²	--
09/07/99	28.50	17.77	10.73	528 ²	2,710	<5.0	<5.0	<5.0	<5.0	96.3/57.9 ¹²	--
11/24/99	28.50	17.37	11.13	1,070 ²	5,530	<5.0	<5.0	5.59	<5.0	--/66 ^{1,12}	--
02/25/00	28.50	22.22	6.28	--	189	4.68	<0.5	<0.5	<0.5	11.9/<2.0 ¹²	--
03/01/00	28.50	21.80	6.70	380 ²	--	--	--	--	--	--	--
05/10/00	28.50	19.90	8.60	830 ⁷	1,600 ⁶	22	<10	<10	<10	100/51 ¹²	--
07/31/00 ¹¹	28.50	18.43	10.07	490 ⁷	2,200 ⁶	76	10	<5.0	13	230/52 ¹²	--
10/30/00 ¹¹	28.50	17.97	10.53	580 ⁹	3,320 ¹⁰	<5.00	<5.00	<5.00	<15.0	147/64 ¹²	--
02/05/01 ¹¹	29.04	19.78	9.26	--	3,960	<5.00	6.02	<5.00	<5.00	159/70 ¹²	--
05/07/01 ¹¹	29.04	20.29	8.75	--	2,800 ⁶	61	12	<10	20	230/49 ¹²	--
05/10/01 ¹¹	29.04	20.21	8.83	390 ¹³	--	--	--	--	--	--	--
08/06/01 ¹¹	29.04	18.59	10.45	870 ⁷	1,600 ⁶	39	14	1.3	5.6	130/43 ¹²	--
11/12/01 ¹¹	29.04	17.82	11.22	1,400	3,100	3.6	23	2.3	5.6	40/46 ¹²	--
02/11/02 ¹¹	29.04	20.66	8.38	700	4,000	10	<5.0	4.2	5.5	44/42 ¹²	--
05/13/02 ¹¹	29.04	19.84	9.20	730	2,500	18	<5.0	<5.0	5.2	44/32 ¹²	--
08/09/02 ¹¹	29.04	18.87	10.17	560	2,700	17	<5.0	<5.0	<10	45/33 ¹²	--
11/07/02 ¹¹	29.04	17.91	11.13	660	2,600	24	<5.0	2.0	4.8	51/37 ¹²	--
02/04/03 ¹¹	29.04	20.44	8.60	370	2,200	13	1.5	2.7	5.0	<50/24 ¹²	--
05/05/03 ¹¹	29.04	21.22	7.82	580	2,100	14	1.8	2.0	3.9	<20/19 ¹²	--
09/06/03 ^{11,14}	29.04	18.79	10.25	780	1,800	2	0.6	0.6	1	28	--
11/14/03 ^{11,14}	29.04	18.52	10.52	860	2,000	1	0.6	0.6	0.9	30	--
02/13/04 ^{14,15}	29.04	20.76	8.28	590	3,600	1	0.6	1	2	21	--
05/13/04 ¹⁴	29.04	19.87	9.17	670	1,600	1	<0.5	0.5	1	20	--
08/17/04 ¹⁴	29.04	18.79	10.25	900	2,500	1	<0.5	<0.5	0.7	25	--
11/10/04 ¹⁴	29.04	19.81	9.23	780	1,500	1	0.6	0.5	1	27	--
02/08/05 ¹⁴	29.04	20.92	8.12	530	2,500	1	0.6	2	3	11	--
06/03/05 ¹⁴	29.04	20.47	8.57	600	1,700	1	<0.5	0.7	1	9	--
08/05/05 ¹⁴	29.04	18.44	10.60	530 ¹⁶	980	0.6	<0.5	<0.5	0.8	9	--

MW-4

08/22/95	27.27	18.16	9.11	--	9,600	100	<10	<10	<10	--	--
----------	-------	-------	------	----	-------	-----	-----	-----	-----	----	----

Table 1
Groundwater Monitoring Data and Analytical Results
Former Chevron Service Station #9-4612
3616 San Leandro Street
Oakland, California

WELL ID/ DATE	TOC* (ft.)	GWE (msl)	DTW (ft.)	TPH-D (ppb)	TPH-G (ppb)	B (ppb)	T (ppb)	E (ppb)	X (ppb)	MTBE (ppb)	TOG (ppb)
MW-4 (cont)											
12/19/95	27.27	18.97	8.30	--	<50	<0.5	<0.5	<0.5	<0.5	<2.5	--
01/31/96	27.27	21.67	5.60	--	<50	<0.5	<0.5	<0.5	<0.5	<2.5	--
04/30/96	27.27	20.27	7.00	--	<50	<0.5	<0.5	<0.5	<0.5	<2.5	--
08/01/96	27.27	18.12	9.15	--	<50	<0.5	<0.5	<0.5	<0.5	--	--
10/30/96	27.27	18.12	10.74	--	110	<0.5	<0.5	<0.5	<0.5	<2.5	--
02/07/97	27.27	19.47	7.80	--	80	<0.5	<0.5	<0.5	<0.5	4.1	--
05/07/97	27.27	21.42	5.85	--	<50	<0.5	<0.5	<0.5	<0.5	<2.5	--
07/22/97	27.27	17.22	10.05	--	150	<0.5	<0.5	<0.5	<0.5	<2.5	--
11/03/97	27.27	16.55	10.72	--	52	0.9	<0.5	<0.5	<0.5	-- ³	--
01/28/98	27.27	20.76	6.51	--	<50	<0.5	<0.5	<0.5	<0.5	<2.5/<2.0 ¹²	--
05/08/98	27.27	20.25	7.02	--	56	<0.5	<0.5	<0.5	<0.5	<2.5/<2.0 ¹²	--
07/29/98	27.27	18.32	8.95	--	<50	0.9	<0.5	<0.5	<0.5	<2.5/<2.0 ¹²	--
11/06/98	27.27	16.68	10.59	--	72	<0.5	<0.5	<0.5	<0.5	<2.5/<2.0 ¹²	--
02/09/99	27.27	21.41	5.86	--	<50	<0.5	<0.5	<0.5	<0.5	<2.0/<1.1 ¹²	--
05/13/99	27.27	19.32	7.95	--	<50	<0.5	<0.5	<0.5	<0.5	<5.0/<2.0 ¹²	--
09/07/99	27.27	17.79	9.48	--	70.2	<0.5	<0.5	<0.5	<0.5	<2.0/<1.0 ¹²	--
11/24/99	27.27	17.22	10.05	--	227	<0.5	<0.5	<0.5	<0.5	--/<0.5 ¹²	--
02/25/00	27.27	INACCESSIBLE	--	--	--	--	--	--	--	--	--
03/01/00	27.27	21.10	6.17	--	<50	<0.5	<0.5	<0.5	<0.5	<2.5/<2.0 ¹²	--
05/10/00	27.27	INACCESSIBLE - CAR PARKED OVER WELL	--	--	--	--	--	--	--	--	--
07/31/00	27.27	17.90	9.37	--	<50	<0.50	<0.50	<0.50	<0.50	<2.5/<2.0 ¹²	--
10/30/00	27.27	17.80	9.47	--	54.0 ¹⁰	<0.500	<0.500	<0.500	<1.50	<2.50/<2.0 ¹²	--
02/05/01	27.27	INACCESSIBLE - CAR PARKED OVER WELL	--	--	--	--	--	--	--	--	--
05/07/01	27.27	19.46	7.81	--	<50	<0.50	<0.50	<0.50	<0.50	<2.5/<2.0 ¹²	--
08/06/01	27.27	17.49	9.78	--	<50	1.1	0.52	<0.50	1.1	6.0/<2.0 ¹²	--
11/12/01	27.27	16.86	10.41	--	93	<0.50	<0.50	<0.50	<1.5	<2.5/<2 ¹²	--
02/11/02	27.27	19.63	7.64	--	<50	<0.50	<0.50	<0.50	<1.5	<2.5/<2 ¹²	--
05/13/02	27.27	18.95	8.32	--	54	<0.50	0.84	<0.50	<1.5	<2.5/<2 ¹²	--
08/09/02	27.27	18.02	9.25	--	54	<0.50	<0.50	<0.50	<1.5	<2.5/<2 ¹²	--
11/07/02	27.27	16.85	10.42	--	<50	<0.50	<0.50	<0.50	<1.5	<2.5/<2 ¹²	--
02/04/03	27.27	19.52	7.75	--	<50	<0.50	<0.50	<0.50	<1.5	<2.5/<0.5 ¹²	--
05/05/03	27.27	20.37	6.90	--	<50	<0.5	<0.5	<0.5	<1.5	<2.5/<0.5 ¹²	--
09/06/03 ¹⁴	27.27	17.77	9.50	--	<50	<0.5	<0.5	<0.5	<0.5	<0.5	--
11/14/03 ¹⁴	27.27	17.47	9.80	--	<50	<0.5	<0.5	<0.5	<0.5	<0.5	--
02/13/04 ¹⁴	27.27	19.91	7.36	--	<50	<0.5	<0.5	<0.5	<0.5	<0.5	--

Table 1
Groundwater Monitoring Data and Analytical Results
Former Chevron Service Station #9-4612
3616 San Leandro Street
Oakland, California

WELL ID/ DATE	TOC* (ft.)	GWE (msl)	DTW (ft.)	TPH-D (ppb)	TPH-G (ppb)	B (ppb)	T (ppb)	E (ppb)	X (ppb)	MTBE (ppb)	TOG (ppb)
MW-4 (cont)											
05/13/04 ¹⁴	27.27	18.99	8.28	--	<50	<0.5	<0.5	<0.5	<0.5	<0.5	--
08/17/04 ¹⁴	27.27	17.64	9.63	--	<50	<0.5	<0.5	<0.5	<0.5	<0.5	--
11/10/04 ¹⁴	27.27	18.81	8.46	--	52	<0.5	<0.5	<0.5	<0.5	<0.5	--
02/08/05 ¹⁴	27.27	20.07	7.20	--	<50	<0.5	<0.5	<0.5	<0.5	<0.5	--
06/03/05 ¹⁴	27.27	19.66	7.61	--	<50	<0.5	<0.5	<0.5	<0.5	<0.5	--
08/05/05 ¹⁴	27.27	17.83	9.44	--	<50	<0.5	<0.5	<0.5	<0.5	<0.5	--
TRIP BLANK											
05/27/93	--	--	--	--	<50	<0.5	<0.5	<0.5	<1.5	--	--
08/18/93	--	--	--	1,400	<50	<0.5	<0.5	<0.5	<1.5	--	<5,000
11/03/93	--	--	--	--	<50	<0.5	<0.5	<0.5	<0.5	--	--
02/10/94	--	--	--	<50	<50	<0.5	<0.5	<0.5	<0.5	--	--
05/12/94	--	--	--	84	<50	<0.5	<0.5	<0.5	<0.5	--	--
08/26/94	--	--	--	--	<50	<0.5	<0.5	<0.5	<0.5	--	--
11/14/94	--	--	--	--	<50	<0.5	<0.5	<0.5	<0.5	--	--
02/01/95	--	--	--	--	<50	<0.5	<0.5	<0.5	<0.5	--	--
05/12/95	--	--	--	--	<50	<0.5	<0.5	<0.5	<0.5	--	--
08/22/95	--	--	--	--	<50	<0.5	<0.5	<0.5	<0.5	<2.5	--
12/19/95	--	--	--	--	<50	<0.5	<0.5	<0.5	<0.5	<2.5	--
01/31/96	--	--	--	--	<50	<0.5	<0.5	<0.5	<0.5	<2.5	--
04/30/96	--	--	--	--	<50	<0.5	<0.5	<0.5	<0.5	<2.5	--
08/01/96	--	--	--	--	<50	<0.5	<0.5	<0.5	<0.5	<2.5	--
10/30/96	--	--	--	--	<50	<0.5	<0.5	<0.5	<0.5	<2.5	--
02/07/97	--	--	--	--	<50	<0.5	<0.5	<0.5	<0.5	<2.5	--
05/07/97	--	--	--	--	<50	<0.5	<0.5	<0.5	<0.5	<2.5	--
07/22/97	--	--	--	--	<50	<0.5	<0.5	<0.5	<0.5	<2.5	--
01/28/98	--	--	--	--	<50	<0.5	<0.5	<0.5	<0.5	--/ <2.0 ¹²	--
05/08/98	--	--	--	--	--	--	--	--	--	--/ <2.0 ¹²	--
07/29/98	--	--	--	--	<50	<0.5	<0.5	<0.5	<0.5	--/ <2.0 ¹²	--
11/06/98	--	--	--	--	<50	<0.5	<0.5	<0.5	<0.5	<2.5	--
02/09/99	--	--	--	--	<50	<0.5	<0.5	<0.5	<0.5	<2.0	--
05/13/99	--	--	--	--	<50	<0.5	<0.5	<0.5	<0.5	<5.0/ <2.0 ¹²	--
09/07/99	--	--	--	--	<50	<0.5	<0.5	<0.5	<0.5	<2.0	--
11/24/99	--	--	--	--	<50	<0.5	<0.5	<0.5	<0.5	<2.5	--

Table 1
Groundwater Monitoring Data and Analytical Results
Former Chevron Service Station #9-4612
3616 San Leandro Street
Oakland, California

WELL ID/ DATE	TOC* (ft.)	GWE (msl)	DTW (ft.)	TPH-D (ppb)	TPH-G (ppb)	B (ppb)	T (ppb)	E (ppb)	X (ppb)	MTBE (ppb)	TOG (ppb)
TRIP BLANK (cont)											
02/25/00	--	--	--	--	<50	<0.5	<0.5	<0.5	<0.5	<5.0	--
03/01/00	--	--	--	--	<50	<0.5	<0.5	<0.5	<0.5	<2.5	--
05/10/00	--	--	--	--	<50	<0.50	<0.50	<0.50	<0.50	<2.5	--
07/31/00	--	--	--	--	<50	<0.50	<0.50	<0.50	<0.50	<2.5	--
10/30/00	--	--	--	--	<50.0	<0.500	<0.500	<0.500	<1.50	<2.50	--
02/05/01	--	--	--	--	<50.0	<0.500	<0.500	<0.500	<0.500	<2.50	--
05/07/01	--	--	--	--	<50	<0.50	<0.50	<0.50	<0.50	<2.5	--
05/10/01	--	--	--	--	<50	<0.50	<0.50	<0.50	<0.50	<2.5	--
08/06/01	--	--	--	--	<50	<0.50	<0.50	<0.50	<0.50	<2.5	--
QA											
11/12/01	--	--	--	--	<50	<0.50	<0.50	<0.50	<1.5	<2.5	--
02/11/02	--	--	--	--	<50	<0.50	<0.50	<0.50	<1.5	<2.5	--
05/13/02	--	--	--	--	<50	<0.50	<0.50	<0.50	<1.5	<2.5	--
08/09/02	--	--	--	--	<50	<0.50	<0.50	<0.50	<1.5	<2.5	--
11/07/02	--	--	--	--	<50	<0.50	<0.50	<0.50	<1.5	<2.5	--
02/04/03	--	--	--	--	<50	<0.50	<0.50	<0.50	<1.5	<2.5	--
05/05/03	--	--	--	--	<50	<0.5	<0.5	<0.5	<1.5	<2.5	--
09/06/03 ¹⁴	--	--	--	--	<50	<0.5	<0.5	<0.5	<0.5	<0.5	--
11/14/03 ¹⁴	--	--	--	--	<50	<0.5	<0.5	<0.5	<0.5	<0.5	--
02/13/04 ¹⁴	--	--	--	--	<50	<0.5	<0.5	<0.5	<0.5	<0.5	--
05/13/04 ¹⁴	--	--	--	--	<50	<0.5	<0.5	<0.5	<0.5	<0.5	--
08/17/04 ¹⁴	--	--	--	--	<50	<0.5	<0.5	<0.5	<0.5	<0.5	--
11/10/04 ¹⁴	--	--	--	--	<50	<0.5	<0.5	<0.5	<0.5	<0.5	--
02/08/05 ¹⁴	--	--	--	--	<50	<0.5	<0.5	<0.5	<0.5	<0.5	--
06/03/05 ¹⁴	--	--	--	--	<50	<0.5	<0.5	<0.5	<0.5	<0.5	--
08/05/05 ¹⁴	--	--	--	--	<50	<0.5	<0.5	<0.5	<0.5	<0.5	--

Table 1
Groundwater Monitoring Data and Analytical Results
Former Chevron Service Station #9-4612
3616 San Leandro Street
Oakland, California

EXPLANATIONS:

Groundwater monitoring data and laboratory analytical results prior to May 10, 2000, were compiled from reports prepared by Blaine Tech Services, Inc.

TOC = Top of Casing	TPH-G = Total Petroleum Hydrocarbons as Gasoline	TOG = Total Oil and Grease
(ft.) = Feet	B = Benzene	(ppb) = Parts per billion
GWE = Groundwater Elevation	T = Toluene	-- = Not Measured/Not Analyzed
(msl) = Mean sea level	E = Ethylbenzene	QA = Quality Assurance/Trip Blank
DTW = Depth to Water	X = Xylenes	
TPH-D = Total Petroleum Hydrocarbons as Diesel	MTBE = Methyl tertiary butyl ether	

* TOC elevations were re-surveyed on March 8, 2001, by Virgil Chavez Land Surveying. The benchmark for the survey was a City of Oakland benchmark, being a cut square top of curb at the centerline return at the northwest corner of East 14th and 37th Avenue, (Benchmark Elevation = 38.21 feet, NGVD 29).

¹ Lab could not get a good ion chromatogram match for MTBE. See laboratory report.

² Chromatogram pattern indicates an unidentified hydrocarbon.

³ No value for MTBE could be determined; see lab report for analyses.

⁴ Confirmation run.

⁵ ORC was installed.

⁶ Laboratory report indicates gasoline C6-C12.

⁷ Laboratory report indicates unidentified hydrocarbons <C16.

⁸ Laboratory report indicates gasoline C6-C12 + unidentified hydrocarbons <C6.

⁹ Laboratory report indicates unidentified hydrocarbons >C16.

¹⁰ Laboratory report indicates hydrocarbon pattern present in the requested fuel quantitation range but does not resemble the pattern of the requested fuel.

¹¹ ORC in well.

¹² MTBE by EPA Method 8260.

¹³ Laboratory report indicates unidentified hydrocarbons C9-C17.

¹⁴ BTEX and MTBE by EPA Method 8260.

¹⁵ ORC removed from well.

¹⁶ Laboratory report indicates the observed sample pattern is not typical of #2 fuel/diesel. It elutes in the DRO range earlier and later than #2 fuel.

Table 2
Dissolved Oxygen Concentrations
Former Chevron Service Station #9-4612
3616 San Leandro Street
Oakland, California

WELL ID	DATE	Before Purging (mg/L)	After Purging (mg/L)
VH-1	05/10/00	0.90	--
	07/31/00	1.25	--
	10/30/00	1.97	--
	05/07/01	1.10	--
	08/06/01	1.40	--
	11/12/01	0.90	--
	02/11/02	1.10	--
	05/13/02	0.70	--
MW-2	05/10/00	0.57	--
	07/31/00	1.26	--
	10/30/00	1.25	--
	05/07/01	0.90	--
	08/06/01	1.10	--
	11/12/01	0.80	--
	02/11/02	0.60	--
	05/13/02	0.80	--
MW-3	05/10/00	1.56	--
	07/31/00	1.46	--
	10/30/00	1.18	--
	05/07/01	0.70	--
	08/06/01	0.90	--
	11/12/01	0.50	--
	02/11/02	0.80	--
	05/13/02	1.80	--
MW-4	05/10/00	INACCESSIBLE - CAR PARKED OVER WELL	--
	07/31/00	0.64	--
	10/30/00	0.97	--
	02/05/01	INACCESSIBLE - CAR PARKED OVER WELL	--
	05/07/01	0.50	--
	08/06/01	0.70	--
	11/12/01	1.00	--
	02/11/02	1.00	--
	05/13/02	2.90	--

Table 2
Dissolved Oxygen Concentrations
Former Chevron Service Station #9-4612
3616 San Leandro Street
Oakland, California

EXPLANATIONS:

(mg/L) = Milligrams per liter

-- = Not Measured

Table 3
Groundwater Analytical Results - Oxygenate Compounds
Former Chevron Service Station #9-4612
3616 San Leandro Street
Oakland, California

WELL ID	DATE	ETHANOL (ppb)	TBA (ppb)	MTBE (ppb)	DIPE (ppb)	ETBE (ppb)	TAME (ppb)
VH-1	02/05/01	<500	<50	160	<2.0	<2.0	<2.0
	05/07/01	--	--	110	--	--	--
	08/06/01	--	--	140	--	--	--
	11/12/01	--	--	61	--	--	--
	02/11/02	--	--	52	--	--	--
	05/13/02	--	--	80	--	--	--
	08/09/02	--	--	89	--	--	--
	11/07/02	--	--	50	--	--	--
	02/04/03	--	--	53	--	--	--
	05/05/03	--	--	62	--	--	--
	09/06/03	--	--	59	--	--	--
	11/14/03	--	--	47	--	--	--
	02/13/04	--	--	47	--	--	--
	05/13/04	--	--	74	--	--	--
	08/17/04	--	--	58	--	--	--
	11/10/04	INACCESSIBLE	--	--	--	--	--
	02/08/05	--	--	48	--	--	--
	06/03/05	--	--	45	--	--	--
08/05/05	--	--	46	--	--	--	
MW-2	02/05/01	<500	<50	140	<2.0	<2.0	<2.0
	05/07/01	--	--	88	--	--	--
	08/06/01	--	--	110	--	--	--
	11/12/01	--	--	98	--	--	--
	02/11/02	--	--	86	--	--	--
	05/13/02	--	--	47	--	--	--
	08/09/02	--	--	69	--	--	--
	11/07/02	--	--	69	--	--	--
	02/04/03	--	--	55	--	--	--
	05/05/03	--	--	31	--	--	--
	09/06/03	--	--	54	--	--	--
	11/14/03	--	--	55	--	--	--
	02/13/04	--	--	31	--	--	--
	05/13/04	--	--	34	--	--	--
08/17/04	--	--	46	--	--	--	

Table 3
Groundwater Analytical Results - Oxygenate Compounds
Former Chevron Service Station #9-4612
3616 San Leandro Street
Oakland, California

WELL ID	DATE	ETHANOL (ppb)	TBA (ppb)	MTBE (ppb)	DIPE (ppb)	ETBE (ppb)	TAME (ppb)
MW-2 (cont)	11/10/04	--	--	37	--	--	--
	02/08/05	--	--	22	--	--	--
	06/03/05	--	--	23	--	--	--
	08/05/05	--	--	23	--	--	--
MW-3	02/05/01	<500	<50	70	<2.0	<2.0	<2.0
	05/07/01	--	--	49	--	--	--
	08/06/01	--	--	43	--	--	--
	11/12/01	--	--	46	--	--	--
	02/11/02	--	--	42	--	--	--
	05/13/02	--	--	32	--	--	--
	08/09/02	--	--	33	--	--	--
	11/07/02	--	--	37	--	--	--
	02/04/03	--	--	24	--	--	--
	05/05/03	--	--	19	--	--	--
	09/06/03	--	--	28	--	--	--
	11/14/03	--	--	30	--	--	--
	02/13/04	--	--	21	--	--	--
	05/13/04	--	--	20	--	--	--
	08/17/04	--	--	25	--	--	--
	11/10/04	--	--	27	--	--	--
	02/08/05	--	--	11	--	--	--
06/03/05	--	--	9	--	--	--	
08/05/05	--	--	9	--	--	--	
MW-4	05/07/01	--	--	<2.0	--	--	--
	08/06/01	--	--	<2.0	--	--	--
	11/12/01	--	--	<2	--	--	--
	02/11/02	--	--	<2	--	--	--
	05/13/02	--	--	<2	--	--	--
	08/09/02	--	--	<2	--	--	--
	11/07/02	--	--	<2	--	--	--
02/04/03	--	--	<0.5	--	--	--	
05/05/03	--	--	<0.5	--	--	--	

Table 3
Groundwater Analytical Results - Oxygenate Compounds
 Former Chevron Service Station #9-4612
 3616 San Leandro Street
 Oakland, California

WELL ID	DATE	ETHANOL (ppb)	TBA (ppb)	MTBE (ppb)	DIPE (ppb)	ETBE (ppb)	TAME (ppb)
MW-4	09/06/03	--	--	<0.5	--	--	--
(cont)	11/14/03	--	--	<0.5	--	--	--
	02/13/04	--	--	<0.5	--	--	--
	05/13/04	--	--	<0.5	--	--	--
	08/17/04	--	--	<0.5	--	--	--
	11/10/04	--	--	<0.5	--	--	--
	02/08/05	--	--	<0.5	--	--	--
	06/03/05	--	--	<0.5	--	--	--
	08/05/05	--	--	<0.5	--	--	--

Table 3
Groundwater Analytical Results - Oxygenate Compounds
Former Chevron Service Station #9-4612
3616 San Leandro Street
Oakland, California

EXPLANATIONS:

TBA = Tertiary butyl alcohol
MTBE = Methyl tertiary butyl ether
DIPE = Di-isopropyl ether
ETBE = Ethyl tertiary butyl ether
TAME = Tertiary amyl methyl ether
(ppb) = Parts per billion
-- = Not Analyzed

ANALYTICAL METHOD:

EPA Method 8260 for Oxygenate Compounds

STANDARD OPERATING PROCEDURE - GROUNDWATER SAMPLING

Gettler-Ryan Inc. field personnel adhere to the following procedures for the collection and handling of groundwater samples prior to analysis by the analytical laboratory. Prior to sample collection, the type of analysis to be performed is determined. Loss prevention of volatile compounds is controlled and sample preservation for subsequent analysis is maintained.

Prior to sampling, the presence or absence of free-phase hydrocarbons is determined using an interface probe. Product thickness, if present, is measured to the nearest 0.01 foot and is noted in the field notes. In addition, all depth to water level measurements are collected with a static water level indicator and are also recorded in the field notes, prior to purging and sampling any wells.

After water levels are collected and prior to sampling, if purging is to occur, each well is purged a minimum of three well casing volumes of water using pre-cleaned pumps (stack, suction, Grundfos), or disposable bailers. Temperature, pH and electrical conductivity are measured a minimum of three times during the purging. Purging continues until these parameters stabilize.

Groundwater samples are collected using disposable bailers. The water samples are transferred from the bailer into appropriate containers. Pre-preserved containers, supplied by analytical laboratories, are used when possible. When pre-preserved containers are not available, the laboratory is instructed to preserve the sample as appropriate. Duplicate samples are collected for the laboratory to use in maintaining quality assurance/quality control standards. The samples are labeled to include the job number, sample identification, collection date and time, analysis, preservation (if any), and the sample collector's initials. The water samples are placed in a cooler, maintained at 4°C for transport to the laboratory. Once collected in the field, all samples are maintained under chain of custody until delivered to the laboratory.

The chain of custody document includes the job number, type of preservation, if any, analysis requested, sample identification, date and time collected, and the sample collector's name. The chain of custody is signed and dated (including time of transfer) by each person who receives or surrenders the samples, beginning with the field personnel and ending with the laboratory personnel.

A laboratory supplied trip blank accompanies each sampling set. For sampling sets greater than 20 samples, 5% trip blanks are included. The trip blank is analyzed for some or all of the same compounds as the groundwater samples.

As requested by ChevronTexaco Company, the purge water and decontamination water generated during sampling activities is transported by IWM to McKittrick Waste Management located in McKittrick, California.



GETTLER-RYAN INC.

WELL MONITORING/SAMPLING FIELD DATA SHEET

Client/Facility #: ChevronTexaco #9-4612 Job Number: 386473
 Site Address: 3616 San Leandro Street Event Date: 8/5/04 (inclusive)
 City: Oakland, CA Sampler: GR

Well ID: VH-1 Date Monitored: 8/5/04 Well Condition: OK
 Well Diameter: 4 in.
 Total Depth: 28.45 ft.
 Depth to Water: 10.10 ft.
18.35 xVF 0.44 = 19 x3 case volume = Estimated Purge Volume: 5 gal. See note

Volume	3/4" = 0.02	1" = 0.04	2" = 0.17	3" = 0.38
Factor (VF)	4" = 0.66	5" = 1.02	6" = 1.50	12" = 5.80

Purge Equipment:
 Disposable Bailer
 Stainless Steel Bailer _____
 Stack Pump _____
 Suction Pump _____
 Grundfos _____
 Other: _____

Sampling Equipment:
 Disposable Bailer
 Pressure Bailer _____
 Discrete Bailer _____
 Other: _____

Time Started: _____ (2400 hrs)
 Time Completed: _____ (2400 hrs)
 Depth to Product: _____ ft
 Depth to Water: _____ ft
 Hydrocarbon Thickness: 0 ft
 Visual Confirmation/Description: _____
 Skimmer / Absorbent Sock (circle one)
 Amt Removed from Skimmer: _____ gal
 Amt Removed from Well: _____ gal
 Water Removed: _____
 Product Transferred to: _____

Start Time (purge): 0910 Weather Conditions: Clear
 Sample Time/Date: 0935 8/5/04 Water Color: Clear Odor: No
 Purging Flow Rate: _____ gpm. Sediment Description: _____
 Did well de-water? No If yes, Time: _____ Volume: _____ gal.

Time (2400 hr.)	Volume (gal.)	pH	Conductivity (umhos/cm)	Temperature (C/F)	D.O. (mg/L)	ORP (mV)
<u>0935</u>	<u>5</u>	<u>7.11</u>	<u>684</u>	<u>18.9</u>	_____	_____
_____	_____	_____	_____	_____	_____	_____
_____	_____	_____	_____	_____	_____	_____
_____	_____	_____	_____	_____	_____	_____

LABORATORY INFORMATION

SAMPLE ID	(#) CONTAINER	REFRIG.	PRESERV. TYPE	LABORATORY	ANALYSES
VH-1	<u>6</u> x vovial	YES	HCL	LANCASTER	TPH-G(8015)/BTEX+MTBE(8260)

COMMENTS: Well inside gutter - impractical to pump - Bailed (5 Gals Purge) + Sampled

Add/Replaced Lock: _____ Add/Replaced Plug: _____ Size: _____



GETTLER - RYAN INC.

WELL MONITORING/SAMPLING FIELD DATA SHEET

Client/Facility #: ChevronTexaco #9-4612 Job Number: 386473
 Site Address: 3616 San Leandro Street Event Date: 8/5/05 (inclusive)
 City: Oakland, CA Sampler: G.R.

Well ID: MW-2 Date Monitored: 8/5/05 Well Condition: OK
 Well Diameter: (2) 14 in.
 Total Depth: 19.50 ft.
 Depth to Water: 9.76 ft.

Volume	3/4" = 0.02	1" = 0.04	2" = 0.17	3" = 0.38
Factor (VF)	4" = 0.66	5" = 1.02	6" = 1.50	12" = 5.80

9.74 xVF 0.17 = 1.65 x3 case volume = Estimated Purge Volume: 5 gal.

Purge Equipment:
 Disposable Bailer
 Stainless Steel Bailer _____
 Stack Pump _____
 Suction Pump _____
 Grundfos _____
 Other: _____

Sampling Equipment:
 Disposable Bailer
 Pressure Bailer _____
 Discrete Bailer _____
 Other: _____

Time Started: _____ (2400 hrs)
 Time Completed: _____ (2400 hrs)
 Depth to Product: _____ ft
 Depth to Water: _____ ft
 Hydrocarbon Thickness: 0 ft
 Visual Confirmation/Description: _____
 Skimmer / Absorbant Sock (circle one)
 Amt Removed from Skimmer: _____ gal
 Amt Removed from Well: _____ gal
 Water Removed: _____
 Product Transferred to: _____

Start Time (purge): 0950 Weather Conditions: Clear
 Sample Time/Date: 1020 8/5/05 Water Color: Clear Odor: No
 Purging Flow Rate: _____ gpm. Sediment Description: _____
 Did well de-water? No If yes, Time: _____ Volume: _____ gal.

Time (2400 hr.)	Volume (gal.)	pH	Conductivity (u mhos/cm)	Temperature (C/F)	D.O. (mg/L)	ORP (mV)
<u>0956</u>	<u>2</u>	<u>7.09</u>	<u>627</u>	<u>18.8</u>	_____	_____
<u>1000</u>	<u>4</u>	<u>7.04</u>	<u>638</u>	<u>18.8</u>	_____	_____
<u>1004</u>	<u>5</u>	<u>7.06</u>	<u>642</u>	<u>18.7</u>	_____	_____
_____	_____	_____	_____	_____	_____	_____

LABORATORY INFORMATION

SAMPLE ID	(#) CONTAINER	REFRIG.	PRESERV. TYPE	LABORATORY	ANALYSES
<u>MW-2</u>	<u>6</u> x vva vial x Amber	YES	HCL	LANCASTER	TPH-G(8015)/BTEX+MTBE(8260)
		YES	NP	LANCASTER	TPH-D

COMMENTS: _____

Add/Replaced Lock: _____ Add/Replaced Plug: _____ Size: _____



GETTLER-RYAN INC.

WELL MONITORING/SAMPLING FIELD DATA SHEET

Client/Facility #: ChevronTexaco #9-4612 Job Number: 386473
 Site Address: 3616 San Leandro Street Event Date: 8/5/08 (inclusive)
 City: Oakland, CA Sampler: GR

Well ID: MW-3 Date Monitored: 8/5/08 Well Condition: OK
 Well Diameter: (2) 4 in.
 Total Depth: 18.05 ft.
 Depth to Water: 10.60 ft.
7.45 x VF 0.17 = 126 x3 case volume = Estimated Purge Volume: 4 gal.

Volume	3/4"= 0.02	1"= 0.04	2"= 0.17	3"= 0.38
Factor (VF)	4"= 0.66	5"= 1.02	6"= 1.50	12"= 5.80

Purge Equipment:
 Disposable Bailer
 Stainless Steel Bailer _____
 Stack Pump _____
 Suction Pump _____
 Grundfos _____
 Other: _____

Sampling Equipment:
 Disposable Bailer
 Pressure Bailer _____
 Discrete Bailer _____
 Other: _____

Time Started: _____ (2400 hrs)
 Time Completed: _____ (2400 hrs)
 Depth to Product: _____ ft
 Depth to Water: _____ ft
 Hydrocarbon Thickness: 0 ft
 Visual Confirmation/Description: _____
 Skimmer / Absorbant Sock (circle one)
 Amt Removed from Skimmer: _____ gal
 Amt Removed from Well: _____ gal
 Water Removed: _____
 Product Transferred to: _____

Start Time (purge): 1035 Weather Conditions: Clear
 Sample Time/Date: 1100 8/5/08 Water Color: Clear Odor: NO
 Purging Flow Rate: _____ gpm. Sediment Description: _____
 Did well de-water? No If yes, Time: _____ Volume: _____ gal.

Time (2400 hr.)	Volume (gal.)	pH	Conductivity (u mhos/cm)	Temperature (C/F)	D.O. (mg/L)	ORP (mV)
<u>1041</u>	<u>1.5</u>	<u>7.18</u>	<u>807</u>	<u>18.7</u>	_____	_____
<u>1045</u>	<u>3</u>	<u>7.14</u>	<u>826</u>	<u>18.8</u>	_____	_____
<u>1048</u>	<u>4</u>	<u>7.15</u>	<u>821</u>	<u>18.8</u>	_____	_____
_____	_____	_____	_____	_____	_____	_____

LABORATORY INFORMATION

SAMPLE ID	(#) CONTAINER	REFRIG.	PRESERV. TYPE	LABORATORY	ANALYSES
<u>MW-3</u>	<u>6</u> x vov vial	YES	HCL	LANCASTER	TPH-G(8015)/BTEX+MTBE(8260)
	<u>2</u> x Amber	YES	NP	LANCASTER	TPH-D
_____	_____	_____	_____	_____	_____
_____	_____	_____	_____	_____	_____

COMMENTS: _____

Add/Replaced Lock: _____ Add/Replaced Plug: _____ Size: _____



GETTLER - RYAN INC.

WELL MONITORING/SAMPLING FIELD DATA SHEET

Client/Facility #: ChevronTexaco #9-4612
 Site Address: 3616 San Leandro Street
 City: Oakland, CA

Job Number: 386473
 Event Date: 8/5/05 (inclusive)
 Sampler: G. M.

Well ID: MW-4
 Well Diameter: (2) 1 1/4 in.
 Total Depth: 19.25 ft.
 Depth to Water: 9.44 ft.

Date Monitored: 8/5/05 Well Condition: OK

Volume	3/4"= 0.02	1"= 0.04	2"= 0.17	3"= 0.38
Factor (VF)	4"= 0.66	5"= 1.02	6"= 1.50	12"= 5.80

9.81 xVF 0.17 = 1.66 x3 case volume= Estimated Purge Volume: 5 gal.

Purge Equipment:
 Disposable Bailer
 Stainless Steel Bailer _____
 Stack Pump _____
 Suction Pump _____
 Grundfos _____
 Other: _____

Sampling Equipment:
 Disposable Bailer
 Pressure Bailer _____
 Discrete Bailer _____
 Other: _____

Time Started: _____ (2400 hrs)
 Time Completed: _____ (2400 hrs)
 Depth to Product: _____ ft
 Depth to Water: _____ ft
 Hydrocarbon Thickness: 0 ft
 Visual Confirmation/Description: _____
 Skimmer / Absorbant Sock (circle one)
 Amt Removed from Skimmer: _____ gal
 Amt Removed from Well: _____ gal
 Water Removed: _____
 Product Transferred to: _____

Start Time (purge): 1110 Weather Conditions: Clear
 Sample Time/Date: 1135 8/5/05 Water Color: Clear Odor: No
 Purging Flow Rate: _____ gpm. Sediment Description: _____
 Did well de-water? No If yes, Time: _____ Volume: _____ gal.

Time (2400 hr.)	Volume (gal.)	pH	Conductivity (umhos/cm)	Temperature (C/F)	D.O. (mg/L)	ORP (mV)
<u>1116</u>	<u>2</u>	<u>7.16</u>	<u>684</u>	<u>18.7</u>		
<u>1120</u>	<u>4</u>	<u>7.11</u>	<u>672</u>	<u>18.6</u>		
<u>1123</u>	<u>5</u>	<u>7.10</u>	<u>671</u>	<u>18.6</u>		

LABORATORY INFORMATION

SAMPLE ID	(#) CONTAINER	REFRIG.	PRESERV. TYPE	LABORATORY	ANALYSES
<u>MW-4</u>	<u>6</u> x vov vial	<u>YES</u>	<u>HCL</u>	<u>LANCASTER</u>	<u>TPH-G(8015)/BTEX+MTBE(8260)</u>
	<u>x</u> Amber	<u>YES</u>	<u>NP</u>	<u>LANCASTER</u>	<u>TPH-D</u>

COMMENTS: _____

Add/Replaced Lock: _____ Add/Replaced Plug: _____ Size: _____

ANALYTICAL RESULTS

Prepared for:

ChevronTexaco c/o Cambria
Suite 12
4111 Citrus Avenue
Rocklin CA 95677
916-630-1855

Prepared by:

Lancaster Laboratories
2425 New Holland Pike
Lancaster, PA 17605-2425

SAMPLE GROUP

The sample group for this submittal is 954779. Samples arrived at the laboratory on Wednesday, August 10, 2005. The PO# for this group is 99011184 and the release number is MTI.

<u>Client Description</u>			<u>Lancaster Labs Number</u>
QA-T-050805	NA	Water	4580796
VH-1-W-050805	Grab	Water	4580797
MW-2-W-050805	Grab	Water	4580798
MW-3-W-050805	Grab	Water	4580799
MW-4-W-050805	Grab	Water	4580800

1 COPY TO
ELECTRONIC
COPY TO

Cambria C/O Gettler- Ryan
Gettler-Ryan

Attn: Deanna L. Harding
Attn: Cheryl Hansen



Analysis Report

2425 New Holland Pike, PO Box 12425, Lancaster, PA 17605-2425 • 717-656-2300 Fax: 717-656-2681 • www.lancasterlabs.com

Questions? Contact your Client Services Representative
Megan A Moeller at (717) 656-2300

Respectfully Submitted,

A handwritten signature in cursive script that reads "Dana M. Kauffman".

Dana M. Kauffman
Manager



Analysis Report

2425 New Holland Pike, PO Box 12425, Lancaster, PA 17605-2425 • 717-656-2300 Fax: 717-656-2681 • www.lancasterlabs.com

Page 1 of 1

Lancaster Laboratories Sample No., WW 4580796

QA-T-050805 NA Water
Facility# 94612 Job# 386473 MTI# 61H-1996 GRD
3616 San Leandro Oakland T0600100333 QA
Collected: 08/05/2005

Account Number: 10904

Submitted: 08/10/2005 09:00
Reported: 08/18/2005 at 00:13
Discard: 09/18/2005

ChevronTexaco c/o Cambria
Suite 12
4111 Citrus Avenue
Rocklin CA 95677

QAOKD

CAT No.	Analysis Name	CAS Number	As Received Result	As Received Method Detection Limit	Units	Dilution Factor
01728	TPH-GRO - Waters The reported concentration of TPH-GRO does not include MTBE or other gasoline constituents eluting prior to the C6 (n-hexane) TPH-GRO range start time.	n.a.	N.D.	50.	ug/l	1
06054	BTEX+MTBE by 8260B					
02010	Methyl Tertiary Butyl Ether	1634-04-4	N.D.	0.5	ug/l	1
05401	Benzene	71-43-2	N.D.	0.5	ug/l	1
05407	Toluene	108-88-3	N.D.	0.5	ug/l	1
05415	Ethylbenzene	100-41-4	N.D.	0.5	ug/l	1
06310	Xylene (Total)	1330-20-7	N.D.	0.5	ug/l	1

State of California Lab Certification No. 2116

Laboratory Chronicle

CAT No.	Analysis Name	Method	Analysis		Analyst	Dilution Factor
			Trial#	Date and Time		
01728	TPH-GRO - Waters	N. CA LUFT Gasoline Method	1	08/11/2005 06:44	Kathie J Bowman	1
06054	BTEX+MTBE by 8260B	SW-846 8260B	1	08/14/2005 16:22	Ginelle L Feister	1
01146	GC VOA Water Prep	SW-846 5030B	1	08/11/2005 06:44	Kathie J Bowman	1
01163	GC/MS VOA Water Prep	SW-846 5030B	1	08/14/2005 16:22	Ginelle L Feister	n.a.



Analysis Report

2425 New Holland Pike, PO Box 12425, Lancaster, PA 17605-2425 • 717-656-2300 Fax: 717-656-2681 • www.lancasterlabs.com

Lancaster Laboratories Sample No. WW 4580797

VH-1-W-050805 Grab Water
Facility# 94612 Job# 386473 MTI# 61H-1996 GRD
3616 San Leandro Oakland T0600100333 VH-1
Collected: 08/05/2005 09:35 by GR

Account Number: 10904

Submitted: 08/10/2005 09:00
Reported: 08/18/2005 at 00:13
Discard: 09/18/2005

ChevronTexaco c/o Cambria
Suite 12
4111 Citrus Avenue
Rocklin CA 95677

OKDV1

CAT No.	Analysis Name	CAS Number	As Received Result	As Received Method Detection Limit	Units	Dilution Factor
01728	TPH-GRO - Waters	n.a.	2,500.	500.	ug/l	10
The reported concentration of TPH-GRO does not include MTBE or other gasoline constituents eluting prior to the C6 (n-hexane) TPH-GRO range start time.						
06054	BTEX+MTBE by 8260B					
02010	Methyl Tertiary Butyl Ether	1634-04-4	46.	0.5	ug/l	1
05401	Benzene	71-43-2	34.	0.5	ug/l	1
05407	Toluene	108-88-3	4.	0.5	ug/l	1
05415	Ethylbenzene	100-41-4	0.6	0.5	ug/l	1
06310	Xylene (Total)	1330-20-7	6.	0.5	ug/l	1

State of California Lab Certification No. 2116

Laboratory Chronicle

CAT No.	Analysis Name	Method	Trial#	Analysis Date and Time	Analyst	Dilution Factor
01728	TPH-GRO - Waters	N. CA LUFT Gasoline Method	1	08/11/2005 14:20	Kathie J Bowman	10
06054	BTEX+MTBE by 8260B	SW-846 8260B	1	08/14/2005 16:46	Ginelle L Feister	1
01146	GC VOA Water Prep	SW-846 5030B	1	08/11/2005 14:20	Kathie J Bowman	10
01163	GC/MS VOA Water Prep	SW-846 5030B	1	08/14/2005 16:46	Ginelle L Feister	n.a.



Analysis Report

2425 New Holland Pike, PO Box 12425, Lancaster, PA 17605-2425 • 717-656-2300 Fax: 717-656-2681 • www.lancasterlabs.com

Page 1 of 1

Lancaster Laboratories Sample No. WW 4580798

MW-2-W-050805 Grab Water
Facility# 94612 Job# 386473 MTI# 61H-1996 GRD
3616 San Leandro Oakland T0600100333 MW-2
Collected: 08/05/2005 10:20 by GR

Account Number: 10904

Submitted: 08/10/2005 09:00
Reported: 08/18/2005 at 00:13
Discard: 09/18/2005

ChevronTexaco c/o Cambria
Suite 12
4111 Citrus Avenue
Rocklin CA 95677

OKD-2

CAT No.	Analysis Name	CAS Number	As Received Result	As Received Method Detection Limit	Units	Dilution Factor
01728	TPH-GRO - Waters The reported concentration of TPH-GRO does not include MTBE or other gasoline constituents eluting prior to the C6 (n-hexane) TPH-GRO range start time.	n.a.	3,500.	500.	ug/l	10
06054	BTEX+MTBE by 8260B					
02010	Methyl Tertiary Butyl Ether	1634-04-4	23.	0.5	ug/l	1
05401	Benzene	71-43-2	4.	0.5	ug/l	1
05407	Toluene	108-88-3	1.	0.5	ug/l	1
05415	Ethylbenzene	100-41-4	N.D.	0.5	ug/l	1
06310	Xylene (Total)	1330-20-7	8.	0.5	ug/l	1

State of California Lab Certification No. 2116

Laboratory Chronicle

CAT No.	Analysis Name	Method	Trial#	Analysis Date and Time	Analyst	Dilution Factor
01728	TPH-GRO - Waters	N. CA LUFT Gasoline Method	1	08/11/2005 14:56	Kathie J Bowman	10
06054	BTEX+MTBE by 8260B	SW-846 8260B	1	08/16/2005 04:45	Dawn M Harle	1
01146	GC VOA Water Prep	SW-846 5030B	1	08/11/2005 14:56	Kathie J Bowman	10
01163	GC/MS VOA Water Prep	SW-846 5030B	1	08/16/2005 04:45	Dawn M Harle	n.a.



Analysis Report

2425 New Holland Pike, PO Box 12425, Lancaster, PA 17605-2425 • 717-656-2300 Fax: 717-656-2681 • www.lancasterlabs.com

Lancaster Laboratories Sample No. WW 4580799

MW-3-W-050805 Grab Water
 Facility# 94612 Job# 386473 MTI# 61H-1996 GRD
 3616 San Leandro Oakland T0600100333 MW-3
 Collected: 08/05/2005 11:00 by GR

Account Number: 10904

Submitted: 08/10/2005 09:00
 Reported: 08/18/2005 at 00:13
 Discard: 09/18/2005

ChevronTexaco c/o Cambria
 Suite 12
 4111 Citrus Avenue
 Rocklin CA 95677

OKD13

CAT No.	Analysis Name	CAS Number	As Received Result	As Received		Units	Dilution Factor
				Method	Detection Limit		
01728	TPH-GRO - Waters The reported concentration of TPH-GRO does not include MTBE or other gasoline constituents eluting prior to the C6 (n-hexane) TPH-GRO range start time.	n.a.	980.		250.	ug/l	5
06609	TPH-DRO CALUFT(Waters) The observed sample pattern is not typical of #2 fuel/diesel. It elutes in the DRO range earlier and later than #2 fuel.	n.a.	530.		50.	ug/l	1
06054	BTEX+MTBE by 8260B						
02010	Methyl Tertiary Butyl Ether	1634-04-4	9.		0.5	ug/l	1
05401	Benzene	71-43-2	0.6		0.5	ug/l	1
05407	Toluene	108-88-3	N.D.		0.5	ug/l	1
05415	Ethylbenzene	100-41-4	N.D.		0.5	ug/l	1
06310	Xylene (Total)	1330-20-7	0.8		0.5	ug/l	1

State of California Lab Certification No. 2116

Laboratory Chronicle

CAT No.	Analysis Name	Method	Analysis		Analyst	Dilution Factor
			Trial#	Date and Time		
01728	TPH-GRO - Waters	N. CA LUFT Gasoline Method	1	08/11/2005 15:31	Kathie J Bowman	5
06609	TPH-DRO CALUFT(Waters)	CALUFT-DRO/8015B, Modified	1	08/12/2005 14:16	Tracy A Cole	1
06054	BTEX+MTBE by 8260B	SW-846 8260B	1	08/14/2005 18:21	Ginelle L Feister	1
01146	GC VOA Water Prep	SW-846 5030B	1	08/11/2005 15:31	Kathie J Bowman	5
01163	GC/MS VOA Water Prep	SW-846 5030B	1	08/14/2005 18:21	Ginelle L Feister	n.a.
02135	Extraction - DRO Water Special	TPH by CA LUFT	1	08/11/2005 02:30	Sherry L Morrow	1



Analysis Report

2425 New Holland Pike, PO Box 12425, Lancaster, PA 17605-2425 • 717-656-2300 Fax: 717-656-2681 • www.lancasterlabs.com

Page 1 of 1

Lancaster Laboratories Sample No., WW 4580800

MW-4-W-050805 Grab Water
Facility# 94612 Job# 386473 MTI# 61H-1996 GRD
3616 San Leandro Oakland T0600100333 MW-4
Collected: 08/05/2005 11:35 by GR

Account Number: 10904

Submitted: 08/10/2005 09:00
Reported: 08/18/2005 at 00:13
Discard: 09/18/2005

ChevronTexaco c/o Cambria
Suite 12
4111 Citrus Avenue
Rocklin CA 95677

OKD-4

CAT No.	Analysis Name	CAS Number	As Received Result	As Received Method Detection Limit	Units	Dilution Factor
01728	TPH-GRO - Waters	n.a.	N.D.	50.	ug/l	1
	The reported concentration of TPH-GRO does not include MTBE or other gasoline constituents eluting prior to the C6 (n-hexane) TPH-GRO range start time.					
06054	BTEX+MTBE by 8260B					
02010	Methyl Tertiary Butyl Ether	1634-04-4	N.D.	0.5	ug/l	1
05401	Benzene	71-43-2	N.D.	0.5	ug/l	1
05407	Toluene	108-88-3	N.D.	0.5	ug/l	1
05415	Ethylbenzene	100-41-4	N.D.	0.5	ug/l	1
06310	Xylene (Total)	1330-20-7	N.D.	0.5	ug/l	1

State of California Lab Certification No. 2116

Laboratory Chronicle

CAT No.	Analysis Name	Method	Trial#	Analysis Date and Time	Analyst	Dilution Factor
01728	TPH-GRO - Waters	N. CA LUFT Gasoline Method	1	08/11/2005 10:19	Kathie J Bowman	1
06054	BTEX+MTBE by 8260B	SW-846 8260B	1	08/14/2005 18:45	Ginelle L Feister	1
01146	GC VOA Water Prep	SW-846 5030B	1	08/11/2005 10:19	Kathie J Bowman	1
01163	GC/MS VOA Water Prep	SW-846 5030B	1	08/14/2005 18:45	Ginelle L Feister	n.a.

Quality Control Summary

 Client Name: ChevronTexaco c/o Cambria
 Reported: 08/18/05 at 12:13 AM

Group Number: 954779

Matrix QC may not be reported if site-specific QC samples were not submitted. In these situations, to demonstrate precision and accuracy at a batch level, a LCS/LCSD was performed, unless otherwise specified in the method.

Laboratory Compliance Quality Control

Analysis Name	Blank Result	Blank MDL	Report Units	LCS %REC	LCSD %REC	LCS/LCSD Limits	RPD	RPD Max
Batch number: 052220026A TPH-DRO CALUFT(Waters)	N.D.	50.	Sample number(s): 4580799 ug/l	69	73	64-125	5	20
Batch number: 05222A07B TPH-GRO - Waters	N.D.	50.	Sample number(s): 4580796,4580800 ug/l	99	92	70-130	7	30
Batch number: 05222A07C TPH-GRO - Waters	N.D.	50.	Sample number(s): 4580797-4580799 ug/l	99	92	70-130	7	30
Batch number: Z052261AA Methyl Tertiary Butyl Ether	N.D.	0.5	Sample number(s): 4580796-4580797,4580799-4580800 ug/l	83		77-127		
Benzene	N.D.	0.5	ug/l	88		85-117		
Toluene	N.D.	0.5	ug/l	89		85-115		
Ethylbenzene	N.D.	0.5	ug/l	89		82-119		
Xylene (Total)	N.D.	0.5	ug/l	92		83-113		
Batch number: Z052271AA Methyl Tertiary Butyl Ether	N.D.	0.5	Sample number(s): 4580798 ug/l	91		77-127		
Benzene	N.D.	0.5	ug/l	94		85-117		
Toluene	N.D.	0.5	ug/l	95		85-115		
Ethylbenzene	N.D.	0.5	ug/l	96		82-119		
Xylene (Total)	N.D.	0.5	ug/l	99		83-113		

Sample Matrix Quality Control

Analysis Name	MS %REC	MSD %REC	MS/MSD Limits	RPD	RPD MAX	BKG Conc	DUP Conc	DUP RPD	Dup RPD Max
Batch number: 05222A07B TPH-GRO - Waters			Sample number(s): 4580796,4580800 116 63-154						
Batch number: 05222A07C TPH-GRO - Waters			Sample number(s): 4580797-4580799 116 63-154						
Batch number: Z052261AA Methyl Tertiary Butyl Ether	(2)	(2)	Sample number(s): 4580796-4580797,4580799-4580800 (2) (2) 69-134 2 30						
Benzene	95	95	83-128 0 30						
Toluene	96	97	83-127 1 30						
Ethylbenzene	96	98	82-129 1 30						
Xylene (Total)	98	99	82-130 1 30						
Batch number: Z052271AA			Sample number(s): 4580798						

*- Outside of specification

- (1) The result for one or both determinations was less than five times the LOQ.
- (2) The background result was more than four times the spike added.

Quality Control Summary

 Client Name: ChevronTexaco c/o Cambria
 Reported: 08/18/05 at 12:13 AM

Group Number: 954779

Sample Matrix Quality Control

Analysis Name	MS %REC	MSD %REC	MS/MSD Limits	RPD	RPD MAX	BKG Conc	DUP Conc	DUP RPD	Dup RPD Max
Methyl Tertiary Butyl Ether	85	96	69-134	13	30				
Benzene	87	100	83-128	14	30				
Toluene	88	102	83-127	15	30				
Ethylbenzene	87	102	82-129	15	30				
Xylene (Total)	90	105	82-130	16	30				

Surrogate Quality Control

 Analysis Name: TPH-DRO CALUPT(Waters)
 Batch number: 052220026A
 Orthoterphenyl

4580799	79
Blank	90
LCS	107
LCSD	108

Limits: 52-134

 Analysis Name: TPH-GRO - Waters
 Batch number: 05222A07B
 Trifluorotoluene-F

4580796	90
4580800	105
Blank	89
LCS	118
LCSD	112
MS	119

Limits: 63-135

 Analysis Name: TPH-GRO - Waters
 Batch number: 05222A07C
 Trifluorotoluene-F

4580797	103
4580798	106
4580799	114
Blank	89
LCS	118
LCSD	112
MS	119

Limits: 63-135

 Analysis Name: BTEX+MTBE by 8260B
 Batch number: Z052261AA
 Dibromofluoromethane

4580796	95
4580797	92

1,2-Dichloroethane-d4

Toluene-d8

4-Bromofluorobenzene

89
89

90
89

87
92

*- Outside of specification

- (1) The result for one or both determinations was less than five times the LOQ.
- (2) The background result was more than four times the spike added.

Quality Control Summary

 Client Name: ChevronTexaco c/o Cambria
 Reported: 08/18/05 at 12:13 AM

Group Number: 954779

Surrogate Quality Control

4580799	91	88	90	94
4580800	94	88	89	87
Blank	94	89	90	87
LCS	93	90	90	91
MS	95	91	90	92
MSD	94	90	90	92
<hr/>				
Limits:	81-120	82-112	85-112	83-113
<hr/>				
Analysis Name: BTEX+MTBE by 8260B				
Batch number: Z052271AA				
	Dibromofluoromethane	1,2-Dichloroethane-d4	Toluene-d8	4-Bromofluorobenzene
4580798	91	83	90	94
Blank	94	90	90	87
LCS	94	89	90	91
MS	93	87	90	90
MSD	93	87	90	91
<hr/>				
Limits:	81-120	82-112	85-112	83-113

*- Outside of specification

- (1) The result for one or both determinations was less than five times the LOQ.
- (2) The background result was more than four times the spike added.

Explanation of Symbols and Abbreviations

The following defines common symbols and abbreviations used in reporting technical data:

N.D.	none detected	BMQL	Below Minimum Quantitation Level
TNTC	Too Numerous To Count	MPN	Most Probable Number
IU	International Units	CP Units	cobalt-chloroplatinate units
umhos/cm	micromhos/cm	NTU	nephelometric turbidity units
C	degrees Celsius	F	degrees Fahrenheit
meq	milliequivalents	lb.	pound(s)
g	gram(s)	kg	kilogram(s)
ug	microgram(s)	mg	milligram(s)
ml	milliliter(s)	l	liter(s)
m3	cubic meter(s)	ul	microliter(s)

< less than - The number following the sign is the limit of quantitation, the smallest amount of analyte which can be reliably determined using this specific test.

> greater than

J estimated value – The result is \geq the Method Detection Limit (MDL) and $<$ the Limit of Quantitation (LOQ).

ppm parts per million - One ppm is equivalent to one milligram per kilogram (mg/kg), or one gram per million grams. For aqueous liquids, ppm is usually taken to be equivalent to milligrams per liter (mg/l), because one liter of water has a weight very close to a kilogram. For gases or vapors, one ppm is equivalent to one microliter of gas per liter of gas.

ppb parts per billion

Dry weight basis Results printed under this heading have been adjusted for moisture content. This increases the analyte weight concentration to approximate the value present in a similar sample without moisture. All other results are reported on an as-received basis.

U.S. EPA CLP Data Qualifiers:

Organic Qualifiers

A	TIC is a possible aldol-condensation product
B	Analyte was also detected in the blank
C	Pesticide result confirmed by GC/MS
D	Compound quantitated on a diluted sample
E	Concentration exceeds the calibration range of the instrument
N	Presumptive evidence of a compound (TICs only)
P	Concentration difference between primary and confirmation columns $>25\%$
U	Compound was not detected
X,Y,Z	Defined in case narrative

Inorganic Qualifiers

B	Value is $<CRDL$, but $\geq IDL$
E	Estimated due to interference
M	Duplicate injection precision not met
N	Spike sample not within control limits
S	Method of standard additions (MSA) used for calculation
U	Compound was not detected
W	Post digestion spike out of control limits
*	Duplicate analysis not within control limits
+	Correlation coefficient for MSA <0.995

Analytical test results for methods listed on the laboratories' accreditation scope meet all requirements of NELAC unless otherwise noted under the individual analysis.

Measurement uncertainty values, as applicable, are available upon request.

Tests results relate only to the sample tested. Clients should be aware that a critical step in a chemical or microbiological analysis is the collection of the sample. Unless the sample analyzed is truly representative of the bulk of material involved, the test results will be meaningless. If you have questions regarding the proper techniques of collecting samples, please contact us. We cannot be held responsible for sample integrity, however, unless sampling has been performed by a member of our staff. This report shall not be reproduced except in full, without the written approval of the laboratory.

WARRANTY AND LIMITS OF LIABILITY - In accepting analytical work, we warrant the accuracy of test results for the sample as submitted. THE FOREGOING EXPRESS WARRANTY IS EXCLUSIVE AND IS GIVEN IN LIEU OF ALL OTHER WARRANTIES, EXPRESSED OR IMPLIED. WE DISCLAIM ANY OTHER WARRANTIES, EXPRESSED OR IMPLIED, INCLUDING A WARRANTY OF FITNESS FOR PARTICULAR PURPOSE AND WARRANTY OF MERCHANTABILITY. IN NO EVENT SHALL LANCASTER LABORATORIES BE LIABLE FOR INDIRECT, SPECIAL, CONSEQUENTIAL, OR INCIDENTAL DAMAGES INCLUDING, BUT NOT LIMITED TO, DAMAGES FOR LOSS OF PROFIT OR GOODWILL REGARDLESS OF (A) THE NEGLIGENCE (EITHER SOLE OR CONCURRENT) OF LANCASTER LABORATORIES AND (B) WHETHER LANCASTER LABORATORIES HAS BEEN INFORMED OF THE POSSIBILITY OF SUCH DAMAGES. We accept no legal responsibility for the purposes for which the client uses the test results. No purchase order or other order for work shall be accepted by Lancaster Laboratories which includes any conditions that vary from the Standard Terms and Conditions of Lancaster Laboratories and we hereby object to any conflicting terms contained in any acceptance or order submitted by client.