



# GETTLER-RYAN INC.

## TRANSMITTAL

March 11, 2005

G-R #386473

TO: Mr. Bruce H. Eppler  
Cambria Environmental Technology, Inc.  
4111 Citrus Avenue, Suite 12  
Rocklin, California 95677

ALAMEDA COUNTY  
APR 08 2005  
E-MAIL

FROM: Deanna L. Harding  
Project Coordinator  
Gettler-Ryan Inc.  
6747 Sierra Court, Suite J  
Dublin, California 94568

RE: **Former Chevron Service Station  
#9-4612  
3616 San Leandro Street  
Oakland, California  
MTI: 61D-1996  
RO 0000233**

WE HAVE ENCLOSED THE FOLLOWING:

COPIES	DATED	DESCRIPTION
2	March 10, 2005	Groundwater Monitoring and Sampling Report First Quarter - Event of February 8, 2005

### COMMENTS:

Pursuant to your request, we are providing you with copies of the above referenced report for **your use and distribution to the following:**

Mr. Dana Thurman, ChevronTexaco Company, P.O. Box 6012, Room K2236, San Ramon, CA 94583

Please provide any comments/changes and propose any groundwater monitoring modifications for the next event prior to **March 28, 2005**, at which time the final report will be distributed to the following:

- cc: Mr. Barney Chan, Alameda County Health Care Services, Dept. of Environmental Health, 1131 Harbor Bay Parkway, Suite 250, Alameda, CA 94502-6577
- Mr. Leonard B. Ratto, Ratto Land Company, P.O. Box 6104, Oakland, CA 94603-0104
- Mr. Terry McIlraith, 407 Castello Road, Lafayette, CA 94549

Enclosures

trans/9-4612-DT



# GETTLER - RYAN INC.

March 10, 2005  
G-R Job #386473

Mr. Dana Thurman  
ChevronTexaco Company  
P.O. Box 6012, Room K2236  
San Ramon, CA 94583

**RE: First Quarter Event of February 8, 2005**  
Groundwater Monitoring & Sampling Report  
Former Chevron Service Station #9-4612  
3616 San Leandro Street  
Oakland, California

Dear Mr. Thurman:

This report documents the most recent groundwater monitoring and sampling event performed by Gettler-Ryan Inc. (G-R) at the referenced site. All field work was conducted in accordance with G-R Standard Operating Procedure - Groundwater Sampling (attached).

Static groundwater levels were measured and the wells were checked for the presence of separate-phase hydrocarbons. Static water level data, groundwater elevations, and separate-phase hydrocarbon thickness (if any) are presented in the attached Table 1. Dissolved Oxygen Concentrations are presented in Table 2. A Potentiometric Map is included as Figure 1.

Groundwater samples were collected from the monitoring wells and submitted to a state certified laboratory for analyses. The field data sheets for this event are attached. Analytical results are presented in the table(s) listed below. The chain of custody document and laboratory analytical report are also attached.

Please call if you have any questions or comments regarding this report. Thank you.

Sincerely,

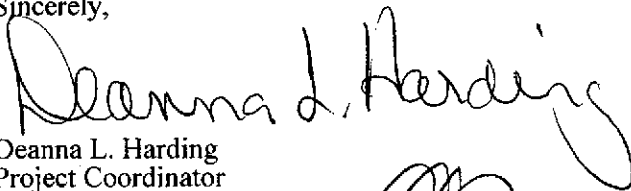
  
Deanna L. Harding  
Project Coordinator



Hagop Kevork  
P.E. No. C55734



Figure 1: Potentiometric Map  
Table 1: Groundwater Monitoring Data and Analytical Results  
Table 2: Dissolved Oxygen Concentrations  
Table 3: Groundwater Analytical Results - Oxygenate Compounds  
Attachments: Standard Operating Procedure - Groundwater Sampling  
Field Data Sheets  
Chain of Custody Document and Laboratory Analytical Reports

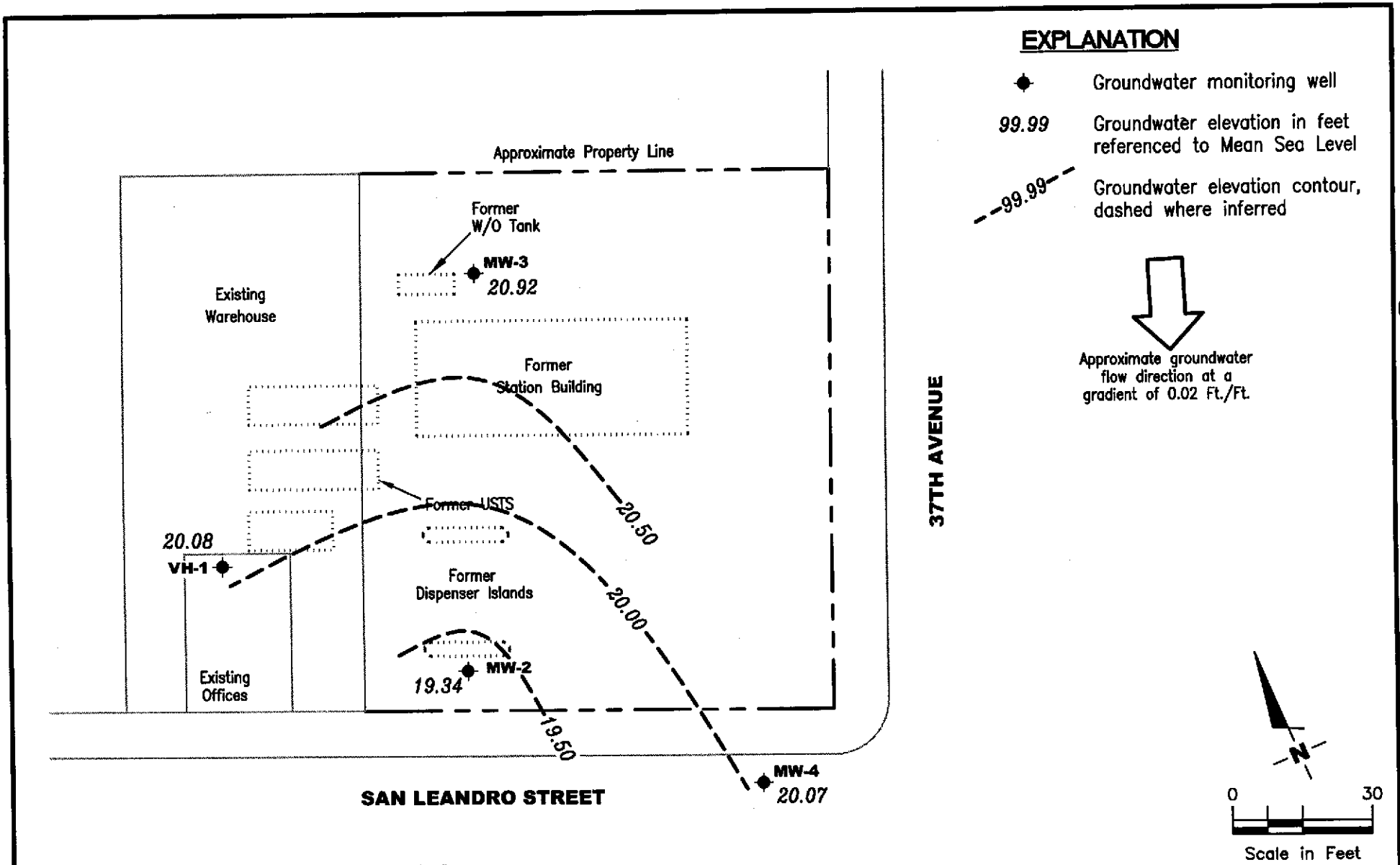

Source: Figure modified from drawing provided by RRM engineering contracting firm.

**GETTLER - RYAN INC.**  
 6747 Sierra Court, Suite J  
 Dublin, CA 94568 (925) 551-7555

**POTENTIOMETRIC MAP**  
 Former Chevron Service Station #9-4612  
 3616 San Leandro Street  
 Oakland, California

FIGURE  
**1**

PROJECT NUMBER  
**386473**

REVIEWED BY

DATE  
 February 8, 2005

REVISED DATE

**Table 1**  
**Groundwater Monitoring Data and Analytical Results**  
Former Chevron Service Station #9-4612  
3616 San Leandro Street  
Oakland, California

WELL ID/ DATE	TOC* (ft.)	GWE (msl)	DTW (ft.)	TPH-D (ppb)	TPH-G (ppb)	B (ppb)	T (ppb)	E (ppb)	X (ppb)	MTBE (ppb)	TOG (ppb)
<b>VH-1</b>											
08/10/88	--	--	13.00	--	11,000	3,300	200	520	540	--	--
06/01/89	--	--	10.32	--	15,000	2,200	120	540	310	--	--
09/15/89	--	--	15.69	--	5,600	1,900	90	350	160	--	--
12/08/89	--	--	14.77	--	11,000	1,900	69	270	99	--	--
03/07/91	--	--	11.26	--	4,500	820	39	120	77	--	--
09/24/91	--	--	12.98	--	3,300	520	19	39	27	--	--
01/08/92	--	--	13.77	--	5,000	600	34	81	76	--	--
04/20/92	--	--	8.18	--	7,400	670	60	110	140	--	--
03/26/93	27.85	21.14	6.71	--	4,900	600	40	72	94	--	--
05/27/93	27.85	19.27	8.58	--	13,000	1,600	120	230	220	--	--
08/18/93	27.85	17.39	10.46	--	2,700	210	10	8.1	18	--	--
11/03/93	27.85	15.28	12.57	--	4,600	680	42	35	68	--	--
02/10/94	27.85	18.77	9.08	--	1,900	260	19	22	29	--	--
05/12/94	27.85	19.76	8.09	--	2,000	390	28	3.9	29	--	--
08/26/94	27.85	17.10	10.75	--	4,900	500	<5.0	23	31	--	--
11/14/94	27.85	18.40	9.45	300	760	69	<2.0	<2.0	2.2	--	--
02/01/95	27.85	21.88	5.97	--	1,300	120	5.9	<0.5	13	--	--
05/12/95	27.85	20.14	7.71	--	4,400	460	31	45	49	--	--
08/22/95	27.85	18.59	9.26	--	2,900	310	15	28	32	--	--
12/19/95	27.85	19.05	8.80	--	930	53	<2.5	<2.5	<2.5	39	--
01/31/96	27.85	22.35	5.50	--	3,700	320	<10	41	40	180	--
04/30/96	27.85	19.81	8.04	--	3,900	270	<20	<20	<20	120	--
08/01/96	27.85	18.67	9.18	--	2,700	140	11	18	28	200	--
10/30/96	27.85	18.67	10.76	--	2,700	140	<12	<12	<12	280	--
02/07/97	27.85	19.75	8.10	--	220	13	0.6	<0.5	1.6	15	--
05/07/97	27.85	18.33	9.52	--	5,200	33	12	21	26	330	--
07/22/97	27.85	17.43	10.42	--	4,200	80	<10	16	24	400	--
11/03/97	27.85	16.85	11.00	--	2,400	150	6.8	6.5	9.5	510	--
01/28/98	27.85	20.75	7.10	--	850	69	4.8	5.0	11	38/48 <sup>12</sup>	--
05/08/98	27.85	20.14	7.71	--	4,200	200	30	40	42	310/200 <sup>12</sup>	--
07/29/98	27.85	18.40	9.45	--	3,800	54	10	27	30	35/290 <sup>12</sup>	--
11/06/98	27.85	17.15	10.70	--	4,800	100	20	12	23	360/210 <sup>12</sup>	--
02/09/99 <sup>5</sup>	27.85	21.87	5.98	--	2,950	79.5	<10	<10	<10	435/312 <sup>12</sup>	--

**Table 1**  
**Groundwater Monitoring Data and Analytical Results**  
Former Chevron Service Station #9-4612  
3616 San Leandro Street  
Oakland, California

WELL ID/ DATE	TOC* (ft.)	GWE (msl)	DTW (ft.)	TPH-D (ppb)	TPH-G (ppb)	B (ppb)	T (ppb)	E (ppb)	X (ppb)	MTBE (ppb)	TOG (ppb)
<b>VH-1 (cont)</b>											
05/13/99	27.85	19.71	8.14	--	4,180	147	12.8	16.5	20.3	433245 <sup>12</sup>	--
09/07/99	27.85	17.94	9.91	--	2,750	57.6	<5.0	6.53	<5.0	297/233 <sup>12</sup>	--
11/24/99	27.85	17.36	10.49	--	2,550	38	3.18	2.54	5.21	--/216 <sup>1,12</sup>	--
02/25/00	27.85	21.20	6.65	--	120	2.7	<0.5	<0.5	<0.5	20.5/11.9 <sup>12</sup>	--
05/10/00	27.85	19.76	8.09	--	1,400 <sup>8</sup>	63	3.3	3.1	4.9	230/110 <sup>12</sup>	--
7/31/00 <sup>11</sup>	27.85	18.30	9.55	--	360 <sup>8</sup>	22	2.7	1.6	3.1	100/88 <sup>12</sup>	--
10/30/00 <sup>11</sup>	27.85	17.91	9.94	--	987 <sup>10</sup>	47.0	1.00	<0.500	1.80	153/130 <sup>12</sup>	--
02/05/01	27.91	19.23	8.68	--	2,670	42.7	<5.00	<5.00	<5.00	225/160 <sup>12</sup>	--
05/07/01 <sup>11</sup>	27.91	19.61	8.30	--	1,800 <sup>6</sup>	100	8.2	10	7.9	440/110 <sup>12</sup>	--
08/06/01 <sup>11</sup>	27.91	18.09	9.82	--	1,000 <sup>6</sup>	67	6.1	2.1	7.1	270/140 <sup>12</sup>	--
11/12/01 <sup>11</sup>	27.91	17.29	10.62	--	220	1.2	<0.50	<0.50	<1.5	63/61 <sup>12</sup>	--
02/11/02 <sup>11</sup>	27.91	19.83	8.08	--	1,700	33	<5.0	6.3	3.8	64/52 <sup>12</sup>	--
05/13/02 <sup>11</sup>	27.91	19.21	8.70	--	2,700	54	4.1	5.6	6.2	100/80 <sup>12</sup>	--
08/09/02 <sup>11</sup>	27.91	18.50	9.41	--	2,400	37	2.4	1.2	3.4	86/89 <sup>12</sup>	--
11/07/02 <sup>11</sup>	27.91	17.34	10.57	--	150	1.3	<0.50	<0.50	<1.5	56/50 <sup>12</sup>	--
02/04/03 <sup>11</sup>	27.91	19.63	8.28	--	1,700	40	3.1	7.8	5.0	100/53 <sup>12</sup>	--
05/05/03 <sup>11</sup>	27.91	20.41	7.50	--	2,100	44	3.4	3.7	5.2	96/62 <sup>12</sup>	--
09/06/03 <sup>11,14</sup>	27.91	18.31	9.60	--	690	7	0.6	<0.5	0.6	59	--
11/14/03 <sup>11,14</sup>	27.91	17.99	9.92	--	1,000	3	0.6	2	0.7	47	--
02/13/04 <sup>14,15</sup>	27.91	19.98	7.93	--	2,400	30	2	4	3	47	--
05/13/04 <sup>14</sup>	27.91	19.24	8.67	--	1,900	49	4	3	5	74	--
08/17/04 <sup>14</sup>	27.91	18.26	9.65	--	1,800	11	1	0.9	2	58	--
11/10/04	27.91	INACCESSIBLE	--	--	--	--	--	--	--	--	--
02/08/05 <sup>14</sup>	27.91	20.08	7.83	--	2,700	26	3	4	5	48	--
<b>MW-2</b>											
02/16/93	27.51	--	--	--	9,200	720	110	250	170	--	--
03/26/93	27.51	19.89	7.62	--	--	--	--	--	--	--	--
05/27/93	27.51	18.04	9.47	--	360	5.3	2.1	1.8	2.5	--	--
08/18/93	27.51	16.46	11.05	--	9,400	1,100	76	110	100	--	--
11/03/93	27.51	14.56	12.95	--	8,600	390	20	2.7	120	--	--
02/10/94	27.51	17.72	9.79	--	2,700	370	38	44	41	--	--

**Table 1**  
**Groundwater Monitoring Data and Analytical Results**  
Former Chevron Service Station #9-4612  
3616 San Leandro Street  
Oakland, California

WELL ID/ DATE	TOC* (ft.)	GWE (msl)	DTW (ft.)	TPH-D (ppb)	TPH-G (ppb)	B (ppb)	T (ppb)	E (ppb)	X (ppb)	MTBE (ppb)	TOG (ppb)
<b>MW-2 (cont)</b>											
05/12/94	27.51	18.59	8.92	--	3,800	650	76	15	62	--	--
08/26/94	27.51	16.14	11.37	--	16,000	1,300	270	28	120	--	--
11/14/94	27.51	17.48	10.03	--	5,100	390	10	43	27	--	--
02/01/95	27.51	20.47	7.04	--	6,900	520	82	170	110	--	--
05/12/95	27.51	18.76	8.75	--	7,700	510	83	110	100	--	--
08/22/95	27.51	17.35	10.16	--	4,500	220	16	61	47	--	--
12/19/95	27.51	18.05	9.46	--	2,900	240	<10	19	18	220	--
01/31/96	27.51	21.91	5.60	--	3,900	320	18	72	39	<25	--
04/30/96	27.51	18.68	8.83	--	5,600	200	36	55	47	170	--
08/01/96	27.51	17.25	10.26	--	6,200	190	15	62	59	220	--
10/30/96	27.51	17.25	11.48	--	5,700	190	<25	67	36	260	--
02/07/97	27.51	18.11	9.40	--	8,300	210	34	70	59	330	--
05/07/97	27.51	17.57	9.94	--	6,900	190	12	38	37	530	--
07/22/97	27.51	16.36	11.15	--	10,000	18	25	62	41	630	--
11/03/97	27.51	15.93	11.58	--	6,500	260	8.5	26	14	590/9.6 <sup>4,12</sup>	--
01/28/98	27.51	19.38	8.13	--	6,700	65	13	67	54	280/94 <sup>12</sup>	--
05/08/98	27.51	18.89	8.62	--	5,500	91	38	43	61	220/62 <sup>12</sup>	--
07/29/98	27.51	17.06	10.45	--	3,600	41	8.9	3.6	14	16/94 <sup>12</sup>	--
11/06/98	27.51	15.89	11.62	--	6,900	77	<5.0	14	17	290/110 <sup>12</sup>	--
02/09/99 <sup>5</sup>	27.51	20.61	6.90	--	8,070	75.6	<10	<10	<10	397/144 <sup>12</sup>	--
05/13/99	27.51	18.21	9.30	--	5,890	120	<5.0	12.5	26.6	401/69.4 <sup>12</sup>	--
09/07/99	27.51	16.57	10.94	--	5,820	41.2	<5.0	14.6	<5.0	260/145 <sup>12</sup>	--
11/24/99	27.51	15.98	11.53	--	5,940	40.9	<10	10.8	<10	--/120 <sup>1,12</sup>	--
02/25/00	27.51	21.00	6.51	--	6,370	101	9.37	39.8	33.2	321/121 <sup>12</sup>	--
05/10/00	27.51	18.49	9.02	--	6,100 <sup>8</sup>	110	13	27	31	560/120 <sup>12</sup>	--
07/31/00 <sup>11</sup>	27.51	17.18	10.33	--	3,000 <sup>8</sup>	75	14	28	28	200/130 <sup>12</sup>	--
10/30/00 <sup>11</sup>	27.51	16.95	10.56	--	6,810 <sup>10</sup>	162	<5.00	8.05	<15.0	372/140 <sup>12</sup>	--
02/05/01 <sup>11</sup>	28.05	18.47	9.58	--	5,860	28.4	6.86	16.2	11.8	285/140 <sup>12</sup>	--
05/07/01 <sup>11</sup>	28.05	18.85	9.20	--	4,700 <sup>6</sup>	120	15	30	42	540/88 <sup>12</sup>	--
08/06/01 <sup>11</sup>	28.05	17.31	10.74	--	3,700 <sup>6</sup>	120	<20	28	33	490/110 <sup>12</sup>	--
11/12/01 <sup>11</sup>	28.05	16.60	11.45	--	7,000	29	<10	27	22	93/98 <sup>12</sup>	--
02/11/02 <sup>11</sup>	28.05	18.99	9.06	--	5,900	43	15	24	27	90/86 <sup>12</sup>	--
05/13/02 <sup>11</sup>	28.05	18.41	9.64	--	5,500	26	5.2	23	26	120/47 <sup>12</sup>	--

**Table 1**  
**Groundwater Monitoring Data and Analytical Results**  
Former Chevron Service Station #9-4612  
3616 San Leandro Street  
Oakland, California

WELL ID/ DATE	TOC* (ft.)	GWE (mst)	DTW (ft.)	TPH-D (ppb)	TPH-C (ppb)	B (ppb)	T (ppb)	E (ppb)	X (ppb)	MTBE (ppb)	TOG (ppb)
<b>MW-2 (cont)</b>											
08/09/02 <sup>11</sup>	28.05	17.76	10.29	--	5,700	26	3.7	26	50	100/69 <sup>12</sup>	--
11/07/02 <sup>11</sup>	28.05	16.78	11.27	--	5,900	33	4.4	23	21	<100/69 <sup>12</sup>	--
02/04/03 <sup>11</sup>	28.05	18.92	9.13	--	5,400	22	4.7	13	14	<50/55 <sup>12</sup>	--
05/05/03 <sup>11</sup>	28.05	19.67	8.38	--	4,500	23	4.7	12	15	<50/31 <sup>12</sup>	--
09/06/03 <sup>11,14</sup>	28.05	17.65	10.40	--	3,200	13	2	7	7	54	--
11/14/03 <sup>11,14</sup>	28.05	17.43	10.62	--	4,000	11	2	7	6	55	--
02/13/04 <sup>14,15</sup>	28.05	19.26	8.79	--	6,200	6	2	8	8	31	--
05/13/04 <sup>14</sup>	28.05	18.49	9.56	--	3,200	6	3	13	11	34	--
08/17/04 <sup>14</sup>	28.05	17.57	10.48	--	4,300	7	1	6	5	46	--
11/10/04 <sup>14</sup>	28.05	18.52	9.53	--	3,000	5	1	6	7	37	--
02/08/05 <sup>14</sup>	28.05	19.34	8.71	--	4,700	3	2	10	8	22	--
<b>MW-3</b>											
02/16/93	28.50	--	--	--	3,500	<0.5	8.1	4.6	7.7	--	--
03/26/93	28.50	21.32	7.18	--	--	--	--	--	--	--	--
05/27/93	28.50	19.17	9.33	--	4,200	580	84	150	100	--	--
08/18/93	28.50	16.50	12.00	1,400	910	12	3.7	6.2	3.8	--	<5,000
11/03/93	28.50	15.21	13.29	--	5,300	29	1.9	0.6	27	--	--
02/10/94	28.50	18.87	9.63	<50	63	<0.5	0.7	<0.5	<0.5	--	--
05/12/94	28.50	19.73	8.77	84	<50	<0.5	0.5	<0.5	<0.5	--	--
08/26/94	28.50	17.08	11.42	--	2,100	12	<0.5	5.0	0.5	--	--
11/14/94	28.50	18.43	10.07	--	140	0.78	<0.5	<0.5	<0.5	--	--
02/01/95	28.50	22.21	6.29	<50	<50	<0.5	<0.5	<0.5	<0.5	--	--
05/12/95	28.50	20.43	8.07	540 <sup>2</sup>	330	13	1.1	1.9	0.69	--	--
08/22/95	28.50	18.55	9.95	550 <sup>2</sup>	980	32	<1.0	<1.0	<1.0	--	--
12/19/95	28.50	19.10	9.40	<50	<50	<0.5	<0.5	<0.5	<0.5	<2.5	--
01/31/96	28.50	23.45	5.05	<50	<50	<0.5	<0.5	<0.5	<0.5	<2.5	--
04/30/96	28.50	20.10	8.40	240 <sup>2</sup>	320	2.4	<0.5	0.75	<0.5	7.8	--
08/01/96	28.50	18.70	9.80	470 <sup>2</sup>	980	9.6	<0.5	0.98	2.2	54	--
10/30/96	28.50	18.70	11.48	760 <sup>2</sup>	2,000	14	<10	<10	<10	140	--
02/07/97	28.50	19.90	8.60	61 <sup>2</sup>	200 <sup>2</sup>	<0.5	<0.5	<0.5	<0.5	8.9	--
05/07/97	28.50	19.49	9.01	550 <sup>2</sup>	3,500	14	3.9	3.6	8.0	160	--

**Table 1**  
**Groundwater Monitoring Data and Analytical Results**  
Former Chevron Service Station #9-4612  
3616 San Leandro Street  
Oakland, California

WELL ID/ DATE	TOC* (ft.)	GWE (msl)	DTW (ft.)	TPH-D (ppb)	TPH-G (ppb)	B (ppb)	T (ppb)	E (ppb)	X (ppb)	MTBE (ppb)	TOG (ppb)
<b>MW-3 (cont)</b>											
07/22/97	28.50	17.38	11.12	800 <sup>2</sup>	3,500	55	<10	<10	<10	150	--
11/03/97	28.50	16.99	11.51	910 <sup>2</sup>	4,100	140	<5.0	<5.0	<5.0	380	--
01/28/98	28.50	21.16	7.34	--	1,100	24	<1.2	<1.2	2.8	33/6.1 <sup>12</sup>	--
05/08/98	28.50	20.44	8.06	250 <sup>2</sup>	990	3.6	7.7	0.7	2.2	37/7.5 <sup>12</sup>	--
07/29/98	28.50	18.25	10.25	290 <sup>2</sup>	1,200	13	<0.5	<0.5	1.4	11/28 <sup>12</sup>	--
11/06/98	28.50	17.11	11.39	390 <sup>2</sup>	2,600	5.3	<2.5	<2.5	3.0	91/41 <sup>12</sup>	--
02/09/99 <sup>5</sup>	28.50	22.40	6.10	184 <sup>2</sup>	406	<1.0	4.03	<1.0	<1.0	17.7/1.97 <sup>12</sup>	--
05/13/99	28.50	19.38	9.12	--	615	13.8	1.05	<0.5	<0.5	43.5/21.2 <sup>12</sup>	--
09/07/99	28.50	17.77	10.73	528 <sup>2</sup>	2,710	<5.0	<5.0	<5.0	<5.0	96.3/57.9 <sup>12</sup>	--
11/24/99	28.50	17.37	11.13	1,070 <sup>2</sup>	5,530	<5.0	<5.0	5.59	<5.0	--/66 <sup>1,12</sup>	--
02/25/00	28.50	22.22	6.28	--	189	4.68	<0.5	<0.5	<0.5	11.9/<2.0 <sup>12</sup>	--
03/01/00	28.50	21.80	6.70	380 <sup>2</sup>	--	--	--	--	--	--	--
05/10/00	28.50	19.90	8.60	830 <sup>7</sup>	1,600 <sup>6</sup>	22	<10	<10	<10	100/51 <sup>12</sup>	--
07/31/00 <sup>11</sup>	28.50	18.43	10.07	490 <sup>7</sup>	2,200 <sup>6</sup>	76	10	<5.0	13	230/52 <sup>12</sup>	--
10/30/00 <sup>11</sup>	28.50	17.97	10.53	580 <sup>9</sup>	3,320 <sup>10</sup>	<5.00	<5.00	<5.00	<15.0	147/64 <sup>12</sup>	--
02/05/01 <sup>11</sup>	29.04	19.78	9.26	--	3,960	<5.00	6.02	<5.00	<5.00	159/70 <sup>12</sup>	--
05/07/01 <sup>11</sup>	29.04	20.29	8.75	--	2,800 <sup>6</sup>	61	12	<10	20	230/49 <sup>12</sup>	--
05/10/01 <sup>11</sup>	29.04	20.21	8.83	390 <sup>13</sup>	--	--	--	--	--	--	--
08/06/01 <sup>11</sup>	29.04	18.59	10.45	870 <sup>7</sup>	1,600 <sup>6</sup>	39	14	1.3	5.6	130/43 <sup>12</sup>	--
11/12/01 <sup>11</sup>	29.04	17.82	11.22	1,400	3,100	3.6	23	2.3	5.6	40/46 <sup>12</sup>	--
02/11/02 <sup>11</sup>	29.04	20.66	8.38	700	4,000	10	<5.0	4.2	5.5	44/42 <sup>12</sup>	--
05/13/02 <sup>11</sup>	29.04	19.84	9.20	730	2,500	18	<5.0	<5.0	5.2	44/32 <sup>12</sup>	--
08/09/02 <sup>11</sup>	29.04	18.87	10.17	560	2,700	17	<5.0	<5.0	<10	45/33 <sup>12</sup>	--
11/07/02 <sup>11</sup>	29.04	17.91	11.13	660	2,600	24	<5.0	2.0	4.8	51/37 <sup>12</sup>	--
02/04/03 <sup>11</sup>	29.04	20.44	8.60	370	2,200	13	1.5	2.7	5.0	<50/24 <sup>12</sup>	--
05/05/03 <sup>11</sup>	29.04	21.22	7.82	580	2,100	14	1.8	2.0	3.9	<20/19 <sup>12</sup>	--
09/06/03 <sup>11,14</sup>	29.04	18.79	10.25	780	1,800	2	0.6	0.6	1	28	--
11/14/03 <sup>11,14</sup>	29.04	18.52	10.52	860	2,000	1	0.6	0.6	0.9	30	--
02/13/04 <sup>14,15</sup>	29.04	20.76	8.28	590	3,600	1	0.6	1	2	21	--
05/13/04 <sup>14</sup>	29.04	19.87	9.17	670	1,600	1	<0.5	0.5	1	20	--
08/17/04 <sup>14</sup>	29.04	18.79	10.25	900	2,500	1	<0.5	<0.5	0.7	25	--
11/10/04 <sup>14</sup>	29.04	19.81	9.23	780	1,500	1	0.6	0.5	1	27	--
02/08/05 <sup>14</sup>	29.04	20.92	8.12	530	2,500	1	0.6	2	3	11	--



**Table 1**  
**Groundwater Monitoring Data and Analytical Results**  
Former Chevron Service Station #9-4612  
3616 San Leandro Street  
Oakland, California

WELL ID/ DATE	TOC* (ft.)	GWE (msl)	DTW (ft.)	TPH-D (ppb)	TPH-G (ppb)	B (ppb)	T (ppb)	E (ppb)	X (ppb)	MTBE (ppb)	TOG (ppb)
<b>MW-4</b>											
08/22/95	27.27	18.16	9.11	--	9,600	100	<10	<10	<10	--	--
12/19/95	27.27	18.97	8.30	--	<50	<0.5	<0.5	<0.5	<0.5	<2.5	--
01/31/96	27.27	21.67	5.60	--	<50	<0.5	<0.5	<0.5	<0.5	<2.5	--
04/30/96	27.27	20.27	7.00	--	<50	<0.5	<0.5	<0.5	<0.5	<2.5	--
08/01/96	27.27	18.12	9.15	--	<50	<0.5	<0.5	<0.5	<0.5	--	--
10/30/96	27.27	18.12	10.74	--	110	<0.5	<0.5	<0.5	<0.5	<2.5	--
02/07/97	27.27	19.47	7.80	--	80	<0.5	<0.5	<0.5	<0.5	4.1	--
05/07/97	27.27	21.42	5.85	--	<50	<0.5	<0.5	<0.5	<0.5	<2.5	--
07/22/97	27.27	17.22	10.05	--	150	<0.5	<0.5	<0.5	<0.5	<2.5	--
11/03/97	27.27	16.55	10.72	--	52	0.9	<0.5	<0.5	<0.5	-- <sup>3</sup>	--
01/28/98	27.27	20.76	6.51	--	<50	<0.5	<0.5	<0.5	<0.5	<2.5/<2.0 <sup>12</sup>	--
05/08/98	27.27	20.25	7.02	--	56	<0.5	<0.5	<0.5	<0.5	<2.5/<2.0 <sup>12</sup>	--
07/29/98	27.27	18.32	8.95	--	<50	0.9	<0.5	<0.5	<0.5	<2.5/<2.0 <sup>12</sup>	--
11/06/98	27.27	16.68	10.59	--	72	<0.5	<0.5	<0.5	<0.5	<2.5/<2.0 <sup>12</sup>	--
02/09/99	27.27	21.41	5.86	--	<50	<0.5	<0.5	<0.5	<0.5	<2.0/<1.1 <sup>12</sup>	--
05/13/99	27.27	19.32	7.95	--	<50	<0.5	<0.5	<0.5	<0.5	<5.0/<2.0 <sup>12</sup>	--
09/07/99	27.27	17.79	9.48	--	70.2	<0.5	<0.5	<0.5	<0.5	<2.0/<1.0 <sup>12</sup>	--
11/24/99	27.27	17.22	10.05	--	227	<0.5	<0.5	<0.5	<0.5	--/<0.5 <sup>12</sup>	--
02/25/00	27.27	INACCESSIBLE		--	--	--	--	--	--	--	--
03/01/00	27.27	21.10	6.17	--	<50	<0.5	<0.5	<0.5	<0.5	<2.5/<2.0 <sup>12</sup>	--
05/10/00	27.27	INACCESSIBLE - CAR PARKED OVER WELL				--	--	--	--	--	--
07/31/00	27.27	17.90	9.37	--	<50	<0.50	<0.50	<0.50	<0.50	<2.5/<2.0 <sup>12</sup>	--
10/30/00	27.27	17.80	9.47	--	54.0 <sup>10</sup>	<0.500	<0.500	<0.500	<1.50	<2.50/<2.0 <sup>12</sup>	--
02/05/01	27.27	INACCESSIBLE - CAR PARKED OVER WELL				--	--	--	--	--	--
05/07/01	27.27	19.46	7.81	--	<50	<0.50	<0.50	<0.50	<0.50	<2.5/<2.0 <sup>12</sup>	--
08/06/01	27.27	17.49	9.78	--	<50	1.1	0.52	<0.50	1.1	6.0/<2.0 <sup>12</sup>	--
11/12/01	27.27	16.86	10.41	--	93	<0.50	<0.50	<0.50	<1.5	<2.5/<2 <sup>12</sup>	--
02/11/02	27.27	19.63	7.64	--	<50	<0.50	<0.50	<0.50	<1.5	<2.5/<2 <sup>12</sup>	--
05/13/02	27.27	18.95	8.32	--	54	<0.50	0.84	<0.50	<1.5	<2.5/<2 <sup>12</sup>	--
08/09/02	27.27	18.02	9.25	--	54	<0.50	<0.50	<0.50	<1.5	<2.5/<2 <sup>12</sup>	--
11/07/02	27.27	16.85	10.42	--	<50	<0.50	<0.50	<0.50	<1.5	<2.5/<2 <sup>12</sup>	--
02/04/03	27.27	19.52	7.75	--	<50	<0.50	<0.50	<0.50	<1.5	<2.5/<0.5 <sup>12</sup>	--
05/05/03	27.27	20.37	6.90	--	<50	<0.5	<0.5	<0.5	<1.5	<2.5/<0.5 <sup>12</sup>	--

**Table 1**  
**Groundwater Monitoring Data and Analytical Results**  
Former Chevron Service Station #9-4612  
3616 San Leandro Street  
Oakland, California

WELL ID/ DATE	TOC* (ft.)	GWE (msl)	DTW (ft.)	TPH-D (ppb)	TPH-G (ppb)	B (ppb)	T (ppb)	E (ppb)	X (ppb)	MTBE (ppb)	TOG (ppb)
<b>MW-4 (cont)</b>											
09/06/03 <sup>14</sup>	27.27	17.77	9.50	--	<50	<0.5	<0.5	<0.5	<0.5	<0.5	--
11/14/03 <sup>14</sup>	27.27	17.47	9.80	--	<50	<0.5	<0.5	<0.5	<0.5	<0.5	--
02/13/04 <sup>14</sup>	27.27	19.91	7.36	--	<50	<0.5	<0.5	<0.5	<0.5	<0.5	--
05/13/04 <sup>14</sup>	27.27	18.99	8.28	--	<50	<0.5	<0.5	<0.5	<0.5	<0.5	--
08/17/04 <sup>14</sup>	27.27	17.64	9.63	--	<50	<0.5	<0.5	<0.5	<0.5	<0.5	--
11/10/04 <sup>14</sup>	27.27	18.81	8.46	--	52	<0.5	<0.5	<0.5	<0.5	<0.5	--
02/08/05 <sup>14</sup>	27.27	20.07	7.20	--	<50	<0.5	<0.5	<0.5	<0.5	<0.5	--
<b>TRIP BLANK</b>											
05/27/93	--	--	--	--	<50	<0.5	<0.5	<0.5	<1.5	--	--
08/18/93	--	--	--	1,400	<50	<0.5	<0.5	<0.5	<1.5	--	<5,000
11/03/93	--	--	--	--	<50	<0.5	<0.5	<0.5	<0.5	--	--
02/10/94	--	--	--	<50	<50	<0.5	<0.5	<0.5	<0.5	--	--
05/12/94	--	--	--	84	<50	<0.5	<0.5	<0.5	<0.5	--	--
08/26/94	--	--	--	--	<50	<0.5	<0.5	<0.5	<0.5	--	--
11/14/94	--	--	--	--	<50	<0.5	<0.5	<0.5	<0.5	--	--
02/01/95	--	--	--	--	<50	<0.5	<0.5	<0.5	<0.5	--	--
05/12/95	--	--	--	--	<50	<0.5	<0.5	<0.5	<0.5	--	--
08/22/95	--	--	--	--	<50	<0.5	<0.5	<0.5	<0.5	--	--
12/19/95	--	--	--	--	<50	<0.5	<0.5	<0.5	<0.5	<2.5	--
01/31/96	--	--	--	--	<50	<0.5	<0.5	<0.5	<0.5	<2.5	--
04/30/96	--	--	--	--	<50	<0.5	<0.5	<0.5	<0.5	<2.5	--
08/01/96	--	--	--	--	<50	<0.5	<0.5	<0.5	<0.5	<2.5	--
10/30/96	--	--	--	--	<50	<0.5	<0.5	<0.5	<0.5	<2.5	--
02/07/97	--	--	--	--	<50	<0.5	<0.5	<0.5	<0.5	<2.5	--
05/07/97	--	--	--	--	<50	<0.5	<0.5	<0.5	<0.5	<2.5	--
07/22/97	--	--	--	--	<50	<0.5	<0.5	<0.5	<0.5	<2.5	--
01/28/98	--	--	--	--	<50	<0.5	<0.5	<0.5	<0.5	--/ <2.0 <sup>12</sup>	--
05/08/98	--	--	--	--	--	--	--	--	--	--/ <2.0 <sup>12</sup>	--
07/29/98	--	--	--	--	<50	<0.5	<0.5	<0.5	<0.5	--/ <2.0 <sup>12</sup>	--
11/06/98	--	--	--	--	<50	<0.5	<0.5	<0.5	<0.5	<2.5	--
02/09/99	--	--	--	--	<50	<0.5	<0.5	<0.5	<0.5	<2.0	--

**Table 1**  
**Groundwater Monitoring Data and Analytical Results**  
Former Chevron Service Station #9-4612  
3616 San Leandro Street  
Oakland, California

WELL ID/ DATE	TOC* (ft.)	GWE (mst)	DTW (ft.)	TPH-D (ppb)	TPH-G (ppb)	B (ppb)	T (ppb)	E (ppb)	X (ppb)	MTBE (ppb)	TOG (ppb)
<b>TRIP BLANK (cont)</b>											
05/13/99	--	--	--	--	<50	<0.5	<0.5	<0.5	<0.5	<5.0/<2.0 <sup>12</sup>	--
09/07/99	--	--	--	--	<50	<0.5	<0.5	<0.5	<0.5	<2.0	--
11/24/99	--	--	--	--	<50	<0.5	<0.5	<0.5	<0.5	<2.5	--
02/25/00	--	--	--	--	<50	<0.5	<0.5	<0.5	<0.5	<5.0	--
03/01/00	--	--	--	--	<50	<0.5	<0.5	<0.5	<0.5	<2.5	--
05/10/00	--	--	--	--	<50	<0.50	<0.50	<0.50	<0.50	<2.5	--
07/31/00	--	--	--	--	<50	<0.50	<0.50	<0.50	<0.50	<2.5	--
10/30/00	--	--	--	--	<50.0	<0.500	<0.500	<0.500	<1.50	<2.50	--
02/05/01	--	--	--	--	<50.0	<0.500	<0.500	<0.500	<0.500	<2.50	--
05/07/01	--	--	--	--	<50	<0.50	<0.50	<0.50	<0.50	<2.5	--
05/10/01	--	--	--	--	<50	<0.50	<0.50	<0.50	<0.50	<2.5	--
08/06/01	--	--	--	--	<50	<0.50	<0.50	<0.50	<0.50	<2.5	--
<b>QA</b>											
11/12/01	--	--	--	--	<50	<0.50	<0.50	<0.50	<1.5	<2.5	--
02/11/02	--	--	--	--	<50	<0.50	<0.50	<0.50	<1.5	<2.5	--
05/13/02	--	--	--	--	<50	<0.50	<0.50	<0.50	<1.5	<2.5	--
08/09/02	--	--	--	--	<50	<0.50	<0.50	<0.50	<1.5	<2.5	--
11/07/02	--	--	--	--	<50	<0.50	<0.50	<0.50	<1.5	<2.5	--
02/04/03	--	--	--	--	<50	<0.50	<0.50	<0.50	<1.5	<2.5	--
05/05/03	--	--	--	--	<50	<0.5	<0.5	<0.5	<1.5	<2.5	--
09/06/03 <sup>14</sup>	--	--	--	--	<50	<0.5	<0.5	<0.5	<0.5	<0.5	--
11/14/03 <sup>14</sup>	--	--	--	--	<50	<0.5	<0.5	<0.5	<0.5	<0.5	--
02/13/04 <sup>14</sup>	--	--	--	--	<50	<0.5	<0.5	<0.5	<0.5	<0.5	--
05/13/04 <sup>14</sup>	--	--	--	--	<50	<0.5	<0.5	<0.5	<0.5	<0.5	--
08/17/04 <sup>14</sup>	--	--	--	--	<50	<0.5	<0.5	<0.5	<0.5	<0.5	--
11/10/04 <sup>14</sup>	--	--	--	--	<50	<0.5	<0.5	<0.5	<0.5	<0.5	--
02/08/05 <sup>14</sup>	--	--	--	--	<50	<0.5	<0.5	<0.5	<0.5	<0.5	--

**Table 1**  
**Groundwater Monitoring Data and Analytical Results**  
Former Chevron Service Station #9-4612  
3616 San Leandro Street  
Oakland, California

**EXPLANATIONS:**

Groundwater monitoring data and laboratory analytical results prior to May 10, 2000, were compiled from reports prepared by Blaine Tech Services, Inc.

TOC = Top of Casing (ft.) = Feet	TPH-G = Total Petroleum Hydrocarbons as Gasoline B = Benzene	TOG = Total Oil and Grease (ppb) = Parts per billion
GWE = Groundwater Elevation (msl) = Mean sea level	T = Toluene E = Ethylbenzene	-- = Not Measured/Not Analyzed
DTW = Depth to Water	X = Xylenes	QA = Quality Assurance/Trip Blank
TPH-D = Total Petroleum Hydrocarbons as Diesel	MTBE = Methyl tertiary butyl ether	

- \* TOC elevations were re-surveyed on March 8, 2001, by Virgil Chavez Land Surveying. The benchmark for the survey was a City of Oakland benchmark, being a cut square top of curb at the centerline return at the northwest corner of East 14th and 37th Avenue, (Benchmark Elevation = 38.21 feet, NGVD 29).
- <sup>1</sup> Lab could not get a good ion chromatogram match for MTBE. See laboratory report.
- <sup>2</sup> Chromatogram pattern indicates an unidentified hydrocarbon.
- <sup>3</sup> No value for MTBE could be determined; see lab report for analyses.
- <sup>4</sup> Confirmation run.
- <sup>5</sup> ORC was installed.
- <sup>6</sup> Laboratory report indicates gasoline C6-C12.
- <sup>7</sup> Laboratory report indicates unidentified hydrocarbons <C16.
- <sup>8</sup> Laboratory report indicates gasoline C6-C12 + unidentified hydrocarbons <C6.
- <sup>9</sup> Laboratory report indicates unidentified hydrocarbons >C16.
- <sup>10</sup> Laboratory report indicates hydrocarbon pattern present in the requested fuel quantitation range but does not resemble the pattern of the requested fuel.
- <sup>11</sup> ORC in well.
- <sup>12</sup> MTBE by EPA Method 8260.
- <sup>13</sup> Laboratory report indicates unidentified hydrocarbons C9-C17.
- <sup>14</sup> BTEX and MTBE by EPA Method 8260.
- <sup>15</sup> ORC removed from well.

**Table 2**  
**Dissolved Oxygen Concentrations**  
Former Chevron Service Station #9-4612  
3616 San Leandro Street  
Oakland, California

WELL ID	DATE	Before Purging (mg/L)	After Purging (mg/L)
VH-1	05/10/00	0.90	--
	07/31/00	1.25	--
	10/30/00	1.97	--
	05/07/01	1.10	--
	08/06/01	1.40	--
	11/12/01	0.90	--
	02/11/02	1.10	--
	05/13/02	0.70	--
MW-2	05/10/00	0.57	--
	07/31/00	1.26	--
	10/30/00	1.25	--
	05/07/01	0.90	--
	08/06/01	1.10	--
	11/12/01	0.80	--
	02/11/02	0.60	--
	05/13/02	0.80	--
MW-3	05/10/00	1.56	--
	07/31/00	1.46	--
	10/30/00	1.18	--
	05/07/01	0.70	--
	08/06/01	0.90	--
	11/12/01	0.50	--
	02/11/02	0.80	--
	05/13/02	1.80	--
MW-4	05/10/00	INACCESSIBLE - CAR PARKED OVER WELL	
	07/31/00	0.64	--
	10/30/00	0.97	--
	02/05/01	INACCESSIBLE - CAR PARKED OVER WELL	
	05/07/01	0.50	--
	08/06/01	0.70	--
	11/12/01	1.00	--
	02/11/02	1.00	--
	05/13/02	2.90	--

**Table 2**  
**Dissolved Oxygen Concentrations**  
Former Chevron Service Station #9-4612  
3616 San Leandro Street  
Oakland, California

---

**EXPLANATIONS:**

(mg/L) = Milligrams per liter

-- = Not Measured

**Table 3**  
**Groundwater Analytical Results - Oxygenate Compounds**  
Former Chevron Service Station #9-4612  
3616 San Leandro Street  
Oakland, California

WELL ID	DATE	ETHANOL (ppb)	TBA (ppb)	MTBE (ppb)	DIFE (ppb)	ETBE (ppb)	TAME (ppb)
VH-1	02/05/01	<500	<50	160	<2.0	<2.0	<2.0
	05/07/01	--	--	110	--	--	--
	08/06/01	--	--	140	--	--	--
	11/12/01	--	--	61	--	--	--
	02/11/02	--	--	52	--	--	--
	05/13/02	--	--	80	--	--	--
	08/09/02	--	--	89	--	--	--
	11/07/02	--	--	50	--	--	--
	02/04/03	--	--	53	--	--	--
	05/05/03	--	--	62	--	--	--
	09/06/03	--	--	59	--	--	--
	11/14/03	--	--	47	--	--	--
	02/13/04	--	--	47	--	--	--
	05/13/04	--	--	74	--	--	--
	08/17/04	--	--	58	--	--	--
	11/10/04	INACCESSIBLE	--	--	--	--	--
02/08/05	--	--	48	--	--	--	
MW-2	02/05/01	<500	<50	140	<2.0	<2.0	<2.0
	05/07/01	--	--	88	--	--	--
	08/06/01	--	--	110	--	--	--
	11/12/01	--	--	98	--	--	--
	02/11/02	--	--	86	--	--	--
	05/13/02	--	--	47	--	--	--
	08/09/02	--	--	69	--	--	--
	11/07/02	--	--	69	--	--	--
	02/04/03	--	--	55	--	--	--
	05/05/03	--	--	31	--	--	--
	09/06/03	--	--	54	--	--	--
	11/14/03	--	--	55	--	--	--
	02/13/04	--	--	31	--	--	--
05/13/04	--	--	34	--	--	--	

**Table 3**  
**Groundwater Analytical Results - Oxygenate Compounds**  
Former Chevron Service Station #9-4612  
3616 San Leandro Street  
Oakland, California

WELL ID	DATE	ETHANOL (ppb)	TBA (ppb)	MTBE (ppb)	DIPE (ppb)	ETBE (ppb)	TAME (ppb)
MW-2 (cont)	08/17/04	--	--	46	--	--	--
	11/10/04	--	--	37	--	--	--
	02/08/05	--	--	22	--	--	--
MW-3	02/05/01	<500	<50	70	<2.0	<2.0	<2.0
	05/07/01	--	--	49	--	--	--
	08/06/01	--	--	43	--	--	--
	11/12/01	--	--	46	--	--	--
	02/11/02	--	--	42	--	--	--
	05/13/02	--	--	32	--	--	--
	08/09/02	--	--	33	--	--	--
	11/07/02	--	--	37	--	--	--
	02/04/03	--	--	24	--	--	--
	05/05/03	--	--	19	--	--	--
	09/06/03	--	--	28	--	--	--
	11/14/03	--	--	30	--	--	--
	02/13/04	--	--	21	--	--	--
	05/13/04	--	--	20	--	--	--
	08/17/04	--	--	25	--	--	--
	11/10/04	--	--	27	--	--	--
02/08/05	--	--	11	--	--	--	
MW-4	05/07/01	--	--	<2.0	--	--	--
	08/06/01	--	--	<2.0	--	--	--
	11/12/01	--	--	<2	--	--	--
	02/11/02	--	--	<2	--	--	--
	05/13/02	--	--	<2	--	--	--
	08/09/02	--	--	<2	--	--	--
	11/07/02	--	--	<2	--	--	--
	02/04/03	--	--	<0.5	--	--	--
	05/05/03	--	--	<0.5	--	--	--
09/06/03	--	--	<0.5	--	--	--	



**Table 3**  
**Groundwater Analytical Results - Oxygenate Compounds**  
 Former Chevron Service Station #9-4612  
 3616 San Leandro Street  
 Oakland, California

WELL ID	DATE	ETHANOL (ppb)	TBA (ppb)	MTBE (ppb)	DIFE (ppb)	ETBE (ppb)	TAME (ppb)
MW-4	11/14/03	--	--	<0.5	--	--	--
(cont)	02/13/04	--	--	<0.5	--	--	--
	05/13/04	--	--	<0.5	--	--	--
	08/17/04	--	--	<0.5	--	--	--
	11/10/04	--	--	<0.5	--	--	--
	02/08/05	--	--	<0.5	--	--	--

**Table 3**  
**Groundwater Analytical Results - Oxygenate Compounds**  
Former Chevron Service Station #9-4612  
3616 San Leandro Street  
Oakland, California

---

---

**EXPLANATIONS:**

TBA = Tertiary butyl alcohol  
MTBE = Methyl tertiary butyl ether  
DIPE = Di-isopropyl ether  
ETBE = Ethyl tertiary butyl ether  
TAME = Tertiary amyl methyl ether  
(ppb) = Parts per billion  
-- = Not Analyzed

**ANALYTICAL METHOD:**

EPA Method 8260 for Oxygenate Compounds

## STANDARD OPERATING PROCEDURE - GROUNDWATER SAMPLING

Gettler-Ryan Inc. field personnel adhere to the following procedures for the collection and handling of groundwater samples prior to analysis by the analytical laboratory. Prior to sample collection, the type of analysis to be performed is determined. Loss prevention of volatile compounds is controlled and sample preservation for subsequent analysis is maintained.

Prior to sampling, the presence or absence of free-phase hydrocarbons is determined using an interface probe. Product thickness, if present, is measured to the nearest 0.01 foot and is noted in the field notes. In addition, all depth to water level measurements are collected with a static water level indicator and are also recorded in the field notes, prior to purging and sampling any wells.

After water levels are collected and prior to sampling, if purging is to occur, each well is purged a minimum of three well casing volumes of water using pre-cleaned pumps (stack, suction, Grundfos), or disposable bailers. Temperature, pH and electrical conductivity are measured a minimum of three times during the purging. Purging continues until these parameters stabilize.

Groundwater samples are collected using disposable bailers. The water samples are transferred from the bailer into appropriate containers. Pre-preserved containers, supplied by analytical laboratories, are used when possible. When pre-preserved containers are not available, the laboratory is instructed to preserve the sample as appropriate. Duplicate samples are collected for the laboratory to use in maintaining quality assurance/quality control standards. The samples are labeled to include the job number, sample identification, collection date and time, analysis, preservation (if any), and the sample collector's initials. The water samples are placed in a cooler, maintained at 4°C for transport to the laboratory. Once collected in the field, all samples are maintained under chain of custody until delivered to the laboratory.

The chain of custody document includes the job number, type of preservation, if any, analysis requested, sample identification, date and time collected, and the sample collector's name. The chain of custody is signed and dated (including time of transfer) by each person who receives or surrenders the samples, beginning with the field personnel and ending with the laboratory personnel.

A laboratory supplied trip blank accompanies each sampling set. For sampling sets greater than 20 samples, 5% trip blanks are included. The trip blank is analyzed for some or all of the same compounds as the groundwater samples.

As requested by ChevronTexaco Company, the purge water and decontamination water generated during sampling activities is transported by IWM to McKittrick Waste Management located in McKittrick, California.



# GETTLER-RYAN INC.

## WELL MONITORING/SAMPLING FIELD DATA SHEET

Client/Facility #: ChevronTexaco #9-4612 Job Number: 386473  
 Site Address: 3616 San Leandro Street Event Date: 2-8-05 (inclusive)  
 City: Oakland, CA Sampler: FT

Well ID: VH-1 Date Monitored: 2-8-05 Well Condition: ok'  
 Well Diameter: 4 in.  
 Total Depth: 28.48 ft.  
 Depth to Water: 7.83 ft.  
20.65 xVF .66 = 13.62 x3 case volume= Estimated Purge Volume: 40.88 gal.

Volume	3/4"= 0.02	1"= 0.04	2"= 0.17	3"= 0.38
Factor (VF)	4"= 0.66	5"= 1.02	6"= 1.50	12"= 5.80

**Purge Equipment:**  
 Disposable Bailer \_\_\_\_\_  
 Stainless Steel Bailer ✓  
 Stack Pump ✓  
 Suction Pump \_\_\_\_\_  
 Grundfos \_\_\_\_\_  
 Other: \_\_\_\_\_

**Sampling Equipment:**  
 Disposable Bailer ✓  
 Pressure Bailer \_\_\_\_\_  
 Discrete Bailer \_\_\_\_\_  
 Other: \_\_\_\_\_

Time Started: \_\_\_\_\_ (2400 hrs)  
 Time Completed: \_\_\_\_\_ (2400 hrs)  
 Depth to Product: \_\_\_\_\_ ft  
 Depth to Water: \_\_\_\_\_ ft  
 Hydrocarbon Thickness: \_\_\_\_\_ ft  
 Visual Confirmation/Description: \_\_\_\_\_  
 Skimmer / Absorbant Sock (circle one)  
 Amt Removed from Skimmer: \_\_\_\_\_ gal  
 Amt Removed from Well: \_\_\_\_\_ gal  
 Water Removed: \_\_\_\_\_  
 Product Transferred to: \_\_\_\_\_

Start Time (purge): 1327 Weather Conditions: CLOUDY  
 Sample Time/Date: 1400 / 2-8-05 Water Color: CLEAR Odor: yes  
 Purging Flow Rate: 3.5 gpm. Sediment Description: \_\_\_\_\_  
 Did well de-water? no If yes, Time: \_\_\_\_\_ Volume: \_\_\_\_\_ gal.

Time (2400 hr.)	Volume (gal.)	pH	Conductivity (u mhos/cm)	Temperature (°F)	D.O. (mg/L)	ORP (mV)
<u>1331</u>	<u>13.5</u>	<u>7.10</u>	<u>564</u>	<u>20.0</u>	_____	_____
<u>1335</u>	<u>27.0</u>	<u>6.62</u>	<u>565</u>	<u>19.8</u>	_____	_____
<u>1339</u>	<u>41.0</u>	<u>6.57</u>	<u>569</u>	<u>20.1</u>	_____	_____
_____	_____	_____	_____	_____	_____	_____

### LABORATORY INFORMATION

SAMPLE ID	(#) CONTAINER	REFRIG.	PRESERV. TYPE	LABORATORY	ANALYSES
<u>VH-1</u>	<u>6</u> x voa vial	<u>YES</u>	<u>HCL</u>	<u>LANCASTER</u>	<u>TPH-G(8015)/BTEX+MTBE(8260)</u>
_____	_____	_____	_____	_____	_____
_____	_____	_____	_____	_____	_____
_____	_____	_____	_____	_____	_____

COMMENTS: \_\_\_\_\_  
 \_\_\_\_\_  
 \_\_\_\_\_

Add/Replaced Lock: \_\_\_\_\_ Add/Replaced Plug: \_\_\_\_\_ Size: \_\_\_\_\_



# GETTLER-RYAN INC.

## WELL MONITORING/SAMPLING FIELD DATA SHEET

Client/Facility #: ChevronTexaco #9-4612 Job Number: 386473  
 Site Address: 3616 San Leandro Street Event Date: 2.8.05 (inclusive)  
 City: Oakland, CA Sampler: FT

Well ID: MW-2 Date Monitored: 2.8.05 Well Condition: SEE PHOTO

Well Diameter: 2 1/4 in.

Total Depth: 19.50 ft.

Depth to Water: 8.71 ft.

Volume	3/4"= 0.02	1"= 0.04	2"= 0.17	3"= 0.38
Factor (VF)	4"= 0.66	5"= 1.02	6"= 1.50	12"= 5.80

10.79 xVF .17 = 1.83 x3 case volume= Estimated Purge Volume: 5.50 gal.

### Purge Equipment:

Disposable Bailer \_\_\_\_\_  
 Stainless Steel Bailer \_\_\_\_\_  
 Stack Pump  \_\_\_\_\_  
 Suction Pump \_\_\_\_\_  
 Grundfos \_\_\_\_\_  
 Other: \_\_\_\_\_

### Sampling Equipment:

Disposable Bailer  \_\_\_\_\_  
 Pressure Bailer \_\_\_\_\_  
 Discrete Bailer \_\_\_\_\_  
 Other: \_\_\_\_\_

Time Started: \_\_\_\_\_ (2400 hrs)  
 Time Completed: \_\_\_\_\_ (2400 hrs)  
 Depth to Product: \_\_\_\_\_ ft  
 Depth to Water: \_\_\_\_\_ ft  
 Hydrocarbon Thickness: \_\_\_\_\_ ft  
 Visual Confirmation/Description: \_\_\_\_\_  
 Skimmer / Absorbant Sock (circle one)  
 Amt Removed from Skimmer: \_\_\_\_\_ gal  
 Amt Removed from Well: \_\_\_\_\_ gal  
 Water Removed: \_\_\_\_\_  
 Product Transferred to: \_\_\_\_\_

Start Time (purge): 1550 Weather Conditions: CLOUDY  
 Sample Time/Date: 1604 / 2.8.05 Water Color: CLEAR Odor: YES  
 Purging Flow Rate: 2.0 gpm. Sediment Description: \_\_\_\_\_  
 Did well de-water? NO If yes, Time: \_\_\_\_\_ Volume: \_\_\_\_\_ gal.

Time (2400 hr.)	Volume (gal.)	pH	Conductivity (umhos/cm)	Temperature (°F)	D.O. (mg/L)	ORP (mV)
<u>1551</u>	<u>2.0</u>	<u>6.93</u>	<u>551</u>	<u>19.6</u>	_____	_____
<u>1552</u>	<u>4.0</u>	<u>6.84</u>	<u>542</u>	<u>20.0</u>	_____	_____
<u>1553</u>	<u>5.5</u>	<u>6.76</u>	<u>527</u>	<u>20.0</u>	_____	_____
_____	_____	_____	_____	_____	_____	_____

### LABORATORY INFORMATION

SAMPLE ID	(#) CONTAINER	REFRIG.	PRESERV. TYPE	LABORATORY	ANALYSES
<u>MW-2</u>	<u>6</u> x voa vial	YES	HCL	LANCASTER	TPH-G(8015)/BTEX+MTBE(8260)
	x Amber	YES	NP	LANCASTER	TPH-D

### COMMENTS:

Add/Replaced Lock: \_\_\_\_\_ Add/Replaced Plug: \_\_\_\_\_ Size: \_\_\_\_\_



# GETTLER-RYAN INC.

## WELL MONITORING/SAMPLING FIELD DATA SHEET

Client/Facility #: ChevronTexaco #9-4612 Job Number: 386473  
 Site Address: 3616 San Leandro Street Event Date: 2-8-05 (inclusive)  
 City: Oakland, CA Sampler: FT

Well ID: MW-3 Date Monitored: 2-8-05 Well Condition: SEE PHOTO

Well Diameter: 2 1/4 in.

Total Depth: 18.04 ft.

Depth to Water: 8.12 ft.

Volume	3/4"= 0.02	1"= 0.04	2"= 0.17	3"= 0.38
Factor (VF)	4"= 0.66	5"= 1.02	6"= 1.50	12"= 5.80

9.92 xVF .17 = 1.68 x3 case volume= Estimated Purge Volume: 5.05 gal.

### Purge Equipment:

Disposable Bailer \_\_\_\_\_  
 Stainless Steel Bailer \_\_\_\_\_  
 Stack Pump ✓  
 Suction Pump \_\_\_\_\_  
 Grundfos \_\_\_\_\_  
 Other: \_\_\_\_\_

### Sampling Equipment:

Disposable Bailer ✓  
 Pressure Bailer \_\_\_\_\_  
 Discrete Bailer \_\_\_\_\_  
 Other: \_\_\_\_\_

Time Started: \_\_\_\_\_ (2400 hrs)  
 Time Completed: \_\_\_\_\_ (2400 hrs)  
 Depth to Product: \_\_\_\_\_ ft  
 Depth to Water: \_\_\_\_\_ ft  
 Hydrocarbon Thickness: \_\_\_\_\_ ft  
 Visual Confirmation/Description: \_\_\_\_\_  
 Skimmer / Absorbant Sock (circle one)  
 Amt Removed from Skimmer: \_\_\_\_\_ gal  
 Amt Removed from Well: \_\_\_\_\_ gal  
 Water Removed: \_\_\_\_\_  
 Product Transferred to: \_\_\_\_\_

Start Time (purge): 1520 Weather Conditions: CLOUDY  
 Sample Time/Date: 1532 / 2-8-05 Water Color: MILKY / V. LT. GRAY Odor: YES  
 Purging Flow Rate: 2.0 gpm. Sediment Description: \_\_\_\_\_  
 Did well de-water? NO If yes, Time: \_\_\_\_\_ Volume: \_\_\_\_\_ gal.

Time (2400 hr.)	Volume (gal.)	pH	Conductivity (umhos/cm)	Temperature (°F)	D.O. (mg/L)	ORP (mV)
<u>1521</u>	<u>1.5</u>	<u>6.99</u>	<u>523</u>	<u>20.4</u>		
<u>1522</u>	<u>3.0</u>	<u>6.87</u>	<u>532</u>	<u>20.7</u>		
<u>1523</u>	<u>5.0</u>	<u>6.76</u>	<u>534</u>	<u>20.9</u>		

### LABORATORY INFORMATION

SAMPLE ID	(#) CONTAINER	REFRIG.	PRESERV. TYPE	LABORATORY	ANALYSES
<u>MW-3</u>	<u>6</u> x voa vial	<u>YES</u>	<u>HCL</u>	<u>LANCASTER</u>	<u>TPH-G(8015)/BTEX+MTBE(8260)</u>
	<u>2</u> x Amber	<u>YES</u>	<u>NP</u>	<u>LANCASTER</u>	<u>TPH-D</u>

### COMMENTS:

Add/Replaced Lock: \_\_\_\_\_

Add/Replaced Plug: \_\_\_\_\_ Size: \_\_\_\_\_



# GETTLER - RYAN INC.

## WELL MONITORING/SAMPLING FIELD DATA SHEET

Client/Facility #: ChevronTexaco #9-4612 Job Number: 386473  
 Site Address: 3616 San Leandro Street Event Date: 2-8-05 (inclusive)  
 City: Oakland, CA Sampler: FT

Well ID: MW-4 Date Monitored: 2-8-05 Well Condition: SEE PHOTO  
 Well Diameter: 2 1/4 in.  
 Total Depth: 19.25 ft.  
 Depth to Water: 7.20 ft.  
12.05 xVF .17 = 2.04 x3 case volume = Estimated Purge Volume: 6.12 gal.

Volume	3/4" = 0.02	1" = 0.04	2" = 0.17	3" = 0.38
Factor (VF)	4" = 0.66	5" = 1.02	6" = 1.50	12" = 5.80

**Purge Equipment:**  
 Disposable Bailer   
 Stainless Steel Bailer \_\_\_\_\_  
 Stack Pump \_\_\_\_\_  
 Suction Pump \_\_\_\_\_  
 Grundfos \_\_\_\_\_  
 Other: \_\_\_\_\_

**Sampling Equipment:**  
 Disposable Bailer   
 Pressure Bailer \_\_\_\_\_  
 Discrete Bailer \_\_\_\_\_  
 Other: \_\_\_\_\_

Time Started: \_\_\_\_\_ (2400 hrs)  
 Time Completed: \_\_\_\_\_ (2400 hrs)  
 Depth to Product: \_\_\_\_\_ ft  
 Depth to Water: \_\_\_\_\_ ft  
 Hydrocarbon Thickness: \_\_\_\_\_ ft  
 Visual Confirmation/Description: \_\_\_\_\_  
 Skimmer / Absorbant Sock (circle one)  
 Amt Removed from Skimmer: \_\_\_\_\_ gal  
 Amt Removed from Well: \_\_\_\_\_ gal  
 Water Removed: \_\_\_\_\_  
 Product Transferred to: \_\_\_\_\_

Start Time (purge): 1456 Weather Conditions: CLOUDY  
 Sample Time/Date: 1514 / 2-8-05 Water Color: CLEAR Odor: NO  
 Purging Flow Rate: 1 gpm. Sediment Description: \_\_\_\_\_  
 Did well de-water? NO If yes, Time: \_\_\_\_\_ Volume: \_\_\_\_\_ gal.

Time (2400 hr.)	Volume (gal.)	pH	Conductivity (umhos/cm)	Temperature (°C)	D.O. (mg/L)	ORP (mV)
<u>1500</u>	<u>2.0</u>	<u>7.25</u>	<u>416</u>	<u>17.9</u>	_____	_____
<u>1504</u>	<u>4.0</u>	<u>7.16</u>	<u>392</u>	<u>18.4</u>	_____	_____
<u>1508</u>	<u>6.0</u>	<u>7.08</u>	<u>385</u>	<u>18.5</u>	_____	_____
_____	_____	_____	_____	_____	_____	_____

### LABORATORY INFORMATION

SAMPLE ID	(#) CONTAINER	REFRIG.	PRESERV. TYPE	LABORATORY	ANALYSES
<u>MW-4</u>	<u>6</u> x vov vial	<u>YES</u>	<u>HCL</u>	<u>LANCASTER</u>	<u>TPH-G(8015)/BTEX+MTBE(8260)</u>
	<u>x Amber</u>	<u>YES</u>	<u>NP</u>	<u>LANCASTER</u>	<u>TPH-D</u>

COMMENTS: \_\_\_\_\_  
 \_\_\_\_\_  
 \_\_\_\_\_

Add/Replaced Lock: \_\_\_\_\_ Add/Replaced Plug: \_\_\_\_\_ Size: \_\_\_\_\_

# Chevron California Region Analysis Request/Chain of Custody



020905-09

Acc #: 10904

For Lancaster Laboratories use only  
Sample #: 4462550-554

Group# 931371  
SCR#:

**Cambria MTI Project # 61H-1996**

Facility #: SS#9-4612 G-R#386473 Global ID#T0600100333  
 Site Address: 3616 SAN LEANDRO STREET, OAKLAND, CA  
 Chevron PM: MTI Lead Consultant: CAMBRIABE  
 Consultant/Office: G-R, Inc., 6747 Sierra Court, Suite J, Dublin, Ca. 94568  
 Consultant Prj. Mgr.: Deanna L. Harding (deanna@grinc.com)  
 Consultant Phone: 925-551-7555 Fax #: 925-551-7899  
 Sampler: FRANK TERNONI  
 Service Order #: \_\_\_\_\_  Non SAR:

Matrix		Analyses Requested											
		Preservation Codes											
Soil	Water	Oil	Air	Total Number of Containers							Preservative Codes		
<input type="checkbox"/> Potable <input type="checkbox"/> NPDES	<input type="checkbox"/> TPH 8015 MOD GRO <input type="checkbox"/> TPH 8015 MOD DRO <input type="checkbox"/> Silica Gel Cleanup <input type="checkbox"/> 8260 full scan <input type="checkbox"/> Oxygenates <input type="checkbox"/> Lead 7420 <input type="checkbox"/> 7421	<input type="checkbox"/> BTEX + MTBE 8260 <input type="checkbox"/> 8021	<input type="checkbox"/>	<input type="checkbox"/>	<input type="checkbox"/>	<input type="checkbox"/>	<input type="checkbox"/>	<input type="checkbox"/>	<input type="checkbox"/>	<input type="checkbox"/>	<input type="checkbox"/>	<input type="checkbox"/>	<input type="checkbox"/>
W	↓	2	X	X									
↓	↓	6	X	X									
↓	↓	6	X	X									
↓	↓	8	X	X	X								
↓	↓	6	X	X									

**Preservative Codes**  
 H = HCl      T = Thiosulfate  
 N = HNO<sub>3</sub>    B = NaOH  
 S = H<sub>2</sub>SO<sub>4</sub>    O = Other

J value reporting needed  
 Must meet lowest detection limits possible for 8260 compounds

8021 MTBE Confirmation  
 Confirm highest hit by 8260  
 Confirm all hits by 8260  
 Run \_\_\_ oxy.s on highest hit  
 Run \_\_\_ oxy.s on all hits

Sample Identification	Date Collected	Time Collected	Grab	Composite	Soil	Water	Oil	Air	Total Number of Containers										Comments / Remarks							
QA	2-8-05				W				2	X	X															
VH-1	↓	1400	X						6	X	X															
MW-2	↓	1604	X						6	X	X															
MW-3	↓	1532	X						8	X	X	X														
MW-4	↓	1514	X						6	X	X															

<b>Turnaround Time Requested (TAT)</b> (please circle) STD. TAT      72 hour      48 hour 24 hour      4 day      5 day	Relinquished by: <u>Frank Ternoni</u>	Date: <u>2-8-05</u>	Time: _____	Received by: _____	Date: _____	Time: _____
	Relinquished by: <u>Deanna Harding</u>	Date: <u>2/8/05</u>	Time: <u>1330</u>	Received by: <u>Richard Amaya</u>	Date: <u>2/9/05</u>	Time: <u>1330</u>
<b>Data Package Options</b> (please circle if required) QC Summary      Type I — Full Type VI (Raw Data) <input type="checkbox"/> Coelt Deliverable not needed WIP (RWQCB) <b>EDF/EDD</b> Disk	Relinquished by: <u>Richard Amaya</u>	Date: <u>2/9/05</u>	Time: <u>1500</u>	Received by: <u>DHL</u>	Date: <u>2/9/05</u>	Time: _____
	Relinquished by Commercial Carrier: <u>DHL</u>	UPS      FedEx      Other	Temperature Upon Receipt: <u>14.2.4</u> °C	Received by: <u>John Alt</u>	Date: <u>2/9/05</u>	Time: <u>0855</u>
				Custody Seals Intact? <input checked="" type="checkbox"/> Yes <input type="checkbox"/> No		



## ANALYTICAL RESULTS

Prepared for:

ChevronTexaco c/o Cambria  
Suite 9  
4111 Citrus Avenue  
Rocklin CA 95677  
916-630-1855

Prepared by:

Lancaster Laboratories  
2425 New Holland Pike  
Lancaster, PA 17605-2425

RECEIVED  
GETTLER-RYAN INC  
GENERAL CONTRACTORS

## SAMPLE GROUP

The sample group for this submittal is 931371. Samples arrived at the laboratory on Thursday, February 10, 2005. The PO# for this group is 99011184 and the release number is MTL.

<u>Client Description</u>			<u>Lancaster Labs Number</u>
QA-T-050208	NA	Water	4462550
VH-1-W-050208	Grab	Water	4462551
MW-2-W-050208	Grab	Water	4462552
MW-3-W-050208	Grab	Water	4462553
MW-4-W-050208	Grab	Water	4462554

1 COPY TO  
ELECTRONIC  
COPY TO

Cambria C/O Gettler- Ryan  
Gettler-Ryan

Attn: Deanna L. Harding  
Attn: Cheryl Hansen



## Analysis Report

2425 New Holland Pike, PO Box 12425, Lancaster, PA 17605-2425 • 717-656-2300 Fax: 717-656-2681 • www.lancasterlabs.com

Questions? Contact your Client Services Representative  
Megan A Moeller at (717) 656-2300.

Respectfully Submitted,

A handwritten signature in cursive script that reads 'Dana M. Kauffman'.

Dana M. Kauffman  
Group Leader



# Analysis Report

2425 New Holland Pike, PO Box 12425, Lancaster, PA 17605-2425 • 717-656-2300 Fax: 717-656-2661 • www.lancasterlabs.com

Page 1 of 1

Lancaster Laboratories Sample No. WW 4462550

QA-T-050208 NA Water  
Facility# 94612 Job# 386473 MTI# 61H-1996 GRD  
3616 San Leandro-Oakland T0600100333 QA  
Collected: 02/08/2005

Account Number: 10904

Submitted: 02/10/2005 09:20  
Reported: 02/22/2005 at 12:58  
Discard: 03/25/2005

ChevronTexaco c/o Cambria  
Suite 9  
4111 Citrus Avenue  
Rocklin CA 95677

361QA

CAT No.	Analysis Name	CAS Number	As Received Result	As Received Method Detection Limit	Units	Dilution Factor
01728	TPH-GRO - Waters	n.a.	N.D.	50.	ug/l	1
The reported concentration of TPH-GRO does not include MTBE or other gasoline constituents eluting prior to the C6 (n-hexane) TPH-GRO range start time.						
06054	BTEX+MTBE by 8260B					
02010	Methyl Tertiary Butyl Ether	1634-04-4	N.D.	0.5	ug/l	1
05401	Benzene	71-43-2	N.D.	0.5	ug/l	1
05407	Toluene	108-88-3	N.D.	0.5	ug/l	1
05415	Ethylbenzene	100-41-4	N.D.	0.5	ug/l	1
06310	Xylene (Total)	1330-20-7	N.D.	0.5	ug/l	1

State of California Lab Certification No. 2116

## Laboratory Chronicle

CAT No.	Analysis Name	Method	Analysis		Analyst	Dilution Factor
			Trial#	Date and Time		
01728	TPH-GRO - Waters	N. CA LUFT Gasoline Method	1	02/13/2005 13:13	K. Robert Caulfeild-James	1
06054	BTEX+MTBE by 8260B	SW-846 8260B	1	02/15/2005 02:20	Dawn M Harle	1
01146	GC VOA Water Prep	SW-846 5030B	1	02/13/2005 13:13	K. Robert Caulfeild-James	1
01163	GC/MS VOA Water Prep	SW-846 5030B	1	02/15/2005 02:20	Dawn M Harle	n.a.



# Analysis Report

2425 New Holland Pike, PO Box 12425, Lancaster, PA 17605-2425 • 717-656-2300 Fax: 717-656-2681 • www.lancasterlabs.com

Lancaster Laboratories Sample No. WW 4462551

VH-1-W-050208 Grab Water  
Facility# 94612 Job# 386473 MTI# 61H-1996 GRD  
3616 San Leandro-Oakland T0600100333 VH-1  
Collected: 02/08/2005 14:00 by FT

Account Number: 10904

Submitted: 02/10/2005 09:20  
Reported: 02/22/2005 at 12:58  
Discard: 03/25/2005

ChevronTexaco c/o Cambria  
Suite 9  
4111 Citrus Avenue  
Rocklin CA 95677

361V1

CAT No.	Analysis Name	CAS Number	As Received Result	As Received Method Detection Limit	Units	Dilution Factor
01728	TPH-GRO - Waters	n.a.	2,700.	50.	ug/l	1
	The reported concentration of TPH-GRO does not include MTBE or other gasoline constituents eluting prior to the C6 (n-hexane) TPH-GRO range start time.					
06054	BTEX+MTBE by 8260B					
02010	Methyl Tertiary Butyl Ether	1634-04-4	48.	0.5	ug/l	1
05401	Benzene	71-43-2	26.	0.5	ug/l	1
05407	Toluene	108-88-3	3.	0.5	ug/l	1
05415	Ethylbenzene	100-41-4	4.	0.5	ug/l	1
06310	Xylene (Total)	1330-20-7	5.	0.5	ug/l	1

State of California Lab Certification No. 2116

## Laboratory Chronicle

CAT No.	Analysis Name	Method	Analysis		Analyst	Dilution Factor
			Trial#	Date and Time		
01728	TPH-GRO - Waters	N. CA LUFT Gasoline Method	1	02/15/2005 02:39	Linda C Pape	1
06054	BTEX+MTBE by 8260B	SW-846 8260B	1	02/15/2005 02:45	Dawn M Harle	1
01146	GC VOA Water Prep	SW-846 5030B	1	02/15/2005 02:39	Linda C Pape	1
01163	GC/MS VOA Water Prep	SW-846 5030B	1	02/15/2005 02:45	Dawn M Harle	n.a.

Lancaster Laboratories Sample No. WW 4462552

 MW-2-W-050208                      Grab                      Water  
 Facility# 94612    Job# 386473    MTI# 61H-1996    GRD  
 3616 San Leandro-Oakland T0600100333 MW-2  
 Collected: 02/08/2005 16:04                      by FT

Account Number: 10904

 Submitted: 02/10/2005 09:20  
 Reported: 02/22/2005 at 12:58  
 Discard: 03/25/2005

 ChevronTexaco c/o Cambria  
 Suite 9  
 4111 Citrus Avenue  
 Rocklin CA 95677

361M2

CAT No.	Analysis Name	CAS Number	As Received Result	As Received Method Detection Limit	Units	Dilution Factor
01728	TPH-GRO - Waters	n.a.	4,700.	50.	ug/l	1
	The reported concentration of TPH-GRO does not include MTBE or other gasoline constituents eluting prior to the C6 (n-hexane) TPH-GRO range start time.					
	An elevated surrogate recovery was observed. The analysis was repeated and an elevated surrogate recovery was again observed indicating a significant matrix effect.					
06054	BTEX+MTBE by 8260B					
02010	Methyl Tertiary Butyl Ether	1634-04-4	22.	0.5	ug/l	1
05401	Benzene	71-43-2	3.	0.5	ug/l	1
05407	Toluene	108-88-3	2.	0.5	ug/l	1
05415	Ethylbenzene	100-41-4	10.	0.5	ug/l	1
06310	Xylene (Total)	1330-20-7	8.	0.5	ug/l	1

State of California Lab Certification No. 2116

### Laboratory Chronicle

CAT No.	Analysis Name	Method	Analysis		Analyst	Dilution Factor
			Trial#	Date and Time		
01728	TPH-GRO - Waters	N. CA LUFT Gasoline Method	1	02/13/2005 04:13	Linda C Pape	1
06054	BTEX+MTBE by 8260B	SW-846 8260B	1	02/15/2005 19:40	Ginelle L Haines	1
01146	GC VOA Water Prep	SW-846 5030B	1	02/13/2005 04:13	Linda C Pape	1
01163	GC/MS VOA Water Prep	SW-846 5030B	1	02/15/2005 19:40	Ginelle L Haines	n.a.

Lancaster Laboratories Sample No. WW 4462553

MW-3-W-050208 Grab Water  
 Facility# 94612 Job# 386473 MTI# 61H-1996 GRD  
 3616 San Leandro-Oakland T0600100333 MW-3  
 Collected: 02/08/2005 15:32 by FT

Account Number: 10904

Submitted: 02/10/2005 09:20  
 Reported: 02/22/2005 at 12:58  
 Discard: 03/25/2005

ChevronTexaco c/o Cambria  
 Suite 9  
 4111 Citrus Avenue  
 Rocklin CA 95677

361M3

CAT No.	Analysis Name	CAS Number	As Received Result	As Received Method Detection Limit	Units	Dilution Factor
01728	TPH-GRO - Waters	n.a.	2,500.	50.	ug/l	1
	The reported concentration of TPH-GRO does not include MTBE or other gasoline constituents eluting prior to the C6 (n-hexane) TPH-GRO range start time.					
06609	TPH-DRO CALUFT(Waters)	n.a.	530.	50.	ug/l	1
06054	BTEX+MTBE by 8260B					
02010	Methyl Tertiary Butyl Ether	1634-04-4	11.	0.5	ug/l	1
05401	Benzene	71-43-2	1.	0.5	ug/l	1
05407	Toluene	108-88-3	0.6	0.5	ug/l	1
05415	Ethylbenzene	100-41-4	2.	0.5	ug/l	1
06310	Xylene (Total)	1330-20-7	3.	0.5	ug/l	1

State of California Lab Certification No. 2116

### Laboratory Chronicle

CAT No.	Analysis Name	Method	Trial#	Analysis Date and Time	Analyst	Dilution Factor
01728	TPH-GRO - Waters	N. CA LUFT Gasoline Method	1	02/13/2005 08:41	Linda C Pape	1
06609	TPH-DRO CALUFT(Waters)	CALUFT-DRO/8015B, Modified	1	02/17/2005 08:37	Tracy A Cole	1
06054	BTEX+MTBE by 8260B	SW-846 8260B	1	02/15/2005 04:25	Dawn M Harle	1
01146	GC VOA Water Prep	SW-846 5030B	1	02/13/2005 08:41	Linda C Pape	1
01163	GC/MS VOA Water Prep	SW-846 5030B	1	02/15/2005 04:25	Dawn M Harle	n.a.
02135	Extraction - DRO Water Special	TPH by CA LUFT	1	02/12/2005 09:30	Claudia M Tabora	1



# Analysis Report

2425 New Holland Pike, PO Box 12425, Lancaster, PA 17605-2425 • 717-656-2300 Fax: 717-656-2681 • www.lancasterlabs.com

Page 1 of 1

Lancaster Laboratories Sample No. WW 4462554

MW-4-W-050208 Grab Water  
Facility# 94612 Job# 386473 MTI# 61H-1996 GRD  
3616 San Leandro-Oakland T0600100333 MW-4  
Collected: 02/08/2005 15:14 by FT

Account Number: 10904

Submitted: 02/10/2005 09:20  
Reported: 02/22/2005 at 12:59  
Discard: 03/25/2005

ChevronTexaco c/o Cambria  
Suite 9  
4111 Citrus Avenue  
Rocklin CA 95677

361M4

CAT No.	Analysis Name	CAS Number	As Received Result	As Received		Units	Dilution Factor
				Method	Detection Limit		
01728	TPH-GRO - Waters	n.a.	N.D.		50.	ug/l	1
	The reported concentration of TPH-GRO does not include MTBE or other gasoline constituents eluting prior to the C6 (n-hexane) TPH-GRO range start time.						
06054	BTEX+MTBE by 8260B						
02010	Methyl Tertiary Butyl Ether	1634-04-4	N.D.		0.5	ug/l	1
05401	Benzene	71-43-2	N.D.		0.5	ug/l	1
05407	Toluene	108-88-3	N.D.		0.5	ug/l	1
05415	Ethylbenzene	100-41-4	N.D.		0.5	ug/l	1
06310	Xylene (Total)	1330-20-7	N.D.		0.5	ug/l	1

State of California Lab Certification No. 2116

## Laboratory Chronicle

CAT No.	Analysis Name	Method	Trial#	Analysis		Analyst	Dilution Factor
				Date and Time			
01728	TPH-GRO - Waters	N. CA LUFT Gasoline Method	1	02/13/2005 00:24		Linda C Pape	1
06054	BTEX+MTBE by 8260B	SW-846 8260B	1	02/15/2005 05:15		Dawn M Harle	1
01146	GC VOA Water Prep	SW-846 5030B	1	02/13/2005 00:24		Linda C Pape	1
01163	GC/MS VOA Water Prep	SW-846 5030B	1	02/15/2005 05:15		Dawn M Harle	n.a.

## Quality Control Summary

 Client Name: ChevronTexaco c/o Cambria  
 Reported: 02/22/05 at 12:59 PM

Group Number: 931371

Matrix QC may not be reported if site-specific QC samples were not submitted. In these situations, to demonstrate precision and accuracy at a batch level, a LCS/LCSD was performed, unless otherwise specified in the method.

### Laboratory Compliance Quality Control

Analysis Name	Blank Result	Blank MDL	Report Units	LCS %REC	LCSD %REC	LCS/LCSD Limits	RPD	RPD Max
Batch number: 050420010A TPH-DRO CALUFT (Waters)	N.D.	50.	Sample number(s): 4462553 ug/l	88	84	61-126	4	20
Batch number: 05043A56A TPH-GRO - Waters	N.D.	50.	Sample number(s): 4462552-4462554 ug/l	101	104	70-130	3	30
Batch number: 05043A56B TPH-GRO - Waters	N.D.	50.	Sample number(s): 4462551 ug/l	101	104	70-130	3	30
Batch number: 05044A08A TPH-GRO - Waters	N.D.	50.	Sample number(s): 4462550 ug/l	104	105	70-130	1	30
Batch number: Z050454AA Methyl Tertiary Butyl Ether	N.D.	0.5	Sample number(s): 4462550-4462551, 4462553-4462554 ug/l	91		77-127		
Benzene	N.D.	0.5	ug/l	90		85-117		
Toluene	N.D.	0.5	ug/l	97		85-115		
Ethylbenzene	N.D.	0.5	ug/l	94		82-119		
Xylene (Total)	N.D.	0.5	ug/l	96		83-113		
Batch number: Z050462AA Methyl Tertiary Butyl Ether	N.D.	0.5	Sample number(s): 4462552 ug/l	93		77-127		
Benzene	N.D.	0.5	ug/l	94		85-117		
Toluene	N.D.	0.5	ug/l	98		85-115		
Ethylbenzene	N.D.	0.5	ug/l	97		82-119		
Xylene (Total)	N.D.	0.5	ug/l	98		83-113		

### Sample Matrix Quality Control

Analysis Name	MS %REC	MSD %REC	MS/MSD Limits	RPD	RPD MAX	BKG Conc	DUP Conc	DUP RPD	Dup RPD Max
Batch number: 05043A56A TPH-GRO - Waters	91		Sample number(s): 4462552-4462554 63-154						
Batch number: 05043A56B TPH-GRO - Waters	91		Sample number(s): 4462551 63-154						
Batch number: 05044A08A TPH-GRO - Waters	116		Sample number(s): 4462550 63-154						
Batch number: Z050454AA Methyl Tertiary Butyl Ether	94	96	Sample number(s): 4462550-4462551, 4462553-4462554 69-134	2	30				

\*- Outside of specification

- (1) The result for one or both determinations was less than five times the LOQ.
- (2) The background result was more than four times the spike added.



## Quality Control Summary

 Client Name: ChevronTexaco c/o Cambria  
 Reported: 02/22/05 at 12:59 PM

Group Number: 931371

### Sample Matrix Quality Control

<u>Analysis Name</u>	<u>MS</u>	<u>MSD</u>	<u>MS/MSD</u>	<u>RPD</u>	<u>RPD</u>	<u>BKG</u>	<u>DUP</u>	<u>DUP</u>	<u>Dup RPD</u>
	<u>%REC</u>	<u>%REC</u>	<u>Limits</u>	<u>RPD</u>	<u>MAX</u>	<u>Conc</u>	<u>Conc</u>	<u>RPD</u>	<u>Max</u>
Benzene	101	101	83-128	0	30				
Toluene	108	111	83-127	3	30				
Ethylbenzene	104	106	82-129	2	30				
Xylene (Total)	105	108	82-130	2	30				
Batch number: Z050462AA      Sample number(s): 4462552									
Methyl Tertiary Butyl Ether	98	102	69-134	4	30				
Benzene	102	103	83-128	1	30				
Toluene	108	111	83-127	2	30				
Ethylbenzene	104	106	82-129	2	30				
Xylene (Total)	105	107	82-130	2	30				

### Surrogate Quality Control

 Analysis Name: TPH-DRO CALUPT(Waters)  
 Batch number: 050420010A  
 Orthoterphenyl

4462553	87
Blank	83
LCS	83
LCSD	80

Limits: 57-128

 Analysis Name: TPH-GRO - Waters  
 Batch number: 05043A56A  
 Trifluorotoluene-F

4462552	183*
4462553	117
4462554	93
Blank	101
LCS	101
LCSD	99
MS	80

Limits: 57-146

 Analysis Name: TPH-GRO - Waters  
 Batch number: 05043A56B  
 Trifluorotoluene-F

4462551	143
Blank	88
LCS	101
LCSD	99
MS	80

Limits: 57-146

Analysis Name: TPH-GRO - Waters

\*- Outside of specification

- (1) The result for one or both determinations was less than five times the LOQ.
- (2) The background result was more than four times the spike added.

## Quality Control Summary

 Client Name: ChevronTexaco c/o Cambria  
 Reported: 02/22/05 at 12:59 PM

Group Number: 931371

### Surrogate Quality Control

 Batch number: 05044A08A  
 Trifluorotoluene-F

4462550	98
Blank	100
LCS	101
LCSD	101
MS	102

Limits: 57-146

 Analysis Name: BTEX+MTBE by 8260B  
 Batch number: Z050454AA

	Dibromofluoromethane	1,2-Dichloroethane-d4	Toluene-d8	4-Bromofluorobenzene
4462550	102	96	103	87
4462551	100	88	100	98
4462553	99	90	100	99
4462554	101	94	103	87
Blank	101	93	103	87
LCS	99	94	101	94
MS	99	92	101	93
MSD	99	93	101	94

Limits: 81-120      82-112      85-112      83-113

 Analysis Name: BTEX+MTBE by 8260B  
 Batch number: Z050462AA

	Dibromofluoromethane	1,2-Dichloroethane-d4	Toluene-d8	4-Bromofluorobenzene
4462552	101	86	101	101
Blank	100	92	104	86
LCS	99	93	101	93
MS	99	95	101	93
MSD	100	96	101	93

Limits: 81-120      82-112      85-112      83-113

\*- Outside of specification

- (1) The result for one or both determinations was less than five times the LOQ.
- (2) The background result was more than four times the spike added.

# Explanation of Symbols and Abbreviations

The following defines common symbols and abbreviations used in reporting technical data:

<b>N.D.</b>	none detected	<b>BMQL</b>	Below Minimum Quantitation Level
<b>TNTC</b>	Too Numerous To Count	<b>MPN</b>	Most Probable Number
<b>IU</b>	International Units	<b>CP Units</b>	cobalt-chloroplatinate units
<b>umhos/cm</b>	micromhos/cm	<b>NTU</b>	nephelometric turbidity units
<b>C</b>	degrees Celsius	<b>F</b>	degrees Fahrenheit
<b>meq</b>	milliequivalents	<b>lb.</b>	pound(s)
<b>g</b>	gram(s)	<b>kg</b>	kilogram(s)
<b>ug</b>	microgram(s)	<b>mg</b>	milligram(s)
<b>ml</b>	milliliter(s)	<b>l</b>	liter(s)
<b>m3</b>	cubic meter(s)	<b>ul</b>	microliter(s)

**<** less than - The number following the sign is the limit of quantitation, the smallest amount of analyte which can be reliably determined using this specific test.

**>** greater than

**J** estimated value - The result is  $\geq$  the Method Detection Limit (MDL) and  $<$  the Limit of Quantitation (LOQ).

**ppm** parts per million - One ppm is equivalent to one milligram per kilogram (mg/kg), or one gram per million grams. For aqueous liquids, ppm is usually taken to be equivalent to milligrams per liter (mg/l), because one liter of water has a weight very close to a kilogram. For gases or vapors, one ppm is equivalent to one microliter of gas per liter of gas.

**ppb** parts per billion

**Dry weight basis** Results printed under this heading have been adjusted for moisture content. This increases the analyte weight concentration to approximate the value present in a similar sample without moisture. All other results are reported on an as-received basis.

## U.S. EPA CLP Data Qualifiers:

### Organic Qualifiers

<b>A</b>	TIC is a possible aldol-condensation product
<b>B</b>	Analyte was also detected in the blank
<b>C</b>	Pesticide result confirmed by GC/MS
<b>D</b>	Compound quantitated on a diluted sample
<b>E</b>	Concentration exceeds the calibration range of the instrument
<b>N</b>	Presumptive evidence of a compound (TICs only)
<b>P</b>	Concentration difference between primary and confirmation columns $>25\%$
<b>U</b>	Compound was not detected
<b>X,Y,Z</b>	Defined in case narrative

### Inorganic Qualifiers

<b>B</b>	Value is $<CRDL$ , but $\geq IDL$
<b>E</b>	Estimated due to interference
<b>M</b>	Duplicate injection precision not met
<b>N</b>	Spike sample not within control limits
<b>S</b>	Method of standard additions (MSA) used for calculation
<b>U</b>	Compound was not detected
<b>W</b>	Post digestion spike out of control limits
<b>*</b>	Duplicate analysis not within control limits
<b>+</b>	Correlation coefficient for MSA $<0.995$

Analytical test results for methods listed on the laboratories' accreditation scope meet all requirements of NELAC unless otherwise noted under the individual analysis.

Measurement uncertainty values, as applicable, are available upon request.

Tests results relate only to the sample tested. Clients should be aware that a critical step in a chemical or microbiological analysis is the collection of the sample. Unless the sample analyzed is truly representative of the bulk of material involved, the test results will be meaningless. If you have questions regarding the proper techniques of collecting samples, please contact us. We cannot be held responsible for sample integrity, however, unless sampling has been performed by a member of our staff. This report shall not be reproduced except in full, without the written approval of the laboratory.

**WARRANTY AND LIMITS OF LIABILITY** - In accepting analytical work, we warrant the accuracy of test results for the sample as submitted. THE FOREGOING EXPRESS WARRANTY IS EXCLUSIVE AND IS GIVEN IN LIEU OF ALL OTHER WARRANTIES, EXPRESSED OR IMPLIED. WE DISCLAIM ANY OTHER WARRANTIES, EXPRESSED OR IMPLIED, INCLUDING A WARRANTY OF FITNESS FOR PARTICULAR PURPOSE AND WARRANTY OF MERCHANTABILITY. IN NO EVENT SHALL LANCASTER LABORATORIES BE LIABLE FOR INDIRECT, SPECIAL, CONSEQUENTIAL, OR INCIDENTAL DAMAGES INCLUDING, BUT NOT LIMITED TO, DAMAGES FOR LOSS OF PROFIT OR GOODWILL REGARDLESS OF (A) THE NEGLIGENCE (EITHER SOLE OR CONCURRENT) OF LANCASTER LABORATORIES AND (B) WHETHER LANCASTER LABORATORIES HAS BEEN INFORMED OF THE POSSIBILITY OF SUCH DAMAGES. We accept no legal responsibility for the purposes for which the client uses the test results. No purchase order or other order for work shall be accepted by Lancaster Laboratories which includes any conditions that vary from the Standard Terms and Conditions of Lancaster Laboratories and we hereby object to any conflicting terms contained in any acceptance or order submitted by client.