

Virgil Chavez Land Surveying
312 Georgia Street
Vallejo, California 94590
(707) 553-2476

4444
February 25, 1997
Project No. 1104-11A

Greg Guras
Gettler-Ryan, Inc.
3035 Prospect Park Dr., Ste 80
Rancho Cordova, Ca. 95670

Subject: Monitoring Well Survey
3220 Lakeshore Avenue
Oakland, Ca.

RECEIVED

3:55 pm, Mar 26, 2009

Alameda County
Environmental Health

Dear Greg:

This is to confirm that we have proceeded at your request to resurvey the ground water monitoring wells located at the above referenced location. The survey was performed on February 21, 1997. Our findings are shown in the table below. The benchmark used for the survey was a City of Oakland benchmark, being a cut square in the top of curb, at the northeasterly corner of Walker and Cheney Ave. Benchmark Elev. = 9.055' City Datum; add 3.00' to USGS datum.

Monitoring Well No.	Rim Elevation	Top of Casing Elevation
U - 1	8.81'	8.46'
U - 2	8.29'	7.66'
U - 3	10.99'	10.60'
U - 4	11.33'	11.15'
U - 5	7.42'	7.01'
U - 6	7.63'	7.14'

5.88

+1.26

+2.5

Sincerely,

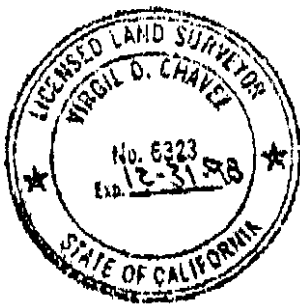

Virgil D. Chavez
Virgil D. Chavez, P.L.S. 6323
Virgil Chavez Land Surveying

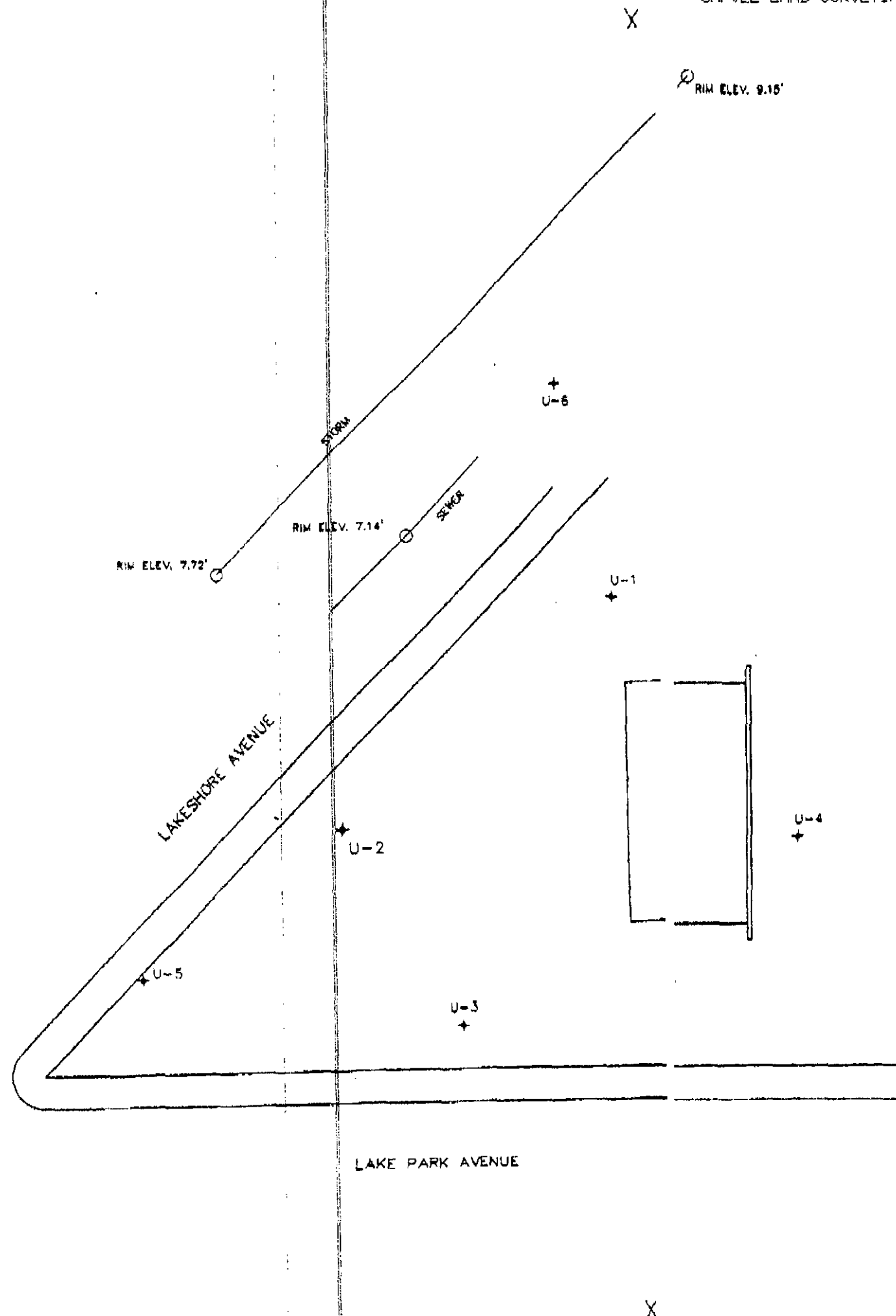

PARTIAL SITE PLAN
UNOCAL SERVICE STATION #6326
3220 LAKESHORE AVENUE
OAKLAND, CALIFORNIA

VIRGIL CHAVEZ LAND SURVEYING
312 GEORGIA STREET, #200
VALLEJO, CALIFORNIA

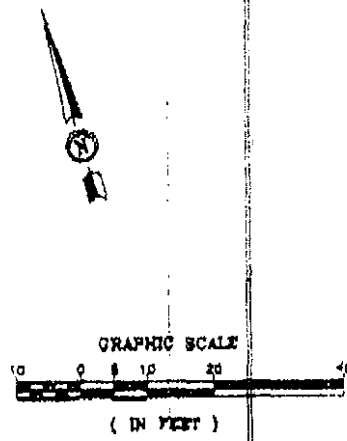



FACSIMILE COVER SHEET

TO: Dave DeWitt

COMPANY: 76 Products Company

FROM: Greg Guss/Steve Carter

DATE: 2/28/97

RE: Station # 5325 - Lakeshore, Oakland

COMMENTS: Corrections and additions to
Survey. Surveyor caught an error
in the rim elevation of one storm
drain manhole, and added flowline
data. Original in mail to our
office today. Call if you have
questions

Original to follow: No Yes, via: _____

Total pages including cover: 3

If there are any problems with this transmission, please call 916-631-1314

PARTIAL SITE PLAN
 UNOCAL SERVICE STATION #5325
 3220 LAKESHORE AVENUE
 OAKLAND, CALIFORNIA

SCALE 1"=30' FEBRUARY, 1997
 VIRGIL CHAVEZ LAND SURVEYING
 312 GEORGIA STREET, #200
 VALLEJO, CALIFORNIA
 (707) 553-2478

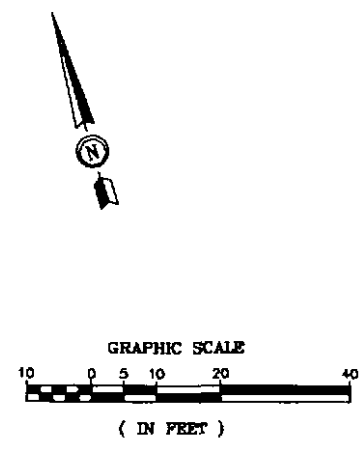
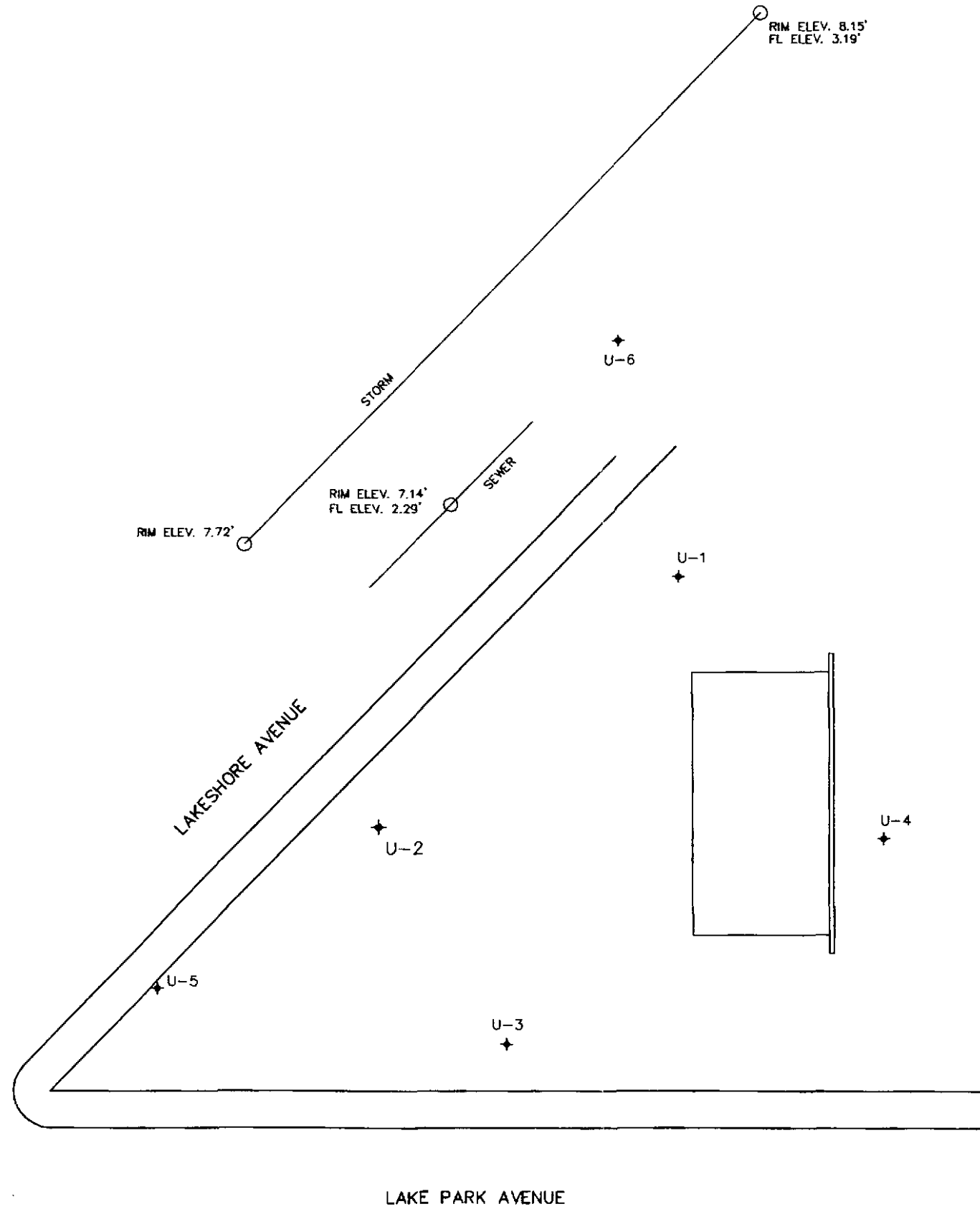

NOTE: ELEVATIONS SHOWN ARE ON CITY DATUM.

○ RIM ELEV. 5.31'
 FL ELEV. -5.75'